



52C09NE0021 11 FACTOR LAKE

010

Diamond Drilling

Area FACTOR LAKE

Report NO 11

Work performed by: ANTHONY RICH

Claim NO	Hole NO	Footage	Date	Note
TB 475157	81-1	203.0	Oct./81	(1)
	81-2	195.0	Oct./81	(1)

2DDH

398'

Notes: (1) #215-82

DIAMOND DRILL RECORD

PROPERTY MAYFLOWER

HOLE NO. 81-1

SHEET NUMBER 1

SECTION FROM 0 TO 51.0

STARTED 12 October 1981

LATITUDE _____

DATUM _____

COMPLETED 17 October 1981

DEPARTURE _____

BEARING 170°

ULTIMATE DEPTH 203

ELEVATION _____

DIP -45°

PROPOSED DEPTH 200

DEPTH FEET	FORMATION	SAMPLE NO.	WIDTH OF SAMPLE	GOLD †	SLUDGE GOLD ‡
0 - 5.5	Dark grey quartz-chlorite schist 2% quartz veins				
5.5 - 9.2	Grey-green quartz-chlorite schist (probably metasediments) intermittent 1/2" quartz veins - sporadic limonite staining				
9.2 - 12.5	Mostly quartz veins - limonitic, some host rock (10%)				
12.5 - 13.2	Brecciated host rock (5.5 - 9.2 above)				
13.2 - 15.0	Quartz vein				
15.0 - 17.2	Breccia (as above)				
17.2 - 32.2	Almost entirely quartz vein with some host rock. Occasional malachite stain. About 3% limonite (after pyrite)				
32.2 - 35.2	About 50-50 vein and grey brecciated quartz chlorite schist				
35.2 - 37.7	Vein similar to 17.2 - 32.2				
37.7 - 41.2	Grey-green chlorite-schist somewhat brecciated				
41.2 - 42.5	Lost core				
42.5 - 43.2	Rotten calcite quartz vein with about 20% limonite				
43.2 - 45.4	Grey green chlorite schist				
45.4 - 51.0	80% quartz vein - essentially barren and 20% brecciated host				

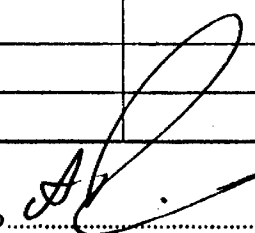
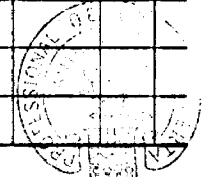
DIAMOND DRILL RECORD

PROPERTY _____

MAYFLOWER

HOLE NO. 81-1

SHEET NUMBER 2

SECTION FROM 51.0 TO 203.0

STARTED _____

LATITUDE _____

DATUM _____

COMPLETED _____

DEPARTURE _____

BEARING _____

ULTIMATE DEPTH _____

ELEVATION _____

DIP _____

PROPOSED DEPTH _____

DEPTH FEET	FORMATION	SAMPLE NO.	WIDTH OF SAMPLE	GOLD \$	SLUDGE GOLD \$
51.0 - 53.2	Epidotized quartz-chlorite-schist with 1% pyrite and 2% galena				
53.2 - 54.5	Barren quartz vein				
54.5 - 62.5	Grey-green epidotized and sheared quartz chlorite schist.				
62.5 - 64.2	More epidote				
64.2 - 67.0	Quartz vein 1% bright pyrite				
67.2 - 73.2	Epidotized quartz-chlorite-schist - brecciated 1-2% sulphides-pyrite pyrrhotite				
73.2 - 80.6	Light grey finely banded quartz-chlorite schist - less than 2% vein - 1% pyrite				
80.6 - 85.0	Lost core				
85.0 - 90.0	As above (schist)				
90.0 - 96.2	About 20-25% veining with pyrite (2%)				
96.2 - 105.2	Green grey quartz chlorite schist - slightly brecciated with 10% veining - 1% pyrite throughout				
105.2 - 112.1	Intense brecciated schist - 50% veining 2% pyrite				
112.1 - 113.9	50% vein 20% pyrite in vein material				
113.9 - 115.6	As 105.2 - 112.1				
115.6 - 203	Monotonous green grey chlorite schist - fine-banded weak veining				

N.M.P., TORONTO-STOCK FORM NO. 501 REV. 12/51

DRILLED BY C.D. HUSTON & SONS LIMITED

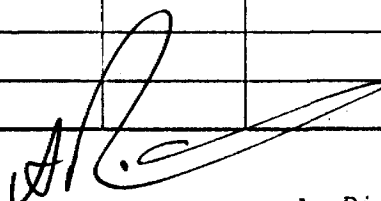
SIGNED  A. Rich. P.



DIAMOND DRILL RECORD

PROPERTY MAYFLOWER

HOLE NO. 81-2

SHEET NUMBER 1

SECTION FROM 0 TO 86.8

STARTED 18 October 1981

LATITUDE _____

DATUM _____

COMPLETED 23 October 1981

DEPARTURE _____

BEARING 150°

ULTIMATE DEPTH 195'

ELEVATION _____

DIP -45°

PROPOSED DEPTH 200'

DEPTH FEET	FORMATION	SAMPLE NO.	WIDTH OF SAMPLE	GOLD \$	SLUDGE GOLD \$
0 - 2.0	No core recovered				
2.0 - 16.0	Grey Metavolcanics - (quartz chlorite) sheared				
16.0 - 20.5	Green-Grey metavolcanics - quartz calcite veining throughout				
20.5 - 31.9	Intense veining quartz (calcite) - 70% of core Chalcopyrite 1% limonite 2%				
31.9 - 33.8	Green chloritic metavolcanics				
33.8 - 37.0	Vein similar to above (20.5-31.9)				
37.0 - 48.8	Approximately 15% vein material, in light-grey quartz-chlorite-schist (metasediment and possibly volcanic) approx. 1% pyrite in host rock.				
48.8 - 49.8	50% vein				
49.8 - 67.4	Grey metasediment (Quartz-chlorite-schist) similar to above 5% veining though intensely sheared, fractured and recemented.				
67.4 - 80.5	Quartz veins with 1% pyrite approx. 10% of core. Metasediment - (volcanic) as above with 1-2% pyrite except evidence of intense shearing and brecciation.				
80.5 - 84.4	as 49.8 - 67.4				
84.4 - 86.8	80% vein material with 2% pyrite				



DIAMOND DRILL RECORD

PROPERTY

MAYFLOWER

HOLE NO. 81-2

SHEET NUMBER 2

SECTION FROM 86.8 TO 195

STARTED _____

LATITUDE _____

DATUM _____

COMPLETED _____

DEPARTURE _____

BEARING _____

ULTIMATE DEPTH _____

ELEVATION _____

DIP _____

PROPOSED DEPTH _____

DEPTH FEET	FORMATION	SAMPLE No.	WIDTH OF SAMPLE	GOLD \$	SLUDGE GOLD \$		
86.8 - 106.1	Brown-grey quartz chlorite schist - probably metasedimentary - up to 5% pyrite in spots 5% vein material - barren quartz						
106.1 - 109.2	Intense shearing and brecciation 20% vein material						
109.2 - 113	Mixed dark and light grey schistose 'metasediments'						
113 - 195	- changing gradually until 122 feet to end of hole is monotonous, easily fractured quartz sericite schist						

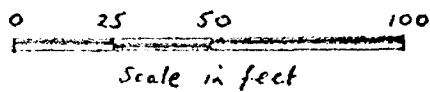
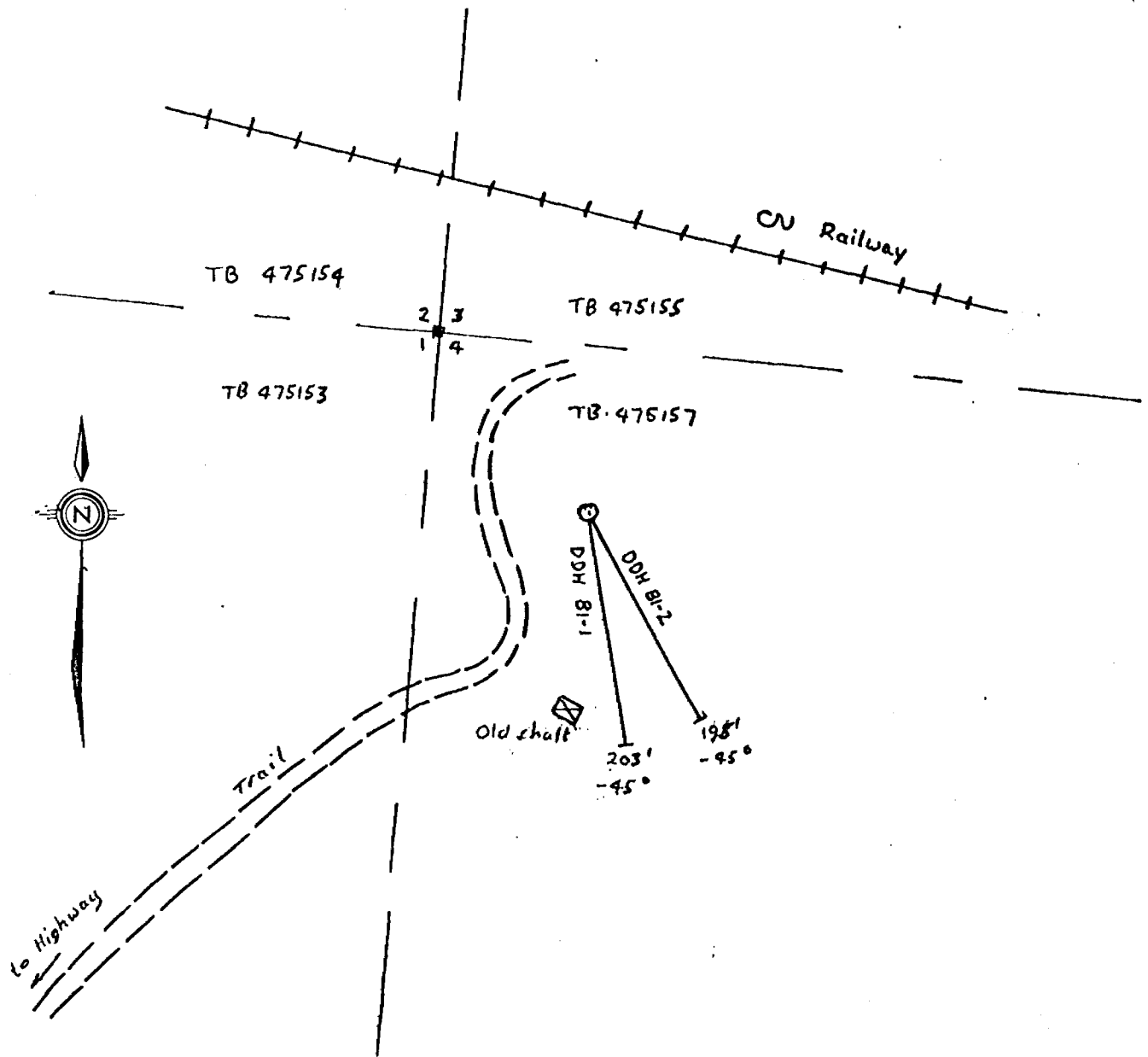

Sketch showing location of
Diamond Drill Holes

Drilling performed 11-23 October 1981 by
C.D. Huston & Sons Ltd. of Winnipeg.
J. DeCare, Port Frances, driller.
Map to accompany Report of Work dated
25 June 1982.

Anthony Rich
Anthony Rich, P.Geol.

