



SUMMARY REPORT
on
DIAMOND DRILL PROGRAM
on the
BAD VERMILION LAKE PROPERTY
MINE CENTRE AREA
NW ONTARIO

A series of eleven holes numbered BV-1 to BV-11, totalling 3,775 feet were logged on October 11, 12, 1988 for George Armstrong of Fort Frances, Ontario. These holes were all drilled on his Bad Vermilion Lake Property located between Shoal Lake and Bad Vermilion Lake, approximately 7 km south of Highway 11, south of Mine Centre, Ontario. These holes were drilled on patented claims K-74, K-75 and FF 2247. The core is stored in Fort Frances, Ontario.

All but two holes were drilled on FF 2247. Hole No.3 and No.4 were drilled on K-74 and K-75 respectively.

Holes 1,5,6,12 and 13 were drilled near the SE volcanic-trondhjemite contact and intersected both, mafic volcanic and trondhjemitic rocks. Holes 2,7,8,9,10 and 11 were drilled north of the volcanic-trondhjemite contact within the intrusive, intersected mostly intrusive trondhjemites and minor volcanics. Holes 3 and 4 intersected trondhjemite rocks only.

Chalcopyrite and pyrite mineralization was intersected in some holes within quartz ankerite veining.

Chalcopyrite and pyrite mineralization were noted in some of the quartz ankerite veining within the sheared and altered trondhjemitic rocks and to a lesser degree within the metavolcanics.

Gold values were obtained from these mineralized quartz-ankerite veinings.

R.A. Bernatchez, P.Eng.,
Consulting Geologist

OM88-3-T-C63

LEGEND

17b - Gabbro

10a - Conglomerates, Boulders-granule arenite, volcanic detritus dominant.

5b - Leuco-Trondhjemite

granodiorite, qtz monzonite

5c - Biotite Trondhjemite

5d - Hornblende biotite Trondhjemite

1a - Flows, mafic, unsubdivided

Symbols

○ Diamond drill hole No.

⊙ quartz vein

○ Tr. Trench or pit

Au - Gold

Ag - Silver

Cu - Copper

Zn - Zinc

Bi - Bismuth

Mo - Molybdenum

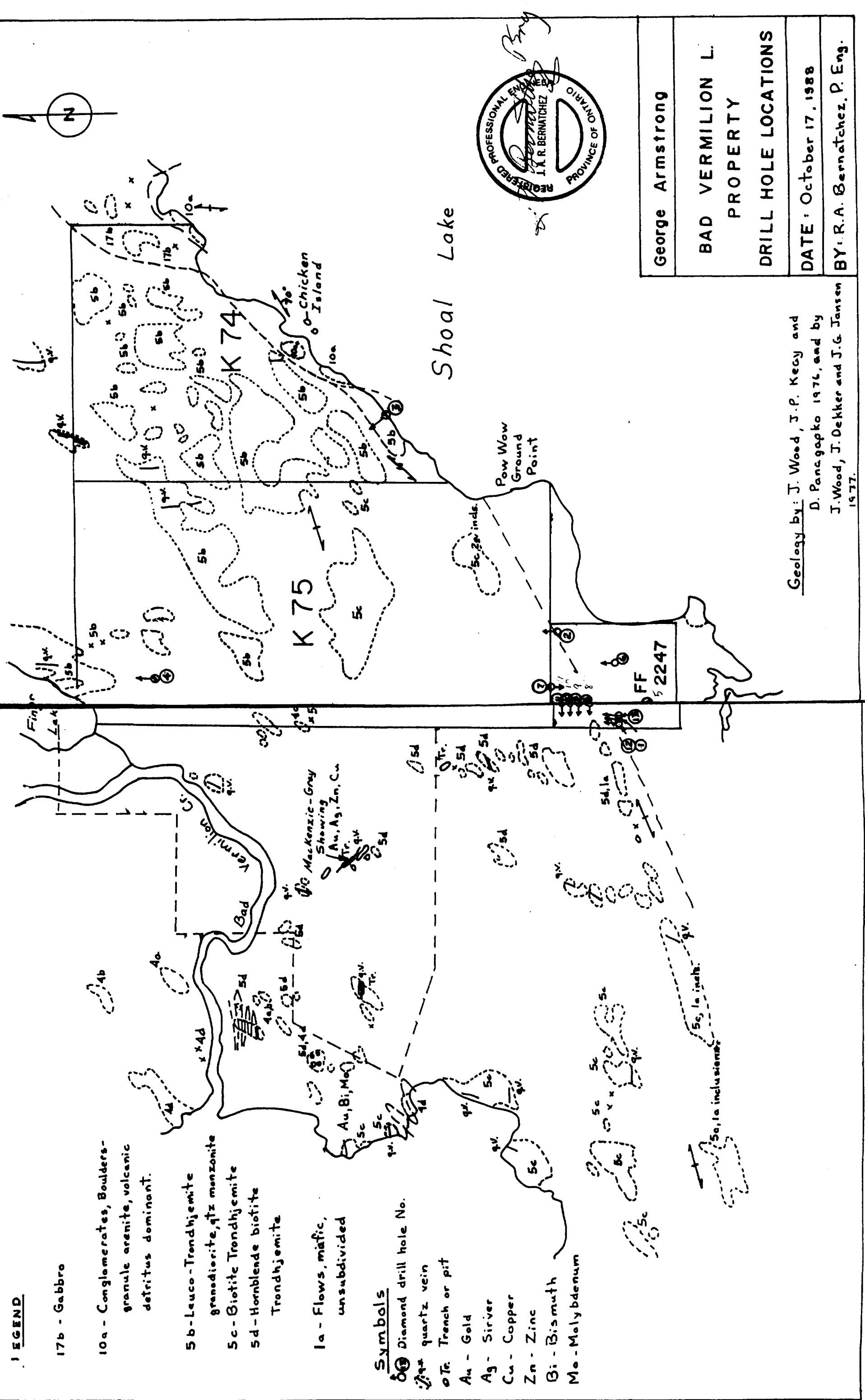

George Armstrong

BAD VERMILION L.
PROPERTY

DRILL HOLE LOCATIONS

DATE: October 17, 1988

BY: R.A. Bernatchez, P. Eng.

Geology by: J. Wood, J.P. Kegy and
D. Pancgopko 1976, and by
J. Wood, J. Dekker and J.G. Jansen
1977.



BELL - WHITE ANALYTICAL LABORATORIES LTD.

P.O. BOX 187.

HAILEYBURY, ONTARIO

TEL: 672-3107

Certificate of Analysis

NO. 1282

DATE: July 26, 1988

SAMPLE(S) OF: Core (1)

RECEIVED: July 1988

SAMPLE(S) FROM: Mr. George Armstrong

<u>Sample No.</u>	<u>Oz. Gold</u>	<u>Oz. Silver</u>	<u>Cu ppm</u>
BV-9-4-1000 *Estimated	Trace	0.02*	1800

hole# Box# sample#

BELL-WHITE ANALYTICAL LABORATORIES LTD.

P. R.

IN ACCORDANCE WITH LONG-ESTABLISHED NORTH AMERICAN CUSTOM, UNLESS IT IS SPECIFICALLY STATED OTHERWISE GOLD AND SILVER VALUES REPORTED ON THESE SHEETS HAVE NOT BEEN ADJUSTED TO COMPENSATE FOR LOSSES AND GAINS INHERENT IN THE FIRE ASSAY PROCESS.



BELL - WHITE ANALYTICAL LABORATORIES LTD.

P.O. BOX 187,

HAILEYBURY, ONTARIO

TEL: 672-3107

Certificate of Analysis

NO. 1174

DATE: July 6, 1988

SAMPLE(S) OF: Rock (5)

RECEIVED: June 1988

SAMPLE(S) FROM: Mr. George Armstrong

<u>Sample No.</u>	<u>Ag ppm</u>	<u>Co ppm</u>
BV-7-10	1.0	
BV-1-13	0.8	22
<i>trenches</i> { HD -900	1.8	
HD -901	1.4	
HD -902	3.6	90

IN ACCORDANCE WITH LONG-ESTABLISHED NORTH AMERICAN CUSTOM, UNLESS IT IS SPECIFICALLY STATED OTHERWISE GOLD AND SILVER VALUES REPORTED ON THESE SHEETS HAVE NOT BEEN ADJUSTED TO COMPENSATE FOR LOSSES AND GAINS INHERENT IN THE FIRE ASSAY PROCESS.

BELL-WHITE ANALYTICAL LABORATORIES LTD.

PER 



BELL-WHITE ANALYTICAL LABORATORIES LTD.

P.O. BOX 187,

HAILEYBURY, ONTARIO

TEL: 672-3107

Certificate of Analysis

NO. 1187

DATE: July 8, 1988

SAMPLE(S) OF: Core (7)

RECEIVED: July 1988

SAMPLE(S) FROM: Mr. George Armstrong, FORT FRANCES, Ontario

<u>Sample No.</u>	<u>Oz. Gold</u>	<u>Oz. Silver</u>
BV-8-1A	Trace	Trace
BV-8-1B	Trace	Trace
BV-8-2	Trace	Trace
BV-8-10A	Trace	Trace
BV-8-10B	0.002*	0.10
BV-8-10C	0.006	0.07
BV-8-10D	Trace	Trace

* Estimated

NOTE: Base metal results will follow at a later date.

BELL-WHITE ANALYTICAL LABORATORIES LTD.



BELL - WHITE ANALYTICAL LABORATORIES LTD.

P.O. BOX 187,

HAILEYBURY, ONTARIO

TEL: 672-3107

Certificate of Analysis

NO. 1170

DATE: July 6, 1988

SAMPLE(S) OF: Rock (5)

RECEIVED: June 1988

SAMPLE(S) FROM: George Armstrong

<u>Sample No.</u>	<u>Oz. Gold</u>	<u>Oz. Silver</u>
BV-7-10	Trace	Trace
BV-1-13	Trace	Trace
<i>Tranches</i> { HD -900	0.002*	Trace
HD -901	0.002*	0.03
HD -902	0.002*	0.02

*Estimated

IN ACCORDANCE WITH LONG-ESTABLISHED NORTH AMERICAN CUSTOM, UNLESS IT IS SPECIFICALLY STATED OTHERWISE GOLD AND SILVER VALUES REPORTED ON THESE SHEETS HAVE NOT BEEN ADJUSTED TO COMPENSATE FOR LOSSES AND GAINS INHERENT IN THE FIRE ASSAY PROCESS.

BELL-WHITE ANALYTICAL LABORATORIES LTD.

PER 



BELL - WHITE ANALYTICAL LABORATORIES LTD.

P.O. BOX 187.

HAILEYBURY, ONTARIO

TEL: 672-3107

Certificate of Analysis

NO. 961

DATE: May 31, 1988

SAMPLE(S) OF: Rock (2)

RECEIVED: May 1988

SAMPLE(S) FROM: Mr. George Armstrong

Sample No.

Oz. Gold

Oz. Silver

Teachen { H1-10
H2-12

0.844**
0.010

1.09
0.06

** Checked

Copper 1.4090 percent

IN ACCORDANCE WITH LONG-ESTABLISHED NORTH AMERICAN CUSTOM, UNLESS IT IS SPECIFICALLY STATED OTHERWISE GOLD AND SILVER VALUES REPORTED ON THESE SHEETS HAVE NOT BEEN ADJUSTED TO COMPENSATE FOR LOSSES AND GAINS INHERENT IN THE FIRE ASSAY PROCESS.

BELL-WHITE ANALYTICAL LABORATORIES LTD.

PER 



BELL - WHITE ANALYTICAL LABORATORIES LTD.

P.O. BOX 187,

HAILEYBURY, ONTARIO

TEL: 672-3107

Certificate of Analysis

NO. 1244

DATE: July 19, 1988

SAMPLE(S) OF: Rock (3)

RECEIVED: July 1988

SAMPLE(S) FROM: Mr. George Armstrong, FORT FRANCES

<u>Sample No.</u>	<u>Oz. Gold</u>	<u>Oz. Silver</u>
BV-6-1-A	0.002	0.02*
BV-6-3-A	0.002	0.03*
BV-6-4-B	0.002*	0.02*

*Estimated

IN ACCORDANCE WITH LONG-ESTABLISHED NORTH AMERICAN CUSTOM, UNLESS IT IS SPECIFICALLY STATED OTHERWISE GOLD AND SILVER VALUES REPORTED ON THESE SHEETS HAVE NOT BEEN ADJUSTED TO COMPENSATE FOR LOSSES AND GAINS INHERENT IN THE FIRE ASSAY PROCESS.

BELL-WHITE ANALYTICAL LABORATORIES LTD.

PER 



BELL - WHITE ANALYTICAL LABORATORIES LTD.

P.O. BOX 187.

HAILEYBURY, ONTARIO

TEL: 672-3107

Certificate of Analysis

NO. 0883

DATE: May 13, 1988

SAMPLE(S) OF: Rock (1)

RECEIVED: May 1988

SAMPLE(S) FROM: Mr. George Armstrong, FORT FRANCES, Ontario

Sample No.

Oz. Gold

Oz. Silver

1000
BV 61

0.220**

0.05

** Checked

BELL-WHITE ANALYTICAL LABORATORIES LTD.

PER 

IN ACCORDANCE WITH LONG-ESTABLISHED NORTH AMERICAN CUSTOM, UNLESS IT IS SPECIFICALLY STATED OTHERWISE GOLD AND SILVER VALUES REPORTED ON THESE SHEETS HAVE NOT BEEN ADJUSTED TO COMPENSATE FOR LOSSES AND GAINS INHERENT IN THE FIRE ASSAY PROCESS.



BELL - WHITE ANALYTICAL LABORATORIES LTD.

P.O. BOX 187, HAILEYBURY, ONTARIO TEL: 672-3107

Certificate of Analysis

NO. 1231

DATE: July 18, 1988

SAMPLE(S) OF: Core (3)

RECEIVED: July 1988

SAMPLE(S) FROM: Mr. George Armstrong

<u>Sample No.</u>	<u>Oz. Gold</u>	<u>Oz. Silver</u>
BV-8-10-100	Trace	Trace
BV-8-11-200	Trace	Trace
BV-8-08-300	Trace	Trace

IN ACCORDANCE WITH LONG-ESTABLISHED NORTH AMERICAN CUSTOM, UNLESS IT IS SPECIFICALLY STATED OTHERWISE, GOLD AND SILVER VALUES REPORTED ON THESE SHEETS HAVE NOT BEEN ADJUSTED TO COMPENSATE FOR LOSSES AND GAINS INHERENT IN THE FIRE ASSAY PROCESS.

BELL-WHITE ANALYTICAL LABORATORIES LTD.

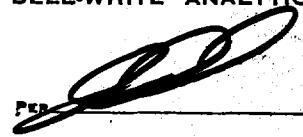
PER _____



BELL - WHITE ANALYTICAL LABORATORIES LTD.

P.O. BOX 187,

HAILEYBURY, ONTARIO

TEL: 672-3107

Certificate of Analysis

NO. 1139

DATE: July 1, 1988

SAMPLE(S) OF: Rock (5)

RECEIVED: June 1988

SAMPLE(S) FROM: Mr. George Armstrong

Sample No.

Oz. Gold

Oz. Silver

BV-4-16

Trace

Trace

BV-90-A

Trace

Trace

BV-90-B

Trace

Trace

BV-90-C

Trace

Trace

BV-98

Trace

Trace

5 samples

Per _____



Drilling Company: LARRY ARMSTRONG CONSTRUCTION COMPANY
 Date Hole Started: May 4, 1988
 Date Completed: May 10, 1988
 Exploration Co., Owner or Optionee: George Armstrong

Collar Elevation Surface: Oct. 11/88
 Date Logged: Oct. 11/88
 Date Submitted: R.A. Bernatchez, P. Eng.
 Logged by: Submitted by (Signature)

Total Footage: 412'

Dip of Hole at Collar: _____

Location of hole in relation to a fixed point on the claim: _____

Map Reference No.: _____
 Location (Twp., Lot, Con. or Lat. and Long.): Mine Center Area
 Property Name: Bad Vermillion

Footage From To	Rock Type	Description Colour, grain size, texture, minerals, alteration, etc.	Planar Feature Angle *	Core Specimen Footage †	Your Sample No.	Sample Footage		Assays †
						From	To	
0 16.5	overburden							
16.5 40.6	meta volcanic (tuffs?)	dark green, porphyroblastic, foliated at 75° to core scattered disseminated grains of py, cp, 2%, 1/4" qtz. ankerite veinlets ptigmatic folding of q.c.v. at 38°. 5%-10% veining from 37.0' to 40.6' intrusive contact at 40.6'						
40.6 60.0	hornblende qtz biotite trondh- jemite partially altered to sericite and sericite schist	grey-green, qtz eyes med. grained, well foliated (70° to core axis at 42.0', 50° at 58.0'). jointing filled with chlorite, rock contains about 20% hornblende, alteration consists of sericite, hematite and carbonatization (ankerite) some sericite schist near the qtz veining from 45.0'-46.0' (70% qtz ank. veining) sericite schist contains diss. py and minor tourmaline, fuchsite observed in sericite schist at 45.5' with qtz veining						
60.0 62.0	hornblende qtz biotite trondh- jemite	same as above except less altered and med to coarse-grained; scattered diss. pyrite (1/2%) and occ. py seam. Hematite alteration from 61.5' to 62.0'						
62.0 63.5	mafic vol. (inclusion)	green, med. to fine-grained sheared and foliated						
63.5 72.4	laucocratic trondhjemite	light flesh-coloured and green streaks and patches with qtz eyes foliation and hornblende content increases from 63.5' to 72.4' scattered grains of pyrite, weakly sericitic and hematized from 68.0' to 70.5'						
72.4 77.0	mafic vol. (inclusion)	green, fine-grained and foliated						

* For features such as foliation, bedding, schistosity, measured from the long axis of the core.
 † Additional credit available. See Assessment Work Regulations.



Drilling Company		Collar Elevation	Bearing of hole from true North	Total Footage	Dip of Hole at		Location of hole in relation to a fixed point on the claim.	Map Reference No.	Claim No. 2247	
From	To	Date Logged	Logged by	Collar						
LARRY ARMSTRONG CONSTRUCTION COMPANY										
Date Hole Started		Date Completed	Date Submitted	Submitted by (Signature)						
Exploration Co., Owner or Optionee		George Armstrong								
Footage		Rock Type	Description		Planar Feature Angle °	Core Specimen Footage †	Your Sample No.	Sample Footage	Sample Length	Assays †
			Colour, grain size, texture, minerals, alteration, etc.					From	To	
77.0	80.3	leucotrochjemitite	light green, coarse-grained equigranular moderately altered, sericitic, hematized and chloritic foliated, scattered grains of pyrite (1%) seams of cp and py, ankerite veinlets up to 1/4" qtz-ankerite vein, some foliation near 80.0'							
80.3	99.0	mafic metavolcanic	green, dark green, fine-grained, foliation - 60° at 90.0', 65° at 97.0', scattered qtz-ankerite veining throughout, Mostly parallel to foliation, pigmatic folding of veining.							
99.0	348.2	hornblende qtz tronchjemitite	light grey-green, coarse-grained, light to mod. foliation, 15-20% hornblende, 20-25% qtz, mod. hematitic and sericitic alteration, slightly foliated. Mod to fine-grained texture from 294.5' to 304.0' carbonatized zones from 296.0' to 298.5', hematized zone from 314.5' to 327.0', qtz-ankerite vein (2") 329.0							
348.2	344.0	mafic metavolcanic	green, fine-grained, sheared, foliated (50% to core) at 350', qtz-ank. vein 352.5' to 353.0'							
344.0	376.5	hornblende-qtz tronchjemitite	light grey-green, coarse-grained foliated (60° to core at 375') silicified, sericitized and carbonatized. Silicification gives off grey colour to rock from 336.5' to 384.1' qtz-ankerite veining from 384.1' to 390.0' (79% qtz veining) with 10-15% cp-py mineralization and up to 40% between 388' and 389'							
376.5	412.0	altered hornblende qtz tronchjemitite	light grey, med to coarse-grained, mod. foliated and altered. Silicified and sericitic section from 399.2 to 400.0 with tourmaline and minor cp (1%)							
		END OF HOLE 412.0'								
		Property Name								
		Location (Twp., Lot, Con. or Lat. and Long.)								

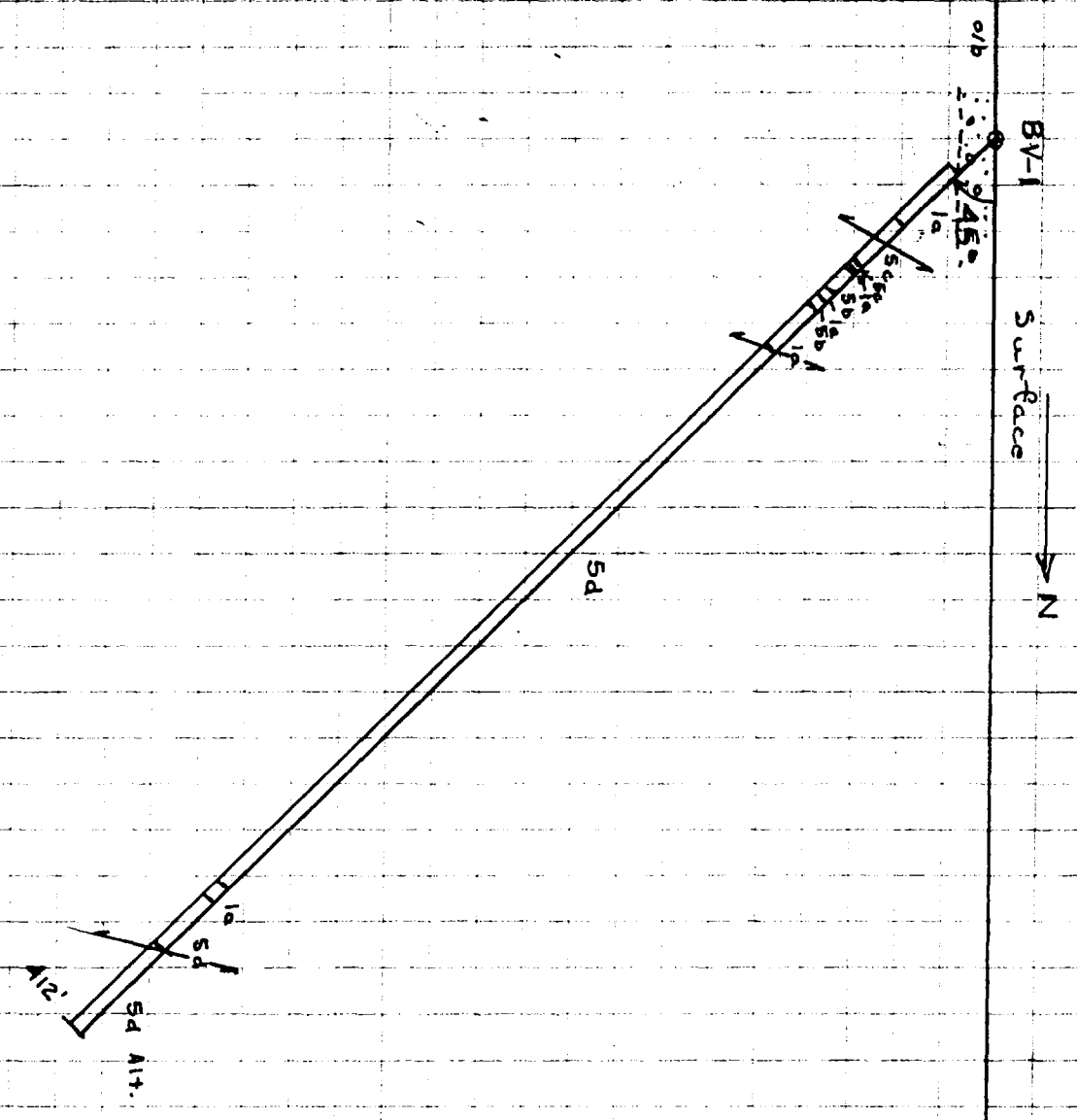

GEORGE ARMSTRONG
 BAD VERMILION LAKE PROPERTY

DDH Section

BV-1

Scale: 1" = 60'

Date: October 17, 1988

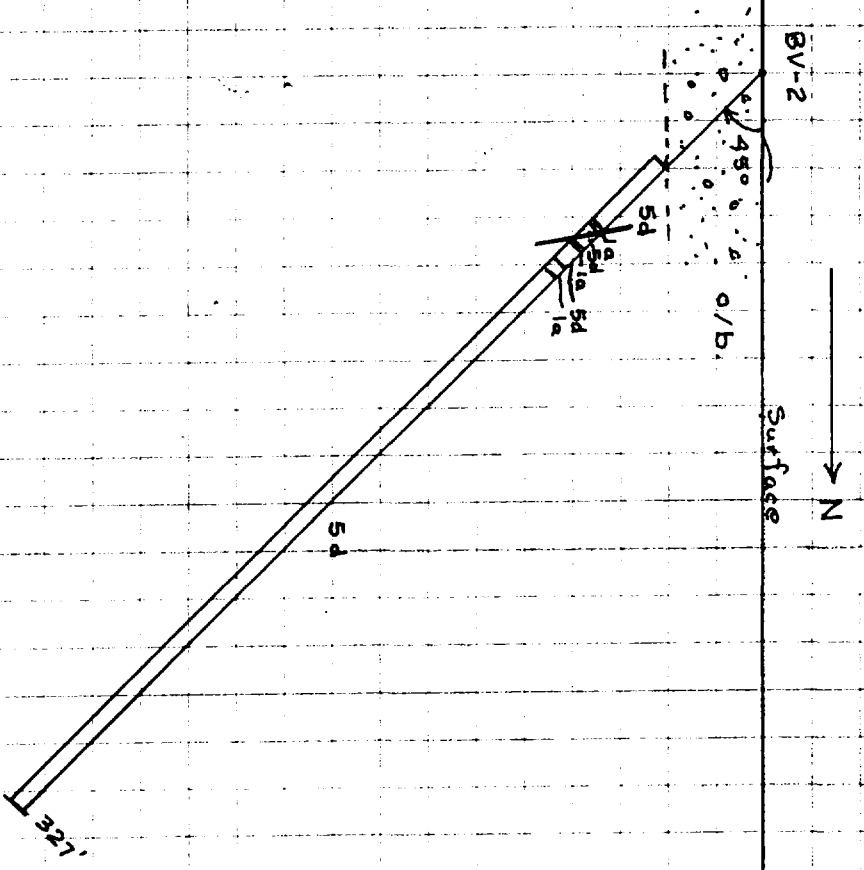

GEORGE ARMSTRONG
 BAD VERMILLION LAKE PROPERTY

DDH Section

BV-2

Scale: 1" = 60'

Date: October 17, 1988



Ontario

Ministry of
Natural
Resources

Diamond
Drilling
Log

Fill in on
every page

Hole No. BV-3
Page No. 1 of 1

Drilling Company
LARRY ARMSTRONG CONSTRUCTION COMPANY

Collar Elevation
Surface
Date Logged
Date Submitted

Bearing of hole from
true North
northwest

Total Footage
442'

Map Reference No.
Location (Twp., Lot, Con. or Lat. and Long.)
Property Name
Bad Vermillion Lake

Date Hole Started
May 17, 1988

Date Completed
May 25, 1988

Dip of Hole at
Collar
45°

Location of hole in relation to a
fixed point on the claim.

Claim No. K - 74

Exploration Co., Owner or Optionee
George Armstrong

Date Logged
Oct. 11/88

Logged by
R.A. Bernatchez, P. Eng.
Submitted by (Signature)
R.A. Bernatchez

Planar
Feature
Angle °

Core
Specimen
Footage †

Footage
From To

Rock Type
overburden

Description
Colour, grain size, texture, minerals, alteration, etc.

Your
Sample No.

Sample Footage
From To
Sample Length
Assays †

0 4.0

hornblende qtz
tronchjemite

grey-green to rusty brown qtz eyes (3-5mm) well foliated
sections, carbonatized, sericitized qtz-ankerite veining with py
veining - 11.9' to 12.3', 57.2' - 57.7', 60.0 - 60.6', 62.0',
156.0'. Intense alteration and shearing from 22.0' to 156.0'

156.4 442.0

hornblende
tronchjemite
grading to horn-
blende-qtz
tronchjemite

grey to grey-green, med - fine-grained, and more mafic to less
mafic, moderately foliated (60° to core) gradational contact at
156.4 Carbonatized, hematized zone around 200.0' foliation
(55° to core), diss. pyrite (2% to 1%) scattered qtz-ank vein
325.5 to 325.7 with diss. and seam of pyrite
Carbonatized zone from 422.0' to 442.0', hornblende altered to
chlorite, section contains large qtz eyes 3 to 5 mm, diss. py
(~1%) moderately foliated 424.0' - 65°, 1" qtz-ank tourmaline
vein at 432.7 (20° to core axis)

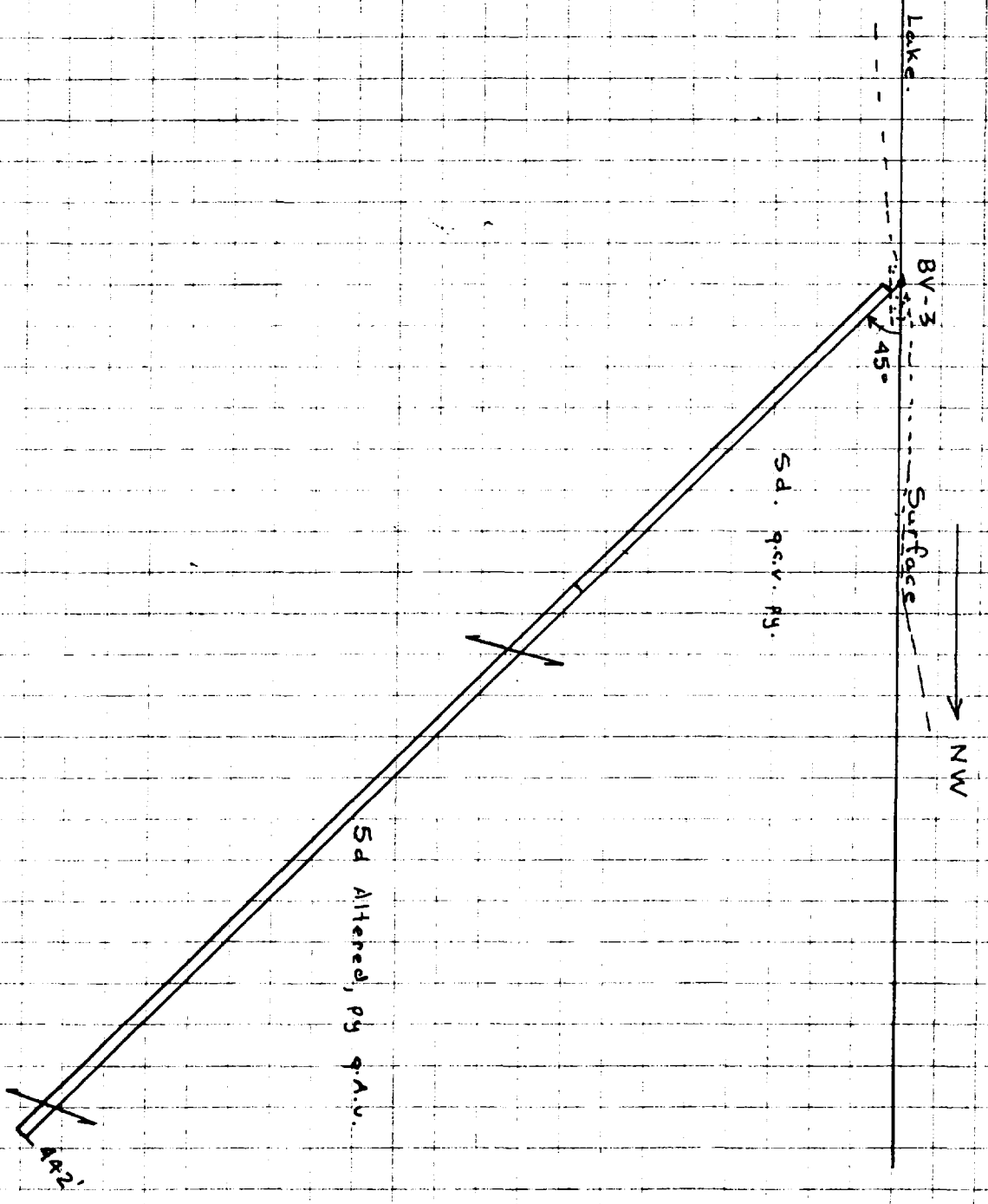

GEORGE ARMSTRONG
 BAD VERMILION LAKE PROPERTY
 DDH Section

BV-3

Scale: 1" = 60'

Date: October 17, 1988

BV-4 Surface → N

450

5b, carb, hem, ser, q.c.v.

407
q.c.v.

GEORGE ARMSTRONG
BAD VERMILLION LAKE PROPERTY

DDH Section

BV-4

Scale: 1" = 60'

Date: October 17, 1988

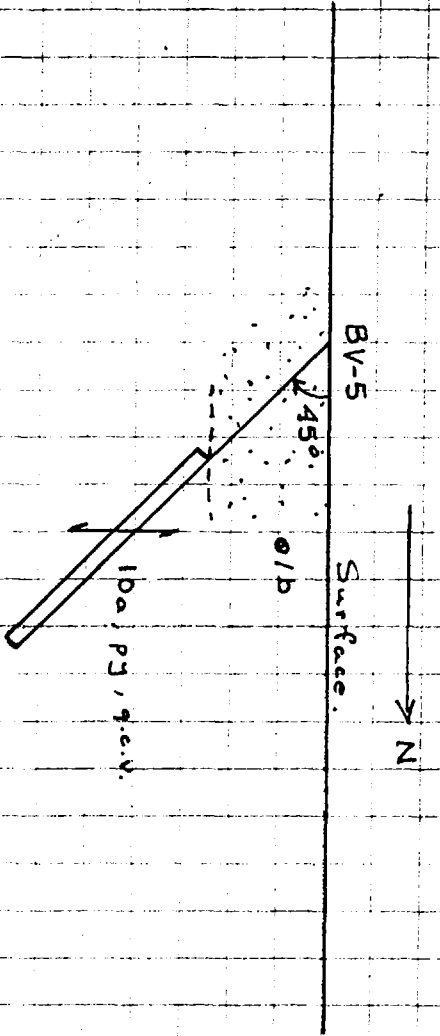

GEORGE ARMSTRONG
 BAD VERMILION LAKE PROPERTY

DDH Section

BV-5

Scale: 1" = 60'

Date: October 17, 1988



Drilling Company		Collar Elevation	Bearing of hole from true North	Total Footage	Dip of Hole at		Location of hole in relation to a fixed point on the claim.	Map Reference No.	Location (Twp., Lot, Con. or Lat. and Long.)		Assays †
Date Hole Started	Date Completed	Date Logged	Logged by	Collar	Fl.	Fl.		Property Name	Sample Footage From	Sample Length	
Exploration Co., Owner or Optionee		Date Submitted	Submitted by (Signature)								
Footage From	To	Rock Type	Description Colour, grain size, texture, minerals, alteration, etc.								
144.1	199.3	granodiorite	1gt grey with green streaks of hornblende altered to chlorite, med. grained foliated 60° to core axis. Pervasive ankerite, sericite alteration scattered irregular ankerite veinlets with occ'l grains of pyrite								
199.3	202.0	mafic metavolcanic	green, med to fine grained with scattered 1" ankerite veins near contacts, some occ'l py grains with veinlets. Foliation 62° to core axis at 201.0'								
202.0	238.5	granodiorite to qtz. diorite	beige to 1gt green with scattered ankeritic alteration, hornblende altered to chlorite, chlorite along joint fractures, foliation 55° to core axis. Moderately to highly altered zones with ankeritic alteration with diss. sulphides (1/2% to 1%) as diss. and seams from 212' to 214'								
238.5	242.7	diorite	fine-grained, 1gt green to grey with dark green streaks of chlorite, foliation 60° to core								
242.7	247.0	chlorite schist with qtz-ankerite veins and pyrite	grey, beige, foliated, with qtz ankerite veining with tourmaline, pyrite (2-5%)								
247.0	350.8	quartz diorite	grey, beige, med to coarse-grained 2-4mm qtz eyes, pervasive ankeritic alteration with occ'l seams of pyrite. Scattered 1/8" to 1/2" qtz-ankerite veinlets throughout. Narrow mafic dyke from 318.7 to 319.5, fine-grained, grey-beige with 3" qtz-ankerite vein and pyrite (1/2%)								
350.8	351.5	mafic metavolcanic	fine-grained, green foliated								
351.5	352.3	diorite	as above from 247.0 to 350.8								



Fill in on every page

Hole No. BY-6

Page No. 3 of 3

Drilling Company		Collar Elevation	Bearing of hole from true North	Total Footage	Dip of Hole at Collar		Location of hole in relation to a fixed point on the claim.	Map Reference No.	Property Name	Location (Twp., Lot, Con. or Lat. and Long.)	Assays ↓			
Date Hole Started	Date Completed	Date Logged	Logged by	Submitted by (Signature)	Collar	Planar Feature Angle *		Core Specimen Footage †				Your Sample No.	Sample Footage From To	Sample Length
Exploration Co., Owner or Optionee	Date Submitted	Fl.			Sample Footage From To									
Footage From To		Rock Type		Description Colour, grain size, texture, minerals, alteration, etc.										
352.3	365.3	mafic		fine-grained, lgt green, foliated, drk green hornblende xtl, qtz ankerite vein from 361.9 to 362.6. Fragmental or vesicular zone from 352.3' to 353.0' light green vesicles with dark green matrix										
		metavolcanic												
365.3	377.0	qtz diorite		grey with drk green hornblende streaks, med-grained, qtz eyes, diss. pyrite										
377.0	408.6	mafic meta-volcanic vesicular		green, lgt green oval patches 8-10mm long, 3 to 5mm thick, foliated qtz ankerite veinlets, 3" vein at 382.0' contains 40% sulphides with 3-5% cp. Missing core 389.7' to 400.7'										
408.6	427.0	quartz diorite		grey-beige, coarse-grained, weakly foliated at 55° to core. Micro fracturing with chlorite, occ'l grains of pyrite										

R.A. Bernath

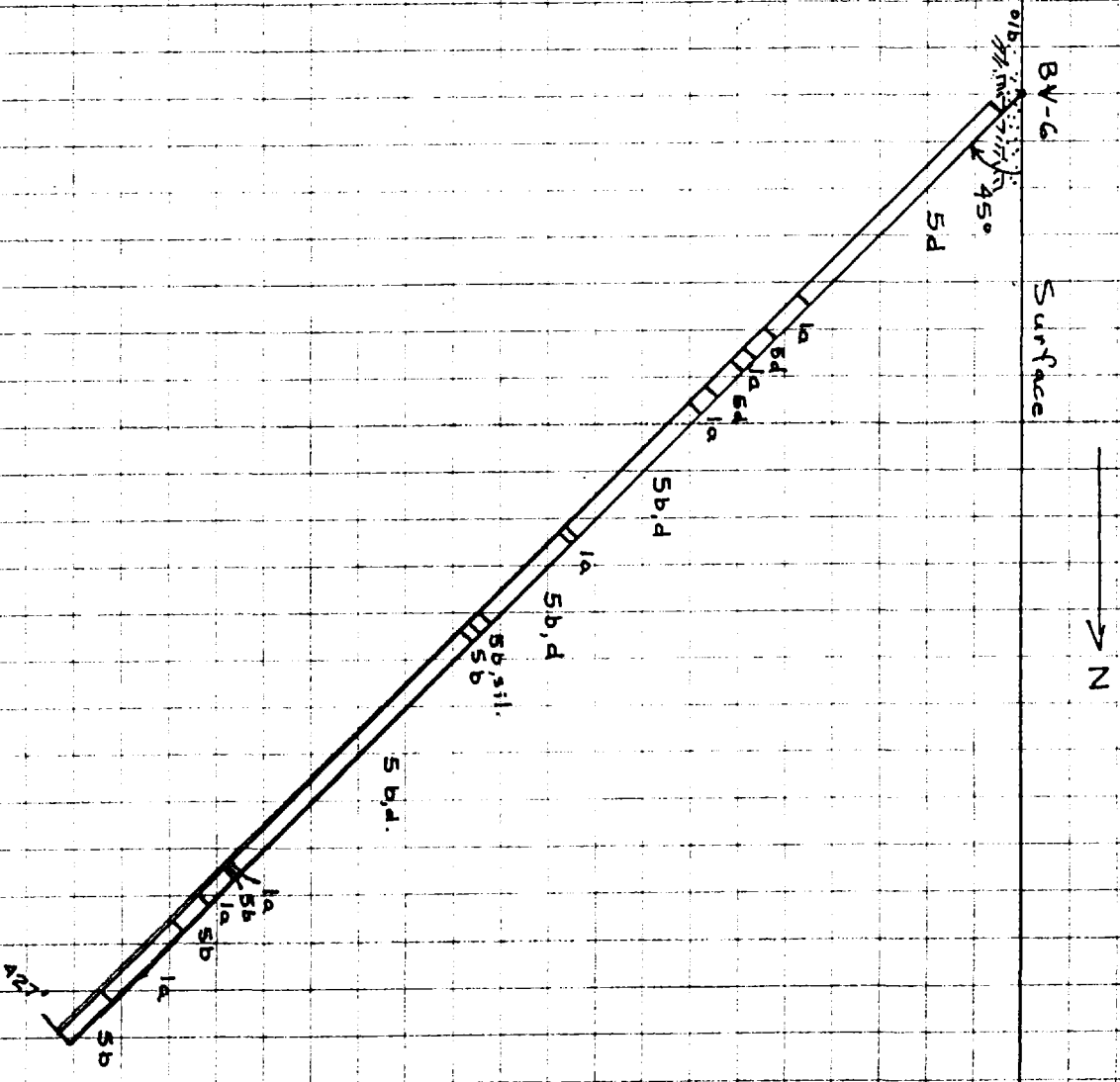

GEORGE ARMSTRONG
 BAD VERMILION LAKE PROPERTY

DDH Section
 BY-6

Scale: 1" = 60'
 Date: October 17, 1988

S

BV-7

Surface

45°

o/b

ARMSTRONG

Sd, carb, ser, q.c.v. sil. ps

Sb, ser, sil, py q.c.v. py cp

Sb, carb, q.c.v.

Sb, q.c.v.

407'

GEORGE ARMSTRONG

BAD VERMILLION LAKE PROPERTY

DDH Section

BV-7

Scale: 1" = 60'

Date: October 17, 1988

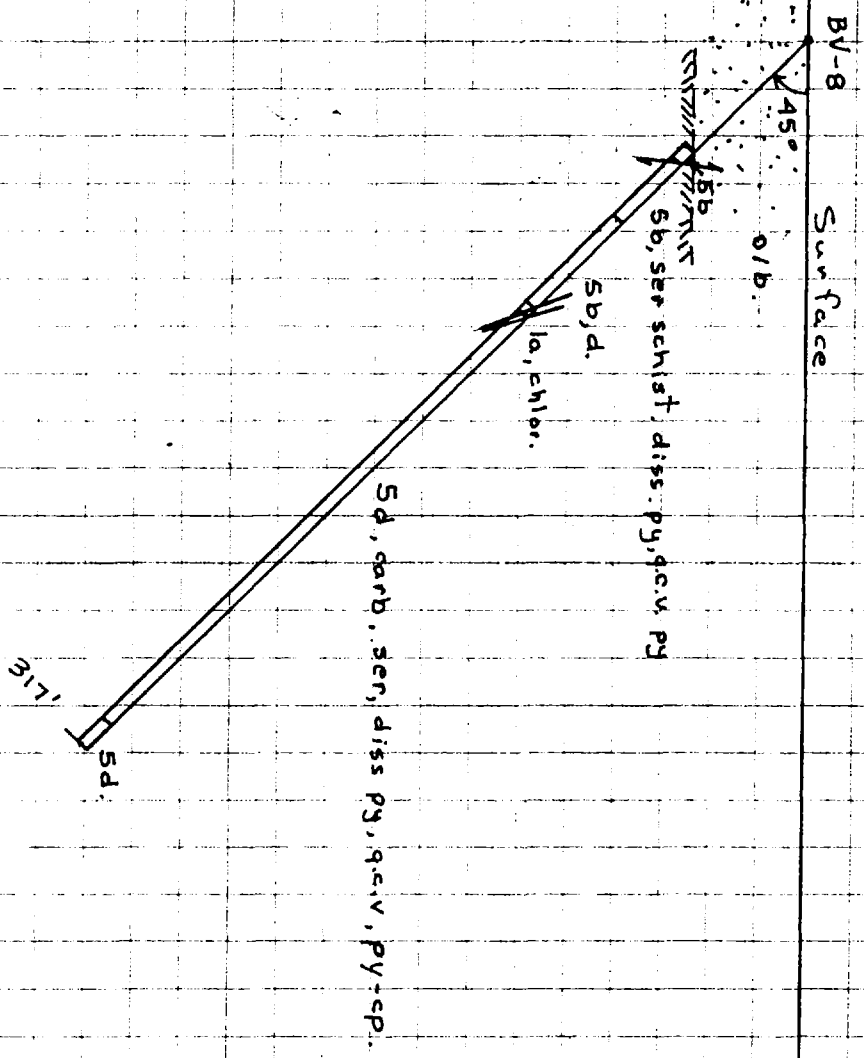

GEORGE ARMSTRONG

BAD VERMILION LAKE PROPERTY

DDH Section

BV-8

Scale: 1" = 60'

Date: October 17, 1988

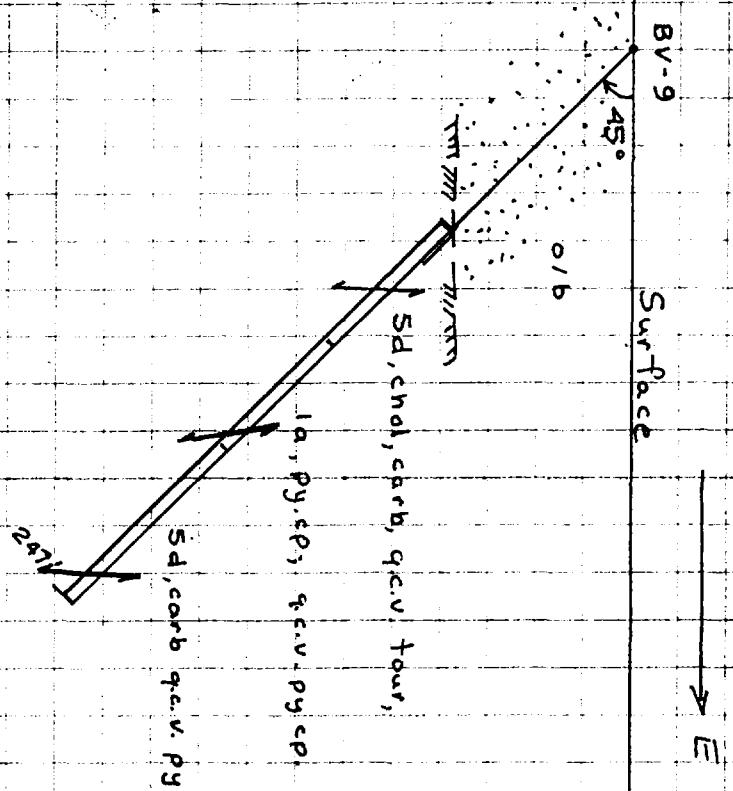

GEORGE ARMSTRONG
 BAD VERMILION LAKE PROPERTY

DDH Section
 BV-9

Scale: 1" = 60'
 Date: October 17, 1988

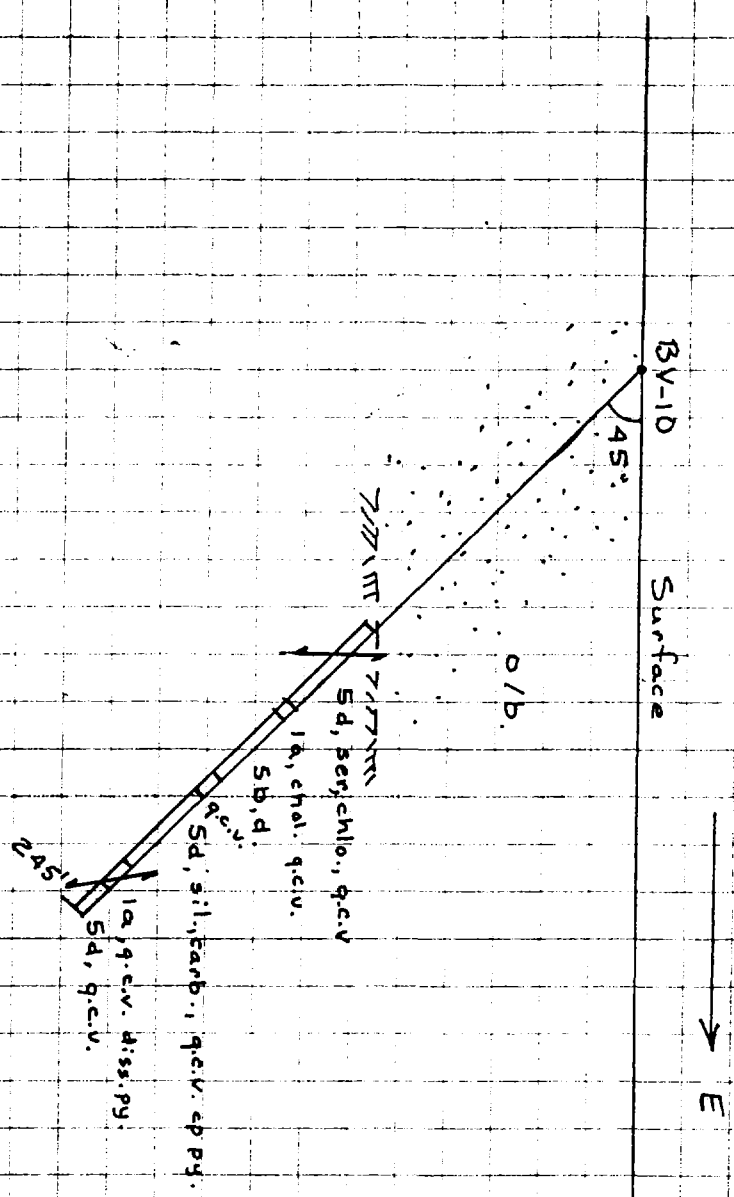

GEORGE ARMSTRONG
 BAD VERMILION LAKE PROPERTY

DDH Section

BV-10

Scale: 1" = 60'

Date: October 17, 1988



Ministry of
Natural Resources
**Diamond
Drilling
Log**

Ontario

Drilling Company **LARRY ARMSTRONG CONSTRUCTION COMPANY**

Date Hole Started **July 18, 1988** Date Completed **July 25, 1988**

Exploration Co., Owner or Optionee **George Armstrong**

Collar Elevation **Surface** Bearing of hole from True North **east** Total Footage **407'**

Date Logged **Oct. 12/88** Logged by **R.A. Bernatchez, P. Eng.**

Date Submitted Submitted by (Signature) *R.A. Bernatchez, P. Eng.*

Dip of Hole at Collar **45°**

Footage From To	Rock Type	Description Colour, grain size, texture, minerals, alteration, etc.	Location of hole in relation to a fixed point on the claim.	Map Reference No.	Claim No.	Hole No.	Page No.
0	overburden						
77.0	hornblende Qtz trondbjemite	pinkish grains scattered throughout in a lgt green to grey matrix of hornblende, Qtz gelspar matrix. Pinkish colour due to pervasive ankerite alteration. Some zones exhibit weathered brown rusty colour due to ankerite, moderately foliated. Hornblende content 5-10%, Qtz eyes 10-15%. Sericitic zone from 250.0 to 272.0' with 12" Qtz-ankerite vein from 253.3 to 254.3' with no mineralization. Foliation at 35°-40° to core					
285.0	mafic metavolcanic	grey, green, fine-grained, foliation 35° to core, occ'l 1/4" Qtz-ankerite veinlets					
289.0	hornblende trondbjemite	beige, lgt green-grey, coarse-grained foliation at 35° to core ankerite-sericite alteration					
394.8	mafic metavolcanic	grey, green, fine-grained, foliated					
403.5	hornblende trondbjemite	beige, lgt green, coarse-grained foliated. Ankerite, sericite, alteration throughout					

Property Name **Bad Vermillion Lake**

Map Reference No. Location (Twp, Lot, Con. or Lat. and Long)

Fill in on every page

Assays †

Hole No. **BV-11** Page No. **1 of 1**

Claim No. **K-75**

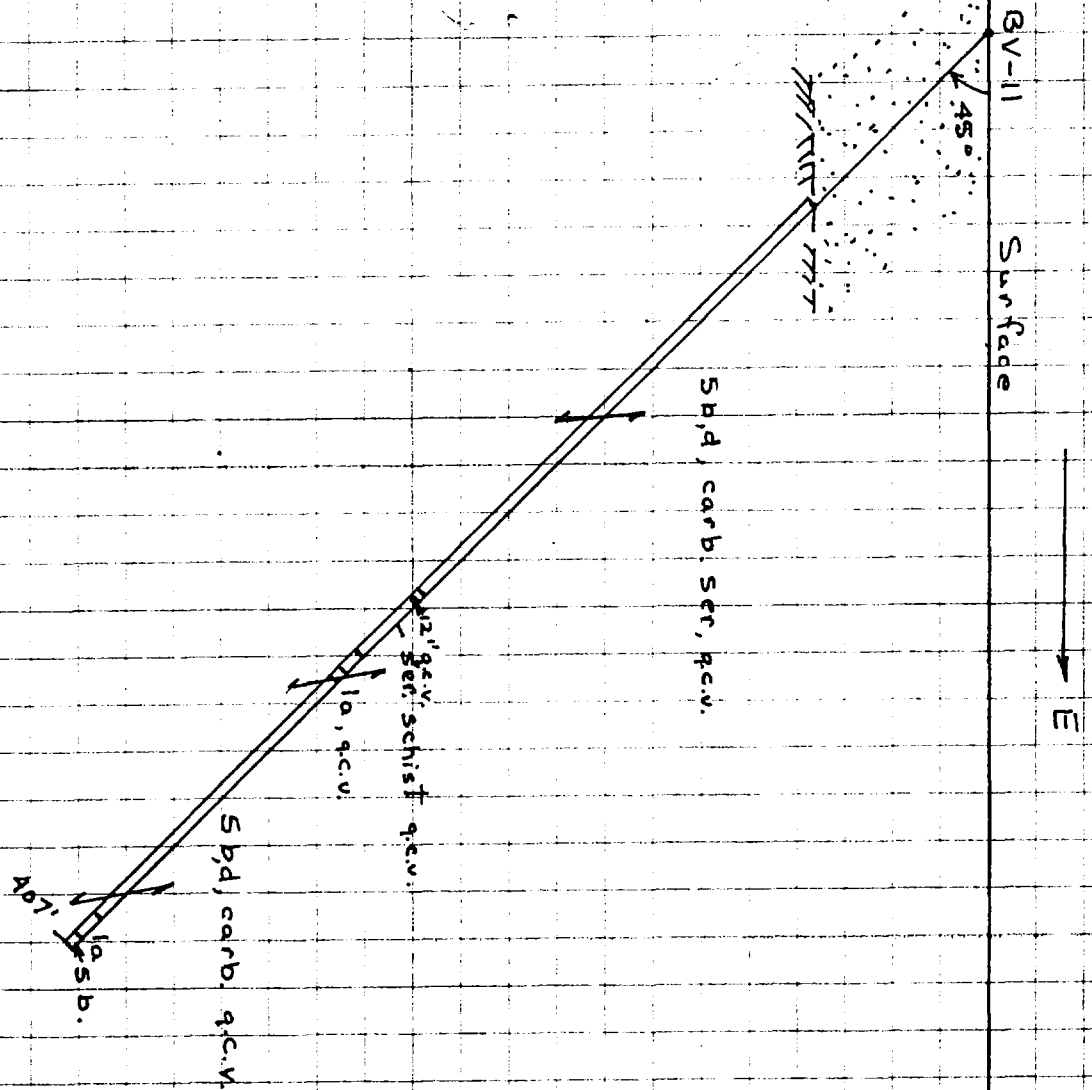

GEORGE ARMSTRONG

BAD VERMILION LAKE PROPERTY

DDH Section

BV-11

Scale: 1" = 60'

Date: October 17, 1988