



52C10NE0080 22 BAD VERMILION LAKE

010

DIAMOND DRILLING

AREA: Bad Vermilion Lake

REPORT No.: 22

WORK PERFORMED BY: Corporate Oil & Gas Ltd.
(C.D. Huston)

<u>CLAIM No.</u>	<u>HOLE No.</u>	<u>FOOTAGE</u>	<u>DATE</u>	<u>NOTE</u>
K 475276	LM - 1	200.0	-	(1)
	LM - 2	200.0	-	(1)
K 475274	LM - 3	200.0	-	(1)
	LM - 4	200.00	-	(1)
	LM - 5	343.0	-	(1)

5/1143'

NOTES: (1) #15-81

M. 2474

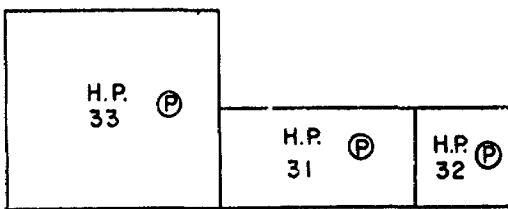
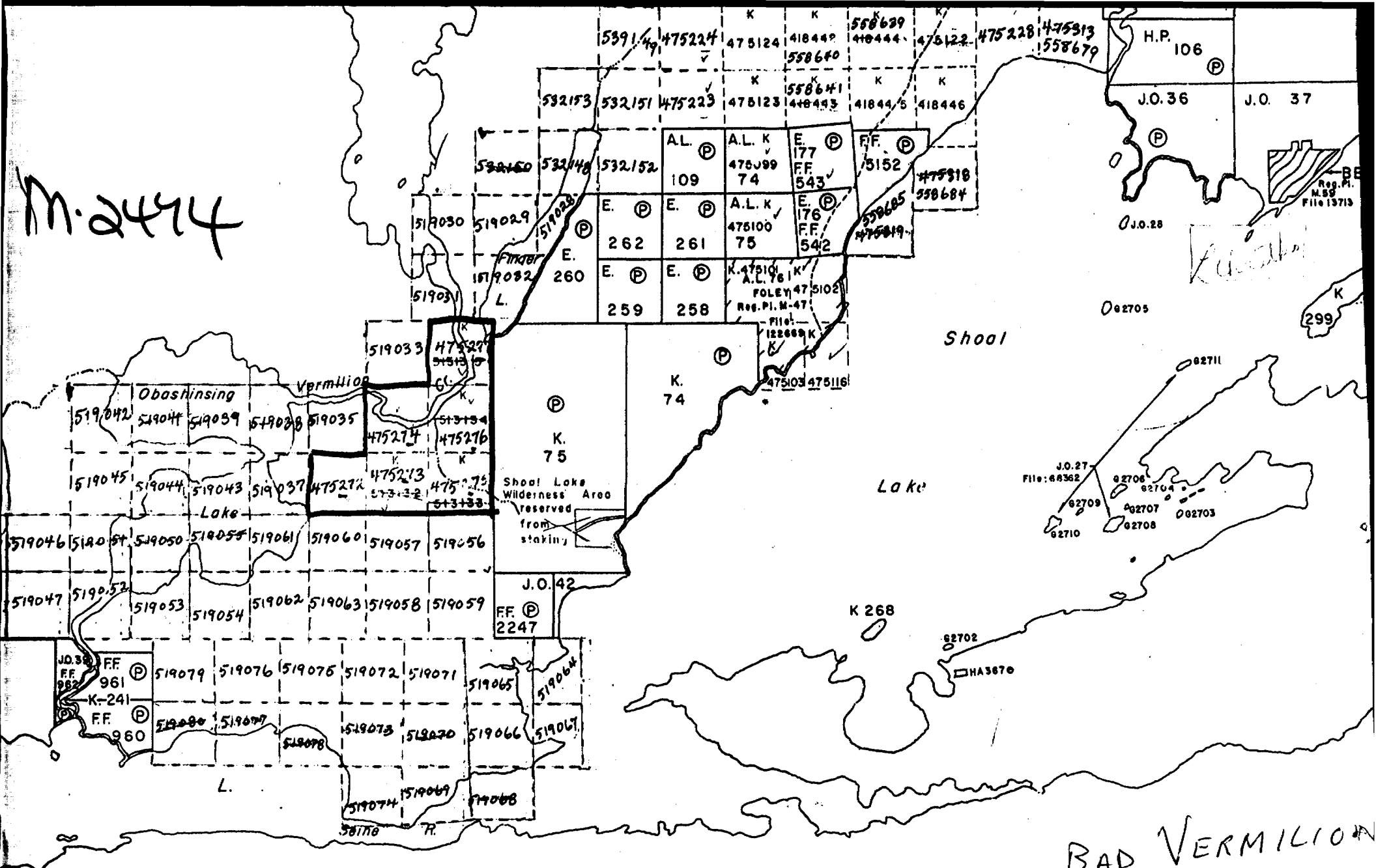

BAD VERMILION

UNIVERSITY OF MICHIGAN LIBRARY

LOCATION: LAT. _____
 DEP. _____
 ELEVATION OF COLLAR _____
 BEARING SOUTH
 DIRECTION AT START: _____
 DIP 45°

PROPERTY Mine Center, Lakatos Mc tavish option
 STARTED _____
 COMPLETED _____
 HOLE NO. IM 1

Depth Feet	FORMATION	Sample No.	Width of Sample	Gold Oz.	Progressive Ft. & Oz.	Average Assay
0.00/7.0	Casing				SILVER	
7.0/176.4	Quartz Feld Porphyry several veinlets of quartz throughout very weak pyrite waxy and schistose					
176.4/178.2	" Blue quartz vein material some galena fine pyrite	D 37	1.8	NIL	NIL	
178.2/180.0	" " "	E 28	1.6	NIL	NIL	
180.0/182.4	- Vein material as above	D38	2.4	NIL	NIL	
182.4/183.5	" - Quartz vein material good fine py	D39	1.1	0.01	NIL	
183.5/ 200.0	" as above grey green schistose.					
200.0 End of Hole Logged by C.D. Huston						
<i>[Signature]</i>						
<i>[Signature]</i>						

DIAMONED DRILL RECORD

Samples Lm-1

LOCATION: LAT. _____
 DEP. _____
 ELEVATION OF COLLAR _____
 DIRECTION AT START: BEARING _____
 DIP _____

PROPERTY _____
 STARTED _____
 COMPLETED _____
 HOLE NO. _____

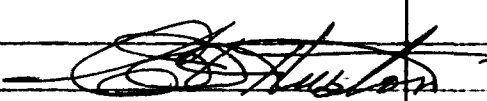
Depth Feet	FORMATION	Sample No.	Width of Sample	Gold Oz.	Progressive Ft. & Oz.	Average Assay
					SILVER	
176.4/178.2-	galena pyrite blue white qtz	D37	1.8	NIL	NIL	
178.2/179.8	fine pyrite is schisted material	E28	1.6	NIL	NIL	QTZ HLN
180.0/182.4	blue qtz fine galena and py.	D38	2.4	NIL	NIL	
182.4/183.5	good fine pyrite blue white qtz	D39	1.1	0.01	NIL	
183.5/187.0	fine pyrite slight shear	D40	3.5	NIL	NIL	
						

Check Assays

LOCATION: LAT. _____
 DEP. _____

PROPERTY _____

ELEVATION OF COLLAR _____

STARTED _____

DIRECTION AT START: BEARING _____

COMPLETED _____

DIP _____

HOLE NO. LM-1

Depth Feet	FORMATION	Sample No.	Width of Sample	Gold Oz..	Progressive FL. & Oz..	Average Assay
	177.0/180.0 weak pyrite	LM1-1	3.0	NIL		
	180.0/185.0 weak qtz and pyrite	Lm1-2	5.0	TR		

[Handwritten signature]

DIAMOND DRILL RECORD

LOCATION: LAT. _____
 DEP. _____
 ELEVATION OF COLLAR _____
 DIRECTION AT START: BEARING SOUTH
 DIP - 45°

PROPERTY Mine Center, Lakatos, Mc Tavish option
 STARTED _____
 COMPLETED _____
 HOLE NO. LM 2

Depth Feet	FORMATION	Sample No.	Width of Sample	Gold Oz.	Progressive Ft. & Oz.	Average Assay
0.00/19.0	Casing					
19.0/21.1	Greenstone- schist- intruded by bands of red ish Qtz feld porphyry- no min.					
21.1/23.3	Greenstone contact zone					
23.3/36.1	Qtz. Feld Porph- sheared rusty weak py.					
36.1/200.0	Quartz Feld Porph- highly sheared throughout very weak to no pyrite occassional quartzcarbonate stringers - no typical vein material encountered.					
	200.0 End of Hole					
	Logged by C.D. Huston					
	<i>[Signature]</i>					
	<i>[Signature]</i>					

DIAMOND DRILL RECORD

Samples

LOCATION: LAT. _____
 DEP. _____
 ELEVATION OF COLLAR _____
 DIRECTION AT START: STRIKING _____
 DIP _____

PROPERTY _____
 STARTED _____
 COMPLETED _____
 HOLE NO. 1M2

SILVER

Depth Feet	FORMATION	Sample No.	Width of Sample	Gold Oz.	Progressive Ft. & Oz.	Average Assay
70.5/172.0	fair py blue qtz	D41	1.5	NIL	NIL	
174/0	fair py blue qtz	D42	2.0	NIL	NIL	
176.5	some weak galena	D43	2.5	NIL	NIL	} Q12.1 J111
178/0	bull quartz	D44	2.5	NIL	NIL	
180.7	blue qtz fair py	D45	1.7	NIL	NIL	
182.7	galena weak chalco some pyrite	D46	2.0	NIL	NIL	
184.0	weak py	D47	1.3	NIL	NIL	
186.0	"	D48	2.0	NIL	NIL	
192.9/194.4		D49	1.5	NIL	NIL	
194.4/196.9	some weak sphal and galena	D50	2.5	NIL	NIL	} Q12.1 J111
196.9/199.1	blue qtz fair py some galena	E3	2.2	NIL	NIL	
199.1/200.0	fine pyrite slight shear	E4	0.9	NIL	NIL	
						

DIAMOND DRILL RECORD

LOCATION: LAT. _____
 DEP. _____
 ELEVATION OF COLLAR _____
 DIRECTION AT START: BEARING _____
 DIP _____

PROPERTY _____ Check assays _____
 STARTED _____
 COMPLETED _____
 HOLE NO. LM-2

Depth Feet	FORMATION	Sample No.	Width of Sample	Gold Oz.	Progressive Ft. & Oz.	Average Assay
171/175	Glassy white qtz wk py	LM2-1	4.0	TR		
175/180	weak py grey qtz	LM2-2	5.0	TR		
180/186	weak py	LM2-3	6.0	TR		
193.0/200.0	fair pyrite grey qtz	LM2-4	7.0	<u>0.04</u>		

[Handwritten signature]

DIAMOND DRILL RECORD

LOCATION: LAT. _____
 DEP. _____
 ELEVATION OF COLLAR _____
 DIRECTION AT START: BEARING SOUTH
 DIP 45°

PROPERTY Mine Center Lakatos No Tavish Option
 STARTED _____
 COMPLETED _____
 HOLE NO. LM -3

Depth Feet	FORMATION	Sample No.	Width of Sample	Gold Oz.	Progressive Fl. & Oz.	Average Assay
0.00/12.0	Casing					
12.0/17.0	Qtz. Feld Porph- red type highly altered sharp contact at 17 feet/					
17.0/80.0	Greenstone- numerous qtz & carb steaks @ 45° to core axis little to no pyrite fair shearing- some black streaks					
80.0/200.0	Qtz Feld Por- weak pyrite throuought. occasional 2" qtz streaks.					
	200.0 End of Hole; Logged by C.D. Huston					
	<i>[Signature]</i>					
	<i>[Signature]</i>					

DIAMOND DRILL RECORD

LOCATION: LAT. _____
 DEP. _____
 ELEVATION OF COLLAR _____
 DIRECTION AT START: BEARING _____
 DIP _____

PROPERTY _____ Samples
 STARTED _____
 COMPLETED _____
 HOLE NO. LM -3

~~GOLD~~ SILVER

Depth Feet	FORMATION	Sample No.	Width of Sample	Gold Oz.	Progressive Fl. & Oz.	Average Assay
146.0/148.5	fine pyrite	E5	2.5	NIL	NIL	
151.0	" "	E6	2.5	NIL	NIL	
153.5	" "	E7	2.5	0.02	NIL	
155.0	" "	E8	2.5	NIL	NIL	
157.0	blue quartz galena fine pyrite	E9	2.0	NIL	NIL	
160.0	blue quartz fine py graphite	E10	3.0	NIL	NIL	
162.5	" " "	E11	2.5	NIL	NIL	
165.0	mottled chalco galena py	E12	2.5	NIL	NIL	
167.0	sphalerite and galena pyrite	E13	2.0	NIL	NIL	
169.3	weak min quartz vein mat	E14	2.3	NIL	NIL	
171.8/	blue quartz good galena	E15	2.5	NIL	NIL	
174.3	weak py	E16	2.5	NIL	NIL	
176.8	weak py	E17	2.5	NIL	NIL	
178.3	weak qtz some pyrite	E18	1.5	NIL	NIL	
181.8	good sphal. py galena chalco slight vugs	E19	3.5	0.03	NIL	
184.3	fine py diss.	E20	2.5	0.01	NIL	
186.8	fine pyrite	E21	2.5	NIL	NIL	
188.8	fine pyrite and some galena	E22	2.0	NIL	NIL	
191.6	fine py slight sphal weak galena	E23	2.8	NIL	NIL	
193.6	Galena sphal chalco white qtz bullish	E24	2.0	0.15	NIL	
196.3	chalco weak py	E25	2.7	0.03	NIL	

QF2
V. 1

[Handwritten Signature]

DIAMOND DRILL RECORD

LOCATION: LAT. _____

 DIP. _____

 ELEVATION OF COLLAR _____

 BEARING _____
 DIRECTION AT START: _____

 DIP _____

PROPERTY _____ Samples _____

 STARTED _____

 COMPLETED _____
 _____ LM 3
 HOLE NO. _____

Depth Feet	FORMATION	Sample No.	Width of Sample	Gold Oz.	Progressive Ft. & Oz.	Average Assay
196.3/197.8	blue qtz pyrite and chalco	E26	1.5	NIL	NIL	
17.8/200.0	slight shear pyrite throughout	E 27	2.2	0.01	NIL	

[Handwritten Signature]

SILVER

DIAMOND DRILL RECORD

LOCATION: LAT. _____
 DEP. _____
 ELEVATION OF COLLAR _____
 BEARING _____
 DIRECTION AT START: _____
 DIP _____

PROPERTY _____ Samples
 STARTED _____
 COMPLETED _____
 HOLE NO. LM-4

Depth Feet	FORMATION	Sample No.	Width of Sample	Gold Oz.	<i>SILVER</i> Progressive Fl. & Oz.	Average Assay
43.5/44.9	Pink & smoky quartz	E32	1.4	0.01		
30.0/33.0	pyrite	E33	3.0	0.02		
36.0/38.2	"	E34	2.2	0.01		
50.0/51.5	"	E35	1.5	TR		
51.5/53.5		E36	2.0	TR		
55.7		E37	2.2	TR		
58.0		E38	2.3	TR		
61.5		E39	3.5	NIL		
63.5		E40	2.0	TR		
65.5		E41	2.0	TR		
66.8		E42	1.3	NIL		
69.2		E43	2.4	NIL		
72.2		E44	3.0	TR		
75.2		E45	3.0	TR		
77.7		E46	2.5	TR		
80.2		E47	2.5	TR		
83.2		E48	3.0	TR		
85.2		E49	2.0	TR		
87.0		E50	1.8	NIL		

[Handwritten signature]

DIAMOND DRILL RECORD

LOCATION: LAT. _____
 DEP. _____
 ELEVATION OF COLLAR _____
 BEARING _____
 DIRECTION AT START: _____
 DIP _____

PROPERTY _____ Samples _____
 STARTED _____
 COMPLETED _____
 HOLE NO. LM -4

Depth Feet	FORMATION	Sample No.	Width of Sample	Gold Oz.	Progressive Ft. & Oz.	Average Assay
87.0/89.4		F1	1.4	NIL		
114.5/117.0		F2	2.5	TR		
133.7/136.3	fine pyrite schisted	E29	2.6	TR		
136.3/138.9	pink and blue quartz schisted	E30	2.6	0.04	} QTL 4.11	
138.9/141.4	" "	E31	2.5	NIL		
161.9/165.1		F6	3.2	NIL		
165.1/166.9		F7	1.8	NIL		
166.9/168.9		F8	2.0	NIL		
168.9/171.9		F9	3.0	TR		
147.0/149.5		F3	2.5	TR		
149.5/151.5		F4	2.2	TR		
157.0/159.7		F5	2.7	TR		
<i>[Handwritten Signature]</i>						

SILVER

DIAMOND DRILL RECORD

LOCATION: LAT. _____
 DEP. _____
 ELEVATION OF COLLAR _____
 BEARING _____
 DIRECTION AT START: _____
 DIP _____

PROPERTY _____ Check assays
 STARTED _____
 COMPLETED _____
 HOLE NO. LM 4

Depth Feet	FORMATION	Sample No.	Width of Sample	Gold Oz.	Progressive Ft. & Oz.	Average Assay
50.0/55.0	blue grey qtz weak py	LM4-1	5.0	TR		
55/60	" "	LM4-2	5.0	TR		
60/65	" "	LM4-3	5.0	TR		
65/70	" "	LM4-4	5.0	TR		
135/140	" "	LM4-5	5.0	NIL		
143.0/146.0	" "	LM4-6	3.0	TR		
<i>[Handwritten signature]</i>						

DIAMOND DRILL RECORD

LOCATION: LAT. _____
 DEP. _____
 ELEVATION OF COLLAR _____
 BEARING _____
 DIRECTION AT START: _____
 DIP _____

PROPERTY _____ Samples
 STARTED _____
 COMPLETED _____
 HOLE NO. LM-5

Depth Feet	FORMATION	Sample No.	Width of Sample	Gold Oz.	Progressive Ft. & Oz.	Average Assay
308.5/311.2	weak py grey qtz waxy	F10	2.7	TR		
311.2/313.5	abundant py- dyke rock (Lamprophyre)	F11	2.3	TR		
313.5/315.7	" "	F12	2.2	NIL		
315.7/318.0	same as F10	F13	2.3	NIL		
318.0/321.3	Qtz vein some sphal weak py	F14	3.3	0.08	J	
321.3/323.5	weak to no min	F15	2.2	NIL		
230.0/232.5		F16	2.5	NIL		
132.5/235.0		F17	2.5	TR		
235.0/237.5		F18	2.5	NIL		
237.5/240.0		F19	2.5	NIL		
240.0/242.5		F20	2.5	TR		
242.5/245.0		F21	2.5	NIL		
245.0/247.5		F22	2.5	TR		
247.5/250.0		F23	2.5	TR		
250.0/252.5		F24	2.5	NIL		
299.0/302.0		F25	2.5	NIL		
302.0/304.5		F26	2.5	TR		
304.5/307.0		F27	2.5	0.01		
307.0/309.5		F28	2.5	TR		

[Handwritten Signature]

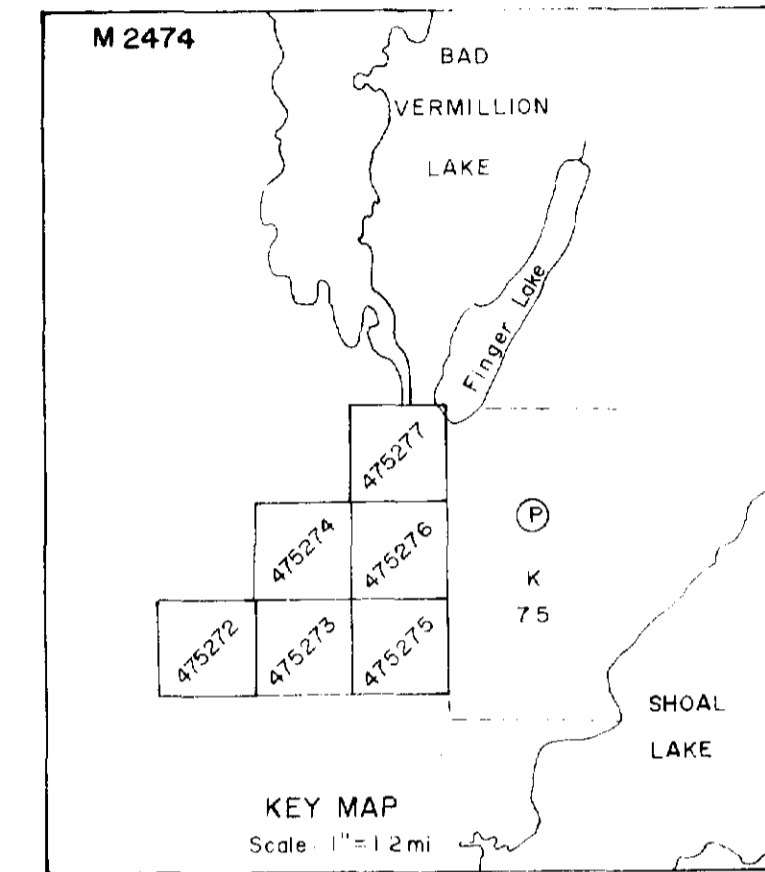
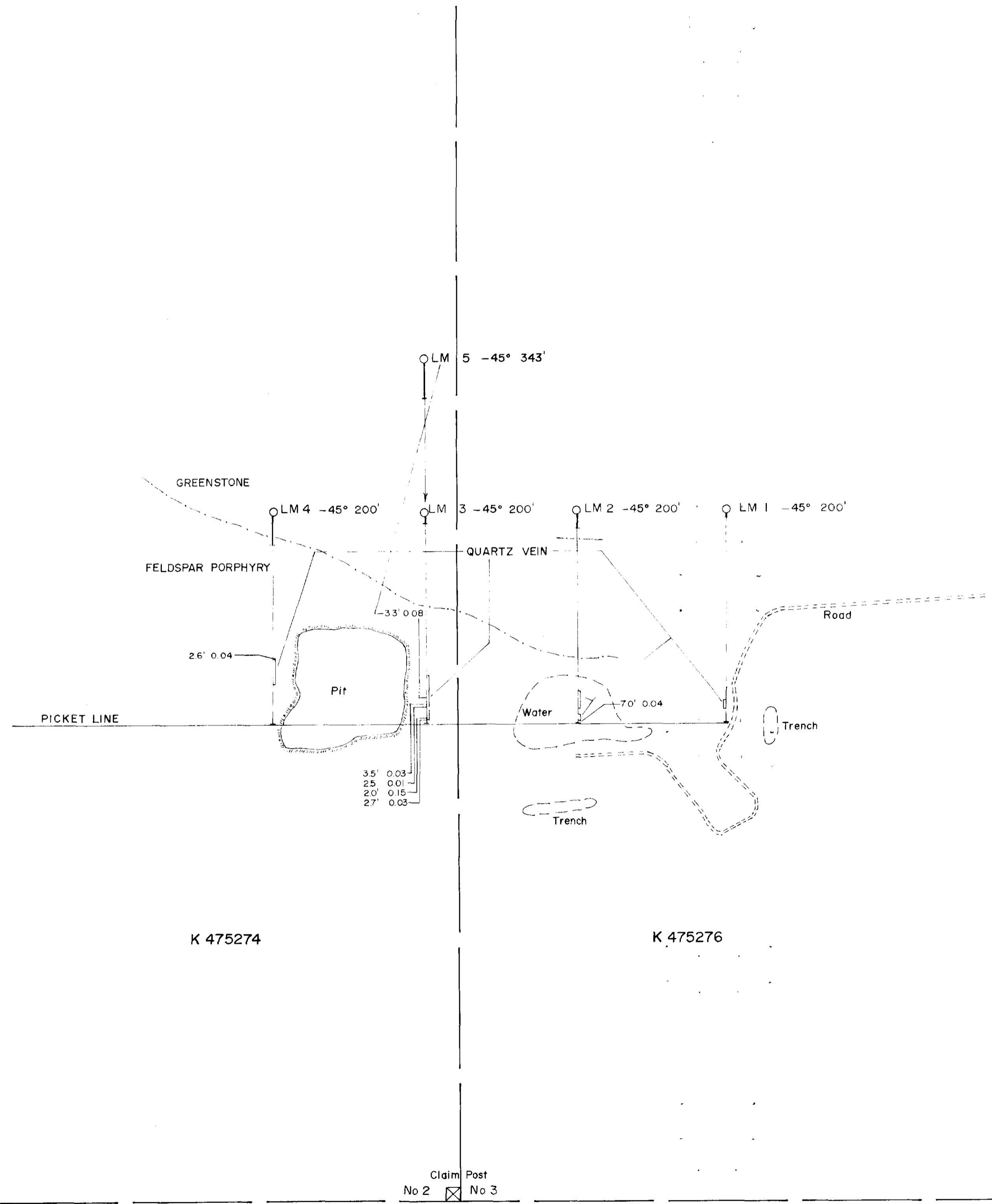

CORPORATE OIL & GAS LTD

DRILLING PLAN

LAKATOS-McTAVISH OPTION

MINE CENTRE, ONTARIO

Scale: 1" = 50'

Date: December 11, 1980

Work by: C.D. Huston & Sons Ltd

Drawn by: JEM

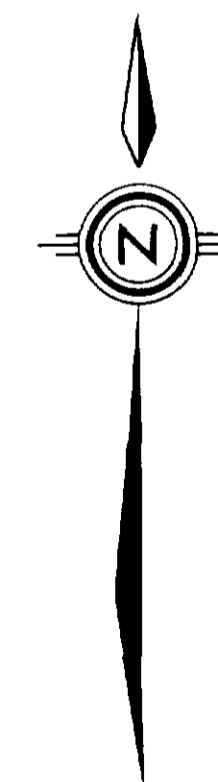

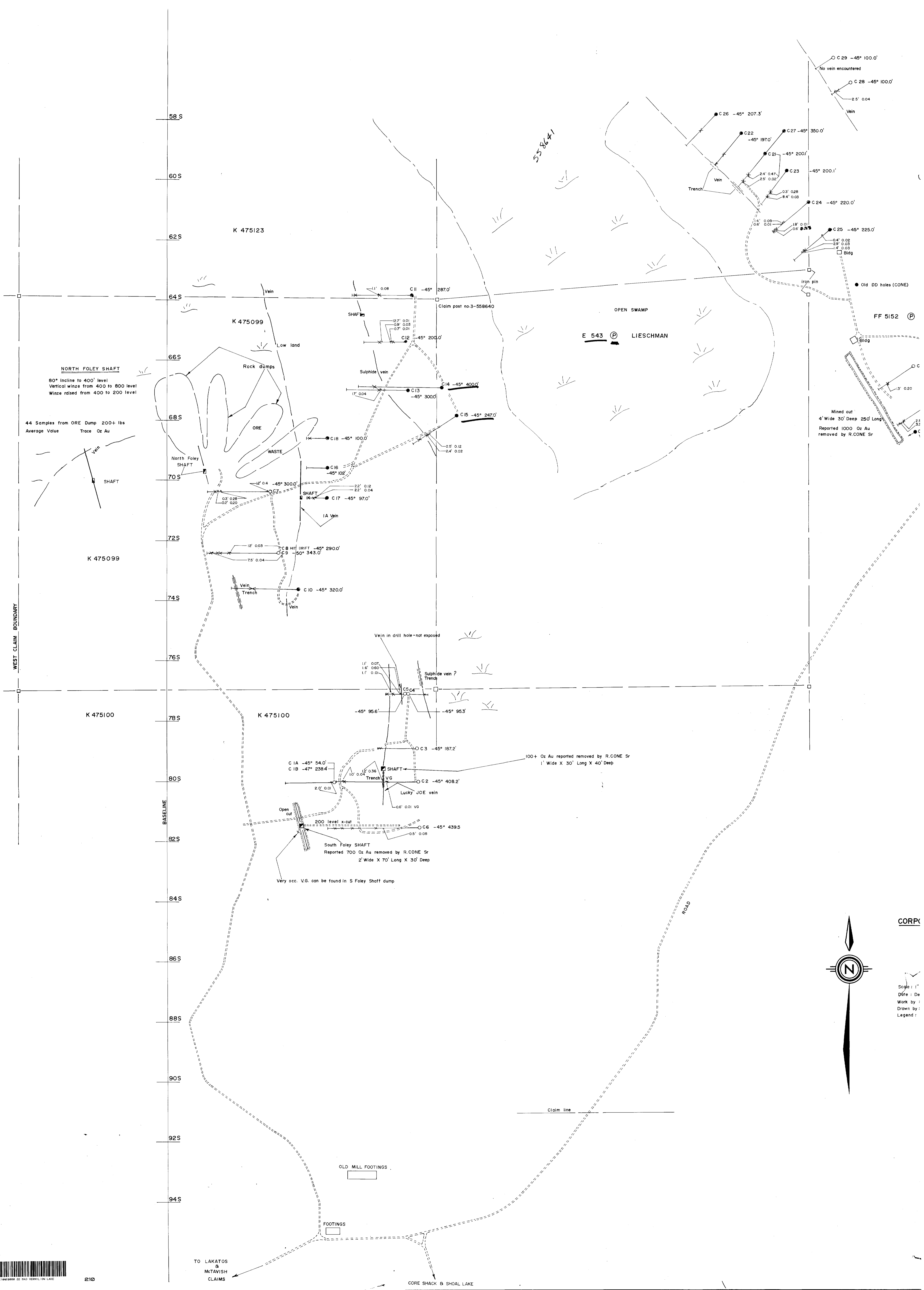

44 Samples from ORE Dump 200+ lbs
Average Value Trace Oz Au

No vein encountered
C 28 -45° 100.0'
2.5' 0.04
Vein
C 29 -45° 100.0'
C 25 -45° 225.0'
0.4' 0.02
2.9' 0.03
4' 0.03
Mined out
4' Wide 30' Deep 250' Long
Reported 1000 Oz Au
removed by R. CONE Sr

100+ Oz Au reported removed by R. CONE Sr
1' Wide X 30' Long X 40' Deep
C 1A -45° 54.0'
C 1B -47° 238.4'
C 2 -45° 408.2'
C 3 -45° 187.2'
C 4 -45° 95.3'
C 5 -45° 95.6'
C 6 -45° 439.5'
C 7 -45° 300.0'
C 8 HIT DRIFT -45° 290.0'
C 9 -50° 343.0'
C 10 -45° 320.0'
C 11 -45° 287.0'
C 12 -45° 200.0'
C 13 -45° 300.0'
C 14 -45° 400.0'
C 15 -45° 247.0'
C 16 -45° 100.0'
C 17 -45° 97.0'
C 18 -45° 100.0'C 19 -50° 343.0'
C 20 -45° 320.0'
C 21 -45° 200.1'
C 22 -45° 197.0'
C 23 -45° 200.1'
C 24 -45° 220.0'
C 25 -45° 225.0'
C 26 -45° 207.3'
C 27 -45° 350.0'
C 28 -45° 100.0'
C 29 -45° 100.0'

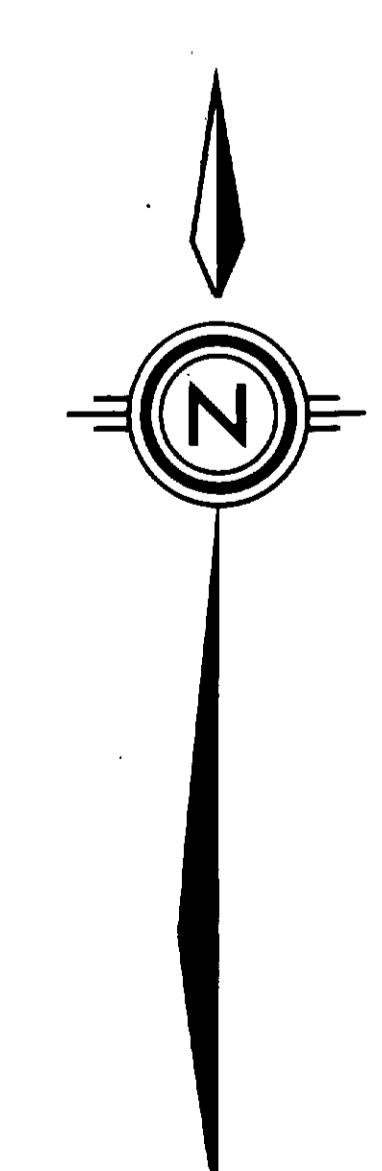

CORPC
Scale: 1" = 100'
Dwg: De
Work by: De
Drawn by: De
Legend:

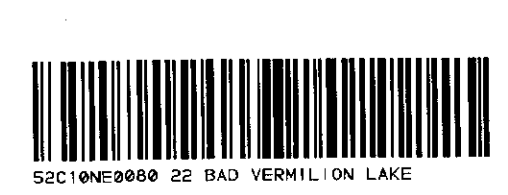

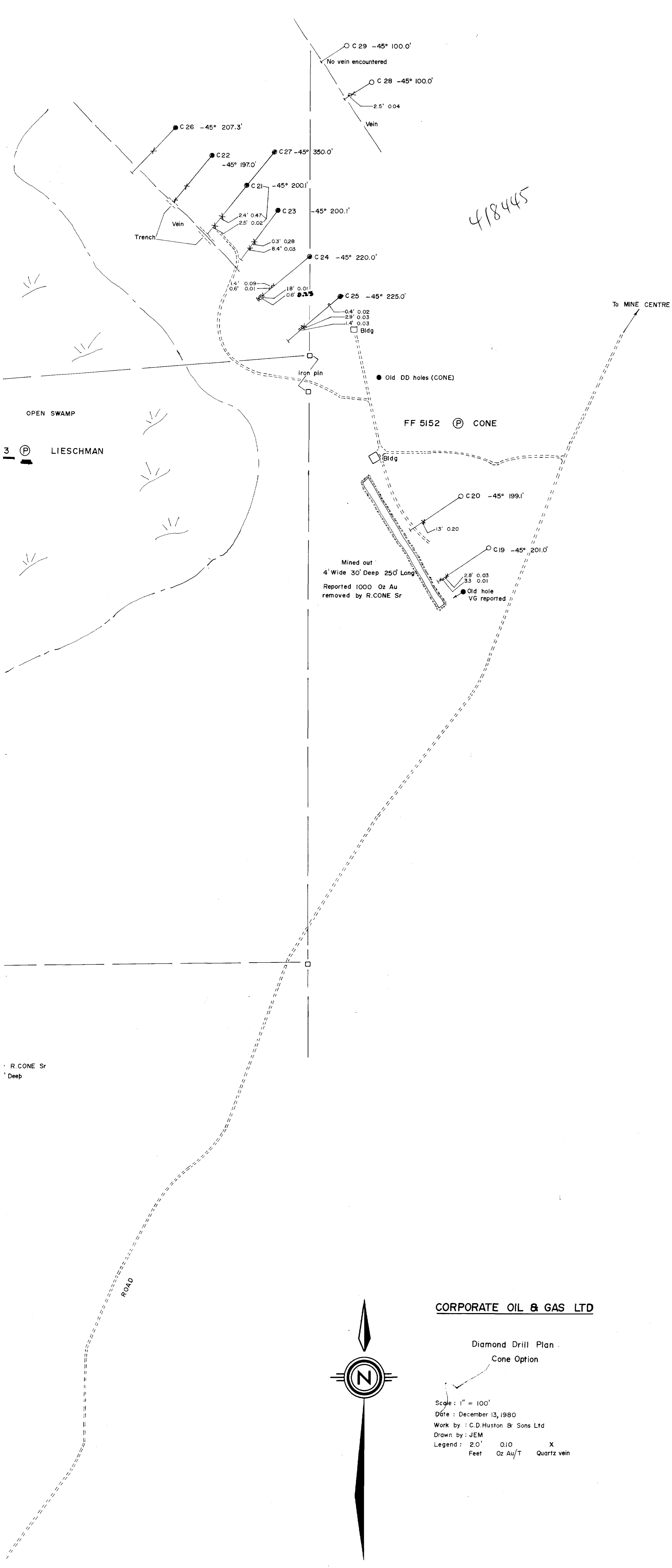

CORPORATE OIL & GAS LTD

**Diamond Drill Plan
Cone Option**

Scale: 1" = 100'
 Date: December 13, 1980
 Work by: C.D. Huston & Sons Ltd
 Drawn by: JEM
 Legend: 2.0' 0.10 X
 Feet Oz Au/T Quartz vein

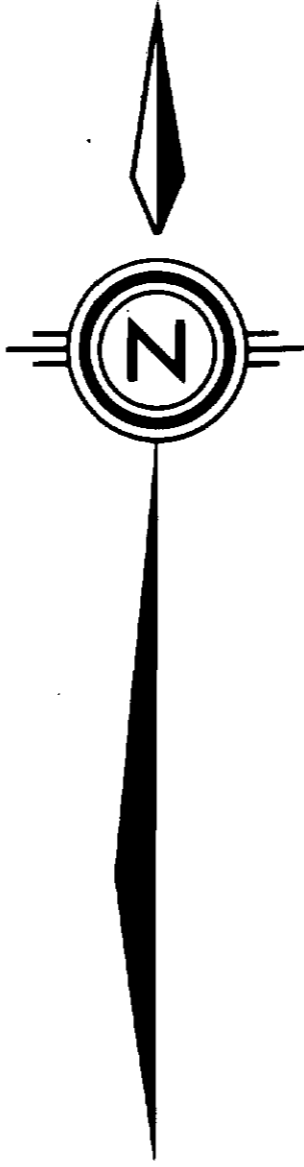

R. CONE Sr
 Deep