



52C10NE0498 16 BAD VERMILLION LAKE

010

# Diamond Drilling

Area of BAD VERMILLION LAKE

Report N<sup>o</sup> 16

Work performed by: The Hanna Mining Co. Limited

Claim N <sup>o</sup>	Hole N <sup>o</sup>	Footage	Date	Note
K 419524	MC76-1	802'	Jan/76	(1) (2)

## Notes:

(1) FOR MORE INFORMATION SEE FILE #63.3367 MEAP CONTRACT A-6 AND  
LITTLE TURTLE LAKE DIAMOND DRILLING #13

(2) #16-77

# GRASSY LAKE - M.2433

92°30'

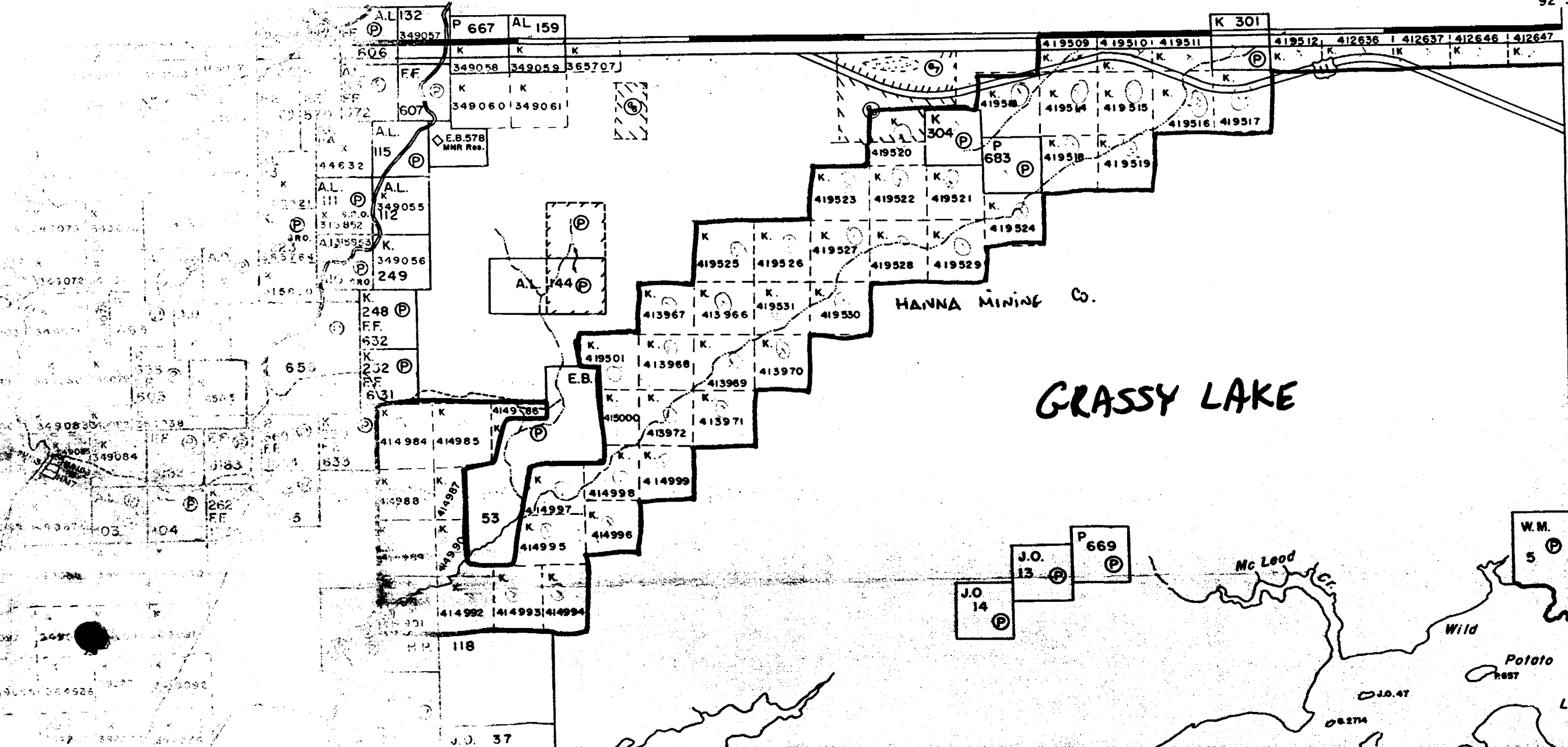

A.L. 132  
P 667 AL 159  
349057  
K K K  
349058 349059 365707  
K K  
349060 349061

K 301  
419509 419510 419511  
419512 412636 412637 412646 412647  
K K K K K K

E.B. 578  
MNR Res.  
A.L. 115  
44632  
A.L. 111  
349055  
A.L. 112  
349056  
249  
K 248  
FF 632  
K 232  
FF 631

A.L. 144

HANNA MINING Co.

## GRASSY LAKE

E.B.  
419501 413968 413970  
413967 413966 419531 419530  
419520 419523 419522 419521  
419525 419526 419527 419528 419529  
415000 413972 413971  
414984 414985  
414988 414997 414998 414999  
414995 414996  
414992 414993 414994

J.O. 13  
P 669  
J.O. 14

W.M. 5

118

J.O. 37

J.O. 47  
08274

Potato  
P. 857

Wild

McLeod



Property Mine Centre

THE HANNA MINING COMPANY

Sheet 2 of 11

Logged by:- John Mubic Location \_\_\_\_\_ Bearing:- \_\_\_\_\_ Depth \_\_\_\_\_ Drill Hole No.:- MC-76-1

Date:- Jan. 14, 1976 N.- \_\_\_\_\_ Inclination:- \_\_\_\_\_ Started: Jan. 8, 1976

Drilled by:- Norwescon Development Ltd. E.- \_\_\_\_\_ Elevation:- \_\_\_\_\_ Completed:- Jan. 15, 1976

Footage		Description	ANGLE OF BEDDING OR FOLIATION TO CORE		Samples				Assays		
From	To		FOOTAGE	ANGLE	No.	From	To	Core Length			
		191.5 - 195.5 - Band of felsic tuff with disseminated pyrite ∠ 1%	195	60°							
		195.5 - 257.2 - Intermediate volcanic with scattered qtz. carbonate amygdules - more carbonatized from 206.3 - 217 widely scattered pyrite crystals < 1/4%. - some scattered qtz. carbonate veining.									
		257.2 - 267 - Intermediate sheared volcanic with less than 1/2% pyrite stringers parallel to shearing.	258	50°							
		267 - 286.5 - Fine grained Intermediate Volcanic as above - scattered pyrite cubes up to 3/8".									
286.5	351.0	Felsic Volcanic - grey, fine grained, feldspathic, weak foliation, some qtz. carbonate stringers, sericitized									
		287- 288.4 - fine grained disseminated pyrite in stringers 10-15% 288-288.4 - little granular sphalerite < 1%			2339	286.5	288.4	1.9	Nil	.04	.19
		288.4 - 295.5 - Felsic volcanic - grey fine grained, with qtz carbonate stringers and sericitic alteration. - sharp contact with underlying tuff	295.5	65°							
		295.5 - 300.0- Grey bedded felsic tuff - bedding at 65° to core. - 3 seams of pyrite 1/4" thick with minor disseminated pyrite.	297	65°							

Property Mine Centre

THE HANNA MINING COMPANY

Sheet 3 of 11

Logged by: John Muhic

Location \_\_\_\_\_

Bearing: \_\_\_\_\_

Depth \_\_\_\_\_

Drill Hole No.: MC-76-1

Date: Jan. 14, 1976

N. \_\_\_\_\_

Inclination: \_\_\_\_\_

Started: Jan. 8, 1976

Drilled by: Norwescon Development Ltd.

E. \_\_\_\_\_

Elevation: \_\_\_\_\_

Completed: Jan. 15, 1976

Footage		Description	ANGLE OF BEDDING OR FOLIATION TO CORE		Samples				Assays				
From	To		FOOTAGE	ANGLE	No.	From	To	Core Length					
		300.0 - 302.0 - Ash bed? - speckled white and dk. grey with angular and rounded white fragments up to 1/8"											
		302.0 - 302.6 - Broken up fractured zone approximately 50% carbonate - some pyrite seams $\approx$ 10%.											
		302.6 - 305.0 - Grey bedded tuff with compositional banding at 75° to core $\leftarrow$ 5% pyrite in seams up to 1/8" parallel to bedding.	304	75°									
		305.0 - 306.5 - Grey tuff - no sulphides											
		306.5 - 309.0 - Grey tuff with seams of pyrite parallel to bedding with pyrite, sphalerite, chalcopyrite in thread - like stringers crosscutting bedding and disseminated grains - 5% sulphides - $\frac{1}{2}$ % sp - trace ccp			2340	306.5	309.0	2.5					
		309.0 - 315.0 - Grey tuff with $\leftarrow$ $\frac{1}{2}$ % chalcopyrite in tiny disseminated grains. - irregular bands of white feldspathic fragments probably spherulites.											
		315.0 - 321.0 - Grey felsic bedded tuff $\leftarrow$ $\frac{1}{2}$ % sulphide including small disseminated grains of sphalerite and chalcopyrite.	317	70°									

Au	Ag	Zn	Cu
oz/ton	oz/ton	%	%
Nil	.02	.83	.06

Property Mine Centre

## THE HANNA MINING COMPANY

Sheet 4 of 11Logged by:- John Muhic Location \_\_\_\_\_ Bearing:- \_\_\_\_\_ Depth \_\_\_\_\_ Drill Hole No.:- MC-76-1Date:- Jan. 14, 1976 N.- \_\_\_\_\_ Inclination:- \_\_\_\_\_ Started: Jan. 8, 1976Drilled by:- Norwescon Development Ltd. E.- \_\_\_\_\_ Elevation:- \_\_\_\_\_ Completed:- Jan. 15, 1976

Footage		Description	ANGLE OF BEDDING OR FOLIATION TO CORE		Samples				Assays			
From	To		FOOTAGE	ANGLE	No.	From	To	Core Length	Au oz/ton	Ag oz/ton	Zn %	Ti %
		321.0 - 326.0 - Grey felsic tuff with gray feldspathic bands up to 1/8" thick - minor disseminated sphalerite grains										
		326.0 - 351.0 - Grey felsic volcanic - with 10% leucoxene crystals - 10% pyrite in brassy cubes and bronze disseminated grains in seams, < 1% sphalerite irregular qtz carbonate veins - up to 1" wide.			2335	326.0	334.0	8.0	.002	Tr	.09	.75
					2336	334.0	343.5	9.5	Nil	.01	.15	.72
					2337	343.5	351.0	7.5	.002	Nil	.08	.73
351.0	458.0	Rhyolite - light grey, very hard, with blue quartz eyes - sericitized, occasional quartz amygdules	351	55°								
		351.0-352.5 - Rhyolite as above 10% sulphides < 1% sphalerite pyrite in seams and disseminated										
		352.5 - 354.0 - Felsic volcanic - dk. grey with leucoxene About 1% sulphide										
		354 - 361.0 - Rhyolite as above with 10% sulphides about 1% sphalerite			2338	351.0	361.0	10.0	.01	.025	.19	

















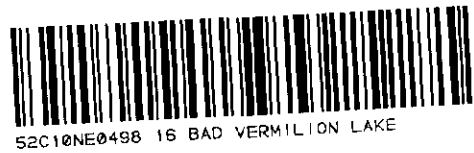
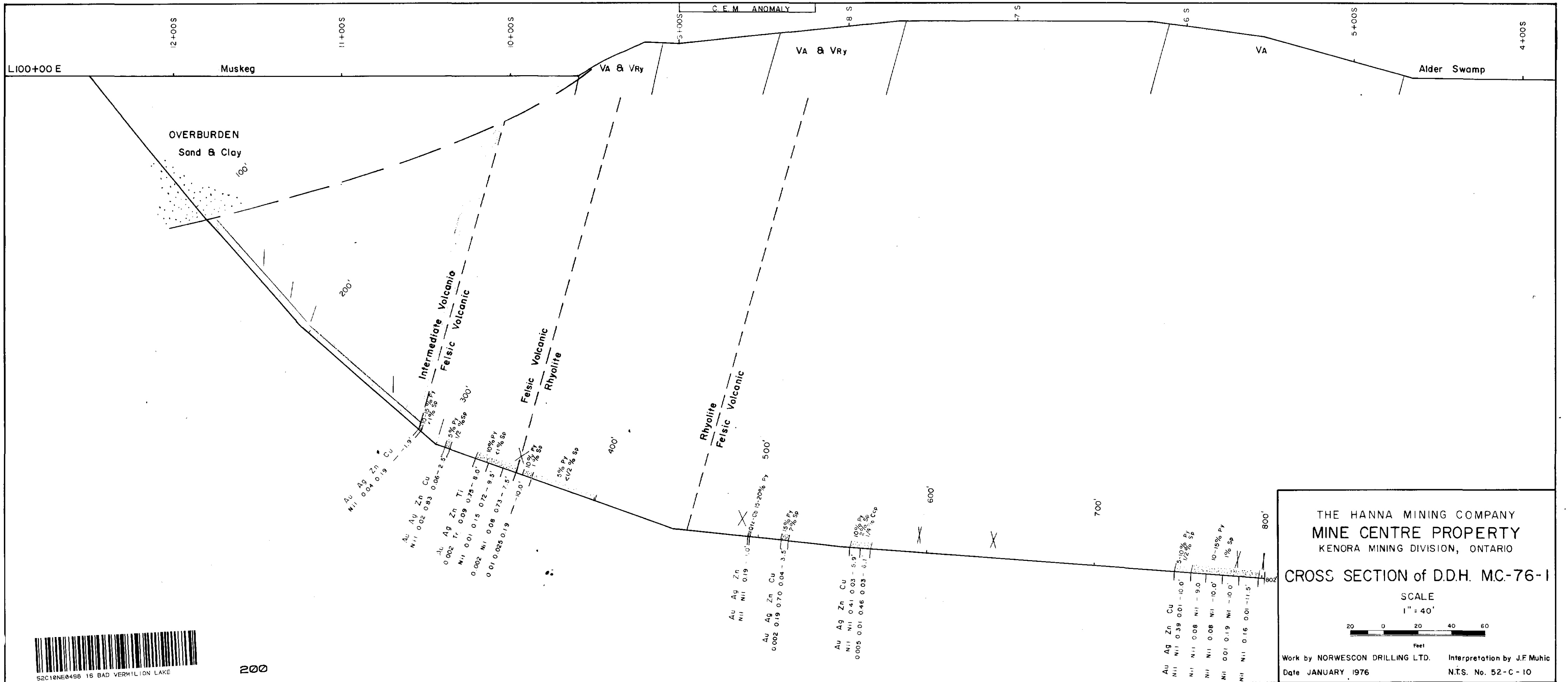



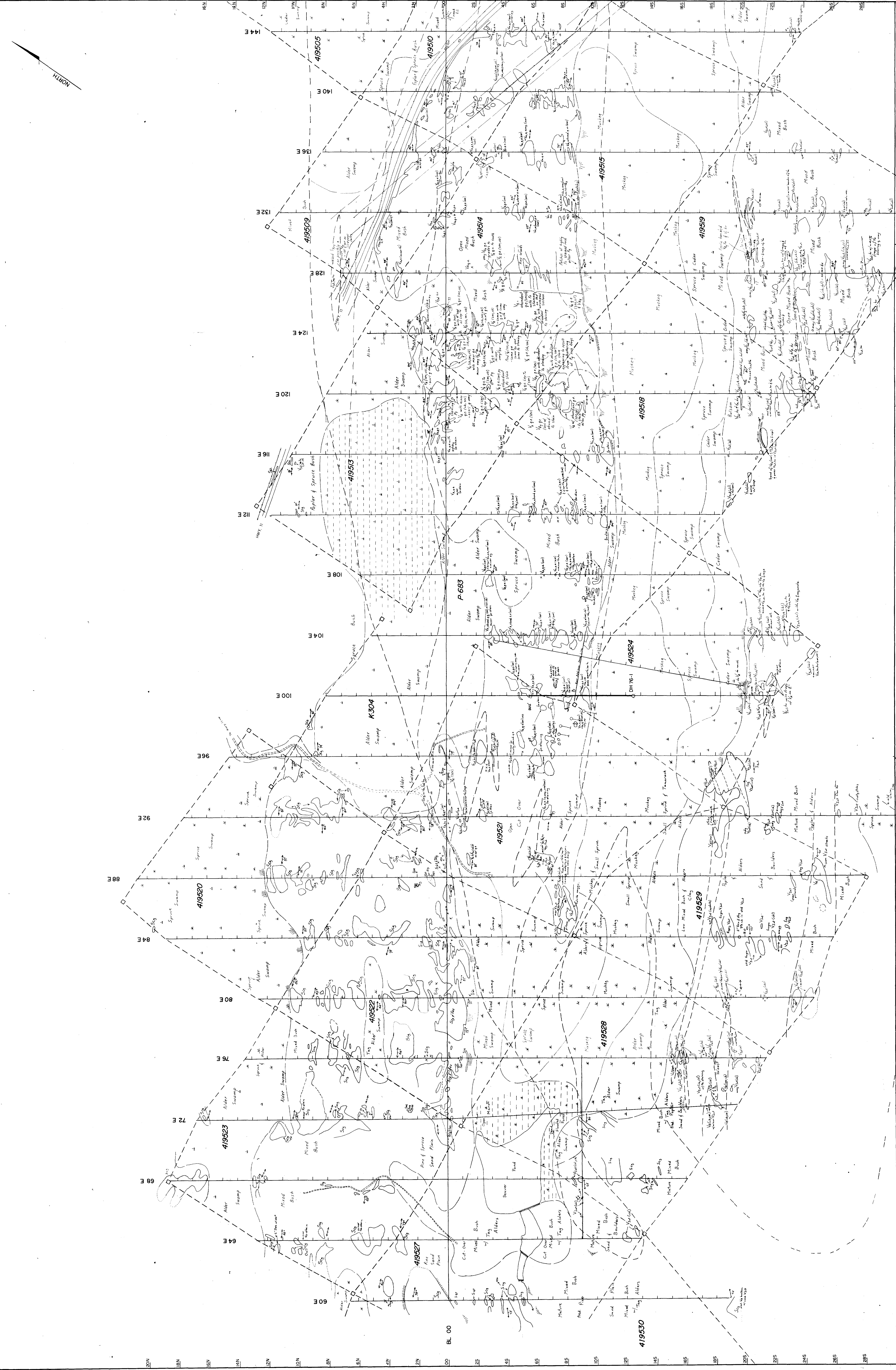

**THE HANNA MINING COMPANY**  
**MINE CENTER PROPERTY**  
 KENORA MINING DIVISION  
 ONTARIO

**GEOLOGIC MAP**

SCALE 1" = 200'  
 0 200 400 600  
 Feet

Work by \_\_\_\_\_ Date \_\_\_\_\_  
 Revised \_\_\_\_\_  
 N.T.S. No. 52-C-0

- SYMBOLS**
- Claim - Chain line
  - Building, cabin
  - Shaft
  - Trench
  - Dike line, vertical, inclined
  - Magnetic attraction
  - Rock sample
  - Rock outcrop - small, large
  - Geological boundary - defined, approximate
  - Strike and dip of bedding - vertical, inclined
  - Strike and dip of relation or orthosity - vertical, inclined
  - Drag fold - direction of plunge
- ABBREVIATIONS**
- amygdaloid
  - associated
  - flag
  - fine grained
  - medium grained
  - coarse grained
  - pillbed
  - carbonaceous
  - calc. carbonate
  - chert
  - iron
  - magnetite
  - pyrite
  - quartz vein
  - sericite
  - sp. schistose
  - schistose
  - appropriate

- LEGEND**
- IgG Gabbro intrusive - undifferentiated
  - IgM Intermediate intrusive - undifferentiated
  - Sg Conglomerate
  - Ser Grit
  - Ssw Greywacke
  - Va Acid volcanics - undifferentiated
  - Vp Rhyolite
  - Vm Intermediate volcanics - undifferentiated
  - Vd Dacite
  - Vs Basic volcanics

**SHEET INDEX**