

WORK REPORT _ STELLAR PROPERTY MINE CENTRE

April 24 -25 1999.

PROPERTY LOCATION AND ACCESS -

The property is located 277 Km west of Thunder Bay on Hwy 11-17 and 45 Km east of Fort Frances along Hwy #11, then 2 Km south on an all weather road to the claim, numbered K1161464, Bad Vermillion Lake Area G2665 - 52C10 staked by R.W. Pitkanen License #E2. 147.

GEOLOGY -

The claim lies between two major faults, the Quetico and Seine River, which trend east - west.

The Quetico fault lies 3 Km to the north and the Seine River fault being 5 Km to the south of the claim.

Granite rocks lie to the north of the Quetico fault and metasediments intruded by felsic to ultrabasic rocks to the south of the Seine River fault.

Between the faults the steeply dipping east - west striking metavolcanics and calcareous metasediments are intruded by a large differentiated sill like body ranging in composition from anorthosite, quartz diorite, trondhjemite and quartz veins in chlorite schists.

LOCAL GEOLOGY -

Area #1 - Sketch A -

The host rock is a carbonate - rich chlorite - sericite schist which forms a shear zone within trondhjemite.

The vein material consists of laminated quartz and ankerite with siderite, pyrite, pyrrhotite, chalcopyrite, sphalerite, galena and visible gold.

Area #2 - Sketch B -

The host rock is similar to Area #1 with more chlorite schist and less shearing.

The vein material consists of laminated quartz and ankerite with pyrite, pyrrhotite and some specks of chalcopyrite.

WORK -

At Area #1 we cut the brush and with shovel and hoe stripped the area and then washed with pump and sampled.

See sketch A

At Area #2 we cut the brush and stripped with shovel and hoe before sampling.

See sketch B.

Work done by -

R.W. Pitkanen, RR #16 Site 3A - 10, Thunder Bay, ON. P7B 6B3

2 days April 24 & 25 LICENSE # E24147

Assisted by

David Pitkanen, RR #1 RMB 97, Fort Frances, ON. P93 3M2

2 days April 24 & 25 License No. C-38372

I drove out in my motorhome Friday April 23 from Thunder Bay and was joined by Dave that evening. We stayed two nights in the motorhome and went home Sunday night.

R.W. Pitkanen

Dave Pitkanen

2.19428



52C10NE2003 2.19428 BAD VERMILION LAKE 010

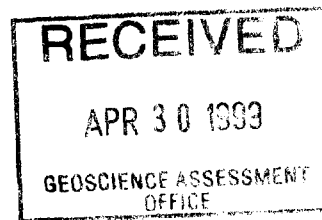

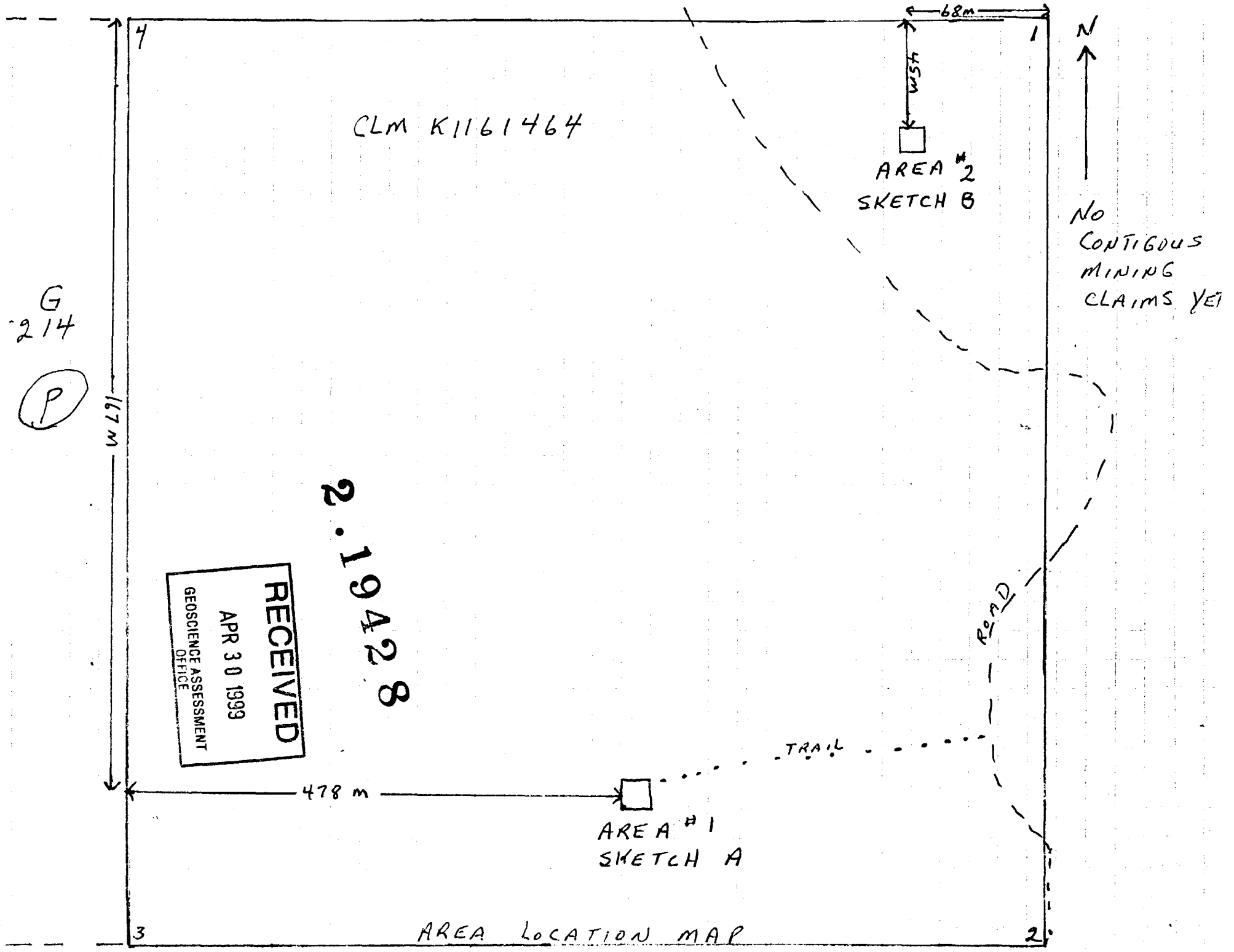

CLM K1161464

AREA #2
SKETCH B

NO
CONTIGUOUS
MINING
CLAIMS YET

G
214

(P)

167 m

RECEIVED
APR 30 1999
GEOSCIENCE ASSESSMENT
OFFICE

2.19428

478 m

AREA #1
SKETCH A

TRAIL

ROAD

AREA LOCATION MAP



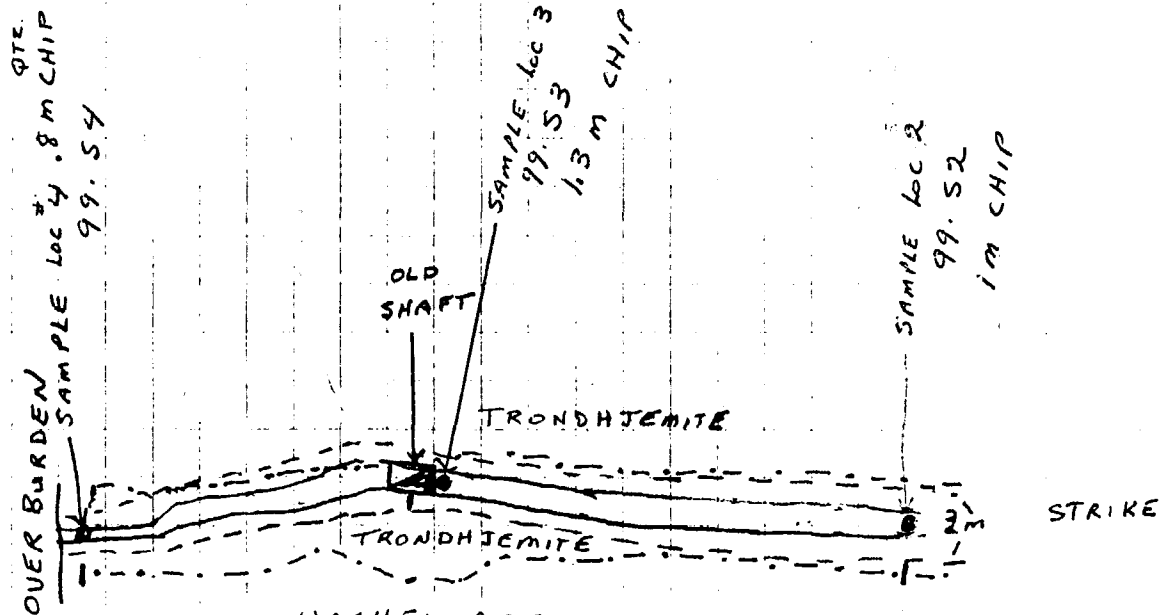

S.W. 1/4
 CLAIM 1161464
 G-2665
 BAD VERMILL
 LAKE AREA

- - - - - WASHED AREA
- QTZ. VEIN
- . - . - SHEAR ZONE - SILICIFIED SCHIST 3m WIDE WITHIN TRONDHJEMITE
- SAMPLE LOC.
- SAMPLE DESCRIPTIONS ON ATTACHED SHEET

— QTZ VEIN VARIES FROM .8m TO 1.5m WIDE

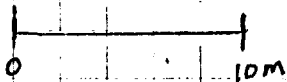

2.19428

RECEIVED
 APR 30 1999
 GEOSCIENCE ASSESSMENT
 OFFICE

SKETCH A
 AREA #1

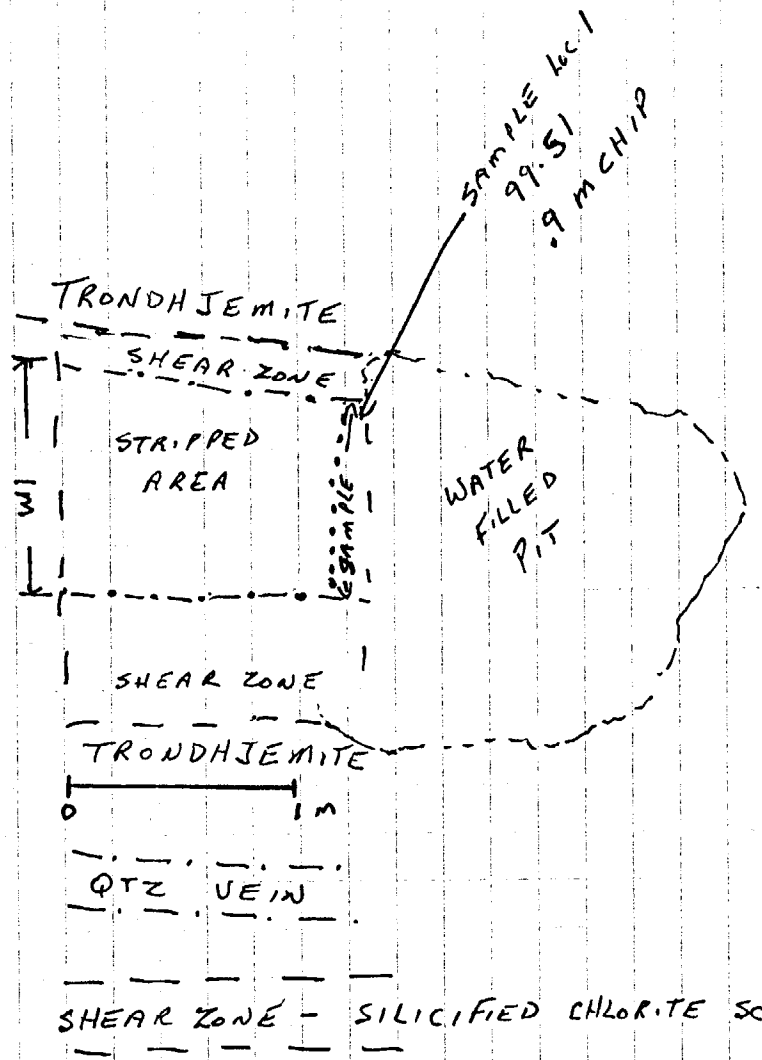

NE 1/4
CLAIM 1161464

G-2665
BAD VERMILLION
LAKE AREA

2.19428

SAMPLE DESCRIPTION ON ATTACHED SHEET
 QUARTZ VEIN AVE. 1 M WIDE
 STRIPPED AREA - OVERBURDEN .5 M DEEP
 - 1 M WIDE X 1.5 M LONG

SEE SKETCH B
AREA # 2

RECEIVED
 APR 30 1993
 GEOSCIENCE ASSESSMENT
 OFFICE

SAMPLES

- 99S1 - From Area #2 - sketch B - .9 m chip - carbonated quartz in chlorite schist, 1% pyrite.
- 99S2 - From Area #1 - sketch A - 22 m east of old shaft, glassy reddish quartz, 2% galena and sphalerite.
1 m chip
- 99S3 - Area #1 - sketch A - east edge of old shaft, carbonated glassy to milky, sugary quartz with
1% pyrite, 2% zinc, minor Po & Pb. 1.3 m chip
- 99S4 - Area #1 - sketch A - 15 m west of old shaft, carbonated quartz in chlorite schist, minor pyrite.
.8 m chip

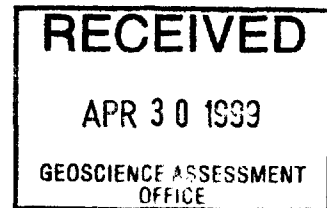



Ontario Ministry of Northern Development and Mines
Mines and Minerals Division

G-2665 - BAD VERMILION LAKE AREA - KENORA Division



Zoom Tools

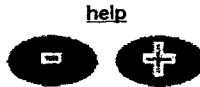

Zoom Level GO

Adjacent Map

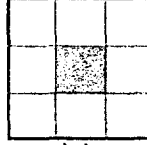

Order Hard Copy Map [help](#)

Download Full Scale image [help](#)

Order Form

Download

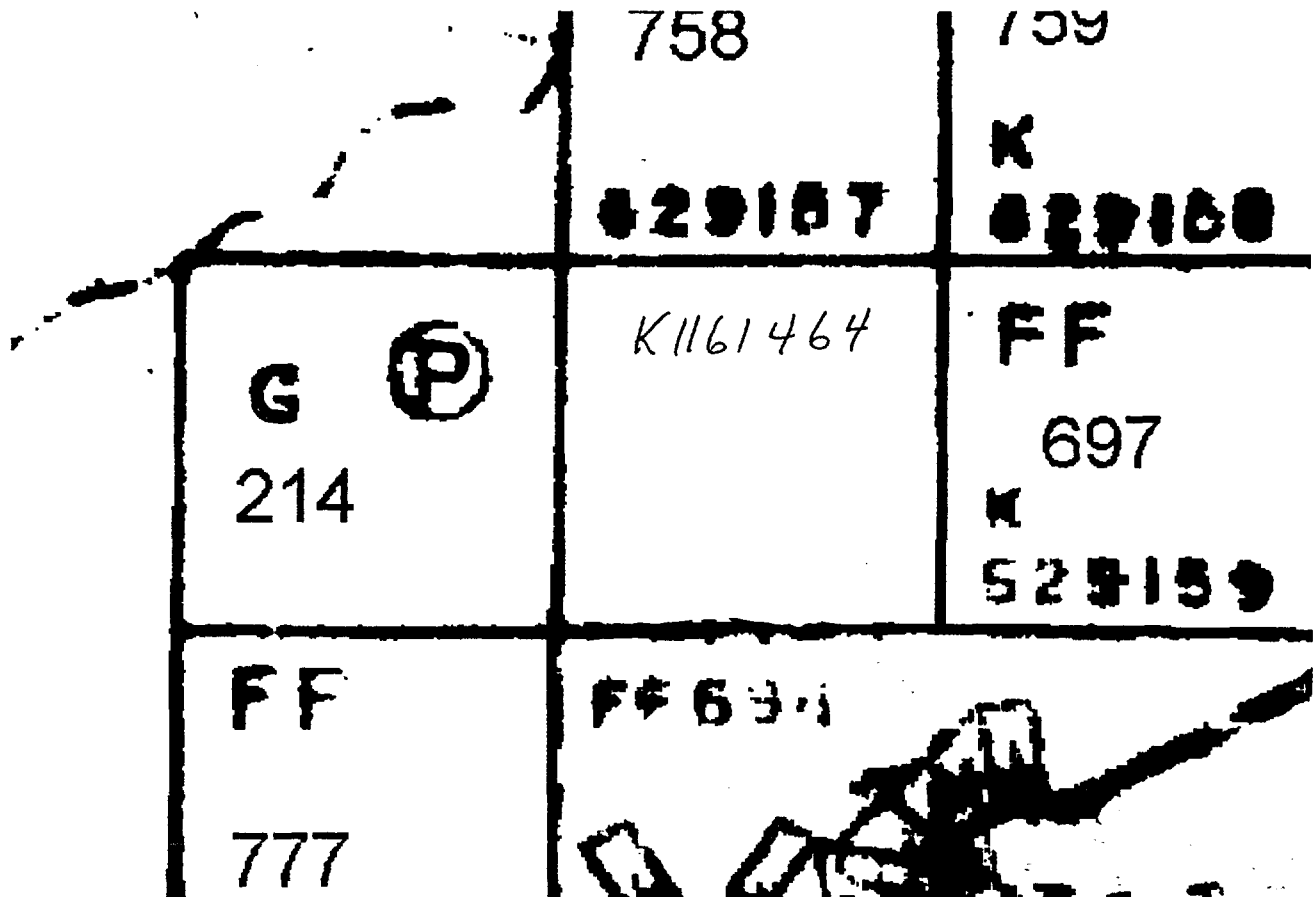

[Back](#) | [Main Menu](#) | [Mining Lands](#)

2.19428



This site maintained by the Government of Ontario
Comments and feedback to: steve.beneteau@ndm.gov.on.ca

© Copyright 1998 Queen's Printer for Ontario

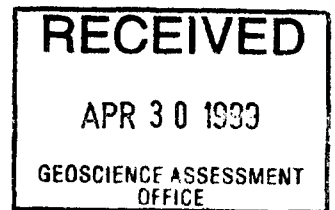

This information is provided as a public service, but we cannot guarantee that the information is current or accurate. Readers should verify the information before acting on it.



ACCURASSAY LABORATORIES

A DIVISION OF ASSAY LABORATORY SERVICES INC.

Page 1

1070 LITHIUM DRIVE, UNIT 2
THUNDER BAY, ONTARIO P7B 6G3
PHONE (807) 623-6448
FAX (807) 623-6820

Ray Pitkanen
RR #16, Site 3A - 10
Thunder Bay, Ontario
P7B 6B3

Apr 26, 1999

Job# 9940197

SAMPLE #		Gold	Gold
Accurassay	Customer	ppb	Oz/t
1	99-S1	<5	<0.001
2	99-S2	21699	0.633
3	99-S3	4072	0.119
4	99-S4	23	<0.001
5 Check	99-S4	28	<0.001

Certified By:

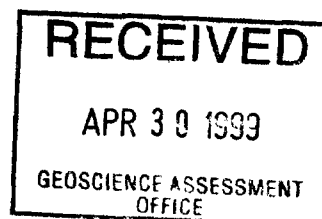



ACCURASSAY LABORATORIES

(A DIVISION OF ASSAY LABORATORY SERVICES, INC.)

MINERAL ASSAYERS, ENVIRONMENTAL CHEMISTS,
ANALYTICAL CONSULTANTS

1070 Lithium Drive, Unit 2, THUNDER BAY, ON P7B 6G3
Tel.: (807) 623-6448 Fax: (807) 623-8820

INVOICE

38811

TO

Pitkanen, Mr. Ray
R.R. #16, Site 3A - 10
Thunder Bay, ON
P7B 6B3

DATE

15-APR-99

CUSTOMER ORDER NO.

WORK ORDER NO.

RECEIVED

APR 30 1999

GEOSCIENCE ASSESSMENT

TERMS

QUANTITY	DESCRIPTION	PRICE	AMOUNT
	Job #9940197		
	10% Discount		
4	Sample Prep	\$3.82	15.28
4	Gold	\$8.69	34.76
1	Report Charge	\$4.50	4.50
	3 - GST @ 7.0%		3.82
	Due 15 MAY 99		
<p>Terms net 30 days, 2.5% per month on overdue accounts.</p> <p><i>Paid Jest 4/29/99 [Signature]</i></p>			<p>2.19428</p>
Total Amount			\$58.36

Thank You!

TPC-52282



Declaration of Assessment Work Performed on Mining Land

Mining Act, Subsection 65(2) and 66(3), R.S.O. 1990

Transaction Number (office use) W9940.00090
Assessment Files Research Imaging



52C10NE2003 2.19428 BAD VERMILION LAKE 900

of subsections 65(2) and 66(3) of the Mining Act. Under section 8 of the o review the assessment work and correspond with the mining land holder. g Recorder, Ministry of Northern Development and Mines, 6th Floor,

Instructions: - For work performed on Crown Lands before recording a claim, use form 0240.
- Please type or print in ink.

1. Recorded holder(s) (Attach a list if necessary)

Name REINO W PITKANEN		Client Number 182681	
Address RR #16, SITE 3A-10, THUNDER BAY		Telephone Number 807-683-7022	
ON P7B 6B3		Fax Number 807-683-7022	
Name		Client Number	
Address		Telephone Number	
		Fax Number	

2. Type of work performed: Check (✓) and report on only ONE of the following groups for this declaration.

- Geotechnical: prospecting, surveys, assays and work under section 18 (regs) Physical: drilling, stripping, trenching and associated assays Rehabilitation

Work Type STRIPPING - SAMPLING	Office Use
	Commodity
	Total \$ Value of Work Claimed 923
Dates Work Performed From 24 04 99 To 25 04 1999 Day Month Year Day Month Year	NTS Reference
Global Positioning System Data (if available)	Mining Division KENORA
Township/Area BAD VERMILION LAKE	Resident Geologist District
M or G-Plan Number G-2665	

Please remember to: - obtain a work permit from the Ministry of Natural Resources as required;
- provide proper notice to surface rights holders before starting work;
- complete and attach a Statement of Costs, form 0212;
- provide a map showing contiguous mining lands that are linked for assigning work;
- include two copies of your technical report.

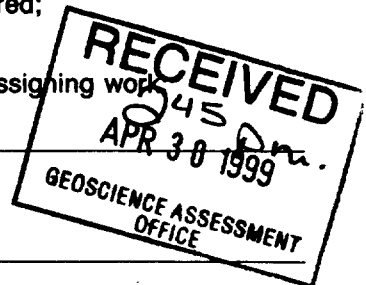

3. Person or companies who prepared the technical report (Attach a list if necessary)

Name RAY W PITKANEN	Telephone Number 807-683-7022
Address RR #16, SITE 3A-10 THUNDER BAY ON P7B6B3	Fax Number 807 683-7022
Name	Telephone Number
Address	Fax Number
Name	Telephone Number
Address	Fax Number

2.19428

4. Certification by Recorded Holder or Agent

I, REINO W PITKANEN (Print Name), do hereby certify that I have personal knowledge of the facts set forth in this Declaration of Assessment Work having caused the work to be performed or witnessed the same during or after its completion and, to the best of my knowledge, the annexed report is true.

Signature of Recorded Holder or Agent <i>Rw Pitkanen</i>	Date April 27/99
Agent's Address	Telephone Number 807-683-7022
	Fax Number 807-683-7022

5. Work to be recorded and distributed. Work can only be assigned to claims that are contiguous (adjoining) to the mining land where work was performed, at the time work was performed. A map showing the contiguous link must accompany this form.

W9910.00090

Mining Claim Number. Or if work was done on other eligible mining land, show in this column the location number indicated on the claim map.	Number of Claim Units. For other mining land, list hectares.	Value of work performed on this claim or other mining land.	Value of work applied to this claim.	Value of work assigned to other mining claims.	Bank Value of work to be distributed at a future date.
eg TB 7827	16 ha	\$26, 825	N/A	\$24,000	\$2,825
eg 1234567	12	0	\$24,000	0	0
eg 1234568	2	\$ 8, 892	\$ 4,000	0	\$4,892
1 1161464	ONE	923.00	923.00	0	
2					
3					
4					
5					
6					
7					
8					
9					
10					
11					
12					
13					
14					
15					
Column Totals					

I, REINO W. PITKANEN do hereby certify that the above work credits are eligible under subsection 7 (1) of the Assessment Work Regulation 8/96 for assignment to contiguous claims or for application to the claim where the work was done.

Signature of Recorded Holder or Agent Authorized in Writing: Reino Pitkanen Date: April 30/99

6. Instructions for cutting back credits that are not approved.

Some of the credits claimed in this declaration may be cut back. Please check (✓) in the boxes below to show how you wish to prioritize the deletion of credits:

- 1. Credits are to be cut back from the Bank first, followed by option 2 or 3 or 4 as indicated.
- 2. Credits are to be cut back starting with the claims listed last, working backwards; or
- 3. Credits are to be cut back equally over all claims listed in this declaration; or
- 4. Credits are to be cut back as prioritized on the attached appendix or as follows (describe):

2.19428

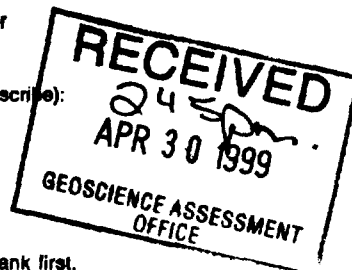

Note: If you have not indicated how your credits are to be deleted, credits will be cut back from the Bank first, followed by option number 2 if necessary.

For Office Use Only

Received Stamp	Deemed Approved Date	Date Notification Sent
	Date Approved	Total Value of Credit Approved
Approved for Recording by Mining Recorder (Signature)		

0241 (0/00)

Personal information collected on this form is obtained under the authority of subsection 6(1) of the Assessment Work Regulation 6/96. Under section 6 of the Mining Act, the information is a public record. This information will be used to review the assessment work and correspond with the mining land holder. Questions about this collection should be directed to the Chief Mining Recorder, Ministry of Northern Development and Mines, 6th Floor, 933 Ramsey Lake Road, Sudbury, Ontario, P3E 6B5.

Work Type	Units of Work <small>Depending on the type of work, list the number of hours/days worked, metres of drilling, kilometres of grid line, number of samples, etc.</small>	Cost Per Unit of work	Total Cost
STRIPPING - SAMPLING	4 MANDAYS	150.00	600.00
Associated Costs (e.g. supplies, mobilization and demobilization).			
- Measure string, Pump gas, Generator + Propane gas for Motorhome			21.08
Assay costs			58.36
Transportation Costs			
Motorhome from Home to site 1161464 277 km or 554 km return @ .30			166.20
Food and Lodging Costs			
Groceries - Safeway			77.77
Total Value of Assessment Work			923.41

RECEIVED
 2:45 PM
 APR 30 1999
 GEOSCIENCE ASSESSMENT OFFICE

2.19428

Calculations of Filing Discounts:

1. Work filed within two years of performance is claimed at 100% of the above Total Value of Assessment Work.
2. If work is filed after two years and up to five years after performance, it can only be claimed at 50% of the Total Value of Assessment Work. If this situation applies to your claims, use the calculation below:

TOTAL VALUE OF ASSESSMENT WORK x 0.50 = Total \$ value of worked claimed.

Note:
 - Work older than 5 years is not eligible for credit.
 - A recorded holder may be required to verify expenditures claimed in this statement of costs within 45 days of a request for verification and/or correction/clarification. If verification and/or correction/clarification is not made, the Minister may reject all or part of the assessment work submitted.

Certification verifying costs:

I, REINOLD W. PITKANEN (please print full name), do hereby certify, that the amounts shown are as accurate as may reasonably be determined and the costs were incurred while conducting assessment work on the lands indicated on the accompanying Declaration of Work form as RECORDED HOLDER I am authorized (recorded holder, agent, or state company position with signing authority) to make this certification.

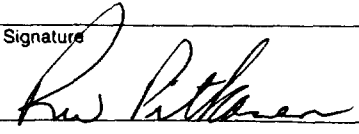
Signature 	Date April 27/99
---	---------------------

Geoscience Assessment Office
933 Ramsey Lake Road
6th Floor
Sudbury, Ontario
P3E 6B5

Telephone: (888) 415-9846
Fax: (877) 670-1555

May 11, 1999

REINO WILLIAM PITKANEN
R.R. 16
SITE 3A-10
THUNDER BAY, Ontario
P7B-6B3

Visit our website at:
www.gov.on.ca/MNDM/MINES/LANDS/mlsmnpge.htm

Dear Sir or Madam:

Submission Number: 2.19428

Status

Subject: Transaction Number(s): W9910.00090 Deemed Approval

We have reviewed your Assessment Work submission with the above noted Transaction Number(s). The attached summary page(s) indicate the results of the review. WE RECOMMEND YOU READ THIS SUMMARY FOR THE DETAILS PERTAINING TO YOUR ASSESSMENT WORK.

If the status for a transaction is a 45 Day Notice, the summary will outline the reasons for the notice, and any steps you can take to remedy deficiencies. The 90-day deemed approval provision, subsection 6(7) of the Assessment Work Regulation, will no longer be in effect for assessment work which has received a 45 Day Notice. Allowable changes to your credit distribution can be made by contacting the Geoscience Assessment Office within this 45 Day period, otherwise assessment credit will be cut back and distributed as outlined in Section #6 of the Declaration of Assessment work form.

Please note any revisions must be submitted in DUPLICATE to the Geoscience Assessment Office, by the response date on the summary.

If you have any questions regarding this correspondence, please contact Bruce Gates by e-mail at bruce.gates@ndm.gov.on.ca or by telephone at (705) 670-5856.

Yours sincerely,



ORIGINAL SIGNED BY
Blair Kite
Supervisor, Geoscience Assessment Office
Mining Lands Section

Work Report Assessment Results

Submission Number: 2.19428

Date Correspondence Sent: May 11, 1999

Assessor: Bruce Gates

Transaction Number	First Claim Number	Township(s) / Area(s)	Status	Approval Date
W9910.00090	1161464	BAD VERMILION LAKE	Deemed Approval	May 11, 1999

Section:

10 Physical PSTRIIP

Correspondence to:

Resident Geologist
Kenora, ON

Recorded Holder(s) and/or Agent(s):

REINO WILLIAM PITKANEN
THUNDER BAY, Ontario

Assessment Files Library
Sudbury, ON

LITTLE TURTLE LAKE - G-2682

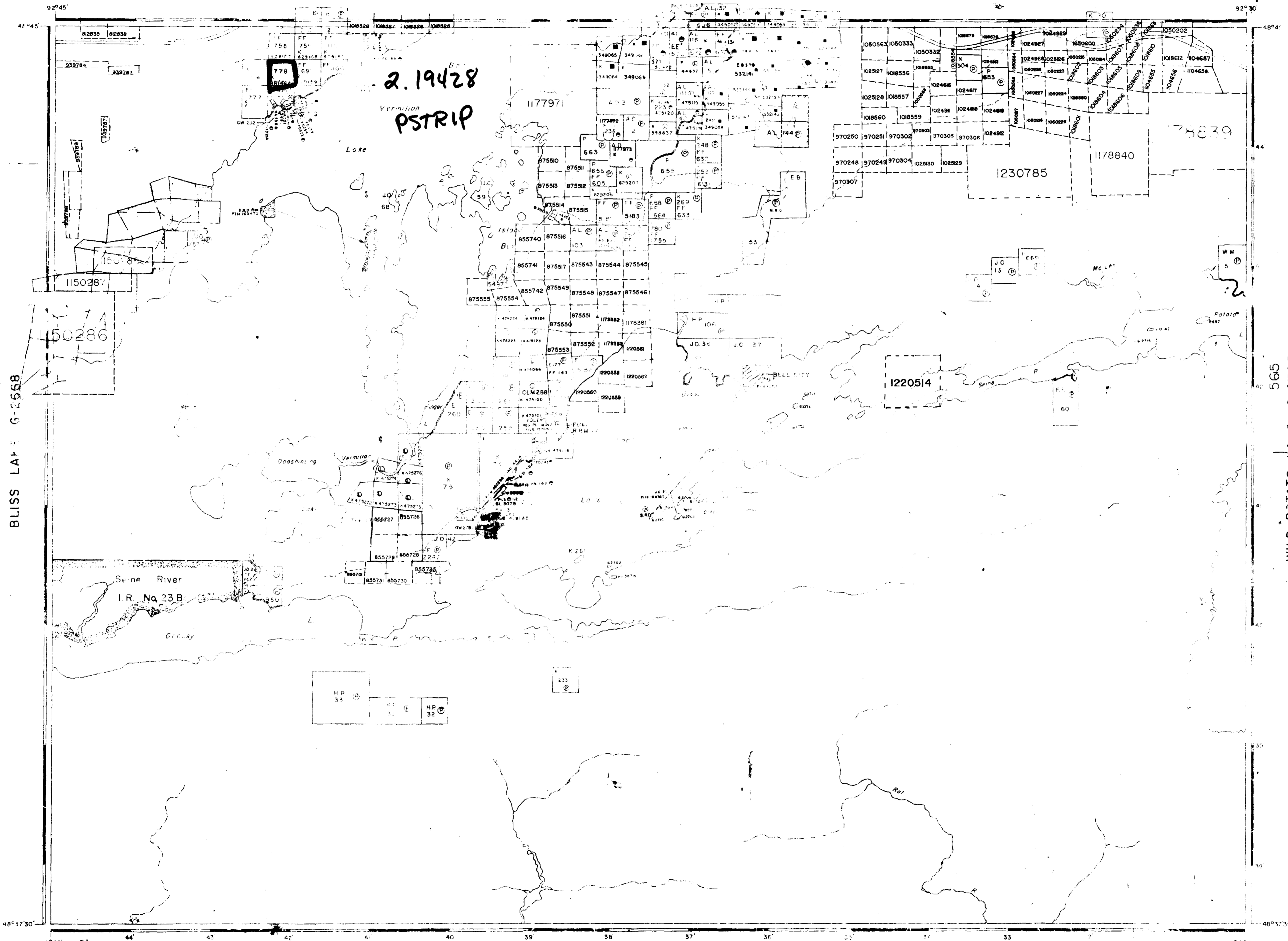

BLISS LAKE - G-2568

WILD POTATO LAKE - G-2793

LEGEND

PATENTED LAND	Ⓟ
CROWN LAND SALE	C.S.
LEASES	Ⓛ
LOCATED LAND	Loc.
LICENSE OF OCCUPATION	L.O.
MINING RIGHTS ONLY	M.R.O.
SURFACE RIGHTS ONLY	S.R.O.
ROADS	—
IMPROVED ROADS	—
KIMIK HIGHWAYS	—
RAILWAYS	—
POWER LINES	—
MARSH OR MUSKOG	—
MINES	—
CANCELLED PATENTED	—

REFERENCES

ALBANY DISTRICT LAND RECORDS
 S.R.O. - SURFACE RIGHTS ONLY
 M.R.O. - MINING RIGHTS ONLY
 L.O. - LICENSE OF OCCUPATION

THE INFORMATION THAT APPEARS ON THIS MAP HAS BEEN COMPILED FROM VARIOUS SOURCES AND IS NOT GUARANTEED.

M.R.O. FORFEITED JAN. 1184 RE-OPENED JUNE 3, 1894
 MAY 12 1899

LANDS OPEN TO STAKE CLAIMS
 JUNE 3, 1894
 C-3-94

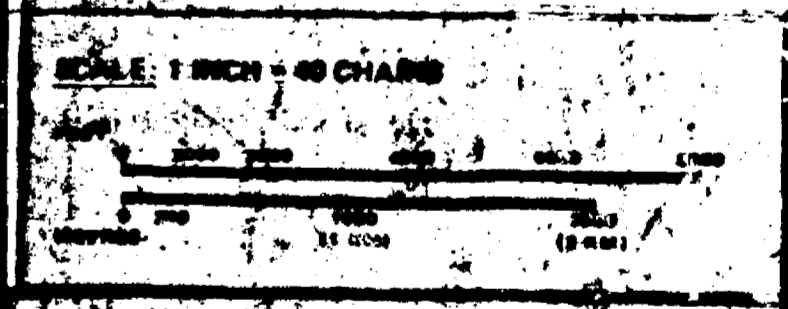

BAD VERMILION LAKE
 DISTRICT OF
FORT FRANCES
KENORA
RAMY RIVER

52610
 14

MELIN LAKE - G-2689

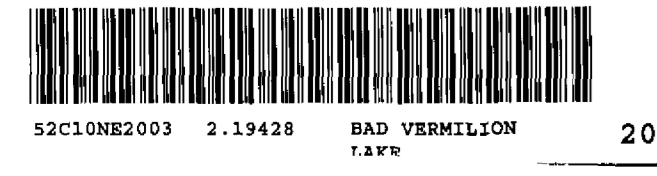

52610