



52C10NW1002 16 BLISS LAKE

010

DIAMOND DRILLING

AREA: BLISS LAKE

REPORT NO: 16

WORK PERFORMED FOR: Minnova Inc.

RECORDED HOLDER: Same as Above [xx]
: Other []

<u>Claim No.</u>	<u>Hole No.</u>	<u>Footage</u>	<u>Date</u>	<u>Note</u>
873627	ML-08	431.60m	Mar/88	(1)

NOTES: (1) W8901.111, date filed May/89

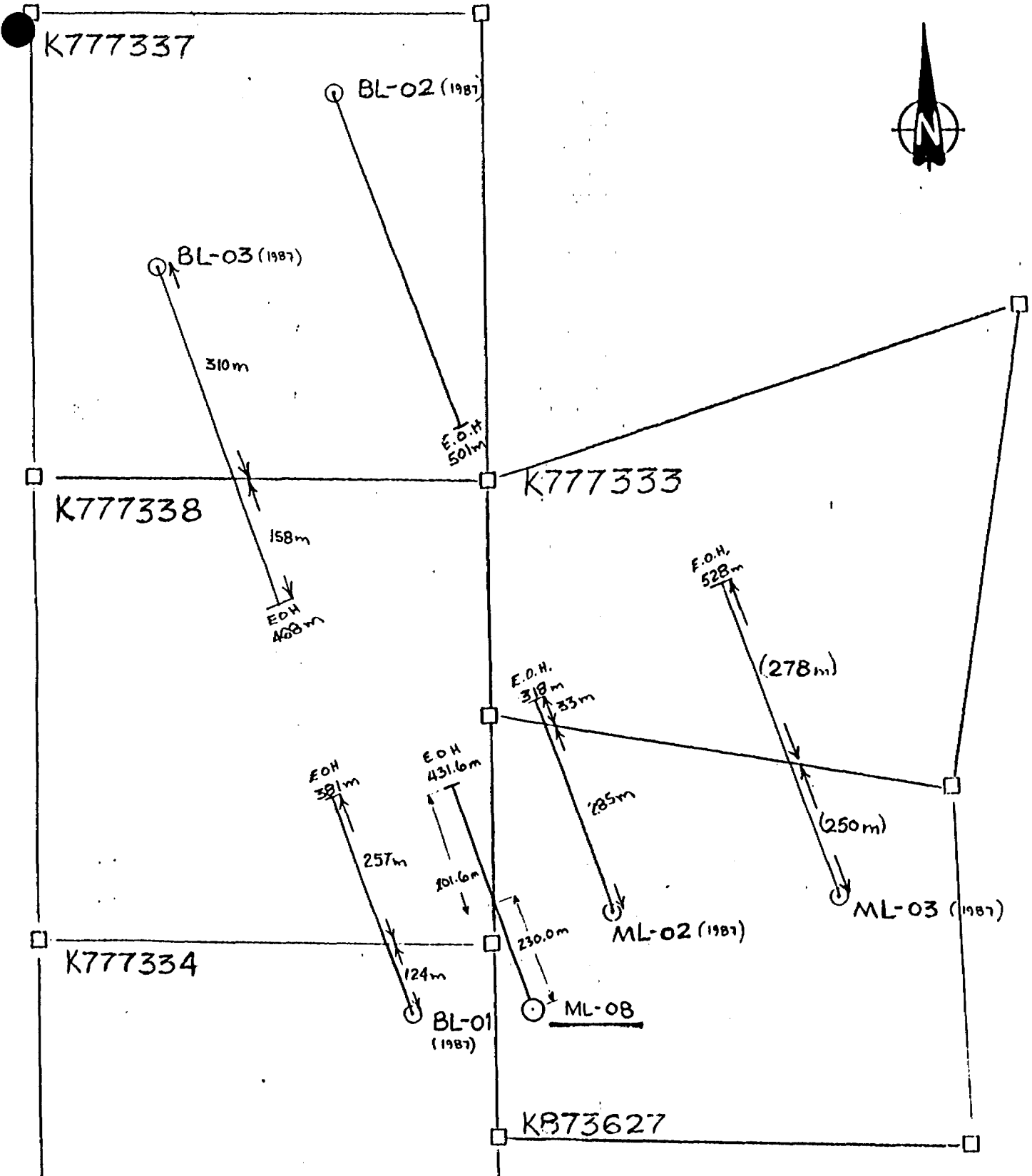

**SWELL BAY
DRILL PLAN**

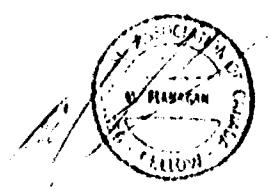
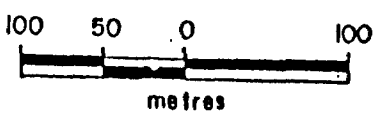



230.0m

K873627

201.6m

K777338

0 50
metres

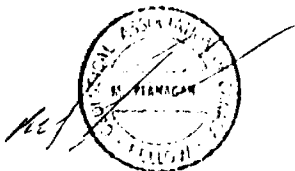

431.6m

HOLE NUMBER: ML-08

MINNOVA INC.
DRILL HOLE RECORD

IMPERIAL UNITS: METRIC UNITS: X

PROJECT NAME: SWELL BAY/MUDGE LAKE
PROJECT NUMBER: PN399
CLAIM NUMBER: 777338, 873627
LOCATION: BLISS LAKE ZONE

PLOTTING COORDS GRID: METRIC
NORTH: 1425.00S
EAST: 12900.00E
ELEV: 0.01

ALTERNATE COORDS GRID:
NORTH: 0+ 0
EAST: 0+ 0
ELEV: 0.00

COLLAR DIP: -69° 0' 0"
LENGTH OF THE HOLE: 431.60m
START DEPTH: 0.00m
FINAL DEPTH: 431.60m

COLLAR GRID AZIMUTH: 360° 0' 0"

COLLAR ASTROMONIC AZIMUTH: 340° 0' 0"

DATE STARTED: March 10, 1988
DATE COMPLETED: March 21, 1988
DATE LOGGED: March 23, 1988

COLLAR SURVEY: NO
MULTISHOT SURVEY: YES
ROD LOG: NO

PULSE EM SURVEY: YES
PLUGGED: NO
HOLE SIZE: BQ

CONTRACTOR: AMITY DRILLING
CASING: 27.5
CORE STORAGE: ROBINSON'S LANDING

PURPOSE:

DIRECTIONAL DATA:

Depth (m)	Astronomic Azimuth	Dip degrees	Type of Test	FLAG	Comments	Depth (m)	Astronomic Azimuth	Dip degrees	Type of Test	FLAG	Comments
24.50	.	-67° 0'	ACID		ROTDIP ONLY
69.00	.	-66° 0'	ACID		
129.50	.	-62° 0'	ACID		ROTDIP MALFUNCTION
154.00	.	-63° 0'	ACID		
178.50	.	-63° 0'	ACID		
212.00	.	-61° 0'	ACID		
212.00	.	-61° 0'	ACID		
257.50	.	-60° 0'	ACID		
281.50	.	-60° 0'	ACID		
316.00	.	-57° 0'	ACID		
340.00	.	-57° 0'	ACID		
405.00	.	-53° 0'	ACID		ROTDIP
410.30	.	-53° 0'	ACID		ROTDIP
36.50	340° 0'	-67° 5'	MULTISHOT	OK	
61.00	344° 0'	-66° 0'	MULTISHOT	OK	
91.00	347° 0'	-64° 0'	MULTISHOT	OK	
122.00	347° 0'	-63° 0'	MULTISHOT	OK	
152.00	347° 0'	-63° 0'	MULTISHOT	OK	
183.00	347° 0'	-63° 0'	MULTISHOT	OK	
213.00	348° 0'	-62° 0'	MULTISHOT	OK	
244.00	349° 0'	-60° 0'	MULTISHOT	OK	
274.00	350° 0'	-59° 0'	MULTISHOT	OK	
305.00	350° 0'	-58° 0'	MULTISHOT	OK	
335.00	348° 0'	-56° 0'	MULTISHOT	OK	
366.00	347° 0'	-54° 30'	MULTISHOT	OK	
396.00	352° 0'	-52° 30'	MULTISHOT	OK	
427.00	354° 0'	-52° 0'	MULTISHOT	OK	

ONTARIO GEOLOGICAL SURVEY
ASSESSMENT FILES
OFFICE
APR 25 1989
RECEIVED

HOLE NUMBER: ML-08

DRILL HOLE RECORD

LOGGED BY: MIKE FLANAGAN

PAGE: 1

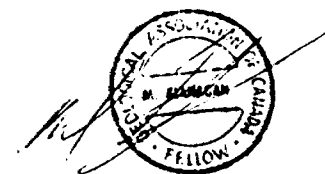

April 15, 1989

MOLE NUMBER: ML-08

MINNOVA INC.
DRILL MOLE RECORD

DATE: 4-July-1988

FROM TO	ROCK TYPE	TEXTURE AND STRUCTURE	ANGLE TO CA	ALTERATION	MINERALIZATION	REMARKS																																																
0.00 TO 24.70	OVERBURDEN «OB»																																																					
24.70 TO 57.90	ANORTHOSITE «ANORT»	Coarse grained, moderately inhomogeneous, greyish green coloured intermediate intrusive. Coarse green-grey feldspar phenocrysts up to 80% of rock in fine grained chloritic matrix. Somewhat porphyritic. Local fine grained chlorite sections. @ 50.0-57.9 strongly sheared @	34																																																			
57.90 TO 294.90	MAFIC «MA»	<p>Green, fine grained, homogeneous moderate to strongly chloritic mafic volcanic. Minor calcite veins. @ 189.8-197.0 increasing chlorite/sericite and (sheared) strong foliation @</p> <p>197.0-198.5 Mafic crystal tuff. Phenocrysts of feldspar and mafic mineral (chloritic) up to 2mm diameter comprising 20% of section.</p> <p>203.0-203.9 Very fine grained mafic with increased py sections of moderate fine grained mafic flow 201.6-205.3. Contact at 205.3</p> <p>208.6-222.6 Section with anhedral grains and grain aggregates up to 5mm in diameter of sulphides with minor coarse patches of sulphides. Contact @ 223.8</p> <p>224.0-225.3 Section with minor stringers of sulphides.</p> <p>225.0-225.3 5% sulphides.</p> <p>247.0-247.2 Barren chert section. Contact @</p>	<p>47</p> <p>50</p> <p>49</p> <p>46</p>	<p>Moderate to strong chlorite throughout section.</p> <p>{57.9-294.9} «chloritic alt»</p>	<p>203.0-203.9 Finely disseminated pyrite < 2%.</p> <p>Py + po < 2%.</p> <p>Py + po 1%.</p> <p>{225.0-225.3} «py + po + ep 5%»</p> <p>Py + po 3% @ 249.2-249.4.</p>	<table border="0"> <tr> <td></td> <td></td> <td></td> <td></td> <td>Na2O</td> <td>Zn</td> </tr> <tr> <td>60.0-</td> <td>63.0</td> <td>MSD 1530</td> <td></td> <td>1.07</td> <td>40</td> </tr> <tr> <td>90.0-</td> <td>93.0</td> <td>MSD 1531</td> <td></td> <td>0.59</td> <td>33</td> </tr> <tr> <td>120.0-</td> <td>123.0</td> <td>MSD 1532</td> <td></td> <td>1.03</td> <td>51</td> </tr> <tr> <td>150.0-</td> <td>153.0</td> <td>MSD 1533</td> <td></td> <td>1.10</td> <td>46</td> </tr> <tr> <td>180.0-</td> <td>183.0</td> <td>MSD 1534</td> <td></td> <td>1.03</td> <td>51</td> </tr> <tr> <td>191.0-</td> <td>194.0</td> <td>MSD 1535</td> <td></td> <td>0.38</td> <td>57</td> </tr> <tr> <td>209.0-</td> <td>212.0</td> <td>MSD 1536</td> <td></td> <td>0.98</td> <td>41</td> </tr> </table> <p>203.0-203.9 MSD 1985</p> <p>230.0-233.0 MSD 1537 0.43 39</p> <p>224.0-225.0 MSD 1986</p> <p>225.0-225.3 MSD 1987</p>					Na2O	Zn	60.0-	63.0	MSD 1530		1.07	40	90.0-	93.0	MSD 1531		0.59	33	120.0-	123.0	MSD 1532		1.03	51	150.0-	153.0	MSD 1533		1.10	46	180.0-	183.0	MSD 1534		1.03	51	191.0-	194.0	MSD 1535		0.38	57	209.0-	212.0	MSD 1536		0.98	41
				Na2O	Zn																																																	
60.0-	63.0	MSD 1530		1.07	40																																																	
90.0-	93.0	MSD 1531		0.59	33																																																	
120.0-	123.0	MSD 1532		1.03	51																																																	
150.0-	153.0	MSD 1533		1.10	46																																																	
180.0-	183.0	MSD 1534		1.03	51																																																	
191.0-	194.0	MSD 1535		0.38	57																																																	
209.0-	212.0	MSD 1536		0.98	41																																																	

MOLE NUMBER: ML-08

DRILL MOLE RECORD

LOGGED BY: MIKE FLANAGAN

PAGE: 2

MOLE NUMBER: ML-08

MINNOVA INC.
DRILL MOLE RECORD

DATE: 4-July-1988

FROM TO	ROCK TYPE	TEXTURE AND STRUCTURE	ANGLE TO CA	ALTERATION	MINERALIZATION	REMARKS
		263.9-266.1 Section with sericitic cherty bands and fragments in fine grained chloritic mafic. 266.0 Foliation @	40	Moderate to strong chlorite. Occasional medium to coarse grain sericite.	276.30-276.35 Cp stringers in sericitic feldspathic white bands. (Py) po, cp stringers increasing in abundance @ 281.3 approximately 5 veinlets/metre with average width of 1mm; to 287.7. 287.7-288.2 < 1% po, cp. 290.8-292.5 1% po, cp, no pyrite. 294.5-294.7 2% po, py.	260.0-263.0 MSD 1538 Na2O Zn 0.33 40 MSD 1991 to 1997. MSD 1988. 290.8-291.7 MSD 1989 291.7-292.4 MSD 1990 Na2O Zn 291.0-292.0 MSD 1539 0.66 150 S102 Cu/ppm 1539 28.3 1670
294.90 TO 297.60	<<E DYKE>>	Grey to charcoal grey, fine grained, moderate equigranular intermediate to felsic dyke in contact with quartz +/- felds porphyritic dyke. Upper contact @ Quartz phenocrysts <= 5mm diameter comprising approximately 4% of porphyritic section. Several dark coloured (biotitic) fragments up to 7mm diameter may suggest pyroclastic.	39			This rock is similar to "Feeder dyke" in ML-04 compare litho samples ML-04 T8D 7351 S102 T102 Al2O3 Na2O 291.7-291.9 60.1 0.72 14.2 4.53 ML-08 MSD 1540 Na2O Zn 295.5-295.8 5.70 87 See also ML-02.
297.60 TO 298.20	MAFIC <<MA>>	Chloritic, strongly foliated mafic.				
298.20 TO 301.10	<<E DYKE>>	Grey, fine grained qtz +/- feldspar porphyritic dyke.				2.3m of lost core 1
301.10 TO 303.50	MAFIC <<MA>>	Chloritic, moderate to strongly foliated.		Chlorite, carbonate stringers.		

MOLE NUMBER: ML-08

DRILL MOLE RECORD

LOGGED BY: MIKE FLANAGAN

PAGE: 3

HOLE NUMBER: ML-08

MINNOVA INC.
DRILL HOLE RECORD

DATE: 4-July-1988

FROM TO	ROCK TYPE	TEXTURE AND STRUCTURE	ANGLE TO CA	ALTERATION	MINERALIZATION	REMARKS
303.50 TO 304.30	GE DYKE «GE DYKE»	Grey, Qtz +/- feldspar porphyritic dyke; diffuse contacts.				
304.30 TO 332.10	MAFIC «MA»	Green, fine grained, homogeneous mafic. Moderately foliated. Foliated feldspar porphyritic mafic flow at 314.7-315.6. 329.6-331.4 Mafic with cherty - sericitic bands associated with py +/- po.		Strong chlorite.	Occasional po +/- cp stringers grading to py only, below 333.0.	MSD 1541 318.0-321.0 Na2O Zn 0.41 46
332.10 TO 332.30	GE DYKE «GE DYKE»	Qtz +/- feldspar porphyritic dyke. Contact B	55			
332.30 TO 333.10	MAFIC «MA»	As above MA.				
333.10 TO 333.60	GE DYKE «GE DYKE»	Qtz +/- feldspar porphyritic dyke; diffuse contacts.				
333.60 TO 359.00	MAFIC «MA»	Green, fine grained mafic. Moderately to strongly foliated with sections containing feldspathic carbonate bands +/- pyrite. Medium grained mafic flow 350.3-351.9		Strong chlorite.		MSD 1542 352.0-355.0 Na2O Zn 1.36 416
359.00 TO 424.10	SPHER RHY «SPHER RHY»	Green, heterogeneous textured variolitic/ spherulitic, hystoclastic and amygdaloidal int/ mafic flows. Matrix chloritic. Thin interflow chloritic seds? and cherty mudstones. Siliceous medium to fine grained spherulites increasingly coalescing with concomitant decrease in chlorite at 380.3. 405.6-406.5 Coarse spherulitic unit. 408.4		Alteration weakening ?	1cm wide cp, po stringer at 385.7 chloritic, po rich 5cm band at 389.3. 394.2-395.0 1% disseminated py +/- sphal.	MSD 1543 365.6-367.1 Na2O Zn 2.68 65 MSD 1544 398.0-401.0. 3.39 68

HOLE NUMBER: ML-08

DRILL HOLE RECORD

LOGGED BY: MIKE FLANAGAN

PAGE: 4

HOLE NUMBER: ML-08

MINNOVA INC.
DRILL HOLE RECORD

DATE: 4-July-1988

FROM TO	ROCK TYPE	TEXTURE AND STRUCTURE	ANGLE TO CA	ALTERATION	MINERALIZATION	REMARKS
		Contact @ 408.4-409.0 Pink hematized fragments and fractures. 10cm wide, chloritic, po-rich metased at 411.5.	56 41		412.4-412.9 1% disseminated po.	
424.10 TO 424.30	CHERT «CHERT»	Mineralized cherty metased.	63		5% finely disseminated po, cp, sphal.	MSD 2000 Po 1%, Cp 0.5%, sphal 0.5% Cu/ppm 758 Zn/ppm 5640
424.30 TO 431.60	ANDESITE «ANDES» E.O.H.	Green, fine grained moderately homogeneous, weakly to moderate foliated andesite. Minor amygdaloidal sections. End of Hole.		Moderate chlorite.		

HOLE NUMBER: ML-08

DRILL HOLE RECORD

LOGGED BY: MIKE FLANAGAN

PAGE: 5



Ministry of Natural Resources
Report of Work

DOCUMENT NO
W8901-111



52C10NW1002 16 BLISS LAKE

900

Ontario
Name and Postal Address of Recorded Holder
BAD VERMILION 63665
LITTLE TURTLE LK 2626512
LAKESHORE TWP M2081 BLISS LK 62668

The Mini

MINNOVA Inc., T-556
SUITE 3970, P. O. BOX 91, COMMERCE COURT WEST, TORONTO, ONTARIO M5L 1C7

Summary of Work Performance and Distribution of Credits

Total Work Days Cr. claimed 4325 DAYS	Mining Claim			Mining Claim			Mining Claim		
	Prefix	Number	Work Days Cr.	Prefix	Number	Work Days Cr.	Prefix	Number	Work Days Cr.
for Performance of the following work. (Check one only) <input type="checkbox"/> Manual Work <input type="checkbox"/> Shaft Sinking Drifting or other Lateral Work. <input type="checkbox"/> Compressed Air, other Power driven or mechanical equip. <input type="checkbox"/> Power Stripping <input checked="" type="checkbox"/> Diamond or other Core drilling BQ <input type="checkbox"/> Land Survey	K	835126	100	LK	835134	100	K	862220	99
		127	100		135	100		221	99
		128	100		136	100		222	99
		129	100		137	100		223	99
		835130	100		835138	100		224	99
		131	100					225	99
		132	100		846551	100		862226	99
		835133	100					see attached page	

All the work was performed on Mining Claim(s): K 670226; K 777338; K 830403; K 830404; K 873627 additional claims

Required Information eg: type of equipment, Names, Addresses, etc. (See Table Below)

WORK PERFORMED BY: AMITY DRILLING LIMITED, 9002 QUARTZ ROAD, WHITEHORSE, YUKON Y1A 2Z5
D.D.H. ML-08 MARCH 10th - 21st, 1988

WORK PERFORMED BY: ST. LAMBERT DRILLING CO. LTD., P.O. BOX 473, VALLEYFIELD, QUEBEC J6S 4V7
D.D.H.'s ML-09, ML-10, HS-09, APRIL 26th - JUNE 20th, 1988

HOLE NUMBER	CLAIM NUMBER(S)	DRILLING DATES	METERS
ML-08	K 777338 201.6 M K 873627 230.0 M	MARCH 10th - 21st, 1988	431.6
ML-09	K 830404 113.0 M K 830403 298.1 M	APRIL 26th - MAY 6th, 1988	411.1
ML-10	K 830404 187.0 M K 830403 71.0 M	MAY 6th - 12th, 1988	258.0
HS-09	K 670226	JUNE 15th - 20th, 1988	282.0

TO BE USED FOR THIS SUBMISSION 4325.0 DAYS
RETAINED FOR FUTURE SUBMISSION 210.25 DAYS

1,382.7 x 3.28 = 4535.25 DAYS/FEET

670221

APR 25 1989

Ontario Geological Survey
ASSESSMENT FILES
OFFICE

Date of Report: APRIL 18th, 1989
Recorded Holder or Agent (Signature):

Certification Verifying Report of Work
I hereby certify that I have a personal and intimate knowledge of the facts set forth in the Report of Work annexed hereto, having performed the work or witnessed same during and/or after its completion and the annexed report is true.

Name and Postal Address of Person Certifying
MICHAEL FLANAGAN c/o MINNOVA Inc. 2606 VICTORIA AVENUE, EAST, THUNDER BAY,
ONTARIO P7C 1E7

Date Certified: APRIL 18th, 1989
Certified by (Signature):

Table of Information/Attachments Required by the Mining Recorder

Type of Work	Specific information per type	Other information (Common to 2 or more types)	Attachments
Manual Work	APR 19 1989 AM Nil 915 PM 789101112123456	Names and addresses of men who performed manual work/operated equipment, together with dates and hours of employment.	Work Sketch: these are required to show the location and extent of work in relation to the nearest claim post.
Shaft Sinking, Drifting or other Lateral Work			
Compressed air, other power driven or mechanical equip.	Type of equipment	Names and addresses of owner or operator together with dates when drilling/stripping done.	Work Sketch (as above) in duplicate
Power Stripping	Type of equipment and amount expended. Note: Proof of actual cost must be submitted within 30 days of recording.		
Diamond or other core drilling	Signed core log showing; footage, diameter of core, number and angles of holes.	Nil	Nil
Land Survey	Name and address of Ontario land surveyer.		

APRIL 18th, 1988

DIAMOND DRILLING ASSESSMENT - LICENCE T-556

ADDITIONAL CLAIMS

• • • • •
Minnova Inc.
Mining Innovation
2606 Victoria Avenue East
Thunder Bay, Ontario
P7C 1E7
Telephone (807) 623-1511
Telecopier (807) 623-7019

<u>CLAIM NUMBER</u>	<u>DAYS</u>
K 939128	58
129	58
939130	58
K 939131	58
and	
K 939783	100
784	100
K 939785	100
and	
K 939787	100
788	100
789	100
K 939790	100
791	100
792	100
793	100
794	100
K 939795	100
and	
K 939798	100
939799	100
and	
K 965521	100
522	100
523	100
524	100
525	100
K 965526	100

Total 45 Claims

4,325 Days used for this
submission

KENORA
MINING DIV.
R E C E I V E D
APR 19 1989
AM PM
789101112123456

MINNOVA

April 18th, 1989

Mr. Scott Rivett
The Mining Recorder
Kenora Mining Division
Ministry of Northern Development and Mines
808 Robertson Street
Kenora, Ontario
P9N 3X9

Minnova Inc.
Mining Innovation
2606 Victoria Avenue East
Thunder Bay, Ontario
P7C 1E7
Telephone (807) 623-1511
Telecopier (807) 623-7019

RE: FILING OF 4,325.0 DAY/FEET DIAMOND DRILLING - 45 CLAIMS

K 835126 etal BLISS, MUDGE, BAD VERMILION LAKE AREAS

Dear Sir:

Enclosed please find two copies of "Yellow Report of Work" covering the filing of 4,325.0 days of BQ diamond drilling on 45 claims. This filing will bring all of these claims to the required 200 days of assessment. We will retain a drill bank for future submission of 210.25 days/feet as the total of the meters drilled on Holes ML-8, 9, 10 and HS-9 is equivalent to 4,535.25 days/feet.

Two sets of drill logs and location sketches/sections accompany the Report of Work.

Yours truly,

MINNOVA Inc.

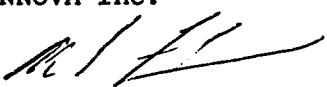

Michael Flanagan

MF/cme

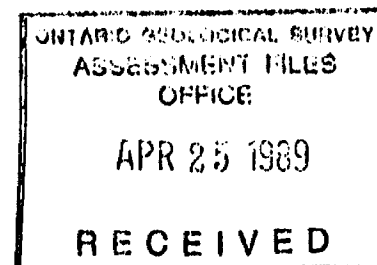
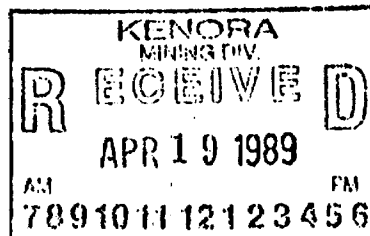
encls. 2 Reports

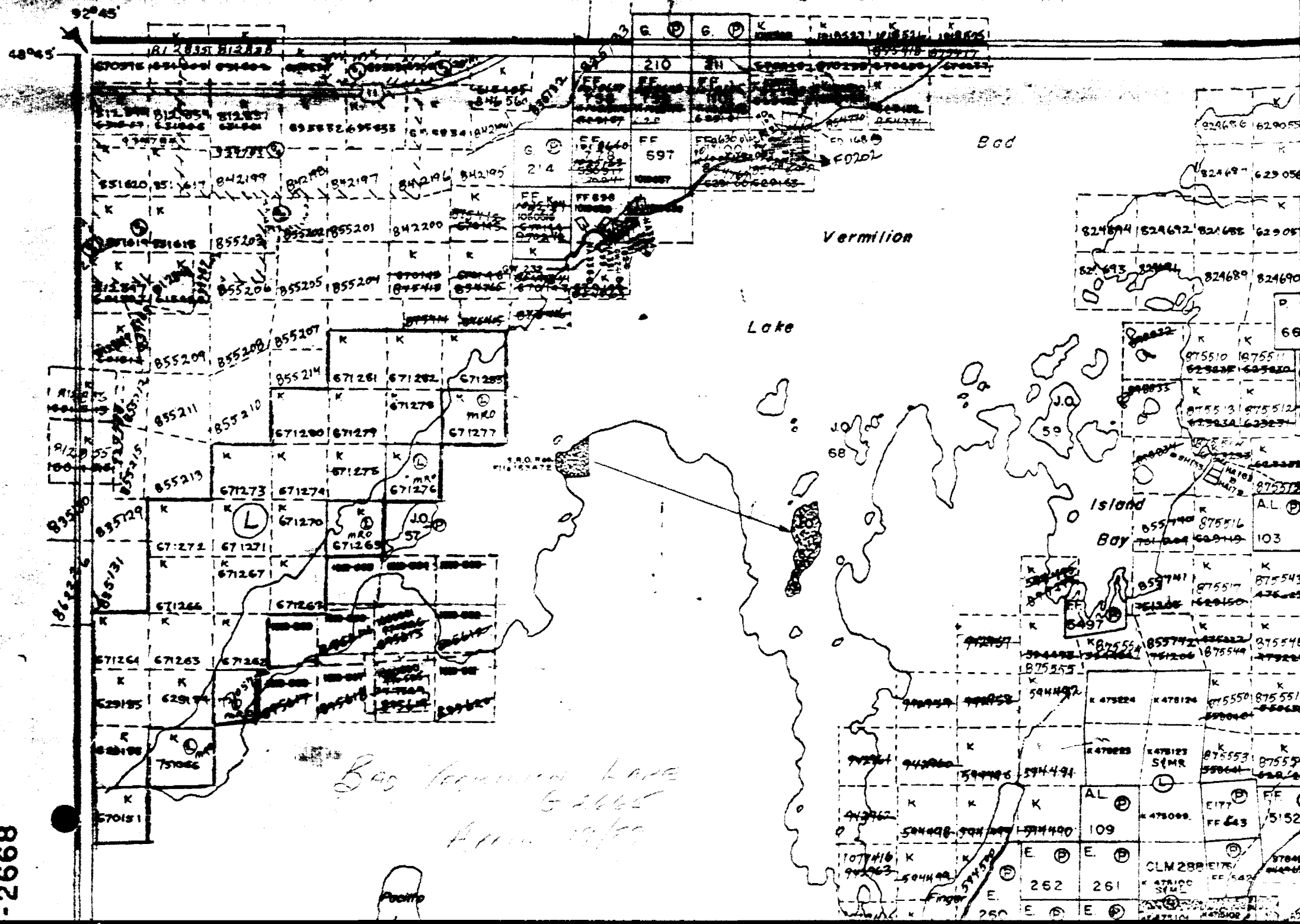

-2668



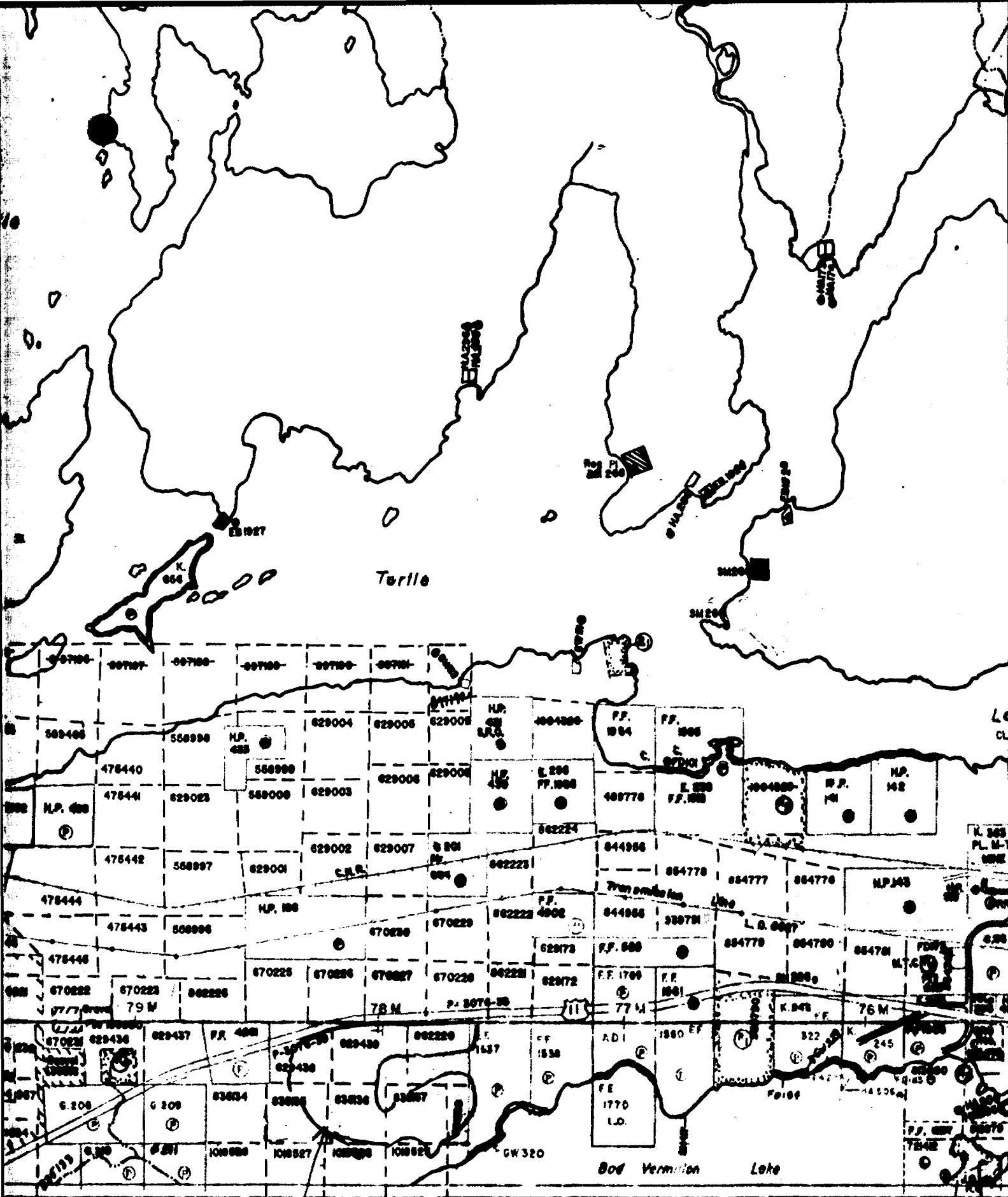

88/89
cut

GRASSY LAKE

LITTLE TURTLE LAKE G 2682 APRIL 19/89

Bliss Lake 62668
April 19/89

TIMBER 84

88/89
cut

Border
Lake

GW 104

BLISS LAKE

VERMILION LAKE 6-2665

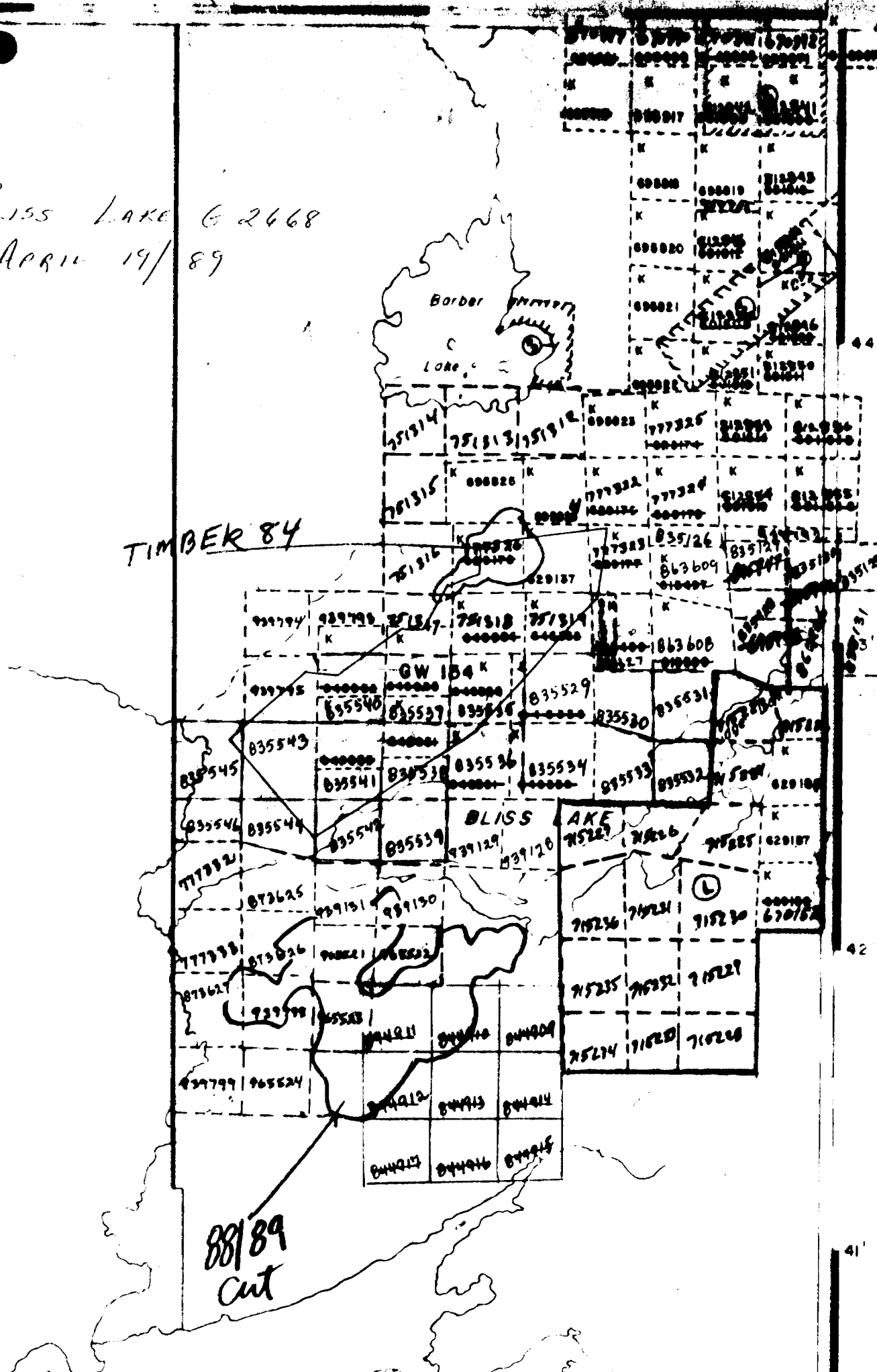

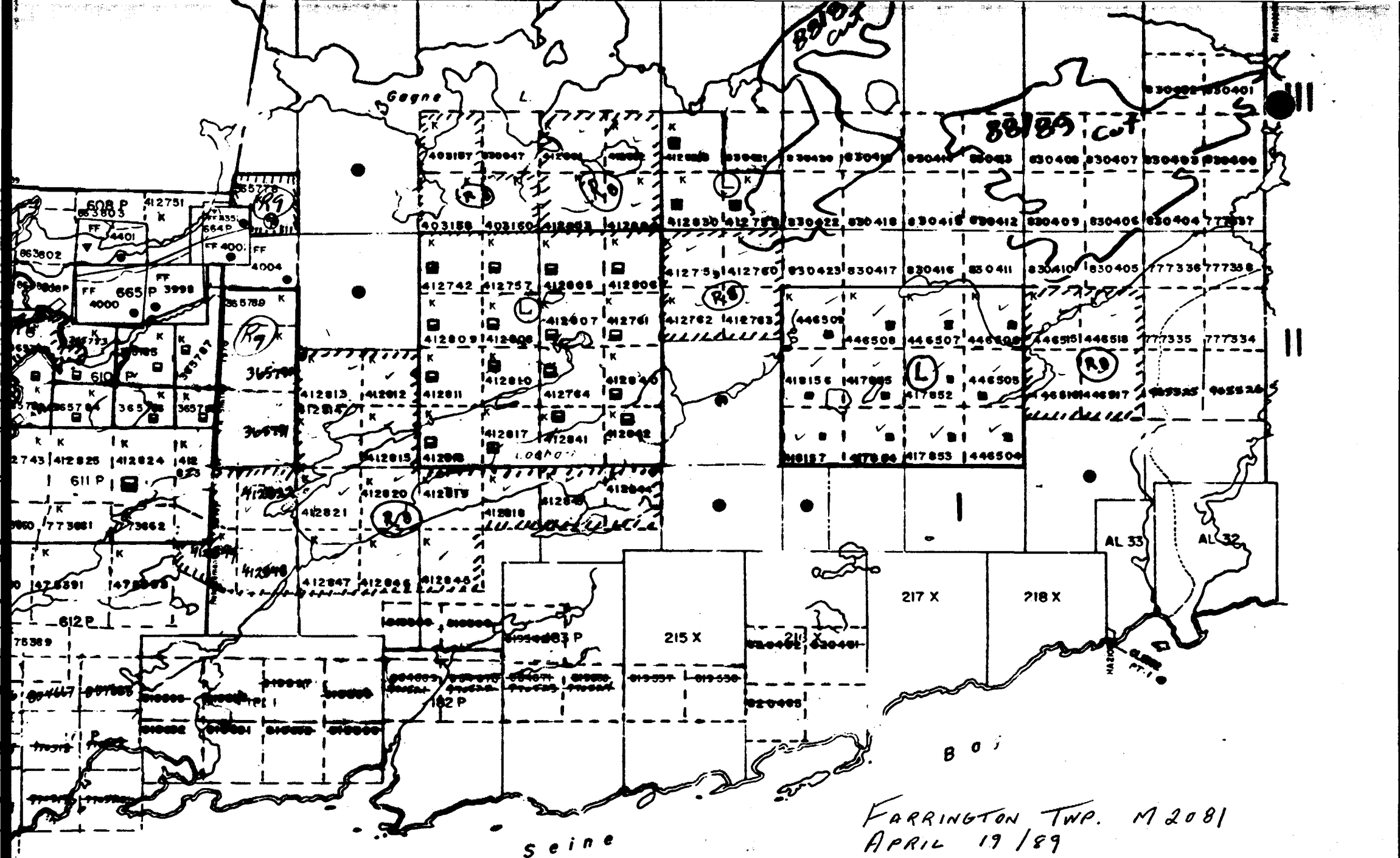

FARRINGTON TWP. M 2081
 APRIL 19 / 89