

DIAMOND DRILLING



52C10NW1007 11 BLISS LAKE

010

AREA: Bliss Lake

REPORT NO: 11

WORK PERFORMED FOR: Titan-Titanium International Inc.

RECORDED HOLDER: SAME AS ABOVE [x]

: OTHER []

<u>CLAIM NO.</u>	<u>HOLE NO.</u>	<u>FOOTAGE</u>	<u>DATE</u>	<u>NOTE</u>
K 715232	T-85-12	293'	Jan/85	(1)
	T-85-13	413'	Jan-Feb/85	(1)
K 715229				
715231-32	T-85-14	383'	Feb/85	(1)
K 629187	T-85-15	353'	Feb/85	(1)
	T-85-16	223'	Feb/85	(1)
	T-85-17	153'	Feb/85	(1)
	T-85-18	213'	Feb/85	(1)

NOTES: (1) #130-85

DIAMOND DRILL RECORD

NAME OF PROPERTY Titan Titanium Int. Inc.
 HOLE NO. T-85-12 LENGTH 293'
 LOCATION Area of Bliss Lake
 LATITUDE 16 S.W. DEPARTURE 730 N.W.
 ELEVATION _____ AZIMUTH 325° DIP -45°
 STARTED Jan. 29/85 FINISHED Jan. 30/85

FOOTAGE	DIP	AZIMUTH	FOOTAGE	DIP	AZIMUTH

HOLE NO. T-85-12 SHEET NO. 1

REMARKS BQ core

LOGGED BY M. Labchuk

FOOTAGE		DESCRIPTION	SAMPLE				ASSAYS			
FROM	TO		NO.	% SULPHIDES	FOOTAGE		TiO2 %	Fe %	OZ/TON	OZ/TON
					FROM	TO				
0	8	Casing								
8	41	Andesite	7001		41	68	27	8.15	54.11	
41	68	Gabbroic and anorthosite - massive sulphides pyrrhotite and visible CU (fine disseminated crystals chalcopyrite)	7002		24.5	134.5	10	2.61	22.02	
			7003		61.0	193.0	32	7.65	32.09	
68	80	Andesite and chlorite 1% estimated, disseminated mineralization	7004		93.0	214.0	21	7.25	31.95	
80	83	Feldspar porphyry dike	7005		214.0	238.0	24	24.00	47.91	
83	152.5	Andesite and chloritic 1% estimated mineralization Note: represent sample taken at 124.5 to 134.5 this will represent grade for footage 83' to 152.5'	7006		238.0	272.0	34	15.55	42.43	
152.5	156	Dike - feldspar porphyry								
156	161	Chlorite schist - no min.								
161	193	Chlorite, gabbroic and anorthosite with blobs of massive mineralization								
193	214	Gabbroic and anorthosite with few inch To 2' blobs of massive mineralization								
214	238	214 to 223.5 - massive mineralization 223.5 to 232.5 - chlorite schist 227.5 to 232.5 - massive mineralization 232.5 to 238 - chlorite schist, no mineralization								
238	272	Massive mineralization very fine grained								
272	293	Chlorite schist banding gabbroic anorthosite 1% estimate mineralization								
End of hole at 293'										

LANGRIDDIES - TORONTO - 366-1166

FORM 1



DIAMOND DRILL RECORD

NAME OF PROPERTY Titan Titanium Int. Inc.
 HOLE NO. T-85-13 LENGTH 413'
 LOCATION Area of Bliss Lake
 LATITUDE 16 S.W. DEPARTURE 730 N.W.
 ELEVATION _____ AZIMUTH 325°
 STARTED Jan. 31/85 FINISHED Feb. 1/85 DIP - 60°

FOOTAGE	DIP	AZIMUTH	FOOTAGE	DIP	AZIMUTH

HOLE NO. T-85-13 SHEET NO. 1

REMARKS BQ core

LOGGED BY M. Labchuk

FOOTAGE		DESCRIPTION	SAMPLE				ASSAYS				
FROM	TO		NO.	SULPHIDES	FOOTAGE			TiO2 %	Fe %	AU	
					FROM	TO	TOTAL			OZ/TON	OZ/TON
0	8	Casing									
8	80	Andesite rusty visible pyrrhotite bits, copper, some fine disseminated chalcopyrite	7007		80.0	89.0	9			0.022	
80	89	Cherty quartz in places, 1% pyrotite	7008		89.0	113.0	24	19.75	58.18		
89	138	This sample was taken for gold only - sample no. 7007 gold Massive ilmenite, some very fine grained pyrotite and minor CU visible (fine disseminated)	7009		113.0	138.0	25	21.80	57.91		
138	281	Gabbroic and anorthosite with some chlorite banding very low mineralization .25%	7010		344.0	354.0	21.5	7.41	31.14		
281	285	Massive mineralization (ilmenite)	7012		375.5	413.0	37.5	18.76	47.05		
285	301	Chlorite schist, very low mineralization .25%									
301	304	Massive mineralization									
304	344	Chlorite schist, very low mineralization .25%									
344	354	Gabbroic and anorthosite, intense mineralization									
354	375.5	Gabbroic and anorthosite with chlorite banding low mineralization, 2% estimated									
375.5	413	Massive mineralization, but weakening at end of hole Problems with wire line (very cold) Should have taken a run more or so									
End of hole at 413'											

LANGRIDGES - TORONTO - 366-1168

FORM 1

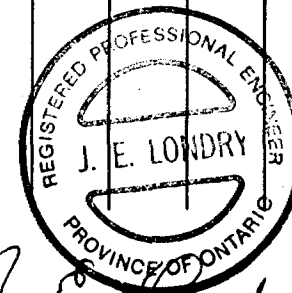

DIAMOND DRILL RECORD

NAME OF PROPERTY Titan Titanium Int. Inc.
 HOLE NO. T-85-14 LENGTH 383'
 LOCATION Area of Bliss Lake
 LATITUDE 1470 S.W. DEPARTURE 730 N.W.
 ELEVATION _____ AZIMUTH 325 DIP -55°
 STARTED Feb. 2/85 FINISHED Feb. 3/85

FOOTAGE	DIP	AZMUTH	FOOTAGE	DIP	AZIMUTH

HOLE NO. T-85-14 SHEET NO. 1
 REMARKS BQ core

LOGGED BY M. Labchuk

FOOTAGE		DESCRIPTION	SAMPLE				TiO2 Fe ASSAYS				
FROM	TO		NO.	SULPHIDES	FOOTAGE			%	%	OZ/TON	OZ/TON
					FROM	TO	TOTAL				
0	8	Casing	7013		75.0	93.5	18.5	22.38	57.74		
8	23	Andesite? silicified and carbonated	7014		178.0	183.0	5.0	4.38	23.43		
23	37	Fine grained gabbro									
37	42	Same - silicified									
42	75	Chlorite, andesite last 2' 6% to 8% pyrrhotite									
75	93.5	Massive mineralization									
93.5	95.5	Chlorite schist									
95.5	120	Andesite quartz banding low mineralization									
120	130	Chlorite schist					5.0	5.65	19.79		
130	143	Andesite, some quartz banding									
143	171	Gabbroic anorthosite 1% to 2% estimated mineralization									
171	173	Chlorite schist									
173	194	Gabbroic and anorthosite - no mineralization									
194	195	Massive mineralization									
195	212	Gabbroic and anorthosite 2% to 3% estimated mineralization									
212	215	Massive mineralization									
215	276	Gabbroic and anorthosite									
276	283	Dike - feldspar porphyry									
283	322.5	Gabbroic and anorthosite, some mineralization									
322.5	374.5	Massive mineralization									
374.5	383	Weakening mineralization to 383									

Note: 7014 is representative of mineralization from 113 to 208'

Note: 7015 is representative of mineralization from 248 to 314

End of hole at 383

LANGRIDGES - TORONTO - 366-1168

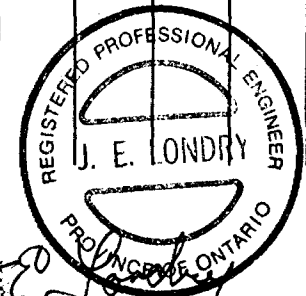

DIAMOND DRILL RECORD

NAME OF PROPERTY Titan Titanium Int. Inc.
 HOLE NO. T-85-15 LENGTH 353'
 LOCATION Area of Bliss Lake
 LATITUDE 10 N.E. DEPARTURE 3 N.W.
 ELEVATION _____ AZIMUTH 325° DIP -55°
 STARTED Feb. 9/85 FINISHED Feb. 10/85

FOOTAGE	DIP	AZIMUTH	FOOTAGE	DIP	AZIMUTH

HOLE NO. T-85-15 SHEET NO. 1

REMARKS BQ core

LOGGED BY M. Labchuk

FOOTAGE		DESCRIPTION	SAMPLE				TiO2 Fe ASSAYS				
FROM	TO		NO.	% SULPHIDES	FOOTAGE		%	%	oz/TON	oz/TON	
					FROM	TO					TOTAL
0	8	Casing									
8	223	Andesite	7019		268.0	295.0	27.0	20.51	46.95		
223	268	Chloritic schist	7020		295.0	323.0	28.0	14.07	38.79		
268	339	Massive, at 322.5, 3/4" band of massive chalcopyrite at 274 occasional bluish banding (serpentine) 1/4" to 3/8"	7021		323.0	348.5	25.5	8.39	32.00		
339	341	Quartz carbonates mineralized									
341	353	Gabbroic anorthosite weaker in mineralization									
End of hole at 353											

LANGRIDGES - TORONTO - 366-1168

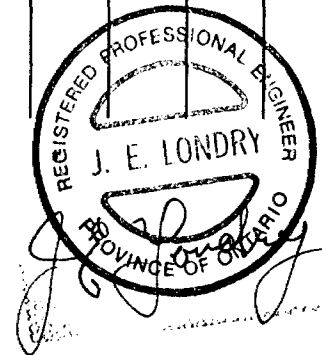

DIAMOND DRILL RECORD

NAME OF PROPERTY Titan Titanium Int. Inc.
 HOLE NO. T-85-16 LENGTH 223
 LOCATION Area of Bliss Lake
 LATITUDE 13 N.E. DEPARTURE 350 N.W.
 ELEVATION _____ AZIMUTH 325° DIP -55°
 STARTED Feb. 12/85 FINISHED Feb. 13/85

FOOTAGE	DIP	AZIMUTH	FOOTAGE	DIP	AZIMUTH

HOLE NO. T-85-16 SHEET NO. 1
 REMARKS BQ core

LOGGED BY M. Labchuk

FOOTAGE		DESCRIPTION	SAMPLE				TiO ₂ Fe ASSAYS				
FROM	TO		NO.	% SULPHIDES	FOOTAGE		%	%	OZ/TON	OZ/TON	
					FROM	TO					TOTAL
0	5	Casing	7022		151.0	183.0	32.0	18.74	39.85		
5	93	Andesite - Greenish black, fine grained	7023		183.0	209.0	26.0	11.74	37.02		
93	94.5	Chlorite schist									
94.5	99.5	Massive mineralization	7024		209.0	223.0	14.0	10.22	36.00		
99.5	100.5	Chlorite schist									
100.5	104.5	Massive mineralization									
104.5	108	Chlorite schist									
108	150	Andesite, greenish black									
150	151	Chlorite schist									
151	223	Massive diminishing, slightly at depth Blue banding from 151' to 166' (¼ serpentine bands) Very fine grain, grey, appears to be drilled Down dip, zone could flatten to 70° - 75° north									
		End of hole at 223'									

LANGRIGES - TORONTO - 366-1168



DIAMOND DRILL RECORD

NAME OF PROPERTY Titan Titanium Int. Inc.
 HOLE NO. T-85-17 LENGTH 153'
 LOCATION Area of Bliss Lake
 LATITUDE 16 N.E. DEPARTURE 345 N.W.
 ELEVATION _____ AZIMUTH 325 DIP -55°
 STARTED Feb. 14/85 FINISHED Feb. 15/85

FOOTAGE	DIP	AZIMUTH	FOOTAGE	DIP	AZIMUTH

HOLE NO. T-85-17 SHEET NO. 1

REMARKS BQ core

LOGGED BY M. Labchuk

FOOTAGE		DESCRIPTION	SAMPLE				ASSAYS				
FROM	TO		NO.	SULPHIDES	FOOTAGE		TiO2		Fe		
					FROM	TO	%	%	OZ/TON	OZ/TON	
0	5	Casing	7025		7.0	43.0	36.0	25.26	51.29		
5	73	Massive, coarse grain	7026		43.0	83.0	40.0	22.20	47.42		
73	141	Diminishing in sulphides as hole progresses, Very fine grain, greyish	7027		83.0	113.0	30.0	12.53	36.56		
141	153	More chlorite schist to less mineralization	7028		113.0	141.0	28.0	12.45	38.06		
			7029		141.0	153.0	12.0	10.68	32.39		
		End of hole at 153'									

LANGRIDDIES - TORONTO - 396-1168

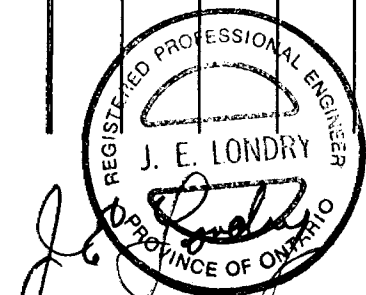

DIAMOND DRILL RECORD

NAME OF PROPERTY Titan Titanium Int. Inc.
 HOLE NO. T-85-18 LENGTH 213'
 LOCATION Area of Bliss Lake
 LATITUDE 10 N.E. DEPARTURE 175 N.W.
 ELEVATION _____ AZIMUTH 325° DIP -55°
 STARTED Feb. 15/85 FINISHED Feb. 16/85

FOOTAGE	DIP	AZIMUTH	FOOTAGE	DIP	AZIMUTH

HOLE NO. T-85-18 SHEET NO. 1
 REMARKS BQ core

LOGGED BY M. Labchuk

FOOTAGE		DESCRIPTION	SAMPLE			TiO2 Fe ASSAYS			
FROM	TO		NO.	SULPHIDES	FOOTAGE FROM TO TOTAL	%	%	OZ/TON	OZ/TON
0	5	Casing							
5	22	Chlorite schist							
22	25	Massive mineralization	7030		157.0 190.0 33.0	16.15	39.56		
25	26	Chlorite schist	7031		190.0 207.0 17.0	12.29	34.18		
26	30	Silicified zone							
30	42	Chlorite schist							
42	43	Massive mineralization							
43	52	Gabbroic anorthosite, minor mineralization							
52	62	Chlorite schist							
62	67	Gabbroic anorthosite, 15% mineralized							
67	87	Chlorite schist blob of massive 86'							
87	104.5	Chlorite schist							
104.5	108	Massive mineralization							
108	111.5	Dike - Fe&dspar porphyry							
111.5	138	Gabbro, minor mineralization							
138	156	Chlorite schist							
156	163.5	Massive mineralization							
163.5	164.5	Chlorite schist							
164.5	172	Massive mineralization							
172	174	Chlorite schist							
174	207	Gabbro anorthosite, medium mineralization fine grained, steel grey							
207	208.5	Chlorite schist							
208.5	213	Fine grained, weakening in mineralization							
		End of hole at 213'							

LANGRIDGES - TORONTO - 366-1168

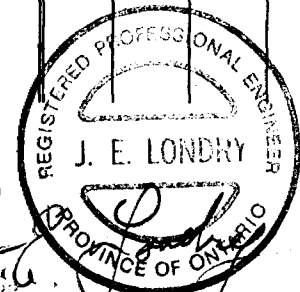

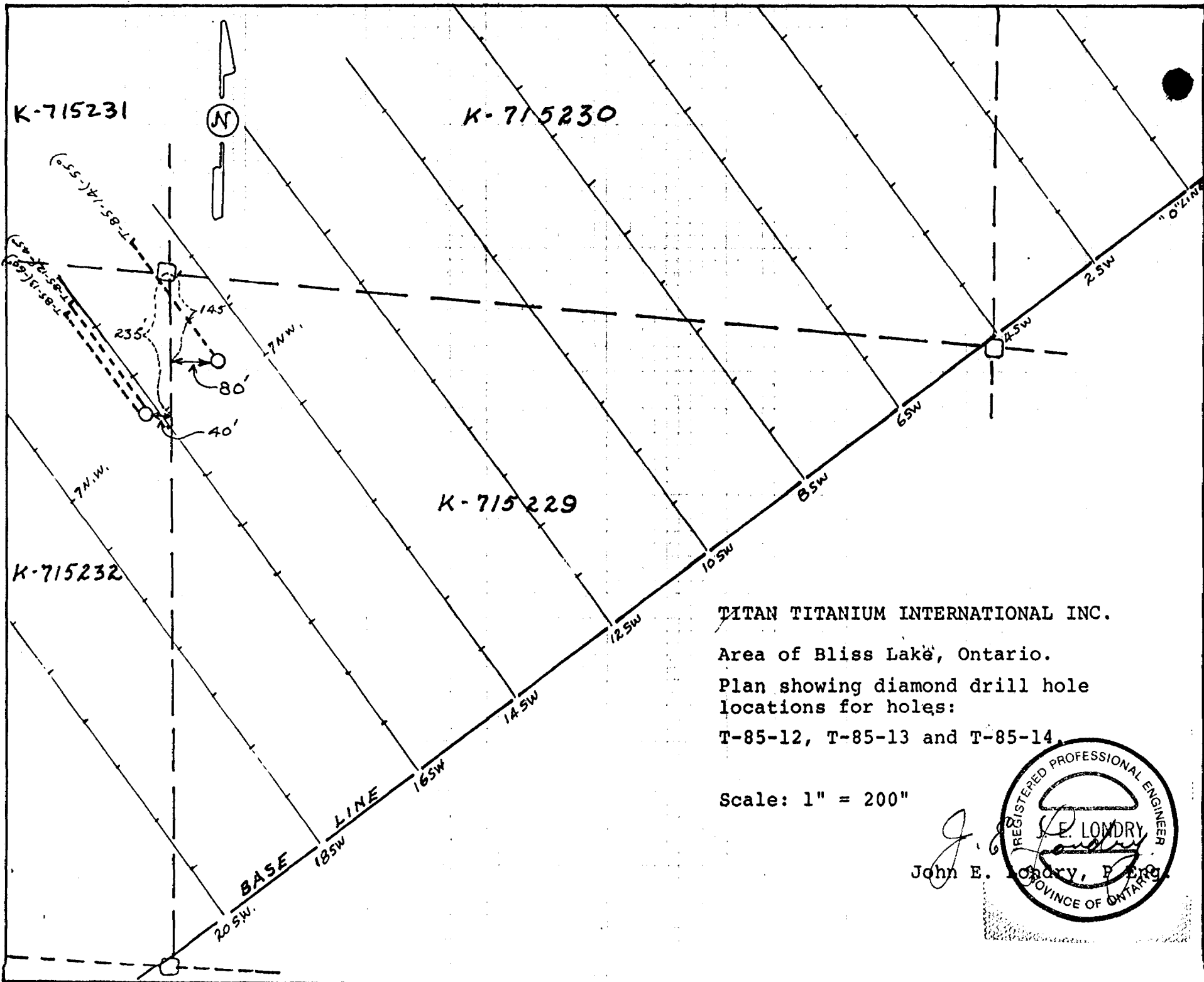

TITAN TITANIUM INTERNATIONAL INC.

Area of Bliss Lake, Ontario.

Plan showing diamond drill hole locations for holes:

T-85-12, T-85-13 and T-85-14.

Scale: 1" = 200"



 John E. Londry, P. Eng.

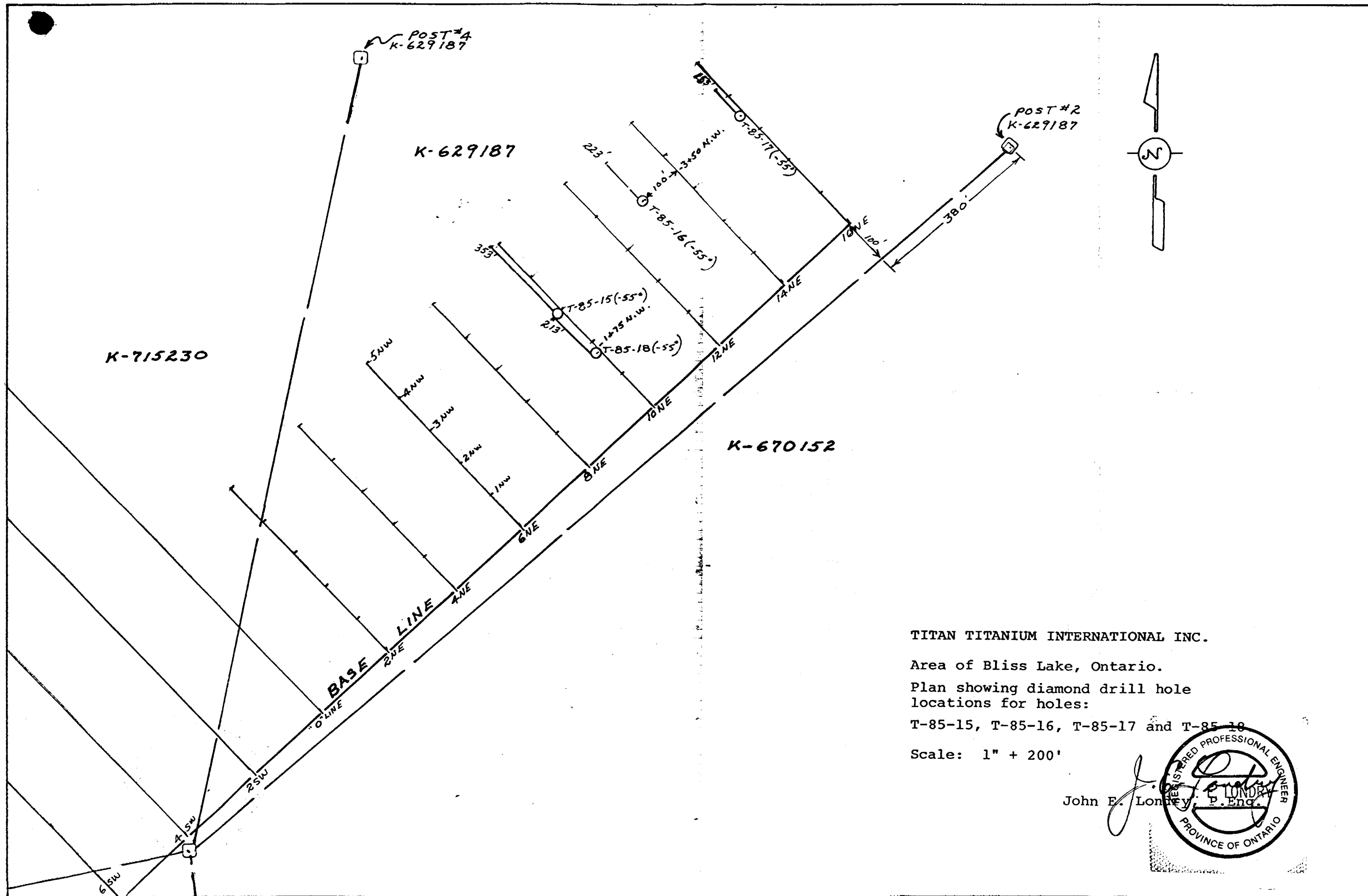

TITAN TITANIUM INTERNATIONAL INC.

Area of Bliss Lake, Ontario.

Plan showing diamond drill hole locations for holes:

T-85-15, T-85-16, T-85-17 and T-85-18

Scale: 1" = 200'

John E. Londrey

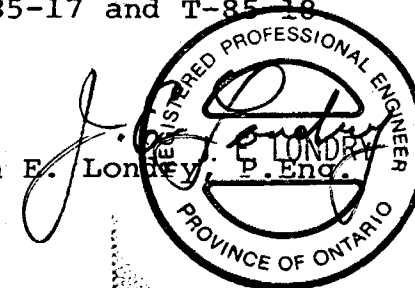



Name and Postal Address of Recorded Holder
TITAN TITANIUM INTERNATIONAL INC. T-1277
SUITE 2302
COMMERCIAL UNION TOWER
TORONTO DOMINION CENTRE, TORONTO, ONT. M5K 1E7

Summary of Work Performance and Distribution of Credits

Total Work Days Cr. claimed 2057 1920	Mining Claim			Work Days Cr.	Mining Claim			Work Days Cr.	
	Prefix	Number	Work Days Cr.		Prefix	Number	Work Days Cr.		
for Performance of the following work. (Check one only) <input type="checkbox"/> Manual Work <input type="checkbox"/> Shaft Sinking Drifting or other Lateral Work. <input type="checkbox"/> Compressed Air, other Power driven or mechanical equip. <input type="checkbox"/> Power Stripping <input checked="" type="checkbox"/> Diamond or other Core drilling <input type="checkbox"/> Land Survey	K	629151	80	K	715223	80	K	715231	80
		629184	80		715224	80		715232	80
		629185	80		715225	80		715233	80
		629186	80		715226	80		715234	80
		629187	80		715227	80		715235	80
		629188	80		715228	80		715236	80
		670152	80		715229	80		751057	80
		715222	80		715230	80		751066	80

All the work was performed on Mining Claim(s): **K-629188, K-715229, K-715232**

Required Information eg: type of equipment, Names, Addresses, etc. (See Table B)

DRILLING DONE BY:
NORWESCON DEVELOPMENT LIMITED
P.O. BOX 8H,
FORT FRANCES, ONT.
P9A 3N1
DRILL: GASOLINE POWERED
WIRE-LINE RIG
DRILLED BQ CORE
DRILLING STARTED JAN. 29, 1985
FINISHED FEB. 16, 1985.

RECEIVED
JUL 04 1985

DRILL HOLE NO'S
T-85-12 - 293'
T-85-13 - 413'
T-85-14 - 383'
T-85-15 - 353'
T-85-16 - 223'
T-85-17 - 153'
T-85-18 - 213'
2,031'

MINING DIV.
JUN 7 1985

Date of Report: **June 5, 1985**
Recorded/Holder or Agent (Signature): **John E. Londry**

Certification Verifying Report of Work
I hereby certify that I have a personal and intimate knowledge of the facts set forth in the Report of Work annexed hereto, having performed the work or witnessed same during and/or after its completion and the annexed report is true.

Name and Postal Address of Person Certifying
JOHN E. LONDRY
77 HOWARD ST., PH3,
TORONTO, ONT. MAX 1J9

Date Certified: **June 5, 1985**
Certified by (Signature): **John E. Londry**

Table of Information/Attachments Required by the Mining Recorder

Type of Work	Specific information per type	Other information (Common to 2 or more types)	Attachments
Manual Work	Nil	Names and addresses of men who performed manual work/operated equipment, together with dates and hours of employment. 629151	Work Sketch: these are required to show the location and extent of work in relation to the nearest claim post.
Shaft Sinking, Drifting or other Lateral Work			
Compressed air, other power driven or mechanical equip.	Type of equipment	Names and addresses of owner or operator together with dates when drilling/stripping done.	Work Sketch (as above) in duplicate
Power Stripping	Type of equipment and amount expended. Note: Proof of actual cost must be submitted within 30 days of recording.		
Diamond or other core drilling	Signed core log showing; footage, diameter of core, number and angles of holes.	Nil	Nil
Land Survey	Name and address of Ontario land surveyor.		