

63.5995

Jan 10/91

Ont. Prospectors
Assistance Program
Toronto, Ont.



52C11NE0001 63.5995 HALKIRK & FARRINGTON

010

Gentlemen,

The 1990 OFAP program has been our most encouraging to date!

Results - Little Turtle gold zone Location A.
We blasted as much of the width & length of this zone as the overburden would allow. We were encouraged with many gold values the highest 4.68 g/ton.

Little Turtle gold zone Location B. we again blasted & were encouraged with good gold values the highest being 24.07 gm/t.

Bad Vermilion Lake zone Locations C, D, E, F, G, H. showed heavily oxidized strong carbonate alteration over a long area (approximately 3 claims) our highest assays being 165659 → 21.3 165657 → 10.2%. Again we had to blast & get under the oxidation to get a good sample.

OP 90-521

90-522

90-523

O.P.A.F.

Recommendations. We approached INCO & they agreed to option the above gold & zinc claims. They are ideally situated with both the H.Y.O.R.O. & Railroad & Highway going through them.

Results - Porter Inlet This area is encouraging to prospect but with no results.

Recommendations - We will have to keep prospecting this area until we hit a good zone at Little Turtle it took (4 years)

Results - Tunnel Bay - Again this area is encouraging to prospect and minor results. We hit 49 P.P.B. platinum - 98 P.P.B. Palladium

Recommendation - We will have to prospect for the right zone but with the use of a backhoe as the overburden is quite heavy.

Sincerely
Louis Cousineau
Ray Cousineau
Ken Desjardis

LOUIS COUSINEAU
 RAY COUSINEAU
 KEN DESJARDINS

DAILY LOG

1990

DATE	PROJECT AREA	WORK PERFORMED
APRIL 12	LITTLE TURTLE TWP. LOCATION A CLAIM 1050574	PROSPECTING GOLD ZONE MARKING LOCATIONS ^{to} " "
APRIL 13	"	" " " " " "
APRIL 14	"	TRENCHING + DRILLING PIT 19
" 15	"	BLASTING + SAMPLING PIT 19
	SAMPLE RX 165580 - GRAB - CHORITE - SERICITE - SCHIST - MINOR SULPHIDE - AU - 845 P.P.B.	
" 17	"	TRENCHING + DRILLING PIT 18
" 18	"	TRENCHING + DRILLING PIT 18
" 19	"	BLASTING + SAMPLING PIT 18
	SAMPLE - RX 165579 - GRAB - CHLORITE - SERICITE - SCHIST - MINOR SULPHIDE - AU - 7 P.P.B.	
" 20	"	TRENCHING + DRILLING PIT 17
" 21	"	BLASTING + SAMPLING PIT 17
	SAMPLE - RX 165582 - GRAB - CHLORITE - FELLS - SCHIST - MINOR SULPHIDE - AU - 147 P.P.B.	
" 22	"	TRENCHING + DRILLING PIT 16
" 23	"	BLASTING + SAMPLING PIT 16
	SAMPLE RX 165586 - GRAB - MAFIC VOLCANIC DARK GREEN - MINOR SULPHIDE - AU - 388 P.P.B.	
" 24	"	TRENCHING + DRILLING PIT 15
" 25	"	BLASTING + SAMPLING PIT 15
	SAMPLE RX 165584 - GRAB - CHLORITE - FELLS - SCHIST - MINOR SULPHIDE - AU - 16 P.P.B.	
" 26	"	TRENCHING + DRILLING PIT 14
" 27	"	BLASTING + SAMPLING PIT 14
	SAMPLE RX 165585 - GRAB - CHLORITE FELLS - SCHIST - MINOR SULPHIDE AU - 23 P.P.B.	

LOUIS COUSINEAU
 RAY COUSINEAU
 KEN DESJARDINS

DAILY LOG

DATE	PROJECT AREA	WORK PERFORMED	
1990 APRIL 28	LITTLE TURTLE TWP LOCATION A CLAIM 1050574	TRENCHING + DRILLING	PIT # 5
29	"	BLASTING + SAMPLING	PIT # 5
	SAMPLE RX 165595 - GRAB -	CHORITE SCHIST - MINOR SULPHIDE	AU. 14.4 P.P.M.
30	"	TRENCHING + DRILLING	PIT # 6
MAY 1	"	BLASTING + SAMPLING	PIT # 6
	SAMPLE RX 165569 - GRAB -	CHLORITE + SERICITE - MINOR SULPHIDE	AU. 5.08 P.P.M.
MAY 2	"	TRENCHING + DRILLING	PIT # 7
3	"	BLASTING + SAMPLING	PIT # 7
	SAMPLE RX 165589 - GRAB - ^{CHIP 2.5M.}	CHORITE SERICITE SCHIST - MINOR SULPHIDE	AU. 171 P.P.M.
4	"	TRENCHING + DRILLING	PIT # 8
MAY 5	"	BLASTING + SAMPLING	PIT # 8
	SAMPLE RX 165591 - CHIP 1.5M	CHLORITE - SERICITE - SCHIST MINOR SULPHIDE	AU. 5.87 P.P.M.
MAY 6	"	TRENCHING + DRILLING	PIT # 9
7	"	BLASTING + SAMPLING	PIT # 9
	SAMPLE RX 165565 - GRAB -	MAFIC VOLCANIC ^{OXIDIZED} DARK GREEN MINOR SULPHIDE	AU 8.27 P.P.M.
MAY 8	"	TRENCHING + DRILLING	PIT # 10
9	"	BLASTING + SAMPLING	PIT # 10
	SAMPLE RX 165566 - GRAB -	QUARTZ - MINOR SULPHIDE	AU 63.9 P.P.M.
MAY 10	"	TRENCHING	PIT # 11
11	"	TRENCHING - DRILLING	PIT # 11
12	"	BLASTING - TRENCHING	PIT # 11
13	"	DRILLING - BLASTING	PIT # 11
14	"	TRENCHING - SAMPLING	PIT # 11
	SAMPLE RX 165594 - 2.5M CHIP	CHORITE SERICITE SCHIST	AU 1.74 P.P.M.

LOUIS COUSINEAU
 RAY COUSINEAU
 KEN DESJARDINS

DAILY LOG

DATE	PROJECT AREA	WORK PERFORMED	
1990 MAY 15	LITTLE TURTLE TWP. LOCATION A - CLAIM 1050574	TRENCHING + DRILLING	PIT # 12
16	"	BLASTING - DRILLING	PIT # 12
17	"	BLASTING - SAMPLING	PIT # 12
	SAMPLE RX 165576 - GRAB - CHORITE SCHIST - MINOR SULPHIDE		AU. 1.90 P.P.M.
MAY 18	"	TRENCHING + DRILLING	PIT # 13
19	"	BLASTING + DRILLING	PIT # 13
20	"	BLASTING + SAMPLING	PIT # 13
	SAMPLE RX 165570 - GRAB - CHORITE SERICITE SCHIST MINOR SULPHIDE		AU 25 P.P.B.
MAY 21	BAD VERMILLION LAKE TWP. LOCATION C - CLAIM 1024617	TRENCHING + DRILLING	PIT # 1
22	"	BLASTING + SAMPLING	PIT # 1 ZINC - 3.54% AU - 1940 P.P.B ZINC - .29%
	SAMPLE RX 165654 - GRAB - SERECIDIC SCHIST + QUARTZ		AU - 104 P.P.B ZINC - .86%
	SAMPLE RX 165656 - GRAB - QTZ, SERECITE SCHIST		AU - 276 P.P.B ZINC - .12%
	SAMPLE RX 165665 - 3.5M CHIP QTZ, SERECITE SCHIST		AU - 276 P.P.B
MAY 23	"	TRENCHING + DRILLING	PIT # 2
24	"	BLASTING + DRILLING	PIT # 2
25	"	BLASTING + SAMPLING	PIT # 2 ZINC - 5.94% AU - 629 P.P.B ZINC - 1.39% AU - 23 P.P.B ZINC - 6.39% AU - 45 ZINC - .12% AU - 11 P.P.B ZINC - .75% AU - 300 P.P.B
	SAMPLE RX 165648 - GRAB QTS FLOODED RHY. MINOR SULPHIDES		
	SAMPLE RX 165649 - GRAB RHY - MINOR SULPHIDES		
	SAMPLE RX 165650 - GRAB STRONGLY FOLIATED RHY. MINOR SULPHIDES		
	SAMPLE RX 165651 - GRAB - QTZ VEIN CUTTING NORMAL		
	SAMPLE RX 165652 - CHIP 1.5M - DITTO 165650		

LOUIS COUSINEAU
 RAY COUSINEAU
 KEN DESJARDINS

DAILY LOG

1990
 DATE

PROJECT AREA

WORK PERFORMED

DATE	PROJECT AREA	WORK PERFORMED	
MAY 26	BAD VERMILION LAKE TWP. LOCATION-E CLAIM 1024617	TRENCHING DRILLING	PIT 20
27		BLASTING - SAMPLING	PIT 20 ZINC - 10.2% AU - 1510 P.P.M. ZINC - 136% AU - 221 P.P.M.
	SAMPLE RX 165657 GRAB -	QTZ FLOODED RHY. MINOR SULPHIDES	
	SAMPLE RX 165658-GRAB - CHIP 18M	SERICITE SCHIST + RHY.	
MAY 28	BAD VERMILION LAKE TWP. LOCATION-H CLAIM 1050564	TRENCHING + DRILLING	PIT 35
29		BLASTING + DRILLING	PIT 35
30		BLASTING + SAMPLING	PIT 35 ZINC .68% AU .58 P.P.M.
	SAMPLE RX 165646 - CHIP 2.5M -	SERICITIZED INT. QTZ CRYSTAL TUFF	
MAY 31	LITTLE TURTLE LAKE TWP. LOCATION B - CLAIM 1050815	TRENCHING - DRILLING	PIT 52
JUNE 1		BLASTING - SAMPLING	PIT 52
JUNE	SAMPLE RX 165600 - GRAB -	QTZ VEIN WITH 20% C.P.	AU: 24.07 P.P.M.
	SAMPLE RX 165612 - 2M CHIP -	ALTERED MAFIC VOLCANIC	AU - 11.6 P.P.M.
JUNE 2	"	TRENCHING - DRILLING	PIT 53
3	"	BLASTING - SAMPLING	PIT 53
	SAMPLE RX 165611 (0.5M CHIP)	SERICITIC QTZ CRYSTAL TUFF	AU. 13.2 g/t
JUNE 6	BAD VERMILION LAKE TWP. LOCATION B - CLAIM 970306	TRENCHING - DRILLING ZINC - QTZ MINOR SULPHIDE	PIT 40
7	"	DRILLING BLASTING PINK QTZ MINOR SULPHIDE	PIT 40
13	"	TRENCHING - DRILLING	PIT 40
14	"	BLASTING SAMPLING	PIT 40
	SAMPLE # 1	ZINC - QTZ MINOR SULPHIDE	AU - TRACE
	SAMPLE # 2	PINK - QTZ MINOR SULPHIDE	AU - TRACE
	SAMPLE # 3 + 4	RHYOLITE MINOR SULPHIDES	AU - TRACE

LOUIS COUSINEAU
 RAY COUSINEAU
 KEN DESJARDINS

DAILY LOG

DATE	PROJECT AREA	WORK PERFORMED	
1990			
JUNE 20	LITTLE TURTLE LAKE G2682 LOCATION B	TRENCHING DRILLING	PIT 51
21	"	BLASTING SAMPLING	PIT 51
	SAMPLE RX165604 HALKIRK TWP. M3081	QUARTZ - 20% C.P.	AU. 4.71 64
25	LOCATION TUNNEL BAY	TRENCHING	PIT #1
26	"	DRILLING - TRENCHING	PIT #1
27	"	DRILLING - BLASTING	PIT #1
29	"	STRIPPING - SAMPLING	PIT #1
	SAMPLE 1-2-3	PIT #1 - RHYOLITE - NICE - MINOR SULPHIDE	AU - TRACE
JULY 17	LITTLE TURTLE LAKE G2682 LOCATION - L - CLAIM 1050580	TRENCHING	PIT 55
18	"	BLASTING - DRILLING	PIT 55
19	"	TRENCHING SAMPLING	PIT 55
22	"	PROSPECTING AROUND PIT 55	samples 11, 12, 13, 14
	SAMPLE #1	SERICITE SCHIST	AU. .08
	SAMPLE #2	SERICITE SCHIST	AU. .01
	SAMPLES 11, 12, 13, 14	TUFF QTZ STRINGERS	AU - TRACE
JULY 24	LITTLE TURTLE LAKE TWP. LOCATION A CLAIM 1050574	4 HOURS PIT #1 BACKHOE 4 HOURS PIT #2	PIT 1+2
25	"	TRENCH - DRILL	PITS 1+2+3
26	"	BLASTING SAMPLING	GRAB SAMPLE PIT #10 PITS 1+2+3
	SAMPLES 1+2+3	SHEARED RHYOLITE - OTL - SERICITE	AU - TRACE
	SAMPLE #10	QUARTZ VEIN - HEAVY PYRITE	AU - 4.68

LOUIS COUSINEAU
 RAY COUSINEAU
 KEN DESJARDINS

DAILY LOG

DATE	PROJECT AREA	WORK PERFORMED	
1990 JULY 31	PORTER INLET TWP. M2459 CLAIM 1104731	PROSPECTING AREA	BETWEEN Pits 1-2
AUG. 1	"	STRIPPING + DRILLING	PIT #1
" 2	"	TRENCH + SAMPLE	PIT #1
4	SAMPLE # 1	TUFF & QUARTZ	AU - TR.
AUG 4	"	STRIPPING	PIT #2
" 5	"	DRILLING + BLASTING SMALL BLUE IN MAGNETITE	PIT #2
	SAMPLE # 2	TUFF & QUARTZ MINOR SULPHIDE	AU - TR.
7	"	TRENCH SAMPLE MAGNETITE	PIT #2
	SAMPLE # 2	MAGNETITE	AU - TR
AUG 8	"	STRIPPING	PIT #3
12	"	DRILLING + BLASTING	PIT #3
15	"	TRENCHING + SAMPLING	PIT #3
	SAMPLE # 3	TUFF - QUARTZ	AU - TR
AUG 16	"	STRIPPING & SAMPLING	PIT #4
	SAMPLE # 4	TUFF - QUARTZ (PINK)	AU - TR.
28	"	PROSPECTING EAST LINE CLAIM 1104731	
	SAMPLES 5-6-7-8-9-10	QUARTZ DIDRITE MINOR SULPHIDE	AU - TR
Oct. 10	BAD VERMILION LAKE TWP LOCATION K - CLAIM 970306	STRIPPING NEXT TO PIT #40	
	SAMPLE 5+6	QUARTZ - MINOR SULPHIDES	AU - TR.
NOV 10	HALKIRK TWP. M3091 LOCATION TUNNEL BAY	DRILLING PIT	PIT #1
NOV. 12	"	BLASTING SAMPLING	PIT #1
	SAMPLE # 1-2-3	RHYOLITE - SILICE - QUARTZ	AU - TR.
	SAMPLE # 4	PINK QUARTZ + GABBRO	PLATINUM 49 PPS PALADIUM 98 PPS

LOUIS COUSINEAU

RAY COUSINEAU

KEN DEJARDINS

CLAIM 1050574

KEN A MINING DIVISION

LITTLE TURTLE LAKE G 2682

RAINY RIVER DISTRICT

PIT #1 - 33' X 6 1/2' X 4' DEEP

PIT #2A - 35' X 25' X 3' DEEP CIRCULAR

PIT #2B - 30' X 5' X 4' DEEP

PIT #3 - 16' X 10' X 3' DEEP

PIT #4 - 4' X 3' X 1 1/2' D.

PIT #5 - 4 1/2' X 3' X 1 1/2' D - RX 165585

PIT #6 - 8' X 4' X 2' D RX 165569

PIT #7 - 6' X 2' X 1 1/2' D RX 165584 - 7' CHIP

PIT #8 - 4' X 4' X 2' D RX 165591 - 5' CHIP

PIT #9 - 3' X 3' X 2' D RX 165565

PIT #10 - 3 1/2' X 4' X 2' D - RX 165566 - 63.9

PIT #11 - 8' X 3' X 2 1/2' D - RX 165594 - 7' CHIP

PIT #12 - 5' X 3' X 2' D RX 165576

PIT #13 - 4' X 5' X 2' D - L SHAPE RX 166570

PIT #14 - 5' X 3' X 1' D - RX 165585

PIT #15 - 4' X 2 1/2' X 1' D RX 165584

PIT #16 - 7' X 3' X 1 1/2' D - RX 165586

PIT #17 - 3' X 5' X 1 1/2' D - RX 165582

PIT #18 - 5' X 4' X 1 1/2' D - RX 165579

PIT #19 - 6' X 3' X 1' D - RX 165580 - 8451 PPA.

CLAIM 1050574 Post #1

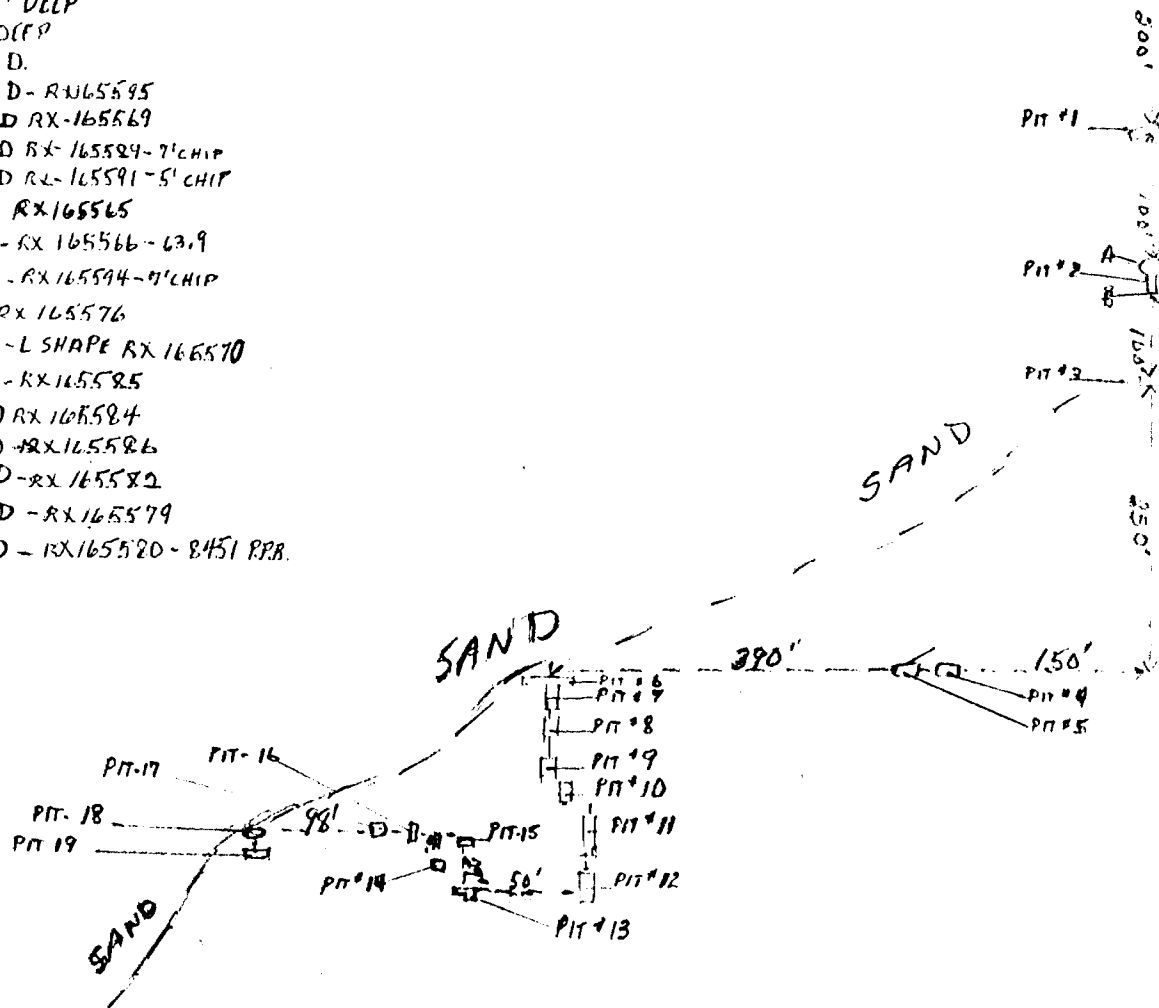

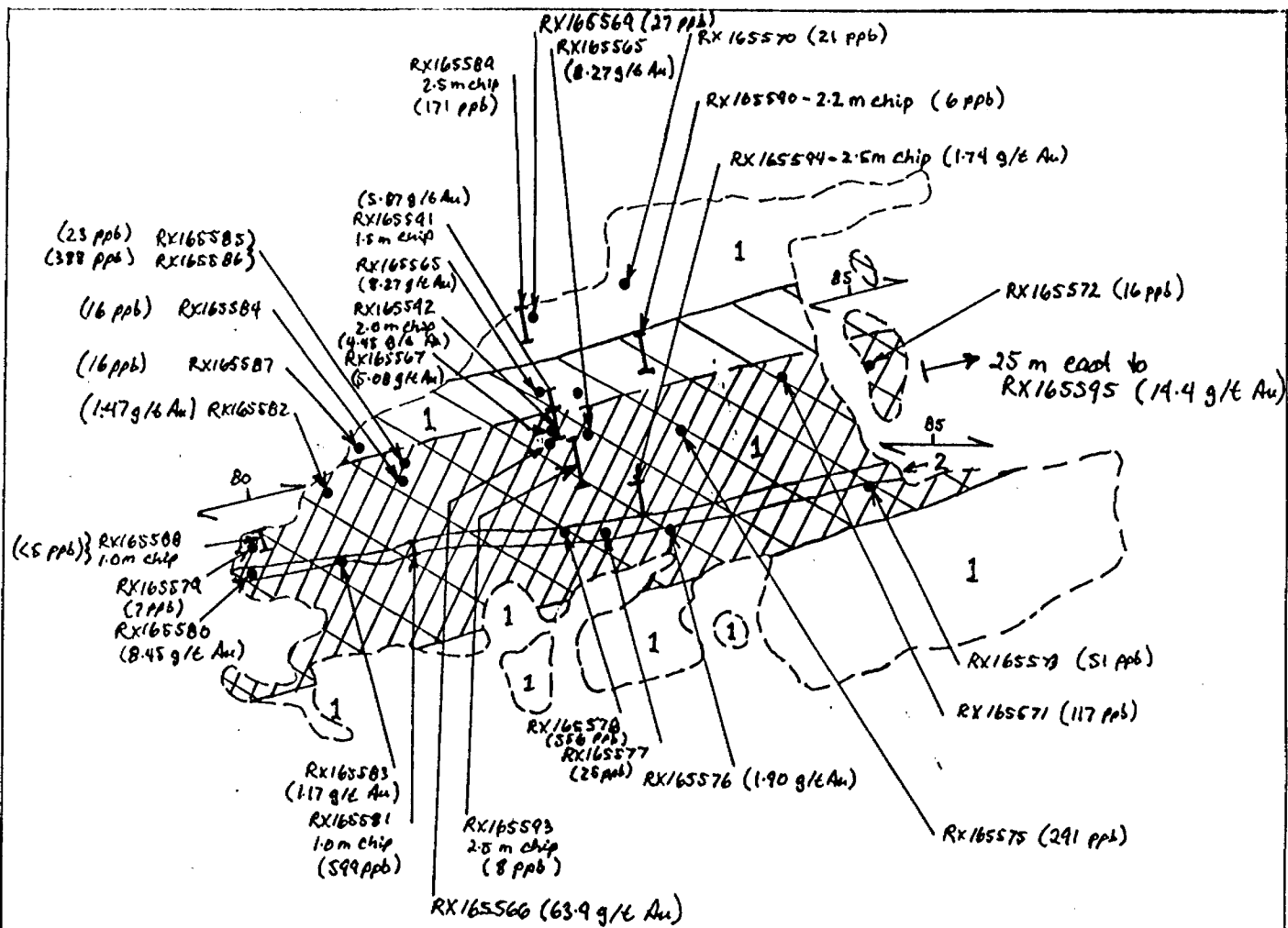

1 Malic volcanics (tuff + flows)

2 Malic dyke

— / — - moderately to strongly foliated

/// - moderate to strong iron carbonate alteration.

• - grab sample location

— | — - chip sample location.

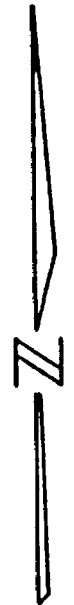
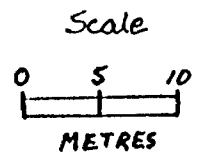

RX165591 } 5.06 g/t Au across 3.5 metres.
 RX165592 } (silicified + pyritized zone).

Assays > 1 g/t Au:

RX165565 - 8.27 g/t	RX165591 - 5.87 g/t
RX165566 - 63.9 g/t	RX165592 - 4.45 g/t
RX165567 - 5.08 g/t	RX165594 - 1.74 g/t
RX165568 - 3.08 g/t	RX165595 - 14.4 g/t
RX165576 - 1.90 g/t	
RX165580 - 8.45 g/t	
RX165582 - 1.47 g/t	
RX165583 - 1.17 g/t	

DETAIL 'A'

GRID LOCATION MAP
 AREA COUSINEAU - MINE CENTRE
 ANOMALY No. _____
 TOWNSHIP _____
 Scale: 1:500

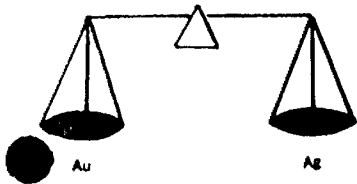

PAUL'S CUSTOM FIRE ASSAYING LTD.

Phone: Bus. (807) 662-8171
 Res. (807) 662-3361
 Fax: (807) 662-1155

PAUL OKANSKI, Assayer
 Box 253, Cochenour, Ontario POV 1L0

ASSAY CERTIFICATE

Date: Aug. 3-90

Sample No.	Description	oz/ton Au	oz/ton Ag
1	62682 LITTLE TURTLE LAKE CLAIM 1050574 PIT # 1	Trace	
2	" " " PIT # 10	4.68	
3			
4			
5			
6			
7			
8			
9			
10			
11			
12			
13			
14			
15			
16			
17			
18			
19			
20			
21			
22			
23			
24			
25			

CUSTOM FIRE ASSAYING LTD.
 BOX 253
 COCHENOUR, ONTARIO POV 1L0

Date Aug 3 1990
 M. L. COYSINEAU

SOLD BY	C.O.D.	CHARGE	ON ACCT.	ACCT. FWD.
---------	--------	--------	----------	------------

1	2	3	4	5	6	7	8	9	10	11	12	13	14	15
1.2	SAMPL Au @ 9.10	18.00												

Paul Okanski
Assayer

Assayer: Paul Okanski



ACCURASSAY LABORATORIES LTD.

P.O. BOX 604
KIRKLAND LAKE, ONTARIO, CANADA P2N 3J5
TEL.: (705) 867-8343

President: Dr. GEORGE DUNCAN, M.Sc., Ph. D., C. Chem (Ont.), C. Chem (U.K.), M.C.I.C., M.R.S.C., A.R.C.S.T.

Certificate of Analysis

Page: 1

30845

Alan Aubut
INCO Gold
851 Field Street
Thunder Bay, Ontario
P7C 4Y1

Date: June 21 19 90

Work Order # : T900338
Project : 60301-50001

Accurassay	SAMPLE NUMBERS Customer	Gold ppb	
521262	RX-165565	8275	
521263	RX-165566	63960	
521264	RX-165567	5088	
521265	RX-165568	3804	
521266	RX-165569	27	
521267	RX-165570	21	
521268	RX-165571	117	
521269	RX-165572	16	
521270	RX-165573	51	
521271	RX-165574	14	
521271	RX-165574	24	Check
521272	RX-165575	291	
521273	RX-165576	1901	
521274	RX-165577	25	
521275	RX-165578	556	
521276	RX-165579	7	
521277	RX-165580	8451	
521278	RX-165581	599	
521279	RX-165582	1475	
521280	RX-165583	1176	
521280	RX-165583	802	Check
521281	RX-165584	16	
521282	RX-165585	23	
521283	RX-165586	388	
521284	RX-165587	16	
521285	RX-165588	<5	
521286	RX-165589	171	
521287	RX-165590	6	
521288	RX-165591	5871	
521289	RX-165592	4079	
521289	RX-165592	4455	Check

Per: Blaine Vetter

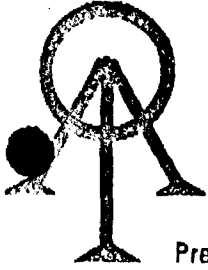

ACCURASSAY LABORATORIES LTD.

P.O. BOX 604
KIRKLAND LAKE, ONTARIO, CANADA P2N 3J5
TEL.: (706) 667-8343

President: Dr. GEORGE DUNCAN, M.Sc., Ph. D., C. Chem (Ont.), C. Chem (U.K.), M.C.I.C., M.R.S.C., A.R.C.S.T.

Certificate of Analysis

Page: 2

30846

Alan Aubut
INCO Gold
851 Field Street
Thunder Bay, Ontario
P7C 4Y1

Date: June 21 19 90

Work Order # : T900338
Project : 60301-50001

Accurassay	SAMPLE NUMBERS Customer	Gold ppb	
521290	RX-165593	8	
521291	RX-165594	1741	
521292	RX-165595	14416	
521293	RX-165596	10931	
521294	RX-165597	17	
521295	RX-165598	<5	
521296	RX-165599	7	
521297	RX-165600	24078	
521298	RX-165601	53	
521298	RX-165601	32	Check
521299	RX-165602	194	
521300	RX-165603	11	
521301	RX-165604	4713	
521302	RX-165605	9	
521303	RX-165606	2433	
521304	RX-165607	5	
521305	RX-165608	6	
521306	RX-165609	2911	
521307	RX-165610	1352	
521307	RX-165610	1331	Check
521308	RX-165611	13228	
521309	RX-165612	11644	
521309	RX-165612	9980	Check

Per: Blaine Vuyak

LOUIS COUSINEAU

RAY COUSINEAU

KEN DESJARDINS

KENDRA MINING DIVISION LITTLE TURTLE LAKE 62682 CLAIM 1050815

LOCATION B

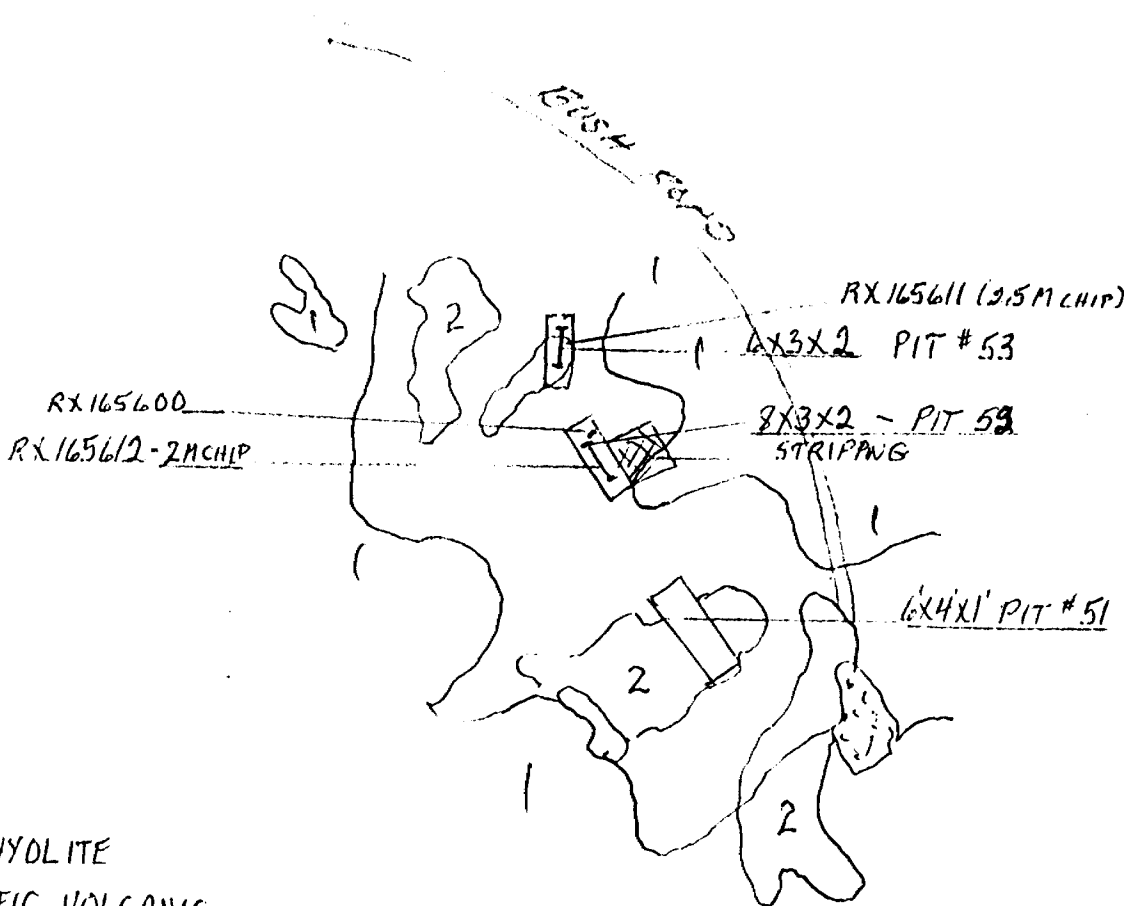

1 - RHYOLITE
 2 - MAFIC VOLCANIC

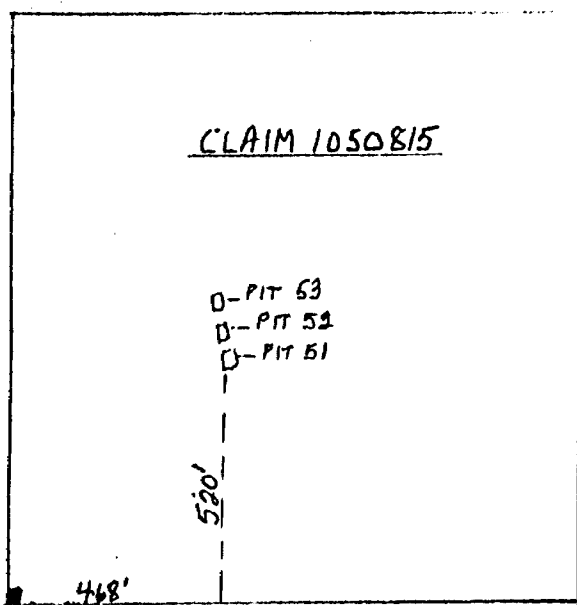

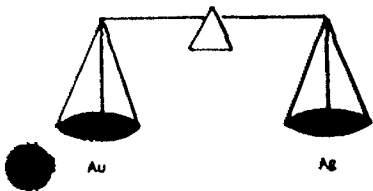

PAUL'S CUSTOM FIRE ASSAYING LTD.

Phone: Bus. (807) 662 8171

Res. (807) 662 3361

Fax: (807) 662 1155

PAUL OKANSKI, Assayer
Box 253, Cochenour, Ontario POV 1L0

I. Cousineau

ASSAY CERTIFICATE

Date: June 26, 1990.

Sample No.	Description	oz/ton Au	oz/ton Ag
1 #1	CLAIM 1050815 Sample #1P17 53	.50	
2 #2	" " Sample #1P17 51	1.32	
3			
4			
5			
6			
7			
8			
9			
10			
11			
12			
13			
14			
15			
16			
17			
18			
19			
20			
21			
22			
23			
24			
25			

CUSTOM FIRE ASSAYING LTD,
BOX 253,
COCHENOUR, ONTARIO POV 1L0

Date JUNE 26 1990
M. I. COUSINEAU

SOLD BY	C.O.D.	CHARGE	ON ACCT.	ACCT. FWD.
1		2 STAMP RECD 900		1800
2				
3				
4				
5				
6				
7				
8				
9				
10				
11				
12				
13				
14				
15				

33

5B525E (MOORE CLEAN PRINT) • Value 2000 PATENTED 1963 1966 1979 1

Assayer: _____

LITTLE TURTLE LAKE TWP. G-2682

RAINY RIVER DISTRICT

CLAIM KD50643

SAMPLE 14
CLAIM K 105080
1050580

SAMPLE 12
SAMPLE 13

PIT # 55

SAMPLE 11

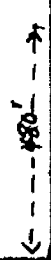

CNR [hatched area] CNR

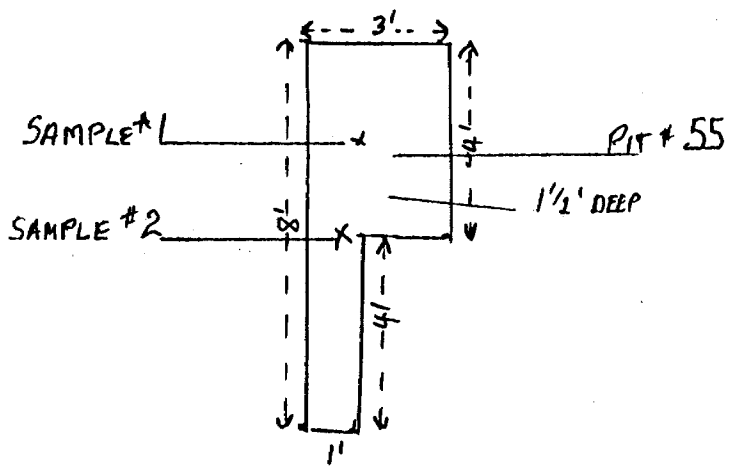

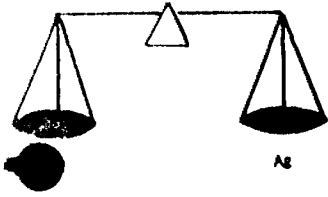

PAUL'S CUSTOM FIRE ASSAYING LTD.

Phone: Bus. (807) 662-8171

Res (807) 662 3361

Fax: (807) 662-1155

PAUL OKANSKI, Assayer
Box 253, Cochenour, Ontario POV 1L0

By: Cousineau

ASSAY CERTIFICATE

Date: July 25-90

Sample No.	Description	oz/ton Au	oz/ton Ag
1	#1	.08	
2	2	.01	
3			
4			
5			
6			
7			
8			
9			
10			
11			
12			
13			
14			
15			
16			
17			
18			
19			
20			
21			
22			
23			
24			
25			

CUSTOM FIRE ASSAYING LTD.
BOX 253
COCHENOUR, ONTARIO POV 1L0

Date July 25 19 90
M. L. COUSINEAU

SOLD BY	C.O.D.	CHARGE	ON ACCT.	ACCT. FWD.
---------	--------	--------	----------	------------

12	3	18.00	
2			
3			
4			
5			
6			
7			
8			
9			
10			
11			
12			
13			
14			
15			

12

Assayer: Paul Okanski

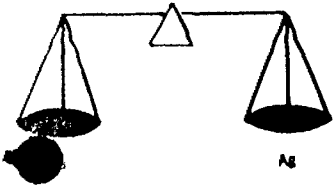

PAUL'S CUSTOM FIRE ASSAYING LTD.

Phone: Bus. (807) 662-8171

Res. (807) 662-3361

Fax: (807) 662-1155

PAUL OKANSKI, Assayer
Box 253, Cochenour, Ontario POV 1L0

ASSAY CERTIFICATE

Date: July 27, 1970

M. Cousineau

Sample No.	Description	oz/ton Au	oz/ton Ag
1	#1 (Trace	
2	2	"	
3	/ 3	"	
4	(4	"	
5			
6			
7			
8			
9			
10			
11			
12			
13			
14			
15			
16			
17			
18			
19			
20			
21			
22			
23			
24			
25			

CUSTOM FIRE ASSAYING LTD.
BOX 253
COCHENOUR, ONTARIO POV 1L0

Date: July 27, 1970
M. L. COUSINEAU

SOLD BY	C.O.D.	CHARGE	ON ACCT.	ACCT. FWD.
1		4 SAMPLES	9.00	100
2		Cheque received # 849	36	100
3			98	100
4				
5		Freight		
6		Thank you		
7				
8				
9				
10				
11				
12				
13				
14				
15				

58525E ANCHOR CLEAN PRINT © Value 2000 PATENTED 1963 1966 1978 1

Assayer: Paul Okanski

BAD VERMILLION LAKE B 2665

LOUIS COUSINEAU RAY COUSINEAU KEN DESJARDINS

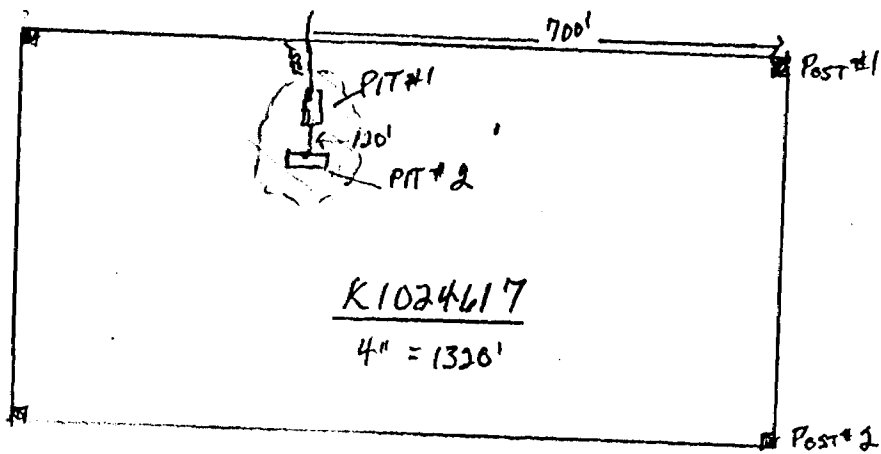

FELSIC VOLCANICS

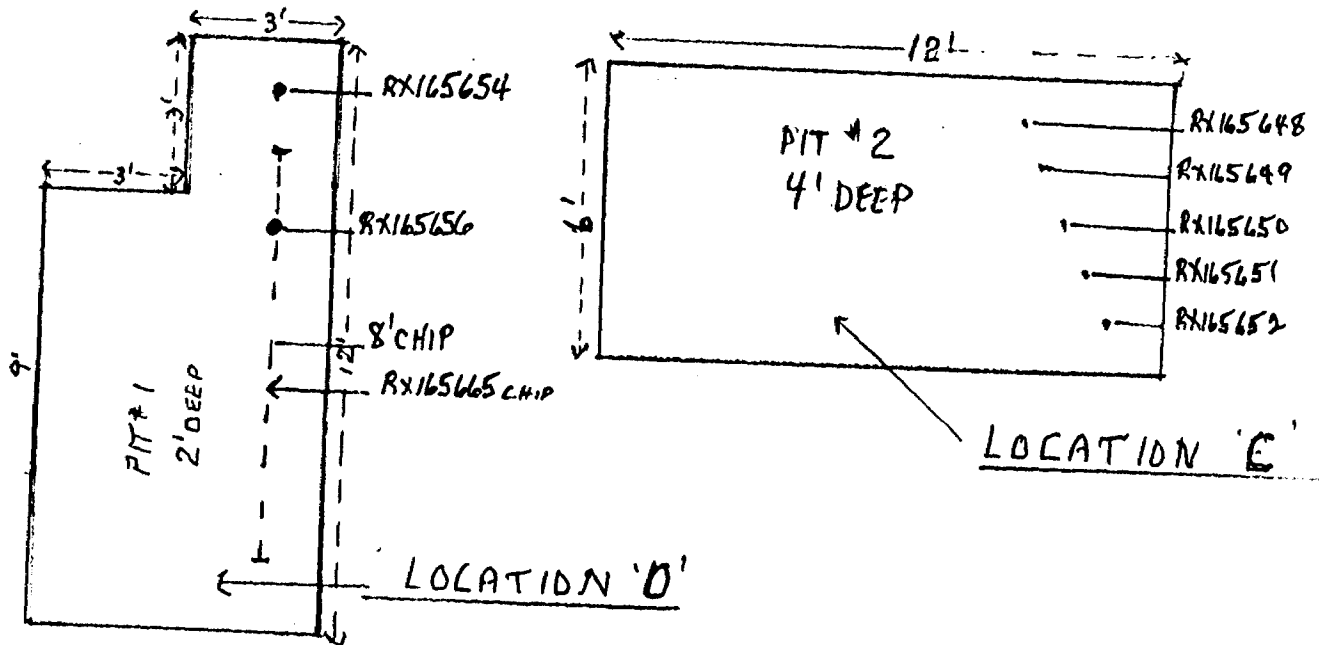

Sample description	AU PPB	AG PPH	AS PPH	BA PPH	BR PPH	CA %	CO PPH	CR PPH	CS PPH	FE %	HF PPH	HG PPH	IR PPB	K %	MO PPH	NA PPH	NI PPH	PO PPH	SB PPH	SC PPH	SE PPH
RX 165635	45	<5	63	560	<1	<1	<5	55	<2	1.50	16	<1	<5	2.5	<5	1230	<50	35	1.4	2.1	<5
RX 165636	8	<5	19	380	<1	<1	<5	82	<2	1.21	14	<1	<5	2.6	<5	939	<50	43	0.5	2.0	<5
RX 165637	90	<5	86	180	<1	<1	21	120	<2	2.44	3	5	<5	0.9	<5	(500)	<50	<30	1.7	0.8	7
RX 165638	12	<5	25	520	<1	<1	<5	99	<2	1.89	16	<1	<5	2.6	<5	1070	<50	31	0.6	1.9	<5
RX 165639	<5	<5	17	320	<1	<1	<5	67	<2	0.47	11	<1	<5	2.1	<5	900	<50	35	0.5	1.6	<5
RX 165640	8	<5	38	430	<1	<1	<5	79	<2	1.70	16	<1	<5	2.7	<5	1120	<50	31	0.7	2.0	<5
RX 165641	19	<5	40	370	<1	<1	<5	80	<2	4.07	12	<1	<5	1.5	<5	747	<50	<30	0.6	2.1	<5
RX 165642	11	<5	41	540	<1	<1	<5	100	<2	1.38	15	<1	<5	2.9	<5	1190	<50	41	0.6	2.5	<5
RX 165643	22	<5	42	470	<1	<1	<5	120	<2	1.39	17	<1	<5	2.8	<5	1180	<50	43	0.6	3.5	<5
RX 165644	<5	<5	<2	220	<1	<1	<5	90	<2	4.63	17	<1	<5	1.9	<5	954	70	32	0.3	3.5	<5
RX 165645	<5	<5	4	310	<1	2	<5	71	<2	3.01	15	<1	<5	2.0	<5	904	<50	30	0.4	2.0	<5
RX 165646	58	<5	66	320	<1	<1	5	100	<2	2.24	8	<1	<5	1.5	<5	658	<50	<30	1.7	1.6	<5
RX 165647	<5	<5	7	<100	<1	<1	<5	320	<2	0.32	<1	<1	<5	<0.5	<5	<500	<50	<30	1.0	0.3	<5
RX 165648	629	23	110	740	1	7	18	95	<2	1.94	3	9	<5	0.5	<5	<500	<50	<30	16	0.9	18
RX 165649	23	<5	52	650	<1	<1	<5	91	<2	1.12	16	<1	<5	1.9	<5	949	<50	50	1.3	0.6	<5
RX 165650	<5	<5	7	270	<1	<1	<5	170	<2	0.58	6	<1	<5	1.0	<5	<500	<50	31	0.6	0.8	<5
RX 165651	11	<5	5	<100	<1	<1	<5	250	<2	0.36	2	<1	<5	<0.5	<5	<500	<50	<30	0.7	0.3	<5
RX 165652	300	5	39	340	<1	<1	<5	130	<2	1.93	8	<1	<5	1.1	<5	553	<50	30	1.9	1.4	<5
RX 165653	80	<5	13	160	<1	<1	5	210	<2	0.94	1	2	<5	1.6	<5	730	<50	<30	1.1	9.5	<5
RX 165654	1940	43	27	<100	<1	2	16	160	<2	1.85	<1	4	<5	0.6	<5	<500	130	<30	27	2.8	33
RX 165655	276	13	97	170	<1	<1	25	110	<2	4.48	2	2	<5	2.0	<5	1110	<50	47	6.7	17	11
RX 165656	104	<5	130	330	<1	<1	35	110	3	8.65	2	<1	<5	2.4	<5	1260	<50	61	2.4	22	9
RX 165657	1510	130	43	<100	<1	<1	39	130	<2	2.63	8	11	<5	1.3	<5	606	<54	<30	11	1.9	120
RX 165658	221	26	35	270	<1	<1	6	130	<2	1.69	7	2	<5	1.3	<5	602	<50	<30	3.4	1.6	23
RX 165659	599	<9	2500	500	<1	<1	51	96	<2	6.25	<1	20	<12	1.0	<5	<500	<180	<30	20	1.4	81
RX 165660	5	<5	14	180	<1	<1	<5	75	<2	3.02	16	<1	<5	2.3	<5	870	<50	45	0.6	2.2	<5
RX 165661	79	12	380	210	<1	<1	7	110	<2	2.64	12	2	<5	1.9	<5	696	<50	42	3.8	2.2	9
RX 165662	30	<5	270	200	<1	<1	5	110	<2	1.77	8	<1	<5	2.7	<5	1000	<50	69	6.6	13	<5
RX 165663	229	42	90	400	<1	<1	50	250	<2	2.32	<1	11	<5	2.2	<5	1590	<56	<30	6.7	13	25
RX 165664	42	<5	140	600	<1	<1	19	360	2	2.88	1	<1	<5	4.1	<5	2200	120	67	4.0	21	7
RX 165665	77	<5	250	400	<1	<1	40	320	<2	6.40	1	<1	<5	2.8	<5	1530	100	53	2.9	22	<5
RX 165666	167	27	140	370	<1	<1	39	230	2	4.03	<1	6	<5	1.7	<5	1820	190	40	2.8	8.9	19

Activation Laboratories Ltd. Work Order: 1803 Report: 1804

Sample description	SN %	SR %	TA PPM	TH PPM	U PPM	V PPM	ZN PPM	LA PPM	CE PPM	MO PPM	SM PPM	EU PPM	TB PPM	YB PPM	LU PPM	CU PPM	CU %
RX 165635	<0.01	<0.05	<1	5.6	1.2	<4	92	10	31	12	4.8	1.4	2.5	13.4	2.43	13	
RX 165636	<0.01	<0.05	1	6.9	2.1	<4	91	18	52	21	7.2	1.5	2.5	12.3	2.24	18	
RX 165637	<0.01	<0.05	<1	1.7	<0.5	<4	38700	16	39	17	4.1	0.6	0.6	3.20	0.60	1100	
RX 165638	<0.01	<0.05	2	6.9	1.9	<4	87	11	36	18	6.0	2.3	2.9	14.5	2.51	14	
RX 165639	<0.01	<0.05	1	3.7	1.3	<4	63	6	26	8	4.3	1.3	2.5	13.5	2.34	2	
RX 165640	<0.01	<0.05	1	6.3	2.1	<4	<50	5	25	8	4.3	1.3	2.9	15.1	2.69	2	
RX 165641	<0.01	<0.05	<1	5.5	1.3	<4	170	11	36	15	5.4	1.6	2.7	13.3	2.41	11	
RX 165642	<0.01	<0.05	2	5.6	0.9	<4	<50	9	30	11	4.2	1.5	2.4	12.6	2.23	5	
RX 165643	<0.01	<0.05	1	5.1	1.6	<4	71	7	23	10	5.1	1.8	3.2	13.6	2.32	6	
RX 165644	<0.01	<0.05	2	7.2	2.5	<4	118	26	84	31	8.3	2.2	2.4	15.4	2.79	5	
RX 165645	<0.01	<0.05	1	7.6	1.7	<4	177	46	110	60	13	2.8	3.0	14.9	2.61	10	
RX 165646	<0.01	<0.05	<1	3.9	0.7	<4	6770	21	51	35	6.4	1.4	1.7	9.00	1.35	120	
RX 165647	<0.01	<0.05	<1	<0.5	<0.5	<4	148	<1	<3	<5	0.1	<0.2	<0.5	0.16	<0.05	14	
RX 165648	<0.02	<0.05	<1	1.7	<0.5	<4	59900	12	29	8	2.5	0.6	<0.5	1.96	0.31	1300	
RX 165649	<0.01	<0.05	4	8.2	1.9	<4	139	46	110	59	11	2.7	2.3	10.6	1.51	11	
RX 165650	<0.01	<0.05	2	3.3	<0.5	<4	639	23	52	28	4.9	1.2	1.0	4.58	0.63	39	
RX 165651	<0.01	<0.05	<1	1.4	<0.5	<4	1210	12	27	13	2.7	0.6	<0.5	1.78	0.27	64	
RX 165652	<0.01	<0.05	3	4.2	1.1	<4	7520	18	42	24	4.7	1.4	1.4	6.04	0.89	790	
RX 165653	<0.01	<0.05	<1	<0.5	<0.5	<4	14000	5	10	9	1.7	0.7	<0.5	1.12	0.18	800	
RX 165654	<0.01	<0.05	<1	<0.5	<0.5	<4	35900	2	3	<5	0.6	<0.2	<0.5	0.56	0.10	800	
RX 165655	<0.01	<0.05	<1	<0.5	<0.5	4	8640	7	19	7	2.3	0.9	<0.5	1.74	0.24	300	
RX 165656	<0.01	<0.05	<1	1.0	<0.5	6	2910	8	24	13	2.9	1.1	<0.5	1.90	0.30	110	
RX 165657	<0.03	<0.05	<1	3.7	<0.5	<4	102000	8	18	<5	2.7	1.1	1.3	8.00	1.31	3000	
RX 165658	<0.01	<0.05	<1	3.2	1.7	<4	13000	8	19	9	3.4	1.0	1.4	8.59	1.39	1500	
RX 165659	<0.10	<0.11	<1	<0.9	<1.6	<4	213000	11	<4	<7	1.8	<0.2	2.2	2.81	0.72	>5000	59
RX 165660	<0.01	<0.05	2	8.1	2.2	<4	1300	55	120	48	14	2.5	3.4	18.0	2.91	43	
RX 165661	<0.01	<0.05	1	5.3	<0.5	<4	22600	21	47	20	6.8	1.4	2.2	14.2	2.37	1600	
RX 165662	<0.01	<0.05	<1	3.7	<0.5	<4	6260	14	35	11	4.9	1.5	1.5	10.0	1.66	150	
RX 165663	<0.03	<0.05	<1	<0.5	<0.5	<4	68200	3	<3	<5	1.0	<0.2	<0.5	1.28	0.16	2100	
RX 165664	<0.01	<0.05	<1	<0.5	<0.5	<4	466	2	<3	<5	0.8	<0.2	<0.5	0.91	0.17	75	
RX 165665	<0.01	<0.05	<1	<0.5	<0.5	<4	586	3	6	<5	0.9	0.3	<0.5	1.00	0.18	54	
RX 165666	<0.01	<0.05	<1	0.8	<0.5	<4	40000	4	9	<5	1.1	0.3	<0.5	0.69	0.11	1200	

RAY COUSINEAU - LOUIS COUSINEAU R.1062 - KENDESJARDINS

BAD VERMILION LAKE G-265

KENORA MINING DIVISION DISTRICT OF RAINY RIVER

K304

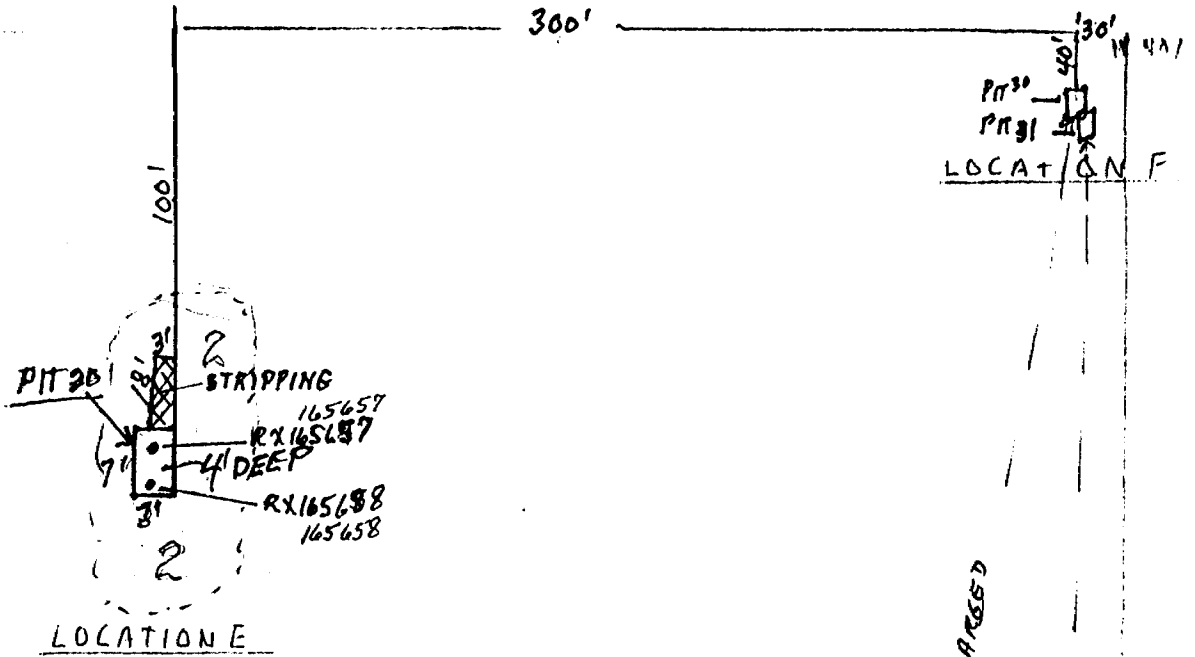

CLAIM 1024617

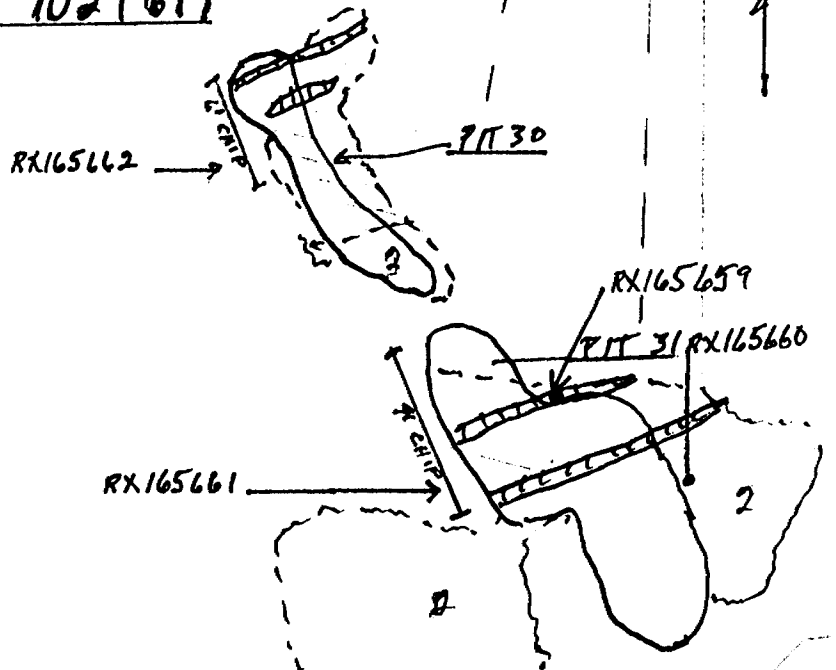

2 - INTERMEDIATE VOLCANICS

STRONG SERICITE ALTERATION

KENDRA MINING DIVISION

RAINY RIVER DISTRICT

BAD VERMILION LAKE G2665

CLAIM NO. 1050564

LOUIS COUSINEAU

RAY COUSINEAU

KEN DESTARDINS

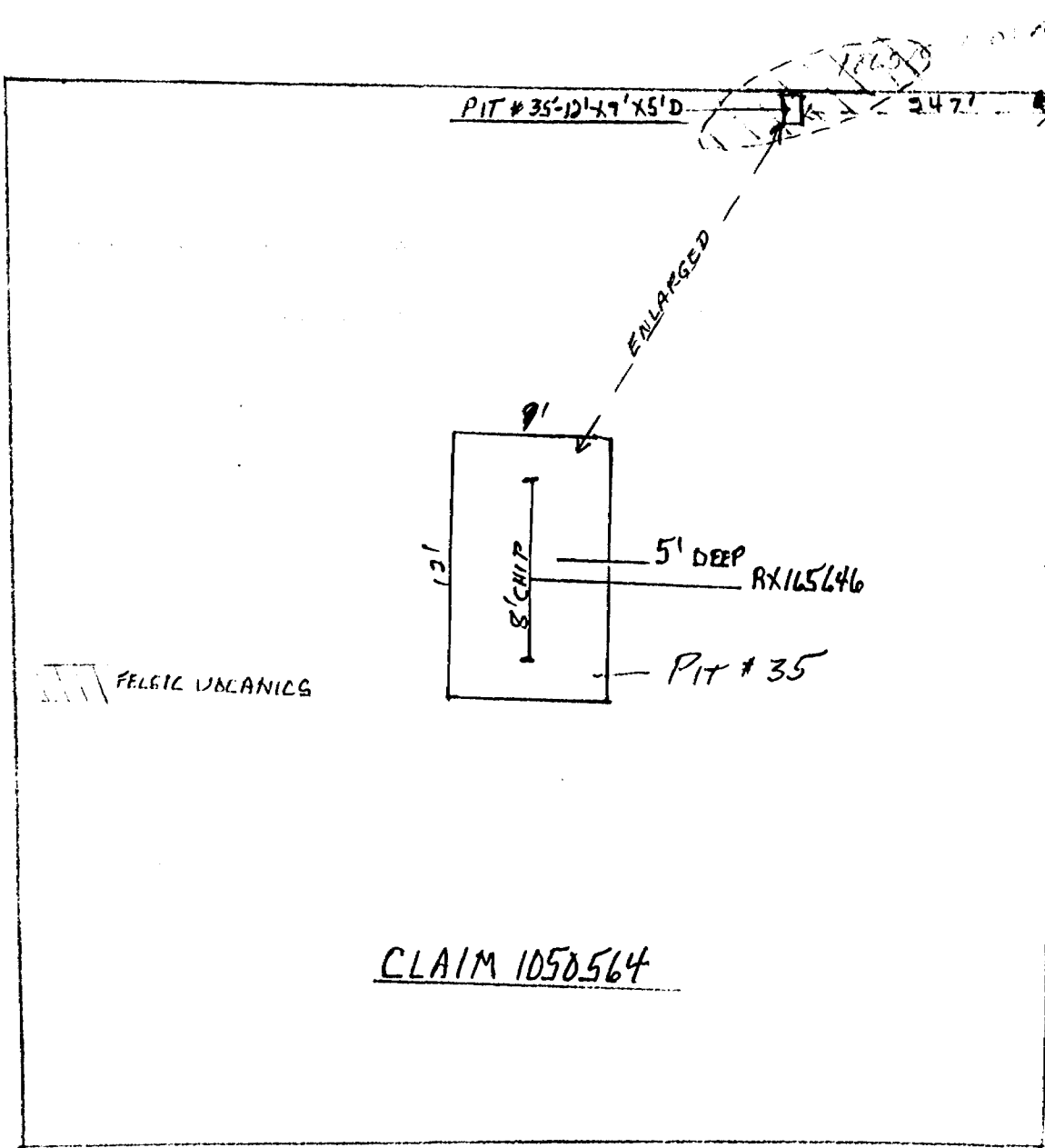

LOUIS COUSINEAU RAY COUSINEAU KEN DESJARDINS

KENORA MINING DIVISION R.R. DISTRICT
BAD VERMILLION LAKE G 2665

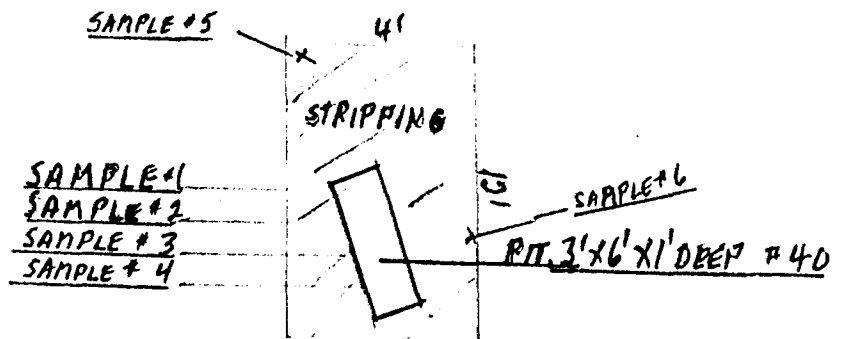
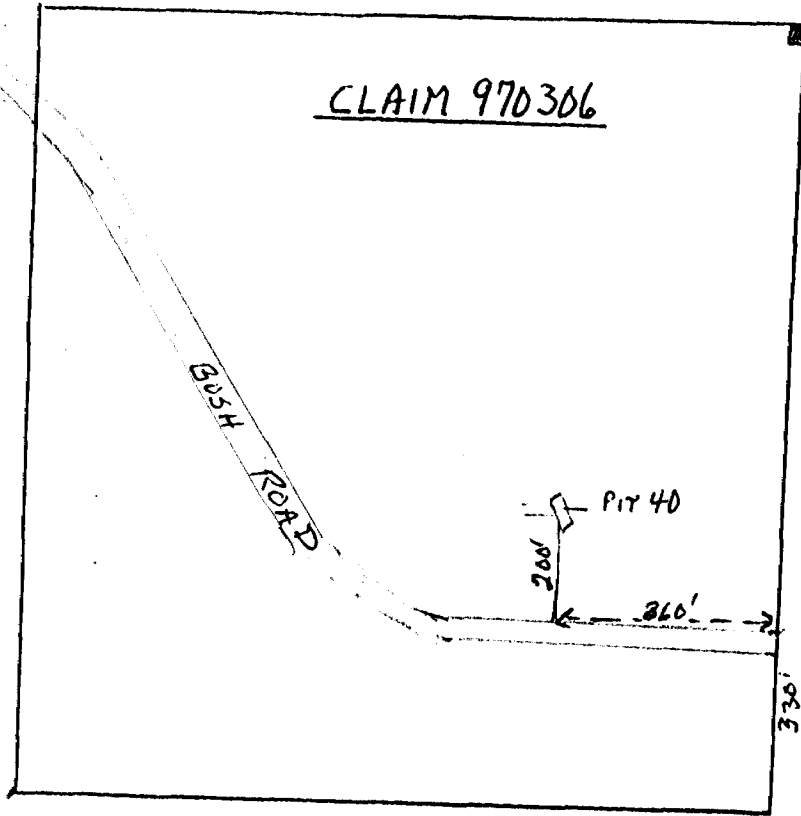

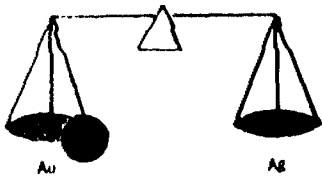

PAUL'S CUSTOM FIRE ASSAYING LTD.

Phone: Bus. (807) 662-8171

Res. (807) 662-3361

Fax: (807) 662-1155

PAUL OKANSKI, Assayer
Box 253, Cochenour, Ontario POV 1L0

L. Cousineau

ASSAY CERTIFICATE

Date: June 20, 1990.

Sample No.	Description	oz/ton Au	oz/ton Ag
1 #1	ZINC	Trace	
2 #2	PINK QTZ.	"	
3 #3	MINOR SULPHIDES	"	
4 #4	MINOR SULPHIDES	"	
5			
6			
7			
8			
9			
0			
1			
2			
3			
4			
5			
6			
7			
8			
9			
0			
1			
2			
3			
4			
5			
6			
7			
8			
9			
0			
1			
2			
3			
4			
5			
6			
7			
8			
9			
0			
1			
2			
3			
4			
5			
6			
7			
8			
9			
0			
1			
2			
3			
4			
5			
6			
7			
8			
9			
0			
1			
2			
3			
4			
5			
6			
7			
8			
9			
0			
1			
2			
3			
4			
5			
6			
7			
8			
9			
0			
1			
2			
3			
4			
5			
6			
7			
8			
9			
0			
1			
2			
3			
4			
5			
6			
7			
8			
9			
0			
1			
2			
3			
4			
5			
6			
7			
8			
9			
0			
1			
2			
3			
4			
5			
6			
7			
8			
9			
0			
1			
2			
3			
4			
5			
6			
7			
8			
9			
0			
1			
2			
3			
4			
5			
6			
7			
8			
9			
0			
1			
2			
3			
4			
5			
6			
7			
8			
9			
0			
1			
2			
3			
4			
5			
6			
7			
8			
9			
0			
1			
2			
3			
4			
5			
6			
7			
8			
9			
0			
1			
2			
3			
4			
5			
6			
7			
8			
9			
0			
1			
2			
3			
4			
5			
6			
7			
8			
9			
0			
1			
2			
3			
4			
5			
6			
7			
8			
9			
0			
1			
2			
3			
4			
5			
6			
7			
8			
9			
0			
1			
2			
3			
4			
5			
6			
7			
8			
9			
0			
1			
2			
3			
4			
5			
6			
7			
8			
9			
0			
1			
2			
3			
4			
5			
6			
7			
8			
9			
0			
1			
2			
3			
4			
5			
6			
7			
8			
9			
0			
1			
2			
3			
4			
5			
6			
7			
8			
9			
0			
1			
2			
3			
4			
5			
6			
7			
8			
9			
0			
1			
2			
3			
4			
5			
6			
7			
8			
9			
0			
1			
2			
3			
4			
5			
6			
7			
8			
9			
0			
1			
2			
3			
4			
5			
6			
7			
8			
9			
0			
1			
2			
3			
4			
5			
6			
7			
8			
9			
0			
1			
2			
3			
4			
5			
6			
7			
8			
9			
0			
1			
2			
3			
4			
5			
6			
7			
8			
9			
0			
1			
2			
3			
4			
5			
6			
7			
8			
9			
0			
1			
2			
3			
4			
5			
6			
7			
8			
9			
0			
1			
2			
3			
4			
5			
6			
7			
8			
9			
0			
1			
2			
3			
4			
5			
6			
7			
8			
9			
0			
1			
2			
3			
4			
5			
6			
7			
8			
9			
0			
1			
2			
3			
4			
5			
6			
7			
8			
9			
0			
1			
2			
3			
4			
5			
6			
7			
8			
9			
0			
1			
2			
3			
4			
5			
6			
7			
8</			

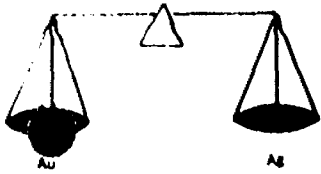

PAUL'S CUSTOM FIRE ASSAYING LTD.

Phone: Bus. (807) 662-8171
 Res. (807) 662-3361
 Fax. (807) 662-1155

PAUL OKANSKI, Assayer
 Box 253, Cochenour, Ontario POV 1L0

L. Cousineau

ASSAY CERTIFICATE

Date: Oct. 17, 1990.

Sample No.	Description	oz/ton Au	oz/ton Ag
1 #1	QUARTZ SAMPLE # 5	Trace	
2 #2	QUARTZ SAMPLE # 6	"	
3	CLAIM 970306 LOCATION A		
4			
5			
6			
7			
8			
9			
10			
11			
12			
13			
14			
15			
16			
17			
18			
19			
20			
21			
22			
23			
24			
25			

CUSTOM FIRE ASSAYING LTD.
 BOX 253
 COCHENOUR, ONTARIO POV 1L0

Date OCT. 17, 19 90
 M L. COUSINEAU

SOLD BY	C.O.D.	CHARGE	ON ACC'T.	ACCT. FWD.
1		Stamp Au @ 900	18.	00
2		Cheque received 1994	18.	00
3			0.	00
4				
5				
6				
7				
8				
9				
10				
11				
12				
13				
14				
15				

Paul Okanski
 Thank you.

46

58525E (C) AKXIRE CLEAN PRINT © Value 2000 PATENTED 1963 1966 1979 1

Assayer: *Paul Okanski*

LOUIS COUSINEAU RAY COUSINEAU KEN DESJARDINS
DISTRICT OF RAINY RIVER KENORA MINING DIVISION

PORTER INLET - M2459

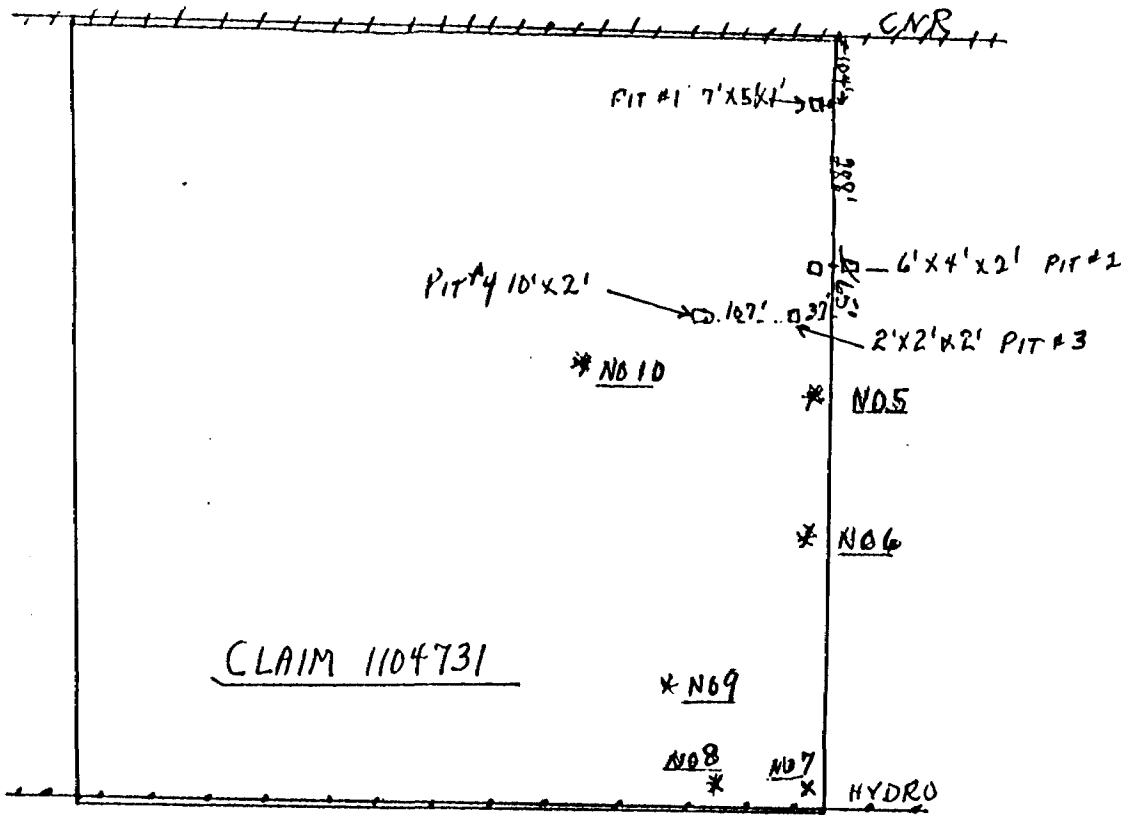

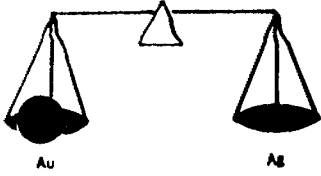

PAUL'S CUSTOM FIRE ASSAYING LTD.

Phone: Bus. (807) 662-8171

Res. (807) 662-3361

Fax: (807) 662-1155

PAUL OKANSKI, Assayer
Box 253, Cochenour, Ontario POV 1L0

L. Cousineau

ASSAY CERTIFICATE

Date: Aug. 15-90

Sample No.	Description	oz/ton Au	oz/ton Ag
1 #1	Porter Inlet July 31 Pct	Trace	
2 2	Pct	"	
3			
4			
5			
6			
7			
8			
9			
10			
11			
12			
13			
14			
15			
16			
17			
18			
19			
20			
21			
22			
23			
24			
25			

CUSTOM FIRE ASSAYING LTD.
BOX 253
COCHENOUR, ONTARIO POV 1L0

Date AUG 15 1990
M. L. COUSINEAU

SOLD BY	C.O.D.	CHARGE	ON ACCT.	ACCT. FWD.
125411		ACE 9.00		18.00
2				
3				
4				
5				
6				
7				
8				
9				
10				
11				
12				
13				
14				
15				

38

SB525E MOORE CLEAN PRINT © Value 2008 PATENTED 1963 1966 1979 1

Assayer: Paul Okanski

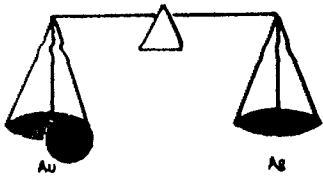

PAUL'S CUSTOM FIRE ASSAYING LTD.

Phone: Bus. (807) 662-8171

Res. (807) 662-3361

Fax: (807) 662-1155

PAUL OKANSKI, Assayer
Box 253, Cochenour, Ontario POV 1L0

ASSAY CERTIFICATE

Date: Sept. 11, 1990

1. Cousineau

Sample No.	Description	oz/ton Au	oz/ton Ag
1	1104231 Sample 15	Trace	
2	46	"	
3	17	"	
4	18	"	
5	19	"	
6	10	"	
7			
8			
9			
10			
11			
12			
13			
14			
15			
16			
17			
18			
19			
20			
21			
22			
23			
24			
25			

CUSTOM FIRE ASSAYING LTD.
BOX 253
COCHENOUR, ONTARIO POV 1L0

Date: SEPT. 11, 19 90

M L. COUSINEAU

SOLD BY	C.O.D.	CHARGE	ON ACCT.	ACCT. FWD.
1				
2				
3				
4				
5				
6				
7				
8				
9				
10				
11				
12				
13				
14				
15				

17

Assayer: Paul Okanski

LOUIS COUSINEAU RAY COUSINEAU KEN DESTARDINS

KENDRA MINING DIVISION DISTRICT OF RAINY RIVER HALKIRK TWP.

TUNNEL BAY PROJECT

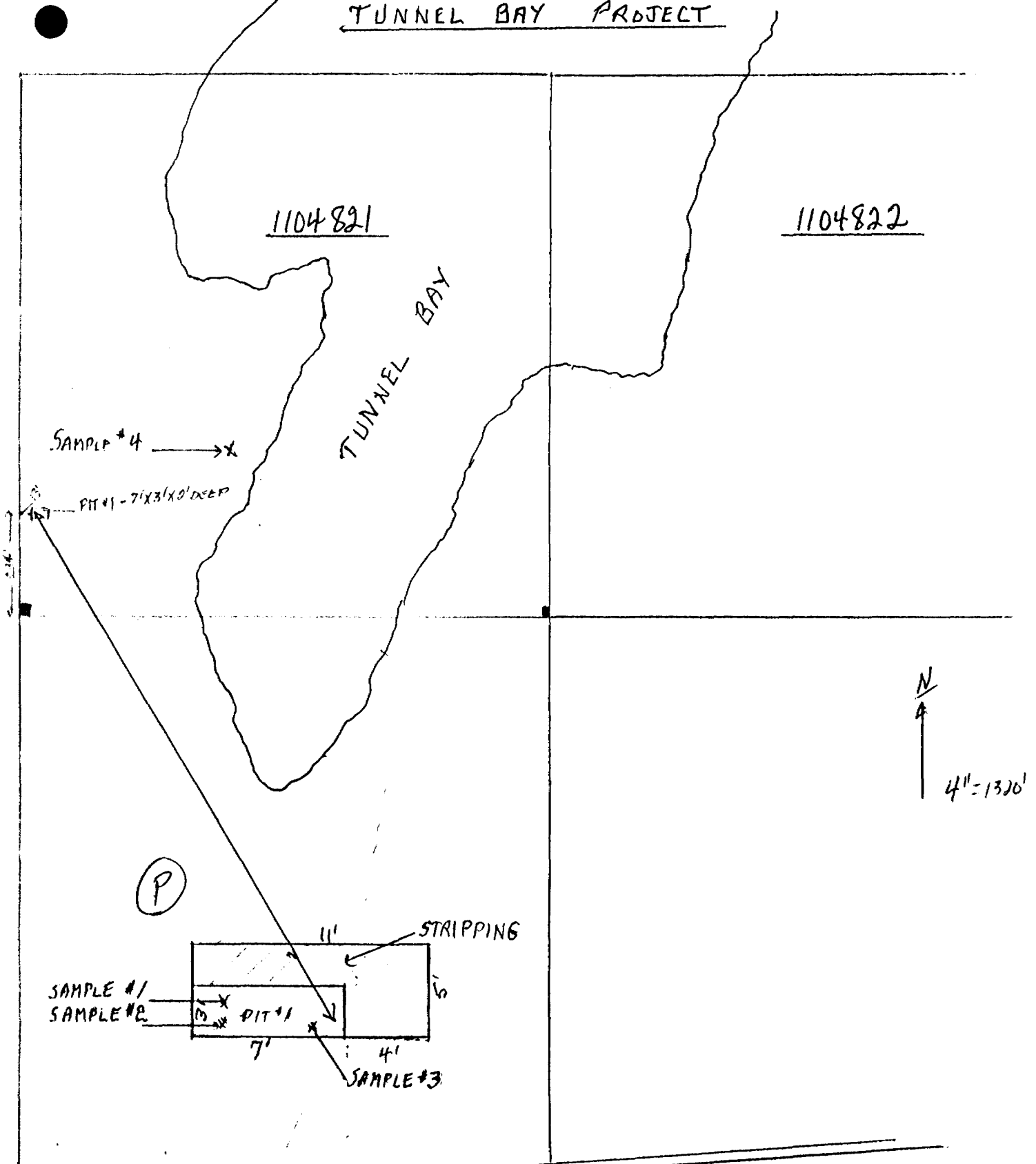

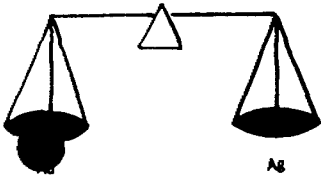

PAUL'S CUSTOM FIRE ASSAYING LTD.

Phone: Bus. (807) 662-8171

Res. (807) 662-3361

Fax: (807) 662-1155

PAUL OKANSKI, Assayer
Box 253, Cochenour, Ontario P0V 1L0

L. Cousineau

ASSAY CERTIFICATE

Date: Nov. 13, 1990.

Sample No.	Description	oz/ton Au	oz/ton Ag
1	#1 Cheque Nov. 7 <i>NY 2A</i>	Trace	
2	#2 " Nov. 7 <i>NY 2A</i>	"	
3	#1 Cheque Nov. 10 <i>NY 25</i>	"	
4	#2 " Nov. 10 <i>NY 3</i>	"	
5			
6			
7			
8			
9			
10			
11			
12			
13			
14			
15			
16			
17			
18			
19			
20			
21			
22			
23			
24			
25			

Assayer:

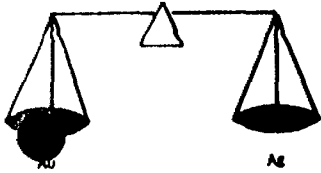

PAUL'S CUSTOM FIRE ASSAYING LTD.

Phone: Bus. (807) 662-8171

Res. (807) 662-3361

Fax: (807) 662-1155

PAUL OKANSKI, Assayer
Box 253, Cochenour, Ontario POV 1L0

I, Consignee

ASSAY CERTIFICATE

Date: Nov. 28, 1990.

Sample No.	Description	oz/ton Au	oz/ton Ag
1 #1	1104821 HALKIRK TWP PIT#1	Trace	
2 2	PIT#2	"	
3 3	PIT#3	"	
4			
5			
6			
7			
8			
9			
10			
11			
12			
13			
14			
15			

CUSTOM FIRE ASSAYING LTD.
BOX 253
COCHENOUR, ONTARIO POV 1L0

Date Nov 28 1990
 M.L. COUSINEAU

SOLD BY	C.O.D.	CHARGE	ON ACCT.	ACC'T. FWD.
---------	--------	--------	----------	-------------

1 3 Small Au @ 900	2700		
2			
3			
4			
5			
6			
7			
8			
9			
10			
11			
12			
13			
14			
15			

09

Assayer: Paul Okanski



ACCURASSAY LABORATORIES LTD.

P.O. BOX 426
KIRKLAND LAKE, ONTARIO, CANADA P2N 3J1
TEL.: (705) 567-3361

President: Dr. GEORGE DUNCAN, M.Sc., Ph. D., C. Chem (Ont.), C. Chem (U.K.), M.C.I.C., M.R.S.C., A.R.C.S.T.

Certificate of Analysis

Page: 1

36524
Louis Cousineau
272 Scott St.
P.O. Box 33
Fort Frances, Ontario
P9A 3M5

Date: December 24 19 90

Work Order # : T901031
Project :

Accurassay	SAMPLE NUMBERS Customer	Gold ppb	Gold Oz/T	Platinum ppb	Palladium ppb	
537751	<i>Sample 1 - 1</i>	11	<0.002	<15	<10	
537752	<i>Sample 2 2</i>	15	<0.002	<15	<10	
537753	<i>Sample 4 → 3</i>	11	<0.002	49	98	
537754	<i>Sample 3 4</i>	95	0.003	<15	<10	
537754		83	0.002	<15	<10	Check

Per: 



ACCURASSAY LABORATORIES LTD.

P.O. BOX 426
KIRKLAND LAKE, ONTARIO, CANADA P2N 3J1
TEL.: (705) 567-3361

President: Dr. GEORGE DUNCAN, M.Sc., Ph. D., C. Chem (Ont.), C. Chem (U.K.), M.C.I.C., M.R.S.C., A.R.C.S.T.

Certificate of Analysis

Page #1

Louis Cousineau
272 Scott Street
P.O.Box 33
FORT FRANCES, ON
P9A 3M5

Date: December 24 19 90

Work Order #: T901031
Project:

36523

Sample Numbers

ELEMENT	Unit	Sample Numbers			
		1	2	3	4
Mo	ppm	6	4	5	1
Cu	ppm	75	95	49	57
Pb	ppm	19	3	6	10
Zn	ppm	20	33	8	324
Ag	ppm	0.4	0.2	0.9	0.2
Ni	ppm	19	67	41	19
Co	ppm	19	35	35	56
Mn	ppm	55	387	44	9079
Fe	%	0.96	3.73	1.68	20.23
As	ppm	12	6	5	3
Au	ppm	nd	nd	nd	nd
Hg	ppm	nd	nd	nd	nd
Sr	ppm	6	26	2	33
Cd	ppm	1	1	1	3
Sb	ppm	4	3	5	3
Bi	ppm	2	2	4	3
V	ppm	13	59	14	157
Ca	%	0.34	1.00	0.04	3.01
P	%	0.03	0.06	0.01	0.02
La	ppm	6	25	2	2
CY	ppm	101	105	150	61
Mg	%	0.08	1.27	0.10	2.21
Ba	ppm	17	26	36	3
Ti	%	0.06	0.15	0.01	0.03
B	ppm	59	374	174	202
Al	%	0.30	1.60	0.11	3.16
Na	%	0.01	0.01	0.01	0.01
Si	%	0.01	0.01	0.01	0.05
W	ppm	7	6	5	2
Be	ppm	1	1	1	3

*Please note: nd=not detected

Per: 

LOUIS COUSINEAU
 RAY COUSINEAU
 KEN DESTJARDINS
 -1990-

LITTLE TURTLE LAKE
 BAD VERMILION

**SAMPLE
 LOCATION
 SITES**

1027000 = 34.09 PPM
 0.100000 = 3.409 PPM
 0.100000 = 3.409 PPM



BENNETT
 M.N.R. ADMINISTRATIVE DISTRICT
 FORT FRANCES
 MINING DIVISION
 KENORA
 LAND TITLES / REGISTRY DIVISION
 RAINY RIVER

Ministry of Natural Resources
 Land Management Branch

Date: FEBRUARY, 1984
 Book: M-2392 G-2667

AREA
LITTLE TURTLE LAKE
 M.N.R. ADMINISTRATIVE DISTRICT
 FORT FRANCES
 MINING DIVISION
 KENORA
 LAND TITLES / REGISTRY DIVISION
 RAINY RIVER

Ministry of Natural Resources
 Land Management Branch

Date: MARCH, 1984
 Book: G-2682

AREA
BAD VERMILION LAKE
 M.N.R. ADMINISTRATIVE DISTRICT
 FORT FRANCES
 MINING DIVISION
 KENORA
 LAND TITLES / REGISTRY DIVISION
 RAINY RIVER

Ministry of Natural Resources
 Ministry of Northern Development and Mines

Date: JULY, 1986
 Book: G-2665

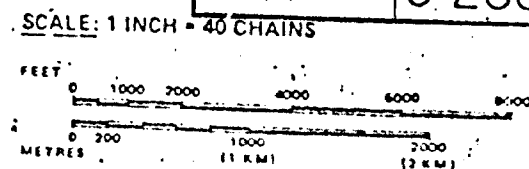
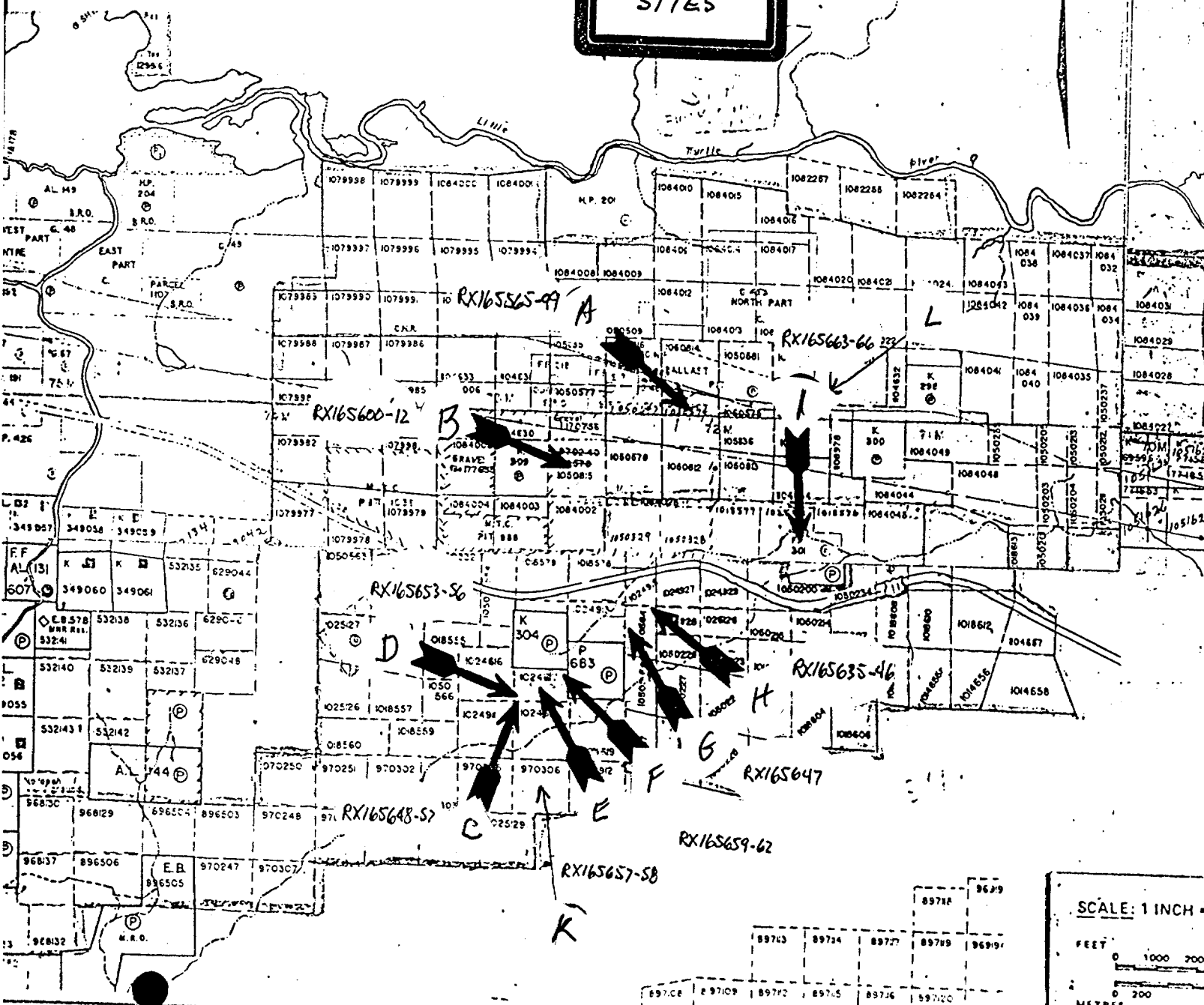

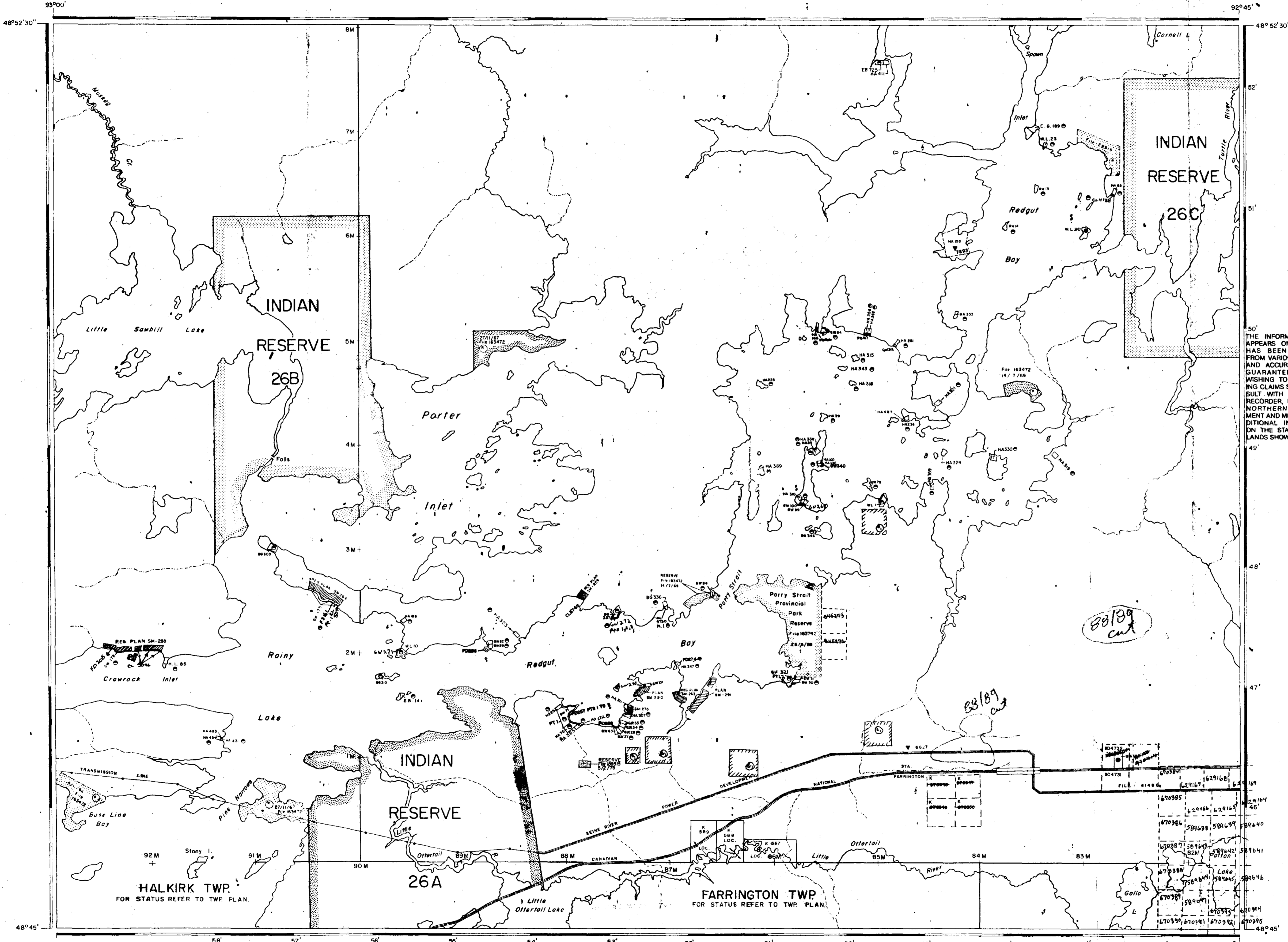

LEGEND

HIGHWAY AND ROUTE No.	
OTHER ROADS	
TRAILS	
SURVEYED LINES	
TOWNSHIPS, BASE LINES, ETC.	
LOTS, MINING CLAIMS, PARCELS, ETC.	
UNSURVEYED LINES	
LOT LINES	
PARCEL BOUNDARY	
MINING CLAIMS ETC.	
RAILWAY AND RIGHT OF WAY	
UTILITY LINES	
NON-PERENNIAL STREAM	
FLOODING OR FLOODING RIGHTS	
SUBDIVISION OR COMPOSITE PLAN	
RESERVATIONS	
ORIGINAL SHORELINE	
MARSH OR MUSKIEG	
MINES	
TRAVERSE MONUMENT	

DISPOSITION OF CROWN LANDS

TYPE OF DOCUMENT	SYMBOL
PATENT SURFACE & MINING RIGHTS	
... SURFACE RIGHTS ONLY	
... MINING RIGHTS ONLY	
LEASE, SURFACE & MINING RIGHTS	
... SURFACE RIGHTS ONLY	
... MINING RIGHTS ONLY	
LICENCE OF OCCUPATION	
ORDER IN COUNCIL	
RESERVATION	
CANCELLED	
SAND & GRAVEL	

THE INFORMATION THAT APPEARS ON THIS MAP HAS BEEN COMPILED FROM VARIOUS SOURCES AND ACCURACY IS NOT GUARANTEED. THOSE WISHING TO STAKE MINING CLAIMS SHOULD CONSULT WITH THE MINING RECORDER, MINISTRY OF NORTHERN DEVELOPMENT AND MINES, FOR ADDITIONAL INFORMATION ON THE STATUS OF THE LANDS SHOWN HEREON.

REFERENCES

AREAS WITHDRAWN FROM DISPOSITION

Description	Order No.	Date	Disposition	File
M.R.O. - MINING RIGHTS ONLY				
S.R.O. - SURFACE RIGHTS ONLY				
M.S. - MINING AND SURFACE RIGHTS				

RECEIVED
SEP 24 1990

FLOODING RIGHTS RESERVED UP TO 80.0' ABOVE MEAN SEA LEVEL ON ALL LANDS BORDERING ON RAINY LAKE. FILE: 4922, 5476.

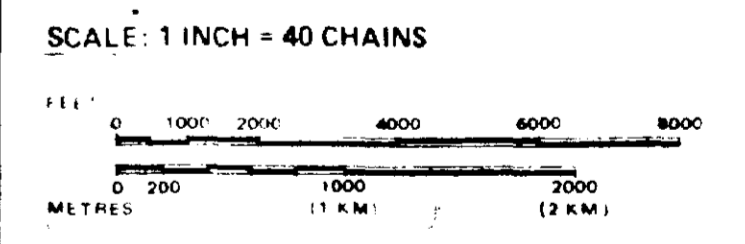

AREA
PORTER INLET (RAINY LAKE)
M.N.R. ADMINISTRATIVE DISTRICT
FORT FRANCES
MINING DIVISION
KENORA
LAND TITLES / REGISTRY DIVISION
RAINY RIVER 63595

Ministry of Land Management
Natural Resources Branch
Ontario

Date: MARCH, 1984
Number: **2459** **G-2693**



52C11E9801 63.5995 HALKIRK & FARRINGTON

HERON LAKE G-2676

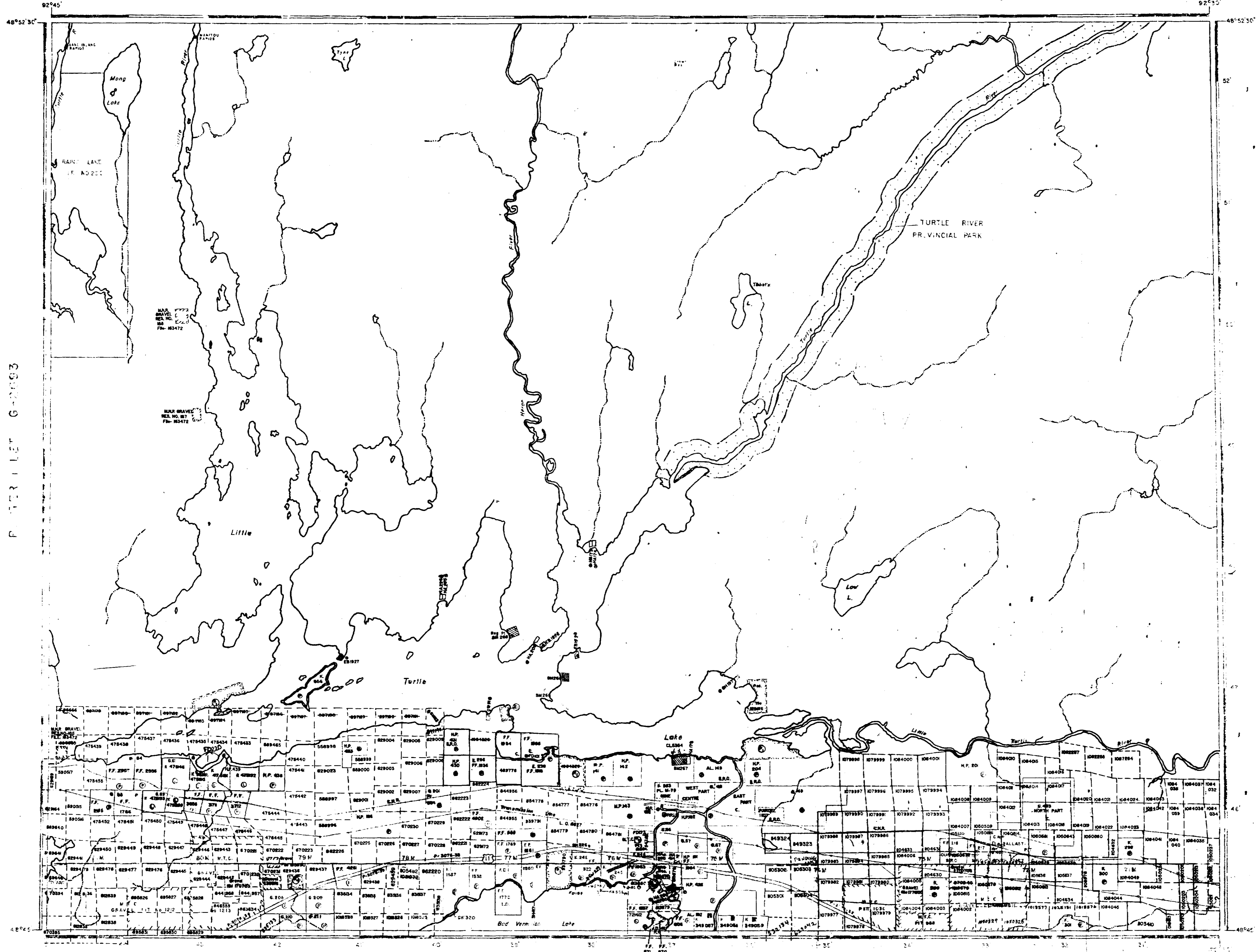

THE INFORMATION THAT APPEARS ON THIS MAP HAS BEEN COMPILED FROM VARIOUS SOURCES AND ACCURACY IS NOT GUARANTEED. THOSE WISHING TO STAKE MINING CLAIMS SHOULD CONSULT WITH THE MINING RECORDER, MINISTRY OF NORTHERN DEVELOPMENT AND MINES, FOR ADDITIONAL INFORMATION ON THE STATUS OF THE LANDS SHOWN HEREON.

LEGEND

- PATENTED LAND C.C.
- CROWN LAND SALE C.S.
- LEASES L.C.
- LOCATED LAND L.O.
- LICENSE OF OCCUPATION L.O.
- MINING RIGHTS ONLY M.R.O.
- SURFACE RIGHTS ONLY S.R.O.
- ROADS ---
- IMPROVED ROADS ---
- KING'S HIGHWAYS ---
- RAILWAYS ---
- POWER LINES ---
- MARCH OF MUSKOGES ---
- MINES ---
- PATENTED S.I.C. ---
- CANCELLED ---

REFERENCES

AREAS WITHDRAWN FROM DISPOSITION

M.R.O. - MINING RIGHTS ONLY
 S.R.O. - SURFACE RIGHTS ONLY
 M.S. - MINING AND SURFACE RIGHTS

Description	Order No.	Date	Disposition	File
Public Lands Act		7/7/67	S.R.O.	83472
			S.R.O.	
	W.7176	10/2/76	S.R.O.	47883
	M.88/77	4/1/77	S.R.O.	358
Park Reserves	M.73/85	2/20/85	M.S.	8852
	M.20/85	10/1/85	P.B.M.	
	W.K.-24/90	20/12/90	S.R.O.	

1/2 of allowance for M.C. 1177 along the shores of bed Vermion Lake-M.R.O.

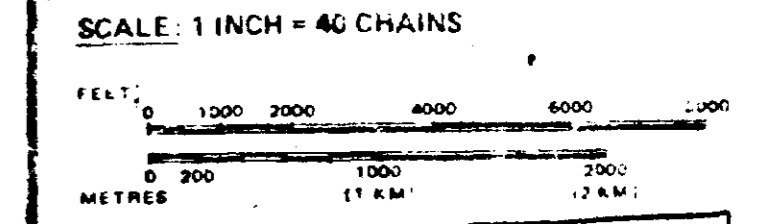

AREA **RECEIVED**
 LITTLE TURTLE LAKE
 78910112123456
 M.N.R. ADMINISTRATIVE DISTRICT
 FORT FRANCES
 MINING DIVISION
 KENORA 63.599
 LAND TITLES / REGISTRY DIVISION
 RAINY RIVER

Ministry of Natural Resources Ontario
 Land Management Branch

Date MARCH, 1984
 Number G-2682



LITTLE TURTLE LAKE - G-2682

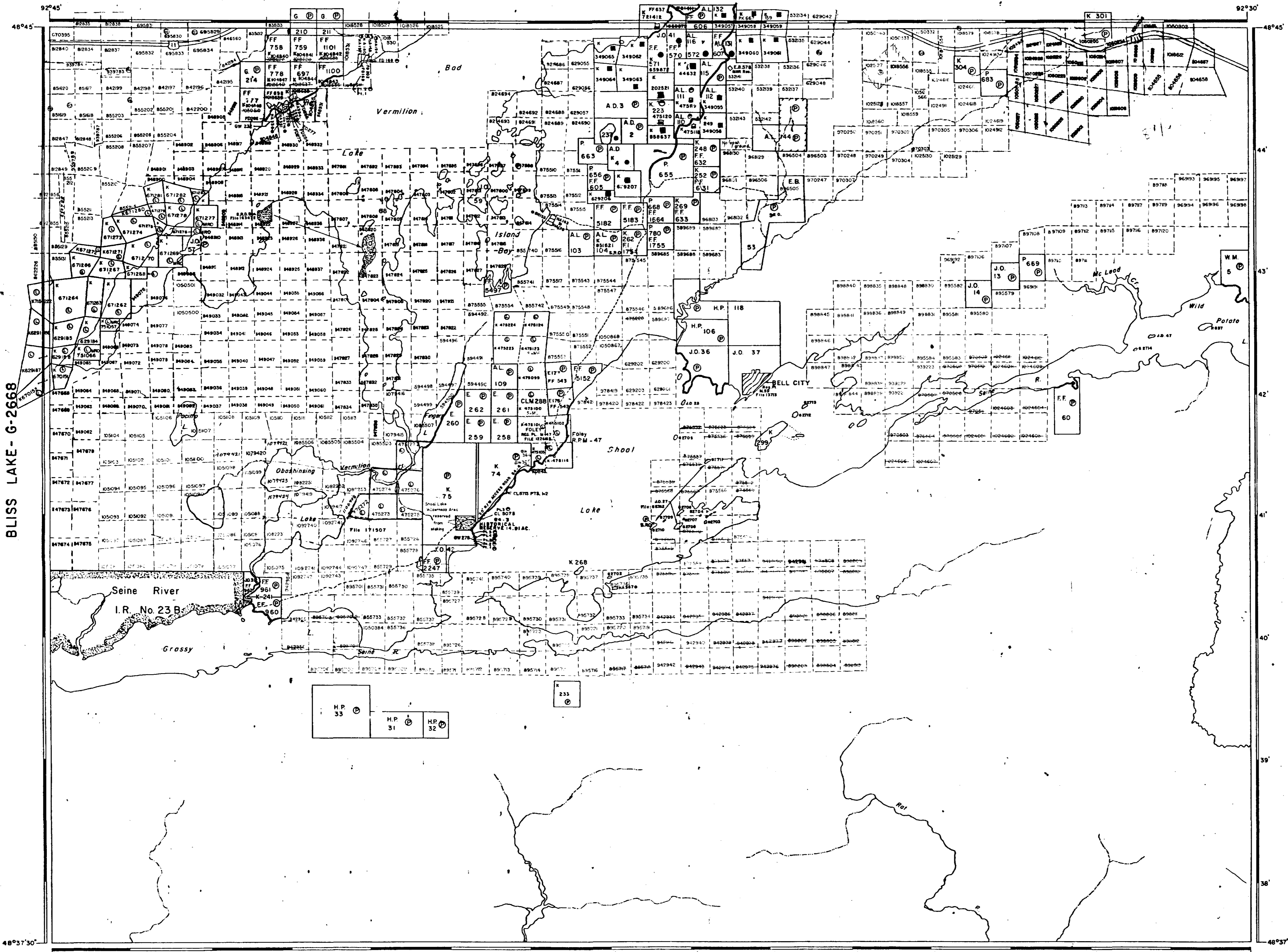

THE INFORMATION THAT APPEARS ON THIS MAP HAS BEEN COMPILED FROM VARIOUS SOURCES, AND ACCURACY IS NOT GUARANTEED. THOSE WISHING TO STAKE MINING CLAIMS SHOULD CONSULT WITH THE MINING RECORDER, MINISTRY OF NORTHERN DEVELOPMENT AND MINES, FOR ADDITIONAL INFORMATION ON THE STATUS OF THE LANDS SHOWN HEREON.

LEGEND

- PATENTED LAND
- CROWN LAND SALE
- LEASES
- LOCATED LAND
- LICENSE OF OCCUPATION
- MINING RIGHTS ONLY
- SURFACE RIGHTS ONLY
- ROADS
- IMPROVED ROADS
- KING'S HIGHWAYS
- RAILWAYS
- POWER LINES
- MARSH OR MUSKEG
- MINES
- CANCELLED
- PATENTED

REFERENCES

ARFAS WITHDRAWN FROM DISPOSITION

M.R.O. - MINING RIGHTS ONLY
S.R.O. - SURFACE RIGHTS ONLY
M+S - MINING AND SURFACE RIGHTS

Description	Order No.	Date	Disposition	File
R	W-21/85	NOV/19/85	S-MR	nov/16/87
F	W-20/85	NOV/19/85	S-MR	nov/16/87
R	W-35/88	MAY/1988	MRO	100665

SAND + GRAVEL

- M.T.C. P# No. 122
- M.T.C. P# No. 123
- M.T.C. P# No. 124
- M.T.C. P# No. 106
- Grove File 170733

KENORA
MINING DIV.
RECEIVED
JAN 09 1991
AM, P# 7891011 12123456

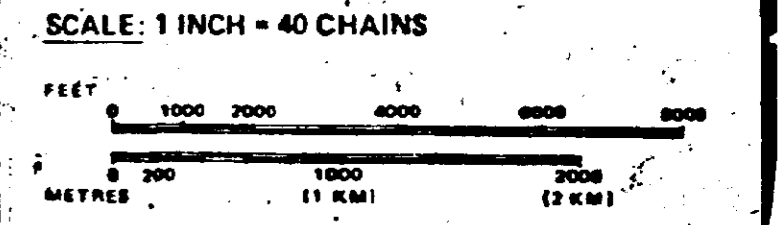

AREA **BAD VERMILION LAKE**

M.N.R. ADMINISTRATIVE DISTRICT
FORT FRANCES
MINING DIVISION
KENORA
LAND TITLES / REGISTRY DIVISION
RAINY RIVER

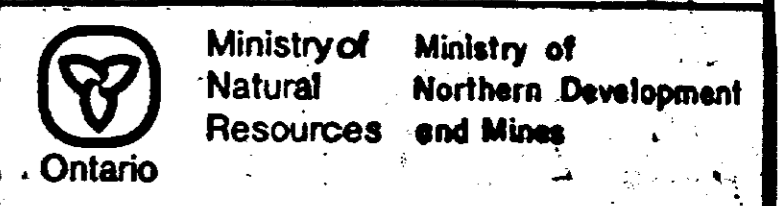

Date: JULY, 1988
Number: **G-2665**



OBIKOBA LAKE M.2126

PORTER INLET M.2453

EFFECTIVE AS SHOWN

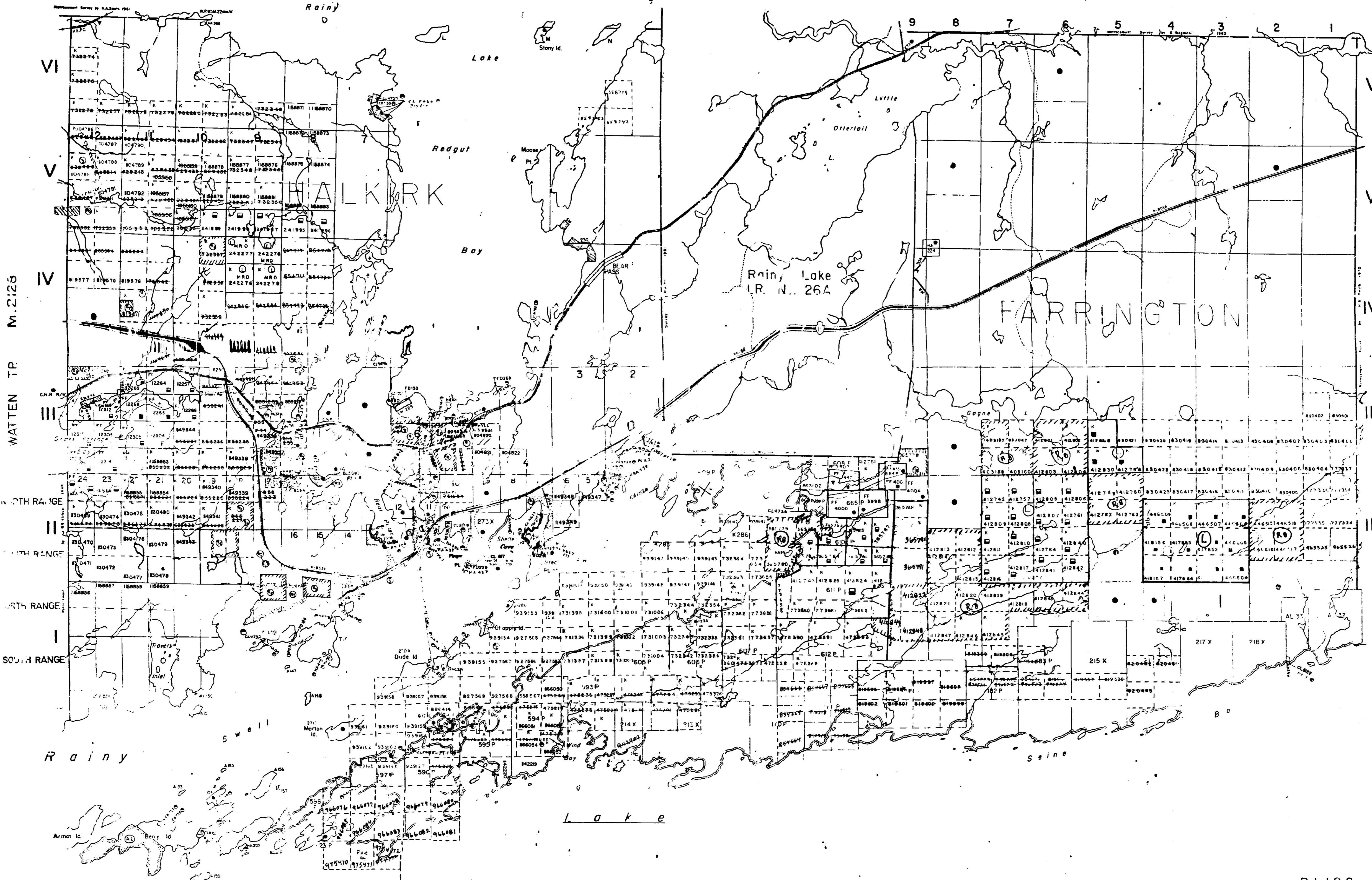

THE INFORMATION THAT APPEARS ON THIS MAP HAS BEEN COMPILED FROM VARIOUS SOURCES, AND ACCURACY IS NOT GUARANTEED. THOSE WISHING TO STAKE MINING CLAIMS SHOULD CONSULT WITH THE MINING RECORDER, MINISTRY OF NORTHERN DEVELOPMENT AND MINES, FOR ADDITIONAL INFORMATION ON THE STATUS OF THE LANDS SHOWN HEREON.

LEGEND

- HIGHWAY AND ROUTE NO.
- OTHER ROADS
- TRAILS
- SURVEYED LINES.
 - WNSHIPS, BASE LINES, ETC.
 - LOTS, MINING CLAIMS, PARCELS, ETC.
- UNSURVEYED LINES
- PARCEL BOUNDARY
- MINING CLAIMS ETC.
- RAILWAY AND RIGHT OF WAY
- UTILITY LINES
- NON-PERENNIAL STREAM
- PERENNIAL STREAM
- SUBSIDY
- ORIGINAL BOUNDARY
- MAPS OF MOUNTAINS
- MINES

SCALE: 1 INCH = 40 CHAINS

KENORA MINING DIV.
RECEIVED
 NOV 26 1990
 AM 7891011 12123456 PM

TOWNSHIPS
HALKIRK AND FARRINGTON
 DISTRICT
 RAINY RIVER

MINING DIVISION
 KENORA
63.599

Ministry of Natural Resources
 Ontario
 Survey and Mapping Branch

Dist. No. APRIL 1970
 Mining Block
 Owner's Plan No. **M.2051**

