



52C15SW0032 10 OBIKOKA LAKE

010

Diamond Drilling

Area of Obikoba Lake

Report NO 10

Work performed by: Rainy Lake Mg. Ltd.

Claim NO	Hole NO	Footage	Date	Note
FF 7966	1	62.3'	May/57	
	2	84.5'	June/57	
	3	92.5'	June/57	
	4	104'	June/57	
	5	103.2'	June/57	
		<u>446.5</u>		

Notes:

Completed
Oct 19/58
JWA 5/1/53

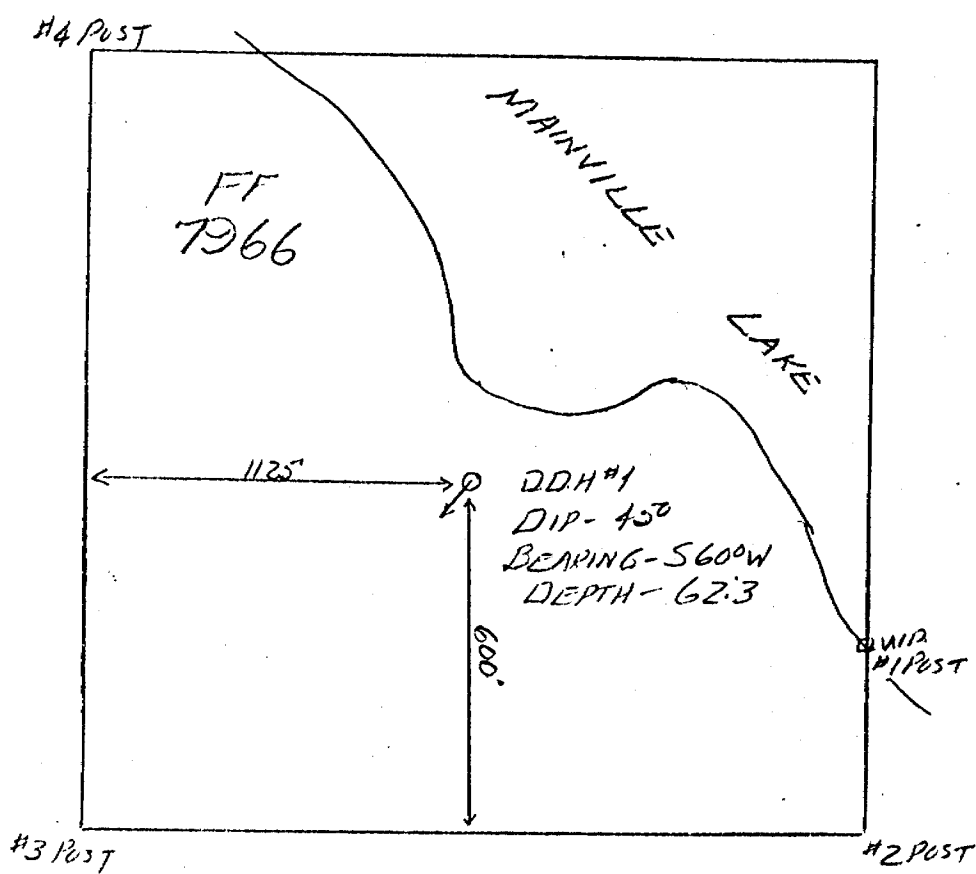

DIAMOND DRILL RECORD

PROPERTY RAINY LAKE MINING, LIMITED

HOLE NO. 1

SHEET NUMBER 1

SECTION FROM _____ TO _____

STARTED May, 1957

LATITUDE 7800 SE.

DATUM _____

COMPLETED May, 1957

DEPARTURE 1242 NE.

BEARING _____ S50°W

ULTIMATE DEPTH 62.3

ELEVATION _____

DIP _____ 45°

PROPOSED DEPTH _____

DEPTH FEET	FORMATION	SAMPLE NO.	WIDTH OF SAMPLE	GOLD %	SLUDGE GOLD %
00-110	CASING				
110-174	GRANITE DIKE Fine-grained grey biotite granite. Biotite gneiss inclusions in the last two feet. GEIGER COUNTER - base reading 20. Readings along dike 30 with one narrow section to 50.				
174-27.9	BIOTITE GNEISS Probably recrystallized sediments.				
27.9-29.0	GRANITE DIKE One contact at 70° to the core axis. Geiger counter - readings normal.				
29.0-62.3	BIOTITE GNEISS Numerous narrow granite dikes ranging from 1" to 12" in width. Contacts 65° to 70° to the core axis. Geiger Counter - base readings.				
62.3	END OF HOLE				

DRILLED BY _____

SIGNED *E. D. McLeod*
"E. D. McLEOD"

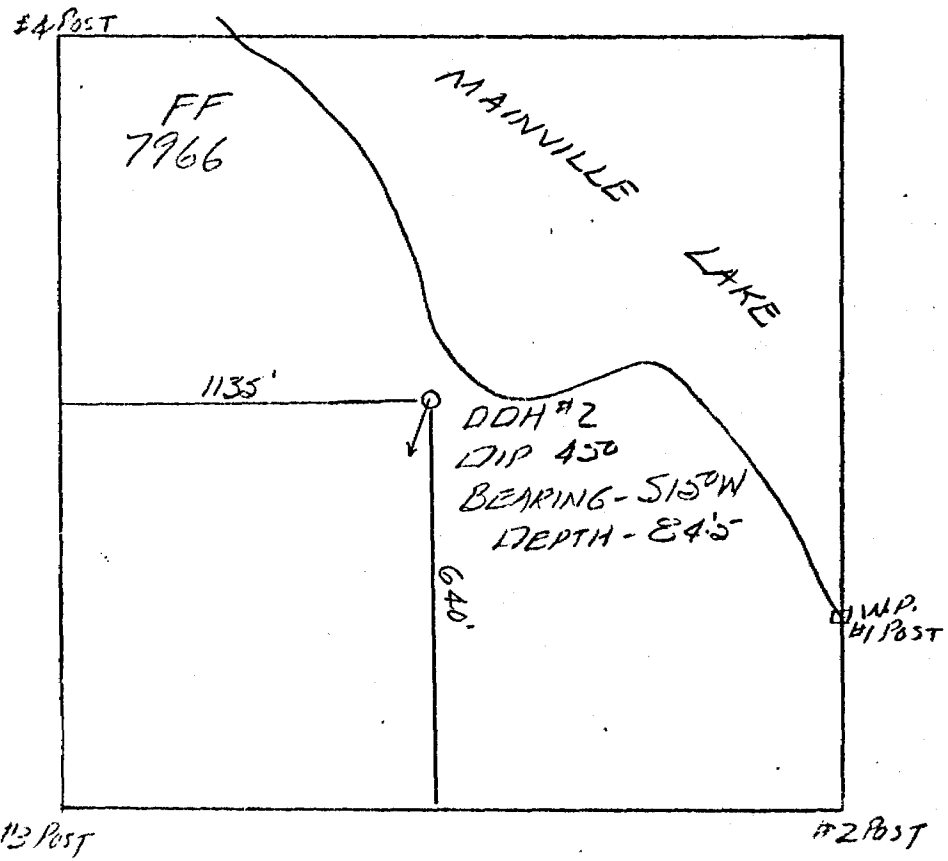

DIAMOND DRILL RECORD

PROPERTY RAINY LAKE MINING, LIMITED HOLE NO. 2

SHEET NUMBER 1 SECTION FROM _____ TO _____ STARTED June, 1957
 LATITUDE 6 & 50 S.E. DATUM _____ COMPLETED June, 1957.
 DEPARTURE 1 & 50 N.W. BEARING S15° W ULTIMATE DEPTH 84.5
 ELEVATION _____ DIP 45° PROPOSED DEPTH _____

DEPTH FEET	FORMATION	SAMPLE NO.	WIDTH OF SAMPLE	GOLD †	SLUDGE GOLD ‡
0.0-5.0	CASING				
5.0-7.5	BIOTITE GNEISS				
7.5-31.7	PEGMATITE DIKE				
	Coarse-grained, light pink in colour, composed of feldspars and quartz with minor biotite mica.				
	GEIGER COUNTER -				
	7.5 to 11.5 - 20 to 40 Base reading	20.			
	11.5 to 14.0 - 50 to 70				
	14.0 to 30.0 - 50				
	30.0 to 31.7 - 30 to 40				
31.7 -40.0	BIOTITE GNEISS				
	Granitized.				
40.0 -43.8	PEGMATITE DIKE				
	Geiger counter -				
	40.0 to 42.8- 30 to 50				
	42.8 to 43.8- 20				
43.8-51.8	BIOTITE GNEISS				
	Scattered narrow pegmatite dikes. Disseminated pyrophyllite and pyrite.				
51.8-53.3	PEGMATITE DIKE -Geiger counter - 20				

N.M.P., TORONTO-STOCK FORM NO. 501 REV. 12/51

DRILLED BY

SIGNED..... *H. D. McLEOD*
 "H. D. McLEOD"

DIAMOND DRILL RECORD

PROPERTY _____

 HOLE NO. 2

 SHEET NUMBER 2

SECTION FROM _____ TO _____

STARTED _____

LATITUDE _____

DATUM _____

COMPLETED _____

DEPARTURE _____

BEARING _____

ULTIMATE DEPTH _____

ELEVATION _____

DIP _____

PROPOSED DEPTH _____

DEPTH FEET	FORMATION	SAMPLE No.	WIDTH OF SAMPLE	GOLD \$	SLUDGE GOLD \$		
55.3-55.0	BIOTITE GNEISS						
55.0-56.5	GRANITE DIKE						
56.5-84.5	BIOTITE GNEISS						
	Scattered narrow granite dikes.						
84.5	END OF HOLE						

N.M.P. TORONTO-STOCK FORM No. 801 REV. 12/51

DRILLED BY

SIGNED

28

#4 POST

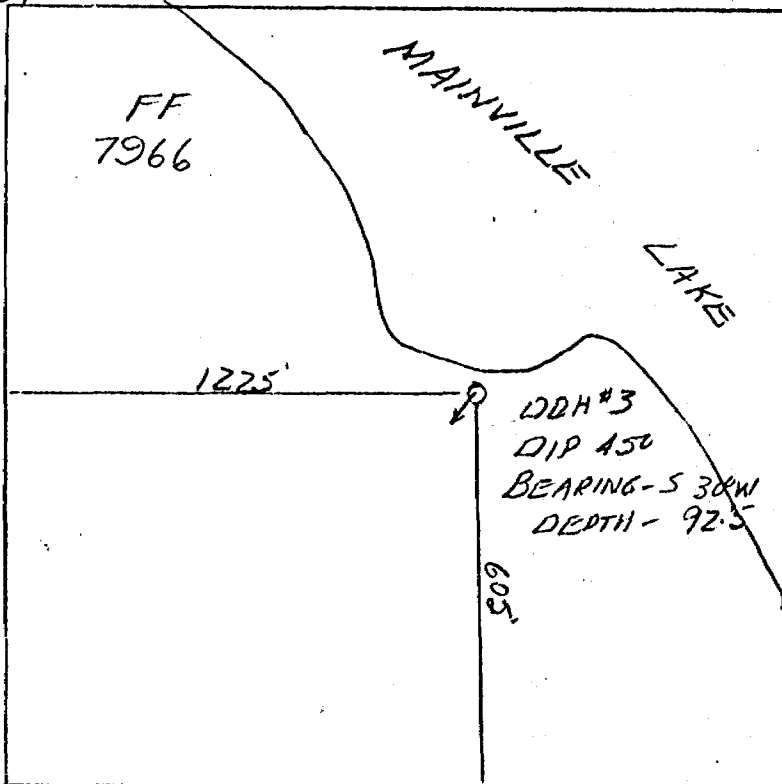

OWP #1 POST

#3 POST

#2 POST

2

DIAMOND DRILL RECORD

PROPERTY RAINY LAKE MINING, LIMITED

HOLE NO. 3

SHEET NUMBER 1

SECTION FROM _____ TO _____

STARTED June, 1957

LATITUDE 6 & 95 S.E.

DATUM _____

COMPLETED June, 1957

DEPARTURE 2 & 40 N. E.

BEARING S. 30° W

ULTIMATE DEPTH 98.5

ELEVATION _____

DIP 45°

PROPOSED DEPTH _____

DEPTH FEET	FORMATION	SAMPLE NO.	WIDTH OF SAMPLE	GOLD \$	SLUDGE GOLD \$
0.0-6.0	CASING				
6.0-10.0	BIOTITE GNEISS				
10.0-14.0	GRANITE DIKE				
	13.7 - One large grain of molybdenite.				
	Geiger counter - 30				
14.0-26.8	BIOTITE GNEISS				
	Scattered narrow granite dikes.				
26.8-32.7	PEGMATITE DIKE				
	Geiger counter -				
	26.8-29.5 - 30 Base reading - 20				
	29.5-31.0 - 50				
	31.0-32.7 - 25				
32.7-56.5	BIOTITE GNEISS				
	Scattered narrow granite and pegmatite dikes. Some pyrite locally.				
56.5-61.0	PEGMATITE DIKE				
	Geiger counter - 20 to 40.				
61.0-66.0	BIOTITE GNEISS				
	One 3" granite dike.				
66.0-66.8	PEGMATITE DIKE				
	Geiger counter - 20 to 40				

N.M.P. TORONTO-STOCK FORM NO. 501 REV. 12/51

DRILLED BY

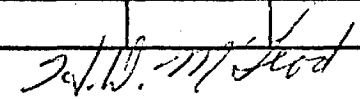
 SIGNED "H. D. McLEOD"

DIAMOND DRILL RECORD

PROPERTY _____ HOLE NO. 5

SHEET NUMBER 2 SECTION FROM _____ TO _____ STARTED _____
 LATITUDE _____ DATUM _____ COMPLETED _____
 DEPARTURE _____ BEARING _____ ULTIMATE DEPTH _____
 ELEVATION _____ DIP _____ PROPOSED DEPTH _____

DEPTH FEET	FORMATION	SAMPLE No.	WIDTH OF SAMPLE	GOLD \$	SLUDGE GOLD \$
66.6-67.6	LOST CORE				
67.6-74.0	PGMATITE LIKE				
	Geiger counter -				
	changeable 20 to 0 maxima of 60.				
74.0-88.6	BIOTITE GNEISS				
	Scattered narrow granite and pegmatite dikes.				
88.6-92.5	GRANITE LIKE				
92.5	END OF HOLE				

N.M.P., TORONTO-STOCK FORM NO. 501 REV. 12/51

DRILLED BY _____ SIGNED _____

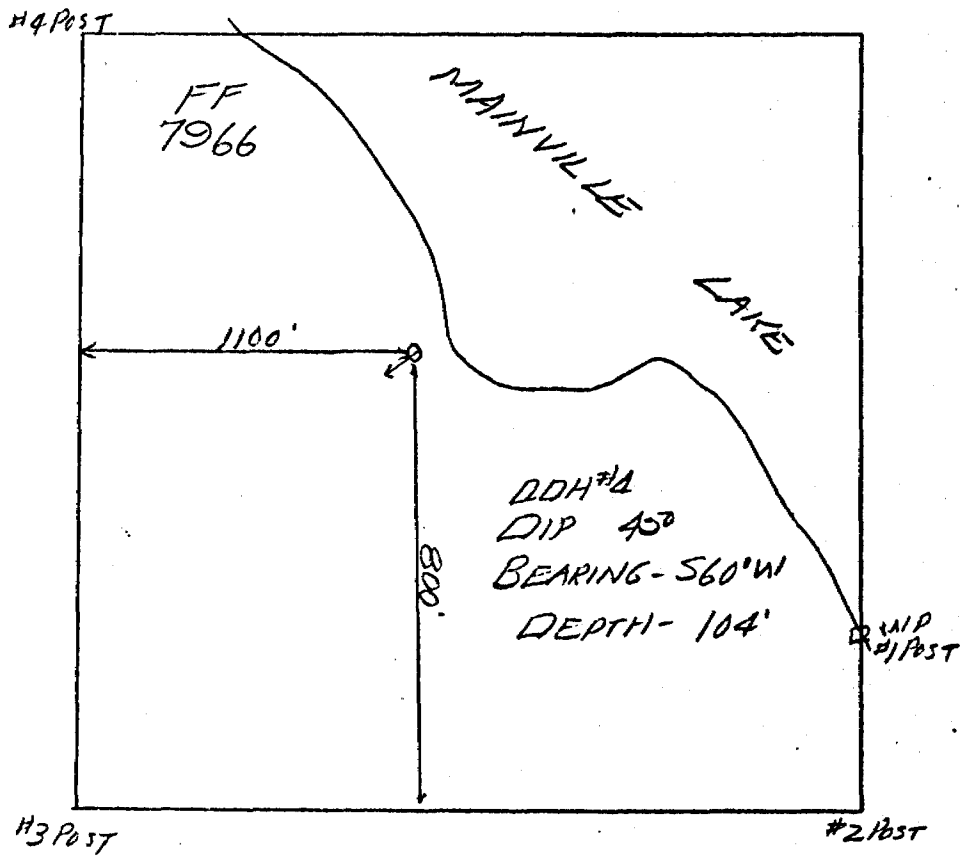

DIAMOND DRILL RECORD

PROPERTY RAINY LAKE MINING, LIMITED

HOLE NO. 4

SHEET NUMBER 1 SECTION FROM _____ TO _____ STARTED June, 1957
 LATITUDE 5 & 00 S.E. DATUM S60° W COMPLETED June, 1957.
 DEPARTURE 1 & 25 N.E. BEARING 45° ULTIMATE DEPTH _____
 ELEVATION _____ DIP _____ PROPOSED DEPTH _____

DEPTH FEET	FORMATION	SAMPLE NO.	WIDTH OF SAMPLE	GOLD \$	SLUDGE GOLD \$
0.0-1.0	CASING				
1.0-31.0	PERMITE				
	1.0-11.5 - Geiger reading - 30-50	951	10.5		
	20-40	952	10.0		
	20-40	953	9.5		
31.0-43.5	BIOTITE GNEISS				
	60% replaced by narrow granite and pegmatite dikes.				
43.5-75.0	PERMITE				
	43.5-55.5 - Geiger reading 30-50	954	10.0		
	53.5-63.5 - 30-60	955	10.0		
	63.5-75.0 - 30-60	956	11.5		
75.0-79.2	BIOTITE GNEISS				
	Numerous narrow granite dikes.				
79.2-93.0	PERMITE				
	Geiger reading - 10-30				
93.0-104.0	BIOTITE GNEISS				
	Scattered narrow granite and pegmatite dikes.				
104.0	END OF HOLE				

N.M.P., TORONTO-STOCK FORM NO. 501 REV. 12/51

DRILLED BY

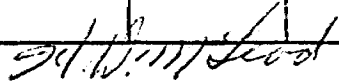
 SIGNED..... "H. D. McLEOD", P. Eng.

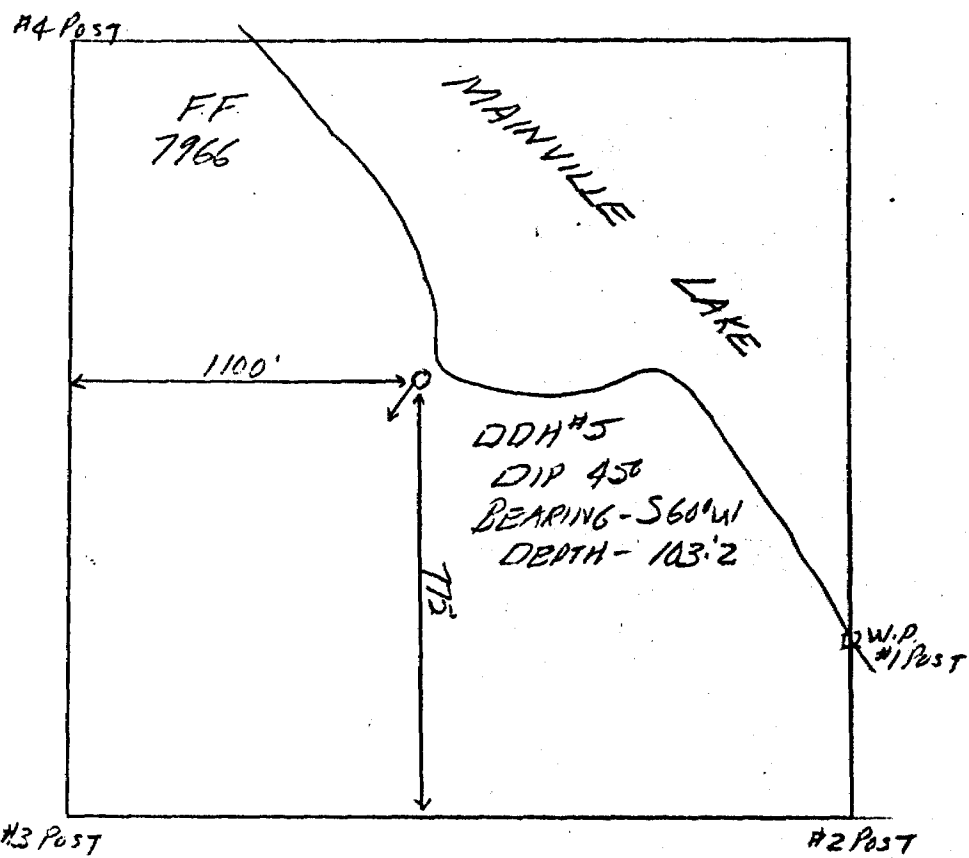

DIAMOND DRILL RECORD

PROPERTY RAINY LAKE MINING, LIMITED HOLE NO. 5

SHEET NUMBER 1 SECTION FROM _____ TO _____ STARTED June, 1957
 LATITUDE 5 & 50 S.E. DATUM _____ COMPLETED June, 1957.
 DEPARTURE 1 & 25 N.E. BEARING S60° W ULTIMATE DEPTH 103.2
 ELEVATION _____ DIP 45° PROPOSED DEPTH _____

DEPTH FEET	FORMATION	SAMPLE NO.	WIDTH OF SAMPLE	GOLD \$	SLUDGE GOLD \$
0.0-1.0	CASING				
1.0-32.8	<u>PERLITE</u>				
	Geiger readings - 10-5.0 - 40 to 75				
	5.0-7.0 - 30 to 40	957	10.5		
	7.0-11.5 - 40 to 60				
	11.5 -15.0 30 to 40	958	3.5		
	15.0 -26.0 40 to 70	959	11.0		
	26.0 -32.8 30 to 50	960	6.8		
32.8-33.8	<u>BIOTITE GNEISS</u>				
33.8-101.0	<u>PERLITE</u>				
	Geiger readings - 33.8-44.0 30 to 40	961	10.2		
	44.0-52.5 30 to 50	962	8.5		
	52.5-60.0 50 to 70	963	7.5		
	60.0-66.0 50 to 70	964	6.0		
	66.0-69.5 30	965	3.5		
	69.5-78.5 40 to 60	966	9.0		
	78.5-86.5 40 to 60	967	8.0		
	86.5-95.0 30 to 40	968	8.5		
	95.0-101.0 30 to 40	969	6.0		
101.0-103.2	<u>BIOTITE GNEISS</u>				
	Stringers and disseminated pynbiotite & pyrite.				

N.M.P. TORONTO-STOCK FORM NO. 501 REV. 12/51

103.2 END OF HOLE.

DRILLED BY

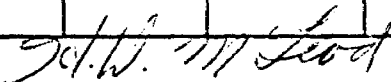
 SIGNED "H. D. McLEOD", P. Eng.