



Jan. 20, 92

Ontario Prospectors  
Assistant Program  
Sudbureg, Ont.

Gentlemen

The 1991-92 OPAP program  
has been very encouraging in  
3 out of 4 zones.

PROJECT  
AREA # 1  
Bennett Lake

RESULTS: Bennett Lake NORTH zone 10-11-12 claim 1149565

Felsic Tuff, quartz stringers - zinc assays  
of 2330, 2740, 2150 P.P.M. The zone is quite  
wide 66' & open 115' long & open, it is  
surrounded by deep overburden - difficult  
to prospect. - Possibility of large  
low grade zinc deposit, will more work.

Recommendations. - We will blast 1 pit at least 6-10'  
deep as we did at Bad Vermillion Lake  
claim 1050564 - it led us to better zones  
and is now optioned by INCO. The quartz  
veins seem to come closer together to the  
South & East, so we will Trucko blast  
a deeper pit in this zone.

Bennett Lake ~~NORTH~~ EAST ZONES 21, 22, 23 claim 1144459

felsic crystal tuff area with quartz veins throughout in all directions. Very encouraging assays .48 <sup>oz</sup> Au, .86 <sup>oz</sup> Au, 36.4 g/t. samples of visible gold. This zone seems to have very good potential, but needs a lot of work to put the puzzle together.

Recommendations. We will open zone 23 (we have already started with new pits and depth.

We will put new pits at both ends of zone 21 + 22 to try and establish length and width of zone & downwater pit.

Work on this area has to be done in winter as summer access is very difficult

Project Area #2 Results - Tunnel Bay - Halibut top. claim 1149456

Quartz sheet - major sulphide area. We thought we finally hit the gold zone but assay results said no.

Recommendations - We sent good grab sample from this area a few years ago but can't seem to find the source - We are without recommendations only to keep on looking?

PROJECT  
Area 3

Results - Little Turtle Lake top claim 1149325

Quartz stringers in tuff mine exp. and beautiful sulphides - Again we

thought we had hit a major gold zone but assays told us different.

Recommendations - This zone is open on all ends and deserves another very good look. Suggest we lengthen width of pit and prospect all around pit area. This is another zone that is very difficult to reach in summer, will have to be done in winter.

PROJECT  
# 4

Results - Porter Inlet - West of claim 670384  
" highway. We prospected this area but just could not seem to locate any mineralized zones of interest.

Recommendations - The area is on the Guelico fault and seems to have all the right host rock, we just can't seem to find the right zone. This area deserves more prospecting!

Sincerely  
Ken Desjardins  
Lair Cousineau  
Ray Cousineau

ACCESS

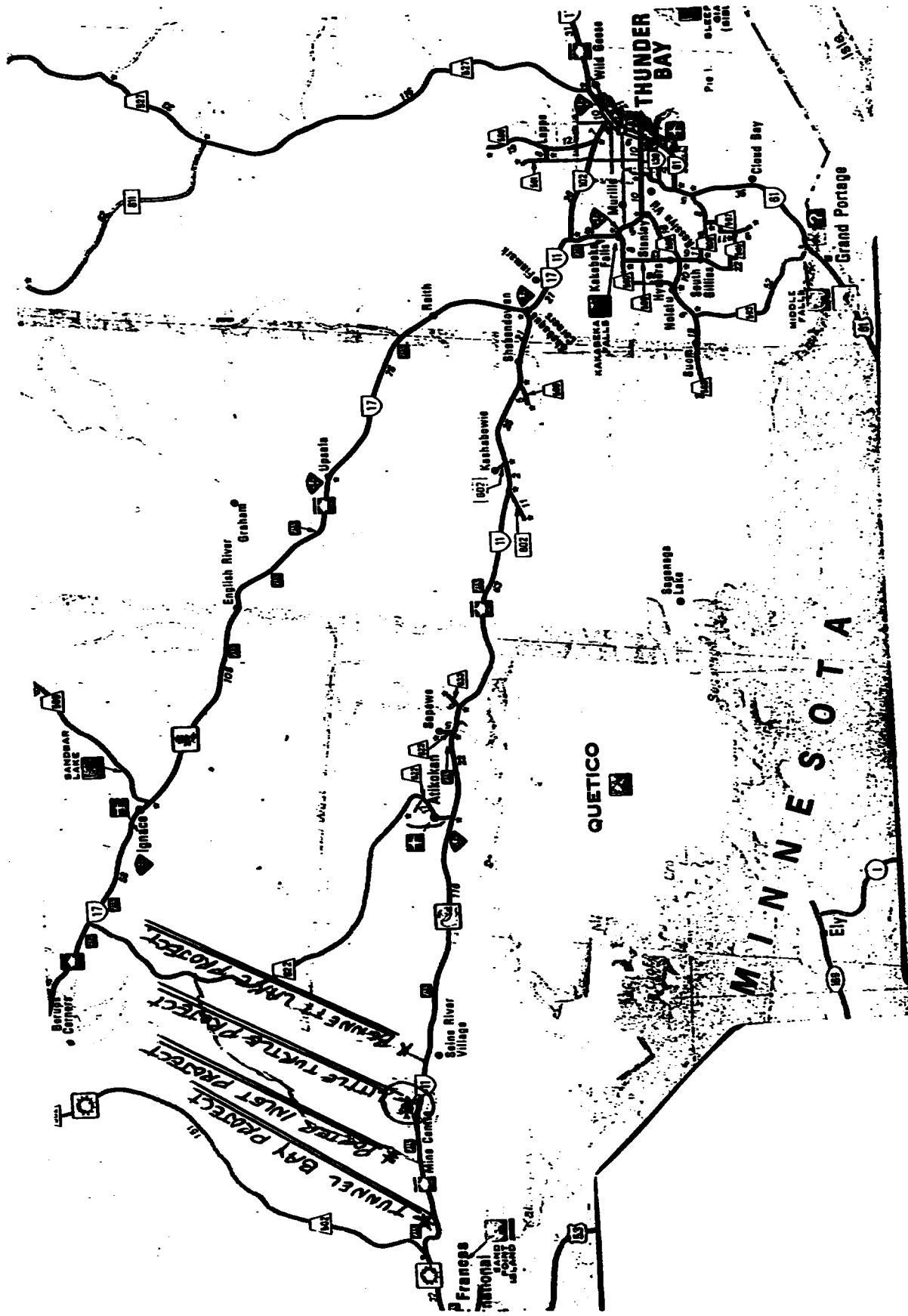

# PROSPECTING DAILY LOG

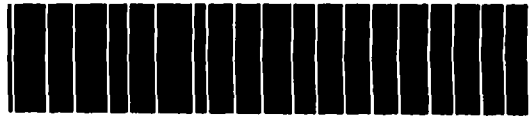

52C16SW0010 OP91-353 HALKIRK

020

PROJECT AREA

DATE

LITTLE TURTLE LAKE

DEC 27 / 91

PROSPECTED EAST AND WEST CLAIM LINES OF CLAIM 1149382  
1-SAMPLE

DEC 28 / 91

PROSPECTED SOUTH CLAIM LINE OF CLAIM 1149325 (2 SAMPLES)

ZONE  
1149382

DEC 29 / 91

PROSPECTED ALONG EAST CLAIM LINE 1149325 (2 SAMPLES)

JAN 8 / 91

1/2 DAY PROSPECTING SOUTH LINE CLAIM 1149325 - (2) - SAMPLES

LOCATION OF PROSPECTING

AREA OUTLINED ON PREVIOUSLY SUBMITTED CLAIM MAP  
DETAILED SKETCH ATTACHED

## DESCRIPTION OF SAMPLES

<u>SAMPLE NO</u>	<u>TYPE</u>	<u>ROCKTYPE</u>	<u>MINERALIZATION</u>	<u>ASSAY</u>
1	GRAB	TUFF	MINOR SULPHIDE	TR-AU.
2	GRAB	QUARTZ VEIN	MINOR SULPHIDE	TR-AU
3	GRAB	QUARTZ STRINGERS IN TUFF	MINOR SULPHIDE WITH CPY.	TR-AU
4	GRAB	QUARTZ VEIN IN TUFF	MINOR SULPHIDE	TR-AU
12	GRAB	QUARTZ VEIN IN TUFF	MINOR SULPHIDE	TR-AU
13	GRAB	QUARTZ VEIN IN TUFF	MINOR SULPHIDE	TR-AU

ACCESS LITTLE TURTLE LAKE

--- ACCESS ROUTE

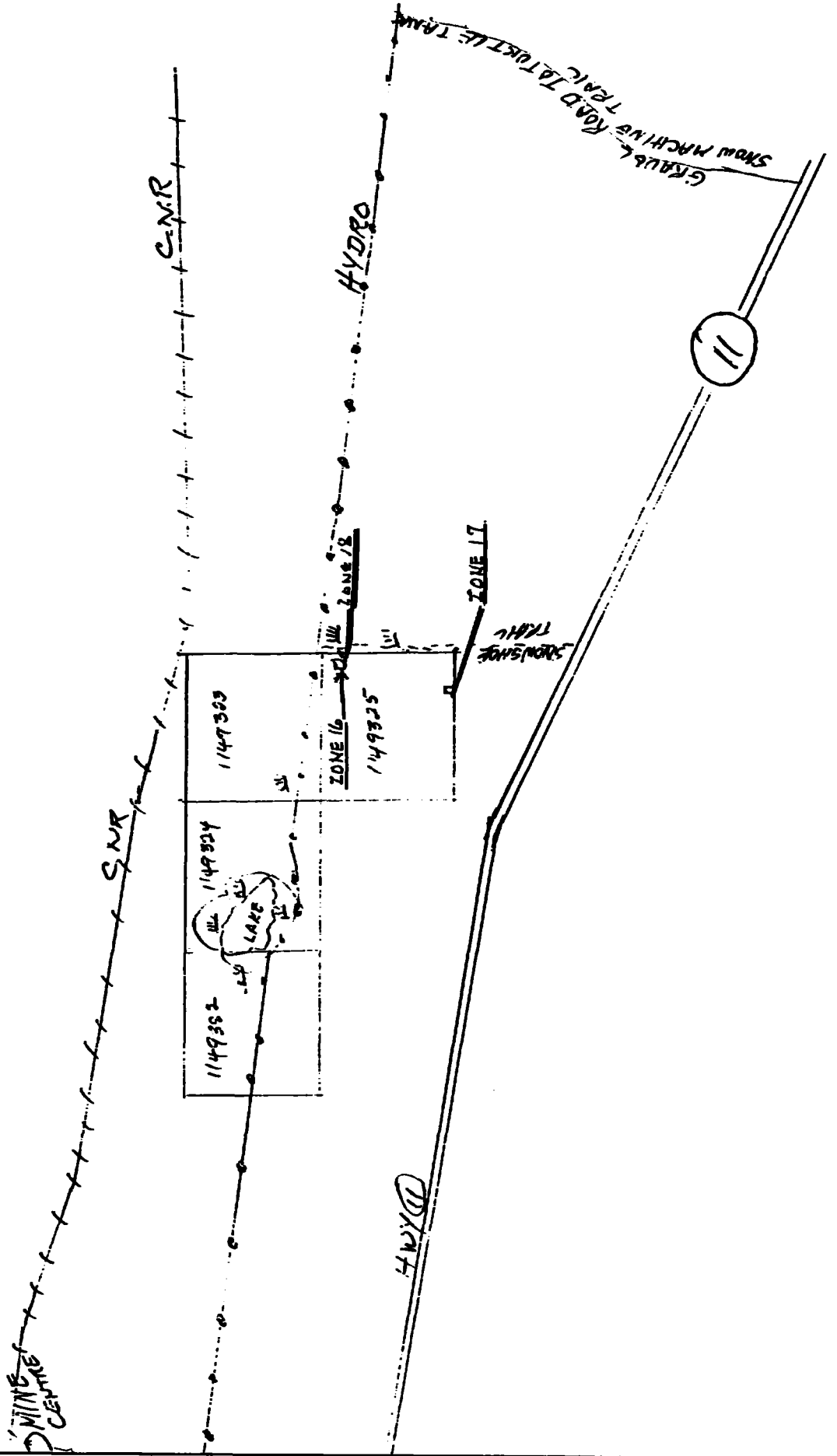

# STRIPPING AND TRENCHING - DAILY LOG

<u>PROJECT AREA</u>	<u>DATE</u>	<u>WORK PERFORMED</u>
<u>LITTLE TURTLE LAKE</u>	JAN 1 <sup>NEW YEARS 1992</sup>	STRIPPING AREA NORTH PART OF EAST LINE (ZONE 16) 6'x3' CLAIM 1149325
	JAN 2	STRIPPING AREA NORTH PART OF EAST LINE (ZONE 16) 8'x2' CLAIM 1149325
	JAN 3	STRIPPING AREA NORTH PART OF EAST LINE (ZONE 16) 7'x3' CLAIM 1149325
	JAN 4	BLASTED - TRENCHED - SAMPLED 2'x10' (ZONE 16)
	JAN 5	BLASTED - TRENCHED - SAMPLED 2'x11' (ZONE 16)
	JAN 6	STRIPPING AREA CENTER PART OF SOUTH LINE (ZONE 17) CLAIM 1149325
	JAN 7	BLASTED - TRENCHED - SAMPLE (ZONE 17)
	JAN 8	STRIPPING (ZONE 18) EAST LINE CL. 1149325 1-SAMPLE ZONE-16 SAMPLE (2)

LOCATION OF STRIPPING AND TRENCHING - SKETCH ATTACHED

SKETCH OF TRENCHING AND SAMPLING

- SKETCH ATTACHED

DESCRIPTION OF SAMPLES

<u>SAMPLE NO</u>	<u>TYPE</u>	<u>ROCK TYPE</u>	<u>MINERALIZATION</u>	<u>ASSAY</u>
5	CHIP 4'	QTZ STRINGERS IN TUFF	NICE SULPHIDES + CPY.	TR - AU
6	CHIP 4'	QTZ STRINGERS IN TUFF	NICE SULPHIDES + CPY.	TR - AU
8	CHIP 4"	QUARTZ TUFF	MINOR SULPHIDES	TR - AU
14	CHIP 2'	QUARTZ TUFF	NICE SULPHIDES	TR - AU
15	CHIP 2'	QUARTZ TUFF	NICE SULPHIDES	TR - AU
16	CHIP 6"	QUARTZ TUFF	NICE SULPHIDES	TR - AU

LITTLE TURTLE LAKE RAINY RIVER DISTRICT

LOCATION OF PROSPECTING

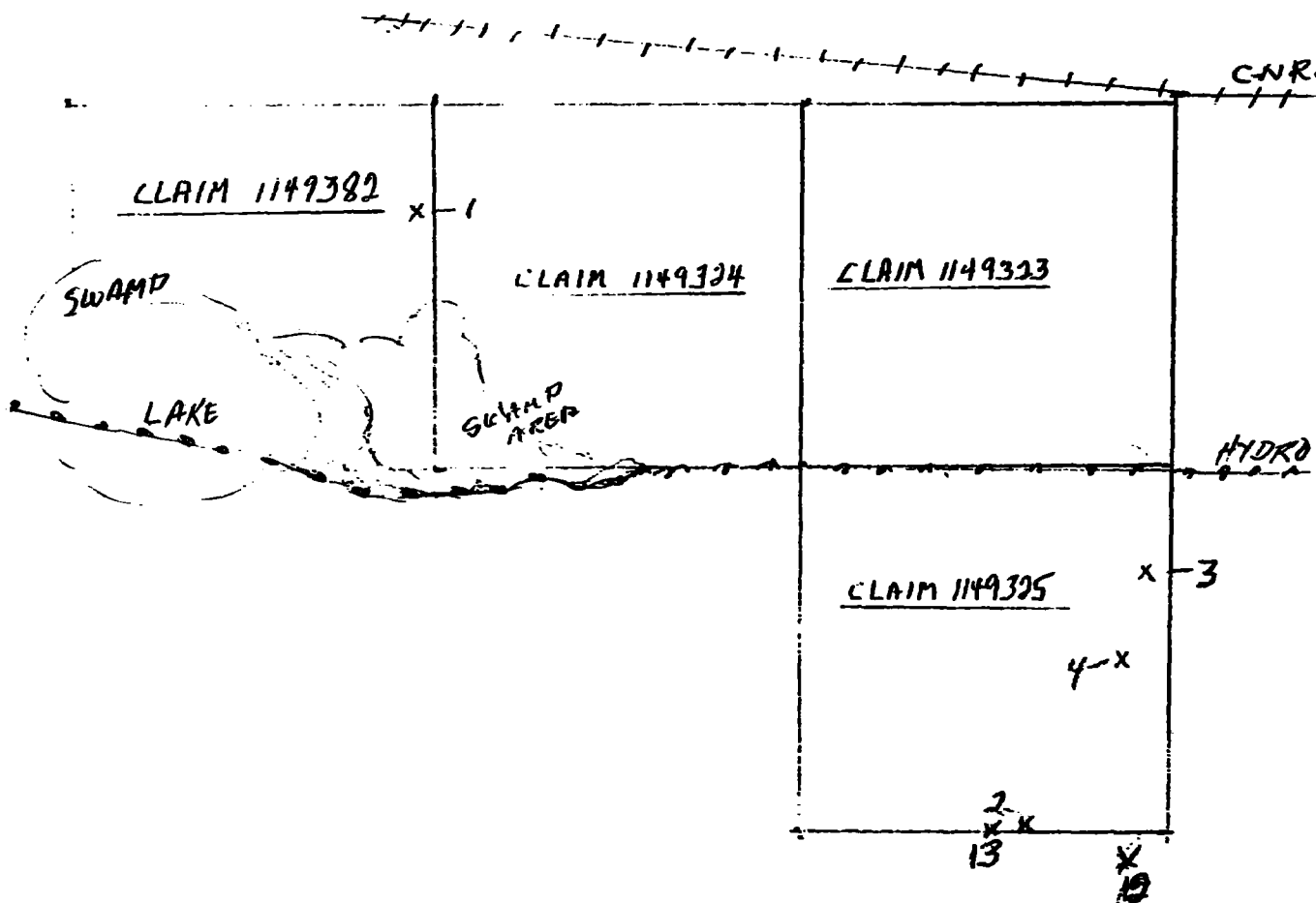



# LITTLE TURTLE LAKE RAINY RIVER DISTRICT

## LOCATION OF STRIPPING & TRENCHING

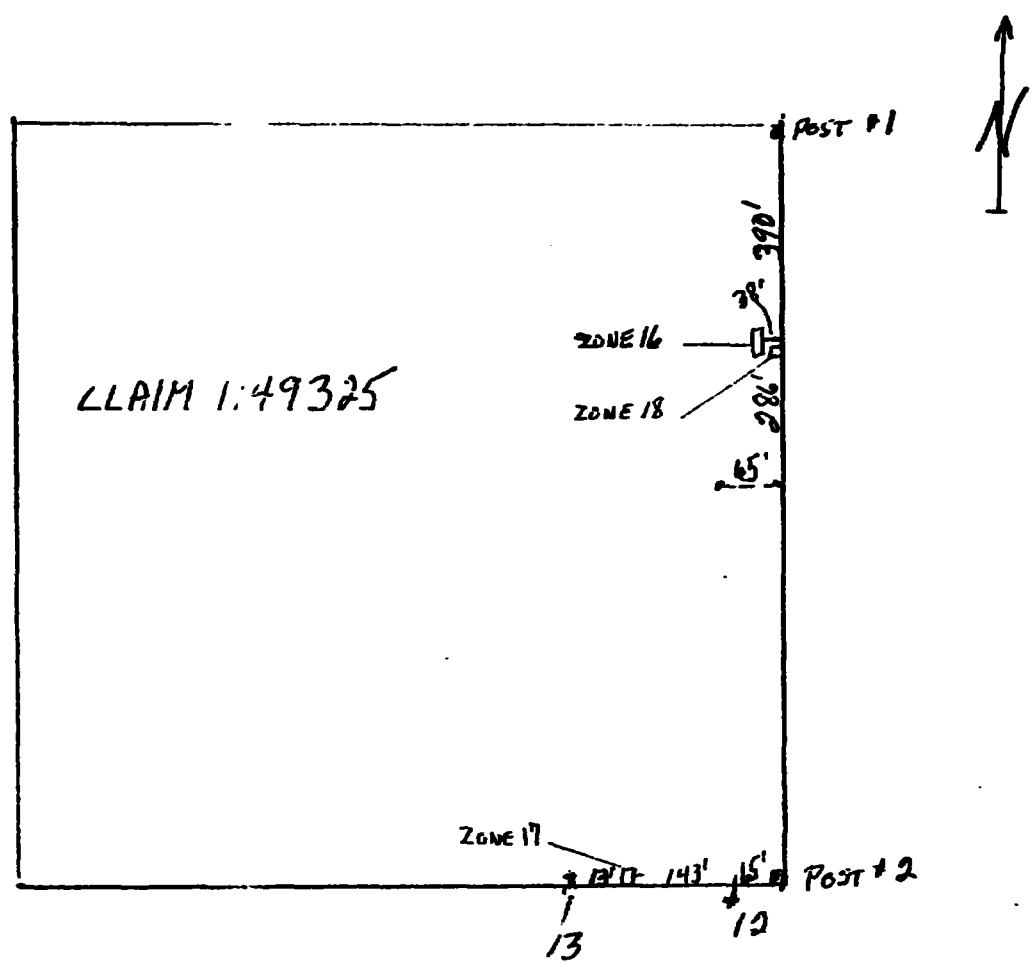

## SKETCH OF STRIPPING AND TRENCHING

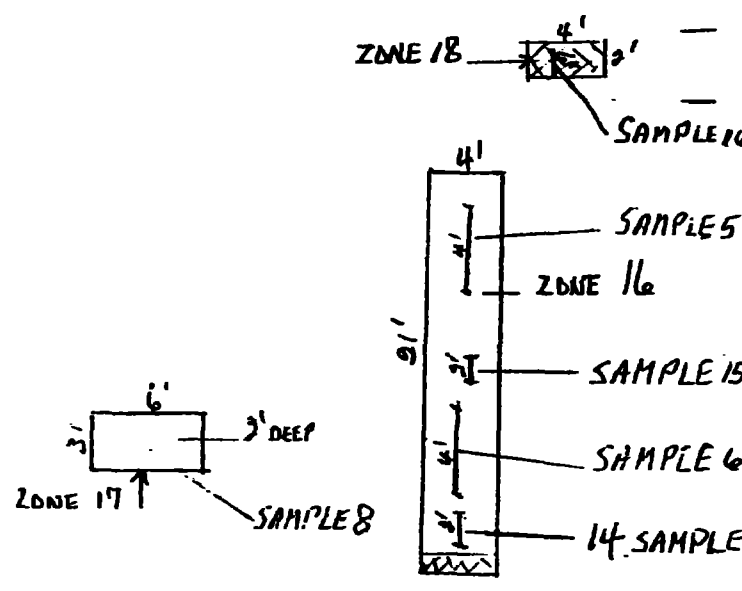

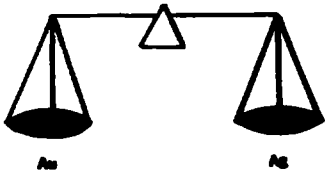

**PAUL'S CUSTOM FIRE ASSAYING LTD.**

Phone: Bus. (807) 662-8171

Res. (807) 662-3361

Fax: (807) 662-1155

**PAUL OKANSKI, Assayer**  
Box 253, Cochenour, Ontario P0V 1L0

L. 11111

**ASSAY CERTIFICATE**

Date: Jan. 7, 1992.

Sample No.	Description	oz/ton Au	oz/ton Ag
1 #1	DEC 27 Claim 1149382	Trace	
2 #2	" 28 " 1149325	"	
3 #3	" 29 " "	"	
4 #4	" 29 " "	"	
5 #5	JAN. 4 ZONE 16	"	
6 8	" 5 " 16	"	
7 9		"	
8 10		"	
9			
10			
11			
12			
13			
14			
15			
16			
17			
18			
19			
20			
21			
22			
23			
24			
25			

Assayer: J. Okanski

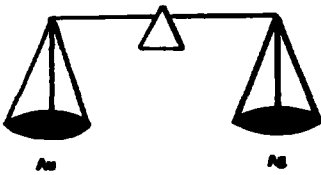

# PAUL'S CUSTOM FIRE ASSAYING LTD.

Phone: Bus. (807) 662-8171

Res. (807) 662-3361

Fax: (807) 662-1155

PAUL OKANSKI, Assayer  
Box 253, Cochenour, Ontario P0V 1L0

## ASSAY CERTIFICATE

Date: Jan. 13, 1992.

L. Cousineau

Sample No.	Description	oz/ton Au	oz/ton Ag
1	#1 JAN. 11 ZONE 22 BENNETT TWP	.48	
2	12 JAN 8 ZONE 17 area LITTLE TURTLE	Trace	
3	13 JAN 8 ZONE 17 area " "	"	
4	14 JAN 8 ZONE 14 " "	"	
5	15 JAN 8 ZONE 16 " "	"	
6	16 JAN 8 ZONE 18 " "	"	
7			
8			
9			
10			
11			
12			
13			
14			
15			
16			
17			
18			
19			
20			
21			
22			
23			
24			
25			

Assayer: *J. Okanski*

# PROSPECTING DAILY LOG



52C16SW0010 OP91-353 HALKIRK

030

PROJECT AREA

DATE

PORTER INLET

NOV. 19/91

PROSPECTED WEST OF CLAIM  
L76384 NORTH OF TRAIL  
BETWEEN CLIFF AND HYDRO LINE

1 - SAMPLE

NOV 20

CONTINUED PROSPECTING  
WEST OF ABOVE. FOUND  
SOME NARROW QUARTZ VEINS

1 - SAMPLE

NOV. 24

PROSPECTED NORTH OF CLAIM  
ON FORMER CLAIMS 1104732  
1050331 - NO SULPHIDES

NO SAMPLES TAKEN.

PINK QUARTZ -

## LOCATION OF PROSPECTING

- AREA OUTLINED ON PREVIOUS SUBMITTED CLAIM MAP
- DETAIL SKETCH ATTACHED

## DESCRIPTION OF SAMPLES

<u>SAMPLE No.</u>	<u>TYPE</u>	<u>ROCK TYPE</u>	<u>MINERALIZATION</u>	<u>ASS</u>
1	GRAB	TUFF-QUARTZ	MINOR SULPHIDE	TR-A
2	GRAB	TUFF-QUARTZ	MINOR SULPHIDE	TR-1

DECIDED TO CONCENTRATE ON OTHER ZONES

WHERE RESULTS WERE MUCH MORE ENCOURAGING

ACCESS PORTER INLET

--- ACCESS

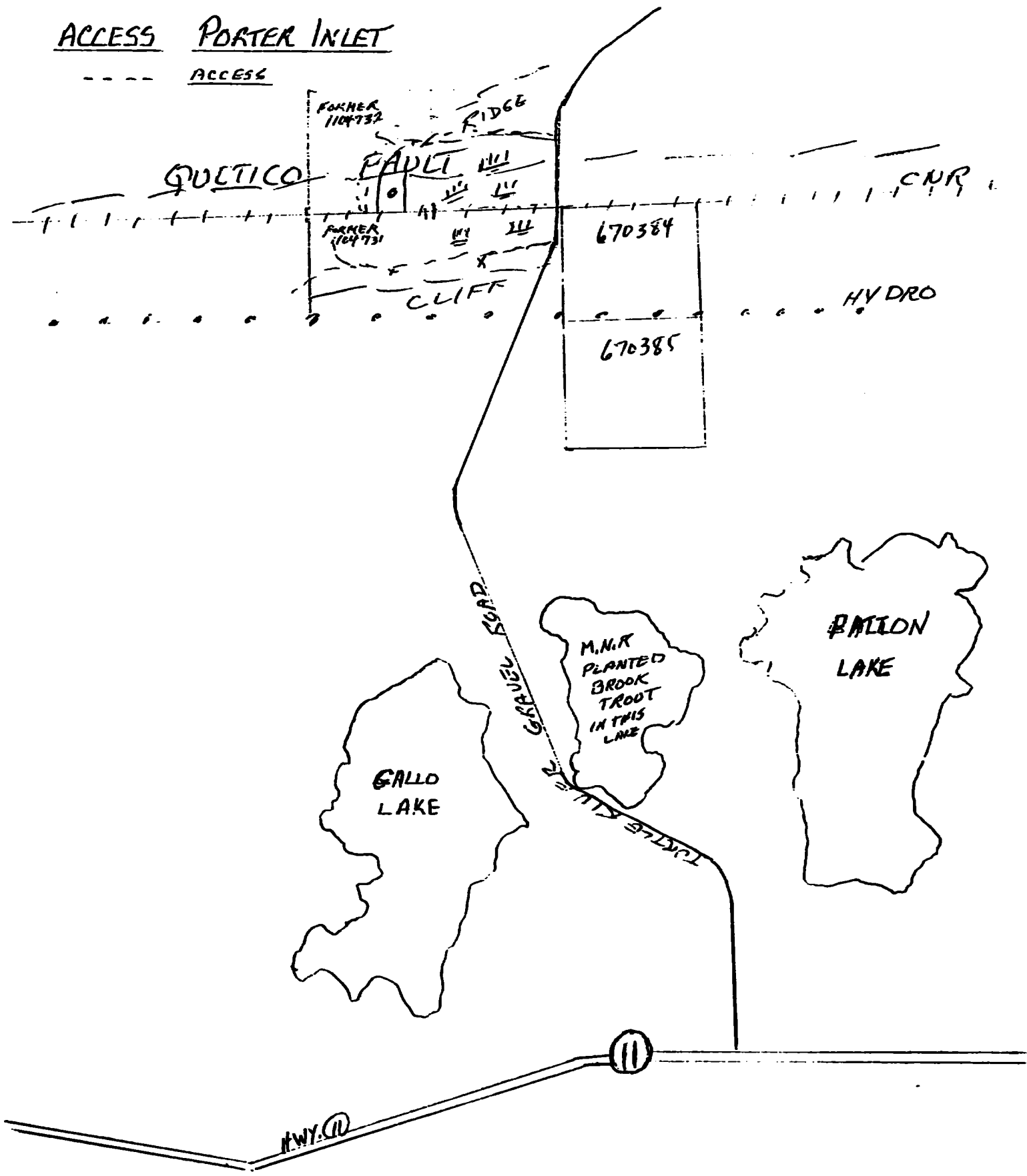

PORTER INLET-2459 RAINY RIVER DISTRICT

LOCATION OF PROSPECTING

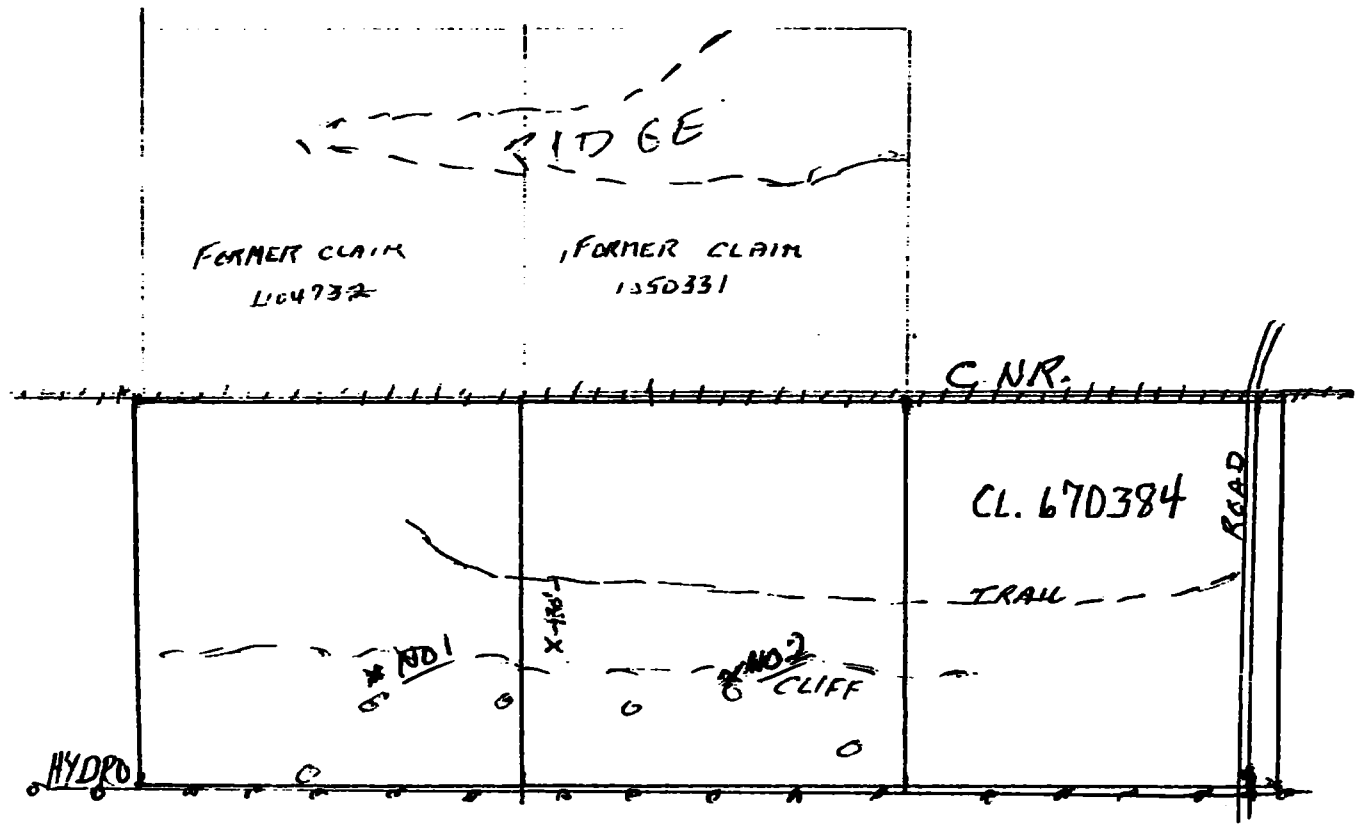

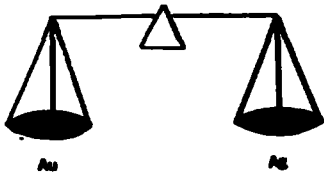

# PAUL'S CUSTOM FIRE ASSAYING LTD.

Phone: Bus. (807) 662-8171

Res. (807) 662-3361

Fax: (807) 662-1155

PAUL OKANSKI, Assayer  
Box 253, Cochenour, Ontario P0V 1L0

L. 11111

## ASSAY CERTIFICATE

Date: Jan. 7, 1992.

Sample No.	Description	oz/ton Au	oz/ton Ag
1	11	Trace	
2	2	"	
3	3	"	
4	4	"	
5	5	"	
6	8	"	
7	9 NOV-17 PORTER INLET	"	
8	10 NOV-24 PORTER INLET	"	
9			
10			
11			
12			
13			
14			
15			
16			
17			
18			
19			
20			
21			
22			
23			
24			
25			

Assayer: *J. Okanski*

# PROSPECTING DAILY LOG



52C16SW0010 CP91-353 HALKIRK

040

PROJECT AREA

DATE

HALKIRK TWP

OCT. 23 / 91

PROSPECT AREA ALONG EAST.  
CLAIM LINE CLAIM 1149457  
1- SAMPLE TAKEN

OCT. 27

PROSPECT EAST CLAIM LINE  
CLAIM 1149456 2 SAMPLES TAKEN

OCT. 30

PROSPECT WEST SHORE LINE  
TUNNELL BAY 1 SAMPLE TAKEN

OCT. 31

PROSPECT SOUTH OF CLAIM 1149457

## LOCATION OF PROSPECTING

- AREA OUT LINED ON PREVIOUS SUBMITTED CLAIM MAP
- DETAIL SKETCH ATTACHED

## DESCRIPTION OF SAMPLES

<u>SAMPLE NO.</u>	<u>TYPE</u>	<u>ROCK TYPE</u>	<u>MINERALIZATION</u>	<u>ASSAY</u>
1	GRAB	QUARTZ SCHIST	MINOR SULPHIDE	20 P.P.B. AU
2	GRAB	QUARTZ CHIST	MINOR SULPHIDE	562 P.P.B. AU
3	GRAB	GABBRO	MINOR SULPHIDE	34 P.P.B. AU
4	GRAB	GABBRO	MINOR SULPHIDE	61 P.P.B. AU



HALKIRK TWP

ACCESS ———

TRAIL - - - - -

TUNNEL BAY

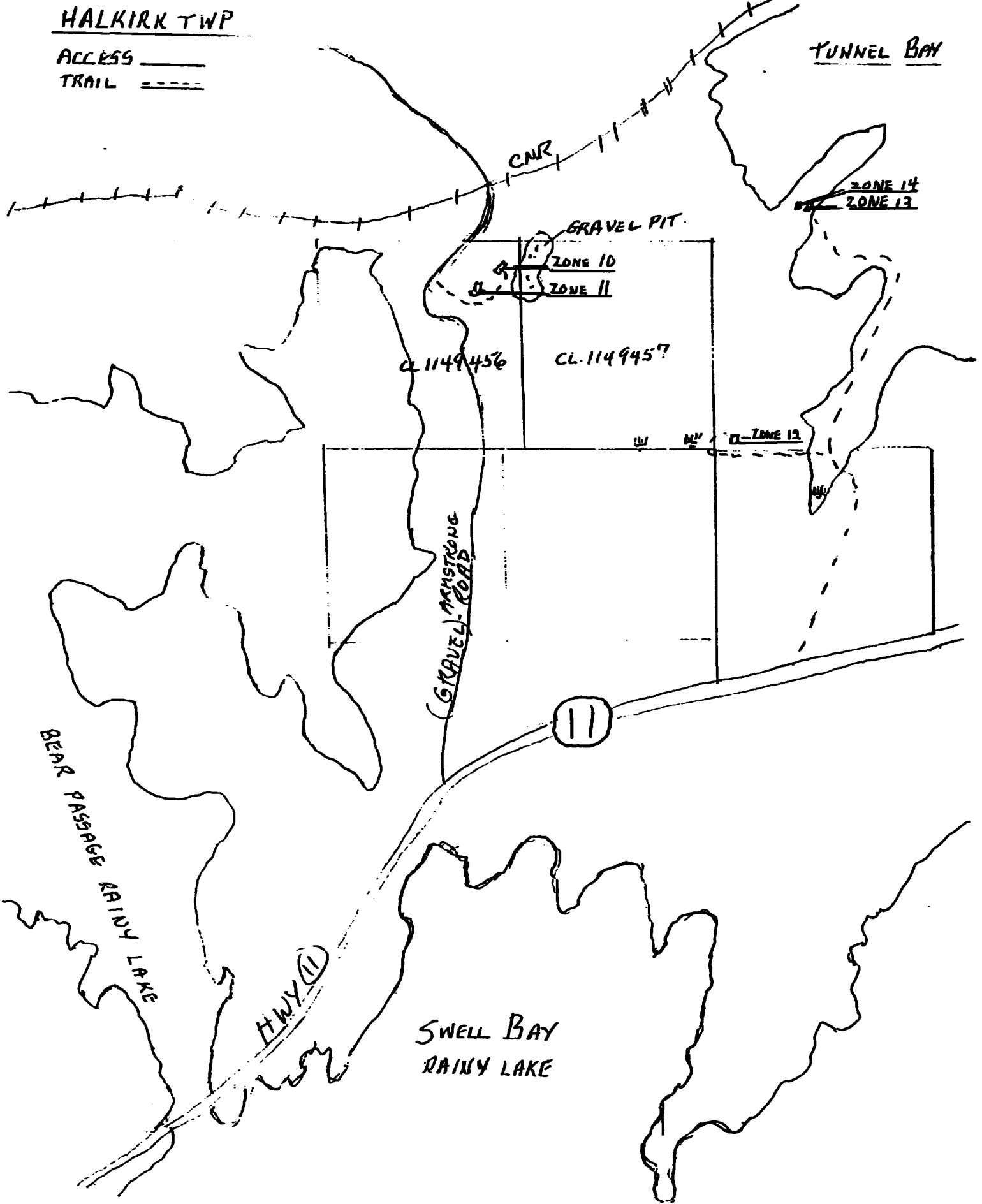

#ALKIRK TWP. RAINY RIVER DISTRICT  
TUNNEL BAY PROJECT  
LOCATION OF PROSPECTING

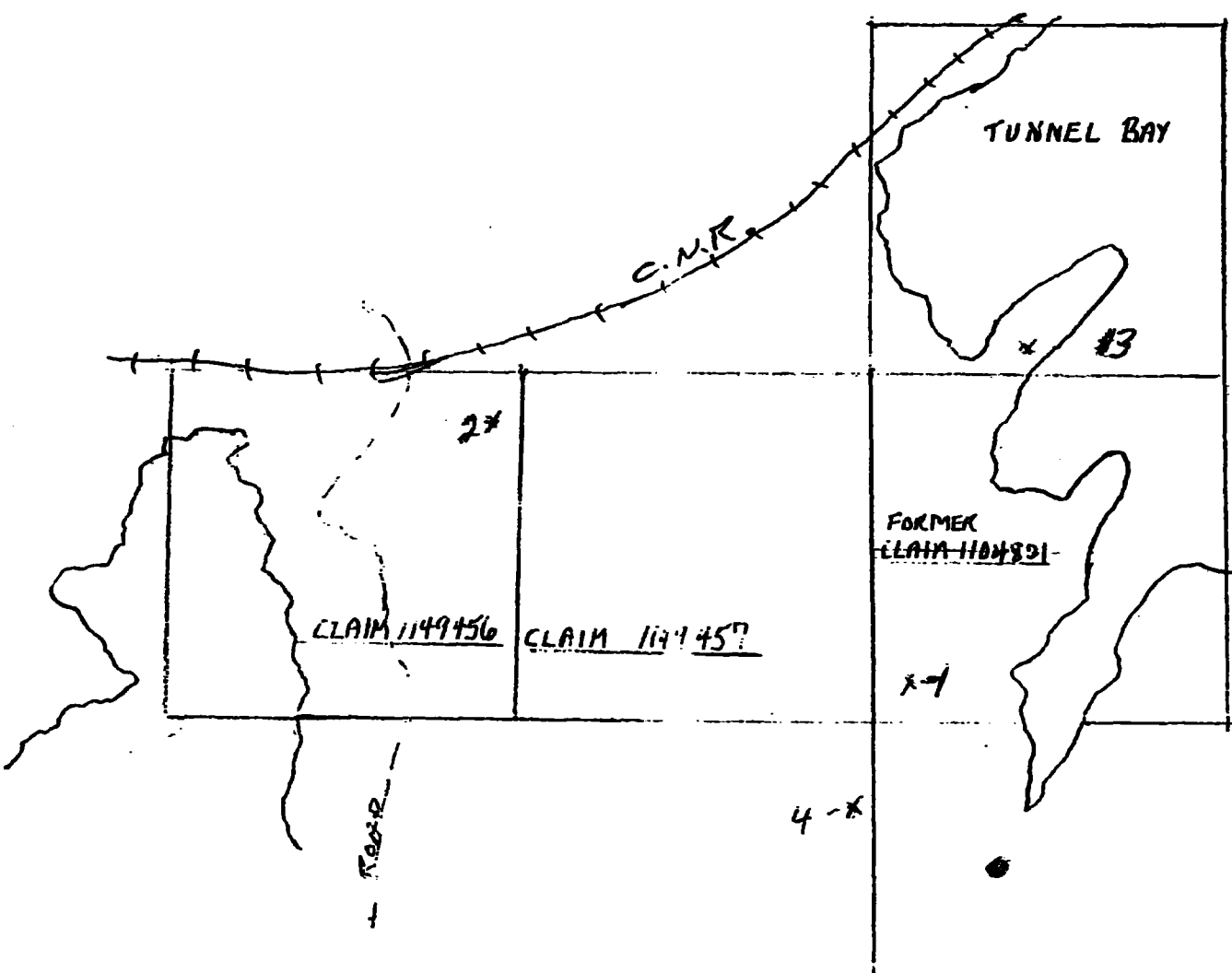

# STRIPPING AND TRENCHING DAILY LOG

<u>PROJECT AREA</u>	<u>DATE</u>	<u>WORK PERFORMED</u>
HALKIRK TWP	DEC 1 /91	STRIP ZONE 13 TUNNELL BAY NORTH OF FORMER CLAIM 1104201
	DEC 2	DRILL - 4 HOLES - BLAST ZONE 13
	DEC 3	TRENCH - SAMPLE - ZONE 13
	DEC 4	STRIP ZONE 14
	DEC 15	FLOW ROAD TO ZONE 10 - STRIP PIT - BACKHOE 6 HOURS
	DEC 11:	TRENCH - CLEAN - ASSAY ZONE 10 ENCOURAGING SULPHIDES
	DEC 20	STRIP - CLEAR - DIG (ZONE 11) 6 HOURS BACKHOE
	DEC 31	DRILL 6 - HOLES - BLAST + 2 HOLES
	DEC 30	TRENCH - CLEAN - ASSAY (ZONE 11)

## LOCATION OF STRIPPING AND TRENCHING

- SKETCH ATTACHED

## SKETCH OF TRENCHING AND SAMPLING

SKETCH ATTACHED

## DESCRIPTION OF SAMPLES

<u>SAMPLE NO</u>	<u>TYPE</u>	<u>ROCK TYPE</u>	<u>MINERALIZATION</u>	<u>ASSAY</u>
5	CHIP (1')	QTZ, PORPHYRY SCHIST	NICE SULPHIDES	TR - AU
6	CHIP (1')	BIOTITE QTZ SCHIST	NICE SULPHIDES	TR - AU
7	CHIP (1')	BIOTITE QTZ SCHIST	NICE SULPHIDES	TR - AU
8	CHIP (2')	BIOTITE QTZ SCHIST	NICE SULPHIDES	TR - AU
9	CHIP (2')	BIOTITE QTZ SCHIST	NICE SULPHIDES	TR - AU

LOCATION STRIPPING AND TRENCHING

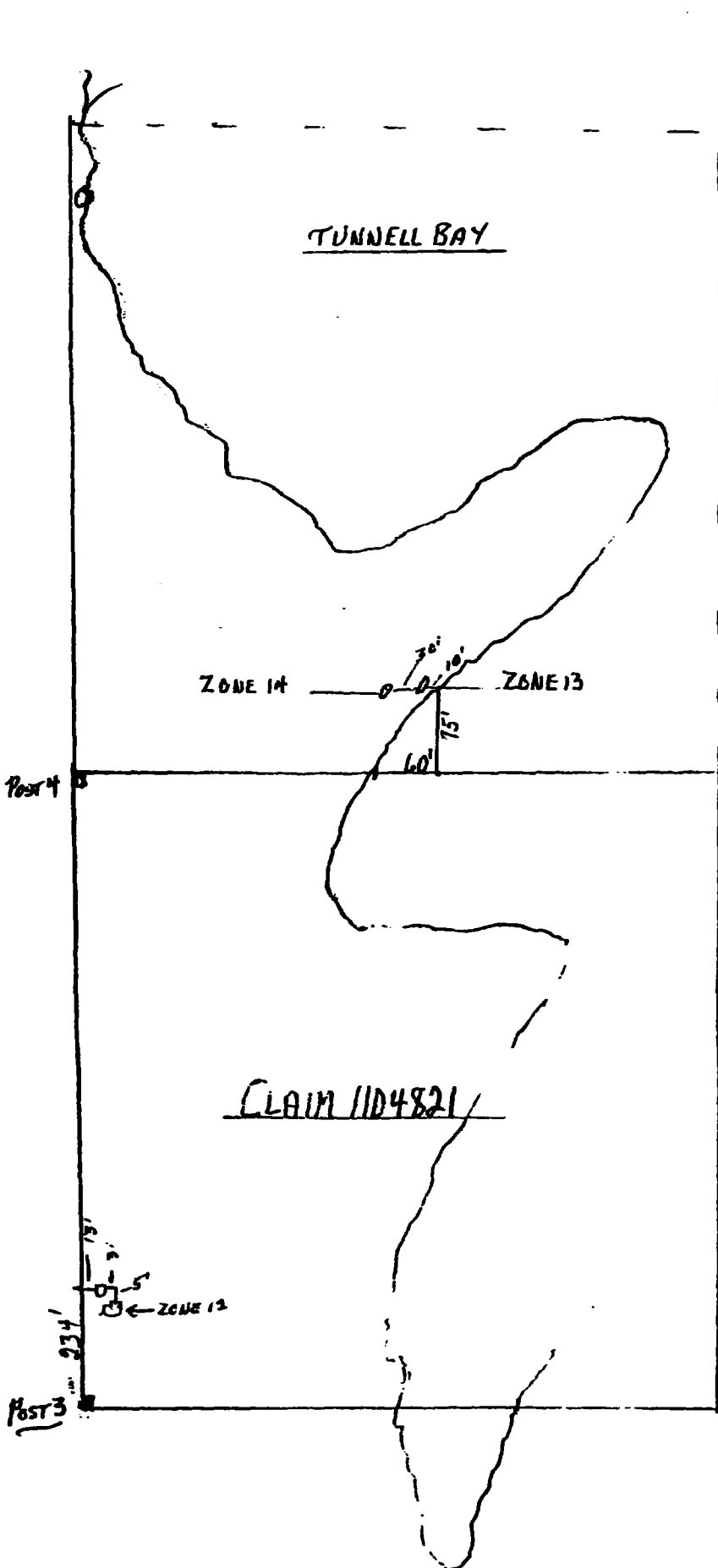

SKETCH

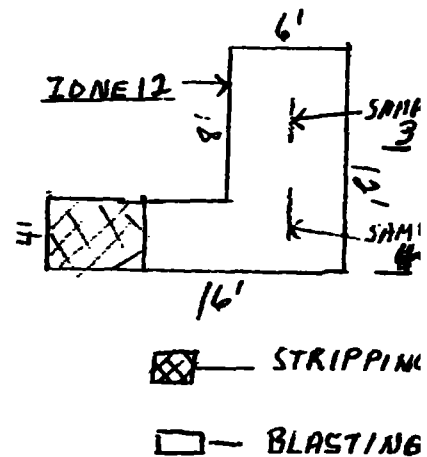
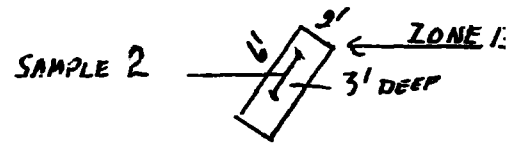
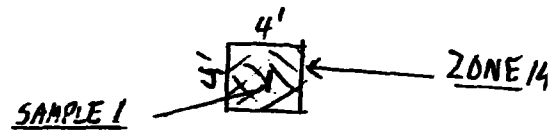

HALKIRK TWP.

RAINY RIVER DISTRICT,

STRIPPING AND TRENCHING

LOCATION

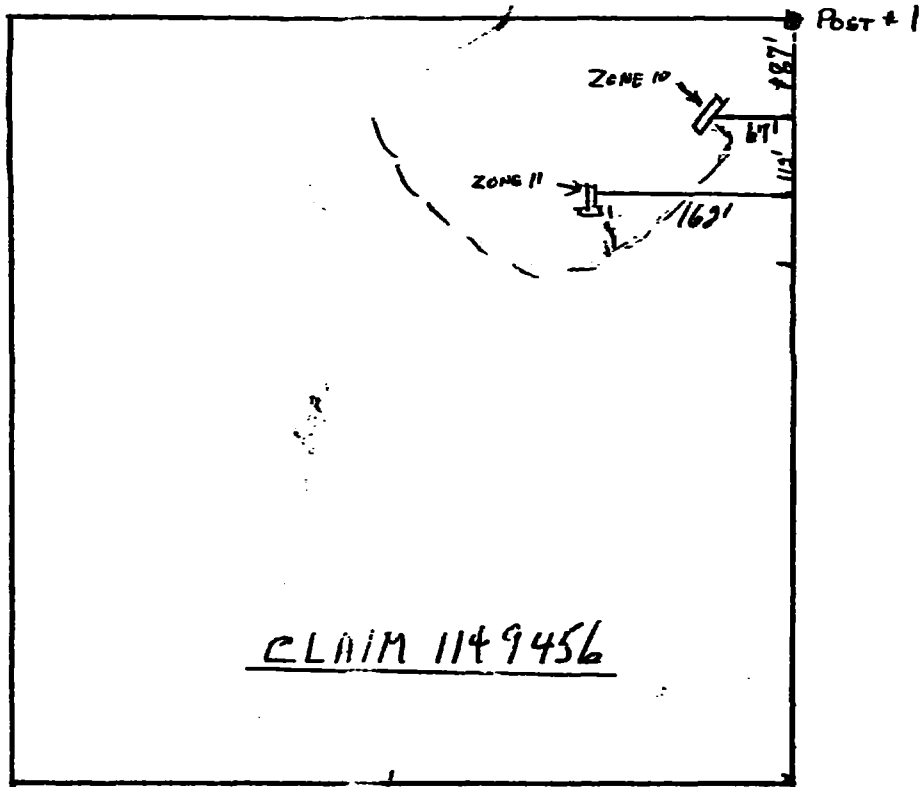

SKETCH

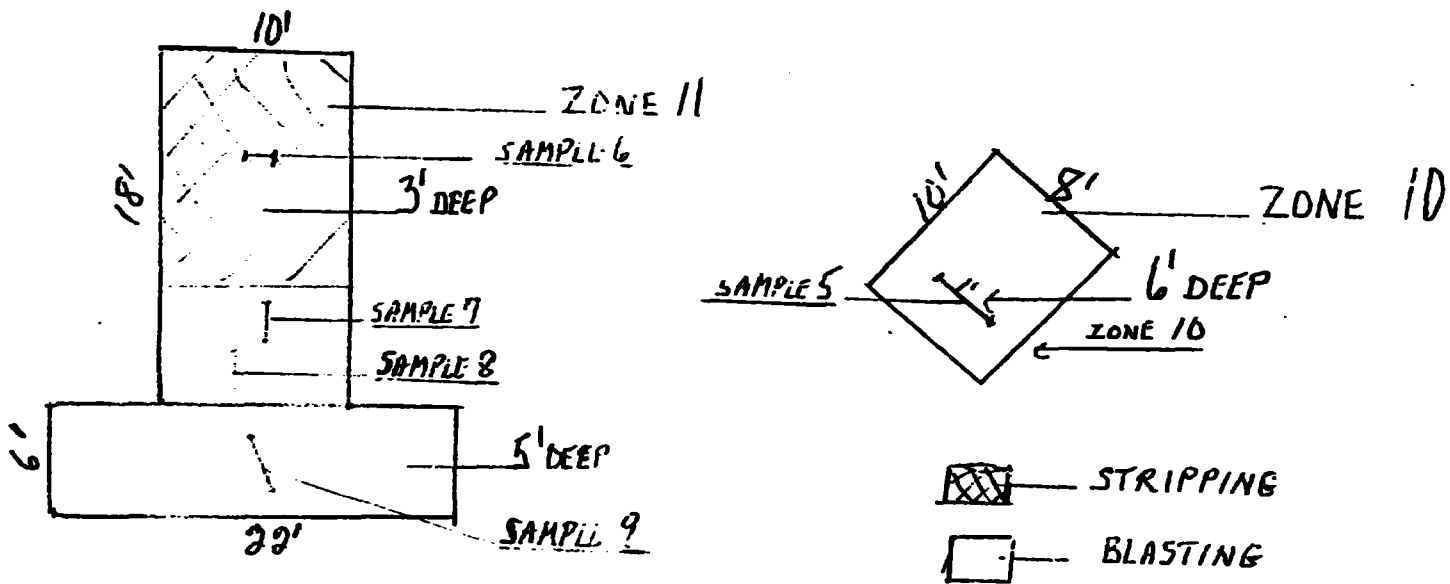

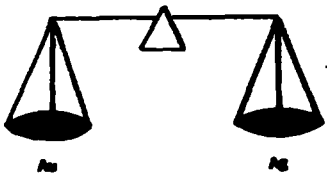

**PAUL'S CUSTOM FIRE ASSAYING LTD.**

Phone: Bus. (807) 662-8171

Res. (807) 662-3361

Fax: (807) 662-1155

**PAUL OKANSKI, Assayer**  
**Box 253, Cochenour, Ontario P0V 1L0**

L. Cousineau

**ASSAY CERTIFICATE**

Date: Dec. 27-91

Sample No.	Description	oz/ton Au	oz/ton Ag
1	#1 Oct 23 ZONE 10	Trace	
2	2 " 27 " 10	"	
3	3 " 30 " 13	"	
4	4 " 31 " 12	"	
5	5 Dec 16 " 10	"	
6	6 " 22 " 11	"	
7	7 " 22 " 11	"	
8	8 " 22 " 11	"	
9	9 " 22 " 11	"	
10			
11			
12			
13			
14			
15			
16			
17			
18			
19			
20			
21			
22			
23			
24			
25			

Assayer: *Paul Okanski*

Sample description	SR	TA	TH	U	V	ZN	LA	CE	ND	SM	EU	TB	YB	LV	Mass
	μ	PPM	PPM	PPM	PPM	PPM	PPM	PPM	PPM	PPM	PPM	PPM	PPM	PPM	g
1	<0.05	2	7.3	2.7	<4	<50	40	93	36	7.8	1.3	1.4	5.89	1.03	37.76
2	<0.05	<1	7.3	1.1	<4	119	38	85	36	7.3	1.0	1.2	6.22	1.11	38.61
3	<0.05	<1	6.9	2.2	<4	2740	41	100	46	8.2	1.5	1.7	6.77	1.16	32.86
4	<0.05	3	7.9	2.1	<4	2150	40	98	39	7.9	1.1	1.6	6.48	1.14	32.04
5 <i>Oct 31 ZONE 12</i>	<0.05	<1	4.7	1.3	<4	<50	27	63	29	4.7	0.7	0.7	4.32	0.76	26.48 <i>SAMPLE #4</i>
6	<0.05	<1	1.1	<0.5	<4	127	21	57	22	4.7	1.6	<0.5	2.08	0.40	29.54
7 <i>OCT 13 ZONE 14</i>	<0.05	<1	7.9	3.0	7	<50	31	67	26	3.7	1.3	<0.5	1.51	0.27	30.25 <i>SAMPLE #1</i>
8	<0.05	2	13	4.3	<4	156	91	230	100	20	4.1	3.6	18.6	3.27	26.50
9	<0.05	1	6.9	1.9	<4	<50	37	85	34	7.2	0.8	1.3	7.02	1.17	31.23
10 <i>" 30 "</i>	13 <i>&lt;0.05</i>	2	8.3	2.9	<4	355	46	130	57	11	2.1	2.1	11.3	2.00	20.89 <i>" 3</i>
11 <i>OCT 17 ZONE 10</i>	<0.05	<1	0.7	<0.5	<4	<50	2	<3	<5	0.3	<0.2	<0.5	0.27	<0.05	41.92 <i>SAMPLE #2</i>

Activation Laboratories Ltd. Work Order: 3389 Report: 3429

Nov 7, 91

Sample description	AU PPM	AG PPM	AS PPM	BA PPM	BR PPM	CA PPM	CO PPM	CR PPM	CS PPM	FE PPM	HF PPM	H6 PPM	IR PPM	MO PPM	NA PPM	NI PPM	RB PPM	SB PPM	SC PPM	SE PPM	SN PPM
1	27	<5	3	830	<1	<1	<5	78	<2	1.84	7	<1	<5	<5	17100	76	54	0.3	2.4	<5	<0.01
2	9	<5	3	1500	<1	<1	<5	130	<2	1.18	7	<1	<5	<5	10200	<50	44	0.5	2.0	<5	<0.01
3	20	5	11	760	<1	<1	<5	73	<2	1.45	7	<1	<5	<5	4730	<50	50	3.0	3.0	<5	<0.01
4	<5	7	3	650	<1	<1	<5	91	<2	1.24	8	<1	<5	<5	10500	<50	58	2.2	2.7	<5	<0.01
5	12	<5	12	140	<1	<1	<5	160	<2	4.18	4	<1	<5	7	14300	<50	42	1.1	1.7	<5	<0.01 SAMPLE 4
6	7	<5	<2	270	<1	3	36	340	<2	6.62	2	<1	<5	<5	16900	<50	82	0.5	27	<5	<0.01
7	20	<5	3	1300	10	<1	28	170	<2	4.51	3	<1	<5	<5	16700	<50	180	<0.2	15	<5	<0.01 SAMPLE #1
8	<5	<5	14	860	<1	<1	6	75	<2	3.60	16	<1	<5	<5	14000	<50	100	0.5	5.5	<5	<0.01
9	<5	<5	8	950	<1	<1	<5	89	<2	1.77	6	<1	<5	<5	17200	<50	38	0.3	2.7	<5	<0.01
10	34	<5	13	990	<1	<1	6	220	<2	4.58	10	<1	<5	<5	1420	<50	140	0.2	9.1	<5	<0.01 SAMPLE #3
11	562	<5	5	<100	<1	<1	25	160	<2	5.06	<1	<1	<5	<5	5110	340	<30	<0.2	0.7	<5	<0.01 SAMPLE #2



Activation Laboratories Ltd. Work Order: 3589 Report: 3581

Sample description	AU	AG	AS	BA	BR	CA	CO	CR	CS	EE	HF	HR	IR	MO	NA	NI	BB	SB	SC	SE	SM	
	PPM	PPM	PPM	PPM	PPM	%	PPM	PPM	PPM	%	PPM	PPM	PPB	PPM	PPM	PPM	PPM	PPM	PPM	PPM	PPM	%
1 OCTAZONE 10	7	<5	<2	220	<1	4	11	21	<2	2.95	3	<1	<5	<5	63900	<50	30	<0.2	2.3	<5	<0.02	
2 " 27 "	<5	<5	<2	430	3	<1	10	33	<2	2.09	3	<1	<5	7	61000	<50	54	<0.2	3.1	<5	<0.01	
3 " 30 "	8	<5	<2	830	4	<1	13	28	<2	2.70	4	<1	<5	<5	66500	<50	81	<0.2	3.6	<5	<0.02	
4 " 31 "	<5	<5	<2	530	5	<1	12	74	<2	2.71	5	<1	<5	33	51900	<50	47	<0.2	10	<5	<0.02	
5 DEC 1/4 zone 10	510	49	<2	<100	<1	<1	7	14	<2	3.76	<1	<1	<5	<5	977	160	30	<0.2	0.4	8	<0.01	
6 " 22 "	5	<5	5	440	<1	3	48	17	<2	5.02	4	<1	<5	<5	60900	<50	30	<0.2	2.8	<5	<0.01	
7 " 21 "	9	<5	<2	440	<1	<1	29	30	3	4.95	6	<1	<4	140	6900	<57	30	<0.2	21	<5	<0.03	
8 " 19 "	252	<5	5	<100	<1	2	45	11	<2	16.8	13	<1	<5	5	3980	<50	30	0.3	20	<5	<0.01	

Sample description	SR	TA	TH	U	V	ZN	LA	CE	MO	SM	EU	TB	YB	LU	Mass
	%	PPM	PPM	PPM	PPM	PPM	PPM	PPM	PPM	PPM	PPM	PPM	PPM	PPM	g
1 OCT. 23 zone 70	0.05	<1	1.0	1.4	<4	<50	3	7	<5	0.6	0.4	<0.5	0.47	<0.05	26.16
2 " 27 "	10	<1	2.8	<0.5	<4	<50	9	19	11	1.3	0.6	<0.5	0.29	<0.05	27.30
3 " 30 "	13	<1	3.9	<0.5	<4	<50	10	18	<5	1.3	0.5	<0.5	0.99	<0.05	27.12
4 " 31 "	12	<1	8.3	2.8	6	<50	24	46	16	2.9	0.9	1.5	1.22	0.12	29.04
5 DEC. 14 zone 6	0.05	<1	<0.5	<0.5	9	<50	<1	<3	<5	0.1	<0.2	<0.5	<0.05	<0.05	30.05
6 " 22 "	11	<1	1.1	<0.5	<4	<50	3	6	<5	0.8	0.5	<0.5	0.65	<0.05	28.61
7 " 22 "	11	<1	15	3.4	<4	137	58	94	26	5.9	2.0	<0.5	2.14	0.30	29.87
8 " 22 "	11	<1	5.4	<0.5	<4	274	26	63	23	8.5	2.3	2.3	15.6	2.40	30.32

# PROSPECTING DAILY LOG

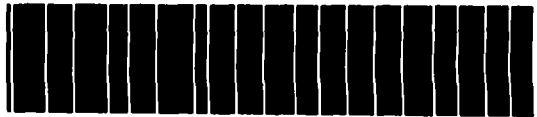

52C16SW0010 OP91-353 HALKRRK

050

PROJECT AREA

DATE

BENNETT LAKE

MAY 05 /91

PROSPECTED SOUTH LINE CLAIM

ZONE - 10-21

1149461 - 1-SAMPLE

MAY 06 /91

PROSPECTED NORTH AND EAST  
LINES CLAIM 1149460 1-SAMPLE

ZONE

MAY 07 /91

PROSPECTED CENTER AREA

20, 21, 22, 23

OF CLAIM 1149459 FOUND OLD  
GOLD PIT 2-SAMPLE

MAY 08 /91

PROSPECTED HYDRD LINE SOUTH

OF CLAIM 1149458 - 1 SAMPLE

JAN. 9 /92 - BY SNOWSHOEING FOUND SUITABLE ROUTE TO ZONE 31 VIA RESER

LOCATION OF PROSPECTING - JAN 10 /92 SNOWSHOE AND CUT OUT ROUTE TO ZONE 31  
NOW ABLE TO USE SNOW MACHINE & BRING IN PLOGGER

- AREA OUTLINED ON PREVIOUSLY SUBMITTED CLAIM MAP
- DETAILED SKETCH ATTACHED

## DESCRIPTION OF SAMPLES

<u>SAMPLE NO</u>	<u>TYPE</u>	<u>ROCK TYPE</u>	<u>MINERALIZATION</u>	<u>ASSAY</u>
1	GRAB	GREENSTONE	MINOR SULPHIDE	TR - AU
2	GRAB	GREENSTONE QTL - STRINGERS	MINOR SULPHIDE	TR - AU
3	GRAB	QUARTZ	MINOR SULPHIDE	TR - AU
4	GRAB	SCHIST + QTL STRINGERS	MINOR SULPHIDE	TR - AU
5	GRAB	SCHIST + QTL STRINGERS	MINOR SULPHIDE	TR - AU

ACCESS BENNETT LAKE

--- ACCESS ROUTE

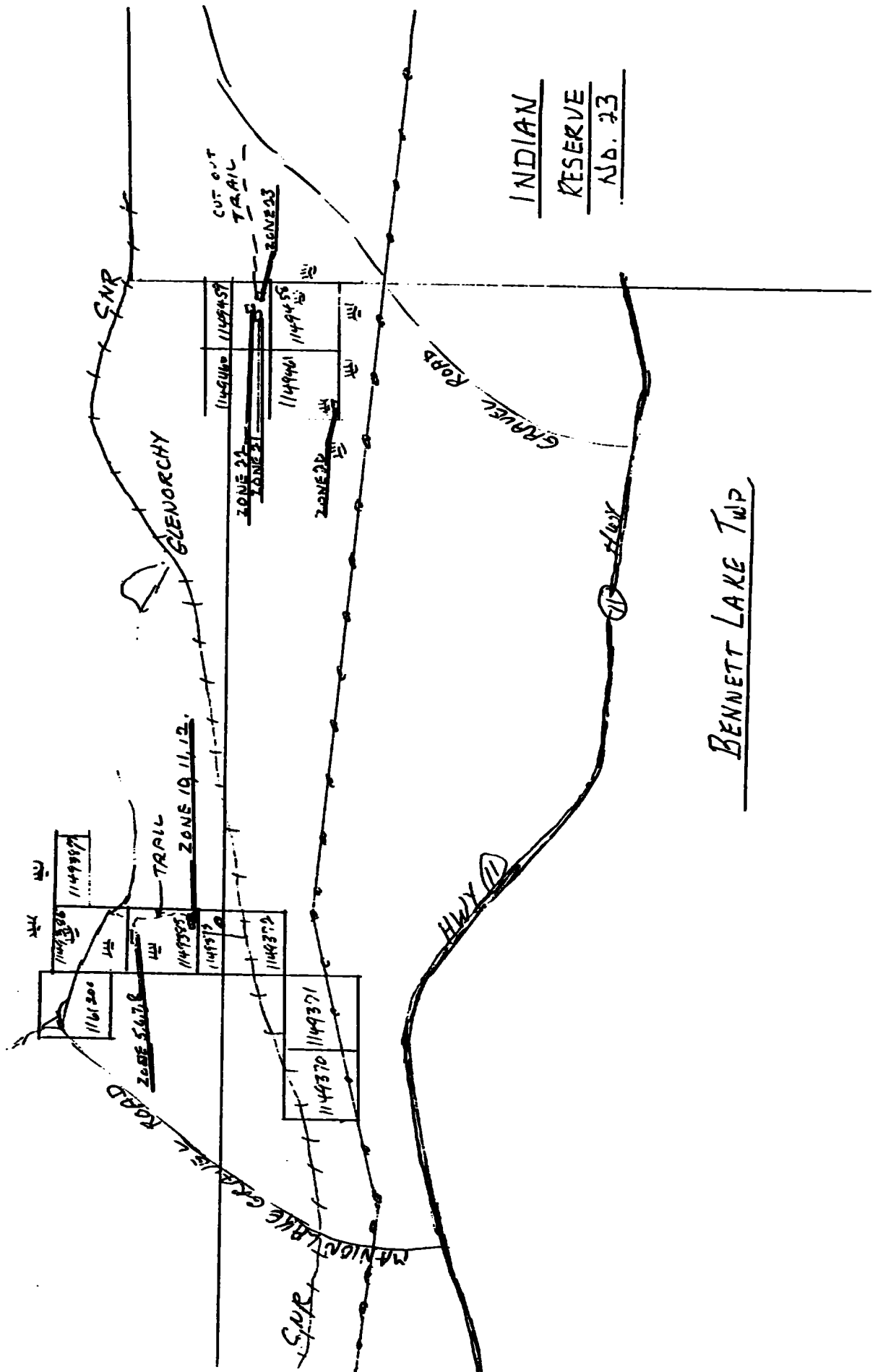

INDIAN  
RESERVE  
AD. 73

BENNETT LAKE TWP

# STRIPPING AND TRENCHING DAILY LOG

<u>PROJECT AREA</u>	<u>DATE</u>	<u>WORK PERFORMED</u>
BENNETT LAKE	MAY 19 / 91	STRIPPING ZONE 20 SOUTH LINE CLAIM 1149461
	MAY 20 / 91	STRIPPING ZONE 21 AROUND OLD PIT CENTER AREA CLAIM 1149459
	MAY 21 / 91	SHOWED OLD PIT TO INCO GEOLOGIST. WILL DO MORE WORK IN WINTER WHEN GROUND IS FROZEN FOR BETTER - SNOW ACCESS

## LOCATION OF STRIPPING AND TRENCHING

SKETCH ATTACHED

## SKETCH OF TRENCHING AND SAMPLING

DESCRIPTION OF SAMPLES SKETCH ATTACHED

INCO GEOLOGIST REPORT OF SAMPLING ENCLOSED

JAN 11 / 92	STRIP + TRENCH ZONE 22 CLAIM 1149459 - 1 SAMPLE
JAN 12 / 92	DRILL + BLAST ZONE 22 CLAIM 1149459
JAN 13 / 92	DRILL + BLAST + TRENCH ZONE 22 CLAIM 1149459 (HARD TO DRILL LOTS OF FRACTURED ROCK)
JAN 14 / 92	STRIP + TRENCH NEW ZONE 23 CLAIM 1149459
JAN 15 / 92	DRILL + BLAST - TRENCH - ZONE 23

<u>SAMPLE NO.</u>	<u>TYPE</u>	<u>ROCK TYPE</u>	<u>MINERALIZATION</u>	<u>ASSAY</u>
11	4" CHIP	TUFF & QTZ STRINGERS	MINOR SULPHIDE	.48 AU
21	12" CHIP	TUFF & QTZ STRINGERS	" "	.04 AU
22	6" CHIP	QUARTZ VEIN + TUFF	" "	.86 AU
23	12" CHIP	TUFF & QTZ STRINGERS	" "	TR. AU
28	12" CHIP	TUFF & QTZ. STRINGERS	" "	TR. AU

BENNETT LAKE RAINY RIVER DISTRICT

LOCATION OF PROSPECTING

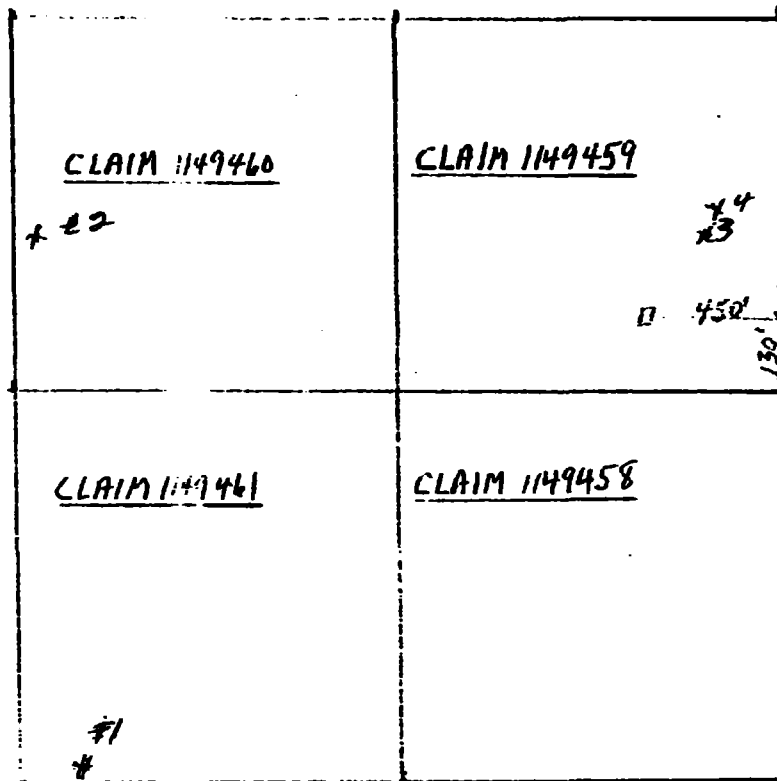

INDIAN  
RESERVE  
NO 23

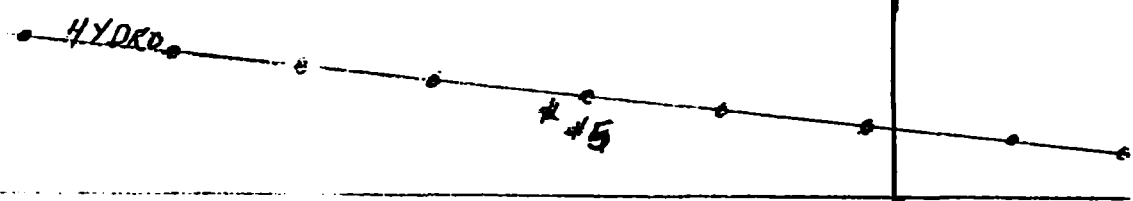

WILD POTATOE LAKE AREA

BENNETT LAKE

RAINY RIVER DISTRICT

LOCATION OF STRIPPING AND TRENCHING



CLAIM 1149460

CLAIM 1149459

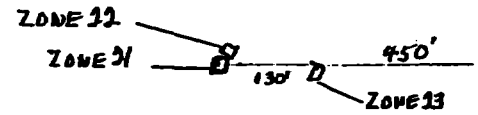

CLAIM 1149461

CLAIM 1149458

ZONE 20



BENNETT LAKE

RAINY RIVER DISTRICT

SKETCH OF STRIPPING AND TRENCHING

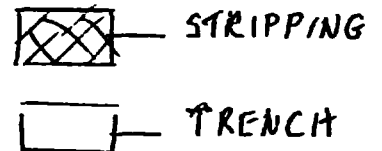
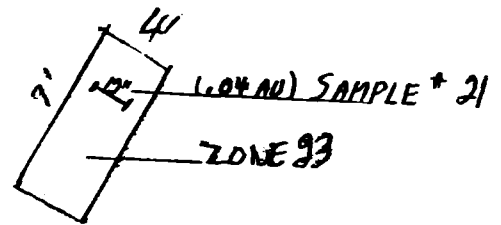
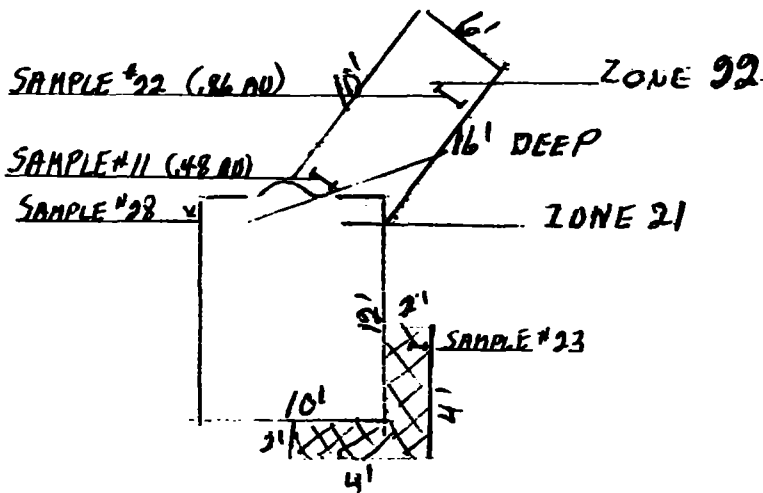
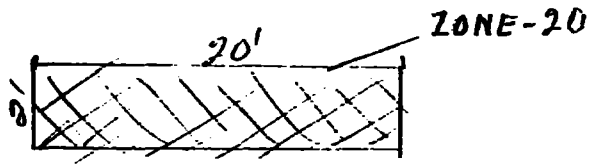



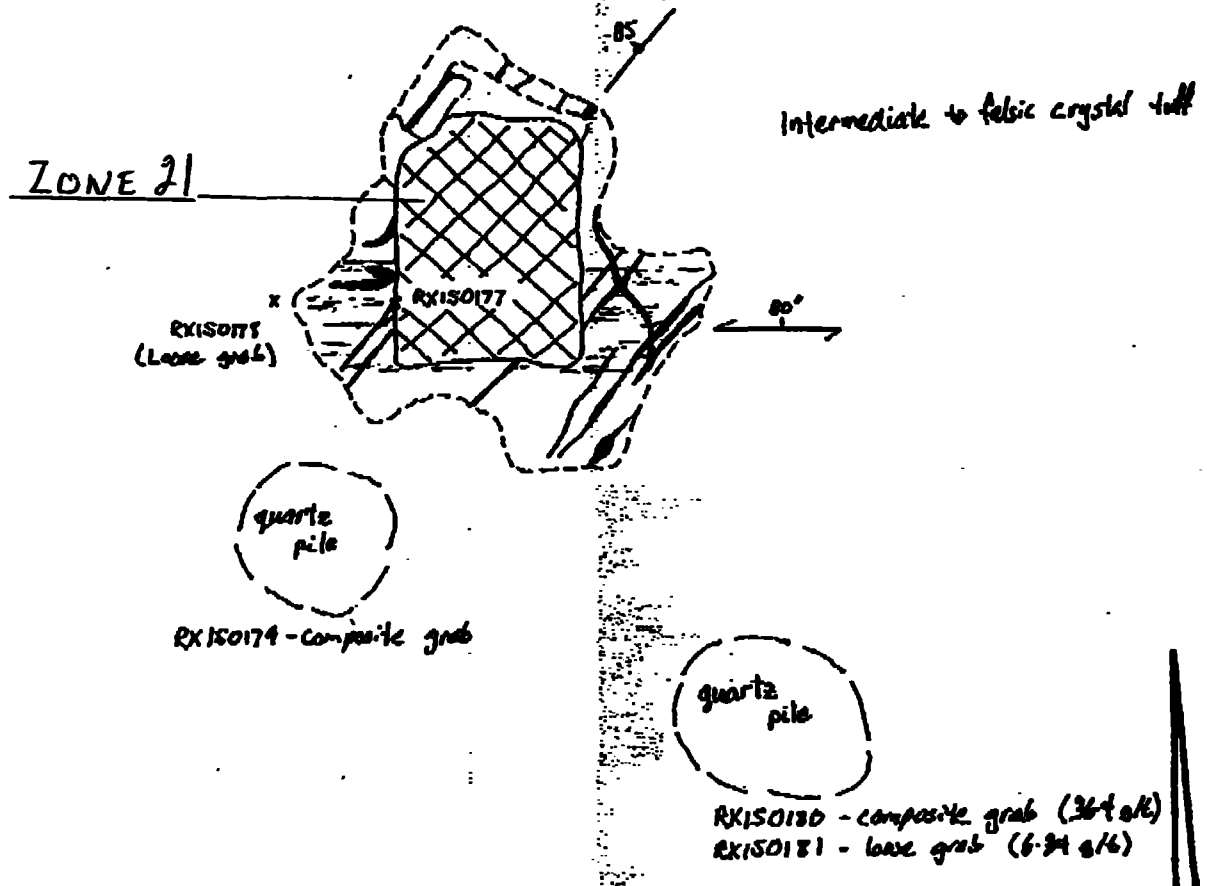



Activation Laboratories Ltd. Work Order: 2748 Report: 2760

Sample description	AU PPM	AG PPM	AS PPM	BA PPM	BR PPM	CA %	CO PPM	CR PPM	CS PPM	FE %	HF PPM	HS PPM	IR PPM	K %	MO PPM	NA PPM	NI PPM	NB PPM	SE PPM	SC PPM	SI PPM
RX 150176	63	<5	22	410	<1	<1	<5	56	<2	2.34	5	<1	<5	3.2	<5	19400	<50	56	1.9	6.4	<5
RX 150177	3570	<5	5	210	<1	<1	<5	170	<2	0.98	1	<1	<5	<0.5	<5	4500	<50	<30	2.4	1.7	<5
RX 150178	1140	<5	4	470	<1	<1	<5	100	<2	2.11	5	<1	<5	2.3	<5	10500	<50	83	2.7	5.3	<5
RX 150179	76	<5	8	290	1	<1	<5	200	<2	1.41	1	<1	<5	<0.5	<5	4520	<50	35	3.0	2.2	<5
RX 150180	32	6	32	270	<1	<1	6	190	<2	2.02	1	<1	<5	<0.5	<5	3520	<50	<30	5.7	1.7	<5
RX 150181	6340	<5	16	350	<1	<1	<5	190	<2	1.52	2	<1	<5	<0.5	<5	4700	<50	<30	2.6	2.1	<5
RX 150182	28	<5	120	<100	<1	<1	35	67	<2	32.2	<1	<1	<5	<0.5	<5	500	130	<30	2.8	0.4	<5
RX 150183	<5	<5	19	340	<1	2	16	150	2	10.4	3	<1	<5	<0.5	<5	12700	<50	<30	3.4	17	<5

Activation Laboratories Ltd. Work Order: 2749 Report: 2760

Sample description	SN %	SR %	TA PPM	TH PPM	U PPM	V PPM	ZN PPM	LA PPM	CE PPM	MO PPM	SI PPM	EU PPM	TB PPM	YB PPM	LU PPM	CU PPM	CU %	Mass g
RX 150176	<0.01	<0.05	<1	7.8	2.5	<4	156	40	81	28	5.1	1.4	<0.5	1.55	0.33	97		30.00
RX 150177	<0.01	<0.05	<1	2.5	<0.5	<4	229	11	24	19	1.4	0.4	<0.5	0.38	0.13	53		30.00
RX 150178	<0.01	<0.05	<1	8.0	2.9	<4	<50	97	82	32	4.5	0.8	<0.5	1.34	0.20	16		30.00
RX 150179	<0.01	<0.05	<1	2.5	<0.5	<4	74	14	27	12	1.7	0.3	<0.5	0.49	0.08	16		30.00
RX 150180	<0.03	<0.05	<1	3.0	<0.7	<4	591	12	26	14	1.4	0.4	<0.5	0.50	<0.05	16		30.00
RX 150181	<0.01	<0.05	<1	3.1	1.6	<4	370	15	35	12	1.8	<0.2	<0.5	0.51	0.10	10		30.00
RX 150182	<0.01	<0.05	<1	<0.5	<0.5	<4	<50	<1	<3	<5	0.1	<0.2	<0.5	0.30	<0.05	16		30.00
RX 150183	<0.01	0.07	<1	4.6	<0.5	<4	98	17	42	17	3.0	0.8	<0.5	1.49	0.29	40		30.00

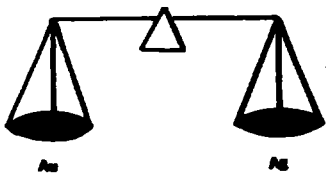

# PAUL'S CUSTOM FIRE ASSAYING LTD.

Phone: Bus. (807) 662-8171

Res. (807) 662-3361

Fax: (807) 662-1155

PAUL OKANSKI, Assayer  
Box 253, Cochenour, Ontario P0V 1L0

No. *1000000000*

## ASSAY CERTIFICATE

Date: May 15-91

Sample No.	Description	oz/ton Au	oz/ton Ag
1 #1	<i>HAY-5 ZONE 20</i>	<i>Trace</i>	
2 2	<i>" 6 CLAIM 1149460</i>	<i>"</i>	
3 3	<i>" 7 " 1149459</i>	<i>"</i>	
4 4	<i>" 7 " 1149459</i>	<i>"</i>	
5 5	<i>" 8 HYDRO LINE</i>	<i>"</i>	
6			
7			
8			
9			
10			
11			
12			
13			
14			
15			
16			
17			
18			
19			
20			
21			
22			
23			
24			
25			

Assayer: *Paul Okanski*

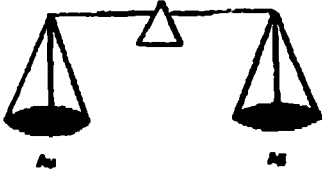

# PAUL'S CUSTOM FIRE ASSAYING LTD.

Phone: Bus. (807) 662-8171  
Res. (807) 662-3361  
Fax: (807) 662-1155

PAUL OKANSKI, Assayer  
Box 253, Cochenour, Ontario POV 1L0

## ASSAY CERTIFICATE

Date: Jan. 17, 1992.

L. Cousineau

Sample No.	Description	oz/ton Au	oz/ton Ag
1	21 JAN. 14 ZONE 23	.04	
2	22 JAN. 13 ZONE 22	.86	
3	23 JAN. 13 ZONE 21	Trace	
4	28 JAN. 13 ZONE 21	"	
5			
6			
7			
8	11 JAN. 11 ZONE 22 (LITTLE TURTLE REPORT) <sup>ASSAY WITH</sup>	.48	
9			
10			
11			
12			
13			
14			
15			
16			
17			
18			
19			
20			
21			
22			
23			
24			
25			

*P. Ok. v.*

# PROSPECTING DAILY LOG



52C18SW0010 OP91-353 HALKIRK

060

PROJECT AREA

DATE

BENNETT LAKE

A- MAY-9

PROSPECTING NORTH LINE  
CLAIM 1149370 NO SAMPLE

ZONE  
5-6-7-8  
+  
D-11-12

B- MAY-10

PROSPECTED SOUTH AND EAST  
LINE CLAIM 1149373 - 1 SAMPLE

MAY-12

PROSPECTED NORTH LINE  
CLAIM 1149373 - 1 SAMPLE

MAY-14

PROSPECTED SOUTH & EAST CLAIM  
LINE CLAIM 1149387 - 1 SAMPLE

MAY-16

PROSPECTED SOUTH LINE CLAIM  
AREA 1149385 - 2-SAMPLES

## LOCATION OF PROSPECTING

- AREA OUTLINED ON PREVIOUSLY SUBMITTED CLAIM MAP
- DETAILED SKETCH ATTACHED

## DESCRIPTION OF SAMPLES

<u>SAMPLE NO</u>	<u>TYPE</u>	<u>ROCKTYPE</u>	<u>MINERALIZATION</u>	<u>ASSAY</u>
1	GRAB	FELSIC TUFF	MINOR SULPHIDES	TR-AU
2	GRAB	QUARTZ VEIN	MINOR SULPHIDES	TR-AU
3	GRAB	GREENSTONE	MINOR SULPHIDES	TR-AU
4	GRAB	FELSIC TUFF	MINOR SULPHIDES	TR-AU
5	GRAB	FELSIC TUFF	MINOR SULPHIDES	TR-AU

BENNETT LAKE RAINY RIVER DISTRICT

A

LOCATION OF PROSPECTING

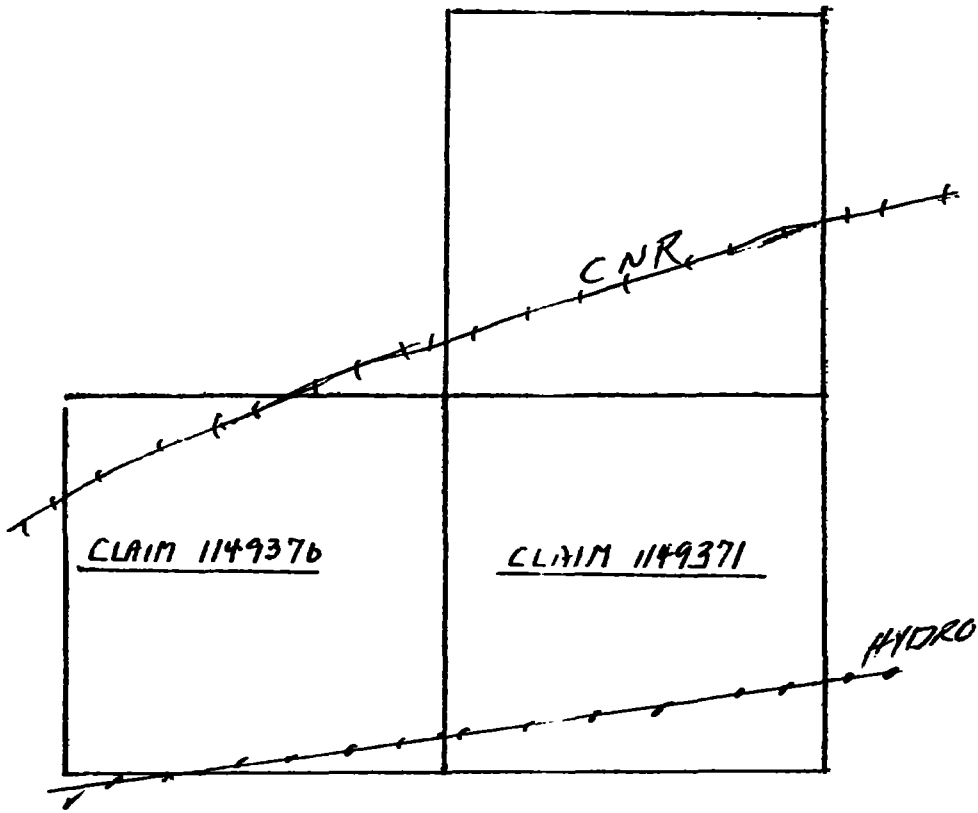

BENNETT LAKE RAINY RIVER DISTRICT

B

LOCATION OF PROSPECTING

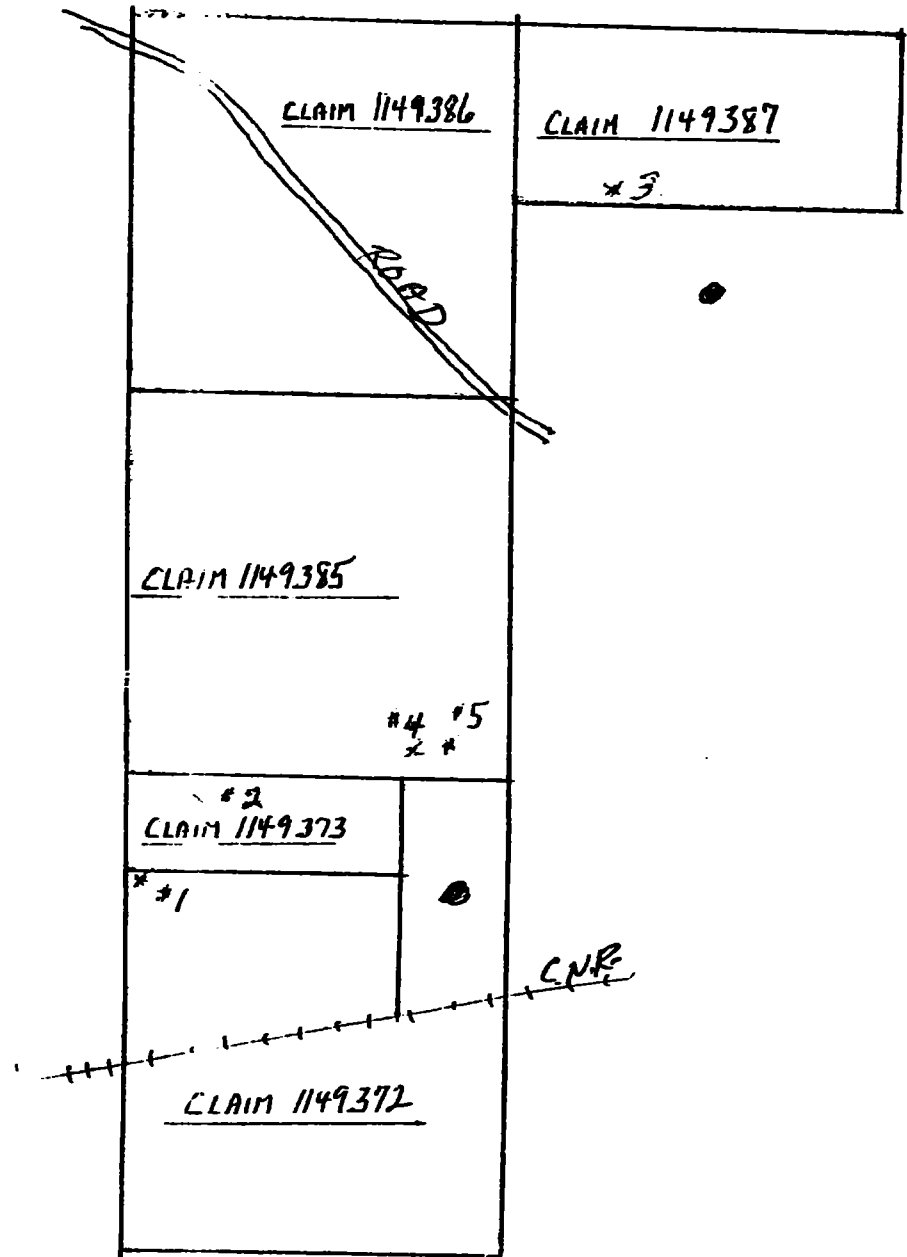



# STRIPPING AND TRENCHING DAILY LOG

<u>PROJECT AREA</u>	<u>DATE</u>	<u>WORK PERFORMED</u>
BENNETT LAKE ZONE 5 & 8	JUNE 2/91	STRIPPING AREA ZONE 5 NORTH LINE CLAIM 1149385
ZONE 5 & 8	JUNE 9	STRIPPING AREA ZONE 6 NORTH LINE CLAIM 1149385
	JUNE 16	STRIPPING AREA ZONE 7 NORTH LINE CLAIM 1149385
	JUNE 22	STRIPPING AREA ZONE 7 NORTH LINE CLAIM 1149385
	JUNE 23	BLAST-DRILL-NORTH 1/2 ZONE 7 NORTH LINE CLAIM 1149385
	JUNE 26	DRILL-BLAST-TRENCH N. 1/2 ZONE 7 NORTH LINE CLAIM 1149385
	JULY 3	STRIP NORTH HALF AREA ZONE 8 NORTH LINE CLAIM 1149385
	JULY 4	STRIP SOUTH HALF AREA ZONE 8 NORTH LINE CLAIM 1149385
	JULY 7	DRILL+BLAST+TRENCH PIT #1 ZONE 8 N.LINE CLAIM 1149385
	JULY 8	DRILL+BLAST+TRENCH+SAMPLE PIT #1 ZONE 8 N.LINE CL. 1149385
	JULY 10	DRILL+BLAST+TRENCH PIT #2 ZONE 8 N.LINE CL. 1149385
	JULY 14	DRILL+BLAST+TRENCH PIT #3 ZONE 8 N.LINE CL. 1149385
	JULY 21	DRILL+BLAST+TRENCH PIT #4 ZONE 8 N.LINE CL. 1149385

## LOCATION OF STRIPPING & TRENCHING

SKETCH ATTACHED

## SKETCH OF TRENCHING AND SAMPLING

SKETCH ATTACHED

## DESCRIPTION OF SAMPLES

<u>SAMPLE NO</u>	<u>TYPE</u>	<u>ROCK TYPE</u>	<u>MINERALIZATION</u>	<u>ASSAY</u>
6	CHIP (B)		MINOR SULPHIDE	TR-AU.
7	CHIP (J)		MINOR SULPHIDE	TR-AU
8	CHIP (U)		MINOR SULPHIDE	TR-AU
9	CHIP (I)		MINOR SULPHIDE	TR-AU

BENNETT LAKE TWP. RAINY RIVER DISTRICT

1-PACE = 2.6' SCALE 1" = 990'

LOCATION STRIPPING AND TRENCHING

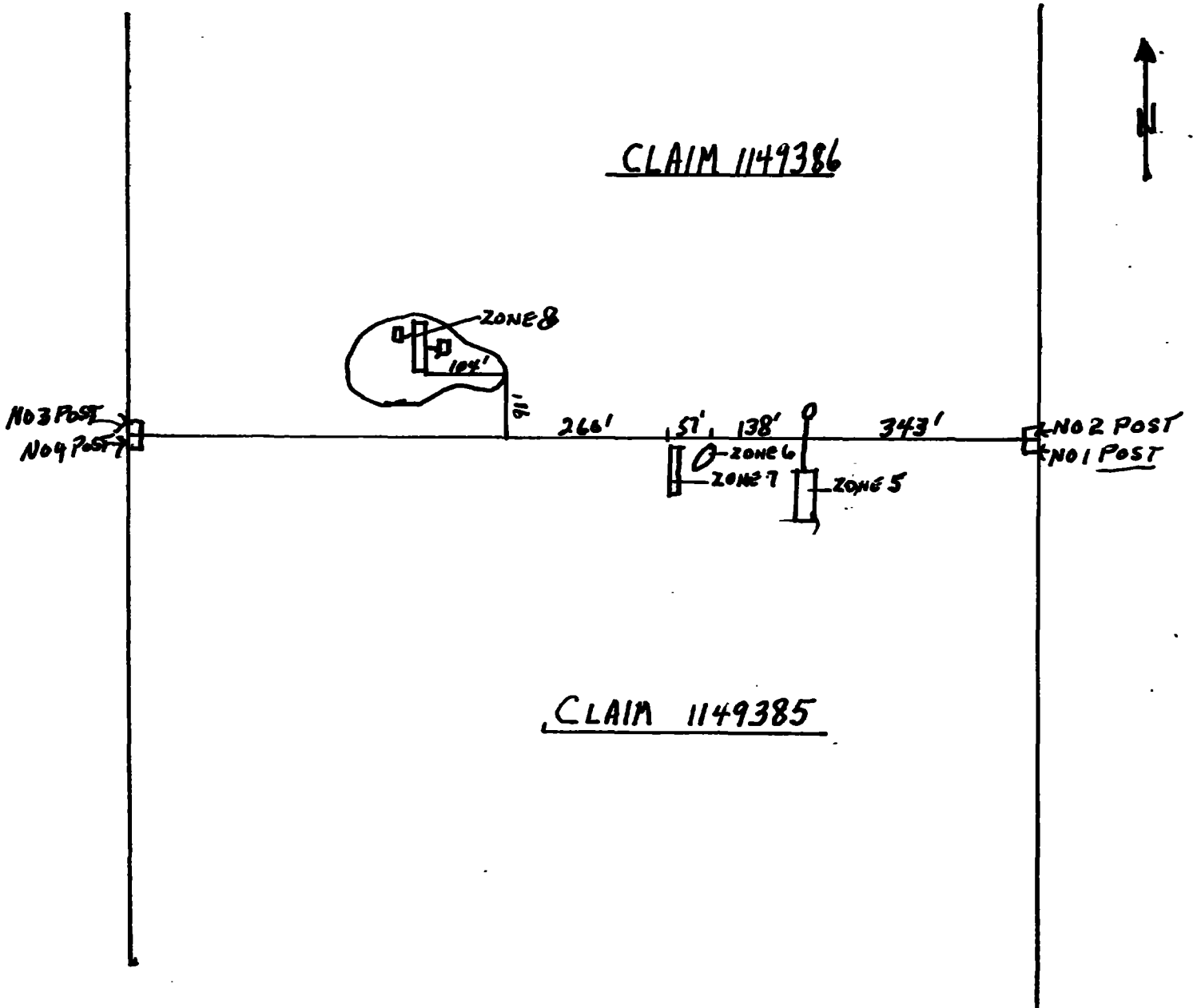

# BENNETT LAKE 2667 RAINY RIVER DISTRICT

## SKETCH STRIPPING AND TRENCHING

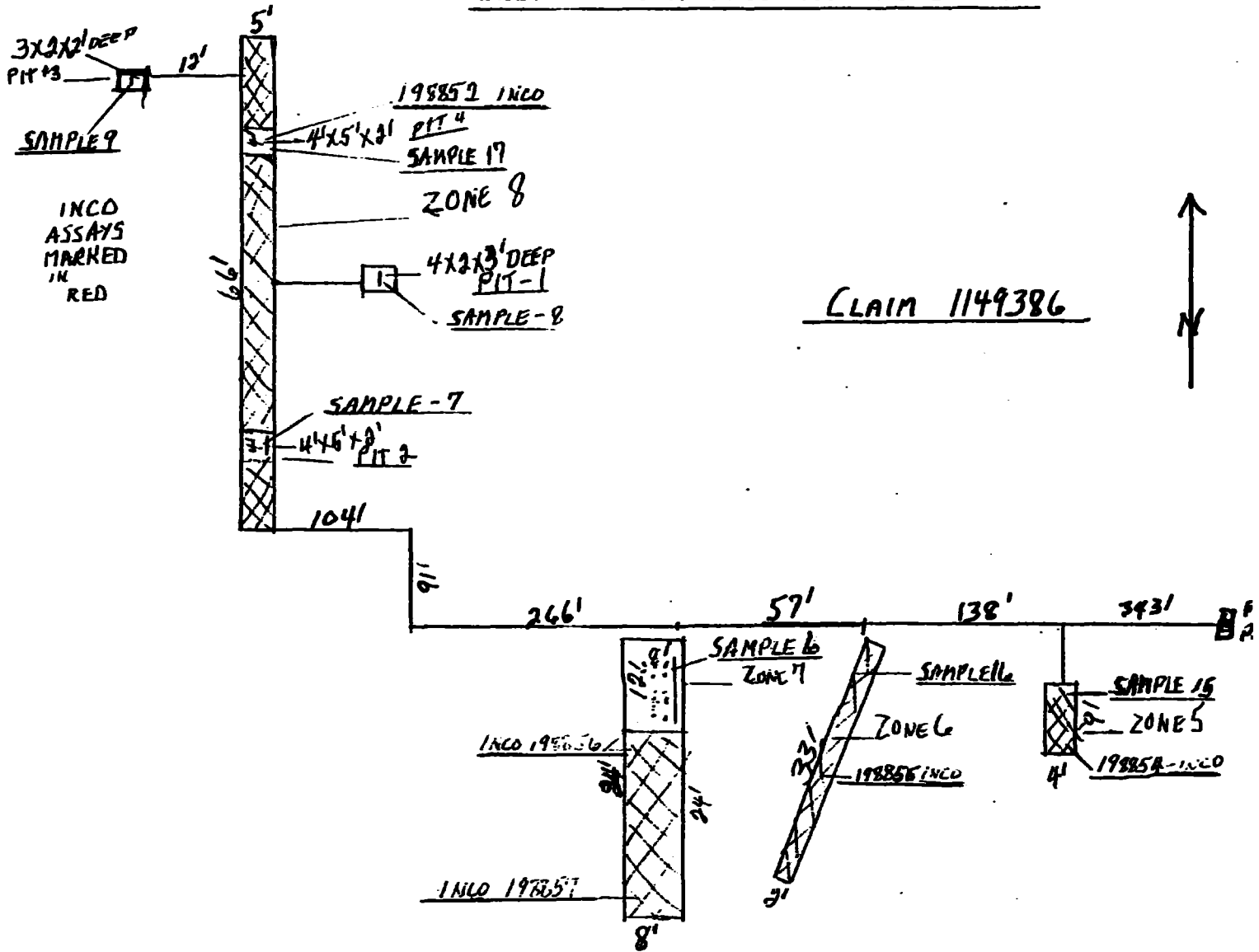

# STRIPPING & TRENCHING - DAILY LOG



52C16SW0010 OP91-353 HALKORR

070

PROJECT AREA

DATE

BENNETT LAKE  
ZONE 10+11  
CLAIM 1149385

ZONE  
10+11  
+12

JULY 24 /4/	STRIP EAST SIDE	ZONE 10
JULY 25	STRIP NORTH SIDE	ZONE 10
JULY 26	STRIP OLD PIT	ZONE 10
JULY 27	DRILL-BLAST-TRENCH N.END PIT 2	ZONE 10
JULY 28	DRILL-BLAST-TRENCH S.END PIT 2	ZONE 10
JULY 30	DRILL-BLAST-TRENCH PIT 1	ZONE 10
JULY 31	TRENCH-STRIP-SAMPLE	ZONE 10
AUG. 1	STRIP NORTH SIDE	ZONE 11-SAMPLE
AUG. 2	STRIP CENTER SIDE	ZONE 11-SAMPLE
AUG. 3	STRIP SOUTH SIDE	ZONE 11
AUG. 4	DRILL-BLAST-TRENCH W.SIDE PIT 3	ZONE 11
AUG. 5	DRILL-BLAST-TRENCH E.SIDE PIT 3	ZONE 11
AUG. 6	DRILL-BLAST-TRENCH W.SIDE PIT 4	ZONE 11
AUG. 7	DRILL-BLAST-TRENCH E.SIDE PIT 4	ZONE 11
AUG. 12	STRIP NORTH	ZONE 11 L SHAPE
AUG. 17	DRILL-BLAST-ZONE 11	FOR DEPTH
AUG. 18	BLAST-TRENCH-SAMPLE	ZONE 11
AUG. 27	TRENCH-SAMPLE	ZONE 10+11 WITH INCLD EXPLORATIONS-ASSAY ENCLD

## LOCATION OF STRIPPING & TRENCHING

SKETCH ATTACHED

## SKETCH OF TRENCHING & SAMPLING

SKETCH ATTACHED

## DESCRIPTION OF SAMPLES

<u>SAMPLE NO</u>	<u>TYPE</u>	<u>ROCK TYPE</u>	<u>MINERALIZATION</u>	<u>ASSAY</u>
11	(CHIP 1 <sup>st</sup> )	QUARTZ	MINOR SULPHIDE	TR-AU
12	(CHIP 2 <sup>nd</sup> )	RYHOLITE	MINOR SULPHIDE	TR-AU
13	(CHIP 3 <sup>rd</sup> )	RYHOLITE	MINOR SULPHIDE	TR-AU
14	(CHIP 3 <sup>rd</sup> )	RYHOLITE	MINOR SULPHIDE	ST-PYB AU

INCLD ASSAY ENCLOSED.

11, 12, 13, 14 } ARE ALSO ON NSU 21 ACTIVATION LABORATORIES ASSAY #3939

# STRIPPING AND TRENCHING DAILY LOGS

<u>PROJECT AREA</u>	<u>DATE</u>	<u>WORK PERFORMED</u>
BENNETT LAKE ZONE 12	SEPT - 1	STRIP - PITS N-1/2 OF ZONE 12
	SEPT - 4	STRIP - CENTER ZONE 12
	SEPT - 5	STRIP - SOUTH 1/3 OF ZONE 12
	SEPT - 7	DRILL - BLAST - TRENCH E HALF PIT 5 ZONE 12
	SEPT - 8	DRILL - BLAST - TRENCH W HALF PIT 5 - ZONE 12
	SEPT - 15	DRILL - BLAST - TRENCH E. HALF PIT 6 - ZONE 12
	SEPT - 22	DRILL - BLAST - TRENCH W - HALF PIT 6 - ZONE 12
	OCT - 2	DRILL - BLAST - TRENCH FOR DEPTH PIT 5 ZONE 12

## LOCATION OF STRIPPING AND TRENCHING

SKETCH ATTACHED

## SKETCH OF TRENCHING AND SAMPLING

## DESCRIPTION OF SAMPLES

<u>SAMPLE No.</u>	<u>TYPE</u>	<u>ROCK TYPE</u>	<u>MINERALIZATION</u>	<u>ASSAY</u>
21	CHIP (3")	QTS. VEIN	MINOR SULPHIDE	TR - AU
22	CHIP (6")	RYDLITE	MINOR SULPHIDE	TR - AU
23	CHIP (12")	RYDLITE	MINOR SULPHIDE	TR - AU

L-PALE = 3.6' = 0.79248 M,  
SCALE 1" = 66.66M

BENNETT LAKE TWP RAINY RIVER DISTRICT  
LOCATION STRIPPING AND TRENCHING

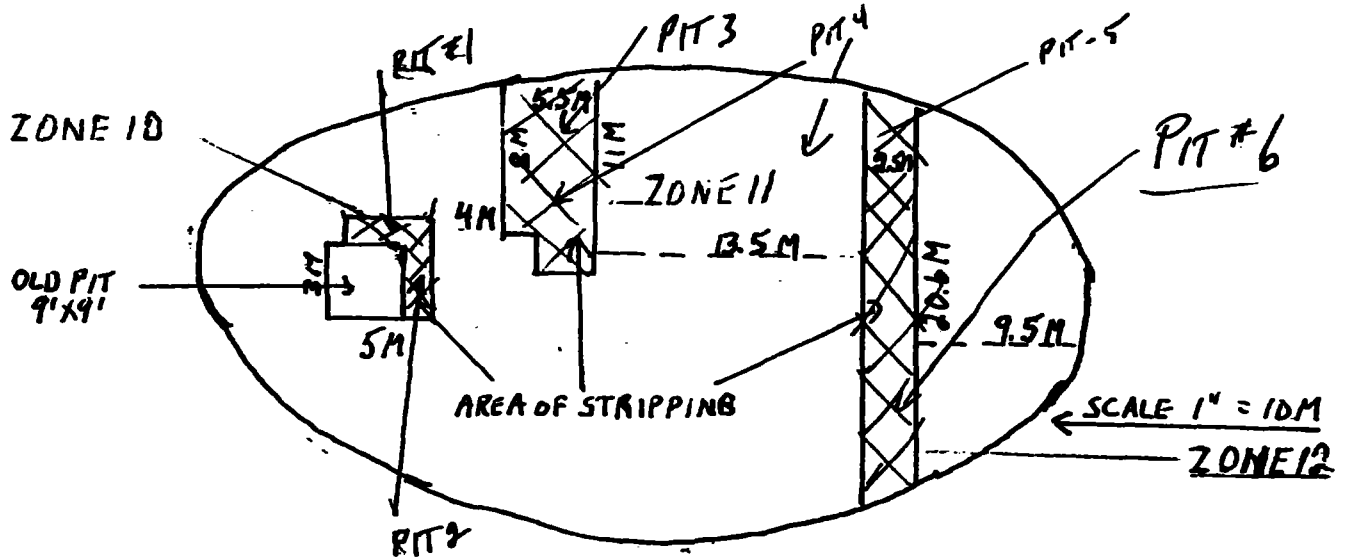
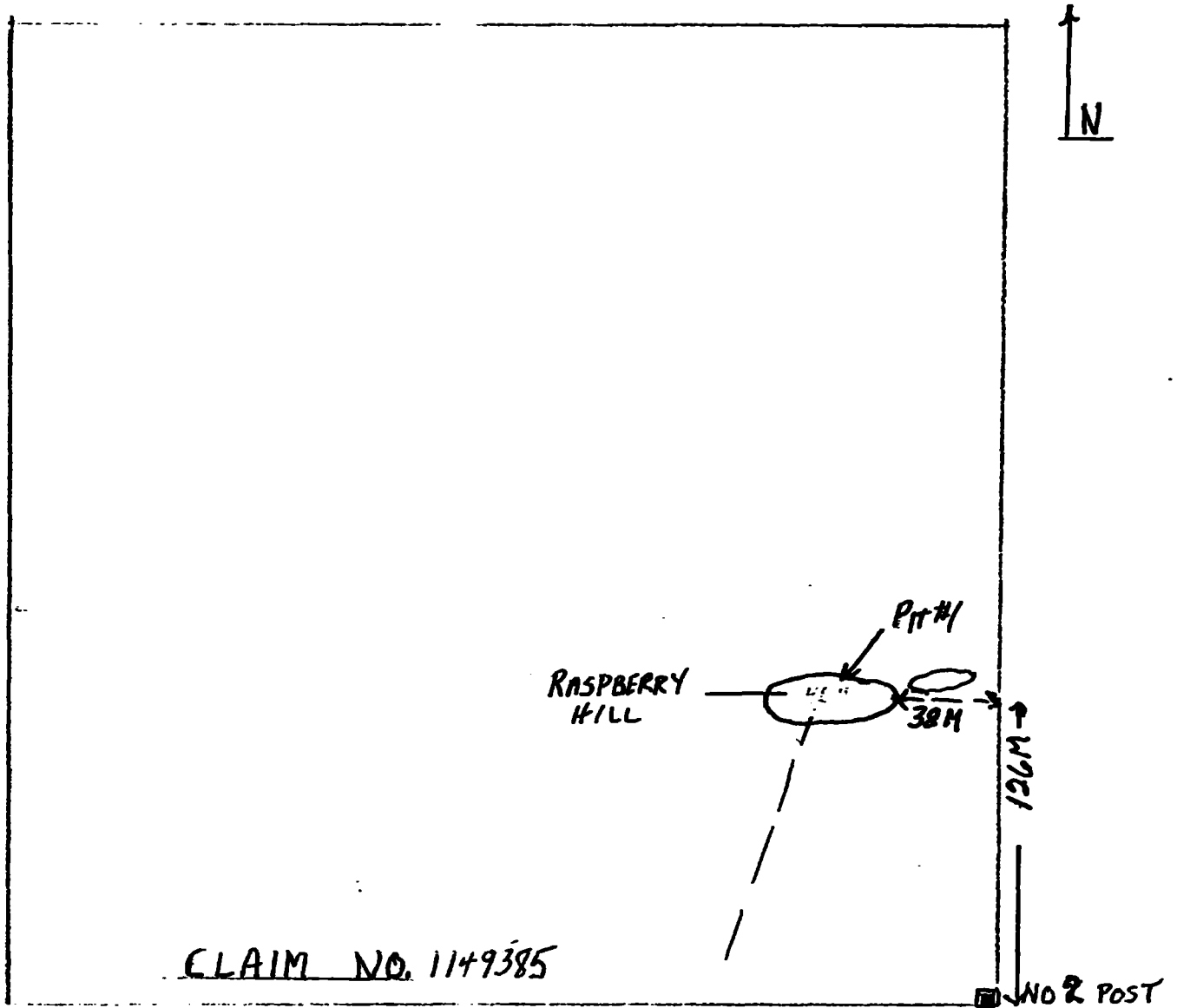

BENNETT LAKE TWP R.R. DISTRICT  
STRIPPING &  
SKETCH OF TRENCHING AND SAMPLING

CLAIM NO. 1149385,

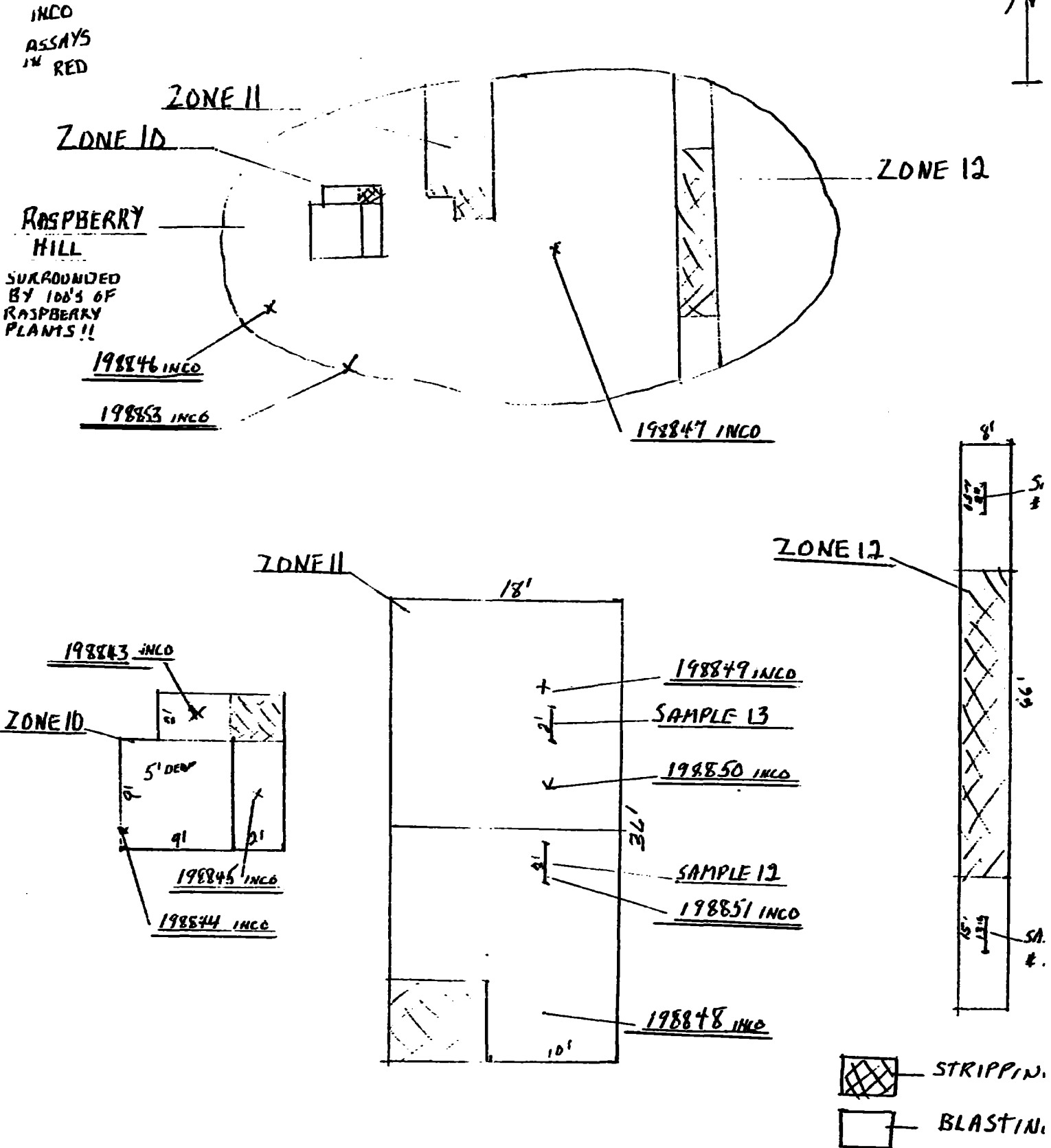

1/10/00

Sample description	AU PPB	AG PPM	AS PPM	BA PPM	BR PPM	CA %	CO PPM	CR PPM	CS PPM	FE %	HF PPM	HG PPM	IR PPB	K %	MO PPM	NA PPM	NI PPM	RE PPM	SB PPM	SC PPM	SE PPM
RX 198843	8	<5	7	720	<1	<1	<5	44	<2	1.29	6.6	<1	<5	2.6	<5	5020	<50	47	0.9	2.4	<5
RX 198844	18	<5	9	580	<1	<1	<5	48	<2	1.35	7.3	<1	<5	1.9	<5	13400	<50	52	1.3	2.8	<5
RX 198845	5	<5	8	740	<1	<1	<5	53	<2	1.12	6.2	<1	<5	2.0	<5	4440	<50	39	1.2	2.4	<5
RX 198846	<5	<5	5	520	<1	<1	<5	54	<2	0.94	5.9	<1	<5	<0.9	<5	14900	<50	35	0.9	2.5	<5
RX 198847	<5	<5	5	680	<1	<1	<5	53	<2	0.86	6.8	<1	<5	<0.8	<5	10500	<50	39	1.0	2.2	<5
RX 198848	<5	<5	8	740	<1	<1	<5	62	<2	1.15	6.4	<1	<5	<0.8	<5	9730	60	42	1.1	2.0	<5
RX 198849	<5	<5	9	970	<1	<1	<5	63	<2	1.24	7.0	<1	<5	3.5	<5	2630	<50	46	1.3	2.4	<5
RX 198850	<5	<5	8	800	<1	<1	<5	55	<2	1.22	6.6	<1	<5	4.8	<5	4080	50	51	1.1	2.5	<5
RX 198851	14	<5	7	670	<1	<1	<5	82	<2	1.15	5.6	<1	<5	<0.7	<5	3550	<50	34	1.9	2.2	<5
RX 198852	<5	<5	<2	260	<1	<1	<5	48	<2	1.70	5.9	<1	<5	3.6	<5	15200	<50	56	0.8	2.2	<5
RX 198853	<5	<5	4	330	<1	<1	<5	82	<2	0.99	4.4	<1	<5	<0.8	<5	13500	<50	<30	0.9	1.6	<5
RX 198854	8	<5	2	<100	<1	<1	<5	73	<2	1.13	6.7	<1	<5	<1.0	<5	26300	<50	<30	0.8	1.3	<5
RX 198855	6	<5	<2	480	<1	<1	<5	82	<2	1.56	11	<1	<5	7.0	<5	22900	53	<30	0.8	2.9	<5
RX 198856	<5	<5	<2	370	<1	<1	<5	75	<2	1.18	11	<1	<5	<1.1	<5	20100	<50	<30	0.8	2.6	<5
RX 198857	<5	<5	7	340	<1	2	26	29	<2	7.24	4.4	<1	<5	<1.1	<5	21600	<50	41	1.0	2.4	<5

LOSS IN EXHIBIT



Sample description	SN %	SR %	TA PPM	TH PPM	U PPM	V PPM	ZN PPM	LA PPM	CE PPM	ND PPM	SM PPM	EU PPM	TB PPM	YB PPM	LU PPM	CU PPM	PB PPM	Mass g
RX 198843	<0.01	<0.05	<1	6.6	2.3	<4	113	36	87	35	7.0	1.0	1.2	6.05	1.01	16	68	30.00
RX 198844	<0.01	<0.05	2	7.1	1.4	<4	171	39	92	40	7.8	1.2	1.4	6.71	1.16	17	520	30.00
RX 198845	<0.01	<0.05	1	6.9	2.5	<4	421	37	88	41	7.3	1.2	1.4	6.18	1.10	46	510	30.00
RX 198846	<0.01	<0.05	1	6.5	1.7	<4	76	35	85	38	7.2	1.2	1.3	6.10	1.03	5	42	30.00
RX 198847	<0.01	<0.05	2	7.3	2.8	<4	97	39	90	41	7.8	1.2	1.5	6.70	1.16	10	150	30.00
RX 198848	<0.01	<0.05	1	6.4	1.2	<4	186	37	88	39	7.4	1.1	1.4	5.84	1.01	19	160	30.00
RX 198849	<0.01	<0.05	1	7.2	2.0	<4	317	41	96	41	8.0	1.3	1.3	6.62	1.15	6	770	30.00
RX 198850	<0.01	<0.05	<1	6.4	2.1	<4	205	39	90	37	7.5	1.1	1.3	6.17	1.10	8	460	30.00
RX 198851	<0.01	<0.05	<1	5.9	1.5	<4	2230	32	77	32	6.3	1.0	1.1	5.14	0.87	75	1800	30.00
RX 198852	<0.01	<0.05	<1	6.0	2.3	<4	74	23	58	25	5.1	0.8	1.1	6.12	1.07	9	30	30.00
RX 198853	<0.01	<0.05	<1	5.0	2.1	<4	<50	25	59	27	5.2	0.6	0.9	3.28	<0.05	13	10	30.00
RX 198854	<0.01	<0.05	<1	5.5	1.7	<4	<50	32	75	31	6.9	1.2	1.7	9.26	1.55	1	4	30.00
RX 198855	<0.01	<0.05	2	9.2	2.6	<4	62	47	120	49	10	1.9	2.4	15.2	2.55	6	6	30.00
RX 198856	<0.01	<0.05	2	9.3	3.5	<4	55	45	110	46	10	1.7	2.5	14.2	2.38	8	12	30.00
RX 198857	<0.01	<0.05	<1	2.2	<0.5	<4	102	18	45	17	4.7	1.5	1.0	5.04	0.88	190	<2	30.00

# INCO LIMITED

TRAVERSE NUMBER \_\_\_\_\_

N.T.S. \_\_\_\_\_

PROJECT Couscoute Area

GEOLOGIST(S) R. McEwen

DATE Aug. 27/91

SAMPLE NUMBER	SAMPLE TYPE			SAMPLE LENGTH, WIDTH, AREA	LATITUDE, LONGITUDE and/or U.T.M.	SAMPLE DESCRIPTION Rock type, lithology, character of soil, stream silt, etc. Formation Mineralization, etc.	RESULTS (ppm. / % / oz. per ton)								
	RX Rock, Talus	SX Stream Silt, Soil	Grb, Chip, Channel				Au ppb	Cu ppm	Zn ppm	Pb ppm					
2Y198543	✓	—	GrAB	—		Fract. Qtz. Ktz. Tuffe, garnets, Vf6-F8, 5% up to 3% Qtzefves, Moby Gfrc, woby Ford, 1-2% f.f. rhy, 3% r.f. Nsspy.	8	16	113	68					
2Y198544	✓	—	—	—		AS 2Y198842 to 7m. Spinalite in Qtz. Vult.	18	17	171	500					
2Y198845	✓	—	—	—		AS 2Y198843 to 2+5% Py, 5-7% Qtz. Vult. Tuffe. 5% r.f. rhy, 2% r.f. Nss. rhy. 1% Phs.	5	46	421	510					
2Y198846	✓	—	—	—		AS 2Y198843 to 7m. Py, 1	45	5	76	42					
2Y198847	✓	—	—	—		AS 2Y198846 Rhy. Styr. Sphc N/S.	45	10	97	150					
2Y198848	✓	—	—	—		AS 2Y198843, to 5% Qtzefves, 3-5% Vf6 - f.f. Nsspy.	45	19	186	160					
2Y198849	✓	—	—	—		AS 2Y198845	45	6	217	220					
2Y198850	✓	—	—	—		AS 2Y198845	25	8	205	460					
2Y198851	✓	—	—	—		AS 2Y198845	14	75	0.228	188					
2Y198852	✓	—	—	—		Styr. Chert, f.f. Nss. Ktz. Tuffe, Moby Styr. Ford, 15-20% f.f. rhy, r.f. Nss. rhy.	45	9	74	30					
2Y198853	✓	—	—	—		Rhyolite, Oliv. Rhyolite, Vf6, Maficite Ford, Nss. rhy. Nss. rhy.	45	13	450	16					

221.

TRAVERSE NUMBER \_\_\_\_\_

PROJECT Couscoute Area

GEOLOGIST(S) R. M. S. FENCHERTON

N.T.S. \_\_\_\_\_

AREA \_\_\_\_\_

DATE Aug. 27/91

SAMPLE NUMBER	SAMPLE TYPE			SAMPLE LENGTH, WIDTH, AREA	LATITUDE, LONGITUDE and/or U.T.M.	SAMPLE DESCRIPTION Rock type, lithology, character of soil, stream silt, etc. Formation Mineralization, etc.	RESULTS (ppm, %/oz. per ton)			
	RX Rock, Talus	SX Stream Silt, Soil	Grab, Chip, Channel				Au ppb	Cu ppm	Zn ppm	Pb ppm
NV19855V	Rock	---	Grab	---	NORTH	Reddish-brown siltstone, quartzite formation FeCh assoc. in quartzite & shale.	8	1	<5	4
NV19855S	---	---	---	---	NORTH	Stratified quartzite & shale FeCh, talc.	6	6	62	6
NV19855A	---	---	---	---	NORTH	Asph. / FeCh, talc, hard, trace py.	<5	8	55	12
NV19855T	---	---	---	---	SOUTH	Int-matrix vit. tufts, druse-ker FeCh, Fe, mod. sulcs, mod. soft qtz-FeCh, v. talc, can't trace py and cp, str-mod. wtc. & 15% crystalline mt.	<5	190	102	22

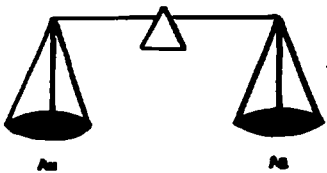

# PAUL'S CUSTOM FIRE ASSAYING LTD.

Phone: Bus. (807) 662-8171

Res. (807) 662-3361

Fax: (807) 662-1155

PAUL OKANSKI, Assayer  
Box 253, Cochenour, Ontario P0V 1L0

L. Cousineau

## ASSAY CERTIFICATE

Date: July 11-91

Sample No.	Description	oz/ton Au	oz/ton Ag
1 #1	May 10/91 Sample - 1	Trace	
2 2	" 12 " 2	"	
3 3	" 14 " 3	"	
4 4+5	" 16 " 4+5	"	
5			
6			
7			
8			
9			
10			
11			
12			
13			
14			
15			
16			
17			
18			
19			
20			
21			
22			
23			
24			
25			

Assayer: *Paul Okanski*

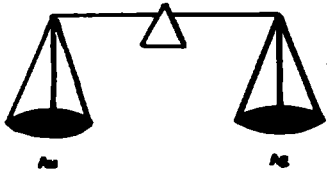

# PAUL'S CUSTOM FIRE ASSAYING LTD.

Phone: Bus. (807) 662-8171

Res. (807) 662-3361

Fax: (807) 662-1155

PAUL OKANSKI, Assayer  
Box 253, Cochenour, Ontario P0V 1L0

L Cousineau

## ASSAY CERTIFICATE

Date: July 24-91

Sample No.	Description	oz/ton Au	oz/ton Ag
1	#1 July 7 Sample # 6	Trace	
2	" 10 " 7	"	
3	" 14 " 9	"	
4	" 8 " 8	"	
5			
6			
7			
8			
9			
10			
11			
12			
13			
14			
15			
16			
17			
18			
19			
20			
21			
22			
23			
24			
25			

Assayer: *Paul Okanski*

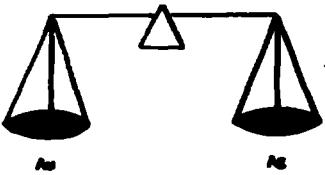

# PAUL'S CUSTOM FIRE ASSAYING LTD.

Phone: Bus. (807) 662-8171

Res. (807) 662-3361

Fax: (807) 662-1155

PAUL OKANSKI, Assayer  
Box 253, Cochenour, Ontario P0V 1L0

## ASSAY CERTIFICATE

Date: Aug. 5-91

Sample No.	Description	oz/ton Au	oz/ton Ag
1	<i>Sample</i> 11 - JULY - 31	Trace	
2	12 - AUG - 1	"	
3	13 - AUG - 7	"	
4			
5			
6			
7			
8			
9			
10			
11			
12			
13			
14			
15			
16			
17			
18			
19			
20			
21			
22			
23			
24			
25			

Assayer: *Paul Okanski*

Activation Laboratories Ltd. Work Order: 3389 Report: 3429

NOV 7, 91

Sample description	AU	AG	AS	BA	BR	CA	CO	CR	CS	FE	HF	HG	IR	MO	NA	NI	RB	SB	SC	SE	SN	
	PPM	PPM	PPM	PPM	PPM	PPM	PPM	PPM	PPM	PPM	PPM	PPM	PPM	PPM	PPM	PPM	PPM	PPM	PPM	PPM	PPM	PPM
1 AUG 18 - ZONE 11	27	<5	3	830	<1	<1	<5	78	<2	1.84	7	<1	<5	<5	17100	76	54	0.3	2.4	<5	<0.01	SAMPLE 14
2 AUG 18 ZONE 11	9	<5	3	1500	<1	<1	<5	130	<2	1.18	7	<1	<5	<5	10200	<50	44	0.5	2.0	<5	<0.01	SAMPLE 11
3 AUG 18 ZONE 11	20	5	11	760	<1	<1	<5	73	<2	1.45	7	<1	<5	<5	4730	<50	50	3.0	3.0	<5	<0.01	SAMPLE 12
4 AUG 18 ZONE 11	<5	7	3	650	<1	<1	<5	91	<2	1.24	8	<1	<5	<5	10500	<50	58	2.2	2.7	<5	<0.01	" 13
5 OCT 31 25 - ZONE 12.51	<5	12	140	<1	<1	<1	<5	160	<2	4.18	4	<1	<5	7	14300	<50	42	1.1	1.7	<5	<0.01	" 14
6 AUG 18 - ZONE 8	7	<5	<2	270	<1	3	36	340	<2	6.62	2	<1	<5	<5	16900	<50	82	0.5	27	<5	<0.01	SAMPLE 11
7 OCT 27 ZONE 12.20	<5	3	1300	<1	10	<1	28	170	<2	4.51	3	<1	<5	<5	16700	<50	180	<0.2	15	<5	<0.01	" 11
8 AUG 18 - ZONE 5	<5	<5	14	860	<1	<1	6	75	<2	3.60	16	<1	<5	<5	14000	<50	100	0.5	5.5	<5	<0.01	SAMPLE 15
9 AUG 18 - ZONE 6	<5	<5	8	950	<1	<1	<5	89	<2	1.77	6	<1	<5	<5	17200	<50	38	0.3	2.7	<5	<0.01	SAMPLE 16
10 OCT 31 36 - ZONE 13.34	<5	13	990	<1	<1	<1	6	220	<2	4.58	10	<1	<5	<5	1420	<50	140	0.2	9.1	6	<0.01	" 13
11 OCT 31 Zone 10	562	<5	5	<100	<1	<1	25	160	<2	5.06	<1	<1	<5	<5	5110	340	<30	<0.2	0.7	<5	<0.01	" 12

NOV. 7/91  
 Activation Laboratories Ltd. Work Order: 3389 Report: 3429

Sample description	SR	TA	TH	U	W	ZN	LA	CE	ND	SH	EU	TB	YB	LU	Mass
	PPM	PPM	PPM	PPM	PPM	PPM	PPM	PPM	PPM	PPM	PPM	PPM	PPM	PPM	g
1 AUG 18 - ZONE 11	<0.05	2	7.3	2.7	<4	<50	40	93	36	7.8	1.3	1.4	5.89	1.03	37.76 SAMPLE 14
2 AUG 18 - ZONE 11	<0.05	<1	7.3	1.1	<4	119	38	85	36	7.3	1.0	1.2	6.22	1.11	38.61 " "
3 AUG 18 - ZONE 11	<0.05	<1	6.9	2.2	<4	2740	41	100	46	8.2	1.5	1.7	6.77	1.16	32.86 SAMPLE 12
4 AUG 18 - ZONE 11	<0.05	3	7.9	2.1	<4	2150	40	98	39	7.9	1.1	1.6	6.48	1.14	32.04 " "
5 OCT 31 - 5-ZONE 12	<0.05	<1	4.7	1.3	<4	<50	27	63	29	4.7	0.7	0.7	4.32	0.76	26.48 " "
6 AUG 18 - ZONE 8	<0.05	<1	1.1	<0.5	<4	127	21	57	22	4.7	1.6	<0.5	2.08	0.40	29.54 " "
7 OCT 31 - ZONE 13	<0.05	<1	7.9	3.0	7	<50	31	67	26	3.7	1.3	<0.5	1.51	0.27	30.25 SAMPLE #1
8 AUG 18 - ZONE 5	<0.05	2	13	4.3	<4	156	91	230	100	20	4.1	3.6	18.6	3.27	26.50 " "
9 AUG 18 - ZONE 6	<0.05	1	6.9	1.9	<4	<50	37	85	34	7.2	0.8	1.3	7.02	1.17	31.23 " "
10 OCT 31 - ZONE 13	<0.05	2	8.3	2.9	<4	355	46	130	57	11	2.1	2.1	11.3	2.00	20.89 " "
11 OCT 31 - ZONE 10	<0.05	<1	0.7	<0.5	<4	<50	2	<3	<5	0.3	<0.2	<0.5	0.27	<0.05	41.92 " "



HERON LAKE G-2676

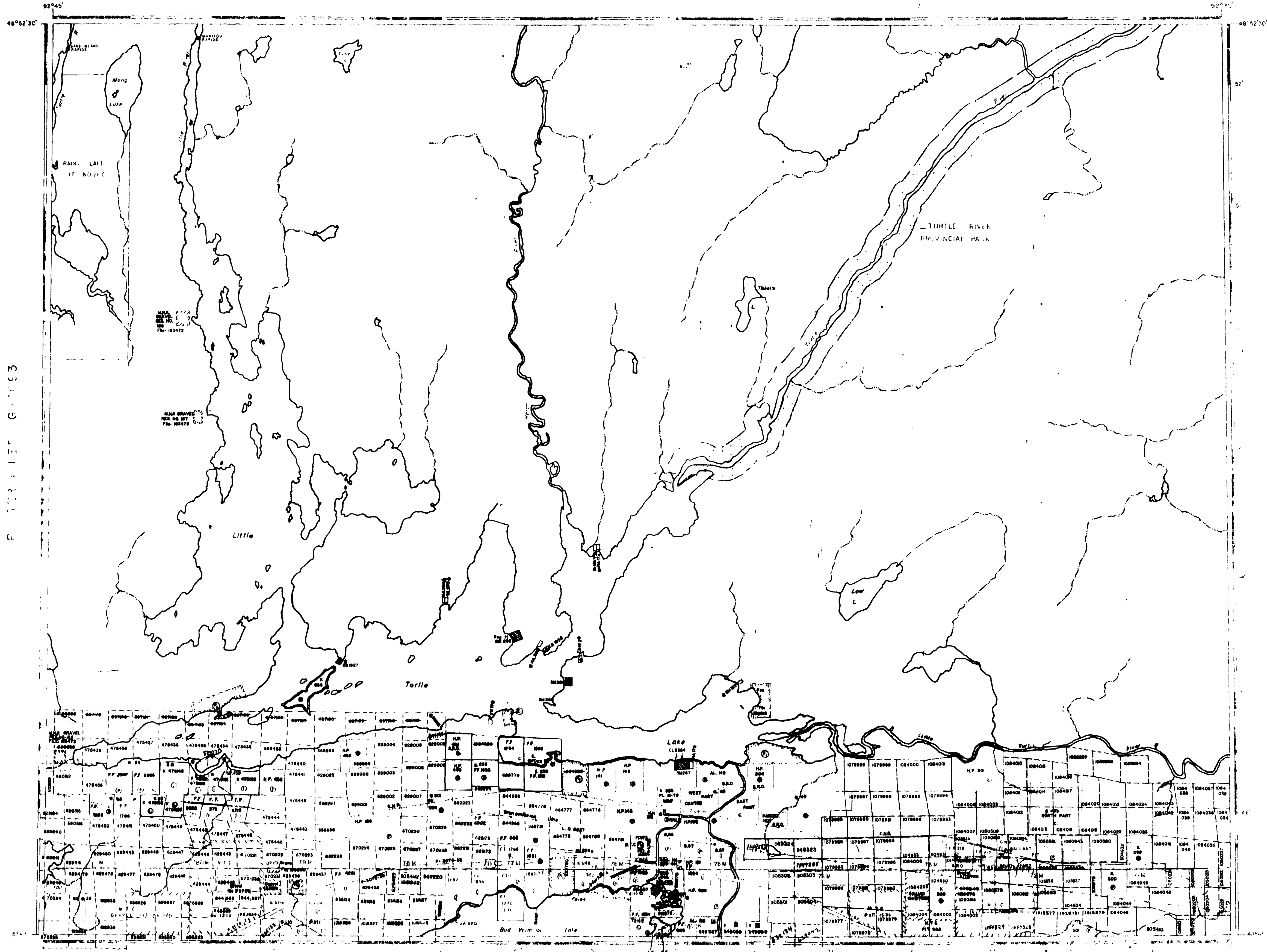

THE INFORMATION THAT APPEARS ON THIS MAP HAS BEEN COMPILED FROM VARIOUS SOURCES AND ACCURACY IS NOT GUARANTEED. THOSE WISHING TO STAKE MINING CLAIMS SHOULD CONSULT WITH THE MINING RECORDER, MINISTRY OF NORTHERN DEVELOPMENT AND MINES, FOR ADDITIONAL INFORMATION ON THE STATUS OF THE LANDS SHOWN HEREON.

LEGEND

- PATENTED LAND (C)
- CROWN LAND SALE CS
- LEASES (L)
- LOCATED LAND LC
- LICENSE OF OCCUPATION LO
- MINING RIGHTS ONLY MRO
- SURFACE RIGHTS ONLY SRO
- ROADS ---
- IMPROVED ROADS ---
- KING'S HIGHWAYS ---
- RAILWAYS ---
- POWER LINES ---
- WATER OF MARKET ---
- MINES ---
- UNDEVELOPED ---

REFERENCES

AREAS WITHDRAWN FROM DISPOSITION

M.R.O. - MINING RIGHTS ONLY  
 S.R.O. - SURFACE RIGHTS ONLY  
 M+S - MINING AND SURFACE RIGHTS

Description	Order No.	Date	Disposition	File
Public Lands Act		11/1/76	S.R.O.	163472
	W 776	10/27/76	S.R.O.	67883
	W 8877	14/10/77	S.R.O.	288
Park Reserve	W 73/83	8/23/83	MRS	10000
	W 20/88	10/1/88	S & M	
	W 24/90	20/11/90	S.R.O.	

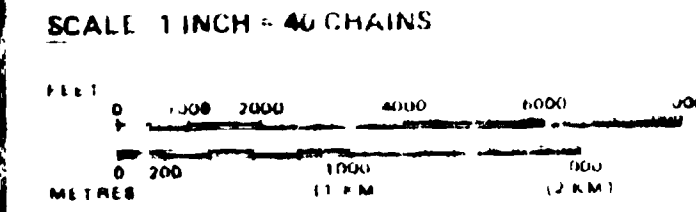
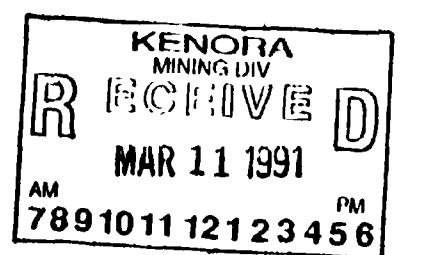

AREA  
**LITTLE TURTLE LAKE**  
 M.N.R. ADMINISTRATIVE DISTRICT  
**FORT FRANCES**  
 MINING DIVISION  
**KENORA**  
 LAND TITLES / REGISTRY DIVISION  
**RAINY RIVER**



Date MARCH, 1984  
 Number **G-2682**



OBIKOBA LAKE M.2126

PORTER INLET M 245J

ong the shores  
AUTHOR: FROM  
(c) of Mining Act

1:50,000  
W.A.S. S.R.O. 16487A  
S.R.O. H  
7.5 N.H.M.R. 17640B  
64 S.R. 7548 V.V.  
15 U.M.C.  
4/1/1991  
108000

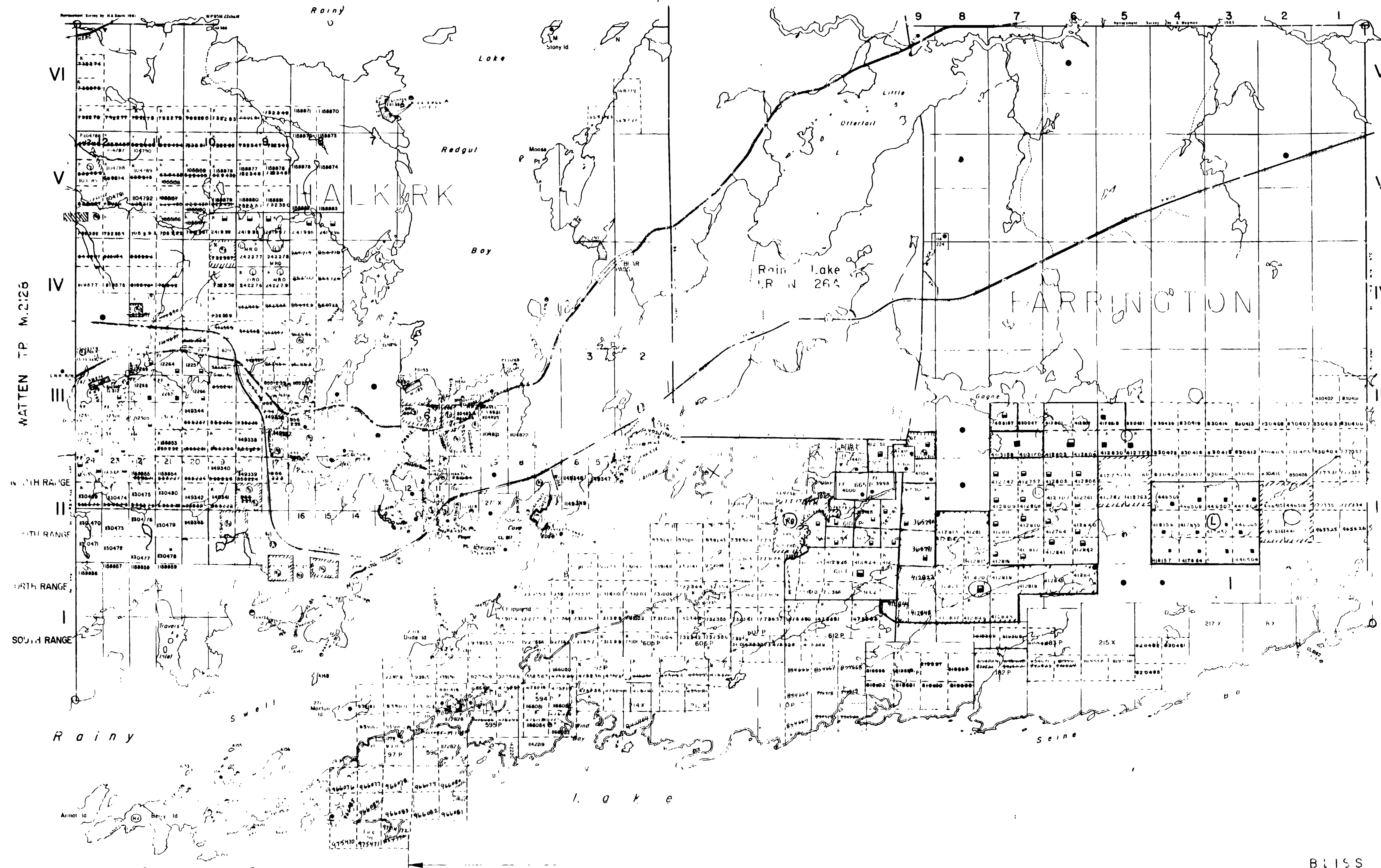

THE INFORMATION THAT APPEARS ON THIS MAP HAS BEEN COMPILED FROM VARIOUS SOURCES, AND ACCURACY IS NOT GUARANTEED. THOSE WISHING TO STAKE MINING CLAIMS SHOULD CONSULT WITH THE MINING RECORDER, MINISTRY OF NORTHERN DEVELOPMENT AND MINES, FOR ADDITIONAL INFORMATION ON THE STATUS OF THE LANDS SHOWN HEREON.

LEGEND

- HIGHWAY AND HOUSE NO.
- OTHER ROADS
- TRAILS
- SURVEYED LINES
  - WNSHIP, BAY, LINES ETC.
  - LOTS, MINING CLAIMS, PARCELS ETC.
- UNSURVEYED LINES
- PARCEL BOUNDARY
- MINING CLAIMS ETC.
- RAILWAY AND RIGHT OF WAY
- UTILITY LINES
- NON-PERENNIAL
- SUBDIVISION
- ORIGINA HOPELINE
- MARSH OR MUSKIEG
- MINES

KENORA  
RECEIVED  
MAR 11 1991  
AM 789101112123456

TOWNSHIPS  
**HALKIRK AND  
FARRINGTON**

DISTRICT  
RAINY RIVER  
MIL. NO. DIST.  
KENORA

Ministry of Natural Resources  
Selling and Marketing Branch  
1 M.205



MANION LAKE AREA - G-2686

LITTLE TURTLE LAKE AREA - G-2682

HEPBURN LAKE AREA - G-2675

WILD POTATO LAKE AREA - G-2703

LEGEND

- HIGHWAY AND ROUTE No.
- OTHER ROADS
- TRAILS
- SURVEYED LINES
- TOWNSHIP BASE LINES, ETC.
- LOTS, MINING CLAIMS PARCELS ETC.
- UNSURVEYED LINES
- LOT LINES
- PARCEL BOUNDARY
- MINING CLAIMS ETC.
- RAILWAY AND RIGHT OF WAY
- UTILITY LINES
- NON PERENNIAL STREAM
- FLOODING OR FLOODING RIGHTS
- SUBDIVISION OR COMPOSITE PLAN RESERVATIONS
- ORIGINAL SHORELINE
- MARSH OR MUSKEG
- MINES
- TRAVERSE MONUMENT

DISPOSITION OF CROWN LANDS

TYPE OF DOCUMENT	SYMBOL
PATENT, SURFACE & MINING RIGHTS	●
SURFACE RIGHTS ONLY	○
MINING RIGHTS ONLY	◐
LEASE SURFACE & MINING RIGHTS	◑
SURFACE RIGHTS ONLY	◒
MINING RIGHTS ONLY	◓
LICENCE OF OCCUPATION	◔
ORDER IN COUNCIL	OC
RESERVATION	○
CANCELLED	○
SAND & GRAVEL	○

NOTE: MINING RIGHTS IN PARCELS PATENTED PRIOR TO MAY 6 1912 VESTED IN ORIGINAL PATENTEE BY THE PUBLIC LANDS ACT R.S.O. 1976 CHAP. 380 SEC. 63 SUBSEC. 1

REFERENCES

AREAS WITHDRAWN FROM DISPOSITION

- M.R.O. MINING RIGHTS ONLY
- S.R.O. SURFACE RIGHTS ONLY
- M.S. MINING AND SURFACE RIGHTS

Description	Claim No.	Date	Disposition	File

SAND AND GRAVEL

- 1953 M.R.O. FILE 16/718
- 1953 M.S. FILE 1039
- 1953 M.S. FILE 1058
- 1953 M.R.O. FILE 16/799 vol 7
- 1953 M.R.O. (Mines) Reserve No 228, File 16/718
- 1953 M.S. FILE NO. 18-14 KENORA

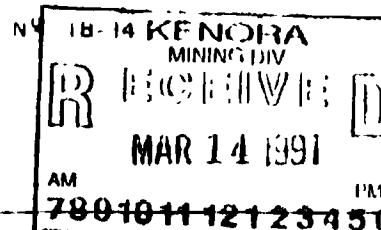

SCALE 1 INCH = 40 CHAINS

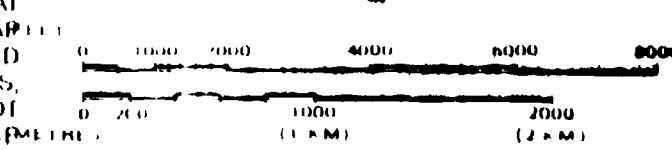

THE INFORMATION THAT APPEARS ON THIS MAP HAS BEEN COMPILED FROM VARIOUS SOURCES, AND ACCURACY IS NOT GUARANTEED. IT IS WISHER TO STATE MINING CLAIMS SHOULD BE CONSULTED WITH THE MINING RECORDS, MINISTRY OF NORTHERN DEVELOPMENT AND MINES TO OBTAIN INFORMATION ON THE STATUS OF THE LANDS SHOWN HEREON.

BENNETT LAKE

M.N.R. ADMINISTRATIVE DISTRICT  
 FORT FRANCES  
 MINING DIVISION  
 KENORA  
 LAND TITLES REGISTRY DIVISION  
 RAINY RIVER

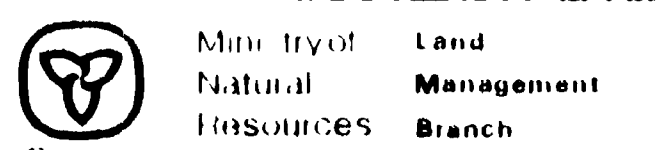

FEBRUARY, 1984  
 G-2667

G-2667



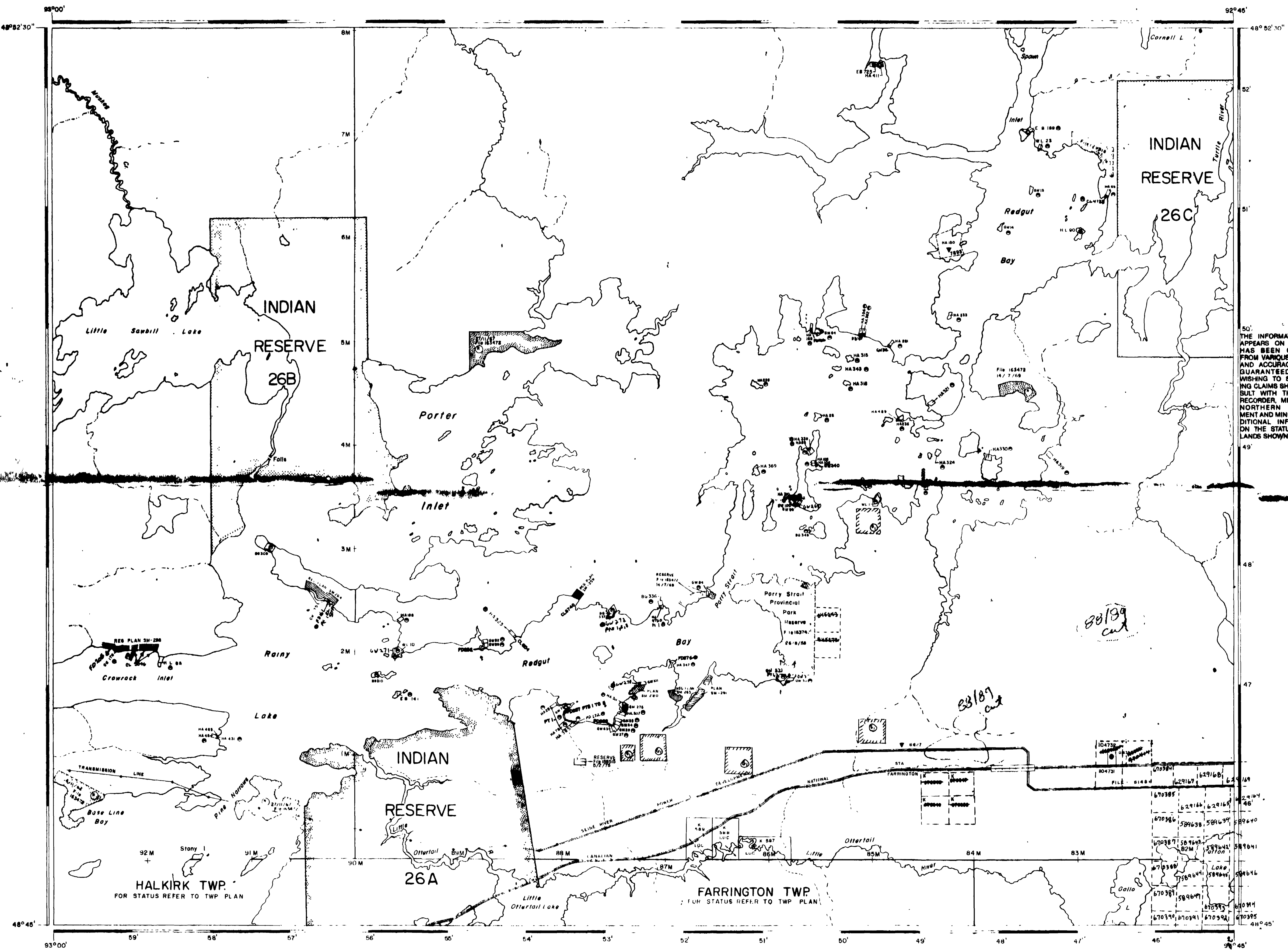

**LEGEND**

HIGHWAY AND ROUTE No	
OTHER ROADS	
TRAILS	
SURVEYED LINES	
TOWNSHIPS, BASE LINES ETC	
LOTS, MINING CLAIMS, PARCELS, ETC	
UNSURVEYED LINES	
LOT LINES	
PARCEL BOUNDARY	
MINING CLAIMS F.T.C.	
RAILWAY AND RIGHT OF WAY	
UTILITY LINES	
NON PERENNIAL STREAM	
FLOODING OR FLOODING RIGHTS	
SUBDIVISION OR COMPOSITE PLAN	
RESERVATIONS	
ORIGINAL SHORELINE	
MARSH OR MUSKEG	
MINES	
TRAVELSE MONUMENT	
TOURIST CAMPS (OP - OUTPOST)	

**DISPOSITION OF CROWN LANDS**

TYPE OF DOCUMENT	SYMBOL
PATENT SURFACE & MINING RIGHTS	
SURFACE RIGHTS ONLY	
MINING RIGHTS ONLY	
LEASE SURFACE & MINING RIGHTS	
SURFACE RIGHTS ONLY	
MINING RIGHTS ONLY	
LICENCE OF OCCUPATION	
ORDER IN COUNCIL	
RESERVATION	
CANCELLED	
SAND & GRAVEL	

NOTE: THE INFORMATION THAT APPEARS ON THIS MAP HAS BEEN COMPILED FROM VARIOUS SOURCES AND ACCURACY IS NOT GUARANTEED. THOSE WISHING TO STAKE MINING CLAIMS SHOULD CONSULT WITH THE MINING RECORDER, MINISTRY OF NORTHERN DEVELOPMENT AND MINES. FOR ADDITIONAL INFORMATION ON THE STATUS OF THE LANDS SHOWN HEREON

**REFERENCES**

**AREAS WITHDRAWN FROM DISPOSITION**

Description	Order No.	Date	Disposition	File
M.R.O. - MINING RIGHTS ONLY				
S.R.O. - SURFACE RIGHTS ONLY				
M + S. MINING AND SURFACE RIGHTS				

MINING DIV.

7891011 12123456

**RECEIVED**

MAR 14 1991

AM 7891011 12123456 PM

FLOODING RIGHTS RESERVED UP TO 5 FEET ABOVE MEAN SEA LEVEL ON ALL LANDS BORDERING ON RAINY LAKE. FILE: 4882, 5478.

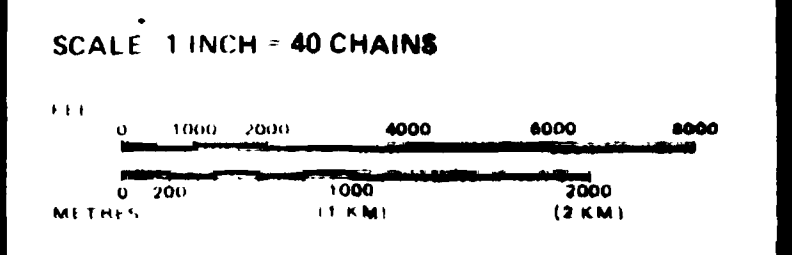

AREA

**PORTER INLET (RAINY LAKE)**

M.N.R. ADMINISTRATIVE DISTRICT

**FORT FRANCES**

MINING DIVISION

**KENORA**

LAND TITLES / REGISTRY DIVISION

**RAINY RIVER**

Ministry of Land Management  
Natural Resources Branch  
Ontario

Date: MARCH, 1984

Number: **G-2693**

~~2459~~

