



REPORT OF THE NATURE OF THE ROCKS

'A' ZONE

SHEAR ZONE UP TO 30 METRES WIDE AND TRENDING 090°. HOSTED BY INTERBEDDED TUFF & FLOWS WITH MINOR INTERBEDDED CHERT. ALTERATION CONSISTS OF CHORLITE - IRON CARBONATE AND SILICIFICATION UP TO 10% MEDIUM OF COARSE GRAINED PYRITE PRESERVED MINERALIZED QUARTZ VEINS 1 TO 3" WIDE THROUGHOUT SHEAR CONTAINING MOSTLY PYRITE AND SOME CHALCOPYRITE.

'B' ZONE

CONSISTS OF MAFIC UNIT (UP TO 20M) INTERCALCULATED WITH RHYOLITE FLOWS. THE MAFIC UNIT IS STRONGLY FOLIATED ACCOMPANIED BY STRONG IRON CARBONATE ALTERATION AND VEINS AND PDS OF QUARTZ, SULPHIDE MINERALIZATION WITH QUARTZ + QUARTZ CAN CONTAIN UP TO 5% CHALCOPYRITE OR ARSENOPYRITE (QUARTZ CARBONATE VEINS THAT INTRUDE CARBONATE ALTERED BASALT HOST MASSIVE CHALCOPYRITE - PYRITE MINERALIZATION.)

KENORA - MINING DIV.
RECEIVED
MAR - 4 1995
AM PM
7 8 9 10 11 12 1 2 3 4 5 6

STRIPPING AND TRENCHING DAILY LOG

1995

LOCATION OF STRIPPING AND TRENCHING SKETCH ATTACHED

SKETCH OF TRENCHING AND SAMPLING SKETCH ATTACHED

DESCRIPTION OF SAMPLES

<u>SAMPLE NO.</u>	<u>TYPE OF SAMPLE</u>	<u>ROCK TYPE</u>	<u>MINERALIZATION</u>	<u>ASSAY RESULTS</u>
MAY 22 - 6B	6" CHIP	BASALT	MED. SULPHIDE	.487 P.P.B. AU
JUNE 8 - 7B	5" CHIP	BASALT	MED. SULPHIDE	.002 OZ. AU.
" 15 - 8B	4" CHIP	BASALT, CU, QTZ	MED. SULPHIDE	.46 OZ AU
" 19 - 11B	4" CHIP	BASALT	MED. SULPHIDE	.04 OZ AU
" 21 - 5B	5" CHIP	BASALT	MINOR SULPHIDE	.06 OZ AU
" 23 - 13B	3" CHIP	BASALT, QTZ.	MED. SULPHIDE	.22 OZ AU
" 26 - 3B	4" CHIP	BASALT	MINOR SULPHIDE	.118 P.P.B. AU
JULY 6 - 10B	6" CHIP	BASALT, QTZ, CU.	MED. SULPHIDE	.70 OZ. AU.
" 8 - 14C	4" CHIP	BASALT, QTZ, CU, FeAsS,	MED. SULPHIDE	3.08 OZ AU.
" 10 - 9B	4" CHIP	BASALT, QTZ.	MED. SULPHIDE	.07 OZ AU.
" 13 - 2B	4" CHIP	BASALT, QTZ, CU.	MED. SULPHIDE	.85 OZ AU.
" 17 - 15C	4" CHIP	RHYOLITE	MINOR SULPHIDE	.003 AU
" 19 - 10C	4" CHIP	BASALT, CU, FeAsS.	MED. SULPHIDE	2.47 OZ AU.
" 22 - 12C	5" CHIP	BASALT, QTZ, CU.	MED. SULPHIDE	.193 OZ AU.
" 24 - 4B	5" CHIP	BASALT, QTZ, CU.	MED. SULPHIDE	.24 OZ. AU.
" 29 - 13C	5" CHIP	BASALT, QTZ, CU, FeAsS	MED. SULPHIDE	4.06 OZ AU.
AUG 2 - 1B	5" CHIP	BASALT, QTZ, CU, FeAsS.	HEAVY SULPHIDE	7.26 OZ. AU.
" 4 - 8B	5" CHIP	BASALT, QTZ, CU.	MED. SULPHIDE	.46 OZ AU
" 11 - 9C	6" CHIP	BASALT	MED. SULPHIDE	.069 AU.
" 14 - 8C	5" CHIP	BASALT, QTZ, CU, FeAsS.	MED. SULPHIDE	3.7 OZ. AU.
" 17 - 5C	5" CHIP	BASALT, QTZ, CU, FeAsS	MED. SULPHIDE	8.2 OZ AU.
" 19 - 6C	5" CHIP	BASALT, QTZ, CU	MED. SULPHIDE	.91 OZ AU.

DESCRIPTION OF SAMPLES - CONT.

<u>SAMPLE NO</u>	<u>TYPE OF SAMPLE</u>	<u>Rock TYPE</u>	<u>MINERALIZATION</u>	<u>ASSAY RESULT</u>
AUG. 21-4C	4" CHIP	BASALT, QTZ, CO.	MED. SULPHIDE	.823 OZ. AU.
" 24-3C	4" CHIP	BASALT, QTZ	MED. SULPHIDE	.025 OZ. AU.
" 26-7C	5" CHIP	BASALT, QTZ.	MED. SULPHIDE	.178 OZ. AU.
" 28-1C	5" CHIP	BASALT, QTZ, CU.	MED. SULPHIDE	.069 OZ. AU.
SEPT. 11-1D	5" CHIP	BASALT, QTZ.	MINOR SULPHIDE	.008 OZ. AU.
" 14-2D	4" CHIP	BASALT, QTZ, CU.	MINOR SULPHIDE	.111 OZ. AU.
" 16-3D	4" CHIP	BASALT, QTZ, CO. FE ASS	MED. SULPHIDE	5.139 OZ. AU.
" 18-7D	4" CHIP	BASALT, QTZ.	MINOR SULPHIDE	.022 OZ. AU.
" 20-5D	6" CHIP	BASALT	MED. SULPHIDE	1.507 OZ. AU.

STRIPPING AND TRENCHING DAILY LOG

1995

<u>PROJECT AREA</u>	<u>DATE</u>	<u>WORK PERFORMED</u>
LITTLE TURTLE LAKE CLAIM 1050.574 ZONE 'A'	MAY 12/95	STRIP SOIL OVERBURDEN 1' PIT 21-A
	MAY 13/95	STRIP SOIL OVERBURDEN 1' PIT 21-B
	MAY 15/95	STRIP SOIL OVERBURDEN 1' PIT 21-A
	MAY 16/95	STRIP SOIL OVERBURDEN 1' PIT 21-B
	MAY 17/95	STRIP SOIL OVERBURDEN 1' PIT 21-B
	MAY 18/95	STRIP SOIL OVERBURDEN 1' PIT 21-A → 8A 147 PBAU → 6A 303 PBAU
	MAY 19/95	DRILL - BLAST PIT 21-B
	MAY 30/95	CLEAN OUT SAMPLE PIT 21-B 337A 50 PBAU
	SEPT 21/95	DRILL - BLAST PIT 21-B
	SEPT 23/95	DRILL - BLAST PIT 21-B
	" 25/95	CLEAN OUT SAMPLE PIT 24 - 60.000 02 AU
	" 28/95	STRIP NORTH CENTRAL PORTION PIT 24
	" 30/95	DRILL - BLAST NORTH CENTRAL PIT 24
	OCT 2/95	CLEAN OUT SAMPLE PIT 24 - 70.000 02 AU
	" 5/95	STRIP CENTRAL PORTION PIT 24
	" 6/95	DRILL - BLAST CENTRAL PORTION PIT 24
	" 7/95	CLEAN OUT SAMPLE PIT 24 - 80.001 02 AU
	" 8/95	STRIP SOUTH CENTRAL PORTION PIT 24
	" 10/95	DRILL - BLAST SOUTH CENTRAL PIT 24
	" 11/95	CLEAN OUT SAMPLE PIT 24 - 100.001 02 AU
	" 12/95	STRIP SOUTH END PIT 24
	" 14/95	DRILL - BLAST SOUTH END PIT 24
	" 15/95	CLEAN OUT SAMPLE PIT 24 - 110.001 02 AU
SEPT. 5/95	STRIP SOUTH CENTRAL PORTION PIT 23	
SEPT 24/95	DRILL - BLAST - SAMPLE 1-HOLE 4D.053 02 AU	

LOCATION OF STRIPPING & TRENCHING

SKETCH ATTACHED

SKETCH OF TRENCHING AND SAMPLING

SKETCH ATTACHED

DESCRIPTION OF SAMPLES

1995

PROJECT AREA LITTLE TURTLE LAKE CLAIM 1050574 ZONE 'A'

<u>SAMPLE NO</u>	<u>TYPE OF SAMPLE</u>	<u>ROCK TYPE</u>	<u>MINERALIZATION</u>	<u>ASSAY RESULT</u>
6-A	4" - CHIP	MAFIC TUFF + QUARTZ	MED SULPHIDE	303 P.P.B. AU
7-A	4" - CHIP	MAFIC TUFF + QUARTZ	MED SULPHIDE	50 P.P.B. AU
8-A	4" - CHIP	MAFIC TUFF + QUARTZ	MINOR SULPHIDE	14 P.P.B. AU
6-D	6" - CHIP	MAFIC TUFF + QUARTZ	MINOR SULPHIDE	.007 OZ AU.
7-D	8" - CHIP	MAFIC TUFF + QUARTZ	MED. SULPHIDE	.022 OZ AU.
9-D	6" - CHIP	MAFIC TUFF + QUARTZ	MINOR SULPHIDE	.001 OZ AU
10-D	6" - CHIP	MAFIC TUFF + QUARTZ	MINOR SULPHIDE	.001 OZ AU.
11-D	6" - CHIP	MAFIC TUFF + QUARTZ	MINOR SULPHIDE	.001 OZ AU.
4-D	6" - CHIP	MAFIC TUFF	HEAVY SULPHIDE	.053 OZ AU.

(8)

A ZONE

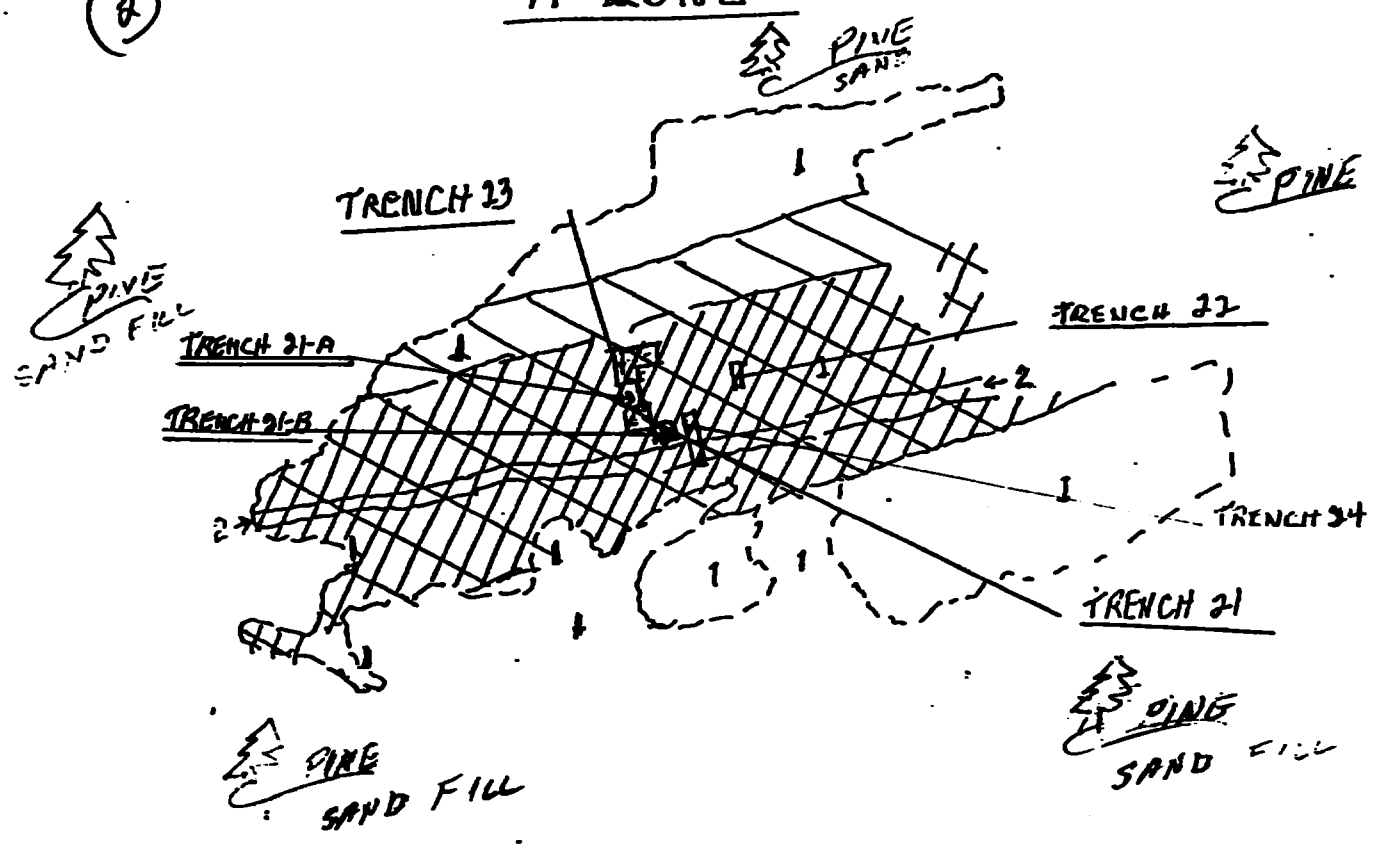

- 1 MAFIC VOLCANICS
- 2 MAFIC DYKE

MODERATELY TO STRONGLY FOLIATED
 MODERATE TO STRONG IRON CARBONATE ALTERATION

SCALE
 0 5 10
 METRES

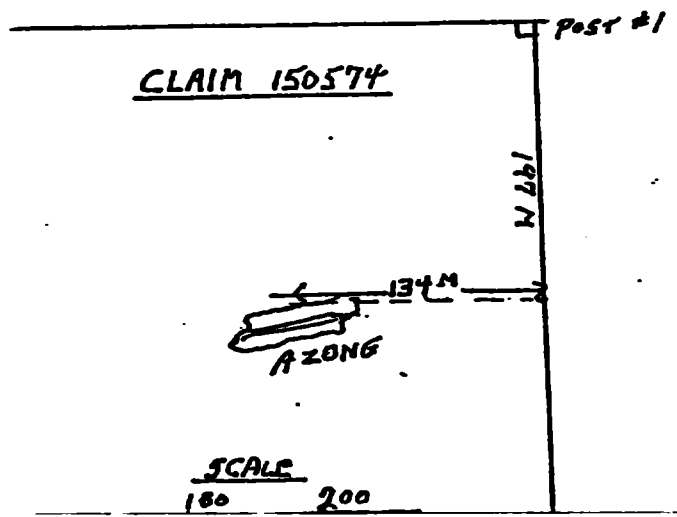

RAINY RIVER DISTRICT
COUSINEAU
 CLAIM NO. 1050574
 TOWNSHIP - LITTLE TURTLE 6-2682

3

SKETCH OF TRENCHING AND SAMPLING

LITTLE TURTLE LAKE G-2682

CLAIM 1050574

A-ZONE GOLD

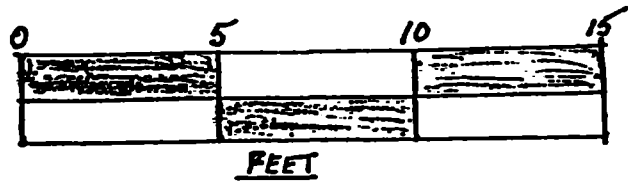

SCALE 1" = 5'

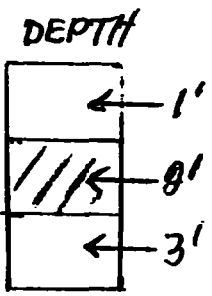
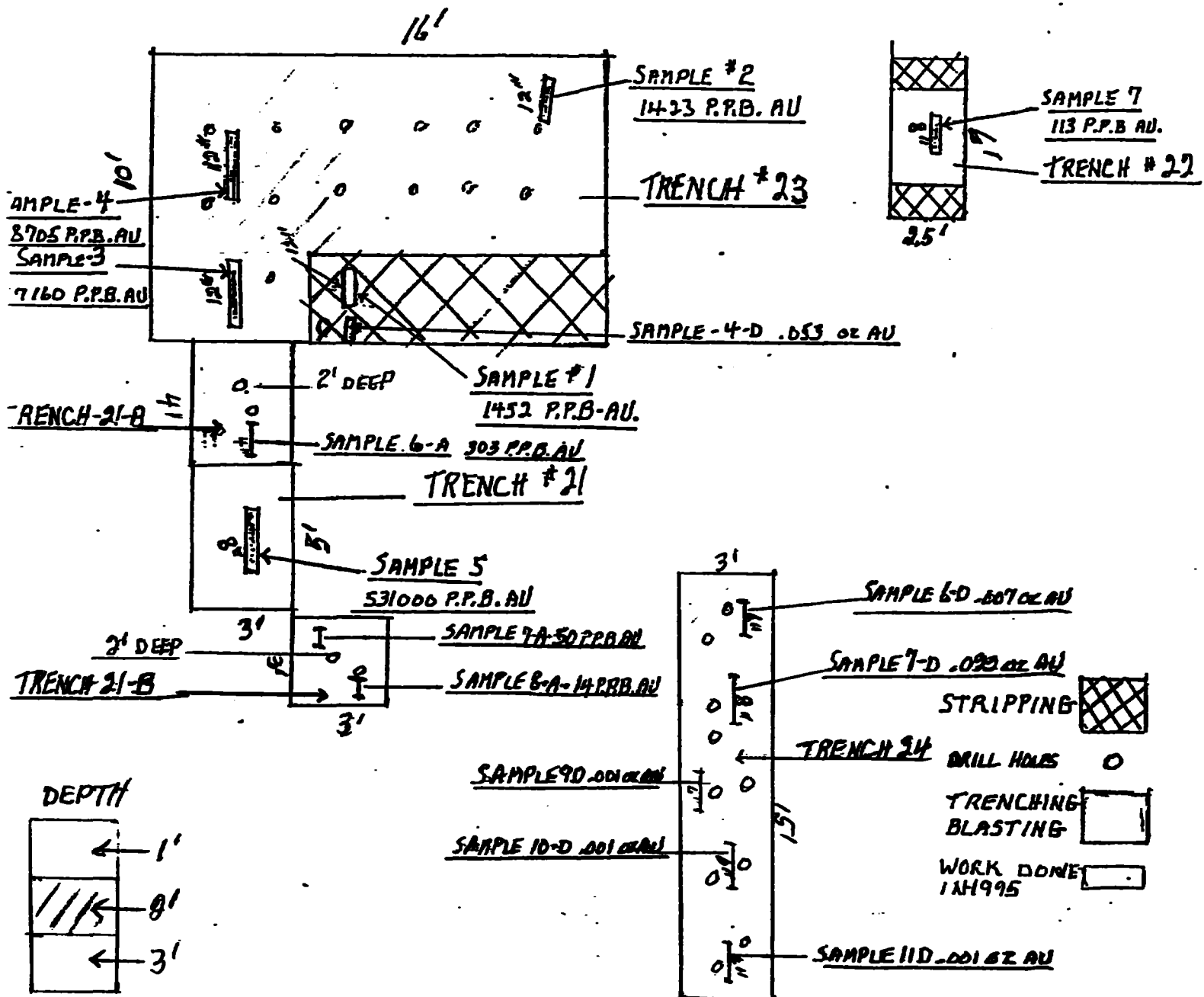

Activation Laboratories Ltd. Work Order: 8742 Report: 8581

Sample description	AU	AG	AS	BA	BR	CA	CO	CR	CS	YS	BT	BD	IN	MO	NA	NI	YS	SB	SC	SE	SH	SR	TA	TR
	PPM	PPM	PPM	PPM	PPM	PPM	PPM	PPM	PPM	PPM	PPM	PPM	PPM	PPM	PPM	PPM	PPM	PPM	PPM	PPM	PPM	PPM	PPM	PPM
1-B	24800	65	210	<100	<1	<1	880	<10	<2	17.4	4	<1	<1	<13	0.87	<180	<14	<0.2	1.0	<13	<0.12	<0.08	<1	<1.3
2-B	29100	5	14	<180	<1	<1	150	38	<2	14.4	3	<1	<1	18	0.13	<150	<18	0.2	6.7	<15	<0.02	<0.05	<1	3.8
3-B	178	<15	3	<180	<1	<1	38	200	<2	8.00	4	<1	<1	<15	1.27	<150	58	1.3	20	<15	<0.01	<0.05	<1	0.7
4-B	3240	<15	8	180	<1	<1	45	26	<2	3.53	<1	<1	<1	<15	<0.05	96	<18	0.2	2.6	5	<0.01	<0.05	<1	<0.5
5-B	3010	8	26	110	<1	<1	15	11	<2	4.64	5	<1	<1	<15	<0.05	<150	<18	0.3	2.3	4	<0.01	<0.05	<1	2.8
6-B	187	110	26	<180	<1	<1	88	67	<2	18.3	1	<1	<1	<15	<0.05	<150	<18	0.3	1.1	14	<0.01	<0.05	<1	<0.5
7-B	178	<15	2	<180	<1	<1	30	240	<2	8.59	3	<1	<1	<15	0.48	100	18	1.2	18	<15	<0.01	<0.05	<1	1.8
8-B	18800	6	28	<180	<1	<1	100	14	<2	4.36	<1	<1	<1	<15	<0.05	250	<18	<0.2	0.5	13	<0.01	<0.05	<1	<0.8
9-B	530	5	6	470	<1	<1	24	160	<2	5.74	3	<1	<1	<15	<0.05	110	84	0.3	11	<15	<0.01	<0.05	<1	1.1
10-B	3350	32	9	230	<1	<1	23	53	<2	8.53	1	<1	<1	<15	<0.05	<150	<18	0.3	4.6	22	<0.01	<0.05	<1	<0.5
11-B	24800	5	52	190	<1	<1	210	29	<2	6.54	<1	<1	<1	<15	<0.05	370	<18	0.4	3.5	30	<0.02	<0.05	<1	<0.5
12-B	3840	56	48	<180	<1	<1	140	23	<2	11.7	<1	<1	<1	<15	<0.05	<150	<18	<0.2	2.2	28	<0.01	<0.05	<1	<0.5
13-B	1500	26	160	<180	<1	<1	790	30	<2	20.7	<1	<1	<1	<15	<0.05	370	<18	<0.2	2.4	48	<0.02	<0.05	<1	<0.5
13-B	7310	5	68	<180	<1	<1	210	61	<2	11.8	1	<1	<1	<15	<0.05	150	<18	<0.2	5.4	22	<0.01	<0.05	<1	<0.5



ACCURASSAY LABORATORIES

A DIVISION OF ASSAY LABORATORY SERVICES INC.

1070 LITHIUM DRIVE, UNIT 2
THUNDER BAY, ONTARIO P7B 6G3
PHONE (807) 623-6448
FAX (807) 623-6820

Page 1

LOUIS COUSINEAU
P.O. BOX 33
FORT FRANCES, ONTARIO
P9A 3M5

September 8, 1995

Job #9541273

Accurassay	Sample # Customer	Gold ppb	Gold Oz/t
	1 - C	2358	0.069
	2 - C	41126	1.200
	3 - C	851	0.025
	4 - C	28212	0.823
	5 - C	281538	8.212
	6 - C	31184	0.910
	7 - C	6096	0.178
	8 - C	128235	3.741
	9 - C	2371	0.069
	10 - C	84706	2.471
	10 - C	82941	2.419
11	CHECK	54	0.002
	11 - C	6626	0.193
	12 - C	139412	4.067
	13 - C	105789	3.086
	14 - C	108	0.003
	15 - C		
	16		

Certified By:



Activation Laboratories Ltd. Work Order: 8253 Report: 8064

Sample description	AV	AG	AS	BA	BR	CA	CO	CR	CS	FE	KF	MG	IR	MO	NA	NI	RB	SB	SC	SE	SI	SR	TA	TE
	PPM	PPM	PPM	PPM	PPM	%	PPM	PPM	PPM	%	PPM	PPM	PPM	PPM	PPM	PPM	PPM	PPM	PPM	%	%	PPM	PPM	
1-A	28	<5	37	450	<1	<1	15	14	<2	13.2	17	<1	<5	8	7520	<50	65	0.4	3.9	<5	<0.01	<0.05	2	7.0
2-A	<5	<5	<2	410	2	6	44	49	<2	7.89	3.7	<1	<5	7	18800	<50	94	<0.2	26	<5	<0.02	<0.05	<1	1.8
3-A	<5	<5	3	630	<1	<1	<5	<10	<2	0.94	16	<1	<5	<5	10000	<50	50	0.3	1.9	<5	<0.01	<0.05	4	8.3
4-A	<5	<5	<2	310	<1	3	5	<10	<2	5.04	15	<1	<5	<5	21900	<50	65	0.2	7.0	<5	<0.01	<0.05	2	6.1
5-A	<5	<5	86	360	<1	9	39	290	<2	8.11	2.0	<1	<5	<5	9750	210	42	0.5	36	<5	<0.01	<0.05	<1	0.6
6-A	303	<5	<2	160	<1	9	42	85	<2	13.6	2.3	<1	<5	<5	4350	<50	<30	0.5	14	<5	<0.01	<0.05	<1	2.0
7-A	50	<5	2	<100	<1	4	39	180	<2	12.5	2.6	<1	<5	<5	13000	<50	<30	0.6	34	<5	<0.01	<0.05	<1	0.7
8-A	14	<5	<2	<100	2	<1	7	21	<2	2.34	<0.5	<1	<5	<5	2250	<50	<30	<0.2	6.0	<5	<0.01	<0.05	<1	0.5



ACCURASSAY LABORATORIES

A DIVISION OF ASSAY LABORATORY SERVICES INC.

1070 LITHIUM DRIVE, UNIT 2
THUNDER BAY, ONTARIO P7B 6G3
PHONE (807) 623-6448
FAX (807) 623-6820
Page 1

LOUIS COUSINEAU
P.O. BOX 33
FORT FRANCES, ONTARIO
P9A 3M5

October 17, 1995

Job #9541603

Accurassay	Sample # Customer	Palladium ppb	Gold ppb	Gold Oz/t	Platinum ppb
	1-D		267	0.008	
	2	2-D	3811	0.111	
	3	3-D	176176	5.139	
	4	4-D	1808	0.053	<15
	5	5-D	51656	1.507	
	6	6-D	253	0.007	
	7	7-D	771	0.022	
	8	8-D	83	0.002	<15
	9	9-D	35	0.001	<15
	10	10-D	14	<0.001	<15
	11 Check	10-D	20	<0.001	<15
	12	11-D	15	<0.001	<15
	13	12-D	12318	0.359	
	14	13-D	161	0.005	
	15	14-D	312	0.009	

Certified By:

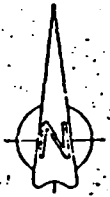

Little Turtle Lake

Little

Turtle

River

LOT OVER AREA

GOLD SHOWING

Canadian National Rail

HEPC

HIGHWAY

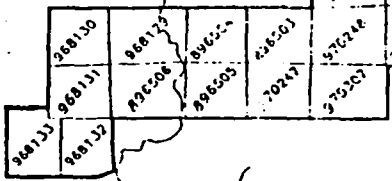
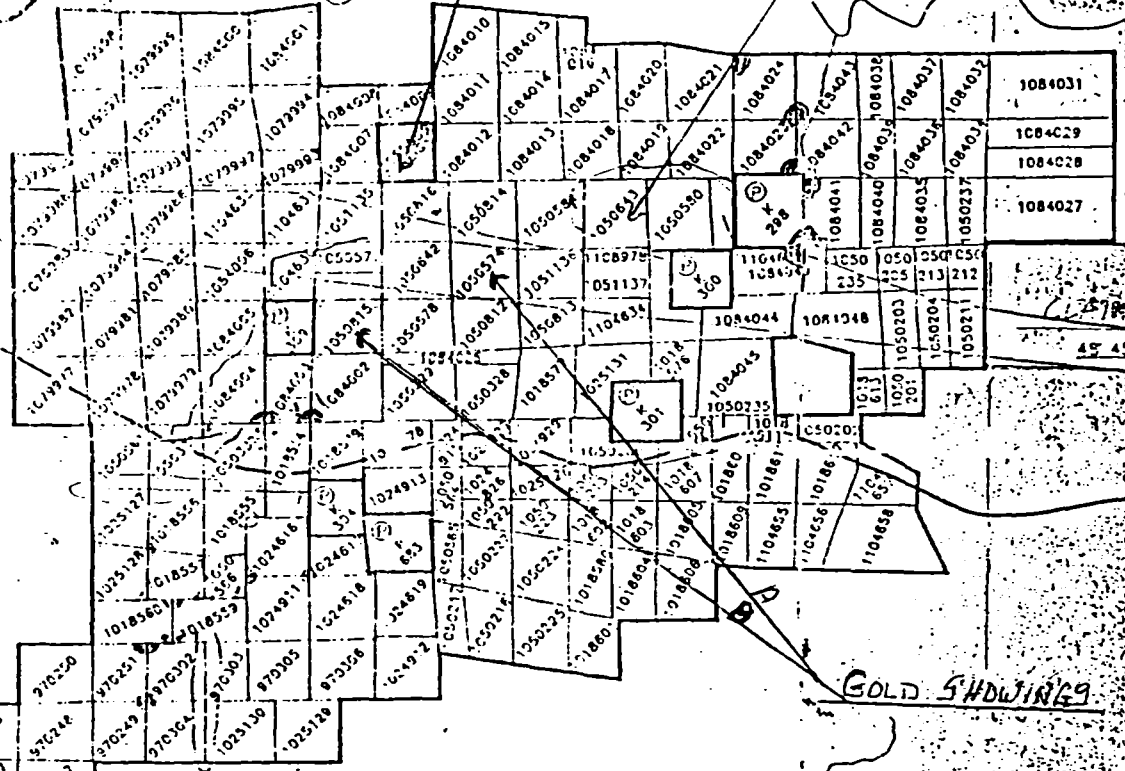

Note: ie 1025129 = K 1025129

COUSINEAU CLAIM GROUP
LITTLE TURTLE LAKE TWP.
BAD VERNILION LAKE TWP

GOLD SHOWING

Shoal Lake

Seine

River

COUSINEAU
 ONTARIO
 Claim Location Map

SCALE 1:50,000

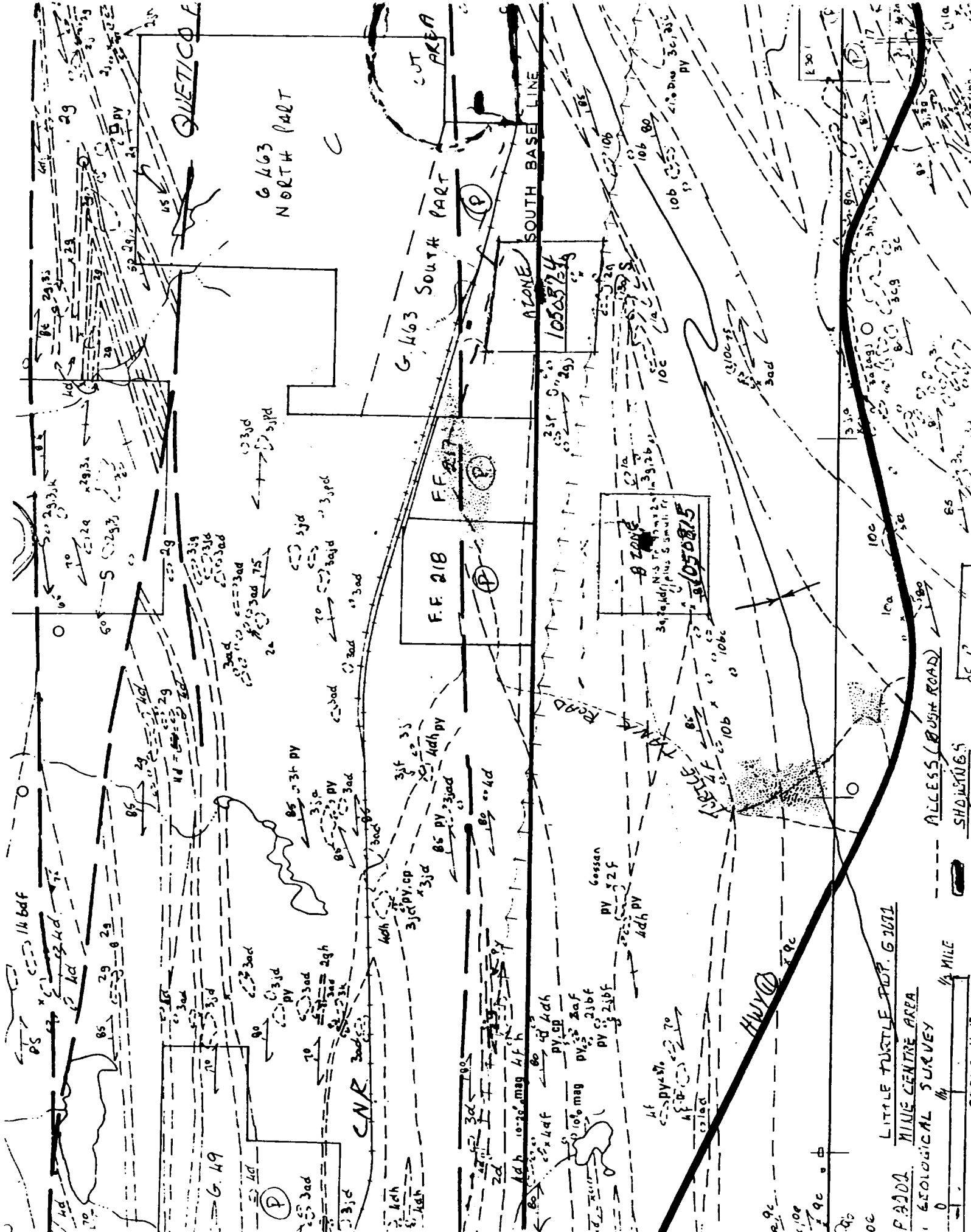

G. 463
NORTH PART

G. 463
SOUTH PART

ALONE
SOUTH BASE LINE

F.F. 218

F.F. 217

1050875

B ZONE

1050875

CNR

TURTLE HANA ROAD

ACCESS (BUSH ROAD)

HWY 100

LITTLE TURTLE PROP. G. 2071

P. 2000
MINE CENTRE AREA

GEOLOGICAL SURVEY

SCALE 1:50,000
1/4 MILE
1/8 MILE

SHOWINGS

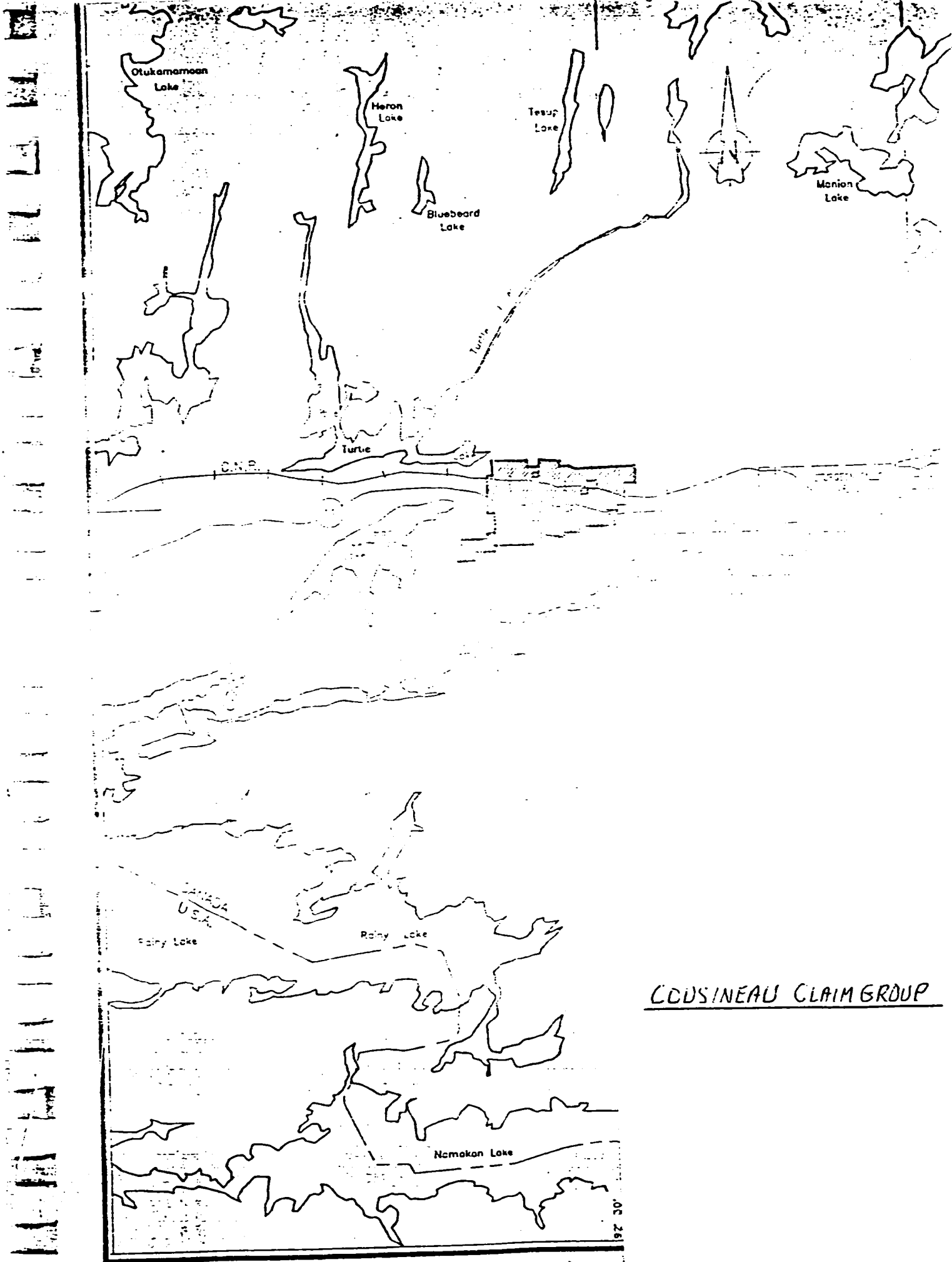

CODSINEAU CLAIM GROUP

TIME SHEET.

OUR NUMBER	063486
DATE	May 22/95 - Sept 20/95
CUSTOMER'S ORDER	
SALESMAN	
TERMS	
F.O.B.	

SOLD TO RAY & LOUIS COUSINEAU
 TIME SHEET - P.O. Box 33
 SHIPPED TO FORT FRANCES, ONT. P4A 3P25
 ADDRESS LITTLE TURTLE LAKE - BUCOE VIA CLAIM 1050815

INVOICE

1995	May 22				
	June 7, 8, 14, 15, 18, 19, 20, 21, 22, 23, 25, 26				
	July 5, 6, 7, 8, 9, 10, 12, 13, 16, 17, 18, 19, 21, 22, 23, 24, 28, 29				
	Aug 1, 2, 3, 4, 9, 10, 11, 13, 14, 16, 17, 18, 19, 20, 21, 23, 24, 25, 26, 27, 28				
	Sept 10, 11, 13, 14, 15, 16, 17, 18, 19, 20				
	TOTAL 67 DAYS				

BROWNLINE B32

SOLD TO Edward Cousineau
 SHIPPED TO Little Turtle Lake Claim 1050574
 ADDRESS "A" zone VIA _____

CUSTOMER'S ORDER	
DATE	
TERMS	
F.O.B.	

INVOICE

Aug 17/95	1 day pluggers	A ZONE	8-10 ³⁰	1-5 ³⁰	39.00
Aug 19/95	1 day pluggers	"	"	"	39.00
Sept 23	1 day pluggers	"	"	"	39.00
Sept 24	1 day pluggers	"	"	"	39.00
Sept 30	1 day pluggers	"	"	"	39.00
Oct 6	1 day pluggers	"	"	"	39.00
Oct 10	1 day pluggers	"	"	"	39.00
Oct 14	1 day pluggers	"	"	"	39.00
OPERATORS - LOUIS COUSINEAU - RAY COUSINEAU					312.00
Three Copco Pluggers rental includes gas, oil					
Bike, tools, fuel @ 29¢ per day					

TIME SHEET.

OUR NUMBER	063486
DATE	May 22/95 - Sept 20/95
CUSTOMER ORDER	
SALESMAN	
TERMS	
F.O.B.	

SOLD TO RAY & LOUIS COUSINEAU
TIME SHEET - P.O. Box 33
 SHIPPED TO FORT FRANCES, ONT. P4R 3P5
 ADDRESS LITTLE TURTLE LAKE - BICONE VIA CLIPIN 1050815

INVOICE

1995	May 22			
	June 7, 8, 14, 15, 18, 19, 20, 21, 22, 23, 25, 26			
	July 5, 6, 7, 8, 9, 10, 12, 13, 16, 17, 18, 19, 21, 22, 23, 24, 28, 29			
	Aug 1, 2, 3, 4, 9, 10, 11, 13, 14, 16, 17, 18, 19, 20, 21, 23, 24, 25, 26, 27, 28			
	Sept 10, 11, 13, 14, 15, 16, 17, 18, 19, 20			
	TOTAL 62 DAYS			

BROWNLINE 832

OUR NUMBER	063488
DATE	Oct 15/95
CUSTOMER ORDER	
SALESMAN	
TERMS	
F.O.B.	

SOLD TO Edward Cousineau
 SHIPPED TO Little Turtle Lake Claim 1050815
 ADDRESS "A" zone VIA

INVOICE

May 17/95	1 day plunger	A ZONE	8-12 ³⁰	1-5 ³⁰	34.00
May 19/95	1 day plunger	"	"	"	34.00
Sept 23	1 day plunger	"	"	"	34.00
Sept 24	1 day plunger	"	"	"	34.00
Sept 30	1 day plunger	"	"	"	34.00
Oct 6	1 day plunger	"	"	"	34.00
Oct 16	1 day plunger	"	"	"	34.00
Oct 14	1 day plunger	"	"	"	34.00
CREATED BY RAY & LOUIS COUSINEAU					212.00

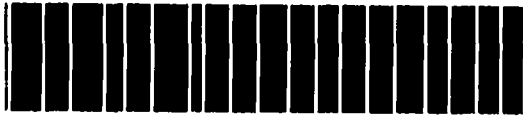

52C16SW0011 W9610-00028 BENNETT LAKE

020

063489

SOLD TO Edward Cousineau

SHIPPED TO Little Turtle Lake Canada 1050594
ADDRESS A ZONE VIA

NO. 063489
DATE 02/15/95
ENTERED BY
DESCRIPTION
QUANTITY
PRICE
TOTAL

INVOICE

Aug 17/95	1 day plugger	A ZONE	8-12 ³⁰	1-5 ³⁰	39.00
18/95	1 " "	"	"	"	39.00
Sept 23/95	1 " "	"	"	"	39.00
Sept 24/95	1 " "	"	"	"	39.00
Sept 30/95	1 " "	"	"	"	39.00
Oct 6/95	1 " "	"	"	"	39.00
Oct 10/95	1 " "	"	"	"	39.00
Oct 14/95	1 " "	"	"	"	39.00
					317.00
<p>Other Costs Plugger rental, includes: gas, oil, bits, tools ect. @ 39⁰⁰ per day</p> <p>Operators LOUIS COUSINEAU - RAY COUSINEAU</p>					

EPSON 7600

SHIPPED TO FORT FRANCES, ONT. P4A 3P5
ADDRESS LITTLE TURTLE LAKE - BZONE VIA CLIPIN 1050815

TERMS
FOB

INVOICE

1995	May 22				
	June 7, 8, 14, 15, 18, 19, 20, 21, 23, 25, 26				
	July 5, 6, 7, 8, 9, 10, 12, 13, 16, 17, 18, 19, 21, 22, 23, 24, 28, 29				
	Aug 1, 2, 3, 4, 9, 10, 11, 13, 14, 16, 17, 18, 19, 20, 21, 23, 24, 25, 26, 27, 28				
	Sept 10, 11, 13, 14, 15, 16, 17, 18, 19, 20				
TOTAL		62 DAYS			

BROWNLINE 832

111

REPORT OF THE NATURE OF THE ROCKS

'A' ZONE

SHEAR ZONE UP TO 30 METRES WIDE AND TENDING
N⁶⁰W. HOSTED BY INTERBEDDED TUFF & FLOWS WITH
MINOR INTERBEDDED LHERC. ALTERATION CONSISTS OF
CHORLITE - IRON CARBONATE AND SILICIFICATION UP
TO 10% MEDIUM OF COARSE GRAINED PYRITE PRES
MINERALIZED QUARTZ VEINS 1 TO 3" WIDE THROUGHOUT
SHEAR CONTAINING MOSTLY PYRITE AND SOME
CHALCOPYRITE.

B' ZONE

CONSISTS OF MAFIC UNIT (UP TO 30M)
INTERCALCULATED WITH RHYOLITE FLOWS.
THE MAFIC UNIT IS STRONGLY FOLIATED
ACCOMPANIED BY STRONG IRON CARBONATE ALTERATION
AND VEINS AND PODS OF QUARTZ, SULPHIDE
MINERALIZATION WITH QUARTZ + QUARTZ CAN
CONTAIN UP TO 5% CHALOPYRITE + BISSOPYRITE
(QUARTZ CARBONATE VEINS THAT INTRUDE
CARBONATE ALTERED BASALT HOST MASSIVE
CHALCOPYRITE - PYRITE MINERALIZATION.)

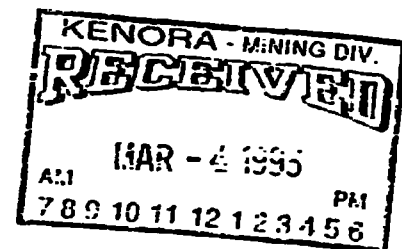

STRIPPING AND TRENCHING DAILY LOG

1995

LOCATION OF STRIPPING AND TRENCHING SKETCH ATTACH.

SKETCH OF TRENCHING AND SAMPLING SKETCH ATTACH.

DESCRIPTION OF SAMPLES

SAMPLE NO.	TYPE OF SAMPLE	ROCK TYPE	MINERALIZATION	ASSAY RESULT
MAY 22 - 6B	6" CHIP	BASALT	MED. SULPHIDE	.487 P.P.B. AU
JUNE 8 - 7B	5" CHIP	BASALT	MED. SULPHIDE	.002 OZ. AU.
" 15 - 8B	4" CHIP	BASALT, CU, QTZ.	MED. SULPHIDE	.46 OZ AU
" 19 - 11B	4" CHIP	BASALT	MED. SULPHIDE	.04 OZ AU.
" 21 - 5B	5" CHIP	BASALT	MINOR SULPHIDE	.06 OZ AU
" 23 - 13B	3" CHIP	BASALT, QTZ.	MED. SULPHIDE	.22 OZ AU
" 26 - 3B	4" CHIP	BASALT	MINOR SULPHIDE	.118 P.P.B. AU
JULY 6 - 10B	6" CHIP	BASALT, QTZ, CU.	MED. SULPHIDE	.70 OZ AU.
" 8 - 14C	4" CHIP	BASALT, QTZ, CU, FeAsS,	MED. SULPHIDE	3.08 OZ AU.
" 10 - 9B	4" CHIP	BASALT, QTZ.	MED. SULPHIDE	.07 OZ AU.
" 13 - 2B	4" CHIP	BASALT, QTZ, CU.	MED. SULPHIDE	.85 OZ AU.
" 17 - 15C	4" CHIP	RHYOLITE	MINOR SULPHIDE	.003 AU
" 19 - 10C	4" CHIP	BASALT, CU, FeAsS	MED. SULPHIDE	2.47 OZ AU.
" 22 - 12C	5" CHIP	BASALT, QTZ, CU.	MED. SULPHIDE	.193 OZ AU.
" 24 - 4B	5" CHIP	BASALT, QTZ, CU.	MED. SULPHIDE	.24 OZ. AU.
" 29 - 13C	5" CHIP	BASALT, QTZ, CU, FeAsS	MED. SULPHIDE	4.06 OZ AU.
AUG 2 - 1B	5" CHIP	BASALT, QTZ, CU, FeAsS.	HEAVY SULPHIDE	7.26 OZ. AU.
" 4 - 8B	5" CHIP	BASALT, QTZ. CU.	MED. SULPHIDE	.46 OZ AU
" 11 - 9C	6" CHIP	BASALT	MED. SULPHIDE	.069 AU.
" 14 - 8C	5" CHIP	BASALT, QTZ, CU, FeAsS.	MED. SULPHIDE	3.7 OZ. AU.
" 17 - 5C	5" CHIP	BASALT, QTZ, CU, FeAsS	MED. SULPHIDE	8.2 OZ AU.
" 19 - 11C	5" CHIP	BASALT, QTZ, CU, FeAsS	MED. SULPHIDE	1.1 OZ AU.

DESCRIPTION OF SAMPLES - CONT.

<u>SAMPLE NO</u>	<u>TYPE OF SAMPLE</u>	<u>ROCK TYPE</u>	<u>MINERALIZATION</u>	<u>ASSAY RESULT</u>
AUG. 21-4C	4" CHIP	BASALT, QTZ, CU.	MED. SULPHIDE	.823 OZ. AU.
" 24-3C	4" CHIP	BASALT, QTZ	MED. SULPHIDE	.025 OZ. AU.
" 26-7C	5" CHIP	BASALT, QTZ.	MED. SULPHIDE	.178 OZ. AU.
" 28-1C	5" CHIP	BASALT, QTZ, CU.	MED. SULPHIDE	.069 OZ. AU.
SEPT. 11-1D	5" CHIP	BASALT, QTZ.	MINOR SULPHIDE	.008 OZ. AU.
" 14-2D	4" CHIP	BASALT, QTZ, CU.	MINOR SULPHIDE	.111 OZ. AU.
" 16-3D	4" CHIP	BASALT, QTZ, CO. FE ASS.	MED. SULPHIDE	5.139 OZ. AU.
" 18-7D	4" CHIP	BASALT, QTZ.	MINOR SULPHIDE	.022 OZ. AU.
" 20-5D	6" CHIP	BASALT	MED. SULPHIDE	1.507 OZ. AU.

1995

MPING AND TRENCHING DAILY LOG

<u>ECT AREA</u>	<u>DATE</u>	<u>WORK PERFORMED</u>
<u>18 RESULTS</u>	<u>TURTLE LAKE</u>	<u>MAY 22/95</u>
<u>33 oz. AU.</u>	<u>1 1050815</u>	<u>JUNE 7/95</u>
<u>225 oz. AU.</u>	<u>2 NE B</u>	<u>" 8/95</u>
<u>78 oz. AU.</u>		<u>" 14/95</u>
<u>69 oz. AU.</u>		<u>" 15/95</u>
<u>208 oz. AU.</u>		<u>" 18/95</u>
<u>111 oz. AU.</u>		<u>" 19/95</u>
<u>5,139 oz. AU.</u>		<u>" 20/95</u>
<u>.022 oz. AU.</u>		<u>" 21/95</u>
<u>1,507 oz. AU.</u>		<u>" 22/95</u>
		<u>" 23/95</u>
		<u>" 25/95</u>
		<u>" 26/95</u>
	<u>JULY 5/95</u>	<u>STRIP PIT 61 OF OVERBURDEN - 1'</u>
	<u>" 6/95</u>	<u>STRIP PIT 61 - SAMPLE 10-B .70 oz AU</u>
	<u>" 7/95</u>	<u>STRIP PIT 65 - OVERBURDEN - 1'</u>
	<u>" 8/95</u>	<u>STRIP PIT 65 - SAMPLE 14-C 3.08 AU</u>
	<u>" 9/95</u>	<u>STRIP PIT 64 - overburden N. 2 1/2' DEEP</u>
	<u>" 10/95</u>	<u>STRIP PIT 64 - SAMPLE 9-B .07 oz AU</u>
	<u>" 12/95</u>	<u>STRIP PIT 64 - overburden N. 3 1/2' DEEP</u>
	<u>" 13/95</u>	<u>STRIP PIT 64 - SAMPLE 2-B .85 oz AU</u>
	<u>" 16/95</u>	<u>STRIP ANHYDRITE AREA 6'x4'x16' PIT 64 - 6" DEEP</u>
	<u>" 17/95</u>	<u>STRIP " " SAMPLE 15-C .003 AU</u>
	<u>" 18/95</u>	<u>STRIP PIT 65 - OVERBURDEN - 6" DEEP</u>
	<u>" 19/95</u>	<u>STRIP PIT 65 - SAMPLE 10-C 2.47 oz AU</u>
	<u>" 21/95</u>	<u>STRIP PIT 65 - overburden - 1' DEEP</u>
	<u>" 22/95</u>	<u>STRIP PIT 65 - SAMPLE 12C - .193 oz AU</u>
	<u>" 23/95</u>	<u>STRIP PIT 60 - OVERBURDEN 1' DEEP</u>
	<u>" 24/95</u>	<u>STRIP PIT 60 - SAMPLE 43 - .24 oz AU</u>
	<u>" 28/95</u>	<u>STRIP PIT 65 - OVERBURDEN - 1' DEEP</u>
	<u>" 29/95</u>	<u>STRIP PIT 65 - SAMPLE 13C - 4.26 AU</u>

STRIPPING AND TRENCHING DAILY LOG

<u>PROJECT AREA</u>	<u>DATE</u>	<u>WORK PERFORMED</u>
<u>LITTLE TURTLE LAKE</u>	AUG. 1/95	STRIP PIT 56 OVERBURDEN 1.5' DEEP
<u>CLAIM 1050815</u>	" 2/95	STRIP PIT 56 - SAMPLE 1B 7.26 OZ AU.
<u>ZONE B</u>	" 3/95	STRIP PIT 64 OVERBURDEN 2.5' DEEP
	" 4/95	STRIP PIT 64 - SAMPLE 8A .46 OZ AU
	" 9/95	BLASTING LARGE ROCK PIT 64
	" 10/95	DRILL - 2.10' PIT 69 STRIP + BLAST - 32' WEST PIT 62
	" 11/95	PIT 69 STRIP + SAMPLE " 9C .069 AU
	" 13/95	STRIP PIT 64 OVERBURDEN 3' DEEP
	" 14/95	STRIP PIT 64 SAMPLE 8-C 3.7 OZ AU
	" 16/95	STRIP PIT 60 OVERBURDEN 1.5' DEEP
	" 17/95	STRIP + SAMPLE PIT 60 - 5C 8.2 OZ AU
	" 18/95	DRILLING PIT 60
	" 19/95	STRIPPING - SAMPLING PIT 60 * 6C .91 OZ AU
	" 20/95	DRILLING PIT 56
	" 21/95	STRIP PIT 56 SAMPLE * 4C .873 OZ AU.
	" 23/95	DRILLING PIT 64
	" 24/95	STRIP PIT 64 SAMPLE 3C .075 OZ AU
	" 25/95	DRILLING PIT 64
	" 26/95	STRIP PIT 64 SAMPLE * 7C .178 OZ AU.
	" 27/95	DRILLING PIT 56
	" 28/95	STRIP PIT 56 SAMPLE * 1C .069 OZ AU
	SEPT 10/95	STRIPPING TIE 10'S PIT 64
	" 11/95	STRIP - SAMPLE " # 1D .008 OZ AU. 3-10-95
	" 12/95	DRILL - 20' EAST PIT 65
	" 14/95	STRIP + SAMPLE " # 2D .111 OZ AU
	" 15/95	DRILL - PIT 64
	" 16/95	STRIP PIT 64 SAMPLE # 3D 5.139 OZ AU.
	" 17/95	STRIPPING - 60' E 10' N PIT 54 BY BUSH ROAD
	" 18/95	STRIP " SAMPLE * 7D .022 OZ AU.
	" 19/95	DRILLING & BLASTING 12' SOUTH PIT 65
	" 20/95	STRIP " SAMPLE 5D 1.57 AU

STRIPPING AND TRENCHING DAILY LOG

1995

<u>PROJEC AREA</u>	<u>DATE</u>	<u>WORK PERFORMED</u>
LITTLE TURTLE LAKE CLAIM 1050.574 ZONE 'A'	MAY 12/95	...
	MAY 13/95	...
	MAY 15/95	...
	MAY 16/95	...
	MAY 17/95	...
	MAY 18/95	...
	MAY 19/95	...
	MAY 20/95	...
	SEPT 21/95	...
	SEPT 23/95	...
	" 25/95	...
	" 28/95	...
	" 30/95	...
	OCT 2/95	...
	" 5/95	...
	" 6/95	...
	" 7/95	...
	" 8/95	...
	" 10/95	...
	" 11/95	...
" 12/95	...	
" 14/95	...	
" 15/95	...	
SEPT. 5/95	...	
SEPT 24/95	...	

LOCATION OF STRIPPING & TRENCHING

SKETCH ATTACHED

SKETCH OF TRENCHING AND SAMPLING

SKETCH ATTACHED

SKETCH OF TRENCHING & SAMPLING

DATE: _____
UP DATE: OCT. 1978

LITTLE TURTLE LAKE - CLAIM 1050815 B-ZONE GOLD

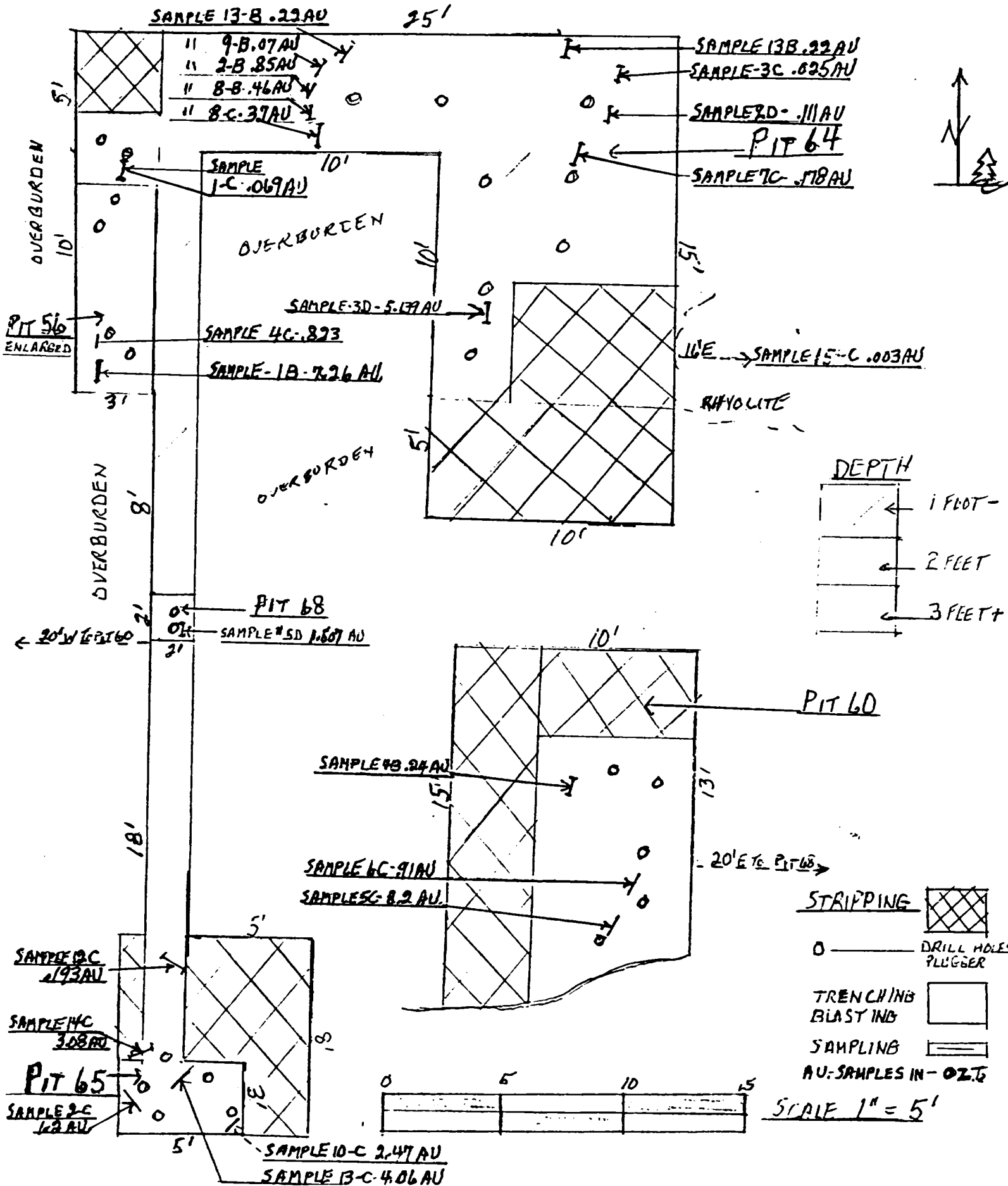

3

SKETCH OF TRENCHING AND SAMPLING

LITTLE TURTLE LAKE G-2682

CLAIM 1050574

A-ZONE GOLD

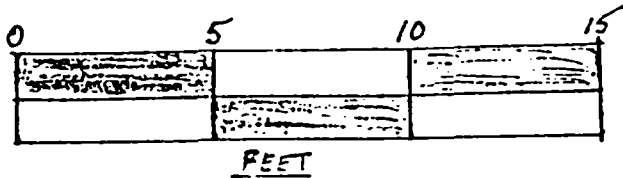

SCALE 1" = 5'

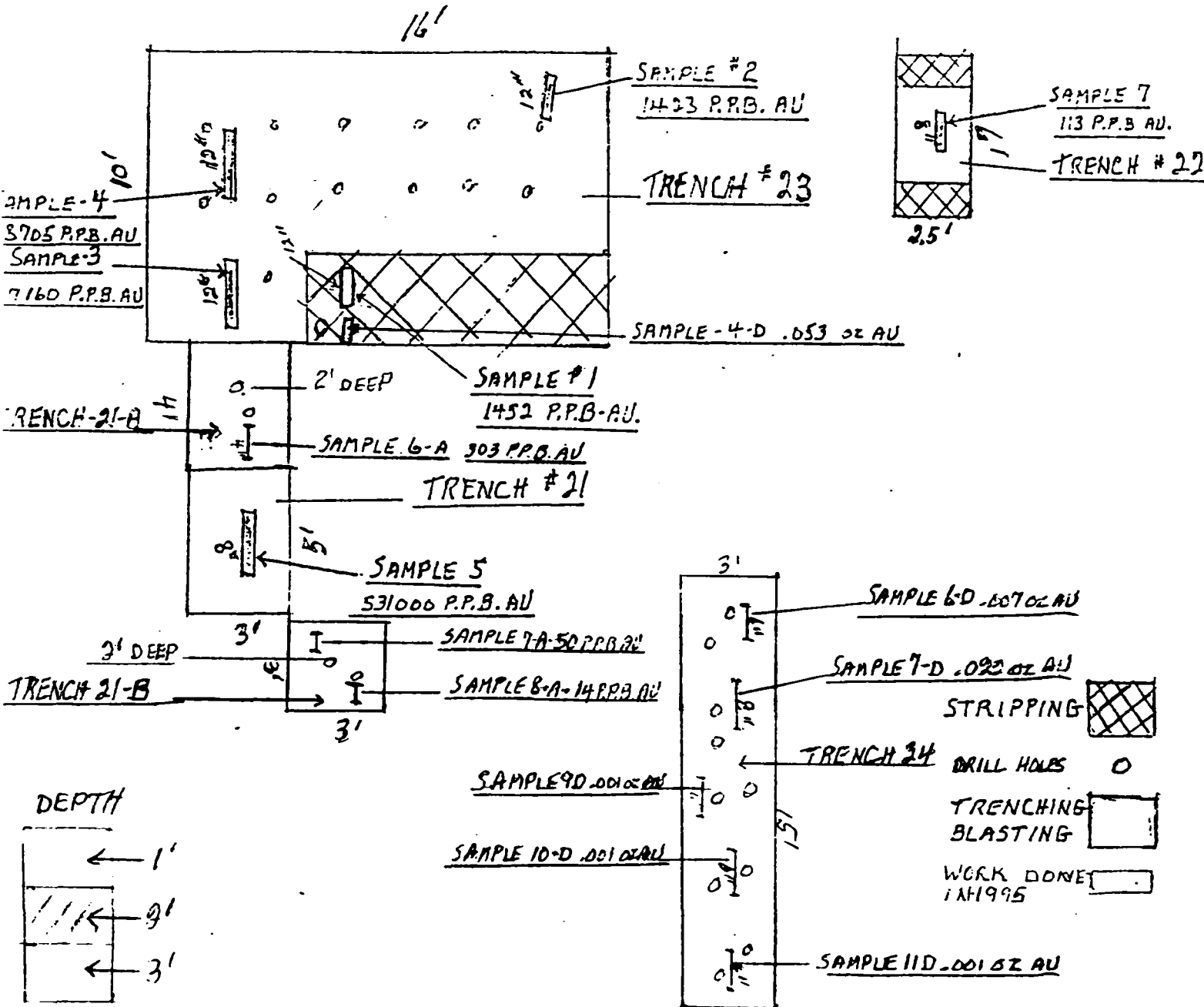

WORK DONE 1/11/95

REVISED 1995
 UPDATE OCT. 1995

LOCATION OF STRIPPING & TRENCHING

(4)

SCRUB BRUSH
 SAND FILL
 PINE
 POPULAR

SCRUB BRUSH
 SAND FILL
 PINE
 POPULAR

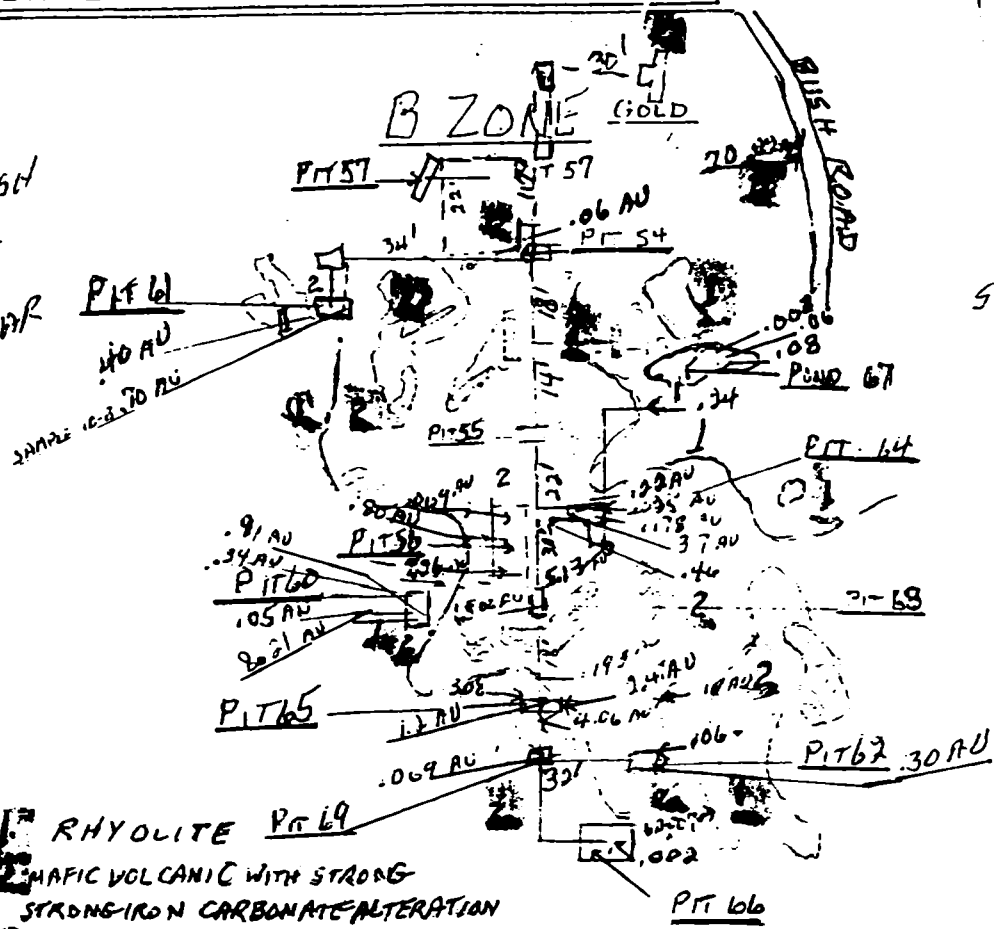

- RHYOLITE
 - MAGMATIC VOLCANIC WITH STRONG STRONG-IRON CARBONATE ALTERATION
 - ⊙ PITS + TRENCHES - PA>T
 - NEW PITS & TRENCHES
 - CONTACT - OBSERVED
 - CONTACT - INFERRED UNDER OVERBURDEN
 - QUARTZ VEIN
- NOTE - STRIP ZONE IS SURROUNDED BY SAND

SCRUB BRUSH
 SAND FILL
 PINE
 POPULAR

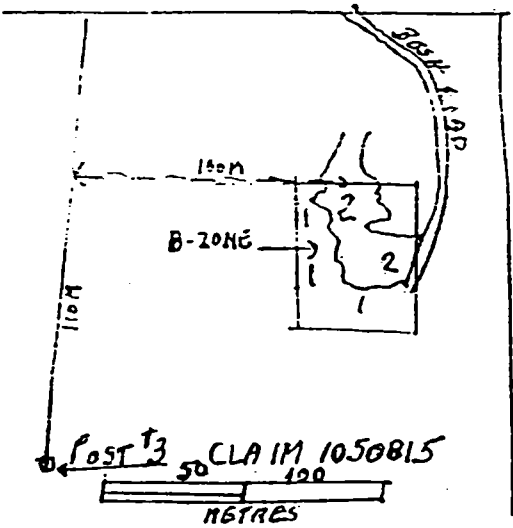
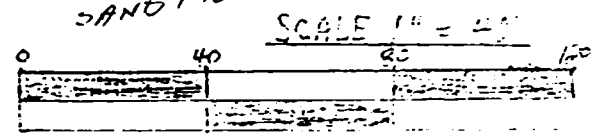

RAINIER RIVER DISTRICT
 COUSINEAU -
 CLAIM No. 1050815
 TOWNSHIP LITTLE TURTLE G2682

SKETCH OF TRENCHING + SAMPLING

LITTLE TURTLE LAKE - CLAIM 1050815 - B ZONE

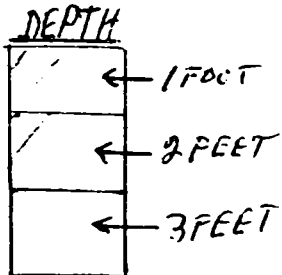
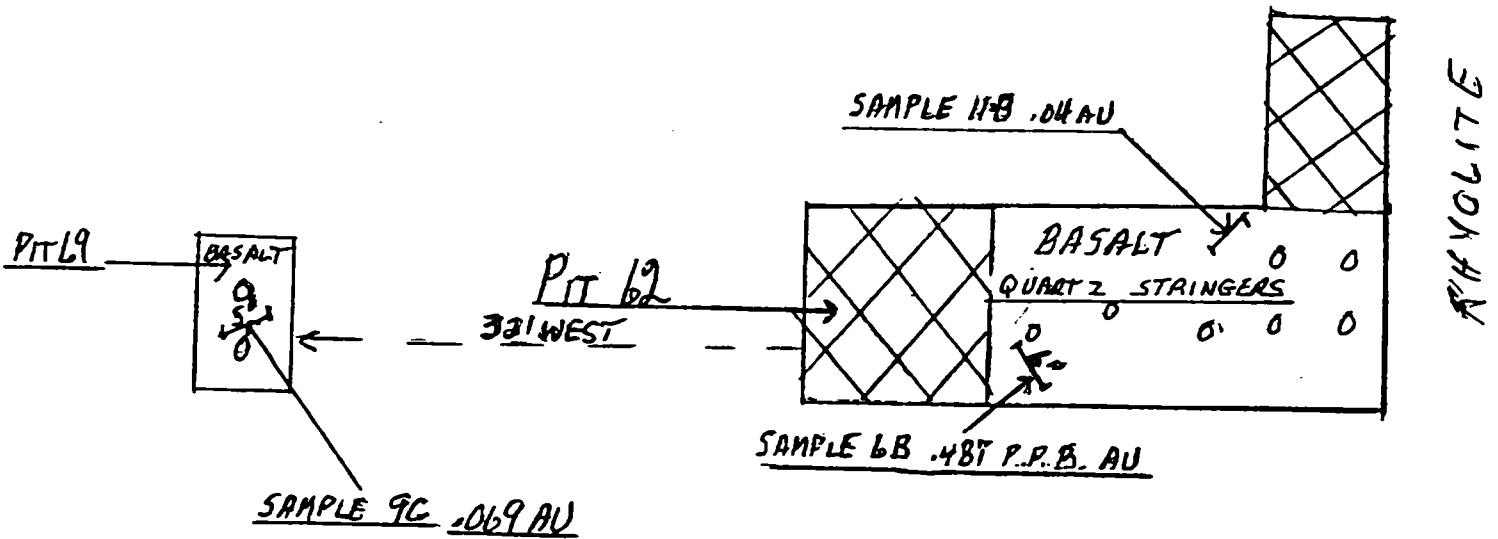
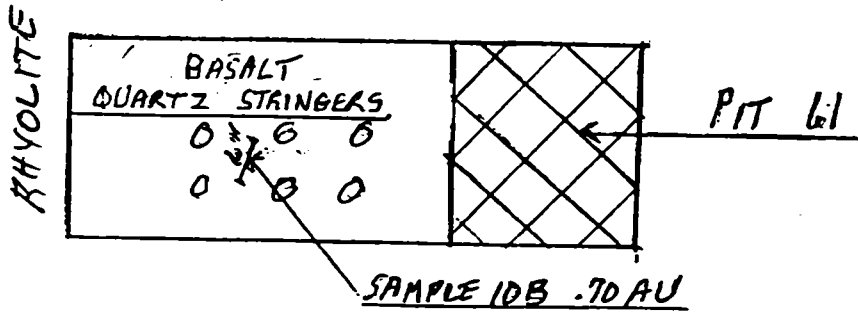
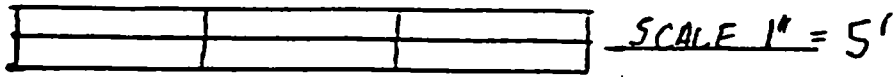

Activation Laboratories Ltd. Work Order: 8742 Report: 8581

Sample description	AU PPM	AG PPM	BA PPM	BR PPM	CA %	CO PPM	CR PPM	CS PPM	YR %	MP PPM	UG PPM	TR PPM	MO PPM	KA %	NI PPM	PB PPM	SB PPM	SC PPM	BR PPM	SM %	SR %	TA PPM	TH PPM
1-B	249000	210	<200	<2	<4	880	<20	<2 17.4		4	<5	<5	<13 0.07		<180	<34	<0.2	1.0	<13	<0.12	<0.08	<1	<1.1
2-B	291000	14	<100	<1	<1	150	39	<2 14.4		3	<1	<5	<5 19 0.13		<50	<30	0.2	6.7	<5	<0.03	<0.05	<1	3.0
3-B	118	3	<100	<1	5	38	200	<2 5.00		4	<1	<5	<5 1.27		<50	50	1.3	20	<5	<0.01	<0.05	<1	0.1
4-B	8260	8	100	<1	2	45	26	<2 3.59		<1	<1	<5	<5 <0.05		96	<30	0.2	2.6	5	<0.01	<0.05	<1	<0.5
5-B	2030	8	110	<1	2	15	11	<2 4.64		5	<1	<5	<5 <0.05		<50	<30	0.3	1.3	6	<0.01	<0.05	<1	2.8
6-B	187	26	<100	<1	<1	88	67	<2 18.9		1	<1	<5	<5 <0.05		<50	<30	0.3	7.1	44	<0.01	<0.05	<1	<0.5
7-B	15	2	<100	<1	6	30	140	<2 8.99		3	<1	<5	<5 0.49		100	30	1.2	15	<5	<0.01	<0.05	<1	1.0
8-B	15100	26	<100	<1	<1	100	14	<2 4.36		<1	<1	<5	<5 <0.05		280	<30	<0.2	0.5	13	<0.01	<0.05	<1	<0.5
9-B	530	6	470	<1	<1	74	160	<2 5.74		3	<1	<5	<5 <0.05		110	54	0.3	13	<5	<0.01	<0.05	<1	1.1
10-B	2590	9	230	<1	1	23	53	<2 8.52		1	<1	<5	<5 <0.05		<50	<30	0.3	4.6	22	<0.01	<0.05	<1	<0.5
11-B	24000	5	52	190	<1	210	20	<2 6.54		<1	<1	<5	<5 <0.05		370	<30	0.4	3.5	20	<0.02	<0.05	<1	<0.5
12-B	1340	58	45	<100	<1	140	23	<2 11.7		<1	<1	<5	<5 <0.05		<50	<30	<0.2	2.2	28	<0.01	<0.05	<1	<0.5
13-B	15100	26	160	<100	<1	790	30	<2 20.7		<1	<1	<5	<5 <0.05		370	<30	<0.2	2.4	48	<0.03	<0.05	<1	<0.5
14-B	1510	5	68	<100	<1	310	62	<2 11.8		1	<1	<5	<5 <0.05		350	<30	<0.2	3.4	22	<0.01	<0.05	<1	<0.5



ACCURASSAY LABORATORIES

A DIVISION OF ASSAY LABORATORY SERVICES INC.

1070 LITHIUM DRIVE, UNIT 2
THUNDER BAY, ONTARIO P7B 6G3
PHONE (807) 623-6448
FAX (807) 623-6820

Page 1

LOUIS COUSINEAU
P.O. BOX 33
FORT FRANCES, ONTARIO
P9A 3M5

September 8, 1995

Job #9541273

Accurassay	Sample # Customer	Gold ppb	Gold Oz/t
	1 - C	2358	0.069
	2 - C	41126	1.200
	3 - C	851	0.025
	4 - C	28212	0.823
	5 - C	281538	8.212
	6 - C	31184	0.910
	7 - C	6096	0.178
	8 - C	128235	3.741
	9 - C	2371	0.069
	10 - C	84706	2.471
	11 CHECK	82941	2.419
	11 - C	54	0.002
	12 - C	6626	0.193
	13 - C	139412	4.067
	14 - C	105789	3.086
	15 - C	108	0.003

Certified By: _____

Chris Bever

Activation Laboratories Ltd. Work Order: 8253 Report: 8064

Sample description	AU PPB	AG PPM	AS PPM	BA PPM	BR PPM	CA %	CO PPM	CR PPM	CS PPM	FE %	HF PPM	HG PPM	IR PPB	MO PPM	NA PPM	NI PPM	RB PPM	SB PPM	SC PPM	SE %	SN %	SR %	TA PPM	TH PPM
1-A	28	<5	37	450	<1	<1	15	14	<2	13.2	17	<1	<5	8	7520	<50	65	0.4	3.9	<5	<0.01	<0.05	2	7.0
2-A	<5	<5	<2	410	2	6	44	49	<2	7.89	3.7	<1	<5	7	18600	<50	94	<0.2	26	<5	<0.02	<0.05	<1	1.8
3-A	<5	<5	3	630	<1	<1	<5	<10	<2	0.94	16	<1	<5	<5	10000	<50	50	0.3	1.9	<5	<0.01	<0.05	4	8.3
4-A	<5	<5	<2	310	<1	3	5	<10	<2	5.04	15	<1	<5	<5	21900	<50	65	0.2	7.0	<5	<0.01	<0.05	2	6.1
5-A	<5	<5	86	360	<1	9	39	230	<2	8.11	2.0	<1	<5	<5	9750	210	42	0.5	36	<5	<0.01	<0.05	<1	0.6
6-A	303	<5	<2	160	<1	9	42	85	<2	13.6	2.3	<1	<5	<5	4350	<50	<30	0.5	14	<5	<0.01	<0.05	<1	2.0
7-A	50	<5	2	<100	<1	4	39	180	<2	12.5	2.6	<1	<5	<5	13000	<50	<30	0.6	34	<5	<0.01	<0.05	<1	0.7
8-A	14	<5	<2	<100	2	<1	7	21	<2	2.36	<0.5	<1	<5	<5	2250	<50	<30	<0.2	6.0	<5	<0.01	<0.05	<1	0.5



ACCURASSAY LABORATORIES

A DIVISION OF ASSAY LABORATORY SERVICES INC.

1070 LITHIUM DRIVE, UNIT 2
THUNDER BAY, ONTARIO P7B 5G3
PHONE (807) 623-6448
FAX (807) 623-6820
Page 1

LOUIS COUSINEAU
P.O. BOX 33
FORT FRANCES, ONTARIO
P9A 3M5

October 17, 1995

Job #9541603

Accurassay	Sample # Customer	Palladium ppb	Gold ppb	Gold Oz/t	Platinum ppb
	1-D	1-D		267	0.008
	2	2-D		3811	0.111
	3	3-D		176176	5.139
	4	4-D	29	1808	0.053
	5	5-D		51656	1.507
	6	6-D		253	0.007
	7	7-D		771	0.022
	8	8-D	<10	83	0.002
	9	9-D	<10	35	0.001
	10	10-D	<10	14	<0.001
	11 Check	10-D	<10	20	<0.001
	12	11-D	<10	15	<0.001
	13	12-D		12318	0.359
	14	13-D		161	0.005
	15	14-D		312	0.009

Certified By: 

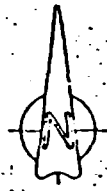

Little Turtle Lake

Little Turtle

GOLD SHOWING

River

LOT OVER AREA

Canadian National Road

HIGHWAY

48 45

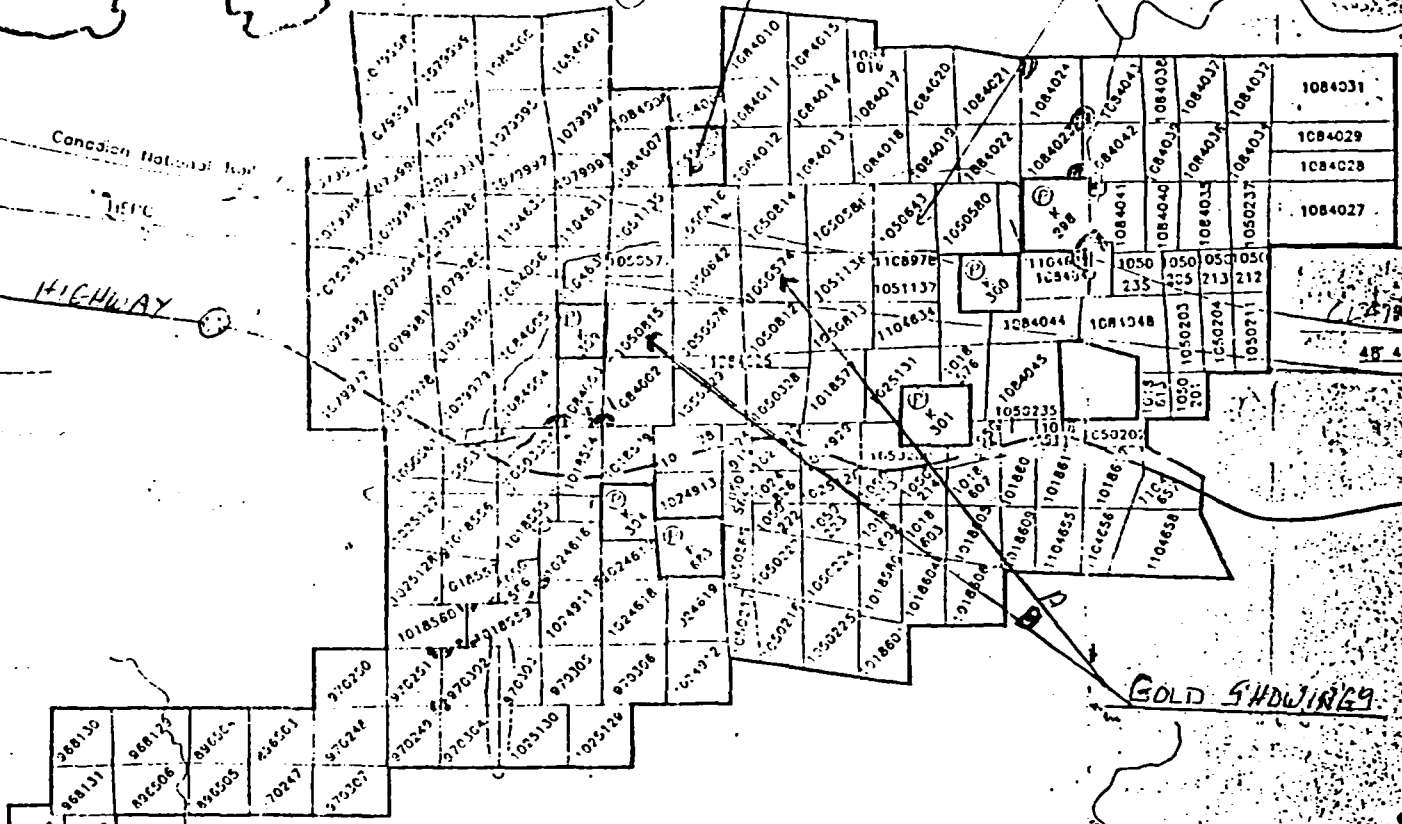

Note: ie 1025129 = K 1025129

COUSINEAU CLAIM GROUP
LITTLE TURTLE LAKE TWP.
BAD VERNILION LAKE TWP.

COUSINEAU
 ONTARIO
 Claim Location Map

SCALE 1:50,000

OCT. 4, 1990 52C/10,15

Shoni Lake

Seine River

2202 LITTLE HUSTLE PROP. G 3111
MINI CENTRE AREA
GEOLOGICAL SURVEY

ACCESS (ROUGH ROAD)

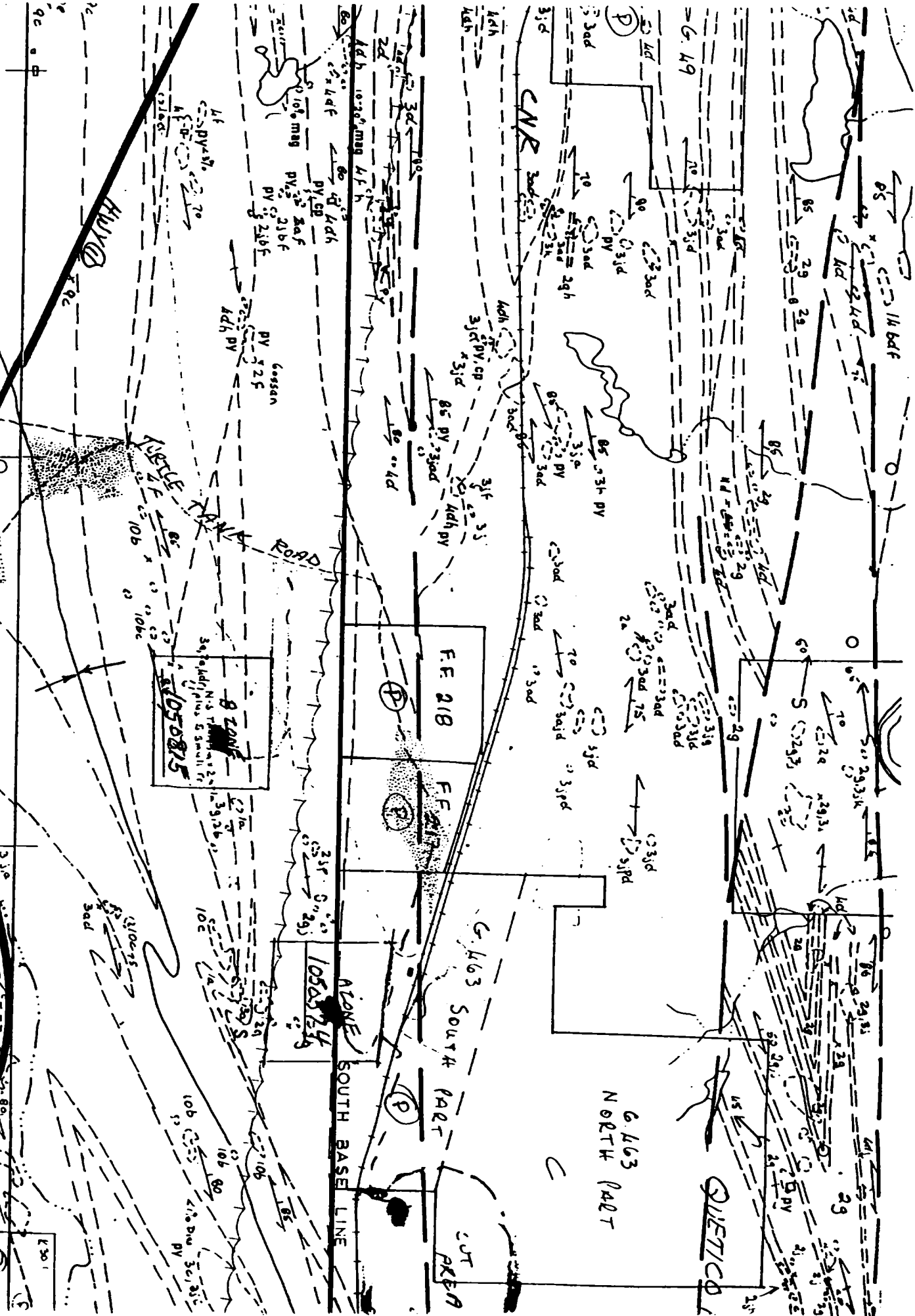

7501

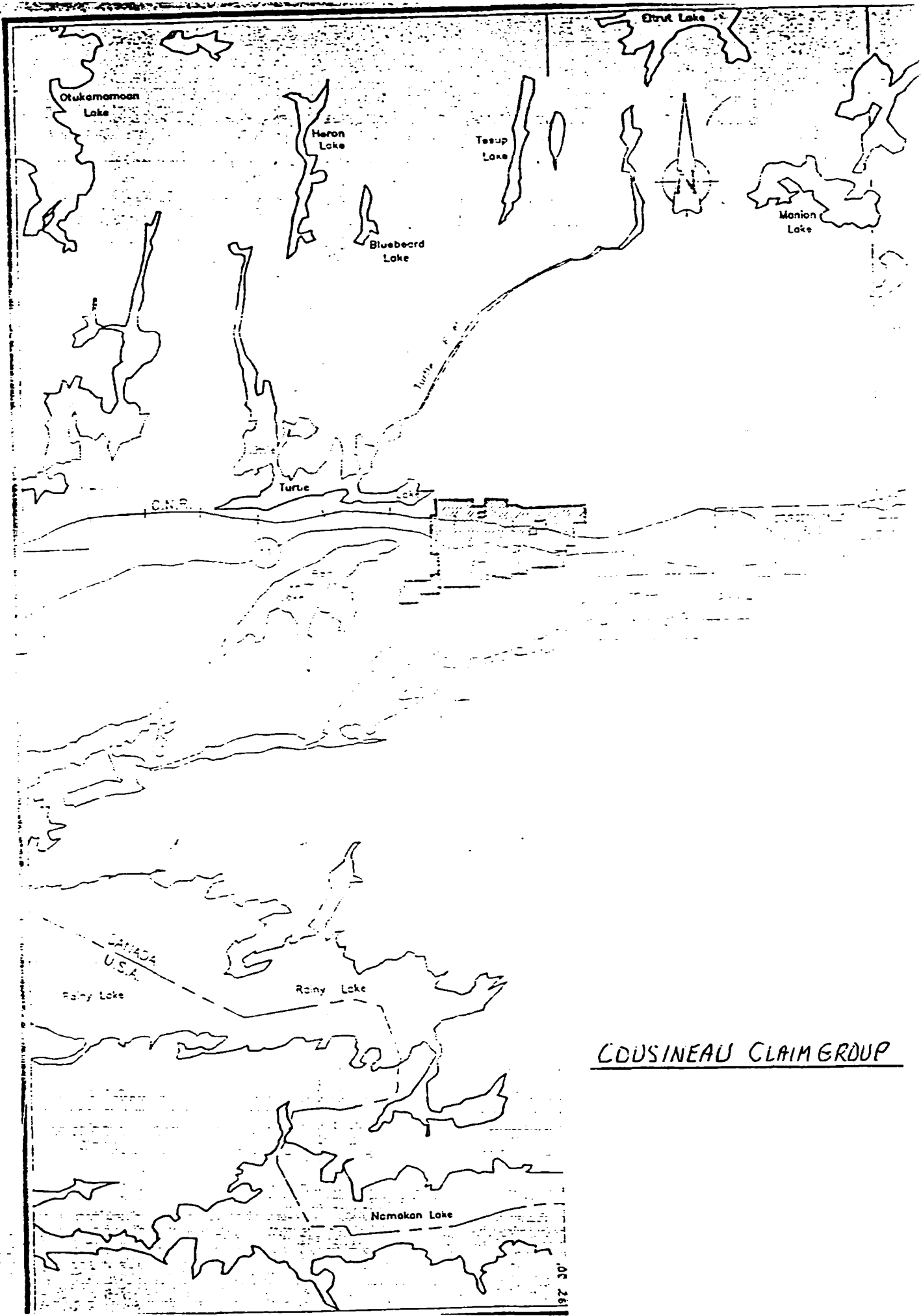

COUSINEAU CLAIM GROUP

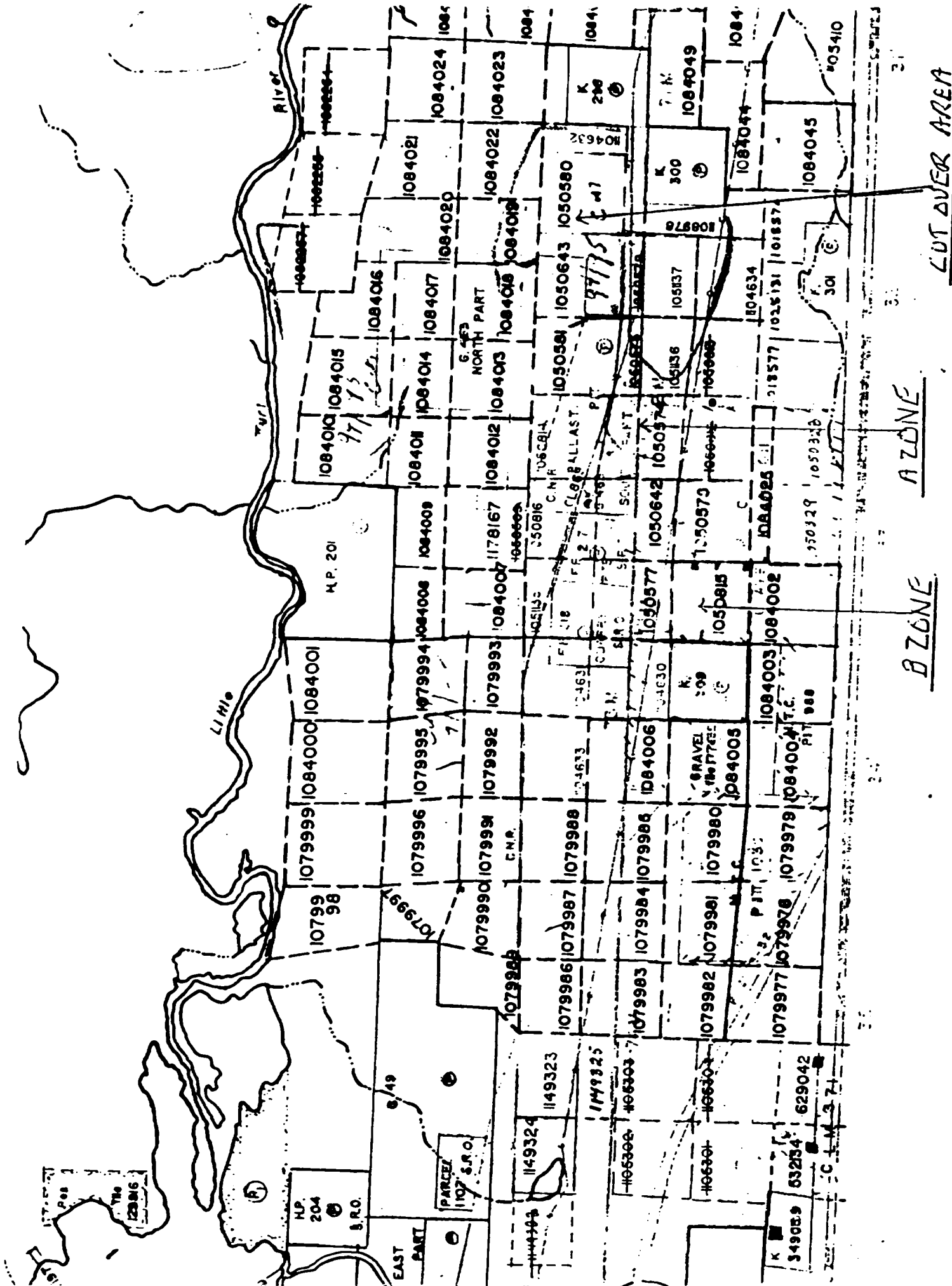

RIVER

LI HIE

M.P. 201

EAST PART

NORTH PART

A ZONE

B ZONE

CUT OVER AREA

1079999 1084000 1084001

1079998

1079997

1079996

1079995

1079994

1079993

1079992

1079991

1079990

1079989

1079988

1079987

1079986

1079985

1079984

1079983

1079982

1079981

1079980

1079979

1079978

1079977

1079976

1079975

1079974

1079973

1079972

1079971

1079970

1079969

1079968

1079967

1079966

1079965

1079964

1079963

1079962

1079961

1079960

1079959

1079958

1079957

1079956

1079955

1079954

1079953

1079952

1079951

1079950

1079949

1079948

1079947

1079946

1079945

1079944

1079943

1079942

1079941

1079940

1079939

1079938

1079937

1079936

1079935

1079934

1079933

1079932

1079931

1079930

1079929

1079928

1079927

1079926

1079925

1079924

1079923

1079922

1079921

1079920

1079919

1079918

1079917

1079916

1079915

1079914

1079913

1079912

1079911

1079910

1079909

1079908

1079907

1079906

1079905

1079904

1079903

1079902

1079901

1079900

1079899

1079898

1079897

1079896

1079895

1079894

1079893

1079892

1079891

1079890

1079889

1079888

1079887

1079886

1079885

1079884

1079883

1079882

1079881

1079880

1079879

1079878

1079877

1079876

1079875

1079874

1079873

1079872

1079871

1079870

1079869

1079868

1079867

1079866

1079865

1079864

1079863

1079862

1079861

1079860

1079859

1079858

1079857

1079856

1079855

1079854

1079853

1079852

1079851

1079850

1079849

1079848

1079847

1079846

1079845

1079844

1079843

1079842

1079841

1079840

1079839

1079838

1079837

1079836

1079835

1079834

1079833

1079832

1079831

1079830

1079829

1079828

1079827

1079826

1079825

1079824

1079823

1079822

1079821

1079820

1079819

1079818

1079817

1079816

1079815

1079814

1079813

1079812

1079811

1079810

1079809

1079808

1079807

1079806

1079805

1079804

1079803

1079802

1079801

1079800

1079799

1079798

1079797

1079796

1079795

1079794

1079793

1079792

1079791

1079790

1079789

1079788

1079787

1079786

1079785

1079784

1079783

1079782

1079781

1079780

1079779

1079778

1079777

1079776

1079775

1079774

1079773

1079772

1079771

1079770

1079769

1079768

1079767

1079766

1079765

1079764

1079763

1079762

1079761

1079760

1079759

1079758

1079757

1079756

1079755

1079754

1079753

1079752

1079751

1079750

1079749

1079748

1079747

1079746

1079745

1079744

1079743

1079742

1079741

1079740

1079739

1079738

1079737

1079736

1079735

1079734

1079733

1079732

1079731

1079730

1079729

1079728

1079727

1079726

1079725

1079724

1079723

1079722

1079721

1079720

1079719

1079718

1079717

1079716

1079715

1079714

1079713

1079712

1079711

1079710

1079709

1079708

1079707

1079706

1079705



Ministry of
Northern Development
and Mines
Ontario

Report of Work Conducted After Recording Claim

Mining Act

Transaction Number

W/9610 00028
ERLIS

Personal information collected on this form is obtained under the authority of the Mining Act. This information will be used for correspondence. Questions about this collection should be directed to the Provincial Manager, Mining Lands, Ministry of Northern Development and Mines, Sudbury, Ontario, P3E 6A5, telephone (705) 670-7264.

- Instructions:
- Please type or print and submit in duplicate.
 - Refer to the Mining Act and Regulations for re Recorder.



52C16SW0011 W9610-00028 BENNETT LAKE

900

- A separate copy of this form must be completed for each work group.
- Technical reports and maps must accompany this form in duplicate.
- A sketch, showing the claims the work is assigned to, must accompany this form.

Recorded Holder(s) EDWARD COUSINEAU / Louis Cousineau	Client No. 121596 / 121624
Address 430 1st St. E (P.O. Box 33) Fort Frances, Ont. P9A 3H5	Telephone No. 807-274-3761
Mining Division KENORA	M or G Plan No. G2667
Township/Area LITTLE TURTLE LAKE	G2682
Date Work Performed From: May 12 / 95	To: Oct. 15 / 95

Work Performed (Check One Work Group Only)

Work Group	Type
Geotechnical Survey	
Physical Work, including Drilling	<input checked="" type="checkbox"/> Physical Work
Rehabilitation	
Other Authorized Work	SECTION IS ONLY
Assays	
Assignment from Reserve	

Total Assessment Work Claimed on the Attached Statement of Costs \$ **10 267.00**

Note: The Minister may reject for assessment work credit all or part of the assessment work submitted if the recorded holder cannot verify expenditures claimed in the statement of costs within 30 days of a request for verification.

Persons and Survey Company Who Performed the Work (Give Name and Address of Author of Report)

Name	Address
LOUIS COUSINEAU	P.O. Box 33, Fort Frances, Ont. P9A 3H5
RAY COUSINEAU	430 1st St (P.O. Box 33) Fort Frances, Ont. P9A 3H5

(attach a schedule if necessary)

Certification of Beneficial Interest * See Note No. 1 on reverse side

I certify that at the time the work was performed, the claims covered in this work report were recorded in the current holder's name or held under a beneficial interest by the current recorded holder.	Date Jan 29 / 96	Recorded Holder or Agent (Signature) <i>Louis Cousineau</i>
--	----------------------------	--

Certification of Work Report

I certify that I have a personal knowledge of the facts set forth in this Work report, having performed the work or witnessed same during and/or after its completion and annexed report is true.		
Name and Address of Person Certifying LOUIS COUSINEAU P.O. Box 33 Fort Frances, Ont. P9A 3H5		
Telephone No. 807-274-3761	Date Jan 29 / 96	Certified By (Signature) <i>Louis Cousineau</i>

For Office Use Only

Total Value Cr. Recorded \$ 10 267.00	Date Recorded FEB. 8, 1996	Mining Recorder <i>Louis Cousineau</i>	Received Stamp KENORA - MINING DIV. RECEIVED FEB - 8 1996 AM 7 8 9 10 11 12 1 2 3 4 5 6 PM
	Deemed Approval Date MAY 8, 1996	Date Approved APRIL 11, 1996	
	Date/Notice for Amendments Sent FEB 23, 1996 (AMENDMENTS due APRIL 5, 1996)		



Statement of Costs
for Assessment Credit

État des coûts aux fins
du crédit d'évaluation

Mining Act/Loi sur les mines

Transaction No./N° de transaction

W9610.00028

Personal information collected on this form is obtained under the authority of the Mining Act. This information will be used to maintain a record and ongoing status of the mining claim(s). Questions about this collection should be directed to the Provincial Manager, Minings Lands, Ministry of Northern Development and Mines, 4th Floor, 159 Cedar Street, Sudbury, Ontario P3E 6A5. telephone (705) 670-7264.

Les renseignements personnels contenus dans la présente formule sont recueillis en vertu de la Loi sur les mines et serviront à tenir à jour un registre des concessions minières. Adresser toute question sur la collecte de ces renseignements au chef provincial des terrains miniers, ministère du Développement du Nord et des Mines, 159, rue Cedar, 4^e étage, Sudbury (Ontario) P3E 6A5, téléphone (705) 670-7264.

1. Direct Costs/Coûts directs

Type	Description	Amount Montant	Totals Total global
Wages Salaires	Labour 25 DAYS Main-d'oeuvre 25 JEN	600.5 RBY	3750 5750
	Field Supervision Supervision sur le terrain		
Contractor's and Consultant's Fees Droits de l'entrepreneur et de l'expert- conseil	Type		
Supplies Used Fournitures utilisées	Type ASSAYS 4X 1738 @ 2.60	156.00	56.00
	15 STICKS FERGITE	31.00	39.00
	201-BLANK QST	11.00	11.00
	2 FUSES @ 4.77	38.00	32.00
Equipment Rental Location de matériel	Type PLOUGH ATLAS CEPLC		
	2 DAYS @ 37.00	37.2	37.20
Total Direct Costs Total des coûts directs			8056

2. Indirect Costs/Coûts indirects

** Note: When claiming Rehabilitation work Indirect costs are not allowable as assessment work.
Pour le remboursement des travaux de réhabilitation, les coûts indirects ne sont pas admissibles en tant que travaux d'évaluation.

Type	Description	Amount Montant	Totals Total global
Transportation Transport	Type TRUCK 141 KM @ 30		
	25 DAYS @	42.30	257.00
Food and Lodging Nourriture et hébergement	TRUCK 25 @ 14.00	350	700.00
	2005 25 @ 14.00	350	
Mobilization and Demobilization Mobilisation et démobilisation			
Sub Total of Indirect Costs Total partiel des coûts indirects			1757.00
Amount Allowable (not greater than 20% of Direct Costs) Montant admissible (n'excédant pas 20 % des coûts directs)			1611.00
Total Value of Assessment Credit (Total of Direct and Allowable indirect costs)		Valeur totale du crédit d'évaluation (Total des coûts directs et indirects admissibles)	9667.00

Note: The recorded holder will be required to verify expenditures claimed in this statement of costs within 30 days of a request for verification. If verification is not made, the Minister may reject for assessment work all or part of the assessment work submitted.

Note: Le titulaire enregistré sera tenu de vérifier les dépenses demandées dans le présent état des coûts dans les 30 jours suivant une demande à cet effet. Si la vérification n'est pas effectuée, le ministre peut rejeter tout ou une partie des travaux d'évaluation présentés.

Filing Discounts

1. Work filed within two years of completion is claimed at 100% of the above Total Value of Assessment Credit.
2. Work filed three, four or five years after completion is claimed at 50% of the above Total Value of Assessment Credit. See calculations below:

Total Value of Assessment Credit	Total Assessment Claimed
	x 0.50 =

Remises pour dépôt

1. Les travaux déposés dans les deux ans suivant leur achèvement sont remboursés à 100 % de la valeur totale susmentionnée du crédit d'évaluation.
2. Les travaux déposés trois, quatre ou cinq ans après leur achèvement sont remboursés à 50 % de la valeur totale du crédit d'évaluation susmentionné. Voir les calculs ci-dessous.

Valeur totale du crédit d'évaluation	Evaluation totale demandée
	x 0,50 =

Certification Verifying Statement of Costs

I hereby certify:
that the amounts shown are as accurate as possible and these costs were incurred while conducting assessment work on the lands shown on the accompanying Report of Work form.

That as PARTNER I am authorized
(Recorded Holder, Agent, Position in Company)

to make this certification

Attestation de l'état des coûts

J'atteste par la présente :
que les montants indiqués sont le plus exact possible et que ces dépenses ont été engagées pour effectuer les travaux d'évaluation sur les terrains indiqués dans la formule de rapport de travail ci-joint.

Et qu'à titre de _____ je suis autorisé
(titulaire enregistré, représentant, poste occupé dans la compagnie)

à faire cette attestation.

Signature: Yves Carrière Date: Jan. 29/96



Report of Work Conducted After Recording Claim

Mining Act

Transaction Number
W9610.00030

Personal information collected on this form is obtained under the authority of the Mining Act. This information will be used for correspondence. Questions about this collection should be directed to the Provincial Manager, Mining Lands, Ministry of Northern Development and Mines, Fourth Floor, 159 Cedar Street, Sudbury, Ontario, P3E 6A5, telephone (705) 670-7264.

- Instructions:**
- Please type or print and submit in duplicate.
 - Refer to the Mining Act and Regulations for requirements of filing assessment work or consult the Mining Recorder.
 - A separate copy of this form must be completed for each Work Group.
 - Technical reports and maps must accompany this form in duplicate.
 - A sketch, showing the claims the work is assigned to, must accompany this form.

Recorded Holder(s) EDWARD COUSINEAU/LOUIS COUSINEAU	Client No. 121596 / 121624
Address 430 1ST ST. E. P.O. Box 33 FORT FRANCES, ONT	Telephone No. 807-274-3761
Mining Division KENORA	Township/Area LITTLE TURTLE LAKE
	M or G Plan No. G2682
Dates Work Performed From: May 22/95 To: Sept 20/95	

Work Performed (Check One Work Group Only)

Work Group	Type
Geotechnical Survey	
Physical Work, Including Drilling	<input checked="" type="checkbox"/> PHYSIC
Rehabilitation	
Other Authorized Work	SECTION 18 ONLY
Assays	
Assignment from Reserve	

Total Assessment Work Claimed on the Attached Statement of Costs \$ **22,962**

Note: The Minister may reject for assessment work credit all or part of the assessment work submitted if the recorded holder cannot verify expenditures claimed in the statement of costs within 30 days of a request for verification.

Persons and Survey Company Who Performed the Work (Give Name and Address of Author of Report)

Name	Address
LOUIS COUSINEAU (AUTHOR)	P.O. Box 33 FORT FRANCES, ONT. P9A 3H5
RAY COUSINEAU	430 1ST ST. E. P.O. Box 33 FORT FRANCES, ONT. P9A 3H5

(attach a schedule if necessary)

Certification of Beneficial Interest * See Note No. 1 on reverse side

I certify that at the time the work was performed, the claims covered in this work report were recorded in the current holder's name or held under a beneficial interest by the current recorded holder.	Date April 3/96	Recorded Holder or Agent (Signature) Louis Cousineau
--	---------------------------	--

Certification of Work Report

I certify that I have a personal knowledge of the facts set forth in this Work report, having performed the work or witnessed same during and/or after its completion and annexed report is true.		
Name and Address of Person Certifying LOUIS COUSINEAU P.O. Box 33 FORT FRANCES, ONT. P9A 3H5		
Telephone No. 807-274-3761	Date Jan 24, 1996	Certified By (Signature) Louis Cousineau

For Office Use Only

Total Value Cr. Recorded \$22,962.	Date Recorded FEB 8, 1996	Mining Recorder [Signature]	Received Stamp KENORA - MINING DIV. RECEIVED FEB - 8 1996 AM 7 8 9 10 11 12 1 2 3 4 5 6 PM
	Deemed Approval Date MAY 8, 1996	Date Approved APRIL 11, 1996	
	Date/Notice for Amendments Sent		



Ministry of
Northern Development
and Mines

Ministère du
Développement du Nord
et des mines

**Statement of Costs
for Assessment Credit**

**État des coûts aux fins
du crédit d'évaluation**

Transaction No./N° de transaction

W 9610.00030

Mining Act/Loi sur les mines

Personal information collected on this form is obtained under the authority of the Mining Act. This information will be used to maintain a record and ongoing status of the mining claim(s). Questions about this collection should be directed to the Provincial Manager, Minings Lands, Ministry of Northern Development and Mines, 4th Floor, 159 Cedar Street, Sudbury, Ontario P3E 6A5, telephone (705) 670-7264.

Les renseignements personnels contenus dans la présente formule sont recueillis en vertu de la Loi sur les mines et serviront à tenir à jour un registre des concessions minières. Adresser toute question sur la collecte de ces renseignements au chef provincial des terrains miniers, ministère du Développement du Nord et des Mines, 159, rue Cedar, 4^e étage, Sudbury (Ontario) P3E 6A5, téléphone (705) 670-7264.

1. Direct Costs/Coûts directs

Type	Description	Amount Montant	Totals Total global
Wages Salaires	Labour <i>RAY - 62 DAYS</i> Main-d'œuvre <i>62.5 - 67 DAYS</i>	<i>420</i> <i>430</i>	<i>17,600.</i>
	Field Supervision Supervision sur le terrain		
Contractor's and Consultant's Fees Droits de l'entrepreneur et de l'expert- conseil			
Supplies Used Fournitures utilisées	Type <i>40 STICKS FORCITE</i>	<i>96.00</i>	
	<i>80 Ø-LINE C50</i>	<i>40.00</i>	
	<i>15-FUSES @ 3.25</i>	<i>48.75</i>	
			<i>184.75</i>
Equipment Rental Location de matériel	Type <i>ATLAS COPCO PLUGGER</i>	<i>351.00</i>	<i>351.00</i>
Total Direct Costs Total des coûts directs			<i>19,135.00</i>

2. Indirect Costs/Coûts indirects

** Note: When claiming Rehabilitation work Indirect costs are not allowable as assessment work.
Pour le remboursement des travaux de réhabilitation, les coûts indirects ne sont pas admissibles en tant que travaux d'évaluation.

Type	Description	Amount Montant	Totals Total global
Transportation Transport	Type <i>TRUCK</i> <i>62x42.30</i>	<i>2622</i>	<i>2622</i>
	<i>161 KM. @ 30</i> <i>= 4830</i>		
Food and Lodging Nourriture et hébergement	<i>RAY 62x14</i>	<i>868.</i>	<i>1736</i>
	<i>LOUIS 62x14</i>	<i>868.</i>	
Mobilization and Demobilization Mobilisation et démobilisation			
Sub Total of Indirect Costs Total partiel des coûts indirects			<i>4358.00</i>
Amount Allowable (not greater than 20% of Direct Costs) Montant admissible (n'excédant pas 20 % des coûts directs)			<i>3829.00</i>
Total Value of Assessment Credit (Total of Direct and Allowable Indirect costs)			<i>22,962.00</i>
Valeur totale du crédit d'évaluation (Total des coûts directs et indirects admissibles)			

Note: The recorded holder will be required to verify expenditures claimed in this statement of costs within 30 days of a request for verification. If verification is not made, the Minister may reject for assessment work all or part of the assessment work submitted.

Note : Le titulaire enregistré sera tenu de vérifier les dépenses demandées dans le présent état des coûts dans les 30 jours suivant une demande à cet effet. Si la vérification n'est pas effectuée, le ministre peut rejeter tout ou une partie des travaux d'évaluation présentés.

Filing Discounts

1. Work filed within two years of completion is claimed at 100% of the above Total Value of Assessment Credit.
2. Work filed three, four or five years after completion is claimed at 50% of the above Total Value of Assessment Credit. See calculations below:

Total Value of Assessment Credit	Total Assessment Claimed
	$\times 0.50 =$

Remises pour dépôt

1. Les travaux déposés dans les deux ans suivant leur achèvement sont remboursés à 100 % de la valeur totale susmentionnée du crédit d'évaluation.
2. Les travaux déposés trois, quatre ou cinq ans après leur achèvement sont remboursés à 50 % de la valeur totale du crédit d'évaluation susmentionné. Voir les calculs ci-dessous.

Valeur totale du crédit d'évaluation	Evaluation totale demandée
	$\times 0,50 =$

Certification Verifying Statement of Costs

I hereby certify:
that the amounts shown are as accurate as possible and these costs were incurred while conducting assessment work on the lands shown on the accompanying Report of Work form.

that as *Partner* I am authorized
(Recorded Holder, Agent, Position in Company)

to make this certification

Attestation de l'état des coûts

J'atteste par la présente :
que les montants indiqués sont le plus exact possible et que ces dépenses ont été engagées pour effectuer les travaux d'évaluation sur les terrains indiqués dans la formule de rapport de travail ci-joint.

Et qu'à titre de _____ je suis autorisé
(titulaire enregistré, représentant, poste occupé dans la compagnie)

à faire cette attestation.

Signature *Louis Roumeau* Date *April 3/96*

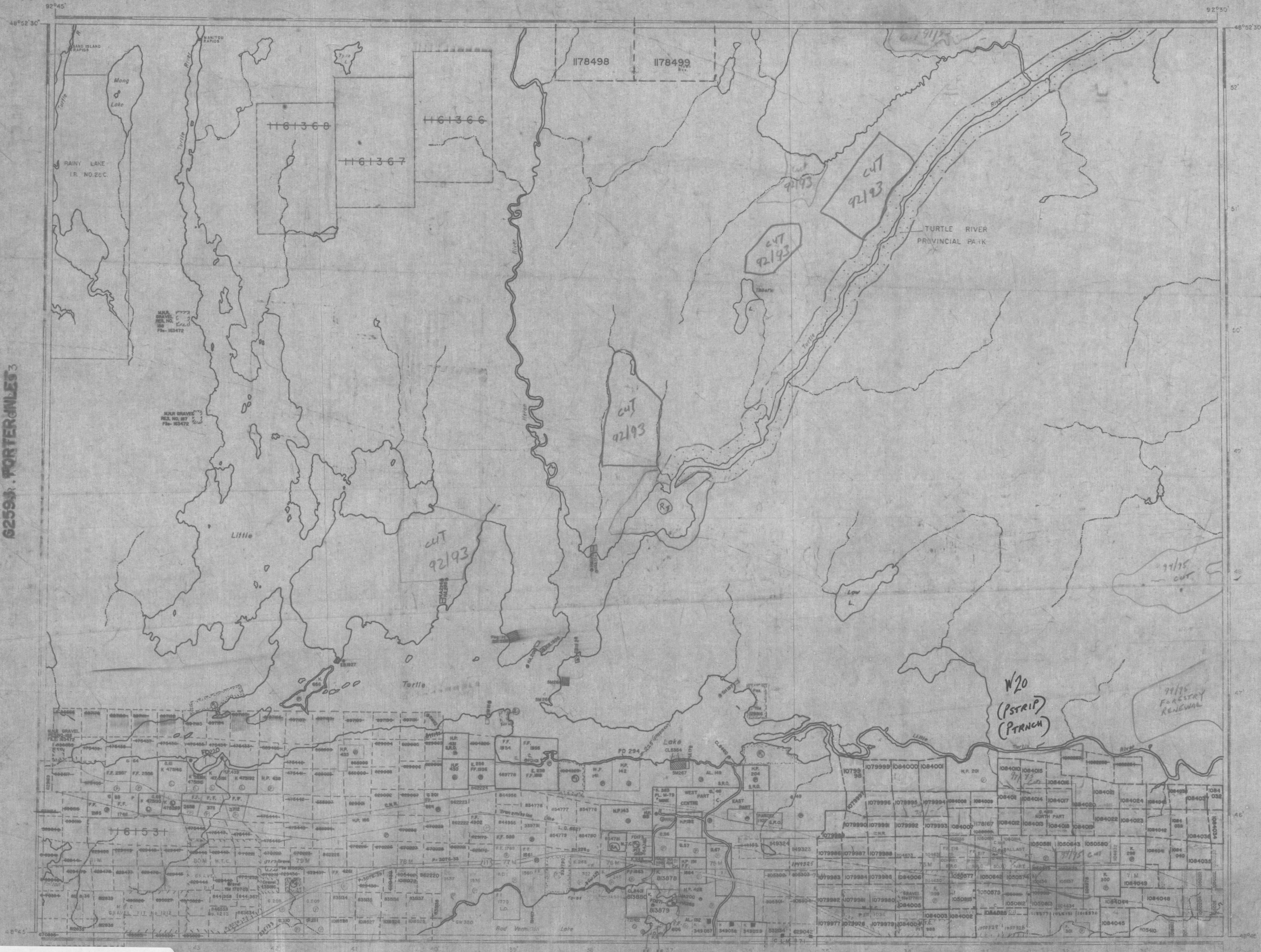

62593 PORTER INLES 3

BENNETT LAKE G-2667

LEGEND

- PATENTED LAND ● or ⊙
- CROWN LAND SALE C.S.
- LEASES L
- LOCATED LAND Loc.
- LICENSE OF OCCUPATION L.O.
- MINING RIGHTS ONLY M.R.O.
- SURFACE RIGHTS ONLY S.R.O.
- ROADS —
- IMPROVED ROADS —
- KING'S HIGHWAYS —
- RAILWAYS —
- POWER LINES —
- MARSH OR MUSKIEG —
- MINES —
- PATENTED S.R.O. —
- CANCELLED —

REFERENCES

AREAS WITHDRAWN FROM DISPOSITION

M.R.O. - MINING RIGHTS ONLY
S.R.O. - SURFACE RIGHTS ONLY
M+S. - MINING AND SURFACE RIGHTS

Description	Order No.	Date	Opposition	File
Public Lands Act		7/7/67	S.R.O.	163472
			S.R.O.	600
	W.776	10/27/76	S.R.O.	67883
	W.8677	14/11/77	S.R.O.	368
Park Reserve	W.73183	2/13/83	M.R.	10560
	W.20183	10/11/85	S.R.O.	
W.K. 24-10		20/10/90	S.R.O.	
MINING ACT	W-KE-05/11	11/26/11	S.R.O.	24MR
MINING ACT	W-K-25/12	11/16/12	S.R.O.	195150

1/2 ch. allowance for M. Cl. 1/70 along the shore of Bad Vermilion Lake - M.R.D.

SCALE: 1 INCH = 40 CHAINS

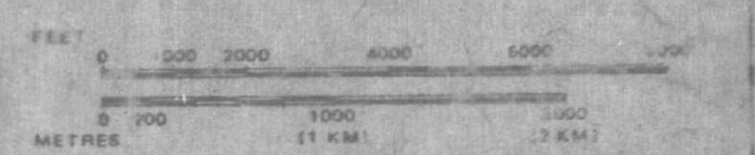

AREA
LITTLE TURTLE LAKE

M.N.R. ADMINISTRATIVE DISTRICT
FORT FRANCES
MINING DIVISION
KENORA
LAND TITLES / REGISTRY DIVISION
RAINY RIVER

DATE OF ISSUE
FEB 19 1996
KENORA
MINING DIVISION

Ministry of Natural Resources
Ontario
Land Management Branch

Date: MARCH, 1984
Title: G-2682



MANION LAKE AREA - G-2686

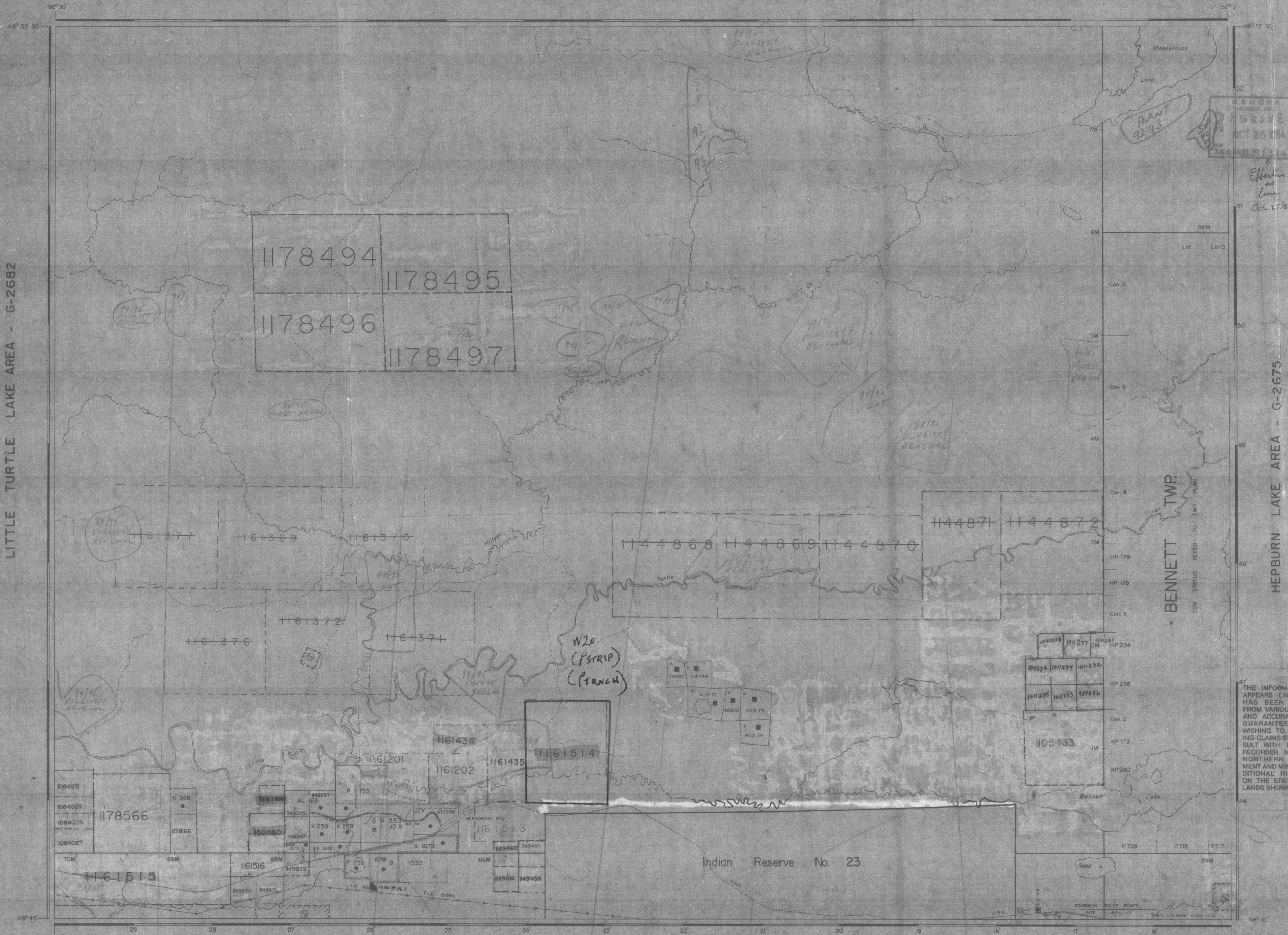

LEGEND

HIGHWAY AND ROUTE No	
OTHER ROADS	
TRAILS	
SURVEYED LINES	
TOWNSHIPS - BASE LINES, ETC	
LOTS, MINING CLAIMS, PARCELS, ETC	
UNSURVEYED LINES	
LOT LINES	
PARCEL BOUNDARY	
MINING CLAIMS ETC	
RAILWAY AND RIGHT OF WAY	
UTILITY LINES	
NON-PERENNIAL STREAM	
FLOODING OR FLOODING RIGHTS	
SUBDIVISION OR COMPOSITE PLAN	
RESERVATIONS	
ORIGINAL SHORELINE	
MARSH OR MUSKEG	
MINES	
TRAVERSE MONUMENT	

DISPOSITION OF CROWN LANDS

TYPE OF DOCUMENT	SYMBOL
PATENT, SURFACE & MINING RIGHTS	
" SURFACE RIGHTS ONLY	
" MINING RIGHTS ONLY	
LEASE, SURFACE & MINING RIGHTS	
" SURFACE RIGHTS ONLY	
" MINING RIGHTS ONLY	
LICENCE OF OCCUPATION	
ORDER-IN-COUNCIL	
RESERVATION	
CANCELLED	
SAND & GRAVEL	

NOTE: MINING RIGHTS IN PARCELS PATENTED PRIOR TO MAY 6, 1913 VESTED IN ORIGINAL PATENTEES BY THE PUBLIC LANDS ACT, R.S.O. 1970, CHAP. 380, SEC. 63, SUBSEC. 1.

REFERENCES

AREAS WITHDRAWN FROM DISPOSITION

- M.R.O. - MINING RIGHTS ONLY
- S.R.O. - SURFACE RIGHTS ONLY
- M.+S. - MINING AND SURFACE RIGHTS

Description	Order No.	Date	Disposition	File

SAND AND GRAVEL

- ① GRAVEL FILE 16271B
- ② M.T.C. PIT 1089
GRAVEL FILE 16271B
- ③ M.T.C. PIT 105B
- ④ GRAVEL FILE 16799 vol 7
- ⑤ M.N.R. Gravel Reserve No 228, File 16271B
- ⑥ M.T.C. PIT No 1B-14

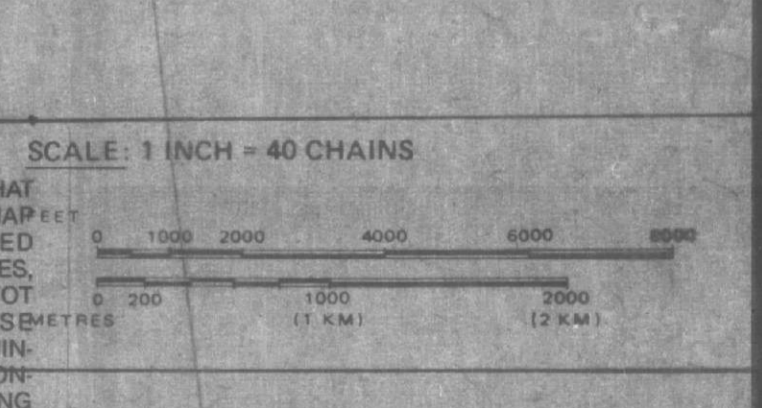

THE INFORMATION THAT APPEARS ON THIS MAP HAS BEEN COMPILED FROM VARIOUS SOURCES, AND ACCURACY IS NOT GUARANTEED. THOSE WISHING TO STAKE MINING CLAIMS SHOULD CONSULT WITH THE MINING RECORDER, MINISTRY OF NORTHERN DEVELOPMENT AND MINES, FOR ADDITIONAL INFORMATION ON THE STATUS OF THE LANDS SHOWN HEREIN.

BENNETT LAKE

M.N.R. ADMINISTRATIVE DISTRICT
FORT FRANCES
 MINING DIVISION
KENORA
 LAND TITLES / REGISTRY DIVISION
RAINY RIVER

DATE OF ISSUE
FEB 19 1996
 KENORA MINING DIVISION

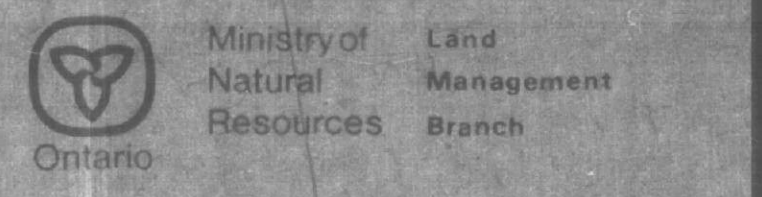

Date: FEBRUARY, 1994
 Number: M-2392 G-2667

LITTLE TURTLE LAKE AREA - G-2682

HEPBURN LAKE AREA - G-2675

WILD POTATO LAKE AREA - G-2703

