

2.17085

1996  
RECEIVED

FEB 27 1997

MINING LANDS BRANCH

BENNETT LAKE - ALICE-A PROJECTFINAL SUBMISSION + TECHNICAL REPORT.APPLICANTS

LOUIS COUSINEAU R1062 - AUTHOR  
 RAY COUSINEAU #13064  
 KEN DESJARDINS #11749

P.O. BOX 33 - FORT FRANCES, ONT. P0A 3M5

LOCATION

KENDRA MINING DIVISION.  
 DISTRICT OF RAINY RIVER

BENNETT LAKE TWP. E 2667

AZONE, BZONE PIT #1, CZONE, EZONE - CL. 1178166  
 AZONE PITS 8+13, BZONE, D-E-FZONES - CL. 1178566

ACCESS

FROM FORT FRANCES, ONT. EAST VIA HWY. 11 TO  
 MINE CENTRE EAST TO MANION LAKE ROAD, TURN NORTH  
 APPROX 1/4 MILE TO C.N.R. CROSSING, CONTINUE  
 APPROX 1/2 MILE TO HYDROLINE BUSH WINTER ROAD,  
 THIS ROAD IS NOT GRAVELLED - SOMETIMES TRUCK  
 BUT MOSTLY ACCESSIBLE ON FOOT.

CHANGES TO PROJECT - AREA VERY HEAVILY OVER BURDENED.

CUT OVER AREAS CAREFULLY SEARCHED FOR ROCK  
 SHOWINGS. IT WAS NOT FEASIBLE TO BRING IN  
 ANY EQUIPMENT (BACK HOE) UNTIL WE COULD  
 LOCATE ANY AREA OF POTENTIAL.

GEOLOGY

THE ROCKS AT THE ALICE A - STRIKE EAST -  
 WEST AND ARE COMPOSED OF MOSTLY CERESITE  
 THE BEST ASSAYS FOUND IN THE PAST WAS  
 0.81 OZ PER TON. THE FELSIC VOLCANIC ROCKS  
 ARE SERICITIZED (SERICITE SCHIST) AND  
 CARBONITIZED (ANKERITE ALTERATION) QUARTZ  
 VEINS ARE PRESENT AND ARE MINERALIZED  
 WITH GALENA - PYRITE - CU - ZN.

010

52C16S0012 2.17085 BENNETT LAKE

GEOLOGY - ZONE E - PIT 1

EIGHT TO TEN FEET WIDE QUARTZ VEIN. THE QUARTZ IS VERY FRACTURED WITH VERY LITTLE SULPHIDE. The fractures HAVE IRON RUST CARBONIZATION WITH SMALL AMOUNTS CO. (MELONCHITE STAIN), ZN, GALENA, IRON CUBES.

NORTH OF QUARTZ VEIN - SERICITE SHEARING WITH LOTS OF BRECCIATED QTZ. SMALL AMOUNTS OF CO, ZN, GALENA.

SOUTH OF QUARTZ VEIN - RHYOLITE WITH LOTS OF IRON CARBONIZATION.

STRIKE - EAST - WEST - ?

WORK DONE A-ZONE - WE CONCENTRATED ON EAST ALICE A SHAFT ZONE - IT WAS VERY HARD TO GET AT - LOTS OF OLD DEBRIS - OVERBURDEN TREES ECT. LOTS OF WATER AROUND. WE COULD TELL NO ONE WAS GOING TO LOOK HERE WHEN THE OTHER SHAFT AREA WAS SO ACCESSIBLE OUR HARD WORK WAS VERY REWARDING! WE KEPT GOING TO OTHER ZONES TRYING TO FIND SOMETHING NEW.

E ZONE - PIT 1 - WE FOUND A VERY SMALL LEAN QTZ VEIN - BUT THE MORE WE STRIPPED THE LARGER IT WAS. WE WERE VERY SURPRISED WHEN SAMPLE 8-B CAME BACK 121000 PP. BAU 5436 PPM ZN. - WE DECIDED TO DO MORE STRIPPING DRILLING BLASTING.

RESULTS - A-ZONE - EAST SHAFT - RESULTS OF WORK DONE ON SHAFT AREA VERY ENCOURAGING - GIVE NEW LOOK TO AREA

RESULTS

## A ZONE

OLD SHAFT AREA

8' x 8'

BEST ASSAY

0.81 OZ. TON

FROM REPORTS OF APPROX.  
10 DIFFERENT CO.  
1988-1993

NEW AREA - PITS 4-5-7-8-9

35' x 30'

BEST ASSAYS

9A - .78 AU 1.7% ZN

15A - 1.91 AU .33% ZN

17A - .26 A 6.64% ZN

E ZONE PIT 1

## NEW ZONE

BEST ASSAYS

BB-121008 PPB AU 5430 PPM ZN

C10-13444 PPB AU 1683 PPM ZN

C11 1384 PPB AU 4861 PPM ZN

D1 2970 PPB AU

THE NEW ASSAYS NOT ONLY ENLARGED  
AREAS OF MINERALIZATION BUT INCREASED  
GOLD PORTION. WE ARE ALSO VERY  
ENCOURAGED WITH ZN FINDINGS.

*Louis Cousineau  
Ray Curran  
Kent Desjardins*

RECEIVED MAY 26 1997

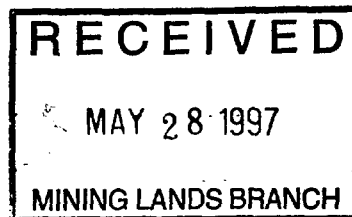

Mr. Bruce Gates

Re: Submission NO. 2,17090  
Transaction NO. W 9710,00017

REVISIONS

# 1 - A-ZONE

WORK DONE - STRIPPING - TRENCHING  
- BLASTING,

NATURE OF ROCKS - FELSIC - METROVOLCAN  
CARBONATIZED & SERICITIZED WITH QUARTZ  
VEINS FROM 1/2" TO 4'

FOUND - AU + ZN MINERALIZATION IN THE  
SERICITE & QTZ VEINS RESAMPLES:  
5A, 9A, 15A, 17A.

B-ZONE

WORK DONE - STRIPPING - TRENCHING

NATURE OF ROCKS - SAME AS A ZONE

FOUND PIT # 1 - HAD MALACHITE STAIN  
BUT WE COULD NOT FIND ANY CU.

C-ZONE

WORK DONE - STRIPPING - TRENCHING - BLASTING

NATURE OF ROCKS - SAME AS A ZONE

FOUND - MINDR. AMOUNTS CU - ZN - WE  
DISAPPOINTED WITH ASSAY RESULTS.

REVISIONS

# 1 G ZONE

WORK DONE STRIPPING-TRENCHING  
NATURE OF ROCKS - MOST OF ROCKS  
IN THIS ZONE ARE GABBRO - QTZ.  
MINOR SULPHIDE  
FOUND NIL BEST ASSAY 143 PPM ZN.

# 2 SHAFT AREA PAGE 2

NATURE OF ROCKS FELSIC -  
METAVOLCANIC CARBONATIZED &  
SERICITIZED WITH QTZ VEINS.  
MINERALIZATION EXPOSED -  
AU - ZN - AG - CU

# 3 DETAILED MAPS ENCLOSED

PAGE 1-B - C & G ZONES  
PAGE 2 - A ZONE

# 4

# B-17 - ACTUAL NO. CHANGE TO C12  
SAMPLE 1-B ON JULY 11 IS CORRECT.  
SAMPLE 1-B ON MAY 28 CHANGE TO C14  
SAMPLE 10-A IS FROM TRENCH 10-B  
SAMPLE C-12 DATE IS SEPT. 26/90  
SAMPLE C-14 DATE IS MAY 28/96  
SAMPLE 4-C IS FROM PIT 7C  
SAMPLE 4-C FROM PIT 11-A IS IN ERROR  
SAMPLE 13C IS FROM PIT 1C  
SAMPLE 7A IS FROM PIT 13C

# 5

PITS - C - 1-2-3-4-5-6-7-8 ARE  
ON CLAIM 1178166

Mr. Bruce Gates

Re:

Submission NO. 217085

Transaction NO. W9710.00016 CL. 1178566

REVISIONS

#1 F-ZONE

WORK DONE STRIPPING - TRENCHING  
BLASTING.

NATURE OF ROCKS FELSIC METROVOLCANIC  
CARBONATISED & SERICITIZED WITH QUARTZ  
VEINS FROM 1/2" TO 4'. PIT 1-E IS IN A SHEAR  
ZONE FRACTURED QTZ. WITH BROWN STAIN  
MINOR SULPHIDE. VERY GOOD GOLD VALUES - UP  
TO 121000 PPB AU. 5430 PPM ZN. THE ROCK  
FOOLED US - IT LOOKED SO LEAN.

F-ZONE STRIPPING. TRENCHING

NATURE OF ROCKS FELSIC METROVOLCANIC  
CARBONATISED & SERICITIZED WITH QUARTZ  
VEINS FROM 1/2" TO 4' - PITS - 1-2-3F ALL HAVE  
THE LARGEST QUARTZ VEINS 3 TO 4 FEET IN  
WIDTH. NO AU ASSAYS OF IMPORTANCE.

#2 SEE PAGE 2-C

#3 DETAILED MAPS ENCLOSED

PAGE 3-B - E AND F ZONES

#4 & 5 SEE PAGE 2-C

#6 WINTER WORK IN THE FALL COVER  
AREAS TO BE WORKED ON WITH  
HEAVY GAGE PLASTIC. PITS OR

# C

WINTER WORK CONT.

TRENCHES ARE COVERED WITH TREES THEN PLASTIC TO GIVE HEIGHT SO THE SNOW WILL BLOW OFF. EXTRA EQUIPMENT NECESSARY FOR WINTER WORK. . . . .

SNOW PLOW

SNOW MOBILE & TRAILER

TOBoggan

SNOW SHOES

ACTUAL PICTURE SHOWING WORK BEING DONE ON PIT I.E ENCLOSED

*Yours truly  
Louis Cousineau*

BENNETT LAKE 62667

N  
R

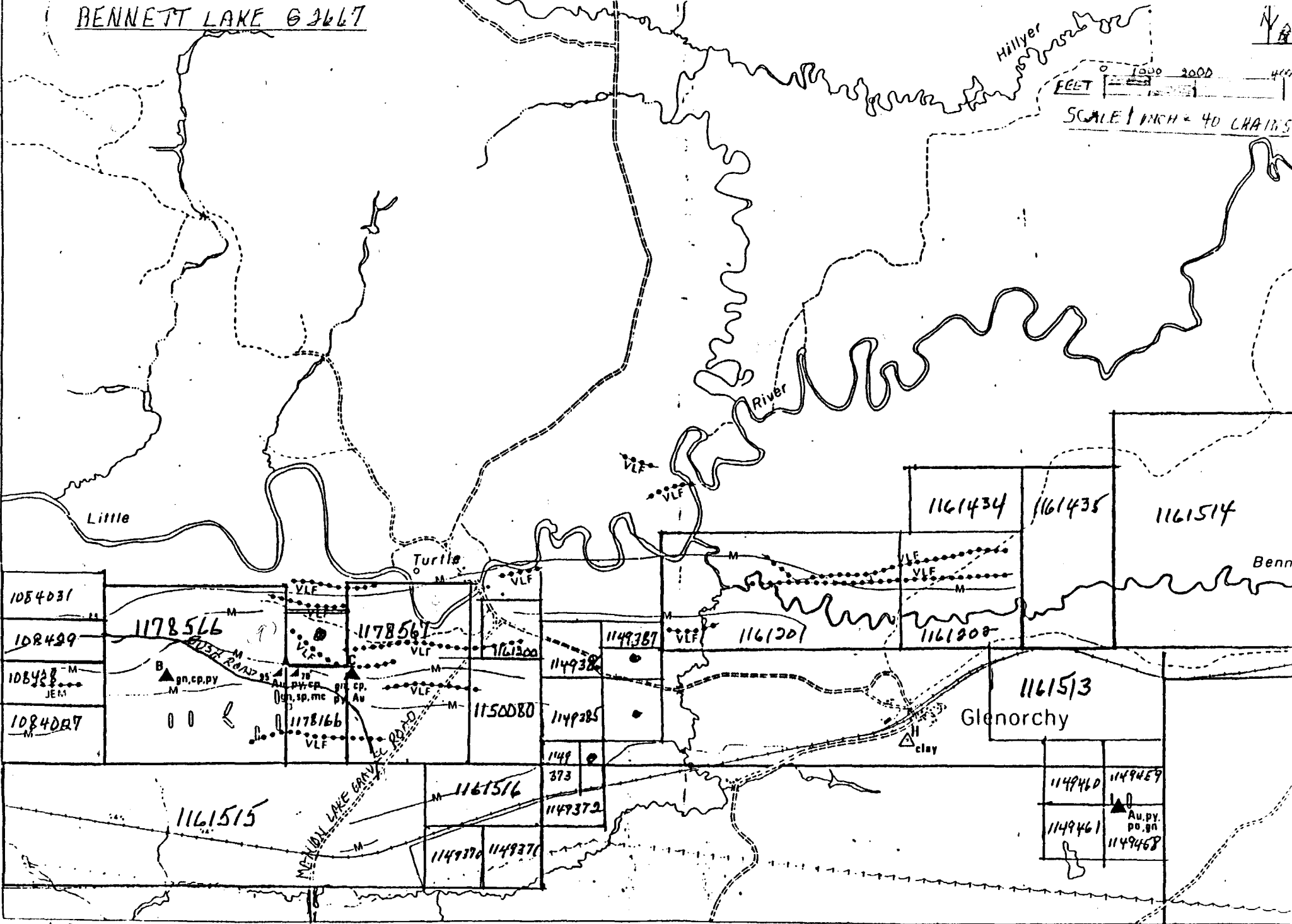
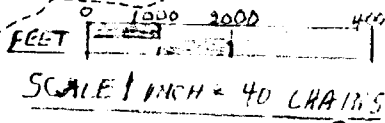

92 30 00

48°45'00"

← FORT FRANCES  
MINE CENTRE

↑↑ HWY 10 ATIKOKAN →

□ ACCESS





CUT OVER AREA

BENETT LAKE  
REVISED MAY 1997

1996

CLAIM 1178166

CLAIM 8566

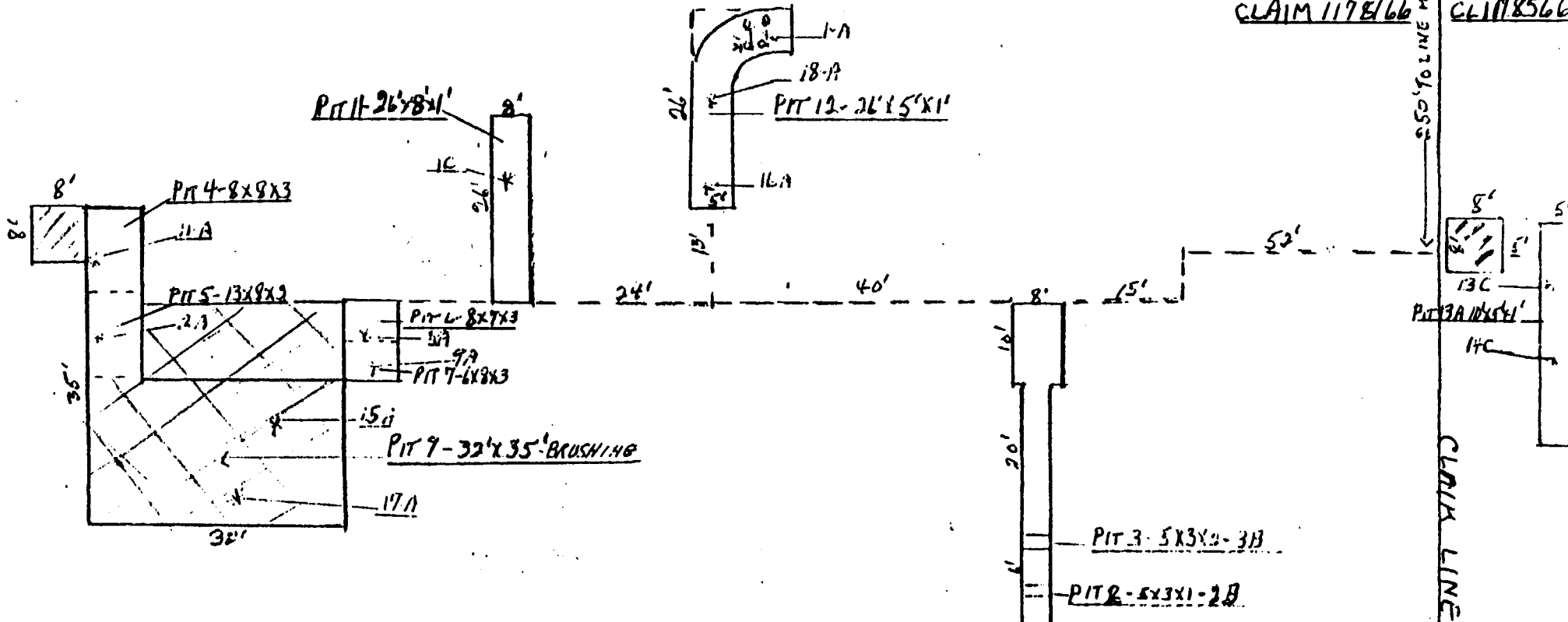

CUT OVER AREA

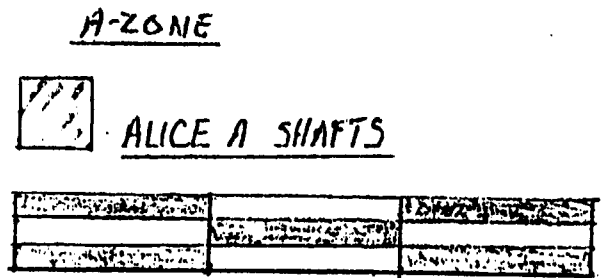
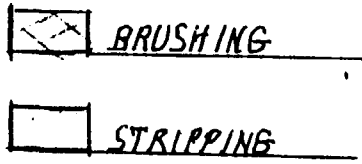

SCALE 1" = 20'



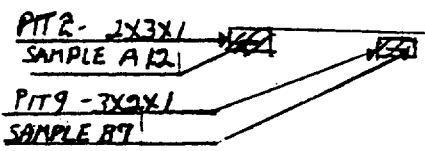
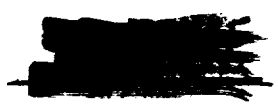
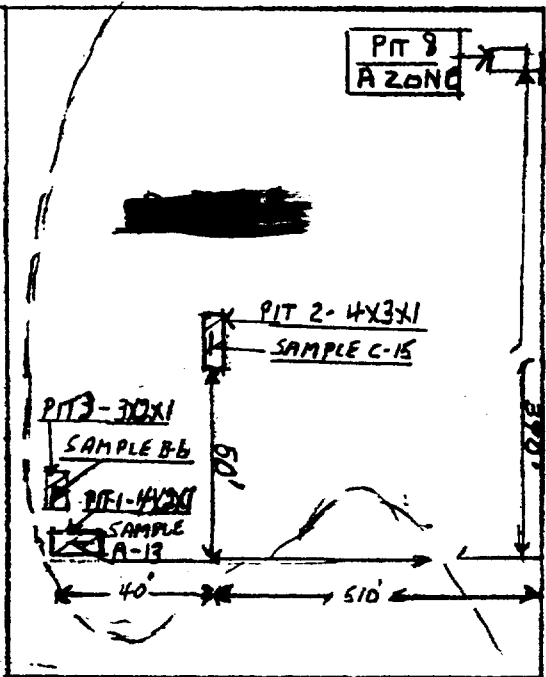
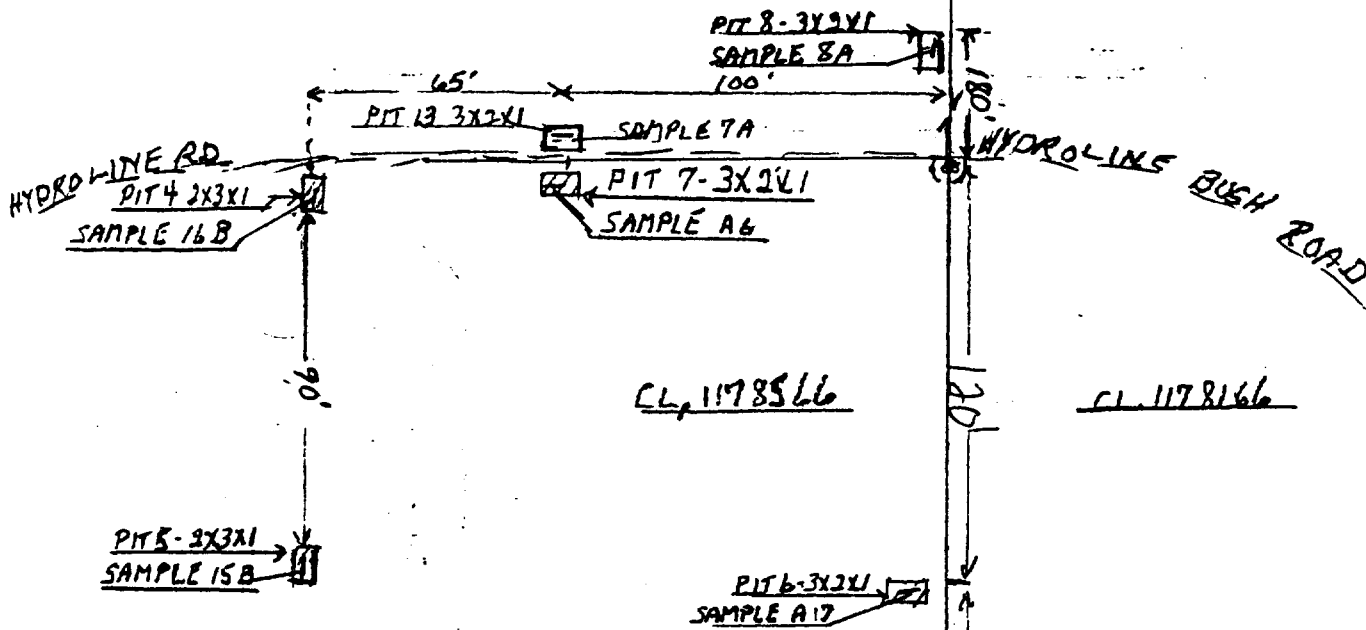

- PIT SCALE  
1/8" = 1'
- ▨ STRIPPING
- ▩ BLASTING

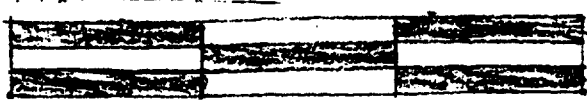

SCALE 1" = 50'

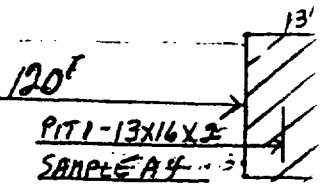
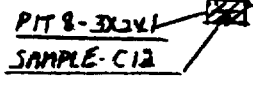

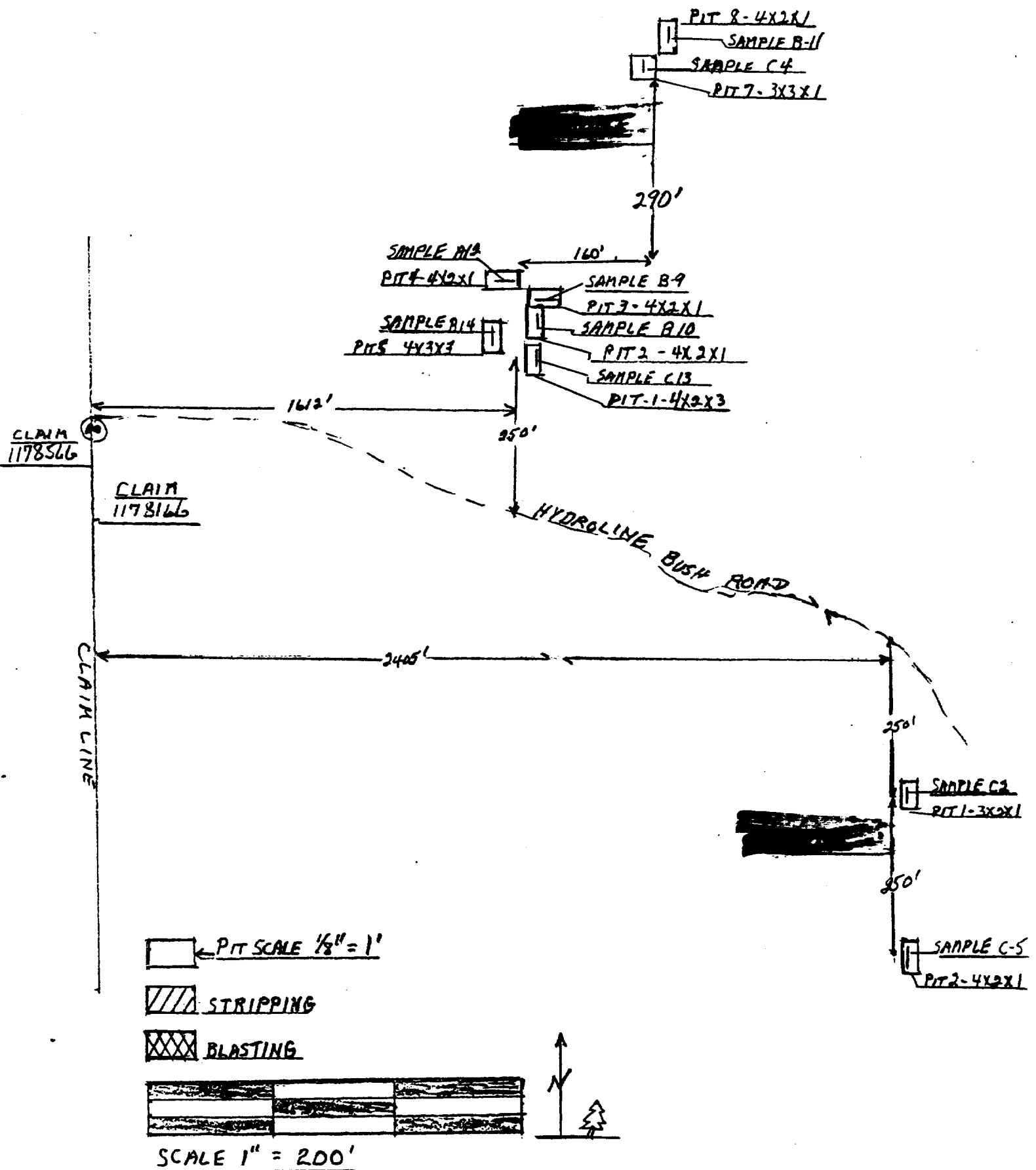

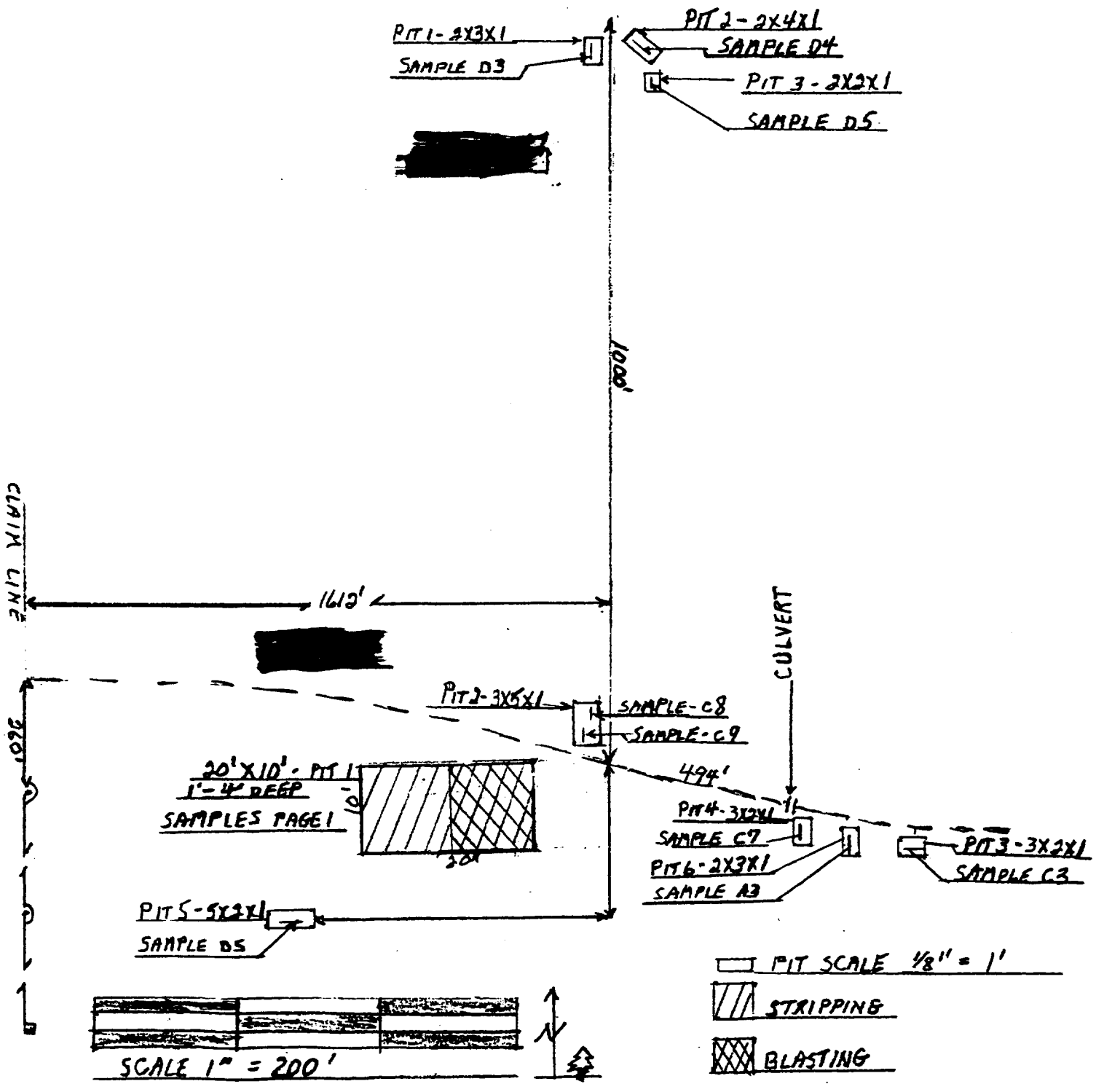

IV. DAILY REPORTS (Summarize work activity in Section I)

Day	Project Area	Date	Work Performed
	ALICE A PROJECT		
1	BENNETT LAKE PITH ZONE A	MAY 17 1976	STRIPPING CLAIM 1178166
2	" " PIT 4 " A	" 18 "	" + BLAST " " SAMPLE 11A
3	" " " 5 " A	" 19 "	" " " "
4	" " " 5 " A	" 20 "	" + BLAST " " SAMPLE 2A
5	" " " 12 " A	" 21 "	" " " "
6	" " " 12 " A	" 22 "	DRILL-4 HOLES "
7	" " " 12 " A	" 23 "	BLAST-SAMPLE " SAMPLE 1A
8	" " " 1 " A	" 26 "	STRIPPING CLAIM "
9	" " " 1 " A	" 28 "	BLAST " " SAMPLE 1-B
10	" " " 2 " A	" 29 "	STRIPPING " "
11	" " " 2 " A	" 30 "	BLAST-SAMPLE " " SAMPLE 2-B
12	" " " 3 " A	" 31 "	STRIPPING " "
13	" " " 3 " A	JUNE 1 "	BLAST-SAMPLE " " SAMPLE 3-B
14	5 " " " 6 " E	" 4 "	STRIP-SAMPLE " 1178566 " 3-A
15	1 " " " 6 " A	" 5 "	" " " 1178166 " 5-A
16	5 " " " 7 " B	" 9 "	" " " 1178566 " 6-A
17	1 " " " 13 " A	" 11 "	" " " 1178166 " 7-A
18	" " " 8 " A	" 13 "	" " " 1178566 " 8-A
19	" " " 7 " A	" 16 "	" " " "
20	" " " 7 " A	" 17 "	" " " " " 9-A
21	" " " 9 " B	" 19 "	" " " " " 10-A
22	" " " 2 " B	" 22 "	" " " " " 12-A
23	" " " 9 " A	" 23 "	" " " " " 15-A
24	" " " 9 " A	" 24 "	" " " " " 15-A
25	" " " 10 " A	" 29 "	" " " " " 14-A
26	" " " 12 " A	" 30 "	" " " " " 16-A
27	" " " 9 " A	JULY 3 "	" " " " " 17-A
28	" " " 9 " A	" 4 "	" " " " " 17-A
29	5 " " " 12 " A	" 7 "	" " " " " 18-A
30	" " " 1 " B	" 9 "	" " " 1178166 " 4-A
31	" " " 1 " B	" 10 "	" " " 1178166 " 4-A
32	1 " " " 1 " B	" 11 "	BLAST " " " " 1-B
33	" " " 1 " D	" 21 "	STRIP " " 1178566 " 13-A
34	" " " 3 " D	AUG. 1 "	" " " " " B-6
35	" " " 1 " E	" 7 "	" " " " "
36	" " " 1 " E	" 8 "	" " " " " 5430 PPT 2N
37	" " " 1 " E	" 9 "	DRILL-7 HOLES " " 12100 PPT 2N
38	" " " 1 " E	" 10 "	BLAST SAMPLE " " " B-B
39	5 " " " 3 " B	" 11 "	STRIP " " " " 4-B
40	" " " 6 " C	" 14 "	" " " 1178166 " 13-B
41	1 " " " 6 " C	" 15 "	BLAST " " 1178166 " 13-B

Attach additional sheets as required.

IV. REGISTRES QUOTIDIENS (Résumez les travaux de la Partie I)

Jour	Volet du projet	Date	Travail effectué
	<u>ALICE A PROSPECT</u>		
42	BENNETT LAKE PIT 1 ZONE C	AUG. 21, 1996	STRIP CLAIM 1178166 SAMPLE
43	" " " 1 " C	" 23 "	DRILL-6 " " "
44	L " " " 1 " C	" 24 "	BLAST-SAMPLE " " " 13-C
45	" " " 1 " F	" 27 "	STRIP " " 1178566 " 3-D
46	" " " 2 " F	" 28 "	" " " " 4-D
47	S " " " 3 " F	" 29 "	" " " " 5-D
48	" " " 3 " C	SEPT. 1 "	" " 1178166 119-B
49	" " " 2 " C	" 4 "	" " " " 10-B
50	" " " 8 " C	" 5 "	" " " " 11-B
51	" " " 4 " C	" 7 "	" " " " 12-B
52	L " " " 5 " C	" 8 "	" " " " 14-B
53	" " " 4 " B	" 14 "	" " 1178566 " 16-B
54	" " " 5 " B	" 15 "	" " " " 15-B
55	" " " 7 " B	" 19 "	" " " " 6-C
56	" " " 5 " E	" 20 "	" " " " 5-B
57	" " " 5 " E	" 23 "	" " " " 5-B
58	" " " 9 " B	" 25 "	" " " " 7-B
59	" " " 6 " B	" 26 "	" " " " 17-B
60	" " " 4 " A	" 28 "	" " " " 1-C
61	" " " 11 " A	" 29 "	BLAST SAMPLE " " 1-C
62	" " " 4 " E	OCT 8 "	STRIP " " " 7-C
63	" " " 3 " E	OCT 9 "	" " " " 3-C
64	" " " 2 " G	" 11 "	" " " " 5-C
65	" " " 2 " E	" 13 "	" " " " "
66	" " " 2 " E	" 14 "	" " " " "
67	" " " 2 " E	" 16 "	DRILL 8-11 " " 8-C
68	S " " " 2 " F	" 17 "	BLAST " " " 9-C
69	L " " " 1 " B	" 20 "	STRIP SAMPLE 1178166 " 2-C
70	" " " 2 " D	" 22 "	" SW 1/4 1178566 " 15-C
71	" " " 1 " E	" 27 "	" SW 1/4 " " "
72	" " " 1 " E	" 29 "	DRILL 9- " " 10-C
73	" " " 1 " E	" 31 "	BLAST " " " 11-C
74	" " " 1 " E	NOV 22 "	STRIP NE 1/4 " " "
75	" " " 1 " E	" 24 "	STRIP NE 1/4 " " "
76	" " " 1 " E	" 26 "	DRILL 7 " " "
77	" " " 1 " E	" 27 "	BLAST SAMPLE " " 1-D
78	" " " 1 " E	DEC 27 "	STRIP NW 1/4 " " "
79	" " " 1 " E	DEC 28 "	DRILL " 7- " " "
80	" " " 1 " E	DEC 29 "	BLAST " " " 2-D
81	S " " " 11 " A	SEPT. 30 "	STRIP-SAMPLE " " 4-C

Ajoutez des feuilles additionnelles au besoin

STRIPPING AND TRENCHING DAILY LOGLOCATION OF STRIPPING AND TRENCHING SKETCH ATTACHEDSKETCH OF TRENCHING AND SAMPLING SKETCH ATTACHEDDESCRIPTION OF SAMPLES

SAMPLE No	TYPE	ROCK TYPE	MINERALIZATION	ASSAY RESULTS
A-1	4" chip	CERESITE-QTZ	MED. SULPHIDE	300 PPM ZN
A-2	3" chip	" "	" "	439 PPM ZN
A-3	4" chip	GABBRO	" "	150 PPM ZN
A-4	6" chip	CERESITE-CU-QTZ	MINOR	256 PPM ZN 151 PPM BAU
A-5	4" chip	CERESITE-QTZ	" "	140 PPM ZN 67 PPM BAU
A-6	5" chip	CERESITE	" "	—
A-7	4" chip	CERESITE-QTZ	" "	98 PPM ZN
A-8	5" chip	CERESITE	" "	114 PPM ZN
A-9	5" chip	QTZ-ZN-	HEAVY	17400 PPM ZN 27,200 PPM BAU
A-10	4" chip	CERESITE	MED	242 PPM ZN 12 PPM BAU
A-11	5" chip	CERESITE-QTZ	MINOR	3170 PPM ZN 3030 PPM BAU
A-12	5" chip	RHYOLITE-QTZ	MINOR	11 PPM AU 97 PPM ZN
A-13	4" chip	RHYOLITE-QTZ	MINOR	1340 PPM BAU
A-14	4" chip	CERESITE-QTZ	MINOR	97 PPM ZN
A-15	4" GRAB	CERESITE-QTZ-ZN CU, GALENA	MED.	2340 PPM ZN 66100 PPM BAU
A-16	5" chip	CERESITE-QTZ	MINOR	127 PPM ZN 435 PPM BAU
A-17	5" GRAB	CERESITE-QTZ-ZN CALCITE	MINOR	66400 PPM ZN 9200 PPM BAU
A-18	5" chip	CERESITE-QTZ	" "	316 PPM ZN 32 PPM BAU
B-1	4" chip	CERESITE-QTZ	MINOR	237 PPM ZN 15 PPM AU
B-2	4" chip	RHYOLITE-QTZ	" "	153 PPM ZN 7 PPM AU
B-3	4" chip	RHYOLITE-QTZ	MED.	243 PPM ZN 9 PPM AU
B-4	4" chip	CERESITE-QTZ	MINOR	2300 PPM ZN 16 PPM BAU
B-5	5" chip	CERESITE-QTZ	" "	193 PPM ZN 274 PPM BAU
B-6	5" chip	CERESITE	" FE	13 PPM BAU
B-7	4" GRAB	QTZ	MED. SULPHIDE	—
B-8	7" chip	FRACTURED QTS BROWNISH ZN	NO SULPHIDE?	5430 PPM ZN 121000 PPM BAU
B-9	5" chip	RUSTY QTS	MINOR	113 PPM BAU



DESCRIPTION OF SAMPLES

<u>SAMPLE No</u>	<u>TYPE</u>	<u>ROCK TYPE</u>	<u>MINERALIZATION</u>	<u>ASSAY RESULTS</u>
B-10	4" chip	RUSTY QTZ.	MINOR SULPHIDE	108 PPB AU
B-11	4" chip	RUSTY QTZ.	MED. SULPHIDE	17 PPB AU
B-12	5" chip	CERESITE-QTZ	MINOR "	—
B-13	4" chip	CERESITE-QTZ	" " +FE	29 PPB AU
B-14	4" chip	CERESITE-QTZ-	" " +ZN	560 PPM ZN
B-15	5" chip	GABBRO-QTZ	" " +FE	—
B-16	5" chip	GABBRO-QTZ	" " +FE	—
C-1	4" chip	CERESITE-QTZ	" "	44 PPB AU
C-2	5" chip	GABBRO	" " +FE	143 PPM ZN 135 PPM ZN
C-3	4" chip	BLACK ANTESITE	MED "	7 PPB AU
C-4	5" chip	CERESITE QTZ	MINOR "	1201 PPM ZN
C-5	5" chip	GABBRO-QTZ	" "	—
C-6	5" chip	CERESITE-QTZ	" "	99 PPM CU
C-7	5" chip	CERESITE-QTZ	" "	41 PPM ZN
C-8	5" chip	CERESITE-QTZ	" " +FE	47 PPM ZN
C-9	5" chip	CERESITE-QTZ	" " +FE	128 PPM ZN
C-10	8" chip	BROWNISH-ZN FRACTURED QTZ	" SULPHIDE CU	3917 PPM CU 1683 PPM ZN 13444 PPB AU
C-11	8" chip	QTZ & CERESITE	" " CU+ZN	259 PPM CU 4861 PPM ZN 1384 PPB AU
C-12	5" chip	CERESITE	" "	22 PPB AU
C-13	5" chip	CERESITE	" "	16 PPB AU
C-14	5" chip	CERESITE	" "	40 PPM ZN
C-15	5" chip	CERESITE-QTZ	" " CU	38 PPB AU 4784 PPM ZN
D-1	8" chip	FRACTURED RUSTY QTZ	" "	2770 PPB AU
D-2	8" chip	QTZ+CERESITE	" "	216 PPB AU
D-3	5" chip	CERESITE-QTZ	" "	16 PPB AU
D-4	5" chip	CERESITE QTZ	" "	45 PPB AU
D-5	5" chip	CERESITE QTZ	" "	—

Activation Laboratories Ltd. Work Order: 11131 Report: 10939

Sample description	AU PPB	AG PPH	AS PPH	BA PPH	BR PPH	CA %	CO PPH	CR PPH	CS PPH	FE %	HF PPH	HG PPH	IR PPB	MO PPH	NA %	NI PPM	RB PPM	SB PPM	SC PPM	SE PPM	SN %	SR %	TA PPM	TH PPM
A-1	<2	<5	0.9	<50	<0.5	7	16	18	<1	26.9	<1	<1	<5	<1	0.11	<22	<15	0.5	9.1	<3	<0.01	<0.05	<0.5	0.5
A-2	<2	<5	3.0	<50	<0.5	10	42	210	<1	9.14	2	<1	<5	<1	1.28	<28	52	3.9	52	<3	<0.01	<0.05	<0.5	<0.2
A-3	<2	<5	22	<50	<0.5	9	52	170	<1	12.2	2	<1	<5	<1	0.42	<28	<15	1.3	46	<3	<0.01	<0.05	<0.5	0.5
A-4	151	16	1.4	580	<0.5	<1	1	5	<1	2.50	13	<1	<5	2	2.00	<20	41	1.4	3.7	<3	<0.01	<0.05	2.0	12
A-5	67	<5	<0.5	810	<0.5	<1	1	12	<1	2.65	17	<1	<5	<1	2.46	<25	55	0.9	5.1	<3	0.03	<0.05	3.7	14
" 6	6	<5	3.5	200	<0.5	<1	27	61	<1	7.30	3	<1	<5	<1	5.85	<35	<15	2.7	31	<3	<0.01	<0.05	<0.5	2.4
7	7	<5	2.0	340	<0.5	2	13	120	<1	5.83	11	<1	<5	<1	2.30	<24	35	1.2	18	<3	<0.01	<0.05	<0.5	5.7
8	<2	<5	<0.5	540	<0.5	<1	1	<5	<1	1.55	12	<1	<5	<1	1.64	<20	78	0.6	2.8	<3	<0.01	<0.05	2.4	12
9	27200	22	160	230	<0.5	<1	46	7	<1	22.5	6	<1	<5	<1	0.45	<24	34	5.9	1.6	3	<0.01	<0.05	0.9	5.0
10	12	<5	3.6	400	<0.5	3	35	17	<1	12.5	6	<1	<5	<1	1.82	<32	33	1.2	39	<3	<0.01	<0.05	<0.5	2.7
" 11	2020	10	1.7	650	<0.5	<1	2	6	<1	2.89	15	<1	<5	<1	2.44	<23	49	9.8	4.7	<3	<0.01	<0.05	1.8	14
12	11	<5	1.9	780	<0.5	<1	1	7	1	2.03	19	<1	<5	<1	0.83	<20	74	1.6	5.8	<3	0.03	<0.05	3.0	15
13	1340	<5	1.9	110	0.6	<1	<1	26	<1	1.02	2	<1	<5	14	0.03	<20	<15	2.4	0.5	<3	<0.01	<0.05	<0.5	2.0
14	3	<5	<0.5	470	<0.5	2	14	130	3	4.02	5	<1	<5	4	4.58	<29	79	0.4	14	<3	0.07	<0.05	<0.5	9.8
15	66100	50	6.2	390	1.8	<1	6	28	<1	3.19	9	<1	<5	<2	0.94	<20	26	10	2.8	<3	<0.02	<0.05	<0.5	8.9
" 16	435	<5	<0.5	670	<0.5	2	2	10	<1	2.79	15	<1	<5	<1	3.03	<24	36	1.3	4.4	<3	0.02	<0.05	1.9	12
17	9200	80	3.3	500	<0.5	2	20	12	<1	3.66	8	2	<5	<1	1.74	<37	39	89	4.2	25	<0.02	<0.05	<0.5	8.5
18	22	<5	<0.5	1300	<0.5	<1	6	6	1	3.99	17	<1	<5	2	0.09	<22	75	1.2	5.4	<3	<0.01	<0.05	3.5	15

Activation Laboratories Ltd. Work Order: 11131 Report: 10939

Sample description	U PPM	W PPM	ZN PPM	LA PPM	CE PPM	ND PPM	SM PPM	EU PPM	TB PPM	YB PPM	LU PPM	Mass g
A 1	<0.5	<1	291	5.0	9	<5	1.1	0.5	<0.5	1.5	0.10	38.72
R 2	<0.5	6	429	5.8	14	12	2.6	1.1	1.1	3.4	0.55	37.55
A 3	<0.5	<1	150	5.8	16	5	3.0	1.3	<0.5	1.8	0.31	33.99
A 4	3.1	<1	256	54	120	54	14	2.3	2.6	17.4	2.48	32.97
A 5	4.0	<1	1410	83	180	75	19	2.8	4.4	24.5	3.56	28.96
H 6	<0.5	<1	<50	14	30	16	3.6	1.1	<0.5	3.2	0.38	29.30
7	2.0	<1	98	39	84	47	11	2.4	2.1	12.5	1.89	34.31
8	2.5	<1	116	37	110	43	11	1.3	3.1	18.6	2.69	28.52
9	2.9	<1	17400	38	73	28	7.5	1.3	1.7	10.8	1.54	53.63
10	<0.5	<1	242	21	49	27	6.4	2.2	1.5	5.7	0.84	27.18
11	2.1	<1	3170	80	160	70	17	2.4	3.9	22.1	3.12	34.64
12	3.5	<1	105	59	130	61	14	2.0	3.5	24.2	3.43	25.98
13	1.0	<1	97	11	24	13	2.4	0.3	<0.5	1.5	0.24	37.48
14	2.5	<1	142	29	54	22	3.5	1.2	<0.5	1.7	0.17	31.10
15	<0.5	<1	3340	64	130	62	14	2.1	2.7	14.0	2.06	36.77
16	2.9	<1	127	78	170	75	18	2.7	3.9	21.5	2.99	32.87
17	<0.5	<1	66400	52	87	22	7.8	1.6	3.2	12.6	1.98	39.94
18	3.7	2	360	83	190	91	20	3.2	4.6	25.3	3.63	23.41

Activation Laboratories Ltd. Work Order: 11680 Report: 11455

Sample description	AU PPB	AG PPM	AS PPM	BA PPM	BR PPM	CA %	CO PPM	CR PPH	CS PPH	FE %	HF PPM	HG PPH	IR PPB	MO PPM	NA %	NI PPM	RB PPH	SB PPH	SC PPH	SE PPM	SN %	SR %	TA PPM	TH PPM
B-1	15	<5	<2	630	<1	<1	<5	160	<2	1.94	12	<1	<5	<5	2.65	<50	40	<0.2	3.6	<5	<0.01	<0.05	2	11
B-2	7	<5	3	1100	<1	<1	<5	<10	<2	3.17	16	<1	<5	<5	3.20	<50	<30	<0.2	4.9	<5	<0.01	<0.05	5	15
B-3	9	<5	6	760	<1	7	34	1500	3	6.28	2	<1	<5	<5	0.27	180	76	0.8	19	<5	<0.01	<0.05	<1	1.7
B-4	16	<5	<2	<100	<1	<1	<5	<10	<2	0.41	<1	<1	<5	<5	0.12	<50	<30	0.2	0.2	<5	<0.01	<0.05	<1	0.6
B-5	274	<5	<2	180	<1	<1	<5	79	<2	0.71	3	<1	<5	<5	0.77	<50	<30	1.3	0.8	<5	<0.01	<0.05	<1	3.1
B 6	13	<5	2	<100	<1	4	32	180	<2	9.21	2	<1	<5	<5	3.56	<50	64	<0.2	33	<5	<0.02	<0.05	3	1.1
7	<5	<5	<2	250	11	2	23	110	<2	2.21	2	<1	<5	<5	3.40	<50	90	<0.2	6.7	<5	<0.01	<0.05	<1	4.3
8	121000	78	110	<100	<1	<1	9	<10	<2	1.88	1	<1	<5	<5	0.09	<50	<30	<0.2	0.3	<5	<0.03	<0.05	<1	<0.6
9	113	<5	<2	180	<1	<1	<5	76	<2	2.37	3	<1	<5	<5	0.02	<50	<30	0.3	0.7	<5	<0.01	<0.05	<1	1.0
" 10	108	<5	3	280	2	<1	<5	<10	<2	1.41	4	<1	<5	<5	1.00	<50	<30	0.3	0.8	<5	<0.01	<0.05	<1	3.4
" 11	17	<5	<2	490	<1	<1	16	12	<2	8.42	7	<1	<5	<5	2.56	<50	<30	<0.2	20	<5	<0.01	<0.05	<1	4.1
12	<5	<5	<2	860	<1	<1	<5	<10	<2	1.46	12	<1	<5	<5	1.88	<50	<30	1.0	3.6	<5	<0.01	<0.05	<1	10
13	29	<5	<2	590	<1	3	41	240	<2	10.6	3	<1	<5	<5	1.90	<50	44	0.9	30	<5	<0.02	<0.05	<1	<0.5
14	<5	<5	<2	600	<1	5	13	49	<2	5.79	5	<1	<5	<5	1.18	<50	45	0.4	15	<5	<0.01	<0.05	<1	4.9
15	<5	<5	3	<100	<1	3	41	180	<2	6.62	3	<1	<5	<5	3.63	<50	<30	2.0	25	<5	<0.02	<0.05	<1	1.7
" 16	<5	<5	<2	390	<1	4	28	110	<2	6.52	3	<1	<5	<5	4.13	<50	<30	2.4	23	<5	<0.02	<0.05	<1	2.1

Activation Laboratories Ltd. Work Order: 11680 Report: 11455

Sample description	U PPM	W PPM	ZN PPM	LA PPM	CE PPM	ND PPM	SM PPM	EU PPM	TB PPM	YB PPM	LU PPM	Mass g
B 1	1.9	<4	237	70	150	68	14	1.8	2.4	16.6	2.82	32.01
B 2	3.1	<4	153	90	190	81	19	3.0	3.6	23.8	3.81	32.82
B 3	<0.5	4	243	20	48	25	6.1	1.9	<0.5	3.3	0.50	30.18
B 4	<0.5	<4	2300	3	6	<5	0.7	<0.2	<0.5	1.1	0.19	37.85
B 5	0.8	<4	693	23	48	19	4.5	0.5	0.8	6.0	1.03	35.39
B 6	<0.5	<4	<50	11	25	17	2.8	0.9	<0.5	2.2	0.40	35.82
7	<0.5	<4	<50	7	12	<5	0.6	0.3	<0.5	0.3	<0.05	30.29
8	<1.9	<4	5430	7	10	<5	1.3	0.2	0.7	1.6	0.24	18.63
9	<0.5	<4	52	11	25	8	2.8	0.8	0.5	3.5	0.59	35.29
10	<0.5	<4	349	26	59	22	5.5	0.6	0.9	6.4	1.01	30.77
11	<0.5	<4	142	33	70	35	7.4	2.1	1.2	7.6	1.32	37.65
12	1.3	<4	<50	44	100	34	9.3	1.6	2.1	14.6	2.31	33.25
13	<0.5	<4	188	8	19	11	3.1	1.3	<0.5	3.1	0.55	34.25
14	<0.5	<4	560	32	76	30	8.5	1.5	1.8	12.5	2.06	34.15
15	<0.5	<4	<50	6	16	6	2.0	0.8	1.2	2.2	0.35	36.04
16	<0.5	<4	<50	10	22	10	2.4	0.8	1.6	2.2	0.28	32.83



# ACCURASSAY LABORATORIES

A DIVISION OF ASSAY LABORATORY SERVICES INC.

1070 LITHIUM DRIVE, UNIT 2  
THUNDER BAY, ONTARIO P7B 6G3  
PHONE (807) 623-6448  
FAX (807) 623-6820

Page 1

L. COUSINEAU  
P.O. BOX 33  
FORT FRANCIS, ONTARIO  
P9A 3M5  
FAX (807) 274-4686

Nov. 13, 1996

Job# 9641457

Accurassay	SAMPLE # Customer	Gold ppb	Gold Oz/t
C-1	1	44	0.001
C-2	2	<5	<0.001
C-3	3	7	<0.001
C-4	4	<5	<0.001
C-5	5	8	<0.001
C-6	6	<5	<0.001
" 7	7	<5	<0.001
8	8	15	<0.001
9	9	8	<0.001
" 10	10	13444	0.392
11 Check	10	12152	0.354
12	11	1384	0.040
" 13	12	22	<0.001
14	13	16	<0.001
15	14	26	<0.001
" 16	15	38	<0.001

Certified By: \_\_\_\_\_

*DBB*



# ACCURASSAY LABORATORIES

A DIVISION OF ASSAY LABORATORY SERVICES INC.

1070 LITHIUM DRIVE, UNIT 2  
THUNDER BAY, ONTARIO P7B 6G3  
PHONE (807) 623-6448  
FAX (807) 623-6820

L. COUSINEAU  
P.O. BOX 33  
FORT FRANCIS, ONTARIO

Page 1  
Nov. 13, 1996

Job# 9641457

FAX (807)274-4676

Sample	Ag ppm	Al %	As ppm	B ppm	Ba ppm	Be ppm	Bi ppm	Ca %	Cd ppm	Co ppm	Cr ppm	Cu ppm	Fe %	Hg ppm	La ppm
C- 1	<0.1	0.11	8	7	29	0.4	<3	1.02	<0.5	9	253	6	2.53	<3	33
C- 2	0.6	1.23	6	7	62	0.3	<3	0.37	<0.5	22	108	55	6.33	<3	26
C- 3	2.9	3.65	34	118	66	2.2	<3	2.79	3.2	65	82	73	9.32	3	12
C- 4	<0.1	0.12	7	<5	31	0.3	<3	0.53	1.5	13	351	27	1.17	<3	14
C- 5	0.4	0.93	10	47	267	1.1	<3	0.27	<0.5	16	121	31	2.62	<3	14
C- 6	0.3	0.85	11	103	37	1.0	<3	1.03	<0.5	27	97	99	4.32	<3	8
C- 7	<0.1	0.79	14	62	173	0.8	<3	0.05	<0.5	11	163	55	3.70	<3	12
" 8	1.7	0.28	26	34	49	1.5	<3	5.13	1.4	50	52	177	5.63	<3	2
" 9	1.8	1.95	29	14	58	2.2	<3	5.02	1.8	43	61	87	6.95	<3	3
" 10	6.9	0.05	7	26	12	0.2	<3	0.02	2.6	15	330	3917	1.22	<3	<1
" 11	6.1	0.24	<2	28	49	0.5	<3	0.75	29.9	7	130	259	1.01	<3	72
" 12	<0.1	0.10	14	13	21	0.6	<3	1.08	<0.5	11	258	7	2.77	<3	32
" 13	<0.1	0.13	7	23	70	0.3	<3	0.04	<0.5	3	121	7	2.09	<3	34
" 14	<0.1	0.26	15	45	29	0.5	<3	0.99	<0.5	8	144	9	3.07	<3	22
" 15	2.6	0.02	<2	8	14	0.3	<3	0.04	<0.5	16	368	4784	1.22	<3	1
	Mg %	Mn ppm	Mo ppm	Na %	Ni ppm	P ppm	Pb ppm	Sb ppm	Si %	Sr ppm	Ti %	V ppm	W ppm	Zn ppm	
C- 1	0.17	462	<1	<0.01	9	57	5	<2	0.03	54	0.01	10	<2	24	
C- 2	0.31	1113	3	<0.01	5	1967	15	<2	0.09	9	0.03	7	<2	143	
C- 3	1.99	1347	5	<0.01	13	1345	39	<2	0.09	67	0.04	101	<2	235	
C- 4	0.21	363	1	<0.01	12	35	8	<2	0.03	27	<0.01	13	12	1201	
C- 5	0.90	320	3	<0.01	38	571	12	<2	0.03	28	0.26	51	<2	63	
C- 6	0.48	1236	3	<0.01	19	1026	6	<2	0.03	14	0.09	44	<2	26	
C- 7	0.43	188	10	<0.01	23	198	14	<2	0.03	16	0.14	50	<2	41	
" 8	1.16	1196	2	<0.01	85	974	27	<2	0.05	83	0.03	20	<2	47	
" 9	2.59	1269	3	<0.01	121	857	31	<2	0.08	99	0.03	60	5	128	
" 10	0.01	97	1	<0.01	14	<10	431	<2	0.02	<1	<0.01	12	33	1683	
" 11	0.17	217	1	<0.01	4	17	4058	<2	0.03	22	<0.01	4	100	4861	
" 12	0.21	492	2	<0.01	13	51	<2	<2	0.03	52	0.01	10	<2	25	
" 13	0.01	89	<1	<0.01	5	211	<2	<2	0.03	4	<0.01	6	<2	19	
" 14	0.23	662	1	<0.01	13	40	21	<2	0.03	36	<0.01	7	<2	40	
" 15	0.01	155	25	<0.01	16	36	16	<2	0.02	<1	<0.01	12	<2	132	

Certified By:



# ACCURASSAY LABORATORIES

A DIVISION OF ASSAY LABORATORY SERVICES INC.

1070 LITHIUM DRIVE, UNIT 2  
THUNDER BAY, ONTARIO P7B 6G3  
PHONE (807) 623-6448  
FAX (807) 623-6820

Page 1

LOUIS COUSINEAU  
P.O. BOX 33  
FORT FRANCIS, ONTARIO  
P9A 3M5

Jan. 7, 1997

Job# 9740005

Accurassay	SAMPLE # Customer		Gold ppb	Gold Oz/t
	D-1	1	2970	0.087
	D-2	2	216	0.006
	D-3	3	16	<0.001
	D-4	4	45	0.001
	D-5	5	<5	<0.001
	6 Check	5	<5	<0.001

Certified By:





Declaration of Assessment Work Performed on Mining Land

Transaction Number (office use) W 9710.00016 Assessment Files Research Imaging



52C16SW0012 2.17085 BENNETT LAKE

900

and 66(3) of the Mining Act. Under section 8 of the Act work and correspond with the mining land holder. of Northern Development and Mines, 6th Floor,

2.17085

Personal information Mining Act, the info Questions about 1 933 Ramsey Lake

Instructions: - For work performed on Crown Lands before recording a claim, see Form 0210. - Please type or print in ink.

RECEIVED FEB 27 1997 MINING LANDS BRANCH

1. Recorded holder(s) (Attach a list if necessary)

Name: LOUIS COUSINEAU, Address: P.O. Box 33, FORT FRANCES, ONT., Telephone Number: 807-274-3761, Fax Number: 807-274-4686

2. Type of work performed: Check (✓) and report on only ONE of the following groups for this declaration.

Geotechnical: [ ] Physical: [x] Rehabilitation: [ ] Work Type: (PSTRIP) (ASSAYS) (PDRILL) (PTRNCH), Office Use: Commodity: GOLD, Total \$ Value of Work Claimed: \$99,727.00, Date Work Performed: From 17 5 96 To 29 12 96, Township/Area: BENNETT LAKE, Mining Division: KENORA

Please remember to: - obtain a work permit from the Ministry of Natural Resources as required; - provide proper notice to surface rights holders before starting work; - complete and attach a Statement of Costs, form 0212; - provide a map showing contiguous mining lands that are linked for assigning work; - include two copies of your technical report.

3. Person or companies who prepared the technical report (Attach a list if necessary)

Name: LOUIS COUSINEAU, Telephone Number: 807-274-3761, Address: P.O. Box 33 Fort Frances, Ont. P9A3M5, Name: RAY COUSINEAU, Telephone Number: 807-274-3923, Address: 430 1st St. E Fort Frances Ont. P9A3M5, Name: KEN DESTARDINS, Telephone Number: 807-274-6747, Address: 518 Nelson St. Fort Frances, Ont. P9A1B4

4. Certification by Recorded Holder or Agent

LOUIS COUSINEAU, do hereby certify that I have personal knowledge of the facts set forth in this Declaration of Assessment Work having caused the work to be performed or witnessed the same during or after its completion and, to the best of my knowledge, the annexed report is true.

Signature of Recorded Holder or Agent: Louis Cousineau, Date: Feb 4/97, Agent's Address: P.O. Box 33, Fort Frances, Ont. P9A3M5, Telephone Number: 807-274-3761, Fax Number: 807-274-4686

5. Work to be recorded and distributed. Work can only be assigned to claims that are contiguous (adjoining) to the mining land where work was performed, at the time work was performed. A map showing the contiguous link must accompany this form.

Mining Claim Number. Or if work was done on other eligible mining land, show in this column the location number indicated on the claim map.	Number of Claim Units. For other mining land, list hectares.	Value of work performed on this claim or other mining land.	Value of work applied to this claim.	Value of work assigned to other mining claims.	Bank. Value of work to be distributed at a future date.
eg TB 7827	16 ha	\$26,825	N/A	\$24,000	\$2,825
eg 1234567	12	0	\$24,000	0	0
eg 1234568	2	\$8,892	\$4,000	0	\$4,892
1 1149372	1		400		
2 1149373	1		400		
3 1149385	1		400		
4 1149386	1		400		
5 1149387	1		400		
6 1150080	2		800		
7 1161200	1		400		
8 1161201	8		3200		
9 1161202	6		1800		
10 1161434	2		600		
11 1161435	6		409		
12 1161513	6		2142		
13 1161514	12		6257		
14 1161515	14		4000		
15 1178566	9	29727	3600	25,208	4519
Column Totals		29727	25208	25,208	4519

2. 17035

I, \_\_\_\_\_, do hereby certify that the above work credits are eligible under subsection 7 (1) of the Assessment Work Regulation 6/96 for assignment to contiguous claims or for application to the claim where the work was done.

Signature of Recorded Holder or Agent Authorized in Writing: Louis Cousineau Date: FEB. 4, 1997

6. Instructions for cutting back credits that are not approved.

Some of the credits claimed in this declaration may be cut back. Please check (✓) in the boxes below to show how you wish to prioritize the deletion of credits:

- 1. Credits are to be cut back from the Bank first, followed by option 2 or 3 or 4 as indicated.
- 2. Credits are to be cut back starting with the claims listed last, working backwards; or
- 3. Credits are to be cut back equally over all claims listed in this declaration; or
- 4. Credits are to be cut back as prioritized on the attached appendix or as follows (describe):

CREDITS CUT BACK ON BANK VALUE OF CLAIM 1178566

Note: If you have not indicated how your credits are to be deleted, credits will be cut back from the Bank first, followed by option number 2 if necessary.

**For Office Use Only**  
 RECEIVED  
 FEB - 7 1997  
 AM 7 8 9 10 11 12 1 2 3 4 5 6 PM

Deemed Approved Date: MAY 8, 1997  
 Date Approved: \_\_\_\_\_  
 Date Notification Sent: \_\_\_\_\_  
 Total Value of Credit Approved: \_\_\_\_\_  
 Approved for Recording by Mining Recorder (Signature): [Signature]

Personal information collected on this form is obtained under the authority of subsection 6(1) of the Assessment Work Regulation 6/96. Under section 8 of the Mining Act, the information is a public record. This information will be used to review the assessment work and correspond with the mining land holder. Questions about this collection should be directed to the Chief Mining Recorder, Ministry of Northern Development and Mines, 6th Floor, 933 Ramsey Lake Road, Sudbury, Ontario, P3E 6B5.

Work Type	Units of Work <small>Depending on the type of work, list the number of hours/days worked, metres of drilling, kilometres of grid line, number of samples, etc.</small>	Cost Per Unit of work	Total Cost
STRIP-DRILL-SAMPLE	LOUIS - 53 DAYS	c 150	7950.00
	RAY - 53 DAYS	c 150	7950.00
	KEN - 53 DAYS	c 150	7950.00
<b>Associated Costs (e.g. supplies, mobilization and demobilization).</b>			
	35 ASSAYS	c 30.56	1119.00
	EXPLOSIVES - B-LINE - FUSES	178.00	178.00
	5-DAYS PLUGGER RENTAL	39.00	195.00
<b>Transportation Costs</b>			
	TRUCK, 161 KM @ 30 = 48.30, 53 DAYS	c 48.30	2559.00
<b>Food and Lodging Costs</b>			
	LOUIS 53 DAYS	c 14.00	742.00
	RAY 53 DAYS	c 14.00	742.00
	KEN 53 DAYS	c 14.00	742.00
<b>Total Value of Assessment Work</b>			<b>29,727.00</b>

**Calculations of Filing Discounts:**

1. Work filed within two years of performance is claimed at 100% of the above Total Value of Assessment Work.
2. If work is filed after two years and up to five years after performance, it can only be claimed at 50% of the Total Value of Assessment Work. If this situation applies to your claims, use the calculation below:

TOTAL VALUE OF ASSESSMENT WORK  $\times 0.50 =$  Total \$ value of worked claimed.

**Note:**

- Work older than 5 years is not eligible for credit.
- A recorded holder may be required to verify expenditures claimed in this statement of costs within 45 days of a request for verification and/or correction/clarification. If verification and/or correction/clarification is not made, the Minister may reject all or part of the assessment work submitted.

**Certification verifying costs:**

I, LOUIS COUSINEAU (please print full name), do hereby certify, that the amounts shown are as accurate as may reasonably be determined and the costs were incurred while conducting assessment work on the lands indicated on the accompanying Declaration of Work form as RECORDED HOLDER (recorded holder, agent, or state company position with signing authority) I am authorized to make this certification.

Signature: Louis Cousineau  
Date: Feb. 4/97

Ministry of  
Northern Development  
and Mines

Ministère du  
Développement du Nord  
et des Mines



Geoscience Assessment Office  
933 Ramsey Lake Road  
6th Floor  
Sudbury, Ontario  
P3E 6B5

June 10, 1997

Scott A. Rivett  
Mining Recorder  
808 Robertson Street  
P.O. Box 5200  
Kenora, ON  
P9N 3X9

Telephone: (705) 670-5853  
Fax: (705) 670-5863

Dear Sir or Madam:

Submission Number: 2.17085

**Status**

**Subject: Transaction Number(s):** W9710.00016 Approval After Notice

---

We have reviewed your Assessment Work submission with the above noted Transaction Number(s). The attached summary page(s) indicate the results of the review. WE RECOMMEND YOU READ THIS SUMMARY FOR THE DETAILS PERTAINING TO YOUR ASSESSMENT WORK.

If the status for a transaction is a 45 Day Notice, the summary will outline the reasons for the notice, and any steps you can take to remedy deficiencies. The 90-day deemed approval provision, subsection 6(7) of the Assessment Work Regulation, will no longer be in effect for assessment work which has received a 45 Day Notice.

Please note any revisions must be submitted in DUPLICATE to the Geoscience Assessment Office, by the response date on the summary.

NOTE: This correspondence may affect the status of your mining lands. Please contact the Mining Recorder to determine the available options and the status of your claims.

If you have any questions regarding this correspondence, please contact Bruce Gates by e-mail at gates\_b@torv05.ndm.gov.on.ca or by telephone at (705) 670-5856.

Yours sincerely,

A handwritten signature in black ink, appearing to read "Ron C. Gashinski".

ORIGINAL SIGNED BY  
Ron C. Gashinski  
Senior Manager, Mining Lands Section  
Mines and Minerals Division

# Work Report Assessment Results

**Submission Number:** 2.17085

**Date Correspondence Sent:** June 10, 1997

**Assessor:** Bruce Gates

**General Comment:**

For approval of future physical submissions ensure that the nature of the rock types and mineralization is shown on the maps.

---

<b>Transaction Number</b>	<b>First Claim Number</b>	<b>Township(s) / Area(s)</b>	<b>Status</b>	<b>Approval Date</b>
W9710.00016	1178566	BENNETT LAKE	Approval After Notice	May 26, 1997

**Section:**

10 Physical PMAN

10 Physical PTRNCH

The revisions outlined in the Notice dated April 11, 1997, have been corrected. Accordingly, assessment work credit has been approved as outlined on the Declaration of Assessment Work Form accompanying this submission.

**Correspondence to:**

Mining Recorder  
Kenora, ON

Resident Geologist  
Kenora, ON

Assessment Files Library  
Sudbury, ON

**Recorded Holder(s) and/or Agent(s):**

LOUIS E COUSINEAU  
Fort Frances, Ontario

MANION LAKE AREA - G-2686

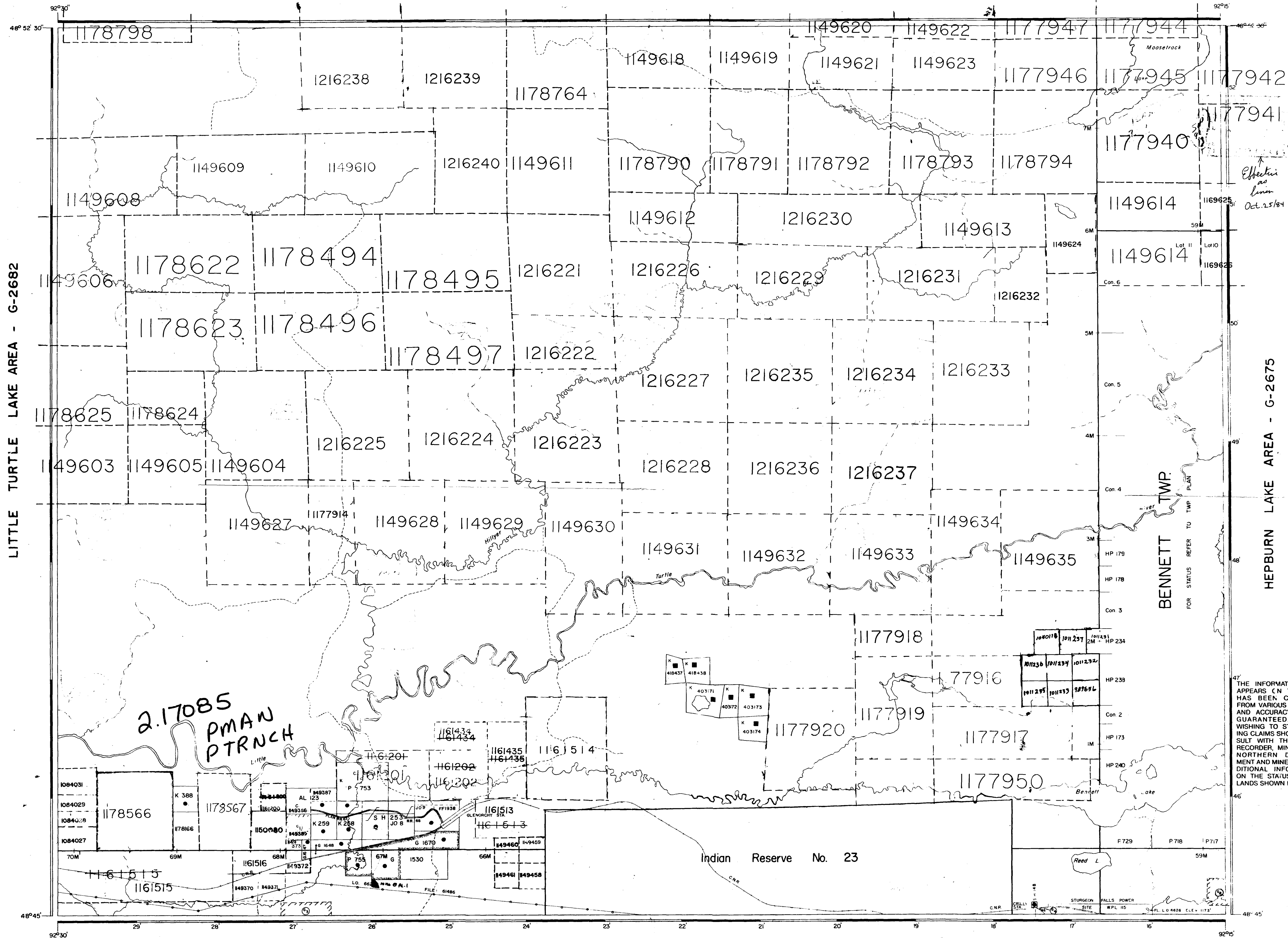

LITTLE TURTLE LAKE AREA - G-2682

HEPBURN LAKE AREA - G-2675

2.17085  
P.M.A.W.  
P.T.R.N.C.H.

Indian Reserve No. 23

WILD POTATO LAKE AREA - G-2703

LEGEND

- HIGHWAY AND ROUTE No.
- OTHER ROADS
- TRAILS
- SURVEYED LINES
  - TOWNSHIPS BASE LINES, ETC.
  - LOTS, MINING CLAIMS, PARCELS, ETC.
- UNSURVEYED LINES
  - LOT LINES
  - PARCEL BOUNDARY
  - MINING CLAIMS ETC.
- RAILWAY AND RIGHT OF WAY
- UTILITY LINES
- NON-PERENNIAL STREAM
- FLOODING OR FLOODING RIGHTS
- SUBDIVISION OR COMPOSITE PLAN
- RESERVATIONS
- ORIGINAL SHORELINE
- MARSH OR MUSKEG
- MINES
- TRAVERSE MONUMENT

DISPOSITION OF CROWN LANDS

TYPE OF DOCUMENT	SYMBOL
PATENT, SURFACE & MINING RIGHTS	●
" SURFACE RIGHTS ONLY	○
" MINING RIGHTS ONLY	○
LEASE, SURFACE & MINING RIGHTS	■
" SURFACE RIGHTS ONLY	■
" MINING RIGHTS ONLY	■
LICENCE OF OCCUPATION	▼
ORDER-IN-COUNCIL	OC
RESERVATION	○
CANCELLED	○
SAND & GRAVEL	○

NOTE: MINING RIGHTS IN PARCELS PATENTED PRIOR TO MAY 8 1913, VESTED IN ORIGINAL PATENTEE BY THE PUBLIC LANDS ACT, R.S.O. 1970, CHAP. 380, SEC. 63, SUBSEC. 1

REFERENCES

AREAS WITHDRAWN FROM DISPOSITION

- M.R.O. - MINING RIGHTS ONLY
  - S.R.O. - SURFACE RIGHTS ONLY
  - M.+S. - MINING AND SURFACE RIGHTS
- | Description            | Order No. | Date | Disposition                  | File               |
|------------------------|-----------|------|------------------------------|--------------------|
| <b>SAND AND GRAVEL</b> |           |      |                              |                    |
| ⑤                      |           |      | GRAVEL                       | FILE 162718        |
| ⑤                      |           |      | M.T.C. PIT 1089              | GRAVEL FILE 162718 |
| ⑤                      |           |      | M.T.C. PIT 1058              |                    |
| ⑤                      |           |      | GRAVEL                       | FILE 16799 vol 7   |
| ⑤                      |           |      | M.N.R. Gravel Reserve No 228 | FILE 162718        |
| ⑤                      |           |      | M.T.C. PIT N° 18-14          |                    |

SCALE: 1 INCH = 4 CHAINS

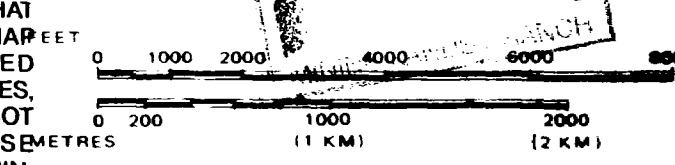

THE INFORMATION THAT APPEARS ON THIS MAP SHEET HAS BEEN COMPILED FROM VARIOUS SOURCES, AND ACCURACY IS NOT GUARANTEED. THOSE WISHING TO STAKE MINING CLAIMS SHOULD CONSULT WITH THE MINING RECORDER, MINISTRY OF NORTHERN DEVELOPMENT AND MINES, FOR ADDITIONAL INFORMATION ON THE STATUS OF THE LANDS SHOWN HEREON.

BENNETT LAKE

M.N.R. ADMINISTRATIVE DISTRICT  
FORT FRANCES MINING DIVISION  
KENORA  
LAND TITLES / REGISTRY DIVISION  
RAINY RIVER

DATE OF ISSUE  
JUN 11 1987  
KENORA MINING DIVISION

Ministry of Natural Resources  
Ontario  
Land Management Branch

Date FEBRUARY, 1984  
Number  
M-2392  
G-2667



G2667