

STRIPPING AND TRENCHING Di

52C16SW8263 63.5721 BENNETT LAKE

010

PROJECT AREADATEWORK PERFORMED

BENNETT LAKE

MAY 19 / 91

STRIPPING ZONE 20  
SOUTH LINE CLAIM 114946

MAY 20 / 91

STRIPPING ZONE 21  
AROUND OLD PIT  
CENTER AREA CLAIM 114945

MAY 21 / 91

SHOWED OLD PIT TO  
INCO GEOLOGIST.  
WILL DO MORE WORK IN WINTER  
WHEN GROUND IS FROZEN FOR  
BETTER - SNOW ACCESSLOCATION OF STRIPPING AND TRENCHING

SKETCH ATTACHED

SKETCH OF TRENCHING AND SAMPLINGDESCRIPTION OF SAMPLES

SKETCH ATTACHED

INCO GEOLOGIST REPORT OF SAMPLING ENCLOSED

JAN 11 / 92 STRIP + TRENCH ZONE 22  
CLAIM 1149459 - 1 SAMPLE

JAN 12 / 92 DRILL + BLAST ZONE 22  
CLAIM 1149459

JAN 13 / 92 DRILL + BLAST + TRENCH ZONE 22  
CLAIM 1149459 (HARD TO DRILL LOTS  
OF FRACTURED ROCK)

JAN 14 / 92 STRIP + TRENCH NEW ZONE 23  
CLAIM 1149459

JAN 15 / 92 DRILL + BLAST - TRENCH - ZONE 23

<u>SAMPLE NO.</u>	<u>TYPE</u>	<u>ROCK TYPE</u>	<u>MINERALIZATION</u>	<u>ASSAY</u>
11	4" CHIP	TUFF & QTZ STRINGERS	MINOR SULPHIDE	.48 AU
21	13" CHIP	TUFF & QTZ STRINGERS	" "	.04 AU
22	6" CHIP	QUARTZ VEIN + TUFF	" "	.86 AU
23	10" CHIP	TUFF & QTZ STRINGERS	" "	TR AU
28	12" CHIP	TUFF & QTZ STRINGERS	" "	TR AU

LOCATION OF STRIPPING AND TRENCHING

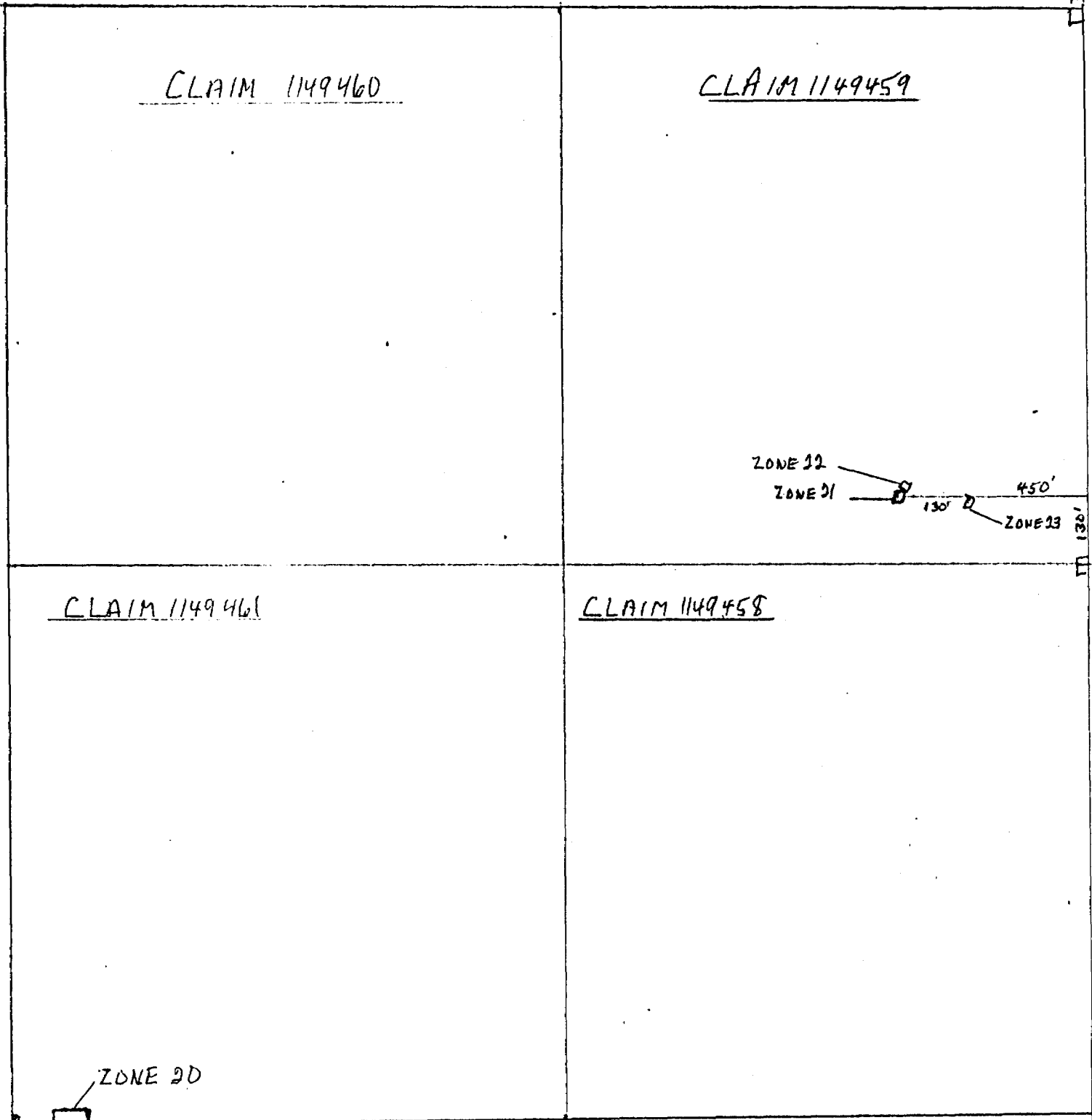

SKETCH OF STRIPPING AND TRENCHING

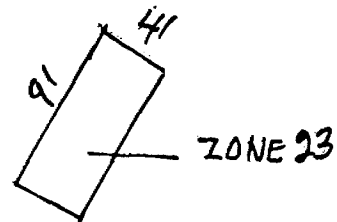
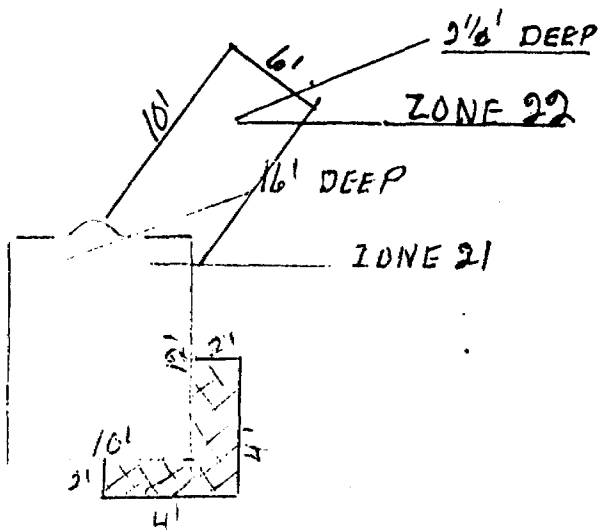
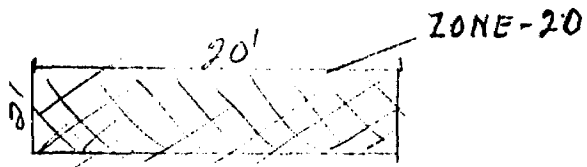

 STRIPPING

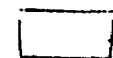
 TRENCH

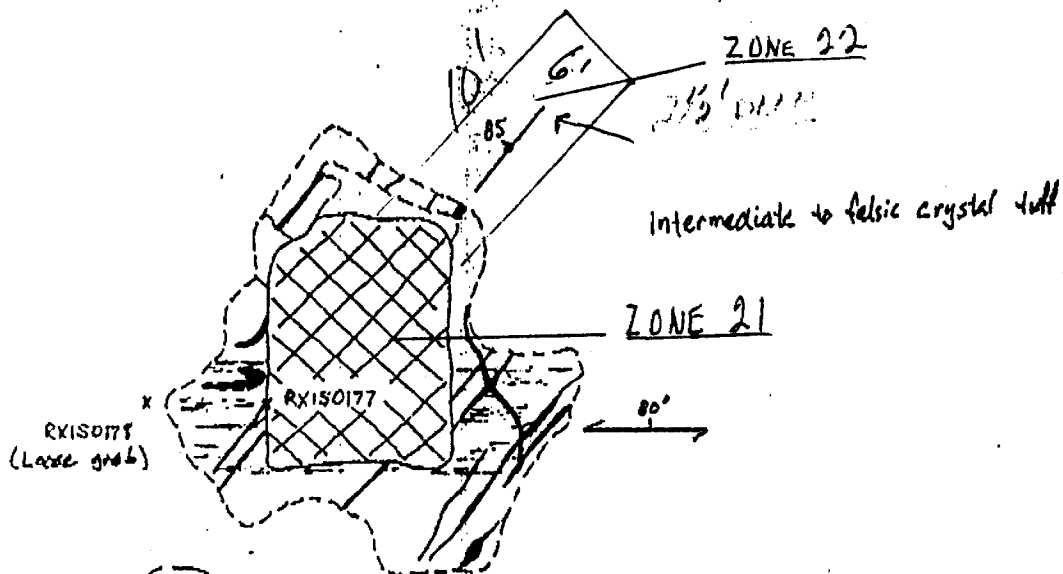

- quartz vein
- foliated.
- Pit

RX150176	-	13 ppb
RX150177	-	3.57 g/t Au
RX150178	-	1.14 g/t Au
RX150179	-	76 ppb
RX150180	-	36.4 g/t Au
RX150181	-	6.34 g/t Au

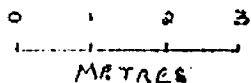

**GRID LOCATION MAP**

AREA \_\_\_\_\_  
 ANOMALY No. \_\_\_\_\_  
 TOWNSHIP \_\_\_\_\_  
 Scale: \_\_\_\_\_

Activation Laboratories Ltd.

Work Order: 2748 Report: 2760

Sample description	AS PPH	AS PPH	AS PPH	CA %	CO PPH	CR PPH	CS PPH	FE %	HF PPH	HG PPH	IR PPH	K %	MO PPH	NA PPH	NI PPH	RB PPH	SS PPH	SC PPH	SE PPH		
RX 150176	18	<5	22	410	<1	<1	<5	95	<2	2.34	5	<1	<5	3.2	<5	19400	<50	56	1.9	6.4	<5
RX 150177	3570	<5	5	210	<1	<1	<5	170	<2	0.90	1	<1	<5	<0.5	<5	4500	<50	<30	2.4	1.7	<5
RX 150178	1140	<5	4	470	<1	<1	<5	100	<2	2.11	5	<1	<5	2.9	<5	10000	<50	80	2.7	5.3	<5
RX 150179	76	<5	8	290	1	<1	<5	200	<2	1.41	1	<1	<5	<0.5	<5	4620	<50	35	3.0	2.2	<5
RX 150180	35200	5	32	270	<1	<1	5	190	<2	2.02	1	<1	<5	<0.5	<5	3520	<50	<30	5.7	1.7	<5
RX 150181	5340	<5	15	350	<1	<1	<5	190	<2	1.52	2	<1	<5	<0.5	<5	4700	<50	<30	2.6	2.1	<5
RX 150182	28	<5	120	<100	<1	<1	35	67	<2	32.2	<1	<1	<5	<0.5	<5	4500	130	<30	2.8	0.4	<5
RX 150183	5	<5	19	300	<1	2	16	150	2	10.4	3	<1	<5	<0.5	<5	12700	<50	<30	3.4	17	<5

Activation Laboratories Ltd.

Work Order: 2748 Report: 2760

Sample description	SN %	SR %	TA PPH	TH PPH	V PPH	W PPH	ZN PPH	LA PPH	CE PPH	NO PPH	SH PPH	EU PPH	TB PPH	YB PPH	LU PPH	CU PPH	CU %	Mass g
RX 150176	<0.01	<0.05	<1	7.8	2.5	<4	155	40	81	28	5.1	1.4	<0.5	1.55	0.33	97		30.00
RX 150177	<0.01	<0.05	<1	2.5	<0.5	<4	229	11	24	13	1.4	0.4	<0.5	0.38	0.13	53		30.00
RX 150178	<0.01	<0.05	<1	8.0	2.9	<4	450	87	82	32	4.5	0.8	<0.5	1.34	0.29	15		30.00
RX 150179	<0.01	<0.05	<1	2.5	<0.5	<4	74	14	27	12	1.7	0.3	<0.5	0.49	0.08	16		30.00
RX 150180	<0.03	<0.05	<1	3.0	<0.7	<4	501	12	26	14	1.4	0.4	<0.5	0.60	<0.05	15		30.00
RX 150181	<0.01	<0.05	<1	3.1	1.6	<4	370	15	35	12	1.8	<0.2	<0.5	0.51	0.10	10		30.00
RX 150182	<0.01	<0.05	<1	<0.5	<0.5	<4	550	<1	<3	<5	0.1	<0.2	<0.5	0.30	<0.05	15		30.00
RX 150183	<0.01	0.07	<1	4.6	<0.5	<4	90	17	42	17	3.0	0.8	<0.5	1.49	0.29	40		30.00

# INCO GOLD

TRAVERSE NUMBER \_\_\_\_\_  
N.T.S. \_\_\_\_\_

PROJECT COUSINEAU  
AREA \_\_\_\_\_

GEOLOGIST(S) P. MEERTHERW  
DATE MAY 21/91

SAMPLE NUMBER	SAMPLE TYPE			SAMPLE LENGTH, WIDTH, AREA	LATITUDE, LONGITUDE and/or U.T.M.	SAMPLE DESCRIPTION Rock type, lithology, character of soil, stream silt, etc. Formation Mineralization, etc.	RESULTS (ppm, %/oz. per ton)						
	RX Rock, Talus	SX Stream Silt, Soil	Grab, Chip, Channel										
RX150176	ROCK	---	GRAB	---		ALTERED RHYOLITE, RUSTY PANYS, GRN-GRY VFG-FE FIS, MDDY CARB, TR-1% FE PY	13	ppb					
RX150177		---		---		QTZ, MILKY, GLASSY TEXTURE, TR, MG CUBIC PY.	3.57	ppm					
RX150178		---		---		QTZ VN AS RX150177 HOSTED BY MAFIC-INT VOLCANIC TUFF TR-1% FE COND ALONG CONTACT OF VN	1.14	ppm					
RX150179		---		---	COMP 1	QTZ VN AS RX150177 W RUSTY FRACTURES, 2-3% FECE, TR PY.	76	ppb					
RX150180		---		---	COMP 2	QTZ VN W 1-2% FE-MG PY ALONG FRACTURES AND VUGS, FECE COND ALNG FRAC	36	ppm					
RX150181		---		---		QTZ VN W TR MG CUBIC PY AND TR FE GALENA ASSOC. PY	6.34	ppm					

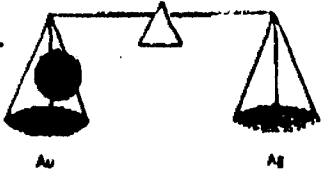

**PAUL'S CUSTOM FIRE ASSAYING LTD.**

Phone: Bus. (807) 662-8171  
Res. (807) 662-3361  
Fax: (807) 662-1155

PAUL OKANSKI, Assayer  
Box 253, Cochenour, Ontario P0V 1L0

**ASSAY CERTIFICATE**

Date: Jan. 17, 1992.

L. Cousineau

Sample No.	Description	oz/ton Au	oz/ton Ag
1 21	JAN 14 ZONE 23	.04	
2 22	" 13 " 22	.86	
3 23	" 13 " 21	Trace	
4 28	" 13 " 21	"	
5			
6			
7			
8 11	(Jan 11 ZONE 22) <sup>assign with</sup> (Little Turtle Report)	.48	
9			
10			
11			
12			
13			
14			
15			
16			
17			
18			
19			
20			
21			
22			
23			
24			
25			

*A. Okanski*

**Report of Work Conducted  
 After Recording Claim**  
 Mining /

63.5721  
 Transaction Number  
 W9210-032

Personal information collected on this form is obtained under the authority of this collection should be directed to the Provincial Manager, Mining Lands, Sudbury, Ontario, P3E 6A5, telephone (705) 670-7264.



900

- Instructions:**
- Please type or print and submit in duplicate.
  - Refer to the Mining Act and Regulations for requirements of filing assessment work or consult the Mining Recorder.
  - A separate copy of this form must be completed for each Work Group.
  - Technical reports and maps must accompany this form in duplicate.
  - A sketch, showing the claims the work is assigned to, must accompany this form.

Recorded Holder(s) <b>RAY COUSINEAU</b>	Client No.
Address <b>430 1ST ST. E (P.D. BOX 33) FORT FRANCES, ONT. (P9A 3M5)</b>	Telephone No. <b>807-274-3923</b>
Mining Division <b>KENORA</b>	Township/Area <b>BENNETT LAKE</b>
	M or G Plan No. <b>G 2667</b>
Dates Work Performed From: <b>MAY 5, 1991</b> To: <b>JAN. 15 1992</b>	

**Work Performed (Check One Work Group Only)**

Work Group	Type
Geotechnical Survey	
Physical Work, Including Drilling	<b>STRIPPING - TRENCHING - BLASTING</b>
Rehabilitation	
Other Authorized Work	
Assays	
Assignment from Reserve	

ONTARIO GEOLOGICAL SURVEY  
 GIS - ASSESSMENT FILES  
 JUN 16 1992

Total Assessment Work Claimed on the Attached Statement of Costs **3806.00**

**Note:** The Minister may reject for assessment work credit all or part of the assessment work submitted if the recorded holder cannot verify expenditures claimed in the statement of costs within 30 days of a request for verification.

**Persons and Survey Company Who Performed the Work (Give Name and Address of Author of Report)**

Name	Address
<b>RAY COUSINEAU</b>	<b>430 1ST ST. E. (P.D. BOX 33) FORT FRANCES, ONT. (P9A 3M5)</b>
<b>LOUIS COUSINEAU (AUTHOR)</b>	<b>P.D. BOX 33 FORT FRANCES, ONT. (P9A 3M5)</b>
<b>KEN DESTARDINS</b>	<b>518 NELSON ST. FORT FRANCES, ONT. P9A 1B4</b>

(attach a schedule if necessary)

**Certification of Beneficial Interest \* See Note No. 1 on reverse side**

I certify that at the time the work was performed, the claims covered in this work report were recorded in the current holder's name or held under a beneficial interest by the current recorded holder.	Date <b>APRIL 20, 1992</b>	Recorded Holder or Agent (Signature) <i>Ray Cousineau</i>
--	-------------------------------	--

**Certification of Work Report**

I certify that I have a personal knowledge of the facts set forth in this Work report, having performed the work or witnessed same during and/or after its completion and annexed report is true.

Name and Address of Person Certifying <b>RAY COUSINEAU 430 1ST ST. E (P.D. BOX 33) FORT FRANCES, ONT. P9A 3M5</b>		
Telephone No. <b>807-274-3923</b>	Date <b>APRIL 20, 1992</b>	Certified By (Signature) <i>Ray Cousineau</i>

**For Office Use Only**

Total Value Cr. Recorded <b>\$ 3806</b>	Date Recorded <b>April 27/92</b>	Mining Recorder <i>Scott Rivett</i>	Received at <b>KENORA</b> MINING DIV. <b>RECEIVED</b> <b>APR 27 1992</b> AM PM <b>7891011 12123456</b>
	Deemed Approval Date	Date Approved <b>April 27/92</b>	
	Date Notice for Amendments Sent		





Statement of Costs for Assessment Credit

État des coûts aux fins du crédit d'évaluation

Mining Act/Loi sur les mines

Transaction No./N° de transaction

Personal information collected on this form is obtained under the authority of the Mining Act. This information will be used to maintain a record and ongoing status of the mining claim(s). Questions about this collection should be directed to the Provincial Manager, Minings Lands, Ministry of Northern Development and Mines, 4th Floor, 159 Cedar Street, Sudbury, Ontario P3E 6A5, telephone (705) 670-7264.

Les renseignements personnels contenus dans la présente formule sont recueillis en vertu de la Loi sur les mines et serviront à tenir à jour un registre des concessions minières. Adresser toute question sur la collecte de ces renseignements au chef provincial des terrains miniers, ministère du Développement du Nord et des Mines, 159, rue Cedar, 4<sup>e</sup> étage, Sudbury (Ontario) P3E 6A5, téléphone (705) 670-7264.

1. Direct Costs/Coûts directs

Type	Description	Amount Montant	Totals Total global
Wages Salaires	Labour 3 MEN Main-d'oeuvre 7-DAYS	7x 450	
	Field Supervision Supervision sur le terrain		3150.00
Contractor's and Consultant's Fees Droits de l'entrepreneur et de l'expert-conseil	Type		
Supplies Used Fournitures utilisées	Type 2,40 28 STICKS FORTITE	55.20	
	40' BLINE @ 50	20.00	
	10 FUSES @ 3.25	32.50	
			107.70
Equipment Rental Location de matériel	Type		
<b>Total Direct Costs Total des coûts directs</b>			

2. Indirect Costs/Coûts indirects

\*\* Note: When claiming Rehabilitation work indirect costs are not allowable as assessment work. Pour le remboursement des travaux de réhabilitation, les coûts indirects ne sont pas admissibles en tant que travaux d'évaluation.

Type	Description	Amount Montant	Totals Total global
Transportation Transport	Type 7 DAYS TRUCK		
	161-KM @ 30 = 48.30	7x48.30	
			358.00
Food and Lodging Nourriture et hébergement	LOUIS 7 DAYS @ 10 =	70	
	RAY 7 DAYS @ 10 =	70	
	KEN 7 DAYS @ 10 =	70	210.00
Mobilization and Demobilization Mobilisation et démobiliation			
<b>Sub Total of Indirect Costs Total partiel des coûts indirects</b>			548.00
<b>Amount Allowable (not greater than 20% of Direct Costs) Montant admissible (n'excédant pas 20 % des coûts directs)</b>			3258.00
<b>Total Value of Assessment Credit (Total of Direct and Allowable indirect costs)</b>			3806.00
<b>Valeur totale du crédit d'évaluation (Total des coûts directs et indirects admissibles)</b>			3806.00

Note: The recorded holder will be required to verify expenditures claimed in this statement of costs within 30 days of a request for verification. If verification is not made, the Minister may reject for assessment work all or part of the assessment work submitted.

Note: Le titulaire enregistré sera tenu de vérifier les dépenses demandées dans le présent état des coûts dans les 30 jours suivant une demande à cet effet. Si la vérification n'est pas effectuée, le ministre peut rejeter tout ou une partie des travaux d'évaluation présentés.

Filing Discounts

- Work filed within two years of completion is claimed at 100% of the above Total Value of Assessment Credit.
- Work filed three, four or five years after completion is claimed at 50% of the above Total Value of Assessment Credit. See calculations below:

Total Value of Assessment Credit	Total Assessment Claimed
	x 0.50 =

Remises pour dépôt

- Les travaux déposés dans les deux ans suivant leur achèvement sont remboursés à 100 % de la valeur totale susmentionnée du crédit d'évaluation.
- Les travaux déposés trois, quatre ou cinq ans après leur achèvement sont remboursés à 50 % de la valeur totale du crédit d'évaluation susmentionné. Voir les calculs ci-dessous.

Valeur totale du crédit d'évaluation	Evaluation totale demandée
	x 0,50 =

Certification Verifying Statement of Costs

I hereby certify: that the amounts shown are as accurate as possible and these costs were incurred while conducting assessment work on the lands shown on the accompanying Report of Work form.

I, \_\_\_\_\_, as \_\_\_\_\_, am authorized (Recorded Holder, Agent, Position in Company)

to make this certification

Attestation de l'état des coûts

J'atteste par la présente: que les montants indiqués sont le plus exact possible et que ces dépenses ont été engagées pour effectuer les travaux d'évaluation sur les terrains indiqués dans la formule de rapport de travail ci-joint.

Et qu'à titre de \_\_\_\_\_ je suis autorisé (titulaire enregistré, représentant, poste occupé dans la compagnie)

à faire cette attestation.

Signature	Date
	APRIL 20, 1997





OUR NUMBER	063465
DATE	March 28, 1991
CUSTOMER'S ORDER	ZONE 29, 21, 23, 23
SALESMAN	
TERMS	
F.O.B.	

SOLD TO LOUIS COUSINEAU  
P.O. Box 33  
 SHIPPED TO FORT FRANCES, ONT. P9A 3M5  
 ADDRESS BENNETT LAKE VIA \_\_\_\_\_

INVOICE

1991	May 5, 6, 7, 8, Prospecting Bennett Lake				
1991	May 19, 20, 21, stripping, trucking, assaying				
1992	Jan 11, 12, 13, 14, 15, stripping, trucking, assaying				
	7 1/2 days work @ 150-			1050.00	
				<del>1800.00</del>	

BROWNLIN 832

OUR NUMBER	063467
DATE	March 18, 1992
CUSTOMER'S ORDER	ZONE 29, 21, 23, 23
SALESMAN	
TERMS	
F.O.B.	

SOLD TO KEN DESTARDINS  
518 NELSON ST.  
 SHIPPED TO FORT FRANCES, ONT. P9A 1B4  
 ADDRESS BENNETT LAKE VIA \_\_\_\_\_

INVOICE

1991	May 5, 6, 7, 8, Prospecting Bennett Lake				
1991	May 19, 20, 21 - stripping, trucking, assaying				
1992	Jan. 11, 12, 13, 14, 15 - stripping, trucking, assaying				
	7 1/2 days work @ 150			1050.00	
				<del>1800.00</del>	

BROWNLIN 832

OUR NUMBER	063466
DATE	March 18, 1994
CUSTOMER'S ORDER	ZONE 20, 21, 22, 23
SALESMAN	
TERMS	
F.O.B.	

SOLD TO RAY COUSINEAU  
P.O. Box 33  
 SHIPPED TO FORT FRANKS, DIST. PSM 315  
 ADDRESS BENNETT LAKE VIA \_\_\_\_\_

INVOICE

1991	May 5, 6, 7, 8. Prospecting Bennett Lake				
1991	May 19, 20, 21 - stripping trenching				
1992	Jan. 11, 12, 13, 14, 15 - stripping trenching				
	7 1/2 days work @ 150			1050 00	
				<del>490 00</del>	