

PROSPECTING DAILY LOG



52C165W8600 2.15096 BENNETT LAKE

010

PROJECT AREA

DATE

WORK PERFORMED

BENNETT LAKE
CLAIM #161514

SEPT. 13

SEPT. 14

PROSPECTED SOUTH OF GRAVEL ROAD CL. 1161514. LARGE E-W RIDGE FOUND. PROSPECTED NORTH SIDE OF THIS RIDGE NAME CENTURY RIDGE DECIDED TO PROSPECT FURTHER NORTH ON THIS RIDGE. FOUND LARGE IRON SULPHIDE ZONE 75' WIDE - WILL STRIP + DRILL

2. 15096

LOCATION OF PROSPECTING

- AREA OUTLINED ON PREVIOUSLY SUBMITTED CLAIM MAP
- DETAIL SKETCH ATTACHED

LOCATION MAP OF PROSPECTING

BENNETT LAKE

CLAIM 1161514

1161435

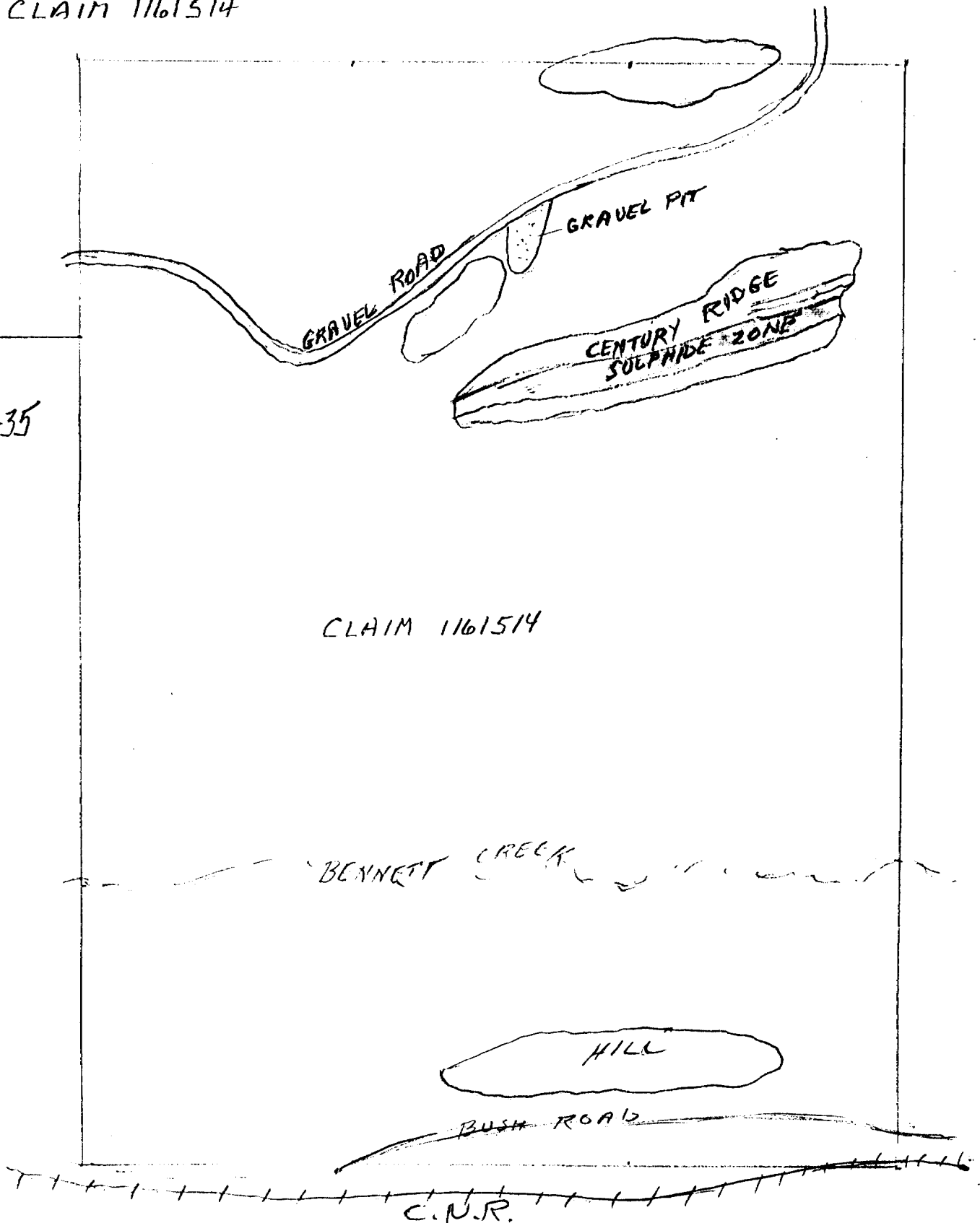

CLAIM 1161514

BENNETT CREEK

HILL

BUSH ROAD

C.N.R.

BENNETT LAKE CLAIM 1161514

SEPT. 1992

BRIEF REPORT OF WORK - NATURE OF ROCK & MINERALIZATION

CLAIM 1161514 ZONES 70, 71, 72.

STRIPPING - TRENCHING - BLASTING
USED ATLAS COPCO PLUGGER FOR DRILLING.
EXPOSED 75' ± SULPHIDE ZONE - EAST-WEST
DIRECTION - OPEN BOTH ENDS - WHERE IT IS
COVERED WITH HEAVY OVER BURDEN. ZONE IS
APPROXIMATELY 500' LONG ±.

INTERMEDIATE TO MAFIC VOLCANIC 60% T.G.

SULPHIDES PY MINAL SP. CAP.

HIGHLY AMPHIBOLIZED. HIGHEST ASSAY 2700 PPM. ZN.

2. 15096

Louis Cousineau

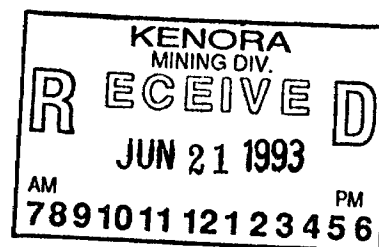

STRIPPING AND TRENCHING DAILY LOG

1992

<u>PROJECT AREA</u>	<u>DATE</u>	<u>WORK PERFORMED</u>
BENNETT LAKE G 2667	SEPT. 16	STRIPPING ZONE 70 SULPHIDE ZONE
	SEPT. 19	STRIPPING ZONE 71
L238/7	SEPT. 20	DRILLED + BLASTED ZONE 71
	SEPT. 23	TRENCHED + ASSAY ZONE 71
	SEPT. 26	STRIPPING ZONE 72
	SEPT. 27	DRILLED + BLASTED ZONE 72-A
	SEPT. 28	DRILLED + BLASTED ZONE 72-B
	SEPT. 30	TRENCHED + SAMPLED ZONE 72

RECEIVED
NOV 15 1993
MINING LANDS BRANCH

LOCATION OF STRIPPING AND TRENCHING

SKETCH ATTACHED

SKETCH OF TRENCHING AND SAMPLING

SKETCH ATTACHED

DESCRIPTION OF SAMPLES

<u>SAMPLE NO.</u>	<u>TYPE OF SAMPLE</u>	<u>ROCK TYPE</u>	<u>MINERALIZATION</u>	<u>ASSAY RESULT</u>
181714	12" CHIP	MAFIC VOLCANIC	MAJOR SULPHIDE	2700 P.P.M. ZN
181715	12" CHIP	" "	" "	278 PPM ZN.
181716	GRAB	" "	" "	50 PPM ZN.
181717	12" CHIP	" "	" "	198 P.P.M. ZN.

SULPHIDE COLOUR ~ REDDISH BROWN
- PYRITE - SP. -
- GRAIN SIZE - 5 GRAIN -
- MEDIUM GRAIN

1992



BENNETT LAKE TWP RAINY RIVER DISTRICT

LOCATION STRIPPING & TRENCHING

1" FACE = 26' 1" = 220'

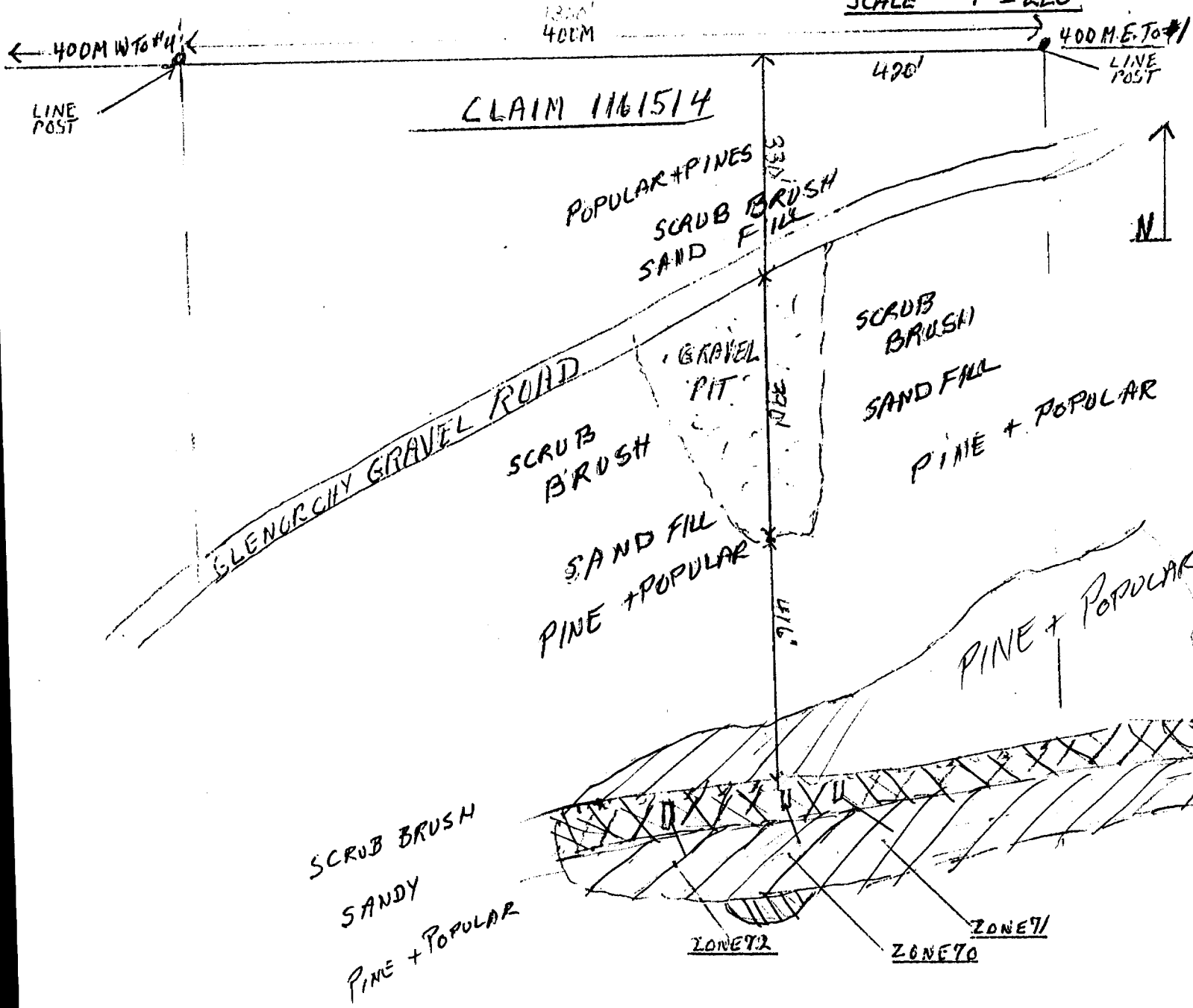
SCALE 1" = 220'



-  — SULPHID ZONE
-  — TUFF
-  — GABBRO

STRIPPING + TRENCHING

LOUIS COUSINEAU

CLAIM 1161514

SCALE: 1" = 5'

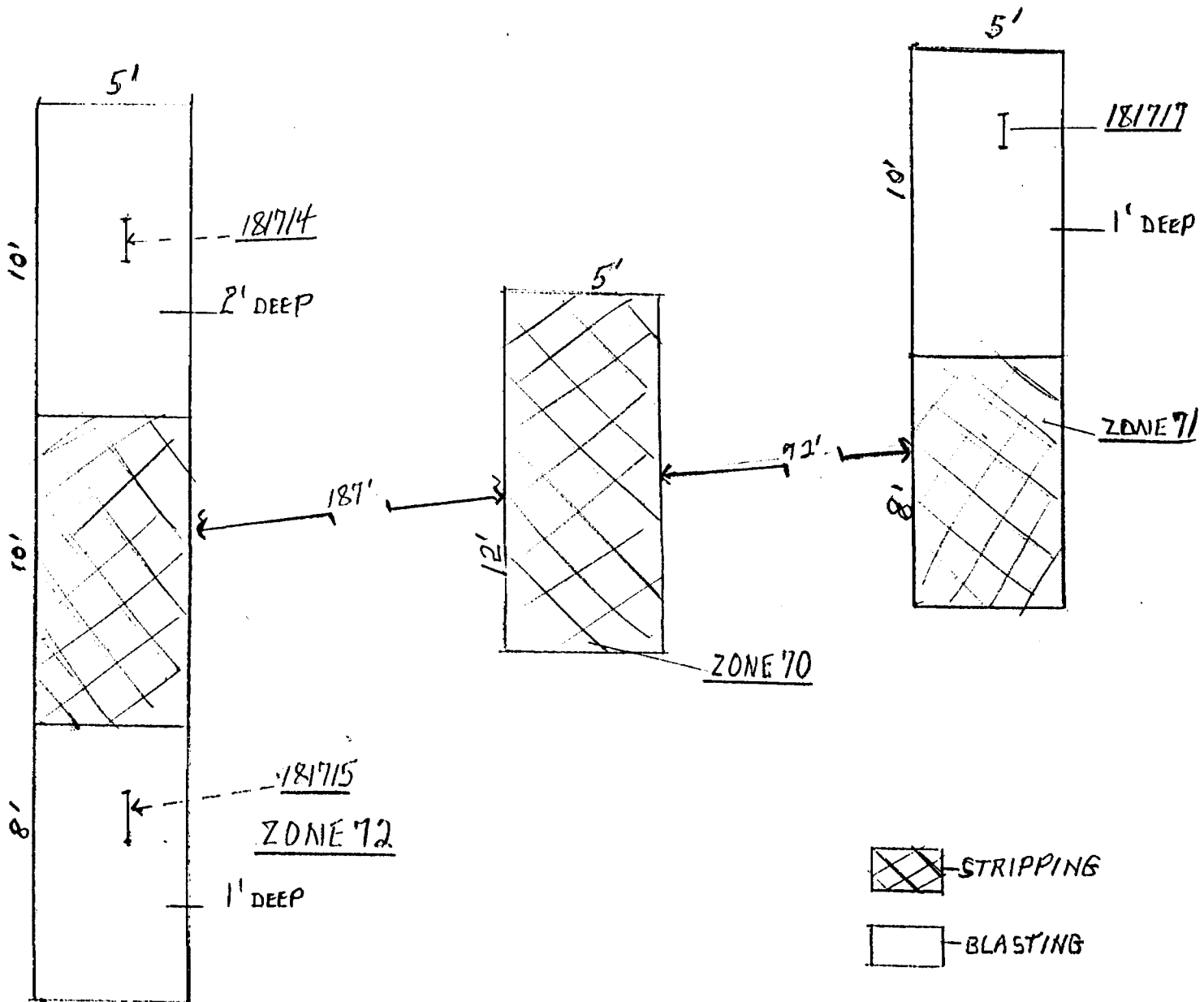
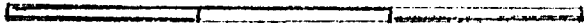

2. 15096

OUR NUMBER	063475
DATE	Sept 16 to Sept 30/92
CUSTOMER'S ORDER	
SALESMAN	
TERMS	
F.O.B.	

SOLD TO Louis and Ray Cousineau of Lou Desjardins

SHIPPED TO Bennett Lake traps

ADDRESS _____ VIA _____

INVOICE

Sept 16/92	1 Day plugger zone 71				39 00
Sept 17/92	1-day plugger zone 72-A				39 00
Sept 28/92	1-day plugger zone 72-B				39 00
	Atlas Casco Plugger Rental				117 00
	includes Bits, gas, oil, tools ect. @ 39.00/1				

2.15096

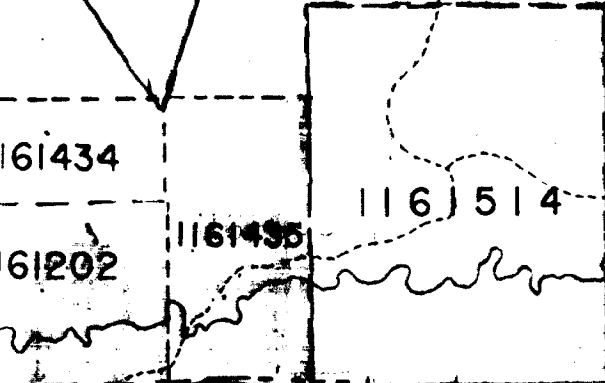
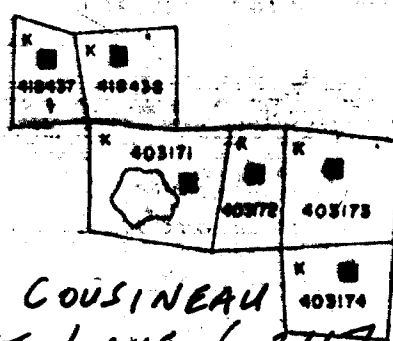
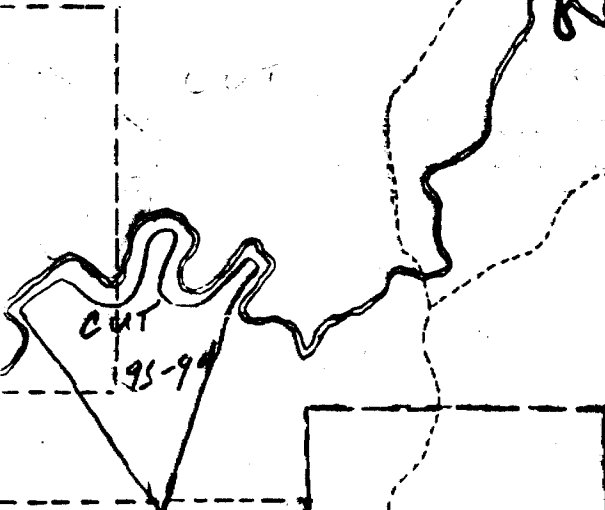
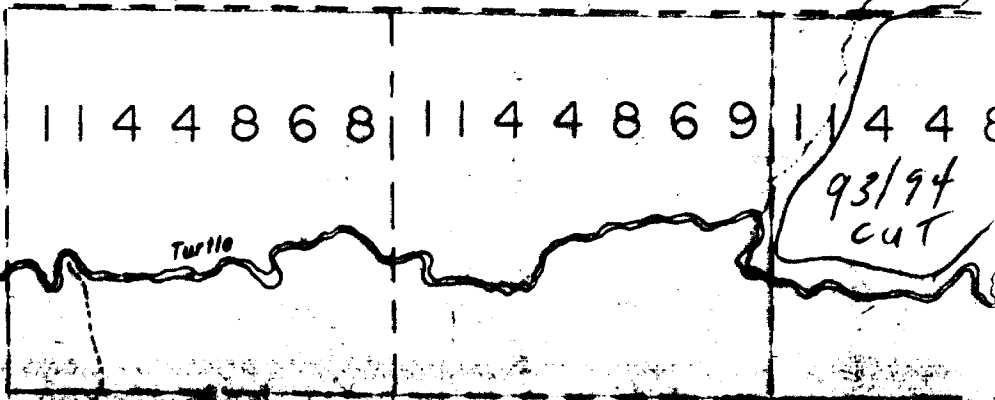
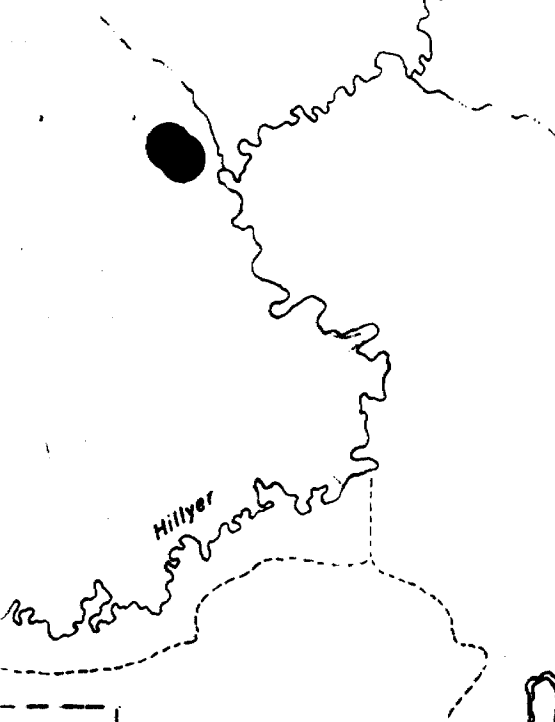

LOUIS COUSINEAU
 BENNETT LAKE 6267
 JULY 5/93

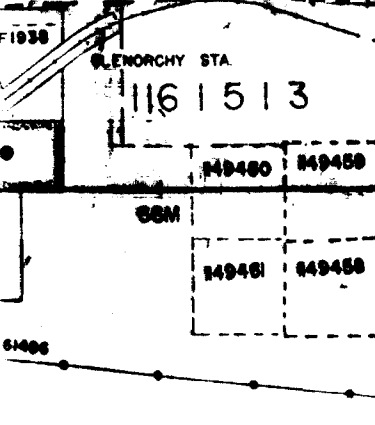

Indian Reserve No. 23

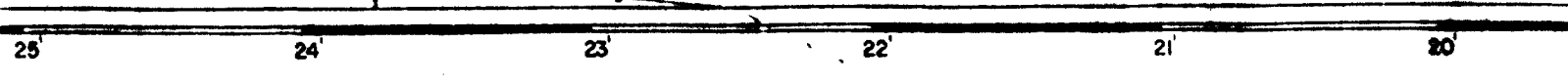

Activation Laboratories Ltd. Work Order: 4561 Report: 4518

Sample description	AU PPD	AS PPM	BA PPM	BR PPM	CO PPM	CR PPM	CS PPM	FE %	FP PPM	BO PPM	IR PPB	MO PPH	NA PPM	RB PPM	SB PPM	SC PPM	SE PPM	SN %	TA PPM	TB PPM	U PPM	V PPM	LA PPM	CB PPM
RX 181701	1470	5	<100	<1	35	110	<2	7.98	<0.5	<1	<5	<5	<500	<30	<0.2	2.0	63	<0.01	<1	<0.5	<0.3	<4	2	4
RX 181702	2920	9	<100	<1	68	210	<2	5.14	0.5	<1	<5	<5	<500	<30	0.5	0.3	230	<0.01	<1	<0.5	<0.5	<4	<1	<3
RX 181703	582	15	630	<1	42	95	<2	12.4	2.2	<1	<5	5	7450	43	1.2	7.2	48	<0.01	<1	1.6	<0.5	5	6	12
RX 181704	372	9	<100	<1	36	150	<2	5.56	0.5	<1	<5	<5	<500	<30	0.4	2.9	32	<0.01	<1	<0.5	<0.5	<4	6	11
RX 181705	1640	16	<100	<1	19	200	<2	9.31	<0.5	<1	<5	<5	<500	<30	1.1	0.4	130	<0.01	<1	<0.5	<0.5	<4	<1	<3
RX 181706	<5	6	230	<1	20	83	<2	4.19	3.3	<1	<5	<5	10300	<30	0.8	13	<5	<0.01	<1	2.5	0.6	<4	15	26
RX 181707	7	11	350	<1	16	85	<2	3.74	3.3	<1	<5	<5	23000	<30	0.8	12	<5	<0.01	<1	2.4	<0.5	<4	12	25
RX 181708	7540	6	<100	<1	69	90	<2	6.79	<0.5	<1	<5	<5	<500	<30	7.9	1.0	33	<0.01	<1	<0.5	<0.5	<4	5	8
RX 181709	20	4	280	<1	21	140	<2	3.67	2.9	<1	<5	<5	18400	<30	2.0	10	<5	<0.01	<1	2.1	<0.5	<4	11	22
RX 181710	14	2	<100	<1	9	62	<2	2.95	4.5	<1	<5	<5	36800	<30	0.7	10	<5	<0.01	<1	3.8	1.5	<4	26	48
RX 181711	8	3	130	<1	18	94	<2	6.61	3.4	<1	<5	<5	8580	<30	1.7	14	<5	0.05	<1	2.0	<0.5	<4	17	31
RX 181712	2820	31	240	<1	49	86	<2	13.4	1.5	<1	<5	<5	<500	32	2.2	4.1	76	<0.01	<1	1.4	<0.5	<4	7	11
RX 181713	<5	<2	300	<1	14	130	<2	4.02	4.4	<1	<5	<5	19700	61	0.3	15	<5	<0.01	<1	3.2	<0.5	<4	19	36
RX 181714	26	3	520	2	21	180	2	3.57	2.8	<1	<5	INT	23400	110	0.4	10	<5	0.05	2	6.0	3.8	12	28	52
RX 181715	22	65	1300	<1	26	140	4	2.85	5.6	<1	<5	INT	22800	180	0.6	11	<5	<0.01	<1	10	3.1	11	29	56
RX 181716	531	8	660	<1	16	84	<2	2.94	3.3	<1	<5	<5	47300	110	0.4	7.9	<5	<0.01	<1	5.2	<0.5	14	29	53
RX 181717	14	8	860	3	27	130	3	3.01	6.3	<1	<5	<5	23700	120	0.4	9.8	<5	<0.01	3	10	2.0	13	45	89

*Bennett
Creek*

Activation Laboratories Ltd. Work Order: 4561 Report: 4518B

Sample description	CU	PB	SN	AG	NI	MN	BR	CO	BI	V	CA	P	MG	SI	AL	K	Y	BB
	PPH	PPH	PPH	PPH	PPH	PPH	PPH	PPH	PPH	PPH	PPH	PPH	PPH	PPH	PPH	PPH	PPH	PPH
RX 181701	862.	74.	23000.	0.2	29.	1651.	12.	92.1	10.	13.	1.33	0.002	0.65	0.01	1.15	0.01	7.	<2.
RX 181702	1278.	999.	55000.	15.2	26.	1579.	5.	193.8	18.	6.	0.97	0.002	0.76	0.01	1.27	0.01	2.	<2.
RX 181703	1532.	560.	25000.	22.4	26.	4702.	62.	95.5	8.	48.	0.34	0.052	1.04	0.25	5.69	1.15	6.	<2.
RX 181704	1121.	100.	37000.	6.3	22.	3220.	22.	134.7	<5.	34.	4.52	0.021	1.64	0.09	2.83	0.12	7.	<2.
RX 181705	1873.	2368.	46000.	30.1	30.	1617.	5.	192.0	11.	7.	0.55	0.002	0.73	0.01	1.37	0.01	2.	<2.
RX 181706	58.	35.	251.	0.8	40.	1064.	234.	<0.5	<5.	94.	4.37	0.050	1.78	0.37	7.33	0.87	13.	<2.
RX 181707	26.	95.	284.	0.7	34.	1265.	233.	<0.5	<5.	90.	3.11	0.053	1.88	0.38	6.82	0.96	12.	<2.
RX 181708	3779.	2343.	120000.	27.7	17.	5457.	23.	389.6	12.	17.	3.85	0.005	1.21	0.02	1.76	0.03	6.	<2.
RX 181709	87.	186.	281.	2.3	39.	1089.	147.	1.4	<5.	79.	3.75	0.044	1.32	0.31	6.41	1.23	11.	<2.
RX 181710	30.	22.	170.	0.5	2.	942.	231.	0.5	<5.	46.	3.46	0.110	0.97	0.56	7.20	0.51	23.	<2.
RX 181711	63.	35.	257.	1.1	47.	2983.	603.	0.8	<5.	115.	7.60	0.088	2.66	0.44	9.15	0.33	20.	<2.
RX 181712	748.	6632.	52000.	31.0	37.	1511.	6.	197.9	16.	35.	0.17	0.036	1.30	0.10	3.73	0.63	8.	<2.
RX 181713	22.	22.	187.	<0.3	59.	1200.	281.	<0.5	<5.	107.	4.19	0.069	2.34	0.44	7.58	1.42	18.	<2.
RX 181714	64.	135.	2700.	2.7	76.	746.	332.	17.3	<5.	63.	2.32	0.070	1.58	0.18	5.76	2.75	22.	3.
RX 181715	71.	51.	278.	2.0	85.	501.	325.	1.3	<5.	80.	1.44	0.036	1.19	0.25	5.30	3.86	22.	3.
RX 181716	38.	14.	50.	0.7	45.	338.	460.	<0.5	<5.	51.	2.62	0.084	1.09	0.31	6.60	1.69	12.	<2.
RX 181717	78.	23.	298.	2.4	83.	574.	225.	1.6	<5.	50.	1.01	0.032	1.14	0.15	5.65	3.17	32.	3.

*Bennett
Creek*

Sample description	ND PPM	BM PPM	BU PPM	TB PPM	YB PPM	LU PPM	Moos g
RX 181701	<5	0.4	0.3	<0.5	0.3	0.07	2.141
RX 181702	<5	0.1	<0.2	<0.5	<0.2	<0.05	2.089
RX 181703	6	1.1	0.3	<0.5	0.6	0.09	2.000
RX 181704	6	1.0	0.2	<0.5	0.4	0.05	2.102
RX 181705	<5	<0.1	<0.2	<0.5	0.2	<0.05	2.339
RX 181706	10	2.1	0.8	<0.5	1.0	0.17	2.440
RX 181707	14	1.9	0.6	<0.5	1.0	0.14	2.135
RX 181708	7	0.7	0.4	<0.5	<0.2	<0.05	2.140
RX 181709	9	1.0	0.6	<0.5	0.8	0.10	2.033
RX 181710	24	3.9	1.3	<0.5	1.7	0.28	2.293
RX 181711	18	2.8	1.1	0.5	1.5	0.25	2.273
RX 181712	<5	1.0	<0.2	<0.5	0.4	0.10	2.197
RX 181713	15	3.0	0.9	<0.5	1.5	0.26	2.030
RX 181714	21	4.5	1.1	<0.5	2.5	0.29	2.183
RX 181715	30	5.0	1.2	1.1	3.2	0.48	1.919
RX 181716	28	3.8	1.1	<0.5	1.1	0.12	2.111
RX 181717	43	7.4	1.5	1.4	4.8	0.71	1.953

Bennett
Crank

STRIPPING + TRENCHING

LOUIS COUSINEAU

CLAIM 1161514

SCALE: 1" = 5'

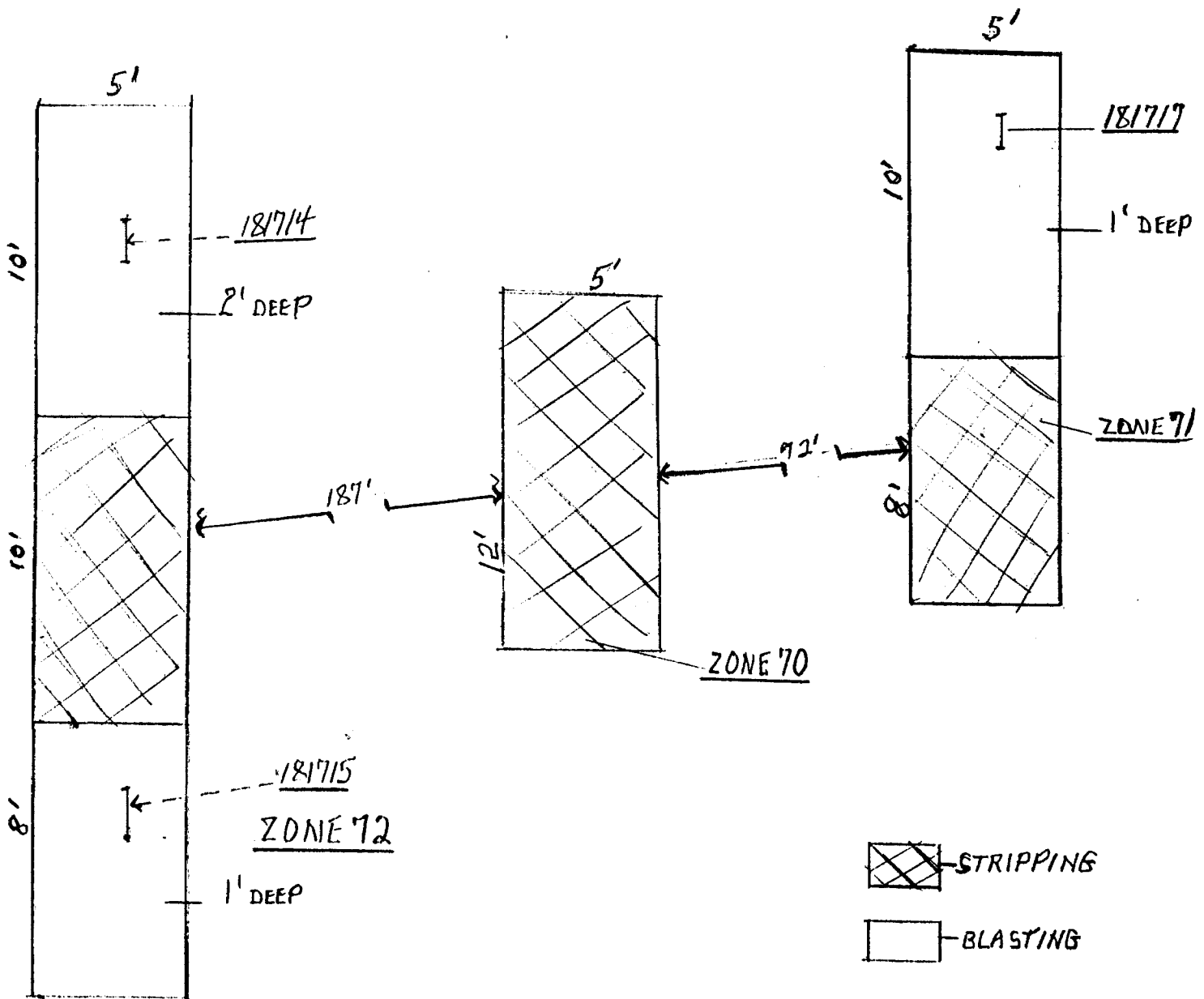
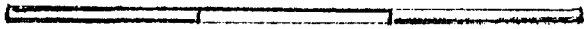



Ontario



52C16SW8600 2.15096 BENNETT LAKE

900

Ministry of
Northern Development
and Mines

Ministère du
Développement du Nord
et des Mines

Geoscience Approvals Section
Willet Green Miller Centre
933 Ramsey Lake Rd
6th Floor
Sudbury, Ontario
P3E 6B5

Telephone: (705) 670-5853
Fax: (705) 670-5863

Our File: 2.15096
Transaction #: W9310.00041

November 22, 1993

Mining Recorder
Ministry of Northern
Development and Mines
808 Robertson Street
P.O. Box 5200
Kenora, Ontario
P9N 3X9

Dear Sir:

**RE: APPROVAL OF ASSESSMENT WORK ON MINING CLAIM K 1161514 IN THE
BENNETT LAKE AREA.**

The Assessment Credits for PROSPECTING, section 8 of the Mining Act Regulations, as listed on the above report of work, have been approved as of NOVEMBER 15, 1993.

Please indicate this approval on the claim record sheets.

If you have any questions please call Clive Stephenson at
(705) 670-5856.

Yours sincerely

Ron C. Gashinski
Senior Manager, Mining Lands Section
Mining and Land Management Branch
Mines and Minerals Division

CDS/ls

cc: Assessment Files Office
Toronto, Ontario

Resident Geologist
Kenora, Ontario

**Report of Work Conducted
Before Recording Claim**

Mining Act

Transaction Number

W9310.00041

MINING LANDS

Personal information collected on this form is obtained under the authority of the Mining Act. This information will be used for correspondence. Questions about this collection should be directed to the Provincial Manager, Mining Lands, Ministry of Northern Development and Mines, Fourth Floor, 159 Cedar Street, Sudbury, Ontario, P3E 6A5, telephone (705) 670-7264.

2.15096

- Instructions:**
- Please type or print and submit in duplicate.
 - Refer to the Mining Act and Regulations for requirements of filing assessment work or consult the Mining Recorder.
 - A separate copy of this form must be completed for each Work Group.
 - Technical reports and maps must accompany this form in duplicate.
 - A sketch, showing the claims the work is assigned to, must accompany this form.

Recorded Holder(s) <i>LOUIS COUSINEAU</i>		Client No. <i>121624 R1062</i>
Address <i>272 SCOTT ST. (P.O. Box 33) FORT FRANCES ONT. P9A 3M5</i>		Telephone No. <i>807-274-3761</i>
Mining Division <i>KENORA</i>	Township/Area <i>BENNIETT LAKE</i>	M or G Plan No. <i>G2667</i>
Dates Work Performed From: <i>SEPT. 13 1992</i>		To: <i>SEPT 30 1992</i>

Work Performed (Check One Work Group Only)

Work Group		<div style="border: 1px solid black; padding: 5px; display: inline-block;"> RECEIVED Type JUL 14 1993 MINING LANDS BRANCH </div>	<div style="border: 1px solid black; padding: 5px; display: inline-block;"> RECORDED JUL - 5 1993 Receipt _____ </div>
Regional Surveys			
Prospecting	<i>PROSPECTING</i>		

Total Assessment Work Claimed on the Attached Statement of Costs \$ 900.

Note: The Minister may reject for assessment work credit all or part of the assessment work submitted if the recorded holder cannot verify expenditures claimed in the statement of costs within 30 days of a request for verification.

Persons and Survey Company Who Performed the Work (Give Name and Address of Author of Report)

Name	Address
<i>LOUIS COUSINEAU (AUTHOR)</i>	<i>272 SCOTT ST. (P.O. Box 33) FORT FRANCES ONT. P9A 3M5</i>
<i>RAY COUSINEAU</i>	<i>430 1ST ST. E FORT FRANCES ONT. P9A 1K8</i>
<i>KEN DESJARDINS</i>	<i>518 NELSON ST. FORT FRANCES ONT. P9A 1B4</i>

(attach a schedule if necessary)

Certification of Beneficial Interest * See Note No. 1 on reverse side

I certify that at the time the work was performed, the claims covered in this work report were recorded in the current holder's name or held under a beneficial interest by the current recorded holder.	Date <i>JUNE 21 1993</i>	Recorded Holder or Agent (Signature) <i>Louis Cousineau</i>
--	-----------------------------	--

Certification of Work Report

I certify that I have a personal knowledge of the facts set forth in this work report, having performed the work or witnessed it during and/or after its completion, and the annexed report is true.		
Name and Address of Person Certifying <i>LOUIS COUSINEAU 272 SCOTT ST. (P.O. Box 33) FORT FRANCES, ONT. P9A 3M5</i>		
Telephone No. <i>807-274-3761</i>	Date <i>JUNE 21 1993</i>	Certified By (Signature) <i>Louis Cousineau</i>

For Office Use Only

Total Value Cr. Recorded <i>\$ 900.00</i>	Date Recorded <i>Oct 4/93</i>	Mining Recorder (Acting) <i>Katrina Pop</i>	Received Stamp <div style="border: 1px solid black; padding: 5px; display: inline-block;"> RECEIVED KENORA MINING DIV. JUL - 5 1993 AM 7891011 12123456 PM </div>
	Deemed Approval Date	Date Approved	
	Date Notice for Amendments Sent		

Personal information collected on this form is obtained under the authority of the Mining Act. This information will be used to maintain a record and ongoing status of the mining claim(s). Questions about this collection should be directed to the Provincial Manager, Minings Lands, Ministry of Northern Development and Mines, 4th Floor, 159 Cedar Street, Sudbury, Ontario P3E 6A5, telephone (705) 670-7264.

Les renseignements personnels contenus dans la présente formule sont recueillis en vertu de la Loi sur les mines et serviront à tenir à jour un registre des concessions minières. Adresser toute question sur la collecte de ces renseignements au chef provincial des terrains miniers, ministère du Développement du Nord et des Mines, 159, rue Cedar, 4^e étage, Sudbury (Ontario) P3E 6A5, téléphone (705) 670-7264.

1. Direct Costs/Coûts directs

Type	Description	Amount Montant	Totals Total global
Wages Salaires	Labour <i>PROSPECTING</i> Main-d'œuvre	<i>3 MLN</i> <i>2-DAYS</i>	<i>900.</i>
	Field Supervision Supervision sur le terrain		
Contractor's and Consultant's Fees Droits de l'entrepreneur et de l'expert- conseil	Type		
Supplies Used Fournitures utilisées	Type		
Equipment Rental Location de matériel	Type		
Total Direct Costs Total des coûts directs			

2. Indirect Costs/Coûts indirects

** Note: When claiming Rehabilitation work indirect costs are not allowable as assessment work. Pour le remboursement des travaux de réhabilitation, les coûts indirects ne sont pas admissibles en tant que travaux d'évaluation.

Type	Description	Amount Montant	Totals Total global
Transportation Transport	Type		
Food and Lodging Nourriture et hébergement			
Mobilization and Demobilization Mobilisation et démobilisation			
Sub Total of Indirect Costs Total partiel des coûts indirects			
Amount Allowable (not greater than 20% of Direct Costs) Montant admissible (n'excédant pas 20 % des coûts directs)			
Total Value of Assessment Credit (Total of Direct and Allowable indirect costs)		Valeur totale du crédit d'évaluation (Total des coûts directs et indirects admissibles)	

Note: The recorded holder will be required to verify expenditures claimed in this statement of costs within 30 days of a request for verification. If verification is not made, the Minister may reject for assessment work all or part of the assessment work submitted.

Note: Le titulaire enregistré sera tenu de vérifier les dépenses demandées dans le présent état des coûts dans les 30 jours suivant une demande à cet effet. Si la vérification n'est pas effectuée, le ministre peut rejeter tout ou une partie des travaux d'évaluation présentés.

Filing Discounts

1. Work filed within two years of completion is claimed at 100% of the above Total Value of Assessment Credit.
2. Work filed three, four or five years after completion is claimed at 50% of the above Total Value of Assessment Credit. See calculations below:

Total Value of Assessment Credit	Total Assessment Claimed
	× 0.50 =

Remises pour dépôt

1. Les travaux déposés dans les deux ans suivant leur achèvement sont remboursés à 100 % de la valeur totale susmentionnée du crédit d'évaluation.
2. Les travaux déposés trois, quatre ou cinq ans après leur achèvement sont remboursés à 50 % de la valeur totale du crédit d'évaluation susmentionné. Voir les calculs ci-dessous.

Valeur totale du crédit d'évaluation	Evaluation totale demandée
	× 0,50 =

Certification Verifying Statement of Costs

I hereby certify:
that the amounts shown are as accurate as possible and these costs were incurred while conducting assessment work on the lands shown on the accompanying Report of Work form.

that as LOUIS COUSINEAU I am authorized
(Recorded Holder, Agent, Position in Company)

to make this certification

Attestation de l'état des coûts

J'atteste par la présente :
que les montants indiqués sont le plus exact possible et que ces dépenses ont été engagées pour effectuer les travaux d'évaluation sur les terrains indiqués dans la formule de rapport de travail ci-joint.

Et qu'à titre de _____ je suis autorisé
(titulaire enregistré, représentant, poste occupé dans la compagnie)

à cette attestation.

Louis Cousineau Date
April 30, 1993

Personal information collected on this form is obtained under the authority of the Mining Act. This information will be used to maintain a record and ongoing status of the mining claim(s). Questions about this collection should be directed to the Provincial Manager, Minings Lands, Ministry of Northern Development and Mines, 4th Floor, 159 Cedar Street, Sudbury, Ontario P3E 6A5, telephone (705) 670-7264.

Les renseignements personnels contenus dans la présente formule sont recueillis en vertu de la Loi sur les mines et serviront à tenir à jour un registre des concessions minières. Adresser toute question sur la collecte de ces renseignements au chef provincial des terrains miniers, ministère du Développement du Nord et des Mines, 159, rue Cedar, 4^e étage, Sudbury (Ontario) P3E 6A5, téléphone (705) 670-7264.

1. Direct Costs/Coûts directs

Type	Description	Amount Montant	Totals Total global
Wages Salaires	Labour <i>PROSPECTING</i> Main-d'oeuvre	<i>3 MLN</i> <i>2-DAYS</i>	<i>900.</i>
	Field Supervision Supervision sur le terrain		
Contractor's and Consultant's Fees Droits de l'entrepreneur et de l'expert- conseil	Type		
Supplies Used Fournitures utilisées	Type		
Equipment Rental Location de matériel	Type		
Total Direct Costs Total des coûts directs			

2. Indirect Costs/Coûts indirects

** Note: When claiming Rehabilitation work indirect costs are not allowable as assessment work.
Pour le remboursement des travaux de réhabilitation, les coûts indirects ne sont pas admissibles en tant que travaux d'évaluation.

Type	Description	Amount Montant	Totals Total global
Transportation Transport	Type		
Food and Lodging Nourriture et hébergement			
Mobilization and Demobilization Mobilisation et démobilisation			
Sub Total of Indirect Costs Total partiel des coûts indirects			
Amount Allowable (not greater than 20% of Direct Costs) Montant admissible (n'excédant pas 20 % des coûts directs)			
Total Value of Assessment Credit (Total of Direct and Allowable indirect costs)		Valeur totale du crédit d'évaluation (Total des coûts directs et indirects admissibles)	

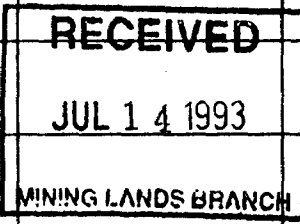

Note: The recorded holder will be required to verify expenditures claimed in this statement of costs within 30 days of a request for verification. If verification is not made, the Minister may reject for assessment work all or part of the assessment work submitted.

Note : Le titulaire enregistré sera tenu de vérifier les dépenses demandées dans le présent état des coûts dans les 30 jours suivant une demande à cet effet. Si la vérification n'est pas effectuée, le ministre peut rejeter tout ou une partie des travaux d'évaluation présentés.

Filing Discounts

1. Work filed within two years of completion is claimed at 100% of the above Total Value of Assessment Credit.
2. Work filed three, four or five years after completion is claimed at 50% of the above Total Value of Assessment Credit. See calculations below:

Total Value of Assessment Credit	Total Assessment Claimed
	× 0.50 =

Remises pour dépôt

1. Les travaux déposés dans les deux ans suivant leur achèvement sont remboursés à 100 % de la valeur totale susmentionnée du crédit d'évaluation.
2. Les travaux déposés trois, quatre ou cinq ans après leur achèvement sont remboursés à 50 % de la valeur totale du crédit d'évaluation susmentionné. Voir les calculs ci-dessous.

Valeur totale du crédit d'évaluation	Evaluation totale demandée
	× 0,50 =

Certification Verifying Statement of Costs

I hereby certify:
that the amounts shown are as accurate as possible and these costs were incurred while conducting assessment work on the lands shown on the accompanying Report of Work form.

that as LOUIS COUSINEAU I am authorized
(Recorded Holder, Agent, Position in Company)

Attestation de l'état des coûts

J'atteste par la présente :
que les montants indiqués sont le plus exact possible et que ces dépenses ont été engagées pour effectuer les travaux d'évaluation sur les terrains indiqués dans la formule de rapport de travail ci-joint.

Et qu'à titre de _____ je suis autorisé
(titulaire enregistré, représentant, poste occupé dans la compagnie)

to make this certification

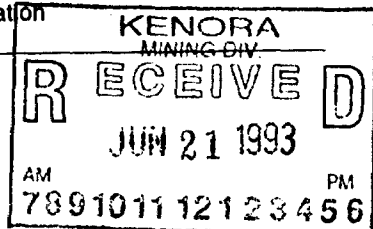

à faire cette attestation.
Signature: Louis Cousineau Date: April 30, 1993



FILE
WITH
ROW'S

Ministry of
Northern Development
and Mines

Ministère du
Développement du Nord
et des Mines

Geoscience Approvals Section
933 Ramsey Lake Road
6th Floor
Sudbury, Ontario
P3E 6B5

Telephone: (705) 670-5853
Fax: (705) 670-5863

Our File: 2.15096
Transaction #: W9310.00042

October 1, 1993

Mining Recorder
MNDM
808 Robertson Street
P.O. Box 5200
Kenora, Ontario
P9N 3X9

Dear Sir:

**RE: DELETION OF ASSESSMENT WORK OVER MINING CLAIM X 1161514 IN THE
BENNETT LAKE AREA.**

As per section 8 of the regulations, only regional surveys or prospecting work performed on crown land before the recording of the claims are eligible for assessment credit. As outlined in section 10 of the regulations the work submitted on the above report of work is physical and as such is only eligible for credit after the claim is recorded.

As the work is ineligible you are hereby authorized to delete Report of Work W9310.00042, recorded on July 5, 1993, from the claim record sheets.

If you have any questions please contact Clive Stephenson at (705) 670-5856.

Yours sincerely,

Ron C. Gashinski
Senior Manager, Mining Lands Section
Mining and Land Management Branch
Mines and Minerals Division

CDS/dm

cc: Assessment Files Office ✓
Toronto, Ontario.

Resident Geologist
Kenora, Ontario



Report of Work Conducted Before Recording Claim

Mining Act

Transaction Number
W9210.00041

MINING LANDS

Personal information collected on this form is obtained under the authority of the Mining Act. This information will be used for correspondence. Questions about this collection should be directed to the Provincial Manager, Mining Lands, Ministry of Northern Development and Mines, Fourth Floor, 159 Cedar Street, Sudbury, Ontario, P3E 6A5, telephone (705) 670-7264.

2-15096

- Instructions:**
- Please type or print and submit in duplicate.
 - Refer to the Mining Act and Regulations for requirements of filing assessment work or consult the Mining Recorder.
 - A separate copy of this form must be completed for each Work Group.
 - Technical reports and maps must accompany this form in duplicate.
 - A sketch, showing the claims the work is assigned to, must accompany this form.

Recorded Holder(s) LOUIS COUSINEAU		Client No. 121624 R1062
Address 272 SCOTT ST. (P.O. BOX 33) FORT FRANCES ONT. P9A 3M5		Telephone No. 807-274-3761
Mining Division KENORA	Township/Area BENNETT LAKE	M or G Plan No. E 2667
Date Work Performed From: SEPT. 13 1992		To: SEPT 30 1992

Work Performed (Check One Work Group Only)

Work Group		<div style="border: 1px solid black; padding: 5px; display: inline-block;"> RECEIVED Type JUL 14 1993 MINING LANDS BRANCH </div>	<div style="border: 1px solid black; padding: 5px; display: inline-block;"> RECORDED JUL - 5 1993 Receipt _____ </div>
Regional Surveys			
Prospecting	PROSPECTING		

Total Assessment Work Claimed on the Attached Statement of Costs \$ 900.

Note: The Minister may reject for assessment work credit all or part of the assessment work submitted if the recorded holder cannot verify expenditures claimed in the statement of costs within 30 days of a request for verification.

Persons and Survey Company Who Performed the Work (Give Name and Address of Author of Report)

Name	Address
LOUIS COUSINEAU (AUTHOR)	272 SCOTT ST. (P.O. BOX 33) FORT FRANCES ONT. P9A 3M5
RAY COUSINEAU	430 1ST ST. E FORT FRANCES ONT. P9A 1K8
KEN DESJARDINS	518 NELSON ST. FORT FRANCES ONT. P9A 1B4

(attach a schedule if necessary)

Certification of Beneficial Interest * See Note No. 1 on reverse side

I certify that at the time the work was performed, the claims covered in this work report were recorded in the current holder's name or held under a beneficial interest by the current recorded holder.	Date JUNE 21 1993	Recorded Holder or Agent (Signature) <i>Louis Cousineau</i>
--	-----------------------------	--

Certification of Work Report

I certify that I have a personal knowledge of the facts set forth in this work report, having performed the work or witnessed it during and/or after its completion, and the annexed report is true.		
Name and Address of Person Certifying LOUIS COUSINEAU 272 SCOTT ST. (P.O. BOX 33) FORT FRANCES ONT. P9A 3M5		
Telephone No. 807-274-3761	Date JUNE 21 1993	Certified By (Signature) <i>Louis Cousineau</i>

For Office Use Only

Total Value Cr. Recorded \$ 900.00	Date Recorded	Mining Recorder (Signature) <i>Victoria D. [unclear]</i>	Received Stamp
Deemed Approval Date Oct 4/93	Date Approved		<div style="border: 1px solid black; padding: 5px;"> KENORA MINING DIV RECEIVED JUL - 5 1993 <small>AMT. PAID TO PROVINCE BY DEPOSIT SLIP</small> 7891011 121 23336 </div>
Date Notice for Amendments Sent			



Statement of Costs
for Assessment Credit

État des coûts aux fins
du crédit d'évaluation

Mining Act/Loi sur les mines

Transaction No./N° de transaction

W9310 00041

2.15096

Personal information collected on this form is obtained under the authority of the Mining Act. This information will be used to maintain a record and ongoing status of the mining claim(s). Questions about this collection should be directed to the Provincial Manager, Minings Lands, Ministry of Northern Development and Mines, 4th Floor, 159 Cedar Street, Sudbury, Ontario P3E 6A5, telephone (705) 670-7264.

Les renseignements personnels contenus dans la présente formule sont recueillis en vertu de la Loi sur les mines et serviront à tenir à jour un registre des concessions minières. Adresser toute question sur la collecte de ces renseignements au chef provincial des terrains miniers, ministère du Développement du Nord et des Mines, 159, rue Cedar, 4^e étage, Sudbury (Ontario) P3E 6A5, téléphone (705) 670-7264.

1. Direct Costs/Coûts directs

Type	Description	Amount Montant	Totals Total global
Wages Salaires	Labour <i>PROSPECTING</i> Main-d'oeuvre	<i>3 MLN</i> <i>2-DAYS</i>	<i>900.</i>
	Field Supervision Supervision sur le terrain		
Contractor's and Consultant's Fees Droits de l'entrepreneur et de l'expert- conseil	Type		
Supplies Used Fournitures utilisées	Type		
Equipment Rental Location de matériel	Type		
Total Direct Costs Total des coûts directs			

2. Indirect Costs/Coûts indirects

** Note: When claiming Rehabilitation work Indirect costs are not allowable as assessment work.
Pour le remboursement des travaux de réhabilitation, les coûts indirects ne sont pas admissibles en tant que travaux d'évaluation.

Type	Description	Amount Montant	Totals Total global
Transportation Transport	Type		
Food and Lodging Nourriture et hébergement			
Mobilization and Demobilization Mobilisation et démobilisation			
Sub Total of Indirect Costs Total partiel des coûts indirects			
Amount Allowable (not greater than 20% of Direct Costs) Montant admissible (n'excédant pas 20 % des coûts directs)			
Total Value of Assessment Credit (Total of Direct and Allowable indirect costs)		Valeur totale du crédit d'évaluation (Total des coûts directs et indirects admissibles)	

Note: The recorded holder will be required to verify expenditures claimed in this statement of costs within 30 days of a request for verification. If verification is not made, the Minister may reject for assessment work all or part of the assessment work submitted.

Note : Le titulaire enregistré sera tenu de vérifier les dépenses demandées dans le présent état des coûts dans les 30 jours suivant une demande à cet effet. Si la vérification n'est pas effectuée, le ministre peut rejeter tout ou une partie des travaux d'évaluation présentés.

Filing Discounts

1. Work filed within two years of completion is claimed at 100% of the above Total Value of Assessment Credit.
2. Work filed three, four or five years after completion is claimed at 50% of the above Total Value of Assessment Credit. See calculations below:

Total Value of Assessment Credit	Total Assessment Claimed
	x 0.50 =

Remises pour dépôt

1. Les travaux déposés dans les deux ans suivant leur achèvement sont remboursés à 100 % de la valeur totale susmentionnée du crédit d'évaluation.
2. Les travaux déposés trois, quatre ou cinq ans après leur achèvement sont remboursés à 50 % de la valeur totale du crédit d'évaluation susmentionné. Voir les calculs ci-dessous.

Valeur totale du crédit d'évaluation	Evaluation totale demandée
	x 0,50 =

Certification Verifying Statement of Costs

I hereby certify:
that the amounts shown are as accurate as possible and these costs were incurred while conducting assessment work on the lands shown on the accompanying Report of Work form.

that as LOUIS COUSINEAU I am authorized
(Recorded Holder, Agent, Position in Company)

to make this certification

Attestation de l'état des coûts

J'atteste par la présente :
que les montants indiqués sont le plus exact possible et que ces dépenses ont été engagées pour effectuer les travaux d'évaluation sur les terrains indiqués dans la formule de rapport de travail ci-joint.

Et qu'à titre de _____ je suis autorisé
(titulaire enregistré, représentant, poste occupé dans la compagnie)

à _____ cette attestation.

Louis Cousineau Date April 30, 1993



Ministry of Northern Development and Mines

Ministère du Développement du Nord et des mines

Statement of Costs for Assessment Credit

État des coûts aux fins du crédit d'évaluation

Mining Act/Loi sur les mines

Transaction No./N° de transaction

W 9310 00041

2.15096

Personal information collected on this form is obtained under the authority of the Mining Act. This information will be used to maintain a record and ongoing status of the mining claim(s). Questions about this collection should be directed to the Provincial Manager, Minings Lands, Ministry of Northern Development and Mines, 4th Floor, 159 Cedar Street, Sudbury, Ontario P3E 6A5, telephone (705) 670-7264.

Les renseignements personnels contenus dans la présente formule sont recueillis en vertu de la Loi sur les mines et serviront à tenir à jour un registre des concessions minières. Adresser toute question sur la collecte de ces renseignements au chef provincial des terrains miniers, ministère du Développement du Nord et des Mines, 159, rue Cedar, 4^e étage, Sudbury (Ontario) P3E 6A5, téléphone (705) 670-7264.

1. Direct Costs/Coûts directs

Type	Description	Amount Montant	Totals Total global
Wages Salaires	Labour PROSPECTING Main-d'oeuvre	3 MLN 2-DAYS	900.
	Field Supervision Supervision sur le terrain		
Contractor's and Consultant's Fees Droits de l'entrepreneur et de l'expert-conseil	Type		
Supplies Used Fournitures utilisées	Type		
Equipment Rental Location de matériel	Type		
Total Direct Costs Total des coûts directs			

2. Indirect Costs/Coûts indirects

** Note: When claiming Rehabilitation work Indirect costs are not allowable as assessment work. Pour le remboursement des travaux de réhabilitation, les coûts indirects ne sont pas admissibles en tant que travaux d'évaluation.

Type	Description	Amount Montant	Totals Total global
Transportation Transport	Type		
Food and Lodging Nourriture et hébergement			
Mobilization and Demobilization Mobilisation et démobiliation			
Sub Total of Indirect Costs Total partiel des coûts indirects			
Amount Allowable (not greater than 20% of Direct Costs) Montant admissible (n'excédant pas 20 % des coûts directs)			
Total Value of Assessment Credit (Total of Direct and Allowable indirect costs)		Valeur totale du crédit d'évaluation (Total des coûts directs et indirects admissibles)	

RECEIVED
 JUL 14 1993
 MINING LANDS BRANCH

Note: The recorded holder will be required to verify expenditures claimed in this statement of costs within 30 days of a request for verification. If verification is not made, the Minister may reject for assessment work all or part of the assessment work submitted.

Note : Le titulaire enregistré sera tenu de vérifier les dépenses demandées dans le présent état des coûts dans les 30 jours suivant une demande à cet effet. Si la vérification n'est pas effectuée, le ministre peut rejeter tout ou une partie des travaux d'évaluation présentés.

Filing Discounts

1. Work filed within two years of completion is claimed at 100% of the above Total Value of Assessment Credit.
2. Work filed three, four or five years after completion is claimed at 50% of the above Total Value of Assessment Credit. See calculations below:

Total Value of Assessment Credit	Total Assessment Claimed
× 0.50 =	

Remises pour dépôt

1. Les travaux déposés dans les deux ans suivant leur achèvement sont remboursés à 100 % de la valeur totale susmentionnée du crédit d'évaluation.
2. Les travaux déposés trois, quatre ou cinq ans après leur achèvement sont remboursés à 50 % de la valeur totale du crédit d'évaluation susmentionné. Voir les calculs ci-dessous.

Valeur totale du crédit d'évaluation	Evaluation totale demandée
× 0,50 =	

Certification Verifying Statement of Costs

I hereby certify: that the amounts shown are as accurate as possible and these costs were incurred while conducting assessment work on the lands shown on the accompanying Report of Work form.

that as LOUIS COUSINEAU I am authorized (Recorded Holder, Agent, Position in Company)

Attestation de l'état des coûts

J'atteste par la présente : que les montants indiqués sont le plus exact possible et que ces dépenses ont été engagées pour effectuer les travaux d'évaluation sur les terrains indiqués dans la formule de rapport de travail ci-joint.

Et qu'à titre de _____ je suis autorisé (titulaire enregistré, représentant, poste occupé dans la compagnie)

to make this certification

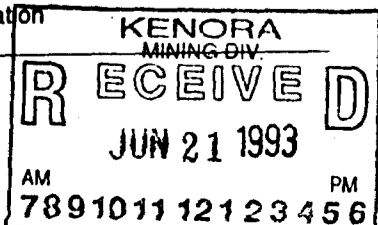

Signature: Louis Cousineau Date: April 30, 1993

à faire cette attestation.

MANION LAKE AREA - G-2686

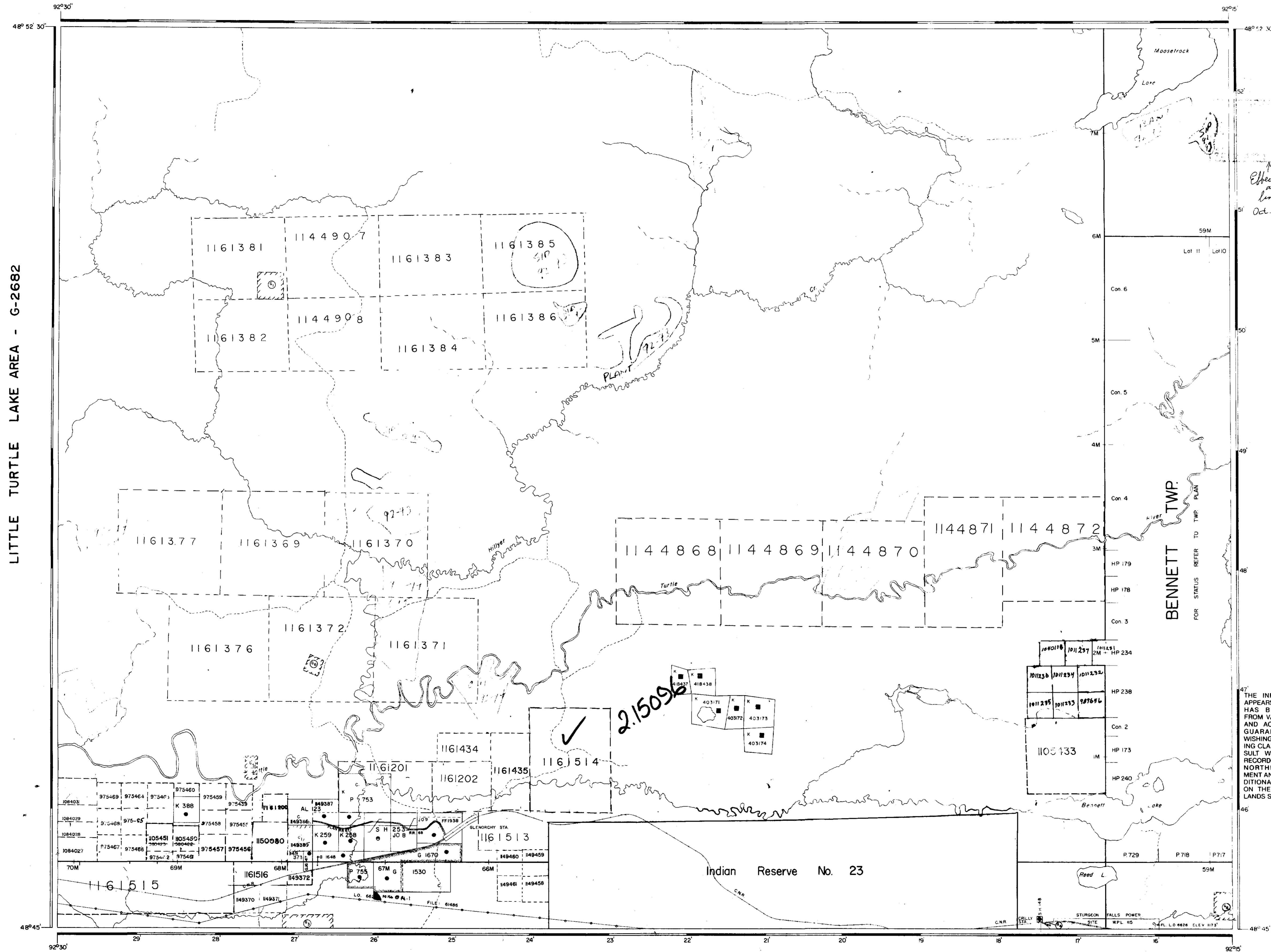

LITTLE TURTLE LAKE AREA - G-2682

HEPBURN LAKE AREA - G-2675

WILD POTATO LAKE AREA - G-2703

LEGEND

- HIGHWAY AND ROUTE No.
- OTHER ROADS
- TRAILS
- SURVEYED LINES
 - TOWNSHIP BASE LINES, ETC.
 - LOTS, MINING CLAIMS, PARCELS, ETC.
- UNSURVEYED LINES
 - LOT LINES
 - PARCEL BOUNDARY
 - MINING CLAIMS ETC.
- RAILWAY AND RIGHT OF WAY
- UTILITY LINES
- NON-PERENNIAL STREAM
- FLOODING OR FLOODING RIGHTS
- SUBDIVISION OR COMPOSITE PLAN RESERVATIONS
- ORIGINAL SHORELINE
- MARSH OR MUSKEG
- MINES
- TRAVERSE MONUMENT

DISPOSITION OF CROWN LANDS

TYPE OF DOCUMENT	SYMBOL
PATENT, SURFACE & MINING RIGHTS	●
" SURFACE RIGHTS ONLY	○
" MINING RIGHTS ONLY	○
LEASE, SURFACE & MINING RIGHTS	■
" SURFACE RIGHTS ONLY	□
" MINING RIGHTS ONLY	□
LICENCE OF OCCUPATION	▼
ORDER-IN-COUNCIL	OC
RESERVATION	⊙
CANCELLED	⊙
SAND & GRAVEL	⊙

NOTE: MINING RIGHTS IN PARCELS PATENTED PRIOR TO MAY 6, 1913, VESTED IN ORIGINAL PATENTEE BY THE PUBLIC LANDS ACT, R.S.O. 1970, CHAP. 380, SEC. 43, SUBSEC. 1.

REFERENCES

AREAS WITHDRAWN FROM DISPOSITION

- M.R.O. - MINING RIGHTS ONLY
 - S.R.O. - SURFACE RIGHTS ONLY
 - M.+S. - MINING AND SURFACE RIGHTS
- | Description | Order No. | Date | Disposition | File |
|-------------|-----------|------|-------------|------|
| | | | | |

SAND AND GRAVEL

- ① GRAVEL FILE 16271
- ② M.T.C. PIT 1089
- ③ GRAVEL FILE 16278
- ④ M.T.C. PIT 1058
- ⑤ GRAVEL FILE 16793
- ⑥ M.N.R. Gravel Reserve No. 228, File 16278
- ⑦ M.T.C. PIT N° 1B-14

2.15096

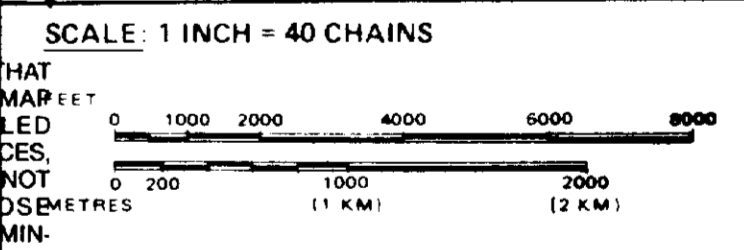

THE INFORMATION THAT APPEARS ON THIS MAP HAS BEEN COMPILED FROM VARIOUS SOURCES, AND ACCURACY IS NOT GUARANTEED. THOSE WISHING TO STAKE MINING CLAIMS SHOULD CONSULT WITH THE MINING RECORDER, MINISTRY OF NORTHERN DEVELOPMENT AND MINES FOR ADDITIONAL INFORMATION ON THE STATUS OF THE LANDS SHOWN HEREIN.

BENNETT LAKE

M.N.R. ADMINISTRATIVE DISTRICT
 FORT FRANCES
 MINING DIVISION
 KENORA
 LAND TITLES / REGISTRY DIVISION
 RAINY RIVER

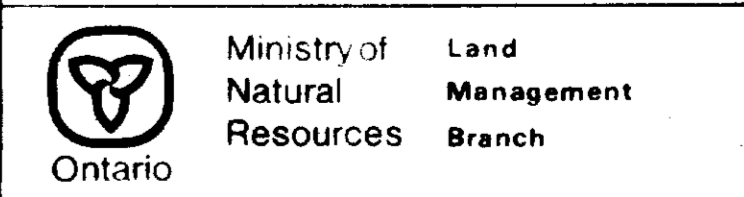

Date: FEBRUARY, 1984
 Number: M-2392 G-2667

