

DIAMOND DRILLING



52E085E0002 12 PHILLIPS

010

Township: Phillips

Report No: 12

WORK PERFORMED FOR: Wasabi Resources Ltd.

RECORDED HOLDER: SAME AS ABOVE [ X ]  
: OTHER [ ]

<u>CLAIM NO.</u>	<u>HOLE NO.</u>	<u>FOOTAGE</u>	<u>DATE</u>	<u>NOTE</u>
K 751067	C-9	110'	Oct/86	(1)
	C-10	100'	Oct/86	(1)
	C-11	176'	Oct/86	(1)
	C-12	200'	Oct/86	(1)
	C-13	140'	Oct/86	(1)
	C-14	100'	Oct/86	(1)
	C-15	115'	Oct/86	(1)
	C-16	120'	Oct/86	(1)
	C-17	309'	Oct/86	(1)
K670134	C-18	120'	Oct/86	(1)
	C-19	140'	Oct/86	(1)
	C-20	120'	Nov/86	(1)
K 751067	C-21	320'	Nov/86	(1)
K 670138	C-22	135'	Nov/86	(1)
K 819335	C-23	309'	Nov/86	(1)
	<u>15</u>	<u>2514'</u>		

NOTES: (1) #23-87 (filed in June/87)

# DIAMOND DRILL RECORD

NAME OF PROPERTY Combined  
 HOLE NO. C-9 LENGTH 110.0 ft.  
 LOCATION Phillips Twp., Ontario  
 LATITUDE 3+60 S DEPARTURE 2+15 W  
 ELEVATION \_\_\_\_\_ AZIMUTH \_\_\_\_\_ DIP Vertical  
 STARTED Oct. 2, 1986 FINISHED Oct. 3, 1986

FOOTAGE	DIP	AZIMUTH	FOOTAGE	DIP	AZIMUTH

HOLE NO. C-9 SHEET NO. 1 of 2  
 REMARKS Drilled by   
Northwest Geophysics  
BQ core  
 LOGGED BY Jeff Sample

FOOTAGE		DESCRIPTION	SAMPLE			ASSAYS			
FROM	TO		NO.	FOOTAGE FROM TO TOTAL	%	%	OZ/TON	OZ/TON	
0.0	0.0	Collar							
0.0	2.5	Casing							
2.5	37.7	<u>Basalt</u> ; d grn; chloritic; loc minor epidote altn or saussuritization; vague pillow selvages; loc num v sml, elongate wh calcite "eyes" or amygdules; occ - num hairline to 0.01' thick fract's filled w wh calcite, one set @ $\approx 5^\circ - 10^\circ$ , 2nd set @ $\approx 70^\circ$ ; also some v irreg fract's; rare fract's filled w pk calcite; rare fract's filled w clear to wh qtz plus wh calcite; gen 1-3%, vv loc to 10% fg dissem py, often trending nearly // to core axis; rare spks cp; loc minor dissem hem. 4.2 - 5.2 sly blchd, altd & silicified 36.8 - 37.7 strongly silicified	86C9-1	36.8	37.7			Au .023	
37.7	39.2	<u>Qtz Vein</u> ; wh to lgy qtz; U ct sly irreg @ $\approx 85^\circ$ ; L ct sly irreg @ $\approx 80^\circ$ ; occ hairline fract's @ $85^\circ$ lined w sericite, chlorite & minor py; occ v irreg patches cp & rare py	86C9-2	37.7	39.2			.006	
39.2	48.8	<u>Highly Altered Rock</u> ; strongly blchd & silicified; probably carb-altd basalt; some vague spots & patches apple grn coloration due to fuchsite? $\leq 1\%$ dissem py (+po); qtz extends from overlying vein into f fract's extending @ low $\angle$ s to along core; loc rare - occ v irreg f fract's filled w wh to lgy qtz & lesser amt wh dol, rare - occ spks & sml patches cp & py, plus v loc minor tourmaline? L ct $\approx 45^\circ$	-3 -4	39.2 44.2	44.2 48.8			.003 .001	

ONTARIO GEOLOGICAL SURVEY  
 ASSESSMENT FILES  
 RESEARCH OFFICE  
 FEB 19 1987  
 RECEIVED

*Jeff Sample*



# DIAMOND DRILL RECORD

NAME OF PROPERTY Combined  
 HOLE NO. C-10 LENGTH 100.0 ft.  
 LOCATION Phillips Twp., Ontario  
 LATITUDE 2+75 S DEPARTURE 2+00 W  
 ELEVATION \_\_\_\_\_ AZIMUTH \_\_\_\_\_ DIP Vertical  
 STARTED Oct. 4, 1986 FINISHED Oct. 5, 1986

FOOTAGE	DIP	AZIMUTH	FOOTAGE	DIP	AZIMUTH

HOLE NO. C-10 SHEET NO. 1 of 3

REMARKS Drilled by Northwest Geophysics  
BQ core

LOGGED BY Jeff Sample

FOOTAGE		DESCRIPTION	SAMPLE				ASSAYS			
FROM	TO		NO.	SULPHUR % SEC	FOOTAGE		%	%	OZ/TON	OZ/TON
					FROM	TO				
0.0	0.0	Collar								
0.0	4.0	Casing								
4.0	8.0	<u>Mixed Rock - Mainly Feldspar Porphyry</u> ; remnants of d grn, chloritic basalt? in feldspar porphyry; rare - occ vf, irreg fractrs filled w wh calcite; $\approx$ 1% dissem py								Au
8.0	8.4	<u>Intrusive Contact Breccia? or Fault Breccia?</u> slickensided cts @ $\approx$ 20°-25°; hem. stain								
8.4	32.3	<u>Feldspar Porphyry</u> ; l gy felds phenocrysts in a m-d grnish-gy, sly chloritic mtx; appears to be contaminated by country rock near L ct; rare - loc occ f, irreg fractrs filled w wh to l gy calcite (fractrs often @ low $\angle$ s to along core); occ f fractrs near U ct lined w specular hem. & maroon hem. stain; $\approx$ 1% dissem py.								
32.3	37.0	<u>Andesite? or altered Feldspar Porphyry?</u> blk & v loc d grn inclusion? of altd And? or altd Felds Porph? U ct 40°; L ct 50°; 4-5% dissem py; lower part is C-bxd w vf fractrs filled w wh calcite	86C10-10		32.3	37.0				.002
37.0	57.6	35.1 & 35.2 0.2' thick veins l gy qtz & wh calcite; $\angle$ s 45° (oblique to U ct) <u>Feldspar Porphyry</u> ; contaminated by mafic volcanic country rock - vague felds phenocrysts, often sly stretched // to core axis, in a d grn, sly chloritic mtx; occ f, irreg fractrs & loc finely fractrd C-bx w mtx of wh calcite & loc w l gy qtz; occ spks & sml patches py, $\approx$ 1% overall	86C10-11		37.0	42.0				.004
			-12		42.0	47.0				.001
			-13		47.0	53.7				.001
			-14		53.7	57.6				.003

Jeff Sample

LANGRIDGES - TORONTO - 366-1188

# DIAMOND DRILL RECORD

 NAME OF PROPERTY Combined

 HOLE NO. C-10 SHEET NO. 2 of 3

FOOTAGE		DESCRIPTION	SAMPLE			ASSAYS				
FROM	TO		NO.	FOOTAGE		%	%	OZ/TON	OZ/TON	
				FROM	TO					TOTAL
37.0	57.6	Con. 53.7-57.6 altd by addition of silica & carbonate; more numerous fract's w mtx of wh to l gy qtz, wh calcite & loc w wh to beige dol. 54.0 0.15' thick wh qtz & calcite vein @ 45°; rare patches cp & py; minor apple grn coloration due to fuchsite. 57.4 irreg bx vein of wh qtz & beige dol $\approx$ 0.05' thick							Au	
57.6	72.3	<u>Altered Rock</u> ; m gy, f.g. fairly massive rock; some vague pillow selvages; appears to be a carb altd & silicified basalt; 2-3% vfg dissem py (vv loc to 10% py); occ - num f irreg fract's & loc C-bx w mtx of l gy qtz, wh dol, rare - occ sml patches py & rare sml patches cp.	86C10-15	57.6	62.6				.006	
				-16	62.6	67.6				.002
				-17	67.6	72.3				.003
72.3	79.4	<u>Altered &amp; Brecciated Rock</u> ; as @ 72.3 but more intensely fract'd & bxd w wh to l gy qtz & wh to beige dol mtx; py dissem & conc along fract's - extremely variable but $\approx$ 5% py overall; < 1% cp 72.4, 73.5 & 79.0 num lge patches py & occ patches cp in qtz-carb filled fract's								.020
				-18	72.3	77.3				.18
				-19	77.3	79.4				
79.4	81.1	<u>Qtz Breccia Vein</u> ; apple grn colored (fuchsitic), carbonatized & silicified frags of country rock in abund wh - l gy qtz mtx; cts $\approx$ 70°-75°; only rare - occ spks dissem py in upper part; abund py, cp & occ patches brn sphal in basal 0.5'.								.015
				-20	79.4	81.1				
81.1	86.1	<u>Altered Basalt</u> ; m gy to grn massive basalt; weakly blechd & altd; occ vague saussuritized spots; rare v irreg fract's filled w l gy qtz & wh calcite; $\approx$ 1% f dissem py; L ct gradational.								.001
				-21	81.1	86.1				



# DIAMOND DRILL RECORD

NAME OF PROPERTY Combined  
 HOLE NO. C-11 LENGTH 176.0 ft.  
 LOCATION Phillips Twp., Ontario  
 LATITUDE 1+95 S DEPARTURE 1+95 W  
 ELEVATION \_\_\_\_\_ AZIMUTH \_\_\_\_\_ DIP Vertical  
 STARTED Oct. 6, 1986 FINISHED Oct. 9, 1986

FOOTAGE	DIP	AZIMUTH	FOOTAGE	DIP	AZIMUTH

HOLE NO. C-11 SHEET NO. 1 of 2  
 REMARKS Drilled by  
Northwest Geophysics  
BQ core  
 LOGGED BY Jeff Sample

FOOTAGE		DESCRIPTION	SAMPLE				ASSAYS				
FROM	TO		NO.	FOOTAGE			P.p.b. Au	%	OZ/TON	OZ/TON	
				FROM	TO	TOTAL					
	0.0	Collar									
0.0	4.0	Casing									
4.0	100.6	<u>Mafic Tuff</u> ; d grn to blk, chloritic; vague f foliation @ low $\angle$ s to rolling along core; foliation is accented by variations in chl. content & loc by sulphides; v abund dissem. calcite; num v irreg frags, hairline to 0.01' thick, filled w wh calcite; one prominent set of frags @ 45°, 2nd prominent set @ $\approx$ 15°-20° in opp. direction; foliation loc off set up to 0.05' along the 45° frags; v loc occ sml patches po, py, cp conc along foliation, rare spks randomly dissem cp. & $\approx$ 1% v f dissem py. $\approx$ 33.5 - 35.5 0.05' thick c-bx w mtx of l gy qtz & wh calcite runs @ low $\angle$ s to along core (   to foliation) 97.6 - 100.6 sly blchd starting below a thin (0.01') calcite-filled parting @ $\approx$ 85°; occ 0.01' thick frags filled w l gy qtz near basal ct.	86C11-22	97.6	100.6		82				
100.6	101.2	<u>Strongly Altered Rock</u> ; grnish-gy, strongly altd to carb (dol); vague foliation @ $\approx$ 70°; occ hairline frags @ $\approx$ 45°; grnish coloration appears to be due to fuchsite; $\leq$ 1% dissem py	-23	100.6	101.2		54				
101.2	102.1	<u>Qtz Vein</u> ; wh qtz; v et 75°-80°; L et 85°-90°; rare-occ vvf, irreg frags filled w chl, py & beige dol	-24	101.2	102.1		23				

Jeff Sample

# DIAMOND DRILL RECORD

 NAME OF PROPERTY Combined

 HOLE NO. C-11

 SHEET NO. 2 of 2

FOOTAGE		DESCRIPTION	SAMPLE			ASSAYS			
FROM	TO		NO.	FOOTAGE		P.P.B. Au	%	OZ/TON	OZ/TON
				FROM	TO				
102.1	118.7	<u>Weakly Altered Tuff</u> ; m-d gy to grnish-gy, weakly carb altd mafic tuff; variably blchd w strong blching near U ct; occ spots or "eyes" wh calcite & dol. gen. elongate // foliation; occ to loc num f., irreg fract's w mtx of wh dol & minor calcite; occ partings & fract's // foliation w mtx of wh dol, minor calcite, variable but gen abund po (magnetic), py & rare patches cp; foliation $\approx 10^{\circ}$ - $15^{\circ}$ to rolling along core.	86C11-25	102.1	108.1				82
			86C11-26	112.7	118.7				78
118.7	123.3	<u>Sulphide-Rich, Weakly Altered Tuff</u> ; tuff as @ 118.7 but more strongly carb-altd & contains $\approx 30\%$ sulps, mainly py w lesser po, rare-occ patches d brn sphal. & rare sml patches cp 121.0-123.3 variably bxd w mtx of lgy to wh qtz & wh calcite & dol.	-27	118.7	123.3				64
123.3	133.8	<u>Qtz Vein</u> ; wh qtz; rare patches cp; rare to v loc occ spks & patches py; occ vvf fract's filled w chl, beige dol & v minor py; also, loc abund blk tourmaline along vf fract's; U ct $\approx 10^{\circ}$ - $15^{\circ}$ // to tuff foliation; L ct $\approx 35^{\circ}$	-28	123.3	128.3				<5
			-29	128.3	133.8				<5
133.8	142.0	<u>Weakly Altered Tuff</u> ; m gy to grnish-gy; loc sly blchd; num sml spots or "eyes" wh calcite, often elongate // foliation; occ f irreg fract's w mtx of wh dol & calcite plus loc abund py & po; foliation rolls along core @ low $\angle$ s	-30	133.8	142.0				<5
142.0	176.0	<u>Relatively Unaltered Mafic Tuff</u> ; m-d gy-grn; v vague foliation rolling along core @ low $\angle$ s; num to v num sml spots or "eyes" wh calcite; gen 2-5% f dissem py plus po; occ partings or fract's 0.02' thick running // to foliation have mtx of wh calcite & loc num patches of py & po.							
	176.0	Foot of Hole							



# DIAMOND DRILL RECORD

NAME OF PROPERTY Combined  
 HOLE NO. C-12 LENGTH 200.0 ft.  
 LOCATION Phillips Twp., Ontario.  
 LATITUDE 1+80 S DEPARTURE 2+80 W  
 ELEVATION \_\_\_\_\_ AZIMUTH \_\_\_\_\_ DIP Vertical  
 STARTED October 10, 1986 FINISHED October 12, 1986

FOOTAGE	DIP	AZIMUTH	FOOTAGE	DIP	AZIMUTH

HOLE NO. C-12 SHEET NO. 1 of 3  
 REMARKS Drilled by Northwest Geophysics  
BQ core  
 LOGGED BY Jeff Sample

FOOTAGE		DESCRIPTION	SAMPLE			ASSAYS			
FROM	TO		NO.	FOOTAGE FROM TO TOTAL	P.P.B. Au	%	OZ/TON	OZ/TON	
0.0	0.0	Collar							
0.0	4.5	Casing							
4.5	53.7	<u>Andesite</u> ; m-d grn, massive, chloritic; v loc num sml spots or "eyes" wh calcite; occ to loc v num f fract's filled w wh calcite & minor py; rare fract's filled w l qz to wh qtz plus minor py & cp; most prom. set of fract's ranges from 60° to 40°; 2-3% mag, dissem & conc along vvf fract's; 1-4% py plus magnetic po; rare to loc occ spks & patches cp; v loc num sml patches d brn sphal. 7.0 - 8.0 loc occ patches d brn sphal. 16.9 0.05' thick wh qtz vein @ 85°-90° 47.9 - 48.4 blchd & altd on either side of a 40° vein @ 49.2; vein is l qz qtz plus wh dol & calcite w occ spks & patches py							
53.7	54.7	<u>Bleached &amp; Altered Andesite</u> ; as @ 53.7 but strongly blchd & somewhat carb. - altd	86C12-31	53.7 54.7	<5				
54.7	56.6	<u>Qtz Breccia Vein</u> ; bx frags of blchd & carb-altd And. in mtx of wh - l qz qtz & wh dol; occ patches po & py; rare spks cp; U ct ≈ 45° & sly oblique to fract's in And; L ct broken	-32		8				
56.6	59.6	<u>Bleached &amp; Altered Andesite</u> ; similar to 54.7	-33		N.A.				
59.6	99.8	<u>Andesite</u> ; similar to 53.7; loc prom vvf fract's w wh calcite mtx @ 60°-40°.							

*Jeff Sample*

# DIAMOND DRILL RECORD

NAME OF PROPERTY Combined

HOLE NO. C-12 SHEET NO. 2 of 3

FOOTAGE		DESCRIPTION	SAMPLE			ASSAYS			
FROM	TO		NO.	FOOTAGE		P.P.B. Au	%	OZ/TON	OZ/TON
				FROM	TO	TOTAL			
99.8	101.7	<u>Strongly Altered Rock</u> ; 1-m qy blchd & carb-alt'd And; U ct along irreg calcite parting @ $\approx 80^\circ$ ; occ spks & sml patches py, cp. 100.1 0.1' thick wh qtz vein @ $45^\circ$ ; occ sml patches wh dol; num lge patches brn sphal.; occ sml patches py. 100.8 0.15' thick wh qtz vein @ $45^\circ-50^\circ$	86C12-34	99.8	101.7		60		
101.7	106.6	<u>Qtz Breccia Vein</u> ; qy to apple grn colored (fuchsitic) frags strongly carb alt'd & silicified rock in mtz of wh to l qy vein qtz & minor wh to ivory colored dol.; rare-occ sml patches cp; rare patches d brn sphal.; vague vvf fract's or partings @ $\approx 70^\circ$ ; U ct sly irreg @ $\approx 70^\circ$ ; L ct $\approx 65^\circ-70^\circ$	-35	101.7	106.6		<5		
106.6	107.2	<u>Strongly Altered Rock</u> ; similar to 101.7 107.0 irreg. 0.01'-0.05' thick wh qtz vein @ $\approx 45^\circ$ ; occ patches d brn sphal; rare spks cp.	-36	106.6	107.2		<5		
107.2	148.1	<u>Andesite</u> ; as @ 53.7 & 99.8; occ v sml spots or "eyes" blue opalescent qtz adj to basal ct. 136.6 0.05' wh qtz bx vein @ $70^\circ$							
148.1	154.5	<u>Mafic Dike? or Inclusion?</u> d grn mafic rock, possibly And; porphyritic w sly elongate, chloritized mafic phenocrysts in a f.g. mtz; v vague foliation, most prom in lower part of unit, rolls along core @ low $\angle$ s & //s basal ct; U ct $45^\circ$ ; L ct $\approx 30^\circ-35^\circ$ in opposite direction; occ vvf-irreg fract's filled w wh calcite; occ spks dissem py & cp.							
154.5	200.0	<u>Andesite</u> ; as @ 148.1; loc num v sml spots or "eyes" of blue opalescent qtz. 160.5 0.1' bx vein w mtz of l qy to wh qtz & wh carb; irreg cts @ $\approx 80^\circ$ 165.0 0.05' qtz-chl vein @ $60^\circ-65^\circ$							



# DIAMOND DRILL RECORD

NAME OF PROPERTY Combined  
 HOLE NO. C-13 LENGTH 140.0 ft.  
 LOCATION Phillips Twp., Ontario  
 LATITUDE 3405 S DEPARTURE 3495 W  
 ELEVATION \_\_\_\_\_ AZIMUTH \_\_\_\_\_ DIP Vertical  
 STARTED Oct. 13, 1986 FINISHED Oct. 15, 1986

FOOTAGE	DIP	AZIMUTH	FOOTAGE	DIP	AZIMUTH

HOLE NO. C-13 SHEET NO. 1 of 2  
 REMARKS Drilled by Northwest Geophysics  
BQ core  
 LOGGED BY Jeff Sample

FOOTAGE		DESCRIPTION	SAMPLE				ASSAYS				
FROM	TO		NO.	% SULPH IDEC	FOOTAGE FROM	FOOTAGE TO	FOOTAGE TOTAL	P.p.b. Au	%	OZ/TON	OZ/TON
	0.0	Collar									
0.0	4.0	Casing									
4.0	32.0	<u>Andesite</u> ; m-d grn, massive, chloritic; feldspars v loc saussuritized; v loc num sml spots or "eyes" wh calcite; occ-loc v num f fract's filled w wh calcite & minor py; rare fract's filled w calcite & l gy to wh qtz plus minor py & cp; most prom. set of fract's is @ 70°-80°; 2-3% ? dissem mag; 1-3% & v loc to 10% dissem py & po; rare-loc occ spks & sml patches cp. 9.9-10.5 inclusion? of mafic tuff; f foliation @ 40°; 0.05' qtz-carb bx vein @ U ct of tuff.									
32.0	34.7	<u>Strongly Altered Rock</u> ; m gy (blchd), carb altd & silicified rock; occ-num irreg fract's filled w l gy to wh qtz & lesser wh to beige dol; ave. 2-4% dissem spks & patches py + po; occ patches cp; U ct sly irreg @ 80°; L ct v irreg. @ 50°-60°. 32.3 - 32.9 Bx Vein; num frags apple grn (fuchsitic) altd rock in l gy to wh qtz mtx; irreg cts @ ≈ 80°; thin partings @ 80° 33.9 0.05' thick vein wh to l gy qtz & minor wh dol; vein trends @ 40°	86C13-37		32.0	34.7		136			
34.7	37.1	<u>Qtz Breccia Vein</u> ; lge frags blchd & carb altd rock in mtx of wh to l gy qtz & minor wh dol; loc occ-num spks & patches po & py; rare-occ patches cp.	-38		34.7	37.1		783			

*Jeff Sample*

LANGRIDGES - TORONTO - 366-1166

# DIAMOND DRILL RECORD

 NAME OF PROPERTY Combined

 HOLE NO. C-13 SHEET NO. 2 of 2

FOOTAGE		DESCRIPTION	SAMPLE			ASSAYS			
FROM	TO		NO.	FOOTAGE		p.p.b. Au	%	OZ/TON	OZ/TON
				FROM	TO				
37.1	59.0	<p><u>Strongly Altered Rock</u>; carb altd rock similar to 34.7; loc vague v f foliation (shring?!) @ 40°-45°</p> <p>≈ 40.2-50.4 almost no veining</p> <p>50.4-50.8 qtz-carb bx vein; cts ≈ 65°-70°</p> <p>51.7-51.8 qtz-carb bx vein; cts ≈ 60°-65° @ oblique ⊥ to vein @ 50.4-50.8</p> <p>52.9-53.2 wh qtz vein; cts 40°-45° &amp; oblique to both above bx veins</p> <p>56.6-56.7 qtz-carb bx vein; cts 40°-45° as @ 52.9-53.2; ≈ 15° of vein is cp.</p>	86C1	3-39	37.1	42.1	253		
				40	42.1	47.1	6		
				41	47.1	52.1	34		
				42	52.1	56.2	45		
				43	56.2	57.2	485		
				44	57.2	59.0	45		
59.0	70.7	<p><u>Weakly to Moderately Altered Rock</u>; mgy to m grn, weakly to moderately carb altd And?; v vague foliation @ ≈ 45°; occ-num f fractrs mainly @ 40°-45° (sly oblique to foliation) filled w wh dol; loc rare-occ 0.01' - 0.02' fractrs filled w qtz &amp; wh dol; 1-3% dissem pytpo; rare spks cp.</p>	-45	59.0	64.0	45			
			46	64.0	70.7	45			
70.7	79.2	<p><u>Strongly Altered Rock</u>; blchd &amp; altd similar to 34.7</p> <p>75.7 0.05' thick wh qtz vein @ 25°</p> <p>78.8 0.03 thick wh qtz vein; drag folded</p>	-47	70.7	75.7	45			
			48	75.7	79.2	78			
79.2	80.4	<p><u>Qtz Breccia Vein</u>; U ct ≈ 60-65°; L ct v irreg ≈ 60°-65°; U 0.6' is wh qtz; L 0.6' consists of bx frags of strongly altd rock in wh qtz mtx; num spks &amp; patches py in lower part.</p>	-49	79.2	80.4	45			
80.4	83.2	<p><u>Strongly Altered Rock</u>; similar to 34.7</p> <p>81.0-81.3 Qtz Bx Vein; minor apple grn coloration due to fuchsite; cts 80°</p>	-50	80.4	83.2	10			
83.2	140.0	<p><u>Andesite</u>; as @ 32.0; v loc minor red-brn hem stain along fractrs.</p>							
140.0		Foot of Hole							

# DIAMOND DRILL RECORD

NAME OF PROPERTY Combined  
 HOLE NO. C-14 LENGTH 100.0 ft.  
 LOCATION Phillips Twp., Ontario.  
 LATITUDE 1+00 S DEPARTURE 3+10 W  
 ELEVATION \_\_\_\_\_ AZIMUTH \_\_\_\_\_ DIP Vertical  
 STARTED Oct. 16, 1986 FINISHED Oct. 17, 1986

FOOTAGE	DIP	AZIMUTH	FOOTAGE	DIP	AZIMUTH

HOLE NO. C-14 SHEET NO. 1 of 2  
 REMARKS Drilled by   
Northwest Geophysics  
BQ core  
 LOGGED BY Jeff Sample

FOOTAGE		DESCRIPTION	SAMPLE			ASSAYS			
FROM	TO		NO.	FOOTAGE FROM TO TOTAL	P.P.B. Au	%	OZ/TON	OZ/TON	
0.0	0.0	Collar							
0.0	37.8	Andesite; m-d grn, massive, chloritic; occ - loc num f, irreg fract's filled w wh calcite; rare - occ sm'l spots or "eyes" blue opalescent qtz; sly shrd & bxd along L ct @ 10° - 15° - along core; 1-2% dissem py							
37.8	83.9	Feldspar Porphyry; 1 gy felds phenocrysts, 0.015' & loc to 0.03' (4-8 mm) in a m-d gy to grnsh-gy fq mtx; rare f fract's @ 5° - 10° filled w wh calcite; ≤ 1% dissem py 65.0 - 71.0 becomes finer grained & more contaminated by country rock; felds phenocrysts are obscure; also appears to be carb altd. 71.0 - 78.0 sly silicified; c felds phenocrysts are sly distorted. 71.0 0.01' wh qtz - carb filled fract @ 65° 72.0 0.005' " " " " " " 75.7 0.01' " " " " " " 60°							
		78.0 - 79.5 finer grained & sly contaminated, similar to 65.0 - 71.0; fairly strongly altd to carb.							
		79.5 - 80.1 poorly defined Bx Vein w mtx of 1 gy to wh qtz, wh dol & calcite & some pale apple grn fuchsite; < 1% dissem py	8601	79.5 80.1		< 5			
		80.1 - 83.9 shrd & bxd; variably carb altd & silicified porphyry; basal ct sly irreg @ ≈ 45°.							

*Jeff Sample*



# DIAMOND DRILL RECORD

NAME OF PROPERTY Combined  
 HOLE NO. C-15 LENGTH 115.0 ft.  
 LOCATION Phillips Twp., Ontario  
 LATITUDE 3+05 S DEPARTURE 5+45 W  
 ELEVATION \_\_\_\_\_ AZIMUTH \_\_\_\_\_ DIP Vertical  
 STARTED Oct. 18, 1986 FINISHED Oct. 20, 1986

FOOTAGE	DIP	AZIMUTH	FOOTAGE	DIP	AZIMUTH

HOLE NO. C-15 SHEET NO. 1 of 2  
 REMARKS Drilled by  
Northwest Geophysics  
BQ core  
 LOGGED BY Jeff Sample

FOOTAGE		DESCRIPTION	SAMPLE				ASSAYS				
FROM	TO		NO.	% SULPHIDES	FOOTAGE FROM	FOOTAGE TO	FOOTAGE TOTAL	P.P.B. Au	%	OZ/TON	OZ/TON
	0.0	Collar									
0.0	2.5	Casing									
2.5	18.8	<u>Andesite</u> ; m-d grn, massive, chloritic; occ f, v irreg frags filled w wh calcite; $\approx$ 1% py, dissem & conc. along f frags; loc 3-4% & v loc up to 10% mag, dissem & conc along f frags 17.0 - 18.8 variably bxd w mtx of wh calcite & qtz	8602		17.0	18.8		<5		Au	
18.8	20.1	<u>Fuchsitic, Strongly Altered Rock</u> ; m gy to apple grn (fuchsitic), strongly carb-alt'd rock; occ - num frags filled w wh qtz & wh dol; 0.3' qtz bx vein @ U ct; U ct $\approx$ 75°; Lct v irreg; v loc num dissem patches py.	8603		18.8	20.1		<5			
20.1	72.0	<u>Strongly Altered Rock</u> ; m gy; rock is carb plus v finely dissem blk amph? or tourmaline? loc abund f dissem. grn pyrox? or amph? plus py & later qtz; occ & becoming increasingly num irreg frags & partings filled w wh dol & l gy to wh qtz; locally abund py (up to 15%) conc along vague foliation @ 40°-45°.	04		20.1	25.1		<5			
		41.0 onwards - increasingly num, v irreg qtz veins & patches	05		25.1	30.1		444			
		51.5 0.075' wh qtz vein w minor wh dol, @ 45°	06		30.1	35.1		1326	.04		
		51.7 - 52.0 occ patches sphal & cp in wh qtz vein @ 45°	07		35.1	40.1		198			
		53.1 - 54.4 qtz vein; cts 45° (oblique to 45° foliation)	08		40.1	45.1		365			
		55.0 0.1' wh qtz vein @ 45°	09		45.1	50.1		451			
			10		50.1	53.1		171			
			11		53.1	54.4		13			
			12		54.4	59.4		919	.024		
			13		59.4	64.4		588			
			14		64.4	69.4		1250	.038		
			15		69.4	72.0		1904	.06		

Jeff Sample





# DIAMOND DRILL RECORD

NAME OF PROPERTY Combined  
 HOLE NO. C-16 LENGTH 120.0 ft.  
 LOCATION Phillips Twp., Ontario  
 LATITUDE 3+95 S DEPARTURE 5+10 W  
 ELEVATION \_\_\_\_\_ AZIMUTH \_\_\_\_\_ DIP Vertical  
 STARTED Oct. 20, 1986 FINISHED Oct. 21, 1986

FOOTAGE	DIP	AZIMUTH	FOOTAGE	DIP	AZIMUTH

HOLE NO. C-16 SHEET NO. 1 of 2  
 REMARKS Drilled By   
Northwest Geophysics  
BQ core  
 LOGGED BY Jeff Sample

FOOTAGE		DESCRIPTION	SAMPLE			ASSAYS			
FROM	TO		NO.	% SULPHIDES	FOOTAGE FROM TO TOTAL	P.P.B. Au	%	OZ/TON	OZ/TON
0.0	0.0	Collar							
0.0	5.0	Casing							
5.0	14.6	<u>Andesite</u> ; m-d grn, massive, chloritic; occ f fracts, mainly @ 60°-80°; filled w wh calcite; ≈ 2% dissem py (tpo?); 2-3% dissem mag.							
14.6	20.0	<u>Strongly Altered Rock</u> ; m gy to brnsh & grnsh strongly carb- altd rock; loc occ-num fracts to 0.05" filled w l gy to wh qtz & wh dol; variable py - gen 1-2% but loc to 8-10%; v loc occ patches cp & sphal (mainly before 17.4'); starting @ 17.4' loc some apple grn coloration due to fuchsite.	8619 20		14.6 17.4 17.4 20.0	625 78			
20.0	23.3	<u>Qtz Breccia Vein</u> ; c-bx frags strongly carb altd rock w ≈ 25-30% l gy to wh qtz mtx; loc occ patches beige dol in mtx; gen v abund dissem py in altd frags (up to 15%); v loc v minor apple grn coloration due to fuchsite; altd rock mainly v finely foliated @ ≈ 80°.	-21		20.0 23.2	205			
23.3	41.8	<u>Strongly Altered Rock</u> ; m-d gy strongly carb altd rock; mainly massive but loc has a vague bxd or nodular appearance & v prom. f foliation; foliated zones carry v sml "knots" & patches wh qtz & wh dol; 23.2 - ≈ 25.0 mainly massive ≈ 25.0 - ≈ 30.0 foliated @ 45°-60°-80° ≈ 30.0 - 41.8 mainly massive; loc occ irreg disseminations & patches py, gen 1-3% but loc to 5 or 6%; rare sml patches cp.	-22 23 24 25		23.2 25.0 25.0 30.0 30.0 35.0 35.0 41.8	64 300 34 32			

*Jeff Sample*



# DIAMOND DRILL RECORD

NAME OF PROPERTY Combined  
 HOLE NO. C-17 LENGTH 309.0 ft.  
 LOCATION Phillips Twp., Ontario  
 LATITUDE 10+50 S DEPARTURE 2+85 W  
 ELEVATION \_\_\_\_\_ AZIMUTH 155° DIP -45°  
 STARTED Oct. 22, 1986 FINISHED Oct. 26, 1986

FOOTAGE	DIP	AZIMUTH	FOOTAGE	DIP	AZIMUTH

HOLE NO. C-17 SHEET NO. 1 of 4  
 REMARKS Drilled by Northwest Geophysics  
BQ core  
 LOGGED BY Jeff Sample

FOOTAGE		DESCRIPTION	SAMPLE				ASSAYS			
FROM	TO		NO.	SULPHIDES	FOOTAGE FROM TO TOTAL	p.p.b. Au	%	OZ/TON	OZ/TON	
0.0	0.0	Collar								
0.0	18.0	Casing								
18.0	28.7	<u>Pyroclastic Breccia</u> ; 1-m gy & loc tan-gy, elongate, angular to sub-rndd bx frags of f.g. felsic or blchd mafic material in a d grn, f.g., chloritic mtx; frags range up to 0.07' wide & are probably up to 0.25' to 0.35' long; the long axes of bx frags trend @ $\approx 50^\circ-55^\circ$ ; rare fract's from hairline to 0.01' thick filled w calcite & loc w v minor hem. stain; loc occ irreg patches calcite; gen abund dissem carb altn (calcite plus some dol?) in bx frags & in mtx; many bx frags have distorted & variably blchd fims; $\approx 1\%$ py dissem throughout frags & mtx & as local concentrations trending // foliation.								
28.7	75.0	<u>Mafic Tuff</u> ; d grn, chlritic, f.g.; occ to loc num f, irreg fract's filled w wh calcite; rare irreg patches wh calcite; v num v sml wh calcite spots or "eyes" dissem throughout unit & gen sly elongate // to vague foliation @ $\approx 50^\circ-55^\circ$ ; $\approx 2-3\%$ v dissem py 31.2 0.04' wh calcite & qtz vein @ $\approx 70^\circ$ 36.7 0.06' wh calcite & qtz vein // foliation								
75.0	85.7	<u>Crackle-Brecciated &amp; Weakly Altered Tuff</u> ; as @ 75.0 but finely C-bxd & sly carb (dol) altd; degree of bxn & altn increases w depth; bx mtx in upper pt. is wh calcite, in lower pt. is wh dol & loc l gy to wh qtz; gen 5-8% & v loc	8627 28		75.0 80.0	80.0 85.7	25 17			

*Jeff Sample*

LANGRIDGES - TORONTO - 366-1168

# DIAMOND DRILL RECORD

 NAME OF PROPERTY Combined

 HOLE NO. C-17 SHEET NO. 2 of 4

FOOTAGE		DESCRIPTION	SAMPLE				ASSAYS			
FROM	TO		NO.	FOOTAGE			P.P.B. Au	%	OZ/TON	OZ/TON
				FROM	TO	TOTAL				
75.0	85.7	Con. to 12-15% dissem py; 2-3% vvf dissem mag?								
85.7	89.7	Qtz Breccia Vein; vague grnish, chloritic, carb-alt'd frags of country rock in abund mtx of wh to l gy qtz & wh to beige dol; v abund blk tourmaline in upper part; U ct irreg @ $\approx 75^{\circ}$ - $80^{\circ}$ ; L ct $40^{\circ}$ ; loc abund dissem py & loc rare patches mag in bx frags.	8629	85.7	89.7					
89.7	98.1	Feldspar Porphyry; l to l-m gy felds phenocrysts in m gy to grnish-gy f.g. gm.; sly blchd near U ct; rare vvf fract's; v rare dissem py.	-30 31	89.7 94.7	94.7 98.1					
98.1	160.4	Crackle-Brecciated & Altered, Magnetite-Rich Volcanic; d grn-blk, f.g., chloritic, strongly C-bxd & variably carb-alt'd mafic volcanics-probably tuffs; mainly alt'd to wh calcite; v loc abund epidote; bx mtx is wh calcite, plus some wh dol & wh qtz; extremely variable dissem py, ranging locally to 10-12%; loc v abund mag, dissem & conc in bx mtx, possibly 5% overall; loc foliation @ $45^{\circ}$ - $55^{\circ}$	-32 33 34 35 36 37 38 39 40 41 42 43	98.1 103.1 108.1 113.1 118.1 123.1 128.1 133.1 138.1 143.1 148.1 153.1	103.1 108.1 113.1 118.1 123.1 128.1 133.1 138.1 143.1 148.1 153.1 160.4					
	98.3-98.9	l gy to wh calcite, dol & qtz vein; cts $\approx 70^{\circ}$ ; occ dissem patches py; occ dissem patches mag & loc abund mag conc along f irreg fract's.								
	104.4	yellowish-grn bnd of carb & epidote?, 0.05' thick; cts $45^{\circ}$ ; 2-3% f dissem mag.								
	121.8-124.5	v irreg 0.05' vein of l gy calcite & qtz @ $5^{\circ}$ -rolling along core - $5^{\circ}$								
	144.5	sml gently folded fract; adjoining rock is alt'd.								
	150.0-160.4	becomes less bxd & mag content decreases								

# DIAMOND DRILL RECORD

 NAME OF PROPERTY Combined

 HOLE NO. C-17 SHEET NO. 3 of 4

FOOTAGE		DESCRIPTION	SAMPLE			ASSAYS			
FROM	TO		NO.	FOOTAGE		P.P.B. Au	%	OZ/TON	OZ/TON
				FROM	TO	TOTAL			
160.4	168.7	Feldspar Porphyry; 1-m gy felds phenocrysts in a m-d gy to grnish f.g. gm.; much chloritic material - probably due to contamination by country rocks; $\leq 1\%$ dissem py; U ct $\approx 60^\circ$ ; L ct $\approx 75^\circ$ 168.1 0.1' l gy - wh qtz vein @ $40^\circ$	8644 45	160.4	165.4		<5		
168.7	172.1	Crackle-Brecciated & Altered Magnetite-Rich Volcanic; similar to basal portion of unit @ 160.4; 1-2% mag.	46	165.4	168.7		<5		
172.1	178.5	Mafic Tuff; d grnish-gy to blk, f.g., sly chloritic; vague foliation @ $55^\circ$ ; rare-occ irreg frags filled w wh calcite; $\leq 1\%$ dissem py; loc 1-2% dissem mag. 175-179 core ground over; 0.5' L.C.							
178.5	242.3	Mafic Tuff, some Bleached & Altered Bands; m grnish-gy to grn, variably chloritic; occ sly more carb-alt'd & blch'd bnds to 0.3'; num irreg partings, frags & patches wh calcite gen // or sub // to foliation @ $55^\circ-65^\circ-70^\circ$ ; also abund f dissem wh calcite; loc vague bnds of C-bx w wh calcite mtx (some bx frags may be pyroclastic frags rather than C-bx frags?); 1-3% f dissem py + po; loc 1-2% dissem mag; v rare spks cp 208.2 0.025' mag-bearing blk parting @ $40^\circ$ 210.0 0.02' wh qtz vein @ $45^\circ$ (nearly $\perp$ foliation). 214.1 - 216.7 moderately to strongly carb-alt'd (calcite + dol) 216.2 irreg 0.05' wh qtz vein @ $\approx 50^\circ$							
242.3	255.0	Feldspar Porphyry; l gy felds. phenocrysts in m-d gy, sly chloritic, f.g. gm.; vague foliation @ $\approx 65^\circ$ (// foliation in adjoining tuff);							

# DIAMOND DRILL RECORD

NAME OF PROPERTY Combined

HOLE NO. C-17 SHEET NO. 4 of 4

FOOTAGE		DESCRIPTION	SAMPLE			ASSAYS			
FROM	TO		NO.	FOOTAGE		P.P.M. Au	%	OZ/TON	OZ/TON
				FROM	TO				
242.3	255.0	Con. U ct $\approx 60^\circ$ ; L ct $\approx 70^\circ$ ; $\approx 1\%$ dissempy 248.2 - 248.7 minor C-bx w wh qtz & wh calcite mtx. 252.0 - 252.1 & 253.9 - 254.7 inclusions d gy altd tuff.							
255.0	256.1	<u>Pyroclastic Breccia</u> ; vague angular to sub-rndd, elongate bx frags of m-d gy & gy-grn to blk, sly carb (calcite) altd f.g. material in a m grn mtx of chl & calcite; occ - num vf, irreg fractrs filled w wh calcite; 1-2% dissemp py; 1-2% dissemp mag.							
256.1	257.0	<u>Feldspar Porphyry</u> ; as @ 255.0; cts $\approx 70^\circ - 75^\circ$ .							
257.0	266.5	<u>Pyroclastic Breccia</u> ; as @ 256.1; foliation $60^\circ - 70^\circ$ .							
266.5	269.5	<u>Feldspar Porphyry</u> ; as @ 255.0							
269.5	271.4	<u>Qtz Breccia Vein</u> ; bx frags of altd felds porph & d chloritic material in mtx of l gy to wh qtz; v loc some blk tourmaline.	8647	269.5	271.4	<5			
271.4	295.5	<u>Feldspar Porphyry</u> ; as @ 255.0; occ f, irreg fractrs filled w wh calcite 285.3 0.03' irreg lgy to wh qtz bx vein @ $65^\circ$							
295.5	309.0	<u>Pyroclastic Breccia</u> ; similar to 256.1 but coarser & clasts are better defined; angular to sub-rndd to rndd elongate clasts to 0.3' wide & probably to 0.5' long (or longer); mainly finely C-bxd w wh calcite mtx; 2-3% dissemp mag & 1-2% dissemp py + po, mainly conc in bx mtx.							
309.0		Foot of Hole							

# DIAMOND DRILL RECORD

NAME OF PROPERTY Combined  
 HOLE NO. C-18 LENGTH 120.0 ft.  
 LOCATION Phillips Twp., Ontario.  
 LATITUDE 3+055 DEPARTURE 7+30 W  
 ELEVATION \_\_\_\_\_ AZIMUTH \_\_\_\_\_ DIP Vertical  
 STARTED Oct. 27, 1986 FINISHED Oct. 29, 1986

FOOTAGE	DIP	AZIMUTH	FOOTAGE	DIP	AZIMUTH

HOLE NO. C-18 SHEET NO. 1 of 2  
 REMARKS Drilled by  
Northwest Geophysics  
BQ core  
 LOGGED BY Jeff Sample

FOOTAGE		DESCRIPTION	SAMPLE				ASSAYS				
FROM	TO		NO.	<del>#</del> SULPH DEC	FOOTAGE FROM	TO	TOTAL	P.P.B. Au	%	OZ/TON	OZ/TON
0.0	0.0	Collar									
0.0	51.5	Casing									
51.5	62.8	Massive Mafic Tuff? d grn, f.g., chloritic massive mafic tuff? or possibly altd And?? occ - num f, irreg fractrs filled w wh calcite & loc minor py; ≈ 1% dissem py; 1-2% dissem mag.									
62.8	66.5	grades to Mafic Tuff; d grn, f.g., chloritic; vague f foliation @ ≈ 50°; num v sml wh calcite spots or "eyes" gen elongate // foliation; 1-2% dissem py+po; 1-2% dissem mag; num vf-f irreg fractrs filled w wh calcite.									
66.5	77.0	Bleached & Altered Tuff; as @ 66.5 but variably carb-altd & blchd; loc v num irreg fractrs filled w wh calcite. 66.9-67.3 wh qtz vein; cts ≈ 55°, sly oblique to foliation	8648 49		66.5	71.5			33		
77.0	85.5	Qtz Breccia Vein; frags & bnds strongly blchd & carb-altd tuff? in mtx of v abund wh qtz; U ct ≈ 30° in plane nearly 90° oblique to foliation; Lct ≈ 45°; up to 10-12% py (+ minor po) in altd bx frags & bnds; loc num sml patches & smears py & rare patches cp along f fractrs in qtz mtx. 77.0-78.3 mainly qtz (& most abund cp) 78.3-79.1 bnd of altd tuff? 79.1-82.7 mainly qtz 82.7-84.6 mainly altd tuff?	50 51 52		77.0	79.1			150		
					79.1	82.7			27		
					82.7	85.5			393		

*Jeff Sample*



# DIAMOND DRILL RECORD

NAME OF PROPERTY Combined

HOLE NO. C-18 SHEET NO. 2 of 2

FOOTAGE		DESCRIPTION	SAMPLE			ASSAYS			
FROM	TO		NO.	FOOTAGE FROM TO TOTAL	P.p.b. Au	%	OZ/TON	OZ/TON	
77.0	85.5	Con.							
85.5	90.5	84.6 - 85.5 mainly qtz <u>Weakly Altered Andesite</u> ; d grn, massive, chloritic; strongly blchd & altd for $\approx 1.0'$ @ U ct, then locally v sly blchd & altd; occ - num vf, irreg fractrs filled w wh calcite; 1-2% dissem py; 1-2% dissem mag. 86.1 0.03' wh qtz vein @ 50'	8653	85.5 90.5	37				
90.5	120.0	<u>Andesite</u> ; massive, d grn, chloritic; loc occ f fractrs filled w wh calcite; $\approx 1\%$ dissem py (+po); $\approx 1\%$ dissem mag.							
	120.0	Foot of Hole							

# DIAMOND DRILL RECORD

NAME OF PROPERTY Combined  
 HOLE NO. C-19 LENGTH 140.0 ft.  
 LOCATION Phillips Twp., Ontario.  
 LATITUDE 2+455 DEPARTURE 8+90 W  
 ELEVATION \_\_\_\_\_ AZIMUTH \_\_\_\_\_ DIP Vertical  
 STARTED Oct. 30, 1986 FINISHED Nov. 2, 1986

FOOTAGE	DIP	AZIMUTH	FOOTAGE	DIP	AZIMUTH

HOLE NO. C-19 SHEET NO. 1 of 2  
 REMARKS Drilled By  
Northwest Geophysics  
BQ core  
 LOGGED BY Jeff Sample

FOOTAGE		DESCRIPTION	SAMPLE			ASSAYS				
FROM	TO		NO.	FOOTAGE FROM	FOOTAGE TO	FOOTAGE TOTAL	P.p.b. Au	%	OZ/TON	OZ/TON
0.0	0.0	Collar								
0.0	18.5	Casing								
18.5	42.0	<u>Feldspar Porphyry</u> ; wh to 1-m gy felds phenocrysts in mgy f.g. gm.; abund chl. in gm.; some minor carb (calcite) altn; rare dissem. py; loc num f-vf fract's filled w wh calcite; most fract's @ 1°-2°-along core (// basal ct); core v blocky - drilled along basal ct from 39.5-46.8. 33.9-34.1 d gy-grn fg mafic dike? or inclusion?								
42.0	90.6	<u>Andesite</u> ; d grn, massive, f.g., chloritic; v blocky; occ vf fract's, mainly @ low $\angle$ s to along core, filled w wh calcite & minor py; locally abund vague C-bx w calcite mtx; 1% dissem py. ≈ 70 - 71.7' 0.05' wide C-bx cuts core @ low $\angle$ ; chloritic rock frags w cg py in wh calcite mtx. 80.3 - 80.5 wh qtz vein @ 65° 85.5 - 90.6 py content increases to 4-5%	8654	85.5	90.6		23			
90.6	100.8	<u>Feldspar Porphyry</u> ; wh to 1-m gy felds phenocrysts in mgy, f.g. gm.; ≈ 1% dissem py; occ f fract's filled w wh calcite; basal part of unit is weakly blehd, carb-altd & silicified	55 56	90.6 95.6	95.6 100.8		41 35			
100.8	106.9	<u>Altered Feldspar Porphyry</u> cut by Qtz Veins; as @ 100.8 but var. blehd, silicified & carb-altd.; occ wh qtz veins & bx veins; loc some	57 58	100.8 103.8	103.8 106.9		<5 <5			

LANGRIDGES - TORONTO - 366-1168

*Jeff Sample*

# DIAMOND DRILL RECORD

 NAME OF PROPERTY Combined

 HOLE NO. C-19 SHEET NO. 2 of 2

FOOTAGE		DESCRIPTION	SAMPLE			ASSAYS			
FROM	TO		NO.	FOOTAGE FROM TO	TOTAL	P.P.B. Au	%	OZ/TON	OZ/TON
100.8	106.9	Con. limonite stain. 100.8-101.5 irreg qtz bx vein 102.3 0.15' wh qtz vein @ 60° 105.2-105.8 bx w wh qtz & carb mtx 106.4-106.6 irreg wh qtz bx vein						Au	
106.9	112.1	<u>Qtz Breccia Vein</u> ; irreg frags blchd, carb -altd & silicified And. in mtx of lgy to wh qtz & lesser wh dol; loc foliated @ ≈ 60°; loc some apple grn coloration due to fuchsite; loc to 10% dissem py in bx frags; rare patches cp; loc some limonite stain; v loc some blk tourmaline	8659	106.9 112.1		<5			
112.1	122.7	<u>Moderately Altered Rock</u> ; var. blchd & carb- altd, dgrn, chloritic rock; num f, v irreg fracts filled w wh dol; gen 1-2% dissem py (+po) but v loc to 10%.	60 61	112.1 117.1 117.1 122.7		17 57			
122.7	127.4	<u>Qtz - Carb Breccia Vein</u> ; frags of altd, chloritic mafic volcanic rock in mtx of l gy to wh qtz & beige to gy dol; 2-3% & loc to 10% py (+po) in bx frags; v loc rare patches cp.	62	122.7 127.4		818		.024	
127.4	128.0	<u>Moderately Altered Rock</u> ; similar to 122.7; rare py	63	127.4 128.0		<5			
128.0	140.0	<u>Mafic Volcanic Rock - Probably Tuff</u> ; massive d grn, chloritic volcanic rock; weakly to moderately carb (calcite) altd; occ - num f frags filled w wh calcite, many frags // v vague foliation @ ≈ 50°; 1-3% dissem py (+po); loc 2-3% dissem mag.							
140.0		Foot of Hole							

# DIAMOND DRILL RECORD

NAME OF PROPERTY Combined  
 HOLE NO. C-20 LENGTH 120.0 Ft.  
 LOCATION Phillips Twp., Ontario.  
 LATITUDE 4+60 S DEPARTURE 8+75 W  
 ELEVATION \_\_\_\_\_ AZIMUTH \_\_\_\_\_ DIP Vertical  
 STARTED Nov. 3, 1986 FINISHED Nov. 4, 1986

FOOTAGE	DIP	AZIMUTH	FOOTAGE	DIP	AZIMUTH

HOLE NO. C-20 SHEET NO. 1 of 2  
 REMARKS Drilled by   
Northwest Geophysics  
BQ core  
 LOGGED BY Jeff Sample

FOOTAGE		DESCRIPTION	SAMPLE			ASSAYS			
FROM	TO		NO.	FOOTAGE		P.p.b. Au	%	OZ/TON	OZ/TON
				FROM	TO	TOTAL			
0.0	0.0	Collar							
0.0	25.5	Casing							
25.5	36.0	<u>Mafic Tuff?</u> d grn, massive, f.g., chloritic; v loc num wh calcite spots elongate // v v vague foliation @ 30°; num v irreg f frags & loc c-bx w mtx of wh calcite, py & loc some mag.; many frags in L pt. // vv vague foliation @ 30°; 3-5% py (+po), dissem & conc along frags; 1-2% mag, dissem & conc along frags; basal 1.0' blchd, carb-alt'd & silicified w prom. foliation @ 30°-40°	8664	31.0	36.0			<5	
36.0	42.5	<u>Feldspar Porphyry</u> ; vague wh-l gy felds phenocrysts in m gy f.g. gm.; sly silicified; shrd or finely foliated @ ≈ 45°; U ct @ 45° // foliation; L ct irreg @ ≈ 45° but oblique to foliation; occ wh qtz veins to 0.1'; gen rare spks but v loc to 3-5% py; 39.0 0.025' wh qtz vein w lge patch blk tourmaline?	65	36.0	42.5			<5	
42.5	48.0	<u>Altered Mafic Volcanic</u> ; d grn, chloritic; var blchd & carb (calcite) alt'd; num frags & loc vf c-bx frags filled w wh calcite & /or loc w wh qtz; ≈ 1% dissem py.	66	42.5	48.0			<5	
48.0	52.8	<u>Qtz Breccia Vein</u> ; v pyritic, carb-alt'd vol. rock bx frags in mtx of wh qtz & minor wh dol.; loc 15-25% dissem py & loc occ sml patches cp in bx frags; bx frags foliated @ 50°-55°; U ct irreg @ ≈ 45°-50°; L ct @ ≈ 55°	67	48.0	52.8			263	

*Jeff Sample*



# DIAMOND DRILL RECORD

NAME OF PROPERTY Combined  
 HOLE NO. C-21 LENGTH 320.0 ft.  
 LOCATION Phillips Twp., Ontario  
 LATITUDE 2+16 S DEPARTURE 3+02 W  
 ELEVATION \_\_\_\_\_ AZIMUTH 155° DIP -45°  
 STARTED Nov 5, 1986 FINISHED Nov. 9, 1986

FOOTAGE	DIP	AZIMUTH	FOOTAGE	DIP	AZIMUTH

HOLE NO. C-21 SHEET NO. 1 of 4  
 REMARKS Drilled by   
Northwest Geophysics  
BQ core  
 LOGGED BY Jeff Sample

FOOTAGE		DESCRIPTION	SAMPLE			ASSAYS				
FROM	TO		NO.	FOOTAGE FROM	FOOTAGE TO	FOOTAGE TOTAL	P.P.B. Au	%	OZ/TON	OZ/TON
0.0	0.0	Collar								
0.0	7.8	Casing								
7.8	50.2	<u>Andesite</u> ; m-d grn, massive, variably chloritic; loc occ f frags filled w wh calcite; some vague inclusions mafic tuff in lower part of unit; ≈ 1-2% dissem py + po; 1-2% dissem mag; 41.5-42.7, 43.9-44.3, 46.5-47.2 v poorly defined inclusions of mafic tuff.								
50.2	66.0	<u>Mafic Tuff</u> ; m-d grn, chloritic; occ - num v sml calcite spots or "eyes"; v vague f foliation @ 45°-50°; occ - num f frags filled w wh calcite; 1-2% dissem py + po; loc 1-3% dissem mag.	8675	61.0	66.0		10			
66.0	71.7	<u>Strongly Altered Tuff</u> ; variably blechd & strongly carb-alt'd mafic tuff; foliation 45°-50°; occ - num sml spots or "eyes" wh calcite (+dol?) often elongate // foliation; num f, irreg frags filled w wh calcite (+dol); num patches cp & occ v sml patches d brn sphal near U ct; U ct. @ 35° nearly ⊥ foliation; minor grn coloration due to fuchsite @ U ct.	76	66.0	71.7		277			
71.7	73.0	67.6 occ sml patches brn dol. in discontinuous wh qtz-carb vein; 1-3% dissem py. <u>Qtz - Carb Breccia Vein</u> ; bx frags of strongly carb (dol) alt'd rock in mtx of wh qtz & minor wh - beige dol; loc v num lge patches d brn sphal.; occ patches cp; loc apple grn coloration due to fuchsite.	77	71.7	73.0		7728	.23		

*Jeff Sample*

# DIAMOND DRILL RECORD

 NAME OF PROPERTY Combined

 HOLE NO. C-21 SHEET NO. 2 of 4

FOOTAGE		DESCRIPTION	SAMPLE			ASSAYS			
FROM	TO		NO.	FOOTAGE		P.p.b. Au	%	OZ/TON	OZ/TON
				FROM	TO				
73.0	90.0	<p><u>Strongly Altered Tuff</u>; as @ 71.7; loc minor wh qtz veining (3-5% vein qtz overall); loc occ sml patches cp &amp; d brn sphal.</p> <p>79.3 one sml patch <u>Visible Gold</u> in late 0.01' thick lgy qtz str which cuts earlier qtz-carb parting.</p> <p>81.6 core doesn't match - pc. of wh qtz vein lost or stolen??</p> <p>81.6-82.1 wh qtz vein; occ sml patches d brn sphal &amp; cp.</p>	8678	73.0	79.0	991		Au	
			—	79.0	79.7	V.G.	-	core removed	
			79	79.7	84.7	95			
			80	84.7	90.0	215			
90.0	91.6	<p><u>Qtz Breccia Vein with Visible Gold</u>; qtz bx vein w v loc num sml patches V.G.; loc v abund blk tourmaline.</p>	—	90.0	91.6	V.G.	-	core removed	
91.6	101.8	<p><u>Strongly Altered Tuff</u>; as @ 90.0; 5-6% vein qtz overall.</p> <p>98.6 0.05' thick qtz-carb vein @ 45°, nearly ⊥ foliation; loc lge patches cp.</p> <p>99.6 - 99.8 wh qtz vein @ 50°; occ patches cp, sphal, minor py.</p> <p>100.0 0.05' wh qtz vein; occ patches cp, sphal, minor py.</p> <p>100.3 0.05' wh qtz vein; minor cp &amp; py</p>	81	91.6	96.6	13			
			82	96.6	101.8	75			
101.8	110.4	<p><u>Qtz Breccia Vein</u>; v irreg bx vein w carb-alt'd rock frags in mt'x of wh qtz &amp; minor wh dol; appears to be primarily a crackle bx; num patches py; occ &amp; loc num patches cp; U ct v irreg; L ct @ ≈ 45° nearly // foliation of underlying unit.</p> <p>108.4 - 109.4 num lge patches cp.</p>	83	101.8	106.8	355			
			84	106.8	110.4	1988	.059		
110.4	118.1	<p><u>Strongly Altered Tuff</u>; as @ 71.7; foliation 45°; occ patches py &amp; cp; 3-5% vein qtz overall.</p> <p>117.5-117.9 bnd w prom. apple grn coloration due to fuchsite, apparently controlled by thin qtz-filled fract's trending ≈ 60°.</p>	85	110.4	115.4	126			
			86	115.4	118.1	160			

# DIAMOND DRILL RECORD

NAME OF PROPERTY Combined

HOLE NO. C-21 SHEET NO. 3 of 4

FOOTAGE		DESCRIPTION	SAMPLE			ASSAYS			
FROM	TO		NO.	FOOTAGE FROM TO	TOTAL	p.p.b. Au	%	OZ/TON	OZ/TON
118.1	130.0	<u>Weakly Altered Tuff</u> ; similar to 66.0 but variably blechd & weakly carb-alt'd; occ f, irreg fract's filled w wh calcite; loc occ bx veins to 0.3' w wh calcite mt'x & v loc minor blk tourmaline? vague foliation $\approx 45^\circ-50^\circ$ ; 1-2% py, dissem & conc along f fract's. $\approx 123.9-130.0$ sat'd w, & sly alt'd by basalt; basal ct is poorly defined.	8687 88	118.1 123.9	123.9 130.0	102 37			
130.0	197.0	<u>Pillow Basalt</u> ; m-d grn, variably chloritic; irreg d grn pillow selvages; num f, irreg fract's filled w wh calcite; loc num sm'l, elongate wh calcite spots or "eyes"; loc minor C-bx w mt'x of wh calcite, occ patches py & loc abund mag; 1-3% q v loc to 8-10% dissem py; loc 1-2% dissem mag; basal ct v poorly defined.							
197.0	212.1	<u>Massive Basalt, Flow? or Intrusive?</u> d grn, chloritic basalt; rare - loc num saussuritized felds xls &/or patches to 0.02'; vv vague foliation @ $60^\circ-70^\circ$ ; loc vv vague inter-growth of mafic xl blades, somewhat similar to spinifex texture; weakly carb (calcite) alt'd; 2-3% & loc to 4-6% f dissem py (tpo); loc rare spks cp; occ vf, irreg fract's filled w wh calcite.							
212.1	213.1	<u>Pillow Basalt</u> ; as @ 197.0; C-bxd w abund wh calcite mt'x.							
213.1	218.1	<u>Altered Ultramafic? Intrusive</u> ; d gy to blk, moderately carb-alt'd UM rock; 3-5% dissem py; rare vf, irreg fract's filled w wh calcite; U ct $45^\circ$ ; L ct $\approx 25^\circ-30^\circ$							
218.1	229.5	<u>Massive Basalt, Flow? or Intrusive?</u> as @ 212.1; rare saussuritized felds phenocrysts.							
229.5	240.0	<u>Pillow Basalt</u> ; as @ 197.0							





# DIAMOND DRILL RECORD

NAME OF PROPERTY Combined  
 HOLE NO. C-22 LENGTH 135.0 ft.  
 LOCATION Phillips Twp., Ontario  
 LATITUDE 0 + 90 S DEPARTURE 0 + 60 W  
 ELEVATION \_\_\_\_\_ AZIMUTH \_\_\_\_\_ DIP Vertical  
 STARTED Nov. 10, 1986 FINISHED Nov. 12, 1986

FOOTAGE	DIP	AZIMUTH	FOOTAGE	DIP	AZIMUTH

HOLE NO. C-22 SHEET NO. 1 of 2  
 REMARKS Drilled by   
Northwest Geophysics  
BQ core

LOGGED BY Jeff Sample

FOOTAGE		DESCRIPTION	SAMPLE			ASSAYS			
FROM	TO		NO.	FOOTAGE FROM TO TOTAL	P.p.b. Au	%	OZ/TON	OZ/TON	
	0.0	Collar							
0.0	6.0	Casing							
6.0	82.5	<u>Mafic Tuff</u> ; d grn, chloritic; vv num sml wh calcite spots or "eyes" elongate // foliation along core to 10°; occ fract's, gen // foliation w mtk of wh calcite & variable po, mag & py & rare spks cp; variable dissem po & py (total po+py ≈ 3-5% overall). ≈ 10.7-13.0 irreg blchd & partially silicified bnd // foliation, w 6-8% dissem mag & num irreg patches & str's potpy; minor d brn limonite? or sphal.?? 41.0-41.2 irreg wh calcite & qtz vein @ ≈ 60° 56.0-64.0 occ v irreg qtz-carb veins & qtz-carb bx veins to 0.1'	8689	10.7 13.0	34				
82.5	88.4	<u>Weakly Altered Tuff</u> ; as @ 82.5 but sly blchd & weakly carb-alt'd.	90	82.5 88.4	13				
88.4	88.9	<u>Qtz-Carb. Breccia Vein</u> ; vague carb-alt'd rock frags in mtk of wh qtz & wh dol; occ spks & patches py; loc occ sml patches d brn sphal; loc some blk tourmaline; U ct ≈ 60°; L ct 85°-90°	91	88.4 89.2	6				
88.9	89.2	<u>Strongly Altered Tuff</u> ; apple grn (fuchsitic), strongly carb (dol) alt'd tuff; cts ≈ 85°							
89.2	93.4	<u>Weakly Altered Tuff</u> ; weakly blchd & carb-alt'd; occ irreg fract's filled w wh calcite, occ patches po & py & rare sml patches cp; minor dissem po + py.	92	89.2 93.4	10				

*Jeff Sample*



# DIAMOND DRILL RECORD

NAME OF PROPERTY Combined  
 HOLE NO. C-23 LENGTH 309.0 ft.  
 LOCATION Phillips Twp., Ontario.  
 LATITUDE 12+00N DEPARTURE 17+60E  
 ELEVATION \_\_\_\_\_ AZIMUTH 155° DIP -45°  
 STARTED Nov. 13, 1986 FINISHED Nov. 16, 1986

FOOTAGE	DIP	AZIMUTH	FOOTAGE	DIP	AZIMUTH

HOLE NO. C-23 SHEET NO. 1 of 4  
 REMARKS Drilled by   
Northwest Geophysics  
BQ core  
 LOGGED BY Jeff Sample

FOOTAGE		DESCRIPTION	SAMPLE			ASSAYS					
FROM	TO		NO.	% SULPHIDES	FOOTAGE		%	%	OZ/TON	OZ/TON	
					FROM	TO	TOTAL				
	0.0	Collar									
0.0	60.9	Casing (one 6' bldr in overburden)									
60.9	85.4	Mafic Tuff; d grn, chloritic; occ saussuritized felds xls to 0.02'; vague foliation @ 40°-45°-50°; occ irreg fract's filled w wh calcite, minor py & minor hem stain; v loc minor epidote altn; loc num sml wh calcite spots or 'eyes'. 67.6 - 68.7 d grn, chloritic mafic dike; U ct 30°; L ct 15°-20° in opp dir. 70.6 - 71.6 d grn, chloritic mafic dike similar to 67.6-68.7; occ f, calcite-filled fract's // 30° cts. ≈ 74.0 - 78.8 var. c-bxd w mtx of wh calcite, loc l gy qtz & var amt epidote 79.2 - 80.0 mafic dike as @ 67.6-68.7; U ct 65°-70°; L ct irreg @ 65°-70°. basal ct of unit v poorly defined.									
85.4	95.6	Basalt; massive, d grn, chloritic; occ f, irreg fract's & loc minor c-bx w mtx of wh calcite; ≤ 1% dissem. py 87.0 - 88.0 tuff as @ 85.4? along edge of core; v blocky & core mixed up. 93.3 - 94.1 tuff as @ 85.4? irreg cts.									
95.6	104.5	Mafic Tuff; as @ 85.4 but sly altd by intruded felds porph or basalt.									
104.5	147.7	Feldspar Porphyry; wh - l gy felds phenocrysts plus loc num d grn - blk hblde & /or pyroxene phenocrysts in a l-m grnish-gy f.g. gm.; occ									

*Jeff Sample*





# DIAMOND DRILL RECORD

NAME OF PROPERTY Combined

HOLE NO. C-23 SHEET NO. 4 of 4

FOOTAGE		DESCRIPTION	SAMPLE			ASSAYS						
FROM	TO		NO.	% SULPHIDES	FOOTAGE			%	%	OZ/TON	OZ/TON	
					FROM	TO	TOTAL					
242.6	309.0	Con. 263.2 - $\approx$ 265.5 sly shrd @ 35°-40° & altd to d grn-blk carb-chl rock. 276.0 0.05' wh qtz vein (core may be out of place - ends dont match). 279.0 .015' bx vein w wh calcite & qtz mtx; cts $\approx$ 30° $\approx$ 289 $\rightarrow$ becomes increasingly chloritic & carb-alt'd.										
	309.0	Foot of Hole										

ONTARIO GEOLOGICAL SURVEY  
 ASSESSMENT FILES  
 RESEARCH OFFICE  
  
 FEB 19 1987  
  
 RECEIVED

Abbreviations & Symbols  
For Geological Maps, Geological Reports  
& Diamond Drill Logs

A

abundant	abund
actinolite	act
adjacent	adj
albite	ab
alteration	altn
altered	altd
amorphous	amor
amount	amt
amphibole	amph
amphibolite	Amph
amygdaloidal	amyg
angle	∠
angular	ang
andesite	And
anhedral	anhed
anhydrite	anhyd
anorthite	an
anorthosite	Anorth
approximate	approx
arenaceous	aren
argillaceous	arg
argillite	Arg
arkose	Ark
arkosic	ark
arsenopyrite	arseno
average	ave

B

band	bnd
banded	bndd
banding	bndg
bed	bd
bedded	bdd
bedding	bdg
bentonite	bent
bioclastic	bio
biotite	Bio
bituminous	bit
black	blk
bleached	blchd
bornite	bor
boulder	bldr
brachiopod	brach
breccia	Bx
brecciated	bxd
brecciation	bxn
brown	brn

C

calcareous	calc
carbonate	carb
carbonaceous	carbonac



C

cassiterite	cas
cemented	cmt
centimeter	cm
chalcedony	Chal
chalcocite	cc
chalcopyrite	cp
chlorite or chloritic	chl
coarse	c
coarse grained	cg
composition	comp
cobble	cob
concentrate (d)	conc
conglomerate	Congl
contact	ct
contorted	contort
co-ordinate	co-ord
covellite	cov
crackle bx (in situ breccia, no rotation of frag- ments)	c-bx
cross-bedded	Xbdd
cross-bedding	Xbdg
cross-laminated	Xlam
cross-section	X-sec
crystal	Xl
crystalline	Xlln

D

dacite	Dac
dark	d
diabase	Diab
diameter	diam
different	diff
diopside	diop
diorite	Dior
direction	dir
disseminated	dissem
dolomite (mineral)	dol
dolomite (rock)	Dol
dunite	Dun

E

east	E
elevation	elev
equivalent	equiv
especially	esp
euهدral	euهد
exposure	exp

F

feldspar	felds
feldspathic	feld
fine	f
fine-grained	fg
foliated	fol
foot or feet	ft. (or ')
foraminifera	foram
formation	fm
fracture (d)	fract (d)
fragment (al)	frag

G

gabbro (ic)	Gab
galena	gn
garnet	gar
generally	gen
glauconite	glauc
gneiss	Gn
gram	gm
granite	Gr
granodiorite	Grd
granular	gran
graphite	graph
graptolite	grap
green	grn

G

greenstone	Grnst
grey	gy
greywacke	Gwke
groundmass	gm
gypsum	gyp

H

hectare	ha
hematite	hem
horizontal	horiz
hornblende	hblde
hornfels	Hfls
hyaloclastite	hct

I

igneous	ign
inch or inches	in (or ")
inclusion or including	incl
interbedded	interbdd

I

intrusion, intrusive) intr  
iron-formation fe-fm  
irregular irreg

J

joint jnt

K

kilogram kg  
kilometer km  
komatiite or komatiitic kom

L

laminated lam  
lamprophyre Lamp  
large lge

L

latitude lat  
leached lchd  
light l  
limestone Ls  
limonite lim  
local or locally loc  
longitude long  
lost core L.C.  
lower L

M

magnetite mag  
malachite mal  
matrix mtx  
maximum max  
medium m  
metamorphic met  
meter m  
mile or miles mi  
millimeter mm  
mineralization minln  
minimum min  
moderate mod  
molybdenite mo  
monzonite Monz  
mottled or mottling mott  
mudstone Mdstn

M

muscovite            musc

N

nepheline            neph  
niccolite            nic  
nodular              nod  
north                N  
numerous             num

O

occasional            occ  
oolitic                ool  
opposite               opp  
orthoclase            orth  
ounce(s)              oz.  
outcrop                otcp  
overburden            O.B.  
oxide or  
oxidized              ox

P

parting(s)            ptg(s)  
pebble                pbl  
pegmatite             Peg  
pentlandite           pn  
peridotite            Perid  
phenocryst            phen  
phylite                Phyl  
piece                  pc  
pink                    pk  
plagioclase            plag  
point                  pt  
porphyry or  
porphyritic            porph  
possibly                poss  
probable                prob  
prominent              prom  
pyrite                 Py  
pyroxine                pyrox  
pyrrhotite             po

Q

quartz                 qtz  
quartzite              Qte

R

range                   rng  
recrystalline           rexlln  
recrystallized         rexllized  
regular                 reg  
rhyolite                Rhy  
rounded                 rndd

S

sand                    sd  
sandstone              Ss  
sandy                   sdy  
saturated               satd  
schist                  Sch  
section                 sec  
sediment (ary)         sed  
sericite,  
sericitic or  
sericitized             seric  
serpentine              serp  
serpentinized          serpd  
shale                   Sh  
sheared                 shrd  
short ton               st  
siderite                sid  
siliceous               silic

S

silt                    slt  
siltstone               Slstst  
silty                   slty  
slate                   Sl  
slightly                sly  
small                   sml  
soluble                 sol  
south                   S  
speck                   spk  
sphalerite              sphal  
station                 sta  
streak (s)              strk(s)  
stringer (s)            str(s)  
sulphide (s)            sulp(s)  
syenite                 Syen

T

tabular                 tab  
temperature             temp  
tenantite               ten  
tetrahedrite            tet  
tonne                   t  
tourmaline              tour

T

township      tp  
trace          tr  
trachyte      Trach  
tremolite     trem

W

weak              wk  
west              W  
white             wh  
with              w

U

ultramafic     UM  
unconformity   unconf  
upper          U

X

xenolith        xen

V

variable or     var  
variably  
variegated      vrgt  
vegetation      veg  
vertical        vert  
very            v  
visible gold    V.G.  
volcanic        vol

Y

yard or yards   yd

@	at
≈	approximately
∠ (s)	angle, angles
→	going, grading, extending or trending to or towards
//	parallel (to)
⊥	perpendicular (to)
>	greater than or equal to
<	less than or equal to

Jeff Sample



Ministry of  
Natural  
Resources

Report  
of Work

*Answers*  
**PHILLIPS TWI**

W97 01 00023

M

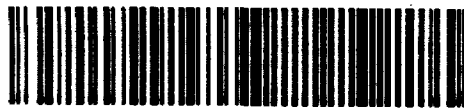

52E06SE0002 12 PHILLIPS

900

Name and Postal Address of Recorded Holder

Wasabi Resources Ltd.

T986

c/o Dominion Explorers Inc.

Ste. 916 111 Richmond Street West, Toronto, Ontario M5H 2G4

Summary of Work Performance and Distribution of Credits

Total Work Days Cr. claimed	Mining Claim			Work Days Cr.	Mining Claim			Work Days Cr.	Mining Claim			Work Days Cr.
	Prefix	Number	Work Days Cr.		Prefix	Number	Work Days Cr.		Prefix	Number	Work Days Cr.	
2,514	K	670131	80	K	670139	60	K	819339	120			
For Performance of the following work. (Check one only) <input type="checkbox"/> Manual Work <input type="checkbox"/> Shaft Sinking Drifting or other Lateral Work. <input type="checkbox"/> Compressed Air, other Power driven or mechanical equip. <input type="checkbox"/> Power Stripping <input checked="" type="checkbox"/> Diamond or other Core drilling <input type="checkbox"/> Land Survey		670132	67.5		810631	120		819340	120			
		670133	80		810632	120		819341	120			
		670134	80		819334	120		819342	120			
		670135	80		819335	120		819343	66.5			
		670136	80		819336	120		819344	60			
		670137	60		819337	120		819345	60			
		670138	60		819338	120		819346	60			

All the work was performed on Mining Claim(s): 670134, 670138, 751067, 819335

Required Information eg: type of equipment, Names, Addresses, etc. (See Table Below)

Drilling Contractor

Mr. Alfred Lambert  
Northwest Geophysics  
278 Sequoia Drive  
THUNDER BAY, Ontario

Core Size B.Q. - 1 7/16 inches  
in diameter

15 holes - total footage  
2,514 feet

Drilling performed, ~~October 1~~ - November 17, 1986

Drill - JKS 300

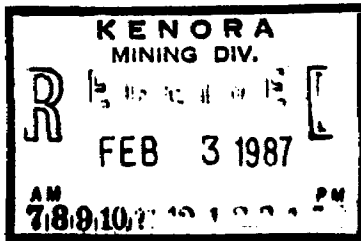
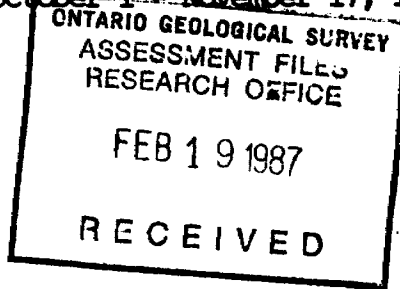

Date of Report  
Jan. 27/87

Recorded Holder or Agent (Signature)  
*W. G. Holman*

Certification Verifying Report of Work

I hereby certify that I have a personal and intimate knowledge of the facts set forth in the Report of Work annexed hereto, having performed the work or witnessed same during and/or after its completion and the annexed report is true.

Name and Postal Address of Person Certifying

U. Abolins 340 Burnett Avenue Willowdale, Ontario M2N 1W4

Date Certified

Jan. 27/87

Certified by (Signature)

*U. Abolins*

Table of Information/Attachments Required by the Mining Recorder

Type of Work	Specific information per type	Other information (Common to 2 or more types)	Attachments
Manual Work	Nil	670131 Names and addresses of men who performed manual work/operated equipment, together with dates and hours of employment.	Work Sketch: these are required to show the location and extent of work in relation to the nearest claim post.
Shaft Sinking, Drifting or other Lateral Work			
Compressed air, other power driven or mechanical equip.	Type of equipment	Names and addresses of owner or operator together with dates when drilling/stripping done.	
Power Stripping	Type of equipment and amount expended. Note: Proof of actual cost must be submitted within 30 days of recording.		
Diamond or other core drilling	Signed core log showing: footage, diameter of core, number and angles of holes.	Nil	Work Sketch (as above) in duplicate
Land Survey	Name and address of Ontario land surveyor.		Nil





Ministry of  
Natural  
Resources

Report  
of Work

Mining Act

Instructions - Supply required data on a separate form for each type of work to be recorded (see table below).  
- For Geo-technical work use form no. 1382 "Report of Work (Geological, Geophysical, Geochemical and Expenditures)".

# 23-87

Name and Postal Address of Recorded Holder <b>Wasabi Resources Ltd.</b> c/o Dominion Explorers Inc. Ste. 916 - 111 Richmond Street West, Toronto, Ontario M5H 2G4	Prospector's Licence No. T986
--	----------------------------------

Summary of Work Performance and Distribution of Credits

Total Work Days Cr. claimed 2,514	Mining Claim			Work Days Cr.	Mining Claim			Work Days Cr.
	Prefix	Number	Work Days Cr.		Prefix	Number	Work Days Cr.	
for Performance of the following work. (Check one only) <input type="checkbox"/> Manual Work <input type="checkbox"/> Shaft Sinking Drifting or other Lateral Work. <input type="checkbox"/> Compressed Air, other Power driven or mechanical equip. <input type="checkbox"/> Power Stripping <input checked="" type="checkbox"/> Diamond or other Core drilling <input type="checkbox"/> Land Survey	K	819347	60					
		819348	60					
		819349	60					
		819350	60					
		819351	60					

All the work was performed on Mining Claim(s): 670134, 670138, 751067, 819335

Required Information eg: type of equipment, Names, Addresses, etc. (See Table Below)

Drilling Contractor

Mr. Alfred Lambert  
Northwest Geophysics  
278 Sequoia Drive  
Thunder Bay, Ontario

Core Size B.Q. - 1 7/16 inches in diameter

15 holes - total footage 2,514 feet

Drilling performed, October 1 - November 17, 1986

Drill - JKS 300

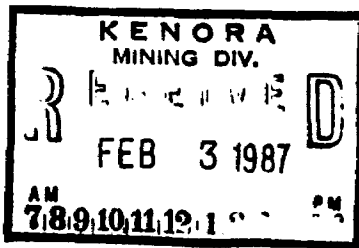

Date of Report January 27/87	Recorded Holder or Agent (Signature) <i>U. Abolins</i>
---------------------------------	---

Certification Verifying Report of Work

I hereby certify that I have a personal and intimate knowledge of the facts set forth in the Report of Work annexed hereto, having performed the work or witnessed same during and/or after its completion and the annexed report is true.

Name and Postal Address of Person Certifying U. Abolins 340 Burnett Avenue Willowdale, Ontario M2N 1W4	Date Certified Jan 27/87	Certified by (Signature) <i>U. Abolins</i>
---	-----------------------------	---

Table of Information/Attachments Required by the Mining Recorder

Type of Work	Specific information per type	Other information (Common to 2 or more types)	Attachments
Manual Work	Nil	Names and addresses of men who performed manual work/operated equipment, together with dates and hours of employment.	Work Sketch: these are required to show the location and extent of work in relation to the nearest claim post.
Shaft Sinking, Drifting or other Lateral Work			
Compressed air, other power driven or mechanical equip.	Type of equipment	Names and addresses of owner or operator together with dates when drilling/stripping done.	
Power Stripping	Type of equipment and amount expended. Note: Proof of actual cost must be submitted within 30 days of recording.		
Diamond or other core drilling	Signed core log showing: footage, diameter of core, number and angles of holes.	Nil	Work Sketch (as above) in duplicate
Land Survey	Name and address of Ontario land surveyor.		Nil

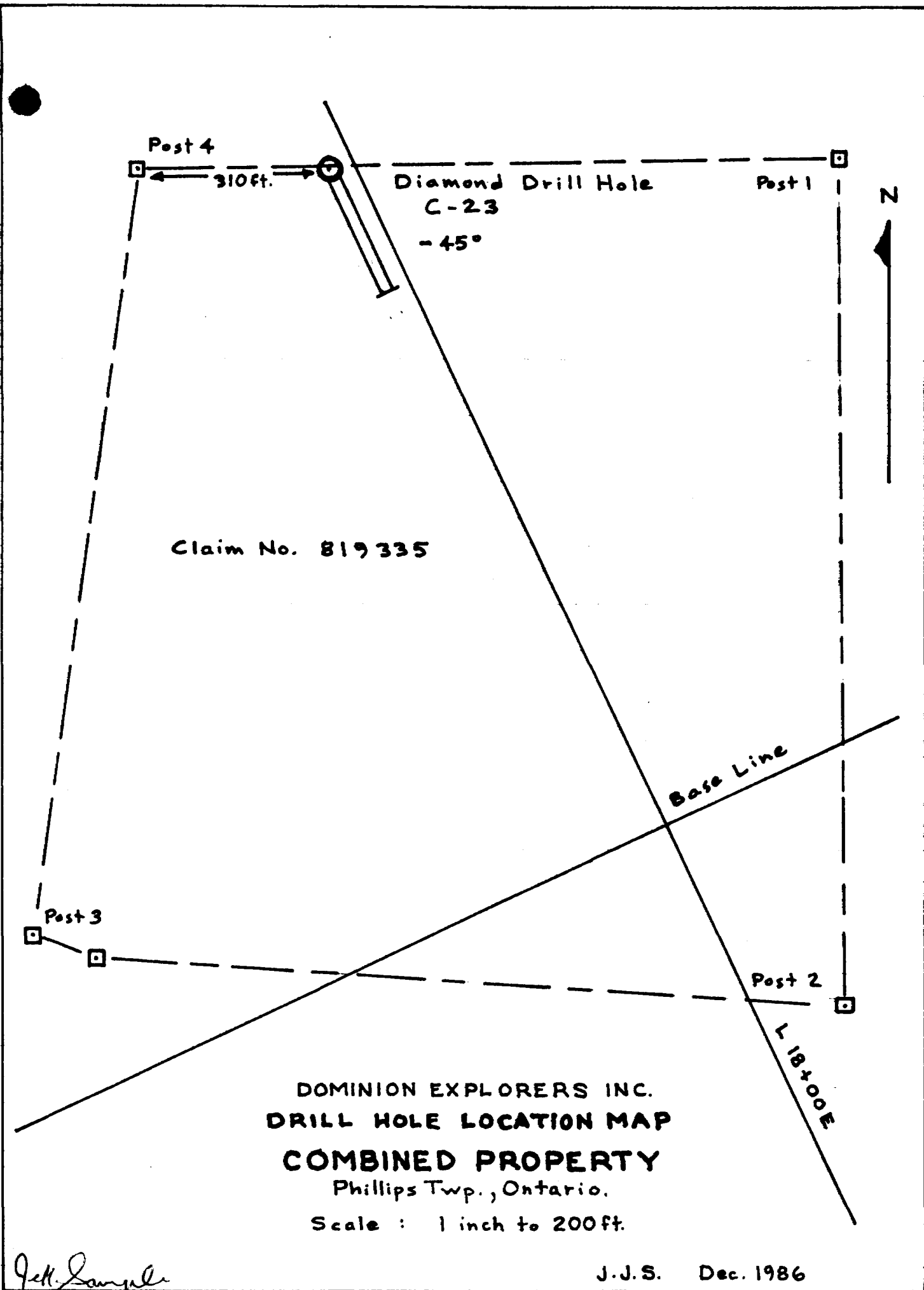

Claim No. 819335

Diamond Drill Hole  
C-23  
-45°

**DOMINION EXPLORERS INC.**  
**DRILL HOLE LOCATION MAP**  
**COMBINED PROPERTY**  
Phillips Twp., Ontario.

Scale : 1 inch to 200ft.

*Jett. Sample*

J.J.S. Dec. 1986



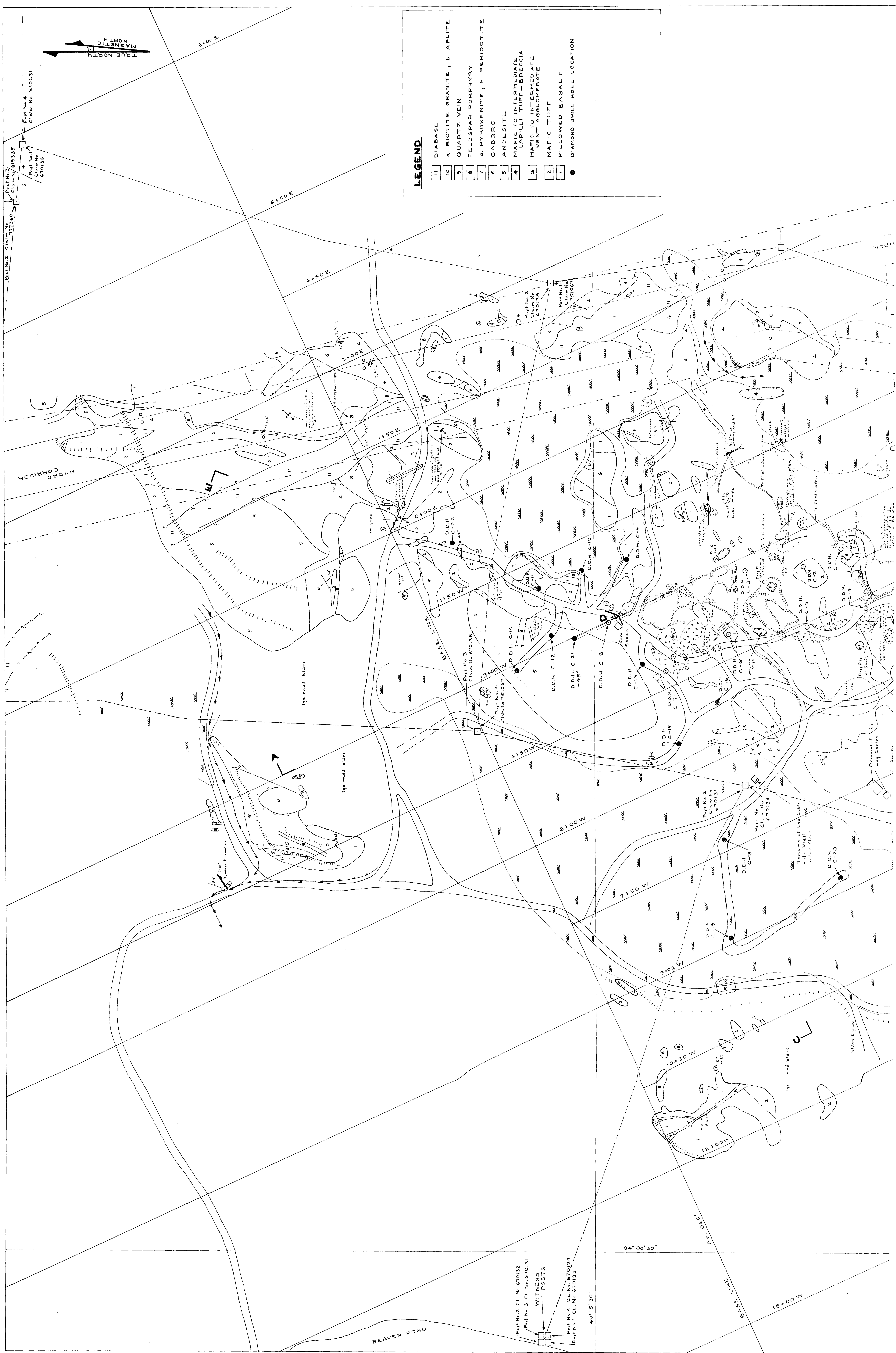

**LEGEND**

- 11 DIABASE
- 10 a. BIOTITE GRANITE, b. APLITE
- 9 QUARTZ VEIN
- 8 FELDSPAR PORPHYRY
- 7 a. PYROXENITE, b. PERIDOTTITE
- 6 GABBRO
- 5 ANDESITE
- 4 MAFIC TO INTERMEDIATE LAPILLI TUFF-BRECCIA
- 3 MAFIC TO INTERMEDIATE VENT AGGLOMERATE
- 2 MAFIC TUFF
- 1 PILLOWED BASALT
- DIAMOND DRILL HOLE LOCATION

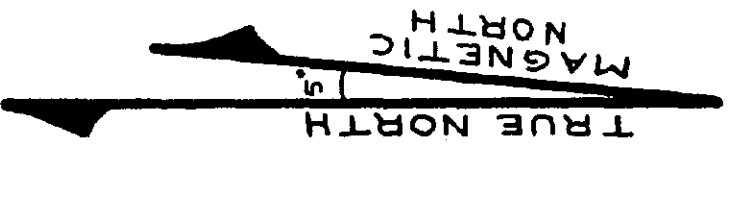

Part No. 2 Claim No. 777240  
 Claim No. 819335  
 Part No. 1 Claim No. 670138  
 Claim No. 810631

Part No. 2 CL. No. 670132  
 Part No. 3 CL. No. 670131  
 WITNESS POSTS  
 Part No. 4 CL. No. 670134  
 Part No. 1 CL. No. 670133

BEAVER POND

HYDRO CORRIDOR

4+50 E

1+50 E

1+50 W

4+50 W

6+00 W

7+50 W

9+00 W

10+50 W

12+00 W

94° 00' 30"

49° 15' 30"

BASE LINE

15' wind bluffs

15' wind bluffs

15' wind bluffs

15' wind bluffs

15' wind bluffs

15' wind bluffs

15' wind bluffs

15' wind bluffs

15' wind bluffs

15' wind bluffs

15' wind bluffs

15' wind bluffs

15' wind bluffs

**LEGEND**

- 11 DIABASE
- 10 a. BIOTITE GRANITE, b. APLITE
- 9 QUARTZ VEIN
- 8 FELDSPAR PORPHYRY
- 7 a. PYROXENITE, b. PERIDOTITE
- 6 GABBRO
- 5 ANDESITE
- 4 MAFIC TO INTERMEDIATE LAPILLI TUFF-BRECCIA
- 3 MAFIC TO INTERMEDIATE VENT AGGLOMERATE
- 2 MAFIC TUFF
- 1 PILLOWED BASALT
- DIAMOND DRILL HOLE LOCATION

DIAMOND DRILL HOLE LOCATIONS

**DOMINION EXPLORERS INC.**

**COMBINED PROPERTY**

PHILLIPS TOWNSHIP, ONTARIO,  
KENORA MINING DISTRICT

**GEOLOGICAL PLAN**

SCALE 0 50' 100' 200'

J. J. SAMPLE

DECEMBER 1986

J.H. Sample

