

DIAMOND DRILLING



52E08SE9233 10 PHILLIPS

010

TOWNSHIP: Phillips

REPORT No.: 10

WORK PERFORMED BY: Tom Pitkanen

<u>CLAIM No.</u>	<u>HOLE No.</u>	<u>FOOTAGE</u>	<u>DATE</u>	<u>NOTE</u>
K 751067	C-01	102'	Sept/84	(1)

NOTES: (1) #228-84

DIAMOND DRILL RECORD

NAME OF PROPERTY Combined - Phillips Twp.
 HOLE NO. C-01 LENGTH 102 feet
 LOCATION _____
 LATITUDE 0 + 10N DEPARTURE 0+00
 ELEVATION - AZIMUTH - DIP -90°
 STARTED Sept. 12, 1984 FINISHED September 13, 1984

FOOTAGE	DIP	AZIMUTH	FOOTAGE	DIP	AZIMUTH

HOLE NO. C-01 SHEET NO. 1 of 2

REMARKS _____

LOGGED BY *U. Abolins*

FOOTAGE		DESCRIPTION	SAMPLE			ASSAYS				
FROM	TO		NO.	% SULPHIDES	FOOTAGE		%	%	OZ/TON	OZ/TON
					FROM	TO				
0	3	Overburden - rubble								
3	3.8	Quartz Vein white, fractured, some sericite along fractaeres								
3.8	6.0	Altered Rock light grey buff colour, 5% CO ₃ , 35% quartz, sericite some fuchsite, tr. py.								
6.0	7.1	Quartz Vein white - mixed with fragments of schistose carbonitized rock, with sericite, siderite, fuchsite patches of sulphides - 3% py.cpy.								
7.1	9.1	Altered Rock and Quartz Veinlets about 50% qtx. as veinlets, rock as in fragments in vein patches of py,cpy, some scattered py xls. green carbonate rich, some tourmaline crystals (needles)								
9.1	102	Feldspar Porphyry 9.1 - 11.1 light grey - carbonitized hairline py along fractures, tr - 1% py xls 11.1 - 13.0 qtz veinlets 2 inches, py patches in veinlets 13.0 - 14.0 qtz veinlets 14 to end grey green, homogeneous, upper portion is carbonitized and soft, then becomes siliceous (rhyodacitic) and porphyritic from 35 ft to end feldspar phenocrysts, present, a dirty white with green subhedral to anhedral, partly digested, some very indistinct, 5%, 3/10 in. 8% micaceous (sericite) clots, eyes, or lenses subparallel to core axis tr: opalescent grey-blue quartz eyes								

EM. 6-1168

LANGRIDGE LIMITED,

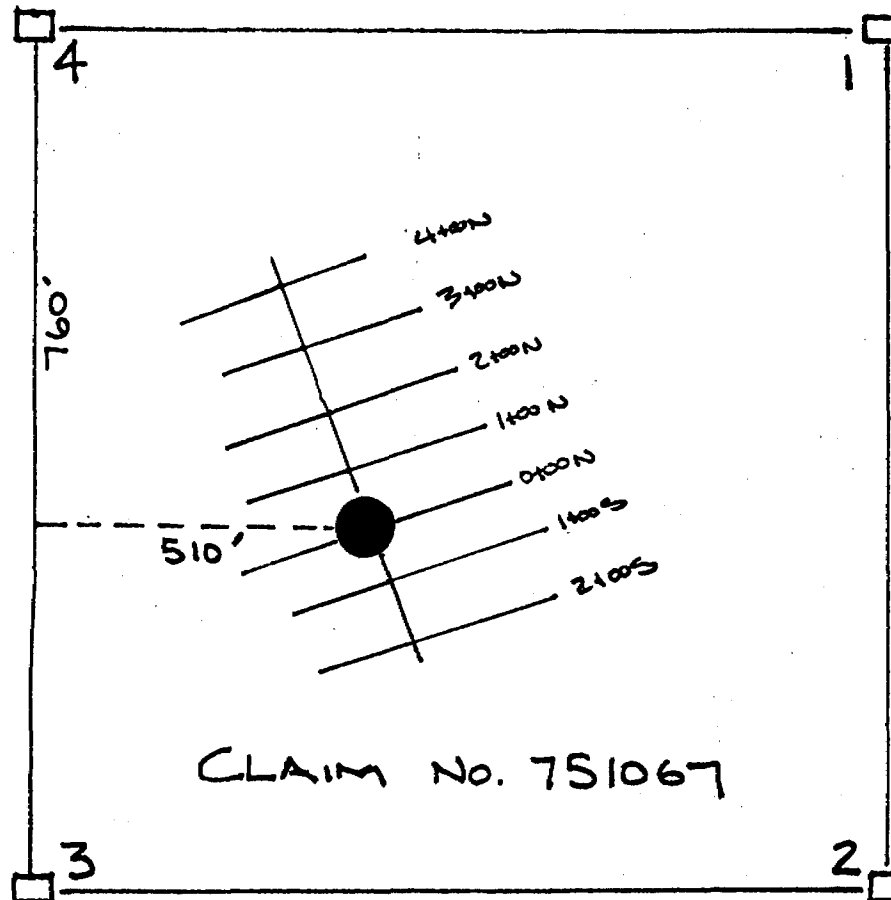

DIAMOND DRILLING
 HOLE G01, -90° (vertical)
 PHILLIPS TOWNSHIP M-2102
 KENORA MINING DIVISION

Walter Holms



Ministry of Natural Resources Ontario

Asses

PHILLIPS TWP M-2102

228-84

A separate form is

THE MINING



52E08SE9233 10 PHILLIPS

900

To the Recorder of KENORA

TOM PITKANEN

R. R. #2 FORT FRANCES, ONTARIO P9A 3M3

prospector's Licence

do hereby report the performance of 102 days of DIAMOND DRILLING type of work

not before reported to be applied on the following contiguous claims

Table with columns: Claim No., Days, Claim No., Days, Claim No., Days. Includes a large 'RECEIVED' stamp from the Ontario Geological Survey Assessment Files Research Office dated OCT 11 1984.

All the work was performed on Mining Claim (s) 751067 (In the case of geological and/or geophysical survey (s) where more than 18 claims are involved attach a schedule)

READ CAREFULLY: THE FOLLOWING INFORMATION IS REQUIRED BY THE MINING RECORDER.

- For Manual Work, Stripping or Opening up of Mines, Sinking Shafts or Other Actual Mining Operations - Names and addresses of the men who performed the work and the dates and hours of their employment.
For Diamond and other Core Drilling - Footage, No. and angle of holes and diameter of core. Name and address of owner or operator of drill. Dates when drilling was done. Signed core log and sketch in duplicate.
For Compressed Air or Other Power Driven or Mechanical Equipment Type of drill or equipment. Names and addresses of men engaged in operating equipment and the dates and hours of their employment.
For Power Stripping - Type of equipment. Name and address of owner or operator. Amount expended. Dates on which work was done. Proof of actual cost must be submitted within 30 days of recording.
With each of the above types of work sketches are required to show the location and extent of the work in relation to the nearest claim post. In the case of diamond or other core drilling the sketch must be submitted in duplicate.
For Geophysical, Geological, Geochemical Surveys and Expenditure Credits - the name of author of report. Covering dates of survey (linecutting & office). Type of instrument used. Total amount of expenditure. Technical reports, maps, expenditure breakdown, receipts must be filed in duplicate with the Minister within 60 days of recording.
For Land Survey - the name and address of Ontario Land surveyor.

The Required Information is as Follows: (Attach a list if this space is insufficient)

Drilling Contractor: Mr. Alfred Lambert Northwest Geophysics 278 Sequoia Drive THUNDER BAY, Ontario Drilling Performed September 12-13, 1984

Core Size BQ - 1 7/16 inches in diameter 1 hole: DDH C-01 Total Footage: 102 feet

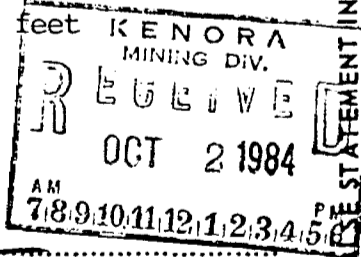

Date September 28, 1984

Signature of Recorded Holder or Agent

The Mining Act Certificate Verifying Report of Work

CHARLES E. PAGE 916 - 111 RICHMOND STREET WEST, TORONTO, ONTARIO, M5H 2G4 (Post Office Address)

- hereby certify: 1. That I have a personal and intimate knowledge of the facts set forth in the report of work annexed hereto, having performed the work or witnessed same during and/or after its completion. 2. That the annexed report is true.

Dated September 28 19 84 Signature

751067

THE PENALTY FOR MAKING A FALSE STATEMENT IN THIS REPORT AND/OR CERTIFICATE IS \$500. OR SIX MONTHS IMPRISONMENT OR BOTH

Tweedsmuir Twp. M.2023

Phillips Twp.
M.2102

