



52E10NE9000 20 CLEARWATER BAY

010

DIAMOND DRILLING

AREA: CLEARWATER BAY

REPORT NO: 20

WORK PERFORMED FOR: Mingold Resources Inc.

RECORDED HOLDER: Same as above [xx]  
: Other [ ]

<u>Claim No.</u>	<u>Hole No.</u>	<u>Footage</u>	<u>Date</u>	<u>Note</u>
K 1004896	ABE-1	757'	May/88	(1)

NOTES: (1) #W8801.154, filed in Nov/88

**ABERNETHY PROJECT**

**Assessment Report**

**on Mining Claims**

**K 1004893-899, 1005352-369**

**ABERNETHY LAKE, CLEARWATER BAY (M-2062)**

**KENORA, ONTARIO**

**DIAMOND DRILLING**

**MAY 1988**

**G. BIDWELL**

**MAY 30, 1988**

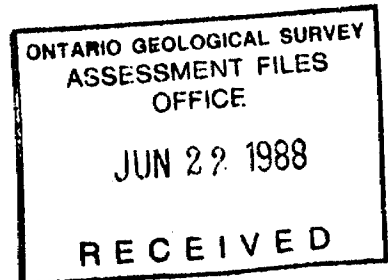

**MINGOLD RESOURCES INC.**  
Eastern District

PROJECT: ABERNETHY LAKE

DRILL HOLE NO. ABE - 1

Date: May 30, 1988

Page 1 of 5

CO-ORDINATES: 1+00 W

CLAIM NO.: 1004896

LOGGED BY: D. Pesce

HOLE SURVEYS (CORRECTED)

2+80 S

CORE SIZE: BQ

DRILLED BY: Kenora Soil & Drilling

DEPTH DIP DIRECTION

COLLAR ELEV.:

DATE STARTED: May 15, 1988

SECTION: 1+00 W

300' 37°

AZIMUTH: 150° (true)

COMPLETED: May 22, 1988

DEPTH: 757.0 ft.

557' 33W°

ANGLE: -45° S

757' 32°

REMARKS: hole drilled to test coincident EM-17, VLF-EM and magnetic anomalies 100 ft to west of 1975 HBED drill hole H-2

DEPTH		ROCK TYPE	DESCRIPTION	SAMPLE				ASSAYS		
FROM	TO			No.	FROM	TO	WIDTH	Au ppb	Ag ppb	Cu ppb
0.0	7.0	Casing								
7.0	757.0	Rhyodacite	- medium grey in color, agglomerate tuff, highly fragmental in sections from 1/8" to 1/4"; moderately to heavily silicified in sections, slightly chloritic in small veinlets	58523	7.0	10.0	3.0			
			- small rose colored garnets about 1/8" in diameter found throughout; occasionally chlorite and garnets found as a chlorite/garnet schist, a few carbonate veinlets sulfides present as pyrrhotite (po) and pyrite (py) about 1% throughout, massive sections from 1/4" to 2" wide of sulfides, trace magnetite, slightly sericitic	58524	10.0	13.0	3.0			
			20.3 - 20.6 massive sulfides 5% po, 15% py slightly chloritic, slightly silicious	58525	13.0	16.0	3.0			
			36.5 - 37.3 disseminated sulfides 10% po 10% py chlorite/garnet schist	58526	16.0	20.0	4.0			
			41.6 - 41.75 massive po 70%	58527	20.0	21.0	1.0			
			42.9 - 44.1 highly fragmented section	58528	21.0	22.5	1.5			
			54.3 1/4" po vein	58529	22.5	25.0	2.5			
			62.9 - 63.7 massive & disseminated sulfides 5% py 2% po moderately silicious	58530	25.0	28.0	3.0			
			64.2 - 64.6 massive and disseminated sulfides 5%py 2% po	58531	28.0	31.0	3.0			
			65.65- 67.2 massive and disseminated sulfides 20% py 5% po	58532	31.0	34.0	3.0			
			69.2 - 70.6 massive and disseminated sulfides 10% py 3% po	58533	34.0	36.0	2.0			
			82.5 - 82.7 massive sulfides 50% py 5% po	58534	36.0	37.5	1.5			
			92.3 - 92.5 massive sulfides 50% po 2% py	58535	37.5	40.0	2.5			
			93.5 1/4" py veinlet	58536	40.0	44.0	4.0			
			107.0 -107.2 quartz vein 1% sulfides	58537	44.0	45.0	1.0			
			110.0 -121.0 highly siliceous tuff, disseminated sulfides 1%	58538	45.0	48.0	3.0			
				58539	48.0	51.0	3.0			
				58540	51.0	54.0	3.0			
				58541	54.0	57.0	3.0			
				58542	57.0	60.0	3.0			
				58543	60.0	62.9	2.6			
				58544	62.9	65.5	2.6			
				58545	65.5	67.1	1.6			
				58546	67.1	69.0	1.9			
				58547	69.0	71.0	2.0			
				58548	71.0	74.0	3.0			
				58549	74.0	77.0	3.0			
				58550	77.0	80.0	3.0			
				58551	80.0	82.0	2.0			
				58552	82.0	83.0	1.0			
				58553	83.0	86.0	3.0			
				58554	86.0	89.0	3.0			
				58555	89.0	91.0	2.0			
				58556	91.0	92.5	1.5			
				58557	92.5	96.0	3.5			
				58558	100.0	103.0	3.0			
				58559	107.0	110.0	3.0			
				58560	110.0	113.0	3.0			
				58561	113.0	116.0	3.0			

ONTARIO GEOLOGICAL SURVEY  
ASSESSMENT FILES  
OFFICE

JUN 22 1988

RECEIVED

KENORA  
MINING DIV.  
RECEIVED  
MAY 31 1988  
5:39 PM  
10 11 12 1 2 3 4 5 6

MINGOLD RESOURCES INC.  
East District

PROJECT: ABERNETHY LAKE

DRILL HOLE NO. ABE #1

Date: May 30, 1988

Page 2 of 5

DEPTH		ROCK TYPE	DESCRIPTION	SAMPLE			ASSAYS		
FROM	TO			No.	FROM	TO	WIDTH	Au ppb	Ag ppb
	128.7 - 130.0		garnet rich 1-2%	58562	116.0	119.7	3.7		
	132.2 - 133.0		disseminated po 2%	58563	119.7	122.0	2.3		
	134.25 - 134.3		po vein	58564	122.0	125.0	3.0		
	140.3 - 143.8		2% disseminated sulfides, moderately siliceous, occasional garnets, slightly chloritic	58565	125.0	128.0	3.0		
				58566	128.0	130.0	2.0		
				58567	130.0	132.0	2.0		
	149.2 - 150.0		5% po 5% py, garnets, moderately siliceous	58568	132.0	133.0	1.0		
				58569	133.0	136.0	3.0		
	150.9 - 151.5		10% py 3% po garnets moderately siliceous	58570	136.0	140.3	4.3		
				58571	140.3	144.2	3.9		
				58572	144.2	147.0	2.8		
				58573	147.0	149.2	2.2		
				58574	149.2	151.5	2.3		
				58575	151.5	154.0	2.5		
				58576	154.0	157.0	3.0		
	162.0 - 166.7		5% disseminated po	58577	157.0	161.0	4.0		
	169.0 - 169.2		2 veinlets of po 1/8" and 1/8"	58578	161.0	163.0	2.0		
	172.8 - 174.0		silicified section 1-2% po	58579	163.0	166.0	3.0		
				58580	166.0	169.0	3.0		
				58581	169.0	171.0	2.0		
				58582	171.0	173.0	2.0		
				58583	173.0	174.2	1.2		
				58584	174.2	176.0	1.8		
				58585	176.0	179.0	3.0		
				58586	179.0	182.0	3.0		
				58587	182.0	185.0	3.0		
				58588	185.0	188.0	3.0		
				58589	188.0	192.0	4.0		
				58590	192.0	195.0	3.0		
				58591	197.5	200.0	2.5		
				58592	200.0	203.0	3.0		
				58593	203.0	206.0	3.0		
				58594	206.0	209.0	3.0		
				58595	209.0	211.5	2.5		
				58596	211.5	214.5	3.0		
	217.0 - 220.7		disseminated sulfides 5% po 2% py moderately to heavily silicified, moderately chloritic	58597	216.5	220.7	4.2		
				58598	220.7	223.0	2.3		
				58599	223.0	226.0	3.0		
	224.0		1/8" po vein	58600	226.0	229.0	3.0		
	227.7 - 227.8		narrow quartz vein, disseminated po and py, 10%	58901	229.0	233.0	4.0		
				58902	233.0	235.0	2.0		
	235.5 - 235.65		massive po 20%, moderately siliceous	58903	235.0	236.0	1.0		
				58904	236.0	239.0	3.0		
				58905	239.0	242.0	3.0		
				58906	246.0	248.0	2.0		
				58907	248.0	251.0	3.0		
				58908	251.0	254.0	3.0		
				58909	254.0	257.0	3.0		
				58910	257.0	260.5	3.5		
				58911	263.0	266.0	3.0		
				58912	266.0	269.0	3.0		
				58913	276.0	278.0	2.0		
				58914	278.0	281.0	3.0		
	281.0 - 282.5		biotite/po veinlet running parallel to core axis 30% po in veinlet	58915	281.0	282.5	1.5		
				58916	282.5	286.0	3.5		
				58917	286.0	290.0	4.0		

**MINGOLD RESOURCES INC.**  
Eastern District

PROJECT: ABERNETHY LAKE

DRILL HOLE NO. ABE #1

Date: May 30, 1988

Page 3 of 5

DEPTH		ROCK TYPE	DESCRIPTION	SAMPLE				ASSAYS		
FROM	TO			No.	FROM	TO	WIDTH	Au ppb	Ag ppb	Cu ppb
				58918	292.0	295.0	3.0			
				58919	295.0	298.0	3.0			
				58920	298.0	301.0	3.0			
				58921	301.0	304.0	3.0			
				58922	304.0	307.0	3.0			
				58923	307.0	310.0	3.0			
				58924	310.0	313.0	3.0			
				58925	313.0	316.0	3.0			
				58926	316.0	319.0	3.0			
				58927	319.0	322.0	3.0			
				58928	322.0	325.0	3.0			
				58929	325.0	328.0	3.0			
				58930	328.0	331.0	3.0			
			331.1 - 331.3 massive and disseminated po 15-20%	58931	331.0	334.0	3.0			
				58932	334.0	337.0	3.0			
				58933	337.0	340.0	3.0			
				58934	340.0	343.0	3.0			
				58935	343.0	346.0	3.0			
				58936	346.0	349.0	3.0			
				58937	349.0	352.0	3.0			
				58938	352.0	355.0	3.0			
				58939	355.0	358.0	3.0			
				58940	358.0	361.0	3.0			
			364.3 - 366.0 garnet rich up to 1/8" in diameter	58941	361.0	364.0	3.0			
				58942	364.0	367.0	3.0			
				58943	367.0	370.0	3.0			
				58944	370.0	373.0	3.0			
				58945	373.0	376.0	3.0			
				58946	376.0	378.0	2.0			
			378.1 - 379.2 disseminated po 3% highly siliceous	58947	378.0	380.0	2.0			
			382.2 - 382.6 disseminated po 3%	58948	380.0	383.0	3.0			
				58949	383.0	385.0	2.0			
			385.2 - 386.0 disseminated po 5%	58950	385.0	386.0	1.0			
				58951	386.0	389.0	3.0			
				58952	389.0	392.0	3.0			
				58953	392.0	395.0	3.0			
				58954	395.0	398.0	3.0			
				58955	398.0	400.0	2.0			
			400.2 - 405.5 massive and disseminated po 5-7% total, moderately to heavily siliceous	58956	400.0	402.0	2.0			
				58957	402.0	404.0	2.0			
				58958	404.0	406.0	2.0			
				58959	406.0	409.0	3.0			
				58960	409.0	412.0	3.0			
				58961	412.0	415.0	3.0			
				58962	415.0	418.0	3.0			
				58963	418.0	421.0	3.0			
				58964	421.0	424.0	3.0			
				58965	424.0	427.0	3.0			
				58966	427.0	430.0	3.0			
				58967	430.0	433.0	3.0			
				58968	433.0	436.0	3.0			

**MINGOLD RESOURCES INC.**  
Eastern District

PROJECT: ABERNETHY LAKE

DRILL HOLE NO. ABE #1

Date: May 30, 1988

Page 4 of 5

DEPTH		ROCK TYPE	DESCRIPTION	SAMPLE				ASSAYS		
FROM	TO			No.	PROM	TO	WIDTH	Au ppb	Ag ppb	Cu ppb
				58969	436.0	439.0	3.0			
				58970	439.0	442.0	3.0			
				58971	442.0	446.0	4.0			
				58972	446.0	449.0	3.0			
				58973	449.0	452.0	3.0			
				58974	452.0	455.0	3.0			
				58975	455.0	458.0	3.0			
				58976	458.0	461.0	3.0			
				58977	461.0	464.0	3.0			
				58978	464.0	467.0	3.0			
				58979	467.0	470.0	3.0			
				58980	470.0	473.0	3.0			
				58981	473.0	475.5	2.5			
				58982	475.5	477.0	1.5			
				58983	477.0	480.0	3.0			
				58984	480.0	483.0	3.0			
				58985	483.0	486.0	3.0			
				58986	486.0	489.0	3.0			
				58987	489.0	492.0	3.0			
				58988	547.0	550.0	3.0			
				58989	550.0	554.0	4.0			
				58990	557.0	580.0	3.0			
				58991	580.0	582.5	2.5			
			582.6 - 584.0	58992	582.5	584.0	1.5			
			moderately to heavily silicified, cross-cutting quartz veins at no regular angles; sulfides 1%	58993	584.0	585.5	1.5			
			py as flakes, disseminated po	58994	585.5	588.0	2.5			
			584.0 - 585.4	58995	588.0	591.0	3.0			
			quartz vein, sericite, chloritic along fractures disseminated	58996	591.0	594.0	3.0			
			sulfides mostly py 1% slightly carbonatized	58997	594.0	597.0	3.0			
				58998	606.0	609.5	3.5			
				58999	609.5	610.5	1.0			
			609.5 - 610.5	59000	610.5	613.0	3.5			
			disseminated po 1-2%; garnet rich	61501	613.0	616.0	3.0			
				61508	616.0	619.0	3.0			
				61502	619.0	622.0	3.0			
				61503	622.0	625.0	3.0			
				61504	625.0	628.0	3.0			
				61505	628.0	631.0	3.0			
				61506	631.0	634.0	3.0			
				61507	634.0	637.0	3.0			
				61509	637.0	640.0	3.0			
				61510	640.0	643.0	3.0			
				61511	643.0	646.0	3.0			
				61512	646.0	649.0	3.0			
				61513	649.0	652.0	3.0			
				61514	652.0	655.0	3.0			
				61515	655.0	658.0	3.0			
				61516	658.0	661.0	3.0			
				61517	661.0	664.0	3.0			
				61518	664.0	667.0	3.0			
				61519	667.0	670.0	3.0			



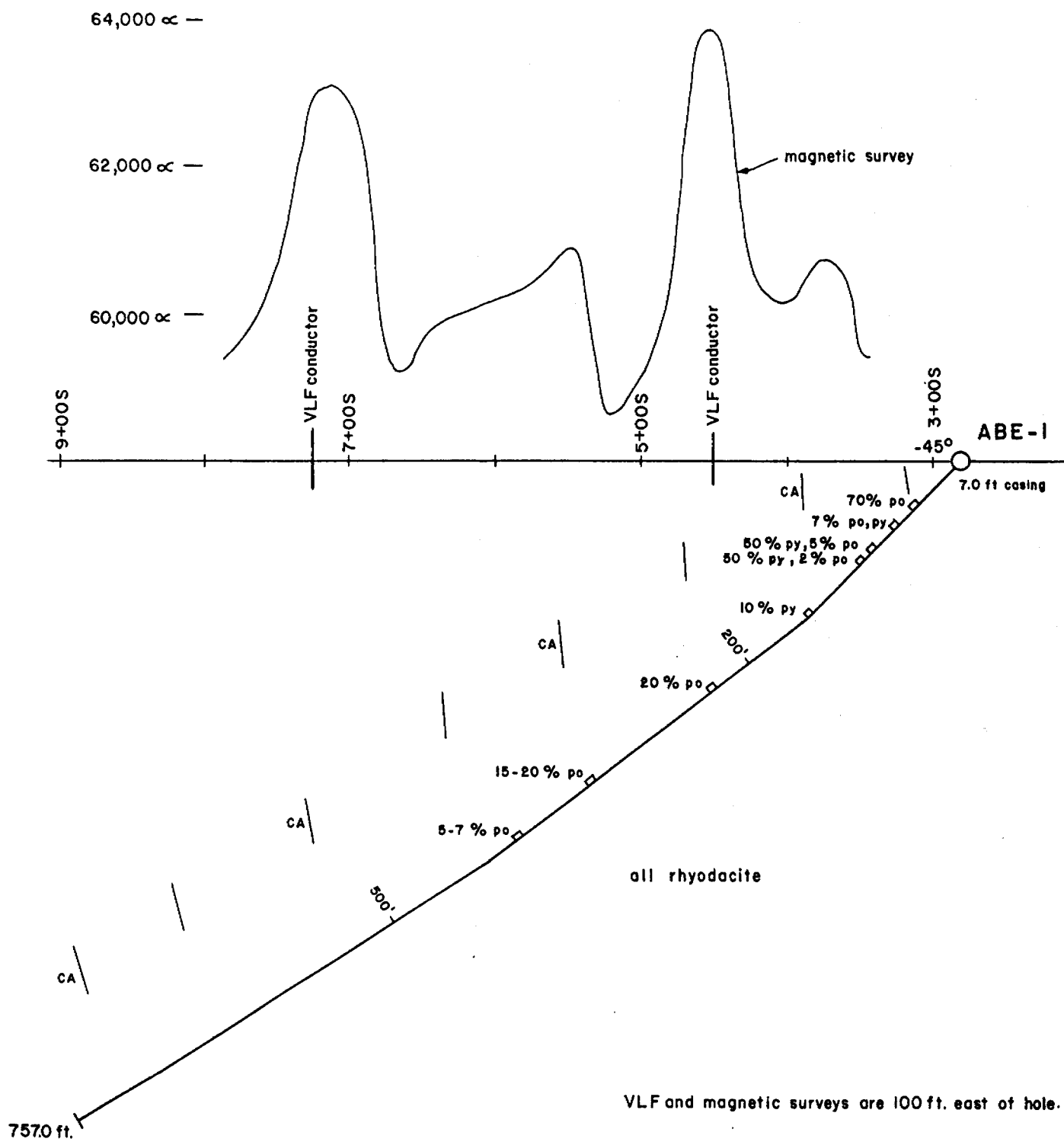

<b>MINGOLD RESOURCES INC.</b>	
EASTERN DISTRICT	THUNDER BAY OFFICE
ABERNETHY LAKE PROJECT	
DRILL HOLE ABE - 1	
Section 1+00W Looking 240°	
SCALE:	DATE:
1" = 100'	May 25/88
	DRAWN BY:
	D. Pesce



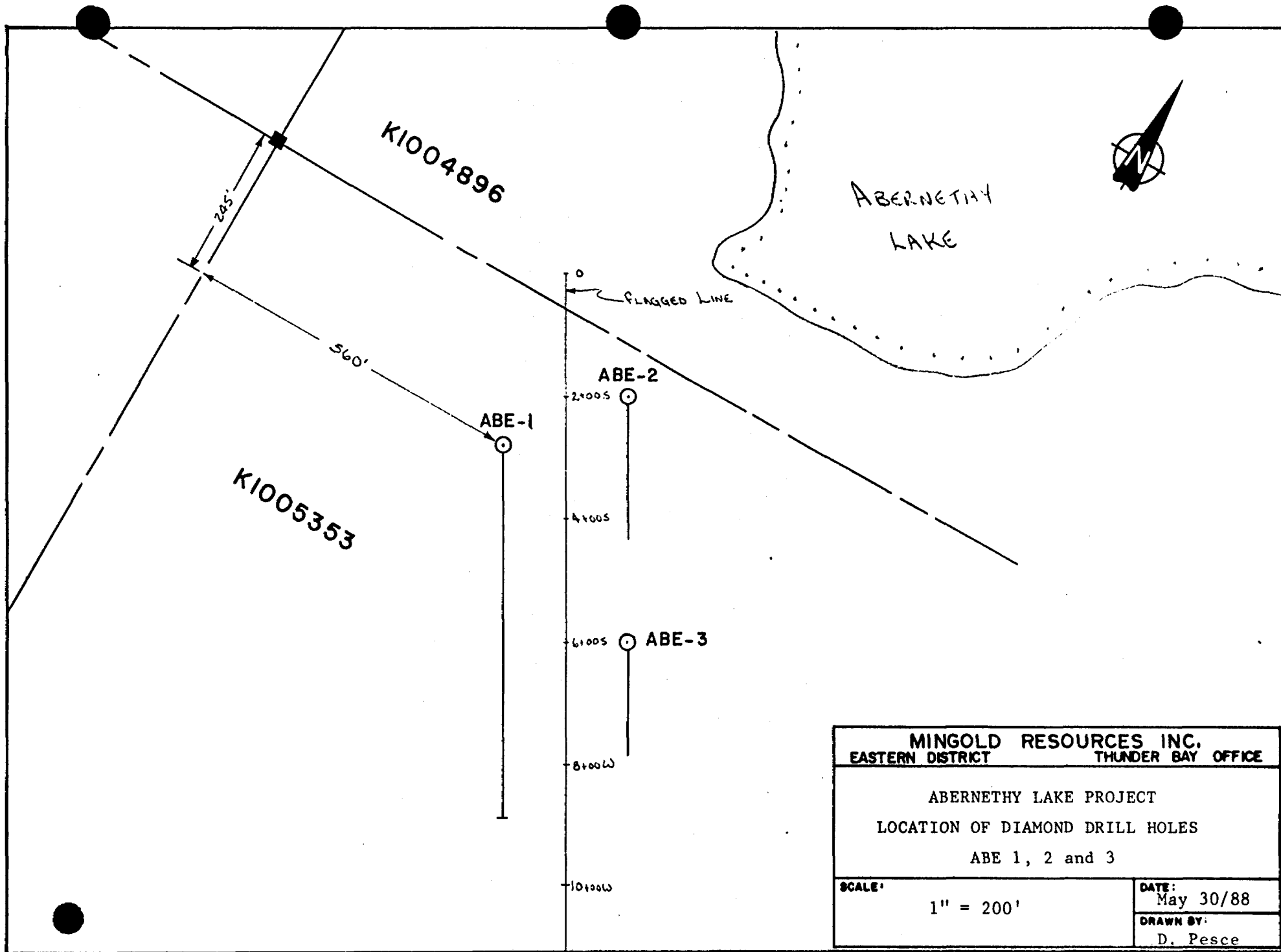

<b>MINGOLD RESOURCES INC.</b> EASTERN DISTRICT                      THUNDER BAY OFFICE	
ABERNETHY LAKE PROJECT LOCATION OF DIAMOND DRILL HOLES ABE 1, 2 and 3	
<b>SCALE:</b> 1" = 200'	<b>DATE:</b> May 30/88
<b>DRAWN BY:</b> D. Pesce	



Ministry of Northern Development and Mines

Report of Work

DOCUMENT NO.

W8801-154

Supply required data on a separate form for each claim

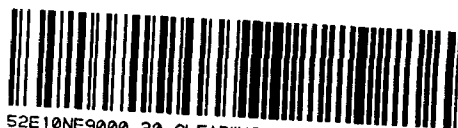

52E10NE9000 20 CLEARWATER BAY

Ontario CLEARWATER BAY Mining Act

2062

Name and Postal Address of Recorded Holder

MINING RESOURCES INC.

900

Box 28, Toronto Dominion Centre, TORONTO, Ontario M5K 1B8

Summary of Work Performance and Distribution of Credits

Total Work Days Cr. claimed 757	Mining Claim			Mining Claim			Mining Claim		
	Prefix	Number	Work Days Cr.	Prefix	Number	Work Days Cr.	Prefix	Number	Work Days Cr.
for Performance of the following work. (Check one only) <input type="checkbox"/> Manual Work <input type="checkbox"/> Shaft Sinking Drifting or other Lateral Work. <input type="checkbox"/> Compressed Air, other Power driven or mechanical equip. <input type="checkbox"/> Power Stripping <input checked="" type="checkbox"/> Diamond or other Core drilling <input type="checkbox"/> Land Survey	K	1004893	60		1005353	20		1005361	20
		1004894	60		1005354	20		1005362	20
		1004895	60		1005355	20		1005363	20
		1004896	60		1005356	20		1005364	20
		1004897	60		1005357	20		1005365	20
		1004898	60		1005358	20		1005366	20
		1004899	37		1005359	20		1005367	20
		1005352	20		1005360	20		1005368	20

All the work was performed on Mining Claim(s): K 1005353 (Claim map M-2062)

Required Information eg: type of equipment, Names, Addresses, etc. (See Table Below)

DIAMOND DRILLING - Core size BQ (1 7/16" diameter)

Kenora Soil & Drilling, Box 109, Kenora, Ontario P9N 3X6

ABE - 1 from May 15 to 22, 1988 drilled to depth of 757 feet

Assessment credit request

ONTARIO GEOLOGICAL SURVEY  
ASSESSMENT SERVICES OFFICE  
JUN 22 1988  
RECEIVED

KENORA MINING DIV.  
RECEIVED  
MAY 31 1988  
AM 10:15  
7 8 9 10 11 12 1 2 3 4 5 6 PM

Core stored at Kenora Soil and Drilling in Kenora and Mingold Resources, Thunder Bay

Date of Report: May 30, 1988  
Recorded Holder or Agent (Signature): [Signature]

Certification Verifying Report of Work

I hereby certify that I have a personal and intimate knowledge of the facts set forth in the Report of Work annexed hereto, having performed the work or witnessed same during and/or after its completion and the annexed report is true.

Name and Postal Address of Person Certifying

G. BIDWELL, 935 Cobalt Crescent, Thunder Bay, Ontario P7B 5Z4

Date Certified: May 30, 1988  
Certified by (Signature): [Signature]

Table of Information/Attachments Required by the Mining Recorder

Type of Work	Specific information per type	Other information (Common to 2 or more types)	Attachments
Manual Work	Nil	Names and addresses of men who performed manual work/operated equipment, together with dates and hours of employment. 1004893	Work Sketch: these are required to show the location and extent of work in relation to the nearest claim post.
Shaft Sinking, Drifting or other Lateral Work			
Compressed air, other power driven or mechanical equip.	Type of equipment	Names and addresses of owner or operator together with dates when drilling/stripping done.	
Power Stripping	Type of equipment and amount expended. Note: Proof of actual cost must be submitted within 30 days of recording.		
Diamond or other core drilling	Signed core log showing; footage, diameter of core, number and angles of holes.		Work Sketch (as above) in duplicate
Land Survey	Name and address of Ontario land surveyer.	Nil	Nil



Mining Act

Name and Postal Address of Recorded Holder <b>MINGO RESOURCES INC.</b>	Prospector's Licence No. <b>T 4617</b>
Box 28, Toronto Dominion Centre, TORONTO, Ontario M5K 1B8	

Summary of Work Performance and Distribution of Credits

	Mining Claim			Mining Claim			Mining Claim		
	Prefix	Number	Work Days Cr.	Prefix	Number	Work Days Cr.	Prefix	Number	Work Days Cr.
for Performance of the following work. (Check one only)	K	1004893	60		1005353	20		1005361	20
<input type="checkbox"/> Manual Work		1004894	60		1005354	20		1005362	20
<input type="checkbox"/> Shaft Sinking Drifting or other Lateral Work.		1004895	60		1005355	20		1005363	20
<input type="checkbox"/> Compressed Air, other Power driven or mechanical equip.		1004896	60		1005356	20		1005364	20
<input type="checkbox"/> Power Stripping		1004897	60		1005357	20		1005365	20
<input checked="" type="checkbox"/> Diamond or other Core drilling		1004898	60		1005358	20		1005366	20
<input type="checkbox"/> Land Survey		1004899	37		1005359	20		1005367	20
		1005352	40		1005360	20		1005368	20

All the work was performed on Mining Claim(s): **K 1005353 (Claim map M-2062)**

Required Information eg: type of equipment, Names, Addresses, etc. (See Table Below)

DIAMOND DRILLING - Core size BQ (1 7/16" diameter)

Kenora Soil & Drilling, Box 109, Kenora, Ontario P9N 3X6

ABE - 1 from May 15 to 22, 1988 drilled to depth of 757 feet

Assessment credit requested = 757 days

ONTARIO GEOLOGICAL SURVEY  
ASSESSMENT FILES  
OFFICE

JUN 22 1988

KENORA MINING DIV.

RECEIVED

MAY 31 1988

AM 10:15 PM

7 8 9 10 11 12 1 2 3 4 5 6

Core stored at Kenora Soil and Drilling in Kenora and Mingo Resources, Thunder Bay

Date of Report May 30, 1988	Recorded Holder or Agent (Signature) 
--------------------------------	--

Certification Verifying Report of Work

I hereby certify that I have a personal and intimate knowledge of the facts set forth in the Report of Work annexed hereto, having performed the work or witnessed same during and/or after its completion and the annexed report is true.

Name and Postal Address of Person Certifying <b>G. BIDWELL, 935 Cobalt Crescent, Thunder Bay, Ontario P7B 5Z4</b>	
Date Certified May 30, 1988	Certified by (Signature) 

Table of Information/Attachments Required by the Mining Recorder

Type of Work	Specific information per type	Other information (Common to 2 or more types)	Attachments
Manual Work	Nil	Names and addresses of men who performed manual work /operated equipment, together with dates and hours of employment.	Work Sketch: these are required to show the location and extent of work in relation to the nearest claim post.
Shaft Sinking, Drifting or other Lateral Work			
Compressed air, other power driven or mechanical equip.	Type of equipment	Names and addresses of owner or operator together with dates when drilling/stripping done.	
Power Stripping	Type of equipment and amount expended. Note: Proof of actual cost must be submitted within 30 days of recording.		
Diamond or other core drilling	Signed core log showing: footage, diameter of core, number and angles of holes.		Work Sketch (as above) in duplicate
Land Survey	Name and address of Ontario land surveyor.	Nil	Nil



Mining Act

Name and Postal Address of Recorded Holder <b>MOLD RESOURCES INC.</b>	Prospector's Licence No.
--	--------------------------

Summary of Work Performance and Distribution of Credits

Total Work Days Cr. claimed	Mining Claim		Work Days Cr.	Mining Claim		Work Days Cr.	Mining Claim		Work Days Cr.
	Prefix	Number		Prefix	Number		Prefix	Number	
for Performance of the following work. (Check one only)	K	1005369	20						
<input type="checkbox"/> Manual Work									
<input type="checkbox"/> Shaft Sinking Drifting or other Lateral Work.									
<input type="checkbox"/> Compressed Air, other Power driven or mechanical equip.									
<input type="checkbox"/> Power Stripping									
<input type="checkbox"/> Diamond or other Core drilling									
<input type="checkbox"/> Land Survey									

All the work was performed on Mining Claim(s):

Required Information eg: type of equipment, Names, Addresses, etc. (See Table Below)

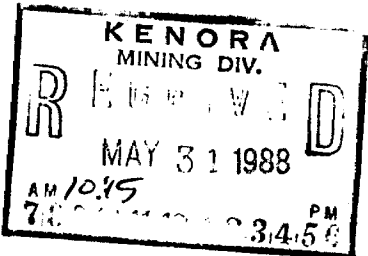

Date of Report	Recorded Holder or Agent (Signature)
----------------	--------------------------------------

Certification Verifying Report of Work

I hereby certify that I have a personal and intimate knowledge of the facts set forth in the Report of Work annexed hereto, having performed the work or witnessed same during and/or after its completion and the annexed report is true.

Name and Postal Address of Person Certifying	
Date Certified	Certified by (Signature)

Table of Information/Attachments Required by the Mining Recorder

Type of Work	Specific information per type	Other information (Common to 2 or more types)	Attachments
Manual Work	Nil	Names and addresses of men who performed manual work/operated equipment, together with dates and hours of employment.	Work Sketch: these are required to show the location and extent of work in relation to the nearest claim post.
Shaft Sinking, Drifting or other Lateral Work			
Compressed air, other power driven or mechanical equip.	Type of equipment	Names and addresses of owner or operator together with dates when drilling/stripping done.	
Power Stripping	Type of equipment and amount expended. Note: Proof of actual cost must be submitted within 30 days of recording.		
Diamond or other core drilling	Signed core log showing; footage, diameter of core, number and angles of holes.		Work Sketch (as above) in duplicate
Land Survey	Name and address of Ontario land surveyor.	Nil	Nil



DOCUMENT NO. W8801-154

Mining Act

Instructions - Supply required data on a separate form for each type of work to be recorded (see table below). For Geo-technical work use form no. 1362 "Report of Work (Geological, Geophysical, Geochemical and Expenditures)".

Name and Postal Address of Recorded Holder: **INGOLD RESOURCES INC.**

Prospector's Licence No. **TAB17**

Summary of Work Performance and Distribution of Credits

Total Work Days Cr. claimed <b>751</b>	Mining Claim			Mining Claim			Mining Claim		
	Prefix	Number	Work Days Cr.	Prefix	Number	Work Days Cr.	Prefix	Number	Work Days Cr.
for Performance of the following work. (Check one only) <input type="checkbox"/> Manual Work <input type="checkbox"/> Shaft Sinking Drifting or other Lateral Work. <input type="checkbox"/> Compressed Air, other Power driven or mechanical equip. <input type="checkbox"/> Power Stripping <input checked="" type="checkbox"/> Diamond or other Core drilling <input type="checkbox"/> Land Survey	K	1005369	20						

All the work was performed on Mining Claim(s):

Required Information eg: type of equipment, Names, Addresses, etc. (See Table Below)

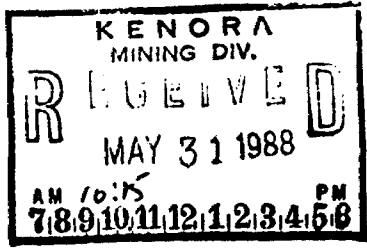

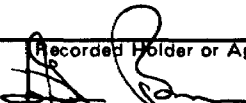
Date of Report: \_\_\_\_\_ Recorded Holder or Agent (Signature): 

Certification Verifying Report of Work

I hereby certify that I have a personal and intimate knowledge of the facts set forth in the Report of Work annexed hereto, having performed the work or witnessed same during and/or after its completion and the annexed report is true.

Name and Postal Address of Person Certifying: **G. BIRDWELL 935 CABALT CRESCENT, THUNDER BAY, ONTARIO P7B 5Z4**

Date Certified: \_\_\_\_\_ Certified by (Signature): 

Table of Information/Attachments Required by the Mining Recorder

Type of Work	Specific information per type	Other information (Common to 2 or more types)	Attachments
Manual Work	Nil	Names and addresses of men who performed manual work/operated equipment, together with dates and hours of employment.	Work Sketch: these are required to show the location and extent of work in relation to the nearest claim post.
Shaft Sinking, Drifting or other Lateral Work			
Compressed air, other power driven or mechanical equip.	Type of equipment	Names and addresses of owner or operator together with dates when drilling/stripping done.	
Power Stripping	Type of equipment and amount expended. Note: Proof of actual cost must be submitted within 30 days of recording.		
Diamond or other core drilling	Signed core log showing; footage, diameter of core, number and angles of holes.		Work Sketch (as above) in duplicate
Land Survey	Name and address of Ontario land surveyor.	Nil	Nil

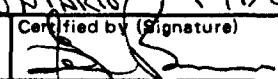