



52E10SW8529 22 SHOAL LAKE

010

Diamond Drilling

Area Shoal Lake

Report No 22

Work performed by: Hopkins & Heintzman

Claim No	Hole No	Footage	Date	Note
K. 32458	63-1		May/63	(1)
K. 32456	63-2		May/63	(1)
	64-1		July/64	(1)
K. 32455	64-2		July/64	(1)
	64-3		July/64	(1)
	64-4		July/64	(1)
K. 32454	64-5		July/64	(1)

241'
 163
 161.5
 101.5
 115.25
 185
 150

Notes:

(1) Formerly report #13 Glass Twp.

Collar On N. boundary of K 32458, about half-way between Posts Nos. 1 and 4.

Coordinates of Collar: 25' N. of shore.
 Dip - 45° Strike 180°

COMPANY Hopkins-Herintzman (Duncan Derry show)
 PROPERTY Glass trap, Shoal Lake.

Claim No.

D.D.H. # 63-1

K. 32458

29 May '63

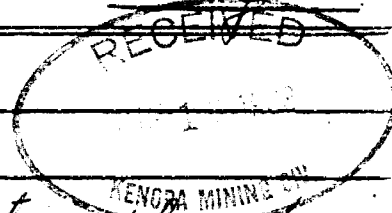

Sample No.	Mr/Hr	Dist. from ft	Formation	Width ft.	Assay Value	%	%	Au Oz.	Oz.	Remarks
		0.0	Casing	1.0						
		1.0	Andesite	230.5						- Dark-green flow, porphyritic in places, becoming greyer with depth. Contains some finely-disseminated pyrite, pyrrhotite, & rarely chalcopy, & is cut by many spasmodic qtz.-carb. stringers & slips in various directions. Exceptions:-
1619		25.1-29.0		3.9						- Silicified porphyry, 95% milky qtz with some very fine-gr pyrite.
1620		110.5-115.5		5.0						- Slightly siliceous talc-chlorite-sericite schist, possibly derived from a former porphyry - slightly pyritized.
1621		162.2-172.2		10.0						- Altered carbonatized brecciated andesite, cut by qtz. str. & containing py, pyrro., & rare chalcopy, & next to the mud seam some rust, limonite & hematite.
		172.0-172.5		0.5						- Mud seam - no core.
		172.5-186.9		14.4						- Altered somewhat carbonatized andesite, rusty next to mud seam.
1622		186.1-186.9		0.8						Best mineralized sect. of the above 14.4' - contains some py & pyrro.
		189.7-220.6		30.9						- Andesite, but cut by more qtz.-carb. str. than usual - almost a stockwork, with occas. finely-dissem. pyrite.
1623		206.5-207.3		0.8						Best mineralized example of above stockwork - seams of py & pyrro.
		231.5	Diorite	9.5						- (or very coarse-grained andes. Dark-green, altered (Keewatin?) It is a high-amphibole diorite, cut by occas. qtz.-carb stringer.

241.0 End of hole.

Logged by Albert Hopkins B.A.S.

Mining Record copy

Collar is at water's edge of Miner's Bay, Shoal Lake

Coordinates of Collar: 1930'N, 3865'E COMPANY Hopkins-Heintzman, Shoal Lake

Claim No.

D.D.H. #63-2

Dip - 45° Strike 222°

PROPERTY Miner's Shoal Glass Tap

K.32456

1 June 1963

Sample No.	Mr/Hr	Dist. from ft.	Formation	Width ft.	Assay Value	%	%	Au. Oz.	Oz.	Remarks
		0.0	Casing	1.0						No core
		1.0	Diorite	70.0						Dark grey-green, high-amphibole, almost an hornblende, medium- to coarse-grained. Finer-grained phases may be c.g. andesite. Cut by occasional seam of seric- or carb- alteration, or qtz-carb stringers.
		71.0	Andesite	37.0						Fine-grained, amygdaloidal; boundary vague.
				79.9-88.0						Streaks of pyrite + a little quartz.
1628				89.2-92.0						Miner's Vein (?) Streaks of py. + a little sphal. + a little qtz. 90% andes., 10% min. + qtz. Poor-looking + not worth another drill hole here.
		108.0	Diorite							As above, boundaries vague + gradual, becoming coarser-grained with depth.
		163.0	End of hole							Drill core left at campsite, on point on Woodtick Bay, on claim no. K.32454.
										Core logged by A. Hopkins B.A.Sc.

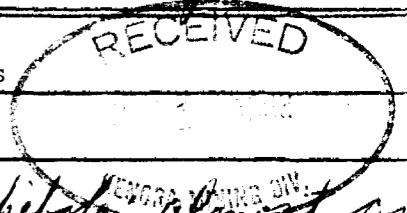

MINING DIV.

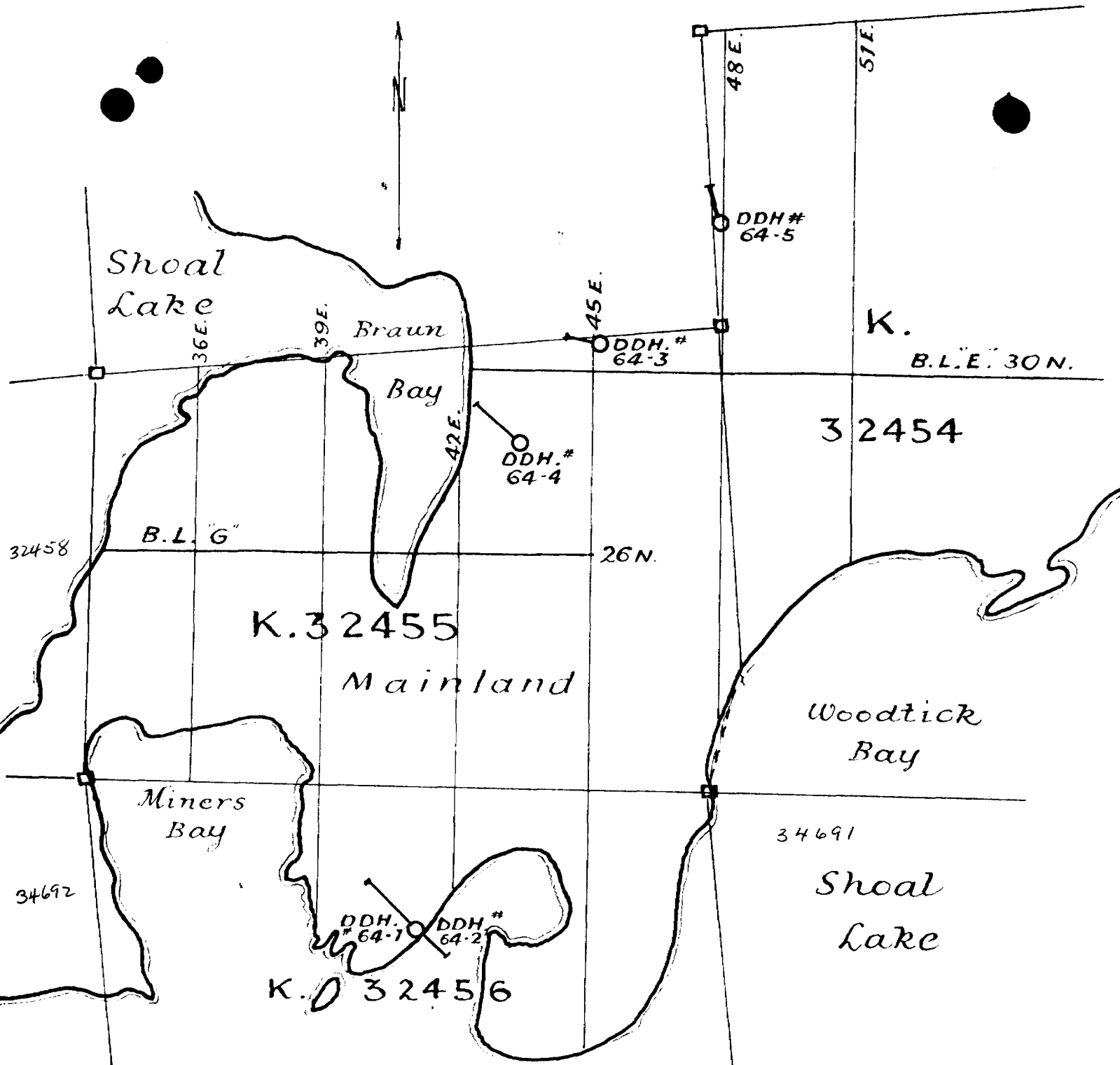

Scale Map
part of

A. Hopkins Property
Glass Tp., Shoal Lake, Ont.

showing

5 Drill Holes bored for
Assessment Work in 1964

Scale: 1" = 300'

A. Hopkins, B.A.Sc.
A. Hopkins

July 25-1964

Coordinates of Collar: 1750' N., 4130' E. COMPANY Hopkins-Heintzman-Shoal Lake.

Claim No.

D.D.H. # 64-1.

Dip -30°

Strike 320°

PROPERTY South group

K.32456

2 July, 1964.

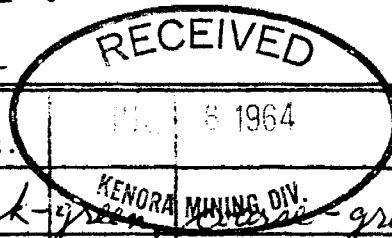

Sample No.	Mr/Hr	Dist. from ft	Formation	Width ft.	Assay Value	%	%	Au. Oz.	Oz.	Remarks
		0'	Pillow lava.	55.4						Dark-green, fine-grained amygdaloid pillow lava, andesite to basalt; pillows av. 2' long, 1' wide, strike 20°, dip -70° E. Cut by occas. narrow qtz. + carb. stringers which contain occas. blebs of pyrite e.g. at 2.8' (1/2" thick) 27.7'-27.9'; 28.8'-29.3' (altered + sheared), etc.
		55.4	Felspar porphyry	15.8						Grey, 1/16" feldspar phenocrysts mostly grey, some reddish, slightly altered, containing dissem. f.g. pyrite, tourm. & missickel (?). Its contacts cut the drill core at 75°.
64-1-1		55.4'-60.8'		4.6						
64-1-2		60.0'-65.0'		5.0						
64-1-3		65.0'-71.2'		6.2						This may be an E. extension of the Miner Zone.
		71.2	Lava Schist	16.3						Highly altered & sheared. This may be Walkers fault
64-1-4		71.2'-75.0'		3.8						lineament B-7-B8. It is about 33% qtz-carb., peppered with v.f.g. py, cubes, some striated missickel elongated crystals, chalcopy, tourm. red haematite in seams, & v.g. (?) at 74.9'. The schist becomes decreasingly altered, mineralized, silicified & carbonatized after 75.0' grading almost back to pillow lava at 87.5'.
		87.5	Pillow Lava	74.0						As above, with occas. py & haema in seams.
64-1-5		101.2-101.4		0.2						Qtz veinlet, slightly pyritized, plus a little chalcopy, missickel, tourm & v.g. (?)

161.5 End of hole.

Core stored near collar of hole.

Albert Hopkins
B.A. Sc.

File

Coordinates of Collar: 1750'N., 4125'E. COMPANY Hopkins-Heintzman Sheal Lake

Claim No.

D.D.H. # 64-2

Dip -30°

Strike 132°

PROPERTY South Group, Glass tp.

K.32456

4 July 1964.

Sample No.	Mr/Hr	Dist. from ft	Formation	Width ft.	Assay Value	%	%	Au. Oz.	Oz.	Remarks
										<u>Object of the Hole:-</u>
										To perform essential assessment work on this 18-claim group, to locate C.W. Walker's "B7-B8 shear and fault zone, and if so, to find whether it contains any ore values.
		0.0	Pillow Lava.	87.0'						Dark green, coarse-grained, cut by many narrow qtz. & qtz-carb stringers, e.g. 6.0'-6.2'.
64-2-1			26.6'-27.3'	0.7'						30% qtz-chlor-carb breccia, fwm. py, pyrro, & a little chalcopy & arsenopy (?). (50% sulfs in tota)
64-2-2			43.3'-43.9'	0.6'						30% qtz with chlorite inclusions, well-min. by py & were traces of pyrro & chalcopy. (25% sulfs in tota).
		87.0	XXXX Fault Zone	14.5'						No solid core, only broken schist, sand, & gravel & mud.
		101.5	End of hole.							<u>Results of the hole:-</u>
										The hole appears to intersect Walker's zone B7-B8, but no core from the actual fault zone was recovered. It is probably mostly gouge and mud therein. Sometime in the future this fault should be rechecked by a steeper hole from same collar set-up, to check the fault for ore values.
										Core stored near collar of hole.
										Core logged by A. Hopkins, B.A.Sc.

RECEIVED
 SEP 21 1964
 HOPKINS SHEAL LAKE

A. Hopkins

File

Coordinates of Collar: 3068'N, 4532'E. COMPANY Hopkins-Heintzman Sheal Lake

Claim No.

D.D.H. # 64-3

● p -45°

Strike 275°

PROPERTY South Group, Glass tp.

K.32455

6 July 1964.

Sample No.	Mr/Hr	Dist. from ft	Formation	Width ft.	Assay Value	%	%	Au. Oz.	Oz.	Remarks
										<u>Object of the Hole</u>
										To test the SW projection of the "Machin Zone", and to perform needed assessment work.
		0.0'	Diorite	43.5'						Massive, dark green mostly coarse-grained, with some medium-grained sections. Cut by barren qtz stringer from 41.6'-41.8'.
		43.5'	Diorite	5.5'						Green, slightly schistose, containing a weak network of tiny feldspathic & qtz veinlets. In places there are a few disseminations of pyrrho, py, and traces of chalcopy.
64-3-1		49.0'	Lava	1.75'				.		Lava top, black & grey slate, chert, much hornblende, with 1% fine-grained py & tr qtz & chalcopy. Dips apparently 80°SE.
		50.75'	Lava	64.5'						Altered to green chloritic schist with minute parallel qtz seams containing a very little py and pyrrho in places.
64-3-2 64-3-2		111.75'	Min'd sil. Lava	3.5'				.		Same as above lava, only with about 30% qtz & a little v.f.g. py, pyrrho, & chalcopy.
		115.25'	End of hole.							<u>Results of this Hole</u>
										This hole should have gone deeper. It should be deepened & checked sometime in the future.
										Core left near collar of holes nos. 64-1 and 64-2.

RECEIVED
JUL 21 1964
KENORA MINING DIV.

Core logged by A.P.E. Hopkins, B.A.Sc. *A. Hopkins*

File

Coordinates of Collar: 2845'N, 4300'E. COMPANY Hopkins-Heintzman, Sheel Lake.

Claim No.

D.D.H. # 64-4

Dip -60° Strike 310°

PROPERTY South Group of 18, Glass tp.

K. 32455

9 July 1964.

Sample No.	Mr/ Hr	Dist. from ft	Formation	Width ft.	Assay Value	%	%	Au. Oz.	Oz.	Remarks
										<u>Object of the Hole</u>
										To perform needed assessment work and to check for the SW projection of the "Machin Zone".
		0.0'	Casing	5.0'						No core.
		5.0'	Diorite	56.3'						Massive, dark green, mostly coarse-grained, with some med.-gr. sections. At 36.75'-38.5' is glassy white qtz with no sulfs.
		61.3'	Diorite, altered	0.7'						Fine-grained, greyish-green.
		64.0'	Diorite	10.0'						Coarse-grained, green.
		74.0'	Diorite	1.4'						Fine-grained, grey.
		75.4'	Lava top	2.6'						Chert, breccia, & schist, with traces of py, pyrro & chalcopy
64-4-1			IX 75.4-77.0'	1.6'						
		78.0'	Lava schist	2.0'						Fine-grained.
		80.0'	Lava or fg. Diorite	IX 3.0'						Coarse-grained, becoming coarser in last 3", then v.f.g. dense lava.
		83.0- 83.3	Lava or Dier.	5.3'						Coarse-grained, green, banded lava, top at 88.3'.
		88.3'	Andesite	2.45'						Green, dense.
		90.75'	Lava Schist	8.25'						Grey, with a few parallel feldspathic qtz veinlets carrying considerable pyrro & tr chalcopy & py. Also a few sulfs in the schist in places.

RECEIVED
 SEP 21 1964
 KENORAMINING CO.

(concluded on p.2)

Coordinates of Collar:

COMPANY Hopkins-Haitsman, Sheel Lake

Claim No. _____

D.D.H. # 64-4

Dip _____

Strike _____

PROPERTY _____

Sample No.	Mr/Hr	Dist. from ft	Formation	Width ft.	Assay Value	%	%	Au. Oz.	Oz.	Remarks
64-4-2			90.75-92.50'	1.75'				.		<i>Little more</i> Mostly sulfs. in this portion
		99.0-	Diorite	24.5'						Green, massive. At 108' is 3" glassy qtz, also at 116.5'-117.0', & at 118' (2").
		123.5'	Lava or Dior. Sch.	3.5'						Grey, med-gr, with a few parallel veins of felspar & qtz. At 125' is 3" of glassy qtz.
		127.0'	Porphy. Lava or Dior.	58'						Green, coarse-grained. At 170.5' is 3" glassy qtz, & at 183' is cherty lava top.
		185'	End of Hole.							
Results of Hole										
This hole did not go deep enough to cut the so-called										
Nashin Zone SW extension. Sometime in the future it should be										
deepened another 50 feet or so.										
The core was dumped near the collar after logging,										
except for boxes 3, 4, and 5, which were saved.										
Core logged by F.E. Hopkins, B.A.Sc.										
10 July 1964.										
<i>F.E. Hopkins</i>										
<i>Ch Hopkins</i>										

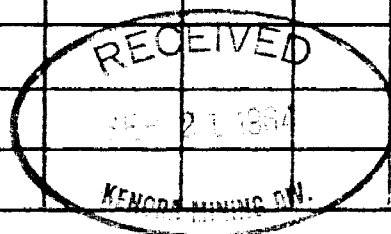

DIAMOND DRILL RECORD, HOLE NO. 64-5

File page 1

PROPERTY Hopkins-Helntzman, Shoal Lake
South Group, Glass Tp.

Claim No. **K32454**
July 28/64

SHEET NUMBER 1
Coordinates of Collar 3352 N, 4792 E
LATITUDE (see attached map)
DEPARTURE
ELEVATION

SECTION FROM _____ TO _____
DATUM _____
BEARING 347°
DIP 60°

STARTED July 9/64.
COMPLETED July 14/64.
ULTIMATE DEPTH 150'
PROPOSED DEPTH 150'

Sample No

DEPTH FEET	FORMATION	SAMPLE NO.	FROM	TO	WIDTH	VALUES			
						GOLD AT	AT	AT	AT
0-14	Rhyolite or porphyry								
14-55	Andesite, green, mass, f.g., few quartz-feldspar veinlets up to 1 1/2" wide, traces pyrrhotite								
64-5-6 55-55'8"	" sheared, parallel streaks pyrrhotite (15%?) little chalcopyrite								
55'8"-57'6"	" lighter color, few " " "								
57'6"-63'3"	" green								
64-5-7 63'3"-66'8"	" 5% pyrrhotite, little chalcopyrite								
66'8"-71'9"	" mass, f granied								
64-5-8 71'9"-75'	" parallel streaks pyrrhotite (10%?) little chalcopyrite								
75-77'3"	" 1% pyrrhotite some chalc.								
77.3"-78	" grey, dense								
64-5-1 80-83'5"	" shist, pyrrhotite (10%?) some chalcopyrite + pyrite, few quartz veinlets								
85'3"-100	" dense becoming little coarser and dark green at depth.								
64-5-2	" 3%? quartz, 3% pyrrhotite 1% pyrite, little chalcopyrite (98'2"-99'9")								
100-123'10"	" or diorite, mass. green, slightly porphyritic in places, few minute quartz veinlets, traces pyrite								

RECEIVED
JUL 21 1964
KENORA MINING DIV.

NORTHERN MINER FORM 505

DRILLED BY Lake Superior Diamond Drilling Co.

SIGNED P. E. Hoffmann

DIAMOND DRILL RECORD, HOLE NO. 64-5

PROPERTY Hopkins-Hemtzman Shoal Lake Ont. CLAIM NO.
South Group, Glass Township K32454

SHEET NUMBER 2 SECTION FROM _____ TO _____ STARTED _____
 LATITUDE _____ DATUM _____ COMPLETED _____
 DEPARTURE _____ BEARING _____ ULTIMATE DEPTH _____
 ELEVATION _____ DIP _____ PROPOSED DEPTH _____

Sample No. ↓

DEPTH FEET	FORMATION	SAMPLE NO.	FROM	TO	WIDTH	VALUES			
						GOLD AT.....	AT.....	AT.....	AT.....
64-5-3	113 ⁰ "-113 ⁹ " wd. 9"								
64-5-4	121-122' 10 1/2" wd. 22 1/2"								
	123'10"-133- Porphyry or rhyolite, light grey								
	133-141'9" Andesite, dense, greenish, traces sulphides at 136'2"-136'10"								
	141'9"-150' Rhyolite, grey								
64-5-5	141'10"-143'5 30% quartz, 1% pyrrhotite, traces chalcopyrite								
	<u>End 150</u>								

RECEIVED
 JUL 21 1914
 MENORA MINING DIV.

NORTHERN MINER FORM 505

DRILLED BY Lake Superior D. D. Co.

SIGNED P. E. Hopkins
A. Hopkins.