



52E10SW8531 20 SHOAL LAKE

010

## Diamond Drilling

Area Shoal Lake

Report NO 20

Work performed by: P.E. Hopkins & J.D. Heintzman

Claim NO	Hole NO	Footage	Date	Note
K. 32667	E1	264'	Aug/61	
	E4	101'	Aug/61	
	E5	108'	Aug/61	
K. 32666	63-7	101.2'		

Notes:

SDM.  
copy

Collar on small bare rock island in Gossan Bay.

Coordinates of Collar: 14460'N., 3966'E. COMPANY Hopkins-Heintzman Shool Lake.

Claim No.

D.D.H. #63-7

Sp - 45° Strike 112°

PROPERTY Sirdar Peninsula, Glass top.

K-32666

6 June 63.

Sample No.	Mr/Hr	Dist. from ft	Formation	Width ft.	Assay Value	%	Cu %	Au. Oz.	Oz.	Remarks
		0.0	Casing	1.0						No core.
		1.0	Amphibolite	50.0						Fine-grained. Could be a coarse-grained high-amphibole andesite. Dark grey colour, cut by occasional stringer of quartz-carbonate.
1641		51.0 - 55.0		4.0						Schist mineralized by streaks of pyrite, pyrrhotite, & a little chalcopyrite.
1642		55.0 - 60.0		5.0						ditto
1643		65.0 - 72.0		7.0						ditto
		51.0	Breccia	50.2						Brecciated andesite, cut by some quartz-carbonate stringers and occasional narrow seams of pyrite and pyrrhotite.
		101.2	End of hole							

RECEIVED  
 JUN 17 1963  
 KENORA MINING DIV.

Purpose of the hole :- To intersect at depth the copper-bearing, iron-rich sulfid schist exposed in benches & shafts N. & S. of Gossan Bay, & to perform required assessment work.

The core is stored at campsite on S. side of Gossan Bay.

The core was logged by A. Hopkins, B.A. Sc.



Coordinates of Collar:

COMPANY Hopkins-Heintzman

Claim No.

D.D.H. # 2-5

Dip

Strike

PROPERTY Sirdar, Glass top, Shoal Lake, Kenora, Ont.

Sample No.	Mr/Hr	Dist. from ft	Formation	Width ft.	Assay Value	%	%	Oz.	Oz.	Remarks
										60.6' & 61.9' are $\frac{1}{2}$ " b q str., also a 63.4'.
										64.3'-64.6' is 90% q with a few specks of chalcopy.
										64.8', 65.3', 66.1', & 67.7' are $\frac{1}{2}$ " b q str.
903			68.8'-70.1'	1.3						Main "A" Sirdar vein (?): - 50% qtz, 10% sulfids, the balance being greenstone breccia, pyrro, pyrite, sphalerite, galena, mispickel, & chalcopy in descending order. 0.3' of this is dense greenstone containing such fine-grained sulfids.
										70.6'-70.7' is silky qtz with a few splashes of pyrro.
										71.0', 71.5', & 72.3', & 73.9' are $\frac{1}{2}$ " b q str.
										75.2' is a $\frac{1}{16}$ " b q str, & 76.8' is a $\frac{1}{2}$ " b q str, & 78.1' is a 1" q str, & 80.2' is a $\frac{1}{8}$ " b q str, & 82.9', 83.8', 84.3', 84.9', 85.5', 85.7', 86.5', & a 86.7' are $\frac{1}{2}$ " bull quartz stringers.
										88.7' is a $\frac{1}{2}$ " b q str, & 90.6' is a $\frac{1}{8}$ " b q str, & 91.0' is a 1" b q str, & 91.7' & 92.6' are $\frac{1}{2}$ " b q str.
										94.0' is a 1" b q str almost parallel to the core, & 95.5' is a $\frac{1}{2}$ " b q str, & 96.1' is a $\frac{1}{2}$ " b q str.
904			97.5'-102.0'	2.5						50% qtz with some sphal, pyrro, mispickel, & chalcopy.

(sulfids 5%, andesite breccia 4%). (Continued)

The collar is 50° back (westerly) from the vein under the "Cut-throat" pit, & is approx. 344' E. & 800' N. of No. 3 Post

Coordinates of Collar: 85°W, 1500'S.

COMPANY Hopkins-Maintz of K.32667.

Claim No.

D.D.H. # 1-5

Dip 45°

Strike 107°

PROPERTY Sirdar, Glass Inc., Shosil Lake, Renora, Ont.

K.32667

24 August 1961.

Sample No.	Mr/Hr	Dist. from ft	Formation	Width ft.	Assay Value	%	%	Oz.	Oz.	Remarks
		0.0	Casing	4.8						
		4.8	Andesite	103.2						Typical dark grey-green, fine-grained, with the occasional pyrite cube & qtz stringer, as at-
										12.0' 1/2" bull qtz stringer, 13.5' 1/2" pyrite cube,
										13.0' 1/2" bull qtz stringer, 15.9' 1/32" qtz stringer
										containing cubes & seams, 17.3' ditto, 17.9' a pyrite cube
										, 23.9' is a qtz stringer with pyrite cubes & seams, at
										25.5' is a 1/2" bull qtz stringer, at 27.0' is a 1" bull
										qtz stringer, at 28.9' is a 1/16" bull qtz stringer, ditto
										at 30.6 and at 31.9', at 33.0' is a 1/16" seam of
										chalcopy, at 33.9' is a 1/2" bull qtz stringer, at 35.0'
										is a 1/2" bull qtz stringer, at 36.4' is a 1/2" bull qtz str,
										at 37.3' is a 1" bull qtz str, at 37.5' is a pyrite cube,
										at 37.9' is a 1" bull qtz str, at 39.9' is a 1/2" b. qtz str,
										at 39.4' is a 1/2" b qtz str, at 40.8' is a 1/2" b qtz str with
										pyrite cubes, at 41.2' is a 1/2" bull qtz str, at 43.0' is
										an 1/8" b qtz str, at
										46.2'-46.3' is fine-grained pyrite.
										at 46.9' is a 1/2" bull qtz stringer, at 48.1' is pyrite in a

minute qtz str, at 57.3' is a 1/8" b qtz str. (Continued)

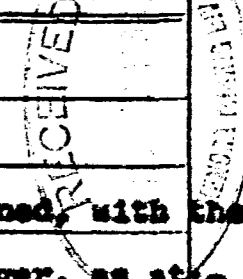

The collar is 45° back (easterly) from vein under pit A-4, I.K. 855' N & 429' E. of No. 3 post of K. 32667.

Coordinates of Collar: **0°E-W, 1445'S.** COMPANY Hopkins-Heintzman Claim No. \_\_\_\_\_ D.D.H. # **E-4**  
 Dip **-60°** Strike **287°** PROPERTY Sirdar, Glass twp., Shoal Lake, Kenora, Ont. **K. 32667** **24 August 1961.**

Sample No.	Mr/Hr	Dist. from ft	Formation	Width ft.	Assay Value	%	%	Oz.	Oz.	Remarks
		0.0	Casing	6.0						
		6.0	Porphyry	74.5						Grey, medium-grained, qtz-felspar porphyry, becoming finer-grained with depth.
										At 28.5' is a 1" altered sericitized zone.
										At 63.6' and at 74.1' are 1/8" bull quartz stringers.
								from 65.4		77.8' the porphyry is finer-grained and altered.
								from 77.8		80.5' it is coarser-grained and fresher-looking.
		80.5	Andesite	20.5						Typical grey-green, fine-grained lava.
905		85.0'-87.6'		2.6						Main zone (7) looks poor. 25% qtz, 1% sulfide, mainly pyrrho, with some chalcopy, py, & sinoblende
										At 100.1' is a 1/2" bull quartz stringer.
		101.0	End of hole.							<u>Note:</u> ore in Altho Hole E-1 failed to cut/the interesting Sirdar zone about 45' N. of this hole, it was felt that the zone deserved 2 more holes (E 4 & 5) The zone, altho cut here, was of academic interest only. The ore is now thought to be related to, and cut off by the porphyry intrusive. The core is stored by the collar. The core was logged

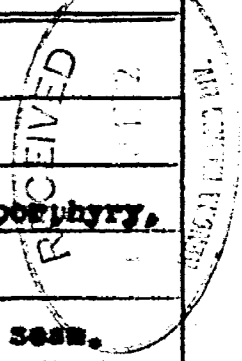

by: *Albert Hopkins, B.A.Sc.*

Coordinates of Collar:

COMPANY ~~Hopkins Heintzen~~

Claim No.

D.D.H. # **E-1**

Ap Strike

PROPERTY Sirdar, Glass top, Shoal Lake, Kenora.

Sample No.	Mr/Hr	Dist. from ft.	Formation	Width ft.	Assay Value	%	%	Oz.	Oz.	Remarks
										228.2 1/2" quartz stringer.
										228.9-229.3 40% quartz
										229.8 1/2" quartz stringer.
										232.4 3/4" quartz stringer.
										232.8 1" quartz stringer
										233.3 1/2" quartz stringer, also at 234.2 & 234.9' /
										237.9 1/2" quartz stringer.
		242.0	Andesite	12.0						High-amphibole (black needle-like crystals), altered, dark-green.
		254.0	Andesite	10.0						Typical, as from 198.6 to 242.0'.
										252.5 1/2" quartz stringer.
										263.6 1/2" quartz stringer.
		264.0	End of hole.							
										Note. This hole was drilled to cut and sample the "Sirdar" zone, and to test the low ground to the west of the Sirdar "A" showings. The hole failed to cut ore, and if the A zone was intersected at all, it must have been at Sample No. 3017. The drill core is stored near the collar of the

hole. This hole was logged by

Coordinates of Collar:

COMPANY Hopkins - Reintzman

Claim No.

D.D.H. #

E-1

ip

Strike

PROPERTY Sirdar, Glass tw., Shoal Lake, Kenora.

Sample No.	Mr/ Hr	Dist. from ft	Formation	Width ft.	Assay Value	%	%	Oz.	Oz.	Remarks
		143.5	Diorite	15.3						Hb-rich, dark coloured, altered, like above diorite
										144.1 144.1 1" of 50% quartz.
										147.6 Several seams of quartz.
										148.4 1/16" quartz seams, and ditto at 149.4', 150.5',
										150.9', 151.5', 152.1', 153.2', 153.4', 154.7', 157.8',
										and 153.8'.
		153.8	Andesite	36.4						As above, but shows some flow structure.
										158.8 1/16" quartz seams, also at 164.0', 164.2', 166.0',
										169.0', 170.2', <del>171.0'</del>
										171.0 Ditto with some pyrrhotite.
										172.6 Ditto with some haematite.
		195.2	Basalt	3.4						Black f.g. lava, fractured, with some py cubes
										e.g. 195.7'
		198.6	Andesite	43.4						As above.
										208.5 1/2" of 50% quartz.
										208.6 An 1/8" diam. py cube.
										211.5 1/4" quartz containing py cubes.
										213.2 3/4" quartz.
										213.9 1/2" quartz, also at 215.2', 217.0', 217.1', and

at 221.4'.

(cont'd)



Coordinates of Collar:

COMPANY Hopkins - Heintzman

Claim No. \_\_\_\_\_

D.D.H. # E-1

Dip

Strike

PROPERTY Sirdar, Glass twp., Shoal Lake, Kenora.

Sample No.	Mr/Hr	Dist. from ft.	Formation	Width ft.	Assay Value	%	%	Oz.	Oz.	Remarks
		34.9	Diorite	11.4						Hb-rich, as above.
									86.0	½" qtz str.
									88.3	1/8" qtz str.
									89.0	½" qtz str.
								92.7	92.7	ditto
									93.3	1.8" qtz str.
									94.4	ditto
		96.3	Andesite	47.2						As above.
									96.0	½" qtz str.
									97.0	½" qtz str.
									98.8	ditto
									100.4	½" qtz str.
									105.6	1" of 50% qtz.
									108.5	1/8" qtz str.
									114.6-114.7	1" of 50% qtz.
									117.8-118.4	25% qtz with some talc & seric.
									118.8-118.9	50% quartz
									119.7	½" of 50% qtz mineralized with pyrrhotite.
									127.2	½" of quartz.

(continued)

Coordinates of Collar:

COMPANY Hookins - Heintzman

Claim No.

D.D.H. # 5-1

ip

Strike

PROPERTY Sirdar, Glass twp., Shoal Lake, Kenora.

Sample No.	Mr/Hr	Dist. from ft.	Formation	Width ft.	Assay Value	%	%	Oz.	Oz.	at Footage	Remarks
										47.7	1/8" qtz seam
										49.0-49.6'	qtz stringer zone, 25% bull qtz strgrs.
		46.7	Diorite	5.2.2							Probably Keewatin, altered, fractured.:-
										46.7-49.0	Hb-rich contact zone, green in colour.
										49.0-51.9	Slightly porphyritic, dark green to black.
										51.3	1/2" qtz str.
										51.6	ditto.
		51.9	Andesite	13.1							grey, fine-grained, fractured, slightly greenish:-
										52.8	1/2" qtz str.
										53.0	ditto
										53.5-54.3	50% qtz str with sparse sulfids (chalcopy).
										56.8	1/8" qtz seam.
										61.6	ditto
										63.7	1" qtz seam.
3025			whole core.							64.3-65.0	50% qtz, sparse sulfs. (chalcopy).
		65.0	Diorite	1.1							Dark, Hb-rich.
										66.1	1/8" qtz str.
		66.1	Andesite	18.8							As above.
										84.3	1/16" qtz str.
										84.9	1/2" qtz. str.

(cont'd)

29° W. 1.9. 900' N. & 400' E. of No. 3 post of K. 32667.

Coordinates of Collar: **CE, 1400'S.**

COMPANY **P.E. Hopkins & J.D. Heintzman**

Claim No. **K.32667** D.D.H. # **E-1.**

Dip **-39°** Strike **287°**

PROPERTY **Sirdar, Glass twp., Shoal Lake, Kenora, Ont.**

Logged by **A. Hopkins, B.A.Sc.** 16 Aug. 1961.

32667

Sample No.	Mr/Hr	Dist. from ft	Formation	Width ft.	Assay Value	%	%	Oz.	Oz.	ft footage	Remarks
		0.0	Casing	3.0							No core.
		3.0	Andesite	43.7							medium-grained, dark greenish-grey, fractured, the fractures often filled with rust, qtz, or carbs.:-
										5.5	Rust
										5.9	Rust
										10.5	1' qtz with sparse chalcopy, py, & pyrro on walls.
										22.5	A sliver of qtz.
										23.3	ditto
										25.4	2 ditto.
										27.4	A few coarse-grained pyrite cubes.
										30.4	An 1/8" qtz seam.
										31.2	1/2" qtz seam.
3017			32.0'-34.8'							32.0-32.5'	50% qtz, a few e.g. py cubes & sparse chalcopy & pyrro.
										33.6-34.8	ditto 40.1 1/2" qtz seam
										35.9	1/8" qtz seam 40.4 ditto
										36.1	ditto 40.9 ditto
										36.3	1/2" qtz seam. 41.2 1/8" qtz seam
										37.2	1/2" qtz seam. 41.3 ditto
										38.1	1/8" qtz seam 41.9 ditto with e.g. py cube in it.
										39.0	ditto 42.3 1/2" qtz seam.
										39.6	1/2" qtz seam 43.5 1/16" qtz seam.

(continued)

RECEIVED  
FEB 10 1962  
KENDRA MINING CO.  
JAN 1962

SIRDAR ZONE

HOPKINS-HEINTZMAN GOLD PROSPECT  
Glass Twp., Shoal Lake Kenora Area  
Ontario  
SCALE 1" = 40 FEET  
Hopkins Mining Consultants Ltd.


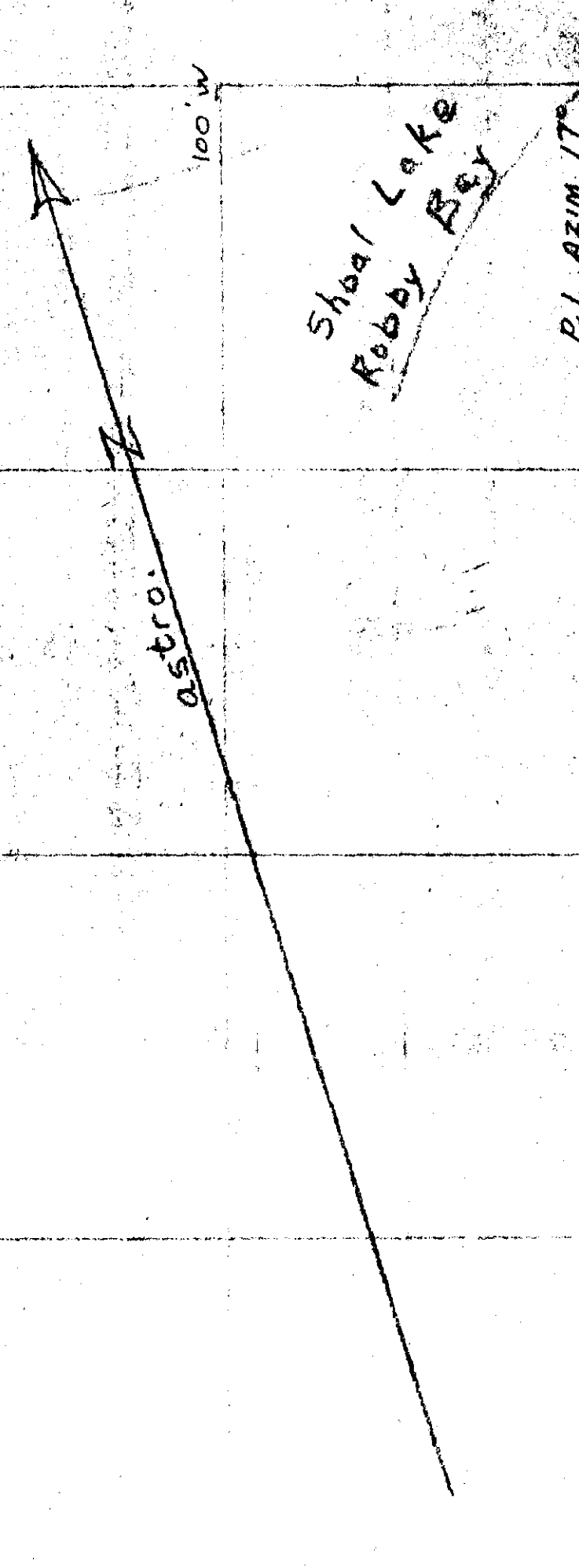

GOESAN BAY  
Sulph. Zone on  
Lake shore @ 600'W

K 32666 / K 32667  
claim / Posts  
K 32665 / K 32664

200' W  
200' E



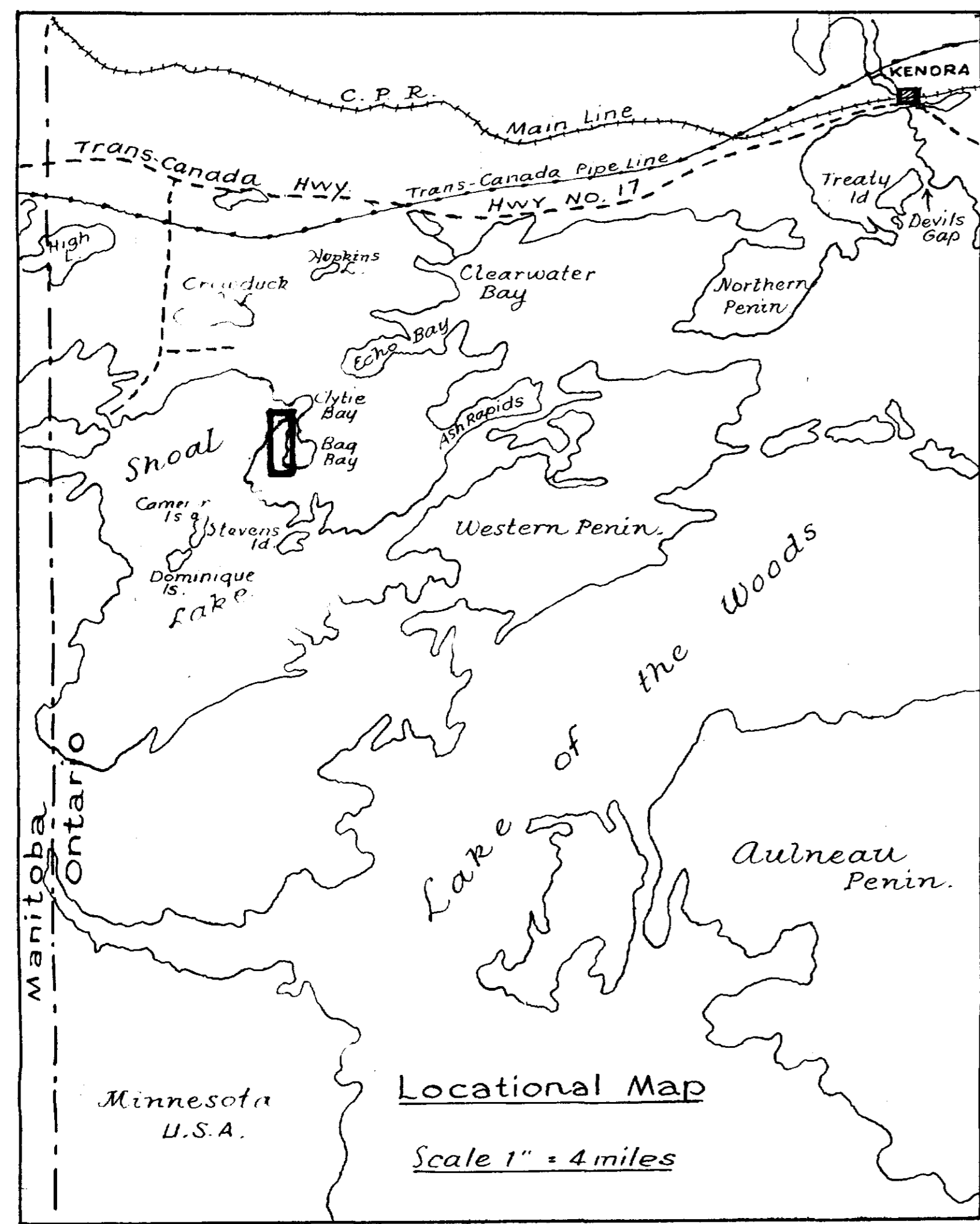

**Legend**

x	Outcrop or Specimen	vfg	Very fine-Grained
1A	Andesite	af	Altered or fresh
1B	Basalt	sl	Slightly
1C	Rhyolite	lo	Low
1D	Pillow Lava	hi	High
2A	Amphibolite	grnd	Ground
2B	Pyroxenite	sil	Siliceous
2C	Gabbro	pyrr	Pyrrhotite
2D	Diorite	hiA	High in Amphibole
2E	Peridotite	vdip	Vertical Dip
3A	Felsite (Porphyry)	di	Dip and Strike
3B	Granite - Porphyry	ca	Outcrop Area outline
3C	Amphibole - Porphyry	tr	Trail
3D	Diorite - Porphyry	sw	Swamp, wet
3E	Quartz vein	gf	Green forest
4A	Carbonate or Carbonatized	st	Stream
4B	Bull-quartz (Glassy)	ds	Drainage Slope
4C	Trace in cold	esd	Glacial Striae Direction
4D	Fault, assumed	cl	Claim Line
4E	Pyrite or Pyritized Chalcopyrite	scf	Survey Claim Post - found
4F	Arsenical or Arsenopyrite, Zinc	tp	Theoretical Claim Post position
4G	Gossan	uf	Unsurveyed Claim Post - found
5	Sheared	b	Boulders
5A	Schist	ob	Overburden, sand, gravel clay, loam, drift (uncoloured)
5B	Fine-Grained (less than 1/8 grain)	oc	Outcrop of bedrock
5C	Medium-Grained (1/8 to 1/4 grain)	trb	Trench to bedrock
5D	Coarse-Grained (1/4 to 1/2 grain)	et	Earth Trench
5E	Ankerite, rusty carb.	str	Stringer, veinlet
5F	Sample No.	wp	Witness Post
5G	Trachyte	ph	Porphyry unclassified
5H	Spruce balsam, & pine bush	gn	Gneissic
5I	Cedar bush	ir	Iron-rich
5J	Marsh, grassy	fl	Float
5K	Hardwood, birch & deciduous trees	dm	D.D. Hole
5L	Phenocrysts up to 1/2"	rd	Rock Dump
5M	Light-coloured	dc	Dark coloured
5N	Dark	hs	Hypothetical Shear (from Walker's Photo interpretation)
A1	Hypothetical Fault (from Walker's Photo interpretation)	os	Hypothetical Shear (from Walker)

168N  
165N  
162N  
159N  
156N  
153N  
150N  
147N  
144N  
141N  
138N  
135N  
132N  
129N  
126N  
123N  
120N  
117N  
114N  
111N  
108N  
105N  
102N



RECEIVED JUN 17 1962  
MINN. MINN. CO.

1968 Assumed Belt  
2 Rock Dumps  
Gossan  
Magnetic Bay

