



52E10SW8541 10 SHOAL LAKE

010

Diamond Drilling

Area of SHOAL LAKE

Report NO 10

Work performed by: Barbara Machin

Claim NO	Hole NO	Footage	Date	Note
K 13773	1	47.0'	Oct/50	
	2	53.0'	Oct/50	
	3	63.0'	Oct/50	
	1	76.0'	1952	
	2	84.0'	1952	

Notes:

Barbore-Machin Group

OCT. 1950

Claim No 13773

Olympic Mine
Stellivon Bay

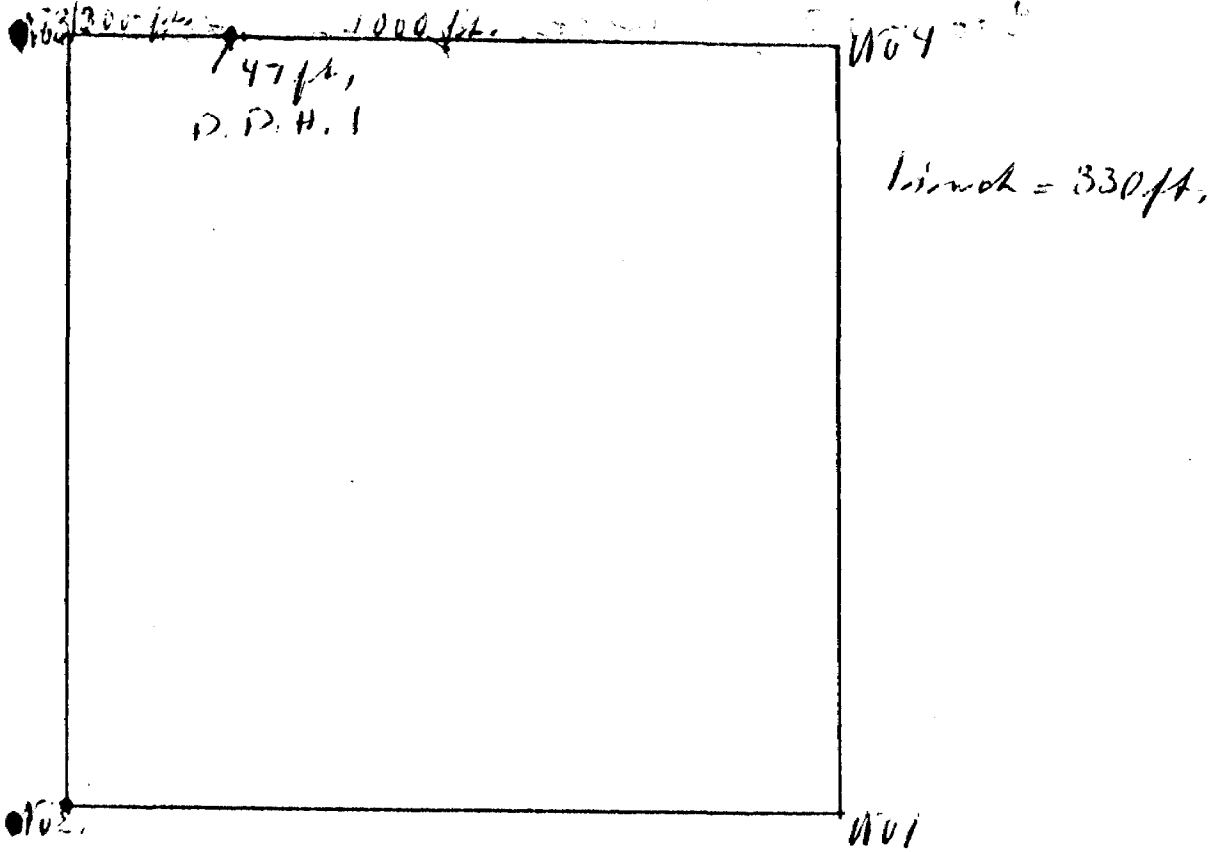

D, D, H, 1 dia. S. E

450

47 ft.

No overburden

Stress vertical

No fault visible

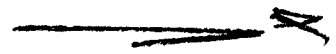

Sipped by J. Elwert Kenora, Ont.
 Core saved at Gold Point Bar
 over

0-128 ft. vol. glycerine
23-246
24-47 vol. glycerine

Barlowe Machine Group

Oct. 1950

Phylogia on
Heldriver Bay

Claim No 13773

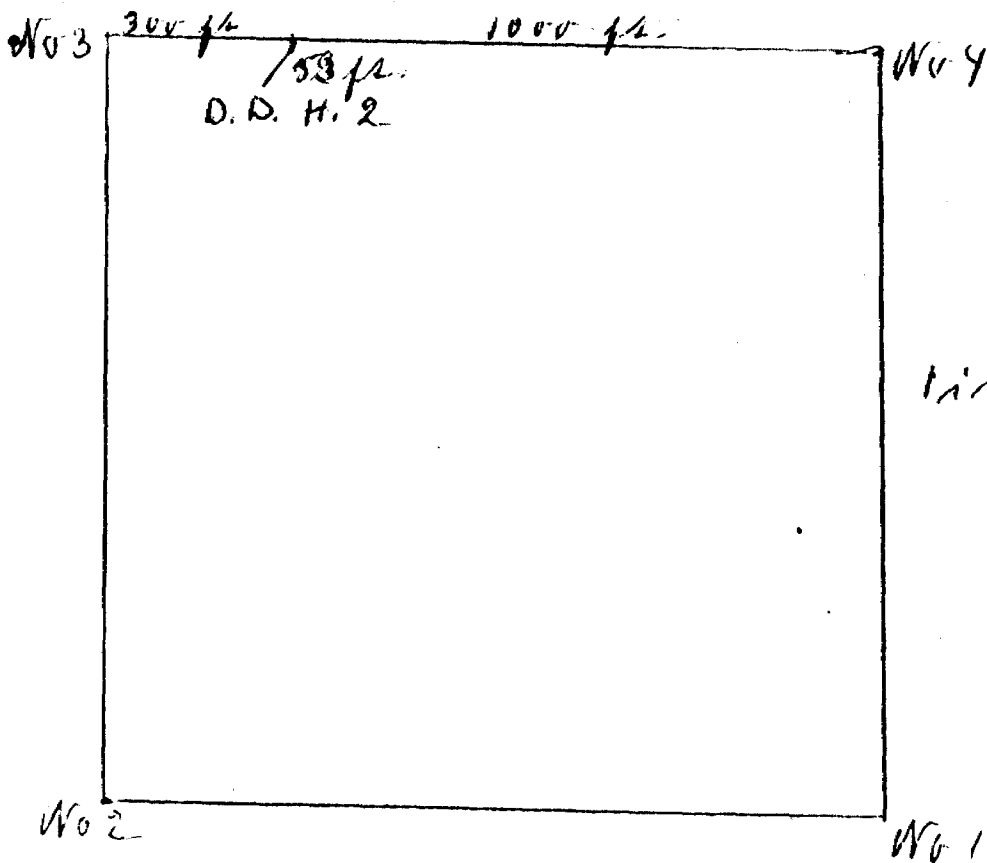

D.D. H. 2 dir. S E

52 ft.

550

No overburden

Strata vertical

No faults visible

Bore logged by J. Herbert Kenmore, Ont.

Bore started at Gold Point Farm

over

10-1-21 5
215-238-111

volc. greenstone

quartzite

23-52

volc. greenstone

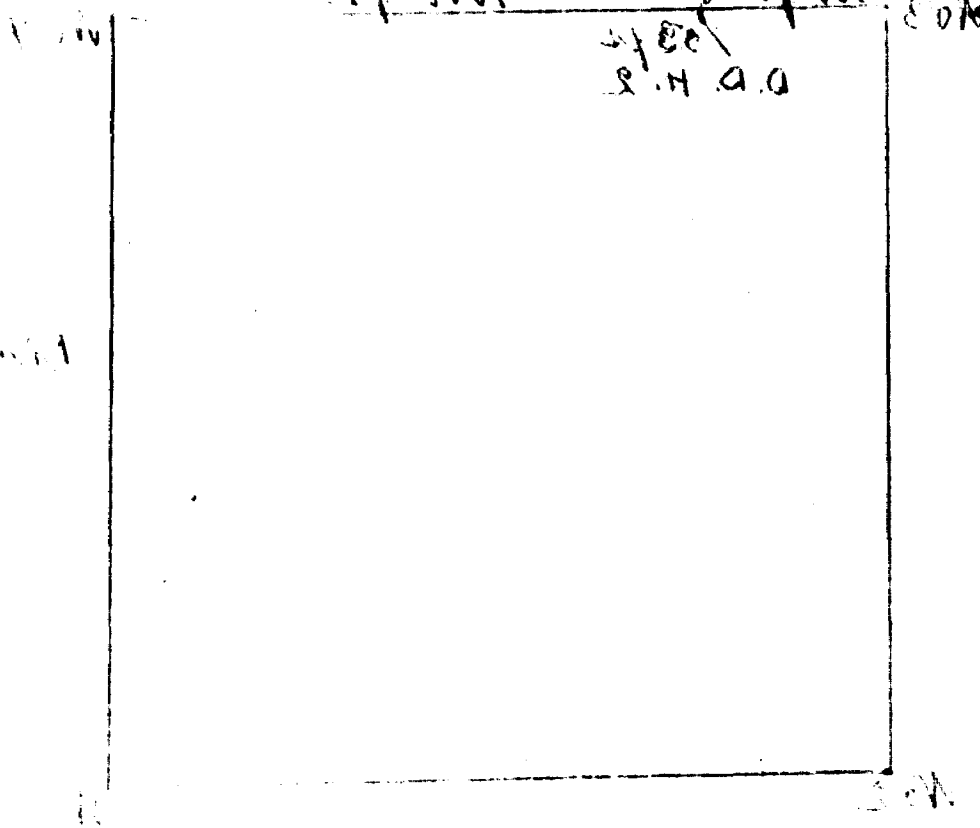

1988

1988

1988

1988

Barbara Mechin - Hydrogeology

Olympic Mine
Heldison Bay

OCT. 1950

U.S. Geol. Surv. No. 13773

D.P. - D. 84
D.P. - D. 84

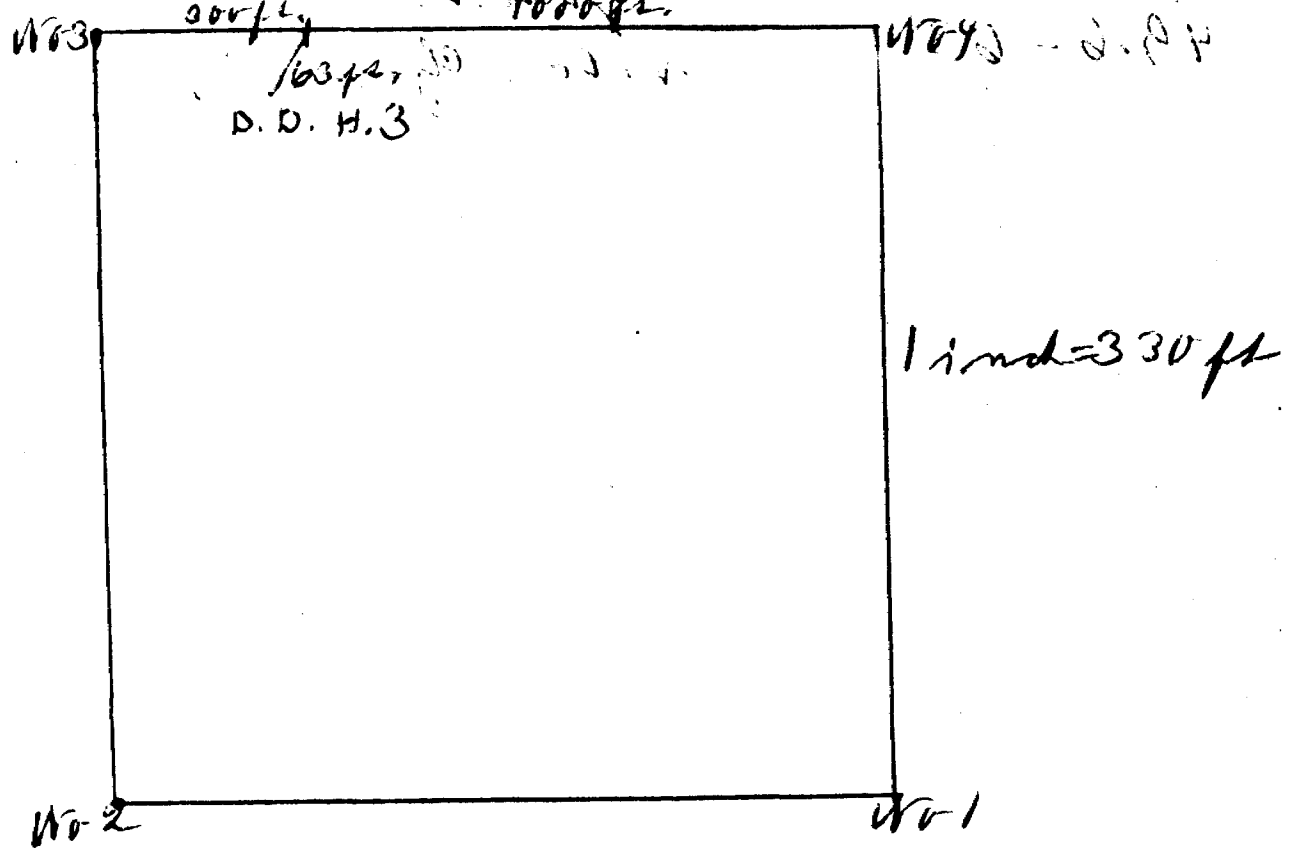

D. D. H. 3 dir. S. E

750

63 ft.

No overburden

Strike vertical

No faults visible

Core logged by J. Elvert, Kenore, Ont.
Core stored at Gold Point Farm

over

26 - 29
 29 - 48.6
 48.6 - 49.6
 49.6 - 613.1

nrb. glycerochrome
 quartz

nrb. glycerochrome
 quartz

nrb. glycerochrome
 quartz

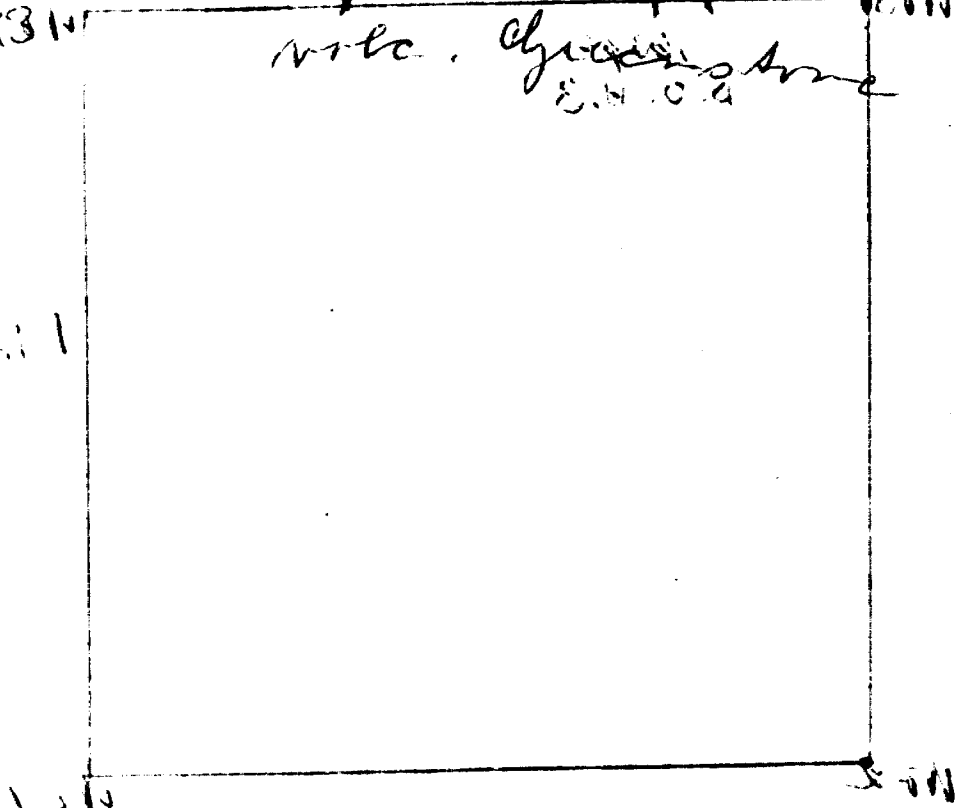

49.6 - 613.1

D.D.H.8

The first section of the
 ...
 ...
 ...

Claim # K 13773

Hell Diver BAY

SHOAL LAKE AREA ← 1952

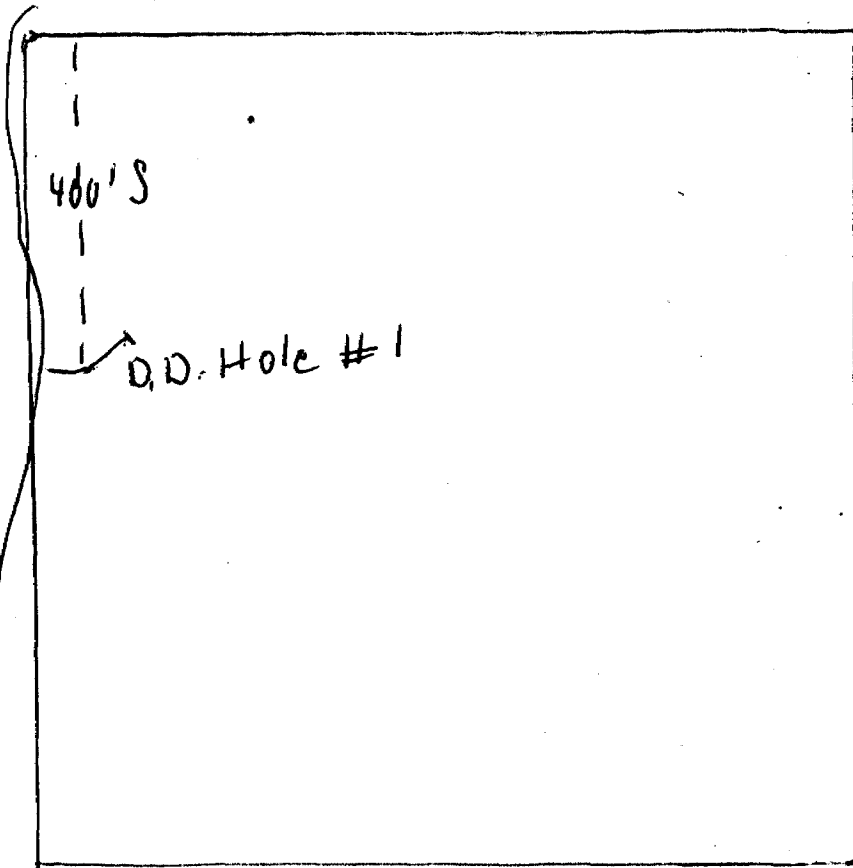

Direction N.E.

Angle 45°

Length 76'

No overburden.

0-68 ft Limestone

68-70 ft quartz bands min.

70-76 ft Basals

logged: Jack Elwert, Renore

Stored at Gold Point Farm camp.

Claim # K 13773

Hell River Bay

1952

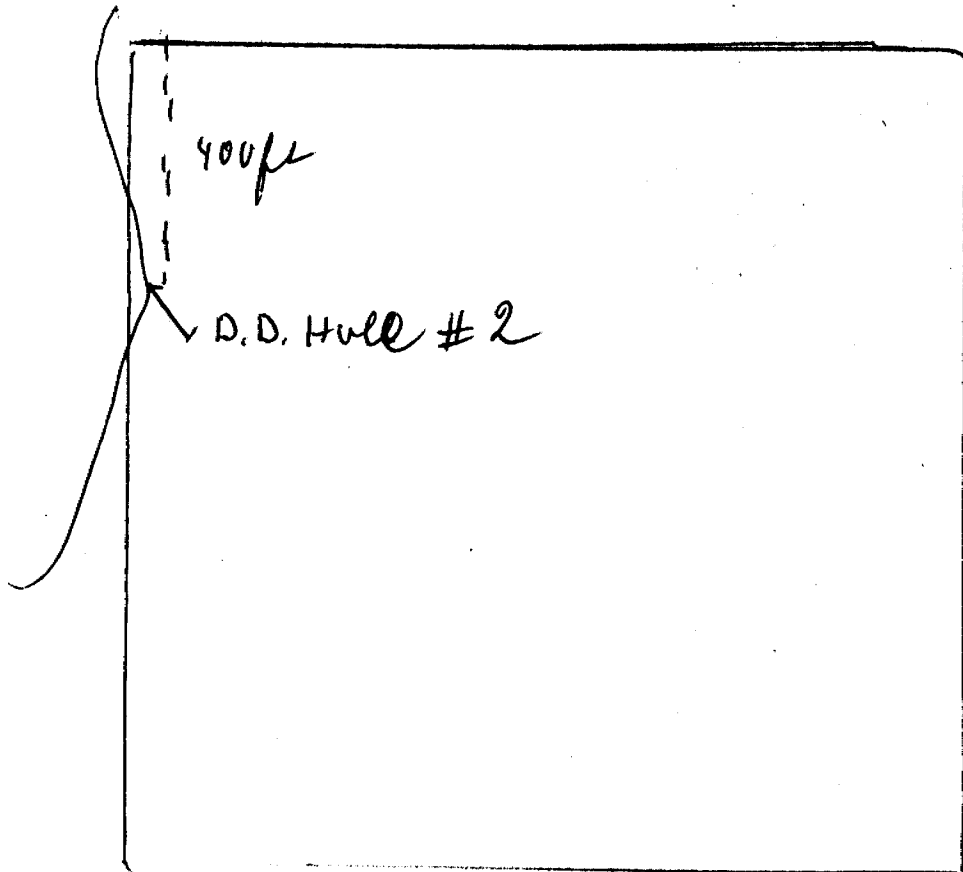

Direction S. E.,

Length 841

Angle 45°

No overburden

0 - 79 ft. Greenstone

79 - 81½ ft. quartz bands min.

81½ ft - 84 ft Basalt

logged: Jack Oliver Renore
Stored at Gold Point Farm Camp.