



DATE: January 30, 1992

NAME: Black Sturgeon Property

LIST OF INDIVIDUALS WHO APPLIED FOR ASSISTANCE FOR THIS PROJECT:
George R. Zebruck

LOCATION AND ACCESS: By truck via Airport Road and Jones Road.
Haycock Township

CHANGES TO PROPOSED PROJECT: Did not do backhoe trenching

GEOLOGY: Quartz veins in sheared granodiorite in eastern part of property. Mafic volcanic and Ultramafic rocks in western part of property.

WORK DONE: Prospecting and sampling done to determine location of gold mineralization in known veins. Bulk sample (small) taken to get better idea of grade at East Zone because assays tend to be erratic, sometimes very high (suggests possible nugget effect. Prospect for other showings. See Attached Maps of sample locations

RESULTS AND RECOMMENDATIONS:

Gold assays up to 1.966 oz. per ton were obtained by samples taken on the East Zone. Values are erratic so a bulk composite chip sample was sent to Casbyn Research to give us a better understanding of a true grade. Results of these tests indicate an overall grade in quartz vein material of .30 oz./ton. 98% of the gold was extracted within 24 hours with little solution loss indicating a relatively free milling gold situation. Shaft zone showed poorer results but gold is present in both quartz vein and sheared granodiorite at this location. A junior company should be found to do a more extensive exploration program on the property. Veins show good continuity over long strike lengths greater than 1 mile. Veins unfortunately are narrow but there seems to be a number of them and more exploration is needed to test the properties.

PROSPECTING DAILY LOG

<u>Project Area</u>	<u>Date</u>	<u>Work Performed</u>
Black Sturgeon Property	May 9	Prospected along shore of Island Lake Claim K 899596 and between lake and west boundary of this claim. 0 samples
	May 10	Property visit with Goldfields. Sampled shaft and east zones. 10 samples + 2 checks. 1 sample from old pit on pipeline.
	May 11	Prospected in area near south boundary of claims K899600 and 899595. Located old pit previously unmapped. 1 sample taken.
	May 23	Property visit with Rio Algom. Prospected area of shaft and east zones and extensions onto G Pogson ground with G. Pogson. To look at continuity of vein systems on both properties. No samples taken.
	June 20	Chip sampling on east zone for large composite sample.
	June 20	Chip sampling on east zone for large composite sample. Sent to Casymyn Research and Engineering for cyanide leach tests of complete sample 50 lbs.

Location of Prospecting

- area outlined on claim map
- detailed sketch attached

Description of Samples

Sample No.	Type of Sample	Rock Type	Mineralization	Assay Results
East Zone				
RC-6891	2 ft. chip	quartz vein	py	.271 Oz/Ton
RC-6892	1 ft. chip	quartz vein	fine py	.158
RC-6893	3 ft. chip	sh'd bio. gran.	fine py	.019
RC-6894	4 ft. chip	quartz vein	fine py	.574
RC-6895	2 ft. chip	quartz vein	fine py	1.966
RC-6896	2 ft. chip	sh'd bio. gran.	fine py	.066
RC-6897	4 ft. chip	qv.+ sh'd bio. gran.	fine py	.015

Sample No	Type of Sample	Rock Type	Mineralization	Assay Results
RC-6898	grab	sh'd carb. basalt	py	.001 Oz/Ton
Shaft Zone				
RC-6899	2 ft. chip	quartz vein	fine py	.011
RC-6900	2.5 ft. chip	qv.+ sh'd bio. gran.	fine py	.006
RC-6900	check			.007
RC-6901	grab	sh'd bio. gran.	fine py	.046
RC-6901	check			.057
23623	grab	sheared basalt	fine py,po	4 (ppb)
East Zone				
326	Composite chip	quartz vein	fine py	9.35 (g/ton)
327	" "	" "	" "	7.94
335	" "	" "	" "	9.57
336	" "	" "	" "	9.54

BLACK STURGEON PROPERTY
 HAYCOCK TWP., ONTARIO
 NTS: 52 E 16
 BLACK STURGEON SHAFT AREA
 ROCK SAMPLE LOCATION MAP
 CLAIM # 899597

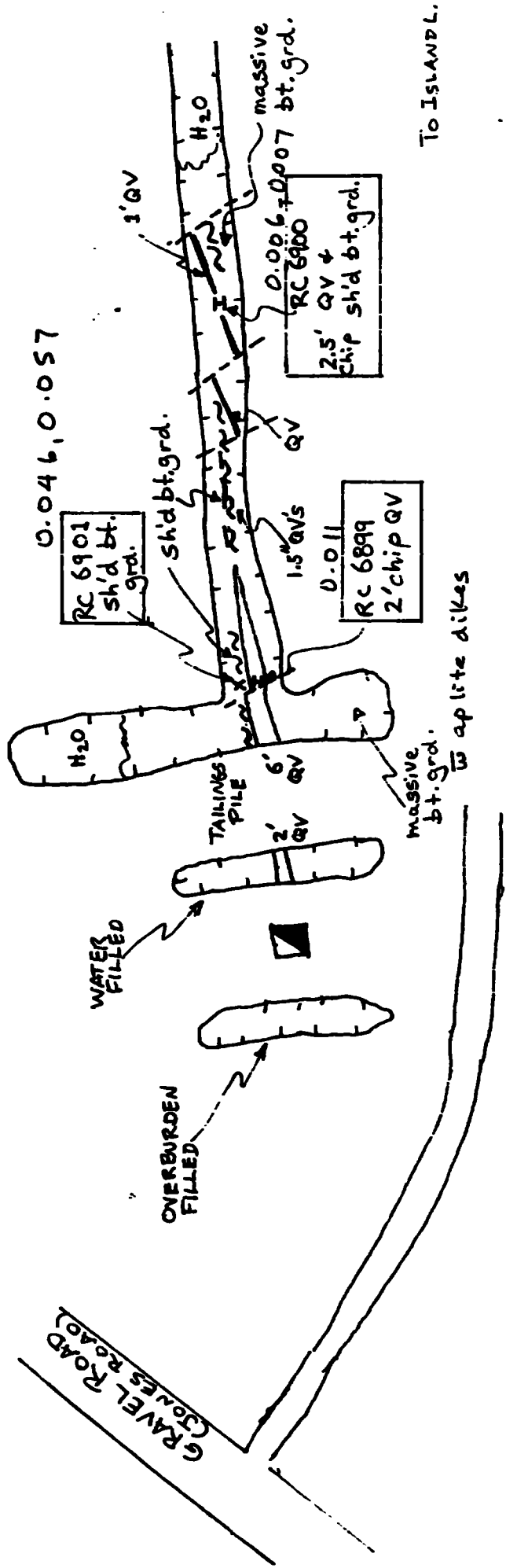

"While we believe this information to have been obtained in accordance with standard industry practices, we make no representation with respect to, nor do we assume any responsibility for the correctness thereof."
 GOLD FIELDS CANADIAN MINING LTD.

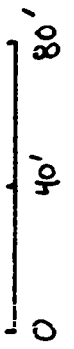

1" = 40'

I	chip sample
X	grab sample
~ ~ ~	shearing (sh'd)
- - -	cross faulting
QV	quartz vein.
▣	shaft
bt grad.	biotite granodiorite

BLACK STURGEON PROPERTY
 HAYCOCK TWP., ONTARIO
 NTS: 52 E 16

EAST SHOWING
 ROCK SAMPLE LOCATION
 CLAIM # 899597

While we believe this information to have been obtained in accordance with standard industry practices, we make no representation with respect to, nor do we assume any responsibility for the correctness thereof.
 GOLD FIELDS CANADIAN MINING, LTD.

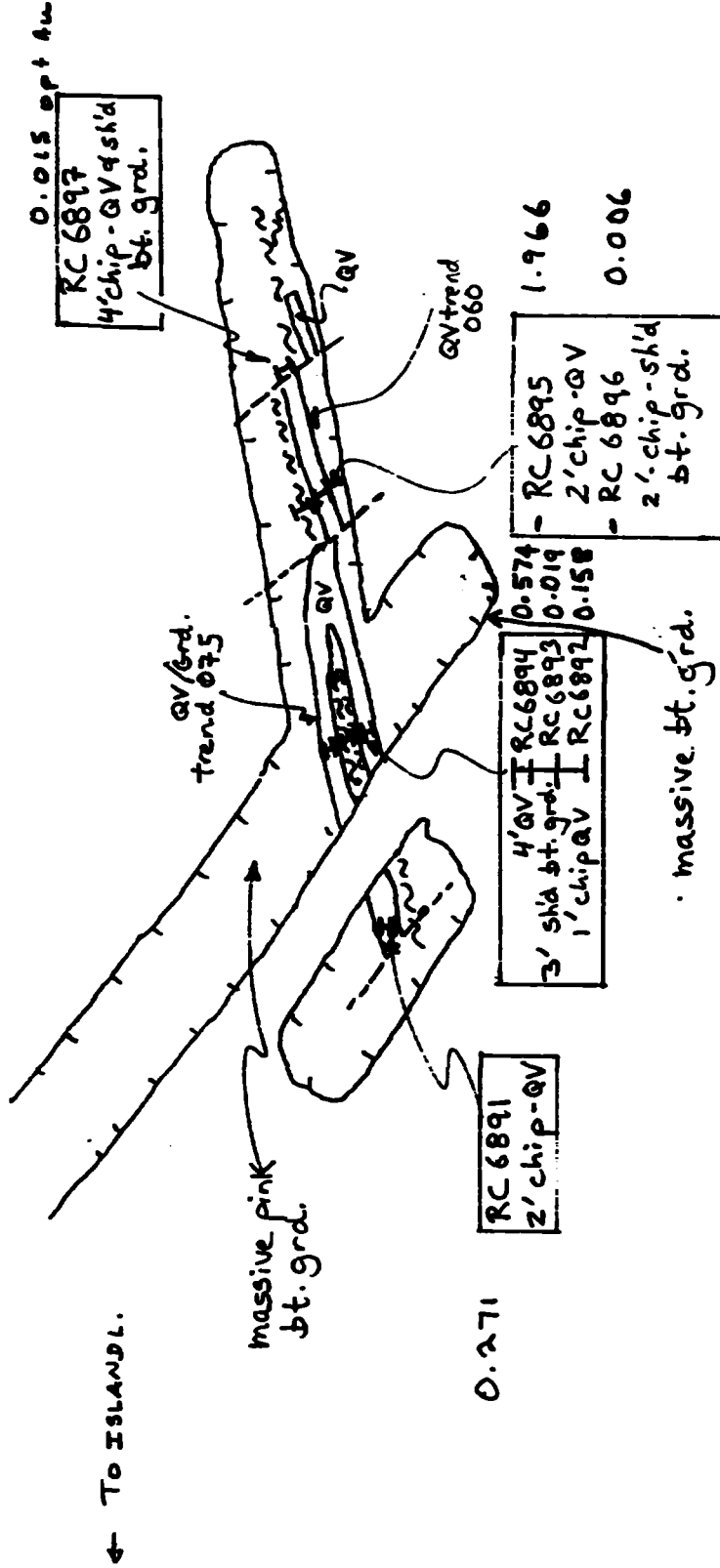

I - chip sample
 --- - shearing (sk'd)
 - - - - - cross fault
 bt. grd. - biotite granoditic
 QV - quartz vein
 NOTE: Pyrite in QV vugs

TKM / C.V. / MAY 10 1901



ACCURASSAY LABORATORIES
 A DIVISION OF BARRINGER LABORATORIES LIMITED, REXDALE, ONTARIO
 BOX 426
 KIRKLAND LAKE, ONTARIO, CANADA P2N 3J1
 TEL.: (705) 567-3361

RECEIVED MAY 23 1991
 G.F.M. - TB

President: Dr. GEORGE DUNCAN, M.Sc., Ph. D., C. Chem (Ont.), C. Chem (U.K.), M.C.I.C., M.R.S.C., A.R.C.S.T.

43578

Certificate of Analysis

Page: 1

Gold Fields Canadian Mining
 886 B Alloy Place
 THUNDER BAY, ONTARIO
 P7B 6E6

May 15

91

Work Order # : T910218
 Project : TB-KM-91-3

SAMPLE NUMBERS		Gold	Gold
Accurassay	Customer	ppb	Oz/T
543718	RC-6891	9325	0.271
543719	RC-6892	5444	0.158
543720	RC-6893	640	0.019
543721	RC-6894	19709	0.574
543722	RC-6895	67550	1.966
543723	RC-6896	194	0.006
543724	RC-6897	517	0.015
543725	RC-6898	10	0.001 - From side of old pit on pipeline.
543726	RC-6899	380	0.011
543727	RC-6900	223	0.006
543727	RC-6900	233	0.007 Check
543728	RC-6901	1576	0.046
543728	RC-6901	1947	0.057 Check

While we believe this information to have been obtained in accordance with standard industry practices, we make no representation with respect to, nor do we assume any responsibility for the correctness thereof.
 GOLD FIELDS CANADIAN MINING LTD

FILE # 91-31
 BLACK STURGEON PROPERTY,
 HAYCOCK TWP., NTS: 52-E-16
 N.W. ONTARIO

Per: George Duncan

ORIGINAL

GOLD FIELDS
CANADIAN MINING LIMITED

Gold Fields

886B Alloy Place
Thunder Bay, Ontario
P7B 6E6
Telephone: 807-345-6222
Facsimile: 807-345-6919

Citybank Place
123 Front Street West, Suite 909
Toronto, Ontario M5J 2M2
Telephone
416 865 0945
Facsimile
416 865 0641

May 31, 1991

Mr. George Zebruck
R.R.1 Airport Road
KENORA, Ontario
P9N 3W7

RE: Black Sturgeon Property

Dear Mr. Zebruck:

Thank you for your assistance in helping us evaluate your Property in Haycock Twp., Ontario.

After having reviewed the data, Gold Fields has decided not to pursue an interest in your Property at this time.

Please find enclosed sample location maps and a Certificate of Analysis as you requested, as well as, the data you so kindly allowed us to review and which you requested we return to you.

Gold Fields appreciates having properties brought to our attention and looks forward to hearing from you in the future. Best wishes with your exploration efforts.

Sincerely,

GOLD FIELDS CANADIAN MINING LIMITED



J. Kevin Montgomery
Project Geologist
Thunder Bay Office

JKM:jg
Encls.

Rio Algom Exploration Inc.

July 3, 1991

Mr. George Zebruk
RR # 1,
Airport Road
Kenora, Ontario
P9N 3W7

Dear George,

Thank you for taking me out to your Black Sturgeon and Princess Properties in late May.

As I mentioned during the property exams Rio Algom is not interested in optioning either property due to the limited size potential.

Your presentation of the Black Sturgeon with G. Pogson's Island Lake property enhances both properties considerably. I agree with your suggestion that the showings align and may be the same structure. Your property is very similar to the Eagle River (Central Crude) property in the Mishibishi Belt near Wawa, Ontario.

The gold showing do not have the size potential required by Rio Algom. Your property may be suitable for junior mining companies and possibly some majors. Portions of the vein (the "East Zone") may also be conducive to small scale mining if you are so inclined.

Don't give up on trying to sell the property. I am sure you will find a suitable partner.

Best Regards,

Betty Morrison

you: Kevin Kivi
Geologist

A subsidiary of Rio Algom Limited

CLIENT : GEORGE ZEIRLUCK
 PROJECT : 91-C-125
 SUBJECT : +10 MESH LEACH TESTS
 DATE : JULY 3, 1991

BOTTLE ROLL +10 MESH MATERIAL

SAMPLE WEIGHT (g)	24 HR		46 HR		72 HR		96 HR		24 HR		46 HR		72 HR		96 HR		GOLD IN RESIDUE (g)	TOTAL GOLD (g)	CALC. HEAD GRADE (g/t)	GOLD EXTRACT (%)
	SOLUTION WEIGHT (g)	WEIGHT (g)	SOLUTION WEIGHT (g)	WEIGHT (g)	SOLUTION WEIGHT (g)	WEIGHT (g)	SOLUTION WEIGHT (g)	WEIGHT (g)	SOLUTION ASSAY (ppm)	ASSAY (ppm)	SOLUTION ASSAY (ppm)	ASSAY (ppm)	SOLUTION ASSAY (ppm)	ASSAY (ppm)	SOLUTION ASSAY (ppm)	ASSAY (ppm)				
342	1200	2390	2360	2340	2320	2320	0.96	1.07	1.26	1.40	0.003248	0.00470	0.00795	6.62	40.86%					

C.G.L. OF +10 MESH MATERIAL FOR BOTTLE ROLL RESIDUE GRADE DETERMINATION

SAMPLE WEIGHT (g)	24 HR		46 HR		72 HR		96 HR		24 HR		46 HR		72 HR		96 HR		TOTAL GOLD (g)	CALC. HEAD ASSAY (g/t)	CGL GOLD RECOVERY (%)
	SOLUTION WEIGHT (g)	WEIGHT (g)	SOLUTION WEIGHT (g)	WEIGHT (g)	SOLUTION WEIGHT (g)	WEIGHT (g)	SOLUTION WEIGHT (g)	WEIGHT (g)	SOLUTION ASSAY (ppm)	ASSAY (ppm)	SOLUTION ASSAY (ppm)	ASSAY (ppm)	SOLUTION ASSAY (ppm)	ASSAY (ppm)	SOLUTION ASSAY (ppm)	ASSAY (ppm)			
91-C125-342	1200	1500	3.10	43	0.00465	0.00005	0.00470	3.92	96.90%										

CLIENT : GEORGE ZERNICK
 PROJECT : 91-C-125
 SUBJECT : BOTTLE LEACH - BLACK STURGEON MINE, EAST ZONE
 DATE : JUNE 26, 1991

BOTTLE ROLL TESTS ON FINE GROUND MATERIAL FOR BEST CASE EXTRACTION

SAMPLE	GRIND SIZE % MINUS 200	SAMPLE WEIGHT (g)	24 HR		48 HR		72 HR		24 HR		48 HR		72 HR		GOLD IN RESIDUE (g)	TOTAL GOLD (g)	CALC. HEAD ASSAY (g/c)	% XTRN FROM BOTTLE ROLL
			SOLUTION WEIGHT (g)	SOLUTION WEIGHT (g)	SOLUTION WEIGHT (g)	SOLUTION WEIGHT (g)	SOLUTION ASSAY (ppm)	SOLUTION ASSAY (ppm)	SOLUTION ASSAY (ppm)	SOLUTION ASSAY (ppm)	SOLUTION ASSAY (ppm)	SOLUTION ASSAY (ppm)	SOLUTION ASSAY (ppm)	SOLUTION ASSAY (ppm)				
326	78.1	1221	2000	1985	1970	5.60	5.60	5.60	5.60	5.60	5.60	5.60	5.60	5.60	0.000195	0.01142	9.35	98.31%
327	78.1	1118	2000	1985	1970	4.49	4.49	4.42	4.42	4.42	4.42	4.42	4.42	4.42	0.000766	0.00887	7.94	98.52%
335	60.9	1160	2080	1985	1970	5.10	5.10	5.00	5.00	5.00	5.00	5.00	5.00	5.00	0.010972	0.01110	9.57	98.79%
336	60.9	1118	2000	1985	1970	5.32	5.32	5.38	5.38	5.38	5.38	5.38	5.38	5.38	0.010559	0.01066	9.54	98.98%

CGL FOR BOTTLE ROLL RESIDUE GRADE DETERMINATION

SAMPLE	SAMPLE WEIGHT (g)	SOLUTION		SOLIDS		GOLD IN SOLUTION		TOTAL GOLD		CALC. HEAD ASSAY (g/c)	CGL GOLD XTRN %
		WEIGHT (g)	ASSAY (ppm)	ASSAY (ppm)	SOLIDS (g)	SOLIDS (g)	GOLD IN (g)	GOLD IN (g)	TOTAL GOLD (g)		
326	1221	1500	0.12	11	0.00018	0.000013	0.000193	0.000193	0.16	0.16	93.06%
327	1118	1500	0.08	10	0.00012	0.000011	0.000131	0.000131	0.12	0.12	91.48%
335	1160	1500	0.08	12	0.00012	0.000013	0.000133	0.000133	0.12	0.12	89.61%
336	1118	1500	0.06	17	0.00009	0.000019	0.000109	0.000109	0.10	0.10	82.56%



Ontario

Mr. G Zebruck
R.R.#1 Airport Road
Kenora
ONT P9N 3W7

0238-91

Sample	Au (ppb)
#23623	4
#23624	<2
#23625	<2
#23630	9
#23631	<2
#23632	26

This is an interim report for samples entered in your name on Sep 19, 1991; additional work will follow as soon as possible.

Please refer to certificate 0238-91 if you have any questions.

Fees Received: Coupon

Peter C. Lightfoot
Acting Chief

91/10/11

Project #2 Pipestone Penninsula

Date: January 30, 1992



Name: Pipestone Penninsula Project

020

List of Individuals Who Applied For Assistance for this Project:

George Zebruck

Changes to Proposed Project:

Concentrated exploration in the Pipestone Penninsula Area rather than wider affield. Looked mainly for nickel mineralization in the mafic and ultramafic rocks rather than a broader spectrum of minerals (better market).

Geology:

A series of mafic and ultramafic rocks separated by intermediate to mafic metavolcanic sequence.

Work Done:

Prospected for nickel in the mafic and ultramafic rocks using Dimethyl Glyoxime powder for nickel determination in the field. Some rocks assayed for gold.

Results and Recommendations:

Results were dissapointing but geology of area is still interesting and more work should be done (perhaps some geochemistry).

Location and Access:

By boat - Moore Bay, Andrew Bay Lake of the Woods.
By truck - To end of Storm Bay Road
- To Gold Hill Mine site via old logging road

PROSPECTING DAILY LOG

<u>Project Area</u>	<u>Date</u>	<u>Work Performed</u>
Pipestone Penninsula Area	May 17	Prospecting and Sampling Traverse T1 5 samples taken
	May 18	Prospecting and Sampling Traverse T2 2 samples taken
	May 20	Prospecting and Sampling Traverse T3 2 samples taken
	May 21	Prospecting and Sampling Traverse T4 1 sample taken
	May 22	Prospecting and Sampling Traverse T5 2 samples taken
	May 24	Prospecting and Sampling Traverse T6 1 sample taken
	May 25	Prospecting and Sampling Traverse T7 3 samples taken
	May 27	Prospecting and Sampling Traverse T8 1 sample taken
	May 28	Prospecting and Sampling Traverse T9 2 samples taken
	May 29	Prospecting and Sampling Traverse T10 4 samples taken
	May 30	Prospecting and Sampling Traverse T11 2 samples taken
	May 31	Prospecting Traverse T12 no samples taken
	June 3	Prospecting and Sampling Traverse T13 5 samples taken
	June 4	Prospecting and Sampling Traverse T14 4 samples taken
	June 5	Prospecting and Sampling Traverse T15 1 sample taken
	June 6	Prospecting and Sampling Traverse T16 1 sample taken
	June 7	Prospecting and Sampling Traverse T17 2 samples taken
	June 8	Prospecting and Sampling Traverse T18 1 sample taken
	June 10	Prospecting Traverse T19 no samples taken
	June 11	Prospecting and Sampling Traverse T20 1 sample taken
	June 12	Prospecting and Sampling Traverse T21 1 sample taken
	June 13	Prospecting Traverse T22 no samples taken
	June 14	Prospecting and Sampling Traverse T23 4 samples taken

<u>Project Area</u>	<u>Date</u>	<u>Work Performed</u>
Pipestone Penninsula Area	June 15	Prospecting and Sampling Traverse T24 1 sample taken
	June 17	Prospecting and Sampling Traverse T25 2 samples taken
	June 18	Prospecting and Sampling Traverse T26 2 samples taken

Location of Prospecting

- area outlined on claim map
- detailed sketches attached

Description of Samples

Prospecting and sampling was carried out mainly for nickel in the mafic and ultramafic rocks of this area. Some samples were taken for geochemical annalysis of Gold. Rocks samples were tested for nickel using Dimethyl Glyoxime powder and are numbered from 1 to 47. Positive test results in rock staining pink to red. Negative result is indicated by no colour change in sample.

<u>Traverse No.</u>	<u>Sample No.</u>	<u>Sample Type</u>	<u>Rock Type</u>	<u>Mineralization</u>	<u>Assay Result</u>
T1	1	Grab	Gabbro	minor Py,Po	Negative
	2	"	"	fine Po	"
	3	"	"	minor Py	"
	4	"	"	fine Po	"
	5	"	Altered Gabbro	w/Py	"
T2	6	"	Altered Gabbro	minor Py,Po	Negative
	7	"	"	" " "	"
T3	8	"	Altered Gabbro	minor Po	Negative
	23624	"	Altered Basalt	minor sulf.	- 2 (ppb) Au
T4	9	"	Ultramafic Talcose	minor sulf.	Negative
T5	10	"	Gabbro	minor sulf.	Negative
	11	"	Altered Gabbro	w/Py,Po	"
T6	12	"	Ultramafic w/carb	minor sulf.	Negative
T7	13	"	Ultramafic Rock	minor pyrite	Negative
	14	"	"	" "	"
	15	"	Altered Ultramafic	w/Py,Po	"

Traverse No.	Sample No.	Sample Type	Rock Type	Mineralization	Assay Result
T8	23625	Grab	Basalt	w/minor Py,Po	- 2 (ppb) Au
T9	16 17	" "	Altered Ultramafic Altered Gabbro ?	minor Py w/Py,Po	Negative "
T10	18 19 20 21	" " " "	Gabbro Altered Ultramafic Gabbro Peridotite	minor sulf. w/Py,Po w/Py,Po w/Po	Negative " " "
T11	22 23	" "	Peridotite Gabbro	minor sulf. minor sulf.	Negative "
T12	no samples taken				
T13	24 25 26 27 28	" " " " "	Gabbro Ultramafic Ultramafic Talcose Gabbro Altered Peridotite	minor Po W/minor sulf. sulf. in frac. w/Po,Py minor sulf.	Negative " " " "
T14	29 30 31 32	" " " "	Alterred Gabbro " " Gabbro	w/Po Py Po w/Po minor sulf.	Negative " " "
T15	33	"	Ultramafic	minor sulf	Negative
T16	34	"	Ultramafic	w/Po	Negative
T17	35 36	" "	Peridotite Gabbro	Py,Po w/Po	Negative "
T18	37	"	Alterred Ultramafic	Py	Negative
T19	no samples taken				
T20	38	"	Peridotite	w/Po	Negative
T21	39	"	Alterred Gabbro	Py,Po	Negative
T22	no samples taken				
T23	40 41 42 43	" " " "	Massive Sulf. I.F. " " "	Po Py Po Po	Negative " " "
T24	23630	"	Quartz vein	minor Py	9 (ppb) Au.

Traverse No.	Sample No.	Sample Type	Rock Type	Mineralization	Assay Result
T25	44	Grab	Gabbro	w/Py, Po	Negative
	45	"	Massive Sulf	Po	"
T26	46	"	Gabbro	w/Po	Negative
	47	"	Gabbro	w/Po	"



Ontario

Mr. G Zebruck
R.R.#1 Airport Road
Kenora
ONT P9N 3W7

0238-91

Sample	Au (ppb)
#23623	4
#23624	<2
#23625	<2
#23630	9
#23631	<2
#23632	26

This is an interim report for samples entered in your name on Sep 19, 1991; additional work will follow as soon as possible.

Please refer to certificate 0238-91 if you have any questions.

Fees Received: Coupon

Peter C. Lightfoot
Acting Chief

91/10/11

G 907

Scale
1 in. = 1/4 mi.

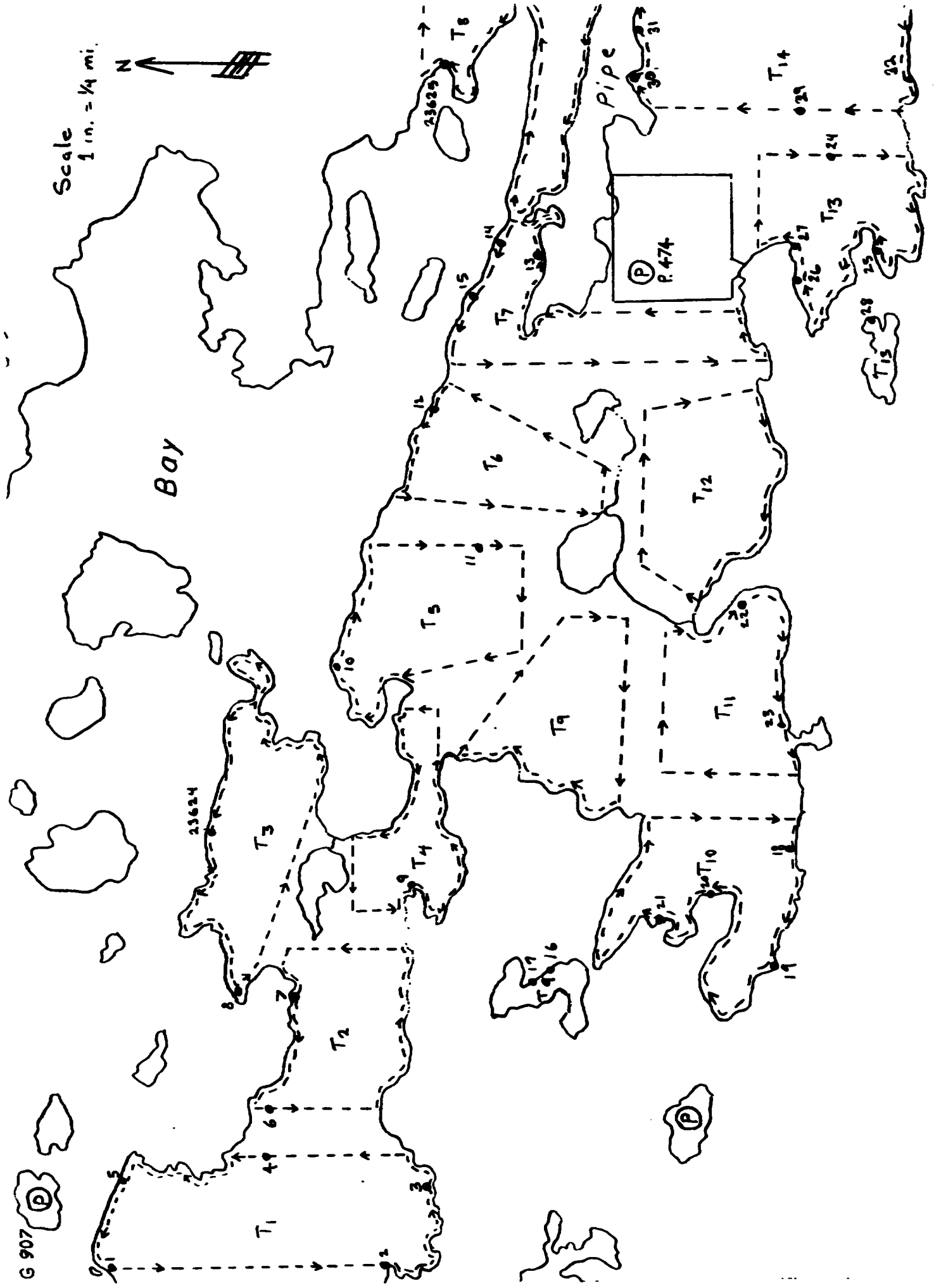
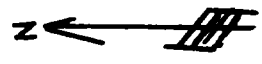

Andrew

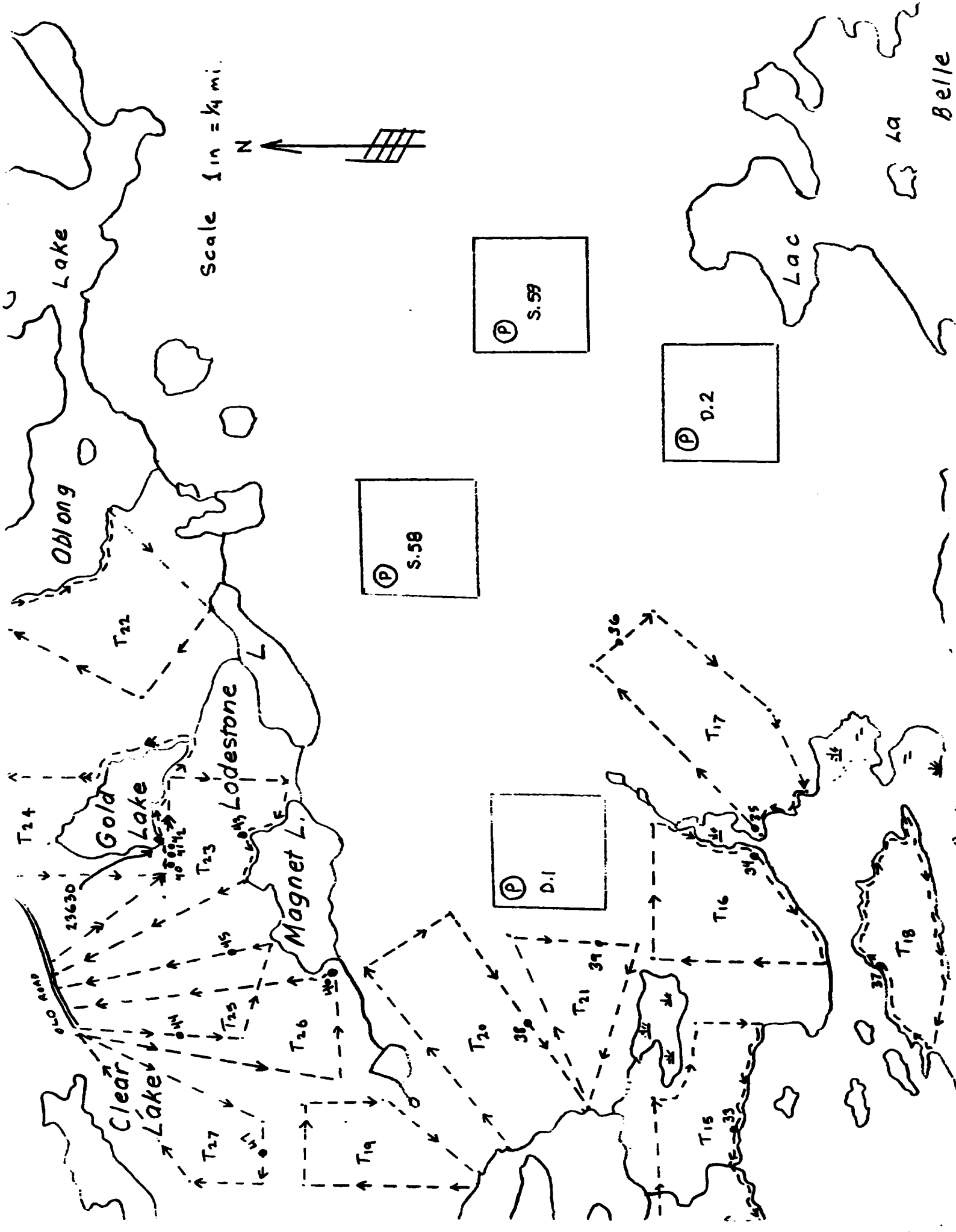

Scale 1 in = 1/4 mi.

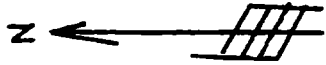

(P) S.58

(P) S.59

(P) D.2

(P) D.1

Clear Lake

Gold Lake

Oblong Lake

Lodestone

Magnet L.

Lac

La Belle

T18

T16

T17

T15

T21

T20

T19

T26

T25

T23

T22

T24

T27

670 ROAD

23630

40

41

42

43

44

45

46

38

39

30

31

32

33

34

35

36

37

Project #3 Bug Lake Iron Formation

DATE: January 30, 1992



NAME: Bug Lake Iron Formation

030

LIST OF INDIVIDUALS WHO APPLIED FOR ASSISTANCE FOR THIS PROJECT:

George R. Zebruck

LOCATION AND ACCESS: Code Township , access by truck Highway 71 and old logging road.

CHANGES TO PROPOSED PROJECT: None.

GEOLOGY: Iron formation in sedimentary rocks.

WORK DONE: Prospecting and sampling. Attempted to find major folds in iron formation as indicated on geophysical maps, but difficult due to overburden and swamp.

RESULTS AND RECOMMENDATIONS:

Gold assays poor similar to results obtained in prospecting to the south of this location.
1 White pegmatite sampled. results low in Be and Li.
Area should be prospected more.

PROSPECTING DAILY LOG

<u>Project Area</u>	<u>Date</u>	<u>Work Performed</u>
Bug Lake Iron Form.	July 20	Prospected northwest side of Bug Lake looking for folds. took 1 sample.
	July 21	Prospected north of Bug Lake looking for folds. Most of area deep overburden or swamp. 1 sample taken.
	July 22	Prospected northeast of road near contact of seds. with granites. 1 sample of white pegmatite taken for Be. Li determination.

Location of Prospecting

- area outlined on claim map
- detailed sketch attached

Description of Samples

<u>Sample No.</u>	<u>Type</u>	<u>Rock Type</u>	<u>Mineralization</u>	<u>Assay Results</u>
23631	Grab	Rusty Seds.	fine pyrite	- 2 (ppb) Au
23632	"	Quartz in Seds?	Barren looking	26 (ppb) Au
23578	"	White Pegmatite		1 ppm Be 18 ppm Li

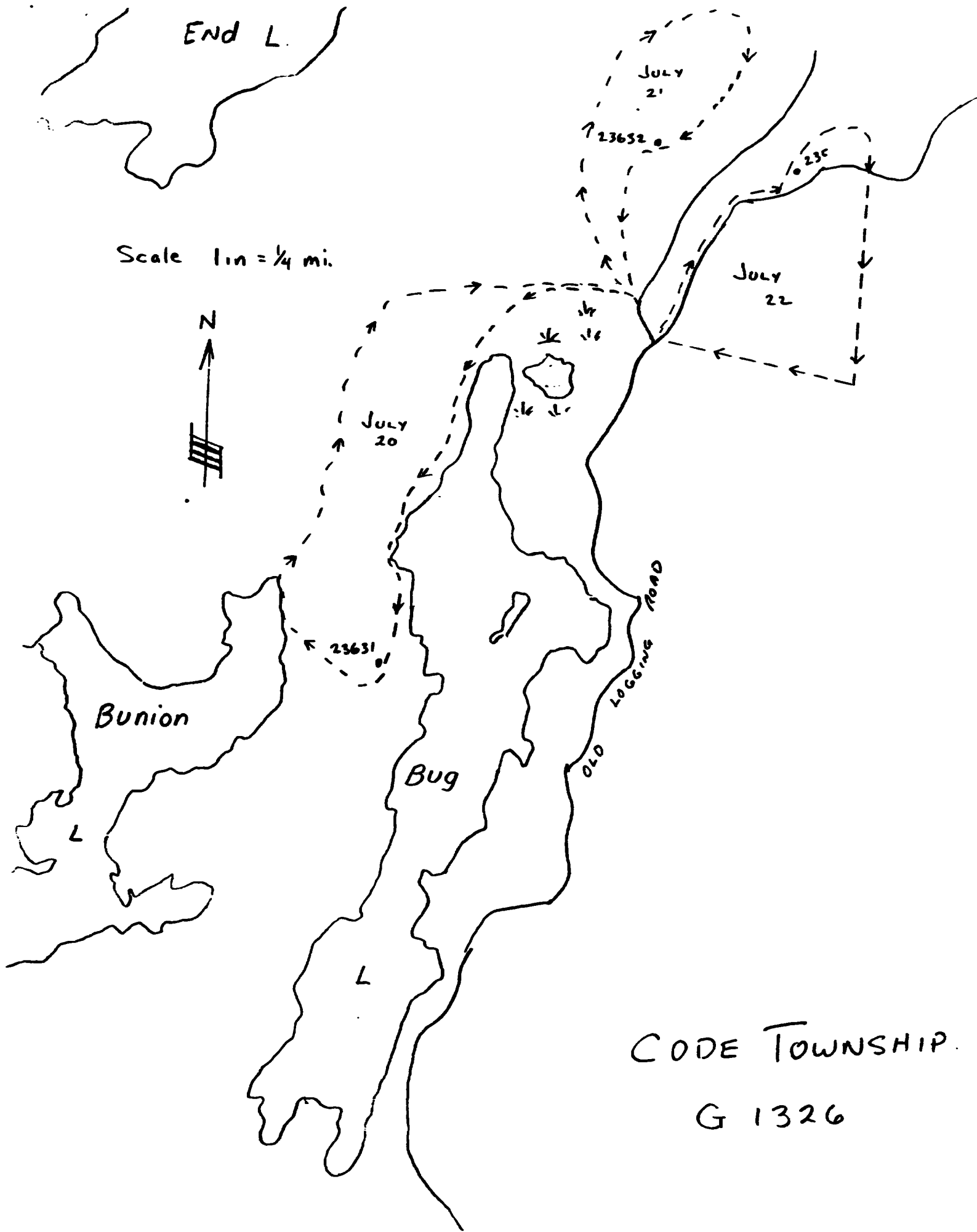

CODE TOWNSHIP.
G 1326



Ontario

Mr. G Zebruck
R.R.#1 Airport Road
Kenora
ONT P9N 3W7

0238-91

Sample	Au (ppb)
#23623	4
#23624	<2
#23625	<2
#23630	9
#23631	<2
#23632	26

This is an interim report for samples entered in your name on Sep 19, 1991; additional work will follow as soon as possible.

Please refer to certificate 0238-91 if you have any questions.
Fees Received: Coupon

Peter C. Lightfoot
Acting Chief

91/10/11



Ontario

Mr. G Zebruck
R.R.#1 Airport Road
Kenora
ONT P9N 3W7

FURTHER TO CERTIFICATE 0238-91

Sample	Be (ppm)
#23578	1

This is an interim report for samples entered in your name on Sep 19, 1991; additional work will follow as soon as possible.

Please refer to certificate 0238-91 if you have any questions.
Fees Received: Regional

Peter C. Lightfoot
Acting Chief

91/10/25



Mr. G Zebruck
R.R.#1 Airport Road
Kenora
ONT P9N 3W7

FURTHER TO CERTIFICATE 0238-91

Sample	Li (ppm)
#23578	18

This is an interim report for samples entered in your name on Sep 19,1991; additional work will follow as soon as possible.

Please refer to certificate 0238-91 if you have any questions.

Fees Received: Regional

Peter C. Lightfoot
Acting Chief

91/10/29

P E T T Y P I E C E

KENORA MINING DIV
R E C E I V E D
 JAN 23 1992
 AM
 789101112123456

THE TOWNSHIP OF

HAYCOCK

DISTRICT OF
 KENORA

KENORA
 MINING DIVISION

SCALE: 1 INCH = 40 CHAINS

LEGEND

PATENTED LAND	(P)
CROWN LAND SALE	CS
LEASES	(L)
EXCATED LAND	LOC
LEASE OF OCCUPATION	LO
MINING RIGHTS ONLY	MRO
SURFACE RIGHTS ONLY	SRO
ROADS	—
IMPROVED ROADS	—
KING'S HIGHWAYS	—
RAILWAYS	—
POWER LINES	—
MARSH OR MUSKEG	—
MINES	X
CANCELLED	C
UNDEVELOPED	U

NOTES

(1) Reserve around all lake & rivers to Dept of Lands & Forests
 (2) Surface rights withdrawn from stake sub 34
 (3) (d) Mg Act shown thus File 163473
 (4) Mining Application Fibre Optics Line Bill Canada January 26, 1987
 (5) W.R. 09/89 April 17, 1989

THE INFORMATION THAT APPEARS ON THIS MAP HAS BEEN COMPILED FROM VARIOUS SOURCES, AND ACCURACY IS NOT GUARANTEED. THOSE WISHING TO STAKE MINING CLAIMS SHOULD CONSULT WITH THE MINING RECORDER, MINISTRY OF NORTHERN DEVELOPMENT AND MINES FOR ADDITIONAL INFORMATION ON THE STATUS OF THE LANDS SHOWN HEREON.

G-1836

PLAN NO **M-1987**

MINISTRY OF NATURAL RESOURCES

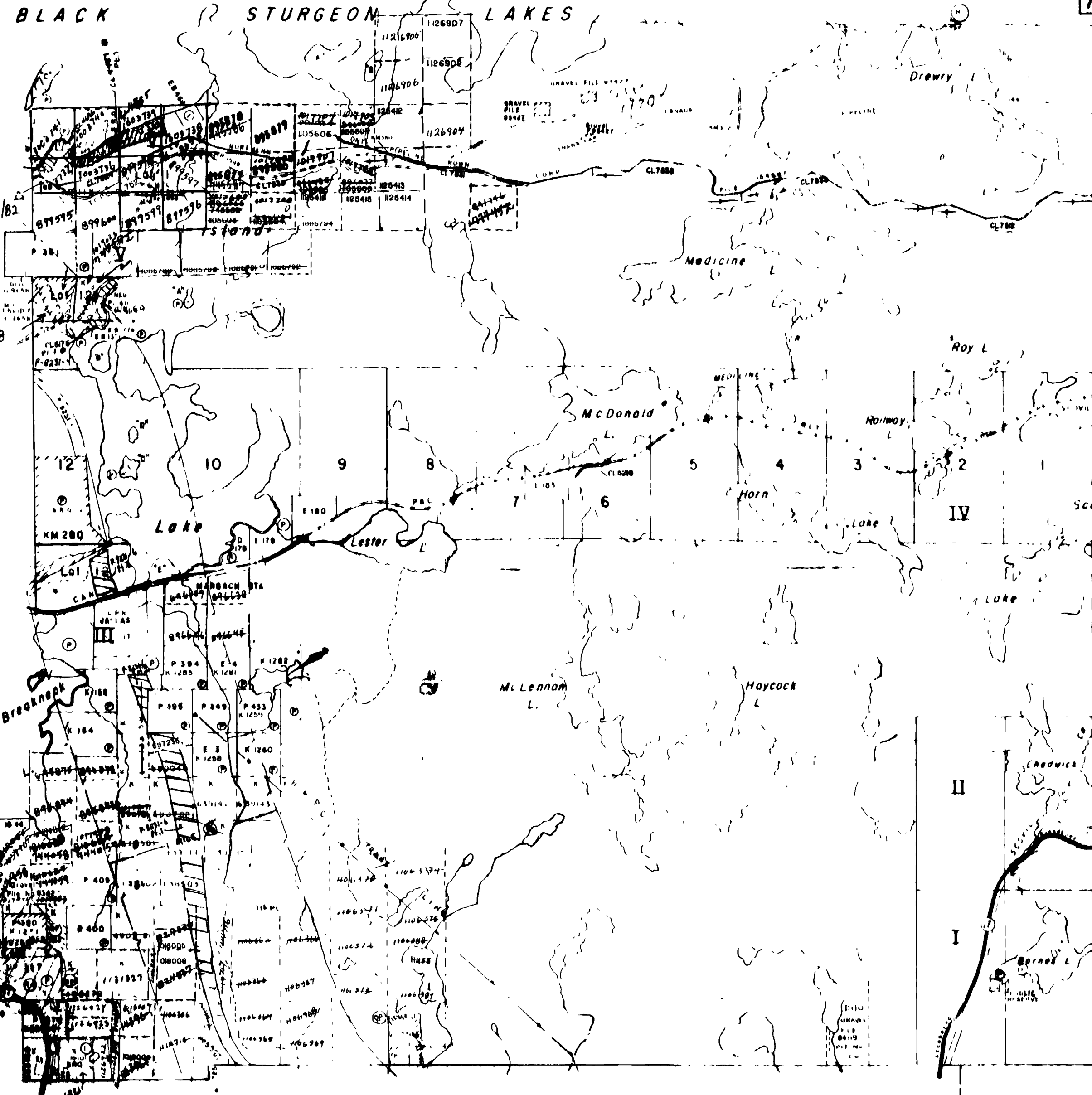

K I R K U P

BLACK STURGEON PROPERTY

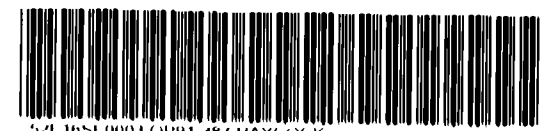

G 1836

Effective date

Bigstone Bay (G.2607)

LAND: OPEN June 1/90 @ 7:00 AM C.S.T
Pipestone Peninsula, P.474, (6:00 AM U.S.T)
MH 270

Wiley Bay (G.2657)

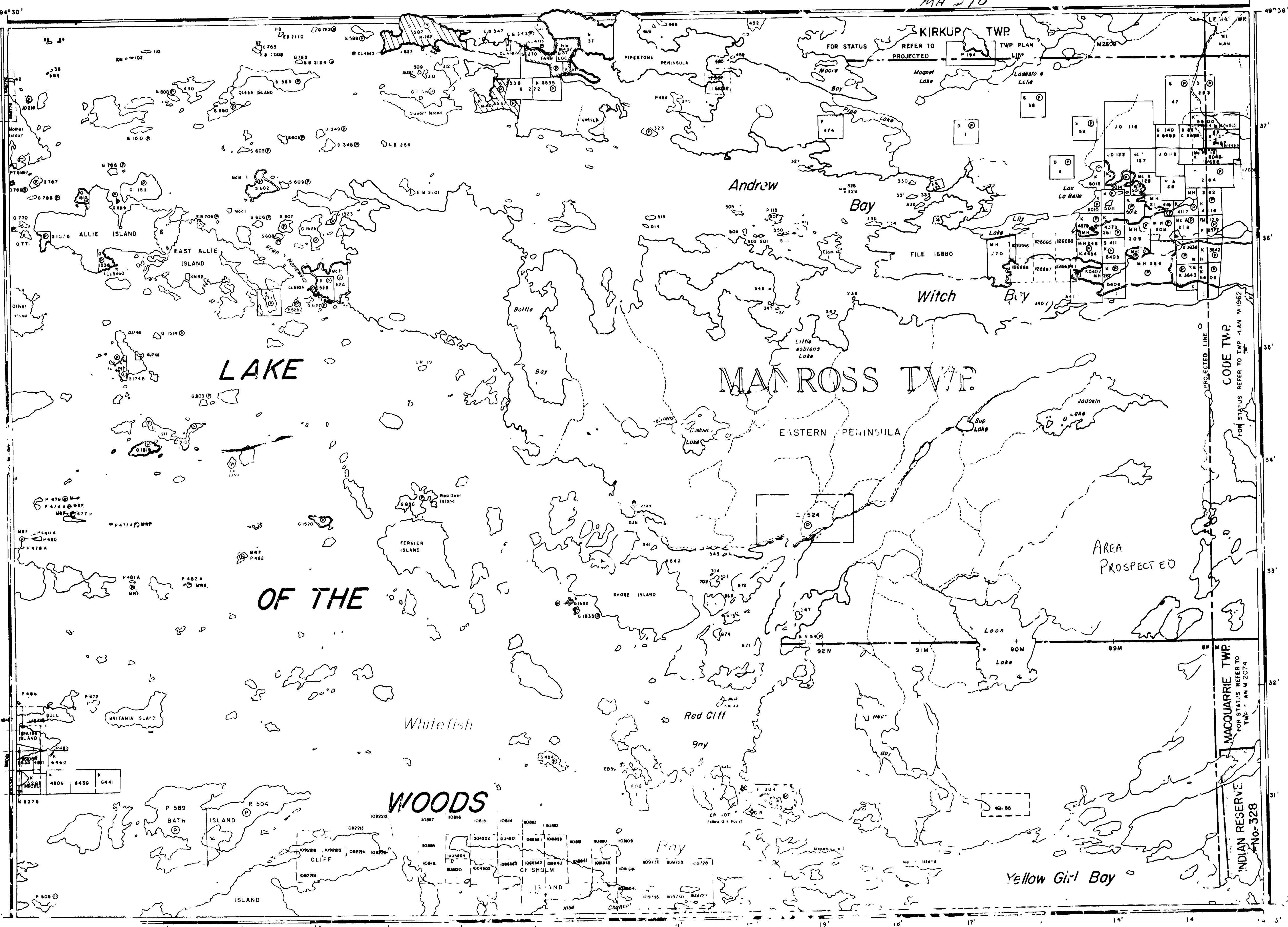

THE INFORMATION THAT APPEARS ON THIS MAP HAS BEEN COMPILED FROM VARIOUS SOURCES AND ACCURACY IS NOT GUARANTEED. THOSE WISHING TO STAKE MINING CLAIMS SHOULD CONSULT WITH THE MINING RECORDER, MINISTRY OF NORTHERN DEVELOPMENT AND MINES FOR ADDITIONAL INFORMATION ON THE STATUS OF THE LANDS SHOWN HEREON.

LEGEND

TOURIST CAMPS	+
PATENTED LAND	□
CROWN LAND SALE	□
LEASES	□
LOCATED LAND	□
LICENSE OF OCCUPATION	□
MINING RIGHTS ONLY	□
SURFACE RIGHTS ONLY	□
ROADS	—
IMPROVED ROADS	—
KINGS HIGHWAYS	—
RAILWAYS	—
POWER LINES	—
MARSH OR MUSKEG	—
MINES	—
CANCELLED	—
TRAILS	—
PATENTED for S.R.O.	—

REFERENCES

400 Surface Rights Reservation around All Lakes & Rivers

Reserve Flooding Rights Up To 100m Above Mean Sea Level On All Lands Bordering Lake Of The Woods File 4522 Vol. 1

Pipestone Provincial Park Shown Thus Withdrawn From Staking

Islands In The Lake Of The Woods That Do Not Form Part Of Macquarie Twp.

Boundary Of Macquarie Twp. Shown Thus

Islands In Lake Of The Woods Withdrawn From Staking Except All The S.C.O. Or Over The Site. File: 6701 Vol. 2

AREAS WITHDRAWN FROM DISPOSITION

M.R.O. - MINING RIGHTS ONLY
S.R.O. - SURFACE RIGHTS ONLY
M.S.E. - MINING AND SURFACE RIGHTS

Dec 1985
W20/85
P-474 MRO REVERT TO CROWN STATUS JUNE 1/86 8:00 LOCAL TIME

SCALE: 1 INCH = 40 CHAIN.

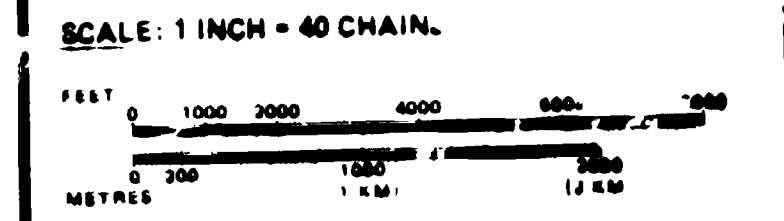

AREA YELLOW GIRL BAY & MACROSS TWP. (LAKE OF THE WOODS)

M.N.R. ADMINISTRATIVE DISCRETION

KENORA RECEIVED

MINING DIVISION JAN 27 1992

KENORA 7891011 12123456

LAND TITLES / REGISTRY DIVISION

KENORA

Ministry of Natural Resources Ontario

Ministry of Northern Development and Mines

Date: DEC 08 / 1986

M.2338

G-2656



MINING RIGHTS OPENED
JUNE 1/87
ON D-269

PELLATT TP. M.2020

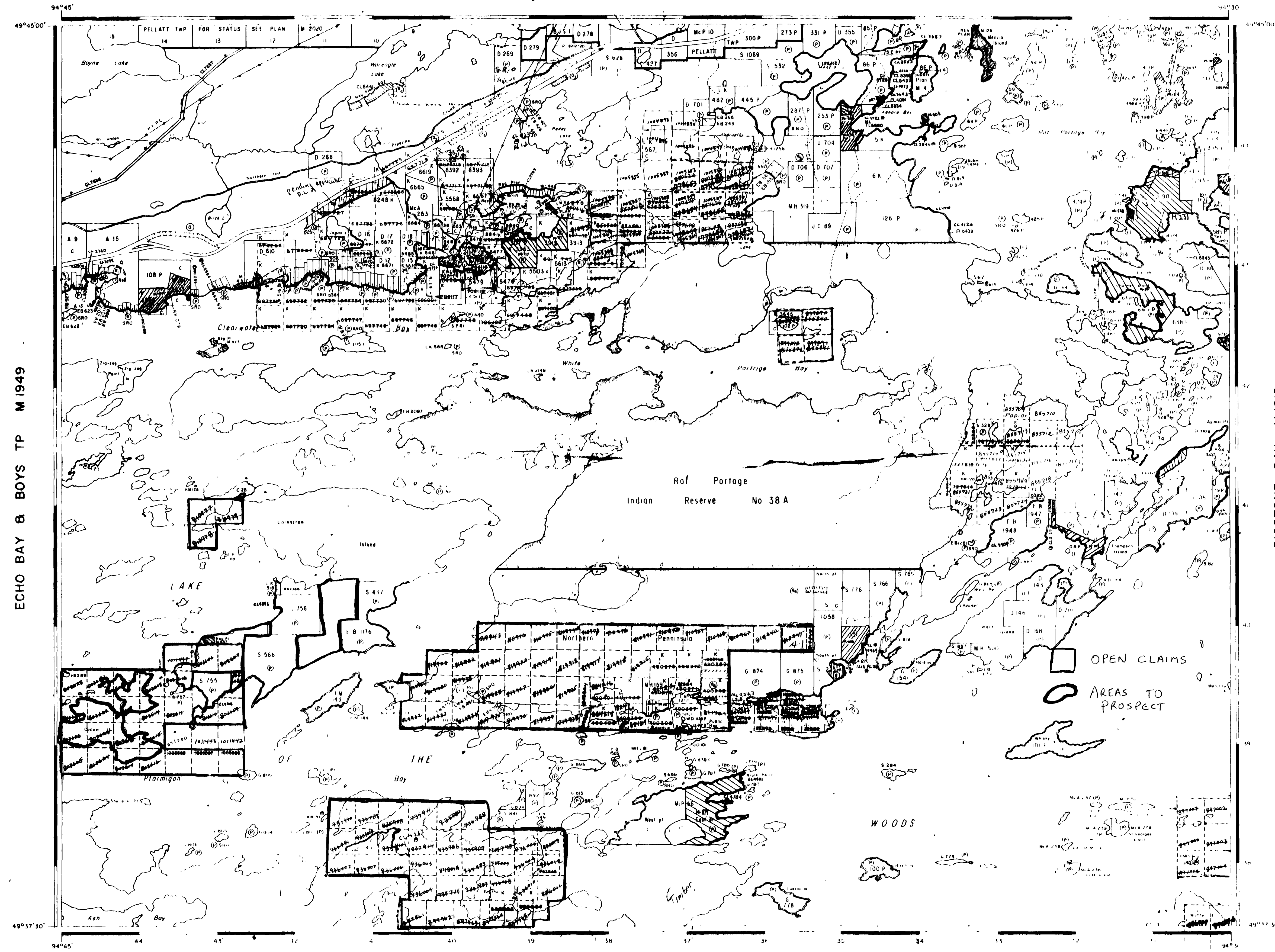

AREA OF
CLEARWATER BAY
 (LAKE OF THE WOODS)
 DISTRICT OF KENORA
 KENORA MINING DIVISION
 SCALE: 1-INCH = 40 CHAINS

LEGEND

PATENTED LAND	● (P)
CROWN LAND SALE	CS
LEASES	(L)
LOCATED LAND	Loc
LICENSE OF OCCUPATION	LO
MINING RIGHTS ONLY	MRO
SURFACE RIGHTS ONLY	SRO
ROADS	—
IMPROVED ROADS	—
KING'S HIGHWAYS	—
RAILWAYS	—
POWER LINES	—
MARSH OR MUSKIEG	—
MINES	—
CANCELLED	C
PATENTED SRO	—

NOTES

400' Reservation of Surface Rights around all lakes & rivers from the contour of 1064'

(M) 400' shown thus to MNR RO Reserved File 163473

For status of S R Subdivisions please enquire at Min of Natural Resources

Areas withdrawn from staking under Section 43 of the Mining Act (R.S.O. 1970)

Order No	File	Date	Disposition
W 65776	188921	19/11/76	SRO
W 21111	68521	2/8/86	SR MMH

SAND and GRAVEL

(M) MNR Gravel Pit No 151
 (S) Gravel File 108094
 (P) Gravel File 163473
 (M) MNR Gravel Pit No 1121
 (S) Gravel File 35200
 (C) QUARRY PERMIT

THE INFORMATION THAT APPEARS ON THIS MAP HAS BEEN COMPILED FROM VARIOUS SOURCES, AND ACCURACY IS NOT GUARANTEED THOSE WISHING TO STAKE MINING CLAIMS SHOULD CONSULT WITH THE MINING RECORDER, MINISTRY OF NORTHERN DEVELOPMENT AND MINES, FOR ADDITIONAL INFORMATION ON THE STATUS OF THE LANDS SHOWN HEREON

7891011123456

NATIONAL TOPOGRAPHIC SERIES 52E10
PLAN NO. M-2062
 ONTARIO
 MINISTRY OF NATURAL RESOURCES
 SURVEYS AND MAPPING BRANCH

ECHO BAY & BOYS TP M 1949

BIGSTONE BAY M 1815



RESERVE FLOODING RIGHTS TO CONTOUR 1084' ON ALL LANDS BORDERING ON LAKE OF THE WOODS

THIS S.R.O. RESERVED TO M.N.R. FILE 163473

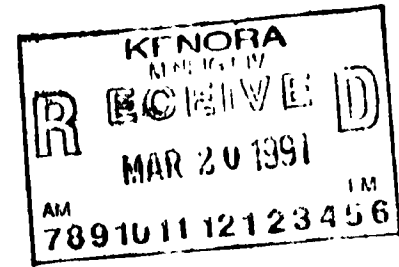

AREA WITHDRAWN FROM DISPOSITION

M.R.O. - MINING RIGHTS ONLY
S.R.O. - SURFACE RIGHTS ONLY
M.F.B. - MINING AND SURFACE RIGHTS

Table with columns: Description, Order No, Date, Disposition, File. Lists various reserve areas and their corresponding file numbers.

INDIAN BAY (SHOAL LAKE)

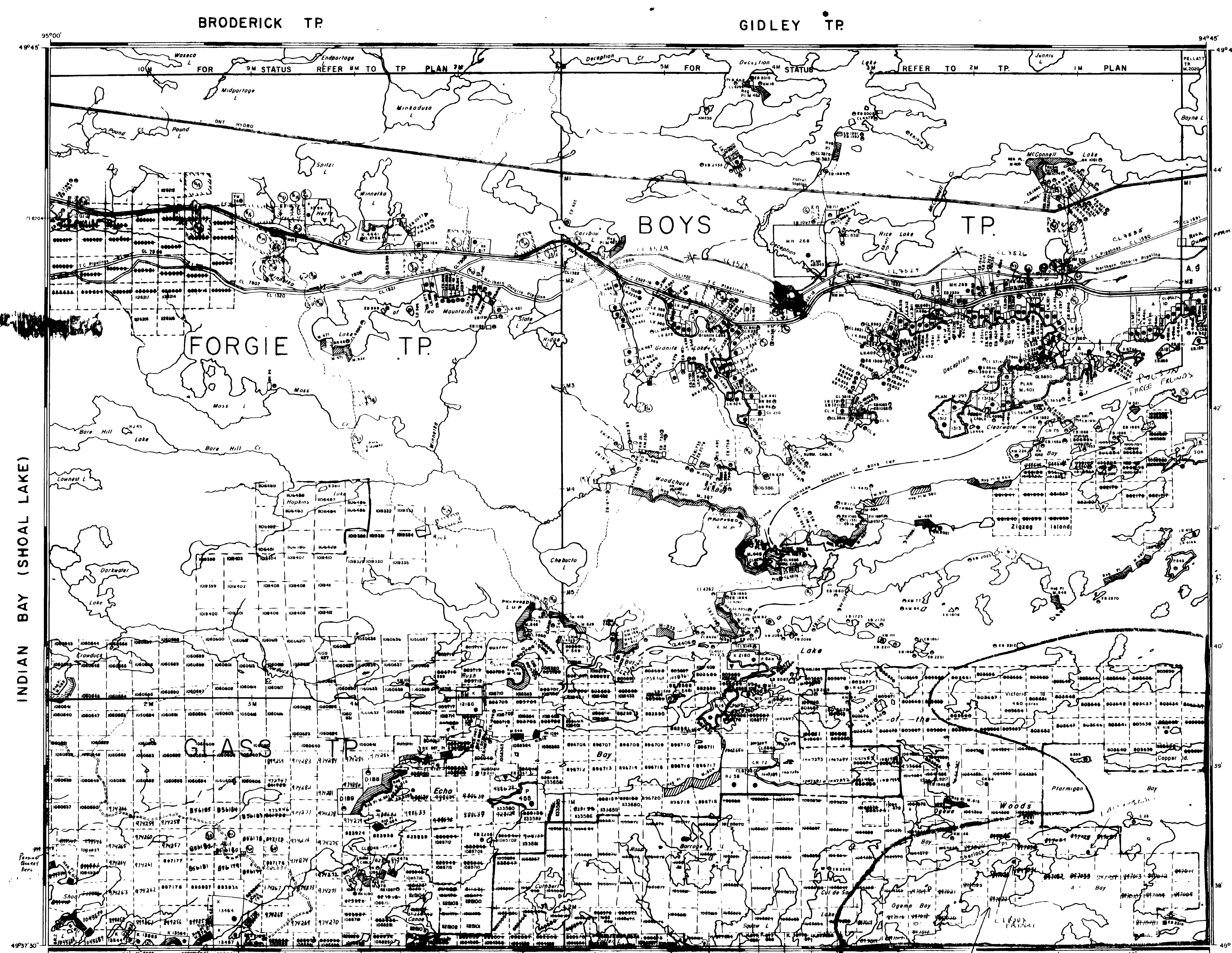

SHOAL LAKE

AREA TO BE PROSPECTED

OPEN CLAIMS

LEGEND

- Highway and route No
Other roads
Trails
Surveyed lines
Townships, base lines, etc.
Lots, mining claims, parcels, etc.

DISPOSITION OF CROWN LANDS

- Type of Document
Patent, surface & mining rights
Surface rights only
Mining rights only
Lease, surface & mining rights
Surface rights only
Mining rights only

SCALE 1 INCH = 40 CHAINS

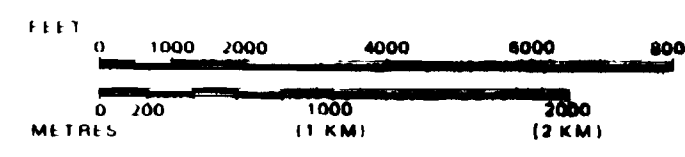

THE INFORMATION THAT APPEARS ON THIS MAP HAS BEEN COMPILED FROM VARIOUS SOURCES AND ACCURACY IS NOT GUARANTEED...

OPAP 91 PROJECT #

G.R. ZEBRUCK Lic (H) 10

AREA ECHO BAY
M.N.R. ADMINISTRATIVE DISTRICT KENORA
MINING DIVISION KENORA
LAND TITLES / REGISTRY DIVISION KENORA

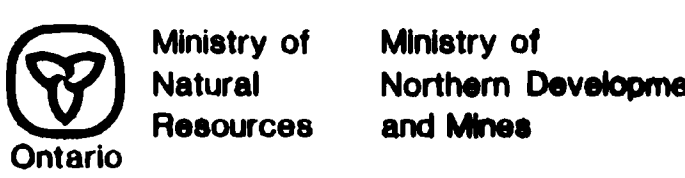

Date JANUARY, 1987
Number G-2616



Bigstone Bay (G.260) LANDS OPEN JUNE 1/90 @ 7:00 AM C.S.T
 Pipestone Peninsula, P.474, MH 270 (8:00 AM L.S.T)

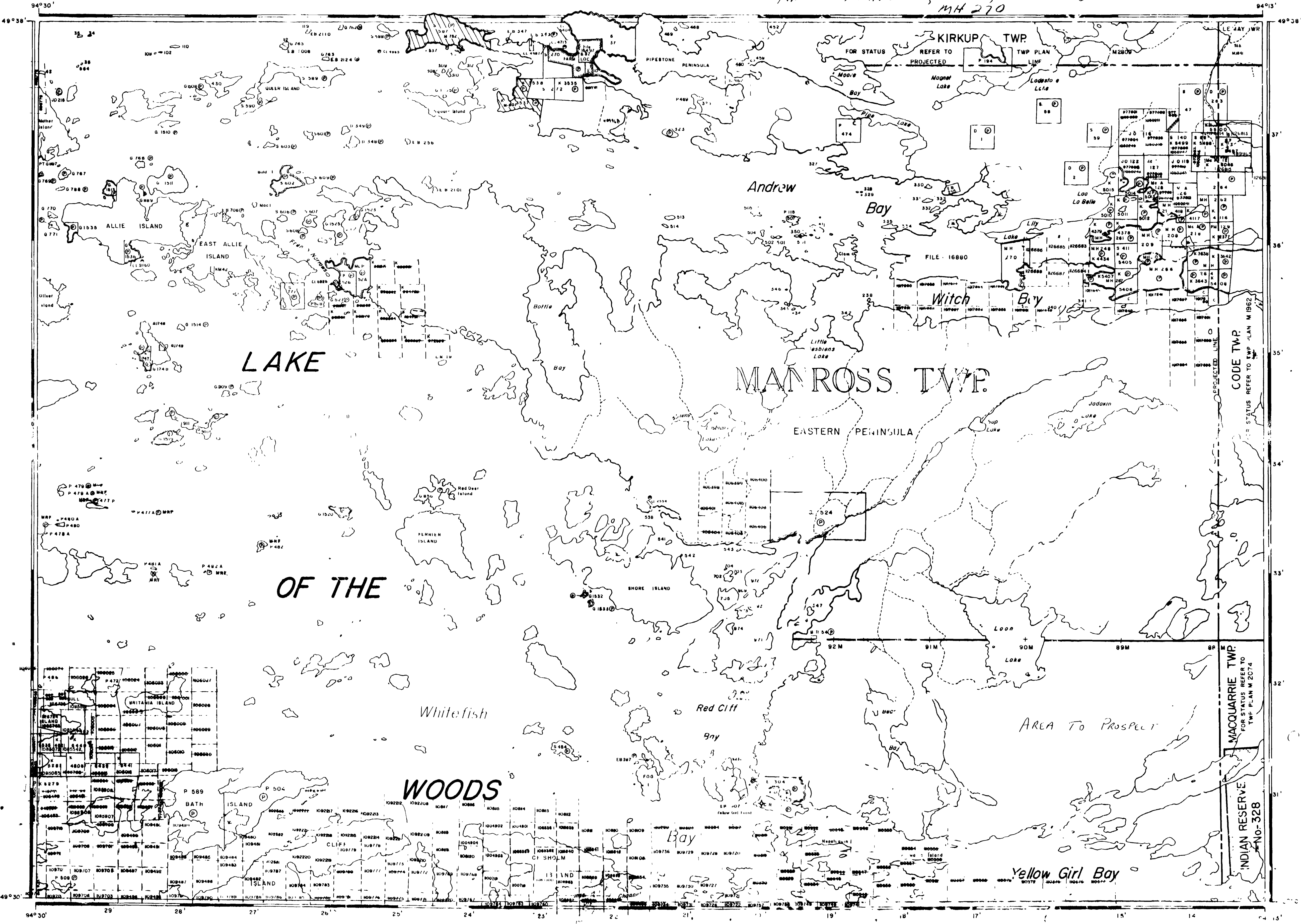

THE INFORMATION THAT APPEARS ON THIS MAP HAS BEEN COMPILED FROM VARIOUS SOURCES, AND ACCURACY IS NOT GUARANTEED. THOSE WISHING TO STAKE MINING CLAIMS SHOULD CONSULT WITH THE MINING RECORDS DIVISION OF THE MINISTRY OF NORTHERN DEVELOPMENT AND MINES, FOR ADDITIONAL INFORMATION ON THE STATUS OF THE LANDS SHOWN HEREON.

Effective as of _____

LEGEND

TOURIST CAMPS	⊙
PATENTED LAND	⊙
CROWN LAND SALE LEASES	⊙
LOCATED LAND	⊙
LICENSE OF OCCUPATION	⊙
MINING RIGHTS ONLY	⊙
SURFACE RIGHTS ONLY	⊙
ROADS	—
IMPROVED ROADS	—
KINGS HIGHWAYS	—
RAILWAYS	—
POWER LINES	—
MARSH OR MUSKEG	—
MINES	⊙
CANCELLED	⊙
TRAILS	—
PATENTED for S.R.O.	⊙

REFERENCES

- 400 Surface Rights Reservation Around All Lakes & Rivers
- Reserve Flooding Rights Up To 100' Above Mean Sea Level On All Lands Bordering Lake Of The Woods. File: 4522 Vol 1
- Islands In The Lake Of The Woods That Do Not Form Part Of Macquarie Twp.
- Boundary Of Manross Twp. Shown Thus: _____
- Islands In Lake Of The Woods Withdrawn From Staking Except All Those 500' Or Over In Size. File: 67051 Vol 2
- Cliff And Shore Island Open for Staking
- AREAS WITHDRAWN FROM STAKING
 - M.R.O. - MINING RIGHTS ONLY
 - S.R.O. - SURFACE RIGHTS ONLY
 - M.S. - MINING AND SURFACE RIGHTS
- W.P.O./B.S. MAY 31/85 588M
- P-474 MH0 REVERT TO CROWN STATUS JUNE 1/86 8:00 LOCAL TIME

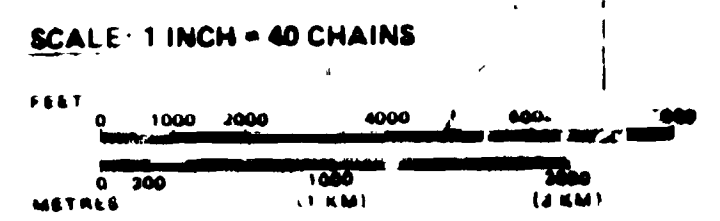

AREA YELLOW GIRL BAY & MANROSS TWP. (LAKE OF THE WOODS)
 M.N.R. ADMINISTRATIVE DISTRICT
KENORA
 MINING DIVISION
KENORA
 LAND TITLES / REGIS. BY DIVISION
KENORA

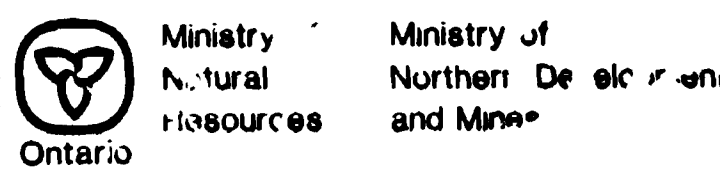

DATE DEC 1987/986
 M.2338
G-2656

Wiley Bay (G.260)



LeMoy Twp - N.1841

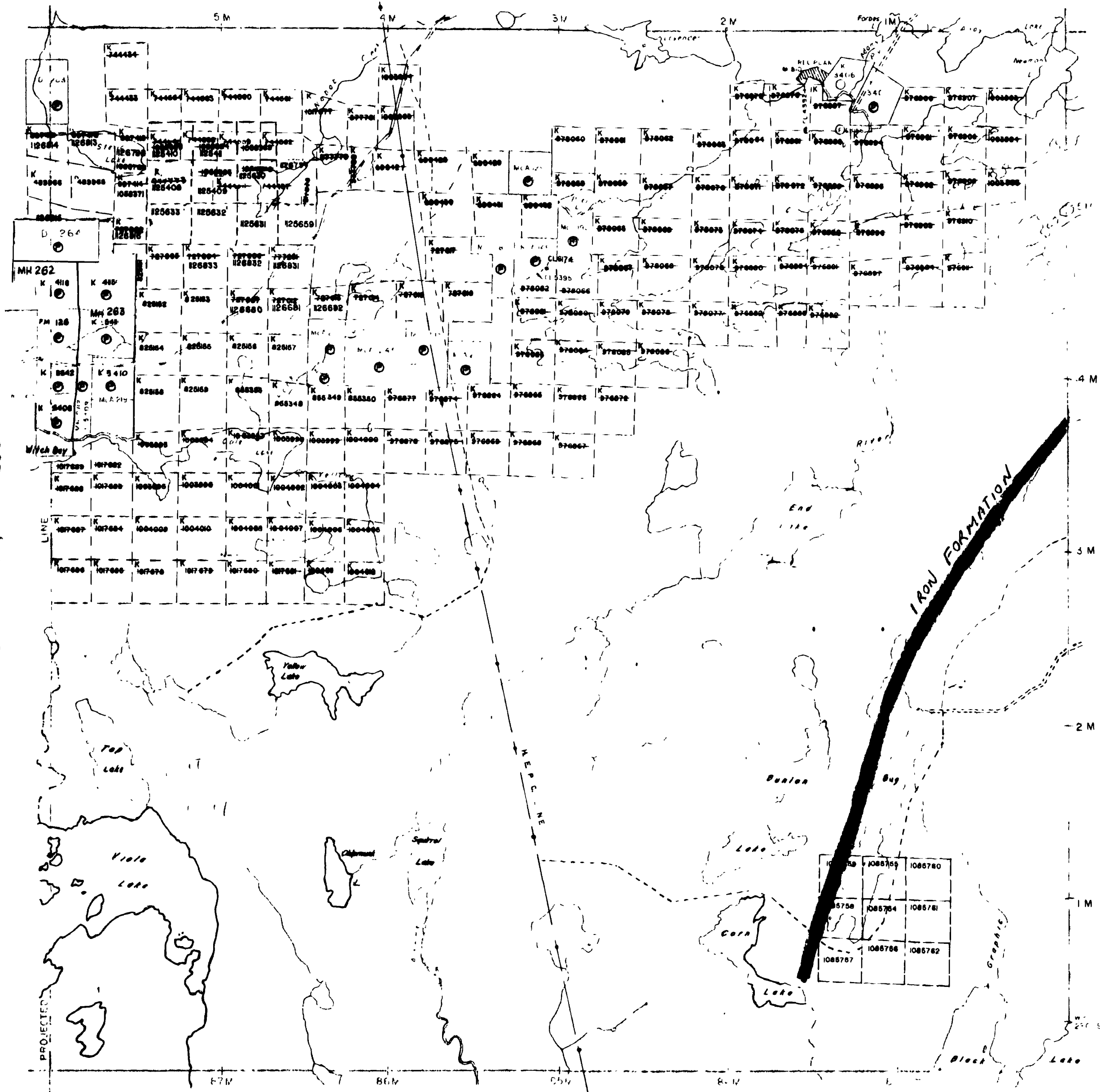

Yellow Girl Bay
Michigan Twp - G-285C

Work up 11557

AREA TO PROSPECT

MacQuarrie Twp - M.1966

THE TOWNSHIP OF

CODE

DISTRICT OF KENORA

KENORA MINING DIVISION

SCALE: 1-INCH 40 CHAINS

LEGEND

PAVED LAND	(C)
CRAN LAND SALE	(C)
LEASES	(C)
LOTTED LAND	(L)
LICENSE OF OCCUPATION	(L)
MINES RIGHTS ONLY	(K)
SURFACE RIGHTS ONLY	(S)
ROADS	(R)
IMPROVED ROADS	(R)
KING'S HIGHWAYS	(R)
RAILWAYS	(R)
POWER LINES	(R)
MARSH OR MUCKED	(R)
WELLS	(R)
CONCRETE	(R)

NOTES

RECEIVED
MAR 22 1991
7891011 12123 456

EFFECTIVE AS LINEN

THE INFORMATION THAT APPEARS ON THIS MAP HAS BEEN COMPILED FROM VARIOUS SOURCES AND ACCURACY IS NOT GUARANTEED. THOSE WISHING TO STAKE MINING CLAIMS SHOULD CONSULT WITH THE MINING RECORDER, MINISTRY OF NORTHERN DEVELOPMENT AND MINES, FOR ADDITIONAL INFORMATION ON THE STATUS OF THE LANDS SHOWN HEREON.

PLAN NO. ~~M1962~~

DEPARTMENT OF MINES

- ONTARIO -

G-1326



PETTY PIECE

BLACK STURGEON LAKES

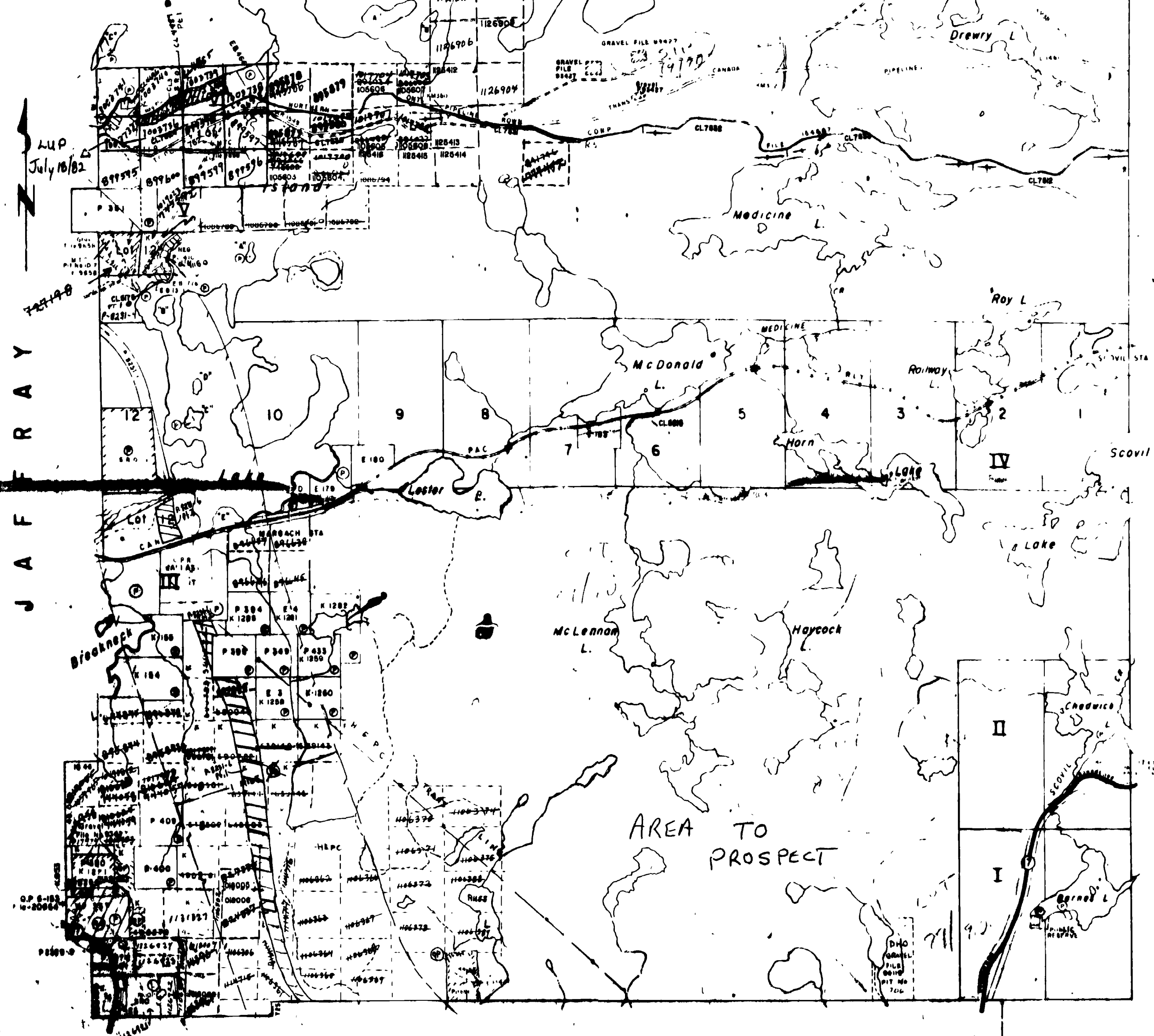

THE TOWNSHIP OF

HAYCOCK

DISTRICT OF KENORA

KENORA MINING DIVISION

SCALE 1-INCH 40 CHAINS

LEGEND

PATENTED LAND	Ⓟ
CROWN LAND SALE	CS
LEASES	Ⓛ
LOCATED LAND	LO
LICENSE OF OCCUPATION	LO
MINING RIGHTS ONLY	MRO
SURFACE RIGHTS ONLY	SRO
ROADS	—
IMPROVED ROADS	—
KINGS HIGHWAYS	—
RAILWAYS	—
POWER LINES	—
MARSH OR MUSKEG	—
CANCELLED	—
QUARRY PERMIT	—

NOTES

400' Reserve around all lakes & rivers to Dept of Lands & Forests

Surface Rights withdrawn from staking Sub 34 Sec (d) Mg Act shown thus File 63473

Amended from original facts 3/10/70 R 93 1970

Order No. 1017 D 17/10/73 SRO MR

RE-APPLIED FOR 1/71 OK-01/91

Ⓟ Pending Application File 63473 Sub 34 Sec (d) Mg Act

Ⓟ W-1-00-100 April 17, 1988

RECEIVED

MAR 22 1991

10 11 12 1 2 3 4 5 6

Effective date

THE INFORMATION THAT APPEARS ON THIS MAP HAS BEEN COMPILED FROM VARIOUS SOURCES, AND ACCURACY IS NOT GUARANTEED. THOSE WISHING TO STAKE MINING CLAIMS SHOULD CONSULT WITH THE MINING RECORDER, MINISTRY OF NORTHERN DEVELOPMENT AND MINES, FOR ADDITIONAL INFORMATION ON THE STATUS OF THE LANDS SHOWN HEREON

PLAN NO. M-1987

MINISTRY OF NATURAL RESOURCES

SLRVI



REFERENCES

AREAS WITHDRAWN FROM DISPOSITION

M.R.O. - MINING RIGHTS ONLY
 S.R.O. - SURFACE RIGHTS ONLY
 M.S. - MINING AND SURFACE RIGHTS

Description	Order No.	Date	Disposition	File

Flooding Rights reserved to 1064' mean sea level.

Islands in Shoal Lake and inlets thereto do not form part of Glass Township.

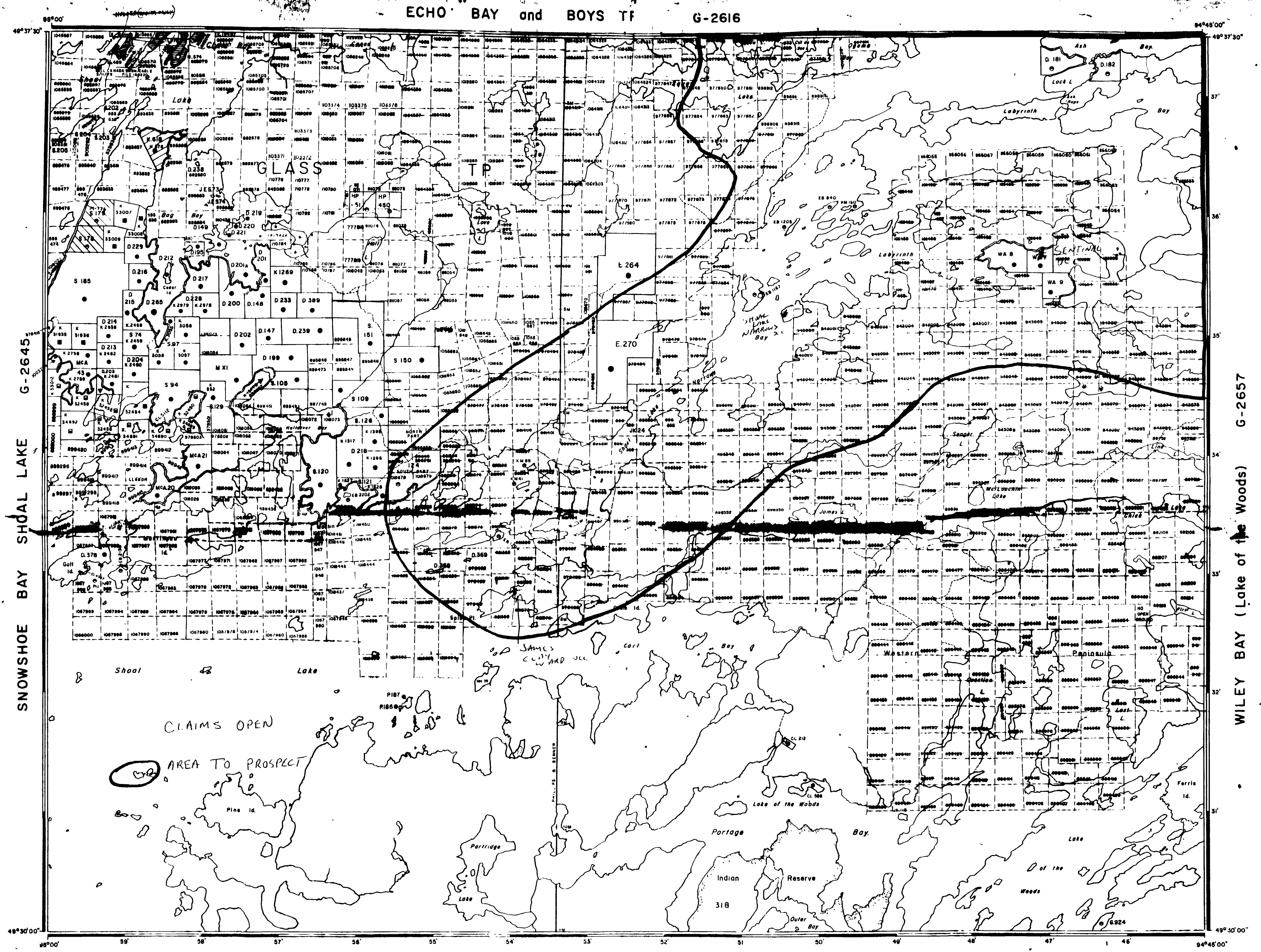

SNOWSHOE BAY SHOAL LAKE G-2645

WILEY BAY (Lake of the Woods) G-2657

ECHO BAY and BOYS TR G-2616

MONUMENT BAY (Lake of the Woods) G-2632

LEGEND

- HIGHWAY AND ROUTE No.
- OTHER ROADS
- TRAILS
- SURVEYED LINES
- TOWNSHIP BASE LINES ETC.
- LOTS MINING CLAIMS PARCELS ETC.
- UNSURVEYED LINES
- LOT LINES
- PARCEL BOUNDARY
- MINING CLAIMS ETC.
- RAILWAY AND RIGHT OF WAY
- UTILITY LINES
- NON PERENNIAL STREAM
- FLOODING OR FLOODING RIGHTS
- SUBDIVISION OR COMPOSITE PLAN
- RESERVATIONS
- ORIGINAL SHORELINE
- MARSH OR MUSKEG
- MINES
- TRAVEL MONUMENT
- TOURIST CAMPS

DISPOSITION OF C TOWN LANDS

TYPE OF DOCUMENT	SYMBOL
PATENT SURFACE & MINING RIGHTS	
SURFACE RIGHTS ONLY	
MINING RIGHTS ONLY	
LEASE SURFACE & MINING RIGHTS	
SURFACE RIGHTS ONLY	
MINING RIGHTS ONLY	
LICENCE OF OCCUPATION	
ORDER IN COUNCIL	
RESERVATION	
CANCELLED	
SAND & GRAVEL	

NOTE: MINING RIGHTS IN PARCELS PATENTED PRIOR TO MAY 6 1917 VESTED IN ORIGINAL PATENTEES BY THE PUBLIC LANDS ACT R.S.O. 1910 CHAP. 380 SEC. 63 SUBSECT. 1

THE INFORMATION THAT APPEARS ON THIS MAP HAS BEEN COMPILED FROM VARIOUS SOURCES AND ACCURACY IS NOT GUARANTEED. THOSE WISHING TO STAKE MINING CLAIMS SHOULD CONSULT WITH THE MINING RECORDER, MINISTRY OF NORTHERN DEVELOPMENT AND MINES, FOR ADDITIONAL INFORMATION ON THE STATUS OF THE LANDS SHOWN HEREON.

MAR 20 1991

111 12123456

OPAP 91 PROJECT #1
 G.R. ZEBRUCK
 Lic. #10002

SCALE 1 INCH = 40 CHAINS

0 1000 2000 4000 8000
 METRES 0 1000 2000 4000 8000

AREA
SHOAL LAKE
 MNR ADMINISTRATIVE DISTRICT
KENORA
 MINING DIVISION
KENORA
 LAND TITLES / REGISTRY DIVISION
KENORA

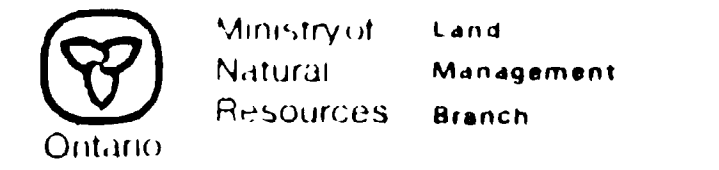

Date: FEBRUARY, 1994
 Number: **G-2642**

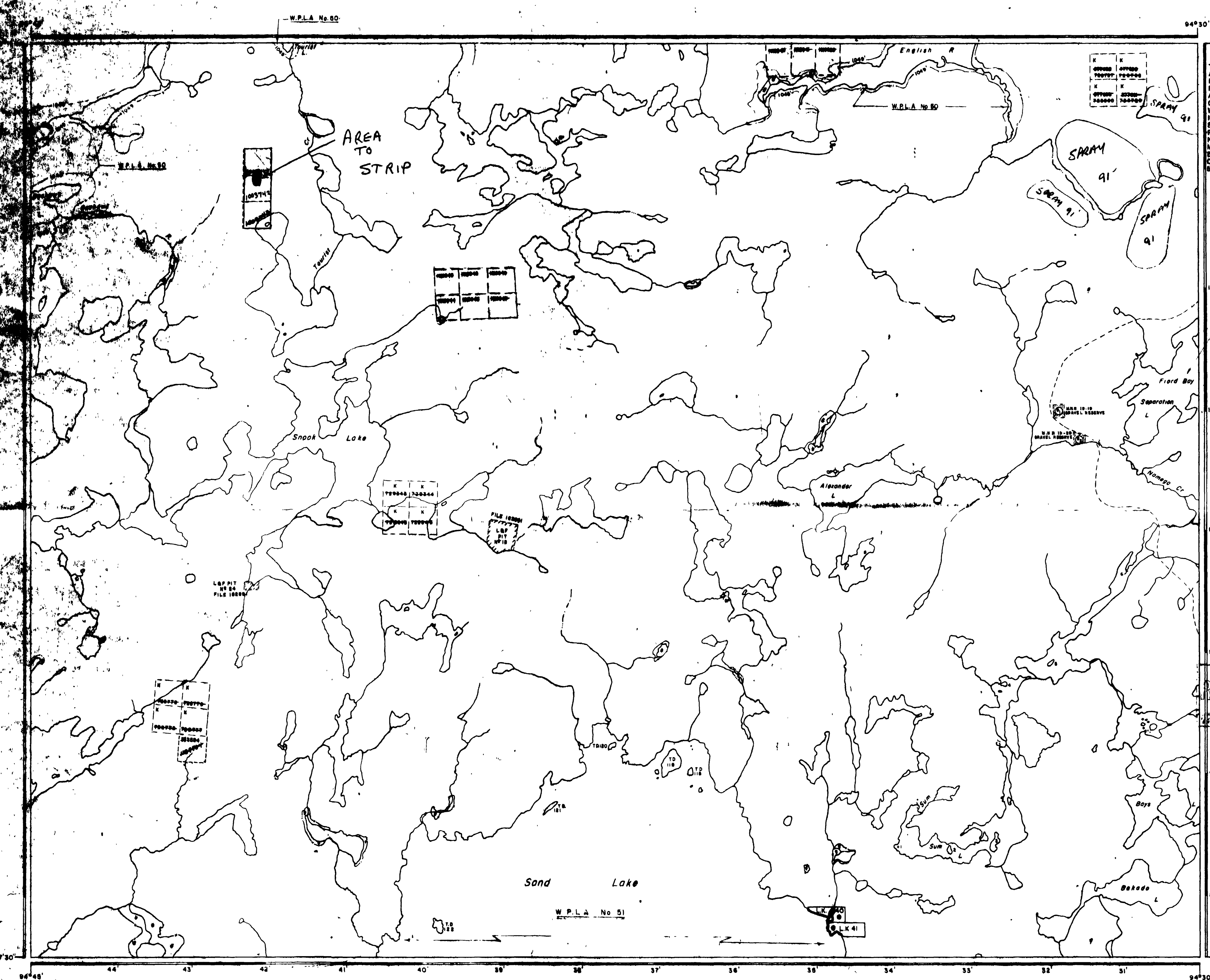

THE INFORMATION THAT APPEARS ON THIS MAP HAS BEEN COMPILED FROM VARIOUS SOURCES AND ACCURACY IS NOT GUARANTEED. THOSE WISHING TO MAKE ANY CLAIMS SHOULD CONSULT WITH THE MINING RECORDER, MINISTRY OF NORTHERN DEVELOPMENT AND MINES, FOR ADDITIONAL INFORMATION ON THE STATUS OF THE LANDS SHOWN HEREON.

L85-1619
8191-387

STOP LAKE AREA G-2523

CHARTER
as per

LEGEND

Highway and Route No.	[Symbol]
Other Road	[Symbol]
Trails	[Symbol]
Surveying Lines	[Symbol]
Locating Land Lines etc.	[Symbol]
Lot, Mining Claim, Parcel, etc.	[Symbol]
Unsurveyed Lines	[Symbol]
Lot Lines	[Symbol]
Parcel Boundary	[Symbol]
Spring, Stream, etc.	[Symbol]
Railway and Right of Way	[Symbol]
Utility Lines	[Symbol]
Non-Perennial Stream	[Symbol]
Flooding or Flooding Right	[Symbol]
Reservoir or Conveyance Plan	[Symbol]
Reservations	[Symbol]
Original Boundaries	[Symbol]
Water Features	[Symbol]
Mines	[Symbol]
Traverse Monument	[Symbol]
Town Camp (67 - 6700)	[Symbol]

DISPOSITION OF CROWN LANDS

Reserve	[Symbol]
Other	[Symbol]
Mineral Rights	[Symbol]
Surface Rights	[Symbol]
Other	[Symbol]

REFERENCES

LANDS WITHDRAWN FROM DISPOSITION

Description	Order No.	Date	Disposition	File
M. & S. - MINING RIGHTS ONLY				
M. & S. - SURFACE RIGHTS ONLY				
M. & S. - MINING AND SURFACE RIGHTS				

FLOODING

RESERVE FLOODING RIGHTS AND LAND UNDER THE WATERS OF THE ENGLISH RIVER BETWEEN SEPARATION LAKE AND CARIBOU FALLS, INCLUDING SOMMER LAKE AND TOLBERT LAKE, BELOW CONTOUR ELEVATION 1045.0, S.E. DATUM 1919, TO H.E.P.C. OF ONTARIO FOR THE DEVELOPMENT OF WATER POWER AT CARIBOU FALLS.

FOR DETAIL OF CONTOUR, REFER TO PLAN No. 48-BY DATED 15th MARCH 1958, (H.E.P.C. PLAN No. 800-3998), W.P.L.A. No. 50 DATED 21st DECEMBER 1959. FILE: 24179.

RESERVE FLOODING RIGHTS WITHOUT COMPENSATION ON SAND LAKE UP TO CONTOUR ELEVATION 1048.5, S.E. DATUM 1919, TO H.E.P.C. OF ONTARIO FOR THE DEVELOPMENT OF WATER POWER AT WHITEDOG FALLS ON THE WINNIPEG RIVER.

FOR DETAIL OF CONTOUR, REFER TO PLAN No. L-28-44 DATED 31st MARCH 1958, (H.E.P.C. PLAN No. 800-3286), W.P.L.A. No. 51 DATED 27th MARCH 1959. FILE: 12969, 4962, 90309.

RESERVE FLOODING RIGHTS ON FIDRO BAY OF SEPARATION LAKE TO A CONTOUR 8 ABOVE THE HIGH WATER MARK RESERVATION REQUESTED 30th NOVEMBER 1958. FILE: 24179.

SCALE: 1 INCH = 40 CHAINS

FEET 0 1000 2000 3000 4000 5000

SNOOK LAKE

MINING RIGHTS ONLY

REGISTRATION NO. 12129458

DATE: MAR 27 1959

FILE: 12129458

OPAP 91
PROJECT #6

G.R. ZEBRUCK
Lic. H10002

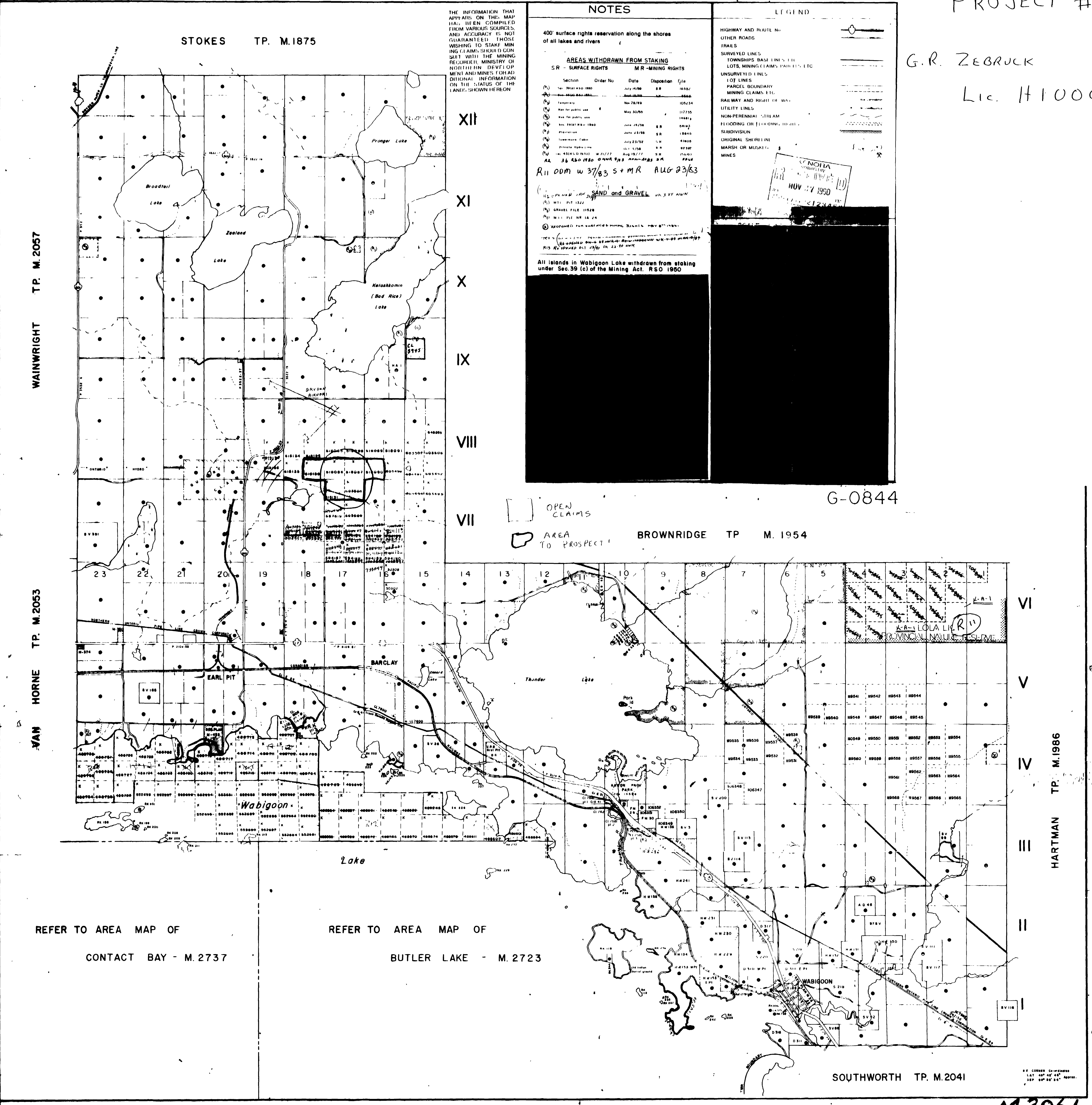

THE INFORMATION THAT APPEARS ON THIS MAP HAS BEEN COMPILED FROM VARIOUS SOURCES, AND ACCURACY IS NOT GUARANTEED. THOSE WISHING TO STAKE MINING CLAIMS SHOULD CONSULT WITH THE MINING REGULATOR, MINISTRY OF NORTHERN DEVELOPMENT AND MINES FOR ADDITIONAL INFORMATION ON THE STATUS OF THE LANDS SHOWN HEREON.

NOTES

400' surface rights reservation along the shores of all lakes and rivers

AREAS WITHDRAWN FROM STAKING

Section	Order No.	Date	Disposition	File
(P)	No. 281430 1980	July 24/80	S.R.	10257
(P)	No. 281430 1980	July 24/80	S.R.	10258
(P)	Temporary	Nov 28/79	S.R.	10234
(P)	Res. for public use	May 30/80	S.R.	10735
(P)	Res. for public use	July 24/80	S.R.	10883
(P)	Res. for public use	July 24/80	S.R.	10882
(P)	Subsurface claim	July 23/78	S.R.	10850
(P)	Private ownership	July 1/80	S.R.	89008
(P)	Private ownership	July 1/80	S.R.	89180
(P)	Private ownership	Aug 19/77	S.R.	10640
(P)	Private ownership	Aug 19/77	S.R.	10641
AA	36 850 1980	Order 8/83	Area-2883 S.R.	89248

R11 odm w 37/83 s + MR AUG 23/83

SAND and GRAVEL

OPEN CLAIMS

AREA TO PROSPECT

All islands in Wabigoon Lake withdrawn from staking under Sec.39 (c) of the Mining Act, RSO 1980

LEGEND

- HIGHWAY AND ROUTE NO.
- OTHER ROADS
- TRAILS
- SURVEYED LINES
- TOWNSHIP BASE LINES ETC.
- LOTS, MINING CLAIMS, PARCELS, ETC.
- UNSURVEYED LINES
- LOT LINES
- PARCEL BOUNDARY
- MINING CLAIMS, ETC.
- RAILWAY AND RIGHT OF WAY
- UTILITY LINES
- NON-PERENNIAL CHANNEL
- FLOODING OR ELEVATION CHANGE
- SUBDIVISION
- ORIGINAL SHIRE LINE
- MARSH OR MUSKEG
- MINES

NOTA
NOVA
NOV 27 1990

WAINWRIGHT TP. M.2057

VAN HORNE TP. M.2053

VII

VIII

IX

X

XI

XII

BROWN RIDGE TP. M. 1954

VI

V

IV

III

II

I

HARTMAN TP. M.1986

REFER TO AREA MAP OF
CONTACT BAY - M. 2737

REFER TO AREA MAP OF
BUTLER LAKE - M. 2723

SOUTHWORTH TP. M.2041

M2061

