



52F03NW0034 2.4281 BLUFFPOINT LAKE

010

RECEIVED

NOV 13 1981

MINING LANDS SECTION

REPORT ON MAGNETIC AND
ELECTROMAGNETIC SURVEYS
STRAW LAKE PROJECT
AREA OF BLUFFPOINT LAKE
DISTRICT OF KENORA, ONTARIO
N.T.S. - 52F/3NW

A. Pryslak
November, 1981

LP

INTRODUCTION

A program of linecutting was carried out in June, 1981, over a group of 32 contiguous claims located in the Bluffpoint Lake area, District of Kenora, Kenora Mining Division (claim map M-2471). Magnetometer and VLF-EM surveys were conducted over the grid in July, 1981.

The southwest corner of the claim block touches onto the east shore of Straw Lake. Access to the grid is via the Cedar Narrow's Road, constructed by Boisse - Cascade for logging purposes. This road connects with highway 812.

A contiguous grid of lines was cut over the land portion of the claims. Line spacing was at 400 feet with the section over the Zone A mineralization being at 200 foot intervals. Stations were established at 50 foot intervals along the grid lines.

The magnetometer used on the survey was a Geometrics G.816 unit which measures the total magnetic field to an accuracy of one gamma.

The electromagnetic instrument used was a Geonics E.M. 16 unit. The survey utilized the Seattle, Washington transmitting station. The instrument measures the in-phase and quadrature components of the induced electromagnetic fields.

GENERAL GEOLOGY

The claim group lies within the Wabigoon Greenstone Belt of the Superior Structural Province. More specifically, it occupies the extreme south part of the Lawrence Lake Batholith. This setting is illustrated by map No. 2443, the Kenora - Fort Francis sheet of the Ontario Geological Compilation Series.

A detailed geological survey was carried out over the entire grid. The two dominant lithologies encountered were granodiorite and diorite. The diorite is the older of the two intrusives and occupies the north part of the claims, the contact being oblique to the grid.

The granodiorite occupying the south part of the claims is quite variable in both texture and composition. Part of this is due to the migmatization with the diorite but the various phases may represent separate intrusions.

MAGNETOMETER SURVEY RESULTS

An area of positive magnetic responses of moderate amplitude occurs immediately to the north and northwest of the small lake shown on plan ST.3294. These responses correlate with the diorite intrusive. Farther to the west, in the region north of BL70N, the diorite appears to lose its magnetic characteristic.

A series of small isolated magnetic anomalies lie in the area south of the small lake. These features correlate with magnetite-bearing phases of the granodiorite.

The remainder of the grid is characterized by a relatively uniform magnetic low response. Exceptions are several small and isolated positive responses. Several of these features correspond with large rafts of diorite (36+00W, 6+00N) but others appear not to have any correlation with the diorite (28+00W, 3+00S).

ELECTROMAGNETIC SURVEY RESULTS

The electromagnetic survey identified a series of features that trend approximately N70'E. For the most part, there is no direct correlation with magnetic anomalies. Almost all of the anomalies fall within topographic depressions and are therefore, the response of conductive overburden.

Diamond drilling and bedrock geology show that the topographic depression also represent shears or fault structures. The VLF-EM responses may represent the combined affect of conductive overburden and dislocation structures.

A handwritten signature in cursive script, appearing to read 'A. Pryslak', written in dark ink.

A. Pryslak

GEOPHYSICAL - GEOLOGICAL
TECHNICAL DATA



52F03NW0034 2.4281 BLUFFPOINT LAKE

TO BE ATTACHED AS AN APPENDIX TO TECHNICAL REPORT
FACTS SHOWN HERE NEED NOT BE REPEATED IN REPORT
TECHNICAL REPORT MUST CONTAIN INTERPRETATION, CONCLUSIONS ETC.

RECEIVED
NOV 13 900
MINING LANE

Type of Survey Geophysical

Township or Area M. 2471 - Bluff Point I.

Claim holder(s) Selco Inc.

Author of Report T. Pryslak/ A. Gubins

Address 15 Hunterspoint Rd., Winnipeg, Manitoba

Covering Dates of Survey June '81 - Nov. '81
(linecutting to office)

Total Miles of Line cut 23 mls.

MINING CLAIMS TRAVERSED	
List numerically	
K	486956
(prefix)	(number)
K	486957
K	486958
K	486959
K	486960
K	486961
K	486962
K	486963
K	486964
K	486965
K	486966
K	486967
K	486968
K	486969
K	486970
K	486971
K	486976
K	486989
K	486990
K	486991
K	486992
K	486993
TOTAL CLAIMS	25

SPECIAL PROVISIONS CREDITS REQUESTED		DAYS per claim
	Geophysical	
ENTER 40 days (includes line cutting) for first survey.	-Electromagnetic	20
	-Magnetometer	40
	-Radiometric	
ENTER 20 days for each additional survey using same grid.	-Other	
	Geological	
	Geochemical	

AIRBORNE CREDITS (Special provision credits do not apply to airborne surveys)

Magnetometer _____ Electromagnetic _____ Radiometric _____
(enter days per claim)

DATE: Sept 16 '81 SIGNATURE: [Signature]
Author of Report or Agent

PROJECTS SECTION

Res. Geol. _____ Qualifications 2.3416

Previous Surveys _____

Checked by _____ date _____

GEOLOGICAL BRANCH [Signature]

Approved by _____ date _____

GEOLOGICAL BRANCH _____

Approved by _____ date _____

OFFICE USE ONLY

If space insufficient, attach list

Show instrument technical data in each space for
type of survey submitted or indicate "not applicable"

GEOPHYSICAL TECHNICAL DATA

GROUND SURVEYS

Number of Stations VLF = 1750 Mag = 1750 Number of Readings VLF=1750 Mag=1750

Station interval 50'

Line spacing 400' (same 200')

Profile scale or Contour intervals Every 100 gammas to 1500 gammas
(specify for each type of survey)
Every 500 gammas and thereafter

MAGNETIC

Instrument Geometrics G816

Accuracy - Scale constant + 1 gamma

Diurnal correction method Base Station

Base station location Intersection of B.L. and Cross Lines

ELECTROMAGNETIC

Instrument Geonics EM16

Coil configuration N.A.

Coil separation N.A.

Accuracy 1.1%

Method: Fixed transmitter Shoot back In line Parallel line

Frequency _____
(specify V.L.F. station)

Parameters measured In-phase and quad-phase components of vertical magnetic field
as a percentage of horizontal primary field.

GRAVITY

Instrument _____

Scale constant _____

Corrections made _____

Base station value and location _____

Elevation accuracy _____

INDUCED POLARIZATION - RESISTIVITY

Instrument _____

Time domain _____ Frequency domain _____

Frequency _____ Range _____

Power _____

Electrode array _____

Electrode spacing _____

Type of electrode _____

STRAW - 1 (Cont'd)

CLAIM NO.

K486994
K486995
K486997



Ministry of
Natural
Resources

Notification of recording
of assessment work credits

Lands Administration Branch
Mining Lands Section
Ministry of Natural Resources
Room 1617, Whitney Block
Queen's Park, Toronto
M7A 1W3

RECEIVED

OCT 27 1981

MINING LANDS SECTION

Date of recording of work: October 13, 1981

Recorded holder: Selco Inc.

Address: 55 University Ave, Suite 1700 TORONTO, Ontario M5J 2H7

Township or Area: Bluff Point Lake M-2471

Type of survey and number of Assessment days credit per claim	Mining claims
Geophysical	K.486956-71 inclusive K.486976 K.486989-95 inclusive K.486997
Electromagnetic <u>20</u> days	
Magnetometer <u>40</u> days	
Radiometric _____ days	
Induced polarization _____ days	
Section 86 (18) _____ days	
Geological _____ days	
Geochemical _____ days	
Man days <input type="checkbox"/> Airborne <input type="checkbox"/>	
Special provision <input checked="" type="checkbox"/> Ground <input checked="" type="checkbox"/>	

Notice to recorded holder:

- Survey reports and maps in duplicate be submitted to the Lands Administration Branch, Toronto within 60 days from the date of recording of this work.
- Reports and maps are being forwarded to the Lands Administration Branch with this letter.

M E Lemay
Acting Mining recorder
c.c. Selco Inc.

Recorded Holder SELCO Inc.
Township or Area Bluff Point Lake

Type of survey and number of Assessment days credit per claim	Mining Claims Assessed
Geophysical Electromagnetic _____ <u>17</u> _____ days Magnetometer _____ <u>34</u> _____ days Radiometric _____ days Induced polarization _____ days Section 86 (18) _____ days Geological _____ days Geochemical _____ days Man days <input type="checkbox"/> Airborne <input type="checkbox"/> Special provision <input checked="" type="checkbox"/> Ground <input checked="" type="checkbox"/> <input checked="" type="checkbox"/> Credits have been reduced because of partial coverage of claims. <input type="checkbox"/> Credits have been reduced because of corrections to work dates and figures of applicant.	K 486956 to 71 inclusive K 486976 K 486989 to 95 inclusive K 486997

Special credits under section 86 (15a) for the following mining claims

No credits have been allowed for the following mining claims

not sufficiently covered by the survey Insufficient technical data filed



Ministry of
Natural
Resources

BLUFF POINT LAKE AREA
M-2471

81-134

STRAW-1

THE MINING ACT REPORT OF WORK

A separate form is
required for each
type of work to be
recorded.

To the Recorder of KENORA Mining Division

I, SELCO INC. T190

name of Recorded Holder Prospector's Licence

55 UNIVERSITY AVE. SUITE 1700 TORONTO M5S 2H7

Post Office Address

do hereby report the performance of 500 days of GEOPHYSICAL EM

type of work

not before reported to be applied on the following contiguous claims

Claim No.	Days	Claim No.	Days	Claim No.	Days
K486956	20	K486962	20	K486968	20
K486957	20	K486963	20	K486969	20
K486958	20	K486964	20	K486970	20
K486959	20	K486965	20	K486971	20
K486960	20	K486966	20	K486976	20
K486961	20	K486967	20		

All the work was performed on Mining Claim (s) as listed above and attached
(In the case of geological and/or geophysical survey (s) where more than 18 claims are involved attach a schedule)

READ CAREFULLY: THE FOLLOWING INFORMATION IS REQUIRED BY THE MINING RECORDER.

For Manual Work, Stripping or Opening up of Mines, Sinking Shafts or Other Actual Mining Operations - Names and addresses of the men who performed the work and the dates and hours of their employment.

For Diamond and other Core Drilling - Footage, No. and angle of holes and diameter of core. Name and address of owner or operator of drill. Dates when drilling was done. Signed core log and sketch in duplicate.

For Compressed Air or Other Power Driven or Mechanical Equipment

Type of drill or equipment. Names and addresses of men engaged in operating equipment and the dates and hours of their employment.

For Power Stripping - Type of equipment. Name and address of owner or operator. Amount expended. Dates on which work was done. Proof of actual cost must be submitted within 30 days of recording.

With each of the above types of work sketches are required to show the location and extent of the work in relation to the nearest claim post. In the case of diamond or other core drilling the sketch must be submitted in duplicate.

For Geophysical, Geological, Geochemical Surveys and Expenditure Credits - the name of author of report. Covering dates of survey (linecutting & office). Type of instrument used. Total amount of expenditure. Technical reports, maps, expenditure breakdown, receipts must be filed in duplicate with the Minister within 60 days of recording.

For Land Survey - the name and address of Ontario Land surveyor.

The Required Information is as Follows: (Attach a list if this space is insufficient)

REPORT: T. Pryslak

DATE: November '81

SPECIAL PROVISIONS

INSTRUMENT: Geonics EM16. VLF

Date Sept. 16 '81

J. E. [Signature]
Signature of Recorded Holder or Agent

The Mining Act
Certificate Verifying Report of Work

I, T. Pryslak
15 Hunterspoint Road, Winnipeg, Manitoba
(Post Office Address)

KENORA
MINING DIV.
RECEIVED
OCT. 13. 1981
AM 7 8 9 10 11 12 1 2 3 4 5 6 PM

hereby certify:

1. That I have a personal and intimate knowledge of the facts set forth in the report of work annexed hereto, having performed the work or witnessed some during and/or after its completion.
2. That the annexed report is true.

Dated September 9, 1981

[Signature]
Signature

K-486956

THE PENALTY FOR MAKING A FALSE STATEMENT IN THIS REPORT AND/OR CERTIFICATE IS \$500. OR SIX MONTHS IMPRISONMENT OR BOTH

STRAW - 1 (Cont'd)

<u>CLAIM NO.</u>	<u>DAYS</u>
K486989	40
K486990	40
K486991	40
K486992	40
K486993	40
K486994	40
K486995	40
K486997	40

Certificate verifying report of work

I, T. Pryslak
15 Hunterspoint Road, Winnipeg, Manitoba

R U
OCT 13 1981
AM

FOR MAK



557771 557770 557767
 K K K
 557768 557835 557768
 K K K
 557826 557834 558671
 K
 558672

K. K
 486997 486996
 K. K K K K K K K
 486995 486994 486990 486989 486974 486973 486972 486971 560928
 486993 486991 486968 486965 486963 486962 486961 486960 486959 486958 486957 486956 486955 486954
 563496 563495 563494
 563493 C. 563490 C. 563491 C. 563492 C.
 8231 C. 4390 C. 4389 C. 3938 C. 3939 C. 3992 C. 5177 C. 5178 C. 5179 C.
 3942 C. 4388 C. 4387 C. 4002 C. 3943 C. 3944 C. 3945 C. 3946 C. 3978 C. 3990 C. 3991 C. 5174 C. 5175 C. 5176 C.
 4952 C. 4953 C. 4954 C. 4955 C. 6793 C. 8233 C. 4292 C. 4291 C. 4290 C. 5145 C. 4103 C. 4102 C. 4099 C. 4100 C.

22' 21' 20' 19' 18'

LAKE M. 2000

2.4281

1982 10 11

2.4281

Mining Recorder
Ministry of Natural Resources
808 Robertson Street
Box 5160
Kenora, Ontario
P9N 3X9

Dear Sir:

RE: Geophysical (Electromagnetic and Magnetometer)
Survey on Mining Claims K 486956 et al in the
Area of Bluff Point Lake

The Geophysical (Electromagnetic and Magnetometer) Survey assessment work credits as listed with my Notice of Intent dated September 3, 1982 have been approved as of the above date.

Please inform the recorded holder of these mining claims and so indicate on your records.

Yours very truly,

E.F. Anderson
Director
Land Management Branch

Whitney Block, Room 6450
Queen's Park
Toronto, Ontario
M7A 1W3
Phone: 416/965-1380

A. Barr:sc

cc: Selco Incorporated
Toronto, Ontario

cc: Resident Geologist
Kenora, Ontario



Ministry of
Natural
Resources

Ontario

SEPT 24, 1982

Your file:

Our file: 2.4281

September 3, 1982

Mr. Wade S. Mathew
Mining Recorder
Ministry of Natural Resources
808 Robertson Street
Box 5160
Kenora, Ontario
P9N 3X9

Dear Sir:

Enclosed are two copies of a Notice of Intent with statements listing a reduced rate of assessment work credits to be allowed for a technical survey. Please forward one copy to the recorded holder of the claims and retain the other. In approximately fifteen days from the above date, a final letter of approval of these credits will be sent to you. On receipt of the approval letter, you may then change the work entries on the claim record sheets.

Yours very truly,

E.F. Anderson
Director
Lands Administration Branch
Whitney Block, Room 6450
Queen's Park
Toronto, Ontario
M7A 1W3
Phone: 416/965-1316

/em

Encl.

cc: Selco Inc.
Toronto, Ontario

cc: Mr. G.H. Ferguson
Mining & Lands Commissioner
Toronto, Ontario



Ministry of
Natural
Resources

Notice of Intent
for Technical Reports

2.4281

September 8, 1982

An examination of your survey report indicates that the requirements of The Ontario Mining Act have not been fully met to warrant maximum assessment work credits. This notice is merely a warning that you will not be allowed the number of assessment work days credits that you expected and also that in approximately 15 days from the above date, the mining recorder will be authorized to change the entries on his record sheets to agree with the enclosed statement. Please note that until such time as the recorder actually changes the entry on the record sheet, the status of the claim remains unchanged.

If you are of the opinion that these changes by the mining recorder will jeopardize your claims, you may during the next fifteen days apply to the Mining and Lands Commissioner for an extension of time. Abstracts should be sent with your application.

If the reduced rate of credits does not jeopardize the status of the claims then you need not seek relief from the Mining and Lands Commissioner and this Notice of Intent may be disregarded.

If your survey was submitted and assessed under the "Special Provision-Performance and Coverage" method and you are of the opinion that a re-appraisal under the "Man-days" method would result in the approval of a greater number of days credit per claim, you may, within the said fifteen day period, submit assessment work breakdowns listing the employees names, addresses and the dates and hours they worked. The new work breakdowns should be submitted direct to the Lands Management Branch, Toronto. The report will be re-assessed and a new statement of credits based on actual days worked will be issued.



Mining Lands Comments

L.D.

V.L.F. plans need new data.

To: Geophysics

Comments

Approved Wish to see again with corrections

Date
JUNE 21/82

Signature
[Signature]

To: Geology - Expenditures

Comments

Approved Wish to see again with corrections

Date

Signature

To: Geochemistry

Comments

Approved Wish to see again with corrections

Date

Signature

To: Mining Lands Section, Room 6462, Whitney Block.

(Tel: 5-1380)

November 20, 1981

2.4281

Office of the Mining Recorder
Ministry of Natural Resources
808 Robertson Street
Box 5160
Kenora, Ontario
P9N 3X9

Dear Madam:

We have received reports and maps for a Geophysical (Electromagnetic and Magnetometer) Survey submitted under Special Provisions (credit for Performance and Coverage) on Mining Claims K.486956 et al, in the Area of Bluff Point Lake.

This material will be examined and assessed and a statement of assessment work credits will be issued.

Yours very truly,

E.F. Anderson
Director
Land Management Branch

Whitney Block, Room 6450
Queen's Park
Toronto, Ontario
M7A 1W3
Phone: 416/965-1380

H. Skura/bk

cc: Selco Inc.
Toronto, Ontario

SELCO INC.

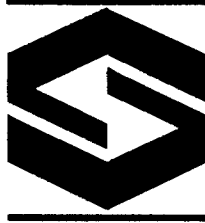

55 University Avenue Suite 1700
Toronto Ontario M5J 2H7 Telephone: (416) 361 0794
Telex: 06 22537 Cable: Selcoex Toronto

November 11, 1981

Mr. F.W. Mathews
Supervisor - Projects Unit,
Mining Lands Section,
Ministry of Natural Resources,
Room 6450, Whitney Block,
Queen's Park,
Toronto, Ontario

Dear Sir,

RE: STRAW PROJECT - PROPERTY 1 M-2472

Further to our Report of Work (October 8, 1981)
please find enclosed the following:-

CONTENT

(in duplicate)

Geophysical Report
Technical Data Sheets
Drawings No. ST.3294
ST.3294c (2)

Yours very truly,

SELCO INC.

J.E. Rackley
Claims Control Co-ordinator

JER/rt
Encl.

RECEIVED

NOV 13 1981

MINING LANDS SECTION

LAWRENCE LAKE M-2579

AREA OF

BLUFFPOINT LAKE

DISTRICT OF KENORA

KENORA MINING DIVISION

SCALE: 1-INCH 40 CHAINS

LEGEND

PATENTED LAND	Ⓟ
CROWN LAND SALE	C.S.
LEASES	Ⓛ
LOCATED LAND	Loc
LICENSE OF OCCUPATION	L.O.
MINING RIGHTS ONLY	M.R.O.
SURFACE RIGHTS ONLY	S.R.O.
ROADS	—
IMPROVED ROADS	—
KING'S HIGHWAYS	—
RAILWAYS	—
POWER LINES	—
MARSH OR MUSKEG	—
MINES	—

NOTES

400' Surface Rights Reservation along the shores of all Lakes and Rivers.

DATE OF ISSUE

FEB 24 1982

Ministry of Natural Resources
TORONTO

24281

NATIONAL TOPOGRAPHIC SERIES 52 F3

PLAN NO. M-2471

ONTARIO
MINISTRY OF NATURAL RESOURCES
SURVEYS AND MAPPING BRANCH

KAIARSKONS LAKE M-2430

BROOKS LAKE M-2473

NAPANEE LAKE M-2469



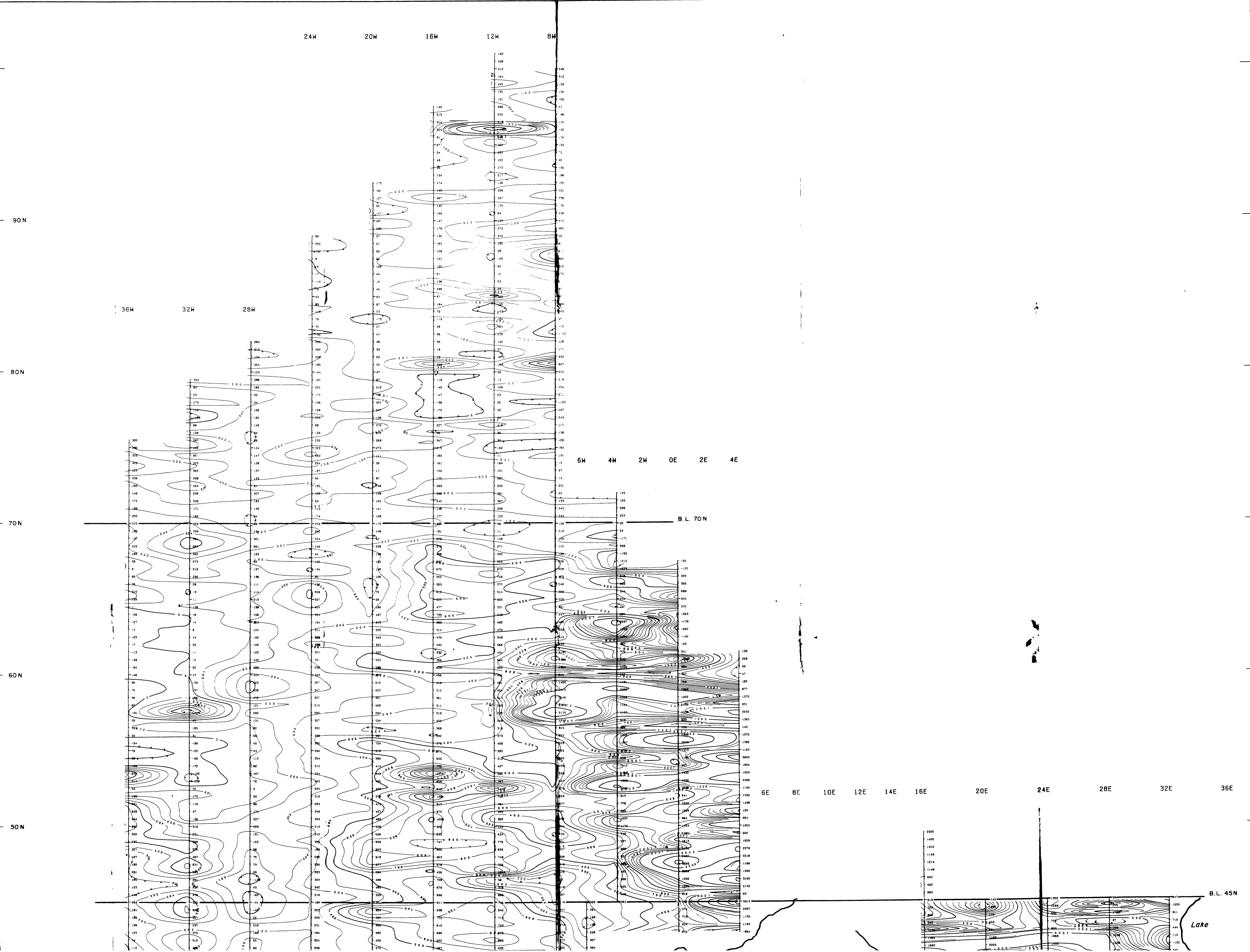

24W 20W 16W 12W 8W

36W 32W 28W

6W 4W 2W 0E 2E 4E

B.L. 70N

6E 8E 10E 12E 14E 16E 20E 24E 28E 32E 36E

B.L. 45N

Lake

90N

80N

70N

60N

50N

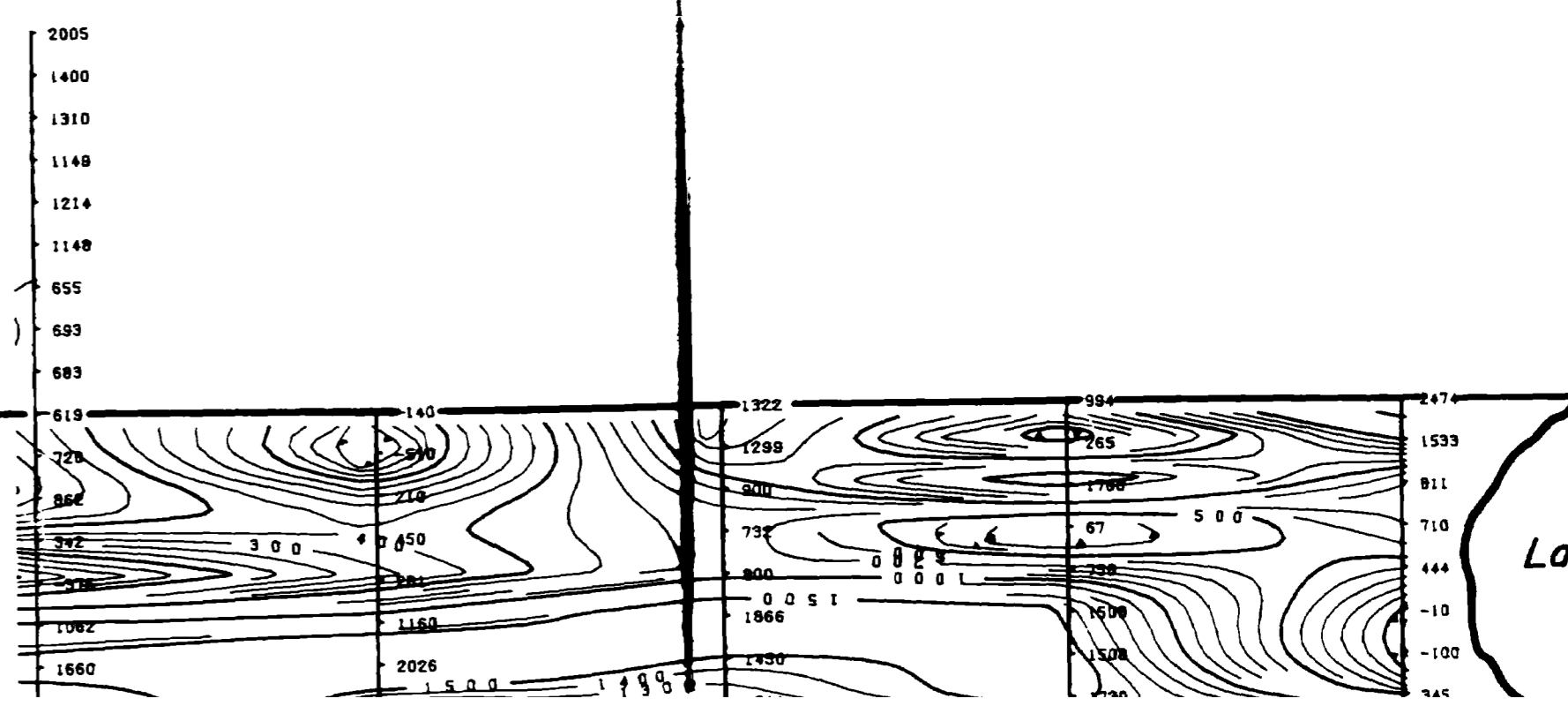

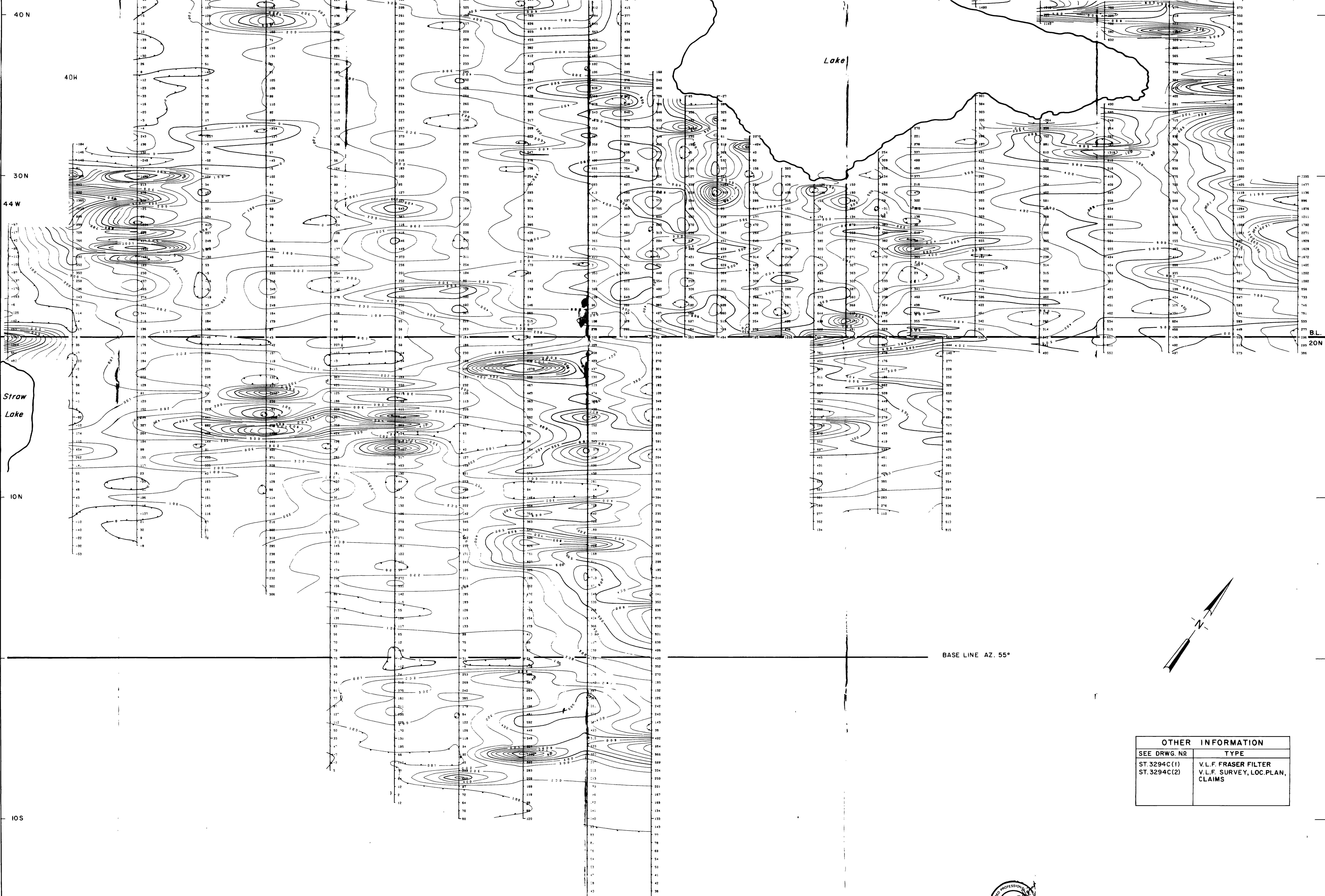

MAGNETOMETER INSTRUMENT
 TYPE: GEOMETRICS G 816
 Readings in Gammas: 1/24
 Base: 60,000 gammas
 Profile:
 Contour Interval: Every 100 gammas to ± 150C gammas
 Every 500 gammas thereafter

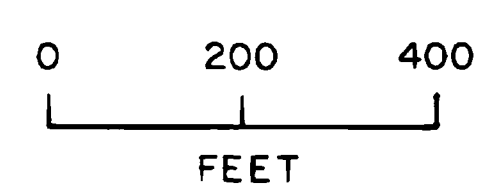

OTHER INFORMATION	
SEE DRWG. NO.	TYPE
ST. 3294C(1)	V.L.F. FRASER FILTER
ST. 3294C(2)	V.L.F. SURVEY, LOC. PLAN, CLAIMS

SELCO INC. EXPLORATION

STRAW LAKE PROJECT
FAIRSERVICE #3-PROPERTY I
MAG. SURVEY

DRAWN BY B. Spade	DATE July 1981	NTS	PLAN ST. 3294
TRACED BY D. G. J. J.	DATE Aug 1981		