



Name and Postal Address of Recorded Holder LOYDEX RESOURCES INC 24 KENTON CRT., WHITBY, ONTARIO L1N 5K7	Prospector's Licence No. T 1293
---	---

Summary of Work Performance and Distribution of Credits

Total Work Days Cr. claimed 32.0	Mining Claim		Work Days Cr.	Mining Claim		Work Days Cr.	Mining Claim		Work Days Cr.
	Prefix	Number		Prefix	Number		Prefix	Number	
for Performance of the following work. (Check one only)	K	705522							
<input type="checkbox"/> Manual Work									
<input type="checkbox"/> Shaft Sinking Drifting or other Lateral Work.									
<input checked="" type="checkbox"/> Compressed Air, other Power driven or mechanical equip.									
<input type="checkbox"/> Power Stripping									
<input type="checkbox"/> Diamond or other Core drilling									
<input type="checkbox"/> Land Survey									

ONTARIO GEOLOGICAL SURVEY
ASSESSMENT FILES
RESEARCH OFFICE
JUN 20 1984
RECEIVED

All the work was performed on Mining Claim(s): **705522**

Required Information eg: type of equipment, Names, Addresses, etc. (See Table Below)

Equipment: Atlas Copco Super Cobra and 3 foot Drill Steel
Prospector Picks
Shovels and axes

Ken Bernier
Box 1481
Scotix Lookout, Ont.
Nov 2, 3, 4, 5, 6 and 7, 1983 — 6 days @ 8 hrs/day = 48

Taylor Roy
General Delivery
Scotix Lookout, Ont.
Nov 2, 3, 4, 5, 6 and 7, 1983 — 6 days @ 8 hrs/day = 48
Min hrs → 96

Credit man days $\frac{96}{3} = 32$ days.

KENORA MINING DIV.
RECORDED
JUN 11 1984
AM 7:20 10:11:12:12:3:4:5:6 PM

Date of Report May 5, 1984	Recorded Holder or Agent (Signature) LS Nelson
--------------------------------------	--

Certification Verifying Report of Work

I hereby certify that I have a personal and intimate knowledge of the facts set forth in the Report of Work annexed hereto, having performed the work or witnessed same during and/or after its completion and the annexed report is true.

Name and Postal Address of Person Certifying L.J. NELSON, LOYDEX RESOURCES, INC 24 KENTON CRT., WHITBY, ONT, L1N 5K7	Date Certified May 5, 1984	Certified by (Signature) LS Nelson
--	--------------------------------------	--

Table of Information/Attachments Required by the Mining Recorder

Type of Work	Specific information per type	Other information (Common to 2 or more types)	Attachments
Manual Work	Nil	705503 Names and addresses of men who performed manual work/operated equipment, together with dates and hours of employment.	Work Sketch: these are required to show the location and extent of work in relation to the nearest claim post.
Shaft Sinking, Drifting or other Lateral Work			
Compressed air, other power driven or mechanical equip.	Type of equipment	Names and addresses of owner or operator together with dates when drilling/stripping done.	Work Sketch (as above) in duplicate
Power Stripping	Type of equipment and amount expended. Note: Proof of actual cost must be submitted within 30 days of recording.		
Diamond or other core drilling	Signed core log showing; footage, diameter of core, number and angles of holes.		
Land Survey	Name and address of Ontario land surveyor.	Nil	Nil



52F04SE5007 W8401-00131 DASH LAKE

900

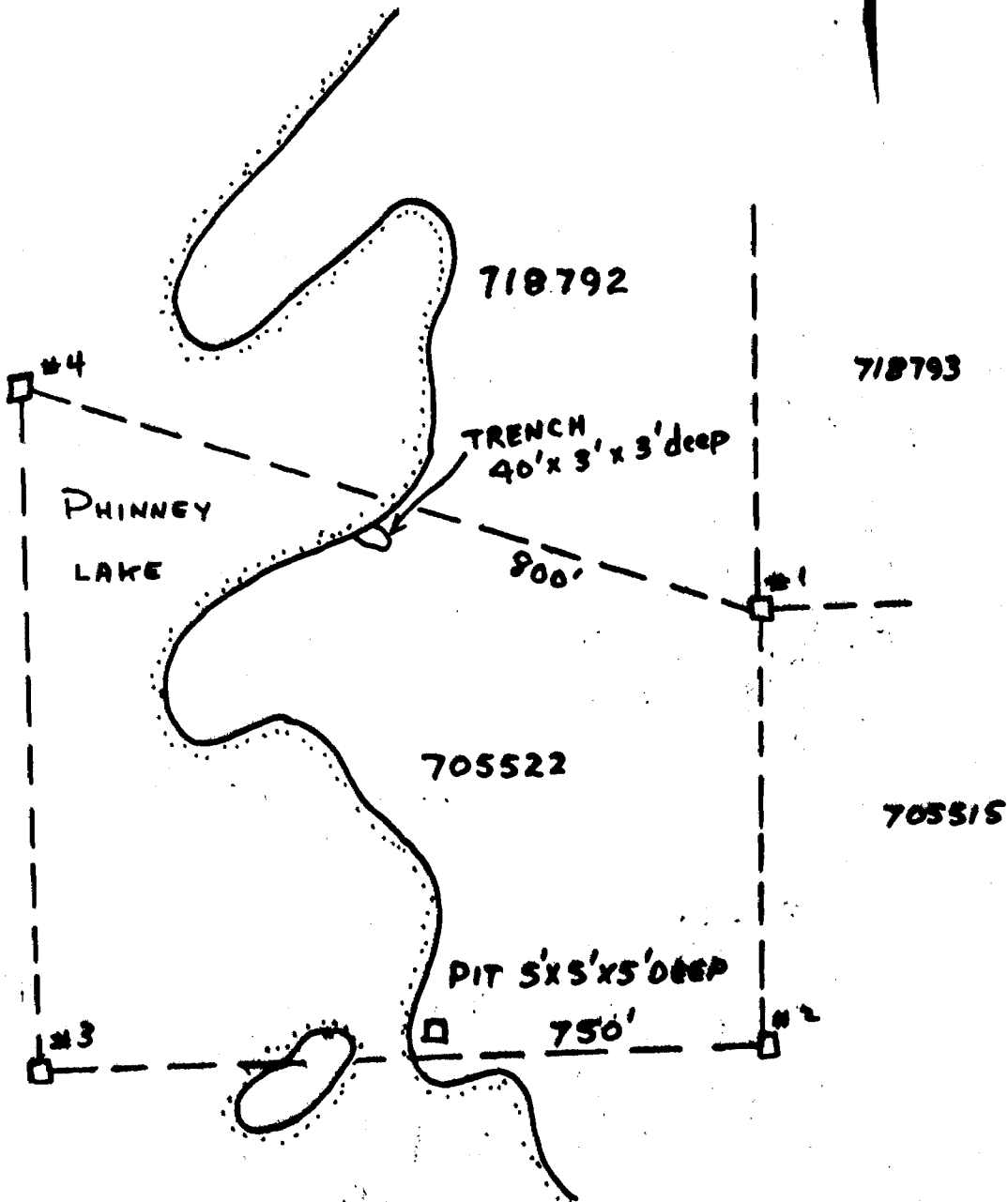

CS Nelson

Scale



LOYDEX RESOURCES INC
 PHINNEY LAKE PROJECT
 TRENCH LOCATIONS
 N.T.S 52-F-4 MAY 5, 1984

BROOKS LAKE M-2473

