

NORTH

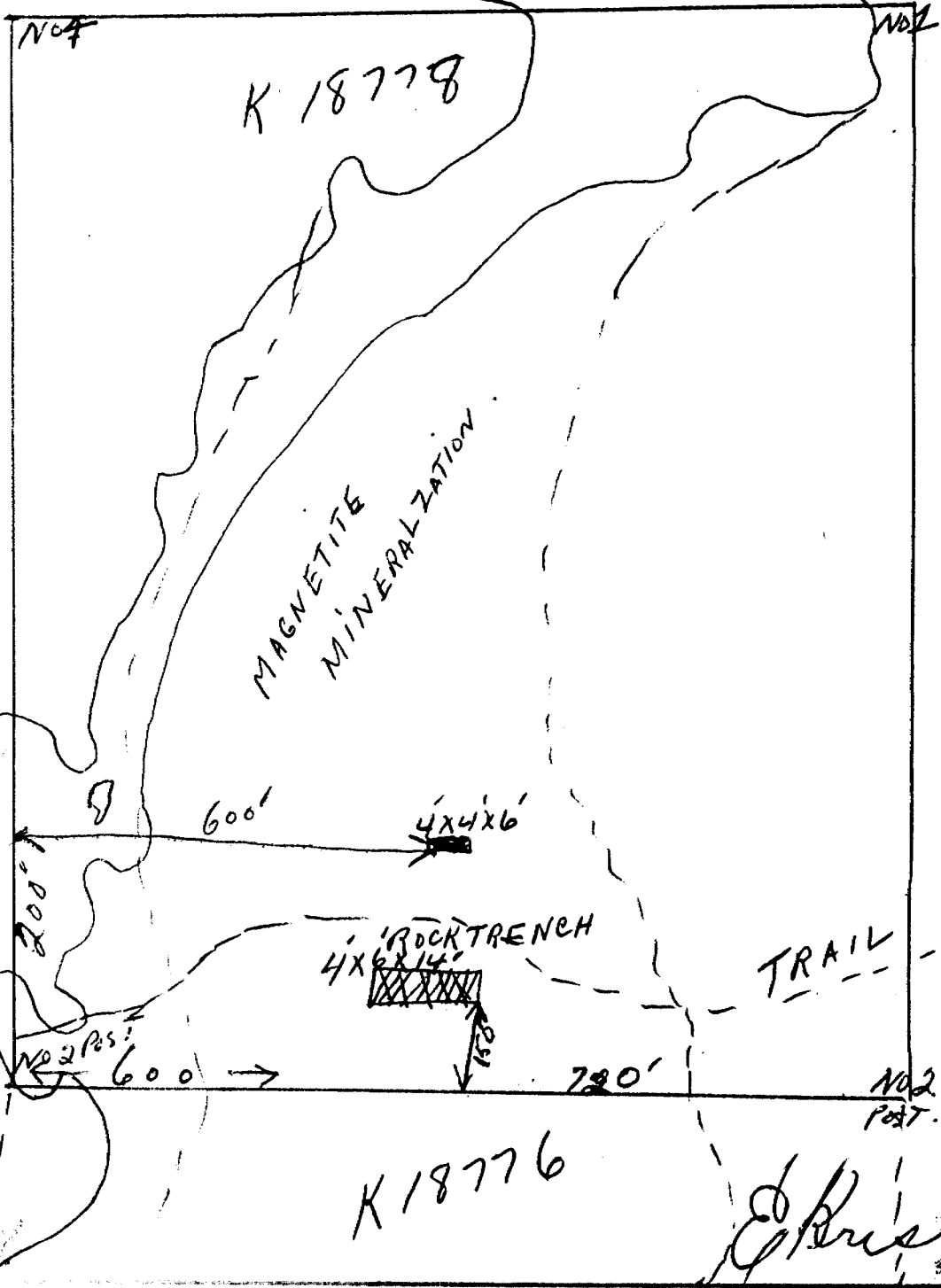

K 18778

MAGNETITE
MINERALIZATION

ROCK TRENCH
4x6x14

TRAIL

K 18776

E. Brisko

NORTH

MANUEL LABOUR WITH PIONEER 110'
(20 BILLS)

ROSS CREEK

ROCK TRENCH
4x50x

D.D.N.
ROCK TRENCH
4x6x50

QUARTZ FIELDS

K-18777

4x6x10

ROCK TRENCH

CABRO

CAMP

TRAIL

S.

1

2

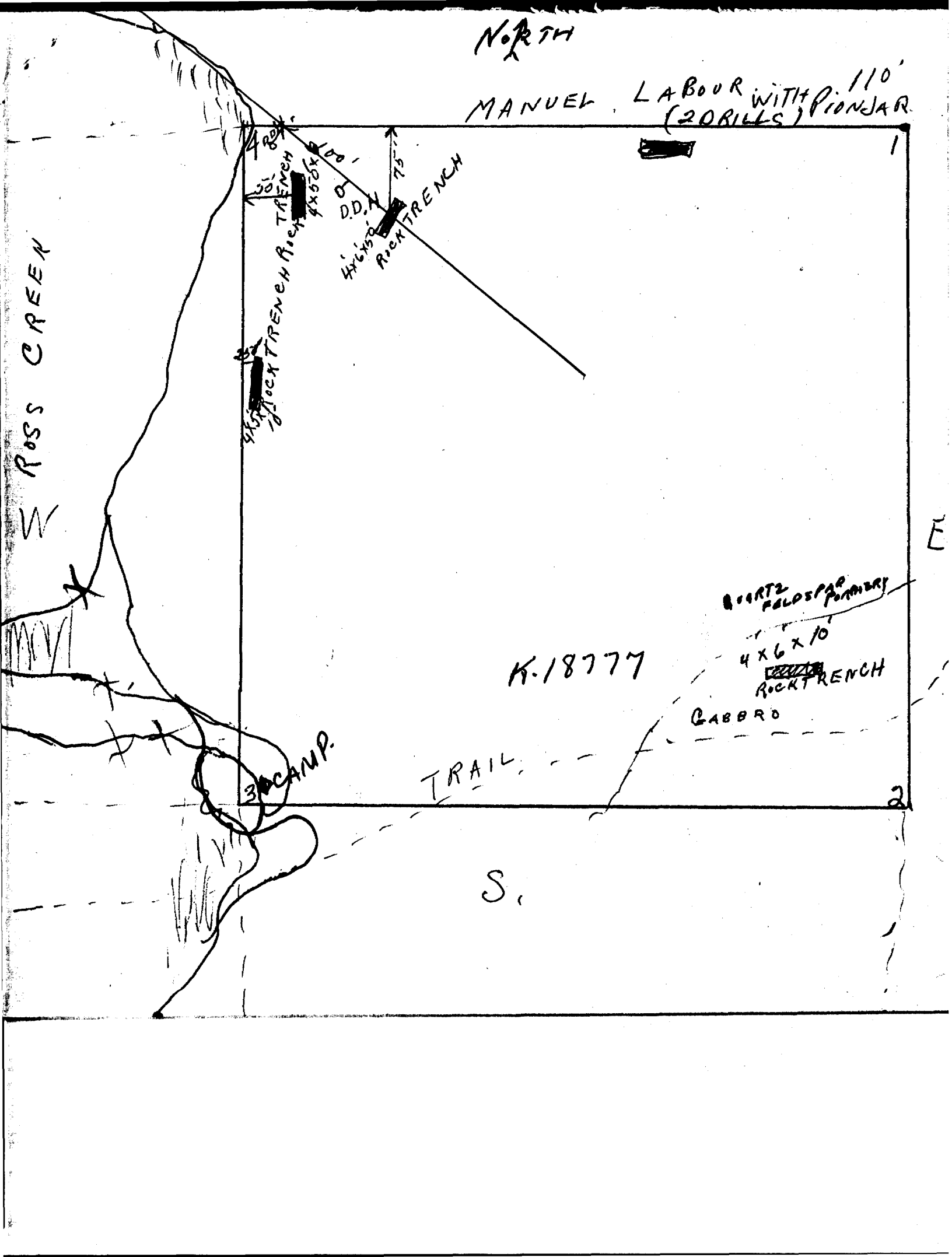

NORTH ↑

DENMARK L.

ROSS CREEK

NO 4 POST

NO 3

~~K 18775~~
K 18777

K 18774

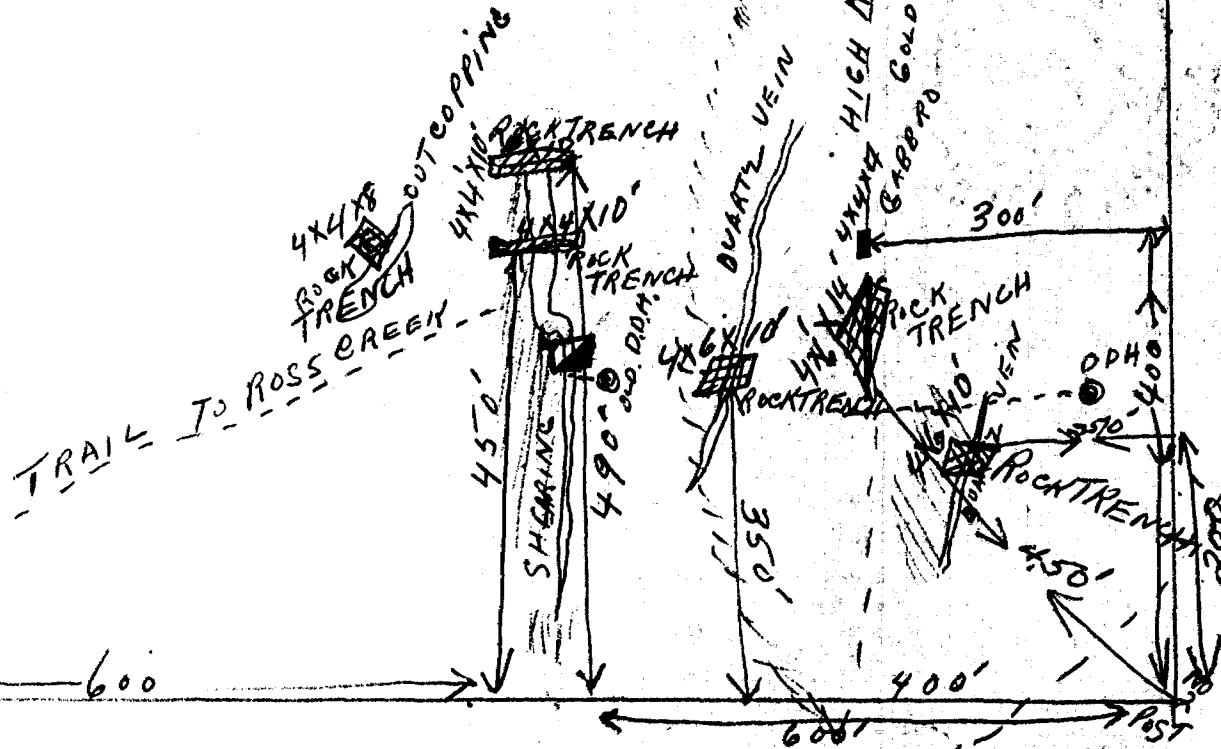

778

18777

N

No 4

No 1

W

18776

DRILLING & BLASTING

SHAFT

MZ

D.D. HOLES

CRIPPING

No 2

E

18775

No 3

No 2

18773

18774

S

Box 410
KENORA, Ont.

OWNERS:

J.R. Gray - E. Krisko, Operator

MODEL XRT - Serial No. 33113 - DIAMOND DRILL CORE LOG

<u>Footage</u>	<u>Type of Core</u>	<u>Claim No.</u>	<u>Date</u>
0 to 25	Quartz Porphery - Mineralized	K-18775	¹⁹⁵⁵ June 21
25 " 50	Sheared Greenstone	K-18775	June 21
50 " 75	Mineralized Andesite	K-18775	June 22
75 " 130	Quartz Feldspar Porphery	K-18775	June 23
0 " 25	Quartz Feldspar Porphery - Mineralized	K-18775	June 24
25 " 50	Sheared Greenstone & 4' Quartz Vein	K-18775	June 24
50 " 75	Sheared Greenstone - Carbonated	K-18775	June 25
75 " 100	Quartz Feldspar Poephery	K-18775	June 26
0 to 25	Perodtite & Massive Quartz Crystals	K-18778	Oct. 3
25 " 50	Mineralized Perodtite Crystals	K-18778	Oct. 4

DIAMOND DRILL CORE LOG

D.D.H. No.	Footage Drilled	Operater	Helper	Type of Core	Date	Location	Total Ft.
1	0 to 30	E. Krisko	Box 410 Kenora Ont.	Mineralized Gabbro	Sept. 10/57	S-E Corner K18777	30
1	30 to 55	"	"	"	Sept. 11/57	" "	25
2	0 to 25	E. KRISKO	Box 410 Kenora Ont.	Quartz-Felds Porphery	Sept. 12/57	N-W Corner K18777	25
2	25 to 60	"	"	Mineralized Quartz-Porph.	Sept. 13/57	" "	35
2	60 to 85	"	"	Quartz-Por	Sept. 14/57	" "	25
2	85 to 100	E. Krisko	"	QuartzPor	Sept. 15/57	" "	25
3	0 to 40'	E. Krisko	" " " J.R. Gray Kenricia Hotel	Gabbro	Sept. 16/57	100 ft. of Post K18777	40
3	40 to 70'	"	" " "	Gabbro Sulphides	Sept. 17/57	" " "	30
3	70-100	"	" " "M	Gabbro	Sept. 18/57	" " "	30
4	0 to 25	E. Krisko	Box 410 Kenora Ont. G. Le Roux Keewatin Ont.	Sulphides in Gabbro	Sept. 19/57	150 ft. SE of No. 4 p. K18777	25
4	25 to 50	E. Krisko	" " " " "	Sulphides in Gabbro	Sept. 20/57	" " "	25
**						Total Days	315

Edward Krisko



K18778

ROCK TRENCH

CAMP.

K18797

ROCK TRENCH D

BRACKET PINE

BLASTED ROCK TRENCHING

DIORITE

PIT EXCAVATION
ROCK B.D.H. NO 3

D.A.H. NO 35

ROCK TRENCHING

GABBRO

B.D.H. NO 2
ROCK TRENCH

GABBRO
SERPENTINE
CRYSTALS

QUARTZ FELDSPAR
PORPHYRY

ROCK TRENCH

ROSS GREEN

K18775

K
18776

GREEN STONES HEARING

GABBRO

K18773

K18774

SHEARING

ROCK TRENCH

W

E

DIAMOND DRILL CORE LOG

CLAIM NUMBER K 18778 & K 18775

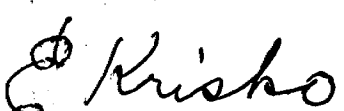
DATE	FOOTAGE DRILLED	Dia. of Core	No. of feet	NAME AND ADDRESS OF OPERATOR
Sept 2nd 1956	D.D.H. No.1 30 Degrees 0 to 30 ft. Gabbro	7/8"	30	E. Krisko Norman Ont. D. Strickland. Kenora Ont.
Sept 3rd. 1956	30 to 70 ft. Massive apitite crystals	"	40	
Sept. 4th. 1956	80 to 105 ft Gabbro(Peridotite)	"	35	
Sept. 5th. 1956	105 to 135 ft. quartz feldspar Pophery, Imenite.	"	30	
Sept 6th 1956	135 to 141 ft. gabbro with Imenite Mineralization	"	6	
Total		"	141 Ft.	
Sept 22/56	D.D.H. No. 2 85 Degrees 0 to 45 ft. Gabbro & Serpenti-	7/8"	45	E. Krisko Norman Ont. R. Gray Kenora Ont.
Sept. 23/56	45 to 85 ft ne Total	"	40 85ft.	
Sept. 24/56	D.D.H. No 3 45 DEgrees 0 to 25ft. Diorite & Greens -tone shearing.	7/8"	25ft.	E. Krisko Norman Ont. R. Gray Kenora Ont.
Complete No of ft. Drilled			251ft.	
				

Diamond Drill Core Log.

Core no.	Date	Footage	Operator-Address	Type of Material	Location	Total Ft. Drilled
1	Sept 17	0-30'	L. Ballard R.R. #2 Kenora, Ont.	Olivene Peridotite	s.w. Corner K18778	30
2	Sept 18	30-70'	L. Ballard R.R. #2 Kenora, Ont.	Olivene Peridotite	S.W. Corner K18778	40
1	Sept 19	70-100'	L. Ballard R. R. #2, Kenora, Ont.	Pegmatite Dyke	S.W. Corner K18778	30
2	Sept 20	0-25'	L. Ballard, R. R. #2, Kenora, Ont.	Cabbro	K18777	25
2	Sept 21	25-50'	L. Ballard, R. R. #2, Kenora, Ont.	Quartz Porphery	K18777	25
3	Sept 22	0-30'	L. Ballard, R. R. #2, Kenora, Ont.	Quartz Porphery	K18777	30
1	Sept 23	30-50'	L. Ballard, R. R. #2, Kenora, Ont.	Quartz & Diorite	K18777	20
					Total	200'

Signature- Operator/

L. Ballard