



GRANGES
EXPLORATION LTD.

885 WEST GEORGIA STREET,
23RD FLOOR
VANCOUVER, BC, CANADA V6C 3E8
TELEPHONE: (604) 687-2831
TELEX: 04-53409
TELECOPIER: (604) 687-8699



52F05NW0508 2.11721 LOBSTICK BAY (LAKE 0

010

September 28, 1988

Ms. M.E. Lemay
Acting Mining Recorder
Kenora Mining Division
808 Robertson Street
P.O. Box 5080
Kenora, Ontario
P9N 3X9

Dear Ms. Lemay:

Please find enclosed a report of work form applying assay credits to claims no. 977996, 977997, 977998 and 977999, situated in the Lobstick Bay Township, within the Kenora Mining District. The assaying was done in conjunction with diamond drilling reported on June 20, 1988.

I trust that everything is in order.

Yours very truly,

GRANGES EXPLORATION LTD.

Per:

Anne Laite
Geologist

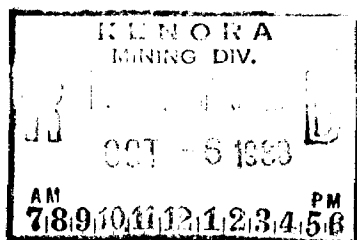

MIN-EN LABORATORIES LTD.

Specialists in Mineral Environments

705 West 15th Street North Vancouver, B.C. Canada V7M 1T2

PL.

PHONE: (604) 980-5814 DR (604) 988-4524

728362

TELEX: VIA USA 7601067 UC

Certificate of ASSAY

Company: GRANGES EXPLORATION
 Project:
 Attention: BERNARD E. GALBOURY

File: 8-55/F1
 Date: JAN 22/88
 Type: ROCK ASSAY

We hereby certify the following results for samples submitted.

Sample Number	AU G/TONNE	AU OZ/TON
ML10-2251	.01	0.001
ML10-2252	.02	0.001
ML10-2253	.02	0.001
ML10-2254	.04	0.001
ML10-2255	.01	0.001
ML10-2256	.01	0.001
ML10-2257	.03	0.001
ML10-2258	.04	0.001
ML10-2259	.02	0.001
ML10-2260	.03	0.001
ML10-2261	.01	0.001
ML10-2262	.01	0.001
ML10-2263	.01	0.001
ML10-2264	.02	0.001
ML10-2265	.01	0.001
ML10-2266	.03	0.001
ML10-2267	.11	0.003
ML10-2268	.02	0.001
ML10-2269	.04	0.001
ML10-2270	.01	0.001
ML10-2271	.16	0.005
ML10-2272	.21	0.006
ML10-2273	.17	0.005
ML10-2274	.08	0.002
ML10-2275	.04	0.001
ML10-2276	.01	0.001
ML10-2277	.20	0.006
ML10-2278	.48	0.014
ML10-2279	.02	0.001
ML10-2280	.04	0.001

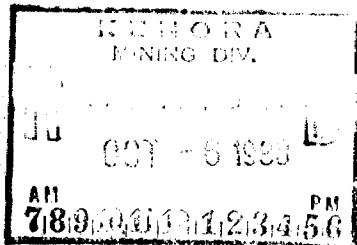

Certified by 

MIN-EN LABORATORIES LTD.

MIN-EN LABORATORIES LTD.

Specialists in Mineral Environments

705 West 15th Street North Vancouver, B.C. Canada V7M 1T2

PL

PHONE: (604) 980-5814 OR (604) 988-4524

TELEX: VIA USA 7601067 UC

Certificate of Assay

Company: GRANGES EXPLORATION
Project:
Attention: BERNERD E. GALBOURY

File: B-55/P2
Date: JAN 22/88
Type: ROCK ASSAY

We hereby certify the following results for samples submitted.

Sample Number	AU G/TONNE	AU OZ/TON
ML10-2281	.02	0.001
ML10-2282	.01	0.001
ML10-2283	.18	0.005
ML10-2284	.01	0.001
ML10-2285	.14	0.004
ML10-2286	.36	0.011
ML10-2287	.61	0.018
ML10-2288	.02	0.001
ML10-2289	.21	0.006
ML10-2290	.16	0.005
ML10-2291	.01	0.001
ML10-2292	.03	0.001
ML10-2293	.06	0.002
ML10-2294	.04	0.001
ML10-2295	1.64	0.048
ML10-2296	.07	0.002
ML10-2297	.61	0.018
ML10-2298	.07	0.002
ML10-2299	.04	0.001
ML10-2300	.02	0.001
ML10-2301	.08	0.002
ML10-2302	.03	0.001

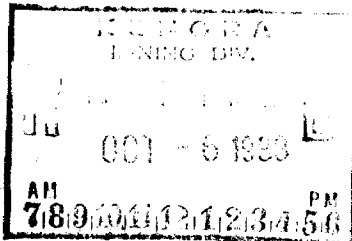

Certified by

Eric J. Mab

MIN-EN LABORATORIES LTD.

MIN-EN LABORATORIES LTD.

Specialists in Mineral Environments

705 West 15th Street North Vancouver, B.C. Canada V7M 1T2

PHONE: (604) 980-5814 OR (604) 988-4524

TELEX: VIA USA 7601067 UC

Certificate of ASSAY

Company: BRANGES EXPLORATION
 Project:
 Attention: BERNARD GAROURY

CLAIM 728368

File: 8-141/P2
 Date: FEB 9/88
 Type: ROCK ASSAY

We hereby certify the following results for samples submitted.

Sample Number	Agg G/TONNE	Agg OZ/TON
ML 14 2395	.01	0.001
ML 14 2396	.01	0.001
ML 14 2397	.02	0.001
ML 14 2398	.01	0.001
ML 14 2399	.02	0.001
ML 14 2400	.01	0.001
ML 14 2401	.02	0.001
ML 14 2402	.04	0.001
ML 14 2403	.01	0.001
ML 14 2404	.02	0.001
ML 14 2405	.01	0.001
ML 14 2406	.02	0.001
ML 14 2407	.01	0.001
ML 14 2408	.01	0.001
ML 14 2409	.01	0.001
ML 14 2410	.02	0.001
ML 14 2411	.02	0.001
ML 14 2412	.02	0.001
ML 14 2413	.03	0.001
ML 14 2414	.02	0.001
ML 14 2415	.01	0.001
ML 14 2416	.01	0.001
ML 14 2417	.02	0.001
ML 14 2418	.02	0.001
ML 14 2419	.01	0.001
ML 14 2420	.04	0.001
ML 14 2421	.01	0.001
ML 14 2422	.02	0.001
ML 14 2423	.01	0.001
ML 14 2424	.02	0.001

KEWONA
 MINING DIV.
 OCT - 6 1988
 AM 7:89 10:11 12:1 2:3 4:56 PM

Certified by

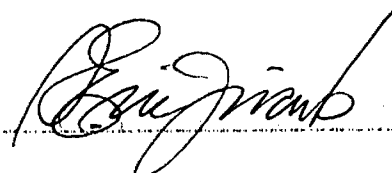

MIN-EN LABORATORIES LTD.

MIN-EN LABORATORIES LTD.

Specialists in Mineral Environments

705 West 15th Street North Vancouver, B.C. Canada V7M 1T2

PHONE: (604) 980-5814 OR (604) 988-4524

TELEX: VIA USA 7601067 UC

Certificate of ASSAY

Company: GRANBES EXPLORATION
 Project:
 Attention: BERNARD BABOURY

728368

File: 8-141/P1
 Date: FEB 9/88
 Type: ROCK ASSAY

We hereby certify the following results for samples submitted.

Sample Number	AU G/TONNE	AU OZ/TON
ML13 2365	.06	0.002
ML13 2366	.03	0.001
ML13 2367	.03	0.001
ML13 2368	.04	0.001
ML13 2369	.08	0.002
ML13 2370	.05	0.001
ML13 2371	.03	0.001
ML13 2372	.02	0.001
ML13 2373	.04	0.001
ML13 2374	.06	0.002
ML13 2375	.05	0.001
ML13 2376	.01	0.001
ML13 2377	.01	0.001
ML13 2378	.02	0.001
ML13 2379	.01	0.001
ML13 2380	.01	0.001
ML13 2381	.20	0.006
ML13 2382	.02	0.001
ML13 2383	.03	0.001
ML13 2384	.01	0.001
ML13 2385	.03	0.001
ML13 2386	.02	0.001
ML13 2387	.02	0.001
ML13 2388	.01	0.001
ML13 2389	.02	0.001
ML13 2390	.01	0.001
ML13 2391	.03	0.001
ML13 2392	.02	0.001
ML13 2393	.01	0.001
ML13 2394	.02	0.001

KEMORA
 MINING DIV.
 OCT - 6 1988
 AM 7:89 PM 11:23:45

Certified by *Bernard Baboury*

MIN-EN LABORATORIES LTD.

MIN-EN LABORATORIES LTD.

Specialists in Mineral Environments

705 West 15th Street North Vancouver, B.C. Canada V7M 1T2

Copy PL.
TELEX: VIA USA 7601067 UC

PHONE: (604) 980-5814 OR (604) 986-4524

Certificate of ASSAY

Company: GRANGES EXPLORATION
Project: HOLE ML 11
Attention: B. GABAURY

CUAIM 728362

File: 8-111/P1
Date: FEB 3 /87
Type: ROCK ASSAY

We hereby certify the following results for samples submitted.

Sample Number	AU G/TONNE	AU OZ/TON
2303	.17	0.005
2304	.21	0.006
2305	.04	0.001
2306	.11	0.003
2307	.03	0.001
2308	.21	0.006
2309	.11	0.003
2310	.03	0.001
2311	1.60	0.047
2312	1.00	0.029
2313	.19	0.006
2314	.02	0.001
2315	.63	0.018
2316	.03	0.001
2317	.01	0.001
2318	.02	0.001
2319	.03	0.001
2320	.14	0.004
2321	.02	0.001
2322	.03	0.001
2323	.02	0.001
2324	.03	0.001
2325	.11	0.003
2326	.05	0.001
2327	.02	0.001
2328	.01	0.001
2329	.02	0.001
2330	.17	0.005
2331	.03	0.001
2332	1.23	0.036

MIN-EN LABORATORIES LTD.
MINING DIV.
OCT - 6 1987
AM 7 89 00 12 1 2 3 4 5 6 PM

Certified by *[Signature]*

MIN-EN LABORATORIES LTD.

MIN-EN LABORATORIES LTD.

Specialists in Mineral Environments

705 West 15th Street North Vancouver, B.C. Canada V7M 1T2

PHONE: (604) 980-5814 DR (604) 988-4524

TELEX: VIA USA 7601067 UC

Certificate of ASSAY

Company: GRANGES EXPLORATION
Project: HOLF ML 11
Attention: B. GABAURY

File: 8-111/P2
Date: FEB 2 /87
Type: ROCK ASSAY

We hereby certify the following results for samples submitted.

Sample Number	AU G/TONNE	AU OZ/TON
2333	.21	0.006
2334	.22	0.006
2335	.03	0.001
2336	.02	0.001
2337	.03	0.001

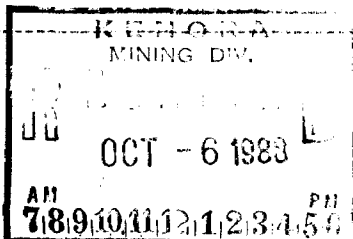

Certified by

[Handwritten Signature]

MIN-EN LABORATORIES LTD.



52F05NW0508 2.11721 LOBSTICK BAY (LAKE O

900

88/#257

Type of Survey(s): **DIAMOND DRILLING - ASSAYS**

Claim Holder(s): **GRANGES EXPLORATION LTD.**

Address: **2300 - 885 WEST GEORGIA ST. VANCOUVER BC V6C 3E8**

Survey Company: **MIN EN LABORATORIES LTD.**

Name and Address of Author (of Geo-Technical report):

Township or Area: **LOBSTICK BAY G.2627**

Prospector's Licence No.: **2.11721 T 1970**

Date of Survey (from & to): **22 01 88** to **29 02 88**

Total Miles of line Cut:

Credits Requested per Each Claim in Columns at right

Special Provisions	Geophysical	Days per Claim
For first survey: Enter 40 days. (This includes line cutting)	- Electromagnetic	
	- Magnetometer	
	- Radiometric	
For each additional survey: using the same grid: Enter 20 days (for each)	- Other	
	Geological	
	Geochemical	
Man Days	Geophysical	Days per Claim
Complete reverse side and enter total(s) here	- Electromagnetic	
	- Magnetometer	
	- Radiometric	
	- Other	
	Geological	
	Geochemical	
Airborne Credits	Geophysical	Days per Claim
Note: Special provisions credits do not apply to Airborne Surveys.	- Electromagnetic	
	- Magnetometer	
	- Radiometric	

Mining Claims Traversed (List in numerical sequence)

Prefix	Mining Claim Number	Expend. Days Cr.	Prefix	Mining Claim Number	Expend. Days Cr.
K	977996	23			
	977997	23			
	977998	23			
	977999	23			

ONTARIO GEOLOGICAL SURVEY
ASSESSMENT FILES
OFFICE
DEC 1 1988
RECEIVED

RECEIVED
OCT 19 1988
MINING LANDS SECTION

Expenditures (excludes power stripping)

Type of Work Performed: **DIAMOND DRILL - ASSAYS**

Performed on Claim(s): **728368, 728362**

Calculation of Expenditure Days Credits

Total Expenditures: **\$ 1396.50** ÷ **15** = **93** Total Days Credits

Instructions: Total Days Credits may be apportioned at the claim holder's choice. Enter number of days credits per claim selected in columns at right.

Total number of mining claims covered by this report of work: **4**

977 996

For Office Use Only

Total Days Cr. Recorded: **92** Date Recorded: **88 Oct 6**

Mining Recorder: **Scott Rivett**

Date Reported as Recorded: **21 Nov 88** Branch District: **W. 100**

Date: **Oct. 3/88** Recorded Holder or Agent (Signature): **[Signature]**

Certification Verifying Report of Work

I hereby certify that I have a personal and intimate knowledge of the facts set forth in the Report of Work annexed hereto, having performed the work or witnessed same during and/or after its completion and the annexed report is true.

Name and Postal Address of Person Certifying: **GEORGE BITNOFF, Vice President Exploration, Granges Exploration Ltd (as above)**

Date Certified: **Oct. 3/88** Certified by (Signature): **[Signature]**

LOBSTICK BAY LAKE OF THE WOODS G-21

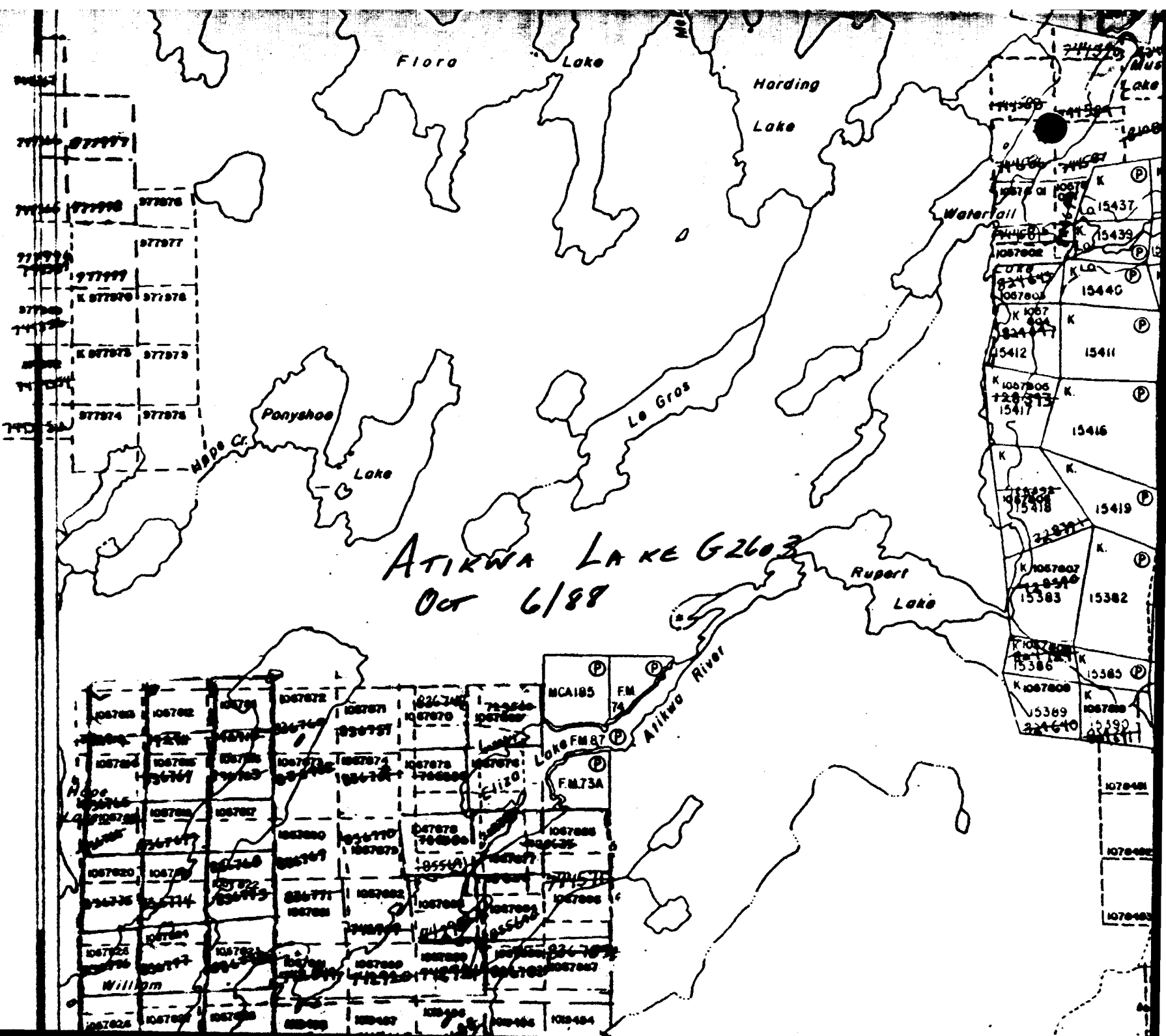

LOGSTICK BAY
52627
Oct. 6/88

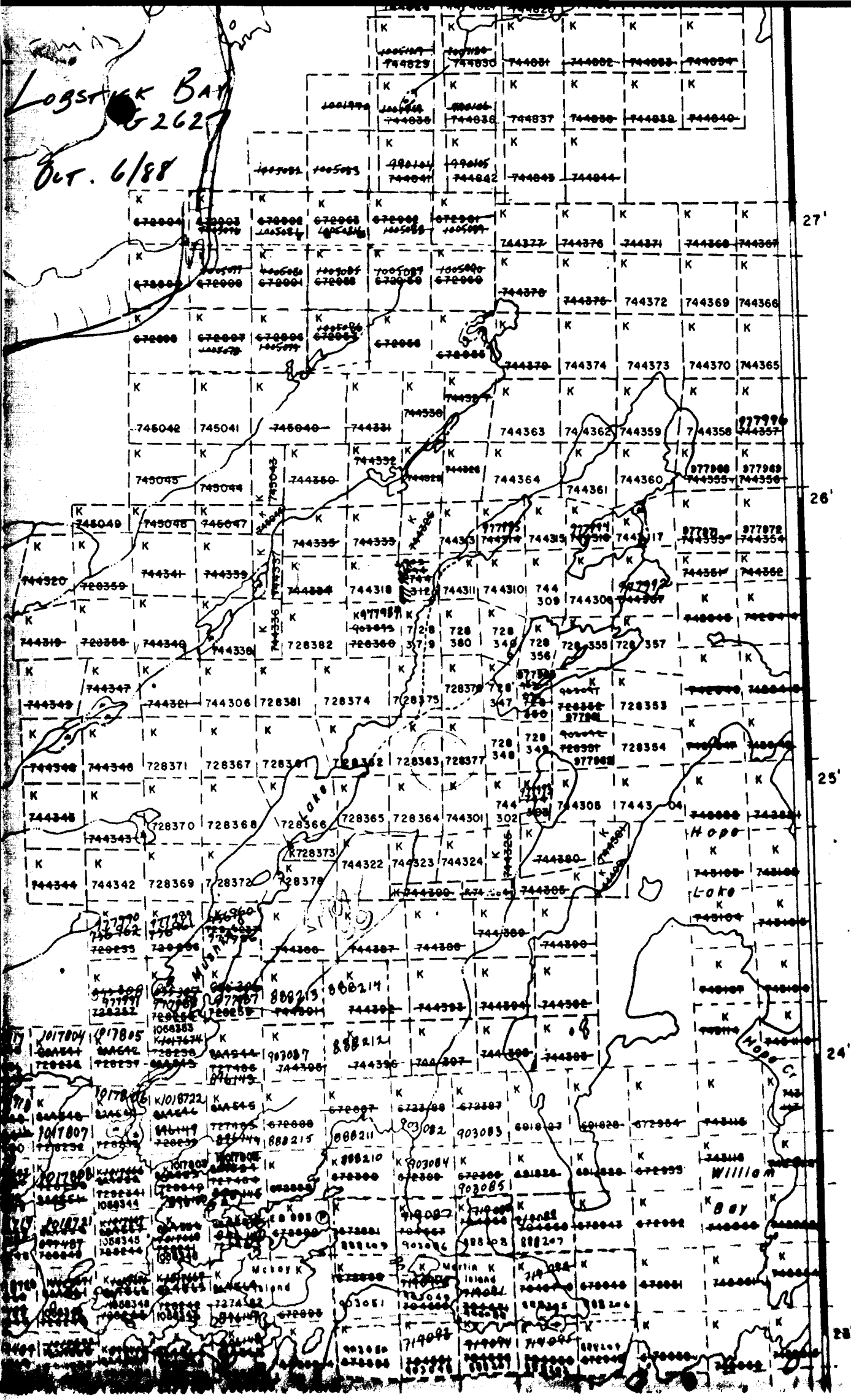

27'

26'

25'

24'

23'

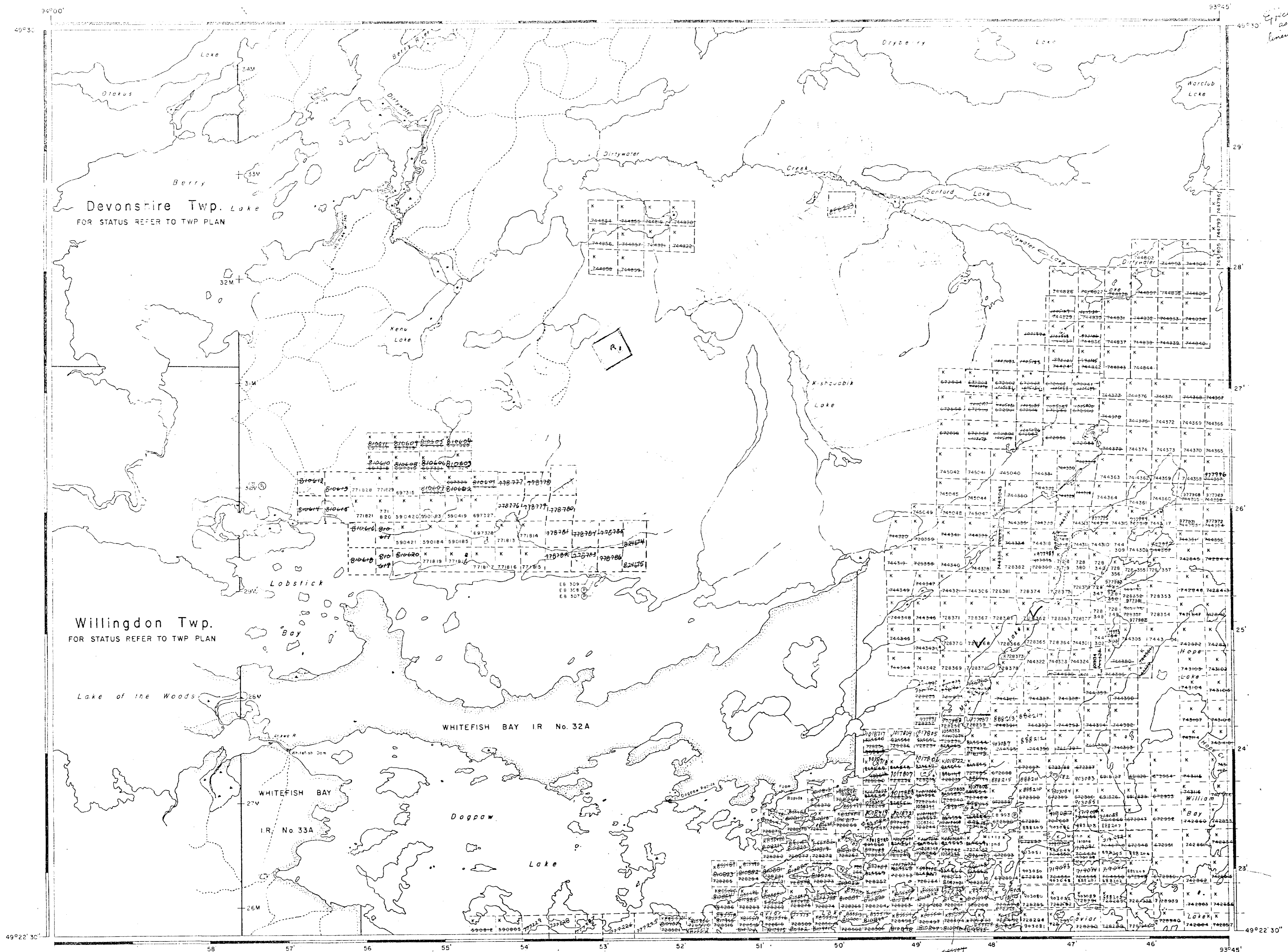

LEGEND

HIGHWAY AND ROUTE No.	
OTHER ROADS	
TRAILS	
SURVEYED LINES:	
TOWNSHIP, GAGE LINES, ETC.	
LOT, MINING CLAIMS, PARTIALS, ETC.	
UNSURVEYED LINES:	
LOT LINES	
PARCEL BOUNDARY	
MINING CLAIMS ETC.	
RAILWAY AND RIGHT OF WAY	
UTILITY LINES	
NON PERENNIAL STREAM	
FLOODING OR FLOODING RIGHTS	
SUBDIVISION OR CONDUIT PLAN	
RESERVATIONS	
ORIGINAL SHORELINE	
MARSH OR MUSKEG	
MINES	
TRANSVERSE MONUMENT	

DISPOSITION OF CROWN LANDS

TYPE OF DOCUMENT	SYMBOL
PATENT, SURFACE & MINING RIGHTS	
" SURFACE RIGHTS ONLY	
" MINING RIGHTS ONLY	
LEASE, SURFACE & MINING RIGHTS	
" SURFACE RIGHTS ONLY	
" MINING RIGHTS ONLY	
LICENCE OF OCCUPATION	
ORDER-IN-COUNCIL	
RESERVATION	
CANCELLED	
SAND & GRAVEL	

NOTE: MINING RIGHTS IN PARCELS PATENTED PRIOR TO MAY 6, 1912, VESTED IN ORIGINAL PATENTEES BY THE PUBLIC LANDS ACT, R.S.O. 1970, CHAP. 380, SEC. 63, & 65 SEC. 1.

REFERENCES

AREAS WITHDRAWN FROM DISPOSITION

M.R.O. - MINING RIGHTS ONLY
 S.R.O. - SURFACE RIGHTS ONLY
 M.+S. - MINING AND SURFACE RIGHTS

Description	Order No.	Date	Disposition	File
WITHDRAWN	WWR-101/81	10/21/81	S+MR	

SAND AND GRAVEL

M.N.R. GRAVEL RESERVE 10-14, FILE 188521

Crown Game Preserve shown thus

By Order in Council Oct. 5, 1961.

Flooding rights reserved up to 1064 above mean sea level on all lakes bordering on Lake of the Woods.

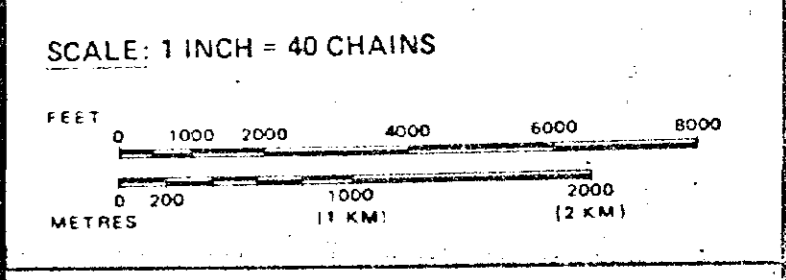

AREA

LOBSTICK BAY

M.N.R. ADMINISTRATIVE DISTRICT OF KENORA MINING DIVISION

KENORA

MINING DIVISION

KENORA

LAND TITLES / REGISTRY DIVISION

KENORA

Ministry of Natural Resources Ontario

Land Management Branch

Date: FEBRUARY, 1984

Number: **M-2635** **G-2627**

