



52F05SE0053 38 ROWAN LAKE

010

DIAMOND DRILLING

Area: Rowan Lake

Report No: 38

WORK PERFORMED FOR: Nuinsco Resources Ltd.

RECORDED HOLDER: SAME AS ABOVE [X]

: OTHER [ ]

<u>CLAIM NO.</u>	<u>HOLE NO.</u>	<u>FOOTAGE</u>	<u>DATE</u>	<u>NOTE</u>
K 612305	CLS-1-83	300'	Oct/85	(1)
	CLS-2-83	548'	Oct/85	(1)
	CLS-7-83	198'	Oct/85	(1)
K 612307	CLS-5-83	200'	Oct/85	(1)

NOTES: (1) #206-85

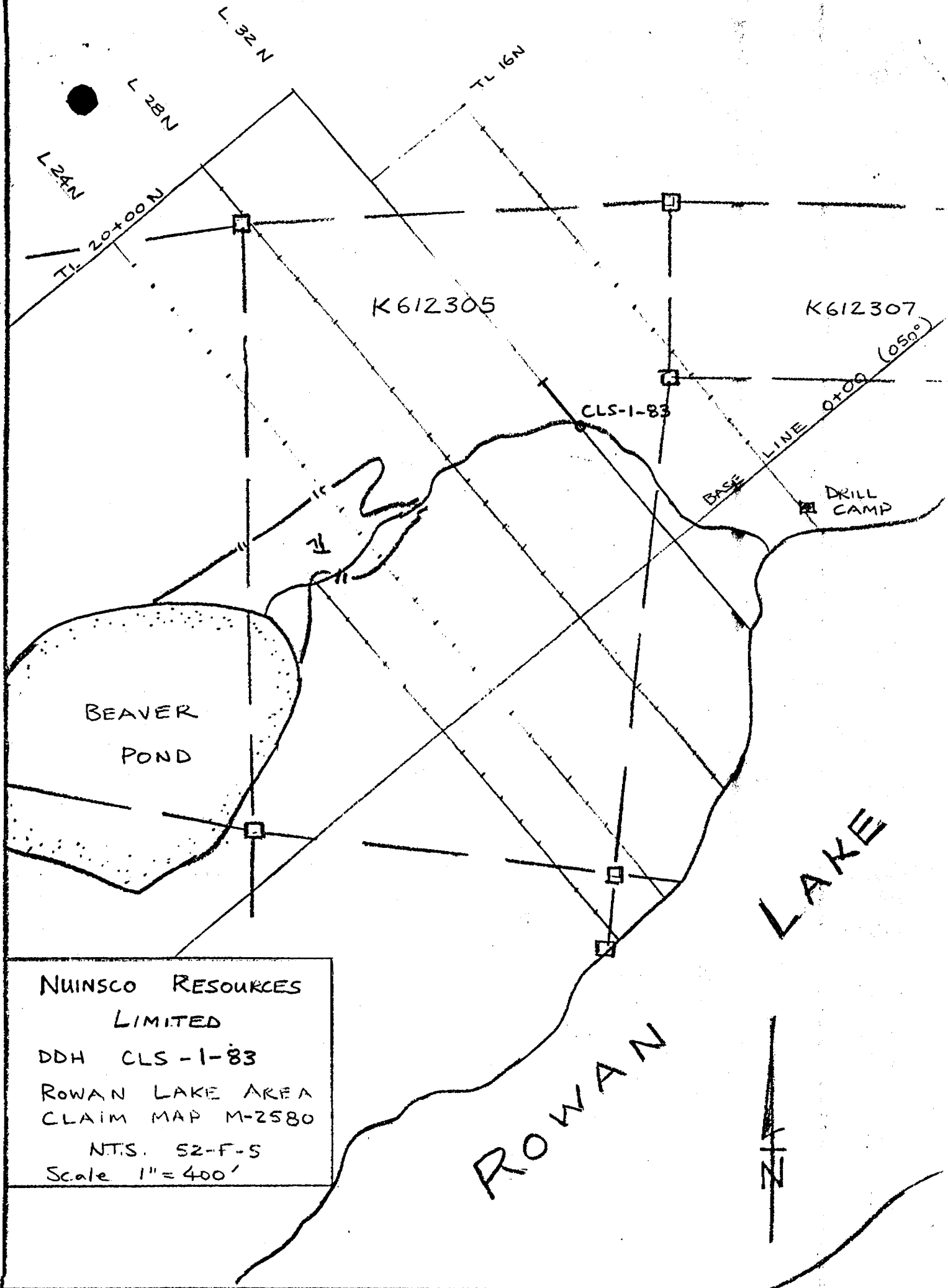

NUINSCO RESOURCES  
LIMITED  
DDH CLS-1-83  
ROWAN LAKE AREA  
CLAIM MAP M-2580  
NTS. 52-F-5  
Scale 1" = 400'

GEOLOGY FOR DRILL HOLE - CLS-1

DRILL LOG

DDH: CLS-1

PROPERTY - CALAVERAS-SULLIVAN

COMPANY - NUINSCO RESOURCES LT

PROJECT - CALAVERAS PROJECT

LATITUDE - N 10000.00  
DEPARTURE - E 10000.00  
ELEVATION - 225.00

COLLAR AZIMUTH - 315  
COLLAR DIP - -45  
HOLE LENGTH - 300.00 FT

DATE STARTED - 28/10/85  
DATE COMPLETED - 28/10/85  
LOGGED BY - PLJ

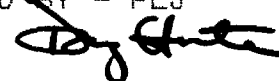

\*\* NOTE - ALL DISTANCES MEASURED IN FT

FROM - TO	ROCK TYPE	GRAIN SIZE	COLOUR	TEXTURE	% MODIFIER	MINERAL	MODIFIER	TYPE OF ALTERATION OR STRUCTURE	CORE ANGLE
0.00 - 5.50	CASING								
COMMENT ON	0.00 TO	5.50	DDH CLS-1 LOCATED AT 28+00N, 5+00W, NO ACID ETCH TEST RESULTS ARE AVAILABLE						
COMMENT ON	0.00 TO	5.50	*TEMPORARY LATITUDES, DEPARTURES, ELEVATION AND DATES.						
5.50 MAFIC - 10.50 FLOW		FINE	MED. DARK GREY GREEN	MASSIVE					
	20 % INTERMEDIATE		ASH TUFF						
10.50 MAFIC - 15.50 FLOW		FINE	MED. DARK GREY GREEN	MASSIVE					
15.50 MAFIC - 35.30 FLOW		FINE	MED. DARK GREY GREEN	MASSIVE	.03 VEINS	TOURMALINE			
COMMENT ON	15.50 TO	35.30	LOCAL SILICEOUS "CHERTY" TUFFACEOUS INTERBEDS FROM 5.50'-35.3'.						
35.30 INTERMEDIATE - 40.00 CRYSTAL TUFF		FINE	MEDIUM GREY	BEDDED (DEFINITELY)					
40.00 INTERMEDIATE - 117.00 TUFF		FINE	MEDIUM GREY	BEDDED (DEFINITELY)					
COMMENT ON	115.00 TO	117.00	DOMINANTLY CRYSTAL TUFF INTERBEDDED WITH THIN UNITS OF "CHERTY" TUFFS.						
117.00 MAFIC - 153.00 FLOW		FINE	MED. DARK GREY GREEN	MASSIVE					
153.00 INTERMEDIATE - 180.20 TUFF		FINE	MEDIUM GREY	BEDDED (DEFINITELY)					
COMMENT ON	176.00 TO	180.20	FROM 153.0'-180.2' VARI-TEXTURED BEDDED INTERMEDIATE TUFFS (CRYSTAL TUFF, ASH						

FROM - TO	ROCK TYPE	GRAIN SIZE	COLOUR	TEXTURE	% MODIFIER	MINERAL	MODIFIER	TYPE OF ALTERATION OR STRUCTURE	CORE ANGLE
COMMENT ON 176.00 TO 180.20 TUFF, CRYSTAL-LITHIC TUFF, LOCAL "CHERTY" TUFFS).									
180.20	FELSIC	MEDIUM	MEDIUM	PORPHYRITIC					
- 187.00	QUARTZ-FELDSPAR PORPHYRY		PINK WHITE						
187.00		FINE	MED. PALE	ORIG. TEXTURE			PERVASIVE	CARBONATE+SERIC	
- 190.00	PROTOLITH ?		TAN PINK	INDETERMINABLE					
190.00		FINE	MEDIUM	ORIG. TEXTURE			PERVASIVE	CARBONATE+SERIC	
- 195.00	PROTOLITH ?		TAN PINK	INDETERMINABLE					
195.00		FINE	MED. PALE	ORIG. TEXTURE			PERVASIVE	CARBONATE+SERIC	
- 200.00	PROTOLITH ?		TAN PINK	INDETERMINABLE					
200.00		FINE	MEDIUM	ORIG. TEXTURE			PERVASIVE	CARBONATE+SERIC	
- 205.00	PROTOLITH ?		TAN PINK	INDETERMINABLE					
205.00		FINE	MED. PALE	ORIG. TEXTURE			PERVASIVE	CARBONATE+SERIC	
- 209.50	PROTOLITH ?		TAN PINK	PART. PRESERVED					
	40 % FELSIC		QUARTZ-FELDSPAR	PORPHYRY					
209.50	FELSIC	FINE	MED. PALE	ORIG. TEXTURE			PERVASIVE	CARBONATE+SERIC	
- 214.50	QUARTZ-FELDSPAR PORPHYRY 40 % PROTOLITH ?		TAN PINK	PART. PRESERVED					
214.50	INTERMEDIATE	FINE	MEDIUM	BEDDED					
- 222.00	TUFF		GREY	(DEFINITELY)					
222.00	INTERMEDIATE	FINE	MEDIUM	BEDDED	1.0 BLEBS	PYRITE			
- 222.60	TUFF		GREY	(DEFINITELY)					

FROM - TO	ROCK TYPE	GRAIN SIZE	COLOUR	TEXTURE	% MODIFIER	MINERAL	MODIFIER	TYPE OF ALTERATION OR STRUCTURE	CORE ANGLE
222.60 - 249.90	TUFF	FINE	VERY DARK BLACK GREY	BEDDED (DEFINITELY)	0.3 EUHEDRAL	PYRITE			
COMMENT ON 249.60 TO 249.90 BEDDED GRAPHITIC TUFFS FROM 222.6'-249.9'.									
249.90 - 273.00	INTERMEDIATE TUFF	FINE	MEDIUM GREY	BEDDED (DEFINITELY)					
COMMENT ON 269.00 TO 273.00 INTERMEDIATE TUFFS, ASH, CRYSTAL AND LITHIC.									
273.00 - 300.00	INTERMEDIATE TUFF	FINE	MEDIUM GREY	BEDDED (DEFINITELY)					
COMMENT ON 273.00 TO 300.00 300 FEET END OF HOLE.									

CALAVERAS-SULLIVAN

DRILL HOLE #      NORTHING      EASTING      ELEVATION      AZIMUTH      DIP  
 CLS-1            10000.00      10000.00      225.00      315          -45

SAMPLE NO.	FROM	TO	WIDTH	ASSAY	INTERVAL	CUMUL. X ASSAY	CUMUL. INT. X AS.	PLOT OF AU ASSAYS (OZ/TON)						
								.095	.145	.195	.245	.295		
0	0.0	5.5	5.5	0.000	0.000	0.000		NO ASSAY REPORTED						
65431	5.5	10.5	5.0	.020	.100	.100	*							
29	10.5	15.5	5.0	.001	.005	.105	*							
0	15.5	35.3	19.8	0.000	0.000	.105		NO ASSAY REPORTED						
65432	35.3	40.0	4.7	.001	.005	.110	*							
0	40.0	70.0	30.0	0.000	0.000	.110		NO ASSAY REPORTED						
1	70.0	75.0	5.0	.001	.005	.115	*							
2	75.0	80.0	5.0	.001	.005	.120	*							
3	80.0	85.0	5.0	.001	.005	.125	*							
4	85.0	90.0	5.0	.001	.005	.130	*							
5	90.0	95.0	5.0	.001	.005	.135	*							
6	95.0	100.0	5.0	.001	.005	.140	*							
7	100.0	105.0	5.0	.001	.005	.145	*							
8	105.0	110.0	5.0	.001	.005	.150	*							
9	110.0	115.0	5.0	.001	.005	.155	*							
0	115.0	117.0	2.0	0.000	0.000	.155		NO ASSAY REPORTED						
0	117.0	153.0	36.0	0.000	0.000	.155		NO ASSAY REPORTED						
10	153.0	158.0	5.0	.001	.005	.160	*							
11	158.0	163.0	5.0	.001	.005	.165	*							
12	163.0	168.0	5.0	.001	.005	.170	*							
13	168.0	172.0	4.0	.001	.004	.174	*							
14	172.0	176.0	4.0	.001	.004	.178	*							
65430	176.0	180.2	4.2	.001	.004	.182	*							
65429	180.2	183.2	3.0	.001	.003	.185	*							
65428	183.2	187.0	3.8	.001	.004	.189	*							
65427	187.0	190.0	3.0	.001	.003	.192	*							
65426	190.0	195.0	5.0	.010	.050	.242	*							
65425	195.0	200.0	5.0	.030	.150	.392	*							
65424	200.0	205.0	5.0	.020	.100	.492	*							
65423	205.0	209.5	4.5	.001	.005	.496	*							
65422	209.5	214.5	5.0	.001	.005	.501	*							
65421	214.5	218.5	4.0	.001	.004	.505	*							
65420	218.5	218.7	.2	.001	.000	.505	*							

SAMPLE NO.	FROM	TO	WIDTH	ASSAY	INTERVAL	CUMUL. X ASSAY	INT. X AS.	PLOT OF AU ASSAYS (OZ/TON)						
								.095	.145	.195	.245	.295		
65419	218.7	222.0	3.3	.010	.033	.538	*							
65418	222.0	222.6	.6	.010	.006	.544	*							
65417	222.6	224.6	2.0	.001	.002	.546	*							
65416	224.6	229.6	5.0	.001	.005	.551	*							
65415	229.6	234.6	5.0	.001	.005	.556	*							
65414	234.6	239.6	5.0	.010	.050	.606	*							
65413	239.6	244.6	5.0	.001	.005	.611	*							
65412	244.6	249.6	5.0	.001	.005	.616	*							
65411	249.6	249.9	.3	.001	.000	.617	*							
65410	249.9	253.1	3.2	.001	.003	.620	*							
65409	253.1	253.4	.3	.001	.000	.620	*							
65408	253.4	254.7	1.3	.001	.001	.621	*							
65407	254.7	259.0	4.3	.001	.004	.626	*							
65406	259.0	264.0	5.0	.001	.005	.631	*							
65405	264.0	269.0	5.0	.001	.005	.636	*							
65404	269.0	273.0	4.0	.001	.004	.640	*							
65403	273.0	300.0	27.0	.001	.027	.667	*							



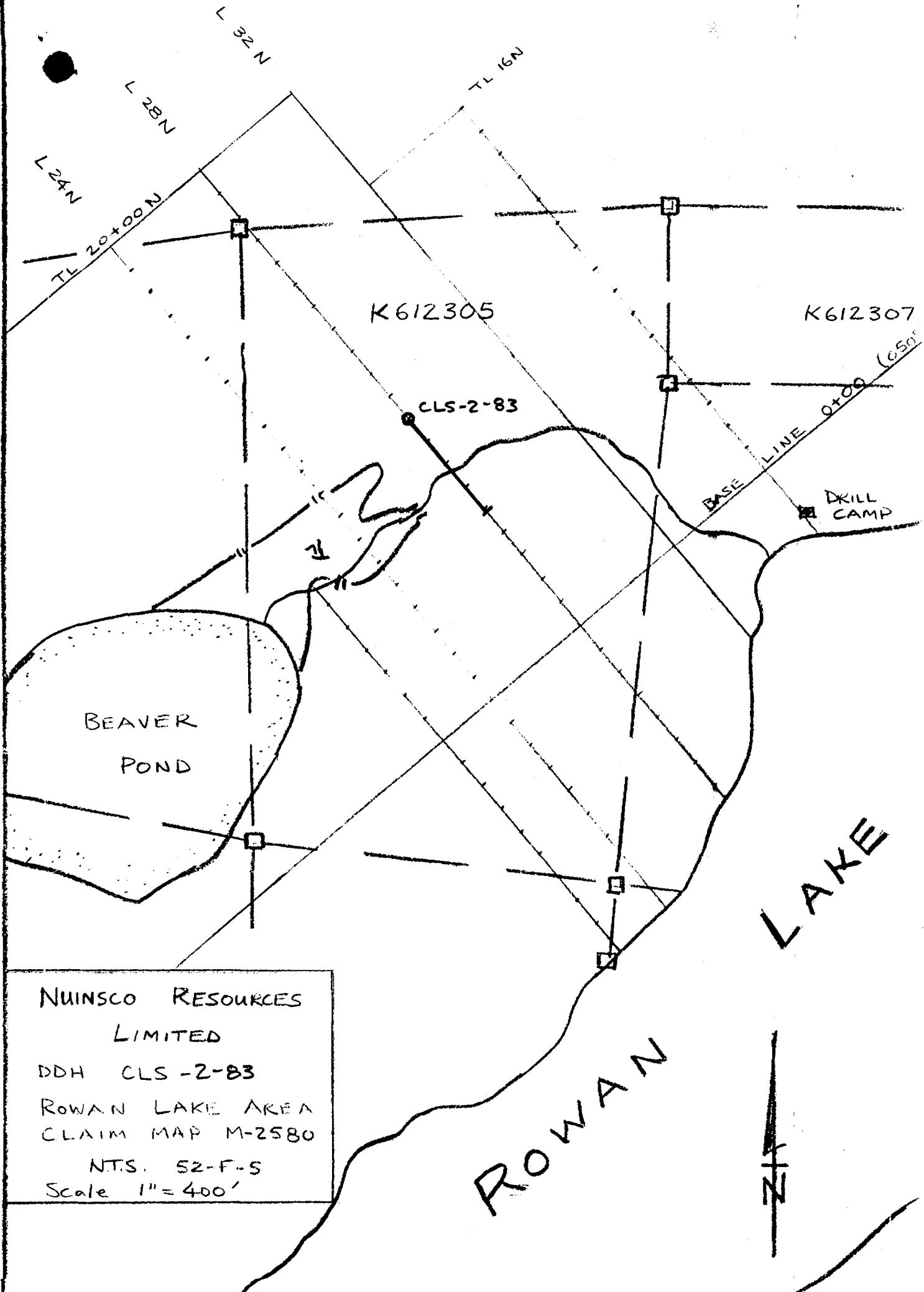

K612305

K612307

CLS-2-83

BASE LINE 0100 (650°)  
DRILL CAMP

BEAVER  
POND

ROWAN  
LAKE

NUINSCO RESOURCES  
LIMITED  
DDH CLS-2-83  
ROWAN LAKE AREA  
CLAIM MAP M-2580  
NTS. 52-F-5  
Scale 1" = 400'



GEOLOGY FOR DRILL HOLE - CLS-2

DRILL LOG

DDH: CLS-2

PROPERTY - CALAVERAS-SULLIVAN

COMPANY - NUINSCO RESOURCES LT

PROJECT - CALAVERAS PROJECT

LATITUDE - N 10000.00  
DEPARTURE - E 10000.00  
ELEVATION - 225.00

COLLAR AZIMUTH - 135  
COLLAR DIP - -45  
HOLE LENGTH - 548.00 FT

DATE STARTED - 31/10/85  
DATE COMPLETED - 31/10/85  
LOGGED BY - FLJ

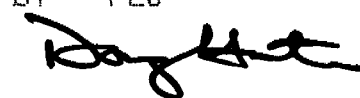

\*\* NOTE - ALL DISTANCES MEASURED IN FT

FROM - TO	ROCK TYPE	GRAIN SIZE	COLOUR	TEXTURE	% MODIFIER	MINERAL	MODIFIER	TYPE OF ALTERATION OR STRUCTURE	CORE ANGLE
0.00 - 15.00	CASING								
COMMENT ON	0.00 TO	15.00	CLS-2, LOCATED AT 28+00N, 9+00W, NO ACID ETCH TESTS AVAILABLE.						
COMMENT ON	0.00 TO	15.00	*TEMPORARY LATITUDE, DEPARTURE, ELEVATION AND DATES.						
15.00 - 265.00	INTERMEDIATE CRYSTAL TUFF	FINE	MEDIUM GREY	MASSIVE					
STRUCTURE AT -	180.00							WEAKLY FOLIATED	62
STRUCTURE AT -	230.00							WEAKLY FOLIATED	61
STRUCTURE AT -	262.00							WEAKLY FOLIATED	61
265.00 - 270.00	INTERMEDIATE TUFF	FINE	MEDIUM GREY	MASSIVE					
270.00 - 274.00	TUFF	FINE	PALE BLACK GREY	BEDDED (DEFINITELY)					
	20 % INTERMEDIATE		CRYSTAL TUFF						
COMMENT ON	270.00 TO	274.00	DOMINANTLY BLACK-GREY GRAPHITIC TUFF.						
274.00 - 277.00	TUFF	FINE	PALE BLACK GREY	BEDDED (DEFINITELY)	2.5	EUHEDRAL		PYRITE	
277.00 - 288.00	TUFF	FINE	MEDIUM BLACK GREY	BEDDED (DEFINITELY)	2.5	EUHEDRAL		PYRITE	
COMMENT ON	277.00 TO	288.00	BEDDED GRAPHITIC TUFF.						
288.00 - 293.20	TUFF	FINE	MEDIUM BLACK	BEDDED (DEFINITELY)	2.5	EUHEDRAL		PYRITE	

FROM - TO	ROCK TYPE	GRAIN SIZE	COLOUR	TEXTURE	% MODIFIER	MINERAL	MODIFIER	TYPE OF ALTERATION OR STRUCTURE	CORE ANGLE
			GREY						
293.20 - 317.60	INTERMEDIATE TUFF	FINE	MEDIUM GREY	BEDDED (DEFINITELY)					
COMMENT ON	313.00 TO	317.60	FROM 293.2'-317.6' BEDDED INTERMEDIATE TUFF, ASH, LITHIC.						
317.60 - 388.00	MAFIC FLOW	FINE	MED. DARK GREY GREEN	AMYGDULOIDAL					
388.00 - 393.00	INTERMEDIATE TUFF	FINE	MEDIUM GREY	BEDDED (DEFINITELY)					
393.00 - 413.00	MAFIC FLOW	FINE	MED. DARK GREY GREEN	MASSIVE					
413.00 - 418.00	INTERMEDIATE TUFF	FINE	MEDIUM GREY	MASSIVE					
COMMENT ON	413.00 TO	418.00	DOMINANTLY LITHIC TUFF.						
418.00 - 473.00	INTERMEDIATE TUFF	FINE	MEDIUM GREY	MASSIVE					
473.00 - 478.00	INTERMEDIATE ASH TUFF	FINE	MEDIUM GREY	BEDDED (DEFINITELY)					
478.00 - 483.00	INTERMEDIATE TUFF	FINE	MEDIUM GREY	MASSIVE					
483.00 - 488.00	INTERMEDIATE ASH TUFF	FINE	MEDIUM GREY	BEDDED (DEFINITELY)					
488.00 - 512.00	INTERMEDIATE ASH TUFF	FINE	MEDIUM GREY GREEN	BEDDED (DEFINITELY)					

FROM - TO	ROCK TYPE	GRAIN SIZE	COLOUR	TEXTURE	% MODIFIER	MINERAL	MODIFIER	TYPE OF ALTERATION OR STRUCTURE	CORE ANGLE
	40 % INTERMEDIATE			LAPILLI TUFF					
COMMENT ON	488.00 TO	512.00		LOCALLY "CHERTY".					
512.00 MAFIC - 548.00 FLOW		FINE	MED. DARK GREY GREEN	AMYGDULOIDAL					
COMMENT ON	512.00 TO	548.00		POSSIBLY LOCALLY PILLOWED, FABRIC BECOMING STRONGER AT END.					
COMMENT ON	512.00 TO	548.00		548 FEET END OF HOLE.					



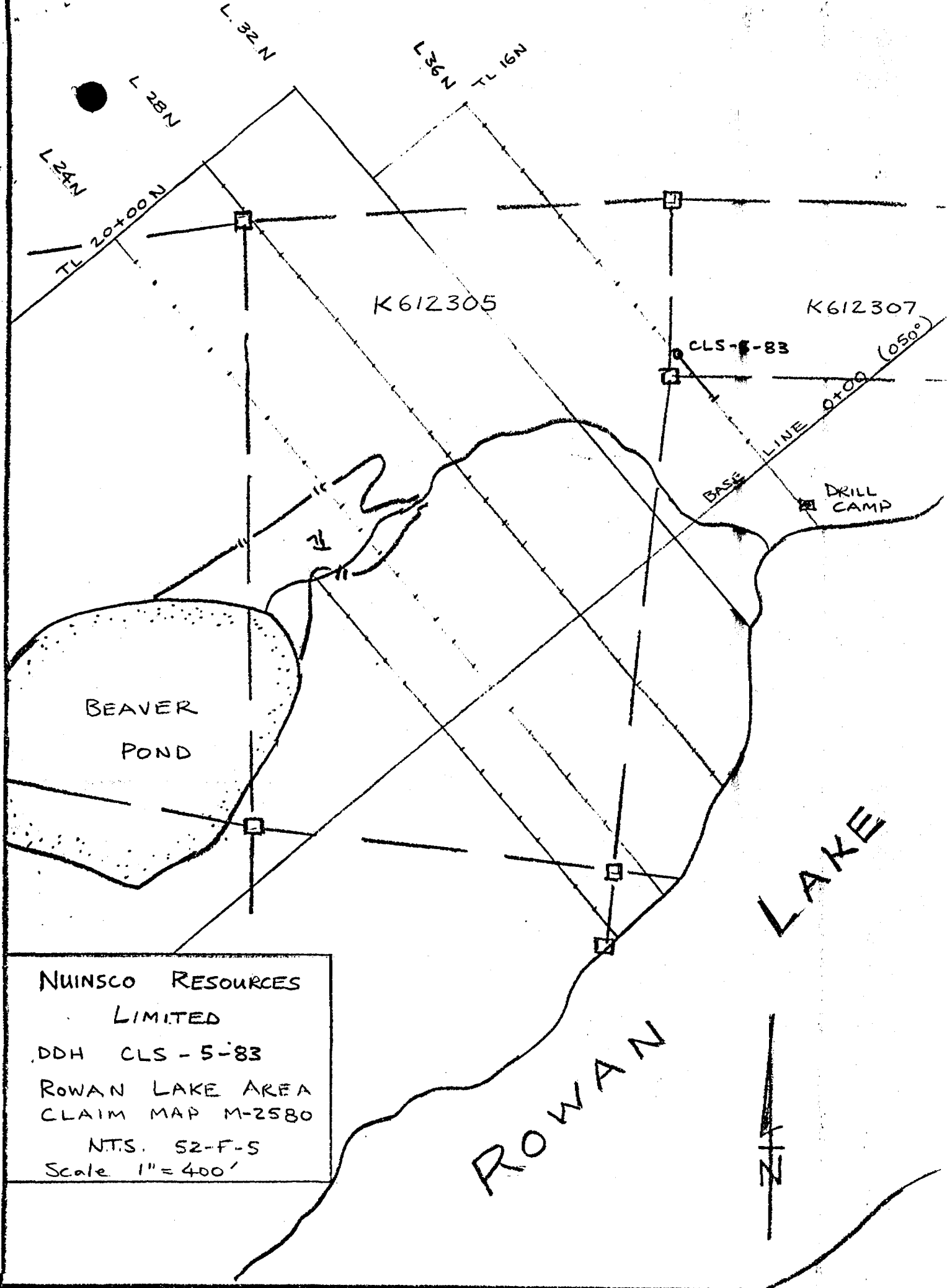

NUINSCO RESOURCES  
 LIMITED  
 DDH CLS-5-83  
 ROWAN LAKE AREA  
 CLAIM MAP M-2580  
 N.T.S. 52-F-5  
 Scale 1" = 400'

GEOLOGY FOR DRILL HOLE - CLS-5

DRILL LOG

DDH: CLS-5

PROPERTY - CALAVERAS-SULLIVAN

COMPANY - NUINSCO RESOURCES LT

PROJECT - CALAVERAS PROJECT

LATITUDE - N 10000.00  
DEPARTURE - E 10000.00  
ELEVATION - 225.00

COLLAR AZIMUTH - 315  
COLLAR DIP - -45  
HOLE LENGTH - 200.00 FT

DATE STARTED - 29/10/85  
DATE COMPLETED - 29/10/85  
LOGGED BY - FLJ



\*\* NOTE - ALL DISTANCES MEASURED IN FT



FROM - TO	ROCK TYPE	GRAIN SIZE	COLOUR	TEXTURE	% MODIFIER	MINERAL	MODIFIER	TYPE OF ALTERATION OR STRUCTURE	CORE ANGLE
0.00 - 14.00	CASING								
COMMENT ON	0.00 TO	14.00		CLS-5 LOCATED AT 36+00N, 5+00W, NO ACID ETCH TESTS AVAILABLE.					
COMMENT ON	0.00 TO	14.00		*TEMPORARY LATITUDE, DEPARTURE, ELEVATION AND DATES.					
14.00 - 200.00	INTERMEDIATE ASH TUFF	FINE	MEDIUM GREY GREEN						
	40 % MAFIC		FLOW						
COMMENT ON	14.00 TO	200.00		INTERBEDDED INTERMEDIATE ASH TUFF-MAFIC AMYGDALOIDAL FLOW VERY LITTLE CARBONAT-					
COMMENT ON	14.00 TO	200.00		IZATION EVIDENT IN PLACES TUFF UNITS ARE VERY SILICEOUS ("CHERTY"). BEDDING					
COMMENT ON	14.00 TO	200.00		VARIABLE FROM 45 DEGREES TO 60 DEGREES TO CORE AXIS.					
COMMENT ON	14.00 TO	200.00		200 FEET END OF HOLE.					

CALAVERAS-SULLIVAN

DRILL HOLE #	NORTHING	EASTING	ELEVATION	AZIMUTH	DIP
CLS-5	10000.00	10000.00	225.00	315	-45

SAMPLE NO.	FROM	TO	WIDTH	ASSAY	INTERVAL	CUMUL. X ASSAY	CUMUL. INT. X AS.	PLOT OF AU ASSAYS (OZ/TON)			
								.095	.145	.195	.245
0	0.0	14.0	14.0	0.000	0.000	0.000		NO ASSAY REPORTED			
0	14.0	200.0	186.0	0.000	0.000	0.000		NO ASSAY REPORTED			

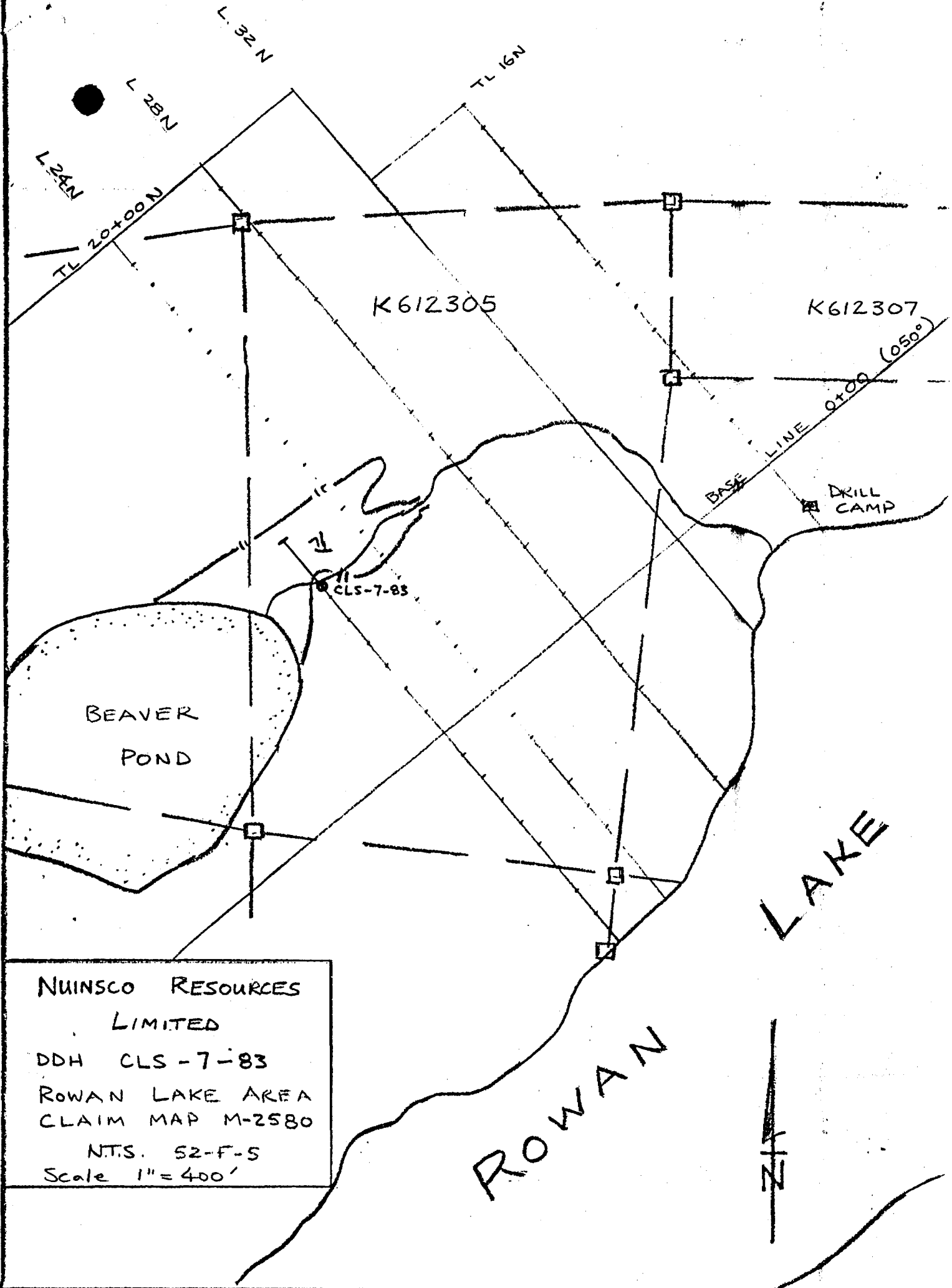

NUINSCO RESOURCES  
LIMITED

DDH CLS-7-83  
ROWAN LAKE AREA  
CLAIM MAP M-2580

NTS. 52-F-5  
Scale 1" = 400'

GEOLOGY FOR DRILL HOLE - CLS-7

DRILL LOG

DDH: CLS-7

PROPERTY - CALAVERAS-SULLIVAN

COMPANY - NUINSCO RESOURCES LT

PROJECT - CALAVERAS PROJECT

LATITUDE - N 10000.00  
DEPARTURE - E 10000.00  
ELEVATION - 225.00

COLLAR AZIMUTH - 315  
COLLAR DIP - -60  
HOLE LENGTH - 198.00 FT

DATE STARTED - 30/10/85  
DATE COMPLETED - 30/10/85  
LOGGED BY - PLJ



\*\* NOTE - ALL DISTANCES MEASURED IN FT







Mining /



52F05SE0053 38 ROWAN LAKE

900

Name and Postal Address of Recorded Holder

**NUINSCO RESOURCES LIMITED**  
Suite 306 - 4198 Dundas St. W., Toronto Ont. M8X 1Y6

Summary of Work Performance and Distribution of Credits

Total Work Days Cr. claimed <b>1481 1360</b>	Mining Claim			Mining Claim			Mining Claim		
	Prefix	Number	Work Days Cr.	Prefix	Number	Work Days Cr.	Prefix	Number	Work Days Cr.
for Performance of the following work. (Check one only) <input type="checkbox"/> Manual Work <input type="checkbox"/> Shaft Sinking Drifting or other Lateral Work. <input type="checkbox"/> Compressed Air, other Power driven or mechanical equip. <input type="checkbox"/> Power Stripping <input checked="" type="checkbox"/> Diamond or other Core drilling <input type="checkbox"/> Land Survey	K	612305	<del>42-56</del> 88	K	666289	<del>42-56</del> 85			
		612307			666290				
		612308			666291				
		612309			666292				
		612314			666293				
		666284			690760				
		666285			690761				
		666286		↓	690775		↓		

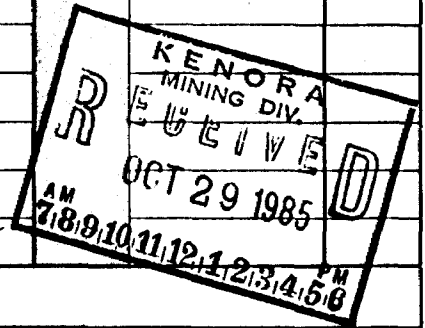

All the work was performed on Mining Claim(s): **K612305, K612307**

Required Information eg: type of equipment, Names, Addresses, etc. (See Table Below)

Equipment - J.K. SMIT '300' DIAMOND DRILL (BQ CORE)

Contractor - D.W. COATES ENTERPRISES LTD.

2560-A. SIMPSON ROAD

RICHMOND, B.C., V6C 2P9

Drill Holes submitted for assessment

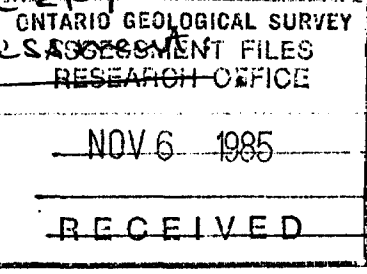

DDH	CLS - 1 - 83	300'
DDH	CLS - 2 - 83	548'
DDA	CLS - 5 - 83	200
DDH	CLS - 7 - 83	198
* DDA	CLS - 4 - 83	235'
DDH	CLS - 6 - 83 (77' remaining from Report #4-84)	
Total work		1481
		1360

\* 235' remaining to be applied for assessment (see Oct. 29/84 work #130-83 report by CJ Nelson)

Date of Report	Recorded Holder or Agent (Signature)
Oct. 29/85	Doug [Signature]

Certification Verifying Report of Work

I hereby certify that I have a personal and intimate knowledge of the facts set forth in the Report of Work annexed hereto, having performed the work or witnessed same during and/or after its completion and the annexed report is true.

Name and Postal Address of Person Certifying

**A. D. HUNTER, EARTHUNT RESOURCES INC., P.O. Box 324**

MILLBROOK, ONT. L0A 1G0

Date Certified	Certified by (Signature)
Oct. 29/85	Doug [Signature]

Table of Information/Attachments Required by the Mining Recorder

Type of Work	Specific Information per type	Other Information (Common to 2 or more types)	Attachments
Manual Work	Nil	Names and addresses of men who performed manual work/operated equipment, together with dates and hours of employment.	Work Sketch: these are required to show the location and extent of work in relation to the nearest claim post.
Shaft Sinking, Drifting or other Lateral Work			
Compressed air, other power driven or mechanical equip.	Type of equipment	612303	
Power Stripping	Type of equipment and amount expended. Note: Proof of actual cost must be submitted within 30 days of recording.		
Diamond or other core drilling	Signed core log showing: footage, diameter of core, number and angles of holes.	Names and addresses of owner or operator together with dates when drilling/stripping done.	Work Sketch (as above) in duplicate
Land Survey	Name and address of Ontario land surveyer.	Nil	Nil

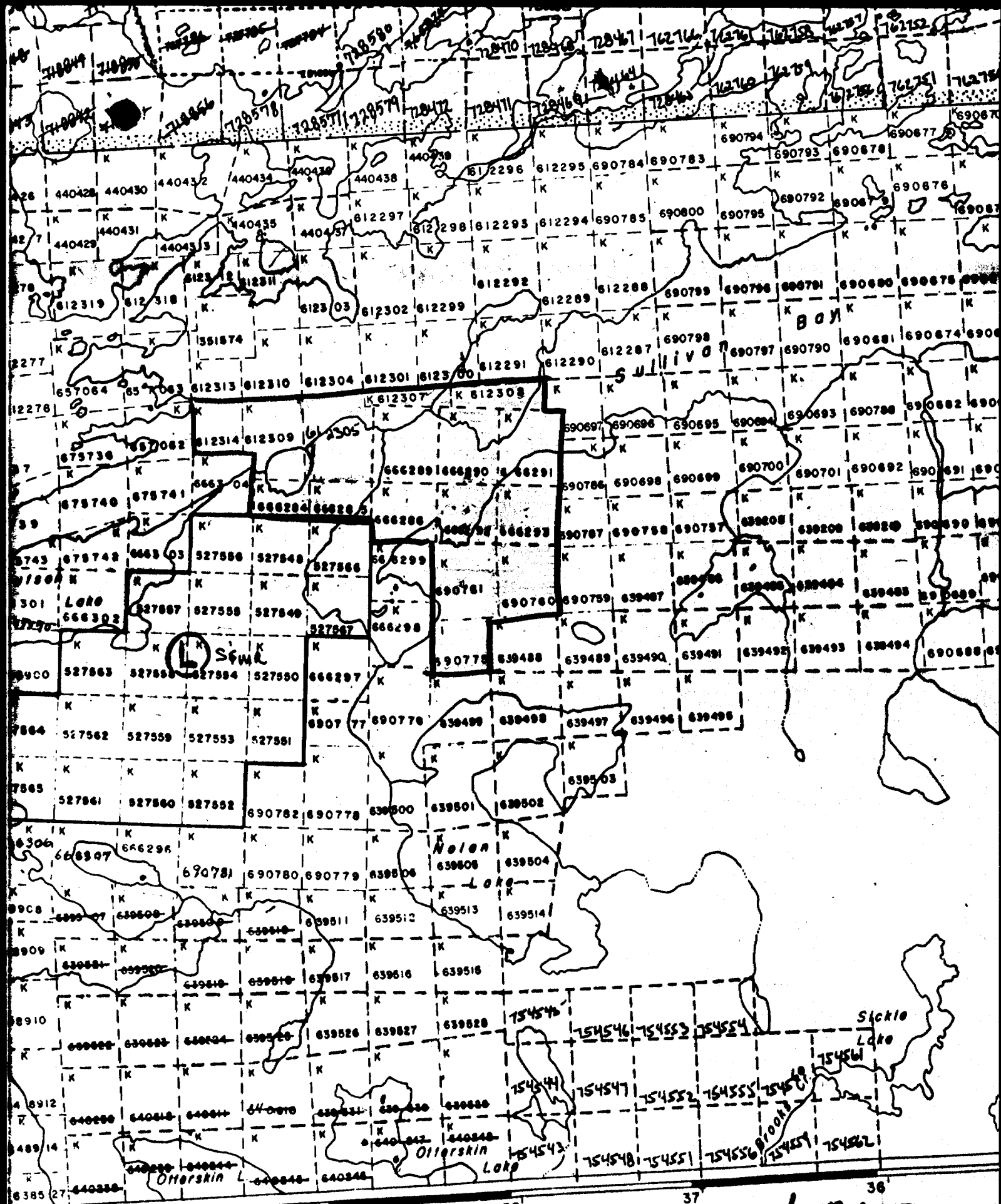

**ROWAN LAKE**  
**BROOKS LAKE M.2473**  
**M-2580**