

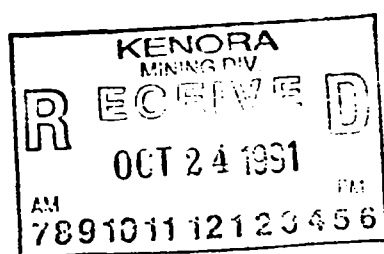

010

DUNFRAZIER GOLD EXPLORATION INC.
BAG LAKE PROPERTY, KENORA MINING DISTRICT
NORTHWESTERN ONTARIO
N.T.S. 52F/5

**Results of the 1989 Geological Mapping Program
and Its Relevance to Exploration Potential on the Bag Lake Property.**



D.R. Melling B.Sc. M.Sc.
Victoria, British Columbia.

November 1, 1989



52F05SE0333 2.14413 TWEEDSMUIR

010C

Table of Contents

	Page #
1.0 Summary	1
2.0 Introduction	2
3.0 Location and Access	2
4.0 History	3
5.0 Mapping Program	3
5.1 Lithologies and Structure	3
5.3 Alteration and Mineralization	5
6.0 Conclusions	5
7.0 References	6
Appendix I Cost Accounting 1989 Mapping Program	
Appendix II Assay Certificates	
Appendix III Certificate of Qualifications	

1.0 Summary

The Bag Lake property is located in the Kenora Mining District of northwestern Ontario 20 km east of Nuinsco Resources Cameron Lake gold mine. Two significant gold occurrences have been previously identified on the property (Melling, 1989). Trenching on the East zone has exposed mineralization 2 ft thick over a strike of 170 ft which grades 0.984 oz/ton gold. Trenching on the West zone has exposed a 30 ft section of altered rocks which grade up to 0.649 oz/ton gold over 3.0 ft where mineralized. Both zones are open along strike and at depth.

This report presents the results of 1:1200 scale grid mapping on the property, encompassing the areas of previous trenching. Several new zones of gold mineralization and/or alteration have been identified which also require further exploration. The two most significant, known here as the North and South zones, returned assays up to 0.067 and 0.076 oz/ton gold respectively. A major exploration program involving additional trenching and diamond drilling is warranted. The nature and scope of this program remains to be established.

The economics of discovering a commercially viable gold deposit on Dunfrazier's property is significantly enhanced by the proximity of Nuinsco's mining operation for which a 1000 ton/per day milling facility is planned.

2.0 Introduction

Building on the results obtained by trenching in 1988 and 1989, a 1:1200 scale mapping program was initiated on the Bag Lake property of Dunfrazier Gold Exploration Inc. (Dunfrazier). Fieldwork was completed between September 25 and October 23, 1989.

An exploration grid approximately 4,900 ft by 3,000 ft was cut covering the previously trenched areas. The objectives of this work were to:

- 1) Gain insight into the possible lithological and structural controls to gold mineralization on the property by mapping the area encompassing the existing trenches;
- 2) Search for extensions of the previously discovered zones of gold mineralization;
- 3) Through systematic prospecting, attempt to discover additional zones of gold mineralization on the property.

3.0 Location and Access

The Bag Lake property comprises 66 mining claims held in good standing by Dunfrazier. It is located about 64 km by air southeast of Kenora. Access to the property is afforded by the Cameron Lake Road, a 24 km all weather gravel road running east from Provincial Highway 71, about 13 km south of Sioux Narrows (Figure 1).

The property extends from kilometre 1 to 7 and straddles the Cameron Lake Road which was constructed in 1985 by Nuinsco Resources Limited to access their Cameron Lake deposit located 18 km to the east. Currently in an advanced stage of exploration, undiluted geological reserves in the Cameron Lake deposit total 3,160,148 tons grading 0.168 oz/ton gold. Other gold occurrences in close proximity occur to the north, south, east and west of the Bag Lake property (Figure 1).

4.0 History

The Bag Lake property was originally staked in 1978 by Mr. Andy Knapp who obtained encouraging results while prospecting in the area. The property was subsequently optioned to Gulf Minerals Canada Limited who completed several hand trenches and drilled 9 holes totalling 3493 ft. Gulf decided to conduct no further work on the property which was returned along with all results to Mr. Knapp.

In 1984 Dunfrazier, under the direction of Mr. W. Cummings, optioned the property. Since then the entire property has been mapped at a scale of 1:4800 and lithogeochemical, magnetometer and induced polarization surveys have been completed over portions of the property. In 1985, 3920 ft in 10 holes were drilled by Dunfrazier and in 1986 an additional 2083 ft in 8 holes were completed. Twenty five claims were added to the group in late 1986. Two trenches were excavated in the vicinity of old Gulf holes numbers 3, 4 and 6 in 1988. In mid 1989 two additional trenches were excavated on what are now termed the East and West zones.

5.0 Mapping Program

To facilitate mapping and future drilling an exploration grid was cut on the property. Grid dimensions are approximately 4,900 ft by 3,000 ft. The base line is 4,900 ft in length. It intersects the Dunfrazier claim boundary at 27 W, has an azimuth of 135° and extends to 22 E. Grid lines were cut perpendicular to the baseline (045° Az), 1500 ft north and 1500 ft south. Towards the western extremity of the grid, south lines were terminated at the north shore of Bag Lake and the claim boundary. About 20.5 miles of grid was cut. In the central portion of the grid, between 16 W and 12 E, lines were cut at 100 ft spacings and chained at 50 ft intervals. Towards the eastern and western peripheries of the grid, lines were cut at 200 ft spacings and chained at 100 ft intervals.

5.1 Lithologies and Structure

Three major rock types occur on the property and consist of basalt, gabbro and feldspar porphyry. All rocks have been metamorphosed to greenschist facies mineral assemblages. Outcrop exposure averages about 35 percent within the grid boundaries.

Basalt flows are the most abundant rock type exposed within the map area and include pillowed and massive varieties with minor associated flow breccias. The rocks are a medium green colour, aphanitic and locally amygdaloidal. In the pillowed flows selvages are well formed and tops are consistently towards the east. This is further supported by the asymmetric distribution of amygdules within individual pillows. One occurrence of pillow shelves illustrates that bedding in the volcanic rocks strikes approximately north-south and dips about 75° E.

Gabbro comprises the second most abundant rock type within the map area. The rocks are fine to medium grained, dark green in colour and locally display a distinctive spotted texture. Locally, blue quartz megacrysts are present. The gabbro comprises in one main body about 1000 ft thick in the central portion of the map area. It intrudes the basalts and strikes roughly north-south suggesting it may be a large semi-concordant sill. The gabbro probably dips towards the east but specific measurements were not afforded.

Feldspar porphyry is the third most abundant rock type exposed within the map area. The rocks are fine to medium grained and may be pink to medium grey in colour. Locally, glassy quartz eyes are present. The feldspar porphyry occurs as dykes ranging from several inches to over 200 ft thick which intrude both the basalts and gabbro. Strikes vary between 045 and 120. Locally, branching amoeboid bodies of porphyry are present.

The rocks display a weak regional foliation which averages about 160/80° S. Locally, the rocks are sheared over narrow widths adjacent to contacts between the porphyry dykes and the mafic units. The existence of the Bag Lake Fault (Melling, 1989) has not been confirmed by this mapping program; however, it may be that it remains concealed beneath the waters of Bag Lake and the swampy area which extends towards the north. A major structure is postulated to exist along the baseline between the East and West trenches. This is supported by stronger foliation development in this area and the apparent dextral offset of the gabbroic intrusion.

5.2 Alteration and Mineralization

Extensions to the East and West zones were not discovered during mapping due largely to lack of outcrop in various key areas. Descriptions of these mineralized zones are presented by Melling (1989) and will not be repeated here.

Two new showings were discovered during mapping and are referred to here as the North and South zones. Both zones display evidence of previous work in the form of hand trenching; however, no records exist which document the date or extent of the work completed.

The North zone occurs about 300 ft north of the East trench between lines 0+00 and 1+50 W. It consists of up to 5 ft of sheared, carbonatized gabbro adjacent to its contact with a porphyry dyke. Small quartz veinlets are present and fine grained disseminated pyrite occurs in amounts up to 2 percent. Assays up to 0.061 oz/ton Au (2086 ppb) were obtained from the zone. The North zone has an orientation of about 160/80° SW and has been traced over 150 ft along strike. It is slightly oblique to the East zone.

The South zone occurs about 800 ft south of the baseline between lines 4 W and 5 E. It consists of up to 6 ft of sheared, carbonatized gabbro which has been traced over 900 ft along strike. Several quartz-carbonate veins occur locally within the zone, and fine disseminated pyrite in amounts up to 1 percent is also present. Assays up to 0.076 oz/ton Au (2616 ppb) were obtained from the zone. The south zone has an orientation of about 145/75° SW.

6.0 Conclusions

Based on the results of mapping, additional trenching on Dunfrazier's Bag Lake property is warranted. Both the newly discovered North and South zones have demonstrated gold potential and are easily accessible. This work should be completed in early 1990 after breakup prior to the initiation of the summer drilling program previously recommended (Melling, 1989).

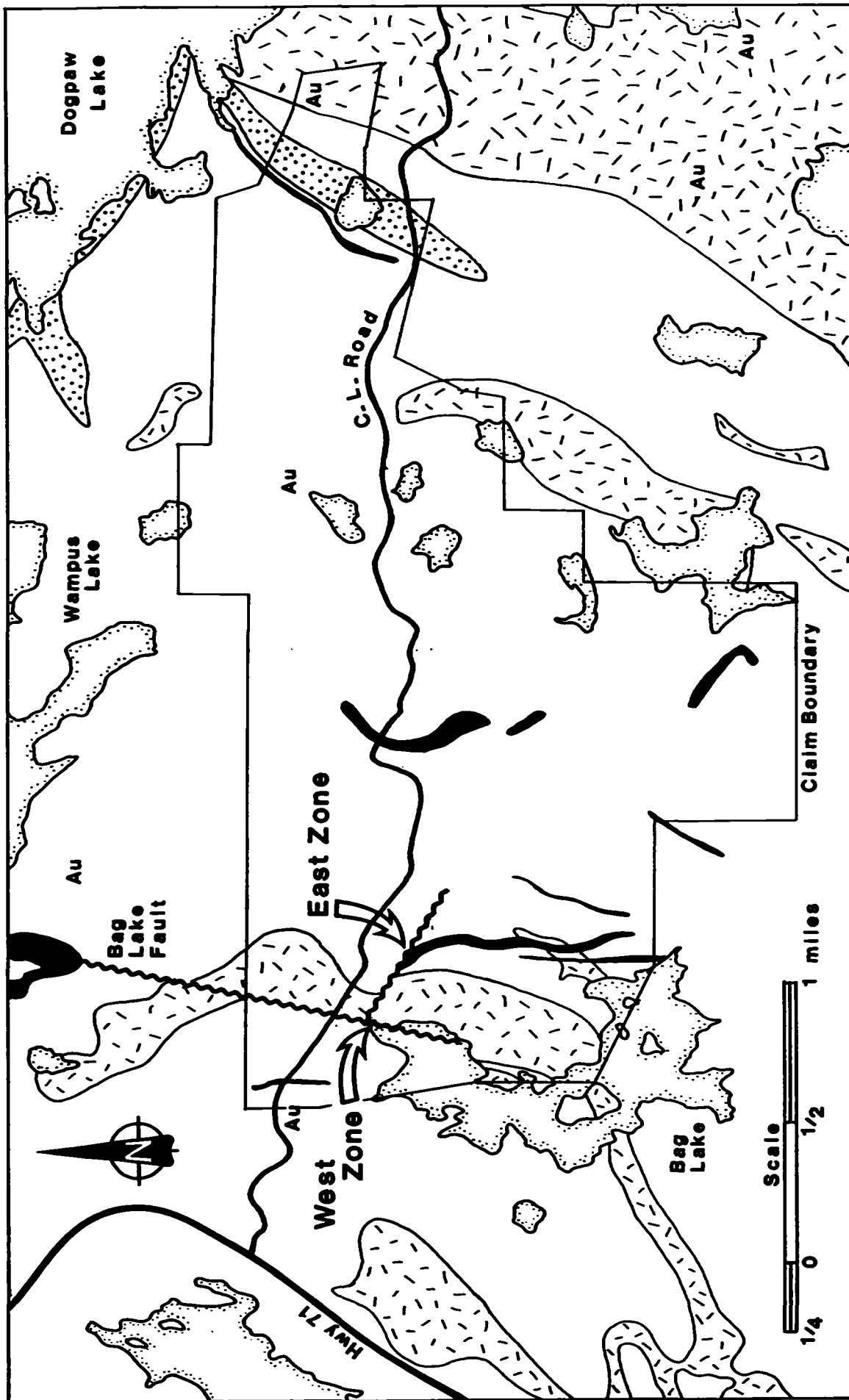

Figure 1. Mafic Volcanics Felsic Volcanics Mafic Intrusion Felsic Intrusion Fault

7.0 References

- Davies, J.C. and Morin, J.A. 1972. Cedartree Lake area, District of Kenora. Ontario Department of Mines and Northern Affairs, Preliminary map P.731. Scale 1 inch to 1/4 mile.
- Davies, J.C. and Morin, J.A. 1976. Geology of the Cedartree Lake area, District of Kenora. Ontario Division of Mines, Geoscience Report 134, 52 p. Accompanied by Map 2319, scale 1 inch to 1/2 mile.
- Melling, D.R. 1989. Results of the 1989 trenching program on the Bag Lake property; geological mapping and sampling. Unpublished company report, Dunfrazier Gold Exploration Inc.
- Ogden, M. 1987. Testing the induced polarization technique on carbonate zones and weak sulfides at the Bag Lake property, Kenora District, Ontario. Unpublished company report, Dunfrazier Gold Exploration Inc., 5 p.
- Ogden, M. 1988. Summary maps. Unpublished company report, Dunfrazier Gold Exploration Inc.
- Ogden, M. 1988. A beneficiation study of the main showings as exposed by two separate backhoe trenching operations. Unpublished company report, Dunfrazier Gold Exploration Inc., 7 p.
- Map G-2613 July 25 1989. Dogpaw Lake, Kenora Mining Division. Ministry of Natural Resources, Land Management Branch.
- Map 2443, 1981. Kenora-Fort Frances Geological Compilation Series, Kenora and Rainy River Districts. Ontario Geological Survey. Scale 1:253,440 or 1 inch to 4 miles.

Appendix I Cost Accounting 1989 Mapping Program

1.	Line cutting	\$ 9238.50
2.	Truck rental (19 days)	\$ 1140.66
3.	Truck expenses (gas)	\$ 109.00
4.	Travel (airfare, hotel, meals)	\$ 2042.76
5.	Room and board (32 days @ \$30/day)	\$ 960.00
6.	Misc. camp expenses (gas, phone, stationary)	\$ 110.00
7.	Assays	\$ 190.00
8.	Miscellaneous (phone, stationary, extra baggage)	\$ 259.96
9.	Consulting fees	\$11850.00
		<hr/>
		\$25900.88

Appendix II
Assay Certificates



ACCURASSAY LABORATORIES LTD.

P.O. BOX 604
KIRKLAND LAKE, ONTARIO, CANADA P2N 3J5
TEL.: (705) 567-5343 3361

President: Dr. GEORGE DUNCAN, M.Sc., Ph. D., C. Chem (Ont.), C. Chem (U.K.), M.C.I.C., M.R.S.C., A.R.C.S.T.

Certificate of Analysis

Page: 1

28072

Dave Melling
Dun Frazier Gold Explorations
5216 Worthington Road
Victoria, British Columbia
V8Y 2T8

Date: October 12 19 89

Work Order # : 181395
Project :

Accurassay	SAMPLE NUMBERS Customer	Gold Oz/T	Gold ppb	
	271724	3401	<0.002	<5
	271725	3402	<0.002	<5
	271726	3403	<0.002	<5
	271727	3404	<0.002	<5
	271728	3405	<0.002	<5
	271729	3406	0.015	530
	271730	3408	<0.002	<5
	271731	3409	<0.002	<5
	271732	3410	0.008	265
	271733	3411	<0.002	<5
	271733	3411	<0.002	<5 Check
	271734	3412	<0.002	<5
	271735	3413	0.061	2086
	271736	3414	0.012	397
	271737	3416	<0.002	<5
	271738	14701	0.013	430
	271739	14702	0.016	563
	271740	14703	<0.002	<5
	271741	14704	<0.002	<5
	271742	14705	<0.002	<5
	271742	14705	<0.002	<5 Check

Per: Sanja Bemochek

ORIGINAL



ACCURASSAY LABORATORIES LTD.

P.O. BOX 604
KIRKLAND LAKE, ONTARIO, CANADA P2N 3J5
TEL.: (705) 567-6343

President: Dr. GEORGE DUNCAN, M.Sc., Ph. D., C. Chem (Ont.), C. Chem (U.K.), M.C.I.C., M.R.S.C., A.R.C.S.T.

Certificate of Analysis

Page: 1

28118

Dave Melling
Dun Frazier Gold Explorations
5216 Worthington Road
Victoria, British Columbia
V8Y 2T8

Date: October 27 19 89

Work Order # : 181410
Project :

Accurassay	SAMPLE NUMBERS Customer	Gold Oz/T	Gold ppb	
	272407	3407	<0.002	<5
	272408	3417	0.002	66
	272409	3418	0.002	66
	272410	3419	<0.002	<5
	272411	3420	<0.002	<5
	272412	3421	0.011	364
	272413	3422	<0.002	<5
	272414	3423	0.076	2616
	272415	3424	0.020	695
	272416	3425	0.029	993
	272416	3425	0.035	1192
	272417	14706	0.055	1887
	272418	14707	0.030	1026
	272419	14708	0.025	861
	272420	14709	<0.002	<5
	272421	14711	<0.002	<5
	272422	14712	0.002	66
	272423	14713	0.003	99
	272424	14714	<0.002	<5
	272425	14715	0.058	1987
	272425	14715	0.043	1490
	272426	14716	<0.002	<5
	272426	14716	<0.002	<5

Check

Check

Check

Handwritten notes:
2.6
3
10/27/89

Handwritten note:
Duncanson

13

Per:

Handwritten signature: Blake Duncanson

Appendix III
Certificates of Qualifications

I, David Rigby Melling residing at 5216 Worthington Road,
Victoria, British Columbia, do hereby certify that:

V 8 Y 2 T 8

1. I am a consulting geologist, practising since 1987.
2. I have been employed in the study and practice of my profession since 1976.
3. I am a graduate of Carleton University, Ottawa, having received an Honours B.Sc. (geology) in 1983 and M.Sc. (geology) in 1986.
4. I am a registered Fellow of the Geological Association of Canada.
5. This report is based on personal experience on the Bag Lake property, and from working in the Kenora Mining District since 1983.
6. I have no interest in, nor do I expect to receive any interest, direct or indirect, in Dunfrazier Gold Exploration Inc.
7. I consent to and authorize the use of this report and my name to a statement of material facts and other public documents.

Dated in Victoria this 1st day of November, 1989.



D.R. Melling B.Sc., M.Sc., FGAC
Consulting Geologist

Certificate of Qualifications

I, Paul Latimer Jones, resident at 27 Briarwood Crescent, Ottawa, Ontario, do hereby certify that:

- 1. I am a consulting geologist, practising since 1986.**
- 2. I have been employed in the study and practice of my profession since 1978.**
- 3. I am a graduate of Carleton University, Ottawa; having received a B.Sc. Honours (geology) degree in 1982.**
- 4. I am a registered Fellow of the Geological Association of Canada, and a member of the Prospectors and Developers Association.**
- 5. My knowledge of the Beg Lake property is based upon a site visit to that property during September and October, 1989, entailing geological mapping; and from working in the Kenora Mining Division dating back to 1983.**
- 6. I have no interest in, nor do I expect to receive any interest, direct or indirect, in Dunfrazier Gold Exploration Inc.**
- 7. I consent to and authorize the use of the attached report and data and my name to a statement of material facts and other public documents.**

Dated in Ottawa, this 17th day of October, 1989.

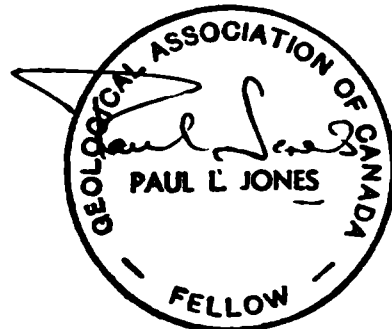

**P.L.Jones, B.Sc., F.G.A.C.
Consulting Geologist.**



Ontario



52F055E0333 2.14413 TWEEDSMUIR

900

Ministry of
Northern Development
and Mines

Ministère du
Développement du Nord
et des Mines

Geoscience Approvals Section
Mining Lands Branch
159 Cedar Street, 4th Floor
Sudbury, Ontario
P3E 6A5

Toll Free: 1-800-465-3880
Telephone: (705) 670-7264
Fax: (705) 670-7262

Our File: 2.14413
Transaction #: W9210.001

March 19, 1992

Michael Ogden
R. R. # 4
Stouffville, Ontario
L4A 7X5

Dear Sir:

**RE: REVISED ASSESSMENT WORK CREDIT FORM FOR MINING CLAIMS K535352 ET AL.
IN THE DOGPAW LAKE AREA.**

As per your request, the Assessment Credits on mining claims K. 487025 and K. 487035 have been altered to reflect the application of \$ 2,000.00 to claim K. 487035. This is the maximum allowable advance application as per subsection 4(5) of the Mining Act Regulations.

If you have any questions please contact Clive Stephenson at (705) 670-7251.

Yours sincerely,

For Ron C. Gashinski
Senior Manager, Mining Lands Branch
Mines and Minerals Division

CDS/jl

Enclosures:

cc: Mining Recorder
Kenora, Ontario

Dunfrazier Gold Exploration Inc.
Oakville, Ontario

REVISED

ASSESSMENT WORK CREDIT FORM

FILE NUMBER: 2.14413

DATE: March 19, 1992

TRANSACTION NUMBER: W9210.001

RECORDED HOLDER: Dunfrazier Gold Exploration Inc.

CLIENT NUMBER: 127974

AREA: Dogpaw Lake

CLAIM NUMBER	VALUE OF ASSESSMENT WORK DONE ON THIS CLAIM	VALUE APPLIED TO THIS CLAIM	VALUE ASSIGNED FROM THIS CLAIM
K535352	\$ 2027.00	\$ 1082.00	\$ 945.00
K535353	\$ 984.00	0.00	\$ 984.00
K535356	\$ 2027.00	\$ 1000.00	\$ 1027.00
K535357	\$ 1505.00	\$ 1000.00	\$ 505.00
K575870	\$ 460.00	0.00	\$ 460.00
K575871	\$ 1505.00	0.00	\$ 1505.00
K575872	\$ 1505.00	0.00	\$ 1505.00
K778731	\$ 1505.00	\$ 200.00	\$ 1305.00
K487021	\$ 984.00	0.00	\$ 984.00
K487027	\$ 460.00	0.00	\$ 460.00
K487031	\$ 460.00	0.00	\$ 460.00
K487025	0.00	\$ 140.00	0.00
K487028	0.00	\$ 2000.00	0.00
K487029	0.00	\$ 2000.00	0.00
K487033	0.00	\$ 2000.00	0.00
K487034	0.00	\$ 2000.00	0.00
K487035	0.00	\$ 2000.00	0.00
TOTALS	\$ 13 422.00	\$ 13 422.00	\$ 10 140.00



Ontario

Ministry of
Northern Development
and Mines

Ministère du
Développement du Nord
et des Mines

Geoscience Approvals Section
Mining Lands Branch
159 Cedar Street, 4th Floor
Sudbury, Ontario
P3E 6A5

Toll Free: 1-800-465-3880
Telephone: (705) 670-7264
Fax: (705) 670-7262

Our File: 2.14413
Transaction #: W9210.001

March 11, 1992

Mining Recorder
Ministry of Northern Development
and Mines
808 Robertson Street
P. O. Box 5200
Kenora, Ontario
P9N 3X9

Dear Sir:

RE: APPROVAL OF A GEOLOGICAL SURVEY ON MINING CLAIMS K535352 ET AL. IN
THE DOGPAW LAKE AREA.

The assessment credits for a Geological Survey, Section 12 of the Mining Act Regulations, as listed on the attached Assessment Work Credit Form, have been approved as of March 9, 1992.

As outlined in the Notice of Deficiency dated January 21, 1992, a portion of the work submitted would be eligible for credit at a rate of 100% of the cost as it would have been filed less than two years from the date of its completion. The information that was supplied indicates that a total of \$ 1,317.64 was for the period October 24-27, 1989 and pertained to costs incurred in the writing of the report. The total of \$ 12,765.00, as outlined in the Notice, already includes 50% of the above report writing costs, so an additional 50% or \$ 658.82 will be allowed.

The total approved for this submission is now \$ 13,423.82 (\$ 13,424.00 rounded off) and as such I have made some small alterations to the allocation of credit schedule supplied by M. Ogden. I have also bypassed the application of any credits to the reserve and applied it directly on the claims requested. Putting it in the reserve, then applying it, would require the filling out of another Report of Work form by the client and consequent processing by the Mining Recorder.

.../2

-2-

March 11, 1992
Mining Recorder - Kenora, Ontario

Please indicate this approval on the record sheets.

If you have any questions please contact Clive Stephenson at
(705) 670-7251.

Yours sincerely,



Ron C. Gashinski
Senior Manager, Mining Lands Branch
Mines and Minerals Division

CD
CDS/jl

Enclosures:

cc: Resident Geologist
Kenora, Ontario

Assessment Files Office
Toronto, Ontario

ASSESSMENT WORK CREDIT FORM

FILE NUMBER: 2.14413

DATE: March 11, 1992

TRANSACTION NUMBER: W9210.001

RECORDED HOLDER: Dunfrazier Gold Exploration Inc.

CLIENT NUMBER: 127974

AREA: Dogpaw Lake

CLAIM NUMBER	VALUE OF ASSESSMENT WORK DONE ON THIS CLAIM	VALUE APPLIED TO THIS CLAIM	VALUE ASSIGNED FROM THIS CLAIM
K535352	\$ 2027.00	\$ 1082.00	\$ 945.00
K535353	\$ 984.00	0.00	\$ 984.00
K535356	\$ 2027.00	\$ 1000.00	\$ 1027.00
K535357	\$ 1505.00	\$ 1000.00	\$ 505.00
K575870	\$ 460.00	0.00	\$ 460.00
K575871	\$ 1505.00	0.00	\$ 1505.00
K575872	\$ 1505.00	0.00	\$ 1505.00
K778731	\$ 1505.00	\$ 200.00	\$ 1305.00
K487021	\$ 984.00	0.00	\$ 984.00
K487027	\$ 460.00	0.00	\$ 460.00
K487031	\$ 460.00	0.00	\$ 460.00
K487025	0.00	\$ 800.00	0.00
K487028	0.00	\$ 2000.00	0.00
K487029	0.00	\$ 2000.00	0.00
K487033	0.00	\$ 2000.00	0.00
K487034	0.00	\$ 2000.00	0.00
K487035	0.00	\$ 1340.00	0.00
TOTALS	\$ 13 422.00	\$ 13 422.00	\$ 10 140.00

Personal information collected on this form is obtained under the authority of the Mining Act. This information will be used for correspondence. Questions about the collection should be directed to the Provincial Manager, Mining Lands, Ministry of Northern Development and Mines, Fourth Floor, 150 Cedar Street, Toronto, Ontario, P3E 6A5, telephone (705) 670-7284.

- Instructions:
- Please type or print and submit in duplicate.
 - Refer to the Mining Act and Regulations for requirements of filing assessment work or consult the Mining Recorder.
 - A separate copy of this form must be completed for each Work Group.
 - Technical reports and maps must accompany this form in duplicate.
 - A sketch, showing the claims the work is assigned to, must accompany this form.

2
3
1981

Recorded Holder(s) DUNFRAZIER GOLD EXPLORATION INC.	Client No. 127974
Address SUITE 203, 447 SPIERS RD OAKVILLE ONT. L6K 3S7	Telephone No. 416-842-2100
Mining Division KENORA	Township/Area DOGPAW LAKE
	M or G Plan No. Q-2613
Dates Work Performed From: SEPT 15, 1989 To: Nov. 13, 1989	

Work Performed (Check One Work Group Only)

Work Group	Type
Geotechnical Survey	GEOTECHNICAL SURVEY
Physical Work, Including Drilling	RECEIVED
Rehabilitation	
Other Authorized Work	JAN 14 1992
Assays	MINING LANDS BRANCH
Assignment from Reserve	

Total Assessment Work Claimed on the Attached Statement of Costs \$ **25,530**

Note: The Minister may reject for assessment work credit all or part of the assessment work submitted if the recorded holder cannot verify expenditures claimed in the statement of costs within 30 days of a request for verification.

Persons and Survey Company Who Performed the Work (Give Name and Address of Author of Report)

Name	Address
DAVID R. MELLING M.Sc.	VICTORIA, B.C. (PH. 604-658-2167)
P. A. JONES B.Sc.	VANCOUVER B.C.

(attach a schedule if necessary)

Certification of Beneficial Interest * See Note No. 1 on reverse side

I certify that at the time the work was performed, the claims covered in this work report were recorded in the current holder's name or held under a beneficial interest by the current recorded holder.	Date OCT 22/91	Recorded Holder or Agent (Signature) <i>Michael Dagen</i> CONSOLE MINING INC.
--	--------------------------	---

Certification of Work Report

I certify that I have a personal knowledge of the facts set forth in this Work report, having performed the work or witnessed same during and/or after its completion and annexed report is true.

Name and Address of Person Certifying
MICHAEL DAGDEN B.Sc. RR-4 STUFFVILLE, ONT. L4A 7K5

Work Report Number for Applying Reserve	Claim Number (see Note 2)	Number of Claim Units
K 535352	K 535352	1.0
K 535353	K 535353	1.25
K 535356	K 535356	1.0
K 535357	K 535357	1.12
K 575869	K 575869	1.0
K 575870	K 575870	1.25
K 575871	K 575871	1.25
K 575872	K 575872	1.0
K 487021	K 487021	1.5
K 487022	K 487022	1.25
K 487023	K 487023	1.25
K 487026	K 487026	1.0
K 487027	K 487027	1.0
K 487030	K 487030	1.0
K 487031	K 487031	1.25
K 778731	K 778731	1.25
Total Number of Claims	16	18.37

Value of Assessment Work Done on this Claim	Value Applied to this Claim
\$4085	NIL
1021	1100
4085	NIL
3064	528
NIL	NIL
1021	5400
3064	1600
2042	NIL
2042	3300
NIL	3700
NIL	1100
NIL	NIL
1021	NIL
NIL	NIL
1021	1100
3064	400 100
Total Value Work Done	7550
Total Value Work Applied	1440

Value Assigned from this Claim	Reserve: Work to be Claimed at a Future Date
\$4085	4085
1021	1100
4085	4085
2536	2536
NIL	NIL
1021	1100
1564	1564
2042	2042
42	42
1100	1100
NIL	1100
NIL	NIL
1021	1100
NIL	NIL
NIL	1100
2964	2964
2964	2964
Total Assigned From	1440
Total Reserve	1440

NOTE: TOTAL AREA OF THESE 16 CLAIMS = 731.54 ACRES VS 640 = 91.54 ACRES TOO BIG
 $91.54 / 40 \times 200 = 457.7 \text{ days} \times 322 = \$10,069$ EXTER WORK DISTRIBUTED HERE

* Credits you are claiming in this report may be cut back. In order to minimize the adverse effects of such deletions, please indicate from



Ministry of
Northern Development
and Mines

Ministère du
Développement du Nord
et des mines

Statement of Costs
for Assessment Credit

État des coûts aux fins
du crédit d'évaluation

Mining Act/Loi sur les mines

Transaction No./N° de transaction

REF: DUNIPRA 2112R
1989 DIETAM 6104

Personal information collected on this form is obtained under the authority of the Mining Act. This information will be used to maintain a record and ongoing status of the mining claim(s). Questions about this collection should be directed to the Provincial Manager, Minings Lands, Ministry of Northern Development and Mines, 4th Floor, 150 Cedar Street, Sudbury, Ontario P3E 6A5, telephone (705) 670-7264.

Les renseignements personnels contenus dans la présente formule sont recueillis en vertu de la Loi sur les mines et serviront à tenir à jour un registre des concessions minières. Adressez toute question sur la collecte de ces renseignements au chef provincial des terrains miniers, ministère du Développement du Nord et des Mines, 150, rue Cedar, 4^e étage, Sudbury (Ontario) P3E 6A5, téléphone (705) 670-7264.

1. Direct Costs/Coûts directs

Type	Description	Amount Montant	Totals Total global
Wages Salaires	Labour Main-d'oeuvre		
	Field Supervision Supervision sur le terrain		
Contractor's and Consultant's Fees Droits de l'entrepreneur et de l'expert- conseil	Type LAMP CUTTING	9,238.6	
	CONSULTING FEES	11,950	
	ASSAYS	190	21,278
Supplies Used Fournitures utilisées	Type		
Equipment Rental Location de matériel	Type		
Total Direct Costs Total des coûts directs			21,278

2. Indirect Costs/Coûts indirects

** Note: When claiming Rehabilitation work Indirect costs are not allowable as assessment work.
Pour le remboursement des travaux de réhabilitation, les coûts indirects ne sont pas admissibles en tant que travaux d'évaluation.

Type	Description	Amount Montant	Totals Total global
Transportation Transport	Type TRUCK RENT	1140	
	" EXPENSE	109	
			1249
Food and Lodging Nourriture et hébergement	APPROPRIATE EXP.	960 110	
			1070
Mobilization and Demobilization Mobilisation et démobilisation	TRAVEL MISC.	2042 260	
			2302
Sub Total of Indirect Costs Total partiel des coûts indirects			4621
Amount Allowable (not greater than 20% of Direct Costs) Montant admissible (n'excédant pas 20 % des coûts directs)			4253
Total Value of Assessment Credit (Total of Direct and Allowable Indirect costs)			25,531
Valueur totale du crédit d'évaluation (Total des coûts directs et indirects admissibles)			25,531

Note: The recorded holder will be required to verify expenditures claimed in this statement of costs within 30 days of a request for verification. If verification is not made, the Minister may reject for assessment work all or part of the assessment work submitted.

Note: Le titulaire enregistré sera tenu de vérifier les dépenses demandées dans le présent état des coûts dans les 30 jours suivant une demande à cet effet. Si la vérification n'est pas effectuée, le ministre peut rejeter tout ou une partie des travaux d'évaluation présentés.

Filing Discounts

1. Work filed within two years of completion is claimed at 100% of the above Total Value of Assessment Credit.
2. Work filed three, four or five years after completion is claimed at 50% of the above Total Value of Assessment Credit. See calculations below:

Total Value of Assessment Credit	Total Assessment Claimed
	× 0.50 =

Remises pour dépôt

1. Les travaux déposés dans les deux ans suivant leur achèvement sont remboursés à 100 % de la valeur totale susmentionnée du crédit d'évaluation.
2. Les travaux déposés trois, quatre ou cinq ans après leur achèvement sont remboursés à 50 % de la valeur totale du crédit d'évaluation susmentionné. Voir les calculs ci-dessous.

Valeur totale du crédit d'évaluation	Evaluation totale demandée
	× 0,50 =

Certification Verifying Statement of Costs

Attestation de l'état des coûts

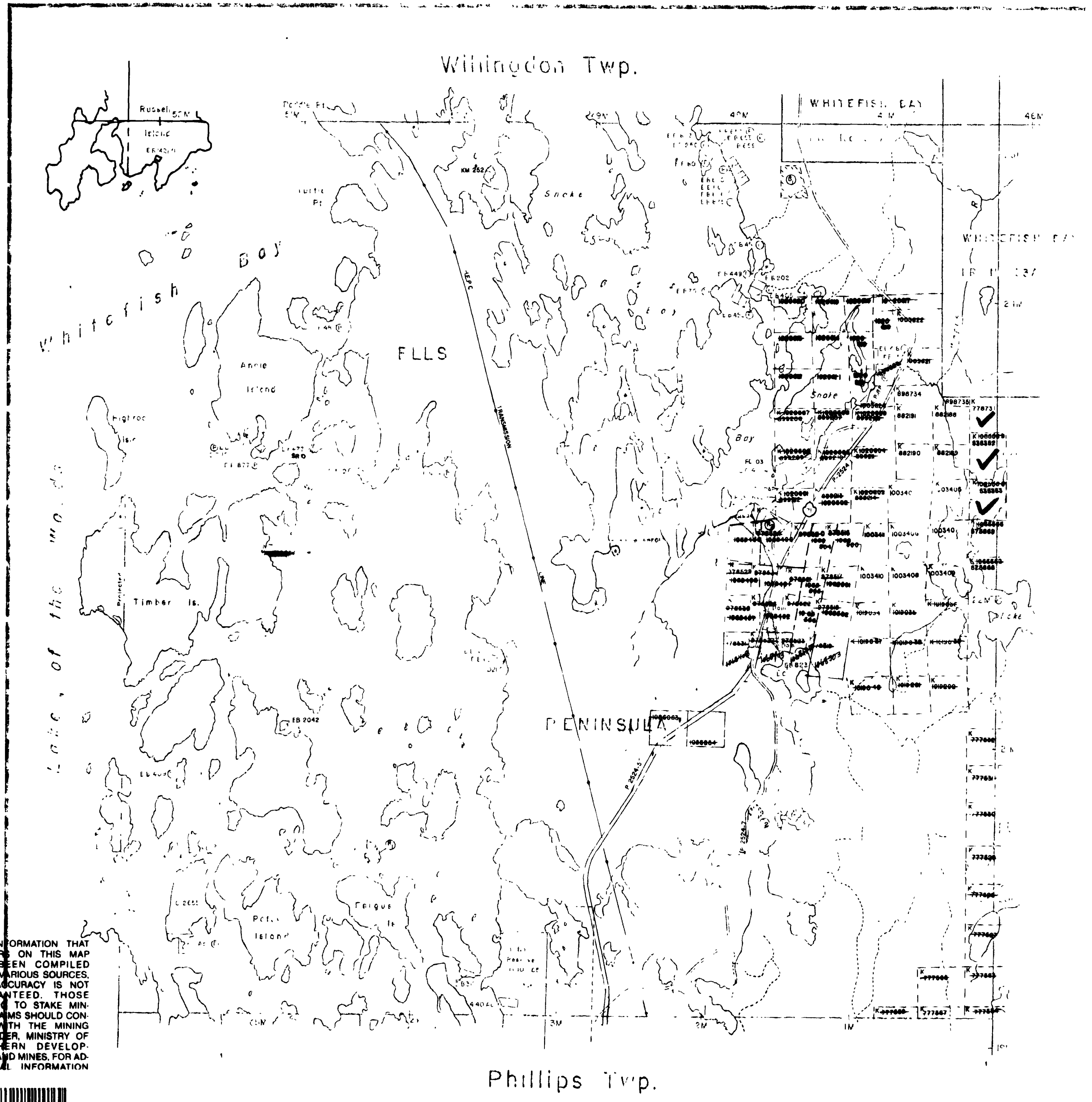

THE INFORMATION THAT APPEARS ON THIS MAP HAS BEEN COMPILED FROM VARIOUS SOURCES, AND ACCURACY IS NOT GUARANTEED. THOSE WISHING TO STAKE MINING CLAIMS SHOULD CONSULT WITH THE MINING RECORDER, MINISTRY OF NORTHERN DEVELOPMENT AND MINES, FOR ADDITIONAL INFORMATION



THE TOWNSHIP OF
 OF
TWEEDSMUIR
 DISTRICT OF
 KENORA
 MINING DIVISION
2.14413
 SCALE: 1 INCH = 40 CHAINS

LEGEND

- PATENTED LAND ⊙
- CROWN LAND SALE CS
- LEASES L
- LOCATED LAND LW
- LICENSE OF OCCUPATION LO
- MINING RIGHTS ONLY MR
- SURFACE RIGHTS ONLY SR
- RESERVED FOR PUBLIC USE RPU
- IMPROVED CITY BLOCK IB
- MINES M
- CARTELS C

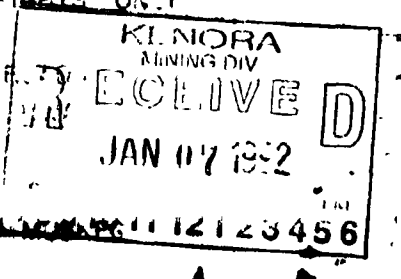

NOTES

1. All areas shown on this map are subject to the provisions of the Mining Act, R.S.O. 1952, Chapter 227, and the Mining Regulations, S.O. 1952, Chapter 227/01.

2. The boundaries shown on this map are those shown on the original plans and are not necessarily the same as the boundaries shown on the maps of the Township of Tweedsmuir.

3. The areas shown on this map are those shown on the original plans and are not necessarily the same as the areas shown on the maps of the Township of Tweedsmuir.

AREAS WITHDRAWN FROM DISPOSITION

S.R. SURFACE RIGHTS		M.P. MINING RIGHTS	
Description	Order No.	Date	Disposition
Reserved For Public Use			16-1475
Sec. 42 of Mg Act			SRU 16-1475

SAND & GRAVEL

MTC PIT 10-9	File 88454
GRAVEL	File 88454

G-1357

PLAN NO. **14123456**

DEPARTMENT OF MINES
 — ONTARIO —

LOBSTICK BAY G-2627

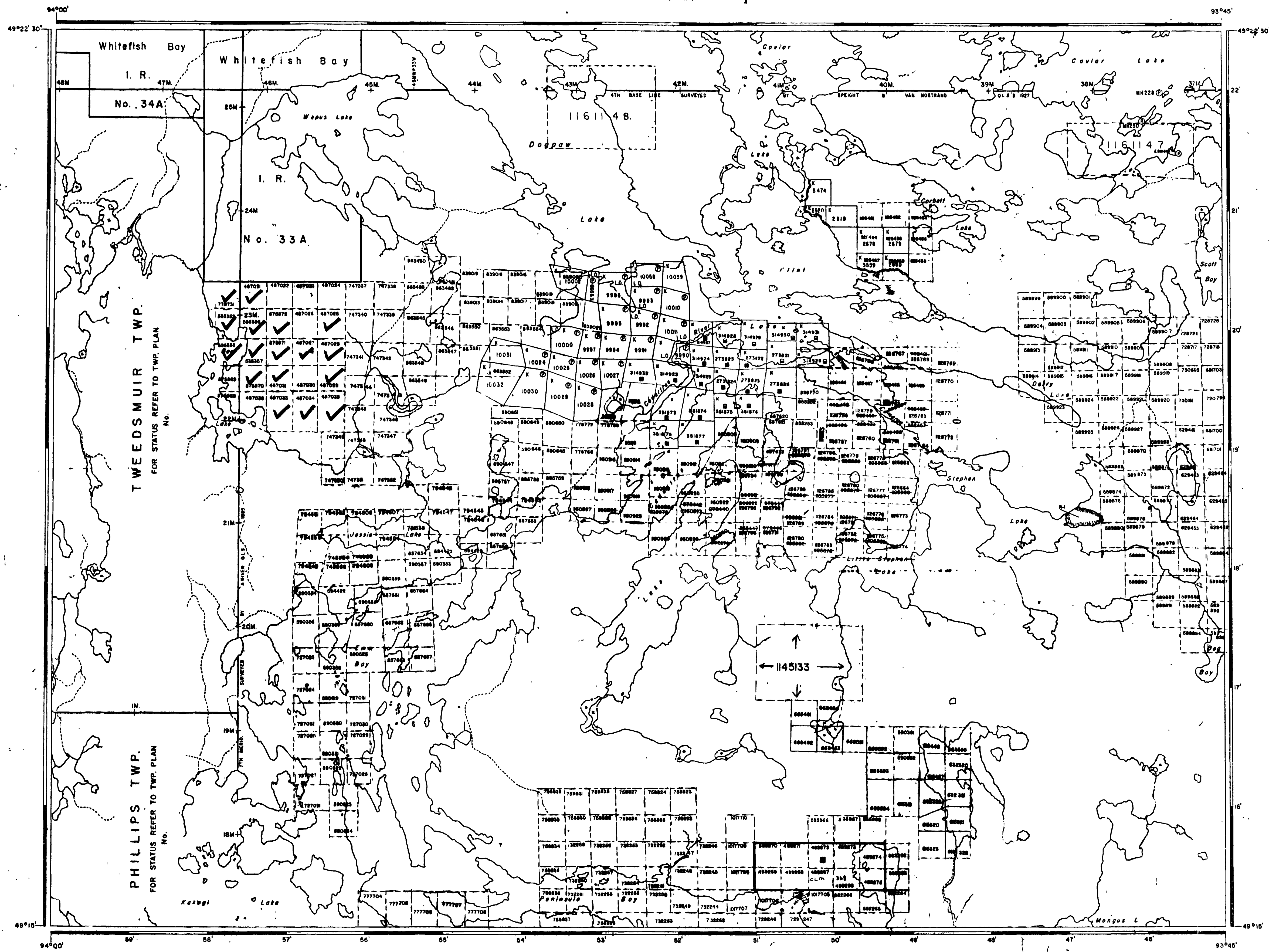

LEGEND

HIGHWAY AND ROUTE No.	
OTHER ROADS	
TRAILS	
SURVEYED LINES:	
TOWNSHIPS, BASE LINES, ETC.	
LOTS, MINING CLAIMS, PARCELS, ETC.	
UNSURVEYED LINES:	
LOT LINES	
PARCEL BOUNDARY	
MINING CLAIMS ETC.	
RAILWAY AND RIGHT OF WAY	
UTILITY LINES	
NON-PERENNIAL STREAM	
FLOODING OR FLOODING RIGHTS	
SUBDIVISION OR COMPOSITE PLAN	
RESERVATIONS	
ORIGINAL SHORELINE	
MARSH OR MUSKEG	
MINES	
TRAVERSE MONUMENT	

DISPOSITION OF CROWN LANDS

TYPE OF DOCUMENT	SYMBOL
PATENT, SURFACE & MINING RIGHTS	
SURFACE RIGHTS ONLY	
MINING RIGHTS ONLY	
LEASE, SURFACE & MINING RIGHTS	
SURFACE RIGHTS ONLY	
MINING RIGHTS ONLY	
LICENCE OF OCCUPATION	
ORDER-IN-COUNCIL	
RESERVATION	
CANCELLED	
SAND & GRAVEL	

NOTE: MINING RIGHTS IN PARCELS PATENTED PRIOR TO MAY 6, 1913, VESTED IN ORIGINAL PATENTEES BY THE PUBLIC LANDS ACT, R.S.O. 1970, CHAP. 200, SEC. 68, SUBSEC. 1.

REFERENCES

AREAS WITHDRAWN FROM DISPOSITION

Description	Order No.	Date	Disposition	F.R.
R-1	W 99 00	MAR 1/72	AMB	100773

THE INFORMATION THAT APPEARS ON THIS MAP HAS BEEN COMPILED FROM VARIOUS SOURCES, AND ACCURACY IS NOT GUARANTEED. THOSE WISHING TO STAKE MINING CLAIMS SHOULD CONSULT WITH THE MINING RECORDER, MINISTRY OF NORTHERN DEVELOPMENT AND MINES, FOR ADDITIONAL INFORMATION ON THE STATUS OF THE LAND SHOWN HEREON.

KENORA
2.14413
 JAN 07 1982
 7291011212458

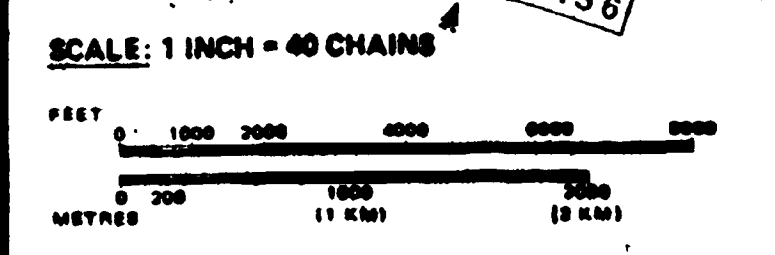

AREA
DOGPAW LAKE
 M.N.P. ADMINISTRATIVE DISTRICT
KENORA
 MINING DIVISION **2.14413**
 LAND TITLES / REGISTRY DIVISION
KENORA

Ministry of Natural Resources
 Land Management Branch
 Ontario

0101 JANUARY 1984
G-2613

HERONRY LAKE G-2621



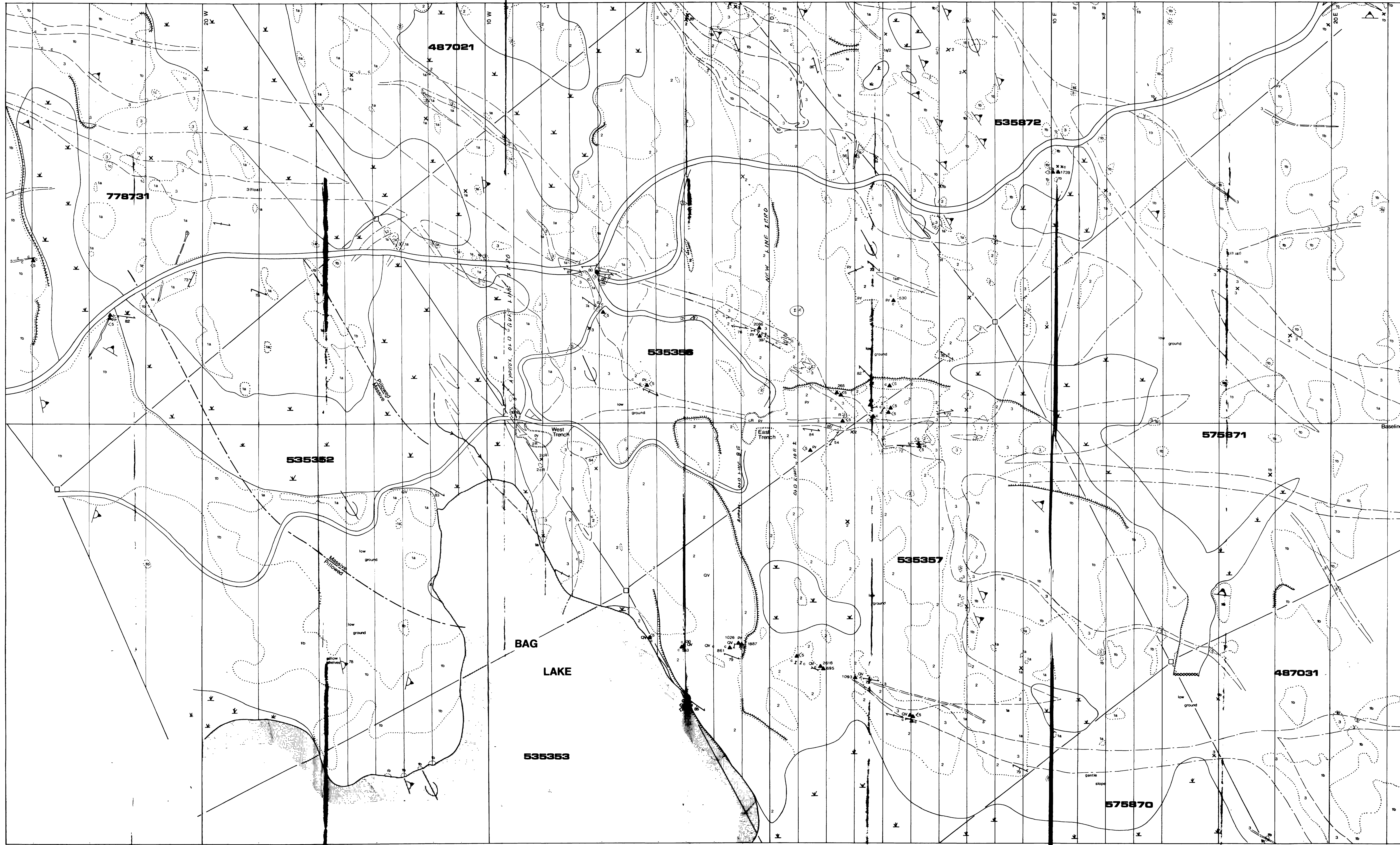

- LEGEND**
- INTRUSION**
- 3 Felsic Feldspar Porphyry Dyke
 - 2 Gabbro
- MAFIC FLOW**
- 1 a Massive
 - b Pillowed
 - c Flow Breccia
- Other Symbols:**
- c Carbonate
 - R Rutile
 - py Pyrite

- SYMBOLS**
- ▲ 430 Sample Location with Value (ppt)
 - ▲ Pillow Top
 - Foliation: inclined
 - Foliation: vertical
 - Glacial Striae
 - Discontinuous Outcrop Area
 - X Small Outcrop
 - Trench
 - Scarp
 - Swamp
 - Geologic Contacts: observed
 - Geologic Contacts: approximate
 - Geologic Contacts: inferred
 - Shoreline
 - Road: Nunseco Cameron Lake
 - Bush Trail
 - Claim Post
 - XXX Beaver Dam

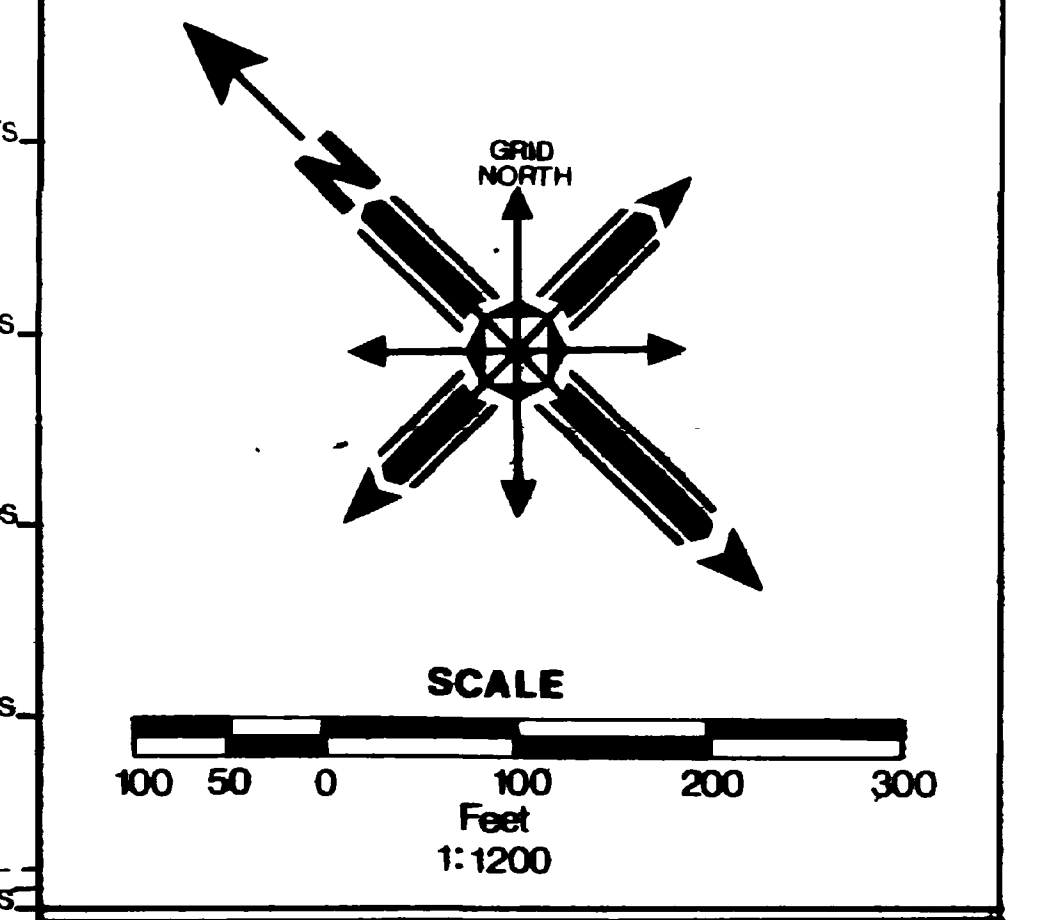

DUNFRAZIER GOLD EXPLORATION INC.

Kenora Mining District
BAG LAKE PROPERTY
 EAST GRID
 GEOLOGICAL PLAN
 NTS 52 F5

By P.L. Jones
 DR. Melling **2-14413** 1989

Dwn. P.L.A.	Date Oct '89	Rev.	Date
-------------	--------------	------	------

P.L. Jones