

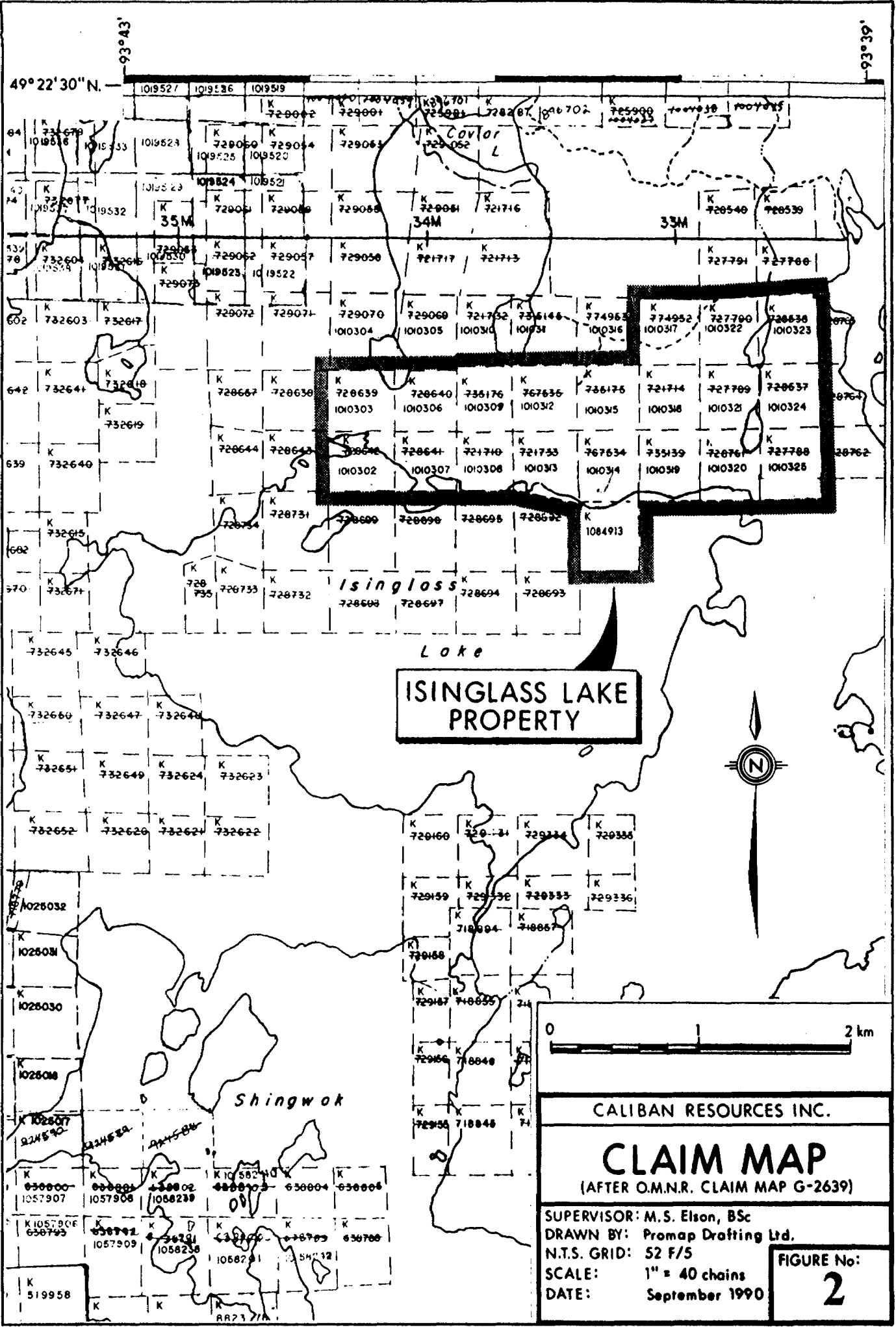

52F055E0502 2.13571 ROWAN LAKE

010

REPORT OF DIAMOND DRILLING



49°22'30"N.

93°43'

93°39'

ISINGLASS LAKE PROPERTY



CALIBAN RESOURCES INC.

CLAIM MAP

(AFTER O.M.N.R. CLAIM MAP G-2639)

SUPERVISOR: M.S. Elson, BSc
 DRAWN BY: Promap Drafting Ltd.
 N.T.S. GRID: 52 F/5
 SCALE: 1" = 40 chains
 DATE: September 1990

FIGURE No:
2

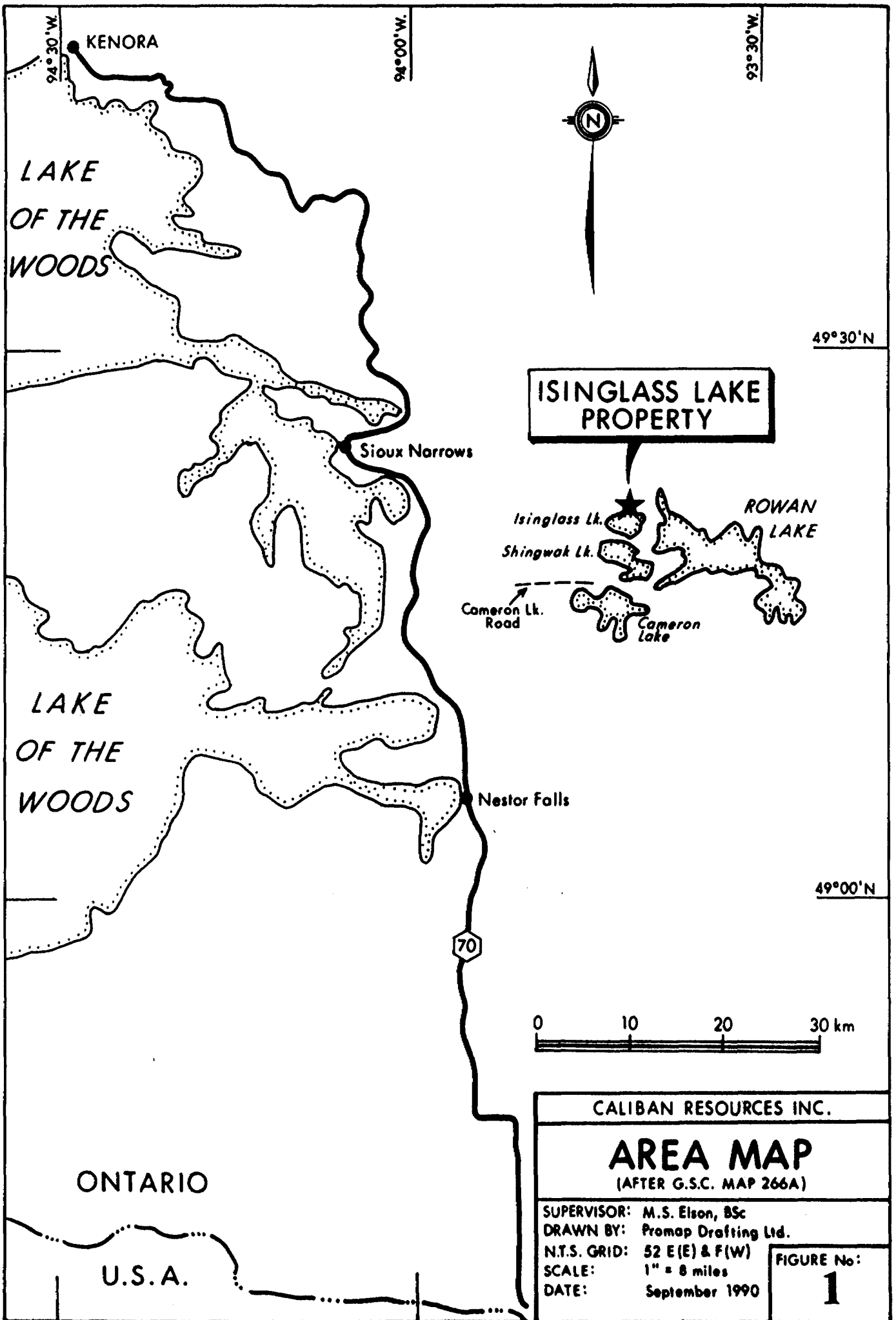

94°30'W
KENORA

94°00'W

93°30'W

LAKE OF THE WOODS

49°30'N

ISINGLASS LAKE PROPERTY

Sioux Narrows

Isinglass Lk.

ROWAN LAKE

Shingwak Lk.

Cameron Lk. Road

Cameron Lake

LAKE OF THE WOODS

Nestor Falls

49°00'N

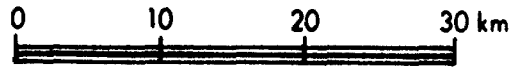

CALIBAN RESOURCES INC.

AREA MAP
(AFTER G.S.C. MAP 266A)

SUPERVISOR: M.S. Elson, BSc
 DRAWN BY: Promap Drafting Ltd.
 N.T.S. GRID: 52 E(E) & F(W)
 SCALE: 1" = 8 miles
 DATE: September 1990

FIGURE No:
1

ONTARIO

U.S.A.

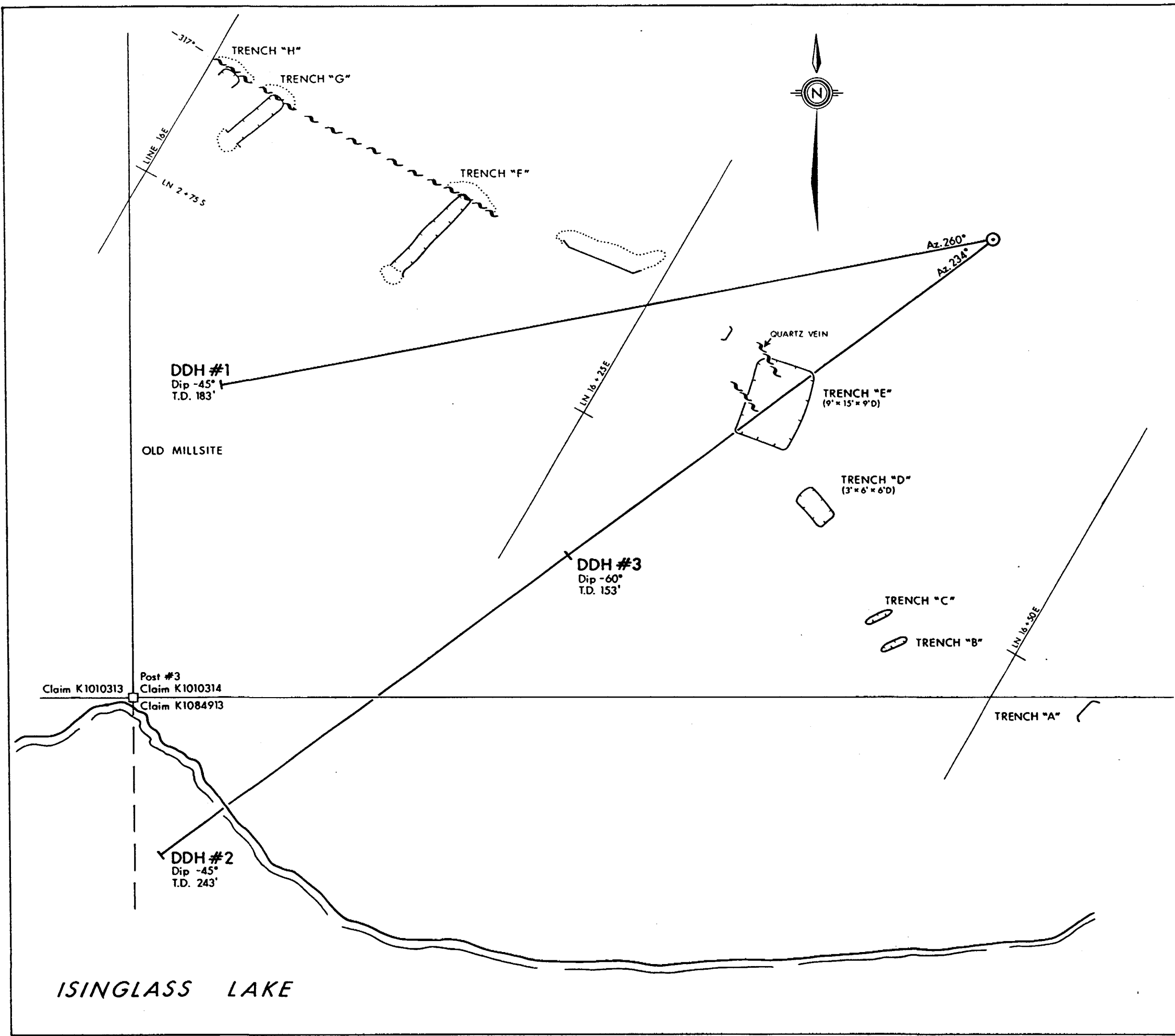

CALIBAN RESOURCES INC.

ISINGLASS LAKE PROJECT
KENORA, ONTARIO

ROSEMAN-THOMPSON GOLD SHOWING
LOCATION OF TRENCHING AND DIAMOND DRILL HOLES, 1990

SUPERVISOR:	M.S. Elson, B.Sc.	FIGURE No: 3
DRAWN BY:	Promap Drafting Ltd.	
MINING DIV:	Kenora	
N.T.S. GRID:	52 F/5 (SE)	
SCALE:	1:200	
DATE:	September 1990	

ISINGLASS LAKE



Complete this form and
related sketch in duplicate.

Fill in on
every page

Hole No. 1 Page No. 1

Drilling Company KENORA SOIL AND DRILLING		Collar Elevation 50' ABOVE ISINGLASS L.	Bearing of hole from true North 260°	Total Footage 183	Dip of Hole at Collar -45°	Address/Location where core stored CORE (130, 1 1/2") IS STORED AT THE DRILL SITE, NORTH SHORE OF ISINGLASS LAKE.	Map Reference No. G-2639	Claim No. K1010314
Date Hole Started MAY 21 1990	Date Completed MAY 24 1990	Date Logged MAY 24 1990	Logged by M.S. ELSON		FL		Location (Twp., Lot, Con. or Lat. and Long.) ROWAN LAKE	
Exploration Co., Owner or Optionee CALIFORNIA RESOURCES INC. 709-543 GRANVILLE ST. VANCOUVER B.C.		Date Submitted JULY 14 1990	Submitted by (Signature) <i>M.S. Elson</i> (M.S. ELSON)		FL			
					FL			Property Name ISINGLASS LAKE

Footage		Rock Type	Description Colour, grain size, texture, minerals, alteration, etc.	Planar Feature Angle *	Core Specimen Footage †	Your Sample No.	Sample Footage		Sample Length	Assays †	
From	To						From	To		Ag (oz/ton)	Au (oz/ton)
0	16	OVERBURDEN	NO CORE RECOVERY								
16	43	GABBRO	Fine grained dark gabbro, minor pyrite in calcite-filled fractures. Minor shearing at 30'. Abundant hematite from 40'-43'.								
43	53	GABBRO	Fine grained gabbro, abundant hematite, minor pyrite and pyrrhotite, calcite veinlets in cross-fractures, minor epidote from 50'-53'								
53	63		Altered gabbro, approximately 0.1 to pyrite, minor hematite.								
63	85		Fine-grained gabbro, hematite staining, trace sulphides, 1/4" quartz stringers at 70'.								
85	95		Porphyritic or brecciated gabbro, minor calcite, abundant feldspar, iron oxide in fractures, specks of magnetite. 4 samples assayed at 2.5' intervals.			90-1 1			.06	.001	
						90-1 2			.04	.008	
						90-1 3			.04	.001	
						90-1 4			.03	.001	
95	118		Fine-grained gabbro, minor calcite in calcite filled fractures, 6' section from 112' to 118' assayed			90-1 5,6			.04	.002 (6)	
									.03	.015 (5)	
118	183		Very black fine-grained gabbro, minor pyrite and pyrrhotite. Epidote in 1-2 mm stringers from 158'-161'.								
183			End of hole.								

* For features such as foliation, bedding, schistosity, measured from the long axis of the core.

† Additional credit available. See Assessment Work Regulations



Complete this form and
related sketch in duplicate.

Fill in on
every page

Hole No. **2** Page No. **1**

Drilling Company KENORA SOIL AND DRILLING		Collar Elevation 50' ASPIR ISENGLASS L.	Bearing of hole from true North 2340	Total Footage 243'	Dip of Hole at Collar -450	Address/Location where core stored CORE (30, 1 1/8") IS STORED AT THE DRILL SITE, NORTH SHORE OF ISENGLASS LAKE.	Map Reference No. G-2639	Claim No. K1010314
Date Hole Started MAY 25 1990	Date Completed MAY 30 1990	Date Logged MAY 30 1990	Logged by M.S. ELSON		FL		Location (Twp., Lot, Con. or Lat. and Long.) ROWAN LAKE	
Exploration Co., Owner or Optionee CALIBAN RESOURCES INC. # 708-543 GRANVILLE ST. VANCOUVER B.C. V6C 1K9		Date Submitted JULY 14 1990	Submitted by (Signature) Mike Elson (M.S. ELSON)		FL			
					FL			Property Name ISENGLASS LAKE

Footage		Rock Type	Description Colour, grain size, texture, minerals, alteration, etc.	Planar Feature Angle *	Core Specimen Footage †	Your Sample No.	Sample Footage		Sample Length	Assays †	
From	To						From	To		Ag (g/t)	Au (g/t)
0	8	OVERBURDEN	NO CORE RECOVERY								
8	13	GABBRO	SHATTERED GABBRO, hematite stained.								
13	63	GABBRO	Fine-grained gabbro, minor pyrite in 0.3 cm calcite filled fractures, very minor pyrrhotite, very minor hematite.								
63	73	GABBRO	Fine-grained dark gabbro, approximately 2% pyrite (white and yellow) disseminated and in fracture fillings, minor iron oxide in fractures. Two assay samples at 5' intervals.			90-2, 1 90-2, 2				.03 .02	.004 .005
73	77	GABBRO	Fine-grained gabbro, minor hematite.			90-2, 3				.06	.007
77	93		Altered gabbro, disseminated pyrite and pyrrhotite, approximately 2% sulphides, minor chlorite. Assayed at 2.5' intervals.			90-2, 4 90-2, 5 90-2, 6 90-2, 7 90-2, 8 90-2, 9 90-2, 10				.04 .05 .05 .02 .02 .01 .02	.035 .002 .001 .002 .004 .006
93	97		Altered gabbro. 4' section assayed.			90-2, 11				.03	.001
97	243		Fine-grained gabbro, slightly altered, minor pyrite and pyrrhotite, occasional 2mm calcite filled fractures, iron oxide staining, minor chlorite in fractures.			90-2, 12 90-2, 13	168 195	170 199		.03 .02	.005 .002
243			End of hole								

* For features such as foliation, bedding, schistosity, measured from the long axis of the core.

† Additional credit available. See Assessment Work Regulations



Complete this form and
related sketch in duplicate.

Fill in on
every page

Hole No. **3** Page No. **1**

Drilling Company KENORA SOIL AND DRILLING		Collar Elevation 50' ABOVE ISINGLASS L.	Bearing of hole from true North 234°	Total Footage 153	Dip of Hole at Collar -60°	Address/Location where core stored CORE (80, 1 1/2") IS STORED AT THE DRILL SITE, NORTH SHORE OF ISINGLASS LAKE.	Map Reference No. G-2639	Claim No. K 1010314
Date Hole Started MAY 30 1990	Date Completed JUNE 3 1990	Date Logged JUNE 4 1990	Logged by M.S. ELSON		Fl.		Location (Twp., Lot, Con. or Lat. and Long.) ROWAN LAKE	Property Name ISINGLASS LAKE
Exploration Co., Owner or Optionee CANIRAN RESOURCES INC. 708 - 543 GRANVILLE ST. VANCOUVER B.C. V6C 1X8		Date Submitted JULY 14 1990	Submitted by (Signature) M.S. Elson (M.S. ELSON)		Fl.			
					Fl.			

Footage		Rock Type	Description Colour, grain size, texture, minerals, alteration, etc.	Planar Feature Angle *	Core Specimen Footage †	Your Sample No.	Sample Footage		Sample Length	Assays †	
From	To						From	To		As (g/in)	Al (g/in)
0	6	OVERBURDEN	NO CORE RECOVERY								
6	60	GABBRO	Fine-grained gabbro, minor pyrite and pyrrhotite, 6" section abundant hematite at 40'								
60	70	GABBRO	Highly altered gabbro, minor hornblende, minor cubic pyrite, section probably gossanous interbedding.			90-3, 1	60	65	.03	.001	
						90-3, 2	65	70	.03	.003	
70	80		Gabbro, minor pyrite								
80	70		Fine-grained gabbro, abundant pyrite, minor quartz veins			90-3, 3	81	87	.04	.011	
						90-3, 4	87	90	.04	.001	
90	153	GABBRO	Dark fine-grained gabbro, very minor pyrite and pyrrhotite								
153			End of hole.								

* For features such as foliation, bedding, schistosity, measured from the long axis of the core.

† Additional credit available. See Assessment Work Regulations

ACME ANALYTICAL LABORATORIES LTD.
852 E. HASTINGS ST. VANCOUVER B.C. V6A 1R6
PHONE(604)253-3158 FAX(604)253-1716

DATE RECEIVED: JUN 12 1990

DATE REPORT MAILED: *June 14/90*

ASSAY CERTIFICATE

Aquiline Resources Inc. FILE # 90-1701
708 - 543 Granville St., Vancouver BC V6C 1X8 Attn: MIKE ELSON

SAMPLE#	AG** oz/t	AU** oz/t
90-1 1	.06	.001
90-1 2	.04	.008
90-1 3	.04	.001
90-1 4	.03	.001
90-1 5	.03	.019
90-1 6	.04	.002
90-2 1	.03	.004
90-2 2	.02	.005
90-2 3	.06	.007
90-2 4	.04	.035
90-2 5	.05	.002
90-2 6	.05	.001
90-2 7	.02	.001
90-2 8	.02	.002
90-2 9	.01	.004
90-2 10	.02	.006
90-2 11	.03	.001
90-2 12	.03	.005
90-2 13	.02	.002
90-3 1	.03	.001
90-3 2	.03	.003
90-3 3	.04	.011
90-3 4	.04	.001

2.13571

- SAMPLE TYPE: Core AG** & AU** BY FIRE ASSAY FROM 1' A.T.

SIGNED BY *C. King* D. TOYE, C. LEONG, J. WANG; CERTIFIED B.C. ASSAYERS

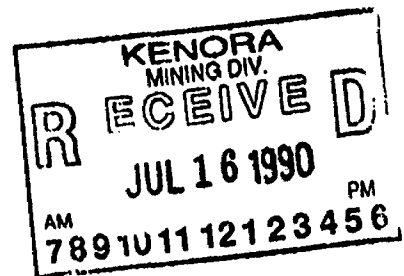

GEOCHEMICAL ANALYSIS CERTIFICATE

Aquiline Resources Inc. File # 90-1701R

708 - 543 Granville St., Vancouver BC

SAMPLE#	Mo ppm	Cu ppm	Pb ppm	Zn ppm	Ag ppm	Ni ppm	Co ppm	Mn ppm	Fe %	As ppm	U ppm	Au ppm	Th ppm	Sr ppm	Cd ppm	Sb ppm	Bi ppm	V ppm	Ca %	P %	La ppm	Cr ppm	Mg %	Ba ppm	Ti %	B ppm	Al %	Na %	K %	W ppm
90-24	6	112	3	34	.2	15	27	339	3.53	2	5	ND	2	68	.8	2	4	71	2.62	.050	59	7	.77	97	.12	2	.61	.03	.04	1
90-25	1	119	8	73	.1	22	22	544	5.22	5	8	ND	2	75	1.2	2	2	125	3.67	.019	159	10	1.93	289	.13	5	1.28	.02	.02	1
90-26	2	14	12	67	.1	18	21	758	4.90	2	5	ND	2	136	1.0	2	5	92	6.65	.064	96	7	1.68	274	.13	2	1.22	.02	.02	1
90-27	1	150	8	79	.2	30	10	572	7.36	3	5	ND	1	98	2.1	2	2	140	3.18	.030	9	13	2.01	18	.14	6	1.56	.03	.02	1
90-28	1	112	23	82	.1	31	30	554	7.05	3	5	ND	1	83	1.3	2	2	142	2.66	.036	54	11	2.40	408	.14	8	1.63	.02	.40	1
90-29	1	22	17	71	.1	21	17	1031	4.20	2	6	ND	1	135	1.6	2	2	78	11.38	.064	341	7	2.35	1744	.05	19	1.44	.01	.79	1
90-210	1	16	19	57	.1	16	15	1298	2.86	3	8	ND	1	205	1.2	2	16	53	19.39	.206	790	5	1.76	1574	.03	19	1.14	.01	.55	1
STANDARD C	17	58	42	133	7.2	67	30	1024	4.05	38	22	7	37	47	17.3	16	22	56	.52	.095	36	56	.93	175	.07	35	1.97	.06	.14	11

ICP - .500 GRAM SAMPLE IS DIGESTED WITH 3ML 3-1-2 HCL-HNO3-H2O AT 95 DEG. C FOR ONE HOUR AND IS DILUTED TO 10 ML WITH WATER.
THIS LEACH IS PARTIAL FOR MN FE SR CA P LA CR MG BA TI B W AND LIMITED FOR NA K AND AL. AU DETECTION LIMIT BY ICP IS 3 PPM.
- SAMPLE TYPE: Core Pulp

DATE RECEIVED: JUL 7 1990

DATE REPORT MAILED: July 11/90

SIGNED BY: C. Leong D. TOYE, C. LEONG, J. WANG; CERTIFIED B.C. ASSAYERS



Ontario



52F056E0502 2.13571 ROWAN LAKE

900

Ministry of
Northern Development
and Mines

Ministère du
Développement du Nord
et des Mines

Mining Lands Section
880 Bay Street, 3rd Floor
Toronto, Ontario
M5S 1Z8

Tel: (416) 965-4888

October 24, 1990

Your File: W9001.251
Our File : 2.13571

Mining Recorder
Ministry of Northern Dev. & Mines
808 Robertson Street
P. O. Box 5200
KENORA, Ontario
P9N 3X9

Dear Madam/Sir:

RE: Data for Expenditure submitted under Section 77(19) of the
Mining Act R. S. O. 1980 on Mining Claims: K 1010302 et al.
in the Rowan Lake Area.

The enclosed statement of assessment work credits for Assaying
has been approved as of the above date.

Please inform the recorded holder of these mining claims and so
indicate on your records.

Yours sincerely,

Ron C. Gashinski
Acting Provincial Manager, Mining Lands
Mines & Minerals Division

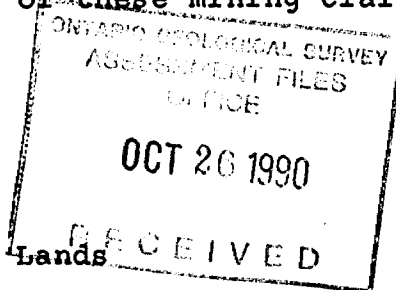

DM
DM: zm
Encl:

cc: Resident Geologist
Kenora, Ontario

Caliban Resources Inc
Vancouver, B. C.

M. C. Ryan
Vancouver, B. C.



Recorded Holder
CALIBAN RESOURCES INC

Township or Area
ROWAN LAKE

Type of survey and number of Assessment days credit per claim	Mining Claims Assessed
Geophysical Electromagnetic _____ days Magnetometer _____ days Radiometric _____ days Induced polarization _____ days Other _____ days Section 77 (19) See "Mining Claims Assessed" column Geological _____ days Geochemical _____ days Man days <input type="checkbox"/> Airborne <input type="checkbox"/> Special provision <input type="checkbox"/> Ground <input type="checkbox"/> <input type="checkbox"/> Credits have been reduced because of partial coverage of claims. <input type="checkbox"/> Credits have been reduced because of corrections to work dates and figures of applicant.	<p>\$ 345.00 Spent on assaying samples taken from Mining Claims:</p> <p>K 1010314 1084913</p> <p>345.00 Days credit allowed which may be grouped in accordance with Section 76(6) of the Mining Act R.S.O. 1980.</p>

Special credits under section 77 (16) for the following mining claims

[Empty box for special credits]

No credits have been allowed for the following mining claims

not sufficiently covered by the survey insufficient technical data filed

[Empty box for no credits]

The Mining Recorder may reduce the above credits if necessary in order that the total number of approved assessment days recorded on each claim does not exceed the maximum allowed as follows: Geophysical - 80; Geological - 40; Geochemical - 40; Section 77(19) - 60.

Aug. 31
Sept. 29

Instructions
- Please type or print.
- Refer to Subsection 77(19), the Mining Act for assessment work requirements and maximum credits allowed under this Subsection.
- Technical Reports, maps and proof of expenditures in duplicate should be submitted to Mining Lands Section, Mineral Development and Lands Branch.

Report of Work
Mining Act (Expenditures, Subsection 77(19))

Type of Work Performed ASSAY	Mining Division KENORA	Township or Area ROWAN LAKE G. 2639
Recorded Holder CALIBAN RESOURCES INC	Prospector's Licence No. T 5261	
Address # 708 - 543 GRANVILLE ST. VANCOUVER BC V6E 1V6	Telephone No. (604) 687-7733	
Work Performed By MIKE ELSON	2. 13571	
Name and Address of Author (of Submission) MIKE ELSON #708-543 GRANVILLE ST. VANCOUVER BC V6E 1V6	Date When Work was Performed From: 19 05 90 To: 07 06 90 Day Mo. Yr. Day Mo. Yr.	

All the work was performed on Mining Claim(s): Indicate no. of days performed on each claim. *See Note No. 1 on reverse side				Mining Claim K1010314	No. of Days 23	Mining Claim	No. of Days	Mining Claim	No. of Days	Mining Claim	No. of Days	Mining Claim	No. of Days
Mining Claim	No. of Days	Mining Claim	No. of Days	Mining Claim	No. of Days	Mining Claim	No. of Days	Mining Claim	No. of Days	Mining Claim	No. of Days	Mining Claim	No. of Days
Mining Claim	No. of Days	Mining Claim	No. of Days	Mining Claim	No. of Days	Mining Claim	No. of Days	Mining Claim	No. of Days	Mining Claim	No. of Days	Mining Claim	No. of Days

Instructions Total days credits may be distributed at claim holder's choice. Enter number of days credits per claim in the expenditure days credit column, (below).	Calculation of Expenditure Days Credits Total Expenditures \$ 345.00	Total Days Credits 15	Total Number of Mining Claims Covered by this Report of Work 1
--	---	---------------------------------	--

Mining Claims (List in numerical sequence). If space is insufficient, attach schedules with required information

Prefix	Mining Claim Number	Expend. Days Cr.	Prefix	Mining Claim Number	Expend. Days Cr.	Prefix	Mining Claim Number	Expend. Days Cr.	Prefix	Mining Claim Number	Expend. Days Cr.
K	1010302	23									

RECEIVE
AUG 07 1990
MINING LANDS SECTION

Total Number of Days Performed 93 23	Total Number of Days Claimed 93 23	Total Number of Days to be Claimed at a Future Date 0
--	--	---

Certification of Beneficial Interest *See Note No. 2 on reverse side

I hereby certify that, at the time the work was performed, the claims covered in this report of work were recorded in the current recorded holder's name or held under a beneficial interest by the current recorded holder.

Date: **July 27/1990**
Recorded Holder or Agent (Signature): **M.C. Ryan for MIKE ELSON**

Certification Verifying Report of Work

I hereby certify that I have a personal and intimate knowledge of the facts set forth in the Report of Work annexed hereto, having performed the work or witnessed same during and/or after its completion and the annexed report is true.

Name and Address of Person Certifying
M.C. RYAN (FOR MIKE ELSON), DIRECTOR, 65-1058 NELSON STREET VANCOUVER, BC. V6E 1M9

Telephone No. (604) **685-4117**
Date: **July 27/90**
Certified By (Signature): **M.C. Ryan for (Mike Elson)**

For Office Use Only

Total Days Cr. Recorded 23	Date Recorded July 31/90	Mining Recorder Scott Rivett
Date Approved as Recorded Oct 23/90	Provincial Manager, Mining Lands See Revised Notice Sheet	

Received Stamp
KENORA MINING DIV. RECEIVED JUL 31 1990 AM 3:15 PM 789101112123456

ATIKWA LAKE (GRAPNEL BAY)

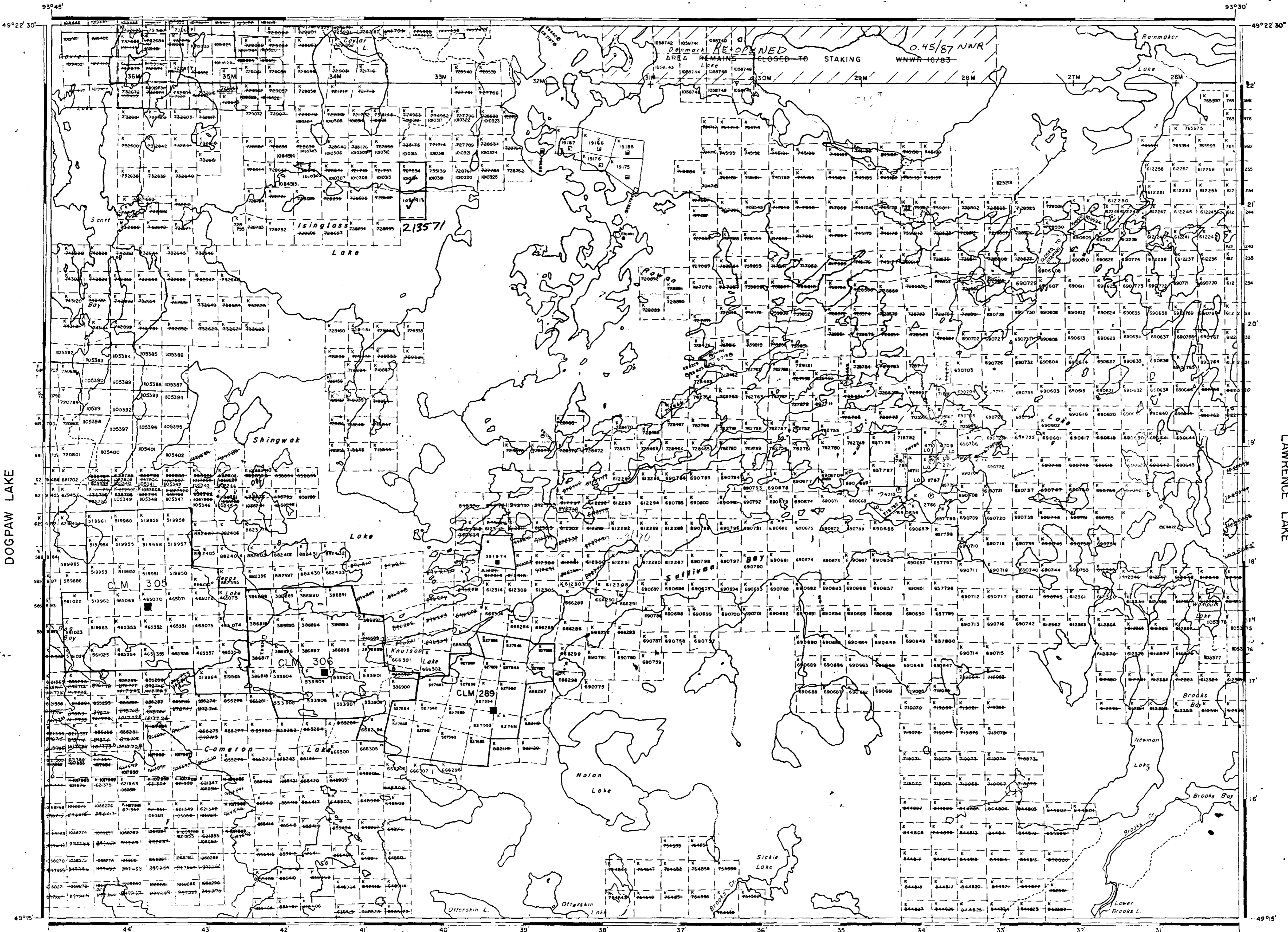

LEGEND

- HIGHWAY AND ROUTE No.
- OTHER ROADS
- TRAILS
- SURVEYED LINES
 - TOWNSHIPS, BASE LINES, ETC.
 - LCTS, MINING CLAIMS, PARCELS ETC.
- UNSURVEYED LINES
 - LOT LINES
 - PARCEL BOUNDARY
 - MINING CLAIMS ETC.
- RAILWAY AND RIGHT OF WAY
- UTILITY LINES
- NON-PERENNIAL STREAM
- FLOODING OR FLOODING RIGHTS
- SUBDIVISION OR COMPOSITE PLAN
- RESERVATIONS
- ORIGINAL SHORELINE
- MARSH OR MUSKEG
- MINES
- TRAVERSE MONUMENT

DISPOSITION OF CROWN LANDS

TYPE OF DOCUMENT	SYMBOL
PATENT, SURFACE & MINING RIGHTS	●
" SURFACE RIGHTS ONLY	○
" MINING RIGHTS ONLY	○
LEASE, SURFACE & MINING RIGHTS	■
" SURFACE RIGHTS ONLY	■
" MINING RIGHTS ONLY	■
LICENCE OF OCCUPATION	▽
ORDER-IN-COUNCIL	OC
RESERVATION	○
CANCELLED	○
SAND & GRAVEL	○

NOTE: MINING RIGHTS IN PARCELS PATENTED PRIOR TO MAY 6 1913, VESTED IN ORIGINAL PATENTEE BY THE PUBLIC LANDS ACT, R.S.O. 1910 CHAP. 380 SEC. 63, SUBSEC. 1

SCALE: 1 INCH = 40 CHAINS

FEET: 0 1000 2000 4000 6000 8000
METRES: 0 200 1000 2000 4000

THE INFORMATION THAT APPEARS ON THIS MAP HAS BEEN COMPILED FROM VARIOUS SOURCES, AND ACCURACY IS NOT GUARANTEED. THOSE WISHING TO STAKE MINING CLAIMS SHOULD CONSULT WITH THE MINING RECORDER, MINISTRY OF NORTHERN DEVELOPMENT AND MINES, FOR ADDITIONAL INFORMATION ON THE STATUS OF THE LANDS SHOWN HEREON.

EFFECTIVE AS SHOWN

KENORA
MINING DIV.
RECEIVED
SEP 28 1986
AM 739101112123456 PM

AREA
ROWAN LAKE
M.N.R. ADMINISTRATIVE DISTRICT
KENORA / FORT FRANCES
MINING DIVISION
KENORA
LAND TITLES / REGISTRY DIVISION
KENORA

Ontario Ministry of Natural Resources
Ministry of Northern Development and Mines

