



52F05SE0503 2.12951 ROWAN LAKE

010

GEOCHEMICAL SURVEY OF CLAIMS K1084914,
K1084915 AND K1010308,
ROWAN LAKE AREA
KENORA MINING DIVISION

Prepared for

CALIBAN RESOURCES INC.
#708 - 543 Granville St.
Vancouver BC
V6C 1X8

by

M. S. Elson, B.Sc.

NORTHERN NATURAL RESOURCE SERVICES LTD.
#708 - 543 Granville St.
Vancouver BC
V6C 1X8

RECEIVED

DEC 01 1989

MINING LANDS SECTION

November 28, 1989

2.12951

INTRODUCTION

A geochemical survey, designed to add to existing geochemical data generated in 1988, was conducted in September 1989 on claims K1084914, K1084915 and K1010308 registered in the name of Caliban Resources Inc., in the Rowan Lake Area, Kenora Mining Division.

LOCATION AND ACCESS

The claims form part of a 27-claim group (Figure 1) located approximately 75 Km southeast of Kenora in northwestern Ontario. The claim group comprises twenty-seven contiguous mineral claims located on the north side of Isinglass Lake. An exploration history of the property prior to its acquisition by Caliban Resources Inc. is included in a report by D.W. Tully submitted to the Ministry in November 1988 by Caliban Resources Inc. as part of an application for assessment credit.

Access to the property is most easily achieved by float-equipped aircraft from Kenora (75 Km) or from the community of Nestor Falls (30 Km). Logging-road access is available to within approximately 3 Km to the north of the property, and water access is available via Cameron and Shingwak Lakes to the south.

REGIONAL AND LOCAL GEOLOGY

The oldest rock in the map area are metavolcanics of a mafic-felsic volcanic cycle of vulcanism. These rocks belong to the western part of the Wabigoon Subprovince. The volcanic cycle was initiated by a vast effusion of basaltic and andesitic lavas, both massive and pillowed. This portion of the volcanic pile is dominately mafic in

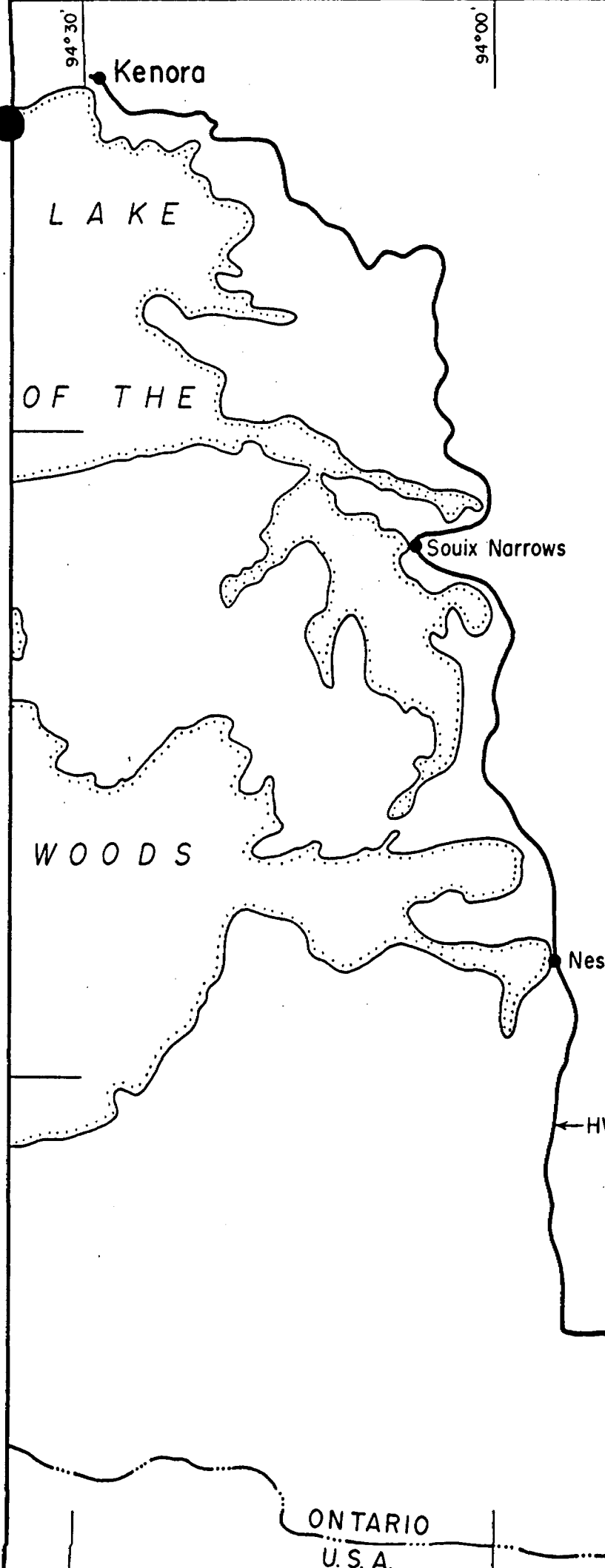

27-CLAIM GROUP

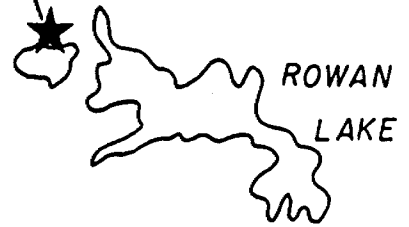

Donald W. Bully

FIGURE 1

AREA MAP

(AFTER G.S.C. MAP 266A)

SCALE 1" = 8 MILES

NOVEMBER 14, 1988

in composition with associated pyroclastic horizons. The mafic volcanics at Isinglass and Rowan Lakes are fine to medium-grained with extensive horizons of recrystallized basalt. Metamorphism in the Rowan Lake-Isinglass Lake area is of the middle to upper rank of greenschist facies.

Locally, a NNE-trending synclinal axis is shown traversing the west boundary area of the 27 mineral claim group and indicates the property occupies the east link of synclinal structure. Geologists studying the Nuinsco Cameron Lake Gold Deposit (approximately 5 Km to the south) have postulated an anticlinal axis trending ENE through Shingwak Lake, immediately south of Isinglass Lake. Massive and pillowed basaltic lavas outcrop in the west, northwest and east-northeast sectors of the claim group. A gabbro mass comprising several phases occupies the central portion of the property. The west contact of this gabbro mass and the host basalt trends northeasterly across the western and northern portion of the claims. Copper-nickel mineralization occurs in this contact zone where the maximum magnetic intensity appears in the large magnetic anomaly that extends over the general area beyond the property confines. The east contact of this gabbro mass also trends northeasterly across the claim area, from a point near the Roseman-Thompson Gold Showing on the north shore of Isinglass Lake to a granitic mass which occurs immediately northeast of the property at Rowan Lake. A small mass of gabbro occurs in the northwest corner of the claim area. A northwest-trending granitic intrusion has invaded the gabbro mass in the west central sector of the property in a direction more or less perpendicular to the west gabbro-basalt contact.

EXPLORATION HISTORY

Gold was discovered on the north shore of Isinglass Lake, probably around the turn of the century. The Property has been the subject of exploration by major mining interests at various times since 1900. Noranda (1952), Dome (1955), Selco (1956) and Canadian Nickel (1970-71) explored the property for its base metal potential; Sylvanite Gold Mines (1943) examined the Roseman-Thompson Gold Showing. In 1988, a program of geochemical soil sampling, VLF-EM and magnetometer surveying, hand-trenching, rock-sampling and limited geological mapping was carried out by a five man exploration crew under the direction of B.J. Price, M.Sc., F.G.A.C. and D.W. Tully. This program resulted in the examination of two gold and two base metal occurrences and suggested additional mineral potential.

METHODS, 1989 PROGRAM

The geochemical survey was conducted in the period September 18-28, 1989, by M.S.Elson, B.Sc. and J.D. Pugh, M.Sc., of Vancouver BC employees of Northern Natural Resources Services Ltd. The objectives of the survey were to follow the recommendations of D.W. Tully, P.Eng., in his report of November 1988 to accumulate additional geochemical information in some areas identified in 1988 as anomolous in gold and copper.

Grid control was established by chain and compass. A total of 1.5 Km of line was cut on the subject claims, consisting of extension of the existing grid baseline to the west, and establishment of control lines

to the south of the baseline and extending to Isinglass Lake. A total of 57 soil samples were collected from the "B" soil horizon at 25-meter intervals established on the control lines (Lines 0W, 1W, 2W, 8+50 E, 9+50 E on Figure 2). Soil samples were collected on claims K1084914, K1084915 and K1010308. The presence of rock outcrop or muskeg prevented soil-sampling at some locations. The samples were stored in Kraft soil sample bags and analyzed by the ICP method (Cu) and by acid leach (Au) at Acme Analytical Laboratories, Vancouver BC.

RESULTS, 1989 PROGRAM

The results of analysis are tabulated in the appendix to this report, plotted on Figure 2, and highlighted in yellow to easily distinguish them from results obtained in 1988.

The results of analysis provide only two indications of additional anomaly. Copper values in Line 1W between 6+75 S and 7+25 S extend a copper anomaly to the west from L0. On line 8+50 E, 6+25 S, a soil sample near the lake shore returned values of 368 ppm Cu and 148 ppb Au. These values are in the upper range of results obtained in 1988 for both elements, and warrant further investigation of the location.

APPENDIX

1. Costs of Analysis
2. Geochemical Analysis Certificate.

ACME ANALYTICAL LABORATORIES LTD.

PHONE: 253-3158

852 East Hastings St., Vancouver, B.C. V6A 1R6

File: 89-4419

Date: Oct 30 1989

[AQUILINE RESOURCES INC.
 708 - 543 GRANVILLE ST.
 VANCOUVER, BC
 V6C 1X8]

TERMS:
 NET TWO WEEKS -
 1 1/2% PER MONTH CHARGED ON
 OVERDUE ACCOUNTS.

NUMBER	ASSAY	PRICE	AMOUNT
57	GEOCHEM CU ANALYSIS BY ICP @	2.25	128.25
57	GEOCHEM AU ANALYSIS BY ACID LEACH (10 GM) @	4.50	256.50
57	SOIL SAMPLE PREPARATION @	0.85	48.45
	TOTAL		433.20
	SAMPLES SUBMITTED BY M. ELSON		✓

PLEASE PAY LAST AMOUNT

ACME ANALYTICAL LABORATORIES LTD.
852 E. HASTINGS ST. VANCOUVER B.C. V6A 1R6
PHONE(604)253-3158 FAX(604)253-1716

DATE RECEIVED: OCT 23 1989

C. it. 30./89.

DATE REPORT MAILED:

GEOCHEMICAL ANALYSIS CERTIFICATE

P - .500 GRAM SAMPLE IS DIGESTED WITH 3ML 3-1-2 HCL-HNO3-H2O AT 95 DEG. C FOR ONE HOUR AND IS DILUTED TO 10 ML WITH WATER.
THIS LEACH IS PARTIAL FOR MN FE SR CA P LA CR MG BA TI B W AND LIMITED FOR NA K AND AL. AU DETECTION LIMIT BY ICP IS 3 PPM.
- SAMPLE TYPE: Soil -80 Mesh AU* ANALYSIS BY ACID LEACH/AA FROM 10 GM SAMPLE.

SIGNED BY *C. Leong* D. TOYE, C. LEONG, J. WANG; CERTIFIED B.C. ASSAYERS

Aquiline Resources Inc. FILE # 89-4419 Page 1

SAMPLE#	Cu PPM	Au* PPB
L2W 4+25S	37	6
L2W 4+50S	38	4
L2W 4+75S	35	11
L2W 5+00S	40	2
L2W 5+25S	61	5
L2W 5+50S	33	1
L2W 5+75S	65	4
L2W 6+00S	40	1
L2W 6+25S	32	1
L2W 6+50S	19	1
L2W 6+75S	21	1
L2W 7+00S	29	8
L2W 7+25S	28	2
L2W 7+50S	67	4
L2W 7+75S	16	1
L2W 8+00S	10	3
L2W 8+25S	41	1
L2W 8+50S	41	1
L2W 8+75S	25	2
L2W 9+00S	61	1
L2W 9+25S	21	2
L1W 5+50S	26	2
L1W 5+75S	10	1
L1W 6+00S	40	1
L1W 6+25S	25	3
L1W 6+50S	16	2
L1W 6+75S	59	3
L1W 7+00S	20	1
L1W 7+25S	167	1
L1W 8+25S	17	1
L1W 8+50S	11	2
L1W 8+75S	12	1
L1W 9+00S	20	1
LO 8+00S	14	1
LO 8+25S	31	1
LO 8+50S	172	2
STD C/AU-S	57	52

SAMPLE#	Cu PPM	Au* PPB
L0 8+75S	35	5
L0 8+90S	38	7
L8+50E 4+00S	48	4
L8+50E 4+25S	39	4
L8+50E 4+50S	32	5
L8+50E 4+75S	25	4
L8+50E 5+00S	9	4
L8+50E 5+25S	12	1
L8+50E 5+50S	23	4
L8+50E 5+75S	69	5
L8+50E 6+00S	65	27
L8+50E 6+25S	368	148
L9+50E 4+00S	14	9
L9+50E 4+25S	9	3
L9+50E 4+50S	14	3
L9+50E 4+75S	13	5
L9+50E 5+00S	14	3
L9+50E 5+25S	20	4
L9+50E 5+50S	22	3
L9+50E 5+75S	52	9
L9+50E 6+00S	6	3
STD C/AU-S	61	51

APPENDIX 1

NORTHERN NATURAL RESOURCE SERVICES LTD.

PROFILE OF COMPANY PERSONNEL

NAME: Michael Scott Elson

POSITION: President
Northern Natural Resources Services, Ltd.
#411 - 850 West Hastings Street
Vancouver, B.C. V6C 1E1

EDUCATION: B.Sc., Zoology
University of Alberta, 1967

PUBLICATIONS: See attached.

PROFESSIONAL EXPERIENCE:

1958 - 1960 Field studies of the commercial fishery conducted on Great Slave Lake, N.W.T. Employed by Fisheries Research Board of Canada.

1960 - 1962 Field studies at Pitt Lake, Chilko Lake, Nadina River and Stellako River of spawning Pacific salmon. Employed by International Pacific Salmon Fisheries Commission.

1967 - 1971 Engaged in all aspects of mineral exploration with Stokes Exploration Management, Vancouver, B.C.

1971 - 1975 Department of the Environment, Fisheries Service:

- 1) Pipeline studies in the northern Yukon Territory for the Mackenzie Valley Pipeline Inquiry.
- 2) Collection of fisheries data for inclusion in Arctic Land Use maps for the entire Yukon Territory.
- 3) Operation of a fence for enumeration of chum salmon in Arctic waters 1972-1974.
- 4) Operation of a counting fence under contract to Department of the Environment in 1975.

1975 - 1987

Northern Natural Resource Services Ltd.:

- 1) Impact assessments of placer mining in the northern Yukon Territory.
- 2) Fish compensation studies relative to the Revelstoke 1880 Hydroelectric Dam on the Upper Columbia River.
- 3) Preparatory material for final arguments on the Mackenzie Valley Pipeline (Berger Inquiry).
- 4) Department of the Environment, Fisheries and Marine Service (Report Preparations):
 - assessments of salmon populations in the northern Yukon Territory -
 - a) Dawson City commercial fishery;
 - b) Klukshu River salmon enumeration;
 - c) resident fishes in the interior pipeline corridor of the northern Yukon Territory.
- 5) Review of material relative to the proposed Kemano II Hydroelectric Development in northern British Columbia.
- 6) Collection of fisheries information from waterbodies along proposed gas pipeline routes in Yukon Territory.
- 7) Preparation of a report on marine tag-recovery data collected along the British Columbia coast.
- 8) Preparation of reports for S.E.P.

Involved in the commercial fishery conducted on the Taku River since 1979; operation of a registered trap-line in northern British Columbia, preparation of an environmental impact assessment for Queenstake Resources Ltd.

APPENDIX II

LIST OF PUBLICATIONS

1. Bryan, J.E., C.E. Walker, R.E. Kendel and M.S. Elson, 1973. Freshwater aquatic ecology in northern Yukon Territory, 1971. Environmental-Social Committee Northern Pipelines, Task Force on Northern Oil Development. Report No. 73-21. Information Canada Catalogue No. R57-3/1973.
2. Elson, M.S., 1976. Enumeration of the 1975 chum salmon spawning population in the Fishing Branch River. Submitted by Northern Natural Resource Services Ltd., to Department of the Environment, Fisheries Service, Vancouver, B.C. Report No. PAC/T-76-1.
3. Elson, M.S., 1975. Enumeration of spawning chum salmon (*Oncorhynchus keta*) in the Fishing Branch River in 1971, 1972, 1973 and 1974. In: Steigenberger, L.W., M.S. Elson and R.T. DeLury, 1975. Northern Yukon Fisheries Studies, 1971 - 1974. Volume 1. Department of the Environment, Northern Operations Branch, Fisheries and Marine Service. Report No. PAC/T-75-19. Chapter II.
4. Elson, M.S., 1974. Catalogue of fish and stream resources of East Central Yukon Territory. Department of the Environment, Fisheries Service, Vancouver, B.C. Report No. PAC/T 74-4.
5. Elson, M.S., MS 1973. Enumeration of chum salmon in the Fishing Branch River. Department of the Environment, Fisheries Service, Vancouver, B.C.
6. Elson, M.S., MS 1973. Fishing Branch Studies - 1973. Department of the Environment, Fisheries Service, Vancouver, B.C.
7. Elson, M.S., MS 1973. Historical exploitation of Yukon fish stocks. Department of the Environment, Fisheries Service, Vancouver, B.C.
8. Steigenberger, L.W. and P.A. Larkin, 1974. Feeding activity and rates of digestion of northern squawfish (*Ptychocheilus oregonensis*). J. Fish. Res. Bd. Can. 31:411-420.
9. Steigenberger, L.W., G.J. Birch, P.G. Bruce and R.A. Robertson, 1974. Northern Yukon Freshwater Fisheries Studies, 1973. Environmental-Social Committee, Northern Pipelines, Task Force on Northern Oil Development. Report No. 74-20.

10. Steigenberger, L.W., R.A. Robertson, K. Johansen and M.S. Elson, 1975. Biological/Engineering Evaluation of the proposed pipeline crossing sites in Northern Yukon Territory. Department of the Environment, Fisheries and Marine Service, Vancouver, B.C. Report No. PAC/T-75-11.
11. Steigenberger, L.W., M.S. Elson and R.T. DeLury, 1975. Northern Yukon Fisheries Studies, 1971 - 1974. Volume 1. Department of the Environment, Fisheries and Marine Service, Vancouver, B.C. Report No. PAC/T-75-19.
- Chapter I
 - (a) Preliminary information on the winter classification of the rivers in the northern Yukon, their physical and chemical characteristics and the fish statistics of the various water bodies examined during the first Yukon pipeline winter survey, March, 1972.
 - (b) Additional aerial survey information of some of the rivers in the northern Yukon, April, 1973.
 - Chapter II
 - Enumeration of spawning chum salmon (*Oncorhynchus keta*) in the Fishing Branch River in 1971, 1972, 1973 and 1974.
 - Chapter III
 - Assessment of chinook salmon (*Oncorhynchus tshawytscha*) stocks in the upper Porcupine River drainage in the northern Yukon Territory.
 - Chapter IV
 - A preliminary study of fish species other than salmon found in the Fishing Branch River, Yukon Territory, in September, 1973.
 - Chapter V
 - Aspects of the historical and present day fisheries exploitation in the northern Yukon Territory.
 - Chapter VI
 - Groundwater contribution to rivers of the Porcupine drainage basin, Yukon Territory.
12. Steigenberger, L.W., M.S. Elson, P.G. Bruce and Y.E. Yole, 1975. Northern Yukon Fisheries Studies, 1971 - 1974. Volume 2. Department of the Environment, Fisheries and Marine Service, Vancouver, B.C. Report No. PAC/T-75-23.

- Chapter I

A preliminary bibliography and summaries of spawning information for fish species present in freshwaters of northern Yukon Territory.

- Chapter II

Fisheries investigations of the Porcupine River drainage in the vicinity of Old Crow in the northern Yukon Territory, October, 1972.

- Chapter III

Fisheries investigations of the Porcupine River drainage in the vicinity of Old Crow in the northern Yukon Territory, April, 1973.

- Chapter IV

A preliminary report of freshwater invertebrates in the northern Yukon Territory, summer 1973 and winter 1974.

- Chapter V

Methods of aging fish species common to rivers and lakes of the northern Yukon Territory, 1972 - 1974.

13. Walker, C.E. and L.W. Steigenberger, 1975. Mackenzie Valley Pipeline Inquiry. Impact on the living environment. FISH. (Yukon Territory). In the matter of the applications by each of:

(a) Canadian Arctic Gas Pipeline Limited for a right-of-way that might be granted across crown lands within the Yukon Territory and the Northwest Territories, and

(b) Foothills Pipelines Ltd. for a right-of-way that might be granted across crown lands within the Northwest Territories

for the purpose of a proposed Mackenzie Valley Pipeline, and, in the matter of the social, environmental and economic impact regionally of the construction, operation and subsequent abandonment of the above proposed pipeline. (Before the Honourable Mr. Justice Berger, Commissioner.) In Yellowknife, Northwest Territories, December, 1975. Volumes 103-105.

14. Elson, M.S. and L.W. Steigenberger, April to November, 1976.

- Northern Natural Resource Services Ltd., 1976. An Environmental Assessment of the Sixty Mile River in Winter, April, 1976. 3535 East 45th Avenue, Vancouver, B.C., V5R 3G2. Submitted to Cogasa Mining Corporation, Vancouver, B.C.
- Northern Natural Resource Services Ltd., 1976. An Environmental Assessment of the Sixty Mile River in Summer, August, 1976. 3535 East 45th Avenue, Vancouver, B.C., V5R 3G2. Submitted to Cogasa Mining Corporation, Vancouver, B.C.
- Northern Natural Resources Services Ltd., 1976. A Biological Investigation related to Placer Mining Operations in the Moosehorn Range in Yukon Territory. September, 1976. 3535 East 45th Avenue, Vancouver, B.C. V5R 3G2. Submitted to Claymore Resources Ltd., Edmonton, Alberta.
- Northern Natural Resource Services Ltd., 1976. Additional Environmental Information of the Sixty Mile River in Summer, November, 1976. 3535 East 45th Avenue, Vancouver, B.C., V5R 3G2. Submitted to Cogasa Mining Corporation, Vancouver, B.C.

15. Steigenberger, L.W. and M.S. Elson, (September), 1976. In the matter of the Water Act and in the matter of an application for a water licence to divert, use and store, water out of the Columbia River at a point about three miles upstream from Revelstoke, B.C., near the lower end of the Little Dalles Canyon, and in the matter of certain objections to the said application. Volumes 11 and 12. September 21 and 22, 1976. Revelstoke, B.C.

16. Elson, M.S. and L.W. Steigenberger, October, 1976. Stream surveys and fish compensation studies to the Upper Arrow Lakes Reservoir (Revelstoke 1880 Project). Submitted by Northern Natural Resource Services Ltd. to the British Columbia Hydro and Power Authority, Vancouver, B.C.

17. Steigenberger, L.W. and M.S. Elson, September, 1976. Site specific and general recommendations relative to proposed pipeline crossings in the Northern Yukon Territory. Preparatory material for the Berger Inquiry. Submitted by Northern Natural Resource Services Ltd. to Hatfield Consulting Ltd., North Vancouver, B.C.

- Elson, M.S. and L.W. Steigenberger, March 1977. Enumeration of the 1976 salmon spawning populations in the Klukshu River, Yukon Territory. Northern Natural Resource Services Ltd. and the staff of the Fisheries and Marine Service, Northern B.C. and Yukon Branch, Whitehorse, Yukon Territory. Submitted to the Department of the Environment, Fisheries and Marine Service, Vancouver, B.C. (Memorandum Report.)
19. Elson, M.S. and L.W. Steigenberger, March, 1977. Measurements of chinook salmon collected in the Yukon River commercial fishery near Dawson City in 1975 and 1976. Submitted by Northern Natural Resource Services Ltd. to the Department of the Environment, Fisheries and Marine Service, Vancouver, B.C. (Memorandum Report.)
 20. Steigenberger, L.W. and M.S. Elson, March, 1977. Northern Yukon Fisheries Studies, 1972 - 1974. Volume 3. Department of the Environment, Fisheries and Marine Service, Northern B.C. and Yukon Branch, Vancouver, B.C. Report No. PAC/T-77-4.
 21. Elson, M.S. and L.W. Steigenberger, 1977. Technical review of the proposed Kemano II hydro development. A review of information prepared by the Department of the Environment, Fisheries & Marine Service, Vancouver, B.C. Submitted to Northern Natural Resource Services Ltd. to the British Columbia Hydro and Power Authority, Vancouver, B.C.
 22. Elson, M.S., E. Johnson, and L.W. Steigenberger, (July), 1977. Collection of fisheries information from water bodies along the proposed Alaska Highway Gas Pipeline Route (to July 15, 1977). Submitted by Northern Natural Resource Services Ltd. to the Department of the Environment, Fisheries & Marine Service, Vancouver, B.C.
 23. Elson, M.S., E. Johnson, and L.W. Steigenberger, (September), 1977. A collection of fisheries information from water bodies associated with pipeline routes in the Yukon Territory from Dawson to Watson Lake (to September 1, 1977). Submitted by Northern Natural Resource Services Ltd. to the Department of the Environment, Fisheries & Marine Service, Vancouver, B.C.
 24. Elson, M.S. and L.W. Steigenberger, (April), 1978. Collection of data from marine tag-recovery programs conducted from 1925-1977 in British Columbia coastal waters. Submitted by Northern Natural Resource Services Ltd. to the Department of the Environment, Salmon Enhancement Program, Project No. 340. Vancouver, B.C. Vol. 1: Sockeye Salmon; Vol. 2: Pink Salmon; Vol. 3: Chum Salmon; Vol. 4: Coho Salmon; Vol. 5: Chinook Salmon.

25. Northern Natural Resource Services Ltd. (October), 1978.
A compilation of fisheries data from waterbodies adjacent to the Alaska Highway from kilometer 1008 to kilometer 1635. Department of Fisheries and Environment, Fisheries and Marine Service, Vancouver, B.C.
26. Northern Natural Resource Services Ltd. (January), 1979.
Stikine-Iskut aquatic ecological studies, 1978.
Downstream sections. British Columbia Hydro and Power Authority, Vancouver, B.C. (Draft Report)
27. Northern Natural Resources Services Ltd. (April), 1979.
Preparation of information for inclusion in the Department of Fisheries and Oceans submissions to the Alaska Highway Gas Pipeline Hearings (April 23 - 28, 1979) (Appendix I and II) Department of Fisheries and Oceans, Vancouver, B.C.
28. Northern Natural Resource Services Ltd. (October) 1979.
Enumeration of Pacific Salmon Fry in Mathers Creek, Queen Charlotte Islands, in 1979. Department of Fisheries and Oceans, Vancouver, B.C.
29. Steigenberger, L.W. (February) 1981.
General and site specific observations and recommendations relative to mitigation and compensation proposals to Peace River Site C Hydroelectric Development. B.C. Hydro and Power Authority, Vancouver, B.C.
30. Steigenberger, L.W. and M.S. Elson (June) 1982.
A treatment of fisheries information collected from Clear Creek, Yukon Territory, in relation to "Government Placer Mining Guidelines". Queenstake Resources Ltd., Vancouver, B.C.
31. Elson, M.S. 1985. A review of the Pitt River Watershed.
Internal Report prepared for Dept. of Fisheries and Oceans, Vancouver, B.C.
32. Elson, M.S. 1985. Distribution and abundance of salmon spawning in the Tatshenshini River system. MS in preparation for Dept. of Fisheries and Oceans, New Westminster, B.C.
33. Elson, M.S., J.D. Pugh and M. Graves 1986.
A Review of International Pacific Salmon Fisheries Commission Bioreconnaissance Data, with reference to proposed Fraser River system sockeye and pink salmon enhancement projects. Prepared by Northern Natural Resource Services Ltd. for Salmonid Enhancement Program, 1090 W. Pender Street, Vancouver, B.C.

March 1. 1990

Vancouver, B.C.

Ministry of Northern Development & Mines,
Mining Lands Section,
3rd Floor, 880 Bay Street,
Toronto, Ontario

Sirs,

I have known Mr. M.S. Elson for 10 years and have worked with him on various mining exploration projects in northern British Columbia and in the Yukon Territory. His personal conduct and diligence in performing the required tasks has always been exemplary.

Yours truly,

G Macdonald, P. Geol

Glen Macdonald
B.Sc. Geology
207 Clearview Drive,
Port Moody, B.C.



AURUM GEOLOGICAL CONSULTANTS INC.

2 March, 1990

Mining Lands Section
3rd Floor, 880 Bay Street
Toronto, Ontario

Re: Assessment report for Caliban Resources Inc.

Dear Sir/Madam;

I have reviewed an assessment report entitled "Geochemical Survey of Claims K1084914, K1084915 and K1010308, Rowan Lake Area, Kenora Mining Division" by M.S. Elson dated November 28, 1989.

Having known Mr. Elson since 1985, I can state that he has worked in mineral exploration intermittently since the late 1960's. He has sufficient experience to perform the work described in the report. I feel that the data are accurate to the limits of the methods employed, and recommend that the report be accepted by your office for full assessment credits.

Sincerely,
Aurum Geological Consultants Inc.

Harmen J. Keyser, B.Sc., FGAC



INDIVIDUAL TIME SHEET

NAME AQUA WINE RES.

WEEK ENDING 27 Nov 89

	JOB	KIND OF WORK	HRS.
FRI.		<i>Draft correction to Map</i>	
SAT.			
MON.			
TUES.			
WED.		<i>1 1/2 hrs.</i>	
THURS.		<i>papers to G. Toop</i>	

PAYMENT RECEIVED	TOTAL HRS.
------------------	------------

DEDUCTIONS	INCOME TAX		
	UNEMPLOYMENT INS.		

PAYMENTS	<i>1 1/2</i> HRS @		
	EX. HRS @		
	TOTAL		
	LESS DEDUCTIONS		

0224

TOTAL

AMOUNT RECEIVED *\$ 20⁰⁰*



Ministry of
Northern Development
and Mines

Lands
W8901-227

Report of Work
(Geophysical, Geological,
Geochemical and Expenditures)

DC
W
Mi



52F05SE0503 2.12951 ROWAN LAKE

900

Type of Survey(s) GEOCHEMICAL 2.12951		Township or Area ROWAN LAKE AREA G.2639
Claim Holder(s) CALIBAN RESOURCES INC.		Prospector's Licence No. T 5261
Address 708 - 543 GRANVILLE ST. VANCOUVER B.C.		
Survey Company NORTHERN NATURAL RESOURCE SERVICES LTD.	Date of Survey (from & to) 12 9 89 28 9 89	Total Miles of line Cut 1.5
Name and Address of Author (of Geo-Technical report)		

Credits Requested per Each Claim in Columns at right

Special Provisions	Geophysical	Days per Claim
For first survey: Enter 40 days. (This includes line cutting)	- Electromagnetic	
	- Magnetometer	
For each additional survey: using the same grid: Enter 20 days (for each)	- Radiometric	
	- Other	
	Geological	
	Geochemical	
Man Days Complete reverse side and enter total(s) here	Geophysical	Days per Claim
	- Electromagnetic	
	- Magnetometer	
	- Radiometric	
	- Other	
	Geological	
	Geochemical	10
Airborne Credits Note: Special provisions credits do not apply to Airborne Surveys.	Electromagnetic	Days per Claim
	Magnetometer	
	Radiometric	

Mining Claims Traversed (List in numerical sequence)

Prefix	Mining Claim Number	Expend. Days Cr.	Prefix	Mining Claim Number	Expend. Days Cr.
K	1084914	20			
	1084915	20			
	1010308	10			

RECEIVED
1 1989
MINING LANDS SECTION

Expenditures (excludes power stripping)

Type of Work Performed

Performed on Claim(s)

Calculation of Expenditure Days Credits

Total Expenditures + 15 = Total Days Credits

\$ [] + 15 = []

Instructions
Total Days Credits may be apportioned at the claim holder's choice. Enter number of days credits per claim selected in columns at right.

Date **Oct 3 1989** Recorded Holder or Agent (Signature) **Mike Elson**

1010302 Total number of mining claims covered by this report of work. **3**

For Office Use Only

Total Days Cr. Recorded **30** Date Recorded **Oct 3/89** Mining Recorder **Scott Rivett**

Date Approved as Recorded **REPLACED BY Document No W9001.44** Branch Director

Certification Verifying Report of Work

I hereby certify that I have a personal and intimate knowledge of the facts set forth in the Report of Work annexed hereto, having performed the work or witnessed same during and/or after its completion and the annexed report is true.

Name and Postal Address of Person Certifying
MIKE ELSON # 708 - 543 GRANVILLE ST. VANCOUVER B.C.

Date Certified **Oct 3 1989** Certified by (Signature) **Mike Elson**

1010302 RECEIVED
1 1989
MINING LANDS SECTION

Assessment Work Breakdown

Man Days are based on eight (8) hour Technical or Line-cutting days. Technical days include work performed by consultants, draftsmen, etc..

Type of Survey <i>GEOCHEMICAL</i>							
Technical Days		Technical Days Credits		Line-cutting Days	Total Credits	No. of Claims	Days per Claim
4	X	7	=	28	+	2	=
				30	+	3	=
						10	

Type of Survey							
Technical Days		Technical Days Credits		Line-cutting Days	Total Credits	No. of Claims	Days per Claim
[]	X	7	=	[]	+	[]	=
				[]	+	[]	=
						[]	

Type of Survey							
Technical Days		Technical Days Credits		Line-cutting Days	Total Credits	No. of Claims	Days per Claim
[]	X	7	=	[]	+	[]	=
				[]	+	[]	=
						[]	

Type of Survey							
Technical Days		Technical Days Credits		Line-cutting Days	Total Credits	No. of Claims	Days per Claim
[]	X	7	=	[]	+	[]	=
				[]	+	[]	=
						[]	

M.K.
2.12951
Report of Work
(Geophysical, Geological and Geochemical Surveys)

AMENDED
DOCUMENT No.
W9001.44

Instructions
- Please type or print.
- Refer to Section 77, the Mining Act for assessment work requirements and maximum credits allowed per survey type.
- If number of mining claims traversed exceeds space on this form, attach a list.
- Technical Reports and maps in duplicate should be submitted to Mining Lands Section, Mineral Development and Lands Branch:

Contacted
May 15

April 15

Type of Survey(s) GEOCHEMICAL	Mining Division KENORA	Township or Area G.2639 ROWAN LAKE AREA
Recorded Holder(s) CALIBAN RESOURCES INC.	Prospector's Licence No. T5261	
Address # 708 - 543 GRANVILLE ST. VANCOUVER B.C.		Telephone No. 604 687 7733
Survey Company NORTHERN NATURAL RESOURCE SERVICES LTD.		
Name and Address of Author (of Geo-Technical Report) M.S. ELSON, 708-543 GRANVILLE ST. VANCOUVER B.C.		Date of Survey (from & to) 12 9 89 Day Mo. Yr. 28 9 89 Day Mo. Yr.

Credits Requested per Each Claim in Columns at right		
Special Provisions	Geophysical	Days per Claim
For first survey: Enter 40 days. (This includes line cutting)	- Electromagnetic - Magnetometer	
For each additional survey using the same grid: Enter 20 days (for each)	- Other Geological Geochemical	
Man Days	Geophysical	Days per Claim
Complete reverse side and enter total(s) here	- Electromagnetic - Magnetometer - Other (DRAFTING)	2
	Geological Geochemical	10
Airborne Credits	Geophysical	Days per Claim
Note: Special provisions credits do not apply to Airborne Surveys.	Electromagnetic Magnetometer Other	
Total miles flown over claim(s).		
Date DEC 11 89	Recorded Holder or Agent (Signature) <i>M.S. Elson</i>	

Mining Claims Traversed (List in numerical sequence)					
Mining Claim		Mining Claim		Mining Claim	
Prefix	Number	Prefix	Number	Prefix	Number
K	1084914				
K	1084915				
K	1010308				
RECEIVED					
MAR 21 1990					
MINING LANDS SECTION					
Total number of mining claims covered by this report of work.					3

Certification Verifying Report of Work

I hereby certify that I have a personal and intimate knowledge of the facts set forth in this Report of Work, having performed the work or witnessed same during and/or after its completion and annexed report is true.

Name and Address of Person Certifying
M.S. ELSON, # 708-543 GRANVILLE ST. VANCOUVER B.C. V6C 1K8

ONTARIO Telephone No. 604 687 7733
ASST. REGISTRAR
OFFICE

Date
DEC 11 '89

Certified By (Signature)
M.S. Elson

For Office Use Only

MAY 2 1990

Total Days Cr. Recorded 36	Date Recorded March 16/90	Mining Recorder <i>M.S. Elson acting</i>
	Date Approved as Recorded 27 April 90	Provincial Manager, Mining Lands <i>W. Plowman</i>

RECEIVED

Received Stamp

KENORA MINING DIV.

RECEIVED

DEC 21 1989

AM 8:56
789101112123456

KENORA MINING DIV.

RECEIVED

MAR 16 1990

AM 7:39
789101112123456

1010302

Assessment Work Breakdown

Man Days are based on eight (8) hour Technical or Line-cutting days. Technical days include work performed by consultants, draftsmen, etc..

Type of Survey GEOCHEMICAL												
Technical Days	X	7	=	Technical Days Credits	+	Line-cutting Days	=	Total Credits	+	No. of Claims	=	Days per Claim
<input style="width: 40px;" type="text" value="4"/>				<input style="width: 40px;" type="text" value="28"/>		<input style="width: 40px;" type="text" value="2"/>		<input style="width: 40px;" type="text" value="30"/>		<input style="width: 40px;" type="text" value="3"/>		<input style="width: 40px;" type="text" value="10"/>

Type of Survey DRAFTING												
Technical Days	X	7	=	Technical Days Credits	+	Line-cutting Days	=	Total Credits	+	No. of Claims	=	Days per Claim
<input style="width: 40px;" type="text" value="1"/>				<input style="width: 40px;" type="text" value="7"/>		<input style="width: 40px;" type="text"/>		<input style="width: 40px;" type="text" value="7"/>		<input style="width: 40px;" type="text" value="3"/>		<input style="width: 40px;" type="text" value="2"/>

Type of Survey												
Technical Days	X	7	=	Technical Days Credits	+	Line-cutting Days	=	Total Credits	+	No. of Claims	=	Days per Claim
<input style="width: 40px;" type="text"/>				<input style="width: 40px;" type="text"/>		<input style="width: 40px;" type="text"/>		<input style="width: 40px;" type="text"/>		<input style="width: 40px;" type="text"/>		<input style="width: 40px;" type="text"/>

Type of Survey												
Technical Days	X	7	=	Technical Days Credits	+	Line-cutting Days	=	Total Credits	+	No. of Claims	=	Days per Claim
<input style="width: 40px;" type="text"/>				<input style="width: 40px;" type="text"/>		<input style="width: 40px;" type="text"/>		<input style="width: 40px;" type="text"/>		<input style="width: 40px;" type="text"/>		<input style="width: 40px;" type="text"/>



Ministry of Northern Development and Mines

Ontario

2.12951

DOCUMENT NO. W9001.45

Instructions

- Please type or print.
- Refer to Subsection 77(19), the Mining Act for assessment work requirements and maximum credits allowed under this Subsection.
- Technical Reports, maps and proof of expenditures in duplicate should be submitted to Mining Lands Section, Mineral Development and Lands Branch.

Report of Work (Expenditures, Subsection 77(19))

Type of Work Performed ASSAYING OF SOIL SAMPLES	Mining Division KENORA	Township or Area G.2639 ROWAN LAKE AREA
Recorded Holder CALLERAN RESOURCES INC.	Prospector's Licence No.	
Address 708-543 GRANVILLE ST. VANCOUVER B.C.		Telephone No. 604 687 7733
Work Performed By NORTHERN NATURAL RESOURCE SERVICES LTD.		
Name and Address of Author (of Submission)		Date When Work was Performed From: 18 9 89 To: 28 9 89 Day Mo. Yr. Day Mo. Yr.

All the work was performed on Mining Claim(s): Indicate no. of days performed on each claim. *See Note No. 1 on reverse side									
Mining Claim	No. of Days	Mining Claim	No. of Days	Mining Claim	No. of Days	Mining Claim	No. of Days	Mining Claim	No. of Days
Mining Claim	No. of Days	Mining Claim	No. of Days	Mining Claim	No. of Days	Mining Claim	No. of Days	Mining Claim	No. of Days
Mining Claim	No. of Days	Mining Claim	No. of Days	Mining Claim	No. of Days	Mining Claim	No. of Days	Mining Claim	No. of Days

Instructions Total days credits may be distributed at claim holder's choice. Enter number of days credits per claim in the expenditure days credit column (below).	Calculation of Expenditure Days Credits Total Expenditures \$ 433.20 + 15 = 28.9	Total Days Credits 28.9	Total Number of Mining Claims Covered by this Report of Work 3
--	--	-----------------------------------	--

Mining Claims (List in numerical sequence). If space is insufficient, attach schedules with required information

Prefix	Number	Expend. Days Cr.	Prefix	Number	Expend. Days Cr.	Prefix	Number	Expend. Days Cr.	Prefix	Number	Expend. Days Cr.
K	1084914	9.6									
K	1084915	9.6									
K	1010308	9.6									
RECEIVED MAR 21 1990 MINING LANDS SECTION											

Total Number of Days Performed 28.9	Total Number of Days Claimed 28.9	Total Number of Days to be Claimed at a Future Date
---	---	---

Certification of Beneficial Interest *See Note No. 2 on reverse side

I hereby certify that, at the time the work was performed, the claims covered in this report of work were recorded in the current recorded holder's name or held under a beneficial interest by the current recorded holder.	Date Dec 11 89	Recorded Holder or Agent (Signature) <i>M. S. Elson</i>
--	--------------------------	--

Certification Verifying Report of Work

I hereby certify that I have a personal and intimate knowledge of the facts set forth in the Report of Work annexed hereto, having performed the work or witnessed same during and/or after its completion and the annexed report is true.

Name and Address of Person Certifying M. S. ELSON #708-543 GRANVILLE ST. VANCOUVER B.C. V6C1X8	Telephone No. 604 687 7733	Date Dec 11 '89	Certified By (Signature) <i>M. S. Elson</i>
--	--------------------------------------	---------------------------	--

For Office Use Only

Total Days Cr. Recorded 28.8	Date Recorded March 16/90	Mining Recorder <i>McLemay/acting</i>
	Date Approved as Recorded April 27/90	Provincial Manager, Mining Lands <i>W. Elson</i>

Received Stamp: **KENORA MINING DIV. RECEIVED DEC 21 1989 AM 8:50 789101112123456**

Received Stamp: **KENORA MINING DIV. RECEIVED MAR 16 1990 789101112123456**

Handwritten: **1010302**

ATIKWA LAKE (GRAPNEL BAY)

LEGEND

- HIGHWAY AND ROUTE NO.
- OTHER ROAD
- TRAILS
- SURVEYED LINES
- TOWNSHIP BOUNDARIES ETC.
- LOCAL MINING CLAIM PARCELS ETC.
- UNSURVEYED LINES
- LOT LINE
- PARCEL BOUNDARY
- MINING CLAIMS
- RAILWAY AND RAILWAY
- UTILITY LINES
- N.R. PERMIT OR OTHER
- FLOODING OR FLOODING RIGHTS
- SUBDIVISION OR COMPOSITE PLAN
- PRESERVATION
- ORIGINAL OR OTHER
- MARSH OR WETLAND
- MINES
- TRAVERSE MINING

DISPOSITION OF CROWN LANDS

- | TYPE OF DOCUMENT | SYMBOL |
|--------------------------------|--------|
| PATENT SURFACE & MINING RIGHTS | |
| SURFACE RIGHTS ONLY | |
| MINING RIGHTS ONLY | |
| LEASE SURFACE & MINING RIGHTS | |
| SURFACE RIGHTS ONLY | |
| MINING RIGHTS ONLY | |
| LICENCE OF OCCUPATION | |
| ORDER-IN-COUNCIL | |
| RESERVATION | |
| CANCELLED | |
| SAND & GRAVEL | |
- NOTE: MINING RIGHTS IN PARCELS PATENTED PRIOR TO MAY 1, 1912, ARE IN ORIGINAL PATENTEE BY THE PUBLIC LANDS ACT, R.S.O. 1970, CHAP. 380, SEC. 63, SUBSEC. 1.

SCALE 1:63,000 = 40 CHAINS

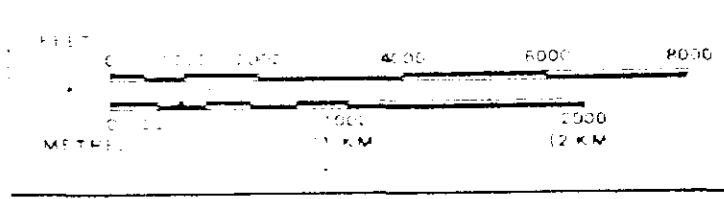

KENORA
REGISTERED
NOV 24 1989
LAWRENCE LAKE

AREA
ROWAN LAKE
M.N.R. ADMINISTRATIVE DISTRICT
KENORA / FORT FRANCES
MINING DIVISION
KENORA
LAND TITLES & REGISTRY DIVISION
KENORA

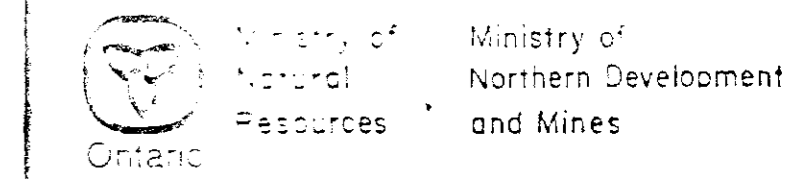

SYSTEM NO. 1000
G-2639

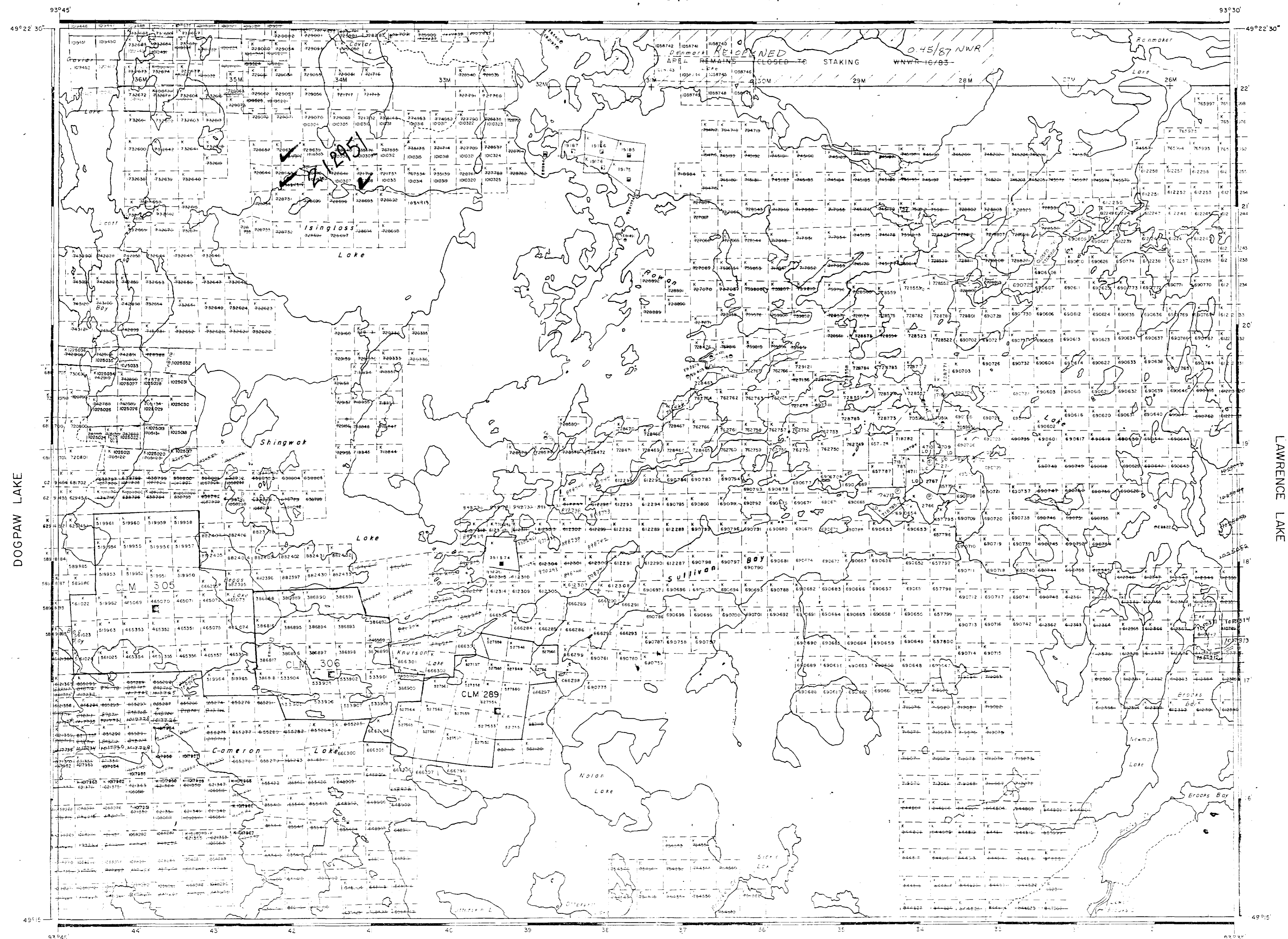

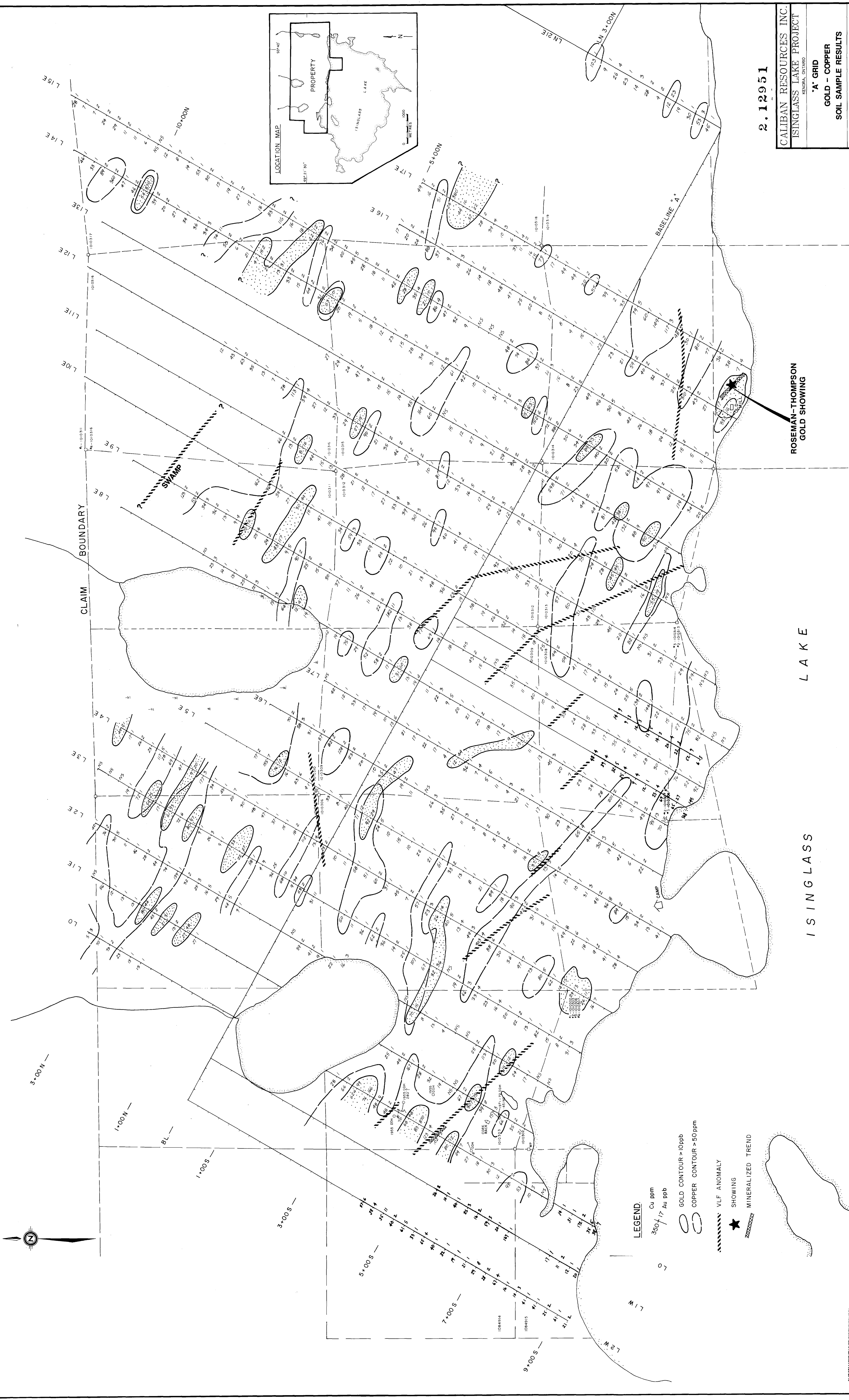

2.12951

CALIBAN RESOURCES INC.
 ISINGLASS LAKE PROJECT
 KENORA, ONTARIO

"A" GRID

GOLD - COPPER
SOIL SAMPLE RESULTS

SCALE 1:2500
 DATE: November 1999
 FIGURE No. 2
 PREPARED BY: P.M. MINERAL GRAPHICS LTD.

**ROSEMAN-THOMPSON
 GOLD SHOWING**

**ISINGLASS
 LAKE**

LEGEND:

Cu ppm
 350, 17 Au ppb

GOLD CONTOUR > 10ppb
 COPPER CONTOUR > 50ppm

VLF ANOMALY
 SHOWING
 MINERALIZED TREND

