



52F05SW0093 63.4152 DOGPAW LAKE

010

KAKAGI LAKE GOLD PROPERTIESISLAND GOLD PROPERTYKAKAGI LAKE, KENORA DISTRICT, ONTARIO. CLAIM MAPS M2473 - M.2475LOCATION

The property is a group of 39 contiguous unpatented mining claims $4\frac{1}{2}$ miles long East West. /Nos. K36040 - K36050 inc, K561449 to K561451 inc. K561483 to K561489 inc. K589552 to K589558 inc. K589489 to K589493 inc. K589937 to K589951 inc. The claims are 70% under water of Kakagi Lake.

Location is near the East end of Kakagi Lake, Kenora District, Ontario. 11 miles North East of Nestor Falls, 42 miles South East of Kenora, Ontario.

Access to the property is by boat from any of the tourist camps located on the South shore of Kakagi Lake. Distance from Lakeview Lodge or Hansen's camp is 9 miles.

GEOLOGY

The regional geology of the area is described by:

- (1) E. M. Burwash Geology of Kakagi Lake Area, Department of Mines, Volume 42 Part 4, Map B.1943.
- (2) Ontario Division of Mines Preliminary Map P-921 Crow Lake Area (Eastern Part) District of Kenora by L. Kaye 1974.
- (3) Ontario Geological Survey Report 194 Shistose Lake Area, C. R. Edwards 1980 Map 2421 and Map 2447.

The general area of Kakagi Lake is underlain by a complex assemblage of mafic to felsic metavolcanic and metadimentary rocks which are locally intruded by basic to intermediate sills.

All units are strongly affected by large scale East trending tight isoclinal folds which plunge North to North East. Shearing is prominent and faulting is widespread.

The gold discovery is a 20 ft. wide shear zone striking North 80° and dips North at $80 - 85^{\circ}$. The major rock type in the immediate area is dacite tuff. The shear itself consists of siliceous dacite tuff containing up to 20% sericite partings. Pyrite in the zone is from 5 to 20% averaging 10%. The zone is covered with 1 to 5 ft. of dirt, rust and humus.

PROPERTY

In August 1944 the discovery was made by Noranda Mines prospectors Roy A. Martin and Jack Kenty by panning the rust on the West end of an island in the Eastern part of Kakagi Lkae.

Trenching uncovered a 15 ft. wide East West striking gold bearing shear zone mineralized with pyrite.

Three (3) blasted rock trenches assayed No. 1- 0.30 Oz. gold across 11.5 ft. No. 2- 0.20 Oz. gold across 14.0 ft. and No. 3 - 0.20 Oz. gold across 12.0 ft.

No. 1 trench was checked in 1958 and assayed 0.31 Oz. gold across 11.0 ft. on strike.

The same or similar shear zone outcrops on Hay Island about one mile West on strike of the trenches. Gold could be panned in this zone but it was too intensely sheared to properly sample.

In September 1944, 16 Xray diamond drill holes on the showing returned assays half those obtained from the trenches. As only 50% of the core was recovered it is thought that the drilling did not give representative results.

At this time Noranda optioned the Wensley Wicks Lake Gold Property 6 miles to the North West. The crew was moved to this discovery and no further work was done on the Island Property. In 1946 Noranda transferred the claims to the prospectors.

From 1946 to 1973 the property was optioned to two (2) different mining companies who made cash down payments on the options but did no physical work on the property.

In 1973 some of the property was mapped by Ontario Department of Mines as part of a regional mapping program.

Samples taken from a rusty shist zone on Hay Island one miles West of the discovery trenches returned assays of 0.04 Oz. gold and 0.34 Oz. gold.

In March 1974 the property was optioned to a joint venture of Noranda Exploration Co., Newconex Exploration Co. and Tombill Mines.

Noranda Exploration were appointed the operating company. In July 1974 a Geological Report on the property was made by L. V. MacCormack.

In February 1945⁷ a Geophysical Survey was done by Noranda. This covered the area 2800 ft. East and 7600 ft. West of the discovery on 400 ft. centre lines running North South.

PROPERTY Con't

Magnetometer and VLF EM methods were used. The report says there were no conductors even tho the lines went over trenches on the mineralized shear zone which has an average of 10% pyrite as logged in subsequent drill holes.

In February - March 194⁷5 seven (7) AQ wire line diamond drill holes were drilled. Six (6) of these were in the vicinity of the discovery trenches one was 4900 ft. West on Hay Island.

The drilling revealed gold bearing zones in two (2) locations 4900 ft. apart.

A zone of pyrite mineralization was located under the trenches on the West end of the East Island. Pyrite occurs in a slightly siliceous dacite tuff shear zone.

Six (6) holes were drilled in the discovery area. Hole MC 7 was drilled at a 40° angle to the strike and did not reach the zone.

Hole MC 75-5 cut the gold bearing zone with 10-15% pyrite at 87.5 ft. to 102.0 ft. which assayed 0.13 Oz. gold for 14.5 ft.

Hole MC 75-3 cut the zone with 5-10% pyrite over 13.6 ft. width 200 ft. below surface. The centre section assayed 0.33 Oz. gold for 5.0 ft. with 0.03 Oz. gold and 0.02 Oz. gold on foot and hanging walls.

The two (2) holes drilled to the East of Discovery Trenches did not cut gold values.

The pyrite zone strikes North 80° dips 80-85° North. It is at least 240 ft. in length, approximately 20 ft. wide near surface and intersected 200 ft. below surface. It appears to pinch out to the East but is open to the West.

Hole No. MC 75-4 on Hay Island 4900 ft. West on strike of the discovery trenches cut the gold bearing zone 20 ft. wide. Assaying 5.0 ft. 0.21 Oz. gold or 10.0 ft. 0.12 Oz. gold.

No drilling has been done on the 4900 ft. between the two (2) showings.

In Ontario Geological Survey Report 194 Geology of Shistose Lake Area, District of Kenora by G. R. Edwards, the author mentions on Page 61 that a grab sample taken 4450 meters at North 76° from the Kakagi Lake gold occurrence (Island Gold Property) assayed 0.18 Oz. gold and 0.12 Oz. silver per ton. This occurs adjacent to a linament which could represent the Eastern extension of the shear zone in which the Kakagi Lake Gold occurrence is located.

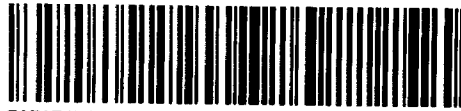

52F05SW0093 63.4152 DOGPAW LAKE

020

KAKAGI LAKE GOLD PROPERTIES

Dogpaw Lk

TIE ON GROUP TO McLENNAN GOLD PROPERTY

KAKAGI LAKE, KENORA DISTRICT CLAIM MAP M.2585

7 CLAIMS NOS. K589470 - K589476 inc.

LOCATION

Tie on McLennan Claim Group adjoin on the South West a 7 patented claim group of claims owned by G. E. McLennan, Kenora, Ontario. The McLennan claims adjoin The Canadian Arrow Gold Property, Dogpaw Lake, Ontario. Access is by boat from any of the commercial tourist camps on Kakagi Lake. The South boundary of the claims is 600 ft. from the most Northern Bay on the West end of Kakagi Lake. The Wicks Lake Claim Group is 4 miles South West. The Peninsula Claim Group is 4½ miles North 170° South.

GEOLOGY

The Western claims are mafic to intermediate meta volcanics. The Eastern part are mafic to ultra mafic intrusive rocks.

On the McLennan Claims two gold bearing veins have been trenched and blasted. Some spectacular free gold was bagged and shipped from one of these trenches.

Thirteen (13) diamond drill holes traced the vein South West into patented claim No. K10029. This claim adjoins claim No. K589475.

The Eastern part of the tie on group are in the same diorite rocks that the Canadian Arrow Gold Property have diamond drill indicated 97,500 tons of 0.43 Oz. gold.

RECOMMENDATIONS

The Claim Group should be prospected by experienced gold prospectors using the grub hoe and gold pan method. This was how the Canadian Arrow and McLennan Gold Veins were found.

Yours truly,

Roy A Martin

ROY A. MARTIN

STURGEON FALLS, ONTARIO.
MAY 1982



52F05SW0093 63.4152 DOGPAW LAKE

030

KAKAGI LAKE GOLD PROPERTIES

WICKS LAKE PROPERTY

KAKAGI LAKE, KENORA DISTRICT ONTARIO, CLAIM MAP M.2585

15 CLAIMS NOS. K489266 - K489227 inc. and K535966 - K53568 inc.

LOCATION

The property is located on Wicks Lake just North of Peninsula Bay, Kakagi Lake, 9 miles North of Highway 71 from Nestor Falls, Ontario.

GEOLOGY

The area was mapped and reported in Ontario Department of Mines Annual Report 1933, Kakagi Lake Area Volume 42, Part 4.

1976 Ontario Division of Mines Geoscience Report 134 Map 2319 C and Ontario Department of Mines Aero Magnetic Map Caviar Sheet cover the area.

PROPERTY

In 1944 Noranda Mines optioned the Eastern Claims from E. Wensley and partners.

During the winter of 1944-1945 surface trenching and rock blasting was done on 2 veins which have strike lengths of up to 2000 ft.

Short shoots of ore were indicated. Average values over 2. to 3. ft. widths were 0.40 Oz. gold.

During the spring and summer of 1945 Noranda did 6534 ft. of E core diamond drilling.

Core recovery was 60%. Values from the recovered core were only 20% of the assays from the surface trenches.

Noranda reported the lost core to be the mineralized sections which carried higher values.

The West Claims of the group were worked on by Sylvanite Mines in 1945. 5 gold bearing veins were found and sampled.

No. 5 Vein was traced by 3 trenches for 300 ft. with low ground and swamp on each end. Assays from these trenches were 18 ft. 0.26 Oz. gold, 6 ft. 0.09 Oz gold and 18 ft. 0.05 Oz gold.

G. L. Holbrooke Exploration Manager for Sylvanite Gold Mines recommended 1000 ft. of diamond drilling to test No. 5 vein. The drilling was not done.

In 1980-1981 Noranda Exploration worked on both the former Noranda and Sylvanite claims. Several good assays up to 5.10 Ozs. gold were obtained from the old Noranda trenches. Assays from former Sylvanite claims were up to 0.11 Oz. gold. Noranda completed an IP,

PROPERTY con't

Magnetometer and soil sampling program over most of the property. The soil samples were assayed for silver, zinc and copper.

They reported that IP appeared capable of locating narrow mineralized quartz veins but was not capable of pinpointing these closely enough to permit drilling them without detailed geological mapping.

5 XRay diamond drill holes were completed on the Western part of the former Noranda and the Sylvanite claims. Assays were up to 0.176 Oz. gold.

In 1945 work Noranda had good assays on the narrow No. 3 vein, 200 ft. West of Wicks Lake up an 80 ft. hill. A 300 lb. bulk sample of this area assayed 0.95 Oz. gold across 1.4 ft.

RECOMMENDATIONS

The diamond drilling on No. 3 vein was not satisfactory.

10 to 12 trenches should be blasted across the vein from the area starting 200 ft. West of Wicks Lake for 200 to 250 ft. to the West.

If these surface trenches give satisfactory results an adit could be made for 200 to 300 ft. This would give 100 ft. of depth on the vein at the end of the adit.

Car and bulk samples would give a more true grade of the vein. than diamond drilling.

Yours truly,

Roy A Martin

ROY A. MARTIN

STURGEON FALLS, ONTARIO.
MAY 1982.



52F05SW0093 63.4152 DOGPAW LAKE

040

KAKAGI LAKE GOLD PROPERTIES

WICKS LAKE CLAIM GROUP

Dog Paw Lk.

KAKAGI LAKE, KENORA DISTRICT, ONTARIO CLAIM MAP M.2585

CLAIM NOS. K489266 to K489277 inc. K535966, K535967, K535968 inc.

WORKED COMPLETED ON CLAIM GROUP

LOCATION

The property is located on Wicks Lake just North of Peninsula Bay, Kakagi lake, 9 miles North of Nestor Falls, Ontario,

The geology and property description is described in accompanying report by Roy A. Martin, May 1982.

DESCRIPTION From July 10th to July 27th 1982 inc. 3 men were employed trenching, drilling and blasting rock trenches on No. 3 Vein Claim K489266.

Ten (10 blasted rock trenches were made along No. 3 Vein starting at a point 225 ft. North 270° from No. 1 Witness Post for Claim No. K489266 on the West shore of Wicks Lake.

The trenches were spaced from 10 to 27 ft. apart. Total distance from East to West trench was 160 ft. on a vertical distance of 70 ft. A total of 700 cubic feet of rock (60 tons) was removed.

Holes were drilled with an Atlas Copco Cobra gasoline plugger drill using tungsten carbide steel.

The quartz vein in the trenches is 2 inches to 6 inches wide with quartz stringers and silicious diorite over a 4 to 6 ft. width. The quartz is usually mineralized with 2% pyrite. The diorite 1 to 3%.

A total of 20 samples were taken. In some trenches the sampling was across 5 ft. of vein and altered walls. In other trenches the hanging and foot walls were sampled separately.

In the centre of the trenching No. 7 trench was in a fault zone. No quartz or alteration was observed. A 0.7 ft. of massive pyrite assayed 0.01 Oz. gold. Best assay in the 10 trenches was 3.0 ft. 1.05 Oz. gold. The average of 10 trenches was 4.28 ft. Of 0.26 Oz. gold for 160 ft. length. Including 2 Noranda Mines 1945 sampling in 2 trenches at each end of the 10 new trenches the average is 3.74 ft. 0.38 Oz. gold for 187 ft.

Eliminating No. 7 trench in the fault zone, the average of 9 trenches is 4.2 ft. 0.30 Oz. gold for 160 ft. length.

LOCATION Con't

Including the Noranda 1945 sampling in 2 trenches at each end of new trenching the average would be 3.3 ft. 0.45 Oz. gold for 187 ft. length.

A map of the trenching at 1" to 10 ft. with assays is enclosed with this report.

A work report for 133 days credit for assessment work is filed with The Kenora Mining Recorder.

Yours truly,

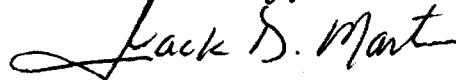

JACK D. MARTIN

682 MORIN STREET,
NORTH BAY, ONTARIO.
P1B 5R7.



52F055W0093 63.4152 DOGPAW LAKE

050

KAKAGI LAKE GOLD PROPERTIES

PENINSULA GOLD PROPERTY

KAKAGI LAKE, KENORA DISTRICT, ONTARIO Map M2475

CLAIMS NOS. K589477 to K589488, inc.

WORK COMPLETED ON CLAIM GROUP

LOCATION

The property is located on a large peninsula on the North side of Kakagi Lake (locally called Crow Lake) 9 miles North of Nestor Falls, Ontario. Nestor Falls is on the Kenora - Fort Frances Highway No. 71, approximately 80 miles South East of Kenora and 60 miles North West of Fort Frances, Ontario. Access is by motor boat from any of the commercial tourist camps on Kakagi Lake.

For History, Geology and Property Description see Report by Roy A. Martin, May 1982.

From June 20th to July 9th three (3) men were employed doing surface work on the above claims.

On Claim No. K509480 - 100 ft. South West of D Zone four (4) blasted rock trenches totalling 110 ft. length were made along a 300 ft. length in the 200 ft. wide carbonated gabbro zone.

The zone os 15 to 20% quartz veins and stringers 1/4 inch to 2 ft. wide with ankerite, 3 to 5% maraposite and 1 to 2% pyrite.

The trenches were 3 to 5 ft. wide and 2 to 3 ft. deep.

Three (3) representative dump samples were taken from the dumps of the 4 trenches. Each sample weighed 20 pounds and was composed of 200 pieces.

The samples were fire assayed for gold and all returned 0.01 Oz. gold.

Using No. 2 Claim Post of Claim No. K589482 as zero a small grid was out. The base line was made North 262° for 40 meters East and 100 meters West.

North South lines were cut from 40 meters East to 100 meters W. a 20 meters intervals. From 40 meters East to 40 meters West, East West lines were cut at 10, 20 and 30 meters North.

In the area adjoining North of 2 blasted trenches that had significant gold values, 91 holes were dug. The locations of these were marked with numbers on flagging tape. The holes were 6" to 2 ft. deep. A sample was taken from each hole and panned for gold.

LOCATION Con't

The estimated value of the material of this if it had been fire assayed was plotted on a map.

Of the 91 holes panned 59 showed estimated values of trace to 0.3 Oz. gold per ton. One hole yielded a piece of quartz with coarse visible gold.

REMARKS

Significant gold pannings from the holes dug extend 15 meters wide for 70 meters North West of the trenches. The area North West, North and South East is swamp covered. The South West is covered with dirt and boulders.

Detailed geological mapping, geophysical and soil sampling should be done over the claims.

Yours truly,

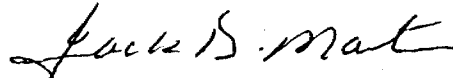

JACK D. MARTIN

682 MORIN STREET,
NORTH BAY, ONTARIO, P1B 5R7
SEPTEMBER 1982.



52F055W0093 63.4152 DOGPAW LAKE

060

KAKAGI LAKE GOLD PROPERTIES

Henry Lake.

PENINSULA GOLD PROPERTY

KAKAGI LAKE, KENORA DISTRICT ONTARIO, MAP M.2475

12 CLAIMS NOS. K589477 to K589488 inc.

LOCATION

The property is located on a large peninsula on the North side of Kakagi Lake (locally called Crow Lake) 9 miles North of Nestor Falls, Ontario. Nestor Falls is on the Kenora - Fort Frances Highway No. 71 approximately 80 miles South East of Kenora and 60 miles North West of Fort Frances, Ontario. Access is by motorboat from any of the commercial tourist camps on Kakagi Lake. The writer used Lakeview Lodge 6 miles from the property. A float plane air base is located at Nestor falls, Ontario.

HISTORY

The area was prospected during 1890-95. Many claims were surveyed including the Peninsula during this period. These are shown on Map 42 B accompanying Dr. E. M. Burwash's Report Kakagi Lake Area Volume 42 Part 4, Ontario Department of Mines Annual Report 1933.

During the break-up period in April - May 1945 Roy A. Martin and Leo Turcotte made a gold discovery in a carbonate zone on the peninsula. When sampling the zone a fair sized piece of free gold was noted this was not included in the sampling. The discovery was on the boundary of staked claims. A reasonable deal could not be made with the owners of these claims. No further work was done on the discovery. The location of the discovery was not revealed to the claim owners.

In 1974 Roy A. Martin and Jack D. Martin with Angus MacDonnell rediscovered the Martin-Turcotte Gold showing. This is called A Zone. Reconnaissance led to the discovery of 3 more gold showings called the B, C and D Zones. 28 claims were staked covering most of the East part of the peninsula.

In most places assays of the trenching and rock blasting into the new discoveries gave low values. Two interesting assays 0.41 oz. gold across 10 ft. in A Zone and 10 ft. of 0.14 oz. gold in D Zone should have been followed up

However as the Syndicate had no funds to do this the claims were allowed to lapse.

HISTORY Con't

In September 1981 Jack D. Martin staked 12 claims Nos. K589477 to K589488 inc. over the old showings.

GEOLOGY

The claim group is located on the South Boundary of Ministry of Natural Resources Geological Map 2819 Geoscience Report 134 and on the North Part of Map 2447.

Two North West - South East faults 2000 feet apart strike across the centre of the claim group.

The West Kakagi Lake anticline striking North 80° is also in the centre of the claim group. The 4 gold zones are on the North limb of the anticline.

Most of the property is metamorphosed mafic and ultra mafic intrusive rocks. These range from gabbro to peridotite. Five small areas of felsic to intermediate meta volcanics and intercalated meta sediments of dacite tuff, pyroclastic breccia and tuff breccia are mapped. Several felsite dikes were observed.

The gold zones are in altered carbonated gabbro intruded by quartz stringers and veins from 1/4" to 2 ft. wide. In places the gabbro is slightly to intensely sheared. The quartz is mineralized with cube iron pyrite, magnetite and some chalcopyrite. Tourmaline was noted in some of the quartz. The contact of quartz with the altered gabbro is in places heavily mineralized for several inches into the gabbro.

A regional structure strikes southwesterly from Cedartree Lake folds back southeasterly along Peninsula Bay (along the North side of the claim group) folds back at South end of Wicks Lake and strikes southwesterly (along the South of the Claim Group) through Kakagi Lake.

The claims are within the hinge of this fold 2 miles from its East edge.

DESCRIPTION

A ZONE

This was the original discovery made by Martin and Turcotte in 1945.

It is slightly sheared carbonated altered gabbro with quartz stringers 1/4" to 8" wide mineralized with pyrite and magnetite. The strike is East-West and dip 80° North

A ZONE Con't

On the East 60 ft. of trenching has been blasted on the zone. 6 chip samples each 10 ft. long were taken on this. The best sample assayed 0.41 oz. gold across 10 ft.

Two trenches to the West of this has assays of trace to 0.02 oz. gold.

Recent prospecting to the North and adjoining this zone indicates a 40 ft. wide area 250 ft. long with many good to very good pannings. A cedar swamp and low ground adjoins this to the North.

B ZONE

This is an outcrop 30 ft. wide and 75 ft. long 1320 ft. west and 200 ft. south of A Zone.

It is a carbonated altered gabbro with quartz stringers and lenses 1/2" to 6" wide. The strike is East West. Some fair pannings have been had from this zone. A 20 ft. blasted rock trench assayed 0.02 Oz. gold.

C ZONE

Is 700 feet South and 50 ft. West of B Zone. It is carbonated altered gabbro with 1/2" to 4" quartz stringers mineralized with pyrite. The strike is East West the dip 80° to North. The Zone is 40 ft. wide no contact on the South. The North contact is massive gabbro at the edge of a slight shearing. The centre is intensely sheared and pans fair tailings of gold. The South 15 ft. is silicious with quartz stringers. This was blasted and assayed trace across 15 ft.

D ZONE

Is 130 ft. South West of C Zone. The rusty dirt along a 100 ft. North South area panned a little gold. A 110 ft. trench was blasted along this.

It is carbonated altered gabbro with quartz stringers from 1/2" to 1 ft. The strike varies from North 60° to North 75°. The dip North 80°. At the North end of the trench it is slightly sheared for 20 ft. then 65 feet is intensely sheared. The last 30 feet is hard and silicious.

The trench was sampled in 10 ft. sections. For 90 ft. assays were 0.01 Oz. gold or less then 10 ft. of 0.14 Oz. gold and 10 ft. of 0.02 Oz. gold.

REMARKS

- (1) The property is located in a structurally favourable area on the hinge of a fold and on an incline.
- (2) In a short time four gold zones were found by surface prospecting with grubhoe and gold pans.
- (3) 200 ft. South West of D Zone is a 200 ft. wide carbonated gabbro zone 15 to 20% quartz stringers 1/4 to 2. ft. wide striking with and across the zone. This contains up to 2% pyrite. The zone has considerable green maraposite. The surface looks very similiar to the Kerr Addison Mine which the writer saw in 1936. Before it was developed into a mine.

RECOMMENDATIONS

- (1) Blast several rock trenches into the carbonate gabbro zone South West of D Zone.
- (2) Make close grid lines 10 meters centres on the area North, West and East of A Zone.
- (3) Prospect this by digging holes with a grub hoe 6" to 2 ft. deep where rust is found and pan these for gold. Plot these on a map with an estimate of the values.

Yours truly,

STURGEON FALLS, ONT.
MAY 1982.

Roy A. Martin
ROY A. MARTIN

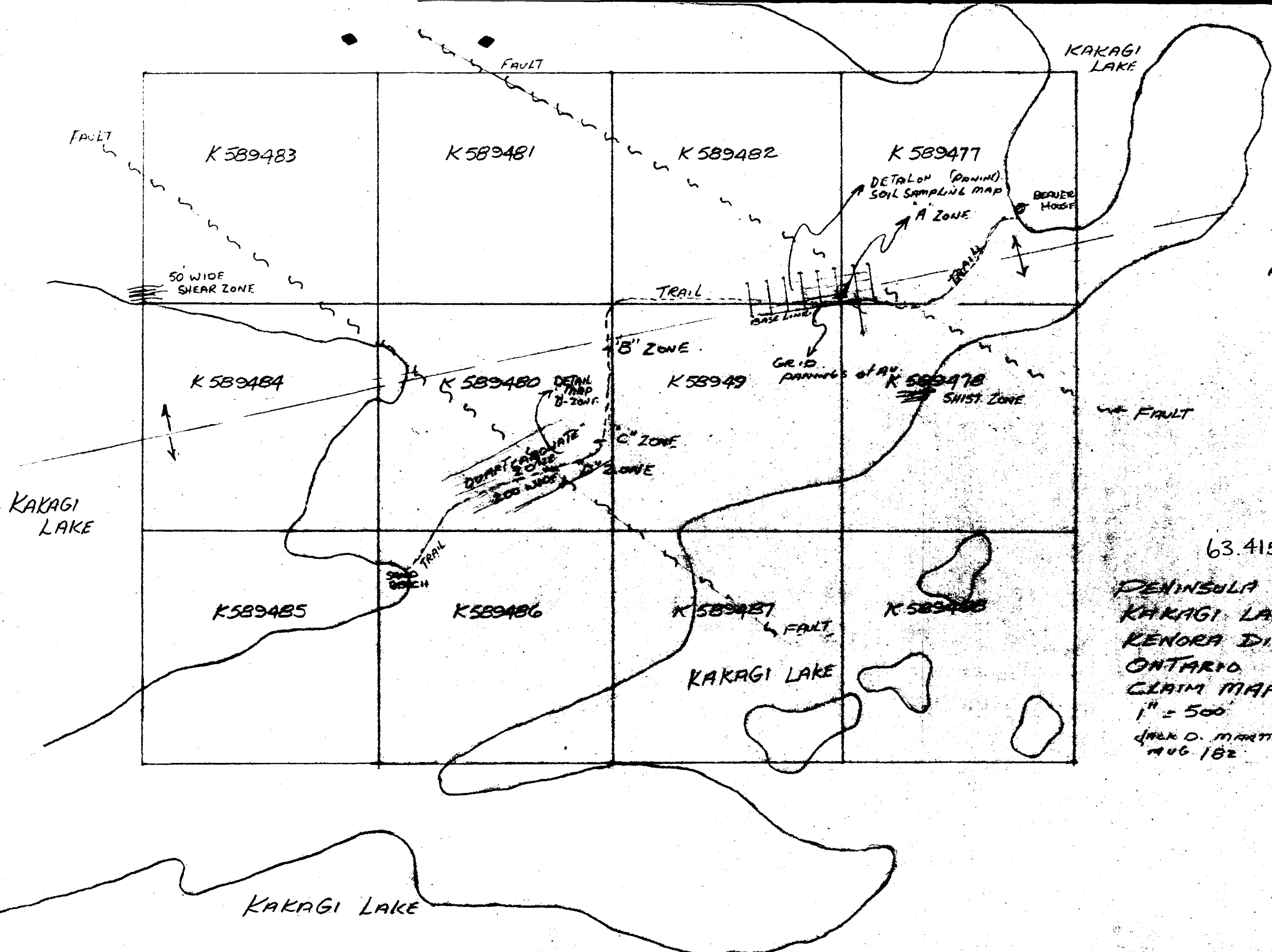

63.4152
 PENINSULA CLAIM GROUP
 KAKAGI LAKE
 KENORA DISTRICT
 ONTARIO
 CLAIM MAP MR 415
 1" = 500'
 JACK D. MARTIN
 AUG 182

D ZONE

TRENCH
20W AU

10' 0.18 0.2 AU

TRAIL

OLD BLASTED TRENCH

BLASTED TRENCH
20' x 3' x 2' DEEP

200 PEGS 20" 0.01 0.2 AU

200' WIDE CARBONATED GABBRO ZONE

15-20% QUARTZ VEINS AND STRINGS 1/4" - 2.0" WIDE
WITH ANKERITE, 3 TO 5% MARIPOSITE AND 1-2% PYRITE

63.4152

D ZONE

PENINSULA GOLD PROPERTY

KARAGI LAKE GOLD PROPERTIES

KARAGI LAKE

KENORA DISTRICT

ONT.

CLAIM MAP
M-2475

400' N 145° TO
POST # 2 K509480

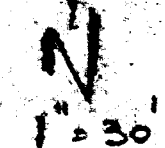

1" = 30'

AUG. 1982
JACK D. MARTIN

TRAIL

BLASTED TRENCH
40' x 4' x 3' DEEP

DUMP

200 PEGS 20"
0.01 0.2 AU

BLASTED TRENCH
30' x 3' x 2' DEEP

DUMP

200 PEGS 20"
0.01 0.2 AU

BLASTED TRENCH
20' x 3' x 2' DEEP

DUMP

(3)

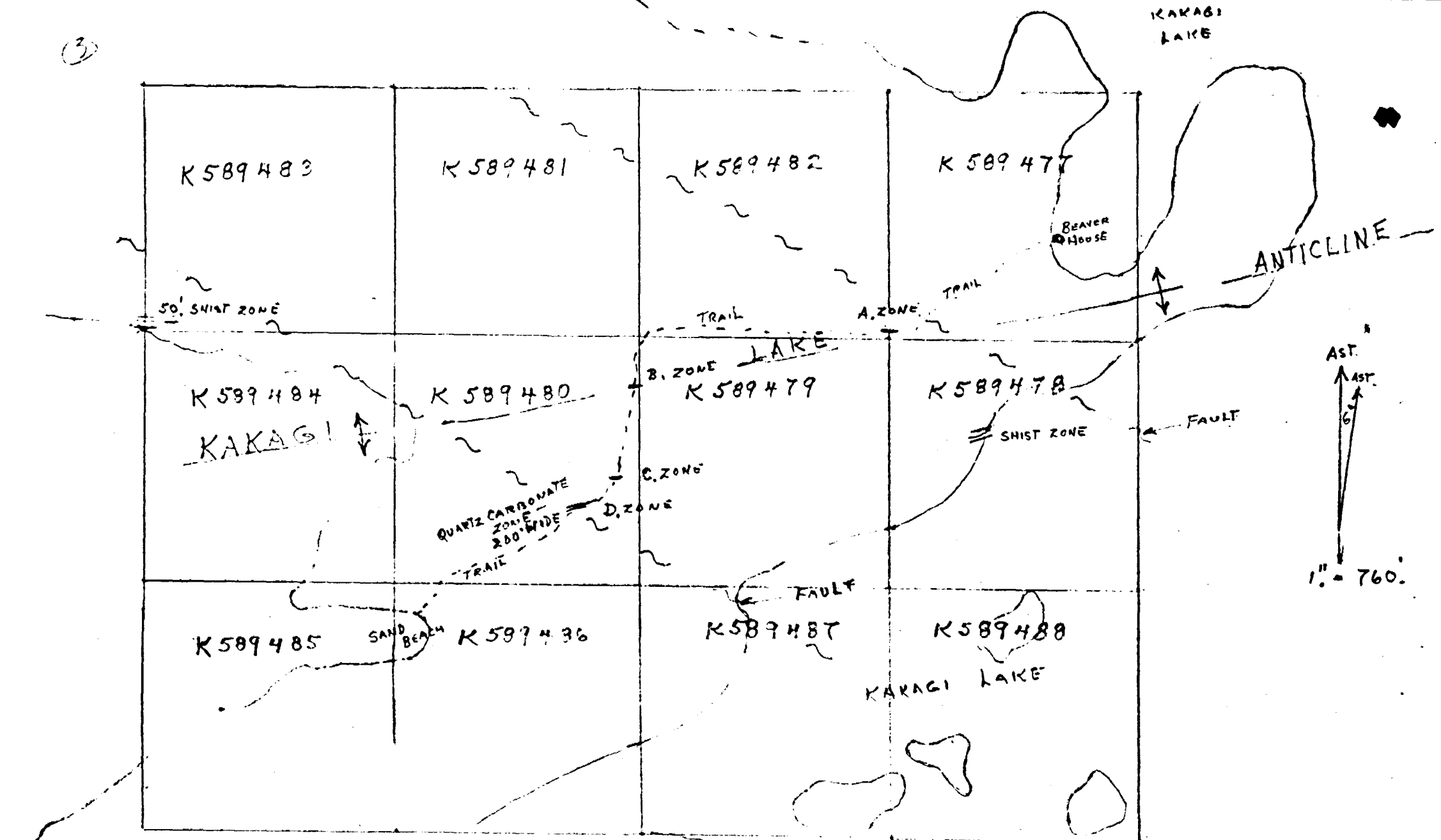

63.4152

PENINSULA CLAIM GROUP

KAKAGI LAKE KENORA DIST

RAM May 1882 D.M. MAP M 2475



63.4152

KAKAGI LAKE GOLD PROPERTIES

KAKAGI LAKE KENORA DISTRICT ONTARIO

ISLAND GOLD GROUP	39 CLAIMS
WICKS LAKE GROUP	15 "
PENINSULA GROUP	12 "
MCLENNAN TIE-ON GROUP	7 "
TOTAL	73 CLAIMS

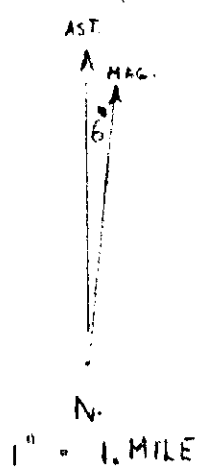

52F055W0093 63.4152 DOGPAW LAKE

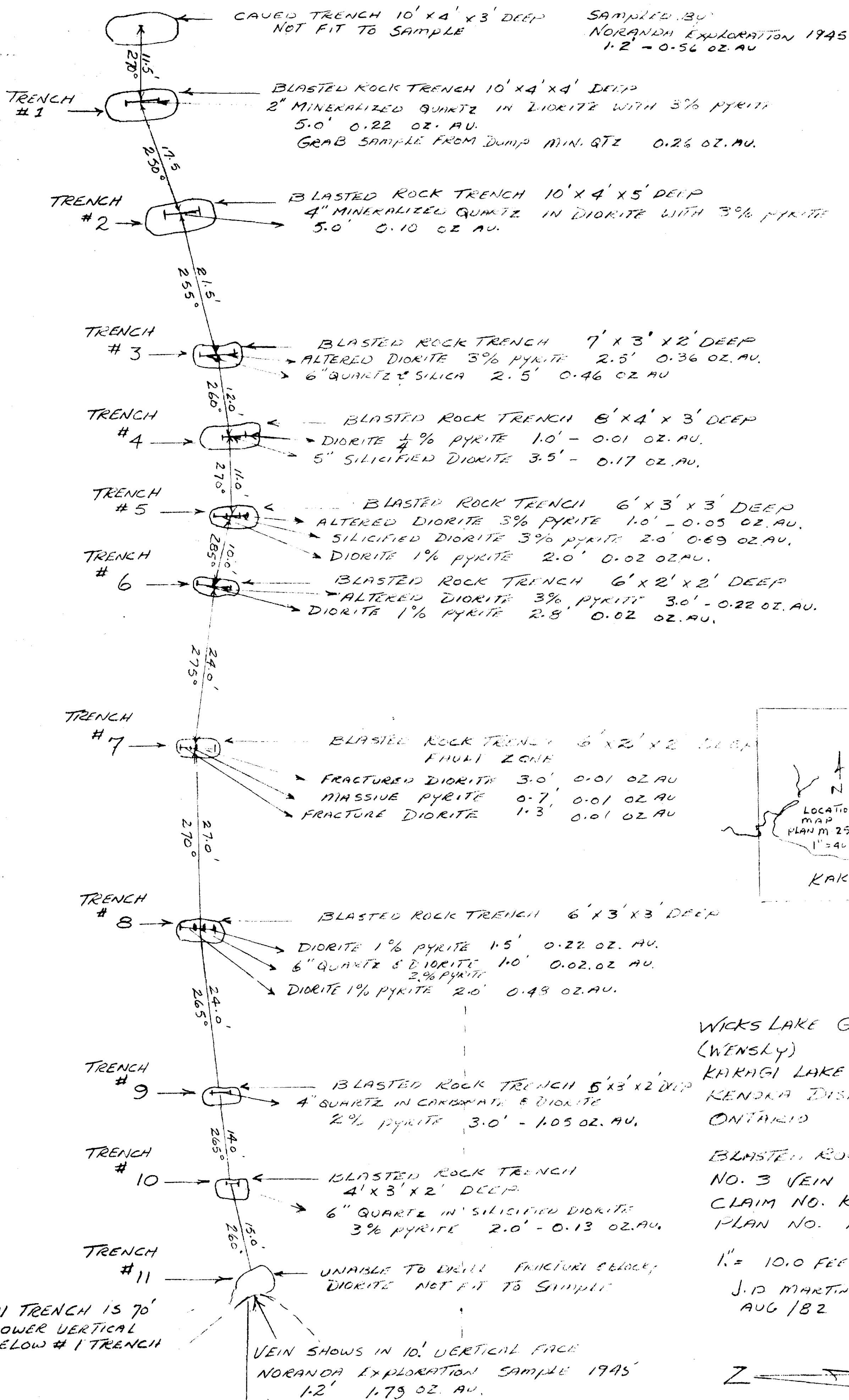

PENINSULA CLAIMS K-589479 - K-589482
SOIL SAMPLING (PANING) ON GRID

No.	LOCATION	PANING RESULTS
1	30N+0W	NIL
2	" + 3W	TRACE
3	" + 6W	TRACE
4	" + 9W	LOW
5	" + 12W	NIL
6	" + 15W	TRACE LOW
7	" + 18W	TRACE
8	" + 22W	NIL
9	" + 25W	TRACE
10	" + 28W	NIL HUMUS
11	" + 30W	NIL "
12	" + 32W	" "
13	" + 35W	" "
14	" + 37W	" "
15	" + 38W	" "
16	" + 40W	" "
17	42N+40W	VERY GOOD
18	41N+36W	GOOD
19	41N+52W	NIL
20	37N+61W	NIL
21	37N+65W	NIL
22	10N + 4E	TRACE
23	10N + 11E	TRACE
24	10N + 15E	TRACE
25	10N + 22E	LOW
26	20N + 2E	NIL
26A	22N + 1E	LOW
27	21N + 3E	NIL
28	20N + 7E	NIL
22AB	11N + 3E	LOW
27P	20N + 5E	NIL
P1	35N + 10W	NIL
R1	21N + 3W	LOW
R2	22N + 3W	FAIR
R3	23N + 3W	NIL
P2	31N + 53W	NIL & OLD TRENCH
P3	35N + 43W	TRACE
P4	31N + 40W	NIL
P5	36N + 40W	TRACE
P6	36.5N + 40W	LOW
P7	37N + 40W	FAIR
26B	22N + 2E	NIL
26C	22N + 5E	FAIR
26D	18N + 7E	TRACE
22A	15N + 8E	FAIR
22B	17N + 8E	GOOD
P8	8N + 1W	FAIR
P9	10N + 15W	FAIR
P10	10N + 3W	LOW FAIR
P11	12N + 1W	NIL
P12	14N + 00	NIL

PENINSULA CLAIMS K-589479 - K-589482
SOIL SAMPLING (PANING) ON GRID

No.	LOCATION	PANING RESULTS
R4	4N+9E	FAIR
R5	5N+9E	LOW
R6	6N+9E	FAIR
R7	7N+9E	LOW
R8	9N+9E	LOW
P13	28N+3W	NIL
P14	25N+10W	TRACE
P15	22N+11W	NIL
P16	20N+11W	LOW
P17	18N+11W	FAIR
P18	16N+11W	NIL
J4	42N+40W	LOW
J5	41N+43W	NIL
J6	41N+44W	NIL
22F	16N+11E	GOOD
J1	16N+21E	NIL
J2	17N+18E	NIL
22-D	16.5N 8.5E	FAIR
26E	18N+8E	FAIR
22C	16.5N+7E	TRACE
22F	15N+13E	VERY GOOD + FREE GOLD IN QUARTZ
22G	16N+12E	GOOD
22H	15N+9E	GOOD
22I	14N+16E	FAIR
22J	17N+8.5E	GOOD
22K	14N+13E	FAIR GOOD
22L		LOW FAIR
22L1	ALL TAKEN IN AREA OF 22F FREE GOLD IN QUARTZ	GOOD
22L2		TRACE
22L3		TRACE
22L4		TRACE
22L5		FAIR
22L6		NIL
R9	9N+5E	TRACE
K10	42N+38W	FAIR GOOD
R11	42N+37.5W	FAIR GOOD
J8	45N+38W	TRACE
P16A	19N+11W	LOW
J9	42N+40W	NIL
J7	41N+44W	TRACE

91 SAMPLES TAKEN FROM 6" TO 2.0' DEPTH

ESTIMATE OF PANINGS
IF MATERIAL WAS FIRE ASSAYED

NIL	NO GOLD IN PAN
LOW	0.02 OZ AU
LOW FAIR	0.05 OZ AU
FAIR	0.10 OZ AU
FAIR GOOD	0.15 OZ AU
GOOD	0.20 OZ AU
VERY GOOD	0.30 OZ AU

JACK D. MARTIN
AUG 1982



L100W

L180W

L60W

L40W

L20W

L00

L20E

L40E

40N

30N

20N

10N

BASE LINE

L 40N

L 30N

L 20N

L 10 N

BASELINE 262°

63.4152

1 CH = 2 METERS

Low ground

Low Ground

HEAVY OVERBURDEN

BOULDER & MORTAR HEADS IN SECTION WEST OF LINE 20W NO RUSTY MATERIAL 200' TO 300' DEPTH

P.2

RUSTY MATERIAL

RUSTY MATERIAL

NOTE 7 PANINGS 22L TO 22L6 NOT PLOTTED IN AREA OF 22F FREE GOLD SAMPLE IN QUANT. RANGE FROM GOOD - FAIR - LOW TRACE ONLY.

RUSTY Free Gold in QUANT.

BLASTED ROCK TRENCHES

K-589452

K-589477

K-589479

K-589478

CLAIM POST

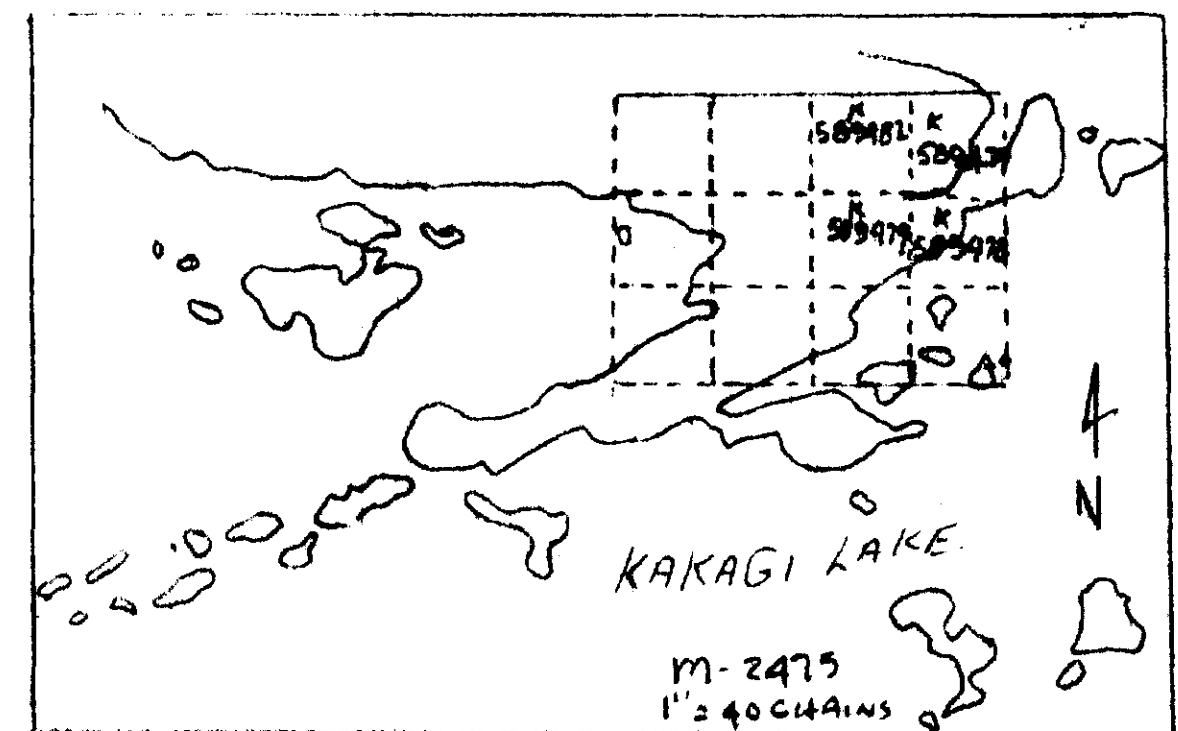

ESTIMATE OF PANINGS IN MATERIAL (FINES) WERE OBSERVED

NIL	•	NO GOLD IN PAN
TRACE	•	FINE GOLD IN PAN
LOW	•	0.02 OZ. AU
LOW-FAR	•	0.05
FAIR	•	0.10 OZ. AU
FAIR-GOOD	•	0.15
GOOD	•	0.20 OZ. AU
VERY GOOD	•	0.30

51 SAMPLES (PANINGS) TAKEN FROM 6" TO 2.0' DEPTH

PENINSULA CLAIMS SOIL SAMPLING ON SAND PROSPECTING & PANING FOR AN CLAIMS K589479 - K589482 KAKAGI LAKE AREA KENORA DISTRICT ONTARIO PLAN NO. M-2475 1" = 3 METRES JUNE - JULY 82 JACK D. MARTIN

