



Au

Ag



52F08SE0005 2.10206 REVELL

YING LTD.

Phone: Bus. (807) 662-8171  
Res. (807) 662-3361

010

PAUL OKANSKI, Assayer  
Box 253, Cochenour, Ontario POV 1L0

A. Glatz

ASSAY CERTIFICATE

Date: May 26, 1987.

Sample No.	Description	oz/ton Au	oz/ton Ag
1	727 chip 3ft. quartz + diorite	Trace	
2	28 chip 3ft. quartz + diorite	<del>xtt.10</del>	
3	29 grab diorite	Trace	
4	730 grab quartz	"	
5	31 grab diorite + py	.01	
6	32 grab diorite	Trace	
7	33 grab dike material	"	
8	34 grab quartz 6'	.01	
9	35 grab diorite	Trace	
10			
11			
12			
13			
14			
15			
16			
17			
18			
19			
20			
21			
22			
23			
24			
25			

KENORA  
MINING DIV.  
FIVE  
JUL 3 1987  
AM 7 8 9 10 11 12 1 2 3 4 5 6 PM

Assayer:

*Paul Okanski*

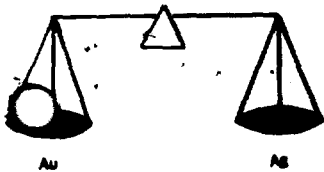

# PAUL'S CUSTOM FIRE ASSAYING LTD.

Phone: Bus. (807) 662-8171  
Res. (807) 662-3361

PAUL OKANSKI, Assayer  
Box 253, Cochenour, Ontario POV 1L0

A. Glatz

## ASSAY CERTIFICATE

Date: Aug. 13-86

Sample No.	Description	oz/ton Au	oz/ton Ag
1 612	2 ft. diorite no sulfide	.01	
2 13	2 ft. diorite little sulfide	Trace	
3 14	3 ft. chip quartz	.02	
4 15	3 ft. chip diorite	Trace	
5 16	grab diorite little sulfide	"	
6 17	grab quartz no sulfide	.01	
7 18	chip sample 1.5 ft. diorite	Trace	
8 19	chip 3 ft. diorite + py	.01	
9 20	grab diorite	Trace	
10 21	grab diorite	"	
11			
12			
13			
14			
15			
16			
17			
18			
19			
20			
21			
22			
23			
24			
25			

KENORA  
MINING DIV  
**RECEIVED**  
JUL 3 1986  
7:09 10 11 12 1 2 3 4 5 6 PM

Assayer: *Paul Okanski*

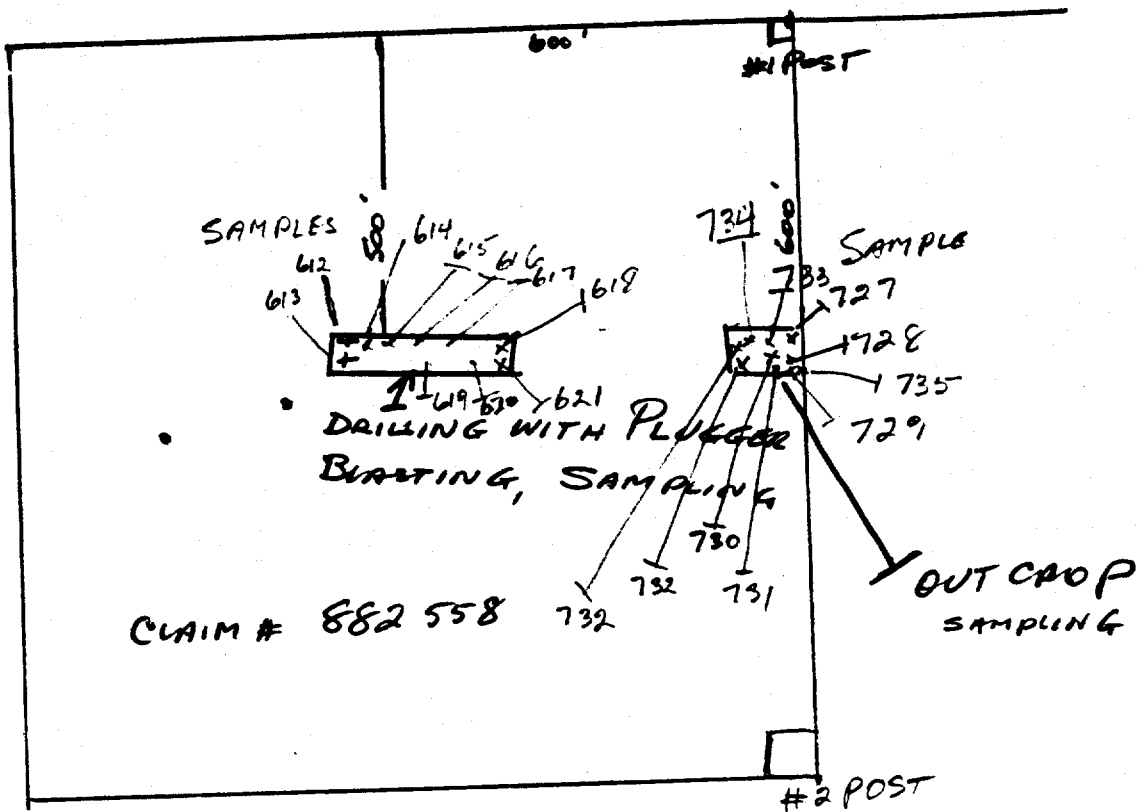

KENC  
MINING DIV.  
JUL 3 1987  
AM 7, 8, 9, 10, 11, 12, 1, 2, 3, 4, 5, 6 PM

# 134-87



Ministry of Natural Resources



52F09SE0005 2.10206 REVELL

300

- Instructions: - Please type or print.  
 - If number of mining claims traversed exceeds space on this form, attach a list.  
 Note: - Only days credits calculated in the "Expenditures" section may be entered in the "Expend. Days Cr." columns.  
 - Do not use shaded areas below.

Type of Survey(s) <b>ASSAYING OF SAMPLES</b>	Township or Area <b>X REVELL TWP. 6.1321</b>
Claim Holder(s) <b>ALEXANDER GLATZ</b>	Prospector's Licence No. <b>X H8691</b>
Address <b>X 15 PARK CRESCENT, DRYDEN ONT. P8N 1T7</b>	
Survey Company	Date of Survey (from & to) Day   Mo.   Yr.   Day   Mo.   Yr.
Name and Address of Author (of Geo-Technical report)	

Credits Requested per Each Claim in Columns at right

Special Provisions	Geophysical	Days per Claim
For first survey: Enter 40 days. (This includes line cutting)	- Electromagnetic	
	- Magnetometer	
For each additional survey: using the same grid: Enter 20 days (for each)	- Radiometric	
	- Other	
Man Days  Complete reverse side and enter total(s) here	Geological	
	Geochemical	
	Geophysical	Days per Claim
	- Electromagnetic	
Airborne Credits  Note: Special provisions credits do not apply to Airborne Surveys.	- Magnetometer	
	- Radiometric	
	Geological	
	Geochemical	

Mining Claims Traversed (List in numerical sequence)

Mining Claim		Expend. Days Cr.	Mining Claim		Expend. Days Cr.
Prefix	Number		Prefix	Number	
K	X 882558 X				
<p><b>RECEIVED</b></p> <p>JUL 3 1987</p> <p><b>MINING LANDS SECTION</b></p>					

Expenditures (excludes power stripping)

Type of Work Performed  
**ASSAY OF SAMPLES**

Performed on Claim(s)  
**882558**

Calculation of Expenditure Days Credits

Total Expenditures \$ **152.00** ÷ **15** = Total Days Credits **10**

Instructions  
Total Days Credits may be apportioned at the claim holder's choice. Enter number of days credits per claim selected in columns at right.

Date **July 1/87** Recorded Holder of Report (Signature) *Alex Glatz*

Certification Verifying Report of Work

I hereby certify that I have a personal and intimate knowledge of the facts set forth in the Report of Work annexed hereto, having performed the work or witnessed same during and/or after its completion and the annexed report is true.

Name and Postal Address of Person Certifying  
**X ALEX GLATZ, 15 PARK CRESCENT, DRYDEN, ONT. P8N 1T7**

Date Certified **X JULY 2/87** Certified by (Signature) *Alex Glatz*

For Office Use Only

Total Days Cr. Recorded **10** Date Recorded **July 3/87** Mining Recorder *MR Lemay Acting*

Date Approved as Recorded **1987-08-28** Branch Chief *MR Chumestey*

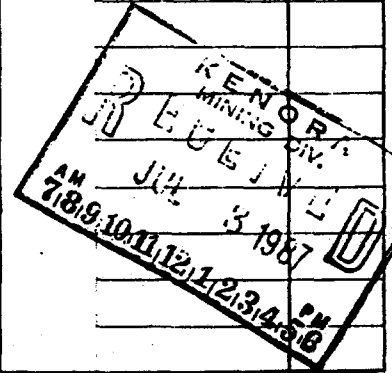



INDEX TO LAND DISPOSITION

PLAN  
 G-1321  
 TOWNSHIP

M.N.R. ADMINISTRATIVE DISTRICT  
 IGNACE  
 MINING DIVISION  
 KENORA  
 LAND TITLES/REGISTRY DIVISION  
 KENORA

REVELL

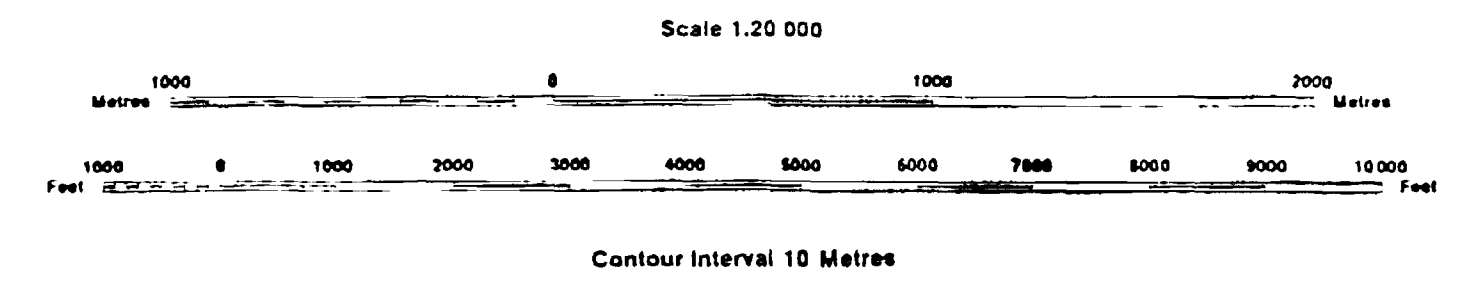

AREAS WITHDRAWN FROM DISPOSITION

- MRO - Mining Rights Only
- SRO - Surface Rights Only
- M + S - Mining and Surface Rights

SYMBOLS

Description	Order No	Date	Disposition	File
Boundary				
Township, Meridian, Base-line				
Road allowance, surveyed				
shoreline				
Lot/Concession: surveyed				
unsurveyed				
Parcel, surveyed				
unsurveyed				
Right-of-way: road				
railway				
utility				
Reservation				
Cliff, Pit, Pile				
Contour				
Interpolated				
Approximate				
Depression				
Control point (horizontal)				
Flooded land				
Mine head frame				
Pipeline (above ground)				
Railway, single track				
double track				
abandoned				
Road, highway, county, township				
access				
trail, bush				
Shoreline (original)				
Transmission line				
Wooded area				

DISPOSITION OF CROWN LANDS

Patent	
Surface & Mining Rights	○
Surface Rights Only	○
Mining Rights Only	○
Lease	
Surface & Mining Rights	□
Surface Rights Only	□
Mining Rights Only	□
License of Occupation	▽
Order-in-Council	○
Cancelled	○
Reservation	○
Sand & Gravel	○

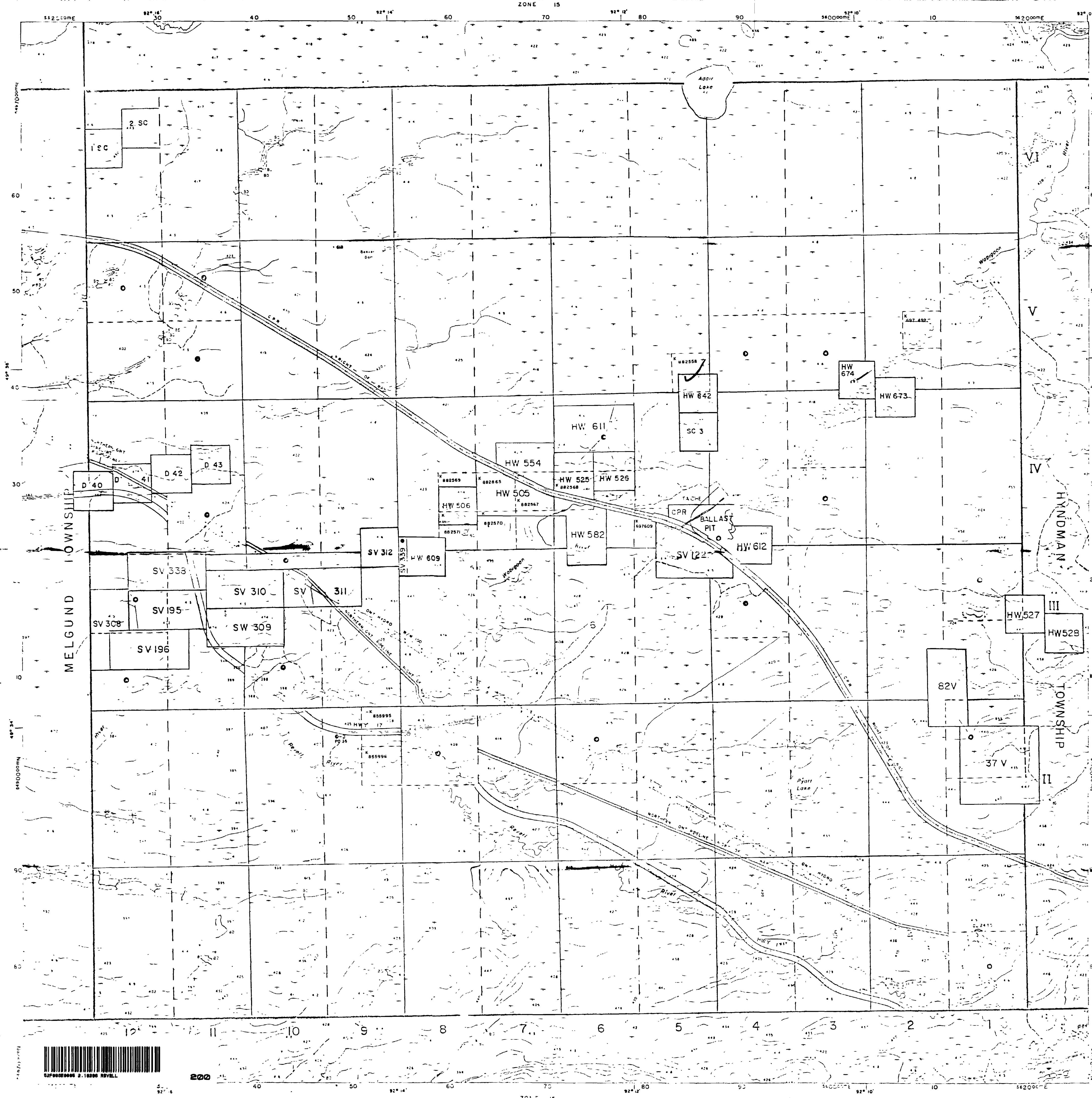

200