



52F10NW0067 2.10659 CONTACT BAY (WABIGOO

010

Preliminary Report on
Harrison Gold Property
Contact Bay Area
Kenora Mining Division
Ontario

RECEIVED

DEC 2 1987

MINING LANDS SECTION

Prepared By:

J. W. Redden, B.Sc.
Box 117
Mabi9oon, ON
P0V 2W0

Dec. 2, 1987

*Final
2.19.82*

Introduction

The property was staked to cover an old gold showing first reported in the 1950's. J. Harrison of Eagle Lake, Ontario staked the property during 1987.

The Property

The property consists of four claims as follows:

K 882550
K 882551
K 972460
K 1007460

Location and Access

The claims are located 1/4 to 1 mile east of Trap Lake about 8 miles south southeasterly from Dryden, Ontario (T191).

Access to the claims is via boat to a trail which runs south from the bend in the river between Mile and Trap Lakes. Present low water levels in the lake system have resulted in a debris-filled swampy area between the river channel and the start of the trail. This makes access via this route difficult. The alternate route used follows the claim line easterly from Trap Lake along the south boundaries of claims K 882551, etc. Though longer, this route is dry and reasonably flat.

Boat access is direct from Dryden or from a landing at the southwest end of Trap Lake.

Previous Work

During the early 1950's 5 diamond drill holes were put down on one zone. No other documentation is available.

General Geology.

The area was mapped by Satterly (O.D.M. map 50e) as being underlain by diorite, quartz-hornblende diorite. No evidence to change this nomenclature was found.

The diorite/granodiorite does appear to contain remnants of the greenstone outcropping to the northeast. This suggests the existing surface to be near the upper limit of dioritic invasion. The greenstone remnants seen could also (in part) represent mafic dikes. The time available did not permit detailed examination to clarify the possibilities.

Shearing of the diorite is widespread. Directions of N20W and

NE-SE shearing were observed and E-W shearing has been reported (W. Sovereign, Pers. comm.). The shearing is typified by variable silicification, carbonatization and pyritization. Mafic material is present in the shears seen. It is not clear whether this was originally present or whether it is the result of the shearing and alteration of the diorite.

Economic Geology:

Two sheared zones are known to occur on the claims and another has been reported (W. Sovereign, Pers. comm.).

The first zone is exposed in a trench, several stripped areas and outcrop along the west boundary of K 972460. The zone strikes N20W with a vertical dip. Shearing over a width of up to 20 feet is exposed. Quartz veins are present within the shear. The quartz is generally white with occasional rusty patches. The veins may be up to 3' wide but generally are only a few inches wide. The total width of quartz would average 8-12" in the exposed areas. Carbonatization is ubiquitous, primarily as disseminations. Pyrite is present in the quartz as disseminations and small aggregates. Pyrite was not noted in the wallrock without quartz.

The sampling results are shown on fig. 2.

The second zone has been exposed in a trench 30' wide, 350' north of the south claim line of K 972460. This zone has been described in MDC 12 as follows:

"Geology: A quartz vein with pyrite and chalcopyrite striking N60W occurs at the contact of a wide diabase dike and a fine-grained diorite to the south.

Economic Features: The vein is 9 feet wide and exposed for a length of 170 feet. An average of 3 channel samples ran 2.31% Cu, 0.11 oz./ton Au, and 1.02 oz./ton Ag over an average width of 4.1 feet. Assays of up to 0.08% Ni and 0.05% Co were reported."

Only one trench is present and the "170 feet" mentioned does not match the field evidence. The one trench present exposes a shear zone 30' wide containing quartz veins up to 6' wide. The zone strikes NE-SE and dips vertically. The shear zone is carbonatized, silicified and pyritized. Wallrock is massive granodiorite.

Sulphides are locally abundant, consisting of chalcopyrite, pyrite and minor pyrrhotite. The centre 3-5' of the main vein contains up to 10% chalcopyrite. A branching vein contains 4" of massive pyrite. Though not so concentrated, sulphides are present across the entire 30' width.

A single drill hole collar was found. From the orientation it is believed to be one of the two original holes drilled on the showing for which logs are not available.

Drill logs for 3 holes are on file. These indicate a zone of quartz mixed with sheared greenstone and altered diorite from 70.5

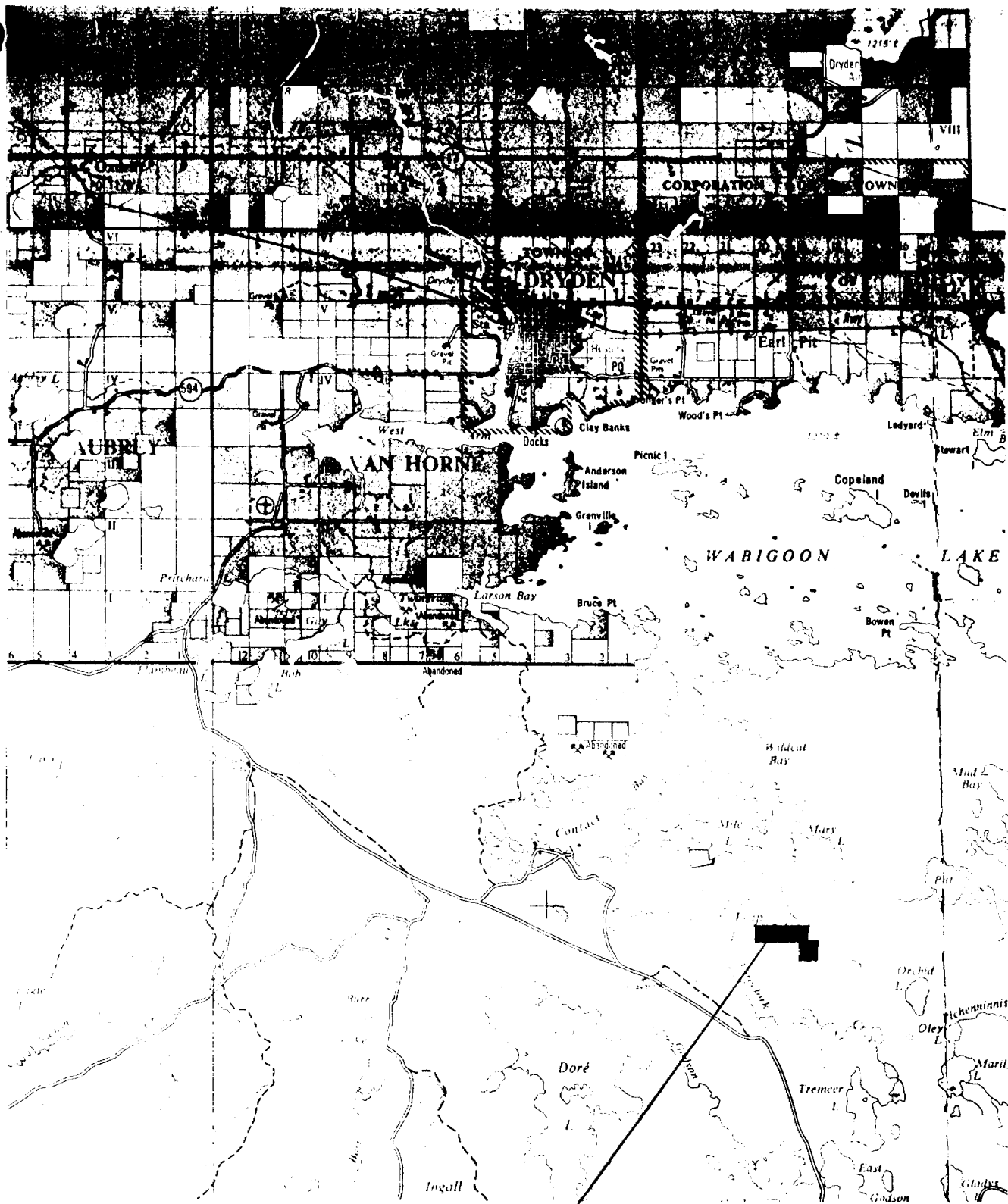

K 882 551	K 882 550	K 972 460
PROPERTY		
K 1007 460		

FIG 1
LOCATION MAP
scale 1" = 2 mi
HARRISON AVE

9/28/47

The first sample was taken from the top of the shaft. The sample was placed in a clean plastic bag and sealed.

The second sample was taken from the middle of the shaft. The sample was placed in a clean plastic bag and sealed.

RECEIVED

FEB 09 1988

MINING LANDS SECTION

The third sample was taken from the bottom of the shaft. The sample was placed in a clean plastic bag and sealed.

The fourth sample was taken from the side of the shaft. The sample was placed in a clean plastic bag and sealed.

The fifth sample was taken from the top of the shaft. The sample was placed in a clean plastic bag and sealed.

The sixth sample was taken from the middle of the shaft. The sample was placed in a clean plastic bag and sealed.

The seventh sample was taken from the bottom of the shaft. The sample was placed in a clean plastic bag and sealed.

The eighth sample was taken from the side of the shaft. The sample was placed in a clean plastic bag and sealed.

Prof. [Signature]
1988

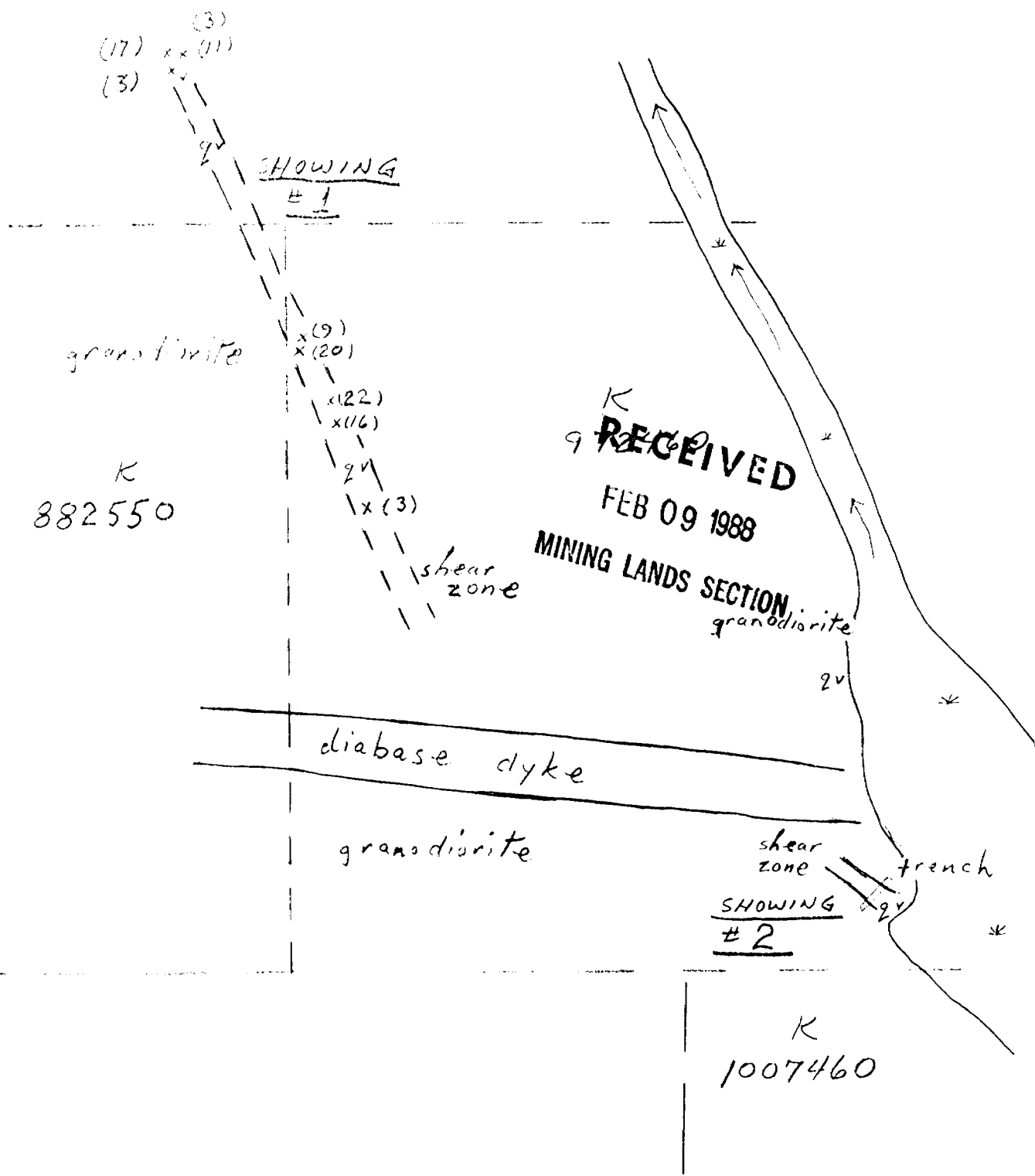

FIG. 2
 HARBOR PL
 CONCEPT PLAN
 REPORT NO. 100



Ministry of Natural Resources

Report of Work (Geophysical, Geochemical & ...)



52F10NW0067 2.10659 CONTACT BAY (WABIGOO)

900

#194-87
... of mining claims traversed ... space on this form, attach a list ...

Type of Survey(s) **EXPENDITURE** Township or Area **CONTACT BAY AREA G.2579**

Claim Holder(s) **J. P. HARRISON** Prospector's Licence No. **H. 6810**

Address **EAGLE RIVER, ONT KOM 1M0**

Survey Company **J. W. Redden** Date of Survey (from & to) **28 08 87 29 08 87** Total Miles of line Cut **-**

Name and Address of Author (of Geo-Technical report) **J. W. Redden, Box 117, Wabigoon, Ont. P0V2W0**

Credits Requested per Each Claim in Columns at right			Mining Claims Traversed (List in numerical sequence)		
Special Provisions	Geophysical		Mining Claim		Expend. Days Cr.
	Days per Claim		Prefix	Number	
For first survey: Enter 40 days. (This includes line cutting)	Electromagnetic		K	882550	20
	Magnetometer			882551	20
	Radiometric			972460	
	Other				
For each additional survey: using the same grid: Enter 20 days (for each)	Geological				
	Geochemical				
	Man Days	Days per Claim			
	Complete reverse side and enter total(s) here				
Airborne Credits Note: Special provisions credits do not apply to Airborne Surveys.	Electromagnetic				
	Magnetometer				
	Radiometric				
	Other				

RECEIVED

OCT 09 1987

MINING LANDS SECTION

Expenditures (excludes power stripping)

Type of Work Performed **preliminary evaluation**

Performed on Claim(s) **ALL**

Calculation of Expenditure Days Credits

Total Expenditures **\$ 600.00** ÷ **15** = **40** Total Days Credits

Instructions
Total Days Credits may be apportioned at the claim holder's choice. Enter number of days credits per claim selected in columns at right.

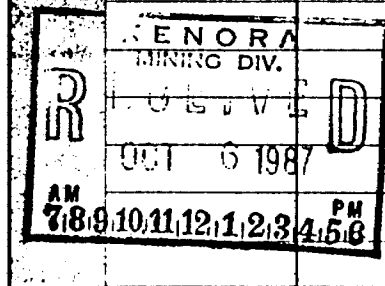

882550

Total number of mining claims covered by this report of work. **3**

Date **Oct 1/87** Recorded Holder or Agent (Signature) *J. W. Redden*

For Office Use Only

Total Days Cr. Recorded **40** Date Recorded **Oct 6/87** Mining Recorder *McLemay Jackson*

Date Approved & Recorded *see work statement* Branch Director

Certification Verifying Report of Work

I hereby certify that I have a personal and intimate knowledge of the facts set forth in the Report of Work annexed hereto, having performed the work or witnessed same during and/or after its completion and the annexed report is true.

Name and Postal Address of Person Certifying **J. W. Redden**

Date Certified **Oct 1/87** Certified by (Signature) *J. W. Redden*

Box 117 Wabigoon Ont P0V2W0



Ministry of
Northern Development
and Mines

Ontario

Ministère du
Développement du Nord
et des Mines

February 10, 1988

Your File: 194-87
Our File: 2.10659

Mining Recorder
Ministry of Northern Development and Mines
808 Robertson Street
Box 5050
Kenora, Ontario
P9N 3X9

ONTARIO GEOLOGICAL SURVEY
ASSESSMENT FIELD
OFFICE

FEB 16 1988

RECEIVED

Dear Sir:

RE: Preliminary Evaluation submitted under Section 77(19)
of the Mining Act R.S.O. 1980 on Mining Claims
K-882550 et al in the Area of Contact Bay

The enclosed statement of assessment work credits for assaying
has been approved as of the above date.

Please inform the recorded holder of these mining claims and
so indicate on your records.

Yours sincerely,

W.R. Cowan, Manager
Mining Lands Section
Mines & Minerals Division

Whitney Block, Room 6610
Queen's Park
Toronto, Ontario
M7A 1W3

Telephone: (416) 965-4888

DK:p1
Enclosure (2)

cc: Resident Geologist
Kenora, Ontario

Mr. J.P. Harrison
Eagle River, Ontario
KOM 1M0



Recorded Holder	J.P. Harrison
Taxation Area	Contact Bay

Type of survey and number of Assessment days credit per claim	Mining Claims Assessed
Geophysical Electromagnetic _____ days Magnetometer _____ days Radiometric _____ days Induced polarization _____ days Other _____ days Section 77 (19) See "Mining Claims Assessed" column Geological _____ days Geochemical _____ days Man days <input type="checkbox"/> Airborne <input type="checkbox"/> Special provision <input type="checkbox"/> Ground <input type="checkbox"/> <input type="checkbox"/> Credits have been reduced because of partial coverage of claims. <input type="checkbox"/> Credits have been reduced because of corrections to work dates and figures of applicant.	<p>\$600.00 SPENT ON A PRELIMINARY EVALUATION ON MINING CLAIMS:</p> <p>K - 882550-51</p> <p>40 DAYS CREDIT ALLOWED WHICH MAY BE GROUPED IN ACCORDANCE WITH SECTION 76(6) OF THE MINING ACT R.S.O. 1980.</p>

Special credits under section 77 (16) for the following mining claims

No credits have been allowed for the following mining claims

not sufficiently covered by the survey insufficient technical data filed

The Mining Recorder may reduce the above credits if necessary in order that the total number of approved assessment days recorded on each claim does not exceed the maximum allowed as follows: Geophysical - 80; Geological - 40; Geochemical - 40; Section 77(19) - 60.

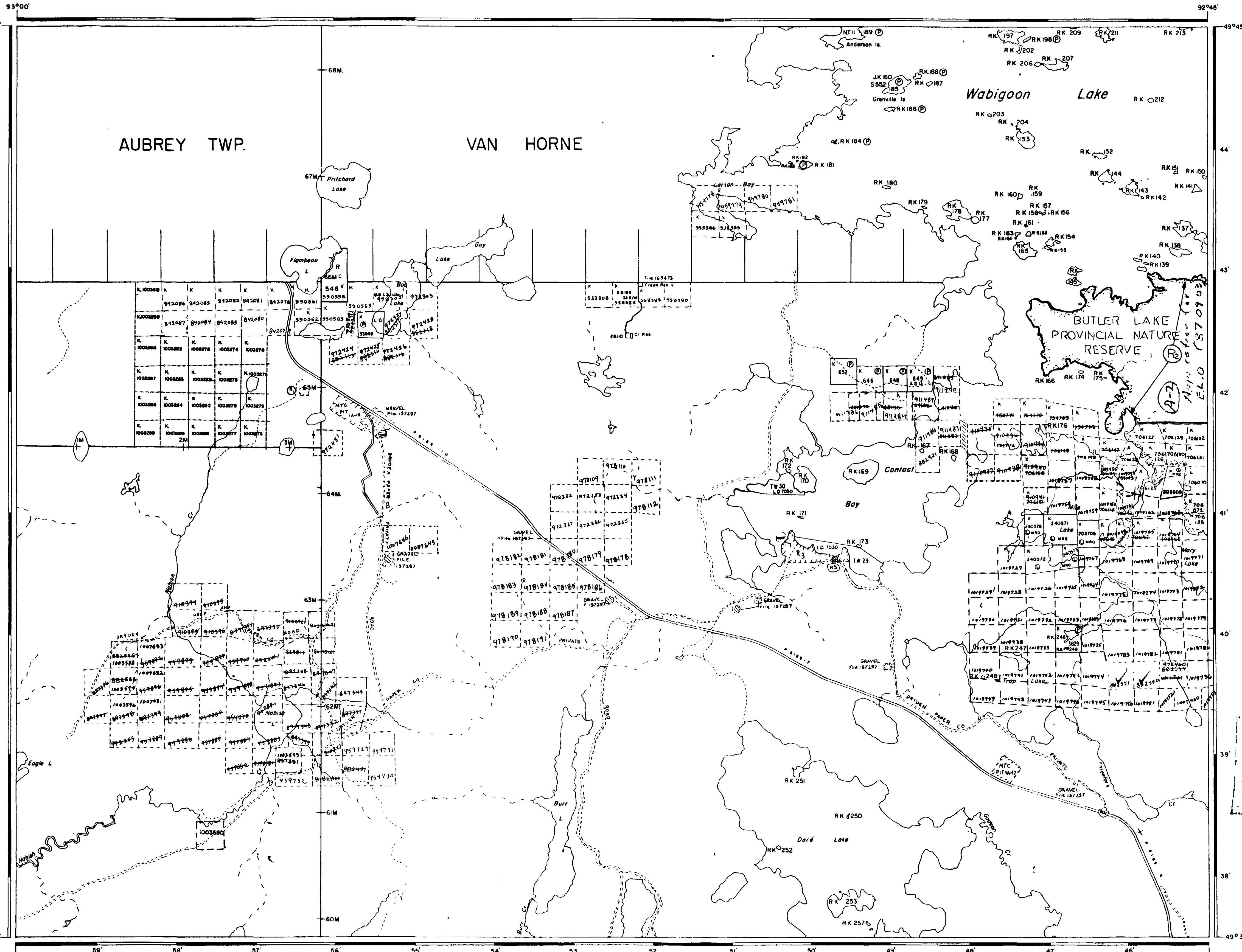

LEGEND

- HIGHWAY AND ROUTE No
- OTHER ROADS
- TRAILS
- SURVEYED LINES
- TOWNSHIP BASE LINES ETC.
- LOTS, MINING CLAIMS PARCELS, ETC.
- UNSURVEYED LINES
- PARCEL BOUNDARY
- MINING CLAIMS ETC.
- RAILWAY AND RIGHT OF WAY
- UTILITY LINES
- NON PERENNIAL STREAM
- FLOODING OR FLOODING RIGHTS
- SUBDIVISION OR COMPOSITE PLAN
- RESERVATIONS
- ORIGINAL SHORELINE
- MARSH OR MUSKEG
- MINES
- TRAVERSE MONUMENT

DISPOSITION OF CROWN LANDS

TYPE OF DOCUMENT	SYMBOL
PATENT SURFACE & MINING RIGHTS	
" SURFACE RIGHTS ONLY	
" MINING RIGHTS ONLY	
LEASE SURFACE & MINING RIGHTS	
" SURFACE RIGHTS ONLY	
" MINING RIGHTS ONLY	
LICENCE OF OCCUPATION	
ORDER IN COUNCIL	
RESERVATION	
CANCELLED	
SAND & GRAVEL	

NOTE: MINING RIGHTS IN PARCELS PATENTED PRIOR TO MAY 6 1913 VESTED IN ORIGINAL PATENTEES BY THE PUBLIC LANDS ACT, R.S.O. 1970 CHAP. 380, SEC. 63 SUBSEC. 1

REFERENCES

AREAS WITHDRAWN FROM DISPOSITION

M.R.O. - MINING RIGHTS ONLY
 S.R.O. - SURFACE RIGHTS ONLY
 M + S. - MINING AND SURFACE RIGHTS

Description	Order No.	Date	Disposition	File
(1)	W 76/77	26/3/77	S.R.O.	141004
(2)	W 54/55	9/15/85	M.R.O.	148814
(3)	Proposed Surface S.R.O.'s	Reservations 700/10/85	Public Lands Act	
(4)	Proposed Surface S.R.O.'s	Reservations 700/10/85	Cancelled	

All islands in Wabigoon Lake withdrawn from staking under Sec. 39 S.O.C. of Mining Act.

Roads indicated Dryden Paper Co Private Road may be used by Prospectors only after permission is obtained from Dryden Paper Co Dryden, Ont.

1985 Proposed Short Term LWD Spine 86

Effective as shown

SCALE 1 INCH = 40 CHAINS

AREA CONTACT BAY WABIGOON LAKE

M.N.R. ADMINISTRATIVE DISTRICT
 DRYDEN
 MINING DIVISION
 KENORA
 LAND TITLES / REGISTRY DIVISION
 KENORA

Ministry of Natural Resources
 Land Management Branch

Date JANUARY 1984
 Number **G-2579**

Buchan Bay G-2573

Butler Lake G-2576

Ukik Lake G-2596

