

52F10NW0084 22 CONTACT BAY (WABIG00

010

Diamond Drilling

Area of Contact Bay

Report N^o 22

Work performed by: Nichro Mines Ltd.

Claim N ^o	Hole N ^o	Footage	Date	Note
K240578	4	181'	Dec/71	(1)
	5	171'	Nov/71	(1)
	9	169'	Apr/72	(1)
K203699	6	182'	Jan/72	(1)
	12	142'	Jan/73	(4)
	13	164'	Jan/73	(4)
	14	137'	Jan/73	(4)
K240572	7B	180'	Mar/72	(1)
	15	172'	Jan/73	(4)
	16	154'	Jan/73	(4)
	17	146'	Feb/73	(4)
	18	128'	Feb/73	(5)
	19	161'	Feb/73	(3)
	20	145'	Feb/73	(6)
	K240571	8	163'	Mar/72
22		139'	Feb/73	(3)
K203700	10	168'	Apr/72	(2)
K240573	21	128'	Feb/73	(3)
K203705	23	167'	Feb/73	(4)
	24	159'	Feb/73	(3)
	25	137'	Feb/73	(3)
	26	149'	Feb/73	(5)
	27	150'	Mar/73	(4)
	28	163'	Mar/73	(5)
	29	127'	Mar/73	(5)
	32	143'	Mar/73	(5)

Notes:

continued.....

Diamond Drilling

Area of Contact Bay (continued) Report N^o 22

Work performed by:

Claim N ^o	Hole N ^o	Footage	Date	Note
K203698	30	146'	Mar/73	(5)
	31	124'	Mar/73	(5)

Notes:

(1) 30/72
(2) 31/72
(3) 13/73
(4) 14/73

(5) 15/73
(6) 16/73

Claim No. K-240570

4

1

Claim No. K-240578
Nichro Mines Ltd.

Claim No. K-240571

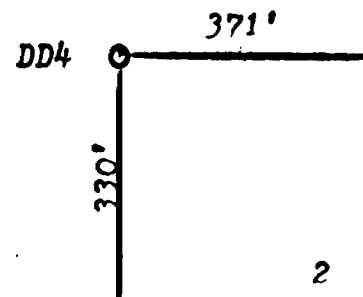

3

2

Claim No. K-240572



THE MINING ACT - DEPARTMENT OF MINES
DIAMOND DRILLING LOG

Start a new page for every new hole, but fill in top portion of form only on first page for each hole.

FILL IN ON EVERY PAGE

HOLE NO. **4** PAGE NO. **1**

DRILLING COMPANY Nichro Mines Ltd.		COLLAR ELEVATION 1280'	BEARING OF HOLE FROM TRUE NORTH	TOTAL FOOTAGE 181'	DIP OF HOLE AT collar 90	LOCATION OF HOLE IN RELATION TO A FIXED POINT ON THE CLAIM	MAP REFERENCE NO. M 2737	CLAIM NO. K-240578
DATE HOLE STARTED 12-4-71	DATE COMPLETED 12-20-71	DATE LOGGED 3-7-72	LOGGED BY Dr. A. S. Michaelson		181 ft		LOCATION (Tp., Lot, Con. OR Lat. and Long.)	
EXPLORATION CO., OWNER OR OPTIONEE Nichro Mines Ltd.		DATE SUBMITTED June 24, 72	SUBMITTED BY (Signature) <i>Janis R. Davis</i>		ft	PROPERTY NAME Nichro Mines Ltd		

FOOTAGE		ROCK TYPE	DESCRIPTION Colour, grain size, texture, minerals, alteration, etc.	PLANAR FEATURE ANGLE *	CORE SPECIMEN FOOTAGE +	YOUR SAMPLE NUMBER	SAMPLE FOOTAGE		SAMPLE LENGTH	ASSAYS +	
FROM	TO						FROM	TO			
0	12	lg - MASSIVE Sulp.	Lt. Gray - Copper Coloration, Pyrrhotite, Chalcopyrite, Pyrite,								
12	24	lg - MASSIVE Sulp.	Med. Gray - Chalcopyrite, Quartz, Pyrite								
24	34	lg - MASSIVE Sulp.	Med. Gray - Chalcopyrite, Pyrites, ultra-basie								
34	48	lg - MASS. Sulp.	DK. Gray - Chalcopyrites, Pyrrhotite, ultra-basie								
48	60	lg - MASS. Sulp.	DK. Gray - Chalcopyrites, Pyrrhotite, ultra-basie.								
60	72	lg - MASS Sulp.	DK. Gray - Chalcopyrites, Pyrrhotite, Asbestos, ultra-basie.								
72	84	lg - MASS Sulp.	DK. Gray - Black, Metalized, Chalcopyrite, Pyrrhotite, Pyrites.								
84	96	lg - MASS. Sulp.	DK. Gray - Black, Metalized, Chalcopyrite, Pyrrhotite, Pyrites.								
96	108	lg - MASS. Sulp.	Black-Gray - High Mag. Pyrrhotite, Pentlandite, Chalcopyrite								
108	120	lg - MASS. Sulp.	Lt. Gray - Asbestos, Diamagnetic, Chalcopyrite, Pyrite.								
120	132	lg - MASS. Sulp.	DK. Gray - Black spotting, High Mag. Pyrrhotite, Chalco, Pyrites.								
132	144	lg - MASS. Sulp.	Lt. Gray, Red Stain, Diamagnetic, Pyrrhotite, Chalco, Pyrites.								
144	156	lg - MASS. Sulp.	Lt. Gray, Red Stain, Diamagnetic, Pyrrhotite, Chalco, Pyrites.								
156	168	lg - MASS. Sulp.	Med Gray - DK Gray Pyrrhotite, Chalcopyrites, Pyrite								
168	180	lg - MASS. Sulp.	DK. Gray - Pyrrhotite, Chalcopyrites, Pyrites								
180	181	lg - MASS. Sulp.	DK. Gray - Black, Pyrrhotite, Asbestos, Chalco, Pyrites.								

#30/72 Nichro Mines
Contact Bay

* For features such as foliation, bedding, schistosity, measured from the long axis of the core.

Claim No. K-240570

4

1

Claim No, K-240578
Nichro Mines Ltd.

Claim No. K-240571

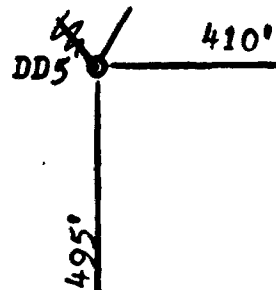

3

2

Claim No. K-240572





THE MINING ACT - DEPARTMENT OF MINES
DIAMOND DRILLING LOG

Start a new page for every new hole, but fill in top portion of form only on first page for each hole.

FILL IN ON EVERY PAGE

HOLE NO. **5** PAGE NO. **1**

DRILLING COMPANY Nickro Mines Ltd.		COLLAR ELEVATION 1280'	BEARING OF HOLE FROM TRUE NORTH N 35° E	TOTAL FOOTAGE 171'	DIP OF HOLE AT collar 45	LOCATION OF HOLE IN RELATION TO A FIXED POINT ON THE CLAIM	MAP REFERENCE NO. M 2737	CLAIM NO. K-240578
DATE HOLE STARTED 11-21-71	DATE COMPLETED 1-10-72	DATE LOGGED 3-7-72	LOGGED BY DR. A.S. Michelson	171 ft	45		LOCATION (Tp., Lot, Con. OR Lat. and Long.)	
EXPLORATION CO., OWNER OR OPTIONEE Nickro Mines Ltd		DATE SUBMITTED 6-26-72	SUBMITTED BY (Signature) <i>Janit R. J. Lewis</i>		ft		PROPERTY NAME Nickro Mines Ltd.	

FOOTAGE		ROCK TYPE	DESCRIPTION Colour, grain size, texture, minerals, alteration, etc.	PLANAR FEATURE ANGLE *	CORE SPECIMEN FOOTAGE +	YOUR SAMPLE NUMBER	SAMPLE FOOTAGE		SAMPLE LENGTH	ASSAYS +	
FROM	TO						FROM	TO			
0	12	lg-Mass Sulp.	Lt. Gray - Gabbro, Pyroxenite, Chalcopyrite, Pyrites								
12	24	lg-Mass Sulp.	Lt. Gray - Pyroxenite, Blue Quartz, Chalcopyrite, Pyroxenite								
24	36	lg-Mass Sulp.	Med. Gray - Chalcopyrite, Quartz, Pyrites, Med. Magnetite								
36	48	lg-Mass Sulp.	Med. Gray - Gabbro - coarse Hornblende Chalcopyrite, Pyrites								
48	60	lg-Mass Sulp.	Dk. Gray - ultra-basic, Chalcopyrite, Pentlandite, Pyroxenite								
60	72	lg-Mass Sulp.	Dk. Gray - Quartz streaks, Chalcopyrite, Pyroxenite, Pyrite, Ho. Mag.								
72	84	lg-Mass Sulp.	Dk. Gray - some metallic copper, Chalcopyrite, Pyrites								
84	96	lg-Mass Sulp.	Lt. Gray - copper stain, some xerites + diorites, Chalcopyrite								
96	108	lg-Mass Sulp.	Lt. Gray - Pyroxenite, Chalcopyrite, Pyrite - Med. Mag.								
108	120	lg-Mass Sulp.	Lt. Gray - Pyroxenite, Pentlandite, some limonite, Pyrites Lt. Mag.								
120	132	lg-Mass Sulp.	Dk. Gray - Black, Pyroxenite, Chalcopyrite, Pyrites - Med. Mag.								
132	144	lg-Mass Sulp.	Dk. Gray - Black - white streaks Chalcopyrite, Pyroxenite, Pyrite								
144	156	lg-Mass Sulp.	Med. Gray - Green streaks, Serpentine, Chalcopyrite, Pyrites								
156	168	lg-Mass Sulp.	Med. Gray - Black, Chalcopyrite, Pyroxenite, Ho. Mag.								
168	171	lg-Mass Sulp.	Dk. Gray - Black, Pyroxenite, Pentlandite, Chalcopyrite, Pyrites								

* For features such as foliation, bedding, schistosity, measured from the long axis of the core.

+ Additional credit available. See Assessment Work Regulations.

Claim No. K- 203703

Claim No. K- 203700

Claim No. K- 203695

4

1

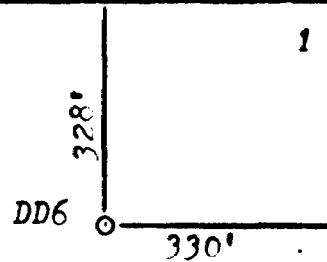

Claim No. K- 203704

Claim No. K-203699
Nichro Mines Ltd.

Claim No. K-203696

3

2

Claim No. K- 203705

Claim No. K- 203698

Claim No. K- 203697



THE MINING ACT - DEPARTMENT OF MINES
DIAMOND DRILLING LOG

Start a new page for every new hole, but fill in top portion of form only on first page for each hole.

FILL IN ON EVERY PAGE

HOLE NO. **6** PAGE NO. **1**

DRILLING COMPANY Nichro Mines Ltd.		COLLAR ELEVATION 1210'	BEARING OF HOLE FROM TRUE NORTH	TOTAL FOOTAGE 182'	DIP OF HOLE AT collar 90	LOCATION OF HOLE IN RELATION TO A FIXED POINT ON THE CLAIM	MAP REFERENCE NO. M 2737	CLAIM NO. K 203699	
DATE HOLE STARTED 1-30-72	DATE COMPLETED 2-18-72	DATE LOGGED 3-7-72	LOGGED BY A.S. Michaelson		182 ft 90		LOCATION (Tp., Lot, Con. OR Lat. and Long.)		
EXPLORATION CO., OWNER OR OPTIONEE Nichro Mines Ltd.		DATE SUBMITTED 6-24-72	SUBMITTED BY (Signature) <i>David R. J. Lewis</i>			ft	PROPERTY NAME Nichro Mines Ltd		

FOOTAGE		ROCK TYPE	DESCRIPTION Colour, grain size, texture, minerals, alteration, etc.	PLANAR FEATURE ANGLE	CORE SPECIMEN FOOTAGE +	YOUR SAMPLE NUMBER	SAMPLE FOOTAGE		SAMPLE LENGTH	ASSAYS +		
FROM	TO						FROM	TO				
0	10	Water	Cased									
10	40	Mud	Cased									
40	52	Ig-Mass Sulphides	Varied gray-Pyrrhotite, Chalcopyrites and Pyrites. Mag. Lt.									
52	64	Ig-Mass Sulphides	Dark gray- Pyrrhotite, Chalcopyrites and Pyrites. Mag. Lt.									
64	76	Ig-Mass Sulphides	Light gray- Asbestos fibers in serpentine. Some green color.									
76	88	Ig-Mass Sulphides	Light gray- Asbestos in serpentine. Ultra basic.									
88	100	Ig-Mass Sulphides	Light gray- Altered serpentine. Ultra basic. Pyrrhotite.									
100	112	Ig-Mass Sulphides	Dark gray- Pyrrhotite, Chalcopyrites and Pyrites. Mag. Lt.									
112	124	Ig-Mass Sulphides	Dark gray- Pyrrhotite, Chalcopyrites and Pyrites. Mag. Strong									
124	136	Ig-Mass Sulphides	Dark gray- some red. Pyrrhotite, Pentlandite and Pyrites.									
136	148	Ig-Mass Sulphides	Dark gray- Heavy metallic zones, Pyrrhotite. Mag. Med.									
148	160	Ig-Mass Sulphides	Dark gray- Mineralization heavy. Pyrrhotite, Pent. Mag. Strong									
160	172	Ig-Mass Sulphides	Dark gray- black. Pyrrhotite, Chalcopyrites, Pyrites. Mag. Str.									
172	182	Ig-Mass Sulphides	Dark gray- black. Pyrrhotite, Chalcopyrites, Pyrites. Mag. Str.									

* For features such as foliation, bedding, schistosity, measured from the long axis of the core.

+ Additional credit available. See Assessment Work Regulations.

Claim No. K-240578

Claim No. K-240571

Claim No. K-203705

4

1

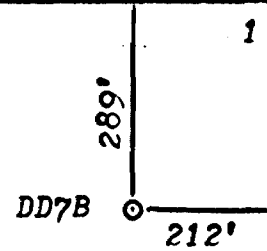

Claim No. K-240572

Claim No. K-240573

3

2

Claim No. K-240577

Claim No. K-240576



THE MINING ACT - DEPARTMENT OF MINES
DIAMOND DRILLING LOG

Start a new page for every new hole, but fill in top portion of form only on first page for each hole.

FILL IN ON EVERY PAGE

HOLE NO. 7B PAGE NO. 1

DRILLING COMPANY Nichro Mines Ltd.		COLLAR ELEVATION 1211	BEARING OF HOLE FROM TRUE NORTH	TOTAL FOOTAGE 180	DIP OF HOLE AT collar 90°	LOCATION OF HOLE IN RELATION TO A FIXED POINT ON THE CLAIM	MAP REFERENCE NO. M 2737	CLAIM NO. K-240572
DATE HOLE STARTED 3-4-72	DATE COMPLETED 3-10-72	DATE LOGGED 4-10-72	LOGGED BY DR. A.S. Michaelson	180 ft	90°		LOCATION (Tp., Lot, Con. OR Lat. and Long.)	
EXPLORATION CO., OWNER OR OPTIONEE Nichro Mines Ltd.		DATE SUBMITTED 6-26-72	SUBMITTED BY (Signature) <i>Janil R. J. Jwin</i>		ft	PROPERTY NAME Nichro Mines Ltd.		

FOOTAGE		ROCK TYPE	DESCRIPTION Colour, grain size, texture, minerals, alteration, etc.	PLANAR FEATURE ANGLE *	CORE SPECIMEN FOOTAGE +	YOUR SAMPLE NUMBER	SAMPLE FOOTAGE		SAMPLE LENGTH	ASSAYS +	
FROM	TO						FROM	TO			
0	12	lg-Mass. Sulp.	Dk. Gray - Magnetite, Pyrrhotite, Chalcopyrite, native copper ste.								
12	24	lg-Mass. Sulp.	Dk. Gray - Pyrrhotite, Chalcopyrite, Cobaltite, Pyrites.								
24	36	lg-Mass. Sulp.	Dk. Gray - Magnetite, Mag. ste, Chalcopyrite, Pyrrhotite								
36	48	lg-Mass Sulp.	Dk. Gray to Black - Magnetite, Pyrrhotite, Chalcopyrite, Pyrites								
48	60	lg-Mass Sulp.	Mottled Gray - Asbestos Fibres, waxy, Chalcopyrite								
60	72	lg-Mass Sulp.	Varies Gray - Asbestos Fibres in serpentine (altered)								
72	84	lg-Mass Sulp.	Mottled Gray - Copper staining, Magnetic, Chalcopyrite.								
84	96	lg-Mass Sulp.	Reddish stain of Chalcopyrite, Pyrrhotite, Pyrites								
96	108	lg-Mass Sulp.	Copper stain - Lt. Mag. Black streaks Pyrrhotite, Pyrites								
108	120	lg-Mass Sulp.	Deep Black Gray - High Mag. 2 ft. talc, Chalcopyrite								
120	132	lg-Mass Sulp.	Lt Gray - Gneiss, highly mineralized, many metallic part.								
132	144	lg-Mass Sulp.	Lt Gray - Green streaks, Chalcopyrite, Pyrrhotite, Pyrites								
144	156	lg-Mass Sulp.	Lt Gray - Green streaks, Chalcopyrite, Pyrrhotite, Pyrites								
156	168	lg-Mass Sulp.	Med. Gray - fine grained, Chalcopyrite								
168	180	lg-Mass Sulp.	Black - some red streaks, many metallic particles, Chalcopyrite.								

* For features such as foliation, bedding, schistosity, measured from the long axis of the core.

+ Additional credit available. See Assessment Work Regulations.

Claim No. K-240570

Claim No. K-203704

4

1

Claim No. K- 240578

Claim No. K-240571
Nichro Mines Ltd.

Claim No. K-203705



165'

DD8

490'

3

2

Claim No. K-240572

Claim No. K-240573



THE MINING ACT - DEPARTMENT OF MINES
DIAMOND DRILLING LOG

Start a new page for every new hole, but fill in top portion of form only on first page for each hole.

FILL IN ON EVERY PAGE

HOLE NO. **8** PAGE NO. **1**

DRILLING COMPANY Nichro Mines Ltd.		COLLAR ELEVATION 1210	BEARING OF HOLE FROM TRUE NORTH	TOTAL FOOTAGE 163	DIP OF HOLE AT collar 90	LOCATION OF HOLE IN RELATION TO A FIXED POINT ON THE CLAIM	MAP REFERENCE NO. M-2737	CLAIM NO. K-240571	
DATE HOLE STARTED 3-11-72	DATE COMPLETED 3-13-72	DATE LOGGED 4-10-72	LOGGED BY DR. A.S. Michaelson		163 ft 90		LOCATION (Tp., Lot, Con. OR Lat. and Long.)	PROPERTY NAME Nichro Mines Ltd	
EXPLORATION CO., OWNER OR OPTIONEE Nichro Mines Ltd		DATE SUBMITTED 6-26-72	SUBMITTED BY (Signature) <i>Janif R. J. Lewis</i>		ft				

FOOTAGE		ROCK TYPE	DESCRIPTION Colour, grain size, texture, minerals, alteration, etc.	PLANAR FEATURE ANGLE *	CORE SPECIMEN FOOTAGE +	YOUR SAMPLE NUMBER	SAMPLE FOOTAGE		SAMPLE LENGTH	ASSAYS +	
FROM	TO						FROM	TO			
0	19	Water	Cased								
19	107	MUD	Cased - flowing water green sand								
107	119	IG - Mass Sulph.	Dk. Gray - Lt. Mg. Chalcopyrite, Pyrrhotite, Pyrites.								
119	131	IG - Mass Sulph.	Dk Gray - Black, Lt. Mag, chalcocite, Pyrrhotite, Pyrites.								
131	143	IG - Mass Sulph.	Dk Gray Black, Chalcopyrite Pyrrhotite, some grey streaks								
143	155	IG - Mass Sulph.	Black - chalcopyrite, some native copper, Pyrrhotite								
155	163	IG - Mass Sulph.	Black - Asbestos fibres, chalcopyrite, Pyrrhotite, Pyrites.								

* For features such as foliation, bedding, schistosity, measured from the long axis of the core.

+ Additional credit available. See Assessment Work Regulations.

Claim No. K- 240570

4

1



Claim No, K- 240578
Nichro Mines Ltd.

Claim No. K-240571



3

2

Claim No. K-240572



THE MINING ACT - DEPARTMENT OF MINES
DIAMOND DRILLING LOG

Start a new page for every new hole, but fill in top portion of form only on first page for each hole.

FILL IN ON EVERY PAGE

HOLE NO. **9** PAGE NO. **1**

DRILLING COMPANY Nichro Mines Ltd		COLLAR ELEVATION 1210	BEARING OF HOLE FROM TRUE NORTH	TOTAL FOOTAGE 169	DIP OF HOLE AT collar 90	LOCATION OF HOLE IN RELATION TO A FIXED POINT ON THE CLAIM	MAP REFERENCE NO. M-2737	CLAIM NO. 240578		
DATE HOLE STARTED 4-18-72	DATE COMPLETED 4-24-72	DATE LOGGED 5-3-72	LOGGED BY Dr. A.S. Michaelson		169 ft 90		LOCATION (Tp., Lot, Con. OR Lat. and Long.) 240578			
EXPLORATION CO., OWNER OR OPTIONEE Nichro Mines Ltd		DATE SUBMITTED 6-26-72	SUBMITTED BY (Signature) Daniel R.T. Davis		ft			PROPERTY NAME Nichro Mines Ltd.		
					ft					

FOOTAGE		ROCK TYPE	DESCRIPTION Colour, grain size, texture, minerals, alteration, etc.	PLANAR FEATURE ANGLE *	CORE SPECIMEN FOOTAGE +	YOUR SAMPLE NUMBER	SAMPLE FOOTAGE		SAMPLE LENGTH	ASSAYS +		
FROM	TO						FROM	TO				
0	16	Water	Cased									
16	118	Mud	Cased									
118	130	lg - Mass Sulp	Lt Gray, Chalcopyrite, Pyrrhotite, Pyrites. Mt. Mag.									
130	142	lg - Mass Sulp	Med Gray, Magnetite, Chalcopyrites, Pyrites									
142	154	lg - Mass Sulp	Med Gray, Chalcopyrites, Pyrrhotite, Pyrites									
154	166	lg - Mass Sulp	Dark Gray - Black, Chalcopyrite, Pyrrhotite, Pyrite.									
166	169	lg - Mass Sulp	Black - sulphides present - badly fractured, hole abandoned									

* For features such as foliation, bedding, schistosity, measured from the long axis of the core.

+ Additional credit available. See Assessment Work Regulations.

Claim No. K-203702

Claim No. K-203701

Claim No. K-203694

Claim No. K-203703

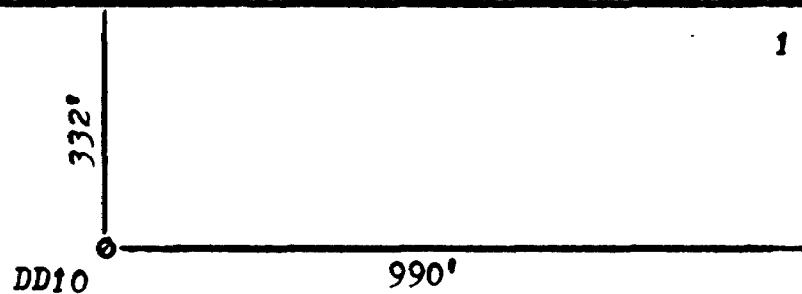

Claim No. K-203700
Nichro Mines Ltd.

Claim No. K-203695



Claim No. K-203704

Claim No. K-203699

Claim No. K-203696



THE MINING ACT - DEPARTMENT OF MINES
DIAMOND DRILLING LOG

Start a new page for every new hole, but fill in top portion of form only on first page for each hole.

FILL IN ON EVERY PAGE

HOLE NO. 10 PAGE NO. 1

DRILLING COMPANY Nichro Mines Ltd.		COLLAR ELEVATION 1210'	BEARING OF HOLE FROM TRUE NORTH	TOTAL FOOTAGE 168	DIP OF HOLE AT collar 90	LOCATION OF HOLE IN RELATION TO A FIXED POINT ON THE CLAIM	MAP REFERENCE NO. M 2737	CLAIM NO. K203700	
DATE HOLE STARTED 4-18-72	DATE COMPLETED 4-24-72	DATE LOGGED 5-3-72	LOGGED BY Dr. P.S. Michelson		168 ft		90	LOCATION (Tp., Lot, Con. OR Lat. and Long.)	
EXPLORATION CO., OWNER OR OPTIONEE Nichro Mines Ltd.		DATE SUBMITTED 6-27-72	SUBMITTED BY (Signature) Janet M. Quinn			ft		PROPERTY NAME Nichro Mines Ltd.	

FOOTAGE		ROCK TYPE	DESCRIPTION Colour, grain size, texture, minerals, alteration, etc.	PLANAR FEATURE ANGLE *	CORE SPECIMEN FOOTAGE +	YOUR SAMPLE NUMBER	SAMPLE FOOTAGE		SAMPLE LENGTH	ASSAYS +	
FROM	TO						FROM	TO			
0	5	Water	Cased								
5	27	Igneous	Some iron stain - diorites - some chalcopyrite, pyrite.								
27	62	Igneous	Serpentine stringers - talc - No Mag.								
62	68	Igneous	Greenish asbestos - altered serpentine - No Mag.								
68	114	Igneous	lt. green talc - some quartz - some sulphides								
114	131	Igneous-Sulphides	Med Gray, Chalcopyrites, pyrites.								
131	140	Ig - Sulphides	Med Gray, Chalcopyrites, Pyrrhotite, pyrite, Lt. Mag.								
140	152	Ig - Sulphides	Gray-Black chalcopyrites, Pyrrhotite, Lt. Mag								
152	164	Ig - Mass Sulphide	Black, Chalcopyrites, Pyrrhotite, pyrites, featuring								
164	168	Ig - Mass Sulphide	Black - sulphides present - core jamming in borehole								

* For features such as foliation, bedding, schistosity, measured from the long axis of the core.

+ Additional credit available. See Assessment Work Regulations.

Claim No. K-203703

Claim No. K-203700

Claim No. K-203695

Claim No. K-203704

Claim No. K-203698
Nichro Mines Ltd.

Claim No. K-203696

Claim No. K-203705

Claim No. K-203698

Claim No. K-203697

4

1

450'

DD 12

125'



3

2



DIAMOND DRILLING LOG

Start a new page for every new hole, but fill in top portion of form only on first page for each hole.

FILL IN ON EVERY PAGE

HOLE NO. 12 PAGE NO. 1

DRILLING COMPANY NICHRO MINES LTD		COLLAR ELEVATION 1216	BEARING OF HOLE FROM TRUE NORTH 142	DIP OF HOLE AT COLLAR 70	LOCATION OF HOLE IN RELATION TO A FIXED POINT ON THE CLAIM	MAP REFERENCE NO. M-2737	CLAIM NO. K-203699
DATE HOLE STARTED 1-21-73	DATE COMPLETED 1-23-73	DATE LOGGED 3-15-73	LOGGED BY <i>W. Davis</i>	142 ft	90	LOCATION (Tp., Lot, Con. OR Lot. and Long.)	
EXPLORATION CO., OWNER OR OPTIONEE NICHRO MINES LTD		DATE SUBMITTED	SUBMITTED BY (Signature) <i>Saul Glover</i>	ft	ft	PROPERTY NAME	

FOOTAGE		ROCK TYPE	DESCRIPTION <small>Colour, grain size, texture, minerals, alteration, etc.</small>	PLANAR FEATURE ANGLE	CORE SPECIMEN FOOTAGE	YOUR SAMPLE NUMBER	SAMPLE FOOTAGE		SAMPLE LENGTH	ASSAYS +
FROM	TO						FROM	TO		
0	14	Water	Closed							
14	68	Mud	Closed							
68	93	Tg - Gabbro	Lt. grey - fine sulphides disseminated throughout							
93	101	Serpentine	Med green - some metallic copper + chalcopurite							
101	104	Serpentine	Med green - asbestos stringers							
104	142	Gabbro	Dk. grey - fine sulphides, med. magnetic							

+ Additional credit available. See Assessment Work Regulations.

Claim No. K-203703

Claim No. K-203700

Claim No. K-203695

Claim No. K-203704

Claim No. K-203699
Nichro Mines Ltd.

Claim No. K-203696

Claim No. K-203705

Claim No. K-203698

Claim No. K-203697

4

DD 13 150'

150'

1

150'

N
↑

3

2



THE MINING ACT - DEPARTMENT OF MINES
DIAMOND DRILLING LOG

Start a new page for every new hole, but fill in top portion of form only on first page for each hole.

FILL IN ON EVERY PAGE

HOLE NO. 13 PAGE NO. 1

DRILLING COMPANY NICHRO MINES LTD.		COLLAR ELEVATION 1210	BEARING OF HOLE FROM TRUE NORTH	TOTAL FOOTAGE 164	DIP OF HOLE AT COLLAR 90	LOCATION OF HOLE IN RELATION TO A FIXED POINT ON THE CLAIM	MAP REFERENCE NO. M-2737	CLAIM NO. K-203699	
DATE HOLE STARTED 1-23-73	DATE COMPLETED 1-24-73	DATE LOGGED 3-15-73	LOGGED BY L.P. Davis		164 ft		90	LOCATION (Tp., Lot, Con. OR Lat. and Long.)	
EXPLORATION CO., OWNER OR OPTIONEE NICHRO MINES LTD.		DATE SUBMITTED	SUBMITTED BY (Signature) <i>Paul Cleaver</i>		ft		ft	PROPERTY NAME	

FOOTAGE		ROCK TYPE	DESCRIPTION Colour, grain size, texture, minerals, alteration, etc.	PLANAR FEATURE ANGLE *	CORE SPECIMEN FOOTAGE *	YOUR SAMPLE NUMBER	SAMPLE FOOTAGE		SAMPLE LENGTH	ASSAYS +		
FROM	TO						FROM	TO				
0	16	Water	Cased									
16	58	Mud	Cased									
58	89	Gabbro	Varied lt. gray, fine grained, disseminated sulphides									
89	107	Serpentine	med. green, Chalcopite & metallic copper, asbestos									
107	150	Gabbro	Dr. gray, fine sulphides, magnetic									
150	164	Gabbro	Varied lt. & med gray, fine grained, sulphides									
164	-	-	best core and short core barrel									

* For features such as foliation, bedding, schistosity, measured from the long axis of the core.

+ Additional credit available. See Assessment Work Regulations.

14/73

Claim No. K-203703

Claim No. K-203700

Claim No. K-203695

4

1

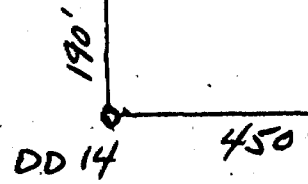

Claim No. K-203704

Claim No. K-203699
Nichro Mines Ltd.

Claim No. K-203696

3

2

Claim No. K-203705

Claim No. K-203698

Claim No. K-203697



THE MINING ACT - DEPARTMENT OF MINES
DIAMOND DRILLING LOG

Start a new page for every new hole, but fill in top portion of form only on first page for each hole.

FILL IN ON EVERY PAGE

HOLE NO. 14
PAGE NO. 1

DRILLING COMPANY <i>NICHRO MINES LTD</i>		COLLAR ELEVATION	BEARING OF HOLE FROM TRUE NORTH	TOTAL FOOTAGE <i>137</i>	DIP OF HOLE AT collar <i>90</i>	LOCATION OF HOLE IN RELATION TO A FIXED POINT ON THE CLAIM	MAP REFERENCE NO. <i>M-2737</i>	CLAIM NO. <i>205699</i>
DATE HOLE STARTED <i>1-25-73</i>	DATE COMPLETED <i>1-25-73</i>	DATE LOGGED <i>3-15-73</i>	LOGGED BY <i>L. Davis</i>	<i>137</i> ft	<i>90</i>		LOCATION (Tp., Lot, Con. OR Lat. and Long.)	
EXPLORATION CO., OWNER OR OPTIONEE <i>NICHRO MINES LTD</i>		DATE SUBMITTED	SUBMITTED BY (Signature) <i>Paul Cleaver</i>		ft		PROPERTY NAME	

FOOTAGE		ROCK TYPE	DESCRIPTION <small>Colour, grain size, texture, minerals, alteration, etc.</small>	PLANAR FEATURE ANGLE *	CORE SPECIMEN FOOTAGE †	YOUR SAMPLE NUMBER	SAMPLE FOOTAGE		SAMPLE LENGTH	ASSAYS ‡	
FROM	TO						FROM	TO			
<i>0</i>	<i>12</i>	<i>Water</i>	<i>Cased</i>								
<i>12</i>	<i>34</i>	<i>Mud</i>	<i>Cased</i>								
<i>34</i>	<i>76</i>	<i>Gabbro</i>	<i>lt gray, fine grained, pyrochroite, chalcocyanite, pyrites</i>								
<i>76</i>	<i>97</i>	<i>Serpentine</i>	<i>med green, some asbestos + metallic luster</i>								
<i>97</i>	<i>137</i>	<i>Gabbro</i>	<i>Dk gray, fine grained, disseminated sulphides</i>								

* For features such as foliation, bedding, schistosity, measured from the long axis of the core.

† Additional credit available. See Assessment Work Regulations.

K-240578

K-240571

K-203705

4

1

K-240572
NICHRO MINES LTD

DD15

125'

K-240573

925'



3

2

K-240577

K-240576



THE MINING ACT - DEPARTMENT OF MINES
DIAMOND DRILLING LOG

Start a new page for every new hole, but fill in top portion of form only on first page for each hole.

FILL IN ON EVERY PAGE

HOLE NO. 15 PAGE NO. 1

DRILLING COMPANY NICHRO MINES LTD		COLLAR ELEVATION 1210	BEARING OF HOLE FROM TRUE NORTH EAST	TOTAL FOOTAGE 172	DIP OF HOLE AT collar 60	LOCATION OF HOLE IN RELATION TO A FIXED POINT ON THE CLAIM	MAP REFERENCE NO.	CLAIM NO. K-240572
DATE HOLE STARTED 1-27-73	DATE COMPLETED 1-29-73	DATE LOGGED 3-15-73	LOGGED BY L. Lewis	172 ft	60		LOCATION (Tp., Lot, Con. OR Lat. and Long.)	PROPERTY NAME
EXPLORATION CO., OWNER OR OPTIONEE NICHRO MINES LTD		DATE SUBMITTED	SUBMITTED BY (Signature) Paul Pleasance	ft	ft			

FOOTAGE		ROCK TYPE	DESCRIPTION Colour, grain size, texture, minerals, alteration, etc.	PLANAR FEATURE ANGLE *	CORE SPECIMEN FOOTAGE +	YOUR SAMPLE NUMBER	SAMPLE FOOTAGE		SAMPLE LENGTH	ASSAYS +	
FROM	TO						FROM	TO			
0	48	Gabbro	Dk. Gray - med grained, disseminated sulphides, metallic copper								
48	67	Serpentine	Mottled gray - asbestos fibers, waxy, sulphides								
67	85	Gabbro	Med gray - red staining, disseminated sulphides								
85	101	Gabbro	Med gray - copper staining, disseminated sulphides								
101	116	Gabbro	Dk. gray - fine grained, pyrochlore, chalcocite, magnetite								
116	143	Gabbro	Lt. gray - fine grained, green streaks, sulphides								
143	172	Gabbro	Black - fine grained, red streaks, disseminated sulphides								

* For features such as foliation, bedding, schistosity, measured from the long axis of the core.

+ Additional credit available. See Assessment Work Regulations.

15/73

K-240578

K-240571

K-203705

4

1

K-240572

NICHO MINES LTD.

DD160 200'

875'

K-240573



3

2

K-240577

K-240576



DIAMOND DRILLING LOG

Start a new page for every new hole, but fill in top portion of form only on first page for each hole.

FILL IN ON EVERY PAGE

HOLE NO.	PAGE NO.
16	1

DRILLING COMPANY NICHRO MINES LTD.		COLLAR ELEVATION 1210	BEARING OF HOLE FROM TRUE NORTH	TOTAL FOOTAGE 154	DIP OF HOLE AT collar 90	LOCATION OF HOLE IN RELATION TO A FIXED POINT ON THE CLAIM	MAP REFERENCE NO. M-2237	CLAIM NO. K 240522
DATE HOLE STARTED 1-30-73	DATE COMPLETED 2-1-73	DATE LOGGED 3-15-73	LOGGED BY P. Lewis	154 ft	90		LOCATION (Tp., Lot, Con. OR Lat. and Long.)	
EXPLORATION CO., OWNER OR OPTIONEE NICHRO MINES LTD.		DATE SUBMITTED	SUBMITTED BY (Signature) <i>Paul Pleaver</i>		ft		PROPERTY NAME	

FOOTAGE		ROCK TYPE	DESCRIPTION Colour, grain size, texture, minerals, alteration, etc.	PLANAR FEATURE ANGLE *	CORE SPECIMEN FOOTAGE +	YOUR SAMPLE NUMBER	SAMPLE FOOTAGE		SAMPLE LENGTH	ASSAYS +
FROM	TO						FROM	TO		
0	10	Water	Closed							
10	64	Mud	Closed							
64	97	Gabbro	Med grey - fine grained, red staining, disseminated sulphides							
97	110	Gabbro	Med. grey, fine grained, metallic copper, disseminated sulphides							
110	124	Gabbro	Dk grey, fine grained, disseminated sulphides							
124	154	Gabbro	lt grey, fine grained, grey streaks, disseminated sulphides							

+ Additional credit available. See Assessment Work Regulations.

K 240578

K-240571

K-203705

4

1

K-240572

NICHRO MINES LTD

DD170

320'

K-240573

N



698'

2

3

K-240577

K-240576



DIAMOND DRILLING LOG

Start a new page for every new hole, but fill in top portion of form only on first page for each hole.

FILL IN ON EVERY PAGE

HOLE NO.	PAGE NO.
17	1

14173

DRILLING COMPANY NICHRO MINES LTD		COLLAR ELEVATION	BEARING OF HOLE FROM TRUE NORTH	TOTAL FOOTAGE 146	DIP OF HOLE AT collar 90	LOCATION OF HOLE IN RELATION TO A FIXED POINT ON THE CLAIM	MAP REFERENCE NO. M 2237	CLAIM NO. K-240572
DATE HOLE STARTED 2-2-73	DATE COMPLETED 2-3-73	DATE LOGGED 3-15-73	LOGGED BY <i>C. Lewis</i>	146 ft	90		LOCATION (Tp., Lot, Con. OR Lat. and Long.)	PROPERTY NAME
EXPLORATION CO., OWNER OR OPTIONEE NICHRO MINES LTD		DATE SUBMITTED	SUBMITTED BY (Signature) <i>Paul Phaver</i>	ft	ft			

FOOTAGE		ROCK TYPE	DESCRIPTION Colour, grain size, texture, minerals, alteration, etc.	PLANAR FEATURE ANGLE +	CORE SPECIMEN FOOTAGE +	YOUR SAMPLE NUMBER	SAMPLE FOOTAGE		SAMPLE LENGTH	ASSAYS +	
FROM	TO						FROM	TO			
0	16	Water	Cased								
16	62	Mud	Cased								
62	84	Gabbro	Varied grey + lt. green, some asbestos in serpentine stringers								
84	103	Gabbro	Med grey, fine grained, disseminated sulphides								
103	120	Gabbro	Dk grey, fine grained, olivocaprites, pyrrhotite, pyrites								
120	146	Gabbro	lt grey, fine grained, Md streaks, metallic copper								

* For features such as foliation, bedding, schistosity, measured from the long axis of the core.

+ Additional credit available. See Assessment Work Regulations.

K-240578

K-240571

K-203705

4

1

K-240572
NICHRO MINES LTD.



DD 18

73'

587'

K-240573

3

2

K-240577

K-240576



DIAMOND DRILLING LOG

Start a new page for every new hole, but fill in top portion of form only on first page for each hole.

FILL IN ON EVERY PAGE

HOLE NO. 18 PAGE NO. 1

DRILLING COMPANY <i>NICHRO MINES LTD</i>		COLLAR ELEVATION <i>1210</i>	BEARING OF HOLE FROM TRUE NORTH <i>128</i>	TOTAL FOOTAGE <i>128</i>	DIP OF HOLE AT COLLAR <i>90</i>	LOCATION OF HOLE IN RELATION TO A FIXED POINT ON THE CLAIM	MAP REFERENCE NO. <i>M 2737</i>	CLAIM NO. <i>H 240522</i>
DATE HOLE STARTED <i>2-4-73</i>	DATE COMPLETED <i>2-4-73</i>	DATE LOGGED <i>3-16-73</i>	LOGGED BY <i>Paul Chaves</i>		<i>129</i> ft		LOCATION (Tp., Lot, Con. OR Lat. and Long.)	
EXPLORATION CO., OWNER OR OPTIONEE <i>NICHRO MINES LTD</i>		DATE SUBMITTED	SUBMITTED BY (Signature) <i>Paul Chaves</i>		ft		PROPERTY NAME	
					ft			

FOOTAGE		ROCK TYPE	DESCRIPTION	PLANAR FEATURE ANGLE *	CORE SPECIMEN FOOTAGE +	YOUR SAMPLE NUMBER	SAMPLE FOOTAGE		SAMPLE LENGTH	ASSAYS +
FROM	TO		Colour, grain size, texture, minerals, alteration, etc.				FROM	TO		
0	9	Water	Cased							
9	47	Mud	Cased							
47	62	Serpentine	Med. green - asbestos stringers, waxy sulphides							
62	93	Gabbro	Med grey - fine grained, chlorite, pyroxene, quartz.							
93	117	Gabbro	Lt grey - fine grained, disseminated sulphides							
117	128	Gabbro	Dk grey - blocky fractured, dog barrel, abundant							

* For features such as foliation, bedding, schistosity, measured from the long axis of the core.

+ Additional credit available. See Assessment Work Regulations.

K-240578

K-240571

K-203905

4

1

K-240572

NICHRO MINES LTD

DD19

500'

825'

K-240573

Contract Bay

Report # 73-13

Nichro Mines Ltd

3

2





THE MINING ACT - DEPARTMENT OF MINES
DIAMOND DRILLING LOG

Start a new page for every new hole, but fill in top portion of form only on first page for each hole.

FILL IN ON EVERY PAGE

HOLE NO. 19
PAGE NO. 1

DRILLING COMPANY NICHRO MINES LTD		COLLAR ELEVATION 1216	BEARING OF HOLE FROM TRUE NORTH	TOTAL FOOTAGE 141	DIP OF HOLE AT collar 90	LOCATION OF HOLE IN RELATION TO A FIXED POINT ON THE CLAIM	MAP REFERENCE NO. M-2237	CLAIM NO. M 240592	
DATE HOLE STARTED 2-5-73	DATE COMPLETED 2-7-73	DATE LOGGED 3-16-73	LOGGED BY D. Lewis	141 ft	90		LOCATION (Tp., Lot, Con. OR Lat. and Long.)		
EXPLORATION CO., OWNER OR OPTIONEE NICHRO MINES LTD		DATE SUBMITTED	SUBMITTED BY (Signature) Paul McLean		ft		PROPERTY NAME		

FOOTAGE		ROCK TYPE	DESCRIPTION Colour, grain size, texture, minerals, alteration, etc.	PLANAR FEATURE ANGLE °	CORE SPECIMEN FOOTAGE	HOLE SAMPLE NUMBER	SAMPLE FOOTAGE		SAMPLE LENGTH	ASSAYS
FROM	TO						FROM	TO		
0	8	Water	Cased							
8	51	Mud	Cased							
51	84	Gabbro	Med gray - fine grained, green streaks, disseminated sulphides							
84	96	Gabbro	Dk gray - fine grained, waxy talc stringers, sulphides							
96	115	Serpentine	Med green, asbestos stringers, metallic copper							
115	143	Gabbro	Lt gray - fine grain, disseminated sulphides							
143	141	Gabbro	Dk gray, fine grain, red streaks, disseminated sulphides							

K-240578

K-240571

K-203705

4

DD 20
100'
36'

Conical Range
Report # 73-16
Niche Mines Ltd.

K-240572
NICHRO MINES LTD.

K-240573



3

2

K-240577

K-240576



DIAMOND DRILLING LOG

Start a new page for every new hole, but fill in top portion of form only on first page for each hole.

FILL IN ON EVERY PAGE

HOLE NO. 20 PAGE NO. 1

DRILLING COMPANY NICHRO MINES LTD		COLLAR ELEVATION 1210	BEARING OF HOLE FROM TRUE NORTH	TOTAL FOOTAGE 145	DIP OF HOLE AT collar 90	LOCATION OF HOLE IN RELATION TO A FIXED POINT ON THE CLAIM	MAP REFERENCE NO. M-2737	CLAIM NO. 240502	
DATE HOLE STARTED 2-10-73	DATE COMPLETED 2-11-73	DATE LOGGED 3-16-73	LOGGED BY P. Lewis	145 ft 90	ft		LOCATION (Tp., Lot, Con. OR Lat. and Long.)	PROPERTY NAME	
EXPLORATION CO., OWNER OR OPTIONEE NICHRO MINES LTD		DATE SUBMITTED	SUBMITTED BY (Signature) <i>Paul P. Lewis</i>		ft				

FOOTAGE		ROCK TYPE	DESCRIPTION Colour, grain size, texture, minerals, alteration, etc.	PLANAR FEATURE ANGLE *	CORE SPECIMEN FOOTAGE +	YOUR SAMPLE NUMBER	SAMPLE FOOTAGE		SAMPLE LENGTH	ASSAYS +	
FROM	TO						FROM	TO			
0	12	Water	Closed								
12	51	Mud	Closed								
51	94	Gabbro	Med gray - fine grained, disseminated sulphides								
94	102	Serpentine	Med green, asbestos stringers, chalcophyllite								
102	107	Asbestos	lt green, asbestos fibers + serpentine stringers								
107	128	Serpentine	lt green, blue streaks, metallic copper, sulphides								
128	145	Gabbro	Dr gray, fine grained, magnetite? sulphides								

* For features such as foliation, bedding, schistosity, measured from the long axis of the core.

16173



K-240571

K-203705

K-203698

4

225'

150'

DD21

1

K-240572

K-240573

NICHRO MINES LTD.

K-240574



3

2

K-240577

K-240576

K-240575



THE MINING ACT - DEPARTMENT OF MINES
DIAMOND DRILLING LOG

Start a new page for every new hole, but fill in top portion of form only on first page for each hole.

FILL IN ON EVERY PAGE

HOLE NO. 21 PAGE NO. 1

DRILLING COMPANY NICHRO MINES LTD.		COLLAR ELEVATION 1210	BEARING OF HOLE FROM TRUE NORTH 128	TOTAL FOOTAGE 128	DIP OF HOLE AT collar 90	LOCATION OF HOLE IN RELATION TO A FIXED POINT ON THE CLAIM	MAP REFERENCE NO. M 2737	CLAIM NO. 14-240373
DATE HOLE STARTED 2-12-73	DATE COMPLETED 2-12-73	DATE LOGGED 3-16-73	LOGGED BY <i>J. Ullow</i>	128 ft	90		LOCATION (Tp., Lot, Con. OR Lat. and Long.)	
EXPLORATION CO., OWNER OR OPTIONEE NICHRO MINES LTD.		DATE SUBMITTED	SUBMITTED BY (Signature) <i>Paul Pleaver</i>	ft	ft		PROPERTY NAME	

FOOTAGE		ROCK TYPE	DESCRIPTION Colour, grain size, texture, minerals, alteration, etc.	PLANAR FEATURE ANGLE	CORE SPECIMEN FOOTAGE +	YOUR SAMPLE NUMBER	SAMPLE FOOTAGE		SAMPLE LENGTH	ASSAYS +	
FROM	TO						FROM	TO			
0	14	Water	Cased								
14	44	Mud	Cased								
44	90	Gabbro	Med grey - fine grained, chalcopporite, pyrrhotite, pyrite								
90	128	Serpentine	lt green - blue streaks, asbestos stringers								

* For features such as foliation, bedding, schistosity, measured from the long axis of the core.

+ Additional credit available. See Assessment Work Regulations.

K-240570

K-203704

K-240578

K-240571

K-203705

NICHRO MINES LTD.



DD 22

175'



K-240572

K-240573



DIAMOND DRILLING LOG

Start a new page for every new hole, but fill in top portion of form only on first page for each hole.

FILL IN ON EVERY PAGE

HOLE NO. 22 PAGE NO. 1

DRILLING COMPANY NICHRD MINES LTD		COLLAR ELEVATION 1210	BEARING OF HOLE FROM TRUE NORTH	TOTAL FOOTAGE 139	DIP OF HOLE AT collar 90	LOCATION OF HOLE IN RELATION TO A FIXED POINT ON THE CLAIM	MAP REFERENCE NO. M-2737	CLAIM NO. 4 240571
DATE HOLE STARTED 2-13-73	DATE COMPLETED 2-16-73	DATE LOGGED 3-16-73	LOGGED BY <i>W. Harris</i>	139 ft 90	ft		LOCATION (Tp., Lot, Con. OR Lat. and Long.)	
EXPLORATION CO., OWNER OR OPTIONEE NICHRD MINES LTD		DATE SUBMITTED	SUBMITTED BY (Signature) <i>Paul Plaver</i>	ft			ft	PROPERTY NAME

FOOTAGE		ROCK TYPE	DESCRIPTION Colour, grain size, texture, minerals, alteration, etc.	PLANAR FEATURE ANGLE *	CORE SPECIMEN FOOTAGE +	YOUR SAMPLE NUMBER	SAMPLE FOOTAGE		SAMPLE LENGTH	ASSAYS +	
FROM	TO						FROM	TO			
0	15	Water	Cased								
15	63	Mud	Cased								
63	94	Gabbro	Med. gray - fine grained, disseminated sulphides								
94	106	Serpentine	Med. green - copper stain in streaks, sulphides								
106	108	Serpentine	Lt. green waxy, some alteration to talc & asbestos								
108	139	Serpentine	Med. green - Lt. Blue streaks								

* For features such as foliation, bedding, schistosity, measured from the long axis of the core.

+ Additional credit available. See Assessment Work Regulations.

13/73

K-240570

K-203704

K-203699

4
K-203705

K-203698

K-240571

NICHRO
MINES LTD

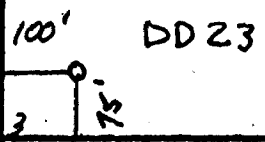

K-240572

K-240573

K-240574



DIAMOND DRILLING LOG

Start a new page for every new hole, but fill in top portion of form only on first page for each hole.

FILL IN ON EVERY PAGE

HOLE NO. 23 PAGE NO. 1

DRILLING COMPANY <i>NICHRO MINES LTD</i>		COLLAR ELEVATION <i>1216</i>	BEARING OF HOLE FROM TRUE NORTH	TOTAL FOOTAGE <i>167</i>	DIP OF HOLE AT collar <i>90</i>	LOCATION OF HOLE IN RELATION TO A FIXED POINT ON THE CLAIM	MAP REFERENCE NO. <i>M-2237</i>	CLAIM NO. <i>M203705</i>	
DATE HOLE STARTED <i>2-12-73</i>	DATE COMPLETED <i>2-20-73</i>	DATE LOGGED <i>3-16-73</i>	LOGGED BY <i>P. Quinn</i>	167 ft 90			LOCATION (Tp., Lot, Con. OR Lat. and Long.)		
EXPLORATION CO., OWNER OR OPTIONEE <i>NICHRO MINES LTD</i>		DATE SUBMITTED	SUBMITTED BY (Signature) <i>Paul Leaver</i>			PROPERTY NAME			

FOOTAGE		ROCK TYPE	DESCRIPTION Colour, grain size, texture, minerals, alteration, etc.	PLANAR FEATURE ANGLE	CORE SPECIMEN FOOTAGE +	YOUR SAMPLE NUMBER	SAMPLE FOOTAGE		SAMPLE LENGTH	ASSAYS +
FROM	TO						FROM	TO		
0	16	Water	Cased							
16	98	Med	Cased							
98	136	Gabbro	Lt gray - fine grained, chalcocyanite, pyrrhotite, pyrite							
136	152	Gabbro	Med gray - fine grained, Red streaks, sulphides							
152	167	Serpentine	Med green - disseminated sulphides, metallic sulphides							

* For features such as foliation, bedding, schistosity, measured from the long axis of the core.

+ Additional credit available. See Assessment Work Regulations.

14773

K-240570

K-203704

K-203699

K-240571

4

K-203705

1

K-203698

NICHRO
MINES LTD



235'

DD 24

225'

3

2

K 240572

K-240573

K-240574



THE MINING ACT - DEPARTMENT OF MINES
DIAMOND DRILLING LOG

Start a new page for every new hole, but fill in top portion of form only on first page for each hole.

FILL IN ON EVERY PAGE

HOLE NO. 24 PAGE NO. 1

DRILLING COMPANY <i>NICHRO MINES LTD</i>		COLLAR ELEVATION <i>1216</i>	BEARING OF HOLE FROM TRUE NORTH <i>154</i>	TOTAL FOOTAGE <i>154</i>	DIP OF HOLE AT COLLAR <i>90</i>	LOCATION OF HOLE IN RELATION TO A FIXED POINT ON THE CLAIM	MAP REFERENCE NO. <i>M-2737</i>	CLAIM NO. <i>M-203705</i>	
DATE HOLE STARTED <i>2-20-73</i>	DATE COMPLETED <i>2-24-73</i>	DATE LOGGED <i>3-16-73</i>	LOGGED BY <i>L. L. Lunn</i>	154 ft <i>90</i>			LOCATION (Tp., Lot, Con. OR Lot. and Long.)		
EXPLORATION CO., OWNER OR OPTIONEE <i>NICHRO MINES LTD</i>		DATE SUBMITTED	SUBMITTED BY (Signature) <i>Paul Lunn</i>		ft		PROPERTY NAME		

FOOTAGE		ROCK TYPE	DESCRIPTION	PLANAR FEATURE ANGLE	CORE SPECIMEN FOOTAGE	YOUR SAMPLE NUMBER	SAMPLE FOOTAGE		SAMPLE LENGTH	ASSAYS
FROM	TO		Colour, grain size, texture, minerals, alteration, etc.				FROM	TO		
0	15	Water	Closed							
15	84	Mud	Closed							
84	127	Gabbro	Med gray - fine grained, disseminated sulphides + stringers							
127	149	Serpentine	Med green - asbestos stringers							
149	159	Serpentine	Med green - blue streaks and apple green streaks							

* For features such as foliation, bedding, schistosity, measured from the long axis of the core.

+ Additional credit available. See Assessment Work Regulations.

1373

K-240570

K-203704

K-203699

K 240571

4

1

K-203705

K-203698

NICHRO
MINES LTD.



375'

DD 25

375'

3

2

K 240572

K 240573

K 240574



THE MINING ACT - DEPARTMENT OF MINES
DIAMOND DRILLING LOG

Start a new page for every new hole, but fill in top portion of form only on first page for each hole.

FILL IN ON EVERY PAGE

HOLE NO. 23 PAGE NO. 1

DRILLING COMPANY NICHRO MINES LTD		COLLAR ELEVATION 1210	BEARING OF HOLE FROM TRUE NORTH	TOTAL FOOTAGE 137	DIP OF HOLE AT collar 90		LOCATION OF HOLE IN RELATION TO A FIXED POINT ON THE CLAIM	MAP REFERENCE NO. M-2737	CLAIM NO. M-203705	
DATE HOLE STARTED 2-26-73	DATE COMPLETED 2-26-73	DATE LOGGED 3-16-73	LOGGED BY J. Lewis		137 ft	90		PROPERTY NAME	LOCATION (Tp., Lot, Con. OR Lat. and Long.)	
EXPLORATION CO., OWNER OR OPTIONEE NICHRO MINES LTD		DATE SUBMITTED	SUBMITTED BY (Signature) <i>Paul Cleaver</i>		ft	ft				

FOOTAGE		ROCK TYPE	DESCRIPTION <small>Colour, grain size, texture, minerals, alteration, etc.</small>	PLANAR FEATURE ANGLE *	CORE SPECIMEN FOOTAGE †	YOUR SAMPLE NUMBER	SAMPLE FOOTAGE		SAMPLE LENGTH	ASSAYS +
FROM	TO						FROM	TO		
0	13	Water	Cased							
13	102	Mud	Cased							
102	111	Ig - mixed	Apparent 22002 large rocks drilled thru.							
111	129	Gabbro	Dk grey - some red streaks, disseminated sulphides							
129	137	Gabbro	Med grey - heavy sulphides, slight magnetism							
Last Hole										

* For features such as foliation, bedding, schistosity, measured from the long axis of the core.

+ Additional credit available. See Assessment Work Regulations.

13173

K-240570

K-203704

K-203699

K-240571

4

1

K-203705

K-203698

NICHRO
MINES LTD.



DD 26

536'

275'

3

2

K-240572

K 240573

K-240574



DIAMOND DRILLING LOG

Start a new page for every new hole, but fill in top portion of form only on first page for each hole.

FILL IN ON EVERY PAGE

HOLE NO. 26	PAGE NO. 1
----------------	---------------

15173

DRILLING COMPANY NICHRO MINES LTD	COLLAR ELEVATION 1210	BEARING OF HOLE FROM TRUE NORTH	TOTAL FOOTAGE 149	DIP OF HOLE AT COLLAR 90	LOCATION OF HOLE IN RELATION TO A FIXED POINT ON THE CLAIM	MAP REFERENCE NO. M-2732	CLAIM NO. K-203705
DATE HOLE STARTED 2-22-73	DATE COMPLETED 2-28-73	DATE LOGGED 3-17-73	LOGGED BY <i>G. Davis</i>	149 ft		LOCATION (Tp., Lot, Con. OR Lat. and Long.)	
EXPLORATION CO., OWNER OR OPTIONEE NICHRO MINES LTD	DATE SUBMITTED	SUBMITTED BY (Signature) <i>Paul Shearer</i>		ft		PROPERTY NAME	

FOOTAGE		ROCK TYPE	DESCRIPTION Colour, grain size, texture, minerals, alteration, etc.	PLANAR FEATURE ANGLE	CORE SPECIMEN FOOTAGE +	YOUR SAMPLE NUMBER	SAMPLE FOOTAGE		SAMPLE LENGTH	ASSAYS +	
FROM	TO						FROM	TO			
0	11	Water	Cased								
11	110	Mud	Cased								
110	137	6-8 bbls	Dk gray - fine grained, disseminated sulphides								
137	149	6-8 bbls	Mud gray - fine grain, chalcophyllite, pyrrhotite, pyrites								

+ For features such as foliation, bedding, schistosity, measured from the long axis of the core.

+ Additional credit available. See Assessment Work Regulations.

K-240570

K-203704

K-203699

K-240571

K-203705

K-203698

NICHRO
MINES LTD



200'

DD27

525'

K-240572

K-240573

K-240573



DIAMOND DRILLING LOG

Start a new page for every new hole, but fill in top portion of form only on first page for each hole.

FILL IN ON EVERY PAGE

HOLE NO. **27** PAGE NO. **1**

DRILLING COMPANY NICHRO MINES LTD		COLLAR ELEVATION 1210	BEARING OF HOLE FROM TRUE NORTH	TOTAL FOOTAGE 150	DIP OF HOLE AT collar 90		LOCATION OF HOLE IN RELATION TO A FIXED POINT ON THE CLAIM	MAP REFERENCE NO. M 2727	CLAIM NO. M-203705
DATE HOLE STARTED 3-1-73	DATE COMPLETED 3-3-73	DATE LOGGED 3-17-73	LOGGED BY <i>J. Uwin</i>		150 ft	90		LOCATION (Tp., Lot, Con. OR Lat. and Long.)	
EXPLORATION CO., OWNER OR OPTIONEE NICHRO MINES LTD.		DATE SUBMITTED	SUBMITTED BY (Signature) <i>Paul Chaver</i>		ft		PROPERTY NAME		

FOOTAGE		ROCK TYPE	DESCRIPTION Colour, grain size, texture, minerals, alteration, etc.	PLANAR FEATURE ANGLE *	CORE SPECIMEN FOOTAGE +	YOUR SAMPLE NUMBER	SAMPLE FOOTAGE		SAMPLE LENGTH	ASSAYS +	
FROM	TO						FROM	TO			
0	14	Water	Cased								
14	94	Mud	Cased								
94	120	Gabbro	Dk gray - fine grain, red streaks disseminated sulphides								
120	142	Gabbro	lt. gray - fine grain, heavy sulphide streaks, ht. mag.								
142	150	Serpentine	Wd green - some metallic copper along fracture planes								

* For features such as foliation, bedding, schistosity, measured from the long axis of the core.

+ Additional credit available. See Assessment Work Regulations.

1473

K-240570

K-203704

K-203699

K-240571

K-203705

K-203698

NICHRO MINES
LTD



500' DD 28

550'

K-240572

K 240573

K-240574

4

1

3

2



DIAMOND DRILLING LOG

Start a new page for every new hole, but fill in top portion of form only on first page for each hole.

FILL IN ON EVERY PAGE

HOLE NO.	PAGE NO.
28	1

1573

DRILLING COMPANY NICHRO MINES LTD		COLLAR ELEVATION 1210	BEARING OF HOLE FROM TRUE NORTH	TOTAL FOOTAGE 163	DIP OF HOLE AT collar 90	LOCATION OF HOLE IN RELATION TO A FIXED POINT ON THE CLAIM	MAP REFERENCE NO. M-2237	CLAIM NO. K203705-
DATE HOLE STARTED 3-3-73	DATE COMPLETED 3-4-73	DATE LOGGED 3-17-73	LOGGED BY G. Lewis	163 ft 90			LOCATION (Tp., Lot, Con. OR Lat. and Long.)	
EXPLORATION CO., OWNER OR OPTIONEE NICHRO MINES LTD		DATE SUBMITTED	SUBMITTED BY (Signature) <i>Paul Plaver</i>		ft		PROPERTY NAME	

FOOTAGE		ROCK TYPE	DESCRIPTION <small>Colour, grain size, texture, minerals, alteration, etc.</small>	PLANAR FEATURE ANGLE *	CORE SPECIMEN FOOTAGE +	YOUR SAMPLE NUMBER	SAMPLE FOOTAGE		SAMPLE LENGTH	ASSAYS +	
FROM	TO						FROM	TO			
0	12	Water	Cased								
12	73	Mud	Cased								
73	85	Serpentine	lt green - Blue streaks, asbestos stringers								
85	114	Gabbro	Med gray - fine green red streaks, disseminated sulphides								
114	134	Gabbro	Dr. green - fine green, chlorophane, pyrrhotite, pyrite								
134	163	Serpentine	Med green - Apple green + Blue streaks, metallic copper, asbestos								

+ Additional credit available. See Assessment Work Regulations.

K 240570

K 203704

K-203699

K-240571

4

1

K-203905

DD29

20'

K 203698

NICHRO MINES
LTD.



718'

3

2

K 240572

K 240573

K-240574



THE MINING ACT - DEPARTMENT OF MINES
DIAMOND DRILLING LOG

Start a new page for every new hole, but fill in top portion of form only on first page for each hole.

FILL IN ON EVERY PAGE

HOLE NO. 29 PAGE NO. 1

DRILLING COMPANY NICHRO MINES LTD		COLLAR ELEVATION 1210	BEARING OF HOLE FROM TRUE NORTH	TOTAL FOOTAGE 127	DIP OF HOLE AT collar 90	LOCATION OF HOLE IN RELATION TO A FIXED POINT ON THE CLAIM	MAP REFERENCE NO. M-2737	CLAIM NO. M 203705	
DATE HOLE STARTED 3-5-73	DATE COMPLETED 3-5-73	DATE LOGGED 3-17-73	LOGGED BY <i>[Signature]</i>	120 ft	90		LOCATION (Tp., Lot, Con. OR Lat. and Long.)		
EXPLORATION CO., OWNER OR OPTIONEE NICHRO MINES LTD		DATE SUBMITTED	SUBMITTED BY (Signature) <i>[Signature]</i>	ft	ft		PROPERTY NAME		
				ft					

FOOTAGE		ROCK TYPE	DESCRIPTION Colour, grain size, texture, minerals, alteration, etc.	PLANAR FEATURE ANGLE *	CORE SPECIMEN FOOTAGE +	YOUR SAMPLE NUMBER	SAMPLE FOOTAGE		SAMPLE LENGTH	ASSAYS +	
FROM	TO						FROM	TO			
0	13	Water	Cased								
13	76	Mud	Cased								
76	95	Gabbro	Med gray - fine grain, disseminated sulphides								
95	101	Gabbro	Body fractured. Dollars only recovered								
101	127	Gabbro	Dr grey - fine grain, disseminated sulphides								

* foliation, bedding, schistosity, measured from the long axis of the core.

+ Additional credit available. See Assessment Work Regulations.

Claim No. K-203704

Claim No. K-203699

Claim No. K-203696

4

1

125'

DD30

Claim No. K-203705

Claim No. K-203698
Nichro Mines Ltd.

Claim No. K-
203697

N



875'

3

2

Claim No. K-240573

Claim No. K-240574

Claim No. K- —



THE MINING ACT - DEPARTMENT OF MINES
DIAMOND DRILLING LOG

Start a new page for every new hole, but fill in top portion of form only on first page for each hole.

FILL IN ON EVERY PAGE

HOLE NO.	PAGE NO.
30	1

15173

DRILLING COMPANY <i>NICHRO MINES LTD</i>		COLLAR ELEVATION <i>1210</i>	BEARING OF HOLE FROM TRUE NORTH	TOTAL FOOTAGE <i>146</i>	DIP OF HOLE AT collar <i>90</i>		LOCATION OF HOLE IN RELATION TO A FIXED POINT ON THE CLAIM	MAP REFERENCE NO. <i>M-2037</i>	CLAIM NO. <i>K 202698</i>	
DATE HOLE STARTED <i>3-6-73</i>	DATE COMPLETED <i>3-8-73</i>	DATE LOGGED <i>3-17-73</i>	LOGGED BY <i>J. G. Lewis</i>		146 ft 90			LOCATION (Tp., Lot, Con. OR Lat. and Long.)	PROPERTY NAME	
EXPLORATION CO., OWNER OR OPTIONEE <i>NICHRO MINES LTD</i>		DATE SUBMITTED	SUBMITTED BY (Signature) <i>Paul Phelan</i>		ft					

FOOTAGE		ROCK TYPE	DESCRIPTION Colour, grain size, texture, minerals, alteration, etc.	PLANAR FEATURE ANGLE +	CORE SPECIMEN FOOTAGE +	YOUR SAMPLE NUMBER	SAMPLE FOOTAGE		SAMPLE LENGTH	ASSAYS +	
FROM	TO						FROM	TO			
0	15	Water	Cased								
15	64	Mud	Cased								
64	82	Gabbro	Med gray - Fine grained, disseminated sulphides, copper stain								
82	131	Gabbro	DK gray - fine grained, chalcophyllite, pyrrhotite, pyrite								
131	146	Serpentine	Med green - some asbestos and metallic copper								

+ Additional credit available. See Assessment Work Regulations.

Claim No. K-203704

Claim No. K-203699

Claim No. K-203696

4

1



280' DD 31

Claim No. K-203705

Claim No. K-
Nichro Mines Ltd.

Claim No. K-203697

TICE

COMPTON
750

TION

3

2

Claim No. K-240573

Claim No. K-240574

Claim No. K- —

K-203699

K-203704

K 240570

ROLL

K-240571

NICHROMINES
LTD
PLACE
K-203705

DD32

50'

ROLL K 203698

1009'



K-240572

K 240573

K 240574



THE MINING ACT - DEPARTMENT OF MINES
DIAMOND DRILLING LOG

Start a new page for every new hole, but fill in top portion of form only on first page for each hole.

FILL IN ON EVERY PAGE

HOLE NO. 32 PAGE NO. 1

DRILLING COMPANY NICHRO MINES LTD		COLLAR ELEVATION 1210	BEARING OF HOLE FROM TRUE NORTH	TOTAL FOOTAGE 143	DIP OF HOLE AT collar 90	LOCATION OF HOLE IN RELATION TO A FIXED POINT ON THE CLAIM	MAP REFERENCE NO. M 2737	CLAIM NO. K-203705	
DATE HOLE STARTED 3-10-73	DATE COMPLETED 3-13-73	DATE LOGGED 3-17-73	LOGGED BY <i>J. Lewis</i>		143 ft 90		LOCATION (Tp., Lot, Con. OR Lat. and Long.)		
EXPLORATION CO., OWNER OR OPTIONEE NICHRO MINES LTD		DATE SUBMITTED	SUBMITTED BY (Signature) <i>Paul Pleaver</i>		ft		PROPERTY NAME		

FOOTAGE		ROCK TYPE	DESCRIPTION Colour, grain size, texture, minerals, alteration, etc.	PLANAR FEATURE ANGLE	CORE SPECIMEN FOOTAGE +	YOUR SAMPLE NUMBER	SAMPLE FOOTAGE		SAMPLE LENGTH	ASSAYS +		
FROM	TO						FROM	TO				
0	10	Water	Cased									
10	54	Mud	Cased									
54	72	Gabbro	Med gray, fine grained, disseminated sulphides									
72	107	Gabbro	Dk gray - fine grained, some red streaks, disseminated sulphides									
107	110	Quartz	Milk white, some pyrites									
110	126	Gabbro	Dk grey, fine grained disseminated sulphides									
126	143	Serpentine	Lt green, blue streaks, some asbestos and metallic appear									

* For features such as foliation, bedding, schistosity, measured from the long axis of the core.

+ Additional credit available. See Assessment Work Regulations.

15173