



52F10NW0097 16 CONTACT BAY (WABIGOO)

010

AREA OF CONTACT BAY REPORT #16

This file contains work performed by Hollinger Mines on claim:

K.40505

Hole #AK-3; 536' November, 1969

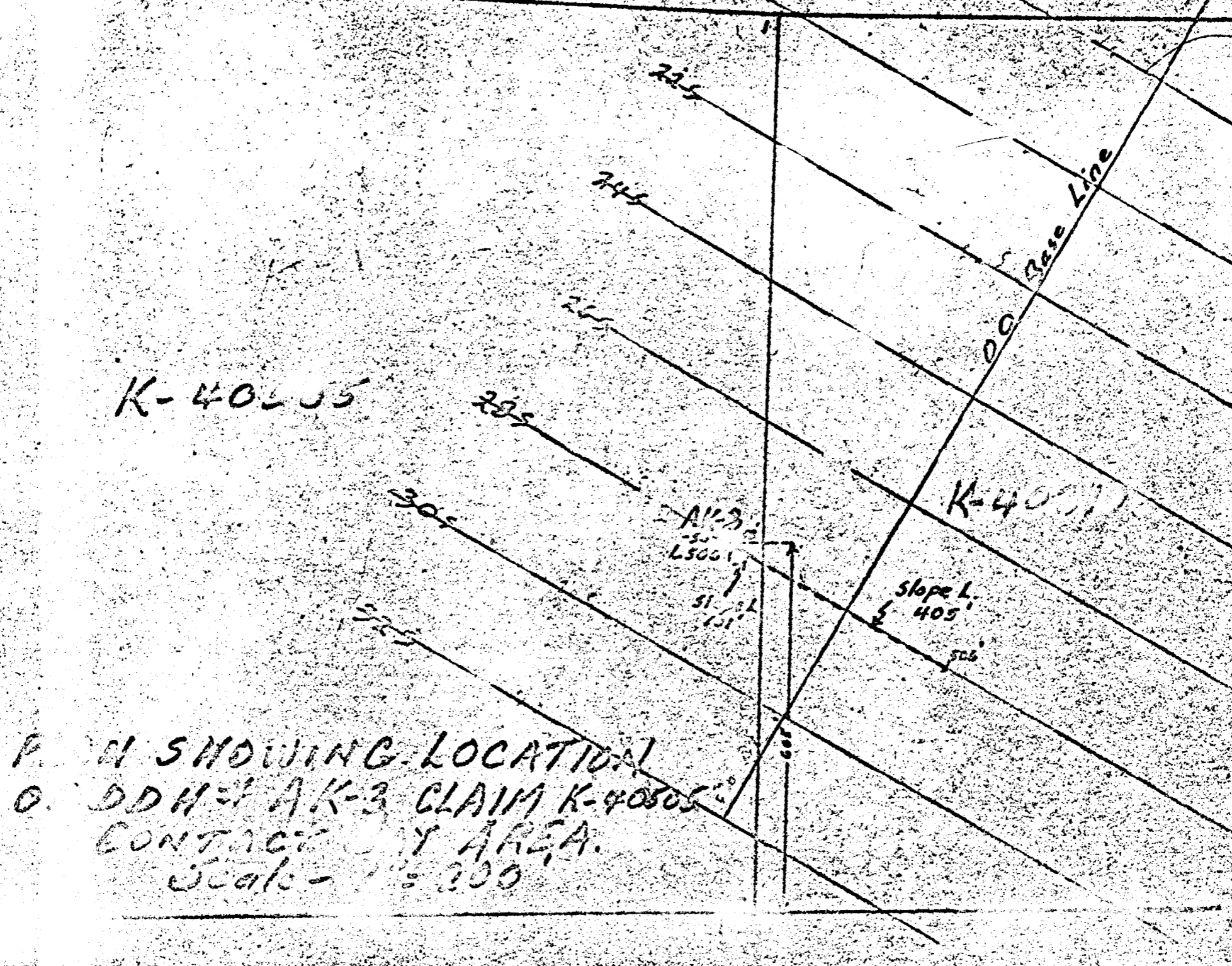

K-40505

K-40511

AK-3

L500

SLOPE 1:405

P. U. SHOWING LOCATION
 O. DDH AK-3 CLAIM K-40505
 CONTACT AREA.
 Scale - 1" = 200'

January 23, 1970

STATEMENT SHOWING DISTRIBUTION OF ASSESSMENT DAYS AS A RESULT
OF 100+ FEET OF DIAMOND DRILLING PERFORMED ON MINING CLAIMS
K-40078, K-40210 and K-40505, KOZOWY OPTION, CONTACT BAY AREA, ONT.

<u>Claim Number</u>	<u>Assessment Days</u>
K - 40072	40 days
40073	40
40074	40
40075	40
40076	40
40077	40
40078	40
40079	40
40080	40
40210	40
40505	80
40506	80
41961	80
41962	80
41963	80
42883	14
42884	14
42885	14
42886	14
42887	16
44561	9
44562	9
44563	9
44564	9
44565	9
44566	9
44567	9
44568	9
202745	20
202746	20
202747	20

Total

100+ days

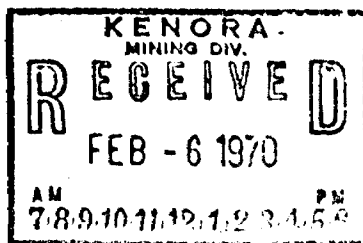

W. H. Hansen
HOLLINGER MINES LIMITED
TIMMINS, ONTARIO

Location of Collar from # 2 of K-40505 North 605' West 58'

FORM 522
 NORTH: ON XL - 28 008
 EAST: at 2725W
 ELEV.
 AZIM: Collar - 560E
 DIP: Collar - 50°
 200' - 47° 500' - 45°

DIAMOND DRILL REPORT

PROPERTY KOZOWY - DRYDEN
 Claim K-40505

HOLE NO. AK 3
 COMMENCED November 14/69
 FINISHED November 18/69
 PURPOSE OF HOLES Exploration

KENORA MINING DIV.
RECEIVED
 FEB - 6 1970
 AM 7.0.0.10.11.12.1.2.3 PM

FROM	TO	DESCRIPTION	CORE SAMPLES					DESCRIPTION OF SAMPLE
			FROM	TO	RECOV.	WIDTH	ASSAY	
0	53	Overburden - Casing						
53	58	Int. massive med. to fine grained dark grey-green, dioritic Textured intrusive Few diss. sulphides						
58	89.2	Int. to basic chloritic fine grained dark green-grey volcanic Some epidote and amphibolitic especially close to later Feldspar porphyry intrusions odd silicic or amphibolitic section may be evidence of pillows (?) Few sulphides and sheared at 35°						
89.2	117	Feldspar porphyry-acid grey green intrusive at 60° with 1/32" flecks of feldspar mixed in places w̄ amphibole needles medium grained and fairly similar to diobitic types described in this hole. Odd qtz.-carb ^{veined} opening indicative of some brecciation.						
117	125.7	Volcanic as at 58 to 89.2 except up to 1/2" long amphibole needles 1' from contacts.						

NORTH _____
 EAST _____
 ELEV. _____
 AZIM. _____
 DIP _____

DIAMOND DRILL REPORT

PROPERTY _____

HOLE NO. AK-3
 COMMENCED _____
 FINISHED _____
 PURPOSE OF _____
 HOLE _____

FROM	TO	DESCRIPTION	CORE SAMPLES					DESCRIPTION OF SAMPLE
			FROM	TO	RECOV.	WIDTH	ASSAY	
125.7	128.5	Feldspar porphyry - as above but more distinct rounded feldspar phenocrysts. Develops blue qtz. eyes in volcanics 1" from contacts contacts at 60° to CA.						
128.5	134.6	Int. to basic volcanic as at 117 to 125.7						
134.6	170.4	Int. intrusive-dioritic-contact F.G. to 136.6-Otherwise medium grained-amphibolitic-massive dark grey green-some mica developed. Some sulphides diss. throughout.						
170.4	223.8	Amygdaloidal pillowed int to basic volcanic- ie in places 1/4" elliptical qtz.-carb. filled amygdoles in intermediate volcanic rock w̄ up to 2" chloritic material every 1-2' (pillow margins?) Whole rock unit - chloritic and amphibolitic Few lighter epidote sections some po. as Diss and flecks						

NORTH _____
 EAST _____
 ELEV. _____
 AZIM. _____
 DIP _____

DIAMOND DRILL REPORT

PROPERTY _____

HOLE NO. **AK 3**

COMMENCED _____
 FINISHED _____
 PURPOSE OF _____
 HOLE _____

FROM	TO	DESCRIPTION	CORE SAMPLES					DESCRIPTION OF SAMPLE
			FROM	TO	RECOV.	WIDTH	ASSAY	
		Qtz. veined at 188.1 ($\frac{1}{2}$ "						
		188.5 to 188.6, 188.9 to 189.2						
		192.6 (1"), 213.3 to 213.6						
		Some Int. intrusives (?)						
		Throughout-short sections						
223.8	234.2	Int. med. to coarse grained amphibolite dike \bar{w} up to $\frac{1}{2}$ " needles, - massive uniform dark green-grey-gabbroic textured rock.						
		Qtz. vein at 234.2 to 234.9						
234.2	247.3	Pillowed amygdaloidal int. volcanic as above.						
		Few sulphides.						
247.3	267.5	Amphibolite dike as at 223.8 to 234.2						
		qtz. vein at 266.9 ($\frac{1}{2}$ "						
		Few sulphides						
267.5	281	Fine frag. (tuff) ie med to coarse acidic lineated rock - grey green \bar{w} gnessic xhixax character lineated at 60° to CA.						

NORTH _____
 EAST _____
 ELEV. _____
 AZIM. _____
 DIP _____

DIAMOND DRILL REPORT

PROPERTY _____

HOLE NO. **AK-3**

4

COMMENCED _____
 FINISHED _____
 PURPOSE OF _____
 HOLE _____

FROM	TO	DESCRIPTION	CORE SAMPLES					DESCRIPTION OF SAMPLE
			FROM	TO	RECOV.	WIDTH	ASSAY	
281	342.2	Amygdaloidal-pillowed dacitic volcanic-ie-as above except more acidic and fewer 1/2" amygdules somewhat porphyritic and larger pillows (?) Few sulphides in pillow rims						
342.2	371?	Fragmental - odd acidic 2"	352	356				2% pq - Ni (?)
		Fragment in matrix of amphibole needles up to 1/2" long Diss. and local conc. of po, py, chalco in coarser amphibole sections	358	360				2%-po - Ni (?)
371	438.5	Fine grained int. vol-probably tuff - ie amphibole chlorite schist sheared at 20° - 40° becoming slightly coarser down hole colour similar to above rocks. Little sulphides Shear zone at 397.5 to 401.0 at 15° to CA - Carbonaceous						

