

TWINGRASS LAKES PROPERTY
Assessment Work Report
Van Horne Township (G-839)
Kenora Mining Division

Wm. J. Sovereign
103 Wabigoon Drive
Dryden, Ontario
P8N 1W4

December 10, 2003

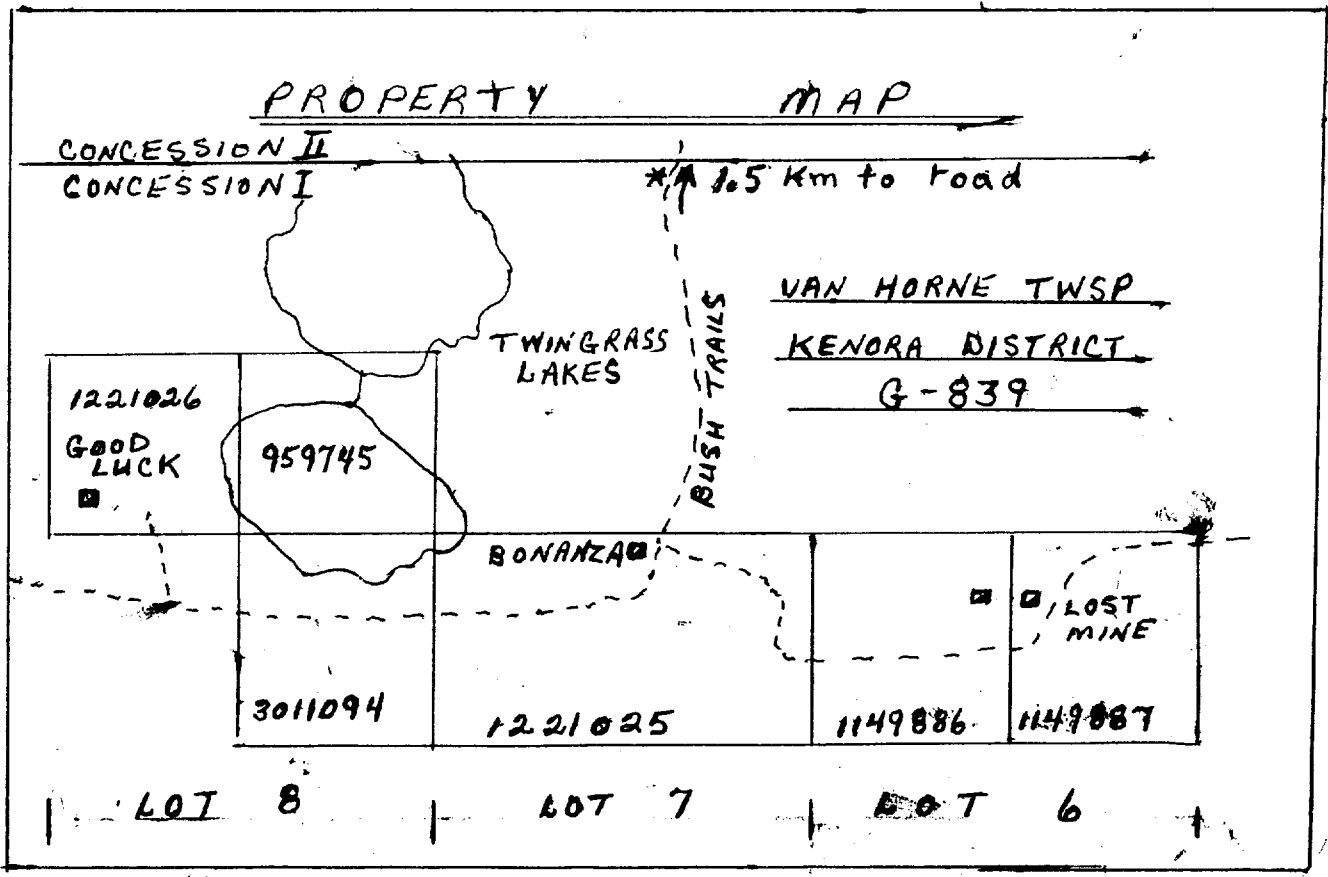
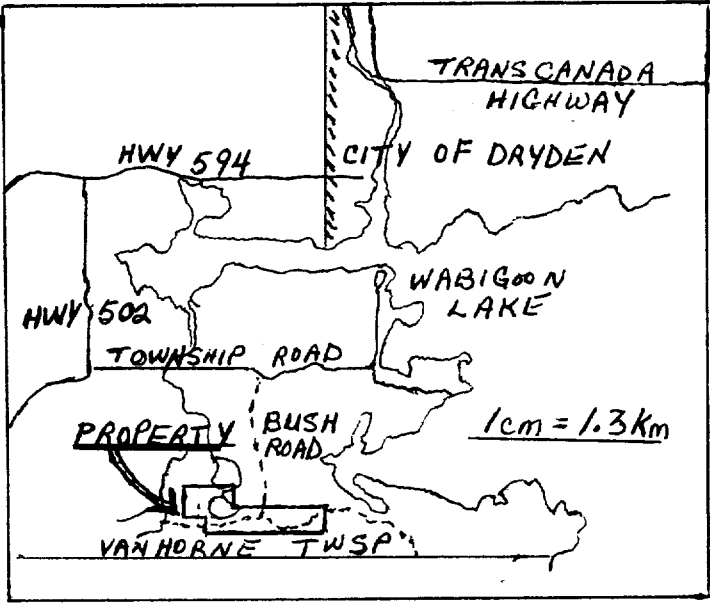

TABLE OF CONTENTS

Location and Property Map	1
Summary of Historical Work	2
Work and Findings	2 & 3
Proposed Plans	3
Gold Assays	4 to 7
2003 Abbreviated Work Log	7 & 8
Calculation of Assessment Value	8 & 9
Maps I Claim 3011094 Prospecting	9
II Good Luck	10
III Bonanza	11
IV (A) Bonanza Peripheral Areas of Prospecting	12
(B) Lost Mine Prospecting and Work Areas	12
Appendices I Assay Lab Reports and Invoices	
II Postal Receipts	
III Ministry Forms (3)	

LOCATION

The Twingrass Lakes Property lies about 6 km south southwest of Dryden, double that by road. The property is accessed by a deteriorated bush road running southward from a well-maintained township road. The bush road is usually passable in summer for the first 1.2 km by vehicle and thereafter by ATV. Approximately 2.5 km south of the township road, the bush road branches easterly and westerly to both extremities of the property.



SUMMARY OF HISTORICAL WORK

The Twingrass Lakes Property, consisting of 7 claim units, is composed of three historical properties, all with their own shafts, pits, and trenches : the Good Luck, the Bonanza, and the Lost Mine. Work on each of these properties stretches back to the very dawn of the 1900's.

The Good Luck early reports give no assays, but mention veins showing "considerable free gold" and "visible gold". In the 1980's, Van Horne Gold assayed a grab sample from the shaft dump at 0.12 oz/t and a sample from the north vein, approximately 14m from the shaft, at 0.29 oz/t across 1 foot. In 1987 Van Horne Gold describes a drill hole (VHG 87-8) placed beneath the shaft, obtaining an assay of 0.02 oz/t. However, Norontex Explorations which took over the property from them disagree with the placement, showing in their report the drill hole being drilled under a pit nearly 60m north and 35m east of the shaft and in a direction away from the shaft. Norontex placed two drill holes on the property. No. 88-4, south of the east-west trending south (or shaft) vein, drilled in a southerly direction failed to find additional veins beneath overburden. Unfortunately, No. 88-5 placed beneath the shaft fails to include assay results with the logged strata. This omission (or loss) is a mystery since other drill holes in the report are well documented.

The Bonanza Mine by 1923 is reported to have had a shaft to 333 feet with 1091 feet of lateral development on 3 levels. Between 1920-23, 1206 tons of ore were treated averaging 0.20 oz/t Au and 0.07 oz/t Ag. The last extensive work was done in 1980 by Van Horne Gold which drilled 13 shallow holes over 400 feet of vein length (the deepest intersection was 270 feet below surface). Total tonnage indicated is 4834 tons with a weighted average grade of 0.2471 oz/t gold across an average true width of 0.91 feet. Among the recommendations of Van Horne's consulting mining engineer were further development by the dewatering, rehabilitation, and sampling of underground workings and, if promising results occur, a further 15 000 feet of diamond drilling. None of his recommendations were followed up.

The Lost Mine in 1929 tested a 34 ton bulk sample that averaged 0.26 oz/t Au, 0.75 oz/t Ag, and 0.29 % Cu. The property was staked in February, 1998, and has been held in good standing since then. Variable surface assays were obtained by the present owner, with the best near the east shaft; Norontex Exploration placed a drill hole near the same shaft in 1987 and obtained two intersections: 0.08 oz/t Au over 0.9 feet and 0.14 oz/t over 1.0 feet.

WORK AND FINDINGS

Since the Twingrass Lakes Property has been examined as recently in the past as the 1980's, it is paramount to bring new information to light. The best means for doing so were: (1) to re-examine old overgrown workings (i.e. pits, trenches) that had first attracted the original prospectors, especially since there's only minuscule, vague surviving data; (2) determine where new surface stripping and assaying might broaden known showings; (3) more thoroughly examining areas that had received cursory attention in the 1980's. These three guiding principles were easily implemented because neither of the small junior mining companies (Van Horne Gold and Norontex) brushed, stripped, or cleaned overgrown pits, trenches, or veins. Furthermore, their land package likely was larger than they could justly handle, and most of their time and funds were spent on an area 2 km to the west. Thus the majority of current work entailed manual labor and assaying.

Good Luck Highlights Centered on the shaft, there appears to be a zone about 30 metres long by an average width close to 0.5 m assaying 14g/tonne Au or better. Approximately 5 m to the north is a parallel vein that gave an assay across 27 cm of 18g/t. In the approximate 50 m stretch westward to the claim boundary past the above 30 m section, the vein has given erratic values - both quite low and quite high (106g/t across 15 cm). Approximately 120 m east of the shaft, after a stretch of low assays, there is a hint (wishful thinking?) that the vein may be increasing its values as it runs beneath deep overburden.

Bonanza Highlights Immediately west of a small water-filled pit (approximately 25 m west of a 30 m-long water-filled trench) a 42 cm-wide sample assayed 12.3g/t Au. Though the vein quickly pinched out westward, it was picked up again 20 m westward (2.6g/t x 22cm) and a further 15 m westward (4.8g/t x 20cm) at a cliff edge where further exposure is blocked by bouldery overburden. The significance of this stretch is that it is on perfect strike - visually and by compass bearing - to the Good Luck vein mentioned above, separated by about 700 m of deep overburden, lake and marsh. Roughly 100 m to the north of the above pit, a westward running vein entering heavy overburden assayed 6.0g/t x 40 cm. In an open cut 170 m east of the later and 107 m west of the shaft, an assay across 21.5cm gave 6.3g/t.

Lost Mine Highlights Only a small amount of stripping and assaying was performed to supplement work last performed in 1999. On the lip of the eastern shaft #87-2 assayed 6.3 g/t Au x 38 cm. About 42 m to the east #87-3 assayed 5.5g/t x 11.5 cm, and a further 5 m east #87-4 gave 4.5g/t x 54 cm. At 23 m west of #87-2, #87-1 assayed 7.4g/t x 16 cm.

PROPOSED PLANS

Sufficient new knowledge on these old properties has hopefully been discovered to interest a mining company to examine several areas with advanced exploration. For instance, promising drill targets would be (1) the Good Luck shaft zone, (2) the 700 metre virgin territory beneath marsh and lake and on strike between the Good Luck and Bonanza claims, (3) the mining consultant's unfilled recommendation of further drilling and work at the Bonanza shaft, and (4) beneath and east of the Lost Mine's eastern shaft. Mechanical stripping is a consideration for the west side of the Good Luck claim, the west end of the Bonanza claim, and east of the Lost Mine shafts.

A possibility not to be overlooked is to outline high grade shoots of ore for custom milling. This appears promising at both the Good Luck shaft and at least diamond drilled "Block G" at the Bonanza shaft (2013 tons @ 0.2964 oz/t Au; true width 2.1 feet). Three smaller blocks (C,D,E), an additional 1267 tons, may also be ore material.

If the property owner fails in his efforts to option the claims, he intends to continue his current practice of manual labor and assaying - at least while there still remain a few as yet insufficiently examined surface targets.

GOLD ASSAYS

Assay locations are determined differently on the three properties. On the Good Luck, measurement were taken along the virtually east-west running main vein starting at the western claim boundary approximately 75 m north of No. 3 post. On the Bonanza, a small grid was cut commencing at the north side of the shaft about 385m west and 75 m south of No. 1 post. On the Lost Mine, a grid was cut centered on the boundary between claims 1149886 and 1149887 at a point 114 metres south of their common No. 1 and No. 4 post respectively.

Table of Gold Assays			
<u>Sample No.</u>	<u>Location</u>	<u>Value (g/t) x Width (cm)</u>	<u>Description</u>
<u>Good Luck (Claim 1221026)</u>			
26-1	5m	2.056g x 46 cm	FeO schist, rusty quartz, carbonate; chip sample of which 36 cm was quartz
26-2	23.5m	5.937g x 26 cm	Friable FeO schist with quartz stringers; chip sample
26-3	23.5m	0.197g x 25 cm	South side of #26-2, silicification, abundant FeO; chip
26-4	63.5m	14.167g x 74 cm	2/3 width quartz vein, FeO schist, channel
26-5	85m	0.531g x 29 cm	8cm quartz plus 21cm rusty, silicified shear; channel
26-6	115m	0.747g x 43 cm	Silicified, Fe O shear, chip
26-7	142.5m	4.759g x 29 cm	Quartz with tourmaline and FeO; channel
26-8	72m & 14m north	0.042g x 35 cm	Shear, rusty, carbonate, chip
26-9	63.5m & 5m north	1.457g x grab	Shear, silicified, carbonate, FeO; grab
26-10	74m	40.650g x 26cm	Quartz with ankerite, FeO, channel
26-11	74m	2.215g x 33cm	Wall rock: 14cm on N side & 19 cm on S side of # 26-10; soft rusty schist with minor rusty quartz; channel
26-12	44m	4.022g x 40cm	Poorly exposed in >1.1m pit bounded by steep trench banks; rusty schist, no quartz; may be wall rock; chip
26-13	58.5m	15.247g x 43 cm	18 cm quartz & 25 cm rusty wall from both sides; channel
26-14	156.5m	1.671g x 18 cm	12 cm rusty quartz & 6 cm rusty schist; chip
26-15	171m	1.188g x 37 cm	10 cm quartz & 27 cm rusty, silicified, sheared wall rock; chip
26-16	196.5m	3.607g x 13 cm	Rusty schist in sheared dyke; channel
26-17	83m & 4m north	17.896g x 27 cm Ag: 2 ppm	Rusty schist with quartz stringers; contact of altered lapilla tuff & fine grained tuff; channel

<u>Sample No.</u>	<u>Location</u>	<u>Value (g/t) x Width (cm)</u>	<u>Description</u>
26-18	63.5m & 5m north	5.827g x 28 cm	North side of #26-9; friable rusty schist with silicified bands; chip sample
26-19	46m & 2.5m north	0.556g x 31 cm	Banded, silicified, bleached, rusty shear; chip
26-20	36.5m	5.248g x 11cm	½ rusty quartz, ½ rusty schist; channel
26-21	36.5m	0.038g x 28 cm	18 cm south of # 26-21; friable rusty schist including 1 cm rusty quartz stringer; chip
26-23	15 m	106.096g x 11 cm Ag: 18 ppm	Rusty quartz, pyrite, tourmaline; channel Check Ag: 9 ppm
26-24	15m	0.047g x 24 cm	24 cm north of #26-23 on silicified, sheared dyke? FeO, pyrite, quartz
26-25	58m	1.751g x 53 cm	Rusty schist, quartz stringers <2 cm, silicified bands; channel
26-26	83m	4.990g x 38 cm	11 cm pinkish, rusty quartz and 14 cm brown “mud-schist” and 13 cm silicified rusty vein; chip
26-27	83m	0.038g x 64 cm	North side of #26-26; massive silicified lapilla tuff, FeO; channel
26-28	83m	0.028g x 118 cm	North side of #26-27; same as #26-27
26-29	83m	0.012g x 120 cm	North side of #26-28; lapilla tuff, FeO; chip
26-30	83m	0.059g x 120 cm	North side of #26-29; same as #26-29 but slightly more altered, softer
26-31	142.5m	0.145g x 63 cm	South side of # 26-7; silicified lapilla tuff at contact with fine-grained tuff; fracture zone with pyrite, FeO, quartz veins & stringers <22 cm variable and random (note: quartz not included in sample); chip
26-32	196.5m	0.021g x 60 cm	5 cm north of #26-16; dark felsic dyke? entering overburden, fine pyrite; chip
26-33	83m	0.037g x 40 cm	South side of #26-26; fracture zone of dark, friable, rusty schist; chip
26-34	25m & 45m north	0.031g x 43 cm	From schist in altered felsite dyke? at contact with lapilla tuff, (2 cm “FeO vein” included); chip
26-35	83m & 6m north	0.031g x 38 cm	From rusty, altered felsite dyke >75 cm wide at contact with lapilla tuff on north and fine-grained tuff on south; grab-chip sample

<u>Sample No.</u>	<u>Location</u>	<u>Value (g/t) x Width (cm)</u>	<u>Description</u>
<u>Bonanza (Claim 1221025)</u>			
25-1	66.5W+9.5S	1.872g x 50cm	Quartz vein(84%) split by 8 cm (16%) schist in shear at contact of felsite dyke and tuff; FeO, pyrite, tourmaline; channel
25-2	225W+100S	0.296g x 16 cm	At eastern end of water-filled trench; vein pinches out only 1.3 m to east but broadens to 48 cm in water only 1 m to west; quartz vein with pyrite, rust; chip
25-3	205W+100S	2.716g x 10 cm	Quartz, tourmaline, FeO; chip
25-4	180W+100S	0.284g x 15 cm	Quartz, FeO; channel
25-5	277W+2S	6.044g x 40 cm	31 cm quartz split by 9cm schist; tourmaline, pyrite, rust; channel
25-6	257W+5.5S	0.734g x 12 cm	West face of pit; quartz, tourmaline, FeO; grab
25-7	135W+13S	1.831g x 10 cm	Quartz vein in shear, abundant FeO; channel
25-8	107.5W+13S	6.314g x 22 cm	Entrance to open cut; average of 2 channels 65 cm apart; quartz with py & trmln
25-9	95W+13S	0.401g x 29 cm	Quartz, abundant trmln; chip
25-10	200W+10N	0.081g x 26 cm	Pit face; quartz vein >22.5 cm <33 cm; muscovite, trmln, FeO; chip
25-11	c.400E+00	0.100g x 50 cm	Contact of felsic tuff and lava flow on south; in fracture zone with quartz stringers & veins <10 cm, py, FeO; chip
25-12	229.5W+78S	0.307g x 253 cm	Silicified stress fracture zone; c. 20% quartz veins and stringers pinching, swelling, crossing, branching; FeO; py, trmln; chip
25-13	280W+105S	12.304g x 42 cm	South side of fractured flow on west lip of pit; Quartz with mica, trmln, rust; chip-channel
25-14	315W+100S	4.787g x 20 cm	At contact of mafic dyke & felsic flow; altered zone; quartz, rust, minor py & trmln; chip
25-15	228W+100S	0.017g x 40 cm	In small pit; quartz, FeO, minor mica; grab-chip
25-16	300W+100S	2.599g x 22 cm	Quartz & silicified, altered felsic flow in fracture contact with dyke; grab

Lost Mine (Claims 1149886 & 1149887)

86-1	120W+20S	1.335g x 48 cm	In pit; composite of 23 cm dark silicified shear in felsite on north and 25 cm on south with quartz stringer and 5 cm vein in dark zone; chip
86-2	120W+26S	0.139g x 77 cm	Buff to pinkish fractured felsite dyke with random quartz stringers; chip
86-3	c.380W+20N	0.041g x 50 cm	In shallow pit; silicified tuff fracture zone; minor FeO, py; representative grab
87-1	26E+33S	7.428g x 16 cm	Quartz, mica, trmln, chlorite, abundant FeO; Channel

87-2	6.305g x 38 cm	49E+35S	West lip of shaft; south to north: 8cm quartz, 18 cm schist, 12 cm quartz; FeO, chlorite; chip
87-3	5.451g x 11.5 cm	92E+30.5S	Rusty quartz vein at dyke contact in tuff; channel
87-4	4.468g x 54 cm	97E+30S	Sheared, dark dyke; chip
87-5	0.205g x 27 cm	92E+30.5S	South side of #87-3; dark, sheared wall rock; chip

2003 ABBREVIATED WORK LOG

<u>Date</u>	<u>Description of Main Work</u>	<u>Hours</u>
Good Luck (Claim 1221026)		
4-10	Brushing overgrown trenches & pits; prospecting	3 1/4
4-15	Brushing, prospecting, sampling	5
4-22	Cleaning old trenches	8
4-25	Sampling, stripping, pitting, measuring	8
5-13	Stripping, pitting, sampling	8
5-29	Stripping and pitting, including sledge-hammering boulders	8
5-31	Pitting, trenching, measuring	8
6-2	Stripping, pitting	8
6-4	Stripping, measuring	7 1/2
6-7	Sampling	6
8-29	Earth trenching	5 1/2
8-31	Sampling, stripping	8
9-3	Stripping, trenching, sampling	8
9-5	Stripping, trenching, sampling	8
9-7	Pitting, sampling	<u>8</u>
Total Hours		107 1/4
Bonanza (Claim 1221025)		
6-11	Stripping, line cutting	6
6-18	Brushing overgrown trenches, line cutting	8
6-23	Stripping, brushing, line cutting	8
6-27	Sampling, line cutting	8
8-10	Stripping, line cutting	6
8-22	Sampling, stripping, prospecting	5
8-23	Prospecting, stripping	7
8-27	Stripping, sampling, prospecting	6
9-9	Stripping, sampling, prospecting	8
10-5	Stripping, line cutting	8
10-7	Sampling, stripping	<u>8</u>
Total Hours		78

Lost Mine (Claim 1149886)		
5-27	Stripping, sampling, prospecting	5
8-27	Sampling, prospecting	<u>2</u>
	Total Hours	7

Lost Mine (Claim 1149887)		
5-21	Stripping, earth pit	8
5-24	Stripping, earth pit	8
5-27	Stripping, sampling, prospecting	<u>3</u>
	Total Hours	19

Claim 3011094		
4-10	Cleaning, brushing old pit	2
6-4	Stripping, brushing	1
6-11	Stripping, prospecting	<u>2</u>
	Total Hours	5

CALCULATION OF ASSESSMENT VALUE

Note: Labor based on \$150 / 8 hour day = \$18.75 / hour

Good Luck (Claim 1221026)		
Labor	107 1/4 hours x \$18.75	\$2010.94
Assay Invoice #81619		136.75
Assay Invoice #81718		91.16
Assay Invoice #81883		151.94
Assay Invoice #81884		11.77
Assay Invoice #82562 (9/15 of total samples)	9/15 x \$227.91 =	136.75
Sample shipment (postage):	\$7.15 + 6.65 + 7.97 + 13.32 =	<u>35.09</u>
	Assessment Value	\$2574.40

Bonanza (Claim 1221025)		
Labor	78 hours x \$18.75	\$1462.50
Assay Invoice #82043		121.55
Assay Invoice #82843		45.58
Assay Invoice #82662 (5/15 of total samples)	5/15 x \$227.91 =	75.97
Sample shipment (postage):	\$8.25 + 6.58 =	<u>14.83</u>
	Assessment Value.....	\$1720.43

Lost Mine (Claim 1149886)

Labor 7 hours x \$18.75		\$131.25
Assay Invoice #82562 (1/15 of total samples)	1/15 x \$227.91 =	15.19
Assay Invoice #81788 (2/7 of total samples)	2/7 x \$106.36 =	30.39
	Assessment Value	\$176.83

Lost Mine (Claim 1149887)

Labor 19 hours x \$18.75		\$356.25
Assay Invoice #81788 (5/7 of total samples)	5/7 x \$106.36 =	75.97
Sample shipment (postage)		8.24
	Assessment Value	\$440.46

Claim 3011094

Labor 5 hours x \$18.75		\$93.75
	Assessment Value	\$93.75

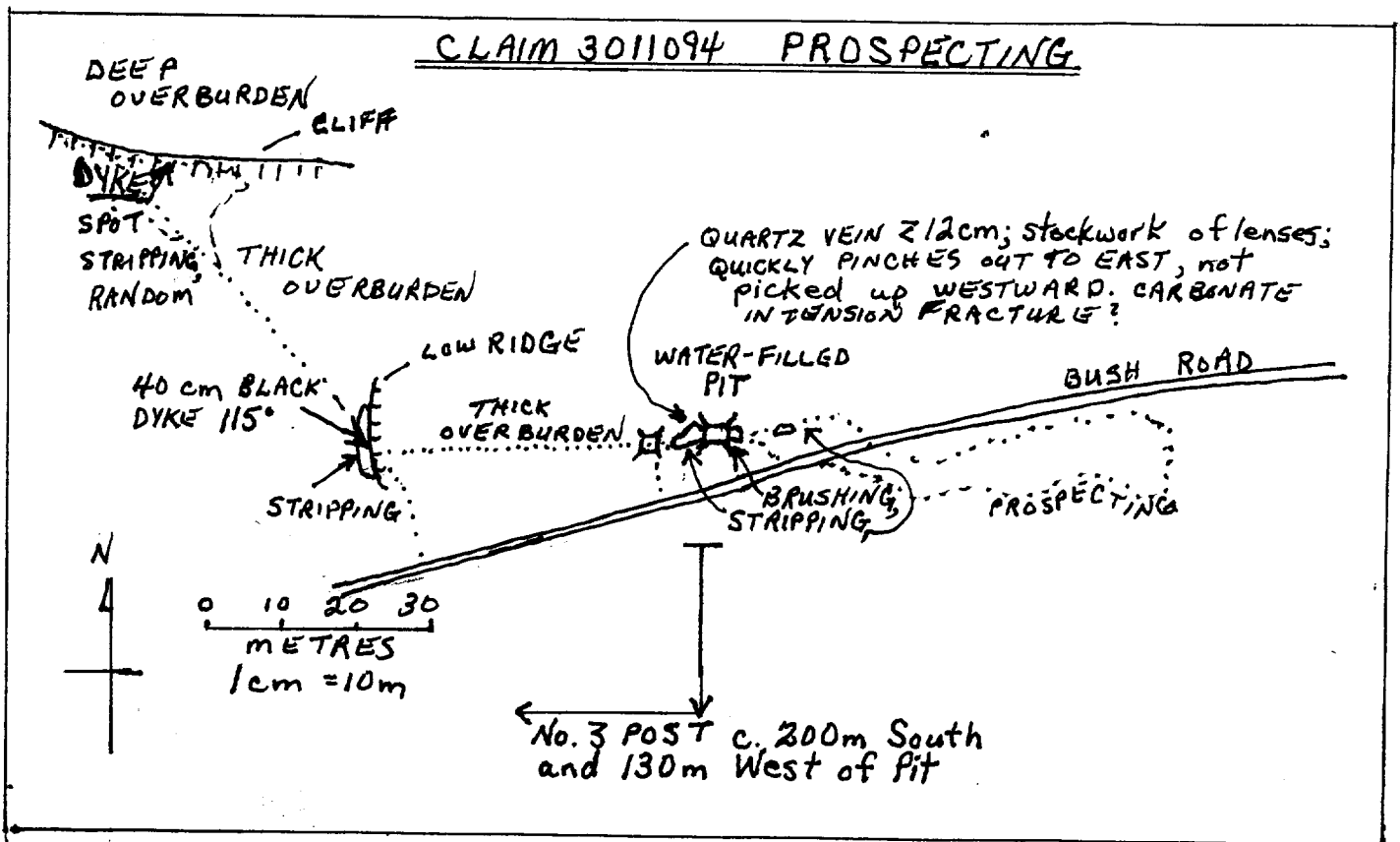

GOOD LUCK

CLAIM 1221026

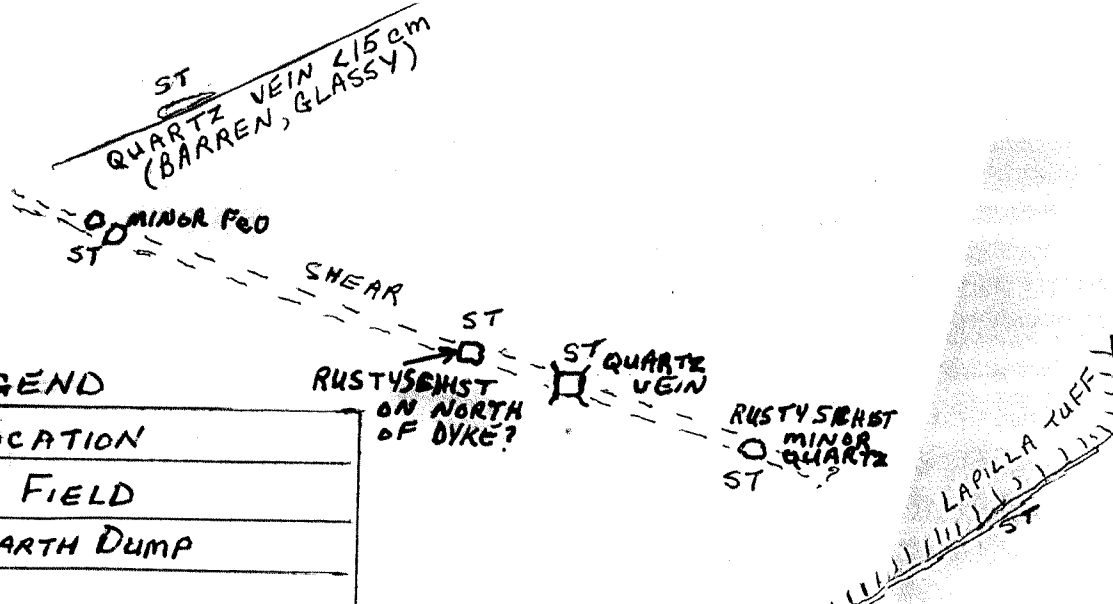

LEGEND

⊙	ASSAY LOCATION
⊙⊙	BOULDER FIELD
	ROCK/EARTH DUMP
⌊	PIT
≡	TRENCH
⌋	EDGE/CLIFF
⌋	SWAMP
⊙	ST STRIPPING
⊙	PT NEW EARTH PITTING
⊙	TR NEW EARTH TRENCHING

26-4 ASSAYS OVER 14g/t

NOTE: AN IMPORTANT FELSIC DYKE MAY LIE NEXT TO OR UNDER THE ENTIRE 200 m CHAIN OF PITS AND TRENCHES

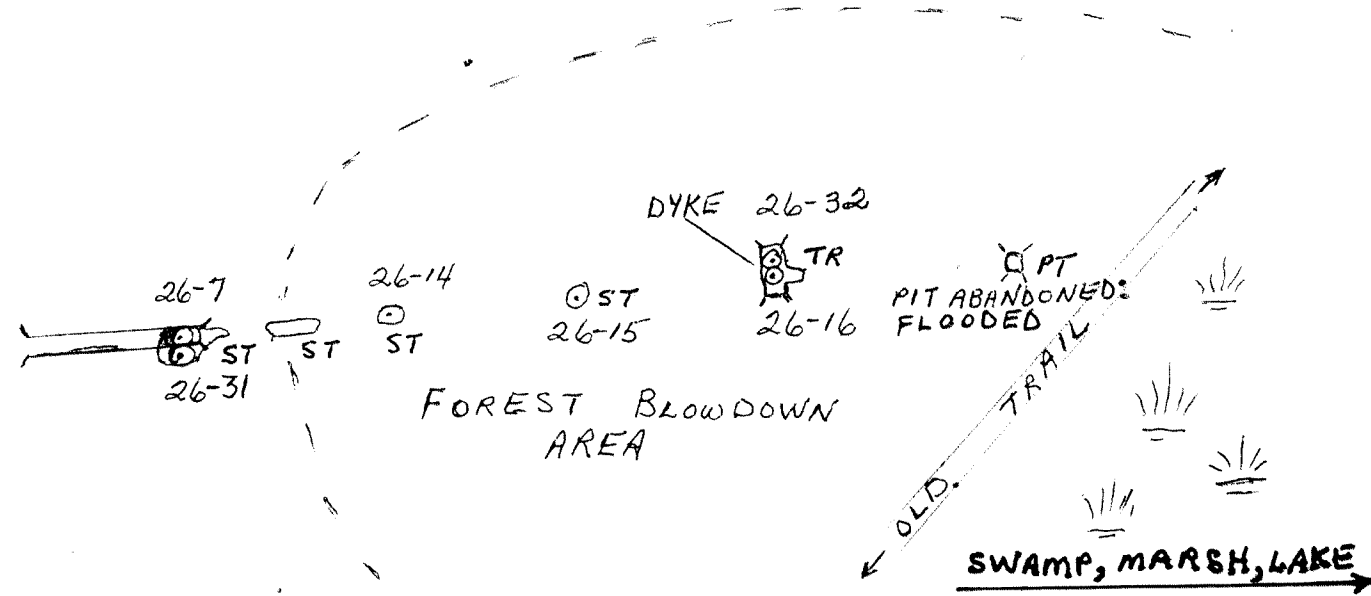
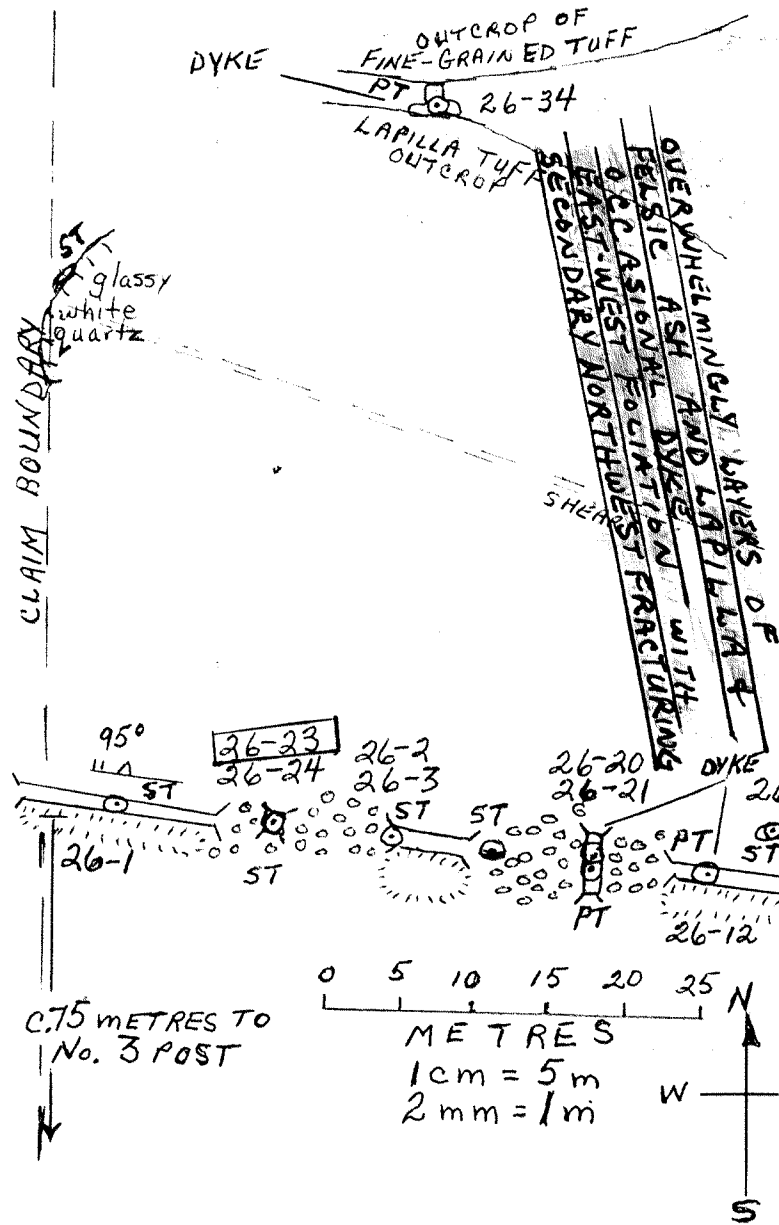

BONANZA CLAIM 1221025

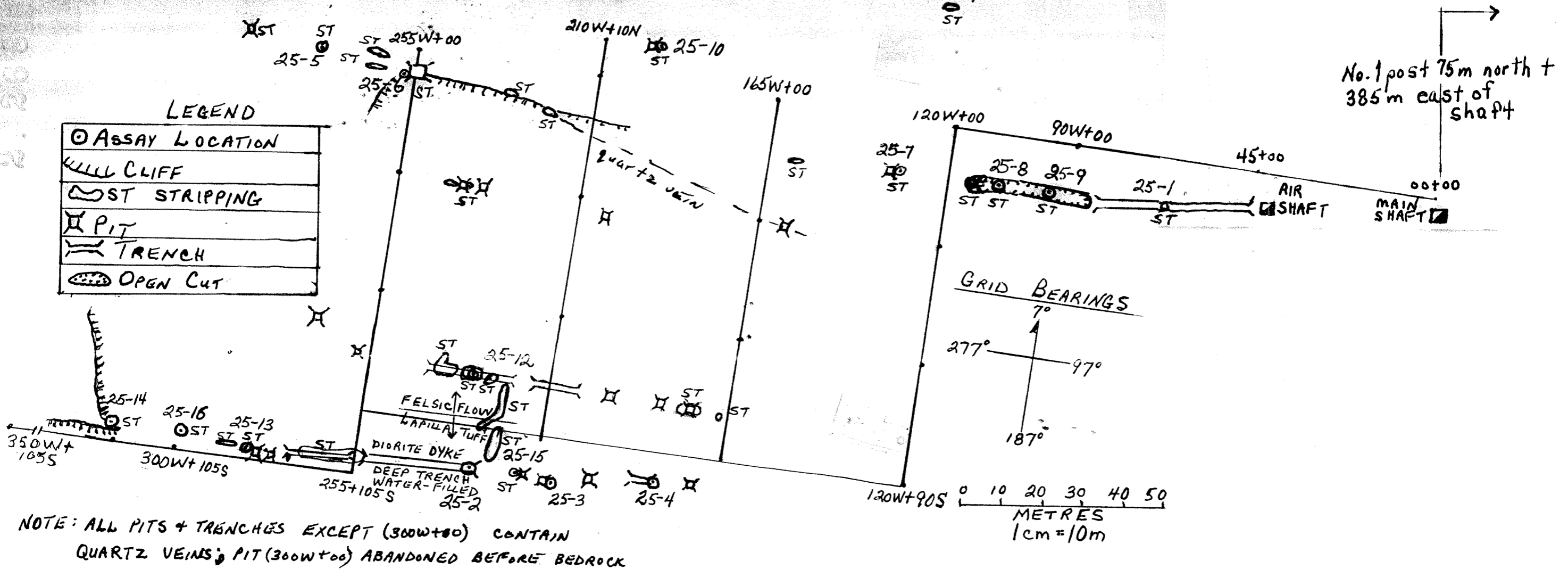

BONANZA PERIPHERAL AREAS OF PROSPECTING

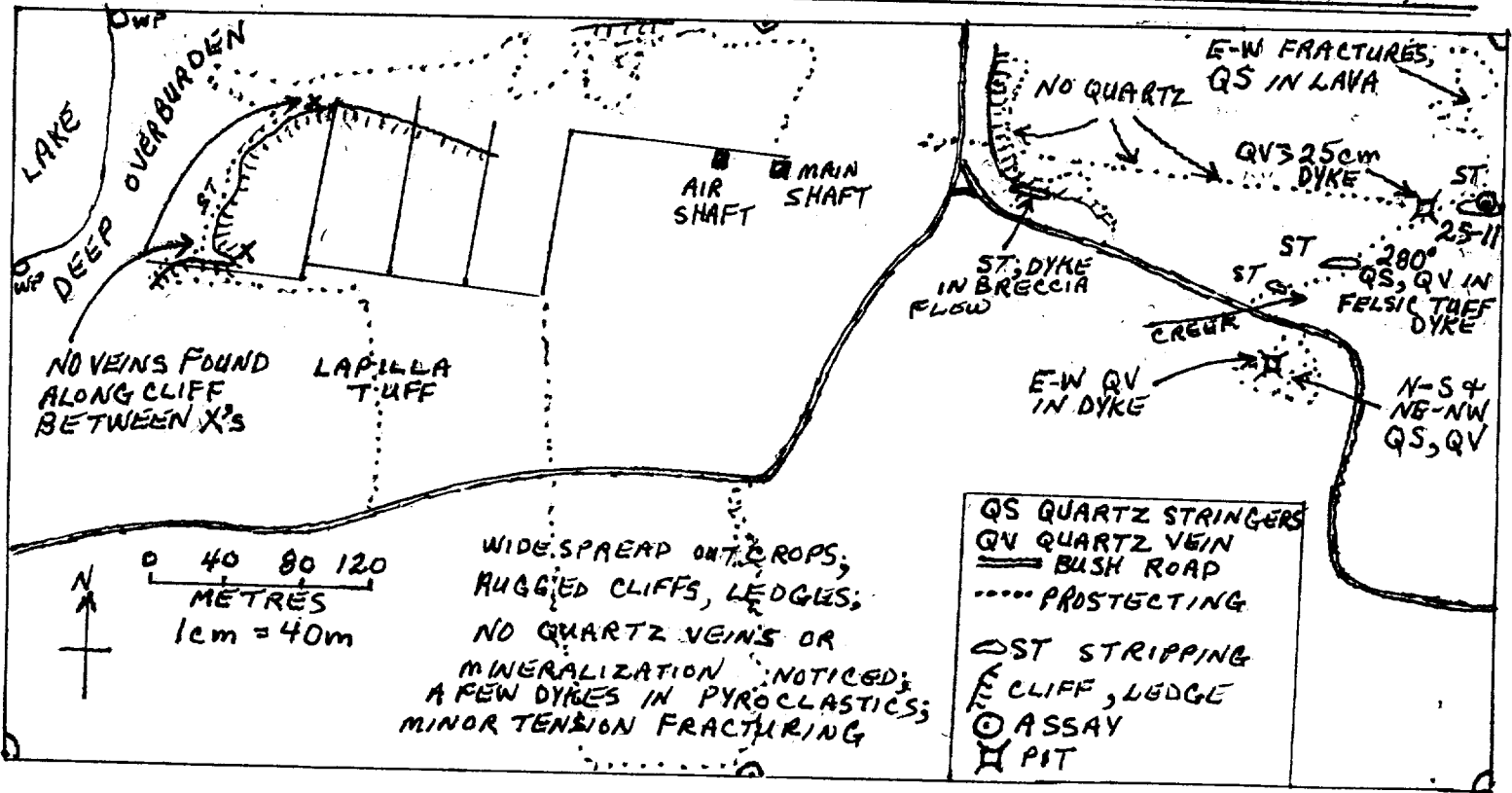

LOST MINE PROSPECTING & WORK AREAS

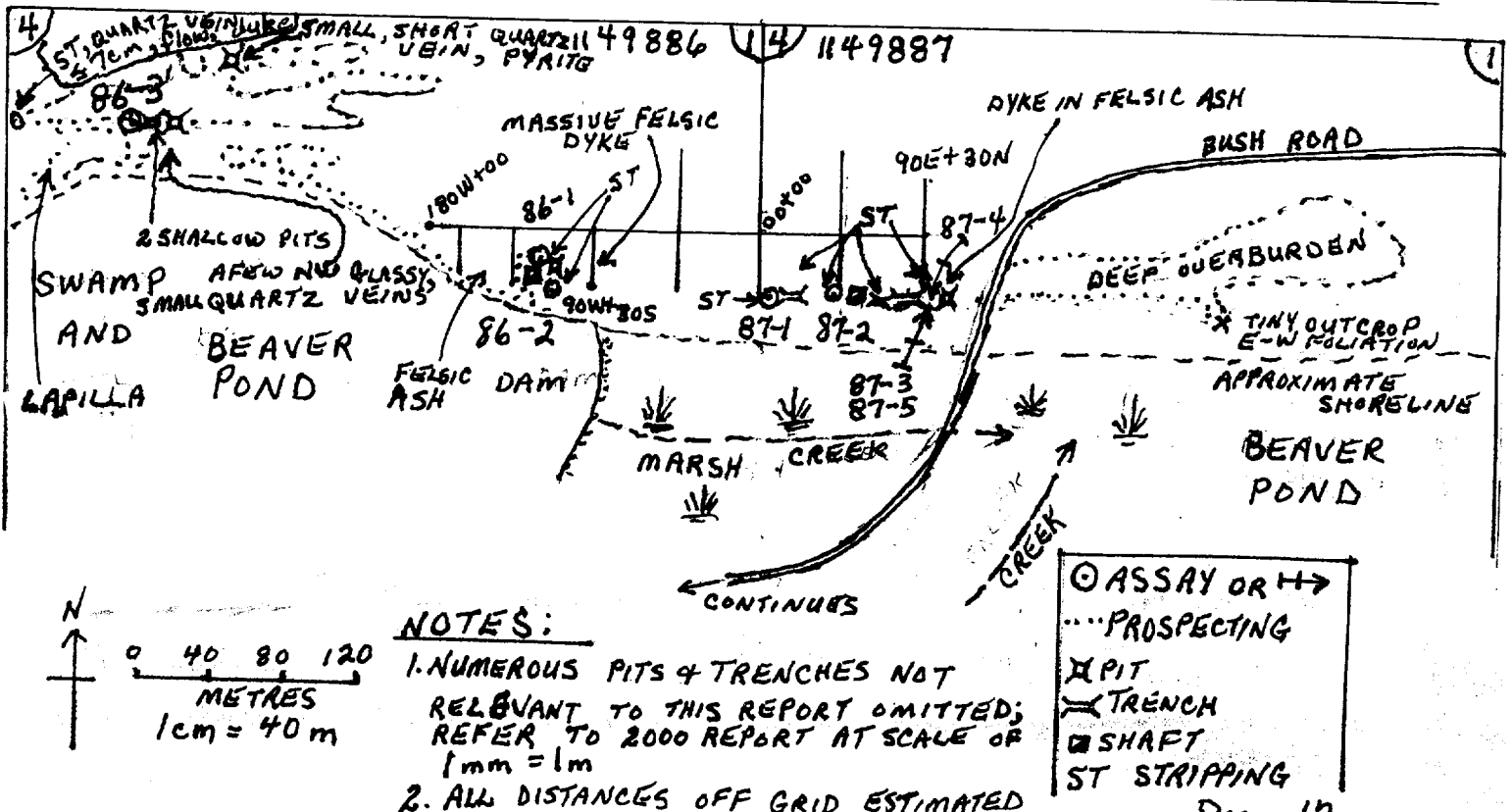

NOTES:

1. NUMEROUS PITS & TRENCHES NOT RELEVANT TO THIS REPORT OMITTED; REFER TO 2000 REPORT AT SCALE OF 1mm = 1m
2. ALL DISTANCES OFF GRID ESTIMATED



1070 LITHIUM DRIVE, UNIT 2 THUNDER BAY, ONTARIO P7B 6G3
PHONE (807) 626-1630 FAX (807) 623 6820 EMAIL accuracy@tbaytel.net WEB www accurassay.com

Certificate of Analysis

Tuesday, June 03, 2003

Sovereign, William
103 Wabigoon
Dryden, ON, CA
P8N1W4
Ph#: (807) 223-6311
Fax#:
Email bsovereign@dryden.net

Date Received : 29-May-03
Date Completed : 02-Jun-03
Job # 200340510
Reference :
Sample #: 7 Rock

Accurassay #	Client Id	Au ppb	Au oz/t	Au g/t (ppm)
29127	86-1	1335	0.039	1.335
29128	86-2	139	0.004	0.139
29129	87-1	7428	0.217	7.428
29130	87-2	6305	0.184	6.305
29131	87-3	5451	0.159	5.451
29132	87-4	4468	0.130	4.468
29133	87-5	175	0.005	0.175
29134 Check	87-5	205	0.006	0.205

PROCEDURE CODES: AL 4403

Certified By: 

AL903-0386-06/03/2003 08:06 AM



1070 LITHIUM DRIVE, UNIT 2 THUNDER BAY, ONTARIO P7B 6G3
PHONE (807) 626-1630 FAX (807) 623 6820 EMAIL accuracy@tbaytel.net WEB www accurassay.com

Certificate of Analysis

Friday, May 02, 2003

Sovereign, William
103 Wabigoon
Dryden, ON, CA
P8N1W4
Ph#: (807) 223-6311
Fax#:
Email bsovereign@dryden.net

Date Received : 30-Apr-03
Date Completed : 02-May-03
Job # 200340357
Reference :

Sample #: 9 Rock

Accurassay #	Client Id	Au ppb	Au oz/t	Au g/t (ppm)
25021	26-1	2056	0.060	2.056
25022	26-2	5937	0.173	5.937
25023	26-3	197	0.006	0.197
25024	26-4	14167	0.413	14.167
25025	26-5	531	0.016	0.531
25026	26-6	747	0.022	0.747
25027	26-7	4759	0.139	4.759
25028	26-8	42	0.001	0.042
25029	26-9	1435	0.042	1.435
25030 Check	26-9	1457	0.043	1.457

PROCEDURE CODES: AL4A-03

Certified By: 

AL903-0386-05/02/2003 09:55 AM



1070 LITHIUM DRIVE, UNIT 2 THUNDER BAY, ONTARIO P7B 6G3
PHONE (807) 626-1630 FAX (807) 623 6820 EMAIL accuracy@tbaytel.net WEB www accurassay.com

Certificate of Analysis

Thursday, May 22, 2003

Sovereign, William
103 Wabigoon
Dryden, ON, CA
P8N1W4
Ph#: (807) 223-6311
Fax#:
Email bsovereign@dryden.net

Date Received : 20-May-03
Date Completed : 22-May-03
Job # 200340434

Reference :

Sample #: 6 Rock

Accurassay #	Client Id	Au ppb	Au oz/t	Au g/t (ppm)
27141	26-10	40650	1.186	40.650
27142	26-11	2215	0.065	2.215
27143	26-12	4022	0.117	4.022
27144	26-13	15247	0.445	15.247
27145	26-14	1671	0.049	1.671
27146	26-15	1188	0.035	1.188
27147 Check	26-15	1079	0.031	1.079

PROCEDURE CORES: AL1Au3

Certified By: 

AL903-0386-05/22/2003 04:20 PM

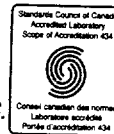

1070 LITHIUM DRIVE, UNIT 2 THUNDER BAY, ONTARIO P7B 6G3
PHONE (807) 626-1630 FAX (807) 623 6820 EMAIL accuracy@tbaytel.net WEB www accurassay.com

Certificate of Analysis

Thursday, June 19, 2003

Sovereign, William
103 Wabigoon
Dryden, ON, CA
P8N1W4
Ph#: (807) 223-6311
Fax#:
Email bsovereign@dryden.net

Date Received : 16-Jun-03
Date Completed : 19-Jun-03
Job # 200340624

Reference :
Sample #: 2 Pulp's

Accurassay #	Client Id	Ag ppm	Co ppm	Cu ppm	Fe ppm	Ni ppm	Pb ppm	Zn ppm
32995	26-17	2						
32996	26-23	18						
32997 Check	26-23	9						

PROCEDURE CODES: AL1A

Certified By: 

AL901-0386-06/19/2003 01:26 PM



1070 LITHIUM DRIVE, UNIT 2 THUNDER BAY, ONTARIO P7B 6G3
PHONE (807) 626-1630 FAX (807) 623 6820 EMAIL accuracy@tbaytel.net WEB www accurassay.com

Certificate of Analysis

Monday, June 16, 2003

Sovereign, William
103 Wabigoon
Dryden, ON, CA
P8N1W4
Ph#: (807) 223-6311
Fax#:
Email bsovereign@dryden.net

Date Received : 11-Jun-03
Date Completed : 16-Jun-03
Job # 200340594
Reference :
Sample #: 10 Rock

Accurassay #	Client Id	Au ppb	Au oz/t	Au g/t (ppm)
31998	26-16	3607	0.105	3.607
31999	26-17	17896	0.522	17.896
32000	26-18	5827	0.170	5.827
32001	26-19	556	0.016	0.556
32002	26-20	5248	0.153	5.248
32003	26-21	38	0.001	0.038
32004	26-23	106096	3.095	106.096
32005	26-24	47	0.001	0.047
32006	26-25	1751	0.051	1.751
32007	26-26	4937	0.144	4.937
32008 Check	26-26	4990	0.146	4.990

PROCEDURE CODES: AL4Au3

Certified By: 

AL903-0386-06/16/2003 02:20 PM



1070 LITHIUM DRIVE, UNIT 2 THUNDER BAY, ONTARIO P7B 6G3
PHONE (807) 626-1630 FAX (807) 623 6820 EMAIL accuracy@tbaytel.net WEB www accurassay.com

Certificate of Analysis

Tuesday, July 08, 2003

Sovereign, William
103 Wabigoon
Dryden, ON, CA
P8N1W4
Ph#: (807) 223-6311
Fax#:
Email bsovereign@dryden.net

Date Received : 03-Jul-03
Date Completed : 08-Jul-03
Job # 200340759
Reference :
Sample #: 8 Rock

Accurassay #	Client Id	Au ppb	Au oz/t	Au g/t (ppm)
38206	25-1	1872	0.055	1.872
38207	25-2	296	0.009	0.296
38208	25-3	2716	0.079	2.716
38209	25-4	284	0.008	0.284
38210	25-5	6044	0.176	6.044
38211	25-6	734	0.021	0.734
38212	25-7	1831	0.053	1.831
38213	25-8	6028	0.176	6.028
38214 Check	25-8	6314	0.184	6.314

PROCEDURE CODES: AL 1403

Certified By: 

AL903-0386-07/08/2003 03:38 PM

1070 LITHIUM DRIVE, UNIT 2 THUNDER BAY, ONTARIO P7B 6G3
PHONE (807) 626-1630 FAX (807) 623 6820 EMAIL accuracy@tbaytel.net WEB www accurassay.com

Certificate of Analysis

Wednesday, October 29, 2003

Sovereign, William
103 Wabigoon
Dryden, ON, CA
P8N1W4
Ph#: (807) 223-6311
Fax#:
Email bsovereign@dryden.net

Date Received : 20-Oct-03
Date Completed : 29-Oct-03
Job # 200341524

Reference :

Sample #: 3 Rock

Accurassay #	Client Id	Au ppb	Au oz/t	Au g/t (ppm)
65174	25-14	4787	0.140	4.787
65175	25-15	17	<0.001	0.017
65176	25-16	2500	0.073	2.500
65177 Check	25-16	2599	0.076	2.599

PROCEDURE CODES: AL4AU3

Certified By:

Derek Demianuk H.Bsc., Laboratory Manager

The results included on this report relate only to the items tested

The Certificate of Analysis should not be reproduced except in full, without the written approval of the laboratory

Page 1 of 1

AL903-0386-10/29/2003 03:18 PM

1070 LITHIUM DRIVE, UNIT 2 THUNDER BAY, ONTARIO P7B 6G3
PHONE (807) 626-1630 FAX (807) 623 6820 EMAIL accuracy@tbaytel.net WEB www accurassay.com

Certificate of Analysis

Wednesday, September 17, 2003

Sovereign, William

103 Wabigoon

Dryden, ON, CA

P8N1W4

Ph#: (807) 223-6311

Fax#:

Email bsovereign@dryden.net

Date Received : 12-Sep-03

Date Completed : 16-Sep-03

Job # 200341282

Reference :

Sample #: 15 Rock

Accurassay #	Client Id	Au ppb	Au oz/t	Au g/t (ppm)
55042	6-3	41	0.001	0.041
55043	25-9	401	0.012	0.401
55044	25-10	81	0.002	0.081
55045	25-11	100	0.003	0.100
55046	25-12	307	0.009	0.307
55047	25-13	12304	0.359	12.304
55048	26-27	38	0.001	0.038
55049	26-28	28	<0.001	0.028
55050	26-29	12	<0.001	0.012
55051	26-30	59	0.002	0.059
55052 Check	26-30	52	0.002	0.052
55053	26-31	145	0.004	0.145
55054	26-32	21	<0.001	0.021
55055	26-33	37	0.001	0.037
55056	26-34	31	<0.001	0.031
55057	26-35	31	<0.001	0.031

PROCEDURE CODES: AL7Au3

Certified By:

Derek Demianuk H.Bsc., Laboratory Manager

The results included on this report relate only to the items tested

The Certificate of Analysis should not be reproduced except in full, without the written approval of the laboratory

Page 1 of 1

Ministry of
Northern Development
and Mines

Ministère du
Développement du Nord
et des Mines



Date: 2003-DEC-22

GEOSCIENCE ASSESSMENT OFFICE
933 RAMSEY LAKE ROAD, 6th FLOOR
SUDBURY, ONTARIO
P3E 6B5

WILLIAM JOHN SOVEREIGN
103 WABIGOON DRIVE
DRYDEN, ONTARIO
P8N 1W4 CANADA

Tel: (888) 415-9845
Fax:(877) 670-1555

Submission Number: 2.26857
Transaction Number(s): W0310.01983

Dear Sir or Madam

Subject: Approval of Assessment Work

We have approved your Assessment Work Submission with the above noted Transaction Number(s). The attached Work Report Summary indicates the results of the approval.

At the discretion of the Ministry, the assessment work performed on the mining lands noted in this work report may be subject to inspection and/or investigation at any time.

If you have any question regarding this correspondence, please contact STEVEN BENETEAU by email at steve.beneteau@ndm.gov.on.ca or by phone at (705) 670-5855.

Yours Sincerely,

A handwritten signature in black ink that reads "Ron C Gashinski".

Ron C. Gashinski
Senior Manager, Mining Lands Section

Cc: Resident Geologist

William John Sovereign
(Claim Holder)

Assessment File Library

William John Sovereign
(Assessment Office)



52F10NW2004 2.26857 VAN HORNE

200

ONTARIO CANADA

MINISTRY OF NORTHERN DEVELOPMENT AND MINES
PROVINCIAL MINING RECORDERS OFFICE

Mining Land Tenure Map

Date / Time of Issue: Mon Dec 22 10:13:10 EST 2003

TOWNSHIP / AREA
VAN HORNE

PLAN
G-0839

ADMINISTRATIVE DISTRICTS / DIVISIONS

Mining Division: Kenora
Land Titles/Registry Division: KENORA
Ministry of Natural Resources District: DRYDEN

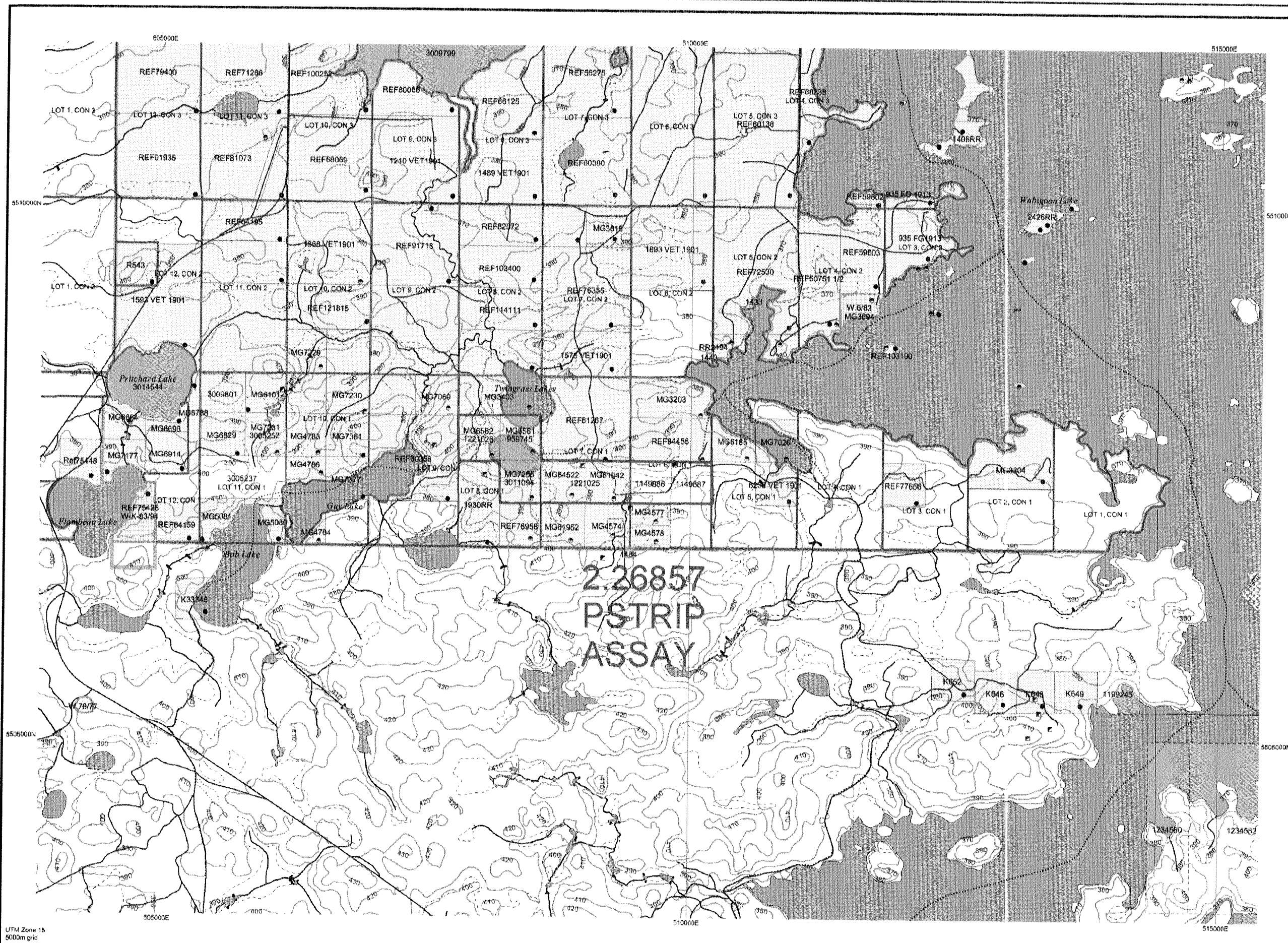

TOPOGRAPHIC

- Administrative Boundaries
- Township
- Concession, Lot
- Provincial Park
- Indian Reserve
- Cliff, Pit & Pile
- Contour
- Mine Shafts
- Mine Infrastructure
- Railway
- Road
- Trail
- Natural Gas Pipeline
- Utilities
- Tower

Land Tenure

- Freehold Patent
 - Surface And Mining Rights
 - Surface Rights Only
 - Mining Rights Only
- Leasehold Patent
 - Surface And Mining Rights
 - Surface Rights Only
 - Mining Rights Only
- Licence of Occupation
 - Uses Not Specified
 - Surface And Mining Rights
 - Surface Rights Only
 - Mining Rights Only
- Land Use Permit
- Order in Council (Not open for staking)
- Water Power Lease Agreement

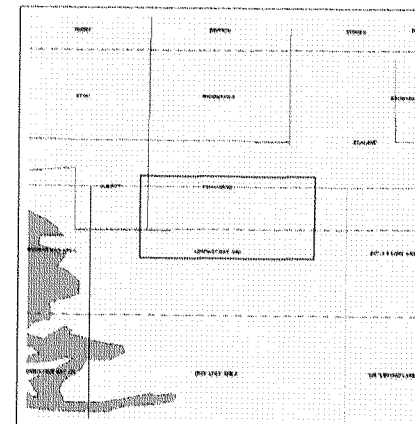

- Mining Claim
 - Filled Only Mining Claims
- LAND TENURE WITHDRAWALS**
- Areas Withdrawn from Disposition
 - Mining Acts Withdrawal Types**
 - Surface And Mining Rights Withdrawn
 - Surface Rights Only Withdrawn
 - Mining Rights Only Withdrawn
 - Order in Council Withdrawal Types
 - Surface And Mining Rights Withdrawn
 - Surface Rights Only Withdrawn
 - Mining Rights Only Withdrawn
 - IMPORTANT NOTICES



LAND TENURE WITHDRAWAL DESCRIPTIONS

Identifier	Type	Date	Description
1363	Wsm	Jan 1, 2001	CROWN RESERVE 8 AUG, 1959 FILE 16288
1366	Wsm	Jan 1, 2001	F-0083-20
1433	Wsm	Jan 1, 2001	Pending Disposition Under the Public Lands Act
1440	Wsm	Jan 1, 2001	Pending Disposition Under the Public Lands Act
1484	Wsm	Jan 1, 2001	CROWN RES
1557	Wsm	Jan 10, 1983	PROPOSED PARK RESERVE, JAN 1983 S.R.O. PUBLIC LANDS ACT
1559	Wsm	Jan 1, 2001	PROPOSED SHORT TERM LUD SPRING 86
W-K-34/01	Wsm	Jul 17, 2001	Sec 35 W-K-34/01 July-17-01 M.R.O. 195150
W-K-85/94	Wsm	May 31, 1994	SEC 35/90 W-R-83/64 NWR M & SR MAY 31/94 300PM CCT 195150
W 34/80	Wsm	Aug 20, 1980	W 34/80 W-23/80 MRS 198513
W 8/83	Wsm	Apr 11, 1983	SEC 36/80 W 6/83 11/6/83 M R O 14683
W 78/77	Wsm	Jan 1, 1980	W 78/77 28/5/77 S R O 181604
WK 10/89	Wsm	May 5, 1989	WK 10/89 MAY 3/89 SAL

Those wishing to stake mining claims should consult with the Provincial Mining Recorder's Office of the Ministry of Northern Development and Mines for additional information on the status of the lands shown hereon. This map is not intended for navigational, survey, or land title determination purposes as the information shown on this map is compiled from various sources. Completeness and accuracy are not guaranteed. Additional information may also be obtained through the local Land Titles or Registry Office, or the Ministry of Natural Resources.

General Information and Limitations
Contact Information
Provincial Mining Recorder's Office
Wildcat Green Miller Centre 933 Ramsey Lake Road
Sudbury ON P3E 8B6
Home Page: www.mrdn.gov.on.ca/MNDMMINES/LANDS/misrmap.htm

Toll Free
Tel: 1 (800) 415-6945 ext 678
Fax: 1 (877) 670-1444

Map Datum: NAD 83
Projection: UTM (5 degree)
Topographic Data Source: Land Information Ontario
Mining Land Tenure Source: Provincial Mining Recorder's Office

This map may not show unregistered land tenure and interests in land including certain patents, leases, easements, right of ways, flooding rights, licences, or other forms of disposition of rights and interests from the Crown. Also certain land tenure and land uses that restrict or prohibit the entry to staking mining claims may not be illustrated.