

PAUL'S CUSTOM FIT



52F10SE0019 2.12464 TURTLEPOND LAKE

010

PAUL OKANSKI, Assayer
Box 253, Cochenour, Ontario POV:1LO

RECEIVED SEP 23 1988

Bond Gold Canada Inc,

ASSAY CERTIFICATE

Date: Sept. 19, 1988.

Sample No.	Description	oz/ton Au	oz/ton Ag
1	WW-01 K. Leonard (1 ASSAY TON)	.06	
2	02	.38	
3	03	.29	
4	04	.24	
5	05	.13	
6	06	.13	
7	07	.07	
8	08	.08	
9	09	.27	
10	10	.13	
11	11	.07	
12	12	.06	
13	13	.06	
14	14	.13	
15			
16			
17			
18			
19			
20			
21			
22			
23			
24			
25			

Assayer:

Paul Okanski

RECEIVED OCT 2 1 1988

PAUL'S CUSTOM FIRE ASSAYING LTD.

Phone: Bus. (807) 662-6171
Res. (807) 662-3361

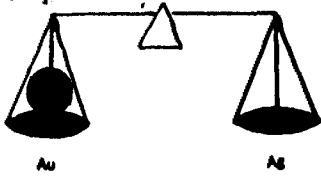

Canada Inc.

PAUL OKANSKI, Assayer
Box 253, Cochenour, Ontario POV 1L0

Bill Miller
gpc/m

Bond Gold ~~Miner~~

ASSAY CERTIFICATE

Date: Oct. 14, 1988.

Sample No.	Description	oz/ton Au	oz/ton Ag
1	28001 Project #346 (1 ASSAY TON)	Trace	
2	02	"	
3	28132	"	
4	33	.04	
5	34	.09	
6	35	Trace	
7	36	.04	
8	37	.09	
9	38	Trace	
10	39	"	
11	40	"	
12	41	"	
13	42	"	
14	43	.04	
15	44	Trace	
16	45	.05	
17	46	.28	
18	47	.10	
19	48	.09	
20	49	.07	
21	50	.01	
22	51	.09	
23	52	Trace	
24	53	.03	
25	54	.04	

Assayer: *Paul Okanski*

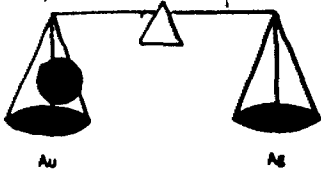

PAUL'S CUSTOM FIRE ASSAYING LTD.

Phone: Bus. (807) 662-8171
Res. (807) 662-3361

PAUL OKANSKI, Assayer
Box 253, Cochenour, Ontario POV 1L0

ASSAY CERTIFICATE

Date: Oct. 14, 1988.

Bond GOLD Canada Inc.

	Sample No.	Description	oz/ton Au	oz/ton Ag
1	28155	#346 (1 ASSAY TON)	.04	
2	56		.04	
3	57		.06	
4	58		Trace	
5	59		.07	
6	60		.08	
7	61		.08	
8	62		.05	
9	63		.03	
10	64		Trace	
11	65		.13	
12	66		.07	
13	67		Trace	
14	68		.03	
15	69		Trace	
16	70		.14	
17	71		.04	
18	72		.05	
19	73		.05	
20	74		.05	
21	28209		.13	
22	10		.09	
23	11		Trace	
24				
25				

Assayer:

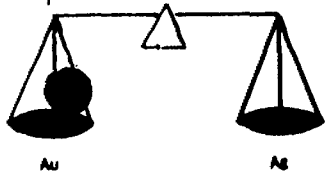

RECEIVED OCT 21 1988

PAUL'S CUSTOM FIRE ASSAYING LTD.

Phone: Bus. (807) 662-8171
Res. (807) 662-3361

PAUL OKANSKI, Assayer
Box 253, Cochenour, Ontario POV 1L0

Bond Gold Canada Inc,

ASSAY CERTIFICATE

Date: Oct. 12, 1988.

Sample No.	Description	oz/ton Au	oz/ton Ag
1	28120 #1346 (1 ASSAY TON)	.08	
2	21	.12	
3	22	.02	
4	23	Trace	
5	24	.03	
6	25	.03	
7	26	.04	
8	27	.01	
9	28	.01	
10	29	.03	
11	30	.03	
12	31	.07	
13	28201	.08	
14	02	Trace	
15	03	.04	
16	04	.05	
17	05	.06	
18	06	.14	
19	07	Trace	
20	08	x .01	
21			
22			
23			
24			
25			

Assayer: *Paul Okanski*

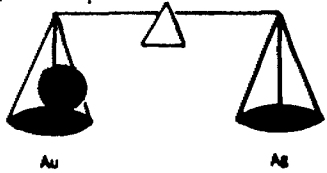

RECEIVED OCT 25 1988
PAUL'S CUSTOM FIRE ASSAYING LTD.

Phone: Bus. (807) 662-8171
Res. (807) 662-3361

PAUL OKANSKI, Assayer
Box 253, Cochenour, Ontario P0V 1L0

*the file white water
geochem*

Bond Gold Canada Inc.

ASSAY CERTIFICATE

Date: Oct. 19, 1988.

Sample No.	Description	oz/ton Au	oz/ton Ag
1	28003 Project # 346 (1 ASSAY TON)	Trace	
2	04	"	
3	05	"	
4	06	.05	
5	07	Trace	
6	08	"	
7	09	"	
8	10	.13	
9	11	.04	
10	12	.08	
11	13	.05	
12	14	.04	
13	15	.13	
14	16	.09	
15	17	.10	
16	18	.13	
17	19	.08	
18	20	.12	
19	21	.05	
20	22	.02	
21	23	.06	
22	28175	.02	
23	76	.04	
24	77	Trace	
25	78	.09	

*Robert [unclear]
white*

Assayer:

Paul Okanski

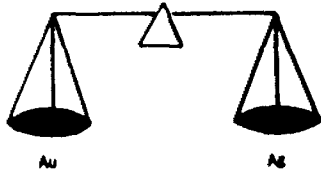

PAUL'S CUSTOM FIRE ASSAYING LTD.

Phone: Bus.
Res.

PAUL OKANSKI, Assayer
Box 253, Cochenour, Ontario POV 1L0

Bond Gold Canada Inc.

ASSAY CERTIFICATE

Date: Oct. 19

	Sample No.	Description	oz/ton Au
1	28179	# 346 (1 ASSAY TON)	.17
2	80		.04
3	81		.03
4	82		Trace
5	83		.09
6	84		Trace
7	85		"
8	86		.04
9	87		.03
10	88		.07
11	89		.07
12	90		.05
13	91		.09
14	92		.05
15	93		Trace
16	94		"
17	95		.01
18	96		Trace
19	97		.05
20	98		x .18
21	00		.04

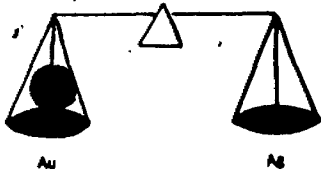

RECEIVED OCT 31 1988

PAUL'S CUSTOM FIRE ASSAYING LTD.

Phone: Bus. (807) 662-8171
Res. (807) 662-3361

PAUL OKANSKI, Assayer
Box 253, Cochenour, Ontario P0V 1L0

Bond Gold Canada Inc.

ASSAY CERTIFICATE

Date: Oct. 24, 1988.

	Sample No.	Description	oz/ton Au	oz/ton Ag
1	28024	Project #346 (1 ASSAYTON)	Trace	
2	25		.03	
3	26		.05	
4	27		Trace	
5	28		.06	
6	29 29		Trace	
7	30		"	
8	31		.02	
9	32		Trace	
10	33		"	
11	34		.19	
12	35		.04	
13	36		.03	
14	37		Trace	
15	38		"	
16	39		"	
17	40		"	
18	41		"	
19	42		"	
20	43		"	
21	44		"	
22	45		.01	
23	46		.09	
24	47		Trace	
25	48x		.03	

Assayer:

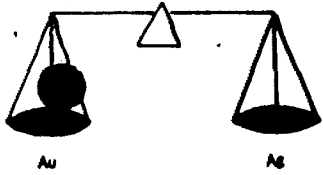

PAUL'S CUSTOM FIRE ASSAYING LTD.

Phone: Bus. (807) 662-8171
Res. (807) 662-3361

PAUL OKANSKI, Assayer
Box 253, Cochenour, Ontario P0V 1L0

Bond Gold Canada Inc,

ASSAY CERTIFICATE

Date: Oct. 24, 1988.

Sample No.	Description	oz/ton Au	oz/ton Ag
1	28049 #346 (1 ASSAY TON)	.07	
2	50	.02	
3	51	.03	
4	52	Trace	
5	53	"	
6	54	1.19	
7	55	.14	
8	56	.03	
9	57	Trace	
10	58	.01	
11	59	Trace	
12	60	""	
13	61	"	
14	62	.01	
15	63	.05	
16	64	.02	
17	65	Trace	
18	66	"	
19	67	"	
20	68	.48	
21	69	.05	
22	70	.03	
23	71	.16	
24	72	.33	
25	73	.07	

Assayer:

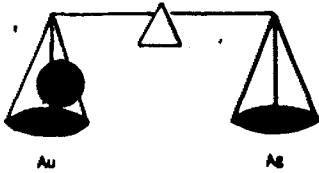

PAUL'S CUSTOM FIRE ASSAYING LTD.

Phone: Bus. (807) 662-8171
Res. (807) 662-3361

PAUL OKANSKI, Assayer
Box 253, Cochenour, Ontario POV 1L0

ASSAY CERTIFICATE

Date: Oct. 24, 1988.

Bond Gold Canada Inc,

	Sample No.	Description	oz/ton Au	oz/ton Ag
1	28074	#346 (1 ASSAY TON)	Trace	
2	75		"	
3	76		.03	
4	77		.05	
5	78		.09	
6	79		Trace	
7	80		"	
8	81		"	
9				
10				
11				
12				
13				
14				
15				
16				
17				
18				
19				
20				
21				
22				
23				
24				
25				

Assayer: *Paul Okanski*



PAUL'S CUSTOM FIRE ASSAYING LTD.

Phone: Bus. (807) 662-8171
Res. (807) 662-3361

PAUL OKANSKI, Assayer
Box 253, Cochenour, Ontario P0V 1L0

Bond Gold Canada Inc.

ASSAY CERTIFICATE

Date: Oct. 25, 1988.

Sample No.	Description	oz/ton Au	oz/ton Ag
1	28218 #346 (1 ASSAY TON)	Trace	
2	19	"	
3	20	.01	
4	21	Trace	
5	22	.04	
6	23	x0k .11	
7	24	.09	
8	25	.68	
9	26	.03	
10	27	Trace	
11	28	"	
12	29	"	
13	30	"	
14			
15			
16			
17			
18			
19			
20			
21			
22			
23			
24			
25			

Assayer: *Paul Okanski*

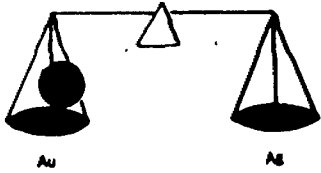

PAUL'S CUSTOM FIRE ASSAYING LTD.

Phone: Bus. (807) 662-8171
Res. (807) 662-3361

PAUL OKANSKI, Assayer
Box 253, Cochenour, Ontario P0V 1L0

OCT 25 1988

Bond Gold Canada Inc,

ASSAY CERTIFICATE

Date: Oct. 25, 1988.

Sample No.	Description	oz/ton Au	oz/ton Ag
1	28082 #346 (1 Assay Ton)	Trace	
2	83	"	
3	84	xt .01	
4	85	.03	
5	86	Trace	
6	87	"	
7	88	"	
8	89	.05	
9	90	Trace	
10	91	"	
11	92	.03	
12	93	.01	
13	94	.01	
14	95	Trace	
15	96	"	
16	97	"	
17	98	.01	
18	99	.11	
19	28100	.10	
20	28212	.19	
21	13	.02	
22	14	Trace	
23	15	.01	
24	16	.02	
25	17	Trace	

Assayer:



BARRINGER

RECEIVED OCT 11 1988

304 CARLINGVIEW DRIVE
REXDALE, ONTARIO
CANADA M9W 5G2
PHONE: 416-675-3870
FAX: 416-675-3876

5735 McADAM ROAD
MISSISSAUGA, ONTARIO
CANADA L4Z 1N9
PHONE: 416-890-8566
FAX: 416-890-8575

346

PROJECT?

. BOND GOLD
SUITE 1116
. 111 RICHMOND ST. WEST
TORONTO, ONTARIO
. M5H 2J4

DATE: SEPTEMBER 30, 1988

PROJECT: 100.41

PERIOD COVERED:

SALES ORDER:

PROGRESS BILLING:

SHIPPING REPORT:

WORK REPORT: 88-1203

FED. SALES TAX: N/A

ONT. SALES TAX: N/A

TERMS: NET 30 DAYS

AUTHORITY: KEVIN LEONARD

TO: ANALYSIS:

PAID NOV 24 1988

14 AU ASSAY FA/AA

7.50

105.00

TOTAL INVOICE

\$105.00

INTEREST AT 2% PER MONTH PAYABLE ON OVERDUE ACCOUNTS.

PLEASE REMIT PAYMENT TO: 304 CARLINGVIEW DRIVE

INVOICE No 13654

BOND GOLD (KEVIN LEONARD)

WD NO: 88-1203

PAGE: 1

SAMPLE ID	AU PPM
WW-1	1.33
WW-2	6.98
WW-3	12.1
WW-4	7.02
WW-5	4.41
WW-6	4.27
WW-7	1.85
WW-8	1.71
WW-9	10.5
WW-10	4.08
WW-11	1.85
WW-12	1.35
WW-13	1.15
WW-14	2.11
RPT WW-10	3.74

BOND GOLD (KEVIN LEONARD)

WO NO: 88-1203

PAGE:

SAMPLE ID	AU PPM
WW-1	1.33
WW-2	6.98
WW-3	12.1
WW-4	7.02
WW-5	4.41
WW-6	4.27
WW-7	1.85
WW-8	1.71
WW-9	10.5
WW-10	4.08
WW-11	1.85
WW-12	1.35
WW-13	1.15
WW-14	2.11
RPT WW-10	3.74



Ministry of Natural Resources

Report of Work (Geophysical, Geological, Geochemical and Expenditures)

DOCUMENT No. W8901-138

Instructions: - Please type or print. If number of mining claims traversed exceeds space on this form, attach a list. Note: - Only days credits calculated in the "Mining Claims Traversed" section may be entered.

Type of Survey(s) Geochemical
Claim Holder(s) Bond Gold Canada Inc.
Address 20 Adelaide St. E., Suite 1100 Toronto, Ontario M5C 2T6
Survey Company Bond Gold Canada Inc.
Date of Survey (from & to) 22 09 88 22 10 88
Name and Address of Author (of Geo-Technical report) Kevin W. Leonard 886 Tanager Avenue Burlington, Ontario



52F10SE0019 2.12464 TURTLEPOND LAKE

900

Credits Requested per Each Claim in Columns at right

Table with columns for Special Provisions, Man Days, Airborne Credits, and sub-columns for Geophysical, Geological, and Geochemical methods (Electromagnetic, Magnetometer, Radiometric, Other).

Mining Claims Traversed (List in numerical sequence)

Table with columns for Mining Claim Prefix, Mining Claim Number, Expend Days Cr., and sub-columns for Mining Claim Prefix, Mining Claim Number, Expend Days Cr.

RECEIVED MAY 23 1989 MINING LANDS SECTION

KENORA RECEIVED MAY 15 1989 789101112123456

Expenditures (excludes power stripping)

Type of Work Performed Geochemical Expenditures
Performed on Claim(s)
Calculation of Expenditure Days Credits: Total Expenditures \$2,946.00 ÷ 15 = Total Days Credits 196.4
Instructions: Total Days Credits may be apportioned at the claim holder's choice. Enter number of days credits per claim selected in columns at right.

1080504
Total number of mining claims covered by this report of work: 10
For Office Use Only: Total Days Credits Reported 196.4, Date Reported May 15/89, Mining Record Book No. 789101112123456, Approved as Recorder See record statement, Branch Director Scott Rivett

Date April 28, 1989, Recorded Holder or Agent (Signature) Kevin Leonard

Certification Verifying Report of Work: I hereby certify that I have a personal and intimate knowledge of the facts set forth in the Report of Work, annexed hereto, having performed the work or witnessed same during and/or after its completion and the annexed report is true.

Name and Postal Address of Person Certifying Kevin Leonard 886 Tanager Ave. Burlington, Ont. L7T 2Y2
Date Certified April 29, 1989, Certified by (Signature) Kevin Leonard



File
2.12464

Date
August 22, 1989

Mining Recorder's Report of
Work No.
W8901-138

Recorded Holder
BOND GOLD CANADA INC.

Township or Area
TURTLEPOND LAKE AREA.

Type of survey and number of Assessment days credit per claim	Mining Claims Assessed
Geophysical Electromagnetic _____ days Magnetometer _____ days Radiometric _____ days Induced polarization _____ days Other _____ days Section 77 (19) See "Mining Claims Assessed" column Geological _____ days Geochemical _____ days Man days <input type="checkbox"/> Airborne <input type="checkbox"/> Special provision <input type="checkbox"/> Ground <input checked="" type="checkbox"/> <input type="checkbox"/> Credits have been reduced because of partial coverage of claims. <input type="checkbox"/> Credits have been reduced because of corrections to work dates and figures of applicant.	\$2946.00 spent on Assaying Samples taken from Mining Claims: K 910929 to 932 incl. 911482-483 976558-559 976561 to 563 incl. 1018107-108 1018111 1018121 196.4 days credit allowed which may grouped in accordance with Section 76(6) of the Mining Act R.S.O. 1980.

Special credits under section 77 (16) for the following mining claims

No credits have been allowed for the following mining claims

not sufficiently covered by the survey insufficient technical data filed



Recorded Holder BOND GOLD CANADA INC.
Township or Area TURTLEPOND LAKE AREA.

Type of survey and number of Assessment days credit per claim	Mining Claims Assessed
Geophysical Electromagnetic _____ days Magnetometer _____ days Radiometric _____ days Induced polarization _____ days Other _____ days Section 77 (19) See "Mining Claims Assessed" column Geological _____ days Geochemical _____ days Man days <input type="checkbox"/> Airborne <input type="checkbox"/> Special provision <input type="checkbox"/> Ground <input checked="" type="checkbox"/> <input type="checkbox"/> Credits have been reduced because of partial coverage of claims. <input type="checkbox"/> Credits have been reduced because of corrections to work dates and figures of applicant.	\$2946.00 spent on Assaying Samples taken from Mining Claims: K 910929 to 932 incl. · 911482-483 · 976558-559 · 976561 to 563 incl. · 1018107-108 · 1018111 · 1018121 196.4 days credit allowed which may grouped in accordance with Section 76(6) of the Mining Act R.S.O. 1980.

Special credits under section 77 (16) for the following mining claims

No credits have been allowed for the following mining claims

not sufficiently covered by the survey insufficient technical data filed

The Mining Recorder may reduce the above credits if necessary in order that the total number of approved assessment days recorded on each claim does not exceed the maximum allowed as follows: Geophysical - 80; Geological - 40; Geochemical - 40; Section 77(19) - 60.



Ontario

Ministry of
Northern Development
and Mines

Ministère du
Développement du Nord
et des Mines

Mining Lands Section
3rd Floor, 880 Bay St.
Toronto, Ontario
M5S 1Z8

Telephone: (416) 965-4888

August 22, 1989

Your file: W8901-138
Our file: 2.12464

Mining Recorder
Ministry of Northern Development and Mines
808 Robertson Street
P.O. Box 5200
Kenora, Ontario
P8N 3X9

Dear Sir:

Re: Data for Expenditures submitted under Section 77(19)
of the Mining Act R.S.O. 1980 on Mining Claims K 910929
et al in Turtlepond Lake Area.

The enclosed statement of assessment work credits for Expenditures has been approved as of the above date.

Please inform the recorded holder of these mining claims and so indicate on your records.

Yours sincerely,

W.R. Cowan
Provincial Manager, Mining Lands
Mines & Minerals Division

Rm

RM:eb

Enclosure

cc: Resident Geologist
Kenora, Ontario

Bond Gold Canada Inc.
1100-20 Adelaide Street E.
Toronto, Ontario
M5C 2T6

Kevin W. Leonard
886 Tanger Ave.
Burlington, Ontario
L7T 2Y2

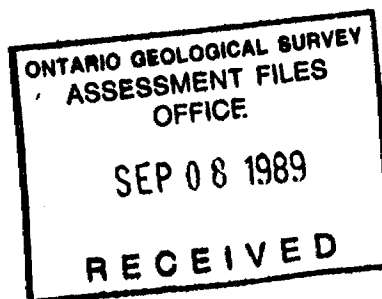

BUTLER LAKE - G-2576

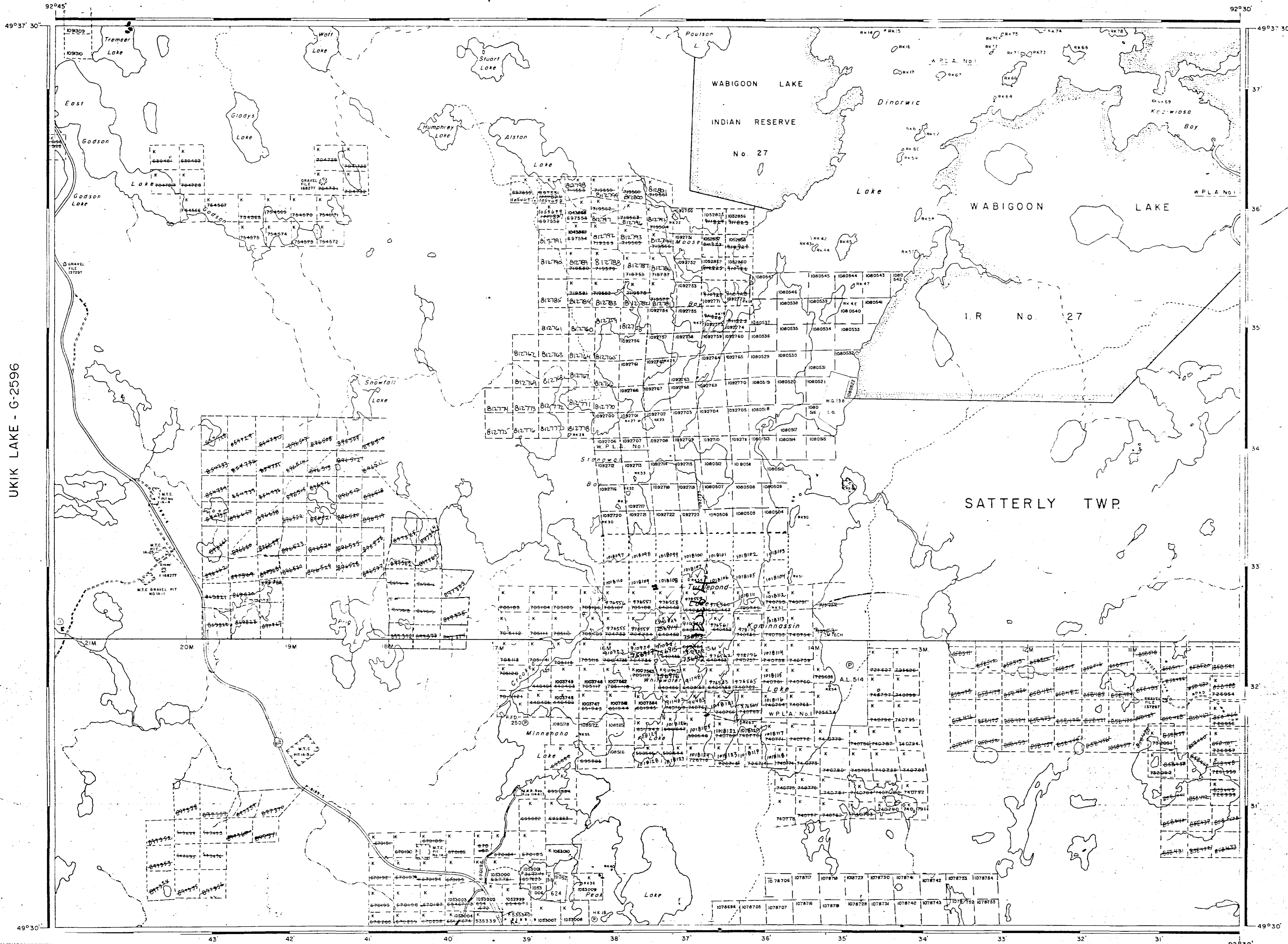

UKIK LAKE - G-2596

TABOR LAKE - G-2592

BOYER LAKE - G-2572

LEGEND

- PATENTED LAND (P)
- CROWN LAND SALE (C.S.)
- LEASES (L)
- LOCATED LAND (Loc.)
- LICENSE OF OCCUPATION (L.O.)
- MINING RIGHTS ONLY (M.R.O.)
- SURFACE RIGHTS ONLY (S.R.O.)
- ROADS (—)
- IMPROVED ROADS (—)
- KING'S HIGHWAYS (—)
- RAILWAYS (—)
- POWER LINES (—)
- MARSH OR MUSKEG (—)
- MINES (—)
- CANCELLED (—)
- PATENTED S.R.O. (—)

REFERENCES

AREAS WITHDRAWN FROM DISPOSITION

- M.R.O. - MINING RIGHTS ONLY
- S.R.O. - SURFACE RIGHTS ONLY
- M.+S. - MINING AND SURFACE RIGHTS

Description	Order No.	Date	Disposition
2 DEPOSITED SURFACE RIGHTS (S.R.O.)			
24 WITHDRAWN S.R.O. Nov 1886 22000 W 1915			

ROADS INDICATED DRYDEN PAPER CO. ARE PRIVATE ROADS, BUT MAY BE USED BY PROSPECTORS ONLY AFTER PERMISSION IS OBTAINED FROM DRYDEN PAPER CO. DRYDEN ONTARIO

FLOODING

RESERVING THE RIGHT TO HOLD THE WATERS OF THE WABIGOON RIVER AND WABIGOON LAKE, INCLUDING DINORWIC, TURTLEPOND, AND MINNEHAHA LAKES AND CROCKED RIVER, TO AN ELEVATION NOT EXCEEDING 1209.92'

WATER POWER LEASE AGREEMENT No. 1, 28 FEB 1989

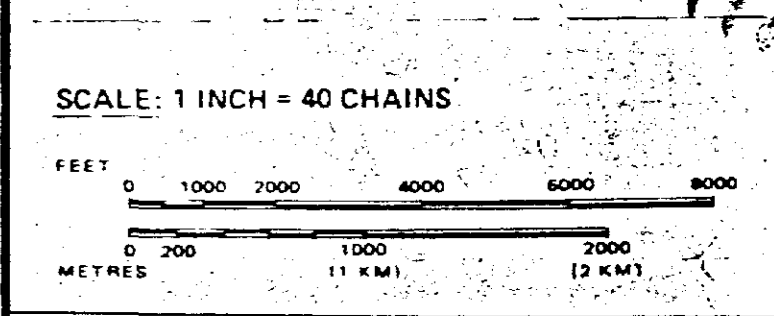

AREA TURTLEPOND LAKE

M.N.R. ADMINISTRATIVE DISTRICT

DRYDEN

MINING DIVISION

KENORA

LAND TITLES / REGISTRY DIVISION

KENORA

RECEIVED JUN 20 1989 AM 7:89 10 11 12 13

Ministry of Natural Resources Ontario

Land Management Branch

Date: FEBRUARY, 1984

Number: **G-2595**

M-2663

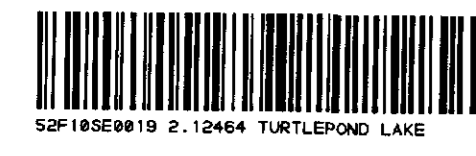

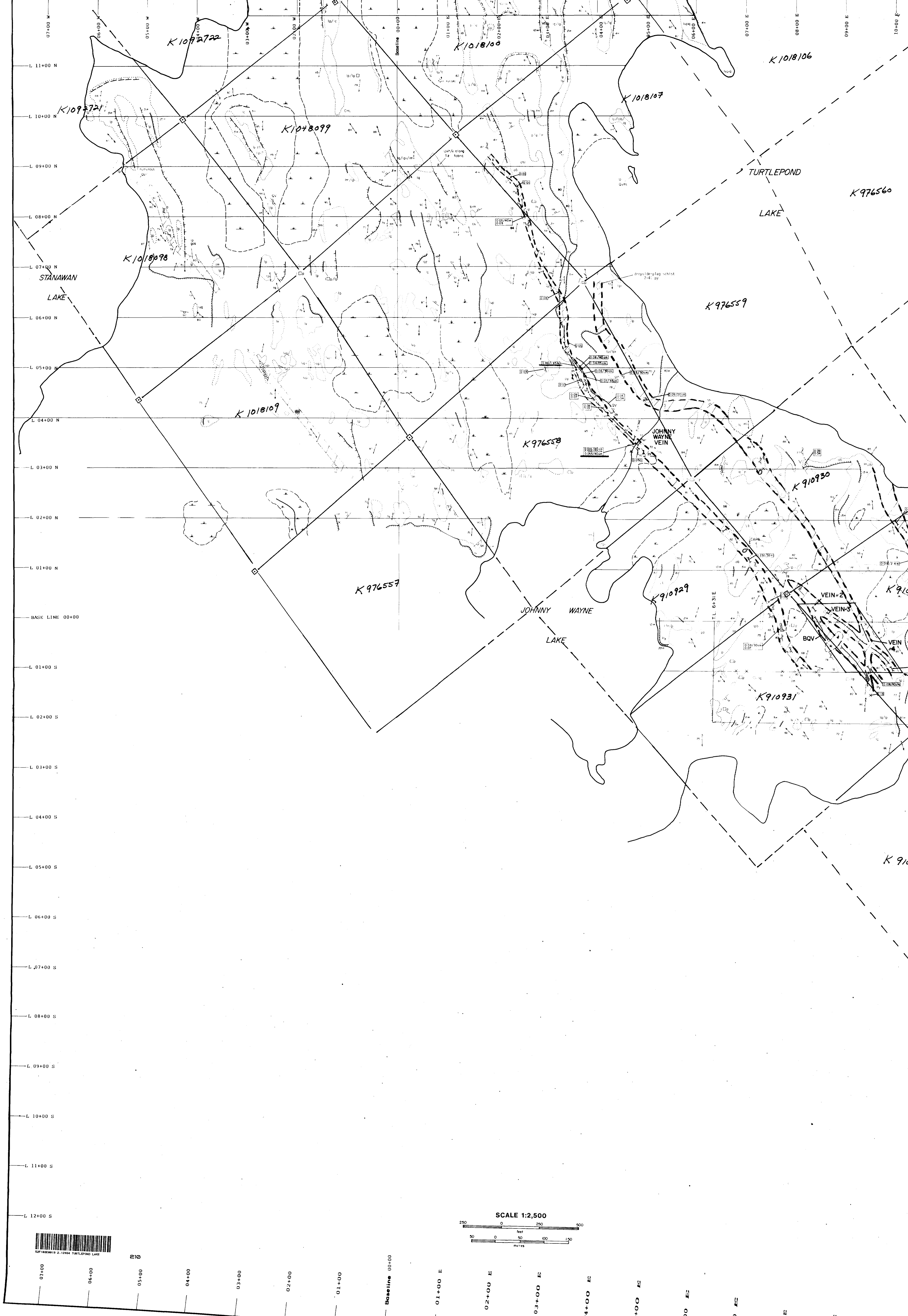

SCALE 1:2,500

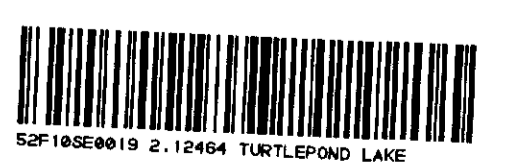
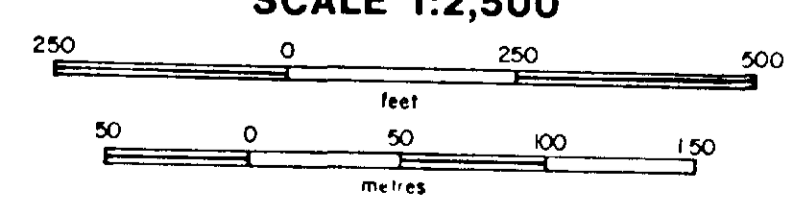

210

07+00 06+00 05+00 04+00 03+00 02+00 01+00 Baseline 00+00 01+00 E 02+00 E 03+00 E 04+00 E 05+00 E 06+00 E 07+00 E

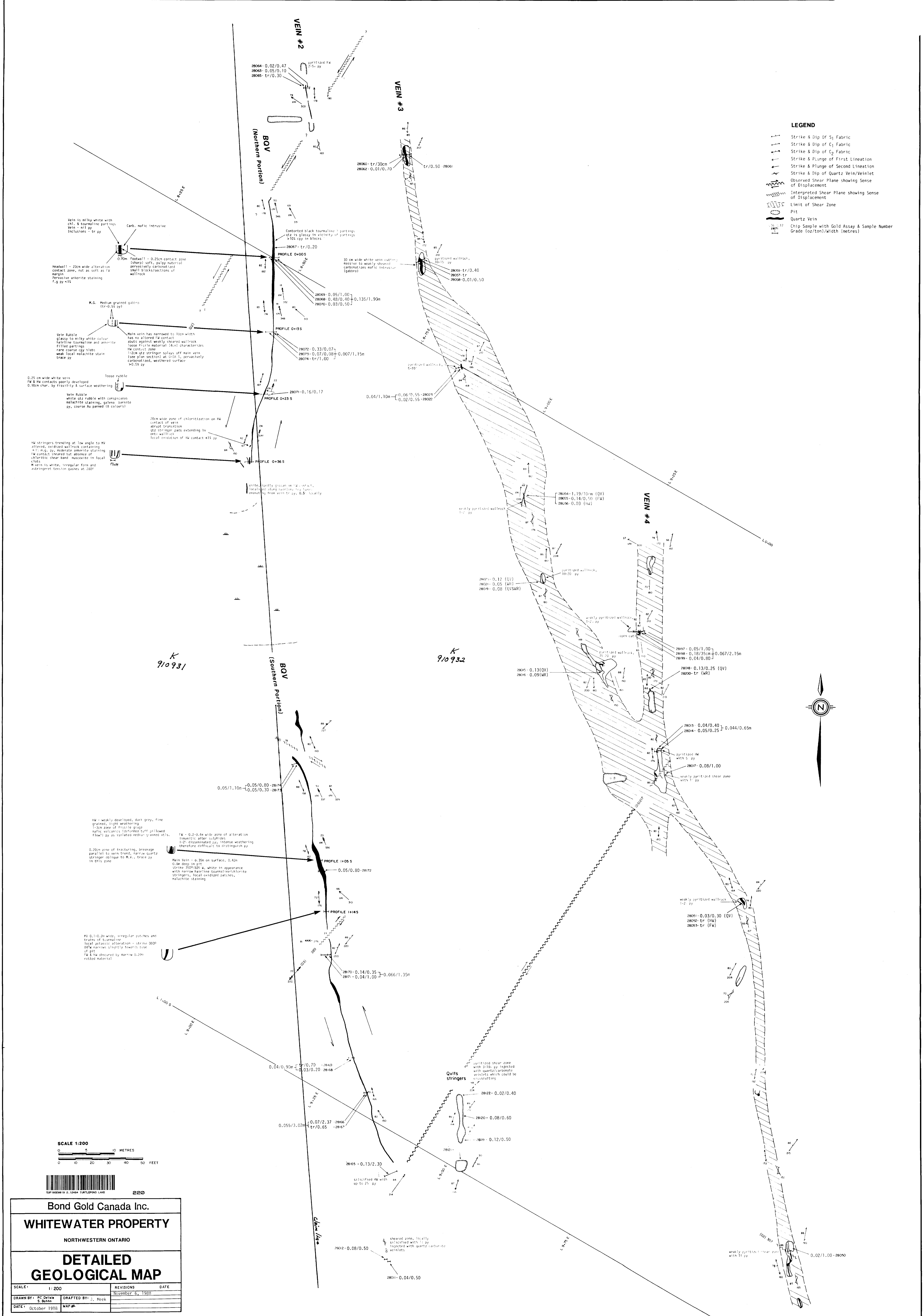

- LEGEND**
- Strike & Dip of S₁ Fabric
 - Strike & Dip of C₁ Fabric
 - Strike & Dip of C₂ Fabric
 - Strike & Plunge of First Lineation
 - Strike & Plunge of Second Lineation
 - Strike & Dip of Quartz Vein/Veinlet
 - Observed Shear Plane showing Sense of Displacement
 - Interpreted Shear Plane showing Sense of Displacement
 - Limit of Shear Zone
 - Pit
 - Quartz Vein
 - Chip Sample with Gold Assay & Sample Number Grade (oz/ton)/width (metres)

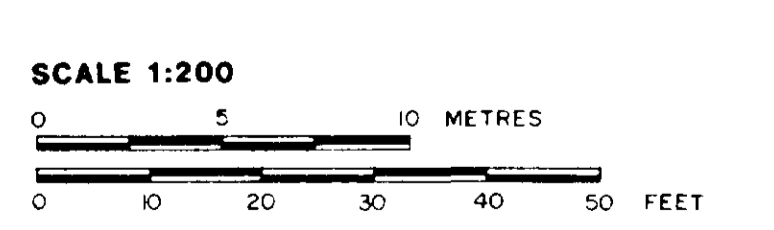

Bond Gold Canada Inc.
WHITWATER PROPERTY
 NORTHWESTERN ONTARIO

DETAILED GEOLOGICAL MAP

SCALE: 1:200	REVISIONS	DATE
DRAWN BY: P. Dehm, S. Behn	DRAFTED BY: J. Meek	NOVEMBER 6, 1998
DATE: October 1998	MAP #:	

K
9/10931

K
9/10932

H₁ - weakly developed, dark grey, fine grained, light weathering
 1-3cm zone of fissile gangue
 mafic volcanics, doleritic tuff gillweeds
 fibrous py as isolated nodules; green stis.

H₂ - 0.20-0.40m wide zone of alteration
 limonite after sulphides
 1-2% disseminated py. Intense weathering
 therefore difficult to distinguish py.

H₃ - 0.35m on surface, 0.40m
 0.30m deep in pit
 siliceous alteration - dense deep
 siliceous alteration - dense deep
 siliceous alteration - dense deep
 siliceous alteration - dense deep

H₄ - 0.10-0.20m wide, irregular patches and
 trails of tourmaline
 local potassic alteration - dense deep
 siliceous alteration - dense deep
 siliceous alteration - dense deep

H₅ - 0.10-0.20m wide, irregular patches and
 trails of tourmaline
 local potassic alteration - dense deep
 siliceous alteration - dense deep

H₆ - 0.10-0.20m wide, irregular patches and
 trails of tourmaline
 local potassic alteration - dense deep
 siliceous alteration - dense deep

H₇ - 0.10-0.20m wide, irregular patches and
 trails of tourmaline
 local potassic alteration - dense deep
 siliceous alteration - dense deep

H₈ - 0.10-0.20m wide, irregular patches and
 trails of tourmaline
 local potassic alteration - dense deep
 siliceous alteration - dense deep

H₉ - 0.10-0.20m wide, irregular patches and
 trails of tourmaline
 local potassic alteration - dense deep
 siliceous alteration - dense deep

H₁₀ - 0.10-0.20m wide, irregular patches and
 trails of tourmaline
 local potassic alteration - dense deep
 siliceous alteration - dense deep

H₁₁ - 0.10-0.20m wide, irregular patches and
 trails of tourmaline
 local potassic alteration - dense deep
 siliceous alteration - dense deep

H₁₂ - 0.10-0.20m wide, irregular patches and
 trails of tourmaline
 local potassic alteration - dense deep
 siliceous alteration - dense deep

H₁₃ - 0.10-0.20m wide, irregular patches and
 trails of tourmaline
 local potassic alteration - dense deep
 siliceous alteration - dense deep

H₁₄ - 0.10-0.20m wide, irregular patches and
 trails of tourmaline
 local potassic alteration - dense deep
 siliceous alteration - dense deep

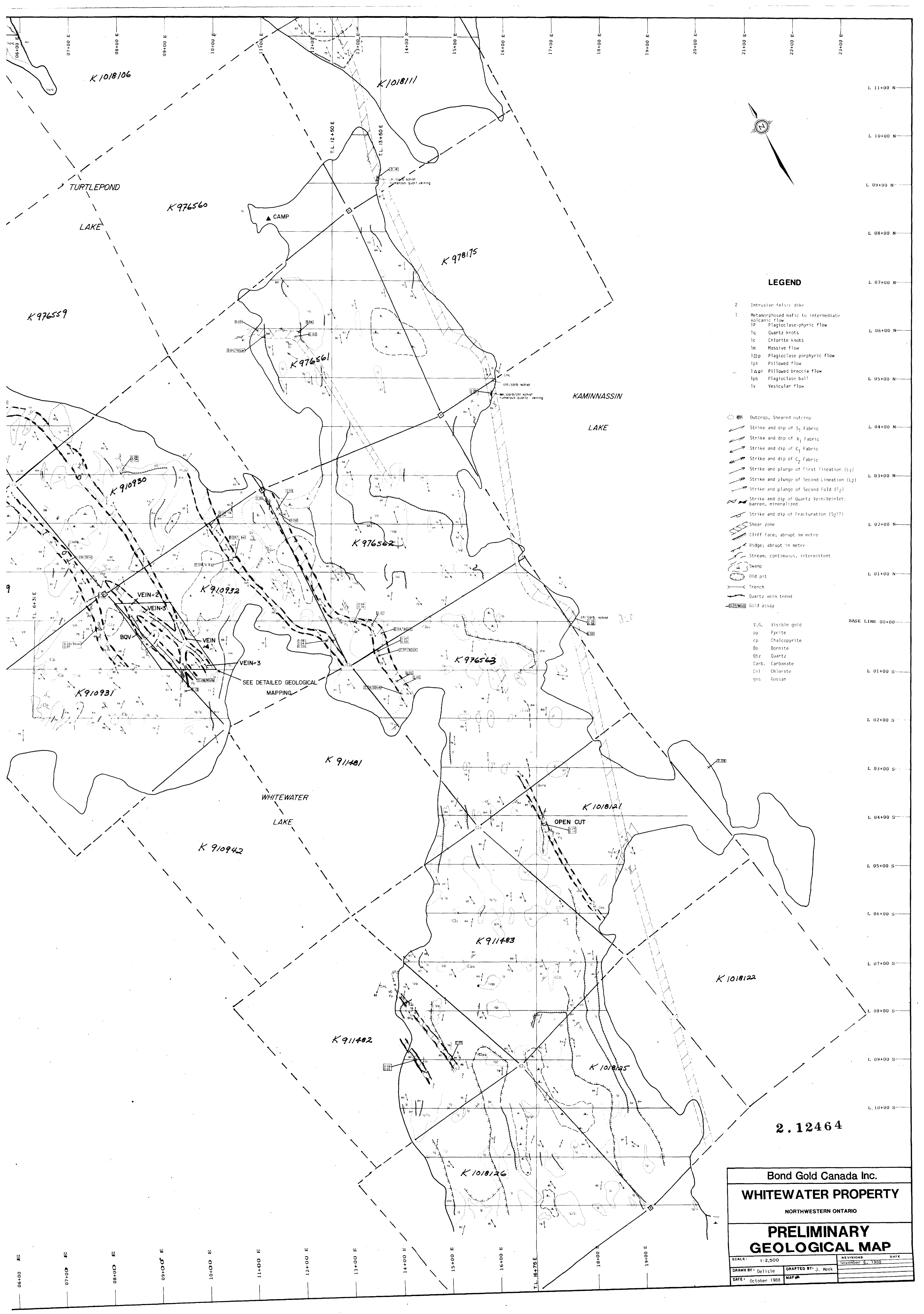

LEGEND

- 2 Intrusive felsic dike
 - 1 Metamorphosed mafic to intermediate volcanic flow
 - IP Plagioclase-phryic flow
 - 1q Quartz knots
 - 1c Chlorite knots
 - 1m Massive flow
 - 1qp Plagioclase porphyric flow
 - 1pi Pillowed flow
 - 1dpl Pillowed breccia flow
 - 1pb Plagioclase ball
 - 1v Vesticular flow
-
- Outcrop, Sheared outcrop
 - ↖ Strike and dip of S₁ Fabric
 - ↗ Strike and dip of R₁ Fabric
 - ↘ Strike and dip of C₁ Fabric
 - ↙ Strike and dip of C₂ Fabric
 - ↖ Strike and plunge of First Lineation (L₁)
 - ↗ Strike and plunge of Second Lineation (L₂)
 - ↘ Strike and dip of Quartz Vein/Veinlet: barren, mineralized
 - ↙ Strike and dip of Fracturation (S₂??)
 - Shear zone
 - Cliff face; abrupt in metre
 - Ridge; abrupt in metre
 - Stream; continuous, intermittent
 - Swamp
 - Old pit
 - Trench
 - Quartz vein trend
 - Gold assay
-
- V.G. Visible gold
 - py Pyrite
 - cp Chalcopyrite
 - bo Bornite
 - qtz Quartz
 - carb. Carbonate
 - chl Chlorite
 - gns Gossan

2.12464

Bond Gold Canada Inc.	
WHITWATER PROPERTY	
NORTHWESTERN ONTARIO	
PRELIMINARY GEOLOGICAL MAP	
SCALE: 1:2,500	REVISIONS: DATE
DRAWN BY: Delisle	DRAFTED BY: J. Meek
DATE: October 1988	MAP: #
	REVISIONS: DATE
	November 6, 1988