



52F11NW0056 2.12694 GARNET BAY (EAGLE LA

010

PROSPECTING & SAMPLING

BERNARD BARTON  
1989

Bernard Barton  
Box 254  
Orlando Ont  
PEN-248.  
Ph 937-4309.

Dear person.

Please, okay these receipts so  
that I may use them for  
assessment work.  
yours truly  
Bernard Barton.

# 88 Samples TAKEN at.

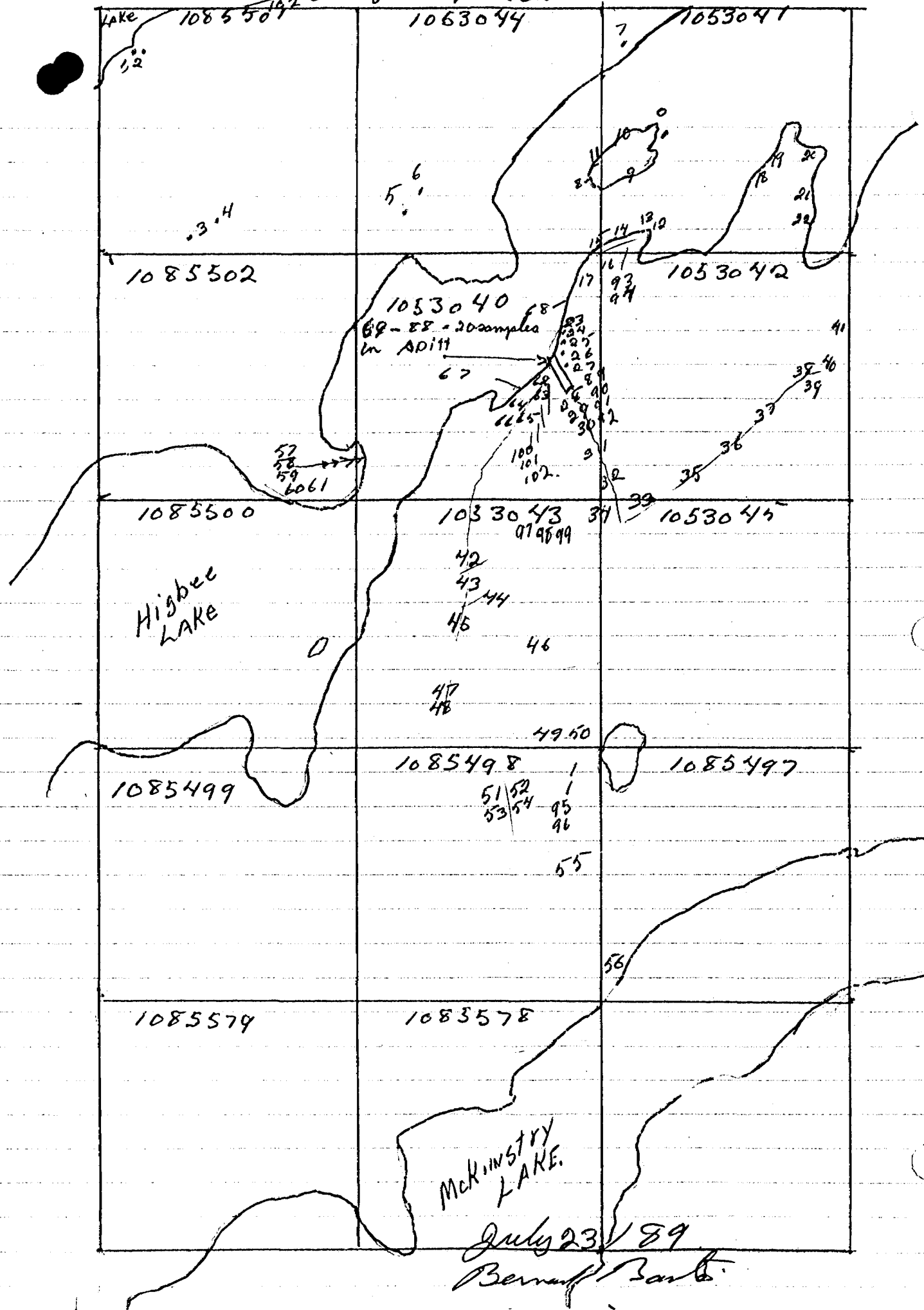

July 23, 1989  
Bernadine Barts

No. of samples taken

12  
9  
12  
8  
13  
7  
3  
1  
6  
1  
1  
1  
73

15 Coupons used.

108.00 ✓  
81.00 ✓  
108.00 ✓  
75.00 ✓  
117.00 ✓  
63.00 ✓  
27.00 ✓  
9.00  
54.00 ✓  
9.00 ✓  
9.00 ✓  
\$ 660.00  
172.50

No of samples taken: 14

267.55  
~~927.55~~  
\$ 1100.05

11.50  
15.  
5750  
11.50  
172.50

all samples sent in  
gold assay

Coupon saved for Gold assay  
Geo Chem.

Value for 1 coupon = 11.50

July 28/89

Bernall Barts.

Bernard Barton  
Box 254 Dryden Ont  
P8N-2Y8.  
ph 807-937-4309.

Assay results of samples sent  
to be recorded for assessment work  
file no. # 2.12694.

Sample no.	Assay for.	Results	
		oz per ton	ppb
1	gold.	NIL	
2	"	NIL	
3	"		3
4	"		22
5	"		22
6	"		480
7	"		2
8	"		0
9	"		17
10	"		12
11	"		185
12	"		190
13	"		3000
14	"		0
15	"		35
16	"		78
17	"	.01	
18	"	.02	
19	"	.001	
20	"	NIL	
21	"	.002	
22	"	.004	
23	"	.18	
24	"	.05	
25	"	.34	
26	"	.46	
27	"	.21	
28	"	.46	
29	"	.06	

Samples taken on:  
 1085501 - 1053044 - 1053041 - 1053045 - 1085500  
 1085502 1053040 - 1053042 1053043. 1085499  
 1085498. 1085497

		Results.		
	Sample NO.	Assayed for.	Operator	ppb
30	30	"	1.38	
31	31	"	.20	
	32	"	2.01	
	33	"	4.01	
	34	"	Trace	
	35	"	.08	
	36	"	.01	
	37	"	Trace	
	38	"	"	
	39	"	"	
	40	"	"	
	41	"	"	
	42	"	.16	
	43	"	.06	
	44	"	.002	
	45	"	NIL	
	46	"	.10	
	47	"	.006	
	48	"	.014	
	49	"	.20	
	50	"	.07	
	51	"	.015	
	52	"	.016	
	53	"	.14	
	54	"	.03	
	55	"	.16	
	56	"	NIL	
	57	"	.001	
	58	"	.02	
	59	"	.06	
	60	"	.08	
	61	"	.001	

Barrard Barton.  
Box 254 Dryden Ont.  
P.S.N-248.  
Ph. 937-4309.  
807.

Results.

Sample No	assayed for	Oz per ton
62	Gold.	.13
63	"	.06
64	"	.18
65	"	.08
66	"	.12
67	"	.48
68	"	NiL
69	"	.05
70	"	.14
71	"	.20
72	"	.01
73	"	.31
74	"	.10
75	"	.16
76	"	.09
77	"	.82
78	"	.34
79	"	.21
80	"	.05
81	"	.01
82	"	.08
83	"	.02
84	"	.01
85	"	.63
86	"	.71
87	"	NiL
88	"	.001
89	"	NiL
90	"	.16
91	"	.20
92	"	.85
93	"	.88

Assay results of samples sent  
to be recorded for assessment work.  
File No # 2.12694

Sample No.	Assayed for	Results.
94	Gold	02 per ton TRACE
95	"	.002
96	"	.001
97	"	.016
98	"	.002
99	"	.001
100	"	.06
101	"	.10
102	"	.21
103	"	.03
104	"	NIL
105	"	.10





## Mining Act

– Do not use shaded areas below.

Type of Survey(s)		Township or Area	
120 2.12694		LINE LK 62586 or GARNET BAY AREA 6258	
Claim Holder(s)		Prospector's Licence No.	
Bernard Barber		56004	
Address			
Box 254 Dryden Ont.			
Survey Company		Date of Survey (from & to)	
		Day   Mo.   Yr.   Day   Mo.   Yr.	
Name and Address of Author (of Geo-Technical report)		Total Miles of line Cut	

## Credits Requested per Each Claim in Columns at right

<p><b>Special Provisions</b></p> <p>For first survey: Enter 40 days. (This includes line cutting)</p> <p>For each additional survey: using the same grid: Enter 20 days (for each)</p>	<p><b>Geophysical</b></p> <ul style="list-style-type: none"> <li>- Electromagnetic</li> <li>- Magnetometer</li> <li>- Radiometric</li> <li>- Other</li> </ul> <p><b>Geological</b></p> <p><b>Geochemical</b></p>	<p><b>Days per Claim</b></p>
<p><b>Man Days</b></p> <p>Complete reverse side and enter total(s) here</p>	<p><b>Geophysical</b></p> <ul style="list-style-type: none"> <li>- Electromagnetic</li> <li>- Magnetometer</li> <li>- Radiometric</li> <li>- Other</li> </ul> <p><b>Geological</b></p> <p><b>Geochemical</b></p>	<p><b>Days per Claim</b></p>
<p><b>Airborne Credits</b></p> <p><b>Note:</b> Special provisions credits do not apply to Airborne Surveys.</p>	<p><b>Electromagnetic</b></p> <p><b>Magnetometer</b></p> <p><b>Radiometric</b></p>	<p><b>Days per Claim</b></p>

Expenditures (excludes power stripping)

Type of Work Performed		
Performed on Claim(s) <i>1085501 1053044 1053040 1055040 1055042 1055040 1053043</i> <i>resay g on 1085498 1085497</i>		
Calculation of Expenditure Days Credits		
Total Expenditures <div style="border: 1px solid black; padding: 5px; display: inline-block;">\$1100.05</div>	<div style="border: 1px solid black; padding: 5px; display: inline-block;">÷ 15</div>	Total Credits <div style="border: 1px solid black; padding: 5px; display: inline-block;">= 73.34</div>
Instructions		
Total Days Credits may be apportioned at the claim holder's choice. Enter number of days credits per claim selected in columns at right.		

**Mining Claims Traversed (List in numerical sequence)**

[illegible]

Total number of mining claims covered by this report of work.

4/

1053 040

For Office Use Only		
Total Days Cr. Recorded	Date Recorded 89 AUG 14	Mining Recorder [Signature] Rivett
73	Date Approved as Recorded Oct 26/89	Branch Director [Signature]

### Certification Verifying Report of Work

I hereby certify that I have a personal and intimate knowledge of the facts set forth in the Report of Work annexed hereto, having performed the work or witnessed same during and/or after its completion and the annexed report is true.

Name and Postal Address of Person Certifying

LINE LAKE 62586

AUGUST 14/89

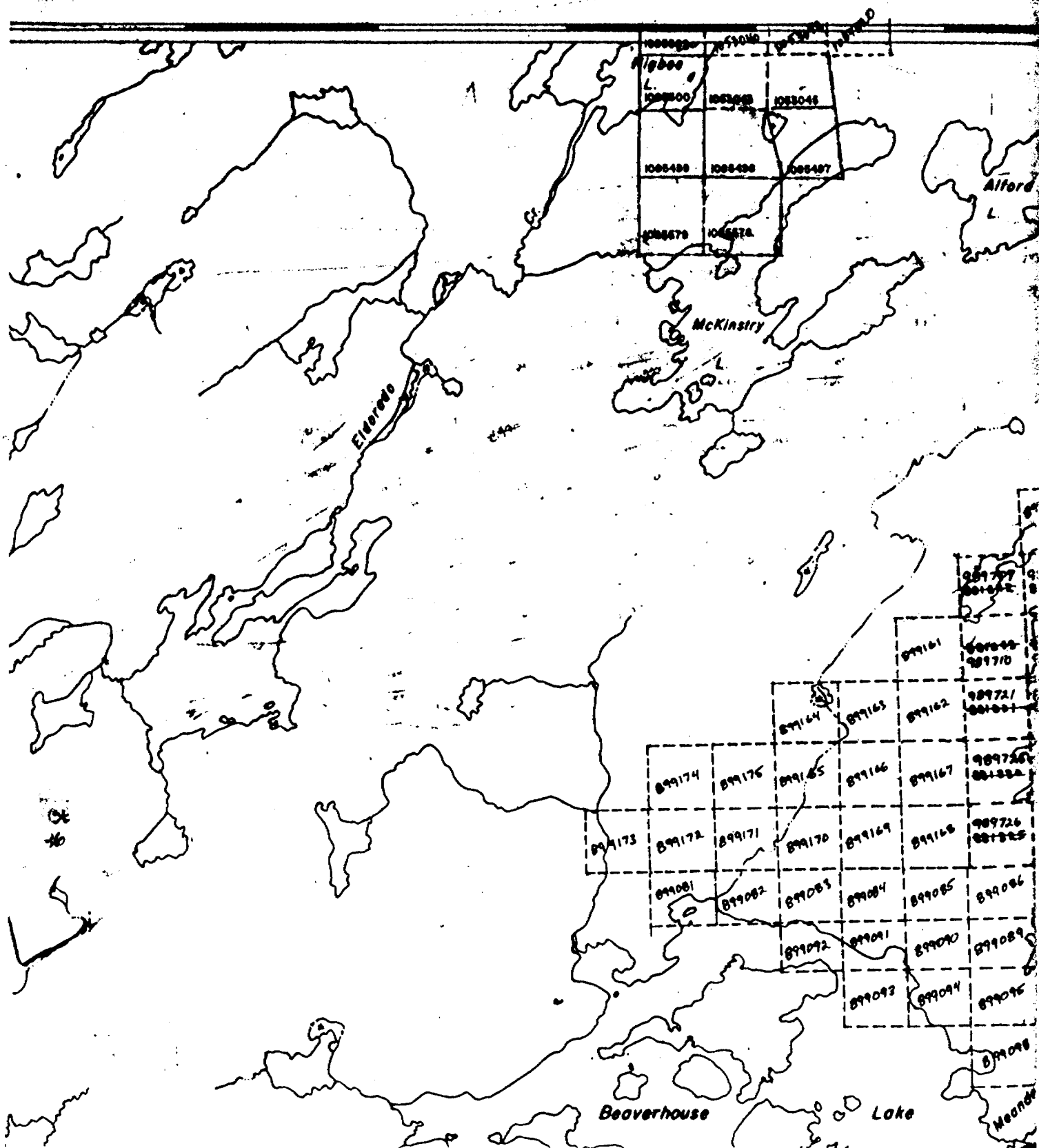

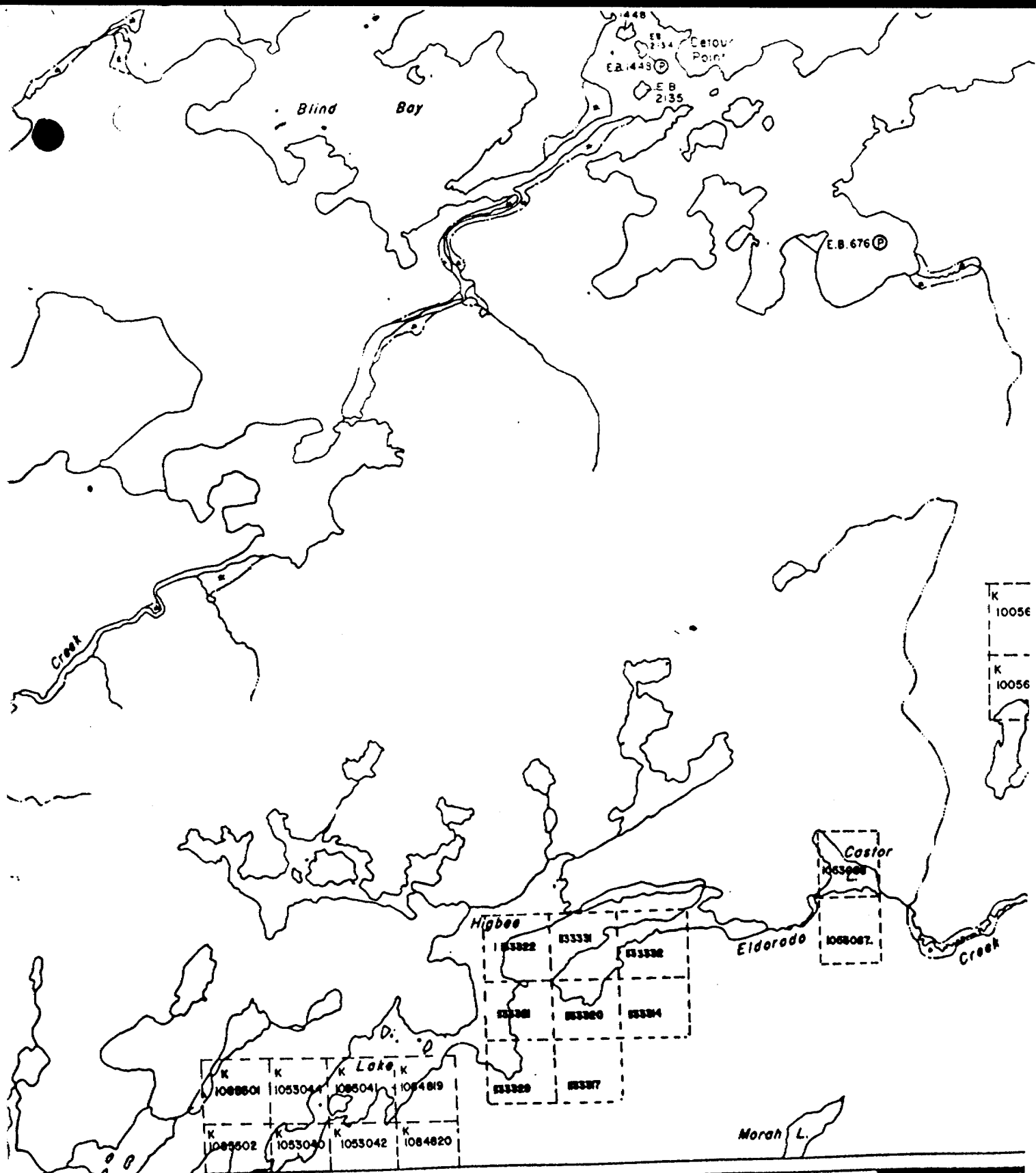

TEGGAU LAKE G-2594

BUCHAN BAY G-2573

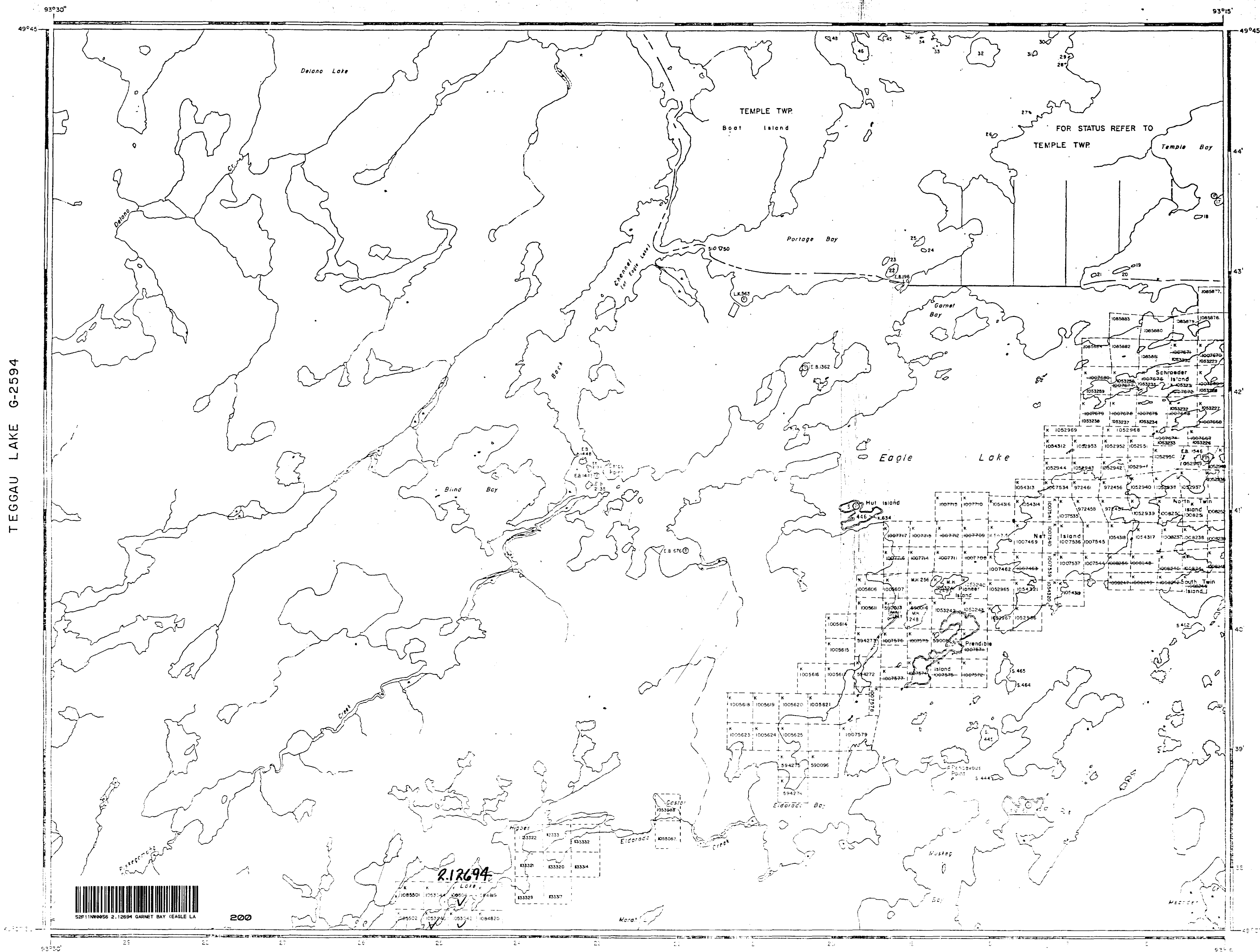

### LEGEND

PATENTED LAND	Ⓟ
CROWN LAND SALE	Ⓢ
LEASES	Ⓛ
LOCATED LAND	Ⓛ
LICENSE OF OCCUPATION	Ⓛ
MINING RIGHTS ONLY	M.R.O.
SURFACE RIGHTS ONLY	S.R.O.
ROADS	—
IMPROVED ROADS	—
KING'S HIGHWAYS	—
RAILWAYS	—
POWER LINES	—
MARSH OR MUSKEG	—
MINES	Ⓢ
CANCELLED	Ⓢ

### REFERENCES

#### AREA WITHDRAWN FROM DISPOSITION

- M.R.O. - MINING RIGHTS ONLY
- S.R.O. - SURFACE RIGHTS ONLY
- M. & S. - MINING AND SURFACE RIGHTS

Description Order No. Date Disposition File

Kenora				
1007715				
1007716				
1007717				
1007718				
1007719				
1007720				
1007721				
1007722				
1007723				
1007724				
1007725				
1007726				
1007727				
1007728				
1007729				
1007730				
1007731				
1007732				
1007733				
1007734				
1007735				
1007736				
1007737				
1007738				
1007739				
1007740				
1007741				
1007742				
1007743				
1007744				
1007745				
1007746				
1007747				
1007748				
1007749				
1007750				
1007751				
1007752				
1007753				
1007754				
1007755				
1007756				
1007757				
1007758				
1007759				
1007760				
1007761				
1007762				
1007763				
1007764				
1007765				
1007766				
1007767				
1007768				
1007769				
1007770				
1007771				
1007772				
1007773				
1007774				
1007775				
1007776				
1007777				
1007778				
1007779				
1007780				
1007781				
1007782				
1007783				
1007784				
1007785				
1007786				
1007787				
1007788				
1007789				
1007790				
1007791				
1007792				
1007793				
1007794				
1007795				
1007796				
1007797				
1007798				
1007799				
1007800				
1007801				
1007802				
1007803				
1007804				
1007805				
1007806				
1007807				
1007808				
1007809				
1007810				
1007811				
1007812				
1007813				
1007814				
1007815				
1007816				
1007817				
1007818				
1007819				
1007820				
1007821				
1007822				
1007823				
1007824				
1007825				
1007826				
1007827				
1007828				
1007829				
1007830				
1007831				
1007832				
1007833				
1007834				
1007835				
1007836				
1007837				
1007838				
1007839				
1007840				
1007841				
1007842				
1007843				
1007844				
1007845				
1007846				
1007847				
1007848				
1007849				
1007850				
1007851				
1007852				
1007853				
1007854				
1007855				
1007856				
1007857				
1007858				
1007859				
1007860				
1007861				
1007862				
1007863				
1007864				
1007865				
1007866				
1007867				
1007868				
1007869				
1007870				
1007871				
1007872				
1007873				
1007874				
1007875				
1007876				
1007877				
1007878				
1007879				
1007880				
1007881				
1007882				
1007883				
1007884				
1007885				
1007886				
1007887				
1007888				
1007889				
1007890				
1007891				
1007892				
1007893				
1007894				
1007895				
1007896				
1007897				
1007898				
1007899				
1007900				
1007901				
1007902				
1007903				
1007904				
1007905				
1007906				
1007907				
1007908				
1007909				
1007910				
1007911				
1007912				
1007913				
1007914				
1007915				
1007916				
1007917				
1007918				
1007919				
1007920				
1007921				
1007922				
1007923				
1007924				
1007925				
1007926				
1007927				
1007928				
1007929				
1007930				
1007931				
1007932				
1007933				
1007934				
1007935				
1007936				
1007937				
1007938				
1007939				
1007940				
1007941				
1007942				
1007943				
1007944				
1007945				
1007946				
1007947				
1007948				
1007949				
1007950				
1007951				
1007952				
1007953				
1007954				
1007955				
1007956				
1007957				
1007958				
1007959				
1007960				
1007961				
1007962				
1007963				
1007964				
1007965				
1007966				
1007967				
1007968				
1007969				
1007970				
1007971				
1007972				
1007973				
1007974				
1007975				
1007976				
1007977				
1007978				
1007979				
1007980				
1007981				
1007982				
1007983				
1007984				
1007985				
1007986				
1007987				
1007988				
1007989				
1007990				
1007991				
1007992				
1007993				
1007994				
1007995				
1007996				
1007997				
1007998				
1007999				
1008000				

SCALE: 1 INCH = 40 CHAINS

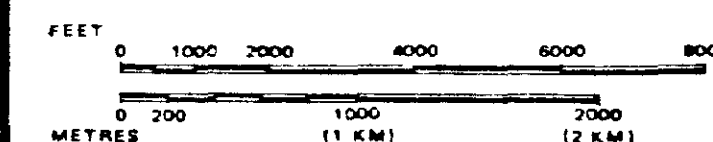

AREA  
**GARNET BAY**  
EAGLE LAKE  
M.N.R. ADMINISTRATIVE DISTRICT  
DRYDEN  
MINING DIVISION  
KENORA  
LAND TITLES / REGISTRY DIVISION  
KENORA

Ministry of Natural Resources  
Land Management Branch  
Ontario

Date: FEBRUARY, 1984

Number

G-2581

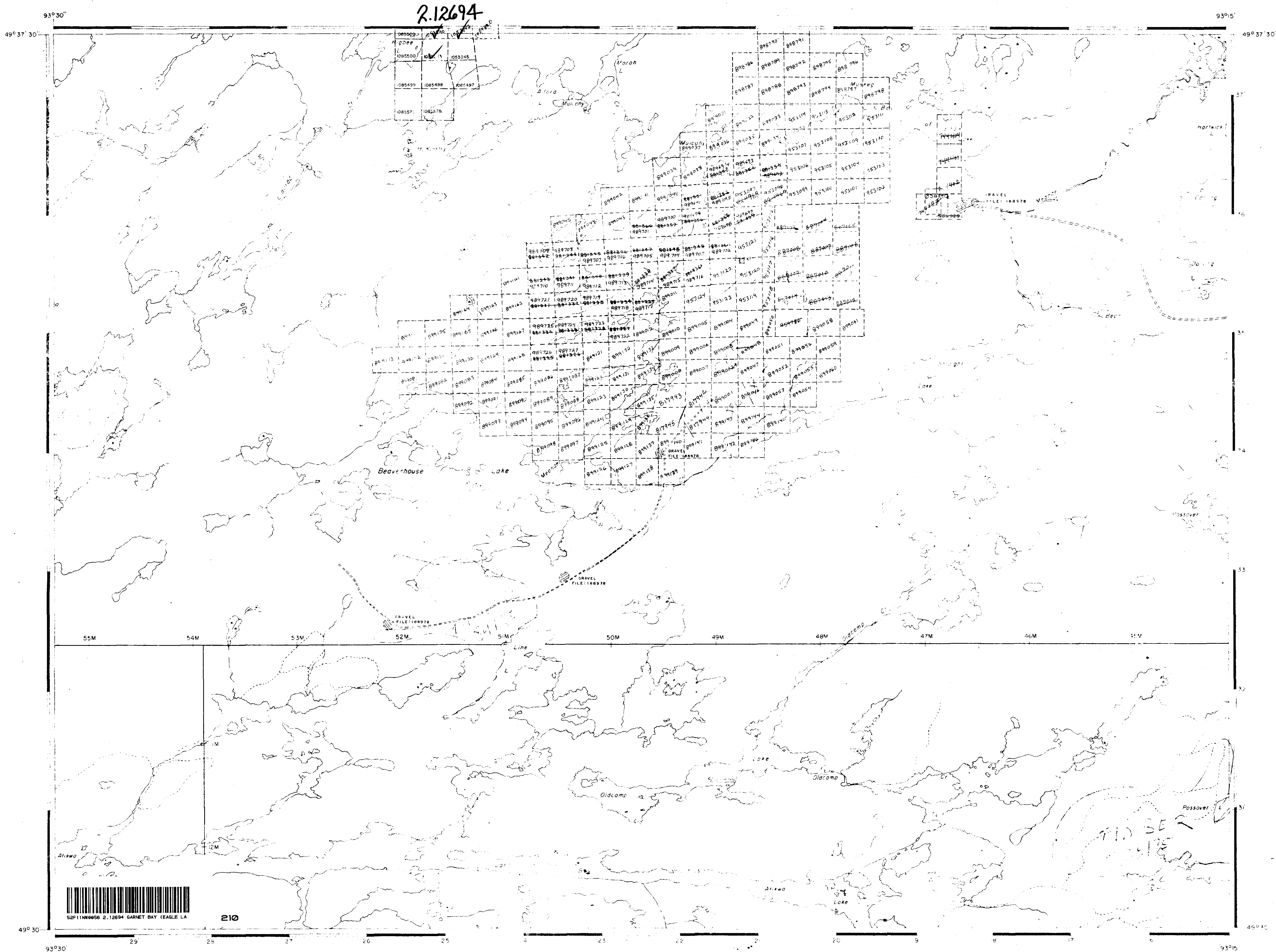

## LEGEND

HIGHWAY AND ROUTE No.	
OTHER ROADS	
TRAILS	
SURVEYED LINES	
TOWNSHIP, BASE LINES, ETC.	
LOTS, MINING CLAIMS, PARCELS, ETC.	
UNSURVEYED LINES	
LOT LINES	
PARCEL BOUNDARY	
MINING CLAIMS ETC.	
RAILWAY AND RIGHT OF WAY	
UTILITY LINES	
NON-PERENNIAL STREAM	
FLOODING OR FLOODING RIGHTS	
SUBDIVISION OR COMPOSITE PLAN	
RESERVATIONS	
ORIGINAL SHORELINE	
MARSH OR MUSKEG	
MINES	
TRAVERSE MONUMENT	

## DISPOSITION OF CROWN LANDS

TYPE OF DOCUMENT	SYMBOL
PATENT, SURFACE & MINING RIGHTS	
" SURFACE RIGHTS ONLY	
" MINING RIGHTS ONLY	
LEASE, SURFACE & MINING RIGHTS	
" SURFACE RIGHTS ONLY	
" MINING RIGHTS ONLY	
LICENCE OF OCCUPATION	
ORDER-IN-COUNCIL	
RESERVATION	
CANCELLED	
SAND & GRAVEL	

NOTE: MINING RIGHTS IN PARCELS PATENTED PRIOR TO MAY 6 1913 VESTED IN ORIGINAL PATENTEE BY THE PUBLIC LANDS ACT, R.S.O. 1970, CHAP. 380, SEC. 63, SUBSEC.

## REFERENCES

## AREAS WITHDRAWN FROM DISPOSITION

- M.R.D. - MINING RIGHTS ONLY
- S.R.D. - SURFACE RIGHTS ONLY
- M.S. - MINING AND SURFACE RIGHTS

Description	Order No.	Date	Disposition	File
R1 PROPOSED SEA TERM END SPRING 84				

SCALE: 1 INCH = 40 CHAINS

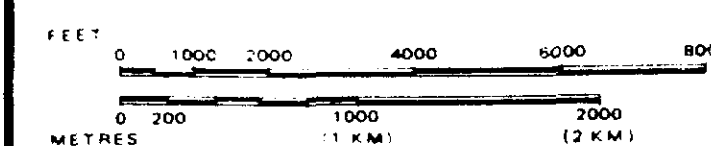

AREA

LINE LAKE

M.N.R. ADMINISTRATIVE DISTRICT

DRYDEN

MINING DIVISION

KENORA

LAND TITLES / REGISTRY DIVISION

KENORA

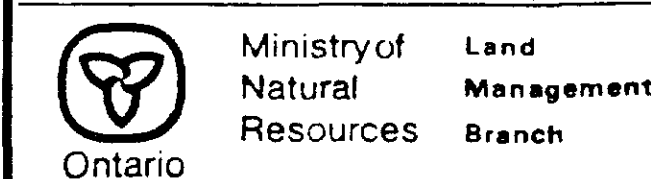

Date FEBRUARY, 1984.

Number

