



52F14SE0007 2 16586 AUBREY

010

REPORT ON GEOPHYSICAL SURVEYS
ON THE PLOMP-EAST PROPERTY
AUBREY TWP., ONTARIO
for
CHAMPION BEAR RESOURCES LTD.

May, 1996

Seymour M. Sears

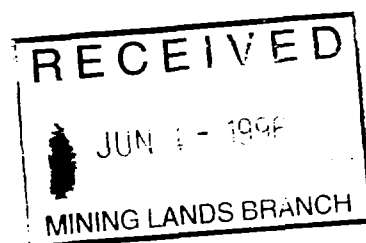
Qual. # 2.5914

2.16586

i

SUMMARY

Ground magnetometer and VLF-EM surveys were carried out over a four (4) claim unit (1 claim) property in Aubrey Township, northwestern Ontario. The claim is referred to as the Plomp - East Property. The claim is owned by Champion Bear Resources Ltd. It is situated approximately 1/2 mile east of the Plomp Farm gold property upon which extensive exploration work has been completed in the past two years. The work was part of a preliminary evaluation of the property.

Bedrock exposure on the claim group includes metasedimentary rocks and chert magnetite iron formation. Much of the property, however, is covered by swamp, farm fields and clay deposits. A series of very strong magnetic anomalies caused by magnetite iron formation have been outlined on the property. As well, several conductive features have been identified by the VLF-EM survey. These are also thought to be related to iron formation and/or overburden. Geological mapping and routine prospecting are recommended on the property.

Respectfully submitted,

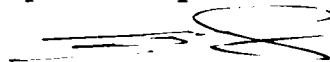

Wawa, Ontario
May, 1996

Seymour M. Sears, B.A., B.Sc.
Geologist



TABLE OF CONTENTS

	PAGE
SUMMARY	i
INTRODUCTION	1
PROPERTY LOCATION AND ACCESS	1
REGIONAL AND PROPERTY GEOLOGY	1
WORK HISTORY.	4
WORK PROGRAM AND RESULTS	4
CONCLUSIONS AND RECOMMENDATIONS	6
STATEMENT OF QUALIFICATIONS	7
REFERENCES	8

TABLE OF FIGURES

Fig. 1. REGIONAL LOCATION MAP	2
Fig. 2. PROPERTY LOCATION MAP.	3

LIST OF MAPS

Map 1) GROUND MAGNETOMETER SURVEY	Back Pocket
Map 2) GEOLOGICAL MAP	Back Pocket

INTRODUCTION

This report presents a summary of the results from a work program carried out in May of 1996 on a four claim unit property in Aubrey Township. The work was carried out by personnel of Sears, Barry and Associates Ltd. on behalf of Champion Bear Resources Ltd.

PROPERTY, LOCATION AND ACCESS

The Plomp East property is located in Aubrey Township, approximately 18 km west of Dryden, Ontario (Fig 1). It consists of 1 unpatented claim (4 claim units) numbered # K 1174436. This claim represents the mining rights only beneath the patented surface rights registered as Ref 126654 in the land registry office of Ontario. It is described as being the south half of Lot 14, Concession V, Aubrey Township.

The northwest corner of the property is located approximately 200 metres southeast of Highway 594, from a point 600 metres south of the Junction of the South Minnitaki Road and Highway 594. This point is approximately 3 kilometres north of the junction of Ojibway Drive and Highway 594. A somewhat overgrown farm road provides access to the center of the claim.

REGIONAL AND PROPERTY GEOLOGY

The property is underlain by Archean Aged rocks of the Superior Province of the Canadian Shield. These include clastic metasediments and iron formation as well as possible felsic volcanic or intrusive rocks. These are members of the Warclub Group Sedimentary sequence, a group of rocks that host a number of gold occurrences including the Plomp Farm occurrence, approximately 1 kilometre to the west.

Gold mineralization in the area occurs in various lithological and structural settings (Chorlton, 1988). These include 1) quartz and quartz carbonate veins; 2) silicified zones and quartz veins associated with shear zones; and 3) sulphide ironstone. Most of the known deposits and prospects in the general area appear to be spatially related to faults and shears that branch out from or parallel a major northeast trending structure known as the Wabigoon Fault System. There also appears to be a strong association between gold mineralization and felsic intrusive rocks.

There are no known gold occurrences on the claim group.

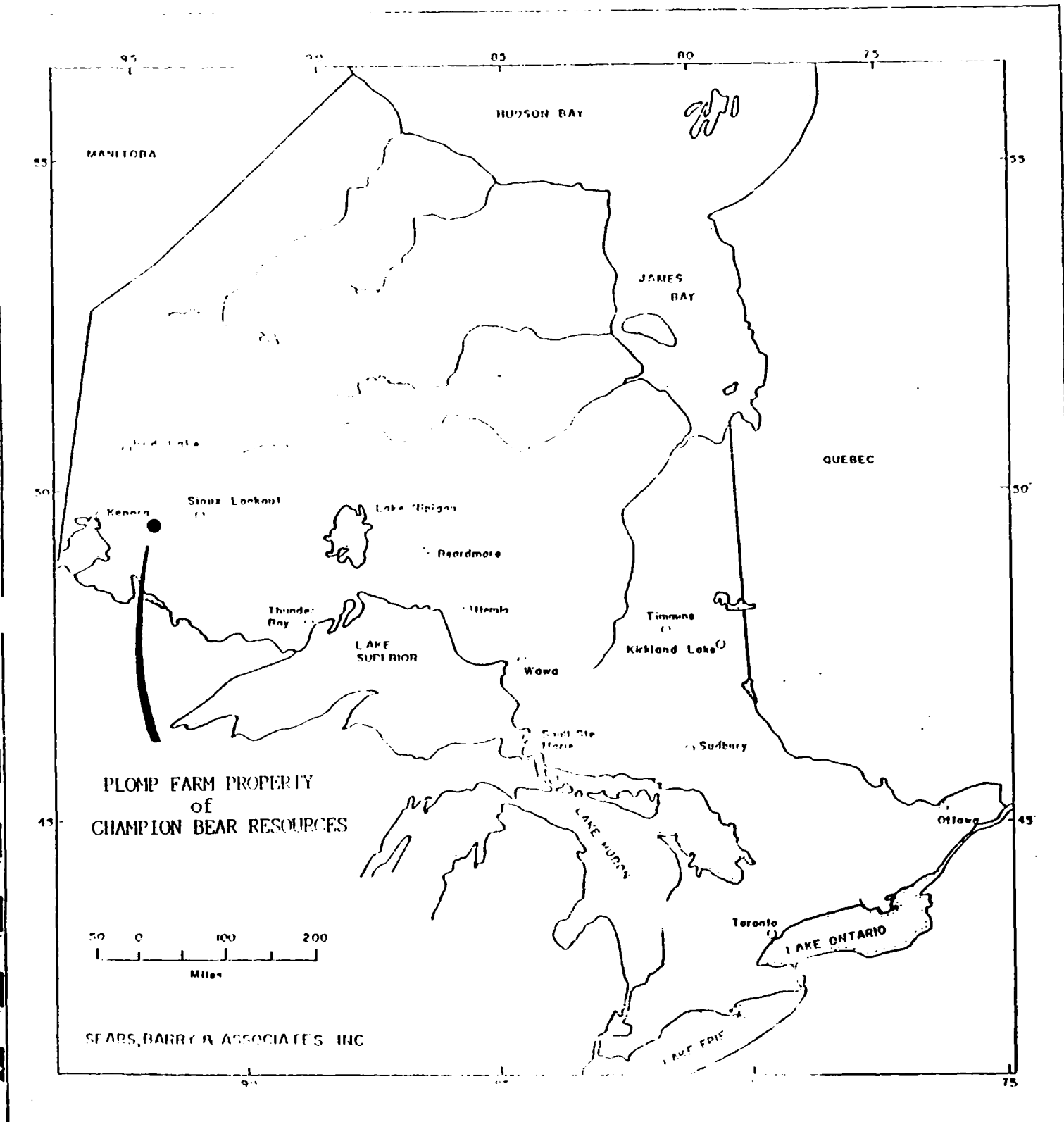

Fig. 1: Regional Location Map of Ontario.

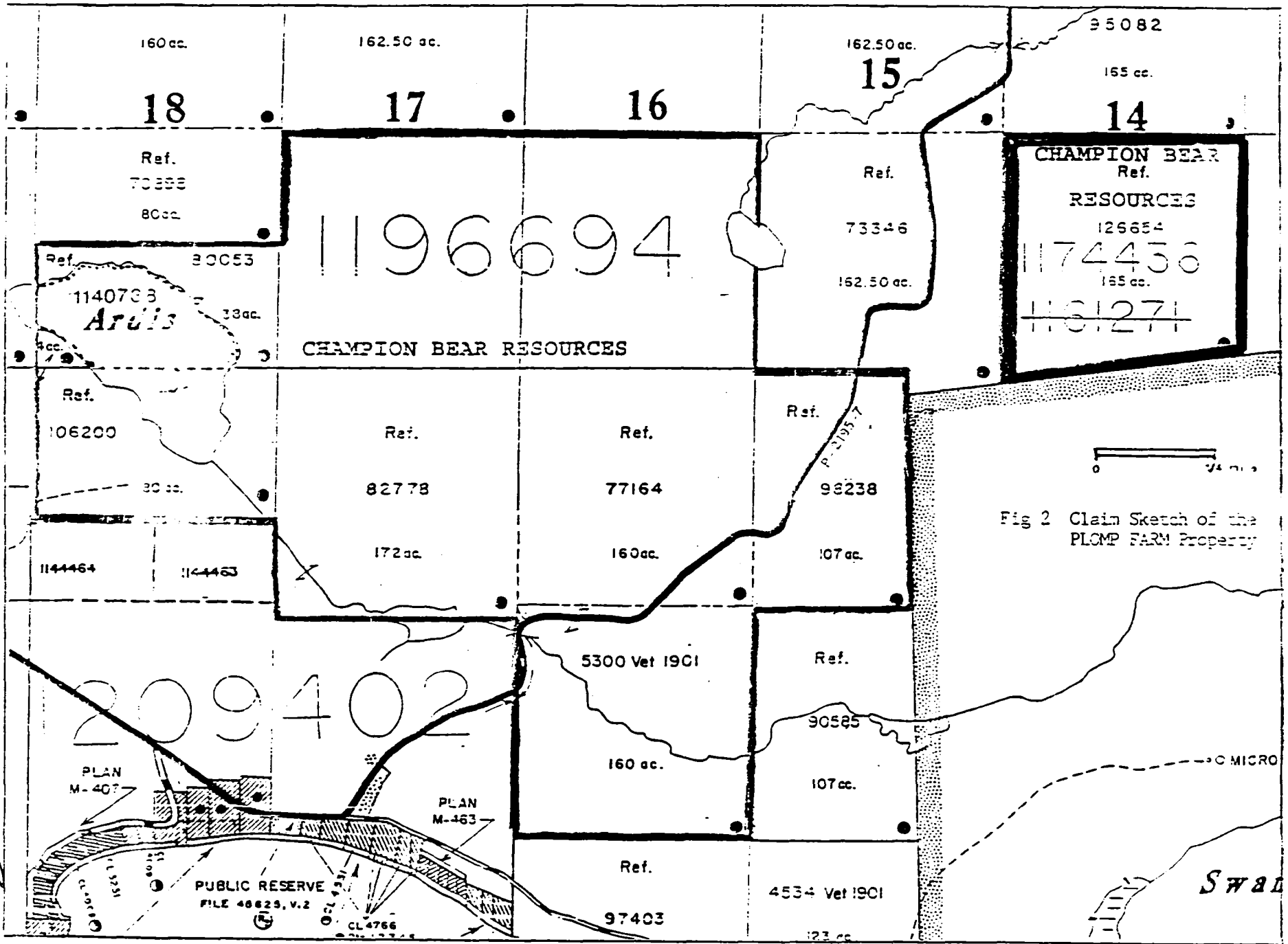

Fig 2 Claim Sketch of the
PLOMP FARM Property

3

SW 81

WORK HISTORY

There has been no assessment work previously reported on the property. Aubrey Township was included in a geological mapping project carried out by W.W. Moorhouse for the Ontario Department of Mines (1939)

WORK PROGRAM AND RESULTS

Overview

The 1996 work program on the Hartman Claim Groups involved the establishment of a flagged compass and hip-chain grid followed by ground magnetometer and VLF-EM surveys. An old blazed line was used as a baseline. Although planned at a bearing of 090 degrees, extreme magnetic attraction at the starting point (00) on the west side of the property resulted in a trend of 082 degrees. One hundred metre spaced north-south crosslines were established with flagged stations at 25 metre intervals. The work is summarized as follows:

	Flagged Grid	Geology	Magnetometer & VLF-EM Survey
TOTAL	8,000 m	-	7,200 m

Magnetometer Survey

The ground magnetometer survey was completed using a Geometrics G-816 Portable Proton Magnetometer. This instrument measures the total intensity of the earth's magnetic field in gammas. A Geometrics G-856A recording Base Station magnetometer was used during the survey to monitor the diurnal variations of the magnetic field. This data was then utilized for correcting the field data. The Base Station was established near the northwest Claim post (Line 0 at 375 N). It had a value of 58762 gammas.

Magnetic intensities were observed at 12.5 metre intervals along the 100 metre spaced grid lines. The diurnally corrected data was plotted at a scale of 1:2500 and contoured (Map 1).

The northern part of the claim has a background magnetic signature of 58,800 gammas. The southern half of the claim contains three parallel linear trends of very high values, from 1000 to 3000 gammas above background with occasional spikes up to 8000 gammas above background. These linear features are thought to be caused by magnetite iron formation. They are often accompanied or flanked by VLF-EM conductors.

The strongest of these extends across the property from 325 S, Line 0 to 350 S Line 900 E. This feature appears to be from 25 to 100 metres wide and dips towards the south. It is undoubtedly caused by chert-magnetite iron formation.

A second narrower magnetic 'high' feature extends from 225 S, Line 0 to 275 S, Line 800 E. It is typically 25 metres wide and appears to be vertical to north dipping. This change in attitude may be the result of interference in the magnetic field from the stronger southern anomaly. It is thought to be caused by chert-magnetite iron formation.

The third magnetic 'high' feature extends from 25 S, Line 0 to 100 S, Line 800 E. It is relatively strong, 25 to 50 metres wide and appears to be interrupted or undetected due to field complexities on Line 300 East. It is also thought to be caused by vertical to south dipping chert-magnetite iron formation.

VLF-EM Survey

The VLF-EM survey utilized a Geonics EM-16 VLF-EM instrument. As with any VLF-EM method, the instrument measures certain components of electromagnetic fields set up by communication stations operating in the 15 to 30 kHz frequency range. For this survey, the Cutler, Maine (NAA) transmitting station (24.0 Khz) was utilized. When the radio waves from this station encounter conductive bodies in the earth, eddy currents are induced creating secondary fields in the area of these conductors. The EM-16 measures in-phase and quadrature-phase portions of the vertical components of these secondary electro-magnetic fields, as a percentage of the primary field of the original signal.

The VLF-EM dip angle data is plotted in Profile form at a scale of 1:2500 on Map 2. The axis of the prominent conductive features are superimposed on the Magnetometer Survey data, Map 1, where they are labelled for reference purposes.

Four conductive features are presented. Three of these (A,B,D) are assumed to be related to the chert-magnetite iron formation detected by the magnetometer survey. The strongest (A) passes through the property from 250 S, Line 0, 325 S, Line 800 E. This feature is located between two strong linear magnetic 'high's. It is probably a complex signature created by the interaction between the two strong magnetic bodies that flank it.

The second linear conductor, (B) extends from 100 North, Line 0 to 125 North, Line 200 E. At this point it may split into two weaker features (C and D) that continue eastward through the claim boundary. The northern feature (C) is possibly related to surface deposits (clay) that occupy this area. The southern trend (D) is accompanied by a strong linear magnetic anomaly and is probably related to chert-magnetite iron formation.

There are numerous other weaker less continuous features, with or without associated magnetic expression. Most of these are underlain by extensive swamp and are thought to be overburden related.

CONCLUSIONS AND RECOMMENDATIONS

Ground geophysical surveys (magnetometer and VLF-EM) were carried out on the Plomp East Property of Champion Bear Resources Limited, 18 kilometres west of Dryden, Ontario. The property consists of 4 claim units in one (1) unpatented mining claim located in Aubrey Township, northwestern Ontario. It was designed as a preliminary evaluation of the property.

The claim is underlain by east-west trending metasedimentary rocks and chert magnetite iron formation. No minerals of economic importance were discovered in this program. Four linear features were defined by ground magnetic and VLF-EM surveys. The property should be covered by routine prospecting and geological mapping.

Wawa, Ontario
May, 1996

Respectfully Submitted,

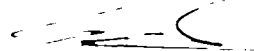

Seymour M. Sears, B.A., B.Sc.
Geologist

STATEMENT OF QUALIFICATIONS

I, Seymour M. Sears, of Wawa, Ontario do certify that:

1. I am a consulting geologist for Sears, Barry and Associates Ltd., P.O. Box 2058, Wawa, Ontario.
2. I am a B. Sc. Graduate in Geology and a B. A. Graduate in Psychology from Mount Allison University, Sackville, New Brunswick.
3. I have been practicing my profession continuously since 1972.
4. I am a Fellow of the Geological Association of Canada.
5. I have not received nor do I expect to receive any interest or securities, direct or indirect in the Aubrey Township Properties or other properties of Champion Bear Resources Limited nor any properties of affiliated companies.

May, 1996

Respectfully submitted,

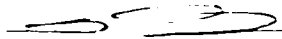

22 Caverhill Street
P.O. Box 2058
Wawa, Ontario
POS 1K0

Seymour M. Sears, B. A., B. Sc.
Geologist

REFERENCES

Chorlton, L.B.

1991 Geological History of the Sandybeach Lake Area, Sioux Lookout-Dinorwic Belt, Wabigoon Subprovince, and its Implications for Gold Exploration; Ontario Geological Survey, Open File Report 5752.

Moorhouse, W.W.

1941 Geology of the Dryden-Wabigoon Area; Ontario Department of Mines, Annual Report, 1941, vol 50, Part 2, pp1-67.

Ontario Division of Mines

1979: Kenora-Fort Francis Area, Geological Compilation Series, Kenora and Sioux Lookout Districts. Map 2443.
Scale 1" = 4 mi.



Les renseignements personnels contenus dans la présente formule sont recueillis en vertu de la Loi sur les mines et serviront à la correspondance. Adresser toute question sur la collecte de ces renseignements au chef provincial des terrains miniers, ministère du Développement du Nord et des Mines, 159, rue Cedar, 4^e étage, Sudbury (Ontario) P3E 6A5; téléphone : (705) 670-7264.

- Directives :
- Dactylographier ou écrire en lettres moulées.
 - Se reporter à la Loi sur les mines et aux règlements pour connaître les dispositions de détail des travaux d'évaluation ou consulter le registraire de claim.
 - Remplir une formule pour chaque groupe de travaux.
 - Joindre à la présente formule deux exemplaires.
 - Joindre à la présente formule une esquisse in-

2.16586



52F14SE0007 2 16586 AUBREY

900

Titulaire(s) enregistré(s) CHAMPION BEAR RESOURCES LTD		116945
Adresse 2005 - 9 th St. SW, Calgary, Alberta, T2T 3C4		N° de téléphone (403) 229-9522
Division des mines Kenora	Canton/secteur Aubrey Twp.	N° de plan M ou G G-510
Dates d'exécution des travaux du: May 16, 1996		au: May 24, 1996

Travaux exécutés (cocher un seul groupe de travaux)

Groupe de travaux	Genre
<input checked="" type="checkbox"/> Levé géotechnique	GROUND MAGNETMETER - VLF-EM (Geophysical Surveys)
<input type="checkbox"/> Travaux physiques, y compris forage	
<input type="checkbox"/> Réhabilitation	
<input type="checkbox"/> Autres travaux autorisés	
<input type="checkbox"/> Essais	
<input type="checkbox"/> Valeur transférée de la réserve	

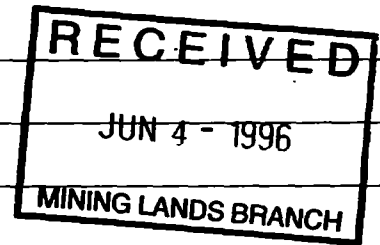

Total des travaux d'évaluation réclamé sur le relevé des frais ci-annexé \$ 2530 - \$

Nota : Le ministre peut rejeter une partie ou la totalité des travaux d'évaluation présentés pour obtenir des crédits d'évaluation si le titulaire enregistré ne peut vérifier les dépenses réclamées sur le relevé des frais dans les trente jours suivant une demande de vérification.

Les personnes et la compagnie d'arpentage qui ont exécuté les travaux (donner le nom et l'adresse de l'auteur du rapport)

Nom	Adresse
Sears Barry & Associates Ltd	P.O. Box 2055, Wawa, Ontario, P0S 1K0
Seymour Sears	(author of Report)

(Joindre une annexe au besoin)

Certification d'intérêt bénéficiaire * Voir la note n° 1 au verso

Je certifie qu'au moment où les travaux ont été exécutés, les claims dont il est question dans le présent rapport étaient enregistrés au nom de leur titulaire actuel ou détenus à titre bénéficiaire par l'actuel titulaire enregistré.	Date May 25/96	Titulaire enregistré ou représentant (Signature) <i>(S. Sears)</i>
--	-------------------	---

Certification du rapport sur les travaux exécutés

Je certifie que j'ai une connaissance directe des faits exposés dans le présent rapport, pour avoir exécuté les travaux ou en avoir constaté l'exécution avant ou après leur achèvement. Je certifie aussi que le rapport ci-annexé est exact.

Nom et adresse du certificateur Seymour M. Sears P.O. Box 2055 Wawa, Ontario, P0S 1K0		
N° de téléphone (705) 856-2018	Date May 25/96	Certifié par (signature) <i>(S. Sears)</i>

Réservé au ministère

Valeur totale des crédits enregistrés	Date d'enregistrement	Registraire de claims <i>(Signature)</i>	Cachet KENORA 2005 MAY 25 1996
	Date de l'approbation prévue Aug 26, 1996	Date d'approbation	
	Date d'envoi de l'avis de modification		



Ministry of
Northern Development
and Mines

Ministère du
Développement du Nord
et des mines

**Statement of Costs
for Assessment Credit**

**État des coûts aux fins
du crédit d'évaluation**

Mining Act/Loi sur les mines

Transaction No./N° de transaction

W9610-00079

Personal information collected on this form is obtained under the authority of the Mining Act. This information will be used to maintain a record and ongoing status of the mining claim(s). Questions about this collection should be directed to the Provincial Manager, Minings Lands, Ministry of Northern Development and Mines, 4th Floor, 159 Cedar Street, Sudbury, Ontario P3E 6A5, telephone (705) 670-7264.

Les renseignements personnels contenus dans la présente formule sont recueillis en vertu de la Loi sur les mines et serviront à tenir à jour un registre des concessions minières. Adresser toute question sur la collecte de ces renseignements au chef provincial des terrains miniers, ministère du Développement du Nord et des Mines, 159, rue Cedar, 4^e étage, Sudbury (Ontario) P3E 6A5, téléphone (705) 670-7264.

1. Direct Costs/Coûts directs

Type	Description	Amount Montant	Totals Total global
Wages Salaires	Labour Main-d'oeuvre		
	Field Supervisor Supervision sur le terrain		
Contractor's and Consultant's Fees Droits de l'entrepreneur et de l'expert- conseil	Type		
	Excavation	1000	
	Geophysical	1080	
	Drafting, S.D., P. 101	600	2320
Supplies Used Fournitures utilisées	Type		
Equipment Rental Location de matériel	Type		
Total Direct Costs Total des coûts directs			2320

2. Indirect Costs/Coûts indirects

** Note: When claiming Rehabilitation work Indirect costs are not allowable as assessment work.
Pour le remboursement des travaux de réhabilitation, les coûts indirects ne sont pas admissibles en tant que travaux d'évaluation.

Type	Description	Amount Montant	Totals Total global
Transportation Transport	Type		
Food and Lodging Nourriture et hébergement	7 Days @ 30	210	210
Mobilization and Demobilization Mobilisation et démobilisation			
Sub Total of Indirect Costs Total partiel des coûts indirects			210
Amount Allowable (not greater than 20% of Direct Costs) Montant admissible (n'excedant pas 20 % des coûts directs)			210
Total Value of Assessment Credit (Total of Direct and Allowable indirect costs)		Valeur totale du crédit d'évaluation (Total des coûts directs et indirects admissibles)	2530

Note: The recorded holder will be required to verify expenditures claimed in this statement of costs within 30 days of a request for verification. If verification is not made, the Minister may reject for assessment work all or part of the assessment work submitted.

Note: Le titulaire enregistré sera tenu de vérifier les dépenses demandées dans le présent état des coûts dans les 30 jours suivant une demande à cet effet. Si la vérification n'est pas effectuée, le ministre peut rejeter tout ou une partie des travaux d'évaluation présentés.

Filing Discounts

1. Work filed within two years of completion is claimed at 100% of the above Total Value of Assessment Credit.
2. Work filed three, four or five years after completion is claimed at 50% of the above Total Value of Assessment Credit. See calculations below:

Total Value of Assessment Credit	Total Assessment Claimed
	x 0.50 =

Remises pour dépôt

1. Les travaux déposés dans les deux ans suivant leur achèvement sont remboursés à 100 % de la valeur totale susmentionnée du crédit d'évaluation.
2. Les travaux déposés trois, quatre ou cinq ans après leur achèvement sont remboursés à 50 % de la valeur totale du crédit d'évaluation susmentionné. Voir les calculs ci-dessous.

Valeur totale du crédit d'évaluation	Évaluation totale demandée
	x 0.50 =

Certification Verifying Statement of Costs

I hereby certify:
that the amounts shown are as accurate as possible and these costs were incurred while conducting assessment work on the lands shown on the accompanying Report of Work form.

that as Agent I am authorized
(Recorded Holder, Agent, Position in Company)

to make this certification

Attestation de l'état des coûts

J'atteste par la présente:
que les montants indiqués sont le plus exact possible et que ces dépenses ont été engagées pour effectuer les travaux d'évaluation sur les terrains indiqués dans la formule de rapport de travail ci-joint.

Et qu'à titre de _____ je suis autorisé
(titulaire enregistré, représentant, poste occupé dans la compagnie)

à faire cette attestation.

Signature	Date
	May 25/96

Ministry of
Northern Development
and Mines

Ministère du
Développement du Nord
et des Mines

Geoscience Assessment Office
933 Ramsey Lake Road
6th Floor
Sudbury, Ontario
P3E 6B5

Telephone: (705) 670-5853
Fax: (705) 670-5863

August 14, 1996

Our File: 2.16586
Transaction #: W9610.00079

Mining Recorder
Ministry of Northern Development & Mines
808 Robertson Street
P.O. Box 5200
Kenora, Ontario
P9N 3X9

Dear Mr. Rivett:

**SUBJECT: APPROVAL OF ASSESSMENT WORK CREDIT ON MINING LAND, CLAIM(S)
1174436 IN AUBREY TOWNSHIP**

Assessment work credit has been approved as outlined on the Declaration of Assessment Work Form accompanying this submission. The credit has been approved under Section 14, Geophysics (MAG,VLF), of the Assessment Work Regulation.

The approval date is August 14, 1996. Please indicate this approval on the claim record.

If you have any questions regarding this correspondence, please contact Steven Beneteau at (705) 670-5855.

Yours sincerely,
ORIGINAL SIGNED BY:

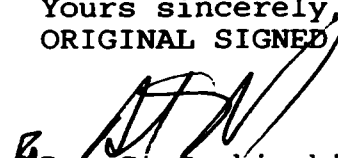
Ron C. Gashinski
Senior Manager, Mining Lands Section
Mines and Minerals Division

SBB SBB/jf

cc: Resident Geologist
Kenora, Ontario

✓ Assessment Files Library
Sudbury, Ontario

REFERENCES

NOTE
DOT AND CONCESSION LINES SHOWN HEREON ARE PROJECTED FROM THE BEST INFORMATION AVAILABLE BUT THEIR TRUE ACCURACY IS NOT GUARANTEED. FOR LEGAL AND SURVEY PURPOSES CONSULT THE ORIGINAL SURVEY PLANS AND FIELD NOTES OF RECORD IN THE MINISTRY OF NATURAL RESOURCES, AT TORONTO.

ACREAGES SHOWN FOR PATENTED LOTS ARE IN ACCORDANCE WITH AREAS GRANTED.

1994 - Herbicide Spray
August 15 - September 14, 1994



200

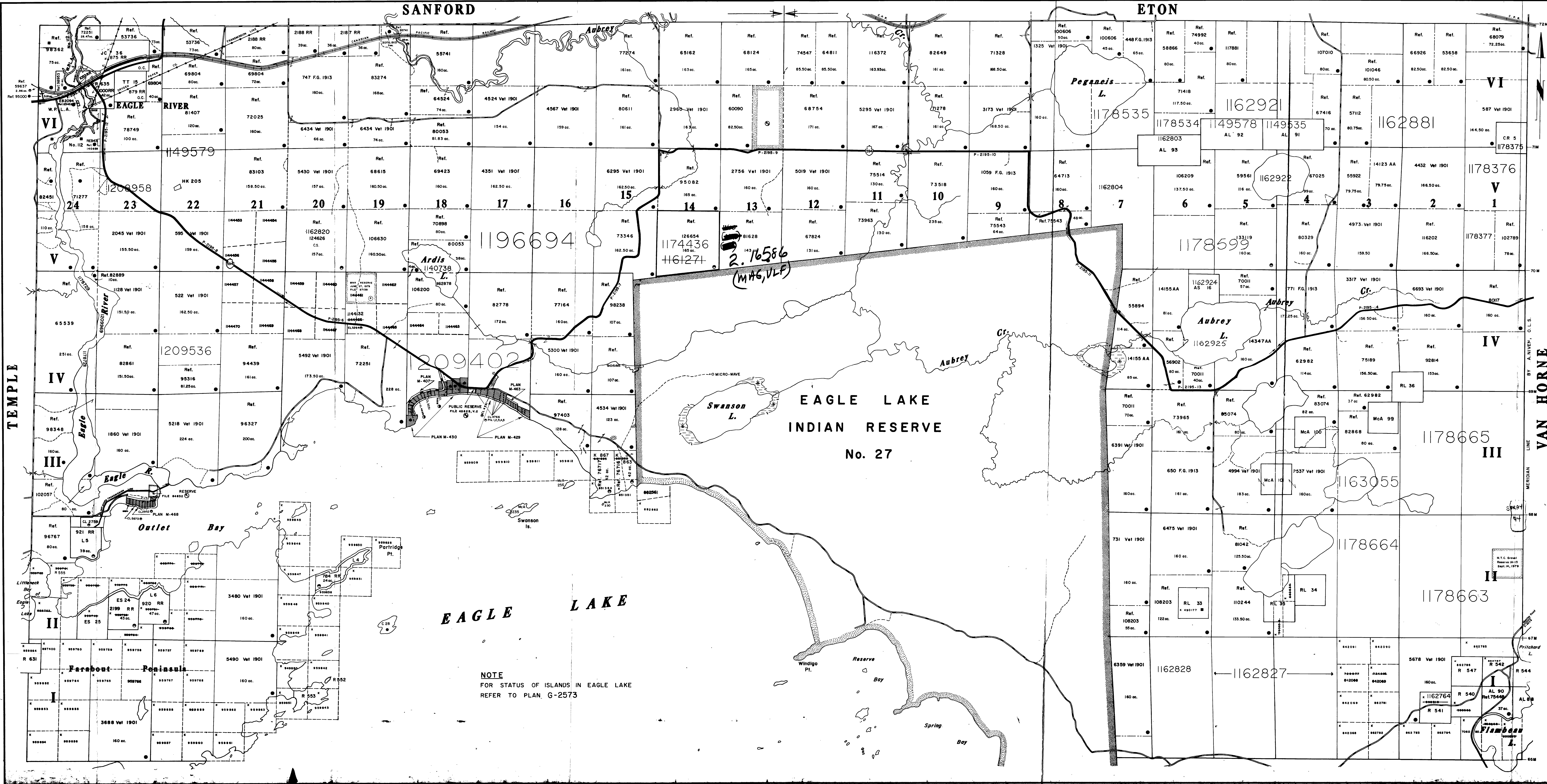

REFERENCES

TOPOGRAPHY
F. R. I. Nos. 496 924, 496 931, 497 924, 497 931.

SURVEYS
F. N. S.'s - 901, 2439, 2977, 1816, 1161, 1710. PLANS - W 32-24, Y 23-9, W 15-7, W 19-21, W 19-49, W 25-36, R 18-15, L 14-23, W 24-25, W 24-26, W 27-14.

HIGHWAYS
HIGHWAYS THROUGH CROWN LANDS FROM MINISTRY OF TRANSPORTATION AND COMMUNICATIONS SURVEY PLANS AS NOTED.

ROADS
PLAN - L14-23.

RAILWAYS
PLAN - (C.P.R.) L 7-14, N 11-18.

TRANSMISSION LINE
PLAN - S 18-2.

THE INFORMATION THAT APPEARS ON THIS MAP HAS BEEN COMPILED FROM VARIOUS SOURCES AND ACCURACY IS NOT GUARANTEED. THOSE DESIRING TO STAKE CLAIMS SHOULD CONSULT WITH THE MINING RECORDER, MINISTRY OF NORTHERN DEVELOPMENT AND MINES, FOR ADDITIONAL INFORMATION ON THE STATUS OF THE LANDS SHOWN HEREON.

LEGEND

HIGHWAY AND ROUTE NO.
OTHER ROADS
TRAILS
SURVEYED LINES, TOWNSHIP, BASE LINES, ETC.
LOTS, MINING CLAIMS, PARCELS, ETC.
UNSURVEYED LINES.
LOT LINES
PARCEL BOUNDARY
MINING CLAIMS ETC.
RAILWAY AND RIGHT OF WAY
UTILITY LINES
NON-PERENNIAL STREAM
FLOODING OR FLOODING RISKS
SUBDIVISION OR COMPOSITE PLAN
RESERVATIONS
ORIGINAL SHORELINE
MARKS OR MARKING
MINES
TRAVEL MONUMENT

DISPOSITION OF CROWN LANDS

TYPE OF DOCUMENT

.....	PATENT, SURFACE & MINING RIGHTS
.....	SURFACE RIGHTS ONLY
.....	MINING RIGHTS ONLY
.....	LEASE, SURFACE & MINING RIGHTS
.....	SURFACE RIGHTS ONLY
.....	MINING RIGHTS ONLY
.....	LICENSE OF OCCUPATION
.....	ORDER-IN-COUNCIL
.....	RESERVATION
.....	CANCELLED
.....	SAND & GRAVEL

AREAS WITHDRAWN FROM DISPOSITION

.....	M.R.O. - MINING RIGHTS ONLY
.....	S.R.O. - SURFACE RIGHTS ONLY
.....	M + S. - MINING AND SURFACE RIGHTS

Description Order No. Date Disposition File No.

.....
.....
.....

DATE OF ISSUE
MAY 31 1996

MINING DIVISION

SCALE: 1 INCH = 20 CHAINS

TOWNSHIP
AUBREY

MINING DIVISION

DRYDEN

KENORA

LAND TITLES / REGISTRY DIVISION

KENORA

Ministry of Natural Resources
Ministry of Northern Development and Mines

RECEIVED
JUN 4 - 1996
MINING LANDS BRANCH

16586

G-810
AUBREY TWP.
MAY 31 1996
16586

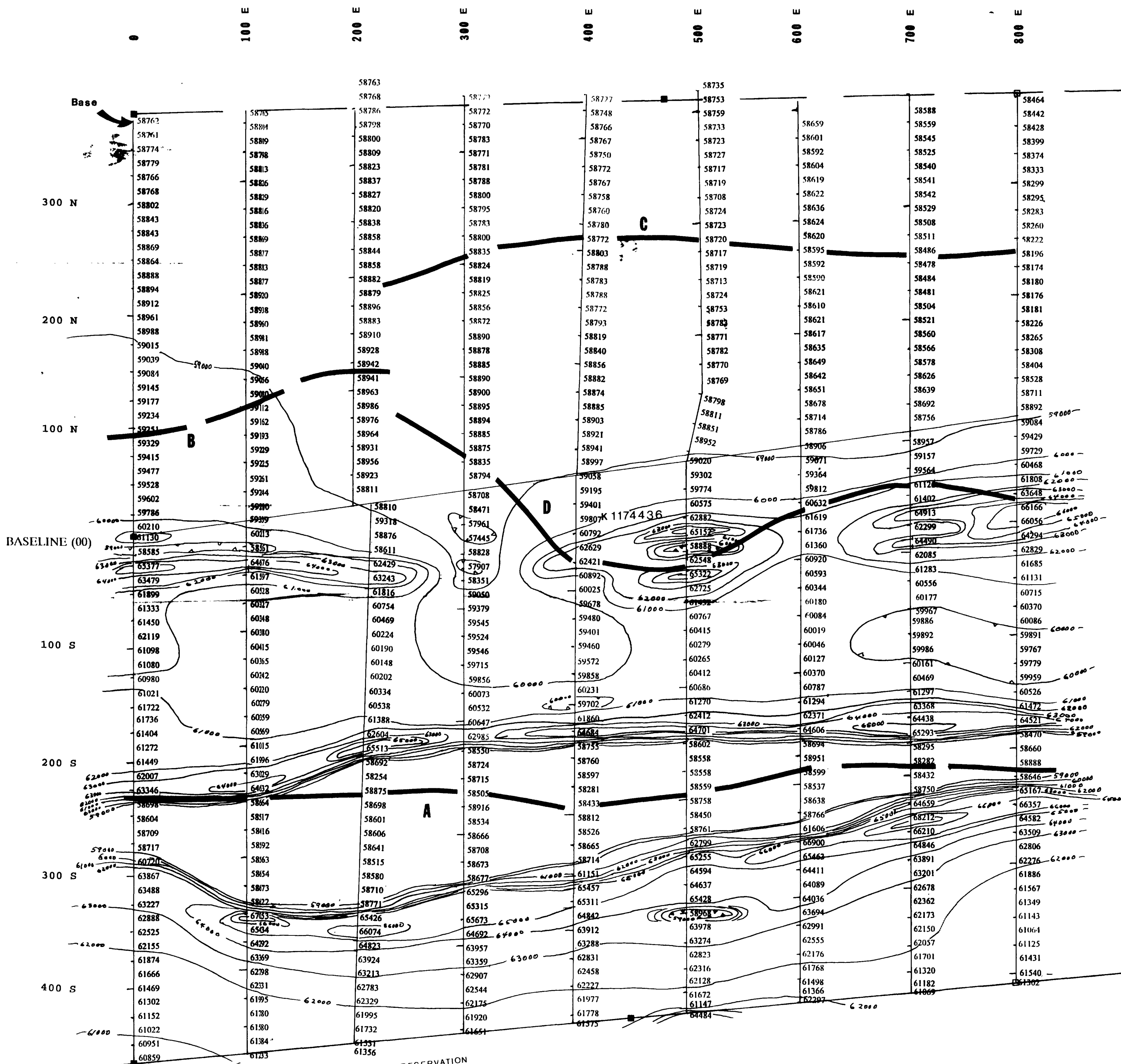

INSTRUMENT: Geometrics G-816, Portable Proton Magnetometer
 Geometrics G-856, Recording Base Station Magnetometer
 OPERATOR: J. Partington

CONTOUR INTERVAL: 1000 X
 CONDUCTOR AXIS (VLF-EM):

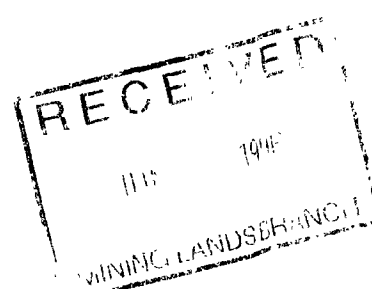

165 86

CHAMPION BEAR RESOURCES LTD.

AUBREY EAST PROPERTY

(Aubrey Township, Ontario)

GROUND MAGNETOMETER SURVEY
 (Total Field Data)

Date: Rev:
 Data By: Sears, Barry and Associates Ltd.

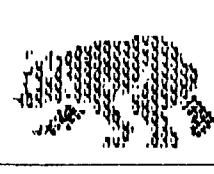

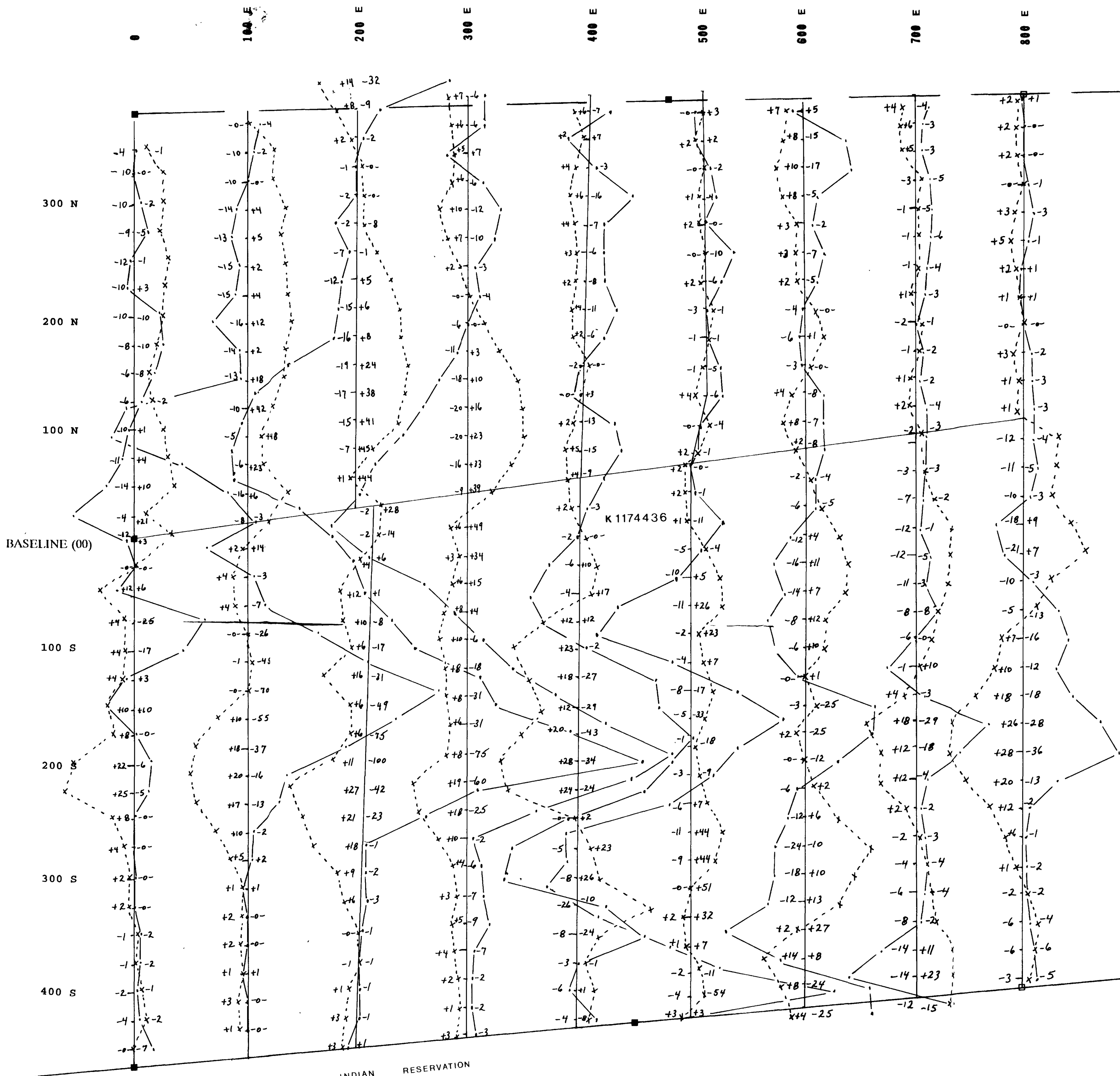

0 100m
Scale 1:2500

RECEIVED
MAY 1 1996
MINING LANDS BRANCH

2.169 8 8

LEGEND

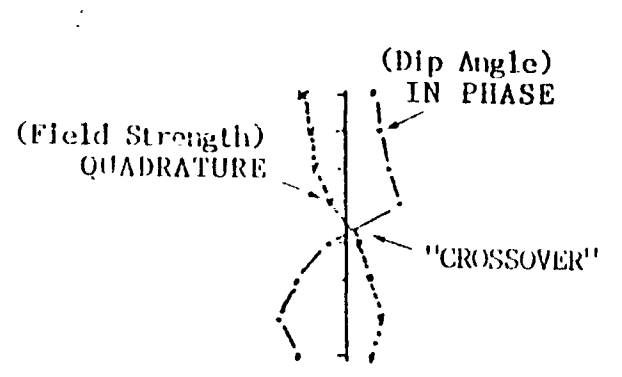

INSTRUMENT: Geonics, EM-16
STATION: Cutler, Me., NAA 24.0 kHz
OPERATOR: J. Portington



220

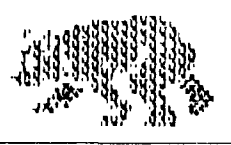

CHAMPION BEAR RESOURCES LTD.

AUBREY EAST PROPERTY
(Aubrey Township, Ontario)

VLF-EM SURVEY
(Profile Data)

Date: _____ Rev: _____
Data By: _____ Sears, Barry and Associates Ltd.