



52F15SE2004 2.18808 ZEALAND

010

TECK EXPLORATION LTD DIAMOND DRILL LOG

RECEIVED
SEP 24 1998
GEOSCIENCE ASSESSMENT
OFFICE

Hole TL-210
Sheet 1 of 4

Job <u>16570</u> N.T.S. <u>52 F/15</u>	Objective <u>Assessment credits</u>	Core Location <u>Wabigoon core shack,</u>	Tests	Dip	Azimuth
Property <u>Thunder Lake West</u>		<u>Hwy 17</u>	At Collar	<u>-50°</u>	<u>360°</u>
Township <u>Zealand</u>	Drilling Co. <u>St. Lambert Drilling</u>	Distance to Water <u>50 m</u>	<u>51m</u>	<u>-51°</u>	<u>356°</u>
Location: Line <u>L24+50W</u>	<u>Co. Ltd.</u>	Casing Lost <u>11.0 m</u>	<u>101m</u>	<u>No test</u>	
Station <u>0+75S</u>	Commenced <u>June 25, 1998</u>	Core Size <u>NQ</u>	<u>(instrument malfunction)</u>		
Claim No. <u>K1106350</u>	Completed <u>June 26, 1998</u>	Date Logged <u>June 27, 1998</u>			
Logged <u>Richard Page</u>	Length <u>101.0 m</u>				

Richard D. Page

DRILL HOLE SUMMARY

Rocks in drill hole consist of alternating units of quartz + feldspar porphyry and greywacke + pelite. Minor quartz-veined sections (e.g., 28.5-30.6 m) but no significant alteration or mineralization.

Technical: Water supply from beaver pond to west. Logging completed on 27 June 1998.

Assay Samples: L7401-L7429 (29 samples).

Depth (m)		Rock Type	Descriptions	Sample No.	From	To	Lgth (m)	Au ppb	Au g/t (P+M)
From	To								
0.0	10.9	OVERBURDEN	Casing.						
10.9	17.1	QUARTZ PORPHYRY 3c	Medium to pale gray, moderately foliated, very blocky and with local mm to cm shears; 1-2% quartz + calcite veins, rare trace pyrite, no significant alteration.						
17.1	47.0	GREYWACKE AND PELITE 2a, b	Dark gray to dark brownish-gray moderately foliated biotite + quartz greywackes with 10 to 30% interlayered biotite-rich pelites with local andalusite porphyroblasts; scattered trace to 1% tiny garnet in greywackes; trace to 0.5% pyrite + pyrrhotite on foliations; rare local weak sericite alteration; quartz veins as noted. 17.1-24.0 - 2b > 2a, trace pyrite. 24.0-27.0 - 2b > 2a, <1% pyrrhotite + pyrite, 1% dark quartz veins.	L7401	24.0	25.5	1.5	<5	
			27.0-28.5 - 2b (a), 25 cm quartz + tourmaline veining, 1% pyrrhotite, traces sphalerite.	L7402	25.5	27.0	1.5	<5	
			28.5-30.6 - 2a (b), quartz vein zone with 15-20% dark quartz veins + veinlets; weak local sericite, <1% pyrite + pyrrhotite.	L7403	27.0	28.5	1.5	400	
			30.6-33.0 - 2a, 1-2% quartz veins, <0.5% pyrite + pyrrhotite.	L7404	28.5	30.0	1.5	15	
			33.0-47.0 - 2a, locally biotite-rich but still greywacke; 13 cm quartz vein from 42.8 m; trace pyrrhotite overall.	L7405	30.0	31.5	1.5	190	
				L7406	31.5	33.0	1.5	<5	
				L7407	45.5	47.0	1.5	5	
47.0	51.5	QUARTZ + FELDSPAR PORPHYRY 3cf	Pale to dark gray, moderately foliated feldspar (5 to 10%) + quartz (1 to 3%) phenocryst felsic porphyry; 22 cm gray quartz vein at upper contact, pyrite seams at lower contact. Patchy irregular silicification with quartz veinlets at several locations (5 to 20 cm); trace pyrite + pyrrhotite overall.	L7408	47.0	48.5	1.5	40	
				L7409	48.5	50.0	1.5	<5	
				L7410	50.0	51.5	1.5	<5	
51.5	57.6	GREYWACKE 2a	Weakly foliated, dark gray to black biotite + quartz greywacke; no significant alteration, <1% quartz veins, trace pyrite. 56.6-57.6 - 1% streaky pyrite.	L7411	51.5	52.5	1.0	20	
				L7412	56.6	57.6	1.0	<5	
57.6	79.5	QUARTZ + FELDSPAR PORPHYRY 3cf	Pale to locally dark gray, weakly foliated, very hard (silica + feldspar) quartz + feldspar porphyry; 3 to 10% diffuse to distinct feldspar phenocrysts (1-2 mm) and 1 to 2% quartz phenocrysts; quite	L7413	57.6	58.8	1.2	5	
				L7414	78.0	79.5	1.5	5	

Depth (m)		Rock Type	Descriptions	Sample No.	From	To	Lgth (m)	Au ppb	Au g/t (P+M)
From	To								
79.5	90.0	GREYWACKE AND PELITE 2a, b	blocky overall, with patchy strongly silicified sections, minor quartz veins overall. Upper contact has 10 cm with 5-8% pyrite veinlets; trace pyrite overall.						
			Complex altered interval consisting of mainly biotite + quartz ± sericite greywacke (60-70%), with 20-25% sericite + biotite pelites or argillites, and minor short units of graphitic argillite (+ pyrite), calc-silicate-altered (amphibole + epidote) greywacke, and quartz + feldspar porphyry. Unit contains 1-2% irregular quartz veins and 1% pyrrhotite + pyrite overall, decreasing downhole.						
			79.5-80.6 - 20 cm graphitic argillite + quartz veins + 5% pyrite veins + stringers; rest is calc-silicate altered layered greywacke (with trace - 1% pyrite + pyrrhotite ± magnetite?)	L7415	79.5	80.6	1.1	30	
			80.6-81.8 - 40 cm calc-silicate altered greywacke, rest is layered 3c/a, trace - 0.5% pyrite ± pyrrhotite.	L7416	80.6	81.8	1.2	25	
			81.8-84.0 - 10 cm brecciated 3c/a, 10 cm black graphitic argillite (5-8% pyrite + pyrrhotite); rest of interval is weakly sericite-altered biotite + sericite + quartz layered schist/greywacke with 1% pyrrhotite + pyrite overall.	L7417	81.8	83.0	1.2	10	
				L7418	83.0	84.0	1.0	5	
			84.0-88.5 - 2a, 10% 2b (scattered garnet), 3-5% quartz veins up to 15 cm, weak to nil sericite alteration, 0.5-1% pyrrhotite + pyrite.	L7419	84.0	85.5	1.5	15	
				L7420	85.5	87.0	1.5	35	
L7421	87.0	88.5		1.5	50				
88.5-90.0 - As above, lower 40 cm is diffuse contact zone between greywacke and gneissic porphyry following; 0.5-1% pyrite + pyrrhotite, rare trace sphalerite.	L7422	88.5	90.0	1.5	760				
	90.0	94.2	GNEISSIC QUARTZ PORPHYRY 3c/a	Typical strongly to weakly layered, quite uniform interval grading from scant quartz phenocryst rock to layered quartz-eye gneiss. Trace to 0.5% pyrite ± pyrrhotite overall, no significant alteration.	L7423	90.0	91.5	1.5	25
				L7424	91.5	92.9	1.4	5	
				L7425	92.9	94.2	1.3	<5	
94.2	99.0	PELITE AND GREYWACKE 2b, a	Strongly foliated biotite + quartz ± sericite ± garnet sedimentary rocks, upper 1.5 m with weak streaky sericitic alteration; rest is dark gray to black (no significant sericite alteration); 0.5-1% pyrrhotite + pyrite overall.	L7426	94.2	95.5	1.3	20	
			L7427	95.5	96.8	1.3	10		
			L7428	96.8	97.8	1.0	10		
			L7429	97.8	99.0	1.2	65		

Depth (m)		Rock Type	Descriptions	Sample No.	From	To	Lgth (m)	Au ppb	Au g/t (P+M)
From	To								
99.0	101.0	QUARTZ + FELDSPAR PORPHYRY 3cf	Weakly to moderately foliated, as in unit at 57.6-79.5 m; no significant sulphides or alteration.						
	101.0	END OF HOLE	<p>Foliations:</p> <p>12m = 58° 21 = 52° 30 = 59° 39 = 58° 48 = 63° 57 = 54° 66 = 51° 75 = 51° 84 = 62° 93 = 57° 101 = 54°</p>						



T S L LABORATORIES

DIVISION OF TSL/ASSAYERS INC.

2 - 302 - 48 th STREET,
SASKATOON, SASKATCHEWAN
S7K 6A4

☎ (306) 931-1033 FAX: (306) 242-4717

CERTIFICATE OF ANALYSIS

SAMPLE(S) FROM Teck Explorations Ltd.
R.R. #5 - 19 Legault Street
North Bay, Ontario
P1B 8Z4

REPORT No.
S7261

SAMPLE(S) OF Drill Core

INVOICE #: 31136
P.O.:

R. Page
Project: 16570

	Au ppb	Au g/t
L7401	<5/<5	
L7402	<5	
L7403	400	.45
L7404	15	
L7405	190	
L7406	<5	
L7407	5	
L7408	40	
L7409	<5	
L7410	<5	
L7411	20/20	
L7412	<5	
L7413	5	
L7414	5	
L7415	30	
L7416	25	
L7417	10	
L7418	5	
L7419	15	
L7420	35	

COPIES TO: J. G. O'Connell, P. Waque
INVOICE TO: Teck Expl.- North Bay

Jul 13/98

SIGNED 



T S L LABORATORIES

DIVISION OF TSL/ASSAYERS INC.

2 - 302 - 48 th STREET,
SASKATOON, SASKATCHEWAN
S7K 6A4

☎ (306) 931-1033 FAX: (306) 242-4717

CERTIFICATE OF ANALYSIS

SAMPLE(S) FROM Teck Explorations Ltd.
R.R. #5 - 19 Legault Street
North Bay, Ontario
P1B 8Z4

REPORT No. S7261

SAMPLE(S) OF Drill Core

INVOICE #: 31136
P.O.:

R. Page
Project: 16570

	Au ppb	Au g/t
L7421	50	
L7422	760	.45/.59
L7423	25	
L7424	5	
L7425	<5	
L7426	20	
L7427	10	
L7428	10	
L7429	65	

COPIES TO: J. G. O'Connell, P. Waque
INVOICE TO: Teck Expl.- North Bay

Jul 13/98

SIGNED _____

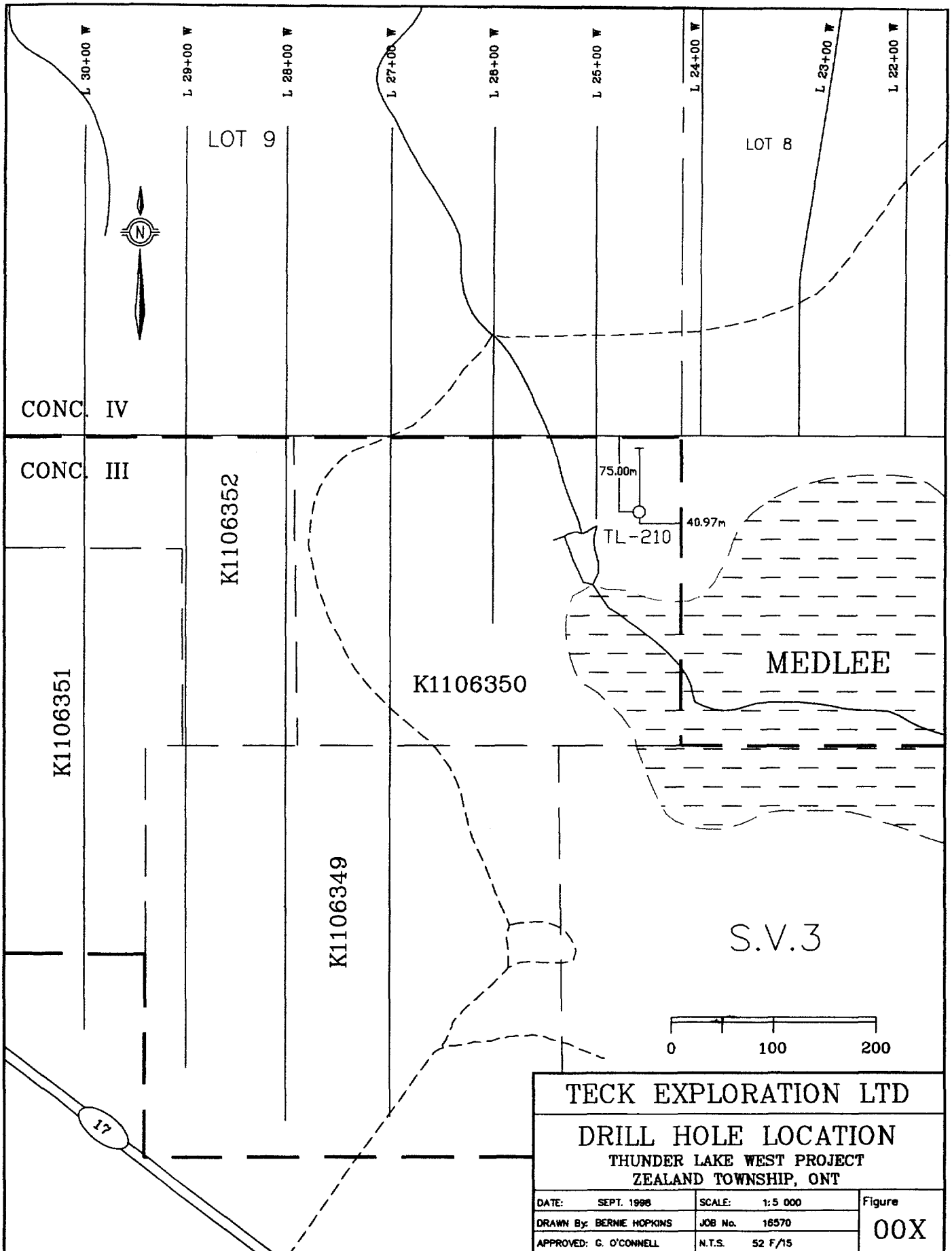

CONC. IV

LOT 9

LOT 8

CONC. III

K1106352

K1106350

MEDLEE

K1106351

K1106349

S.V.3

75.00m
TL-210
40.97m

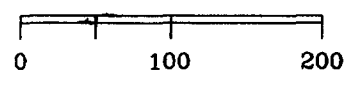

TECK EXPLORATION LTD		
DRILL HOLE LOCATION		
THUNDER LAKE WEST PROJECT		
ZEALAND TOWNSHIP, ONT		
DATE: SEPT. 1998	SCALE: 1:5 000	Figure 00X
DRAWN By: BERNIE HOPKINS	JOB No. 16570	
APPROVED: G. O'CONNELL	N.T.S. 52 F/15	

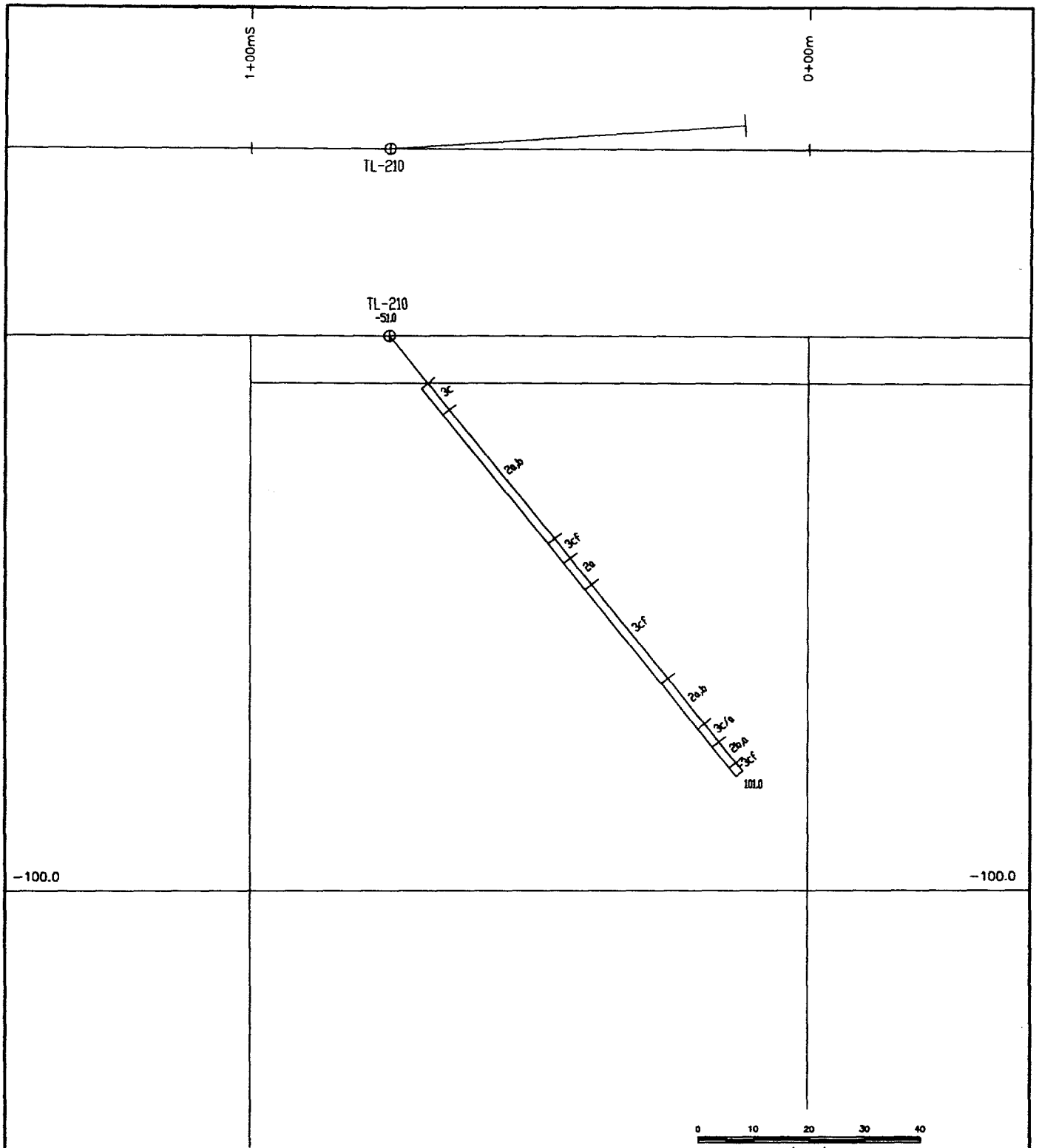

3

Felsic Volcanics and Intrusive Rocks

- a. Quartz porphyritic biotite + quartz + feldspar gneiss
- c. Quartz ± feldspar porphyry
- f. Feldspar + quartz crystal gneiss (3af)

2

Metasediments

- a. Massive to foliated biotite + quartz + feldspar rocks (greywackes)
- b. Finely laminated quartz + feldspar + biotite schists (pelites)

TECK EXPLORATION LTD		
SECTION LINE 24+05mW		
THUNDER LAKE WEST ZEALAND TWP., ONT.		
DATE: SEPT. 1996	SCALE: 1:1 000	Figure
DRAWN By: BERNIE HOPKINS	JOB No. 16570	
APPROVED: G. O'CONNELL	N.T.S. 52 F/15	



Declaration of Assessment Work Performed on Mining Land

Mining Act, Subsection 65(2) and 66(3), R.S.O. 1990

Transaction Number (office use) W981000122 Assessment Files Research Imaging



52F15SE2004 2.18808 ZEALAND

900

subsections 65(2) and 66(3) of the Mining Act. Under section 8 of the Mining Act, assessment work and correspond with the mining land holder. Questions about this orthern Development and Mines, 3rd Floor, 933 Ramsey Lake Road, Sudbury,

Instructions: - For work performed on Crown Lands before recording a claim, use form 0240. - Please type or print in ink.

1. Recorded holder(s) (Attach a list if necessary)

Form with fields for Name, Address, Client Number, Telephone Number, and Fax Number for Teck Exploration Ltd.

2. Type of work performed: Check (✓) and report on only ONE of the following groups for this declaration.

Geotechnical: prospecting, surveys, assays and work under section 18 (regs) [X] Physical: drilling stripping, Trenching and associated assays Rehabilitation

Form with fields for Work Type (Diamond drilling and associated assays), Office Use, Dates Work Performed, NTS Reference, Mining Division, and Resident Geologist District.

Please remember to: - obtain a work permit from the Ministry of Natural Resources as required; - provide proper notice to surface rights holders before starting work; - complete and attach a Statement of Costs, form 0212; - provide a map showing contiguous mining lands that are linked for assigning work; - include two copies of your technical report.

3. Person or companies who prepared the technical report (Attach a list if necessary)

Form with fields for Name, Address, Telephone Number, and Fax Number for Richard Page. Includes a RECEIVED stamp dated SEP 24 1998.

4. Certification by Recorded Holder or Agent

I, Gerry O'Connell, do hereby certify that I have personal knowledge of the facts set forth in this Declaration of Assessment Work having caused the work to be performed or witnessed the same during or after its completion and, to the best of my knowledge, the annexed report is true.

Form with fields for Signature of Recorded Holder or Agent, Date (September 16, 1998), Agent's Address, Telephone Number, and Fax Number.

Deemed Dec 23/98 2.18808

5. **Work to be recorded and distributed.** Work can only be assigned to claims that are contiguous (adjoining) to the mining land where work was performed, at the time work was performed. A map showing the contiguous link must accompany this form.

W9810.00122

Mining Claim Number. Or if work was done on other eligible mining land, show in this column the location number indicated on the claim map.	Number of Claim Units. For other mining land, list hectares.	Value of work performed on this claim or other mining land.	Value of work applied to this claim.	Value of work assigned to other mining claims.	Bank. Value of work to be distributed at a future date
eg TB 7827	16 ha	\$26,825	N/A	\$24,000	\$2,825
eg 1234567	12	0	\$24,000	0	0
eg 1234568	2	\$ 8,892	\$ 4,000	0	\$4,892
1 1106352	1		1600		
2 1106351	1		1200		
3 1106350	1	5485	1200	3911	374
4 1106349	1		1111		
5					
6					
7					
8					
9					
10					
11					
12					
13					
14					
15					
Column Totals		5485	5111	3911	374

I, Gerry O'Connell, do hereby certify that the above work credits are eligible under subsection 7 (1) of the Assessment Work Regulation 6/96 for assignment to contiguous claims or for application to the claim where the work was done.

Signature of Recorded Holder or Agent Authorized in Writing

Gerry O'Connell

Date

September 16, 1998

6. **Instructions for cutting back credits that are not approved.**

Some of the credits claimed in this declaration may be cut back. Please check (✓) in the boxes below to show how you wish to prioritize the deletion of credits:

- 1. Credits are to be cut back from the Bank first, followed by option 2 or 3 or 4 as indicated.
- 2. Credits are to be cut back starting with the claims listed last, working backwards; or
- 3. Credits are to be cut back equally over all claims listed in this declaration; or
- 4. Credits are to be cut back as prioritized on the attached appendix or as follows (describe):

Note: If you have not indicated how your credits are to be deleted, credits will be cut back from the Bank first, followed by option number 2 if necessary.

For Office Use Only

Received Stamp

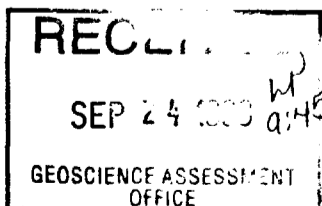

Deemed Approved Date

Date Notification Sent

Date Approved

Total Value of Credit Approved

Approved for Recording by Mining Recorder (Signature)

0241 (03/97)

2.18808

Personal information collected on this form is obtained under the authority of subsection 6 (1) of the Assessment Work Regulation 6/96. Under section 8 of the Mining Act, this information is a public record. This information will be used to review the assessment work and correspond with the mining land holder. Questions about this collection should be directed to a Provincial Mining Recorder, Ministry of Northern Development and Mines, 3rd Floor, 933 Ramsey Lake Road, Sudbury, Ontario, P3E 6B5.

Work Type	Units of work Depending on the type of work, list the number of hours/days worked, metres of drilling, kilometres of grid line, number of samples, etc.	Cost Per Unit of work	Total Cost
Diamond Drilling	101.0m	47.5/m	4,801
Geology	1 day	225/day	225
Assaying	29 samples	10.50/sample	304
Associated Costs (e.g. supplies, mobilization and demobilization).			
Transportation Costs			
	4WD truck	80/day	80
Food and Lodging Costs			
	Motel 1 day	40/day	40
	Food 1 day	35/day	35
Total Value of Assessment Work			5485

Calculations of Filing Discounts:

1. Work filed within two years of performance is claimed at 100% of the above Total Value of Assessment Work.
2. If work is filed after two years and up to five years after performance, it can only be claimed at 50% of the Total Value of Assessment Work. If this situation applies to your claims, use the calculation below:

TOTAL VALUE OF ASSESSMENT WORK x 0.50 = Total \$ value of worked claimed.

Note:

- Work older than 5 years is not eligible for credit.
- A recorded holder may be required to verify expenditures claimed in this statement of costs within 45 days of a request for verification and/or correction/clarification. If verification and/or correction/clarification is not made, the Minister may reject all or part of the assessment work submitted.

Certification verifying costs:

I, Gerry O'Connell (please print full name), do hereby certify, that the amounts shown are as accurate as may reasonably be determined and the costs were incurred while conducting assessment work on the lands indicated on the accompanying Declaration of Work form as District Manager I am authorized to make this certification. (recorded holder, agent, or state company position with signing authority)

RECEIVED
SEP 24 1998
GEOSCIENCE ASSESSMENT OFFICE

Signature: *[Handwritten Signature]*
Date: September 16, 1998

Geoscience Assessment Office
933 Ramsey Lake Road
6th Floor
Sudbury, Ontario
P3E 6B5

Telephone: (888) 415-9846
Fax: (877) 670-1555

October 16, 1998

TECK EXPLORATION LTD.
SUITE 600, 200 BARRARD STREET
VANCOUVER, B.C.
V6C-3L9

Visit our website at:
www.gov.on.ca/MNDM/MINES/LANDS/mlsmnpge.htm

Dear Sir or Madam:

Submission Number: 2.18808

Status

Subject: Transaction Number(s): W9810.00122 Deemed Approval

We have reviewed your Assessment Work submission with the above noted Transaction Number(s). The attached summary page(s) indicate the results of the review. **WE RECOMMEND YOU READ THIS SUMMARY FOR THE DETAILS PERTAINING TO YOUR ASSESSMENT WORK.**

If the status for a transaction is a 45 Day Notice, the summary will outline the reasons for the notice, and any steps you can take to remedy deficiencies. The 90-day deemed approval provision, subsection 6(7) of the Assessment Work Regulation, will no longer be in effect for assessment work which has received a 45 Day Notice. Allowable changes to your credit distribution can be made by contacting the Geoscience Assessment Office within this 45 Day period, otherwise assessment credit will be cut back and distributed as outlined in Section #6 of the Declaration of Assessment work form.

Please note any revisions must be submitted in **DUPLICATE** to the Geoscience Assessment Office, by the response date on the summary.

If you have any questions regarding this correspondence, please contact Bruce Gates by e-mail at gatesb2@epo.gov.on.ca or by telephone at (705) 670-5856.

Yours sincerely,



ORIGINAL SIGNED BY
Blair Kite
Supervisor, Geoscience Assessment Office
Mining Lands Section

Work Report Assessment Results

Submission Number: 2.18808

Date Correspondence Sent: October 16, 1998

Assessor: Bruce Gates

Transaction Number	First Claim Number	Township(s) / Area(s)	Status	Approval Date
W9810.00122	1106350	ZEALAND	Deemed Approval	October 15, 1998

Section:
16 Drilling PDRILL

Correspondence to:
Resident Geologist
Kenora, ON

Recorded Holder(s) and/or Agent(s):
Gerry O'Connell
NORTH BAY, ONTARIO

Assessment Files Library
Sudbury, ON

TECK EXPLORATION LTD.
VANCOUVER, B.C.

WAINWRIGHT TWP. M2057

VAN HORNE TWP. G0839

REFER TO AREA MAP OF
CONTACT BAY G2579

REFER TO AREA MAP OF
BUTLER LAKE G2576

SOUTHWORTH TWP. G0835

ZEALAND TWP.

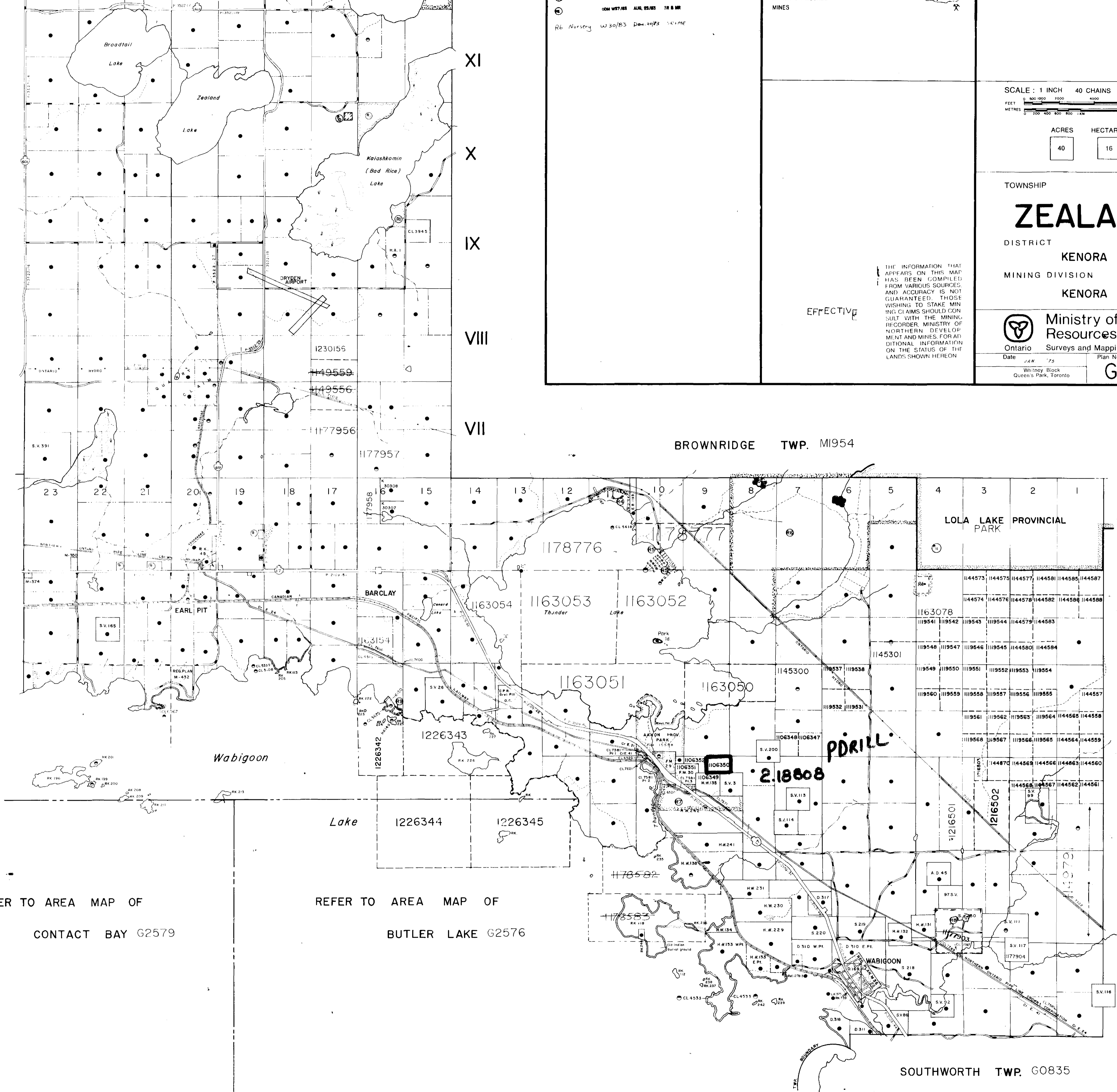

43 880 970 W7177 JUL 19/77 SR 0640
 10M W7177S JUL 19/78 SR 8 MR
 Re. Noting W30/83 Dec. 20/83 141146

MARSH OR MUSKEG MINES

THE INFORMATION THAT APPEARS ON THIS MAP HAS BEEN COMPILED FROM VARIOUS SOURCES AND ACCURACY IS NOT GUARANTEED. THOSE WISHING TO STAKE MINING CLAIMS SHOULD CONSULT WITH THE MINING RECORDER, MINISTRY OF NORTHERN DEVELOPMENT AND MINES, FOR ADDITIONAL INFORMATION ON THE STATUS OF THE LANDS SHOWN HEREON.

EFFECTIVE

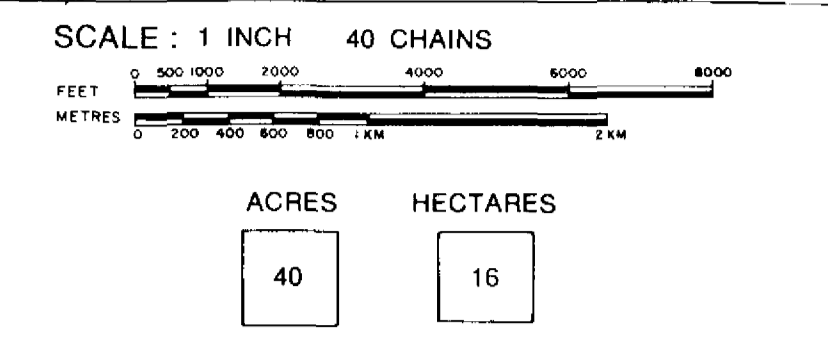

TOWNSHIP
ZEALAND
 DISTRICT
 KENORA
 MINING DIVISION
 KENORA

Ministry of Natural Resources
 Ontario
 Surveys and Mapping Branch

Date: JAN '75 Plan No. G-844
 Whitney Block
 Queen's Park, Toronto

BROWNRIIDGE TWP. M1954

LOLA LAKE PROVINCIAL PARK

HARTMAN TWP. G0820

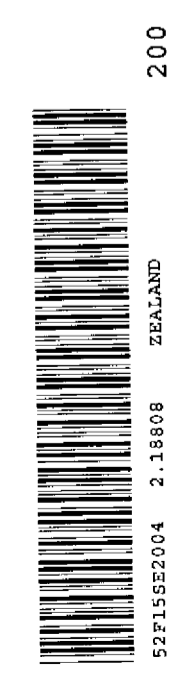

S.F. CORNER Co-ordinates
 LAT. 50° 46' 44" Approx.
 DEP. 100° 38' 54" Approx.