

ADRIAN S. HUDSON
CONSULTING MINING ENGINEER
75 CHATSWORTH DRIVE
TELEPHONE HUDSON 0629
TORONTO 12



52F16NE8279 63A.105 PICKEREL

GEOLOGICAL REPORT

on Properties of

EAGLE LUND MINES LIMITED

and

GOLD EAGLE MINES LIMITED

Pickerel Township
District of Kenora, Ontario

INTRODUCTION:

During July and August, 1950, the writer made a geological survey of the holdings of Eagle Lund Mines Limited and Gold Eagle Mines Limited.

North-south picket lines were run at intervals of 440 feet. The old surveyed concession lines were cleaned out and the north-south picket lines were tied in to the lot corner posts along two concession lines.

In most sections outcrops were numerous but a heavy covering of moss interfered with some of the detailed work.

OWNERSHIP:

Eagle Lund Mines Limited, 185 Bay Street, Toronto, owns 18 claims as follows:- Pa 10246 to 10263.

Gold Eagle Mines Limited, 185 Bay Street, Toronto, holds 27 claims as follows:- Pa 10266 to 10283 and 10307 to 10315.

LOCATION:

The claims are situated in the north western part of Pickerel Township (Concessions 4 to 6, Lots 4 to 8) in the Patricia Mining Division, District of Kenora. Provincial Highway No. 72 cuts diagonally across the properties 18 to 20 miles south west of Sioux Lookout.

ACKNOWLEDGEMENTS:

Reference has been made to H.S. Armstrong's preliminary report on Echo Township and M.E. Hurst's report on the Sioux Lookout Area.

TABLE OF FORMATIONS:

LENOZOIC:

Recent and Pleistocene:

Boulder clay, sand, gravel, boulders

PRECAMBRIAN:

Intrusives:

Granodiorite

Porphyry dikes - quartz and feldspar porphyries

Volcanics:

Basic to Intermediate Lavas

Pyroclastics, Tuffs and Agglomerates

Acid Lavas

ACID LAVAS:

Fine grained light grey rhyolite, similar in appearance to the rhyolite in the conecho core, occupies the northwest half of claim 10255. Elsewhere on the properties the occurrences are small and, on further investigation, may be found to be dikes of fine grained waxy porphyry.

BASIC TO INTERMEDIATE LAVAS:

Most of the claims are occupied by basic to intermediate lavas. For convenience in mapping most of the intermediate lavas have been tentatively shown as andesite.

Pillow lavas are common and are occasionally interbedded with spherulitic lavas. Top determinations on the pillows indicate south facing flows.

PYROCLASTICS, TUFFS AND AGGLOMERATES:

The tuffs and agglomerates have been altered and recrystallized to such an extent that the original characteristics have been obliterated in many cases. There are several bands of tuffs, most of which lie in the southern part of the property.

Classification in the field between recrystallized tuffs and feldspar porphyry was often difficult. In several places a gradation can be seen from tuffs to a coarse porphyritic material with feldspar phenocrysts.

PORPHYRY (Quartz and Feldspar):

A number of porphyry dikes were noted. Some of these were obviously intrusive dikes (e.g. quartz porphyry dikes on claim 10246) but some of the other occurrences, mapped as porphyry dikes, may be recrystallized tuffs.

GRANODIORITE:

A dike of granodiorite, varying from 10 to 40 feet in width, has been traced for a distance of 3,000 feet from the northern part of claim 10248, through 10246 into the northern part of 10254.

The various outcrop line up on a strike of N.58°E. The dip is 80° to the north.

The granodiorite is fine grained and varies from light to dark grey. In places it is heavily carbonatized.

In the few areas stripped of moss the dike was intensely fractured with an abundance of quartz stringers striking both longitudinal and transverse to the dike.

Mineralization varies from fine to coarse pyrite; in one section cubes up to one inch in diameter were seen in the granodiorite alongside the quartz. Visible gold was seen in one section.

STRUCTURE:

The strike of all the rocks throughout the property is remarkably constant at from N.55°E. to N.65° E. The dip varies from 70° to the northwest to vertical, with a tendency for the steeper dip in the northern part of the property.

FAULTING:

It seems probable that there has been some strike faulting along the incompetent tuff beds but actual evidence to support this was not obtained.

On claim 10276 a north-south ridge bordering a swamp suggests a transverse fault but, in general, mapping was not carried out in sufficient detail to determine the existence of transverse faults.

ECONOMIC GEOLOGY:

The occurrence of greatest economic interest is the granodiorite dike previously described. Diamond drilling, now about to commence, will allow a more accurate description at a later date.

A second occurrence of interest was the discovery of some gold-bearing quartz stringers by Harold Barry in June, 1950. This showing on 10309 consists of four 1/2 inch quartz stringers in a narrow shear in a flow top. Grab samples ran up to 0.6 oz. In itself this showing is not impressive but it lines up with a belt containing tuffs, porphyry and a narrow granodiorite dike. This zone extends for half a mile southwest across the property and should be prospected in detail. This may line up with Conwest's recent discovery.

A third section of possible economic interest is a strong zone of carbonatization along the shore of Lake Minnitaki on claim 10252. Numerous quartz stringers up to six inches in width occur along the water's edge for a length of 300 feet or more. The width of carbonatization on the shore is 10 to 30 feet but may extend further under the lake. The dip is 80° N. and the strike is N.60° E. A little pyrite was seen. This zone deserves at least one diamond drill hole to determine conditions under the lake.

September 12, 1950.

A. S. Hudson
A.S. Hudson, B.A.Sc., P.Eng.

LOCATION OF EAGLE LUND SHOW

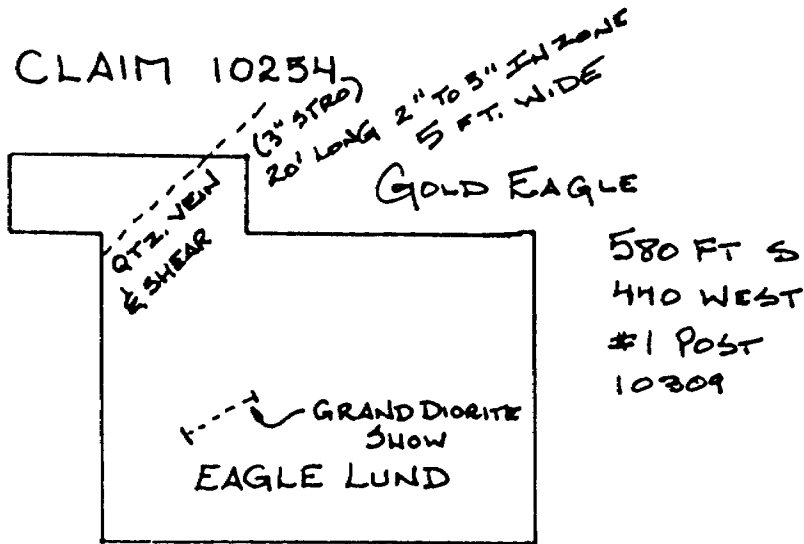

SHOWING ON EAGLE

J. BAKER, CONWEST EXPL. STATES TWO SHOWINGS ON PROPERTY. ADA HUDSON IN CHARGE. MOST RECENT SHOWING IS QUARTZ VEIN AT FOLLOWING LOCATION.

880 FT. W OF LOT POST 6 & 7 OF CONCESSION 1 & 2 @ 4200 FT S.

THIS CORRESPONDS TO MILEAGE 19 @ 1000 FT. OF ROAD.

V. C. NOTED IN THIS VEIN NOT IN GRAND DIORITE

SECOND SHOW ON PA 10313 RIGHT ON THE PA. ASSAYS 2300, 3.50
1000, 3.50

GALENO & COARSE PYRITE NOTED.

**DUPLICATE COPY
POOR QUALITY ORIGINAL
TO FOLLOW**

High Level Mine
1/2 mile
1/2 mile

1/2 mile

SHOWING ON EAGLE LAND

J. BAKER, CORNWELL COAL Co. has two showings on property known as the Hudson in large tract recent showing is given near the following location:

880 ft W of box post 617 of concession 1 x 2 x 4200 ft²
This concession is adjacent to
x 1000 ft of Road.

V.S. noted in this vein
at the given location.

Second showing on the 10313 right
on the Pa. Assays 27.7, 3.5
10.0, 3.5
galena & coarse pyrite noted.

~~10313~~

p.f. 10313

LOCATIONS OF EAGLE LAND

SNOW

CLAIM 10254

20 ft
50 ft
400 WBS
H. POST
10.09

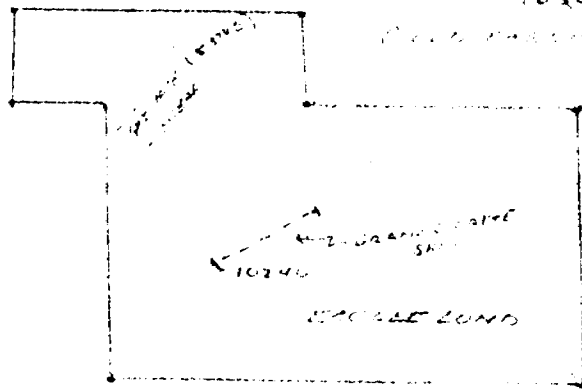

J.P. DEAN SHOW (PICKET 100 W)

SHOWING (1)

TYPICAL CROSS FRACTURED GRANIOR AS NEWLAND & MASHER CLAIMS

1-2" QTZ. SLAG. V.G. SOLID.

ALBIL ALIA ALONG FRACTURES WITH COARSE PYRITE.

QTZ. FRACTURE GOES AT LEAST 15 FT. LONG

ON NORTH SIDE PILLOW LAVAS STRIKE N 50°

? 55° APPROX FACE TO NORTH.

WIDTH OF DIKE ? TO NORTH PROBABLY

20 FT WIDE. STRIPPED 100 FT BY 15 FT.

TWO OTHER SHOWS; ONE 500 FT WEST NEXT 1200 FT WEST BOTH ?

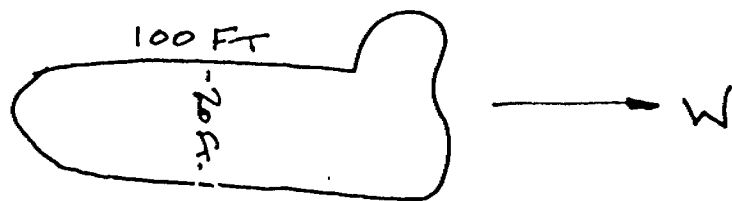

SHOWING ○ ALONG ? LINE AT 1 x 50 FT WEST, 410 FT W.

FROM SHOW. SMALL PATCH OF ? GRANODIORITE WITH COARSE CUBIC PYRITE. PIT IN SAND 6' x 4' . PANS COURSE

GOLD. 1 x 3 1200 FT W ALONG H 58 E PICKET LINE.

(SP ? LAVA AT 900 W. ON PICKET LINE)

TWO STRIPPED AREAS ARE AT 1200. ANOTHER 1300 TO 1350 EXPOSING GRANODIORITE + ?

SLAG, QTZ VEINS + COARSE PYRITE. STRIKE N 60 E. DIP 80-85° N OF DIKE.

DUPLICATE COPY
POOR QUALITY ORIGINAL
TO FOLLOW

DUPLICATE COPY
POOR QUALITY ORIGINAL
TO FOLLOW

SPRING SLOW (PLOTS 100 W)

Showing
Type was part of section
in Cleveland's ...
1-2 ft along ...
Calibrated ...
core ...
Core ...
The north side follows ...
strike N 50° ...
face to north.
width of strike ...
in the ... 20 ft ...
Strip 100 ft ...

Two other slow on 500
ft west next 1000 ft west
both gone down

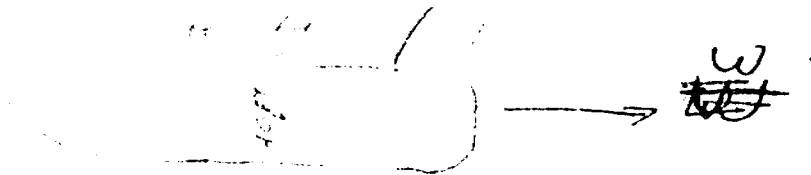

Showing (1) ...
185° ... 200 ft ...
...
...
131200 ...

(Explains slow at 900 ft ...)

Two ... 12 ...
... 1300 ...
granodiorite + ...
gl ...
Strike N 60° ...

GROSS FRACTURE

HERE NOT AS CLEAR. SEVERAL

ELONGATED STRINGS.

NORTH WALL MASSIVE DIORITE.

MAY BE TO ?

LONGITUDINAL PATTERN ? DEVELOPED SLAG WITH
OPPOSITE JOINTS.

HERE FIXED & PATTERN IS A STOCK WORK.

WIDTH IS FT.

APPEARS TO BE GRANITIZED REMNANT OF ? LAVA.

AT END OF THIS ZONE HAVE N 30E (13+50)

FRACTURES DEVELOPED 52° TO NORTH.

STRINGERS ALL DIE OUT AT WALL AGAIN.

SUGGEST THAT THE WEST DIPPING DRAG FRACTURES
CARRY THE PYRITE TO OTHER BARRIER.

AT 00 ON EAST END OF ? LINE ? 100E OF #1
SHOWING IS CROSS TRENCH EXPOSING 45' GRANODIOR.

**DUPLICATE COPY
POOR QUALITY ORIGINAL
TO FOLLOW**

of date. Class building public
Here not as other school buildings
shall with museum building
3 ft. down to basement
Single door public use entrance
along with open part
in this case will have
two of that and the
part in a state road
width 15 ft
Appears to be open to ground of
glaciated land
Ground line from line 42.5 (B+50)
feature line of 42.5 ft

Along all the way it would
be fine.

Suggestion that the road
be made as follows: all
the points & lines shown

11 50 on east end of
paved line as 100 E of
42.5 ft on road
1/2 way 45' of gravel.

KAGLELUND MINES

SAMPLES RECEIVED

		<u>AU.</u> <u>GE/TON</u>	<u>AU. \$38.00</u> <u>PER TON</u>	<u>AU. \$38.50</u> <u>PER TON</u>
<u>SAMPLE NO. 1.</u>	Sheared greenstone - odd ribbon quartz, fairly well mineralized pyrite.	0.20	7.00	7.70
<u>SAMPLE NO. 2.</u>	white fractured quartz bands dark schist, sparse fine pyrite.	0.01		
<u>SAMPLE NO. 3.</u>	Quartz - fractured, some coarse and fine pyrite. Tourmaline.	0.05	1.75	1.92
<u>SAMPLE NO. 4.</u>	Quartz and schist, pyrite (coarse) - quartz glossy.	0.30	10.50	11.55
<u>SAMPLE NO. 5.</u>	Sheared schisted greenstone, some quartz and quartz ribbons sugary type - coarse and fine pyrite.	0.60	21.00	23.10
<u>SAMPLE NO. 6.</u>	Sheared schisted greenstone, some quartz and quartz ribbons sugary type - coarse and fine pyrite.	0.01		

H. BERRY
- SAMPLES.

1	1	1	1
2	2	2	2
3	3	3	3
4	4	4	4
5	5	5	5
6	6	6	6
7	7	7	7
8	8	8	8
9	9	9	9
10	10	10	10
11	11	11	11
12	12	12	12
13	13	13	13
14	14	14	14
15	15	15	15
16	16	16	16
17	17	17	17
18	18	18	18
19	19	19	19
20	20	20	20
21	21	21	21
22	22	22	22
23	23	23	23
24	24	24	24
25	25	25	25
26	26	26	26
27	27	27	27
28	28	28	28
29	29	29	29
30	30	30	30
31	31	31	31
32	32	32	32
33	33	33	33
34	34	34	34
35	35	35	35
36	36	36	36
37	37	37	37
38	38	38	38
39	39	39	39
40	40	40	40
41	41	41	41
42	42	42	42
43	43	43	43
44	44	44	44
45	45	45	45
46	46	46	46
47	47	47	47
48	48	48	48
49	49	49	49
50	50	50	50
51	51	51	51
52	52	52	52
53	53	53	53
54	54	54	54
55	55	55	55
56	56	56	56
57	57	57	57
58	58	58	58
59	59	59	59
60	60	60	60
61	61	61	61
62	62	62	62
63	63	63	63
64	64	64	64
65	65	65	65
66	66	66	66
67	67	67	67
68	68	68	68
69	69	69	69
70	70	70	70
71	71	71	71
72	72	72	72
73	73	73	73
74	74	74	74
75	75	75	75
76	76	76	76
77	77	77	77
78	78	78	78
79	79	79	79
80	80	80	80
81	81	81	81
82	82	82	82
83	83	83	83
84	84	84	84
85	85	85	85
86	86	86	86
87	87	87	87
88	88	88	88
89	89	89	89
90	90	90	90
91	91	91	91
92	92	92	92
93	93	93	93
94	94	94	94
95	95	95	95
96	96	96	96
97	97	97	97
98	98	98	98
99	99	99	99
100	100	100	100

SEE ACCOMPANYING

MAP(S) IDENTIFIED AS

52 F / 16 NE - 0035, #1-3

LOCATED IN THE MAP
CHANNEL IN THE FOLLOWING
SEQUENCE (X)

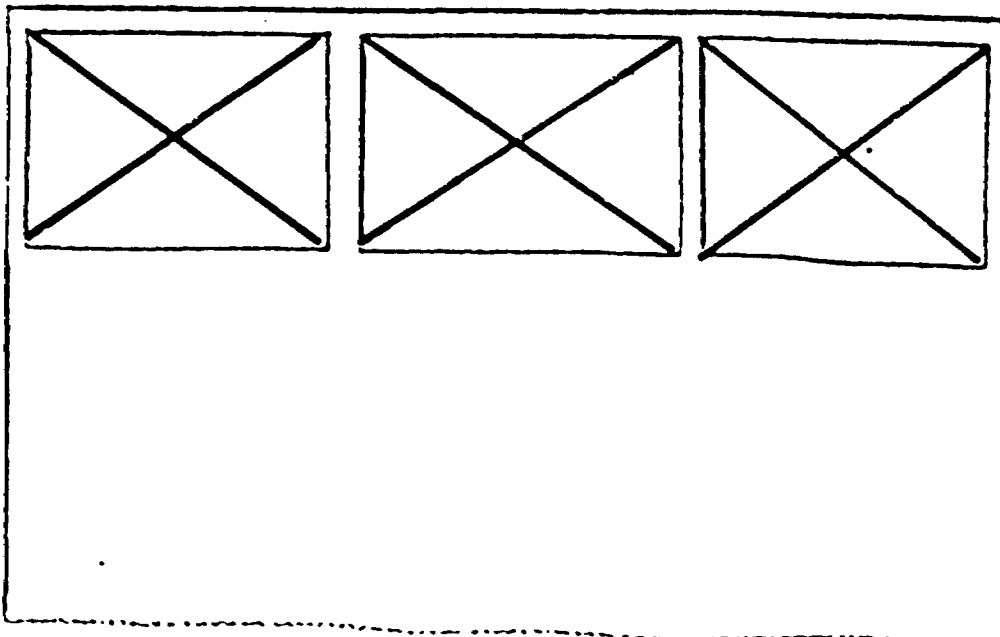

FOR ADDITIONAL
INFORMATION

SEE MAPS:

52 F / 16 NE - 0035 # 4-8

KEY MAP EAGLE LUND AND GOLDEAGLE GROUPS

Pickereel Twp. Ont
Scale 1 in = 1/2 mi

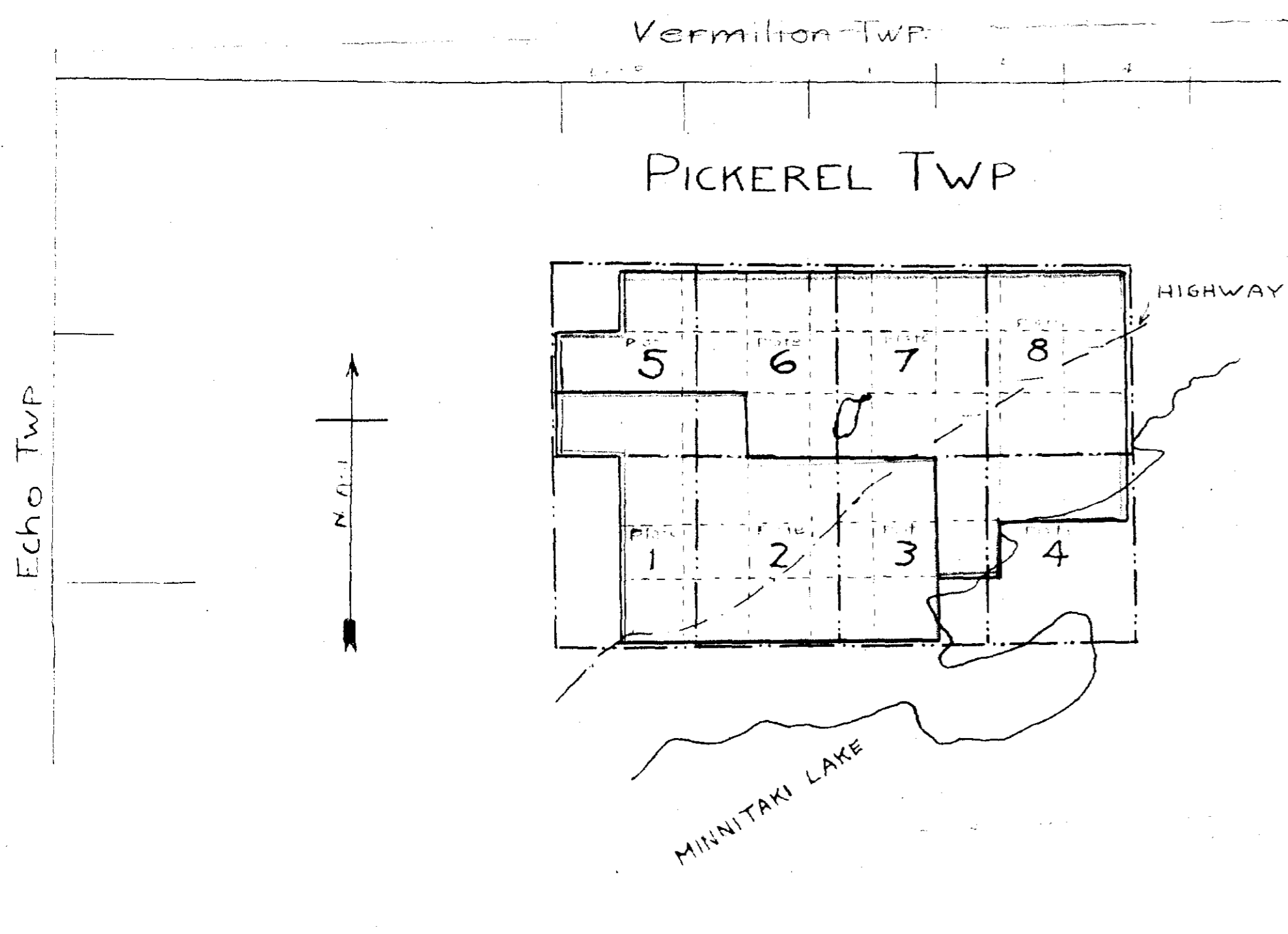

- 1 ■ Granodiorite
- 2 ■ Porphyry - Quartz + Feldspar
- 3 ■ Basic to Intermediate Lavas
Pillow Lavas (PL) Andesite (An)
Basalt (Bas) Sheared (Sh)
- 4 ■ Pyroclastics Tuffs Agglomerates
Commonly recrystallized "Leopard Rock" L.R.
- 5 ■ Acid Lavas
- 6 ■ Carbonatized Zones
- Picket Lines
- Outcrops
- Trenches
- Cedar + Spruce Swamps
- Geological Boundary - Defined
- Geological Boundary - Approx
- Geological Boundary - Assumed
- Dip and Strike Schistosity
- MA Magnetic Attraction
- YG Visible Gold

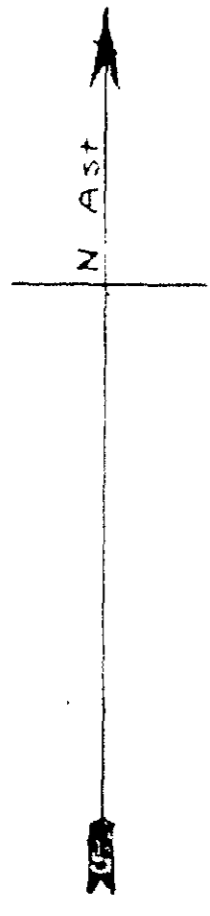

EAGLE LUND GOLD MINES LTD
 GOLDEAGLE MINES LTD
 Pickereel Twp. Ont
 Scale 1" = 100'
 PLATE No 1

G. S. Hudson Aug 28/50



20

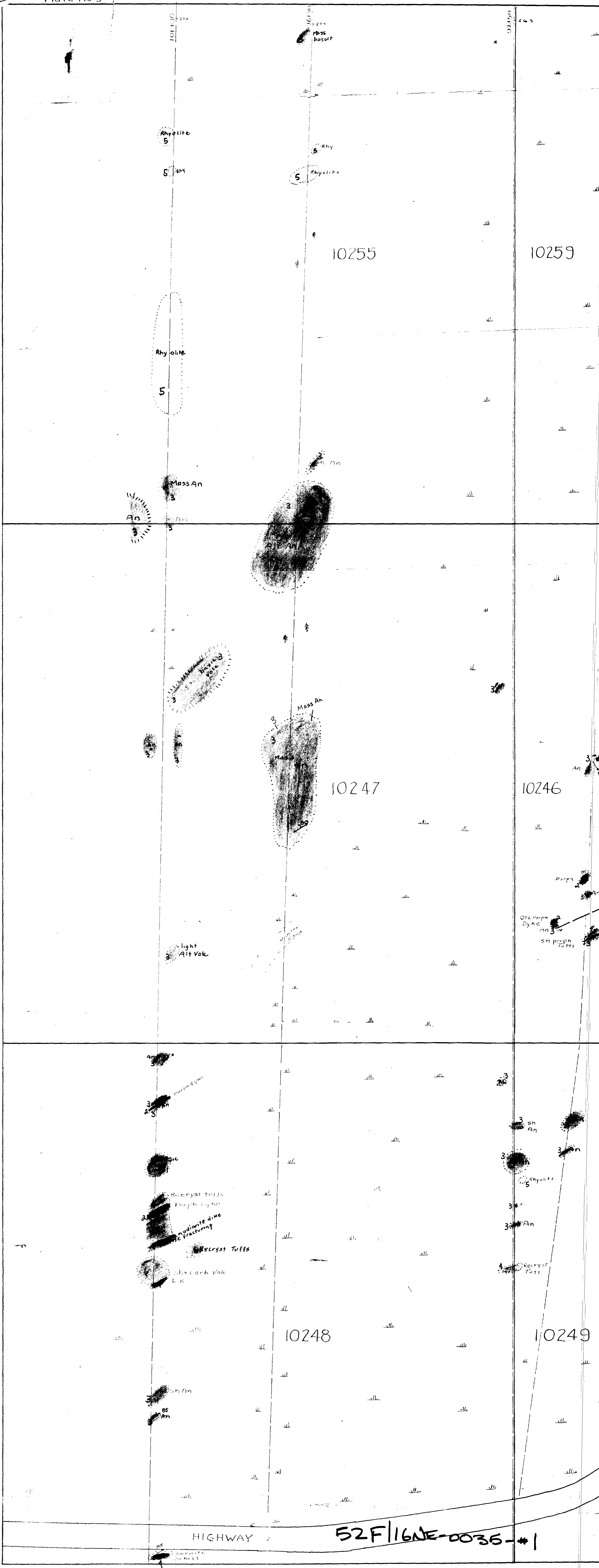

52F/16NE-0036-#1

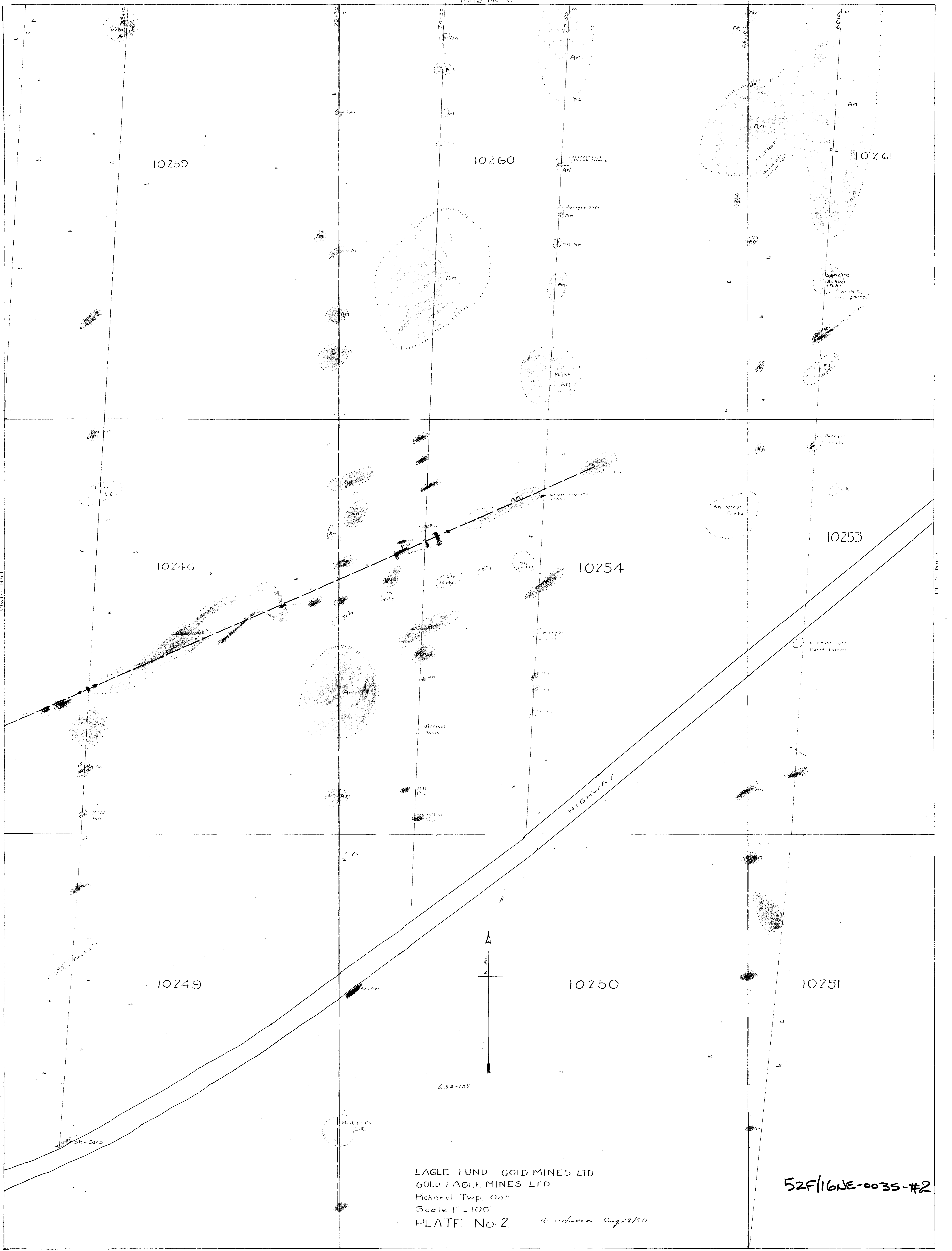

EAGLE LUND GOLD MINES LTD
 GOLD EAGLE MINES LTD
 Pickering Twp, Ont
 Scale 1" = 100'
 PLATE No. 2
 G.S. Hoover Aug 28/50

52F/16NE-0035-#2

10261

10262

10307

10253

10263

10315

10251

10252

HIGHWAY

HIGHWAY

MINNITAKI LAKE

EAGLE LUND GOLD MINES LTD

GOLD EAGLE MINES LTD

Pickering Twp. Ont

Scale 1" = 100'

PLATE No. 3

52F/16NE-0035-#3

A.S. Hudson Aug 28/50

63A-105

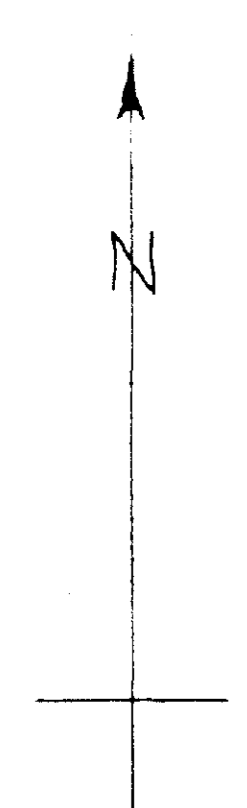

Flow Top
Asst
L.R.

Basic
Lavas

Sh An
Little
Gtz.

Mass
An

Sh An
strong

Sh An

Yes

Flow Top
Asst

Recryst
Vale

Sh An

Sh An

An

Sh An

An

An

Sh Porph

Recryst
Vale

Coarse
Leopards Rock

Recryst
Tuffs

Coarse
An

An

An

Sh Porph

Sh line
An

Very coarse
Porph

Recryst P.L.
with Porph texture

Tuffs + Agg.

Finer L.R.

Light
Porph

Coarse
Light Rph

Plate No. 4

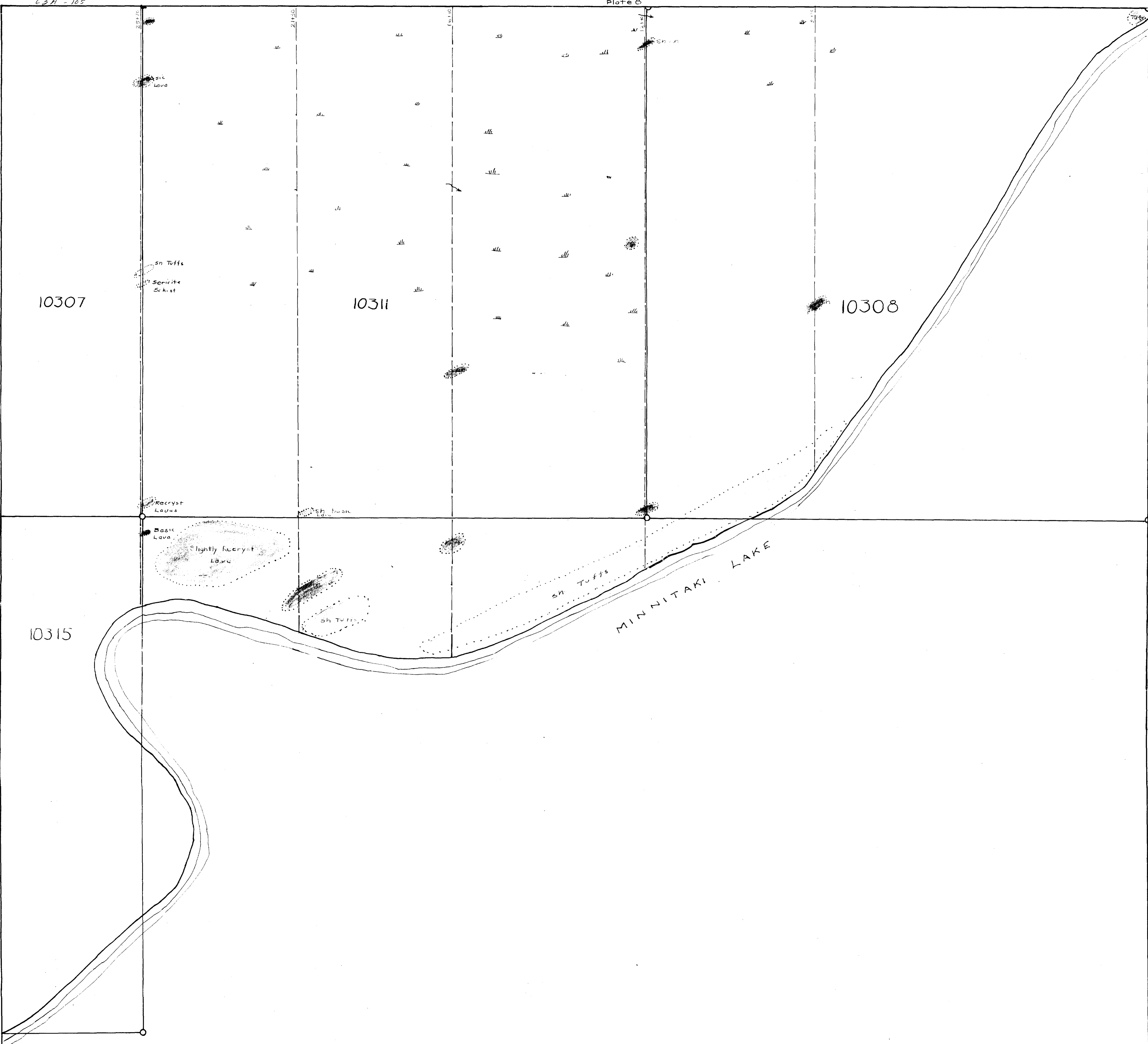

EAGLE LUND GOLD MINES LTD.
 GOLD EAGLE MINES LTD.
 Pickering Twp. Ont.
 Scale 1" = 100'
 PLATE No. 4

A.S. Schumacher May 28/50

52F/16NE-0035-#4



Sand
Plains

10312

10310

10313

10314

10309

Approximate edge of sand plains

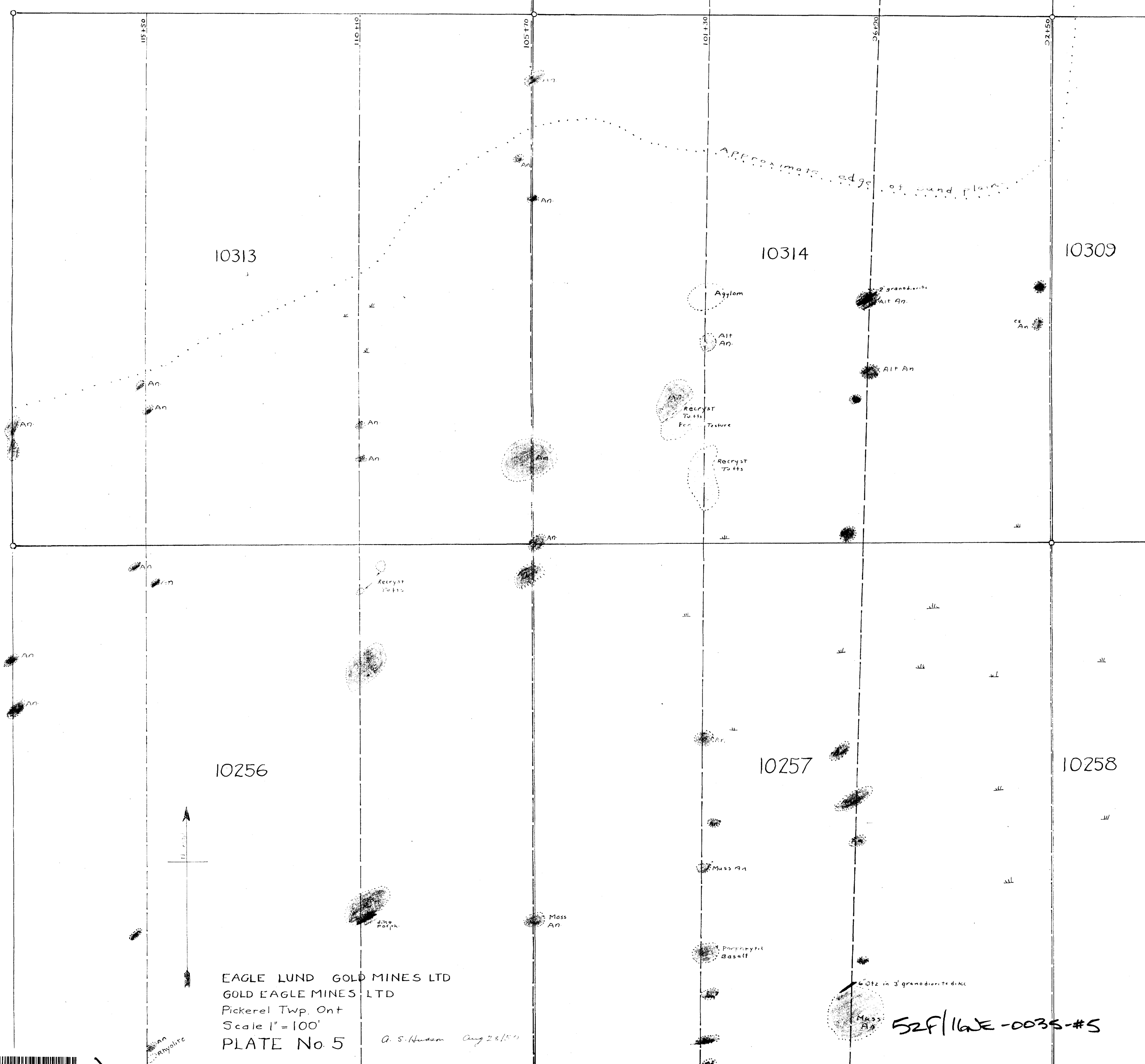

10256

10257

10258

EAGLE LUND GOLD MINES LTD
 GOLD EAGLE MINES LTD
 Pickering Twp. Ont
 Scale 1" = 100'
 PLATE No 5

A. S. Hudson Aug 28, 1959

52F/16E-0035-#5



10310

10275

10276

10309

10282

10281

10258

10283

10280

EAGLE LUND GOLD MINES LTD
 GOLD EAGLE MINES LTD
 Pickering Twp. Ont
 Scale 1"=100
 PLATE No 6
 G. S. Hudson
 Sept 5/50

SRF/16NE-0035-#6

Plate No 5

Plate No 7



10276

10277

10270

10281

10278

10271

SMALL
LANE

10280

10279

10274

HIGHWAY

5RF/16NE-0035-#7

EAGLE LUND GOLD MINES LTD
GOLD EAGLE MINES LTD
Pickard Twp. Ont
Scale 1" = 100'
PLATE No. 7

A.S. Hume
Aug 1977



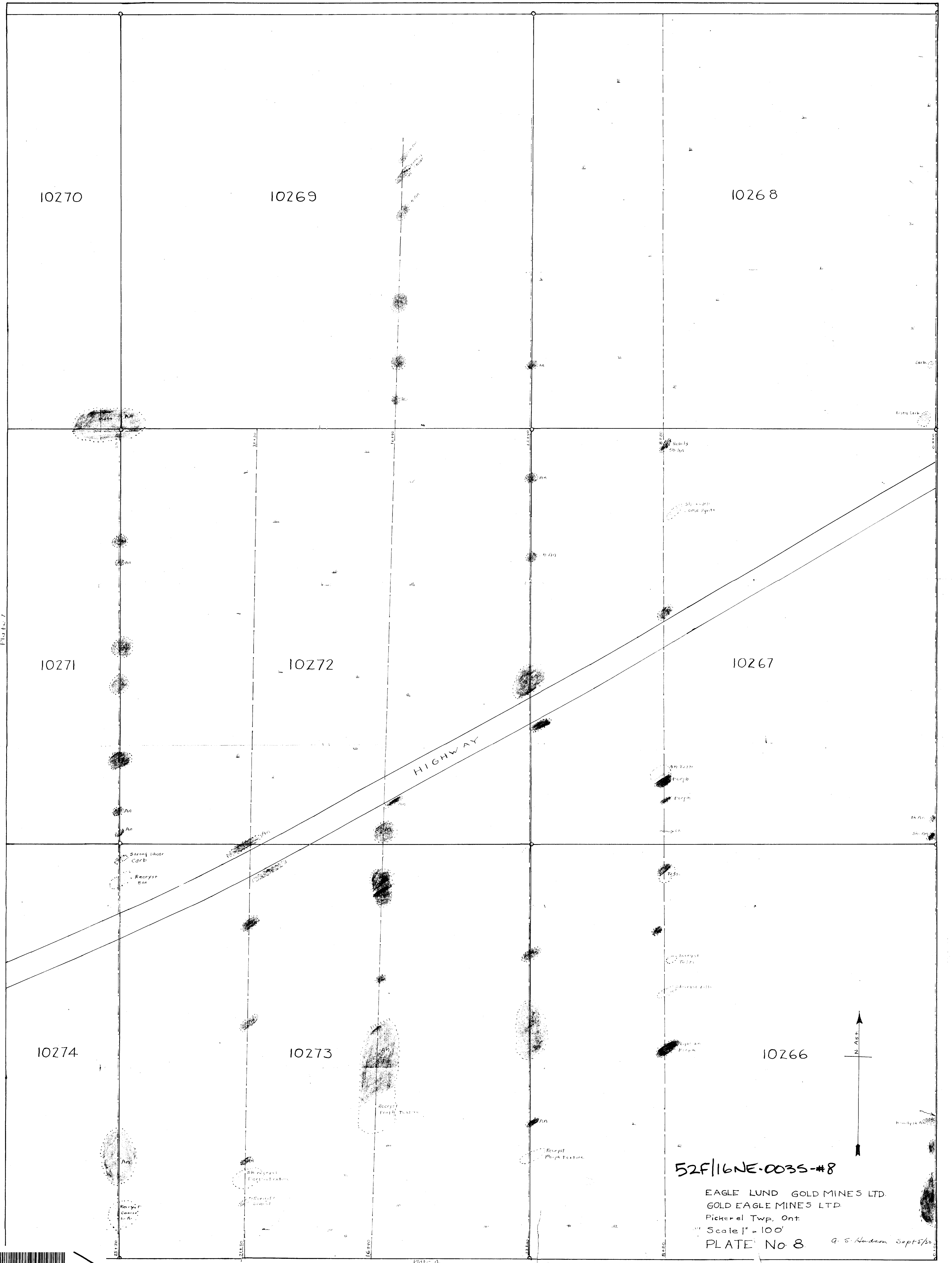

10270

10269

10268

10271

10272

10267

10274

10273

10266

HIGHWAY

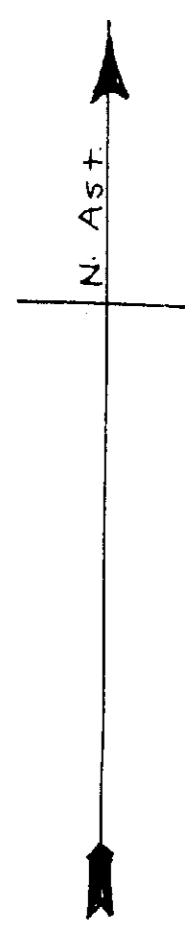

52F/16NE-0035-#8

EAGLE LUND GOLD MINES LTD.

GOLD EAGLE MINES LTD.

Pickering Twp. Ont.

Scale 1" = 100'

PLATE No 8

G. S. Hudson Sept 5/80

