



52F16NE8324 34 PICKEREL

010

DIAMOND DRILLING

Area: Kabik Lake

Report No: 34

WORK PERFORMED FOR: Tarbush Lode Mining Limited

RECORDED HOLDER: SAME AS ABOVE [x]

: OTHER []

<u>CLAIM NO.</u>	<u>HOLE NO.</u>	<u>FOOTAGE</u>	<u>DATE</u>	<u>NOTE</u>
PA 850188	TB85-2	218'	Oct/85	(1)
	TB85-3	339'	Oct/85	(1)
	TB85-4	247'	Oct/85	(1)
	TB85-6	218'	Nov/85	(1)
	TB85-7	368'	Nov/85	(1)
TOTAL	5 DH	1390'		

NOTES: (1) #86-14

PATRICIA MINING DIV.
RECEIVED
 JAN 13 1986
 P.M.
 7 8 9 10 11 12 1 2 3 4 5

CLAIM 850188

CORE STORAGE
 EAGLELUND DRILLING

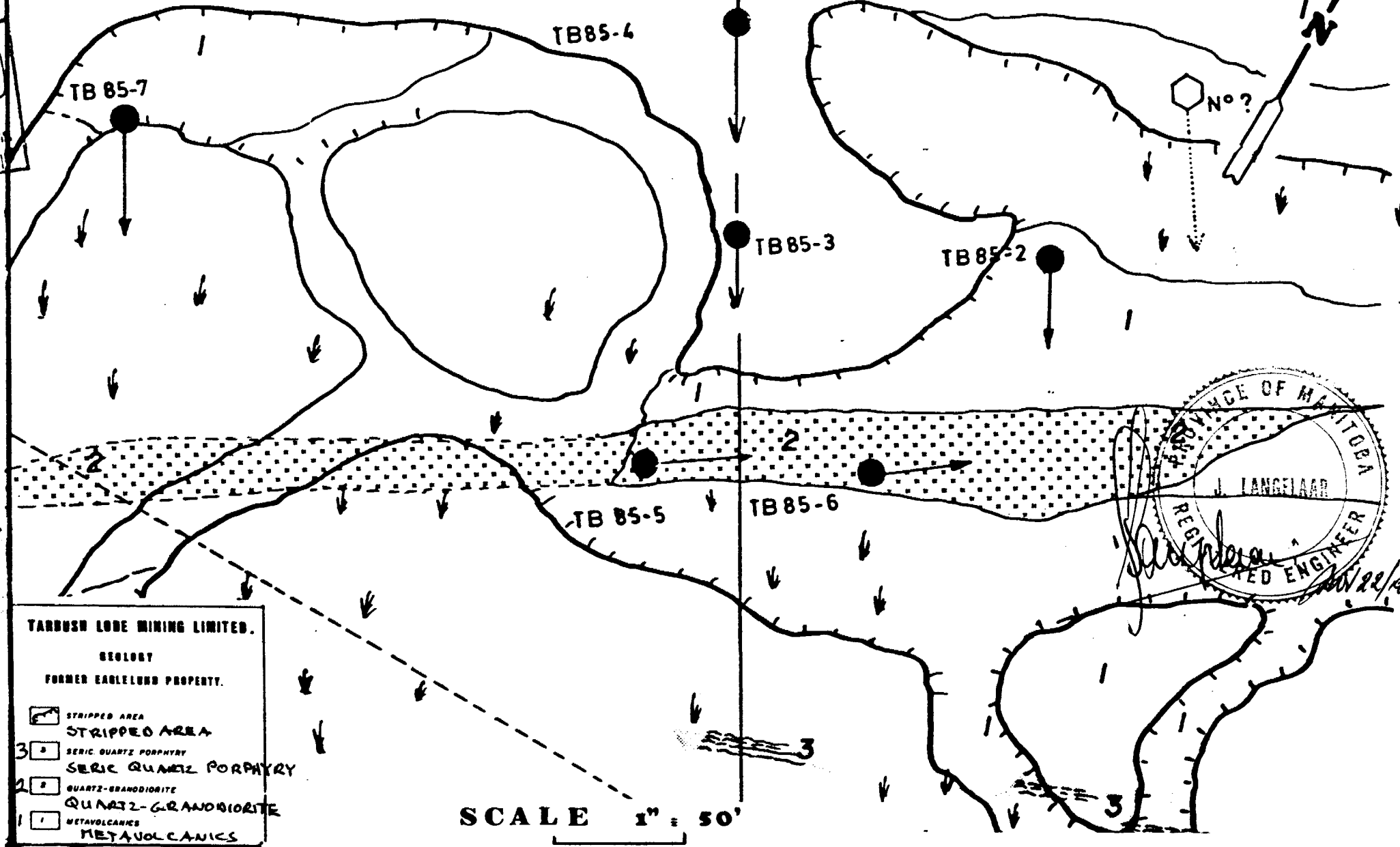

TARDUSH LOBE MINING LIMITED.
 GEOLOGY
 FORMER EAGLELUND PROPERTY.

- 3 [Stippled Box] STRIPPED AREA
- 3 [Box with '3'] SERIC QUARTZ PORPHYRY
- 2 [Box with '2'] QUARTZ-GRANODIORITE
- 1 [Box with '1'] METAVOLCANICS

PROVINCE OF MANITOBA
 J. LANGELAAR
 REGISTERED ENGINEER
 1/22/88

PATRICIA M. DIV.
RECEIVED
 JAN 13 1986
 P.M.
 7:00/10/11/12/1/2/8/15/16

CLAIM 850188

CORE STORAGE
 EAGLELUND DRILLING

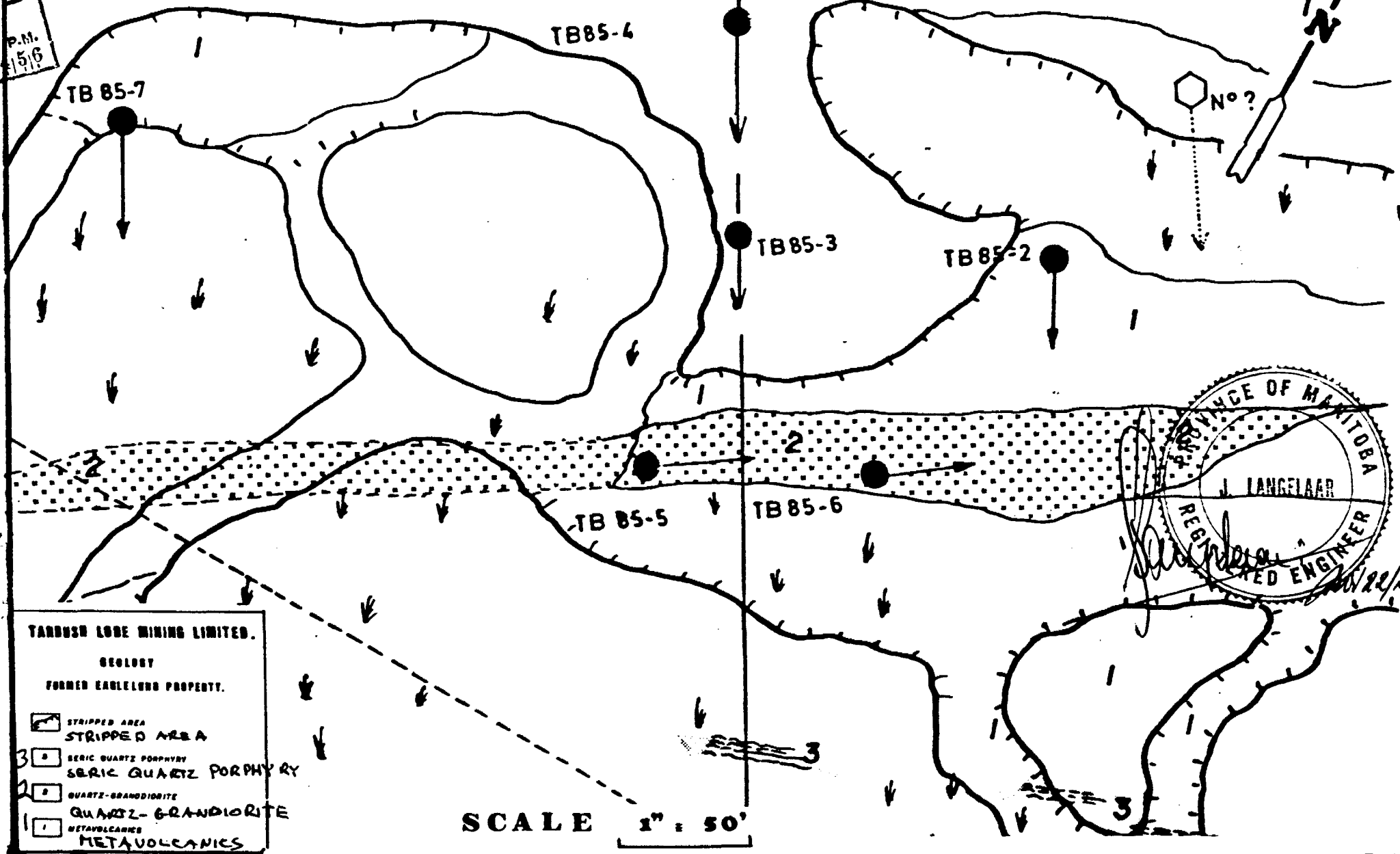

TARDUS LOBE MINING LIMITED.
 GEOLOGY
 FORMER EAGLELUND PROPERTY.

- 3 [Pattern] STRIPPED AREA
- 2 [Pattern] SERIC QUARTZ PORPHYRY
- 1 [Pattern] QUARTZ-GRANODIORITE
- [Pattern] METAVOLCANICS

SCALE 1" = 50'

PATRICIA MINING DIV.
RECEIVED
 JAN 13 1985
 P.M.
 7 10 9 10 11 12 1 2 3 4 5 6 7 8 9 10 11 12

CLAIM 850188

CORE STORAGE
 EAGLELUND DRILLING

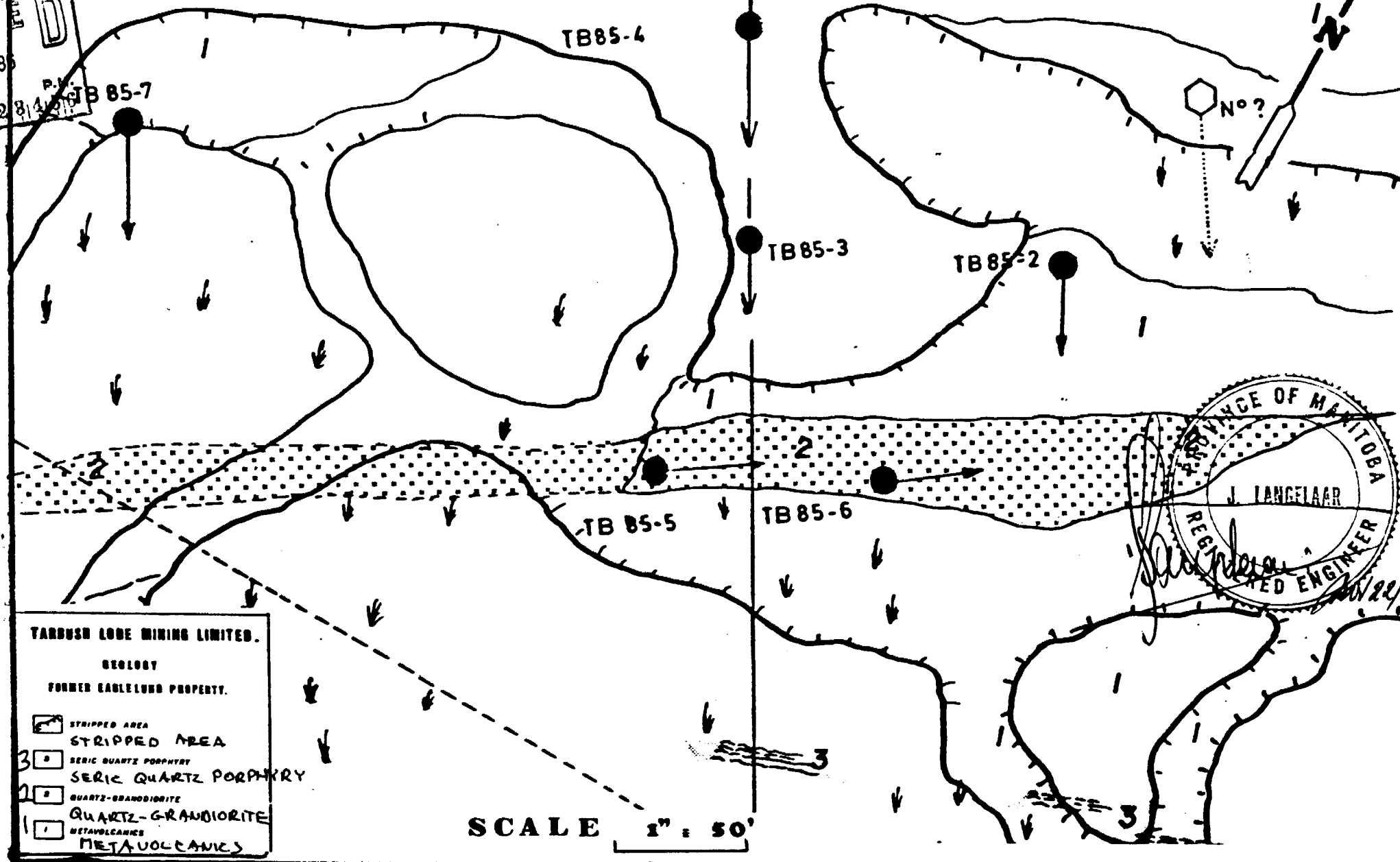

TARDUSH LOBE MINING LIMITED.
 GEOLOGY
 FORMER EAGLELUND PROPERTY.

- 3 [Dotted Pattern] SERIC QUARTZ PORPHYRY
- 2 [Dotted Pattern] QUARTZ-SCHIST
- 1 [Dotted Pattern] QUARTZ-GRANOBIORITE
- [Dotted Pattern] METAVOLCANICS

SCALE 1" = 50'

PROVINCE OF MANITOBA
 J. LANGELAAR
 REGISTERED ENGINEER
 22/85

PATRICIA MINING DIV.
RECEIVED
 JAN 13 1986
 P.M.
 A.M. 7 8 9 10 11 12 1 2 3 4 5 6

CLAIM 850188

CORE STORAGE
 EAGLELUND DRILLING

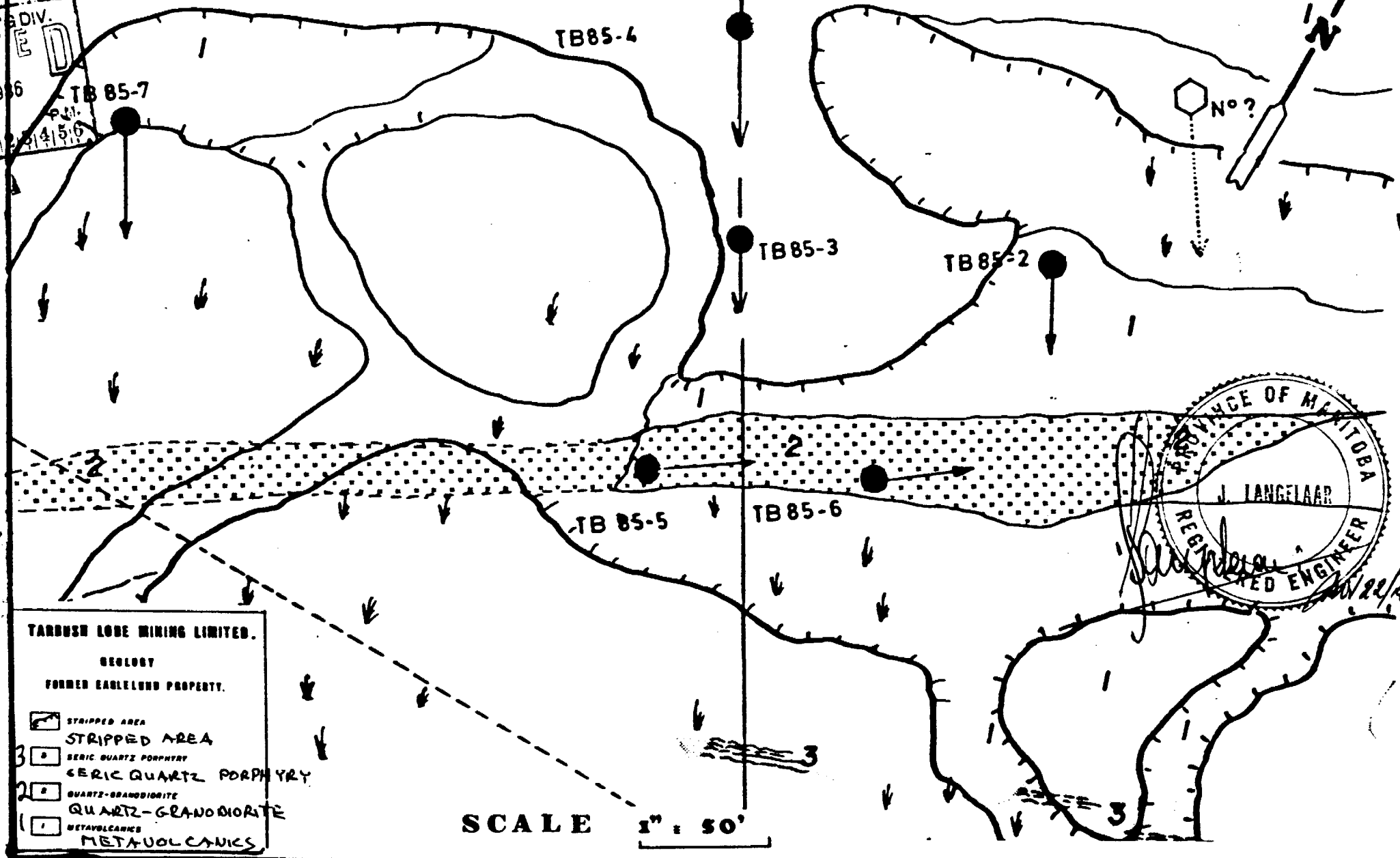

TARDUSH LOBE MINING LIMITED.
 GEOLOGY
 FORMER EAGLELUND PROPERTY.

- 3 [Dotted Pattern] STRIPPED AREA
- 2 [Dotted Pattern] SERIC QUARTZ PORPHYRY
- 2 [Dotted Pattern] SERIC QUARTZ PORPHYRY
- 2 [Dotted Pattern] QUARTZ-GRANODIORITE
- 1 [Dotted Pattern] QUARTZ-GRANODIORITE
- 1 [Dotted Pattern] METAVOLCANICS

PROVINCE OF MANITOBA
 J. LANGELAAR
 REGISTERED ENGINEER
 22/88

DIP TESTS ON PAGE ... NONE

PROPERTY <u>Tarbush - Eaglelund portion</u>	CLAIM NO. <u>850188</u>	BEARING <u>150° mag</u>	LAT: <u>not grid</u>	LOCATION OF D. DRILL HOLE IN RELATION TO NEAREST CLAIM POST: <u>440' west and 260' north of post</u>	HOLE NO. <u>TB 85-2</u>
DAY STARTED <u>Oct 13/'85</u> DAY COMPL. <u>Oct 18,'85</u>	J.V. NO. <u>n.a.</u>	ANGLE <u>45°</u>	DEP: <u>related</u>	CLAIM POST: <u>440' west and 260' north of post</u>	TOTAL DEPTH <u>218'</u>
LOGGED BY <u>J. Langelaar</u>	GRID NO. <u>n.a.</u>	NTS <u>52F16</u>	ELEV: <u>?</u>	No 1 - 850188	PAGE NO. <u>1</u>

FOOTAGE		Rock Classification	Other Features - Veins, Fractures, Foliation, etc.	MINERALIZATION		ASSAY DATA						oz/ton Au	oz/ton Ag	Avg
From	To			Type	%	Sample	Width	% Ni	% Cu	% Zn	% Fe			
		No casing;	collared in bedrock after	powerstripping.										
		SUMMARY:	71.5 - 104.0 Finegrained	Granodiorite with numerous quartzveins and veinlets										
			This unit is contained within mafic metavolcanics ranging from flows to tuffaceous horizons. On either side of the granodiorite, several feet of transitional material - due to contact metamorphism.											
2.0	4.4	Tuffaceous unit												
4.4.	8.5	quartz sericite schist; contains 4" of intermed - mafic volcanics; this interval resembles somewhat the (quartz porphyry) sericite schist approx. 300 feet south of collar of this hole on surface.												
		checksample:	4.4 - 6.4	Py	2-3%	A 3716								have
8.5	10.0	Tuffaceous sed, coreangles @ 45°		Py	2-3%	A 3717								have
10.0	69.5	Mix of crystal tuff and minor mafic flow units - andesitic to basaltic; contains small stringlets of carbonates and abundance of finely dissem. magnetite; coreangles @ 20' @ 50° and 44' @ 45°.												
		Contact with next granodiorite gradational over approx. 4'.												

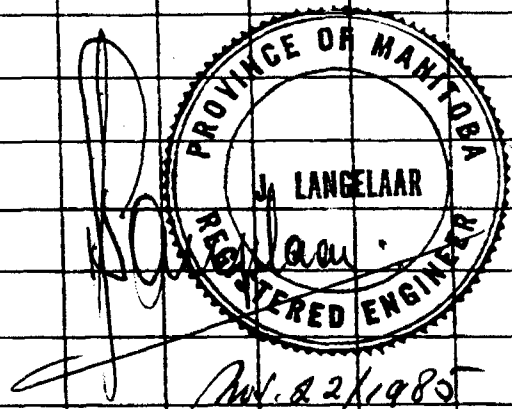

PROPERTY <u>Tarbush - Eaglelund portion</u>	CLAIM NO. <u>850188</u>	BEARING <u>150° mag</u>	LAT: <u>not grid</u>	LOCATION OF D. DRILL HOLE IN RELATION TO NEAREST CLAIM POST: <u>440' west and 260' north of post</u>	HOLE NO. <u>TB 85-2</u>
DAY STARTED <u>Oct 13/'85</u> DAY COMPL. <u>Oct 18, '85</u>	J.V. NO. <u>n.a.</u>	ANGLE <u>45°</u>	DEP: <u>related</u>		TOTAL DEPTH <u>218'</u>
LOGGED BY <u>J. Langelaar</u>	GRID NO. <u>n.a.</u>	NTS <u>52F16</u>	ELEV: <u>?</u>	No 1 - 850188	PAGE NO. <u>3</u>

FOOTAGE		Rock Classification	Other Features - Veins, Fractures, Foliation, etc.	MINERALIZATION		ASSAY DATA									
From	To			Type	%	Sample	Width	% Ni	% Cu	% Zn	% Fe	% Pb	oz/ton Au	oz/ton Ag	Avg
102.0	104.0	Finegrained quartzdiorite; odd Po		Py	2%	A3733									
104.0	107.3	As above but transitional into following unit of metavolcs; 3" quartzvein @ 104.0				A3734							.01		
107.3	121.3	Transitional material into metavolcanics. Freedom. tuffaceous but contains silicified sections which may be granodiorite offshoots; minor quartzveinlets and carbon. present.													
		checksample: 118 - 120				A3735									
121.3	218.0	Freedom mafic metavolcanics - andesites to basalts with abundant carbonate stringers and veinlets; may contain minor tuffaceous interbeds and occasional stringer of Py; some sections are (very) magnetic.													
		checksample: 188 - 191.0		abund. carbs	1%Py	A3736									
		Coreangles at 213.0 (tuffs) @ 58°													
		End of hole.													

PATRICIA MIN. DIV.
RECEIVED
 JAN 13 1986
 A.M. 7 8 9 10 11 12 P.M. 1 2 3 4 5 6

PROPERTY <u>TARBUSH - Eaglelund portion</u>	CLAIM NO. <u>850188</u>	BEARING <u>150° mag</u>	LAT: <u>on picket-line, 120'</u>	LOCATION OF D. DRILL HOLE IN RELATION TO NEAREST CLAIM POST: <u>555' west of and 205' north of post #1: 850188</u>	HOLE NO. <u>TB 85-3</u>
DAY STARTED <u>Oct 18 '85</u> DAY COMPLETION <u>Oct 21/'85</u>	J.V. NO. <u>n.a.</u>	ANGLE <u>45°</u>	DEP: <u>west of</u>	TOTAL DEPTH <u>339'</u>	
LOGGED BY <u>J. Langelaar</u>	GRID NO. <u>n.a.</u>	NTS <u>52F16</u>	ELEV: <u>TB 85-2</u>	PAGE NO. <u>1</u>	

FOOTAGE		Rock Classification	Other Features - Veins, Fractures, Foliation, etc.	MINERALIZATION		ASSAY DATA								
From	To			Type	%	Sample	Width	% Ni	% Cu	% Zn	% Fe	% Pb	oz/ton Au	oz/ton Ag
		SUMMARY:												
		86.3 - 127.0	Finegrained granodiorite with two generations of quartz: i.e. 1) white generally wide quartz and 2) grey quartz in minute veinlets and "hairline" cracks.											
		267.0-317.4	Sericite quartz porphyry - moderately - weakly sheared											
		319.7-335.4	Coarse grained quartz porphyry, minor sericite.											
0	14.0	Casing												
14.0	25.5	Var. metavolcs; predominantly tuffs; odd 1/2" to 1" quartzcarb. veins crosscutting formation @ 56°-78°												
25.5	27.1	Finegrained metasediments, somewhat sericitic, Coreangles @ 51°												
27.1	56.0	Predominantly basic flow material: andesitic - basaltic with carb stringers and veinlets. Locally magnetic. May contain tuffaceous interbeds; minor specks of pyrite: less than 1%; locally chloritization. From 41.0 - 44.9 mix of tuffs & seds; odd Py												

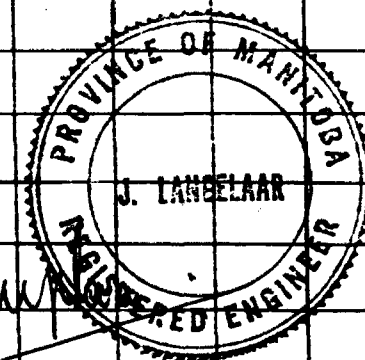

Jan. 22, 1985

DIP TESTS ON PAGE

PROPERTY <u>TARBUSH - Eaglelund portion</u>	CLAIM NO. <u>850188</u>	BEARING <u>150° mag</u>	LAT: <u>on picket-</u> <u>line, 120'</u>	LOCATION OF D. DRILL HOLE IN RELATION TO NEAREST CLAIM POST: <u>555' west of</u> <u>and 205' north of</u>	HOLE NO. <u>TB 85-3</u>
DAY STARTED <u>Oct 18 '85</u> DAY COMPLET <u>Oct 21/'85</u>	J.V. NO. <u>n.a.</u>	ANGLE <u>45°</u>	DEP: <u>west of</u>	TOTAL DEPTH <u>339'</u>	
LOGGED BY <u>J. Langelaar</u>	GRID NO. <u>n.a.</u>	NTS <u>52F16</u>	ELEV: <u>TB 85-2</u>	post #1: <u>850188</u>	PAGE NO. <u>6</u>

FOOTAGE		Rock Classification	Other Features - Veins, Fractures, Foliation, etc.	MINERALIZATION		ASSAY DATA								
From	To			Type	%	Sample	Width	% Ni	% Cu	% Zn	% Fe	% Pb	oz/ton Au	oz/ton Ag
contin.	335.4		sheared over first 6 feet; odd py and odd tourmaline											
		checksample:	326.0 - 329.0			A3757							low	
335.4	339.0		Variable metavolcanics - andesitic - basaltic flows.											
			End of hole.											
			NO DIP TESTS.											
			CASING LEFT IN HOLE - 14 feet.											
			Hole makes water!											

PATRICIA M. DIV.
RECEIVED
 JAN 13 1986
 A.M. 7, 8, 9, 10, 11, 12, 1, 2, 3, 4, 5, 6 P.M.

PATRICIA M. DIV.
RECEIVED
 JAN 13 1986
 A.M.
 2 3 4 5 6 7 8 9 10 11 12 1 2 3 4 5 6 7 8 9 10 11 12

CLAIM 850188

CORE STORAGE
 EAGLELUND DRILLING

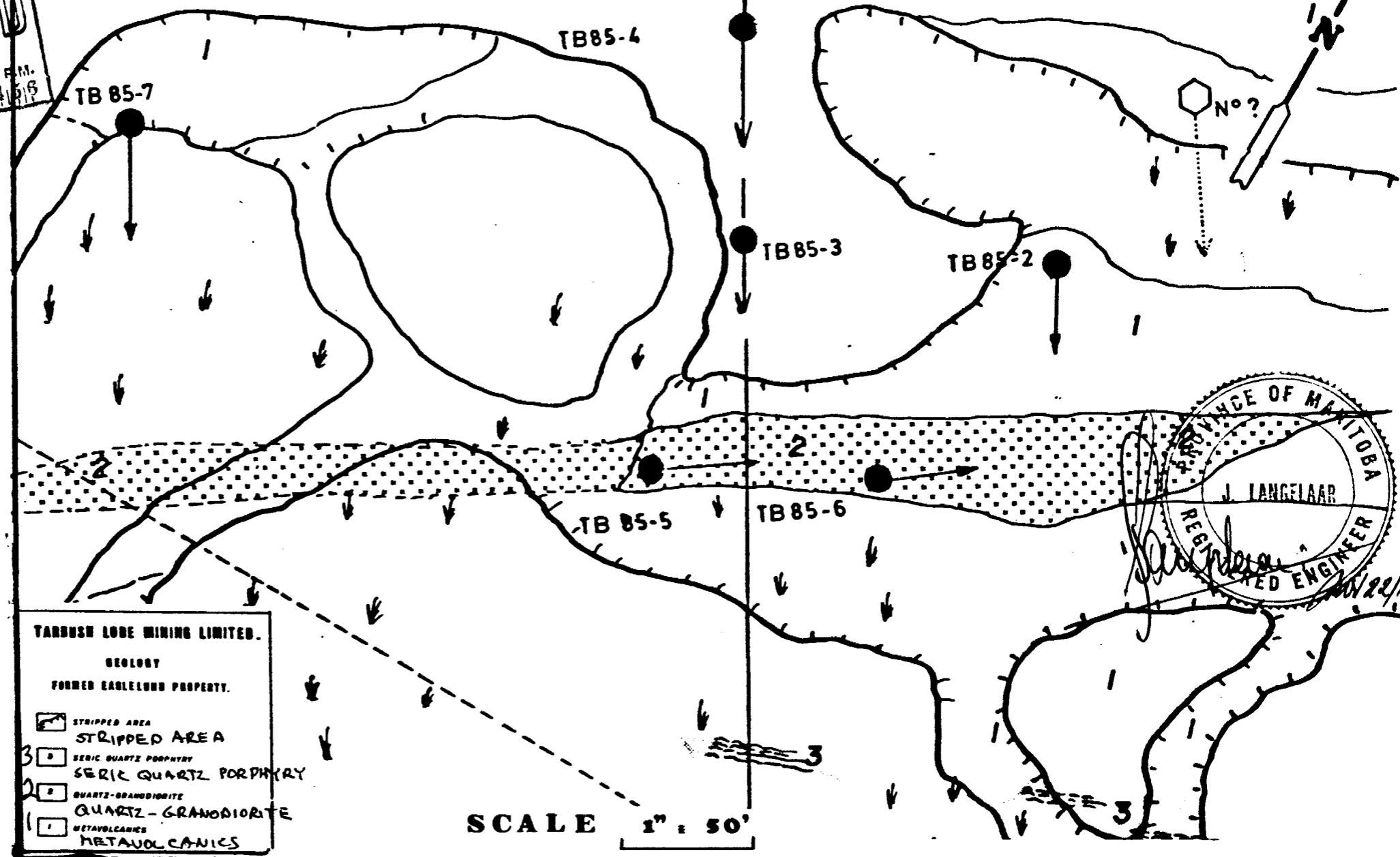

YARDUSH LOBE MINING LIMITED.
 GEOLOGY
 FORMER EAGLELUND PROPERTY.

- 3 [Dotted Pattern] SERIC QUARTZ PORPHYRY
- 2 [Horizontal Lines] QUARTZ-GRANODIORITE
- 1 [Vertical Lines] METAVOLCANICS

[Dashed Line] STRIPPED AREA

SCALE 1" = 50'

PROVINCE OF MANITOBA
 J. LANGELAAR
 REGISTERED ENGINEER
 22/86

DIP TESTS ..NONE.....

PROPERTY <u>TARBUSH - Eaglelund portion</u>	CLAIM NO. <u>850188</u>	BEARING <u>51 1/2° mag</u>	LAT: <u>see summary</u>	LOCATION OF D. DRILL HOLE IN RELATION TO NEAREST CLAIM POST: <u>155' north & 465' west of N°1 850-188</u>	HOLE NO. <u>TB85-6</u>
DAY STARTED <u>Nov 3/'85</u> DAY COMPL <u>Nov. 6/'85</u>	J.V. NO. <u>n.a.</u>	ANGLE <u>45°</u>	DEP: _____		TOTAL DEPTH <u>218'</u>
LOGGED BY <u>J. Langelear</u>	GRID NO. <u>n.a.</u>	NTS <u>52F16</u>	ELEV: _____		PAGE NO. <u>1</u>

FOOTAGE		Rock Classification	Other Features - Veins, Fractures, Foliation, etc.	MINERALIZATION		ASSAY DATA								
From	To			Type	%	Sample	Width	% Ni	% Cu	% Zn	% Fe	% Pb	oz/ton Au	oz/ton Ag
		SUMMARY: a) POSITION: this drillhole is located 92' east of TB85-5 and 12' south of same												
		b) Main Granodiorite occurs between 4' and about 103'; past 103' material becomes somewhat transitional into metavolcanics; at 169' the units encountered are metavolcs.												
		c) This hole has been drilled with the strike.												
0	4.0	Casing												
4.0	103.0	Variable granodiorite and quartzdiorite with multi quartzveins & veinlets; for details see descriptions following:												
4.0	6.0	Badly broken core; part of regolith.												
6.0	10.0	Finegrained granodiorite; several 1"-3" & 4" white quartzveins; Py in blebs (few) and minor dissemin.												
		odd Po overall				1-2%								
10.0	14.0	As above though less quartzvein mat.			Py	2%	A4118							Trace
14.0	15.0	As above; one inch solid Py crosscutting core				2%	A4119							.24
15.0	28.0	Fine- to mediumgrained granodiorite; somewhat brecciated in places, abundant white quartzveins, ranging from 1" to 7"; Po minor; fair amount of tourmaline; Py				2%								

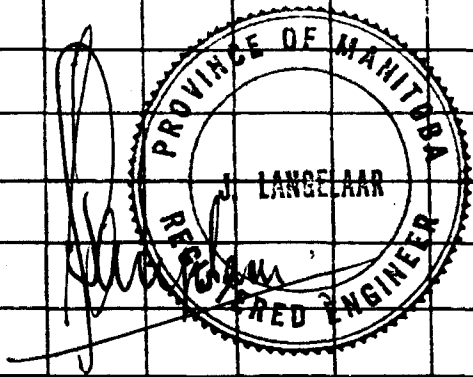

Nov 22, 1985

DIP TESTS ON PAGE

PROPERTY _____	CLAIM NO. _____	BEARING _____	LAT: _____	LOCATION OF D. DRILL HOLE IN RELATION TO NEAREST CLAIM POST:	HOLE NO. <u>TB85-6</u>
DAY STARTED _____ DAY COMPL. _____	J.V. NO. _____	ANGLE _____	DEP: _____		TOTAL DEPTH _____
LOGGED BY _____	GRID NO. _____	NTS _____	ELEV: _____		PAGE NO. <u>3</u>

FOOTAGE		Rock Classification	Other Features - Veins, Fractures, Foliation, etc.	MINERALIZATION		ASSAY DATA						oz/ton Au	oz/ton Ag	Avg				
From	To			Type	%	Sample	Width	% Ni	% Cu	% Zn	% Fe				% Pb			
contin'd	98.1	check samples:	78.0 - 80.0 two one inch q.v's, cubic and vuggy Py															
			86.0 - 88.0 brecciated 5' at start; 2 white 2" q.v's, minor tourmaline			A 4124												trace
98.1	103.0		Extremely finegrained granodiorite; texture is almost like rhyolite; minor 1" q.v's; odd Py in dissemin. contains some grey quartzveinlets.			A 4125												trace
103.0	± 169		Finegrained quartzdiorite - granodiorite; minor 1/2" white q.v's; odd grey q.veinlets; Py is less than 1% in scattered disseminations. This section may contain small assimilated greenstone intervals. Increase in quartzmaterial @ 148' over 5". Past 148 few 1 - 3" sections where Py is concentrated up to 2%															
± 169	218.0		Variable metavolcanics - some tuffs; first 4 - 5' may be transitional from the granodiorite. Odd quartzcarb veins and veinlets. Coreangles from 2° - 8°; odd scattered specks and bleb of Py															
			END OF HOLE.															

PATRICIA MINING DIV.
RECEIVED
 JAN 13 1986
 A.M. P.M.
 7:00 10:00 12:00 1:00 2:00 3:00

DIP TESTS ON PAGE ... No. 1

PROPERTY <u>TARBUSH - Eaglelund portion</u>	CLAIM NO. <u>850188</u>	BEARING <u>142° mag</u>	LAT: <u>see</u>	LOCATION OF D. DRILL HOLE IN RELATION TO NEAREST CLAIM POST: <u>125'</u> north & <u>775'</u> west of N°1 <u>850188</u>	HOLE NO. <u>TB 85-7</u>
DAY STARTED <u>Nov 10/1985</u> DAY COMPL. <u>Nov. 14 '85</u>	J.V. NO. <u>n.a.</u>	ANGLE <u>65°</u>	DEP: <u>summary</u>		TOTAL DEPTH <u>368'</u>
LOGGED BY <u>J. Langelaar</u>	GRID NO. <u>n.a.</u>	NTS <u>52F16</u>	ELEV: <u>-</u>		PAGE NO. <u>1</u>

FOOTAGE		Rock Classification	Other Features - Veins, Fractures, Foliation, etc.	MINERALIZATION		ASSAY DATA								
From	To			Type	%	Sample	Width	% Ni	% Cu	% Zn	% Fe	% Pb	oz/ton Au	oz/ton Ag
			DIPTTEST AT 328' - measured angle @ 59° corrected angle @ 52°											
		SUMMARY:												
		250.3 - 257.6	Questionable - transitional - granodiorite; rest of hole var. metavolcanics - pred. tuffs											
0	3.0		Badly broken core - regolith; var. tuffs.											
3.0	109.6		Variable metavolcanics; predominantly tuffaceous with minor interbedded sediments and flow material. Carb. veining present; odd speck of Py. Core angles at 27' @ 40° Broken core at 43' over 3" (maybe minor shear). Minor chlorite seamlets.											
109.6	114.4		Tuff - sedim. interval, carb veinlets, odd disseminations of Py; core angles @ 39°											
114.4	147.9		Predom. tuffaceous units; carb. veinlets present. Badly broken core at 137' over 6" (minor shear??) Generally distinctive core angles. Py less than 1%											
147.9	149.2		Sed.-tuffac. interval, light grey, odd Py											
149.2	± 211.6		Var. metavolcanics; predom. tuffaceous -X-tal tuff, odd lapilli.											

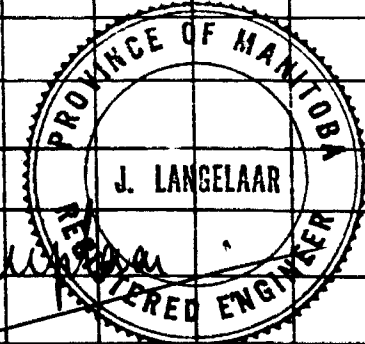
J. Langelaar

 Nov. 22, 1985

DIP TESTS ON PAGE

PROPERTY _____	CLAIM NO. _____	BEARING _____	LAT: _____	LOCATION OF D. DRILL HOLE IN RELATION TO NEAREST CLAIM POST:	HOLE NO. TB 85-7
DAY STARTED _____ DAY COMPL. _____	J.V. NO. _____	ANGLE _____	DEP: _____		TOTAL DEPTH _____
LOGGED BY _____	GRID NO. _____	NTS _____	ELEV: _____		PAGE NO. 2

FOOTAGE		Rock Classification	Other Features - Veins, Fractures, Foliation, etc.	MINERALIZATION		ASSAY DATA						oz/ton Au	oz/ton Ag	Avg.	
From	To			Type	%	Sample	Width	% Ni	% Cu	% Zn	% Fe				% Pb
211.6	246.3	Predom. (light grey) dacitic tuffs; contains minor intervals of more basic (light green) tuffs. Carb. veining and scattered Py - odd cube and dissemin. (The light grey "dacitic tuffs" may also be the contact-metamorphic equivalent of the more basic tuffs as a result of the proximity of the granodiorite in this area- some of the material resembles the transitional material encountered in previous drill holes near the contact with the granodiorite.													
246.3	250.3		Var. metavolcs. tuffs - most ash, some lapilli.												
250.3	257.6		Questionable, transitional (light grey) granodiorite with odd 1/2" quartz vein; odd speck of Cp and Py												
			Checksample: 255.6 - 257.6			A4126									
250.3	368.0	Basic metavolcs - medium to dark green; some flow material; odd 2 - 3" patch and	presom. tuffs. veins of carb.												
		END OF HOLE.													

PATRICIA M. MEDY
RECEIVED
JAN 13 1986
A.M. P.M.
7 8 9 10 11 12 1 2 3 4 5 6

#86-14

Ontario ASSESS LIB

Mining A



52F16NE8324 34 PICKEREL

900

Name and Postal Address of Recorded Holder

TARBUSH ODE MINING LIMITED

4000 Yonge Street - Apartm. 411 Toronto - Ont. Kabik & Pickerel Twp M2258

Summary of Work Performance and Distribution of Credits

Total Work Days Cr. claimed	Mining Claim			Work Days Cr.	Mining Claim			Work Days Cr.	
	Prefix	Number	Work Days Cr.		Prefix	Number	Work Days Cr.		
1291.7 days	PA	519499	60	PA	519507	60	PA	519515	60
		519500	60		519508	60		519516	60
		519501	60		519509	60		518518	60
		519502	60		519510	60		519519	60
		519503	60		519511	60		519520	60
		519504	60		519512	60			
		519505	60		519513	60		704657	3.7
		519506	60		519514	60		519517	28

All the work was performed on Mining Claim(s): 850188

Required Information eg: type of equipment, Names, Addresses, etc. (See Table Below)

Diamond Drilling performed during October/November 1985 by Fontaine
Diamond Drilling - Kenora Ont.

TOTAL 1390 days
Using #86-14 1291.7 days
Rem. Balance 98.3 days

TB 85-2 @ 218 feet Diamond drill logs enclosed.

TB 85-3 @ 339 feet

TB 85-4 @ 247 feet

TB 85-6 @ 218 feet JAN 27 1986 entitled: "Report on the powerstripping & Diamond Drill programs, claims

TB 85-7 @ 368 feet

RECEIVED 850187 & 850188" by Norontex Exploration

Total: 1390 feet

Balance: 98.3 feet

ONTARIO GEOLOGICAL SURVEY
ASSESSMENT FILES
RESEARCH OFFICES
RECEIVED
JAN 13 1986

Pa. 437218

Date of Report Nov. 23, 1985
Recorded Holder or Agent (Signature)

Certification Verifying Report of Work A.M.

I hereby certify that I have a personal and direct knowledge of the facts set forth in the Report of Work annexed hereto having performed the work or witnessed same during and/or after its completion and the annexed report is true.

Name and Postal Address of Person Certifying

J. Langelaar, Norontex Exploration Ltd, R.R.#1, box 7 site 11

Dryden - Ont. P8N 2Y4

Date Certified Jan. 10, 1986
Certified by (Signature)

Table of Information/Attachments Required by the Mining Recorder

Type of Work	Specific information per type	Other information (Common to 2 or more types)	Attachments
Manual Work	Nil	Names and addresses of men who performed manual work/operated equipment, together with dates and hours of employment.	Work Sketch: these are required to show the location and extent of work in relation to the nearest claim post.
Shaft Sinking, Drifting or other Lateral Work			
Compressed air, other power driven or mechanical equip.	Type of equipment	Names and addresses of owner or operator together with dates when drilling/stripping done.	Work Sketch (as above) in duplicate
Power Stripping	Type of equipment and amount expended. Note: Proof of actual cost must be submitted within 30 days of recording.		
Diamond or other core drilling	Signed core log showing; footage, diameter of core, number and angles of holes.	Nil	Nil
Land Survey	Name and address of Ontario land surveyor.		

VI

Ojibway Provincial Park
File. 168897

Pa 533047	Pa 533046	Pa 533045
Pa 533044	Pa 533043	Pa 533042
Pa 533041	Pa 533040	Pa 533039
Pa 533038	Pa 533037	Pa 533036

KRL 2443	KRL 2444	KRL 2445
KRL 2446	KRL 2447	KRL 2448
KRL 2449	KRL 2450	KRL 2451
KRL 2452	KRL 2453	KRL 2454

V Maskinonge

PICKEREL

IV

III

Hooch Cr.

850511

850512

850514

850515

Pa 533129

Pa 533128

Pa 533127

Pa 533126

Pa 533125

Pa 533124

Pa 533123

Pa 533122

Pa 533121

Pa 533120

Pa 533119

Pa 533118

Pa 533117

Pa 533116

Pa 533115

Pa 487121

Pa 487120

Pa 487119

Pa 487118

Pa 487117

Pa 487116

Pa 487115

Pa 487114

Pa 487113

Pa 487112

Pa 487111

Pa 487110

Pa 487109

Pa 487108

Pa 487107

Pa 487106

Pa 487105

Pa 519506

Pa 519505

Pa 519504

Pa 519503

Pa 519502

Pa 519501

Pa 519500

Pa 519499

Pa 519498

Pa 519497

Pa 519496

Pa 519495

Pa 519494

Pa 519493

Pa 519492

Pa 519491

Pa 519490

Pa 519489

Pa 487105

Pa 487104

Pa 487103

Pa 487102

Pa 487101

Pa 487100

Pa 487099

Pa 487098

Pa 487097

Pa 487096

Pa 487095

Pa 487094

Pa 487093

Pa 487092

Pa 487091

Pa 487090

Pa 487089

Pa 487088

Pa 519515

Pa 519514

Pa 519513

Pa 519512

Pa 519511

Pa 519510

Pa 519509

Pa 519508

Pa 519507

Pa 519506

Pa 519505

Pa 519504

Pa 519503

Pa 519502

Pa 519501

Pa 519500

Pa 519499

Pa 519498

Pa 490621

Pa 490620

Pa 490619

Pa 490618

Pa 490617

Pa 490616

Pa 490615

Pa 490614

Pa 490613

Pa 490612

Pa 490611

Pa 490610

Pa 490609

Pa 490608

Pa 490607

Pa 490606

Pa 490605

Pa 490604

Pa 486386

Pa 486385

Pa 486384

Pa 486383

Pa 486382

Pa 486381

Pa 486380

Pa 486379

Pa 486378

Pa 486377

Pa 486376

Pa 486375

Pa 486374

Pa 486373

Pa 486372

Pa 486371

Pa 486370

Pa 486369

Pa 486386

Pa 486385

Pa 486384

Pa 486383

Pa 486382

Pa 486381

Pa 486380

Pa 486379

Pa 486378

Pa 486377

Pa 486376

Pa 486375

Pa 486374

Pa 486373

Pa 486372

Pa 486371

Pa 486370

Pa 486369

Mines Pt

Kobik Lake &
Pickrel Twp
6-2079

Southwest



Report of Work

#86-13

Instructions - Supply required data on a separate form for each type of work to be recorded (see table below).
- For Geo-technical work use form no. 1362 "Report of Work (Geological, Geophysical, Geochemical and Expenditures)".

The Mining Act

Name and Postal Address of Recorded Holder Tarbush Lode Mining Limited 4000 Yonge Street - Apartm.411 Toronto - Ont.	Prospector's Licence No. T969 Kabik & Pickereel G2079 Echo twp M-2236
---	---

Summary of Work Performance and Distribution of Credits

Total Work Days Cr. claimed 56.37	Mining Claim		Work Days Cr.	Mining Claim		Work Days Cr.	Mining Claim		Work Days Cr.
	Prefix	Number		Prefix	Number		Prefix	Number	
for Performance of the following work. (Check one only)	PA	704657	56.37						
<input type="checkbox"/> Manual Work									
<input type="checkbox"/> Shaft Sinking Drifting or other Lateral Work.									
<input type="checkbox"/> Compressed Air, other Power driven or mechanical equip.									
<input type="checkbox"/> Power Stripping									
<input checked="" type="checkbox"/> Diamond or other Core drilling									
<input type="checkbox"/> Land Survey									

ONTARIO GEOLOGICAL ASSESSMENT FILE RESEARCH OFFICE
JAN 27 1986
RECEIVED

RECEIVED
MINING DIV.
JAN 3 1986
A.M. P.M.
7 8 9 10 11 12 1 2 3 4 5 6

All the work was performed on Mining Claim(s): 850188, 519513, 850186

Required Information eg: type of equipment, Names, Addresses, etc. (See Table Below)

The 56.37 days work is the balance of work applied November 25, 1985 on claims 487099 - 487121 incl.

Work consists of Powerstripping (Oct 4 - Oct 17, 1985) @\$3600
and diamond drilling : hole #TB85-1 @ 469' 195-208 Previous Balance 56.37
hole #TB85-5 @ 176' 196-13 Using 56.37
645'

For details on reports & maps see data submitted November 25, 1985

NOTE: 3.7 days have been applied from work recorded on claims 510499 - 519520 (see)

Date of Report Nov. 23 1985	Recorded Holder or Agent (Signature) <i>J. Langelaar</i>
--------------------------------	---

Certification Verifying Report of Work

I hereby certify that I have a personal and intimate knowledge of the facts set forth in the Report of Work annexed hereto, having performed the work or witnessed same during and/or after its completion and the annexed report is true.

Name and Postal Address of Person Certifying J. Langelaar, Norontex Exploration Ltd; R.R.#1, box 9 site 11 Dryden - Ontario P8N 2Y4	Date Certified January 9, 1986	Certified by (Signature) <i>J. Langelaar</i>
--	-----------------------------------	---

Table of Information/Attachments Required by the Mining Recorder

Type of Work	Specific information per type	Other information (Common to 2 or more types)	Attachments
Manual Work	Nil	Names and addresses of men who performed manual work/operated equipment, together with dates and hours of employment.	Work Sketch: these are required to show the location and extent of work in relation to the nearest claim post.
Shaft Sinking, Drifting or other Lateral Work			
Compressed air, other power driven or mechanical equip.	Type of equipment	Names and addresses of owner or operator together with dates when drilling/stripping done.	Work Sketch (as above) in duplicate
Power Stripping	Type of equipment and amount expended. Note: Proof of actual cost must be submitted within 30 days of recording.		
Diamond or other core drilling	Signed core log showing; footage, diameter of core, number and angles of holes.		
Land Survey	Name and address of Ontario land surveyor.	Nil	Nil

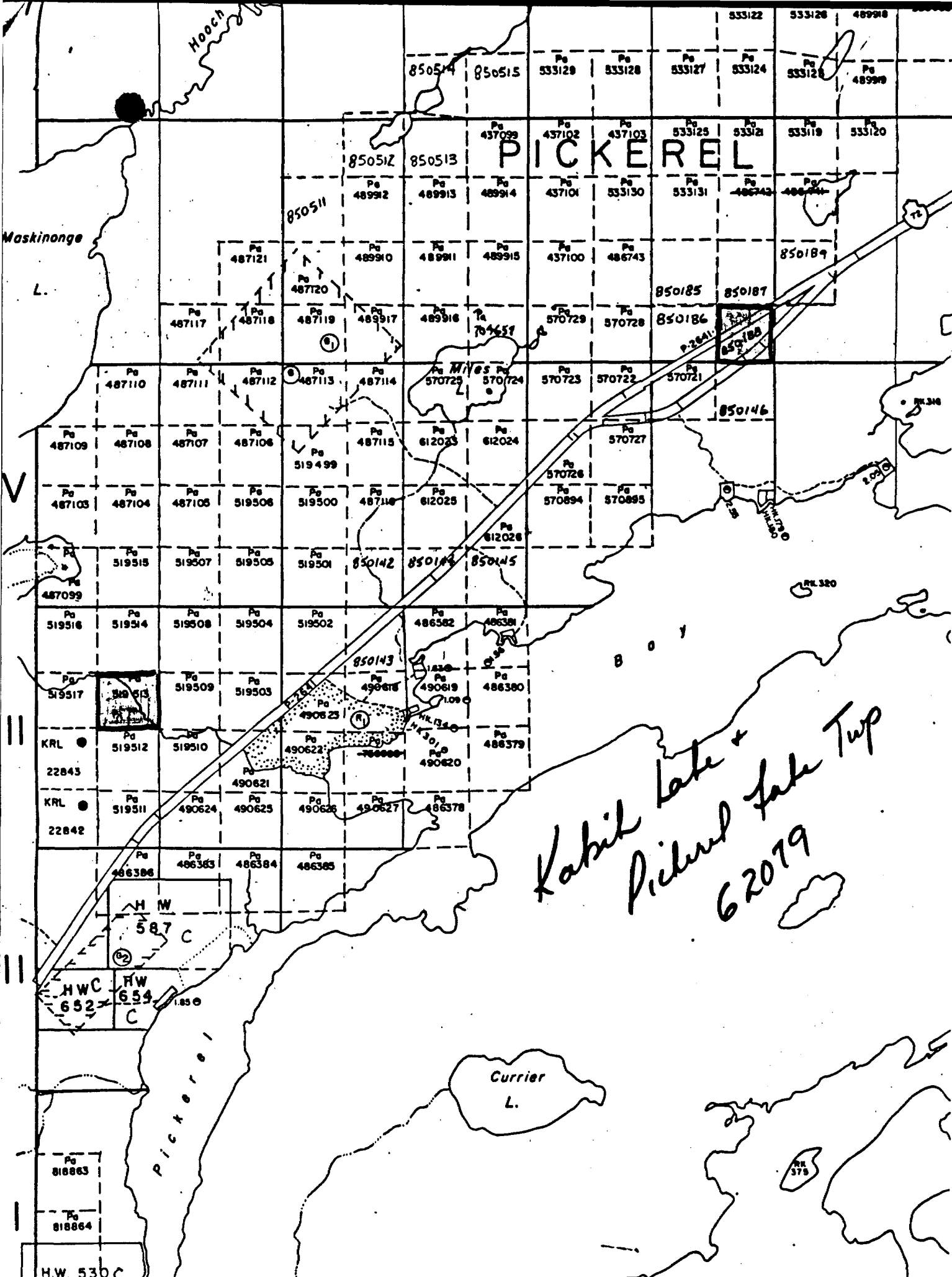

drilling	core, number and angles of holes.		above) in duplicate
Land Survey	Name and address of Ontario land surveyor.	Nil	Nil