



52F16NW0037 52F16NW0029A1 ECHO

Echo Township M-2236



Ministry of Natural Resources

Report of Work

#84-10

Instructions

See instructions on a separate form for details of work to be recorded. See also section 136 of the Mining Act (Geological, Geotechnical and Environmental)

Res. Geologist

The Mining Act

Name and Postal Address of Person Reporting: DONALD WILKINSON RRI SITE 39, BOX 10, DRYDEN, ONT P8N 2V4

Registration Number: E27736

Summary of Work Performance and Distribution of Credits

Table with columns for Mining Claim Number, Name, and Date. Includes handwritten entries like '612092 M...' and '594485 M...'. A stamp from Patricia Mungby is present.

Required Information eg: type of equipment, Names, Address, etc. (See Table below) R. 437114

GARDNER DENVER 750 COMPRESSOR & AIR TRACK DRILL 160 HOURS + 3 x 2 OPERATORS = 106.60 HRS. SKIDDER & DOZER ISLAND 200 DAYS. NORWEST CONST. & MINING EQUIPMENT CO. BOX 760, DRYDEN, ONT. OPERATORS - G. THOMPSON, DRYDEN; R. FELSKE, DRYDEN; T. WOOD, DRYDEN; D. WILKINSON, DRYDEN. STRIPPING - FEB. 3 - FEB 10 '83 - 40 HRS @ 30 min. HOLE DRILLING - FEB. 3 - MARCH '85. P. 594485

Date of Report: JAN. 12/84. Reported by: Donald Wilkinson

Certification Verifying Report of Work

I hereby certify that I have a personal and complete knowledge of the facts set forth in the Report of Work enclosed herein, having performed the work or witnessed same during and/or after its completion and the enclosed report is true.

Name and Postal Address of Person Certified: DONALD WILKINSON RRI SITE 39, BOX 10, DRYDEN, ONT. P8N 2V4. Date Certified: JAN 12/84. Certified by: Donald Wilkinson

Table of Information/Attachments Required by the Mining Recorder

Table with 4 columns: Type of Work, Specific Information per type, Other Information (Common to 2 or more types), and Attachments. Rows include Manual Work, Shaft Sinking, Power Stripping, Diamond or other core drilling, and Land Survey.

Invoice

Norwest Construction & Mining Equipment Limited

Box 960, Dryden, Ontario

Phone (807) 937-4428

DATE Apr 30/83

NO. \_\_\_\_\_

SOLD TO: DEN WILKINSON  
RR 1 SITE 39  
Box 10  
DRYDEN, ONT

SHIP TO: FEB 3 - 11 Mar 10/83  
CLAIM # PA437114  
ECHE TOWNSHIP

Quantity	Part Number	Description	Ship	B/O	Unit Price	Amount
		ASSAYS				1698
40	HRS	SKIDDER RENTAL (STRIPPER)	40		50 <sup>00</sup>	2000 <sup>00</sup>
160	HRS	COMBINE & AIR TOOL (BELL HOLE SAMPLER) 2100 FT BELL HOLE DEMONSTRATION PERFORMED ON CLAIM # PA437114	160		175 <sup>00</sup>	28000 <sup>00</sup>
		OPERATOR G THOMPSON DRYDEN				
		OPERATOR R FELNER				
		MANUAL LABOR D WILKINSON				
		MANUAL LABOR T WOOD				
		--- " --- CLEANING TRACKS	160			
		--- " --- BAGGING SAMPLES	160			
		--- " --- CLEANING	160			
		ABOVE WORK DONE FOR 50% OWNERSHIP OF CLAIMS IN ECHE TOWNSHIP C# 437114, 437115, 437116, 594485, 612092				

PATRICIA MINING DIV.  
**RECEIVED**  
 JAN 12 1983  
 A.M. 7:00 P.M. 11:59

TERMS: NET 30 DAYS ON APPROVED CREDIT,  
 2% INTEREST ON OVERDUE ACCOUNTS

SUB TOTAL  
 PROV. SALES TAX  
 TOTAL **31698**

PATRICIA MINING DIV.  
**RECEIVED**  
 JAN 12 1984  
 A.M. P.M.  
 7 8 9 10 11 12 1 2 3 4 5 6

MASSIVE  
 SULPHIDE  
 AREA

2008 Holes 1-39

- 1- 85' 45"
- 2- 90' 45"
- 3- 105' 45"
- 4- 62' 40"
- 5- 65' VERT
- 6- 65' V
- 7- 85' 45"
- 8- 80' 45"
- 9- 40' 40"
- 10- 30' V
- 11- 60' 40"
- 12- 20' V
- 13- 30' V
- 14- 15' V
- 15- 45' V
- 16- 80' 40"
- 17- 10' V
- 18- 20' V
- 19- 50' 40"
- 20- 42' 45"
- 21- 30' V
- 22- 20' V
- 23- 35' V
- 24- 85' 45"
- 25- 70' 45"
- 26- 60' 40"
- 27- 70' 40"
- 28- 110' 45"
- 29- 40' 45"
- 30- 40' 45"
- 31- 80' 40"
- 32- 15' V
- 33- 20' V
- 34- 45' 40"
- 35- 80' 45"
- 36- 100' 40"
- 37- 30' V
- 38- 45' 45"
- 39- 28' V

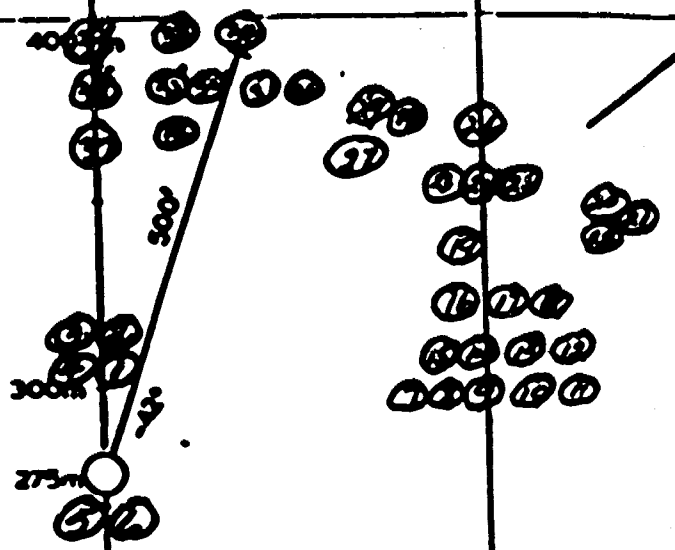

2 1/2" CORE HOLE DRILLING  
 TO TEST MASSIVE  
 SULPHIDE.  
 D. WILKINSON  
 CLAIM Pa 437114.

200m  
 100m

300W

100W

0

100E

200E

ECHO TWP  
 MCAREE TWP

Pa  
 43714

Pa  
 43715

POWER LINE

Hwy 22

SCALE

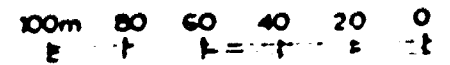

100 metres

D. WILKINSON

PATRICIA MINING DIV.  
**RECEIVED**  
JAN 12 1984  
A.M. P.M.  
7 8 9 10 11 12 1 2 3 4 5 6

AREA STRIPPED  
FEB/1983  
WORK PERMIT # D. WILKINSON  
DATED FEB 3/1983

P<sub>2</sub>  
43714

P<sub>2</sub>  
43715

ECHO TWP  
MCAREE TWP

300W

200W

100W

0

100E

200E

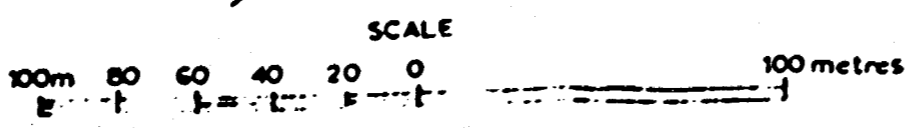

D. WILKINSON

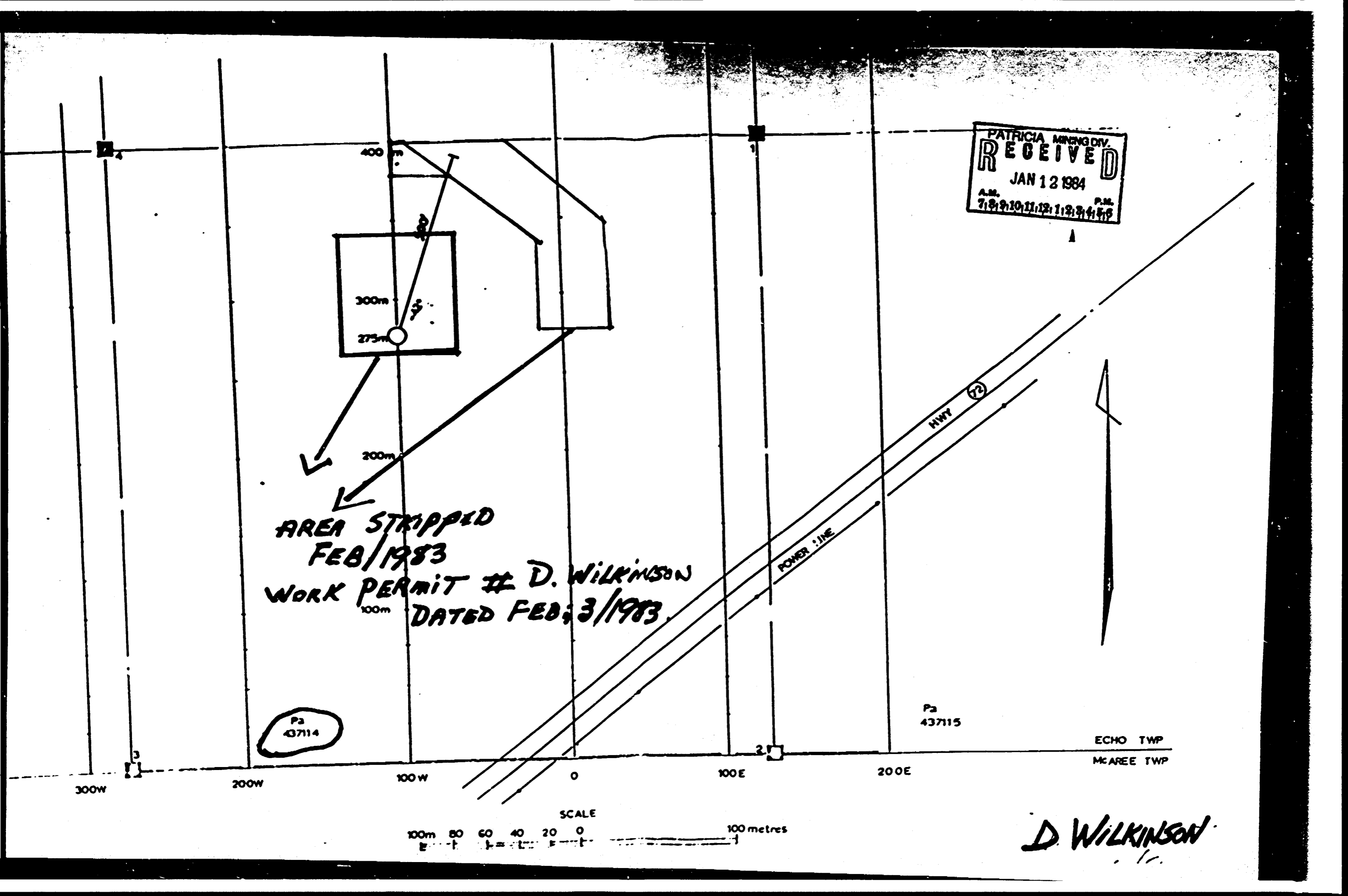

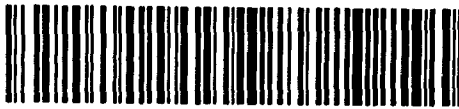

52F16NW0037 52F16NW0029A1 ECHO

900

Mossinong L

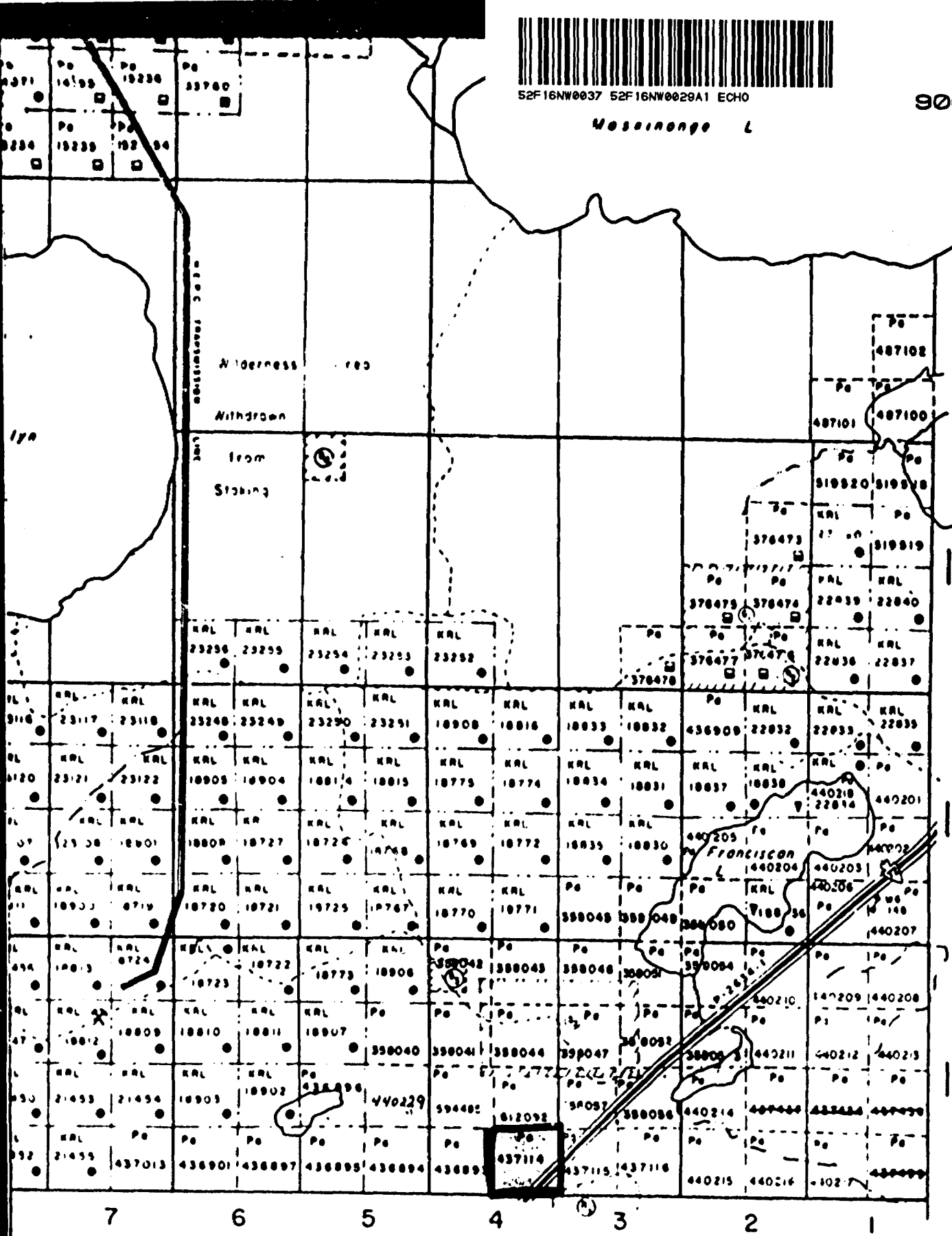

IV

III

II

I

7 6 5 4 3 2 1

McAREE Tp M. 2254

Echo Township  
M-2236

Scale  
1" = 40 chns