

Diamond Drilling

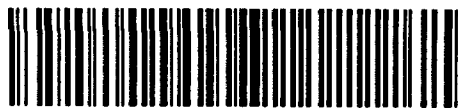

52F16NW0130 52F16NW0023B1 WEBB

010

Township OF WEBB

Report NO: 18

Work performed by: Canol Metal M.L.  
(Alex Koxowy & Alex Leduchowski)

Claim NO	Hole NO	Footage	Date	Note
PA 32891	1	223.0'	Aug/64	
	2	246.0'	Aug/64	
	3	152.0'	Aug/64	
	4	111.0'	Oct/64	
	<u>4 DH</u>	<u>732.0'</u>		

Notes:

# DIAMOND DRILL REPORT

DRILLED BY: Lantz Diamond Drilling

DRILLED ON BEHALF OF: Canol Metal M.L.

CLAIM: Pa.32891

MINING DIVISION: Patricia

LOCATION OF PROPERTY: Webb Twp. Ontario

HOLE NO.: 1

ANGLE: 45

DIRECTION: S.W.

DEPTH: 223'

LOCATION OF HOLE: shown on drill plan No.4

DATE STARTED: Aug.4th

FINISHED: Aug.6th/64

LOGGED BY: J.Donner  
666

DEPTH		DESCRIPTION OF CORE
From	To	
0	32	Casing
32	89.5	Greenstone, few garnets & quartz cross stringers up to 1'
89.5	97.5	Quartz porphyry, massive
97.5	107.5	Greenstone
107.5	125.3	Qtz porphyry, sheared
125.3	142.4	Greenstone
142.4	151.4	Qtz porphyry, sheared
151.4	154.6	Greenstone, altered
154.6	-----	PEGMATITE - 17.4'
154.6	155.1	" 7' fine grain wall zone, few small black crystals
155.1	160	4.9' grey qtz, spodumen - pale yellow green and pink with a few ribbon, bluff feldspar, and a little lepidolite.
160	161.1	1.1' fine grain mass, few small tourmaline
161.1	168.1	" 7' spedumene, qtz, feldspar
168.1	169.1	" 1' lost core
169.1	171.5	" 2.4' fine grain, qtz and feldspar with some spedumene
171.5	172	" .5' fine grain wall zone
172	174.6	Host rock?, sheared
174.6	182.5	Host-rock with few purple qtz cross stringers up to 1' markers?
182.5	218	Host-rock, with few qtz cross stringers, some with tourmatline
218	218.6	.6' Zoned pegmatite, qtz, feldspar & tourmatline
218.6	223	Host-rock
223-	- - -	- - - -END OF HOLE.

Note: the qtz cross stringers appear  
to be running parallel to the  
pegmatite, marker?

**DUPLICATE COPY**  
**POOR QUALITY ORIGINAL.**  
**TO FOLLOW**

# DIAMOND DRILL REPORT

Drilled by: **Lantz Diamond Drilling**  
 Drilled on behalf of: **Canol Metal M. L.**  
 Claim: **Pa. 32891** Mining Division: **Patricia**  
 Location of Property: **Webb TWP. Ontario.**  
 Hole No.: **1** Angle: **45** Direction: **S. W.** Depth: **223'**  
 Location of Hole: **shown on drill plan No. 4.**  
 Date Started: **Aug. 4th** Finished: **Aug. 6th 1964** Logged by: **J. Dornier**

666

Depth		Description of Core
From	To	
0	32	Casing
32	89.5	Greenstone, few garnets & quartz <sup>cross</sup> stringers up to 1/2'
89.5	97.5	Quartz porphyry, massive
97.5	107.5	Greenstone
107.5	125.3	Quartz porphyry, sheared
125.3	142.4	Greenstone
142.4	151.4	Quartz porphyry, sheared
151.4	154.6	Greenstone, altered
154.6	- - -	<del>NEGATIVE</del> - 17.4'
154.6	155.1	" 7' fine grain wall zone, few small black crystals
155.1	160	" 4.9' grey quartz, epidomene - pale yellow green and pink with a few ribbon, bluff feldspar, and, a little lepidolite.
160	161.1	" 1.1' fine grain mass, few small tourmaline
161.1	168.1	" 7' epidomene, quartz, feldspar
168.1	169.1	" 1' lost core
169.1	171.5	" 2.4' fine grain, quartz and feldspar with some epidomene
171.5	172	" .5' fine grain wall zone
172	174.6	Host rock?, sheared
174.6	182.5	Host-rock, with <sup>cross</sup> few purple quartz stringers up to 1/4', <del>markers?</del> <sup>cross</sup>
182.5	218	Host-rock, with few quartz <sup>cross</sup> stringers, some with tourmaline
218	218.6	.6' Zoned pegmatite, quartz, feldspar & tourmaline
218.6	223	Host Rock
223	- - -	- - - end of hole. <u>1.000</u> the quartz cross stringers appear to be running parallel to the pegmatite, marker?

Webb Inc.

# Diamond Drill Hole No. 1

Shown on Diamond Drill Plan No. 4

Located 350 feet W-18° N. of Post No. 2.

M. C. No. PA 32891

Scale: 1 in. = 40 ft.

Scale  
1" = 40'

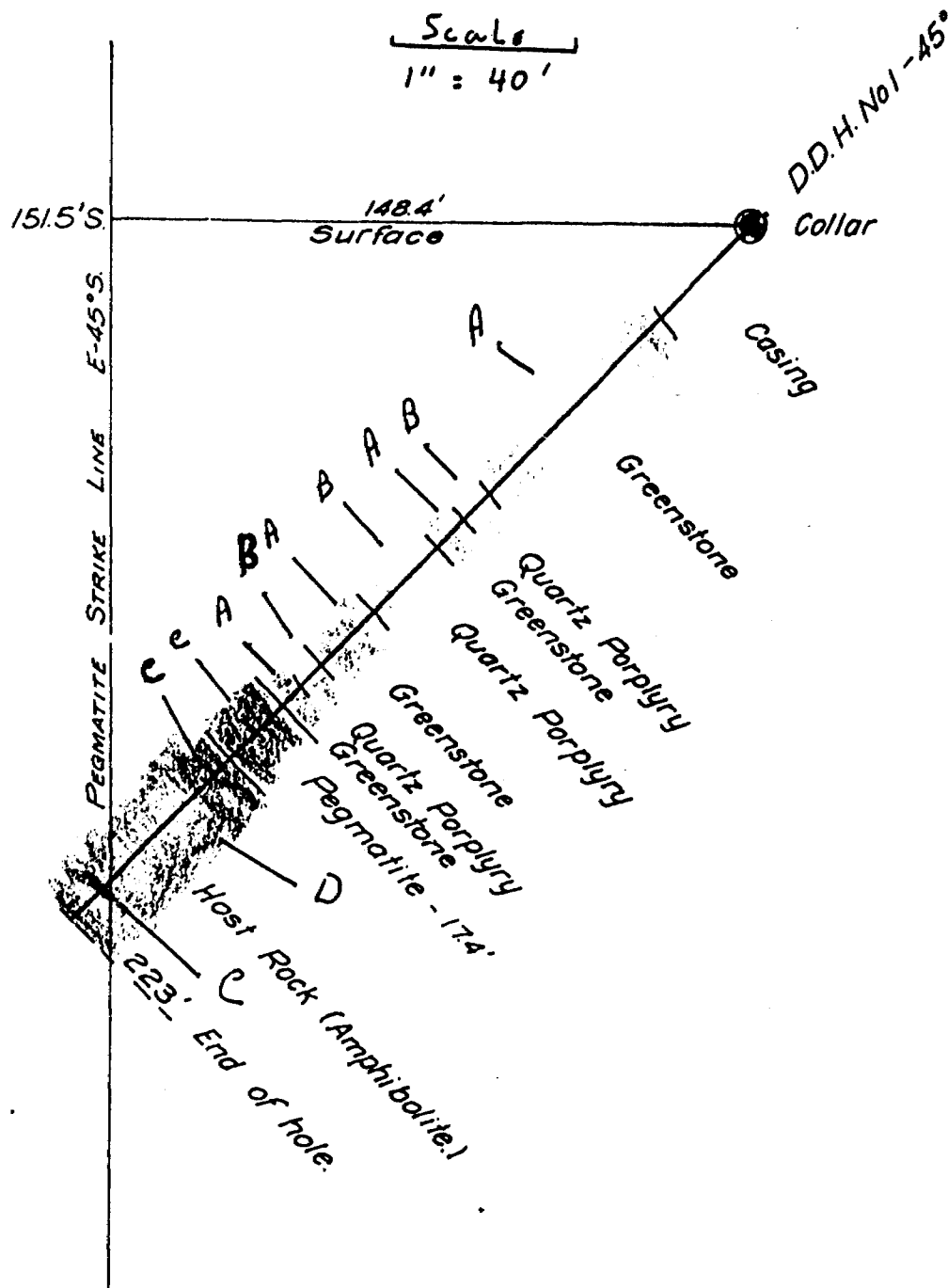

# DIAMOND DRILL REPORT

DRILLED BY: Lantz Diamond Drilling

DRILLED ON BEHALF OF: Canol Metal M.L.

CLAIM: Pa.32891

MINING DIVISION: Patricia

LOCATION OF PROPERTY: Webb Twp. Ontario

HOLE NO.: 2      ANGLE: 45      DIRECTION: S.W.      DEPTH: 246'

LOCATION OF HOLE: shown on drill plan No.4

DATE STARTED: Aug. 8th

FINISHED: Aug.10th/64

LOGGED BY: J.Donner  
666

DEPTH		DESCRIPTION OF CORE
From	To	
0	43	Casing
43	54.5	Sediments, few garnets
54.5	- - -	Quartz porphyry
54.5	64.5	" 10' some sulphide, sample No.4, assay for gold
64.5	67.5	" 3' " " " No.5, " " "
		" @ 69' qtz tourmaline stringer
67.5	80.2	" granitized
-	129	"
129	- - -	Sediments, some garnets
		" @ 134 granitized
	152	"
152	160.5	Greenstone, dark
160.5	178	Sediments, some garnets
178	192.8	Greenstone, few quartz cross stringers
192.8	- - -	Pegmatite, zoned
192.8	193.7	" .9' tourmaline at wall, red & white feld. some spedumene, sample No.7.
193.7	197.5	" 3.4' massive white feld. with few red & quartz, sample No. 8.
197.5	202	" 4.5' qtz. spodumene, feld. & tourmaline @ wall, sample No.9.
- - -	202	Pegmatite - 9.2'
202	212	Greenstone, few qtz cross stringers
212	- - -	Sediments, some garnets
214.9	216.2	" 2.3' 25% sulphides, assay for gold and nickel sample No. 6., -magnetic.
232	246	Quartz porphyry
246	- - -	END OF HOLE

NOTE: The qtz cross stringers appear  
to be running parallel

**DUPLICATE COPY  
POOR QUALITY ORIGINAL  
TO FOLLOW**

# DIAMOND DRILL REPORT

Drilled by: **Lantz Diamond Drilling**

Drilled on behalf of: **Canol Metal M. L.**

Claim: **Pa32881**

Mining Division: **Patricia**

Location of Property: **Webb Twp. Ontario.**

Hole No.: **2**      Angle: **45**      Direction: **S. W.**      Depth: **246'**

Location of Hole: **Shown on drill plan No. 4.**

Date Started: **Aug. 8th**      Finished: **Aug. 10th** <sup>1964</sup>      Logged by: **J. Donner**

666

Depth		Description of Core
From	To	
0	43	Casing
43	54.5	Sediments, few garnets
54.5	- - -	Quartz porphyry
54.5	64.5	" 10' some sulphide, sample No 4, assay for gold
64.5	67.5	" 3' " " " " No 5, " " "
67.5	80.2	" @ 69' quartz tourmaline stringer
-	129	" granitized
129	- - -	Sediments, some garnets
	152	" @ 134 granitized
152	160.5	Greenstone, dark
160.5	178	Sediments, some garnets
178	192.8	Greenstone, few quartz cross stringers
192.8	- - -	Pegmatite, zoned
192.8	193.7	" .8' tourmaline at wall, red & white feldspar
		some spodumene, sample No 7.
193.7	197.5	" 3.4' massive white feldspar feldspar with few red & quartz, sample No 8.
197.5	202	" 4.5' quartz, spodumene, feldspar, & tourmaline
- - -	202	@ wall, sample No 9.
		Pegmatite - 9.2'
202	212	Greenstone, few quartz cross stringers
212	- - -	Sediments, some garnets
214.9	216.2	" 2.3' 25% sulphides, assay for gold and nickel
- - -	232	sample No 6, - magnetic.
232	246	Quartz porphyry
246	- - -	end of hole.

Note: The quartz cross stringers appear to be running parallel

# Diamond Drill Hole No.2

Shown on Diamond Drill Plan No.4

Located 250 feet W.-13° N. of Post No. 2

M. C. No. Pa 32891

Scale: 1 in. = 40 ft.

Scale  
1" = 40'

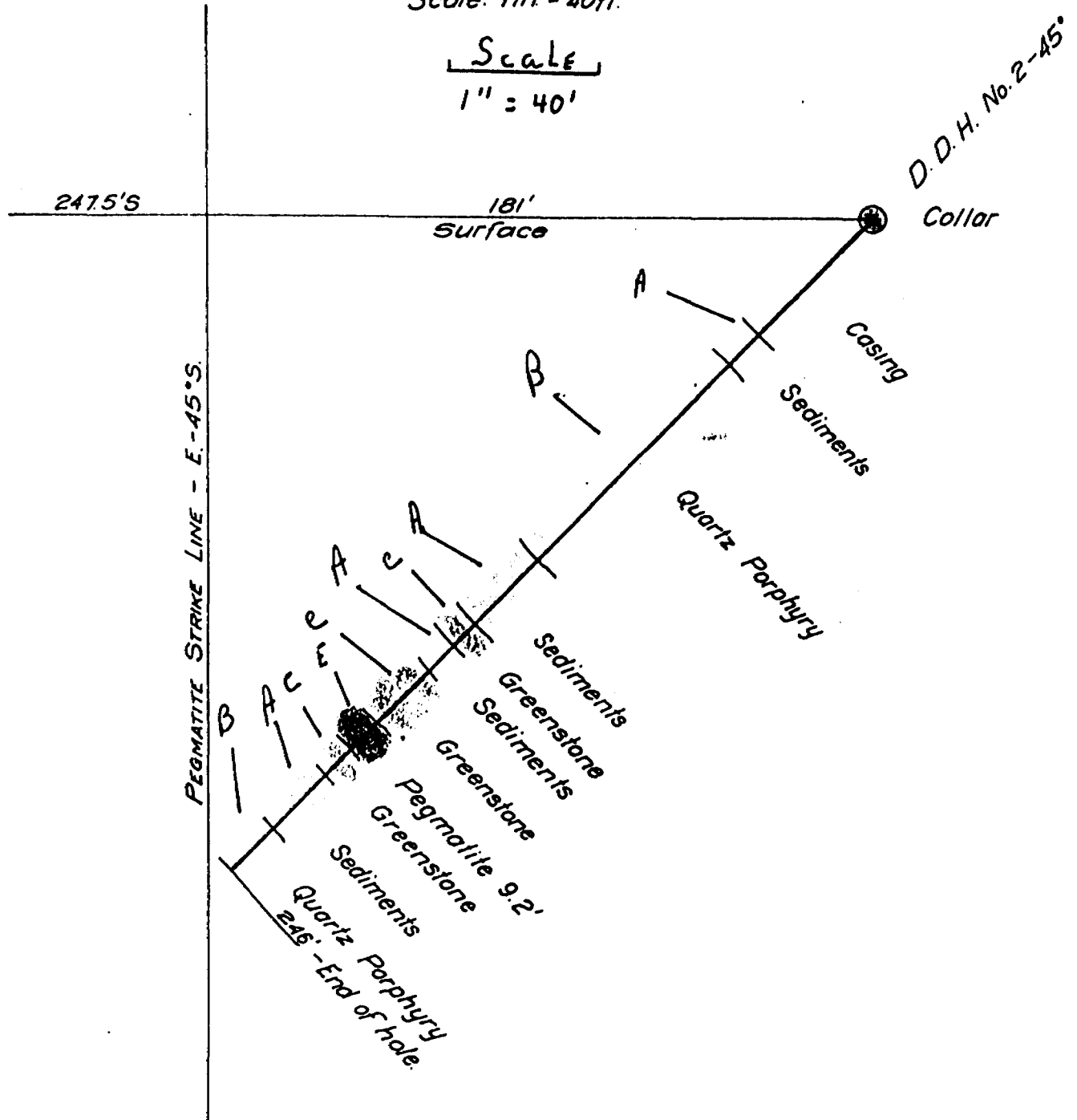

# DIAMOND DRILL REPORT

DRILLED BY: Lantz Diamond Drilling

DRILLED ON BEHALF OF: Canol Metal M.L.

CLAIM: Pa.32894

MINING DIVISION: Patricia

LOCATION OF PROPERTY: Webb Twp. Ontario

HOLE NO.: 3

ANGLE: 45

DIRECTION: S.W.

DEPTH: 152'

LOCATION OF HOLE: shown on drill plan No. 4.

DATE STARTED: Aug. 11th

FINISHED: Aug.13/64

LOGGED BY: J.Donner  
666

DEPTH		DESCRIPTION OF CORE
From	To	
0	49	Casing
49	55	Greenstone, with few qtz cross stringers.
55	- - -	Quartz porphyry?.
55	60	" altered with a little sulphide
60	62.3	" massive, with about 20% pyrrhotite (magnetic) sample no 10. assay for gold & nickel. - 2.3'
62.3	63.3	" 1' sheared rock, 30% sulphides, sample No. 11. assay for gold.
- - -	63.3	"
63.3	125.9	Sediments few garnets
125.9	130.9	5' pegmatite, red & white feld., minor lithium minerals, some tourmaline in wall contacts.
130.9	152	Sediments, some garnets nearing bottom of hole.
152	- - -	END OF HOLE

**DUPLICATE COPY  
POOR QUALITY ORIGINAL  
TO FOLLOW**



# DIAMOND DRILL REPORT

Drilled by: Lantz Diamond Drilling

Drilled on behalf of: Canol Metal M. L.

Claim: Pa32894

Mining Division: Patricia

Location of Property: Webb TWP. Ontario

Hole No.: 3 Angle: 45 Direction: S. W. Depth: 152'

Location of Hole: Shown on drill plan No 4.

Date Started: Aug. 11th Finished: Aug. 13th<sup>1964</sup> Drilled by: J. Donner

666

Depth		Description of Core
From	To	
0	49	Casing
49	55	Grenstone, with few quartz cross stringers
55	- - -	Quartz porphyry?,
55	60	" altered with a little sulphide
60	62.3	" massive, with about 20% pyrrhotite (magnetic)
62.3	63.3	sample no 10. assay for gold & nickel.- 2.3'
- - -	63.3	" 1' sheared rock, 30% sulphides, sample No 11, assay for gold.
63.3	125.9	Sediments few garnets
125.9	130.9	5' pegmatite, red & white feldspar, minor lithium minerals, some tourmaline in wall contacts.
130.9	152	Sediments, some garnets nearing bottom of hole.
152	- - -	end of hole.

# Diamond Drill Hole No.3

Shown on Diamond Drill Plan No.4

Located 240 feet S-73° N. of Post No.1

M. C. No. PA 32894

Scale: 1 in. = 40 ft.

Scale

1" = 40'

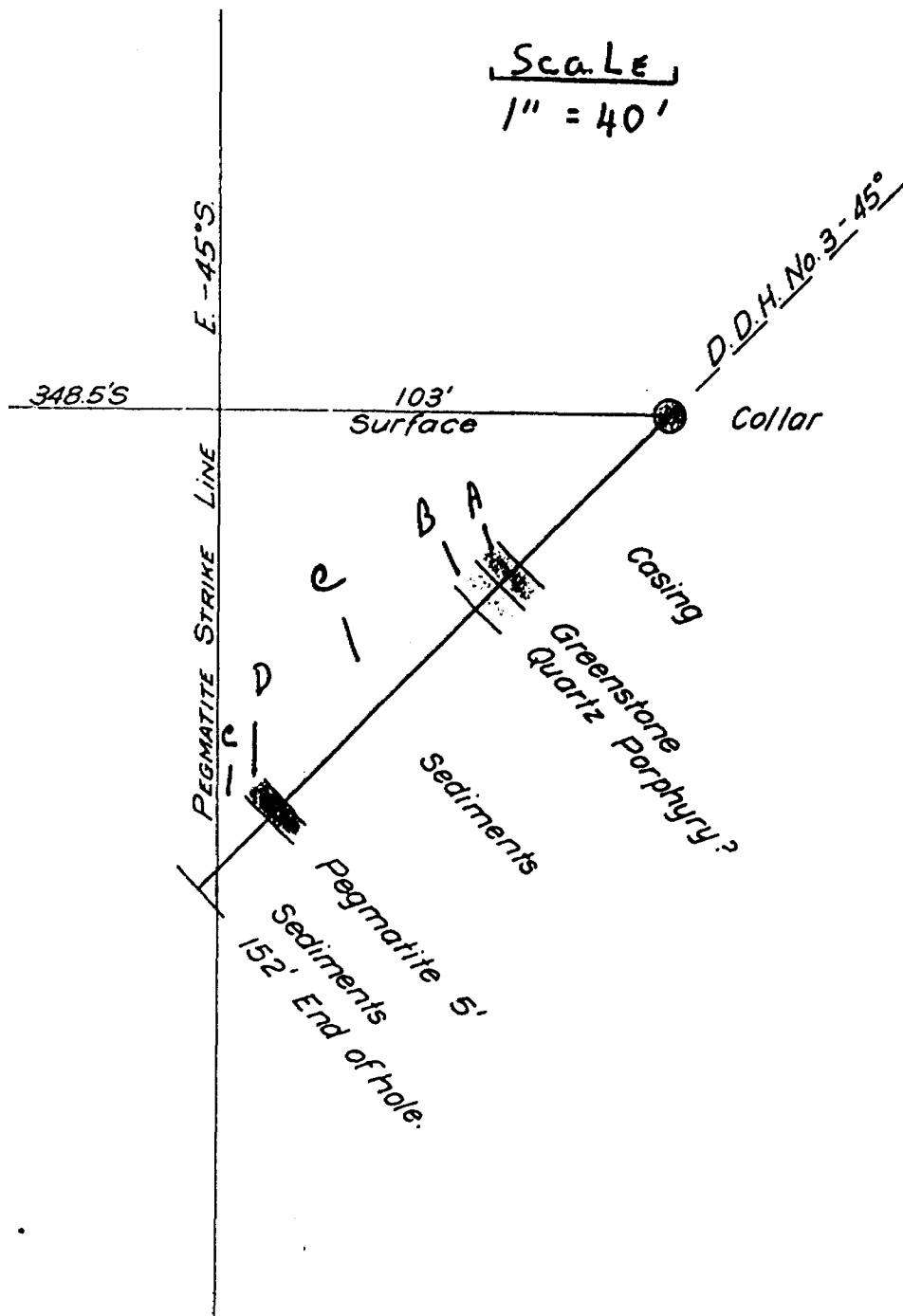

# DIAMOND DRILL REPORT

DRILLED BY: Lantz Diamond Drilling

DRILLED ON BEHALF OF: Canol Metal M.L.

CLAIM: Pa.32893

MINING DIVISION: Patricia

LOCATION OF PROPERTY: Webb Twp. Ontario

HOLE NO.: 4      ANGLE: 45      DIRECTION: W-70N      DEPTH:111'

LOCATION OF HOLE: shown on drill plan No. 4/

DATE STARTED: Oct. 16th

FINISHED: Oct.18/64

LOGGED BY: J.Donner  
666

DEPTH		DESCRIPTION OF CORE
From	To	
0	29	Casing
29	74	Greenstone
74	111	sheared & altered qtz porphyry? with some sulphides.
111	- - -	- - -END OF HOLE

**DUPLICATE COPY  
POOR QUALITY ORIGINAL.  
TO FOLLOW**

#9

DIAMOND DRILL REPORT

Drilled by: Lantz Diamond Drilling  
Drilled on behalf of: Canol Metal M. L.  
Claim: Pa32893 Mining Division: Patricia

Location of Property: Webb TWP. Ontario.

Hole No.: 4 Angle: 45 Direction: W - 70N Depth: 111'

Location of Hole: Shown on Drill Plan No 4.

Date Started: Oct. 16th Finished: Oct. 18/64 Logged by: J. Donner

666

Depth		Description of Core
From	To	
0	29'	casing
29	74	greenstone
74	111'	sheared & altered quartz porphyry? with some sulphides.
111'	- - -	- - end of hole.

## Diamond Drill Hole No.4

Shown on Diamond Drill Plan No.4

Located 525 feet S. - 8° W. of Post No. 1 on

M. C. No. PA 32893

Scale: 1 in. = 40 ft.

SCALE

1" = 40'

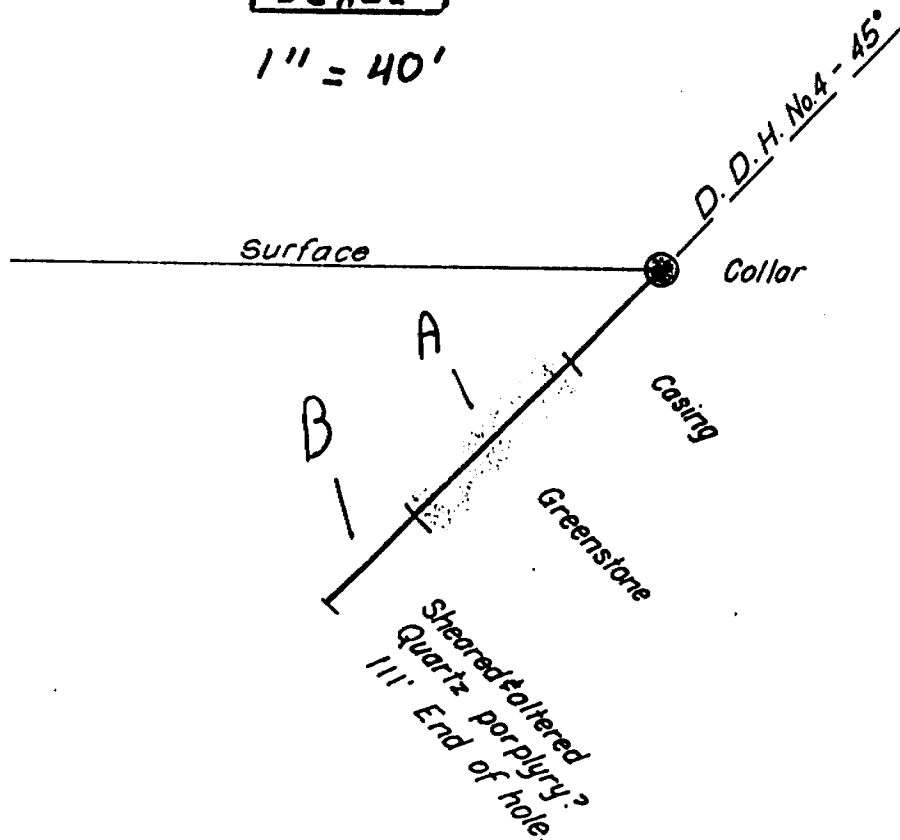

PA 37395

Length of D.W. Hole 154'



52F16NW0130 52F16NW0023B1 WEBB

900

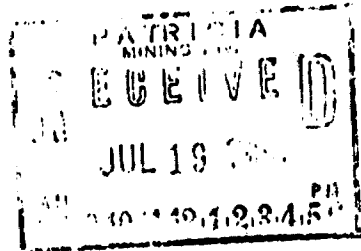

7	PA 37395	1
550' SOUTH 4 POST=PA37395		
110' EAST HOLE ON 45°		
DRILLED FROM SOUTH TOWARD		
3		2

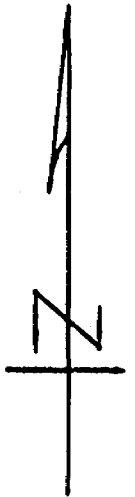

Sinner Lookout  
Dated July 18. 68

BREAK DOWN OF TIME FOR ASSESSMENT WORK CREDIT  
on  
Alex Koxowy & Alex Leduchowske Property  
Webb TWP. Ontario

Period: March, April, June, July, August, & October 1964.

Section 84.--(7):-

Using gas rock drill trenching solid rock.  
R. Donner, of Lac du Bonnet, Manitoba, March 27th to  
April 3rd, 8 days,  
and  
A. Leduchowske, of Dryden, Ontario, March 27th to  
April 2nd, 7 days - total 15 days @ 10 hours per  
day. @ 3 hours per day for such work - / 50 man days

Section 84.--(10):-

Buldozer stripping overburden.  
\$440.72, Dryden Paper Co. statement attached - / 44 " "

Section 84.--(13):-

Manual work.  
J. Donner, of 98 Balmoral Place, Winnipeg,  
Manitoba, March 26th to April 5th, 11 days  
@ 10 hours per day, - @ 6 hours per day for  
such work - / 18 " "

Section 84.--(9):-

Geological Survey, Plan NO 1.  
P. Osis, of Lac du Bonnet, Manitoba, June 4th to  
24th, tying in outcrops & etc., 21 days - 4 - 84 " "  
and  
J. Donner, of 98 Balmoral Place, Winnipeg, Manitoba,  
June 4th to 30th, mapping & etc., 25 days - 4 - 100 " "

Section 84.--(8):-

Magnetometer Survey, Plan NO 4.  
P. Osis, of Lac du Bonnet, Manitoba, line cutting,  
July 1st to 10th, 10 days - 4 - 40 " "  
Aug. 1st to 27th, 27 days - 4 - 108 " "  
and  
J. Donner, of 98 Balmoral Place, Winnipeg, Manitoba,  
taking magnetometer readings & mapping,  
July 1st to 10th, 10 days, - 4 - 40 " "  
Aug. 1st to 31st, 31 days, - 4 - 124 " "  
and  
K. Flegg, of Lac du Bonnet, Manitoba,  
line cutting, Aug. 1st to 18th, 18 days, - 4 - 72 " "  
and  
H. Haggarty, of Wabigoon, Ontario,  
line cutting, Aug. 14th to 20th, 5 days, - 4 - 20 " "

Section 84.--(5):-

Diamond Drilling, D.D.H. #1-223',  
D.D.H. #2-246', D.D.H. #3-152', & D.D.H. #4-111',  
total of 731 feet drilled, - / 731 " "  
TOTAL - - - 1431 " "

*John Donner*  
November 2nd, 1964

1967 - To claim No. 37395, setting up 550 ft. south of 3 Post,  
100 ft. east.

2 Men	4 June/64	18 hrs.	drilling casing down to 24 ft.
" "	10 "	"	12 hrs. casing to 36 ft. bed rock.
" "	12 "	"	6 hrs. coring diamond drilling
" "	13 "	"	4 hrs. " " "
" "	14 "	"	4 hrs. " " "
" "	15 "	"	5 hrs. " " "
" "	16 "	"	4 hrs. " " "
" "	17 "	"	14 hrs. " " "
" "	18 "	"	7 hrs. " " "

Casing 36 ft., 118 ft. 7/8 drill core  
Total footage of core 118 ft. from 36 ft to  
154 ft. the bottom of the hole. the core  
is a mineralized (pyrite) greenstone schist,  
no ore of value was encountered. Very much the  
same from top to bottom. I am out of money  
and will be unable to continue further work  
at this time.

550' south  
100' east 4 Post 37395.

**DUPLICATE COPY  
POOR QUALITY ORIGINAL.  
TO FOLLOW**



1967 ~~BLT 1011 L 1244 10/10/67~~ TO CLAIM NO 37395, SETTING UP  
2 MEN 4 JUNE 18 HRS DRILLING CASING DOWN TO 24 FT

2 MEN 10 JUNE 12 HRS CASING TO 36 FT BED ROCK.

11 12 JUNE 2 HRS CORING DIAMOND DRILLING.

11 13 JUNE 4 HRS CORING DIAMOND DRILLING.

14 JUNE 4 HRS CORING DIAMOND DRILLING.

15 JUNE 5 HRS CORING DIAMOND DRILLING.

16 JUNE 4 HRS CORING DIAMOND DRILLING.

17 JUNE 14 HRS CORING DIAMOND DRILLING.

18 JUNE 7 HRS CORING DIAMOND DRILLING.

CASING 36 FT 188 FT  $\frac{7}{8}$  DRILL CORE

TOTAL FOOTAGE OF CORE 118 FT FROM 36 FT TO

154 FT THE BOTTOM OF THE HOLE THE CORE

IS A MINERALIZED (PYRITE) GREENSTONE

NO ORE OF VALUE WAS ENCOUNTERED

VERY MUCH THE SAME FROM TOP TO BOTTOM.

OUT OF MONEY AND WILL BE

UNABLE TO CONTINUE FURTHER

WORK AT THIS TIME.

550 SOUTH 4 POST 37395  
100' EAST

P. Thompson

DIAMOND DRILLING

Pa. 37395

OWNER OF DRILL: WM THOMPSON

DIAMETER OF CORE: 7/8"

ANGLE OF HOLE: 45°

DIRECTION

CASING - 36' - Gravel-Sand-Boulder

36' to 154' Mineralized greenstone  
schist scattered pyrite  
throughout.

COMMENCED DRILLING: June 4th/64 - completed hole June 18/67

DATED: June 18/68

LOGGED BY: WM THOMPSON

DUPLICATE SKETCHES ATTACHED.

**DUPLICATE COPY  
POOR QUALITY ORIGINAL.  
TO FOLLOW**

DIAMOND DRILLING. P.A. 37395

OWNER OF DRILL - W. M. THOMPSON

DIAMETER OF CORE - 2 1/8"

ANGLE OF HOLE - 45°

DIRECTION -

CASING - 36' - GRAVEL-SAND - BOULDERS

36' TO 154' MINERALIZED GREENSTONE

Schist "scattered Pyrite

throughout.

COMPLETED DRILLING - JUNE 4th - COMPLETED DATE. JUNE 18-1967

DATED - JULY 18-68

LOCATED BY W. M. Thompson

Duplicate sketches attached

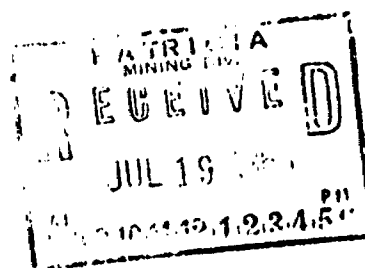



52F16NW0130 52F16NW0023B1 WEBB

020

LITHIUM SHOWINGKozowy-Leduchowski Claims

2½ miles east of Gullwing Lake. M.T.S. 52F/16NW

A northwest trending pegmatite dike lies at the eastern edge of an outcrop of basic volcanic rock and amphibolite in an area of heavy overburden in Webb Township. The pegmatite, exposed by stripping over a length of about 170 feet, is about 30 feet wide and dips steeply to the northeast. Zoning is apparent in places. Spodumene, tourmaline and a green mica occur with quartz and feldspar in most of the exposed area. A series of chip samples across the width of two 30 foot trenches assayed about one percent lithium. A pocket about three feet in diameter containing abundant pollucite was found near the east edge of the dike.

Three holes drilled to the southeast intersected progressively narrower widths of pegmatite. All intersections contained minor spodumene, but none contained pollucite.

By J. C. Davies

Date ?

J. C. Davies Resident Geologist, Kenora  
1963 ? to 1968

H. L. King Resident Geologist, Kenora  
May 6, 1968

**DUPLICATE COPY  
POOR QUALITY ORIGINAL  
TO FOLLOW**

## LITHIUM SHOWING

### Kozowy-Leduchowski Claims

2½ miles east of Cullwing Lake. N.T.S. 52F.18/NW

A northwest trending pegmatite dike lies at the eastern edge of an outcrop of basic volcanic rock and amphibolite in an area of heavy overburden in Webb township. The pegmatite, exposed by stripping over a length of about 170 feet, is about 30 feet wide and dips steeply to the northeast. Zoning is apparent in places. Spodumene, tourmaline and a green mica occur with quartz and feldspar in most of the exposed area. A series of chip samples across the width of two 30 foot trenches assayed about one percent lithium. A pocket about three feet in diameter containing abundant pollucite was found near the east edge of the dike.

Three holes drilled to the southeast intersected progressively narrower widths of pegmatite. All intersections contained minor spodumene, but none contained pollucite.

by J. C. DAVIES

Date?

J. C. Davies ← Resident Geologist, Kenora  
1963? to 1968

H. L. King Resident Geologist May 6, 1968  
Kenora

WEBB Twp.

TCT  
2

LAKE

[illegible]

A. Kozowy  
A. Leduchowski

42 F16

LAKE

1" = 40 chns

**W E B B**

TIPo WPo P

Kozowy - Lachowowski

WILSON

PH-4-COT

LAKE

SEE ACCOMPANYING  
MAP(S) IDENTIFIED AS

52 F/16 NW-0023-B1 #1

52 F/16 NW-0023-B1 #2

LOCATED IN THE MAP  
CHANNEL IN THE FOLLOWING  
SEQUENCE (X)

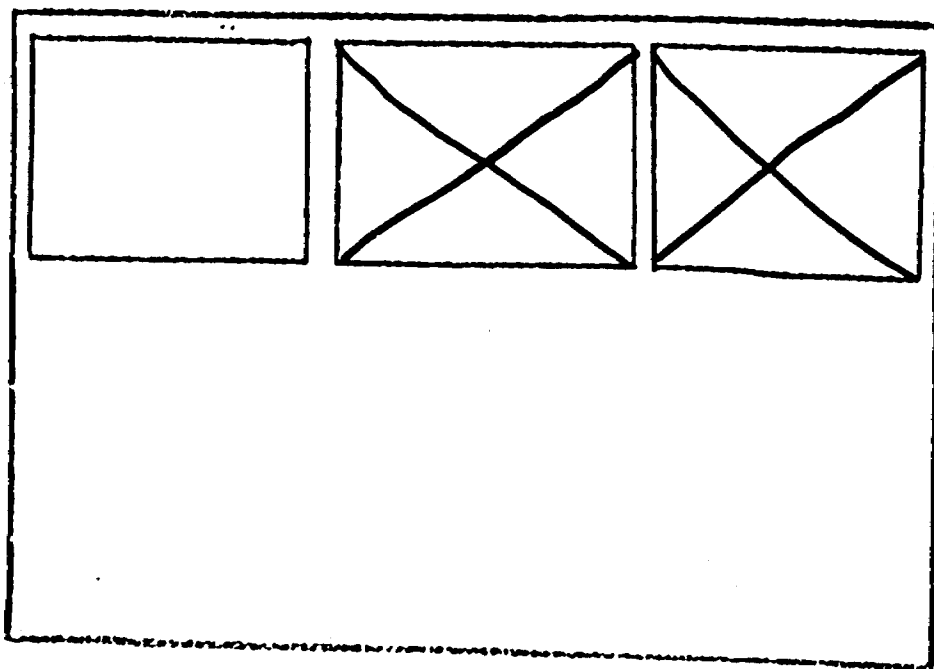



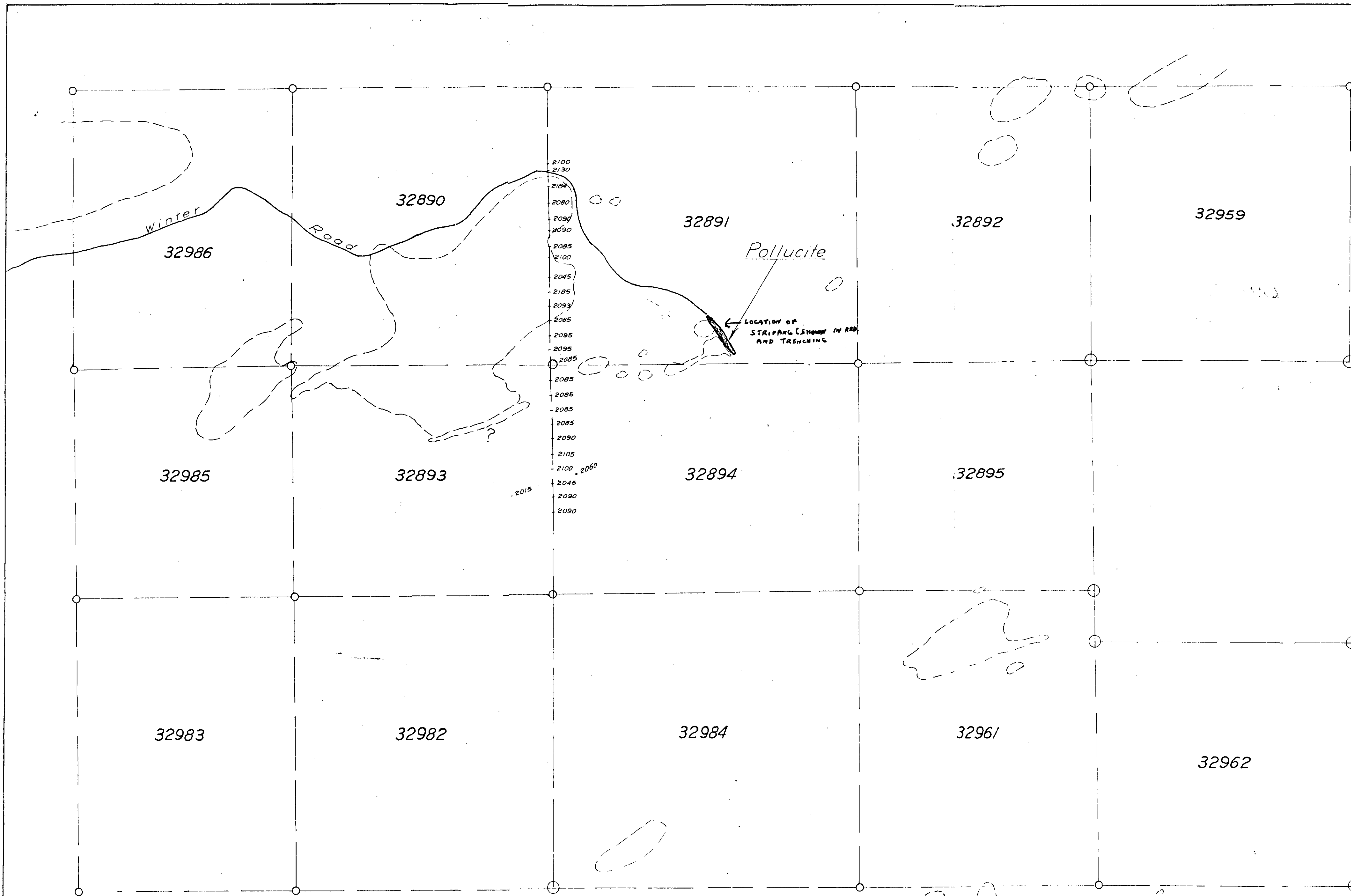

**PLAN No. 1**  
 RECONNAISSANCE GEOLOGICAL SURVEY  
 ON 14 CLAIM PROPERTY OF  
 Alex Kozowy and Alex Leduchowski  
 WEBB TWP. ONTARIO  
 Patricia Mining Division  
 District of Kenora  
 Scale 0 250 500 750 1000 feet

**Rock Outcrops Found**

- ☐ Overburden
- ☐ Pegmatite
- ☐ Granite outcrops and Assumed Boundaries
- ☐ Host Rock coarse grain dark grey massive rock
- ☐ Peridotite
- ☐ Fine grain altered greenstone
- ☐ Sediments

MAG. READINGS DIRECT FROM SHARPE 'A3' MAGNETOMETER



52F16NW0130 52F16NW0023B1 WEBB

200

52 F/16 NW-0023-B1 #1

# PLAN No. 4 SHOWING DIAMOND DRILLING AND MAGNETOMETER SURVEY

ON 14 CLAIM PROPERTY OF  
Alex Kozowy and Alex Leduchowski  
WEBB TWP. ONTARIO  
Patricia Mining Division  
District of Kenora

Scale 0 100 200 300 400 feet

- Overburden
- Pegmatite
- Quartz Porphyry
- Host Rock coarse grain dark grey massive rock
- Peridotite
- Fine grain altered greenstone
- Sediments

MAG. READINGS DIRECT FROM SHARPE 'A3' MAGNETOMETER

READINGS ABOVE NORMAL- 2090 AND HIGHER

READINGS BELOW NORMAL- 2070 AND LOWER

52 F/16 NW 0023-B1 # 2

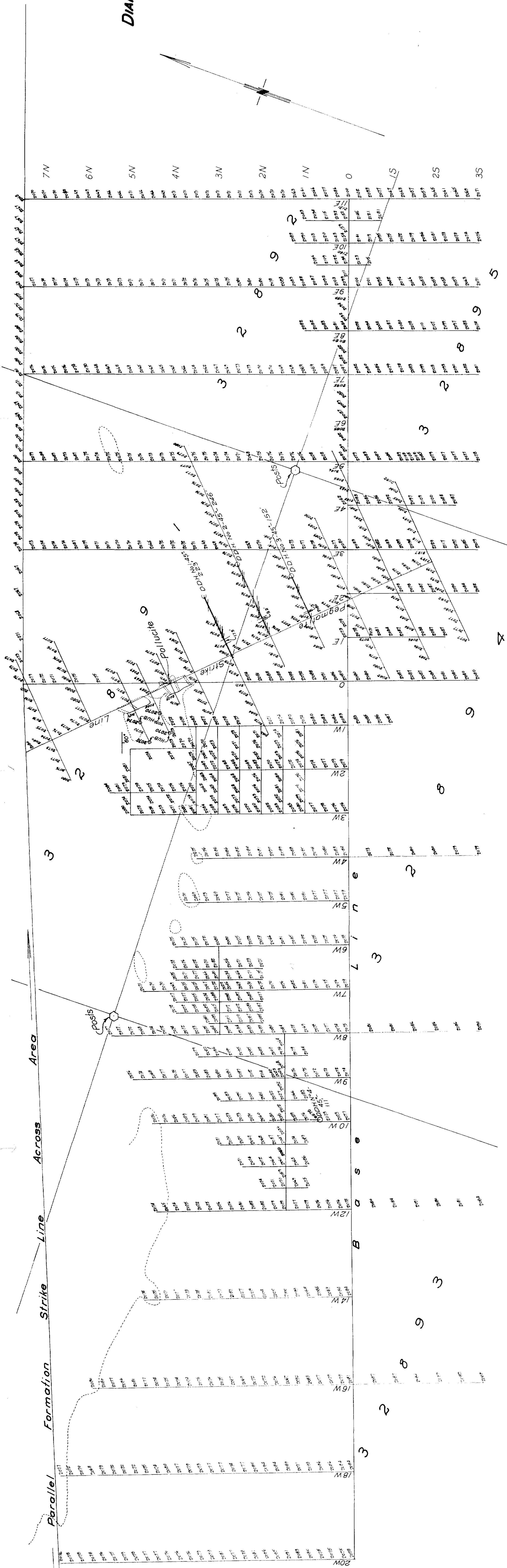

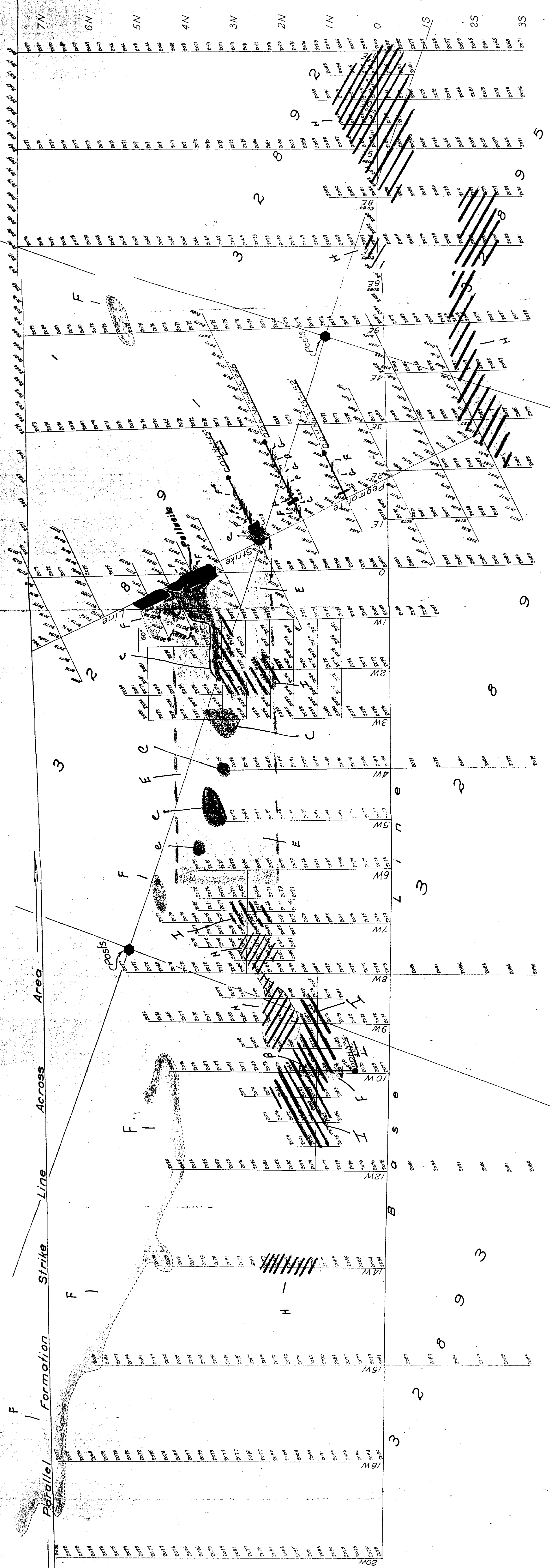

**PLAN No. 4**  
SHOWING  
**DIAMOND DRILLING AND MAGNETOMETER SURVEY**  
ON 14 CLAIM PROPERTY OF  
**Alex Kozowy and Alex Leduchowski**  
**WEBB TWP ONTARIO**  
Patricia Mining Division  
District of Kenora

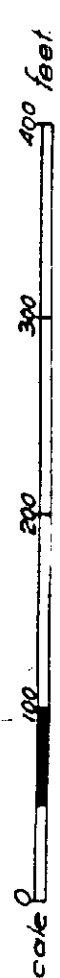

- Overburden
- A Pegmatite
- B Quartz Porphyry
- C+E Host Rock coarse grain dark grey massive rock (limp-hilly)
- F Peridotite
- G Fine grain altered greenstone
- Sediments

MAG. READINGS DIRECT FROM SHARPE 'A3' MAGNETOMETER

READINGS ABOVE NORMAL- 2050 AND HIGHER.

READINGS BELOW NORMAL- 2070 AND LOWER.

John Dower  
November 23rd, 1964

52 F/16 NW-0023-B1-#2

