



DIAMOND DRILLING

52F16NW0207 52F16NW0020D1 MCILRAITH

010

TOWNSHIP: MCILRAITH

REPORT No.: 18

WORK PERFORMED BY: SELCO MINING CORPORATION LTD.

<u>CLAIM No.</u>	<u>HOLE No.</u>	<u>FOOTAGE</u>	<u>DATE</u>	<u>NOTE</u>
PA 498132	30-5-2 <u>LDH</u>	283.0 <u>283.0'</u>	MAR/79	(1)

NOTES:

(1) #22-81

SELCO MINING CORPORATION LIMITED

DIAMOND DRILL RECORD

HOLE NO. 30-5-2

PROPERTY GULLWING AREA

(PA 498132)

SHEET NO 1/ 2

BEARING — Grid South

LOCATION 28+00E
0+25S

DIP COLLAR — 60°

Acid Test: -263' = -55°

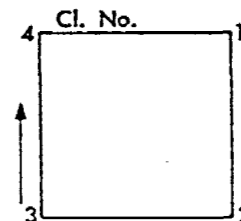

ELEVATION

TOTAL DEPTH 283'

CORE SIZE AQ

STARTED Mar. 20, 1979

COMPLETED March 22, 1979

FROM	TO	DESCRIPTION	SAMPLE NO.	FROM	TO	CORE LENGTH	CORE RECOVERED	ASSAYS				REMARKS
0.0	7.0	CASING										
7.0	10.0	HETEROLITHIC RHYODACITE BRECCIA Very fine grained pale grey clasts in a medium grey weakly biotitic fine grained matrix. Core is highly fractured.										
10.0	27.0	DACITIC TUFF Fine grained, dark grey biotitic tuff. Well foliated 40° to core axis. Uniform texture throughout.										
27.0	46.0	HETEROLITHIC RHYODACITE BRECCIA Fine grained, medium to pale grey clasts in a pale grey matrix. High clast to matrix ratio. Clasts generally > 1" dia. Rare clast of pyrite. Contact with above dacite tuff is gradational.										
46.0	50.0	DACITE LAPILLI TUFF Gradational with above breccia but darker grey due to higher biotitic content. Occasional blue quartz eye and rare clasts of pyrite and pyrrhotite.										
50.0	62.0	HETEROLOTHIC RHYODACITE BRECCIA Most prominent clasts are pale grey, hard, quartz porphyry. Matrix is grey, moderately biotitic but siliceous and very hard.										
62.0	105.0	INTERBEDDED DACITE TUFFS AND RHYODACITE BRECCIA Dacite tuff units are fine grained, dark grey to green with abundant small white siliceous clasts in a matrix with small clusters of /..										

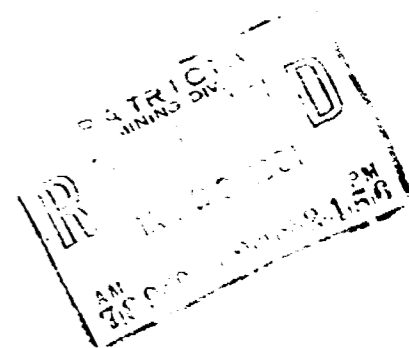

DRILLED BY AMALGAMATED DRILLING

SIGNED A.P. PRYSLAK

SELCO MINING CORPORATION LIMITED
DIAMOND DRILL RECORD

HOLE NO. 30-5-2
SHEET NO 2/2
LOCATION 28+00E
0+25S

PROPERTY _____

BEARING _____
DIP COLLAR _____

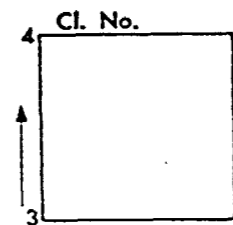

ELEVATION _____
TOTAL DEPTH _____
CORE SIZE _____

STARTED _____

COMPLETED _____

FROM	TO	DESCRIPTION	SAMPLE NO.	FROM	TO	CORE LENGTH	CORE RECOVERED	ASSAYS				REMARKS
2.0	105.0	<p>INTERBEDDED DACITE TUFFS AND RHYODACITE BRECCIA/cont..</p> <p>bright green amphiboles and dark grey wisps of biotite. Fine grained bedded pyrite clasts to 0.5 inches dia. are common. Also minor disseminated pyrite and pyrrhotite.</p> <p>Footage of predominant dacite tuff are: 62.0-65.5; 68.5-72.0; 73.5-74.5; 91.0-93.0; 99.0-105.0.</p> <p>Rhyodacite breccia breccias consist of pale grey to white sericitic clasts to several inches dia. and 1-2% bedded pyrite clasts in a fine grained, pale grey matrix.</p> <p>Contacts between dacite tuff units and rhyodacite breccia is usually gradational over 2-10 inches.</p> <p>94.0 - 95.0: brecciated zone with thin carbonate veinlets containing minor sphalerite, pyrite and pyrrhotite.</p> <p>98.8 -99.0: 80% bedded pyrite in a chloritic matrix (conductor?)</p>										
5.0	283.0	<p>HETEROLITHIC RHYODACITE BRECCIA</p> <p>Abundant white rhyolite to rhyodacite clasts, fine grained and massive to quartz porphyry; occasional yellow rhyolite clast, and rare bedded pyrite clast.</p> <p>Complete lack of sorting or bedding.</p> <p>Matrix is fine grained, grey and biotitic.</p> <p>105-115: Sericitic alteration which would appear to be associated to shearing at 15-300 to core axis. Foliation elsewhere averages 450 to core axis.</p>										

DRILLED BY _____

SIGNED _____

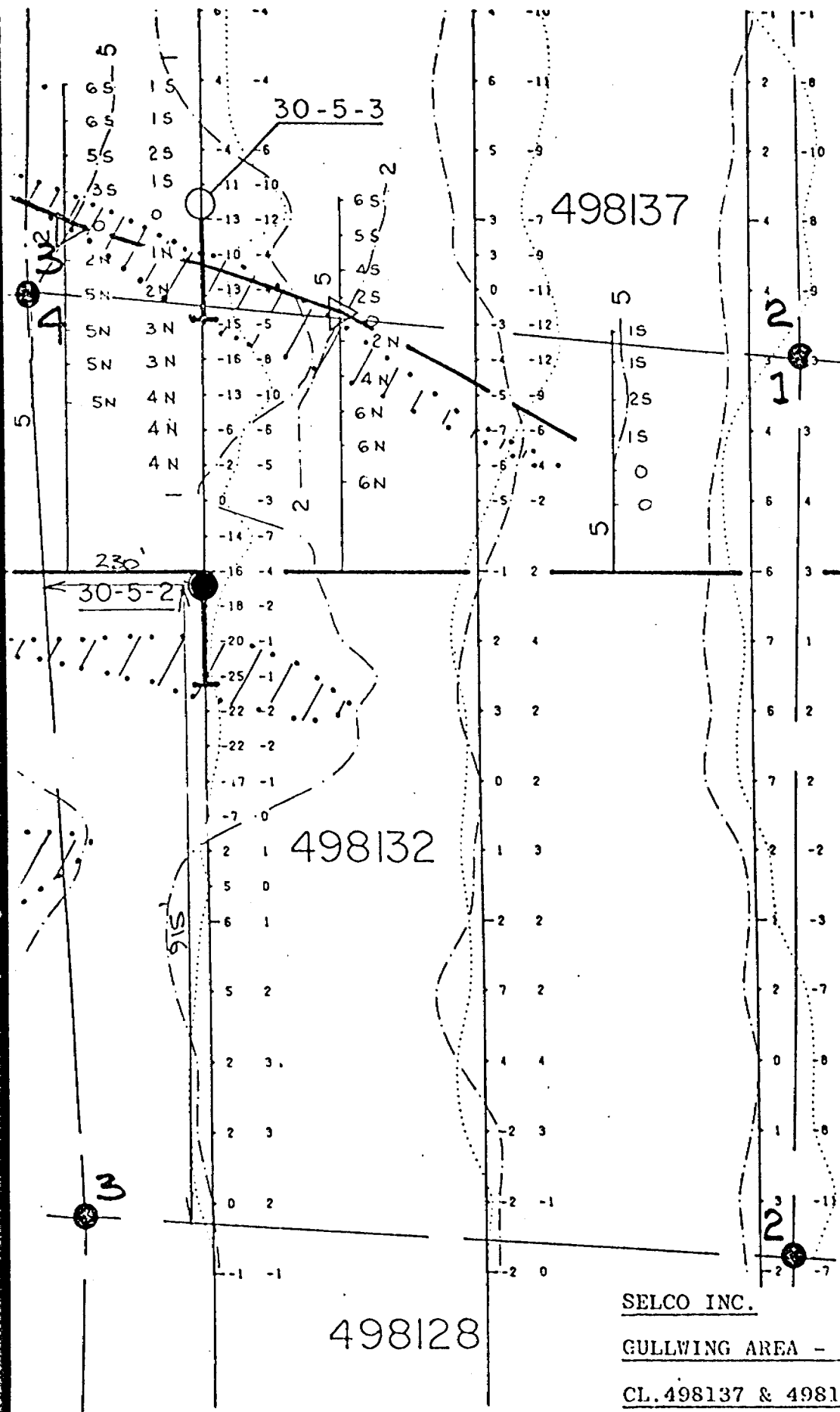

BASE LINE A:

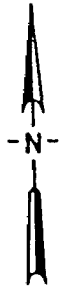
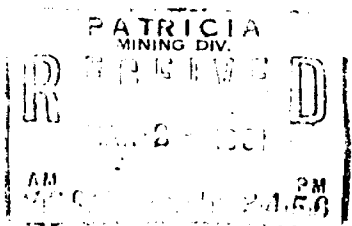

1" = 200'

10S

SELCO INC.

GULLWING AREA - D.D.H.'s 30-5-2, 30-5-3

CL. 498137 & 498132, M-1852, ONTARIO

Scale 1":200'

March, 1981



52F16NW0207 52F16NW0020D1 MCILRAITH

30-5

900

McIlraith Township

M-1852

A separate form is required for each type of work to be recorded.

81-22

THE MINING ACT REPORT OF WORK

To the Recorder of... SIOUX LOOKOUT... Mining Division
I, Selco Inc. T-190
name of Recorded Holder Prospector's Licence
55 University Avenue, Suite 1700, Toronto, Ontario M5J 2H7
Post Office Address

do hereby report the performance of ...240... days of Diamond Drilling
not before reported to be applied on the following contiguous claims

Table with 6 columns: Claim No., Days, Claim No., Days, Claim No., Days. Rows include Pa 498130, Pa 498131, Pa 498132, Pa 498133, Pa 498136.

All the work was performed on Mining Claim (s) Pa 498132
(In the case of geological and/or geophysical survey (s) where more than 18 claims are involved attach a schedule)

READ CAREFULLY: THE FOLLOWING INFORMATION IS REQUIRED BY THE MINING RECORDER.

- For Manual Work, Stripping or Opening up of Mines, Sinking Shafts or Other Actual Mining Operations - Names and addresses of the men who performed the work and the dates and hours of their employment.
For Diamond and other Core Drilling - Footage, No. and angle of holes and diameter of core. Name and address of owner or operator of drill. Dates when drilling was done. Signed core log and sketch in duplicate.
For Compressed Air or Other Power Driven or Mechanical Equipment
Type of drill or equipment. Names and addresses of men engaged in operating equipment and the dates and hours of their employment.
For Power Stripping - Type of equipment. Name and address of owner or operator. Amount expended. Dates on which work was done. Proof of actual cost must be submitted within 30 days of recording.
With each of the above types of work sketches are required to show the location and extent of the work in relation to the nearest claim post. In the case of diamond or other core drilling the sketch must be submitted in duplicate.
For Geophysical, Geological, Geochemical Surveys and Expenditure Credits - the name of author of report. Covering dates of survey (linecutting & office). Type of instrument used. Total amount of expenditure. Technical reports, maps, expenditure breakdown, receipts must be filed in duplicate with the Minister within 60 days of recording.
For Land Survey - the name and address of Ontario Land surveyor.

The Required Information is as Follows: (Attach a list if this space is insufficient)

Table with 8 columns: D.D.H., TOTAL, REMAINING, USING, BEARING, DIP, CORE, DATES. Row: 30-5-2, 283', 283', 240', Grid S, -60°, AQ, 20.03/79-22.03.79

CONTRACTOR: Amalgamated Drilling
R.R. #5,
THUNDER BAY, Ontario

Balance 173 days

Date March 23, 81

Signature of Recorded Holder or Agent

The Mining Act
Certificate Verifying Report of Work

I, A.P. Pryslak
P.O. Box 100, COCHENOUR, Ontario P0V 1L0
(Post Office Address)

hereby certify:

- 1. That I have a personal and intimate knowledge of the facts set forth in the report of work annexed here-to, having performed the work or witnessed same during and/or after its completion.
2. That the annexed report is true

Dated March 16 1981

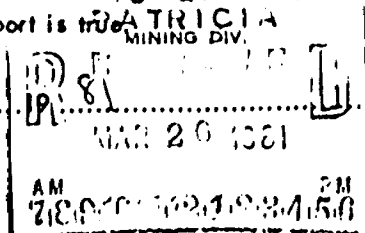

Signature

Pa. 498102

THE PENALTY FOR MAKING A FALSE STATEMENT IN THIS REPORT AND/OR CERTIFICATE IS \$500. OR SIX MONTHS IMPRISONMENT OR BOTH

PATENT DIV.
MINING DIV.
JUN 25 1979
AM 7:00 PM 1:50
1:2500

N
↑

McILRAITH TWP

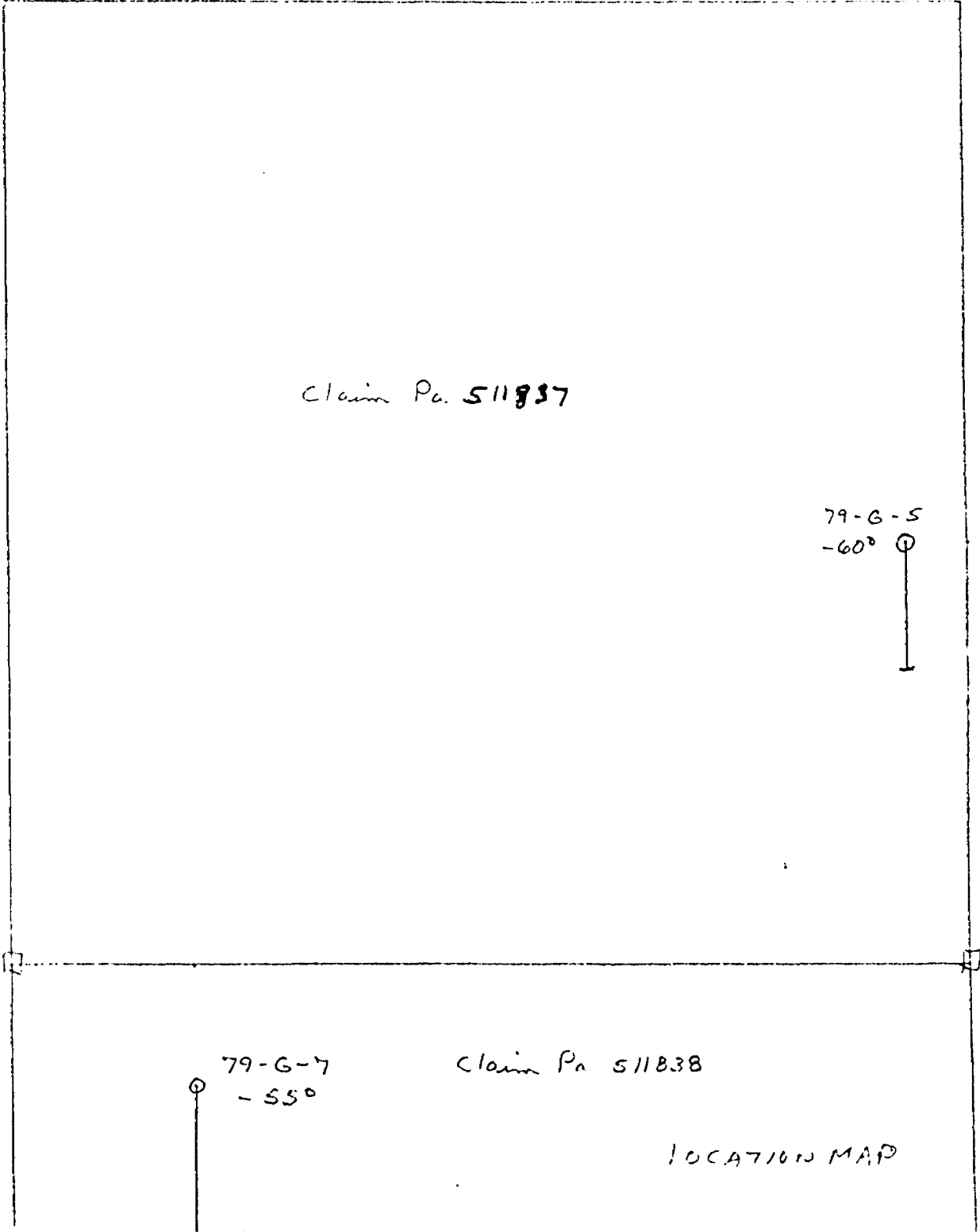

Claim Pa. 511837

79-G-5
-60°

79-G-7
-55°

Claim Pa 511838

LOCATION MAP

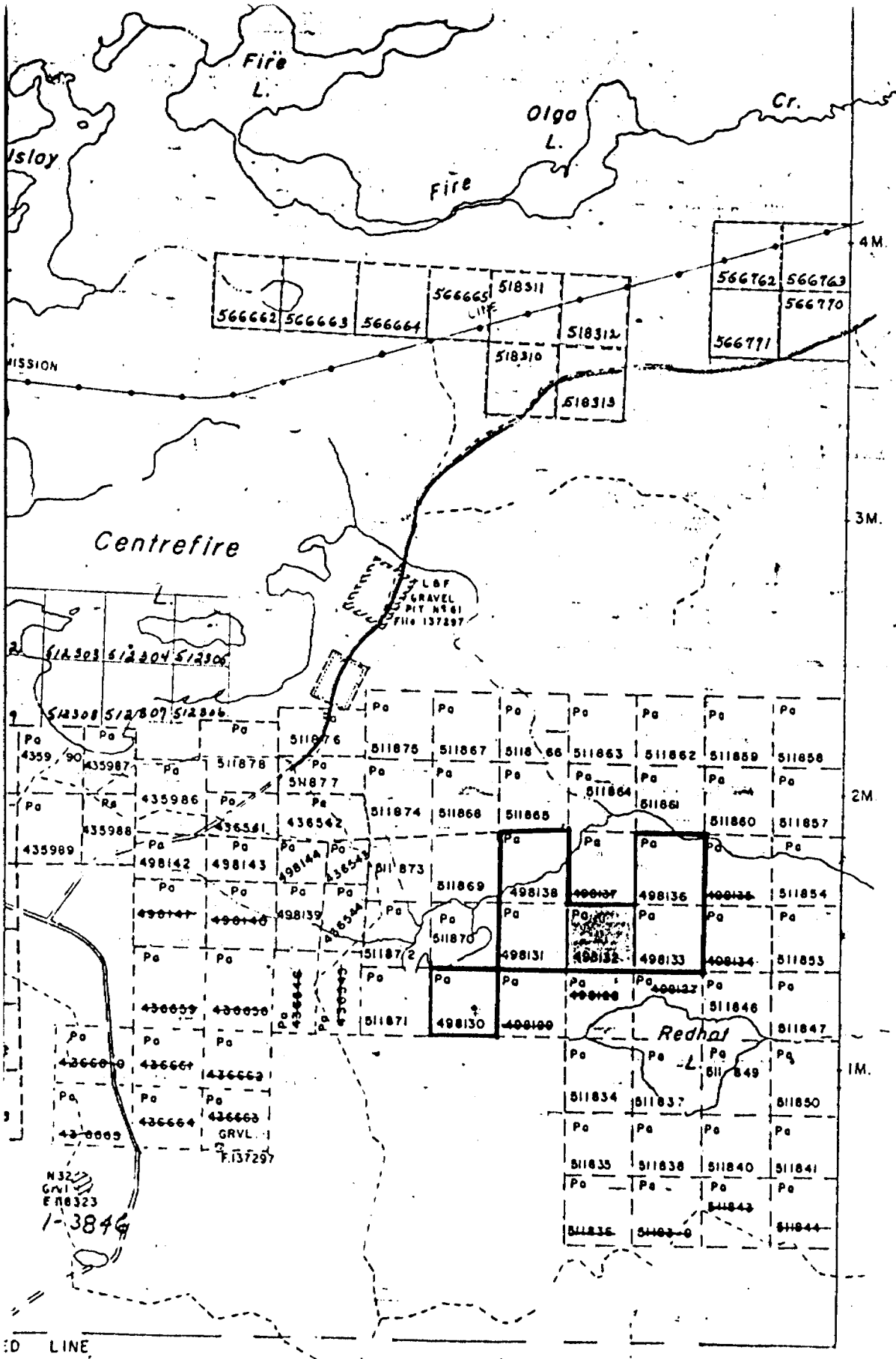

4M
3M
2M
1M

1
2
3
4
5
6
7
8
9

Ms Ilraith Township (M-2251)

PL
CE
LC
LI
MI
SU
RC
IM
KI
RA
PO
MS
ML
CA

Th
th
42

(M-1874)

scale Ms Ilraith Township
1" = 40 chs M-1852

PLA

MIN