



52F16NW8220 52F16NW0059A1 PICKEREL

010

52 F / 16 NW - 0059-A1

Load: - Combo

SEE ACCOMPANYING  
MAP(S) IDENTIFIED AS

52F116NW-0059-A1 #1

LOCATED IN THE MAP  
CHANNEL IN THE FOLLOWING  
SEQUENCE (X)

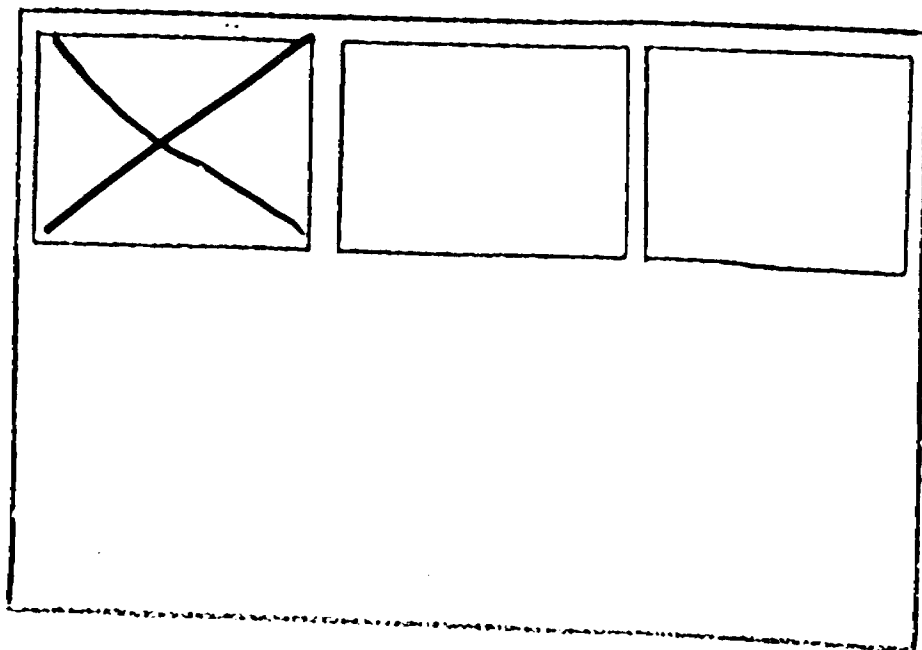

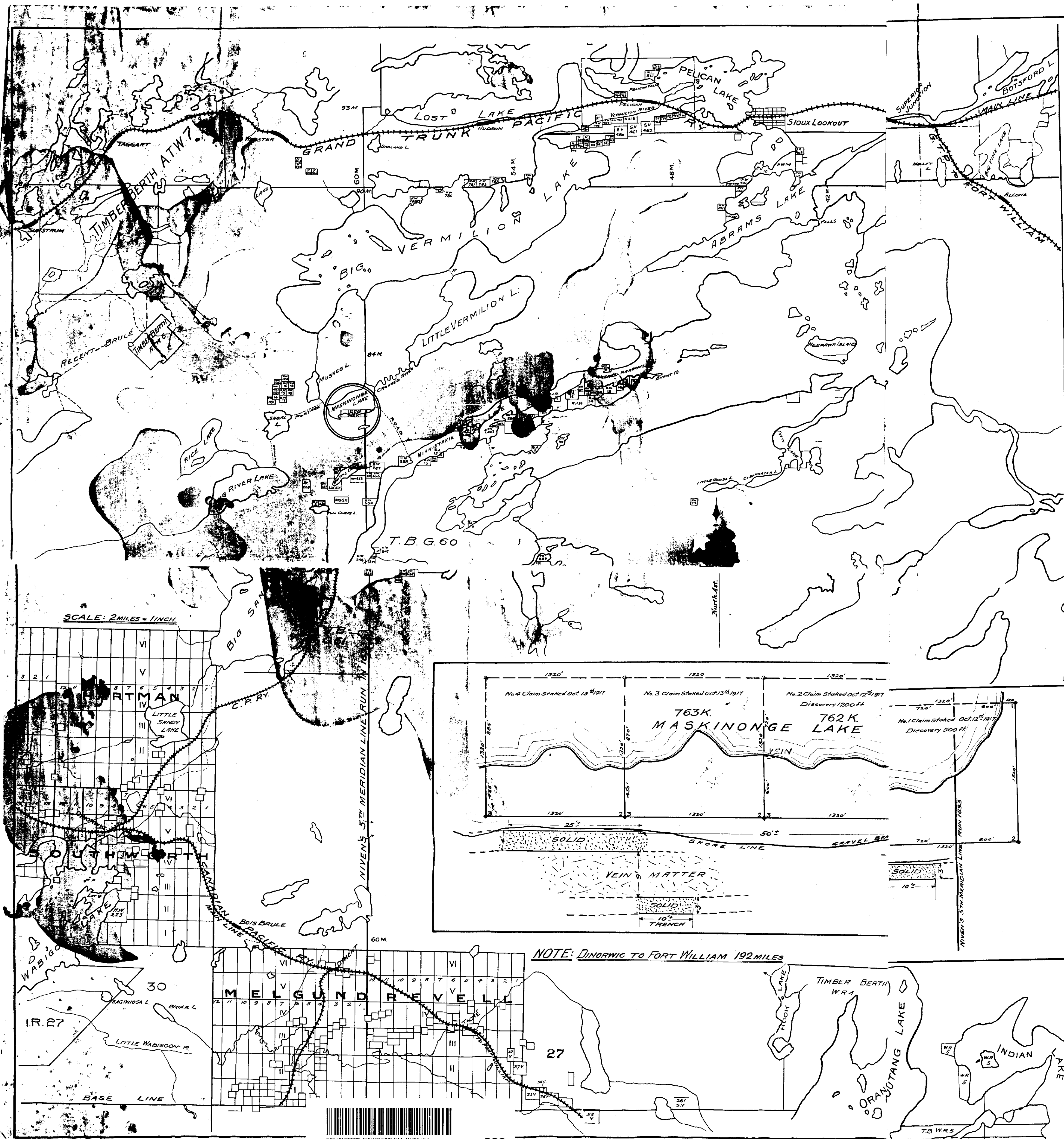

**PLAN**  
 SHOWING LOCATION OF  
**WOODNEY SULPHIDE CLAIMS**

MASKINONGE LAKE  
KENORA MINING DIVISION,  
ONTARIO-CANADA

SCALE: AS SHOWN

FROM INFORMATION FURNISHED  
*W. Woodney*  
 COBALT, ONT.  
 December 10<sup>th</sup> 1917.

For *William Woodney* COBALT, December 1<sup>st</sup> 1917  
 Ont.

No.	DESCRIPTION	% S	% Cu.	% Fe.	% Zn.	% Pb.
827	<i>Pyrite</i>	44.7	Trace	Trace		

