



52F16SE0005 2.14641 KEIKEWABIK LAKE

010

OPAP91 - 272

Prospecting Report

Swimit Lake - Rivers

Project

By

Alex Glatz

MINING DIVISION
PATRICIA
INDEXING RECORDER

32 MAR 24 4 9 : 34

Property:

This project consists of 3 unpatented mining claims. Two claims, 1133605 and 1133606, are on the Swimit Lake or Schmidt showing and claim 1145042 covers the Rivers showing 1.8 km to the southwest.

Location:

The claims are located in the Keikewabik Lake area and in McAree Township in the Patricia Mining Division, south of Sioux Lookout.

Access:

Road access exists to within .6 km of claim 1133605. Canadian Pacific Forest Products built this forest access road in 1988 and 1989. From Dryden the property can be reached via Hwy. 17 to Tache and from there a high standard forest access road runs north to Swimit Lake. Travel distance is 100 km.

The road is not plowed all the way in the wintertime and the last 8 km may have to be travelled by snowmobile. The Rivers showing is one hours walking through the bush from Swimit Lake. However, since a windstorm hit the area in the summer of 1991 traversing the ground is much more difficult now. There also is a bulldozed trail leading to this showing from the southwest for a distance of 16 km, originating from a gravel road in McFie Twp. The trail crosses a creek which freezes over in the winter, making access by snowmobile possible.

Regional Geology:

The Sioux Lookout District is underlain by a north-east trending belt of folded greenstones and sediments, about 24 km wide and 80 km long which is surrounded and locally intruded by granite and related rocks. In this assemblage are three parallel belts of volcanic rocks and two of sediments. Most of the important gold occurrences and deposits found to date are related to a belt of felsic intrusive rocks in Echo, Pickerel and Jordan Townships which cut the central greenstone volcanic belt. The Goldlund property, now under exploration by Noranda, lies within the central volcanic belt in Echo Township. The Rivers (Wallbridge) property lies in the most southerly greenstone belt, about 6 km southeast of the central belt. The Swimit Lake (Schmidt) showing and the Midas occurrence also occur in this greenstone belt.

Local Geology:

The area is underlain by pillow lavas, basic flows, series of intermediate to acid flows and agglomerates, intruded by porphyries at the Swimit Lake property.

At the Rivers property, the one claim is underlain by andesite and porphyries.

The porphyry is silicified in places and hosts a large number of quartz veins. Shearing occurred along the contact of the lava and porphyry, and pockets of sulfides are often concentrated in the sheared colcanics.

Work done:

A total of 43 samples were taken and analysed for gold and some were tested for silver. A planned geophysical survey had to be shelved as a windstorm flattened much of the timber on the upper slopes, making grid layout very difficult and expensive. Also, the airborne geophysics look very flat.

Using a backhoe, trenching was done along the suspected strike of the high grade zone occurring on patented ground immediately south of 1133605. The zone was trenched for 350 ft. where it pinched out.

While the zone is offset by a number of small porphyry dikes within the alteration zone, a number of small parallel and en echelon quartz veins have been uncovered by the trenching. Some of the veins yielded high assays in gold with the highest being 4.36 oz/ton Au across .3m.

On claim 1145042 (Rivers) an array of old trenches were tested by composite sampling to find the gold bearing veins. This was successful when samples taken from 3 trenches with similar quartz and silicification assayed .68 oz/t gold. Subsequent detailed sampling of these 3 trenches showed that each of them carried gold, with the highest value being .98 oz/t gold and 10.18 oz/t silver. This corresponds with old reports of drilling where Teck Corporation intersected .7 oz/t gold over 4 feet 30 years ago.

Conclusions and recommendations:

Having found two areas of high grade gold mineralization makes these claims candidates for further exploration and drilling.

On the Swimit showing drilling would be the next step but should be done in conjunction with the known gold zone on the patented lot to the south. The owner of the ground has been contacted and seems to be interested in a joint option deal with a company.

A major exploration firm is interested in the ground and a meeting is scheduled to discuss terms.

Swimit Lake and Rivers project
Sample description.

<u>Sample #</u>	<u>Sample type</u>	<u>Rock type</u>	<u>Mineralization</u>	<u>Au</u>	<u>Ag</u>
9616	Composite	Sheared Quartz	1% py	Trace	
9617	Composite	Quartz	Minor galena	.68 oz/t	Nil
9618	Composite	Acidic rock	Minor sulfides	Trace	
9619	Composite	Porphyry	Minor sulfides	Trace	Nil
9620	Grab	Agglomerate	Fine sulfides	Nil	
9621	Grab	Andesite	Minor sulfides	30 ppb	
9632	Grab	Basalt	3% sulfide	Trace	
9633	Grab	Grey quartz	Minor sulfides	.48 oz/t	
9634	Grab	Dark dike	Minor sulfides	Trace	
9635	Grab	Breccia	Specks of py	Trace	
9636	Grab	Sheared quartz	6% sphalerite	3.20 oz/t	
9637	Grab	Quartz	1% sp,pb,cp	689 ppb	11.3 ppm
9638	Grab	Porphyry	Minor py	Nil	.2 ppm
9639	Chip	Blue quartz	Specks of sulfides	3994 ppb	.9 ppm
9641	Grab	Loose quartz	1% sphalerite	19680 ppb	7.9 ppm
9663	Comp. gr.	Quartz	Minor pb	.98 oz/t	10.18 oz/t
9664	Chip 1.5m	Quartz & porph.	Minor py, cp, pb	.54 oz/t	3.56 oz/t
9665	Grab	Silic. porphyry	Nil	.20 oz/t	4.46 oz/t
9666	Grab	Sheared porphyry	1% py, carbonate	Trace	2.02 oz/t
9667	Grab	Black rock	2% py	62 ppb	.8 ppm
9681	Grab	Quartz & wallrock	Sphalerite & galena	1.92 oz/t	
7501	Grab	Quartz	Py, gal.	Trace	1.6 oz/t
7502	Grab	Wallrock	Py, carbonate	Trace	1.50 oz/t
7503	Grab	Quartz & lava	Minor cp	.01 oz/t	Nil
7504	Chip 1.0m	Andesite & quartz	Minor sulfides	.14 oz/t	
7505	Chip .6m	Quartz, 10% wallr.	Minor sulfides	Trace	Nil
7506	Chip 1.0m	Andesite	Minor cp	.02 oz/t	Nil
7507	Chip 1.0m	Quartz vein	Py, gal	.14 oz/t	Nil
7508	Chip 1.0m	Vein & wallrock	Minor py	.14 oz/t	Nil
7509	Chip 1.2m	Black rock	-	Trace	Nil
7510	Chip .1m	Quartz	-	Trace	Nil
7511	Chip 2.0m	Shear. andes. & gab.	Minor py	Trace	Nil
7512	Grab	Quartz & andesite	Cp, gal	1.22 oz/t	Nil

Swimit Lake and Rivers project
 Sample description

<u>Sample #</u>	<u>Sample type</u>	<u>Rock type</u>	<u>Mineralization</u>	<u>Au</u>	<u>Ag</u>
7513	Chip .3m	Quartzvein	Cp, gal.	.96 oz/t	Nil
7514	Chip 1.0m	Quartz & wall	Minor sulfides	.14 oz/t	Nil
7515	Chip .3m	Quartzvein	Minor gal.	4.36 oz/t	Nil
7516	Chip .3m	Wallrock&Q	Minor sulfides	3261 ppb	
7517	Chip .3m	Silic. rock	Minor sulfides	5760 ppb	
7518	Chip .3m	Alt. lava	-	31 ppb	
7519	Chip .3m	Quartzvein	Minor sulfides	2537 ppb	
7520	Chip .3m	Q & wallrock	Py, cp, gal	11246 ppb	
7521	Chip .3m	Quartz	Minor sulfides	26400 ppb	
7522	Cip .15m	Quartz	Py, cp, gal	8983 ppb	

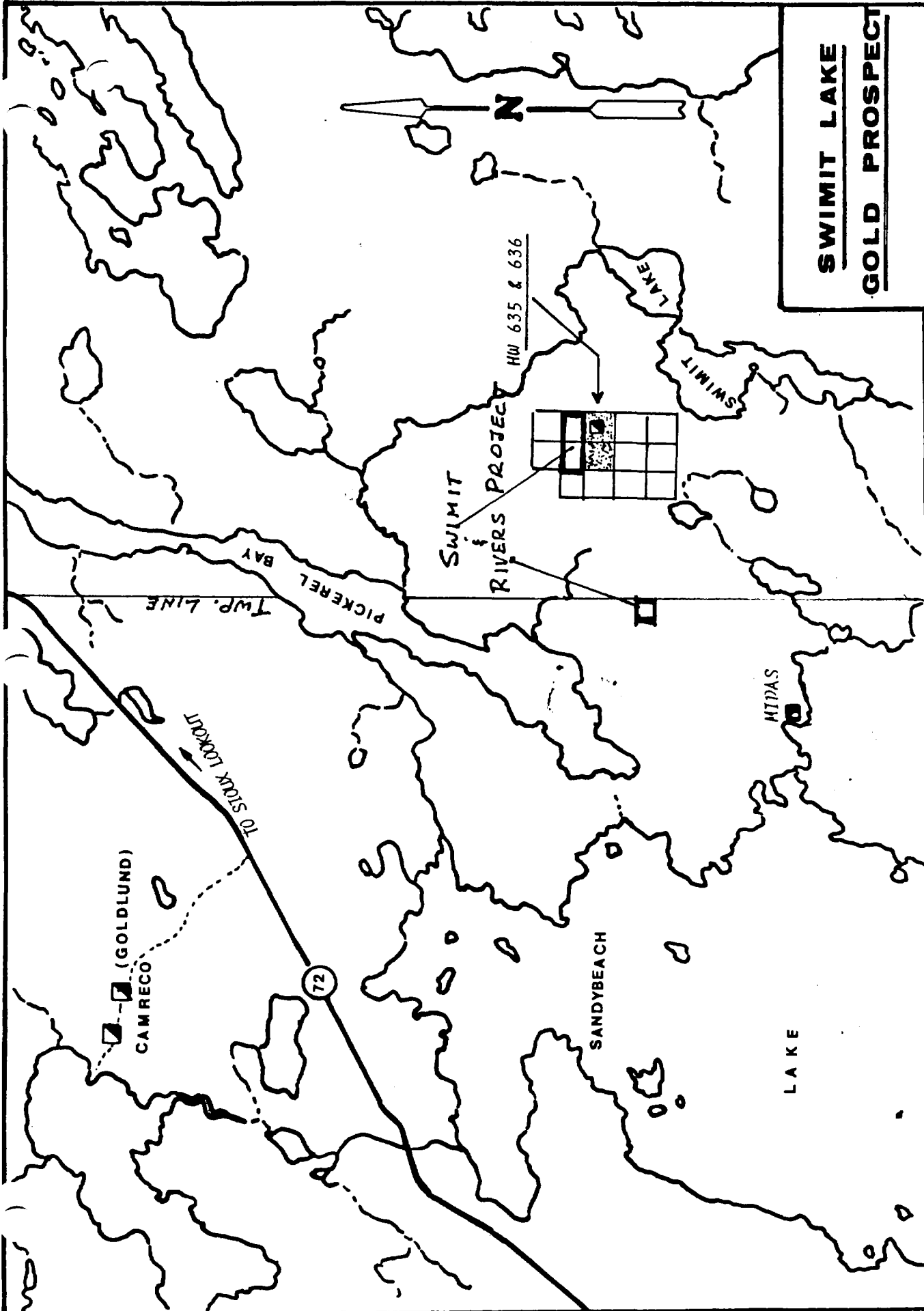

SWIMIT LAKE
GOLD PROSPECT

March 1991



SCALE IN MILES

LOCATION MAP.

FIGURE

52F16

KEIKEWABIK LAKE AREA

G-2087

	1133622*	1133621*
1133643*	SWIMIT L. PROJECT	
	PAT. HW 635	 PAT. HW 636
1133642*		
1133641*	1133637*	1133636*
1133640*	1133638*	1133639*

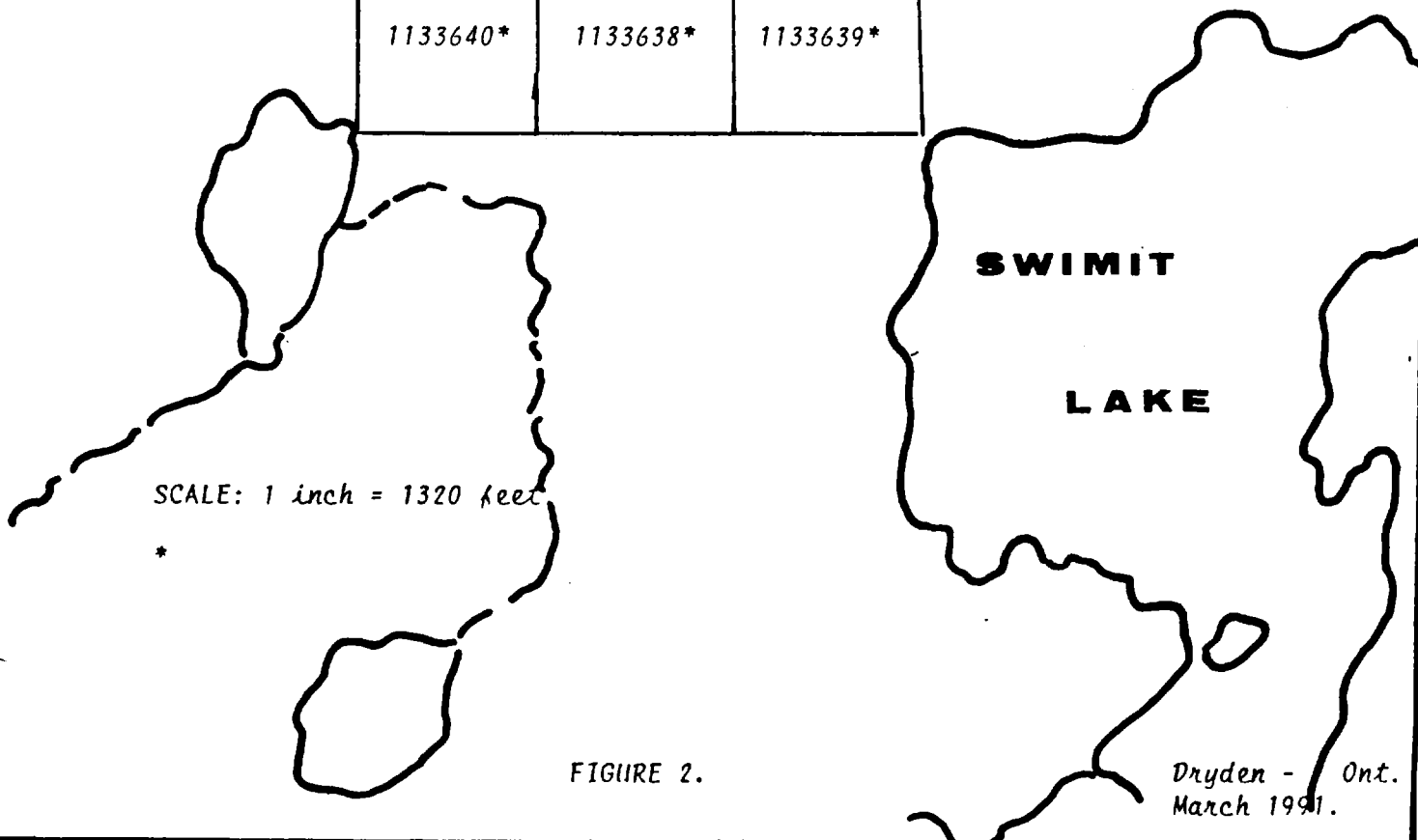

SCALE: 1 inch = 1320 feet

FIGURE 2.

Dryden - Ont.
March 1991.

SCALE: 1:8000

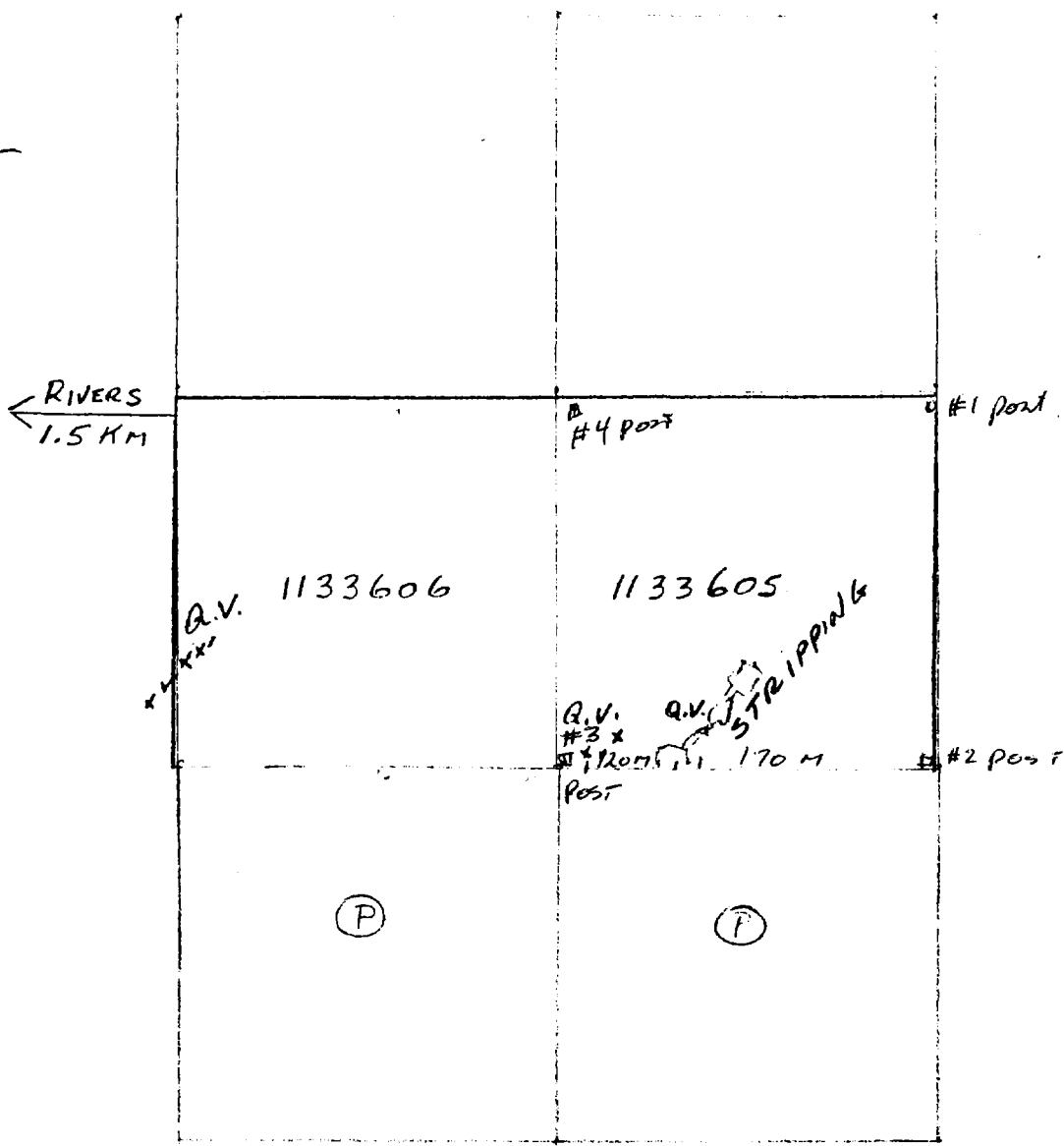

SWIMIT LAKE GOLD SHOWING

OPAP PROJECT #2

OP91-272

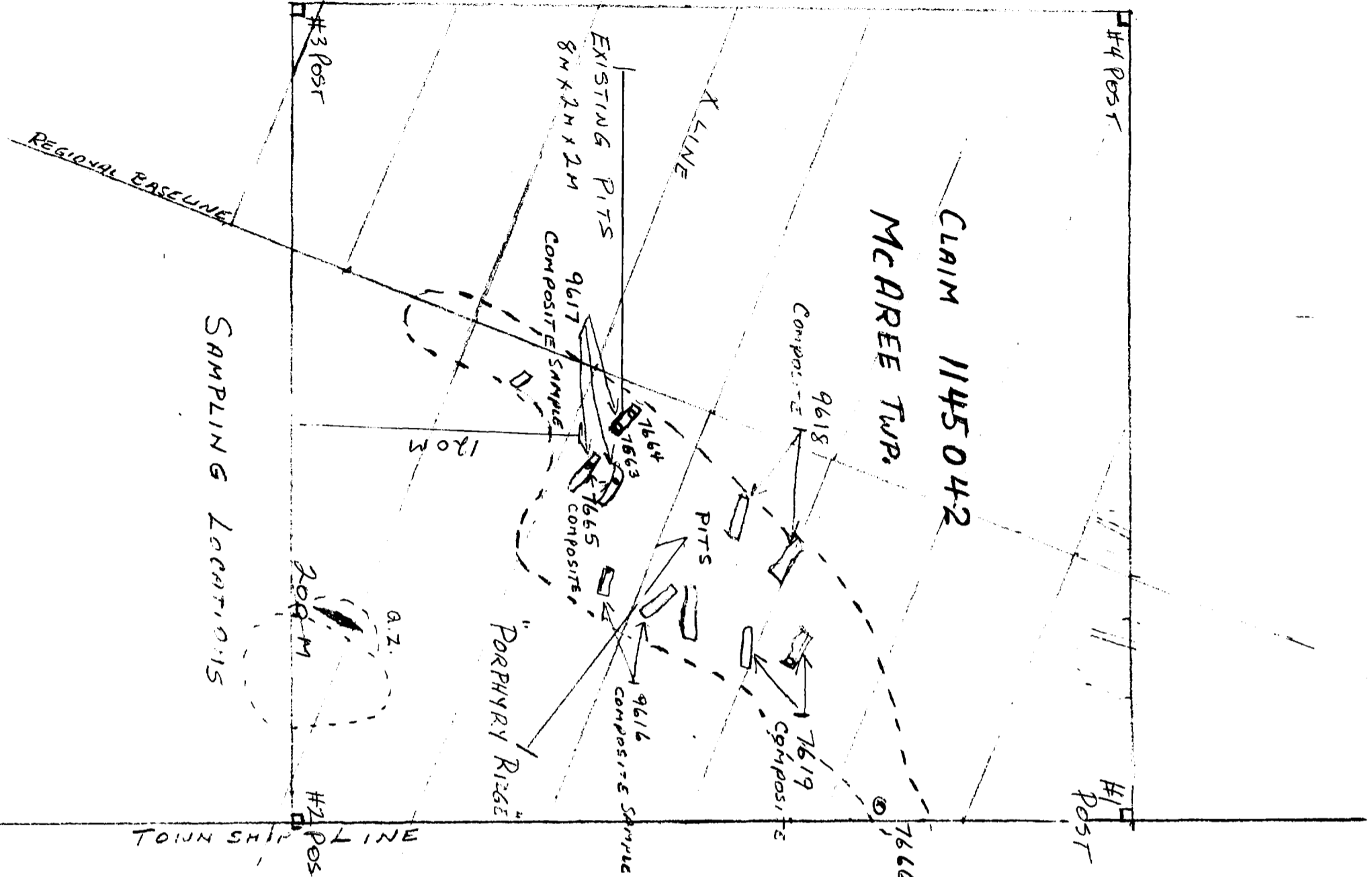

CLAIM 1145042
 McARREE TWP.

7666 KEINELMHEIT L.
 AREA

SAMPLING LOCATIONS

N
 SCALE:
 1:2400
 (1 INCH = 200 FT.)

SWIMMIT L. RIVERS
 PROJECT
 OPAP 91-272
 PATRICIA MINING
 DIVISION

SWHIT LAKE GOLD SHOWING.

MAIN ZONE TRENCHED OCT. 1991

XXXX = QUARTZ VEIN

 SAMPLE LOCATION

SCALE: 1:400

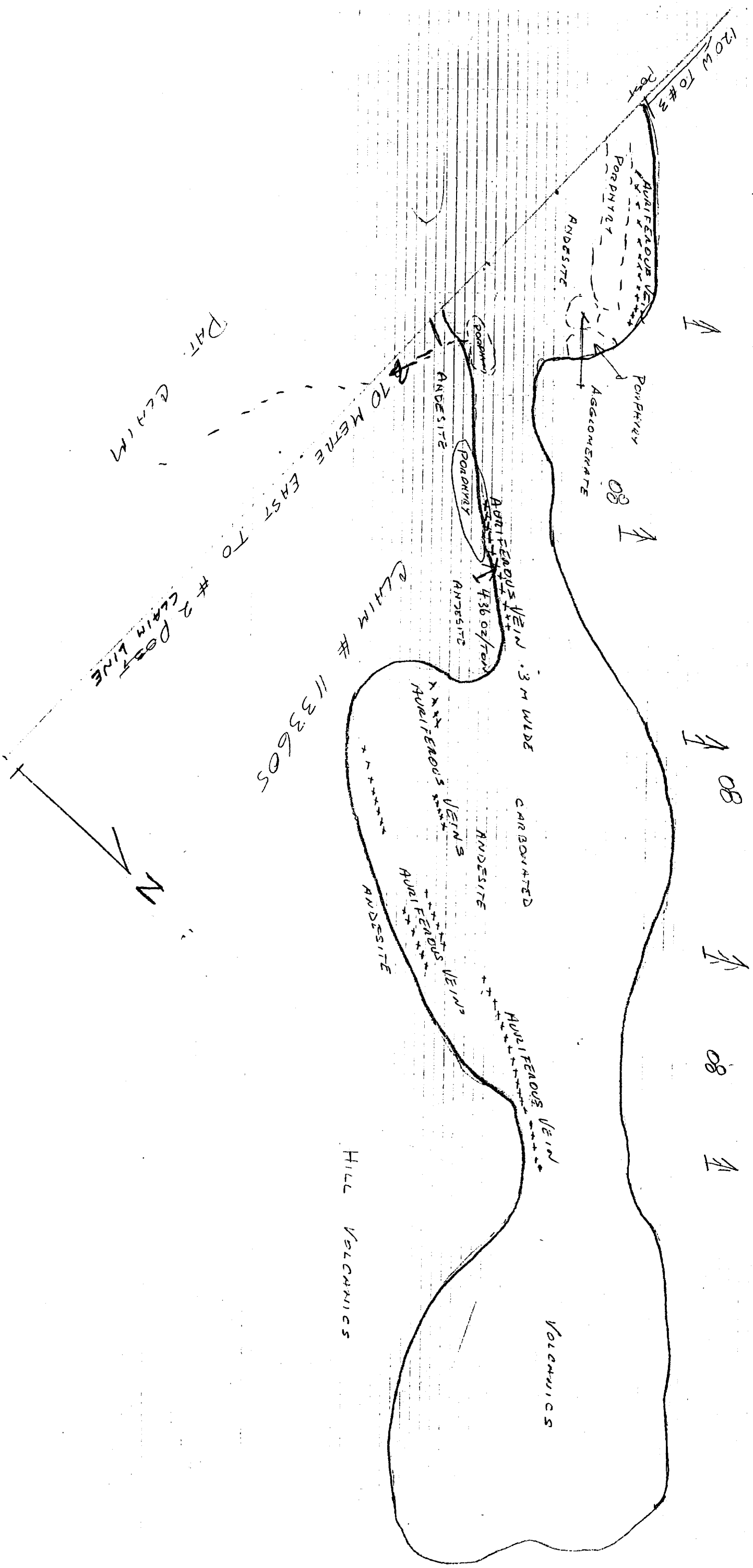

SWIMIT LAKE GOLD SHOWING.

MAIN ZONE TRENCHED Oct. 1991

XXXX = QUARTZ VEIN

● = SAMPLE LOCATION

SCALE: 1:400.

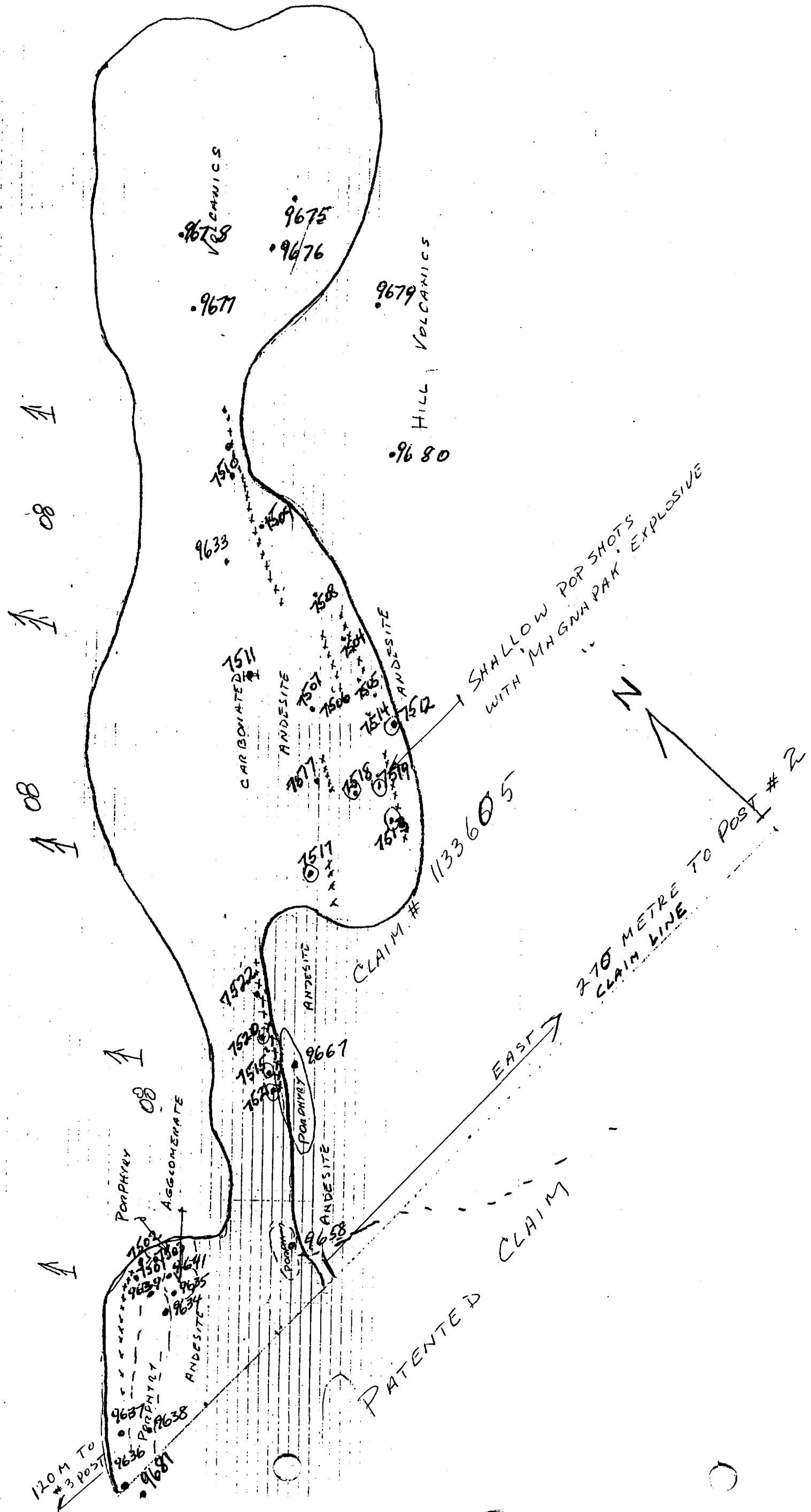



Ontario



52F16SE0005 2.14641 KEIKEWABIK LAKE

900

Ministry of
Northern Development
and Mines

Ministère du
Développement du Nord
et des Mines

Geoscience Approvals Section
Mining Lands Branch
933 Ramsey Lake Road
6th Floor
Sudbury, Ontario
P3E 6B5

Telephone: (705) 670-5853
Fax: (705) 670-5863

Our File: 2.14641
Transaction #: W9230.0024

October 6, 1992

Mining Recorder
Ministry of Northern Development
and Mines
Court House Building
PO. Box 3000
Sioux Lookout, Ontario
POV 2T0

Dear Sir:

RE: Approval of Assessment Work on mining claim PA 1133605 et al in
the Keikewabik Lake Area.

The assessment credits for assays, section 17 of the Mining Act
Regulations, as listed on the above mentioned report of work have been
approved as of September 14, 1992.

If you require any additional information please call Dale Messenger
at (705) 670-5858.

Yours sincerely,

Ron C. Gashinski
Senior Manager, Mining Lands Branch
Mines and Minerals Division

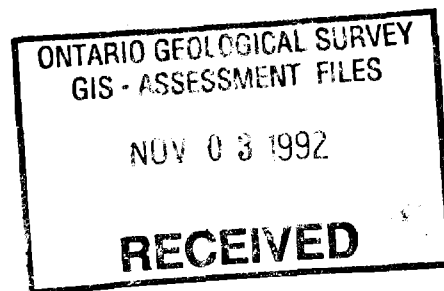

JM
DEM/jl
Enclosures:

cc: Assessment Files Office
Toronto, Ontario

Resident Geologist
Sioux Lookout, Ontario



Mining Lands

Mining Act

Personal information collected on this form is obtained under the authority of the Mining Act. This information will be used for correspondence. Questions about this collection should be directed to the Provincial Manager, Mining Lands, Ministry of Northern Development and Mines, Fourth Floor, 159 Cedar Street, Sudbury, Ontario, P3E 6A5, telephone (705) 670-7264.

2.14641

- Instructions:
- Please type or print and submit in duplicate.
 - Refer to the Mining Act and Regulations for requirements of filing assessment work or consult the Mining Recorder.
 - A separate copy of this form must be completed for each Work Group.
 - Technical reports and maps must accompany this form in duplicate.
 - A sketch, showing the claims the work is assigned to, must accompany this form.

Recorded Holder(s) ALEXANDER GLATZ		Client No. 137 014
Address 15 PARK CRESCENT, DRYDEN, ONT. P8N1T7		Telephone No.
Mining Division SIoux LOOKOUT	Township/Area HEIKENABIK L. AREA	M or G Plan No. G 2087
Dates Work Performed From: APRIL 91		To: DEC. 91

Work Performed (Check One Work Group Only)

Work Group	Type	RECORDED	AG: 59
Geotechnical Survey			
Physical Work, Including Drilling			
Rehabilitation			
Other Authorized Work			
Assays	43 SAMPLE ASSAYS		
Assignment from Reserve			

Total Assessment Work Claimed on the Attached Statement of Costs \$ 870.00

Note: The Minister may reject for assessment work credit all or part of the assessment work submitted if the recorded holder cannot verify expenditures claimed in the statement of costs within 30 days of a request for verification.

Persons and Survey Company Who Performed the Work (Give Name and Address of Author of Report)

Name	Address
CUSTOM FIRE ASSAYING	Box 253, COCHENOUR, ONT.
SWASTIKA LABORATORIES	Box 10, SWASTIKA, ONT.
WARNOCK HERSEY	WINNIPEG, MAN.
ONT. MIN. OF MINES	TORONTO

(attach a schedule if necessary) REPORT BY ALEX GLATZ, DRYDEN, ONT.

Certification of Beneficial Interest * See Note No. 1 on reverse side

I certify that at the time the work was performed, the claims covered in this work report were recorded in the current holder's name or held under a beneficial interest by the current recorded holder.	Date MARCH 1/92	Recorded Holder or Agent (Signature) <i>Alexander Glatz</i>
--	---------------------------	--

Certification of Work Report

I certify that I have a personal knowledge of the facts set forth in this Work report, having performed the work or witnessed same during and/or after its completion and annexed report is true.

Name and Address of Person Certifying
ALEXANDER GLATZ, DRYDEN

Telephone No. (507) 223-6145	Date MARCH 1/92	Certified By (Signature) <i>Alexander Glatz</i>
--	---------------------------	--

For Office Use Only

Total Value Cr. Recorded \$870.00	Date Recorded June 16, 1992	Acting Mining Recorder <i>Richard King</i>	Received Stamp RECORDED JUN 16 1992
	Deemed Approval Date Sept 16, 1992	Date Approved Sept 14/92	
	Date Notice for Amendments Sent		

Receipt _____

Work Report Number for Applying Reserve	Claim Number (see Note 2)	Number of Claim Units
	1133605	1
	1133606	1
	1133621	1
Total Number of Claims		3

Value of Assessment on this Claim	Value Applied to this Claim
784	0
60	0
26	0
Total Value Work Done	870
Total Value Work Applied	

Value Assigned from this Claim	Reserve: Work to be Claimed at a Future Date
	784
	60
	26
Total Assigned From	870
Total Reserve	

Credits you are claiming in this report may be cut back. In order to minimize the adverse effects of such deletions, please indicate from which claims you wish to prioritize the deletion of credits. Please mark (✓) one of the following:

- Credits are to be cut back starting with the claim listed last, working backwards.
- Credits are to be cut back equally over all claims contained in this report of work.
- Credits are to be cut back as prioritized on the attached appendix.

In the event that you have not specified your choice of priority, option one will be implemented.

Note 1: Examples of beneficial interest are unrecorded transfers, option agreements, memorandum of agreements, etc., with respect to the mining claims.

Note 2: If work has been performed on patented or leased land, please complete the following:

I certify that the recorded holder had a beneficial interest in the patented or leased land at the time the work was performed.	Signature <i>Warren J. [Signature]</i>	Date March 1/92
---	---	--------------------



Ministry of Northern Development and Mines

Ministère du Développement du Nord et des mines

Statement of Costs for Assessment Credit

État des coûts aux fins du crédit d'évaluation

Mining Act/Loi sur les mines

Transaction No./N° de transaction
W9230-0024

Personal information collected on this form is obtained under the authority of the Mining Act. This information will be used to maintain a record and ongoing status of the mining claim(s). Questions about this collection should be directed to the Provincial Manager, Minings Lands, Ministry of Northern Development and Mines, 4th Floor, 159 Cedar Street, Sudbury, Ontario P3E 6A5, telephone (705) 670-7264.

Les renseignements personnels contenus dans la présente formule sont recueillis en vertu de la Loi sur les mines et serviront à tenir à jour un registre des concessions minières. Adresser toute question sur la collecte de ces renseignements au chef provincial des terrains miniers, ministère du Développement du Nord et des Mines, 159, rue Cedar, 4^e étage, Sudbury (Ontario) P3E 6A5, téléphone (705) 670-7264.

1. Direct Costs/Coûts directs

Type	Description	Amount Montant	Totals Total global
Wages Salaires	Labour Main-d'oeuvre		
	Field Supervision Supervision sur le terrain		
Contractor's and Consultant's Fees Droits de l'entrepreneur et de l'expert-conseil	Type		
	13 SAMPLES		300
Supplies Used Fournitures utilisées	Type		
Equipment Rental Location de matériel	Type		
Total Direct Costs Total des coûts directs			

2. Indirect Costs/Coûts indirects

Note: When claiming Rehabilitation work Indirect costs are not allowable as assessment work. Pour le remboursement des travaux de réhabilitation, les coûts indirects ne sont pas admissibles en tant que travaux d'évaluation.

Type	Description	Amount Montant	Totals Total global
Transportation Transport	Type		
	POSTAGE	70	
			70
Food and Lodging Nourriture et hébergement			
Mobilization and Demobilization Mobilisation et démobilisation			
Sub Total of Indirect Costs Total partiel des coûts indirects			70
Amount Allowable (not greater than 20% of Direct Costs) Montant admissible (n'excédant pas 20 % des coûts directs)			
Total Value of Assessment Credit (Total of Direct and Allowable Indirect costs) Valeur totale du crédit d'évaluation (Total des coûts directs et indirects admissibles)			870

Note: The recorded holder will be required to verify expenditures claimed in this statement of costs within 30 days of a request for verification. If verification is not made, the Minister may reject for assessment work all or part of the assessment work submitted.

Note: Le titulaire enregistré sera tenu de vérifier les dépenses demandées dans le présent état des coûts dans les 30 jours suivant une demande à cet effet. Si la vérification n'est pas effectuée, le ministre peut rejeter tout ou une partie des travaux d'évaluation présentés.

Filing Discounts

- Work filed within two years of completion is claimed at 100% of the above Total Value of Assessment Credit.
- Work filed three, four or five years after completion is claimed at 50% of the above Total Value of Assessment Credit. See calculations below:

Total Value of Assessment Credit	Total Assessment Claimed
	x 0.50 =

Remises pour dépôt

- Les travaux déposés dans les deux ans suivant leur achèvement sont remboursés à 100 % de la valeur totale susmentionnée du crédit d'évaluation.
- Les travaux déposés trois, quatre ou cinq ans après leur achèvement sont remboursés à 50 % de la valeur totale du crédit d'évaluation susmentionné. Voir les calculs ci-dessous.

Valeur totale du crédit d'évaluation	Evaluation totale demandée
	x 0,50 =

Certification Verifying Statement of Costs

I hereby certify: that the amounts shown are as accurate as possible, and these costs were incurred while conducting assessment work on the lands shown on the accompanying Report of Work form.

that as RECORDED HOLDER I am authorized (Recorded Holder, Agent, Position in Company) to make this certification

Attestation de l'état des coûts

J'atteste par la présente: que les montants indiqués sont le plus exact possible et que ces dépenses ont été engagées pour effectuer les travaux d'évaluation sur les terrains indiqués dans la formule de rapport de travail ci-joint.

Et qu'à titre de _____ je suis autorisé (titulaire enregistré, représentant, poste occupé dans la compagnie) à faire cette attestation.

Signature: Alexander Pletch Date: MARCH 1/9

2. 1464 1

22 JUN 1961 A10:00

MINING RECORDER
PROSPECTS
MINING DIVISION

Swimit Lake Showing

Manual work performed by Alex Glatz, 15 Park Crescent, Dryden, Ont.

Date	Claim	Work done	Samples	Amount
91-04-01	1145042	prospecting	1	150
91-04-02	1145042	prospecting	3	150
91-04-25	1133606	prospecting	5	150
91-06-25	1133606	prospecting + mapping	-	150
91-07-09	1133605	prospecting	6	150
91-07-20	1133605	prospecting + mapping	-	150
91-08-05	et al	recon prospecting on fringe claims		150
91-09-07	1133605	locate area for stripping		150
91-09-18		recon prospecting + find access trail		150
91-10-21		supervising backhoe work		150
91-10-22		supervising backhoe work		150
91-10-23		supervising backhoe work	10	150
91-10-24		supervising backhoe work		150
91-10-26		checking new exposures	14	150
91-10-28		blasting new exposures	10	150
91-11-25		mapping stripped area		150

Total

\$ 2400

Backhoe work - Swimit Lake

Performed by:

Kupper Contracting Limited
General Delivery,
Waldhof, Ontario
POV 2X0
1-(807)-227-2194

<u>Dates:</u>	<u>Hours</u>	<u>\$/Hr.</u>	<u>Total \$</u>
91-10-21	8	54.00	432.00
91-10-22	10	54.00	540.00
91-10-23	10	54.00	540.00
91-10-24	10	54.00	540.00
		TOTAL	2052.00
		GST	143.00
		TOTAL EXPENSE	<u>\$2195.00</u>

TRENCHES

All 7 trenches in the stripped area were made with "MAGNAPAK" explosives to obtain fresh sample material.

These are small, shallow openings, approximately .10 - .12m deep and .3m in diameter and their location corresponds to the sample locations of sample #7515 to #7521.

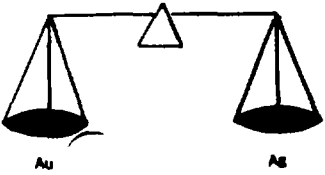

PAUL'S CUSTOM FIRE ASSAYING LTD.

Phone: Bus. (807) 662-8171

Res. (807) 662-3361

Fax: (807) 662-1155

PAUL OKANSKI, Assayer
Box 253, Cochenour, Ontario POV 1L0

Glatz

ASSAY CERTIFICATE

Date: Apr. 15, 1991.

	Sample No.	Description	oz/ton Au	oz/ton Ag
1	9610		Trace	NIL
2				
3				
4				
5				
6				
7				
8				
9				
10				
11				
12				
13				
14				
15				
16				
17				
18				
19				
20				
21				
22				
23				
24				
25				

Assayer: J. Okanski

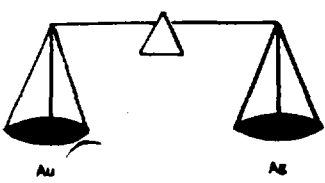

PAUL'S CUSTOM FIRE ASSAYING LTD.

Phone: Bus. (807) 662-8171

Res. (807) 662-3361

Fax: (807) 662-1155

PAUL OKANSKI, Assayer
Box 253, Cochenour, Ontario POV 1L0

ASSAY CERTIFICATE

Date: May 2-91

A. Glatz

	Sample No.	Description	oz/ton Au	oz/ton Ag
1	9616		Trace	
2	17		.68	Nil
3	18		Trace	
4	19		"	Nil
5				
6				
7				
8				
9				
10				
11				
12				
13				
14				
15				
16				
17				
18				
19				
20				
21				
22				
23				
24				
25				

Assayer:

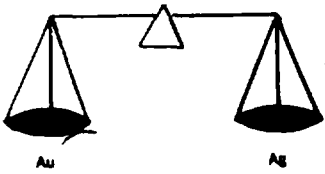

PAUL'S CUSTOM FIRE ASSAYING LTD.

Phone: Bus. (807) 662-8171

Res. (807) 662-3361

Fax: (807) 662-1155

PAUL OKANSKI, Assayer
Box 253, Cochenour, Ontario POV 1L0

A. Glatz

ASSAY CERTIFICATE

Date: Sept. 18-91

Sample No.	Description	oz/ton Au	oz/ton Ag
1	9632 ✓	Trace	
2	33	.48	
3	34	Trace	
4	35	"	
5	36	3.20	
6			
7			
8			
9			
10			
11			
12			
13			
14			
15			
16			
17			
18			
19			
20			
21			
22			
23			

Handwritten note: 9632 is 10.48

Assayer: *Paul Okanski*



Established 1928

Swastika Laboratories

A Division of Assayers Corporation Ltd.

Assaying - Consulting - Representation

Geochemical Analysis Certificate

1W-4043-RG1

Company: **A. GLATZ**

Date: **SEP-30-91**

Project:

Copy 1. 15 Park Cres. Dryden, Ont. P8N 1T7

Attn:

We hereby certify the following Geochemical Analysis of 7 rock samples submitted SEP-24-91 by .

Sample Number	Au PPB	Au check PPB	Ag PPM
9630 <i>T sample</i>	Nil		0.3
9637 ✓	689	614	11.3
9638 ✓	Nil		0.2
9639 ✓	3994		0.9
9640	Nil		0.8
9641 ✓	18789	19680	7.9
9642 <i>T sample</i>	Nil		0.1

*Swastika Laboratories
T sample - 9/29/91*

Certified by Donna Gardner

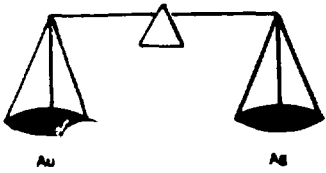

PAUL'S CUSTOM FIRE ASSAYING LTD.

Phone: Bus. (807) 662-8171
Res. (807) 662-3361
Fax: (807) 662-1155

PAUL OKANSKI, Assayer
Box 253, Cochenour, Ontario POV 1L0

ASSAY CERTIFICATE

Date: Oct. 28-91

A. Glatz

Sample No.	Description	oz/ton Au	oz/ton Ag
1	7501 ✓	Trace	1.06
2	02	"	1.50
3	03	.01	NIL
4	04	.14	"
5	05	Trace	"
6	06	.02	"
7	07	.14	"
8	08	.14	"
9	09	Trace	"
10	10	"	"
	11	"	"
12	12	1.22	"
13	13	.96	"
14	14	.14	"
15	15	4.36	"
16	9660	Trace	1.52
17	61	"	1.36
18	62	"	.90
19			
20			
21			
22			
23			

Assayer: *Paul Okanski*

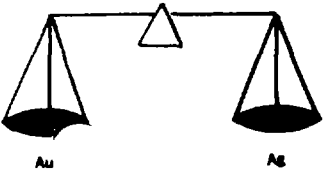

PAUL'S CUSTOM FIRE ASSAYING LTD.

Phone: Bus. (807) 662-8171
Res. (807) 662-3361
Fax: (807) 662-1155

PAUL OKANSKI, Assayer
Box 253, Cochenour, Ontario POV 1L0

A. Glatz

ASSAY CERTIFICATE

Date: Nov. 6-91

	Sample No.	Description	oz/ton Au	oz/ton Ag
1	9663		.98	10.18
2	65		.54	3.56
3	65		.20	4.46
4	66		Trace	2.02
5				
6				
7				
8				
9				
10				
11				
12				
13				
14				
15				
16				
17				
18				
19				
20				
21				
22				
23				
24				

Assayer: *Paul Okanski*



Swastika Laboratories

A Division of Assayers Corporation Ltd.

Established 1928

Assaying - Consulting - Representation

Geochemical Analysis Certificate

1W-4370-RG1

Company: **ALEX GLATZ**

Date: NOV-11-91

Project:

Copy 1. 15 Park Cressent, Dryden, Ont. P8N 1T7

Attn:

We hereby certify the following Geochemical Analysis of 11 rock samples submitted NOV-04-91 by .

Sample Number	Au PPB	Au check PPB	Au 2nd PPB	Ag PPM
7516	3261			
7517	5760	5486		
7518	31			
7519	2537			
7520	11246			
7521	26400	25989	36857	
7522	8983			
9667	408			0.8
9668	62			0.1
9669	Nil			0.4
9670	Nil			0.1

Temple

Certified by *Donna Gordon*

KABIK LAKE & PICKEREL TWP. G-2079

LEGEND

- HIGHWAY AND ROUTE No.
- OTHER ROADS 92 OCT 21 P 2-9
- TRAILS
- SURVEYED LINES
- TOWNSHIPS BASE LINES
- LOTS MINING CLAIMS PARCELS ETC.
- UNSURVEYED LINES
- LOT LINES
- PARCEL BOUNDARY
- MINING CLAIMS ETC.
- RAILWAY AND RIGHT OF WAY
- UTILITY LINES
- NON PERENNIAL STREAM
- FLOODING OR FLOODING RIGHTS
- SUBDIVISION OR COMPOSITE PLAN
- RESERVATIONS
- ORIGINAL SHORELINE
- MARSH OR MUSKEG
- MINES
- TRAVERSE MONUMENT

DISPOSITION OF CROWN LANDS

TYPE OF DOCUMENT	SYMBOL
PATENT SURFACE & MINING RIGHTS	●
SURFACE RIGHTS ONLY	○
MINING RIGHTS ONLY	◐
LEASE SURFACE & MINING RIGHTS	◑
SURFACE RIGHTS ONLY	◒
MINING RIGHTS ONLY	◓
LICENCE OF OCCUPATION	◔
ORDER IN COUNCIL	◕
RESERVATION	◖
CANCELLED	◗
SAND & GRAVEL	◘

REFERENCES

AREAS WITHDRAWN FROM DISPOSITION

- M + D MINING RIGHTS ONLY
- S + R SURFACE RIGHTS ONLY
- M + S MINING AND SURFACE RIGHTS

Description	Order No.	Date	Disposition	File
	27/82	11/2/82	S + R	11-202
	28/82	8/2/82	S + R	11-202

JUNE 12, 1984

THE 12, 1984

Nov 11/87

Aug 19/87

88/01/06

4-10-87

Oct 23/87

Dec 28/89

16-2/90

RECEIVED

OCT 27 1992

MINING LANDS BRANCH

SCALE 1 INCH = 40 CHAINS

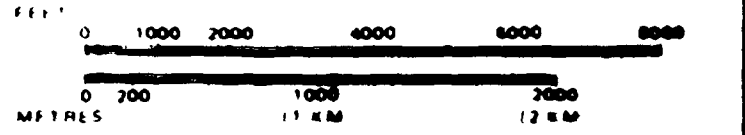

AREA KEIKEWABIK LAKE

MINING DIVISION

M + N R ADMINISTRATIVE DISTRICT

SIoux LOOKOUT/IGNACE

MINING DIVISION

KENORA - PATRICIA

LAND TITLES / REGISTRY DIVISION

KENORA

Ontario Ministry of Natural Resources Land Management Branch

Date FEBRUARY, 1984

Number G-2087

THE INFORMATION THAT APPEARS ON THIS MAP HAS BEEN COMPILED FROM VARIOUS SOURCES, AND ACCURACY IS NOT GUARANTEED. THOSE WISHING TO STAKE MINING CLAIMS SHOULD CONSULT WITH THE MINING RECORDER, MINISTRY OF NORTHERN DEVELOPMENT AND MINES, FOR ADDITIONAL INFORMATION ON THE STATUS OF THE LANDS SHOWN HEREON.

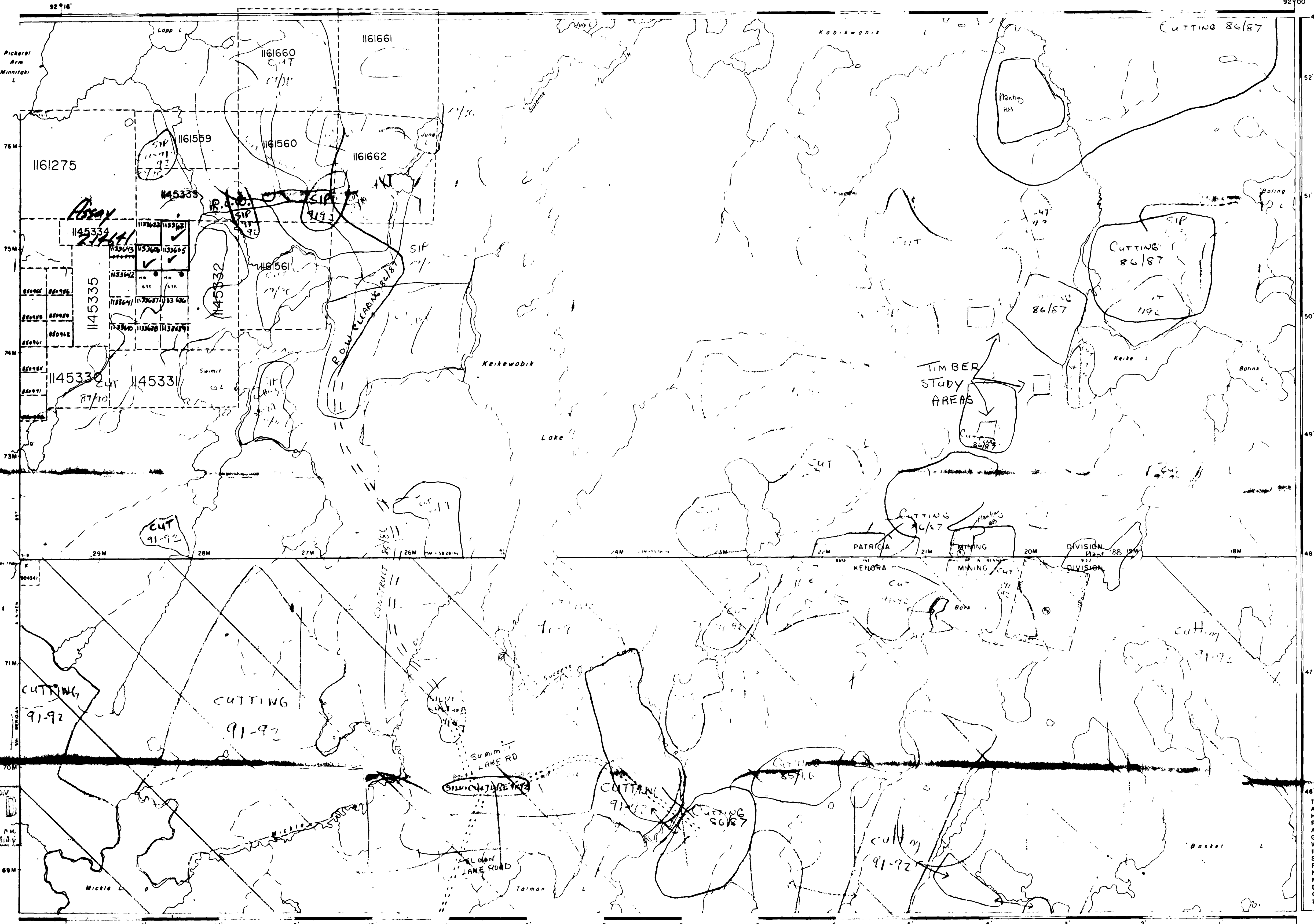

MCAREE TWP. G-5369

PATRICIA Mining Division

LARD LAKE G-2099

KENORA Mining Division
SUZANNE LAKE G-2562

PATRICIA Mining Division
RECORDED
MAY 25 1984



200

497921 8 part of 4:7922