



52F16SE0006 63.5701 MCAREE

010

OPAP91 - 272

Prospecting Report

Swimit Lake - Rivers

Project

By

Alex Glatz

MINING RECORDER
PATRICIA
MINING DIVISION

32 MAR 24 4 9 : 34

Property:

This project consists of 3 unpatented mining claims. Two claims, 1133605 and 1133606, are on the Swimit Lake or Schmidt showing and claim 1145042 covers the Rivers showing 1.8 km to the southwest.

Location:

The claims are located in the Keikewabik Lake area and in McAree Township in the Patricia Mining Division, south of Sioux Lookout.

Access:

Road access exists to within .6 km of claim 1133605. Canadian Pacific Forest Products built this forest access road in 1988 and 1989. From Dryden the property can be reached via Hwy. 17 to Tache and from there a high standard forest access road runs north to Swimit Lake. Travel distance is 100 km.

The road is not plowed all the way in the wintertime and the last 8 km may have to be travelled by snowmobile. The Rivers showing is one hours walking through the bush from Swimit Lake. However, since a windstorm hit the area in the summer of 1991 traversing the ground is much more difficult now. There also is a bulldozed trail leading to this showing from the southwest for a distance of 16 km, originating from a gravel road in McFie Twp. The trail crosses a creek which freezes over in the winter, making access by snowmobile possible.

Regional Geology:

The Sioux Lookout District is underlain by a north-east trending belt of folded greenstones and sediments, about 24 km wide and 80 km long which is surrounded and locally intruded by granite and related rocks. In this assemblage are three parallel belts of volcanic rocks and two of sediments. Most of the important gold occurrences and deposits found to date are related to a belt of felsic intrusive rocks in Echo, Pickerel and Jordan Townships which cut the central greenstone volcanic belt. The Goldlund property, now under exploration by Noranda, lies within the central volcanic belt in Echo Township. The Rivers (Wallbridge) property lies in the most southerly greenstone belt, about 6 km southeast of the central belt. The Swimit Lake (Schmidt) showing and the Midas occurrence also occur in this greenstone belt.

Local Geology:

The area is underlain by pillow lavas, basic flows, series of intermediate to acid flows and agglomerates, intruded by porphyries at the Swimit Lake property.

At the Rivers property, the one claim is underlain by andesite and porphyries.

The porphyry is silicified in places and hosts a large number of quartz veins. Shearing occurred along the contact of the lava and porphyry, and pockets of sulfides are often concentrated in the sheared colcanics.

Work done:

A total of 43 samples were taken and analysed for gold and some were tested for silver. A planned geophysical survey had to be shelved as a windstorm flattened much of the timber on the upper slopes, making grid layout very difficult and expensive. Also, the airborne geophysics look very flat.

Using a backhoe, trenching was done along the suspected strike of the high grade zone occurring on patented ground immediately south of 1133605. The zone was trenched for 350 ft. where it pinched out.

While the zone is offset by a number of small porphyry dikes within the alteration zone, a number of small parallel and en echelon quartz veins have been uncovered by the trenching. Some of the veins yielded high assays in gold with the highest being 4.36 oz/ton Au across .3m.

On claim 1145042 (Rivers) an array of old trenches were tested by composite sampling to find the gold bearing veins. This was successful when samples taken from 3 trenches with similar quartz and silicification assayed .68 oz/t gold. Subsequent detailed sampling of these 3 trenches showed that each of them carried gold, with the highest value being .98 oz/t gold and 10.18 oz/t silver. This corresponds with old reports of drilling where Teck Corporation intersected .7 oz/t gold over 4 feet 30 years ago.

Conclusions and recommendations:

Having found two areas of high grade gold mineralization makes these claims candidates for further exploration and drilling.

On the Swimit showing drilling would be the next step but should be done in conjunction with the known gold zone on the patented lot to the south. The owner of the ground has been contacted and seems to be interested in a joint option deal with a company.

A major exploration firm is interested in the ground and a meeting is scheduled to discuss terms

Swimit Lake and Rivers project
Sample description.

<u>Sample #</u>	<u>Sample type</u>	<u>Rock type</u>	<u>Mineralization</u>	<u>Au</u>	<u>Ag</u>
9616	Composite	Sheared Quartz	1% py	Trace	
9617	Composite	Quartz	Minor galena	.68 oz/t	Nil
9618	Composite	Acidic rock	Minor sulfides	Trace	
9619	Composite	Porphyry	Minor sulfides	Trace	Nil
9620	Grab	Agglomerate	Fine sulfides	Nil	
9621	Grab	Andesite	Minor sulfides	30 ppb	
9632	Grab	Basalt	3% sulfide	Trace	
9633	Grab	Grey quartz	Minor sulfides	.48 oz/t	
9634	Grab	Dark dike	Minor sulfides	Trace	
9635	Grab	Breccia	Specks of py	Trace	
9636	Grab	Sheared quartz	6% sphalerite	3.20 oz/t	
9637	Grab	Quartz	1% sp, pb, cp	689 ppb	11.3 ppm
9638	Grab	Porphyry	Minor py	Nil	.2 ppm
9639	Chip	Blue quartz	Specks of sulfides	3994 ppb	.9 ppm
9641	Grab	Loose quartz	1% sphalerite	19680 ppb	7.9 ppm
9663	Comp. gr.	Quartz	Minor pb	.98 oz/t	10.18 oz/t
9664	Chip 1.5m	Quartz & porph.	Minor py, cp, pb	.54 oz/t	3.56 oz/t
9665	Grab	Silic. porphyry	Nil	.20 oz/t	4.46 oz/t
9666	Grab	Sheared porphyry	1% py, carbonate	Trace	2.02 oz/t
9667	Grab	Black rock	2% py	62 ppb	.8 ppm
9681	Grab	Quartz & wallrock	Sphalerite & galena	1.02 oz/t	
7501	Grab	Quartz	Py, gal.	Trace	1.6 oz/t
7502	Grab	Wallrock	Py, carbonate	Trace	1.50 oz/t
7503	Grab	Quartz & lava	Minor cp	.01 oz/t	Nil
7504	Chip 1.0m	Andesite & quartz	Minor sulfides	.14 oz/t	
7505	Chip .6m	Quartz, 10% wallr.	Minor sulfides	Trace	Nil
7506	Chip 1.0m	Andesite	Minor cp	.02 oz/t	Nil
7507	Chip 1.0m	Quartz vein	Py, gal	.14 oz/t	Nil
7508	Chip 1.0m	Vein & wallrock	Minor py	.14 oz/t	Nil
7509	Chip 1.2m	Black rock	-	Trace	Nil
7510	Chip .1m	Quartz	-	Trace	Nil
7511	Chip 2.0m	Shear. andes. & gab.	Minor py	Trace	Nil
7512	Grab	Quartz & andesite	Cp, gal	1.22 oz/t	Nil

Swimit Lake and Rivers project
Sample description

<u>Sample #</u>	<u>Sample type</u>	<u>Rock type</u>	<u>Mineralization</u>	<u>Au</u>	<u>Ag</u>
7513	Chip .3m	Quartzvein	Cp, gal.	.96 oz/t	Nil
7514	Chip 1.0m	Quartz & wall	Minor sulfides	.14 oz/t	Nil
7515	Chip .3m	Quartzvein	Minor gal.	4.36 oz/t	Nil
7516	Chip .3m	Wallrock&Q	Minor sulfides	3261 ppb	
7517	Chip .3m	Silic. rock	Minor sulfides	5760 ppb	
7518	Chip .3m	Alt. lava	-	31 ppb	
7519	Chip .3m	Quartzvein	Minor sulfides	2537 ppb	
7520	Chip .3m	Q & wallrock	Py, cp, gal	11246 ppb	
7521	Chip .3m	Quartz	Minor sulfides	26400 ppb	
7522	Cip .15m	Quartz	Py, cp, gal	8983 ppb	



LIB Mining Act

Personal information collected on this form is obtained under the authority of the Mining Act. This information will be used for the purposes of the Mining Act. This collection should be directed to the Provincial Manager, Mining Lands, 1 Sudbury, Ontario, P3E 6A5, telephone (705) 670-7264.



52F16SE0006 63.5701 MCAREE

900

- Instructions:**
- Please type or print and submit in duplicate.
 - Refer to the Mining Act and Regulations for Recorder.
 - A separate copy of this form must be completed for each Work Group.
 - Technical reports and maps must accompany this form in duplicate.
 - A sketch, showing the claims the work is assigned to, must accompany this form.

Recorded Holder(s) <i>ALEXANDER GLATZ</i>		Client No. <i>137014</i>
Address <i>15 PARK CRESCENT, DRYDEN, ONT. P8N 1T7</i>		Telephone No. <i>(807) 223 6145</i>
Mining Division <i>SIOUX LOOKOUT</i>	Township/Area <i>KEIKEWABIK L. AREA</i>	M or G Plan No. <i>G 2087</i>
Dates Work Performed From: <i>APRIL 1991</i>		To: <i>DEC. 1991</i>

Work Performed (Check One Work Group Only)

Work Group	Type
Geotechnical Survey	
Physical Work, Including Drilling	<i>STRIPPING, TRENCHING, SAMPLING & MAPPING</i>
Rehabilitation	
Other Authorized Work	
Assays	
Assignment from Reserve	

Total Assessment Work Claimed on the Attached Statement of Costs \$ 5462

Note: The Minister may reject for assessment work credit all or part of the assessment work submitted if the recorded holder cannot verify expenditures claimed in the statement of costs within 30 days of a request for verification.

Persons and Survey Company Who Performed the Work (Give Name and Address of Author of Report)

Name	Address
<i>GEORGE KUPPER</i>	<i>WALDHOE, VERMILION BAY, ONT.</i>
<i>A. GLATZ</i>	<i>DRYDEN</i>

(attach a schedule if necessary)

Certification of Beneficial Interest * See Note No. 1 on reverse side

I certify that at the time the work was performed, the claims covered in this work report were recorded in the current holder's name or held under a beneficial interest by the current recorded holder.	Date <i>MARCH 1/92</i>	Recorded Holder or Agent (Signature) <i>Alexander Glatz</i>
--	---------------------------	--

Certification of Work Report

I certify that I have a personal knowledge of the facts set forth in this Work report, having performed the work or witnessed same during and/or after its completion and annexed report is true.		
Name and Address of Person Certifying <i>A. GLATZ, DRYDEN</i>		
Telephone No. <i>(807) 223-6145</i>	Date <i>MARCH 1/92</i>	Certified By (Signature) <i>Alexander Glatz</i>

For Office Use Only

Total Value Cr. Recorded <i>\$5462.00</i>	Date Recorded <i>June 16, 1992</i>	Mining Recorder <i>Richard Kump</i>	Received Stamp RECORDED JUN 16 1992
	Deemed Approval Date <i>Sept 16, 1992</i>	Date Approved <i>June 16, 1992</i>	
	Date Notice for Amendments Sent		
			Receipt _____

Statement of Costs for Assessment Credit

Transaction No./N° de transaction
W9230-0023

État des coûts aux fins du crédit d'évaluation

Mining Act/Loi sur les mines

Personal information collected on this form is obtained under the authority of the Mining Act. This information will be used to maintain a record and ongoing status of the mining claim(s). Questions about this collection should be directed to the Provincial Manager, Minings Lands, Ministry of Northern Development and Mines, 4th Floor, 159 Cedar Street, Sudbury, Ontario P3E 6A5, telephone (705) 670-7264.

Les renseignements personnels contenus dans la présente formule sont recueillis en vertu de la Loi sur les mines et serviront à tenir à jour un registre des concessions minières. Adresser toute question sur la collecte de ces renseignements au chef provincial des terrains miniers, ministère du Développement du Nord et des Mines, 159, rue Cedar, 4^e étage, Sudbury (Ontario) P3E 6A5, téléphone (705) 670-7264.

1. Direct Costs/Coûts directs

Type	Description	Amount Montant	Totals Total global
Wages Salaires	Labour 16 x 150 Main-d'oeuvre	2400	
	Field Supervision Supervision sur le terrain		2400
Contractor's and Consultant's Fees Droits de l'entrepreneur et de l'expert-conseil	Type		
Supplies Used Fournitures utilisées	Type		
	EXPLOSIVES	60	
			60
Equipment Rental Location de matériel	Type		
	BACKHOE	2200	
			2200
Total Direct Costs Total des coûts directs			4660

2. Indirect Costs/Coûts indirects

** Note: When claiming Rehabilitation work Indirect costs are not allowable as assessment work. Pour le remboursement des travaux de réhabilitation, les coûts indirects ne sont pas admissibles en tant que travaux d'évaluation.

Type	Description	Amount Montant	Totals Total global
Transportation Transport	Type		
	TRUCK	120	
			120
Food and Lodging Nourriture et hébergement	FOOD #10 x 16	160	160
Mobilization and Demobilization Mobilisation et démoblisation	BACKHOE	522	522
Sub Total of Indirect Costs Total partiel des coûts indirects			802
Amount Allowable (not greater than 20% of Direct Costs) Montant admissible (n'excédant pas 20 % des coûts directs)			932
Total Value of Assessment Credit (Total of Direct and Allowable Indirect costs) Valeur totale du crédit d'évaluation (Total des coûts directs et indirects admissibles)			5462

Note: The recorded holder will be required to verify expenditures claimed in this statement of costs within 30 days of a request for verification. If verification is not made, the Minister may reject for assessment work all or part of the assessment work submitted.

Note : Le titulaire enregistré sera tenu de vérifier les dépenses demandées dans le présent état des coûts dans les 30 jours suivant une demande à cet effet. Si la vérification n'est pas effectuée, le ministre peut rejeter tout ou une partie des travaux d'évaluation présentés.

Filing Discounts

1. Work filed within two years of completion is claimed at 100% of the above Total Value of Assessment Credit.
2. Work filed three, four or five years after completion is claimed at 50% of the above Total Value of Assessment Credit. See calculations below:

Total Value of Assessment Credit	Total Assessment Claimed
	x 0.50 =

Remises pour dépôt

1. Les travaux déposés dans les deux ans suivant leur achèvement sont remboursés à 100 % de la valeur totale susmentionnée du crédit d'évaluation.
2. Les travaux déposés trois, quatre ou cinq ans après leur achèvement sont remboursés à 50 % de la valeur totale du crédit d'évaluation susmentionné. Voir les calculs ci-dessous.

Valeur totale du crédit d'évaluation	Evaluation totale demandée
5462	2731

Certification Verifying Statement of Costs

I hereby certify: that the amounts shown are as accurate as possible and these costs were incurred while conducting assessment work on the lands shown on the accompanying Report of Work.

that as RECORDED HOLDER I am authorized (Recorded Holder, Agent, Position in Company) to make this certification

Attestation de l'état des coûts

J'atteste par la présente : que les montants indiqués sont le plus exact possible et que ces dépenses ont été engagées pour effectuer les travaux d'évaluation sur les terrains indiqués dans la formule de rapport de travail ci-joint.

Et qu'à titre de _____ je suis autorisé (titulaire enregistré, représentant, poste occupé dans la compagnie) à faire cette attestation.

Signature: [Signature] Date: MARCH 1/92

92 JUN 16 A10:00

MINING RECORDER
PATRICIA
MINING DIVISION

Swimit Lake Showing

Manual work performed by Alex Glatz, 15 Park Crescent, Dryden, Ont.

Date	Claim	Work done	Samples	Amount
91-04-01	1145042	prospecting	1	150
91-04-02	1145042	prospecting	3	150
91-04-25	1133606	prospecting	5	150
91-06-25	1133606	prospecting + mapping	-	150
91-07-09	1133605	prospecting	6	150
91-07-20	1133605	prospecting + mapping	-	150
91-08-05	et al recon	prospecting on fringe claims		150
91-09-07	1133605	locate area for stripping		150
91-09-18	recon	prospecting + find access trail		150
91-10-21		supervising backhoe work		150
91-10-22		supervising backhoe work		150
91-10-23		supervising backhoe work	10	150
91-10-24		supervising backhoe work		150
91-10-26		checking new exposures	14	150
91-10-28		blasting new exposures	10	150
91-11-25		mapping stripped area		150

Total

\$ 2400

Backhoe work - Swimit Lake

Performed by:

Kupper Contracting Limited
General Delivery,
Waldhof, Ontario
POV 2X0
1-(807)-227-2194

<u>Dates:</u>	<u>Hours</u>	<u>\$/Hr.</u>	<u>Total \$</u>
91-10-21	8	54.00	432.00
91-10-22	10	54.00	540.00
91-10-23	10	54.00	540.00
91-10-24	10	54.00	540.00
		TOTAL	2052.00
		GST	143.00
		TOTAL EXPENSE	<u>\$2195.00</u>

TRENCHES

All 7 trenches in the stripped area were made with "MAGNAPAK" explosives to obtain fresh sample material.

These are small, shallow openings, approximately .10 - .12m deep and .3m in diameter and their location corresponds to the sample locations of sample #7515 to #7521.

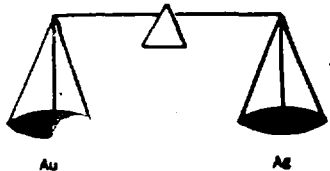

PAUL'S CUSTOM FIRE ASSAYING LTD.

Phone: Bus. (807) 662-8171
Res. (807) 662-3361
Fax: (807) 662-1155

PAUL OKANSKI, Assayer
Box 253, Cochenour, Ontario P0V 1L0

A. Glatz

ASSAY CERTIFICATE

Date: Apr. 15, 1991.

	Sample No.	Description	oz/ton Au	oz/ton Ag
1	9610		Trace	NIL
2				
3				
4				
5				
6				
7				
8				
9				
10				
11				
12				
13				
14				
15				
16				
17				
18				
19				
20				
21				
22				
23				
24				
25				

Assayer: *J. Okanski*

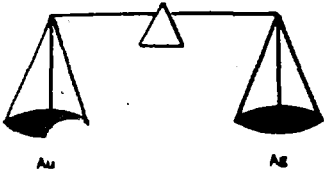

PAUL'S CUSTOM FIRE ASSAYING LTD.

Phone: Bus. (807) 662-8171

Res. (807) 662-3361

Fax: (807) 662-1155

PAUL OKANSKI, Assayer
Box 253, Cochenour, Ontario POV 1L0

ASSAY CERTIFICATE

Date: May 2-91

A. Glatz

Sample No.	Description	oz/ton Au	oz/ton Ag
1	9616	Trace	
2	17	.68	Nil
3	18	Trace	
4	19	"	Nil
5			
6			
7			
8			
9			
10			
11			
12			
13			
14			
15			
16			
17			
18			
19			
20			
21			
22			
23			
24			
25			

Assayer: *Paul Okanski*

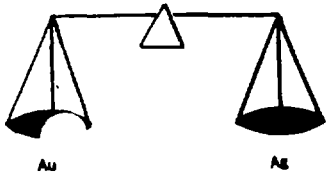

PAUL'S CUSTOM FIRE ASSAYING LTD.

Phone: Bus. (807) 662-8171
Res. (807) 662-3361
Fax: (807) 662-1155

PAUL OKANSKI, Assayer
Box 253, Cochenour, Ontario P0V 1L0

A. Glatz

ASSAY CERTIFICATE

Date: Sept. 18-91

	Sample No.	Description	oz/ton Au	oz/ton Ag
1	9632		Trace	
2	33	<i>Specimen at hand</i>	.48	
3	34		Trace	
4	35		"	
5	36		3.20	
6				
7				
8				
9				
10				
12				
13				
14				
15				
16				
17				
18				
19				
20				
21				
22				
23				
25				

Assayer: *Paul Okanski*



Established 1928

Swastika Laboratories

A Division of Assayers Corporation Ltd.

Assaying - Consulting - Representation

Geochemical Analysis Certificate

1W-4043-RG1

Company: **A. GLATZ**

Date: SEP-30-91

Project:

Copy 1. 15 Park Cres. Dryden, Ont. P8N 1T7

Attn:

We hereby certify the following Geochemical Analysis of 7 rock samples submitted SEP-24-91 by .

Sample Number	Au PPB	Au check PPB	Ag PPM
9630 <i>T sample</i>	Nil		0.3
9637 ✓	689	614	11.3
9638 ✓	Nil		0.2
9639 ✓	3994		0.9
9640	Nil		0.8
9641 ✓	18789	19680	7.9
9642 <i>T sample</i>	Nil		0.1

*Swastika Laboratories
T sample 1991*

Certified by Donna Gardner

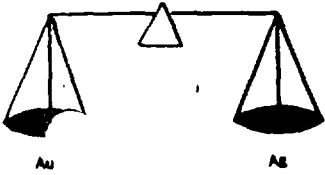

PAUL'S CUSTOM FIRE ASSAYING LTD.

Phone: Bus. (807) 662-8171

Res. (807) 662-3361

Fax: (807) 662-1155

PAUL OKANSKI, Assayer
Box 253, Cochenour, Ontario P0V 1L0

A. Glatz

ASSAY CERTIFICATE

Date: Oct. 28-91

Sample No.	Description	oz/ton Au	oz/ton Ag
1 7501		Trace	1.06
2 02		"	1.50
3 03		.01	NIL
4 04		.14	"
5 05		Trace	"
6 06		.02	"
7 07		.14	"
8 08		.14	"
9 09		Trace	"
10 10		"	"
11 11		"	"
12 12		1.22	"
13 13		.96	"
14 14		.14	"
15 15		4.36	"
16 9660		Trace	1.52
17 61		"	1.36
18 62	Temple	"	.90
19			
20			
21			
22			
23			
25			

Assayer:

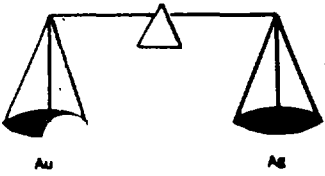

PAUL'S CUSTOM FIRE ASSAYING LTD.

Phone: Bus. (807) 662-8171

Res. (807) 662-3361

Fax: (807) 662-1155

PAUL OKANSKI, Assayer
Box 253, Cochenour, Ontario POV 1L0

A. Glatz

ASSAY CERTIFICATE

Date: Nov. 6-91

	Sample No.	Description	oz/ton Au	oz/ton Ag
1	9663		.98	10.18
2	65		.54	3.56
3	65		.20	4.46
4	66		Trace	2.02
5				
6				
7				
8				
9				
10				
11				
12				
13				
14				
15				
16				
17				
18				
19				
20				
21				
22				
23				
24				

Assayer: Paul Okanski



Swastika Laboratories

A Division of Assayers Corporation Ltd.

Assaying - Consulting - Representation

Established 1928

Geochemical Analysis Certificate

1W-4370-RG1

Company: **ALEX GLATZ**

Date: **NOV-11-91**

Project:

Copy 1. 15 Park Cressent, Dryden, Ont. P8N 1T7

Attn:

We hereby certify the following Geochemical Analysis of 11 rock samples submitted NOV-04-91 by .

Sample Number	Au PPB	Au check PPB	Au 2nd PPB	Ag PPM
7516	3261			
7517	5760	5486		
7518	31			
7519	2537			
7520	11246			
7521	26400	25989	36857	
7522	8983			
9667	408			0.8
9668	62			0.1
9669	Nil			0.4
9670	Nil			0.1

Temple

Certified by Donna Anderson

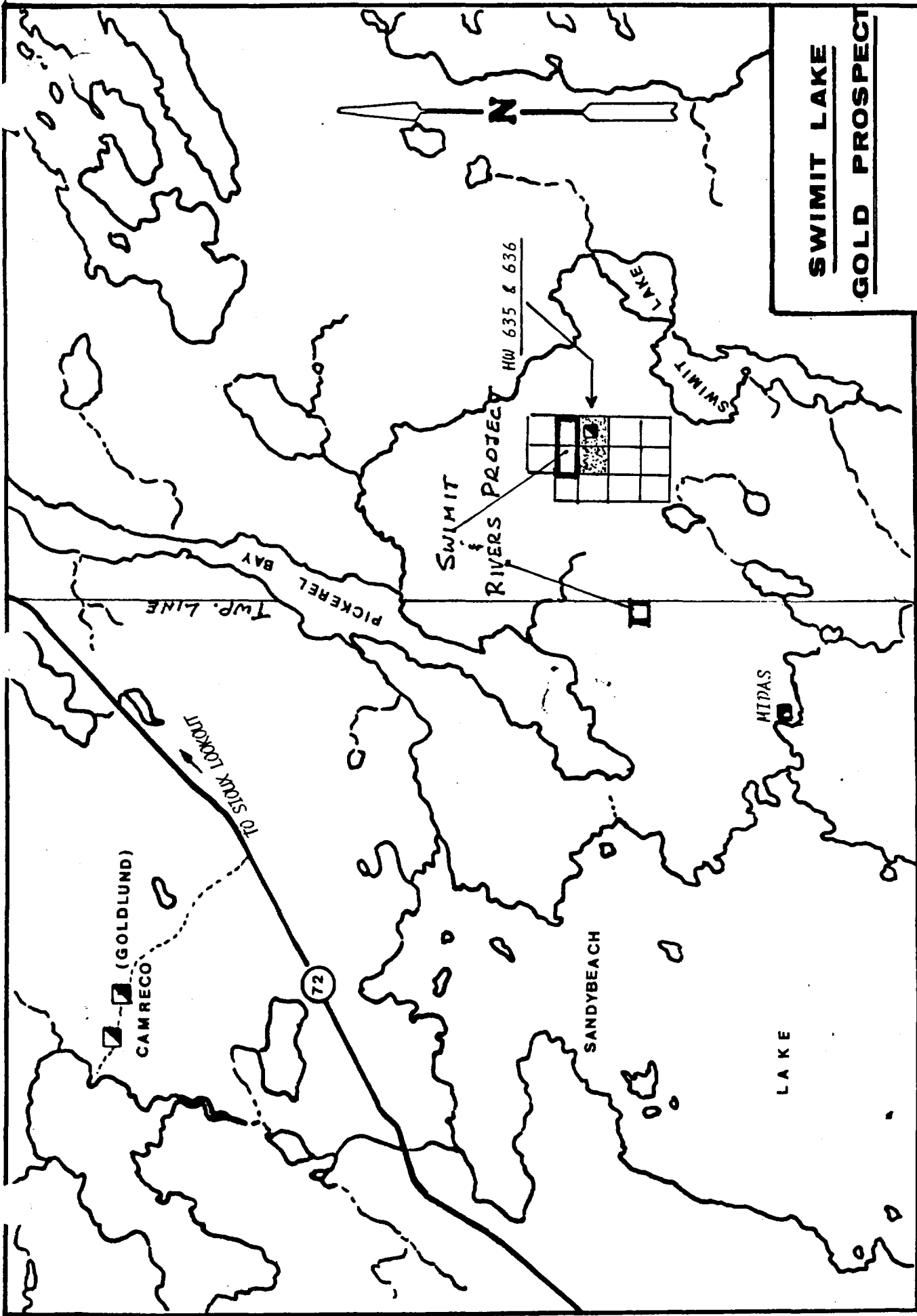

SWIMIT LAKE
GOLD PROSPECT

March 1991



LOCATION MAP.
 FIGURE

52F16

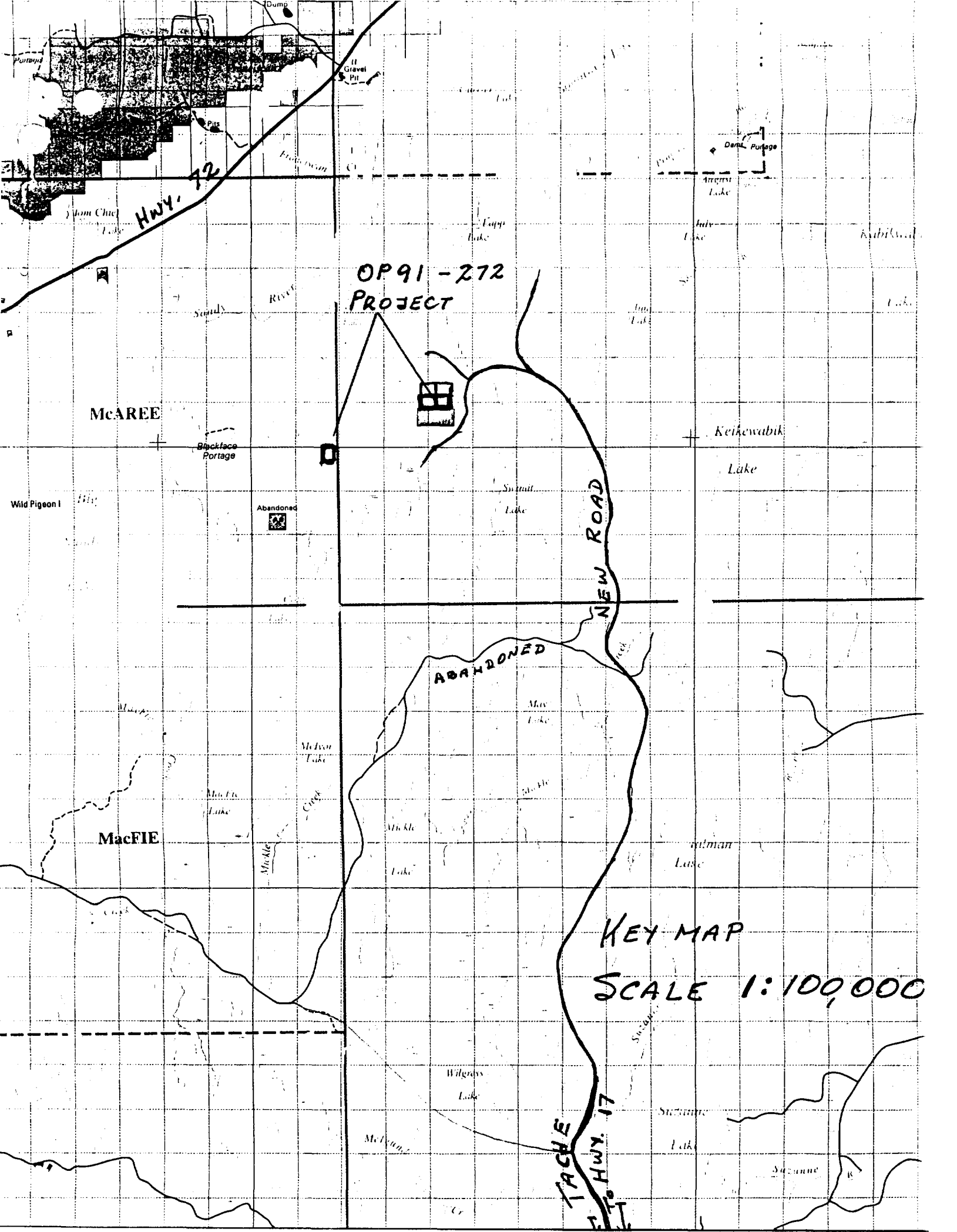

OP91-272
PROJECT

HWY. 12

NEW ROAD

ABANDONED

McAREE

MacFIE

KEY MAP
SCALE 1:100,000

TACHE
HWY. 17

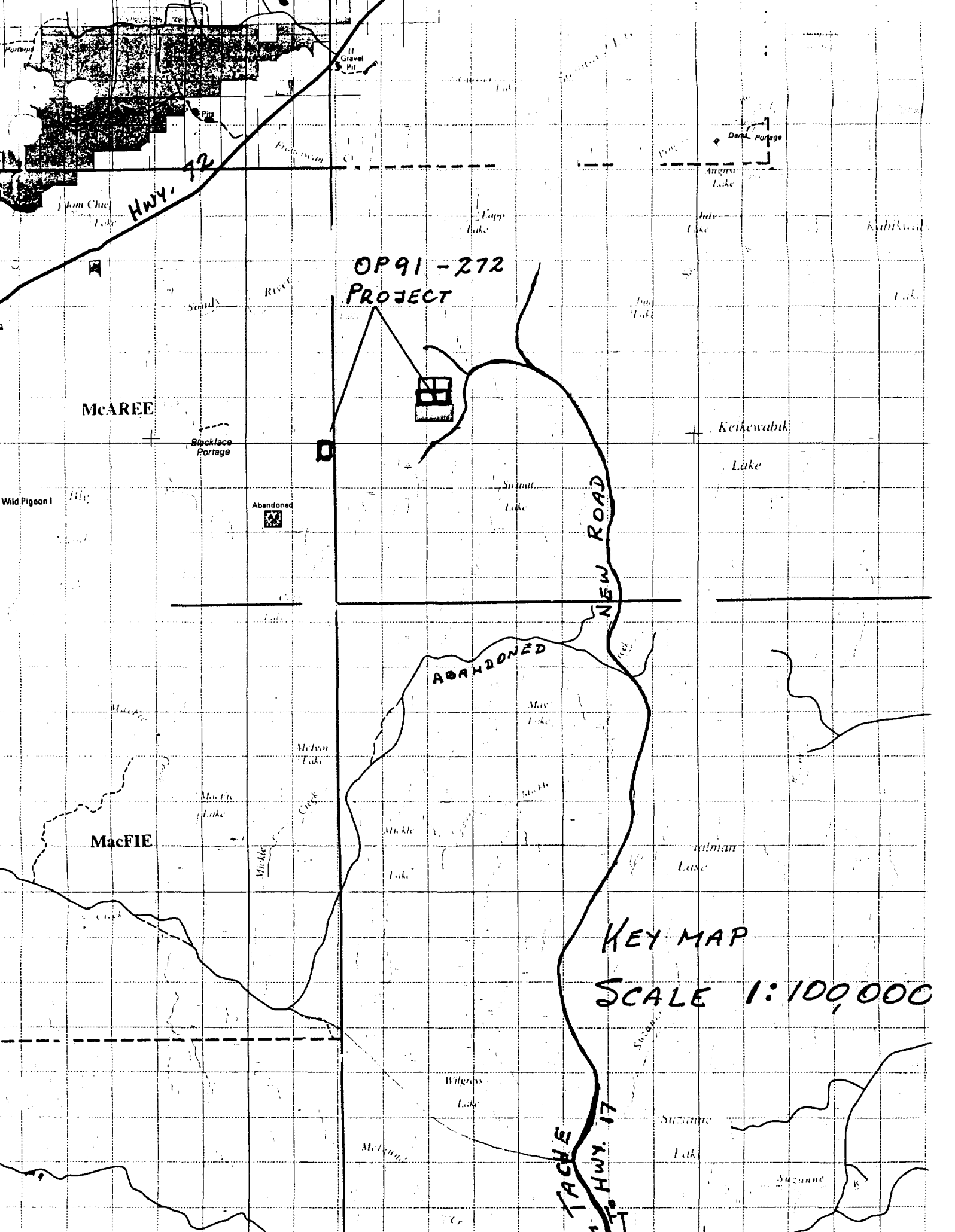

1052954	1052955
1052957	1052956
TLC	
1052958	1052959

92 9 16'

andy beach Cr.

MCAREE TWP.

TWP. LINE

KEIKEWABIK L. AREA

Lapp L.

Pictorial Arm of Minnetaki Lake

R.O.W

1007000	1007001	1007002	1007003	1007004	1007005	1007006	1007007	1007008	1007009	1007010	1007011	1007012	1007013	1007014	1007015	1007016	1007017	1007018	1007019	1007020	1007021	1007022	1007023	1007024	1007025	1007026	1007027	1007028	1007029	1007030	1007031	1007032	1007033	1007034	1007035	1007036	1007037	1007038	1007039	1007040	1007041	1007042	1007043	1007044	1007045	1007046	1007047	1007048	1007049	1007050	1007051	1007052	1007053	1007054	1007055	1007056	1007057	1007058	1007059	1007060	1007061	1007062	1007063	1007064	1007065	1007066	1007067	1007068	1007069	1007070	1007071	1007072	1007073	1007074	1007075	1007076	1007077	1007078	1007079	1007080	1007081	1007082	1007083	1007084	1007085	1007086	1007087	1007088	1007089	1007090	1007091	1007092	1007093	1007094	1007095	1007096	1007097	1007098	1007099	1007100	1007101	1007102	1007103	1007104	1007105	1007106	1007107	1007108	1007109	1007110	1007111	1007112	1007113	1007114	1007115	1007116	1007117	1007118	1007119	1007120	1007121	1007122	1007123	1007124	1007125	1007126	1007127	1007128	1007129	1007130	1007131	1007132	1007133	1007134	1007135	1007136	1007137	1007138	1007139	1007140	1007141	1007142	1007143	1007144	1007145	1007146	1007147	1007148	1007149	1007150	1007151	1007152	1007153	1007154	1007155	1007156	1007157	1007158	1007159	1007160	1007161	1007162	1007163	1007164	1007165	1007166	1007167	1007168	1007169	1007170	1007171	1007172	1007173	1007174	1007175	1007176	1007177	1007178	1007179	1007180	1007181	1007182	1007183	1007184	1007185	1007186	1007187	1007188	1007189	1007190	1007191	1007192	1007193	1007194	1007195	1007196	1007197	1007198	1007199	1007200	1007201	1007202	1007203	1007204	1007205	1007206	1007207	1007208	1007209	1007210	1007211	1007212	1007213	1007214	1007215	1007216	1007217	1007218	1007219	1007220	1007221	1007222	1007223	1007224	1007225	1007226	1007227	1007228	1007229	1007230	1007231	1007232	1007233	1007234	1007235	1007236	1007237	1007238	1007239	1007240	1007241	1007242	1007243	1007244	1007245	1007246	1007247	1007248	1007249	1007250	1007251	1007252	1007253	1007254	1007255	1007256	1007257	1007258	1007259	1007260	1007261	1007262	1007263	1007264	1007265	1007266	1007267	1007268	1007269	1007270	1007271	1007272	1007273	1007274	1007275	1007276	1007277	1007278	1007279	1007280	1007281	1007282	1007283	1007284	1007285	1007286	1007287	1007288	1007289	1007290	1007291	1007292	1007293	1007294	1007295	1007296	1007297	1007298	1007299	1007300	1007301	1007302	1007303	1007304	1007305	1007306	1007307	1007308	1007309	1007310	1007311	1007312	1007313	1007314	1007315	1007316	1007317	1007318	1007319	1007320	1007321	1007322	1007323	1007324	1007325	1007326	1007327	1007328	1007329	1007330	1007331	1007332	1007333	1007334	1007335	1007336	1007337	1007338	1007339	1007340	1007341	1007342	1007343	1007344	1007345	1007346	1007347	1007348	1007349	1007350	1007351	1007352	1007353	1007354	1007355	1007356	1007357	1007358	1007359	1007360	1007361	1007362	1007363	1007364	1007365	1007366	1007367	1007368	1007369	1007370	1007371	1007372	1007373	1007374	1007375	1007376	1007377	1007378	1007379	1007380	1007381	1007382	1007383	1007384	1007385	1007386	1007387	1007388	1007389	1007390	1007391	1007392	1007393	1007394	1007395	1007396	1007397	1007398	1007399	1007400	1007401	1007402	1007403	1007404	1007405	1007406	1007407	1007408	1007409	1007410	1007411	1007412	1007413	1007414	1007415	1007416	1007417	1007418	1007419	1007420	1007421	1007422	1007423	1007424	1007425	1007426	1007427	1007428	1007429	1007430	1007431	1007432	1007433	1007434	1007435	1007436	1007437	1007438	1007439	1007440	1007441	1007442	1007443	1007444	1007445	1007446	1007447	1007448	1007449	1007450	1007451	1007452	1007453	1007454	1007455	1007456	1007457	1007458	1007459	1007460	1007461	1007462	1007463	1007464	1007465	1007466	1007467	1007468	1007469	1007470	1007471	1007472	1007473	1007474	1007475	1007476	1007477	1007478	1007479	1007480	1007481	1007482	1007483	1007484	1007485	1007486	1007487	1007488	1007489	1007490	1007491	1007492	1007493	1007494	1007495	1007496	1007497	1007498	1007499	1007500
850954	850955	850956	850957	850958	850959	850960	850961	850962	850963	850964	850965	850966	850967	850968	850969	850970	850971	850972	850973	850974	850975	850976	850977	850978	850979	850980	850981	850982	850983	850984	850985	850986	850987	850988	850989	850990	850991	850992	850993	850994	850995	850996	850997	850998	850999	851000																																																																																																																																																																																																																																																																																																																																																																																																																																																																						

1133622	1133621
1133643	1133642
1133641	1133640
1133639	1133638
1133637	1133636
1133635	1133634
1133633	1133632

SIP CUT 11/92

CUT 8/90

Swimit

NW 403

KEIKEWABIK LAKE AREA

Q-2087

	1133622*	1133621*
1133643*	SWIMIT L. PROJECT	
1133642*	PAT. HW 635	 PAT. HW 636
1133641*	1133637*	1133636*
1133640*	1133638*	1133639*

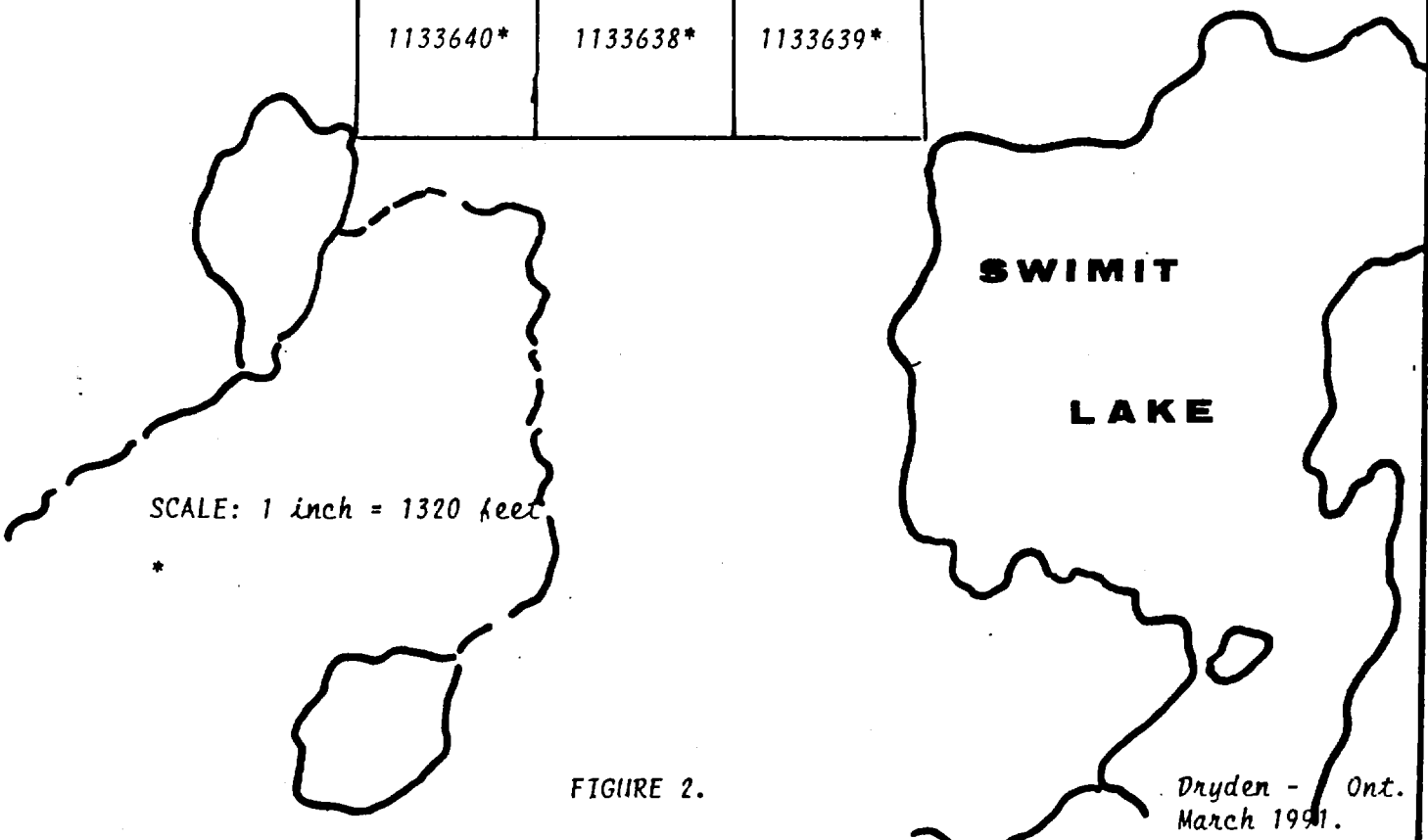

SCALE: 1 inch = 1320 feet

*

FIGURE 2.

Dryden - Ont.
March 1991.

SCALE : 1:8000

RIVERS
← 1.5 KM

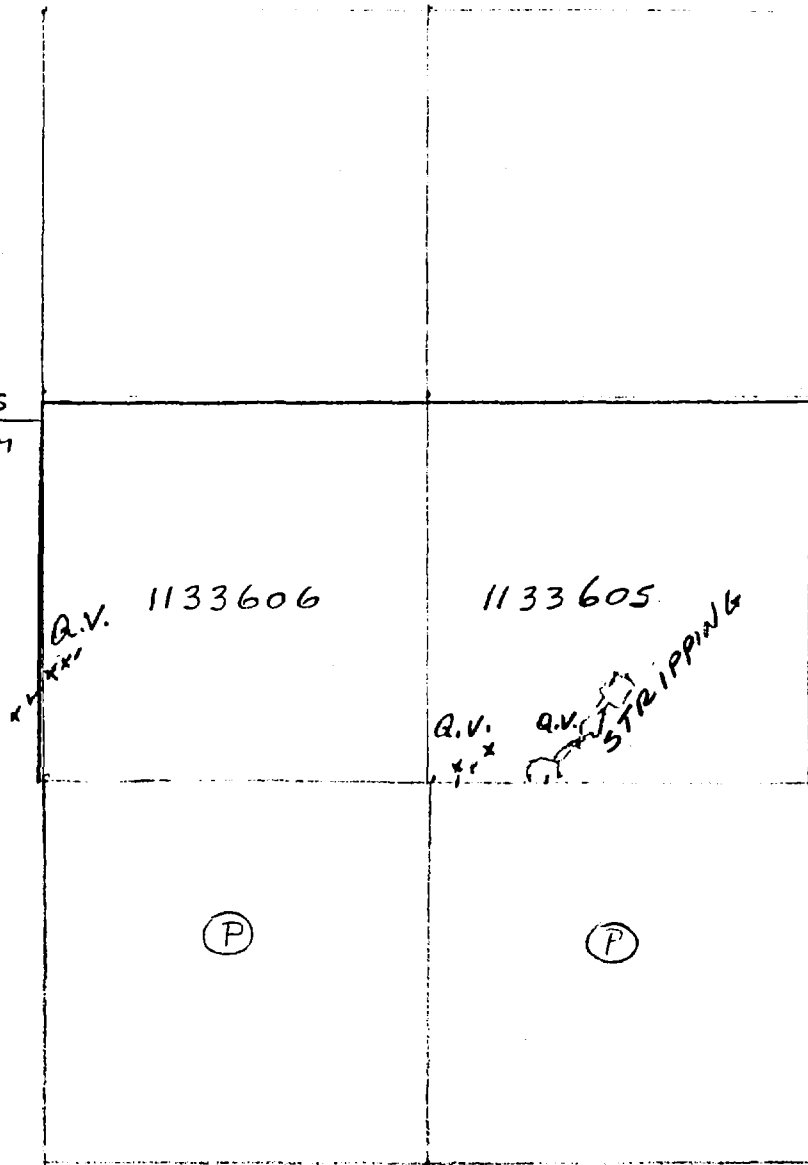

SWIMIT LAKE GOLD SHOWING

OPAP PROJECT #2

OP91-272

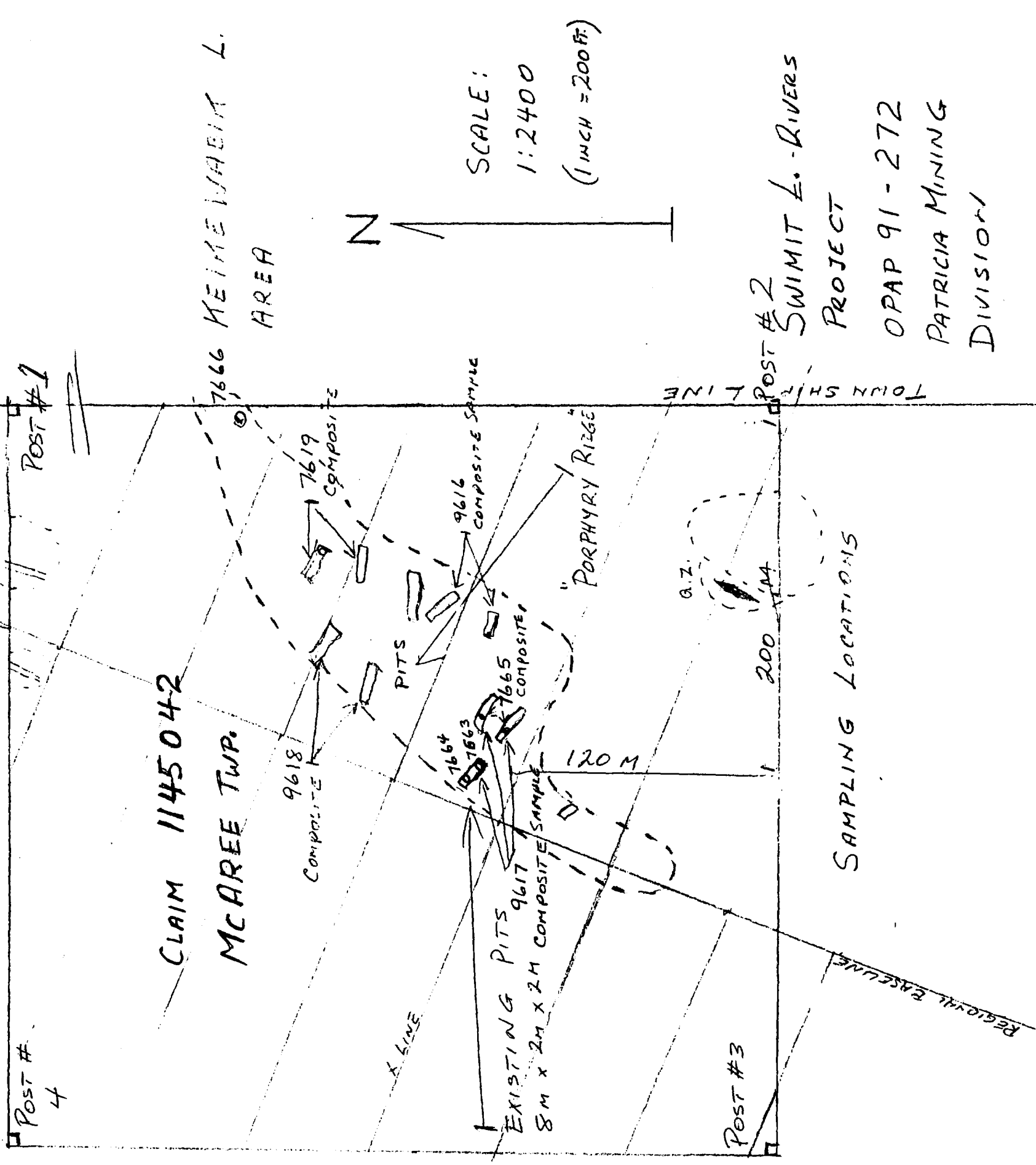

SWIMMIT L. RIVERS
 PROJECT
 OPAP 91-272
 PATRICIA MINING
 DIVISION

SWIMIT LAKE GOLD SHOWING.

MAIN ZONE TRENCHED OCT. 1991

XXX = QUARTZ VEIN

~~○ = SAMPLE LOCATION~~

SCALE: 1:400

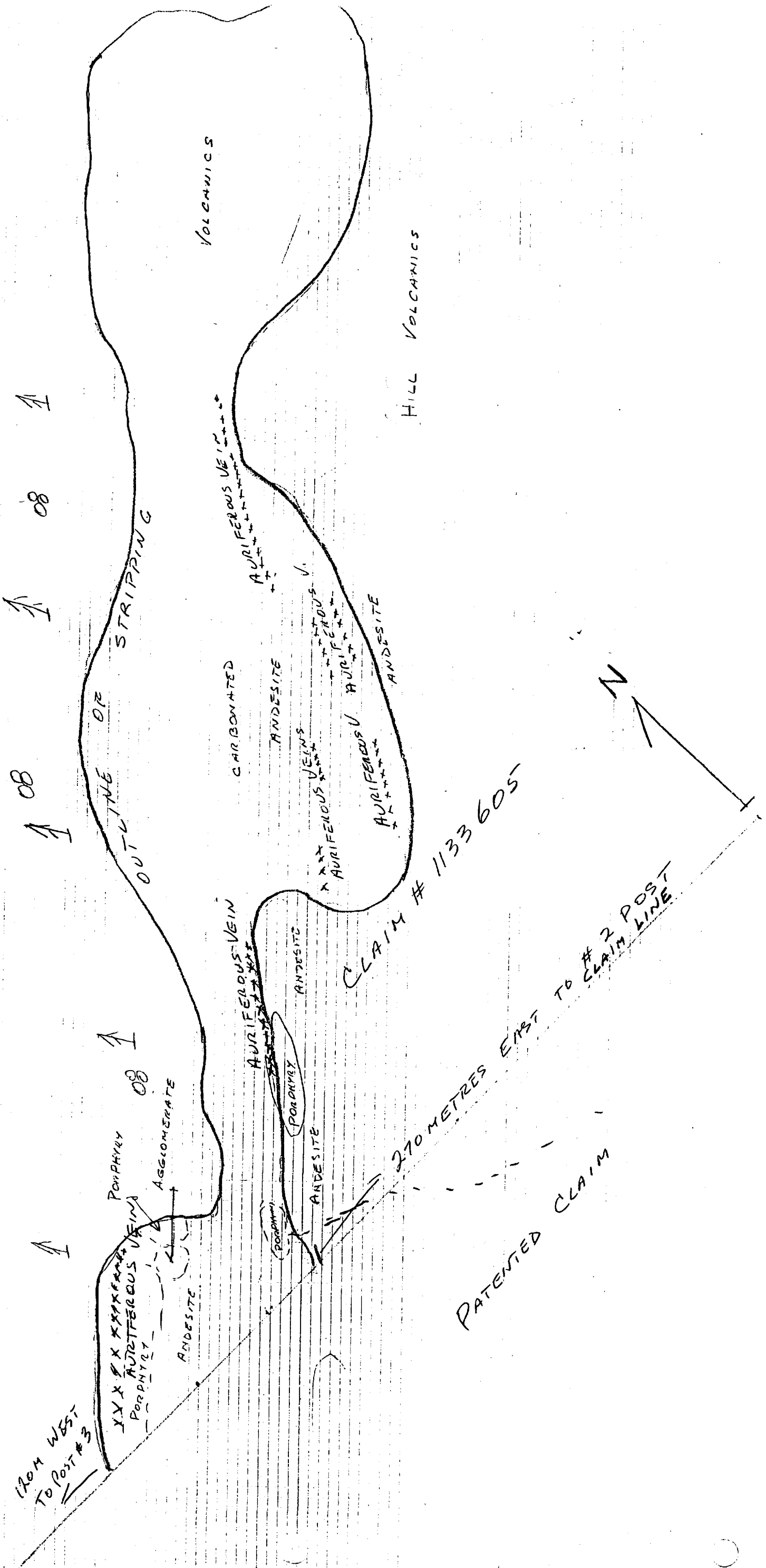

SWIMIT LAKE GOLD SHOWING.

MAIN ZONE TRENCHED OCT. 1991

XXXX = QUARTZ VEIN

● = SAMPLE LOCATION

SCALE: 1:400

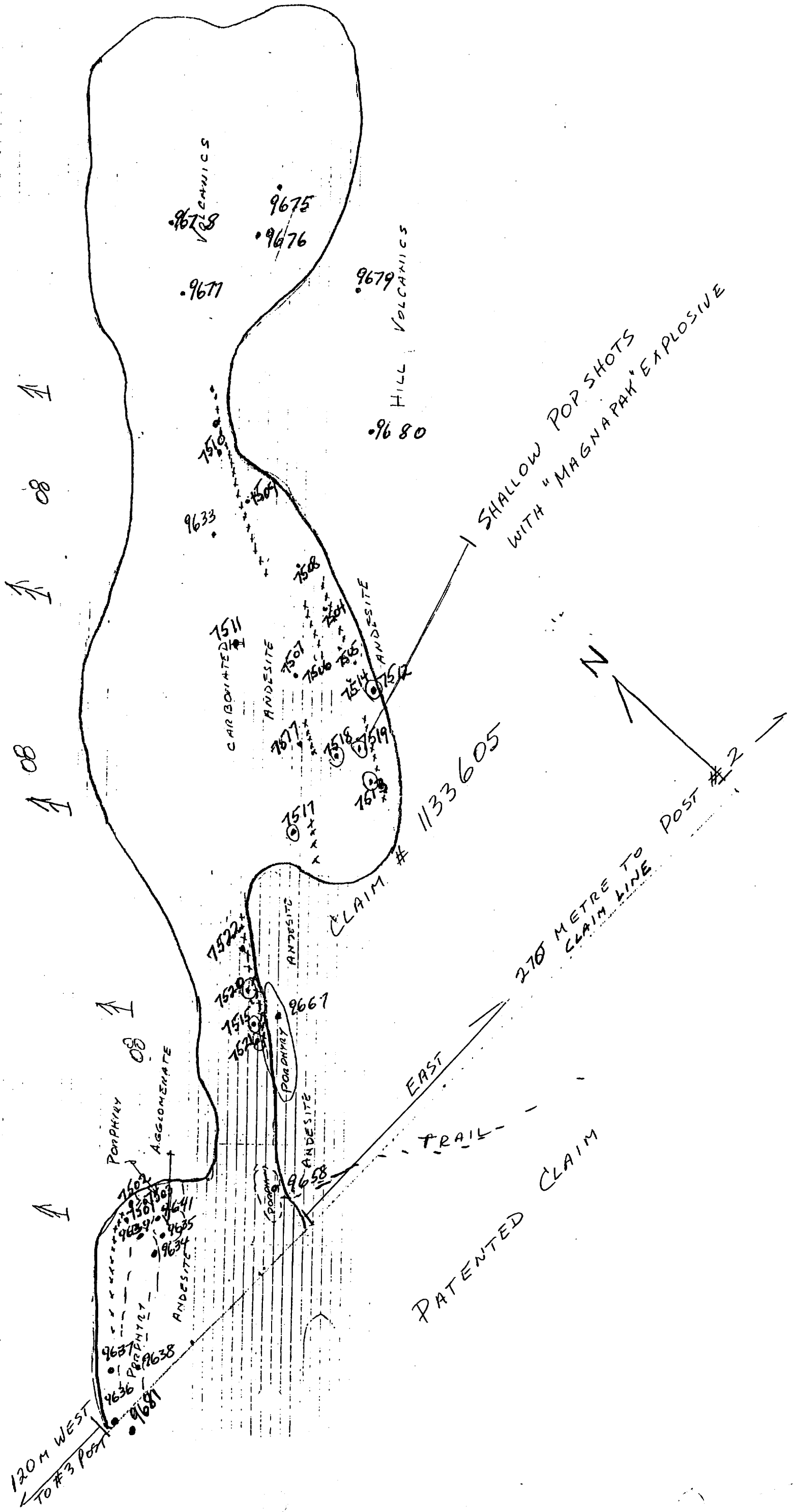

GEOLOGY OF CLAIMS 1133605 & 1133606

KEIKE WAHIK AREA

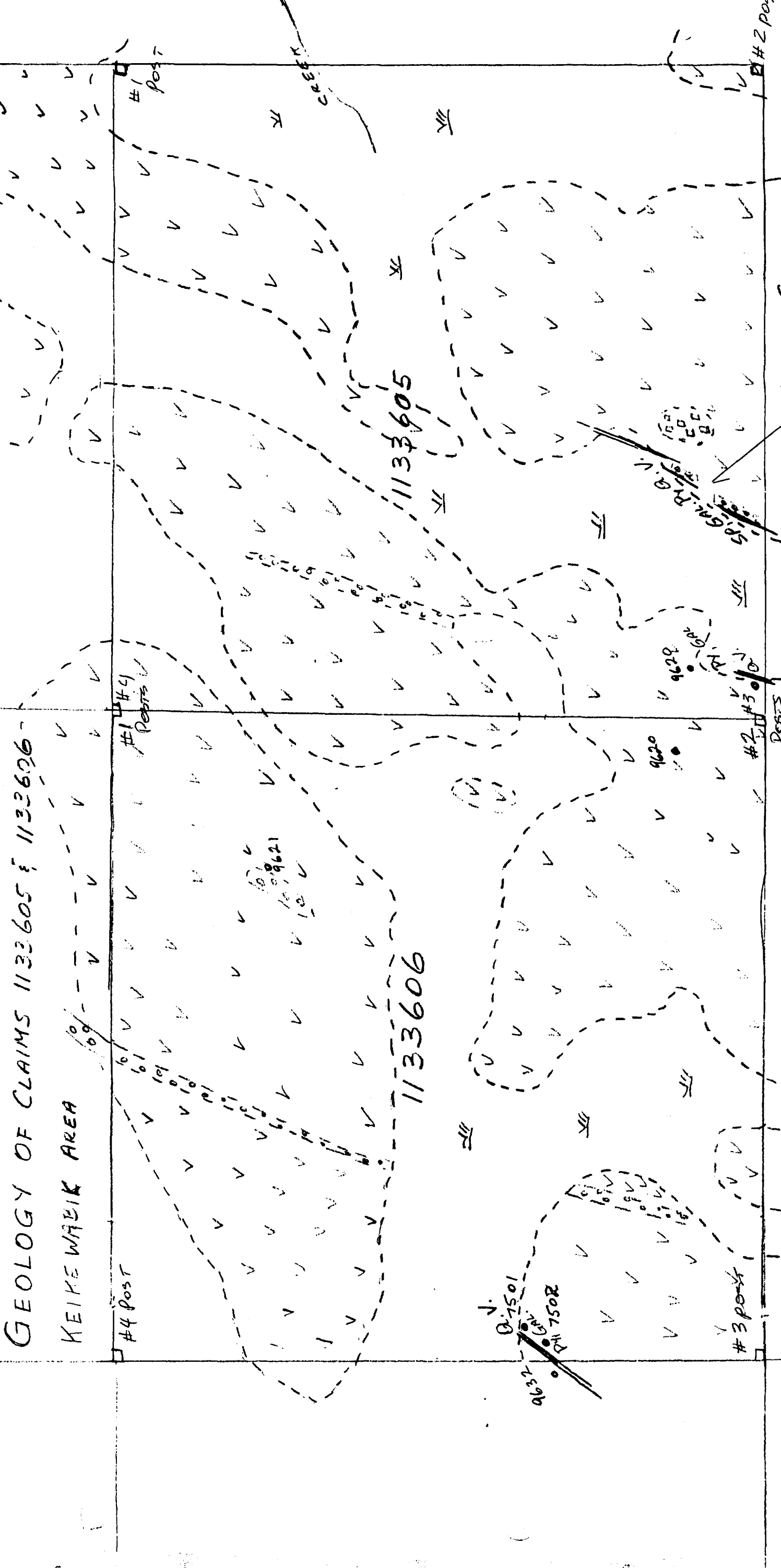

- LEGEND:
- V V PILLOW LAVA
 - O O O O PORPHYRY DIKES
 - □ □ □ AGGLOMERATE

SWIMIT L. - RIVERS PROJECT
 OPAP 91-272
 PATRICIA MINING DIVISION
 SCALE: 1:2400 (1 INCH = 200 FT.)

AREA OF STRIPPING
 FOR SAMPLE LOCATION SEE TRENCH PLAN