



52F16SW0015 52F16SW0011A1 MCAREE

010

Diamond Drilling

Township of McAree

Report No: 12

Work performed by: Rivers option

Claim No	Hole No	Footage	Date	Note	
PA20900	1	284.7'	Sept/60		
	2	308'	Sept/60		
	3	305'	Sept/60		
	4	498.5'	Sept/60		
	5	327'	Sept/60		
			89'	Oct/60	
			<u>416'</u>		
	6	505'	Oct/60		
	7	407.5'	Oct/60		

TOTAL: 7 DH 2724.7

Notes.

# DIAMOND DRILL RECORD

9-7-35 d. 20900

PROPERTY McAREE TWP. - RIVERS OPTION HOLE NO. 1

SHEET NUMBER 1 SECTION FROM \_\_\_\_\_ TO \_\_\_\_\_ STARTED \_\_\_\_\_  
 LATITUDE 1400N DATUM \_\_\_\_\_ COMPLETED September 6, 1960  
 DEPARTURE 35E BEARING N 67° W ULTIMATE DEPTH 284.7'  
 ELEVATION 1000 DIP -45° PROPOSED DEPTH \_\_\_\_\_

DEPTH FEET	FORMATION	SAMPLE NO	WIDTH OF SAMPLE	GOLD g	BLIND GOLD g
0.0 - 38.0	Basic volcanics				
38.0 - 54.0	Feldspar porphyry				
54.0 - 84.0	Basic volcanics				
84.0 - 105.0	Feldspar porphyry				
105.0 - 111.0	Intermediate to basic volcanics				
111.0 - 114.0	Feldspar porphyry				
114.0 - 119.2	Intermediate to basic volcanics				
119.2 - 145.0	Feldspar porphyry				
145.0 - 162.7	Intermediate volcanics				
162.7 - 182.5	Feldspar porphyry				
182.5 - 190.0	Intermediate to basic volcanics				

20900

N.M.P. TORONTO-STOCK FORM NO. 801 REV. 12/51

DRILLED BY \_\_\_\_\_

  
 SIGNED W. J. Matthews *W. J. Matthews*

# DIAMOND DRILL RECORD

PROPERTY MoARKEE TWP. - RIVERS OPTION

HOLE NO. 1

SHEET NUMBER 2 SECTION FROM \_\_\_\_\_ TO \_\_\_\_\_ STARTED \_\_\_\_\_  
 LATITUDE \_\_\_\_\_ DATUM \_\_\_\_\_ COMPLETED \_\_\_\_\_  
 DEPARTURE \_\_\_\_\_ BEARING \_\_\_\_\_ ULTIMATE DEPTH \_\_\_\_\_  
 ELEVATION \_\_\_\_\_ DIP \_\_\_\_\_ PROPOSED DEPTH \_\_\_\_\_

DEPTH FEET	FORMATION	SAMPLE NO	WIDTH OF SAMPLE	GOLD g	SLUDGE GOLD g
190.0 - 196.0	Feldspar porphyry				
196.0 - 204.5	Intermediate volcanics				
204.5 - 216.6	Feldspar porphyry				
216.6 - 221.0	Intermediate volcanics				
221.0 - 228.0	Feldspar porphyry				
228.0 - 241.5	Altered intermediate volcanics				
241.5 - 267.0	Feldspar porphyry				
267.0 - 284.7	Altered and brecciated intermediate volcanics				
284.7	END OF HOLE				

N.M.P. TORONTO-STOCK FORM NO. 501 REV. 12/51

DRILLED BY \_\_\_\_\_

*W. J. Matthews*

SIGNED W. J. Matthews

*W. J. Matthews*

# DIAMOND DRILL RECORD

PROPERTY McAREE TWP. - RIVERS OPTION HOLE NO. 2

SHEET NUMBER 1 SECTION FROM \_\_\_\_\_ TO \_\_\_\_\_ STARTED September 7, 1960  
 LATITUDE 1450N DATUM \_\_\_\_\_ COMPLETED September 13, 1960  
 DEPARTURE 34E BEARING N67°W ULTIMATE DEPTH 308.0'  
 ELEVATION 1014' DIP -45° PROPOSED DEPTH \_\_\_\_\_

DEPTH FEET	FORMATION	SAMPLE NO	WIDTH OF SAMPLE	GOLD g	BLUES OF GOLD
0.0 - 5.0	Oyerburden				
5.0 - 63.5	Intermediate to basic volcanics				
63.5 - 101.0	Feldspar porphyry				
101.0 - 113.5	Intermediate to basic volcanics				
113.5 - 144.0	Feldspar porphyry				
144.0 - 172.0	Intermediate to basic volcanics				
172.0 - 188.5	Feldspar porphyry				
188.5 - 194.0	Intermediate to basic volcanics				
194.0 - 223.5	Feldspar porphyry				
223.5 - 233.7	Intermediate volcanics				

N.M.P. TORONTO-STOCK FORM NO. 301 REV. 12/51

DRILLED BY \_\_\_\_\_

*J. G. Ward for*  
 SIGNED W. J. Matthews *W. J. Matthews*

# DIAMOND DRILL RECORD

PROPERTY \_\_\_\_\_ McADLE TWP. - RIVERS OPTION \_\_\_\_\_ HOLE NO. 2

SHEET NUMBER 2 SECTION FROM \_\_\_\_\_ TO \_\_\_\_\_ STARTED \_\_\_\_\_  
 LATITUDE \_\_\_\_\_ DATUM \_\_\_\_\_ COMPLETED \_\_\_\_\_  
 DEPARTURE \_\_\_\_\_ BEARING \_\_\_\_\_ ULTIMATE DEPTH \_\_\_\_\_  
 ELEVATION \_\_\_\_\_ DIP \_\_\_\_\_ PROPOSED DEPTH \_\_\_\_\_

DEPTH FEET	FORMATION	SAMPLE NO	WIDTH OF SAMPLE	GOLD g	SLUDGE GOLD g
233.7 - 239.0	Feldspar porphyry				
239.0 - 259.5	Highly altered, brecciated volcanics				
259.5 - 276.0	Feldspar porphyry				
276.0 - 287.5	Highly altered, brecciated volcanics				
287.5 - 304.0	Feldspar porphyry				
304.0 - 308.0	Intermediate to basic volcanics				
308.0	END OF HOLE				

N.M.P. ONTO-STOCK FORM 19 801 REV 12/51

DRILLED BY \_\_\_\_\_

J. Frank for

SIGNED W. J. Matthews *W. Matthews*

# DIAMOND DRILL RECORD

PROPERTY MOARKE TWP. - RIVERS OPTION HOLE NO. 3

SHEET NUMBER 1 SECTION FROM \_\_\_\_\_ TO \_\_\_\_\_ STARTED September 13, 1960  
 LATITUDE 1490N DATUM \_\_\_\_\_ COMPLETED September 18, 1960  
 DEPARTURE 0+00 BEARING N 67° W ULTIMATE DEPTH 305'  
 ELEVATION 1020' DIP -45° PROPOSED DEPTH \_\_\_\_\_

DEPTH FEET	FORMATION	SAMPLE NO	WIDTH OF SAMPLE	GOLD g	SLUDGE GOLD g
0.0 - 5.0	Overburden				
5.0 - 33.5	Feldspar porphyry				
33.5 - 39.0	Altered basic volcanics				
39.0 - 65.5	Feldspar porphyry				
65.5 - 70.5	Basic to intermediate volcanics				
70.5 - 76.0	Feldspar porphyry				
76.0 - 100.5	Highly altered volcanics				
100.5 - 102.5	Feldspar porphyry				
102.5 - 107.0	Highly altered basic volcanics				
107.0 - 114.0	Feldspar porphyry				

N.M.P. TORONTO-STOCK FORM NO. 801 REV. 12/51

DRILLED BY \_\_\_\_\_

*G. J. Blank for*  
 SIGNED W. J. Matthews *WJMatthews*

# DIAMOND DRILL RECORD

PROPERTY McAREE TWP. - RIVERS OPTION HOLE NO. 3

SHEET NUMBER 2 SECTION FROM \_\_\_\_\_ TO \_\_\_\_\_ STARTED \_\_\_\_\_

LATITUDE \_\_\_\_\_ DATUM \_\_\_\_\_ COMPLETED \_\_\_\_\_

DEPARTURE \_\_\_\_\_ BEARING \_\_\_\_\_ ULTIMATE DEPTH \_\_\_\_\_

ELEVATION \_\_\_\_\_ DIP \_\_\_\_\_ PROPOSED DEPTH \_\_\_\_\_

DEPTH FEET	FORMATION	SAMPLE No	WIDTH OF SAMPLE	GOLD g	SLUDGE GOLD g
114.0 - 119.0	Highly altered basic volcanics				
119.0 - 150.0	Feldspar porphyry				
150.0 - 178.0	Highly altered basic volcanics				
178.0 - 263.2	Feldspar porphyry				
263.2 - 288.0	Highly altered volcanics				
288.0 - 303.0	Feldspar porphyry				
303.0 - 305.0	Highly altered basic volcanics				
305.0	END OF HOLE				

N.M.P. TORONTO-STOCK FORM NO 501 REV. 12/51

DRILLED BY \_\_\_\_\_

*J. Blank for*  
 SIGNED W. J. Matthews *WJ Matthews*

# DIAMOND DRILL RECORD

PROPERTY McAREE TWP. - RIVERS OPTION HOLE NO. 4

SHEET NUMBER 1 SECTION FROM \_\_\_\_\_ TO \_\_\_\_\_ STARTED September 19, 1960  
 LATITUDE 1500N DATUM \_\_\_\_\_ COMPLETED September 28, 1960  
 DEPARTURE 100E BEARING N 67° W ULTIMATE DEPTH 498.5  
 ELEVATION 979' DIP -45° PROPOSED DEPTH \_\_\_\_\_

DEPTH FEET	FORMATION	SAMPLE NO	WIDTH OF SAMPLE	GOLD g	SLUDGE GOLD g
0.0 - 6.0	Overburden				
6.0 - 17.0	Basic volcanics				
17.0 - 25.0	Feldspar porphyry				
25.0 - 150.5	Altered intermediate to basic volcanics				
150.5 - 152.0	Feldspar porphyry				
152.0 - 157.0	Altered brecciated volcanics				
157.0 - 179.5	Feldspar porphyry				
179.5 - 186.0	Altered volcanics				
186.0 - 200.0	Feldspar porphyry				
200.0 - 203.0	Altered volcanics				

N.M.P. TORONTO-STOCK FORM NO. 501 REV. 12/51

DRILLED BY \_\_\_\_\_

  
 SIGNED W. J. Matthews 



# DIAMOND DRILL RECORD

PROPERTY McAREE TWP. - RIVERS OPTION HOLE NO. 4

SHEET NUMBER 2 SECTION FROM \_\_\_\_\_ TO \_\_\_\_\_ STARTED \_\_\_\_\_  
 LATITUDE \_\_\_\_\_ DATUM \_\_\_\_\_ COMPLETED \_\_\_\_\_  
 DEPARTURE \_\_\_\_\_ BEARING \_\_\_\_\_ ULTIMATE DEPTH \_\_\_\_\_  
 ELEVATION \_\_\_\_\_ DIP \_\_\_\_\_ PROPOSED DEPTH \_\_\_\_\_

DEPTH FEET	FORMATION	SAMPLE NO	WIDTH OF SAMPLE	GOLD g	AGGREG. GOLD g
203.0 - 208.5	Feldspar porphyry				
208.5 - 255.0	Highly altered volcanics				
255.0 - 273.0	Feldspar porphyry				
273.0 - 286.5	Altered volcanics				
286.5 - 315.0	Feldspar porphyry				
315.0 - 320.0	Altered volcanics				
320.0 - 342.0	Feldspar porphyry				
342.0 - 379.5	Altered volcanics				
379.5 - 395.0	Feldspar porphyry				
395.0 - 412.0	Altered volcanics				

N.M.P. TORONTO-STOCK FORM NO. 501 REV. 12/51

DRILLED BY \_\_\_\_\_

*W. J. Matthews*

SIGNED: W. J. Matthews *W. J. Matthews*

# DIAMOND DRILL RECORD

PROPERTY McAREE TWP. - RIVERS OPTION HOLE NO. 4

SHEET NUMBER 3 SECTION FROM \_\_\_\_\_ TO \_\_\_\_\_ STARTED \_\_\_\_\_

LATITUDE \_\_\_\_\_ DATUM \_\_\_\_\_ COMPLETED \_\_\_\_\_

DEPARTURE \_\_\_\_\_ BEARING \_\_\_\_\_ ULTIMATE DEPTH \_\_\_\_\_

ELEVATION \_\_\_\_\_ DIP \_\_\_\_\_ PROPOSED DEPTH \_\_\_\_\_

DEPTH FEET	FORMATION	SAMPLE No	WIDTH OF SAMPLE	GOLD g	SLUDGE GOLD g
412.0 - 437.0	Feldspar porphyry				
437.0 - 451.0	Altered volcanics				
451.0 - 455.0	Feldspar porphyry				
455.0 - 467.0	Altered volcanics				
467.0 - 498.5	Feldspar porphyry				
498.5	END OF HOLE				

N.M.P. TORONTO-STOCK FORM NO 801 REV. 12/51

DRILLED BY \_\_\_\_\_

*J. Thank you*  
 SIGNED W. J. Matthews *W. J. Matthews*

# DIAMOND DRILL RECORD

PROPERTY MOARREE TWP. - RIVERS OPTION HOLE NO. 5

SHEET NUMBER 1 SECTION FROM \_\_\_\_\_ TO \_\_\_\_\_ STARTED September 28, 1960  
 LATITUDE 16+00N DATUM \_\_\_\_\_ COMPLETED October 1, 1960 & Oct 22  
 DEPARTURE 120E BEARING N 67° W ULTIMATE DEPTH 327.0  
 ELEVATION 996 DIP -45° PROPOSED DEPTH \_\_\_\_\_

DEPTH FEET	FORMATION	SAMPLE NO	WIDTH OF SAMPLE	GOLD g	% GOLD
0.0 - 5.0	Overburden				
5.0 - 17.3	Feldspar porphyry				
17.3 - 132.0	Altered volcanics				
132.0 - 135.0	Feldspar porphyry				
135.0 - 138.0	Altered volcanics				
138.0 - 139.5	Quartz				
139.5 - 162.0	Altered volcanics				
162.0 - 182.5	Feldspar porphyry				
182.5 - 192.5	Altered volcanics				
192.5 - 209.0	Feldspar porphyry				

N.M.P. TORONTO-STOCK FORM NO. 501 REV. 12/51

DRILLED BY \_\_\_\_\_

*E. Matthews*  
 SIGNED W. J. Matthews *W. Matthews*

# DIAMOND DRILL RECORD

PROPERTY McAREE TWP. - RIVERS OPTION HOLE NO. 5

SHEET NUMBER 2 SECTION FROM \_\_\_\_\_ TO \_\_\_\_\_ STARTED \_\_\_\_\_

LATITUDE \_\_\_\_\_ DATUM \_\_\_\_\_ COMPLETED \_\_\_\_\_

DEPARTURE \_\_\_\_\_ BEARING \_\_\_\_\_ ULTIMATE DEPTH \_\_\_\_\_

ELEVATION \_\_\_\_\_ DIP \_\_\_\_\_ PROPOSED DEPTH \_\_\_\_\_

DEPTH FEET	FORMATION	SAMPLE NO	WIDTH OF SAMPLE	GOLD %	SLUDGE GOLD %
209.0 - 251.0	Altered volcanics				
251.0 - 261.0	Feldspar porphyry				
261.0 - 294.5	Altered volcanics				
294.5 - 302.0	Feldspar porphyry				
302.0 - 306.0	Altered basic to intermediate volcanics				
306.0 - 327.0	Feldspar porphyry				
327.0	END OF HOLE				
	DEEPEMED - October 22, 1960				
327.0 - 328.8	Feldspar porphyry				
328.8 - 331.9	Altered volcanics				
331.9 - 363.0	Volcanics - brecciated - quartz stringers				
363.0 - 374.5	Feldspar porphyry				
374.5 - 416.0	Volcanics - brecciated - altered				
	409.0 - 411.0 - porphyry				
416.0	END OF HOLE				

*Note 327 to 416 not applied to assessment work*

N.M.P. TORONTO - STOCK FORM NO. 501 REV. 12/51

DRILLED BY \_\_\_\_\_

*J. J. Matthews*

SIGNED W. J. Matthews *W. J. Matthews*

# DIAMOND DRILL RECORD

PROPERTY MoARKE TWP. - RIVERS OPTION HOLE NO. 6

SHEET NUMBER 1 SECTION FROM \_\_\_\_\_ TO \_\_\_\_\_ STARTED October 3, 1960  
 LATITUDE 1450N DATUM \_\_\_\_\_ COMPLETED October 8, 1960  
 DEPARTURE 116E BEARING N 67° W ULTIMATE DEPTH 505'  
 ELEVATION 998 DIP 0 - 45° 500' - 40° PROPOSED DEPTH \_\_\_\_\_

DEPTH FEET	FORMATION	SAMPLE NO.	WIDTH OF SAMPLE	GOLD g	SLUDGE GOLD g
0.0 - 17.5	Casing				
17.5 - 29.0	Intermediate volcanics				
29.0 - 37.8	Feldspar porphyry				
37.8 - 159.0	Intermediate volcanics				
159.0 - 161.0	Feldspar porphyry				
161.0 - 163.3	Intermediate volcanics				
163.3 - 186.8	Feldspar porphyry				
186.8 - 192.0	Intermediate volcanics				
192.0 - 193.0	Contact zone - sheared volcanics and porphyry				
193.0 - 220.0	Quartz feldspar porphyry				

N.M.P. TORONTO-STOCK FORM NO. 301 REV. 12/51

DRILLED BY \_\_\_\_\_

*A. J. Walker*

SIGNED A. J. Walker

*A. J. Walker*

# DIAMOND DRILL RECORD

PROPERTY McARKE TWP. - RIVERS OPTION HOLE NO. 6

SHEET NUMBER 2 SECTION FROM \_\_\_\_\_ TO \_\_\_\_\_ STARTED \_\_\_\_\_  
 LATITUDE \_\_\_\_\_ DATUM \_\_\_\_\_ COMPLETED \_\_\_\_\_  
 DEPARTURE \_\_\_\_\_ BEARING \_\_\_\_\_ ULTIMATE DEPTH \_\_\_\_\_  
 ELEVATION \_\_\_\_\_ DIP \_\_\_\_\_ PROPOSED DEPTH \_\_\_\_\_

DEPTH FEET	FORMATION	SAMPLE NO	WIDTH OF SAMPLE	GOLD g	BLUES GOLD g
220.0 - 274.5	Intermediate volcanics				
274.5 - 300.7	Quartz porphyry				
300.7 - 327.5	Intermediate volcanics				
327.5 - 338.5	Quartz porphyry				
338.5 - 353.8	Intermediate volcanics				
353.8 - 381.4	Feldspar porphyry				
381.4 - 385.3	Intermediate volcanics				
385.3 - 398.0	Feldspar porphyry				
398.0 - 410.4	Intermediate volcanics				
410.4 - 413.5	Feldspar porphyry				

N.M.P. TORONTO-STOCK FORM NO. 501 REV. 12/81

DRILLED BY \_\_\_\_\_

*J. Walker*

SIGNED A. J. Walker

*A. J. Walker*

# DIAMOND DRILL RECORD

PROPERTY McAREE TWP. - RIVERS OPTION HOLE NO. 6

SHEET NUMBER 3 SECTION FROM \_\_\_\_\_ TO \_\_\_\_\_ STARTED \_\_\_\_\_  
 LATITUDE \_\_\_\_\_ DATUM \_\_\_\_\_ COMPLETED \_\_\_\_\_  
 DEPARTURE \_\_\_\_\_ BEARING \_\_\_\_\_ ULTIMATE DEPTH \_\_\_\_\_  
 ELEVATION \_\_\_\_\_ DIP \_\_\_\_\_ PROPOSED DEPTH \_\_\_\_\_

DEPTH FEET	FORMATION	SAMPLE NO	WIDTH OF SAMPLE	GOLD g	SLURRY GOLD g
413.5 - 434.0	Intermediate volcanics				
434.0 - 436.0	Feldspar porphyry				
436.0 - 438.5	Intermediate volcanics				
438.5 - 449.0	Feldspar porphyry				
449.0 - 455.3	Intermediate volcanics				
455.3 - 459.0	Feldspar porphyry				
459.0 - 463.5	Intermediate volcanics				
463.5 - 475.3	Quartz porphyry				
475.3 - 505.0	Feldspar porphyry				
505.0	END OF HOLE				

N.M.P. TORONTO-STOCK FORM NO. 501 REV. 12/51

DRILLED BY \_\_\_\_\_

*A. J. Walker*  
 SIGNED A. J. Walker  
*A. James Walker*

# DIAMOND DRILL RECORD

PROPERTY MOARREE TWP. - RIVERS OPTION HOLE NO. 7

SHEET NUMBER 1 SECTION FROM \_\_\_\_\_ TO \_\_\_\_\_ STARTED \_\_\_\_\_  
 LATITUDE 1700N DATUM \_\_\_\_\_ COMPLETED October 18, 1960  
 DEPARTURE 92E BEARING N 67° W ULTIMATE DEPTH 407.5'  
 ELEVATION 995 DIP 0 -45°, 200' -42°, 400' -42° PROPOSED DEPTH \_\_\_\_\_

DEPTH FEET	FORMATION	SAMPLE NO.	WIDTH OF SAMPLE	GOLD g	SLUDGE GOLD g
0.0 - 17.0	Overburden				
17.0 - 50.0	Intermediate volcanics				
50.0 - 69.0	Feldspar porphyry				
69.0 - 84.5	Intermediate volcanics				
84.5 - 90.5	Quartz-feldspar porphyry				
90.5 - 107.4	Volcanics, schisted at 50°				
107.4 - 112.3	Quartz porphyry				
112.3 - 116.0	Intermediate volcanics				
116.0 - 121.0	Quartz feldspar porphyry				
121.0 - 132.0	Quartz porphyry				

N.M.P. TORONTO-STOCK FORM NO. 501 REV. 12/51

DRILLED BY \_\_\_\_\_

*J. J. Walker for*

SIGNED A. J. Walker

*A. J. Walker*



# DIAMOND DRILL RECORD

PROPERTY MoAREE TWP. - RIVERS OPTION HOLE NO. 7

SHEET NUMBER 2 SECTION FROM \_\_\_\_\_ TO \_\_\_\_\_ STARTED \_\_\_\_\_  
 LATITUDE \_\_\_\_\_ DATUM \_\_\_\_\_ COMPLETED \_\_\_\_\_  
 DEPARTURE \_\_\_\_\_ BEARING \_\_\_\_\_ ULTIMATE DEPTH \_\_\_\_\_  
 ELEVATION \_\_\_\_\_ DIP \_\_\_\_\_ PROPOSED DEPTH \_\_\_\_\_

DEPTH FEET	FORMATION	SAMPLE NO	WIDTH OF SAMPLE	GOLD g	SLUDGE GOLD g
132.0 - 135.4	Intermediate volcanics				
135.4 - 170.0	Quartz porphyry				
170.0 - 226.6	Intermediate volcanics				
226.6 - 233.0	Feldspar porphyry				
233.0 - 268.2	Intermediate volcanics				
268.2 - 294.0	Quartz-feldspar porphyry				
294.0 - 352.5	Intermediate volcanics				
352.5 - 365.6	Feldspar porphyry				
365.6 - 369.0	Intermediate volcanics				
369.0 - 394.0	Quartz porphyry				
394.0 - 407.5	Intermediate volcanics				
407.5	END OF HOLE				

N.M.P., TORONTO-STOCK FORM NO. 501 REV. 12/51

DRILLED BY \_\_\_\_\_

*A. J. Walker*  
 SIGNED A. J. Walker  
*A. James Walker*

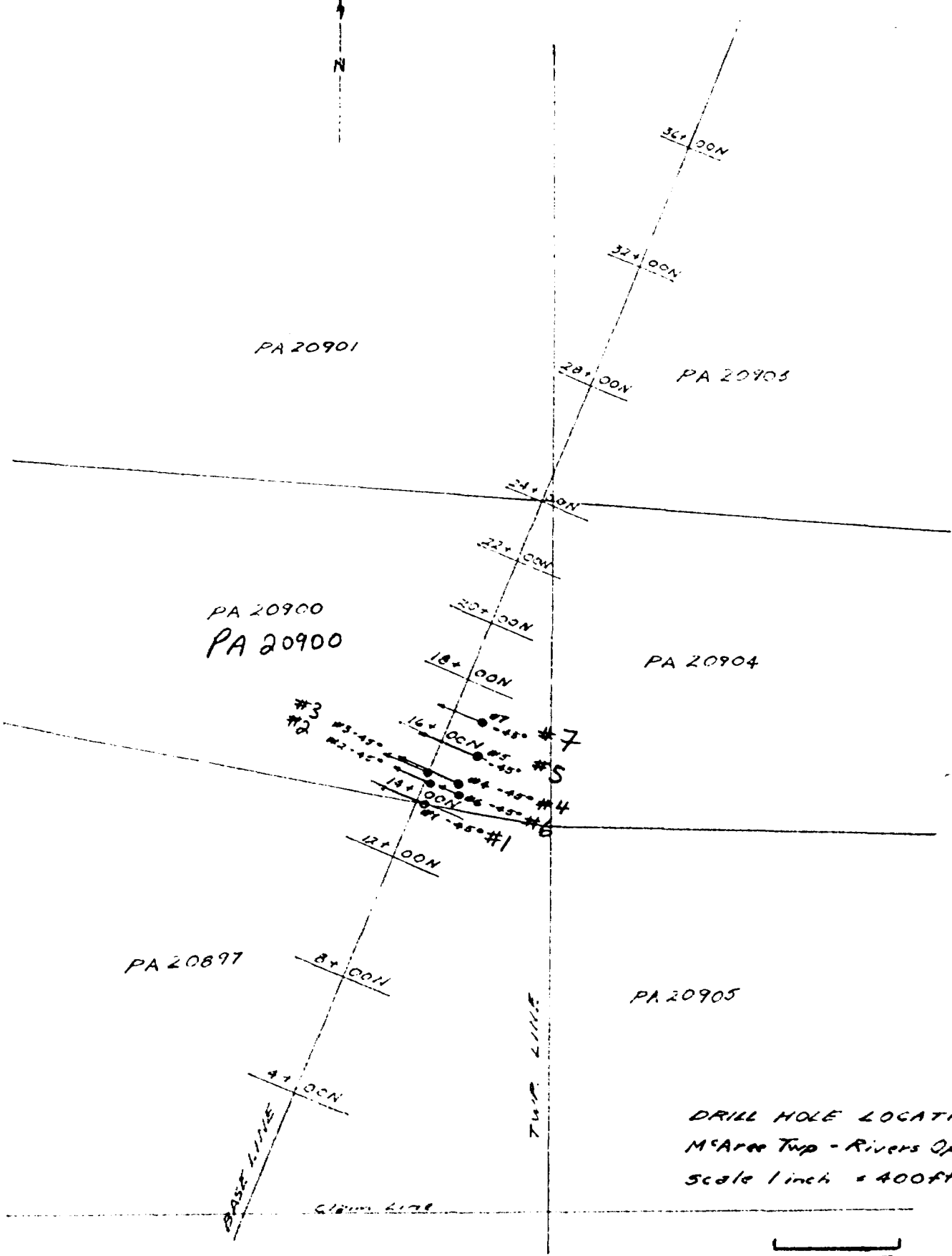

PA 20901

PA 20905

PA 20900  
PA 20900

PA 20904

PA 20897

PA 20905

DRILL HOLE LOCATIONS  
M<sup>c</sup>Area Twp - Rivers Option  
Scale 1 inch = 400ft.

1" = 400ft.

