



52G11NW0002 63.5900 ENGLISH LAKE

010

**SURPRISE LAKE PROPERTY**

**WORK REPORT**

**November, 1991**  
**B. D'Silva BSc**

Figure  
(from Speed, 1985)

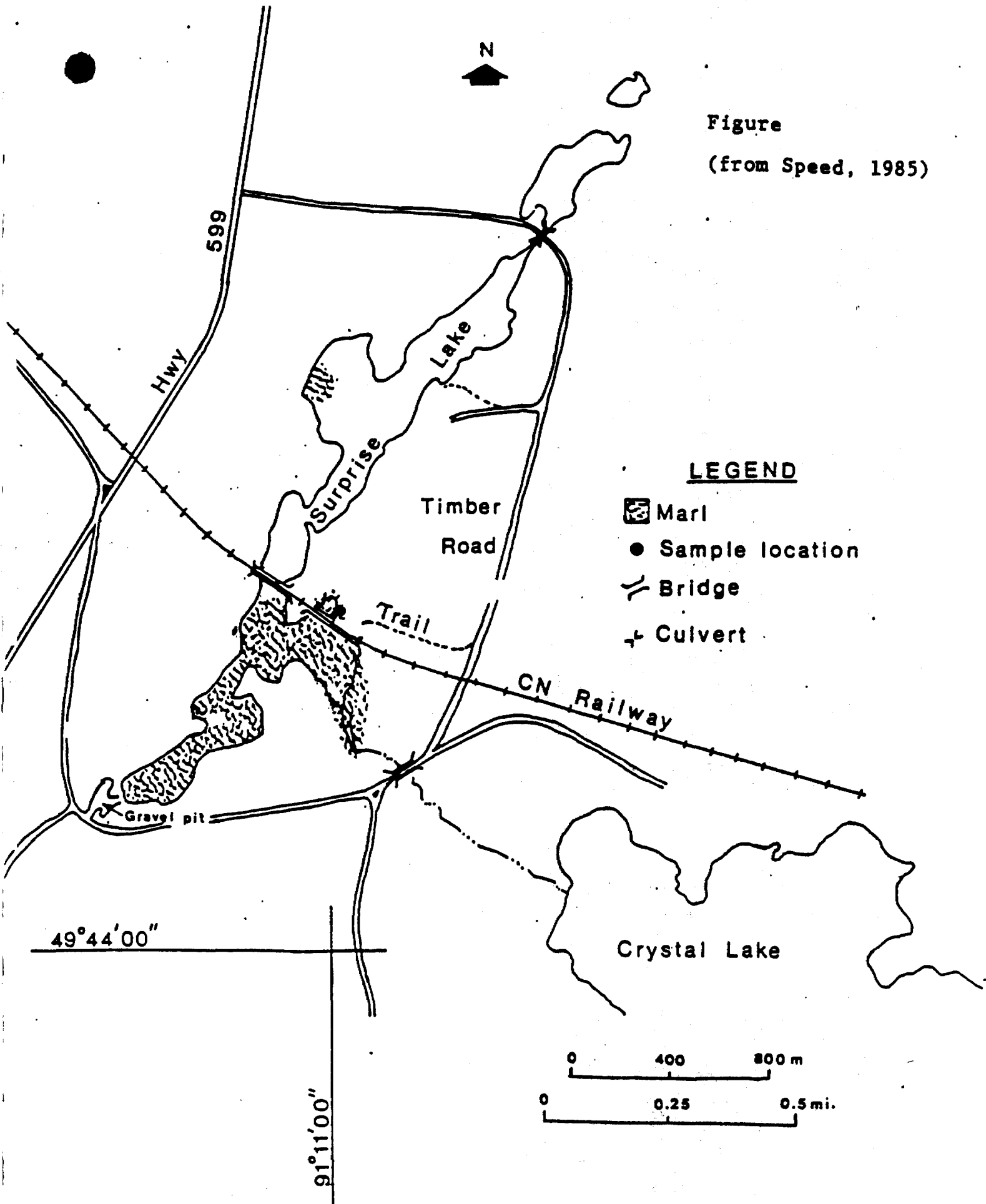

Sketch map of the Surprise Lake marl occurrence.

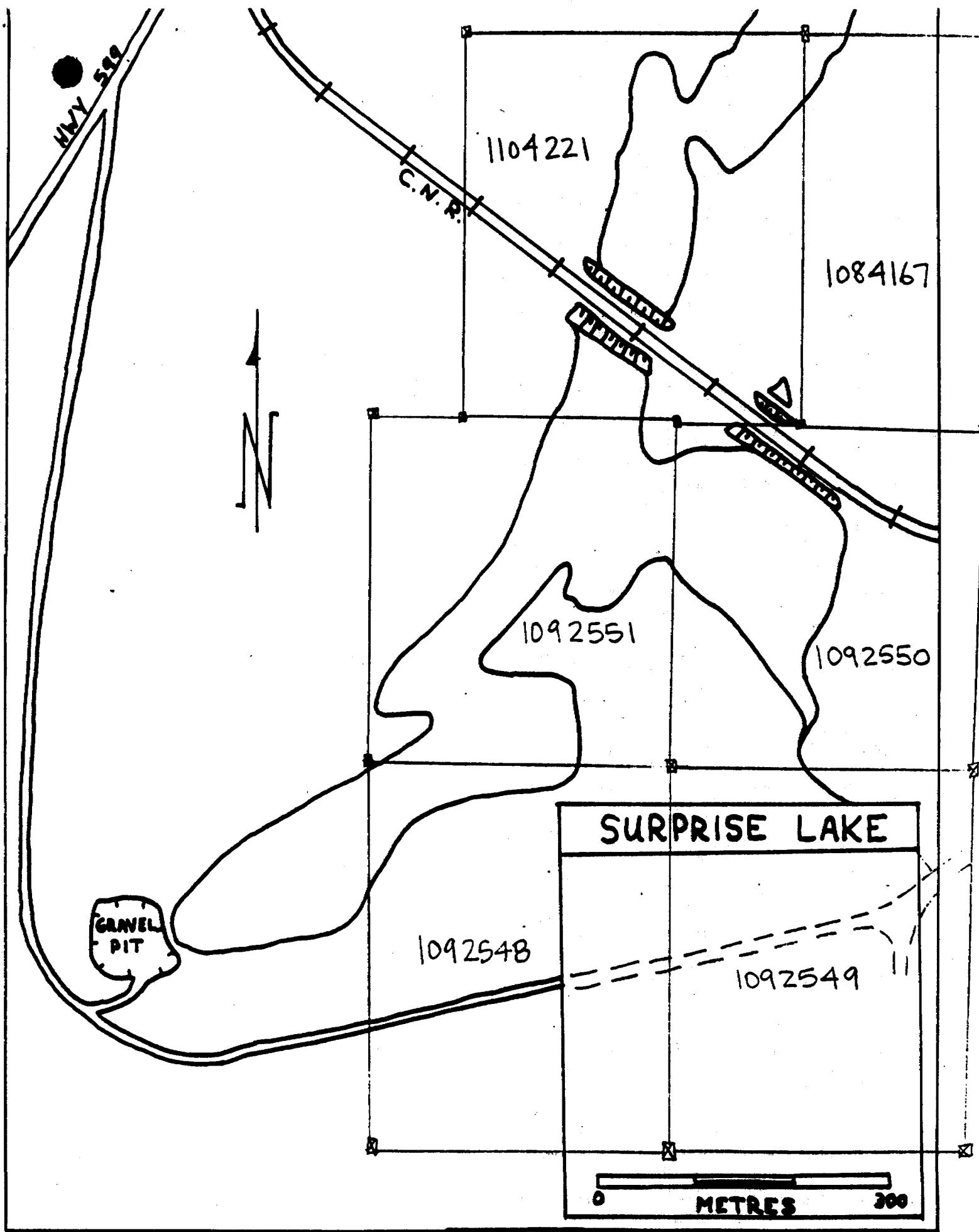

## LOCATION AND ACCESS

Surprise Lake is located east of Highway 500 about 70 km southeast of Sioux Lookout and 50 km north of Ignace in the Kenora Mining Division.

**Claim map sheet:** G2565 Valora Lake and G2540 English Lake

**NTS:** 52 G/11, 52 G/14

## GEOLOGY

The area under study is glacial drift covered Archean shield terrain. The Surprise Lake marl deposit occurs as an extensive sediment layer on the bottom of the south part of Surprise Lake and in a low wet area north of the railroad tracks (see map).

The marl is composed of a calcium carbonate silt and variable amounts of organics and silica sand. The marl bed varies greatly in thickness, up to 3m, and typically overlays sand and minor gravel. An organic layer, up to 0.5m in thickness, locally overlays the marl. Water depth is 1.0 to 3.0m. Testing of the marl bed has outlined several areas where the thickness and volume of the marl bed may be sufficient to sustain production.

## **WORK DONE**

**A seven day program of trenching and stripping was undertaken on the Surprise Lake property. Sixteen samples were obtained and analyzed for  $\text{CaCO}_3$ ,  $\text{MgCO}_3$ , and organics. Two days were required for data analysis, drafting, and report preparation.**

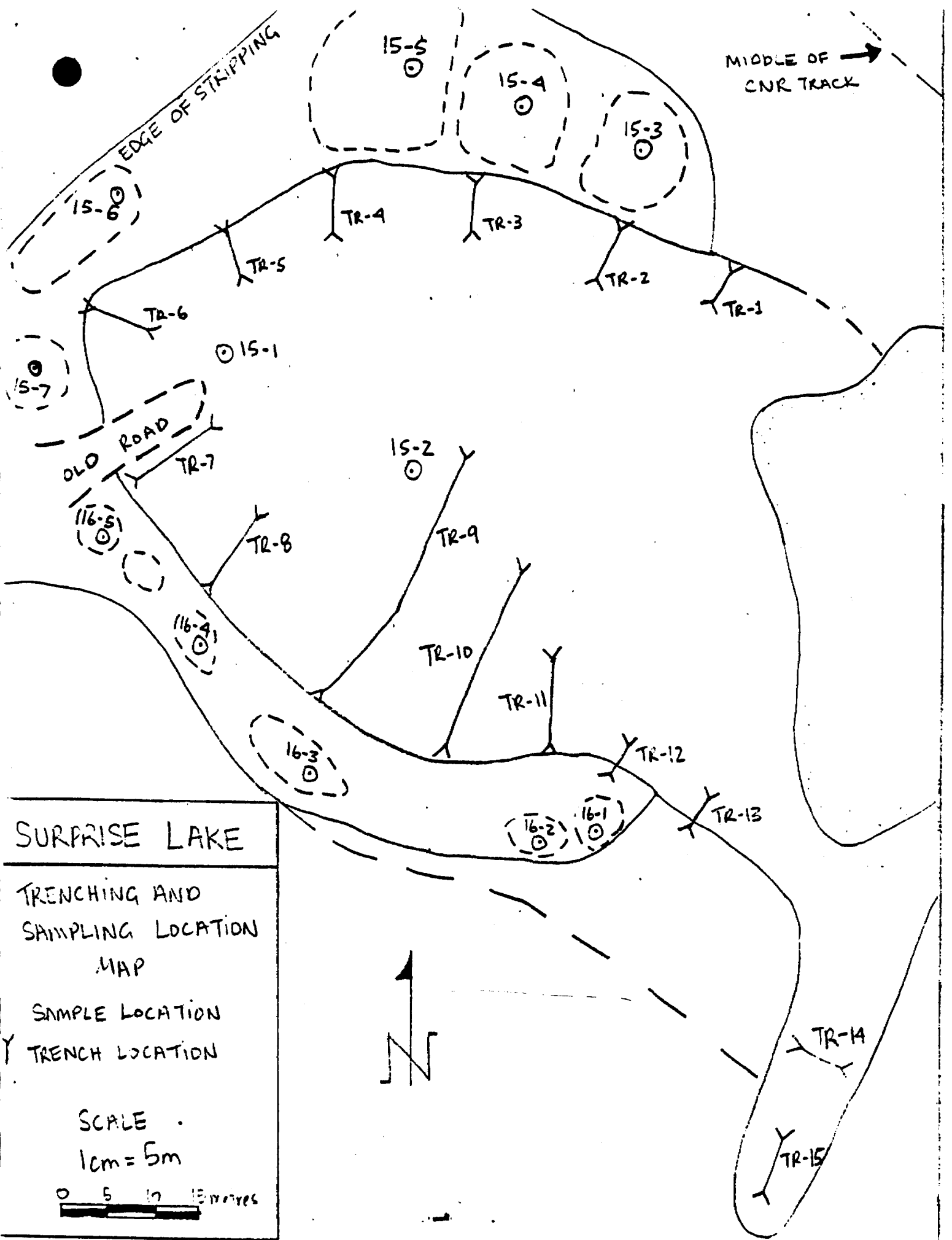

**SURPRISE LAKE**

TRENCHING AND  
SAMPLING LOCATION  
MAP

○ SAMPLE LOCATION  
Y TRENCH LOCATION

SCALE .  
1cm = 5m

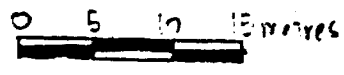

## CERTIFICATE OF QUALIFICATIONS

I, Barbara D'Silva, of 365 Lark Street, Thunder Bay, Ontario, certify that I have BSc, majoring Geology and that I hold a valid Ontario Prospector License. I have 10 years of field experience in Exploration Geology and have been an active participant in the work performed on this property.

Date: \_\_\_\_\_

Signed: \_\_\_\_\_  
B. D'Silva BSc



52G11NW0002 63.5900 ENGLISH LAKE

020

ASSAYS



33 Chauncey Avenue, Toronto, Ontario M8Z 2Z2  
Tel: (416) 239-3527 FAX: (416) 239-4012

25

CERTIFICATE OF ANALYSIS

CERTIFICATE NO. MI-3219-01 DATE: November 5, 1991  
SUBMITTED BY: B. D'Silva  
PROJECT:  
DATE RECEIVED: October 25, 1991 SAMPLES OF: Pulps

SAMPLE NO.:	CaCO3 %	MgCO3 %	Organics %
91-6-6-1	79.69	2.95	4.89
91-6-6-2	88.04	2.51	4.78
91-6-6-3	89.22	2.35	4.40
91-6-6-4	93.81	2.35	4.53
91-6-6-5	92.04	2.15	4.87
91-6-15-1	5.88	.98	36.95
91-6-15-2	10.99	1.37	64.40
91-6-15-3	93.74	2.45	2.69
91-6-15-4	90.49	2.32	2.88

  
-----  
J. van Erpelen Mgr



**T.S.L. LABORATORIES**  
(DIVISION OF ASSAYERS CORP.)

**SPECIALISTS IN MINERAL ENVIRONMENTS**  
CHEMISTS • ASSAYERS • ANALYSTS • GEOCHEMISTS

TELEPHONE (604) 980-5814 OR (604) 988-4524  
FAX (604) 980-9821

**SMITHERS LAB.:**  
3178 TATLOW ROAD  
SMITHERS, B.C. CANADA V0J 2N0  
TELEPHONE (604) 847-3004  
FAX (604) 847-3006

**Geochemical Analysis Certificate**

**1V-0636-BG1**

Company: **T.S.L.**  
Project: **B. D'SILVA TB-1602**  
Attn: **BARB D'SILVA**

Copy 1. **BARB D'SILVA**  
2. **D. PARKER**

Date: **AUG-15-91**

**We hereby certify the following Geochemical Analysis of 17 SOIL/MUD samples submitted JUL-04-91 by BARB D'SILVA.**

Sample Number	CO3 %	TOTAL CA %	TOTAL MG %	*O.C %
91-06-0-1	18.64	19.61	.61	1.37
91-06-0-2	14.19	20.67	.53	1.31
91-06-0-3	15.54	20.93	.52	1.25
91-06-0-4	19.79	21.10	.46	2.21
91-06-0-5	21.64	20.92	.45	1.38
91-06-15-1	TRACE	3.15	.27	.174
91-06-15-2	TRACE	4.20	.18	.343
91-06-15-3	45.97	20.95	.47	7.79
91-06-15-4	16.59	20.95	.49	.796
91-06-15-5	23.53	20.30	.52	.902
91-06-15-6	15.34	19.71	.46	1.37
91-06-15-7	17.89	20.77	.47	1.32
91-06-16-1	15.14	16.97	.53	2.11
91-06-16-2	22.03	19.70	.45	2.34
91-06-16-3	20.54	21.04	.47	1.97
91-06-16-4	14.49	20.39	.46	2.30
91-06-16-5	14.64	16.76	.47	1.95

\*O.C = ORGANIC CARBON

Certified by 

REPORT NO. 20147

DATE RECEIVED: 19/07/91  
DATE PRINTED: 01/08/91

SUBMITTED BY:  
**BARBARA D'SILVA**

SUBMITTED FOR:

YOUR SAMPLE NUMBER **1** LABORATORY NUMBER **771317**

TEST RESULTS		FERTILIZER RECOMMENDATIONS					
TEST	RESULTS	OPTION 1		OPTION 2		OPTION 3	
SOL PH		<b>5.1</b>		<b>INSUFFICIENT INFORMATION</b>		<b>TONS PER ACRE</b>	
BUFFER PH		<b>5.4</b>		<b>TONS PER ACRE</b>		<b>TONS PER ACRE</b>	
TOTAL SALTS		LAST CROP		LAST CROP		LAST CROP	
n ppm		ACRES		ACRES		ACRES	
SODIUM		OMAF REC	AFL REC	OMAF REC	AFL REC	OMAF REC	AFL REC
% ORGANIC MATTER		Kg/ha	Before	Kg/ha	Before	Kg/ha	Before
NITRATE N		N	0				
PHOSPHOROUS		P <sub>2</sub> O <sub>5</sub>	0				
POTASSIUM		K <sub>2</sub> O	0				
MAGNESIUM		Mg	0				
CALCIUM		Ca	lime (t/ha)	9	lime (t/ha)	lime (t/ha)	
SULPHATES		SO <sub>4</sub>					
ZINC		Zn					
MANGANESE		Mn					
COPPER		Cu					
IRON		Fe					
BORON		B					
ACTUAL % BASE SATURATION OF CEC							
% POTASSIUM		% MAGNESIUM		% CALCIUM		CEC OF SOIL	
		2		53		43	
GRAPH OF TEST RESULTS							
		DEFICIENT	LOW	ABSOLUTE	EXTRAVAGANT	EXCESSIVE	

NITRATE N  
PHOSPHOROUS \*\*\*\*\*  
POTASSIUM \*\*\*\*\*  
MAGNESIUM \*\*\*\*\*  
CALCIUM \*\*\*\*\*  
SULPHATES \*\*\*\*\*  
ZINC  
MANGANESE  
COPPER  
IRON  
BORON

THE YIELD OF ANY CROP IS CONTROLLED BY MANY FACTORS OTHER THAN PLANT NUTRITION. STATING A YIELD GOAL IS NOT A GUARANTEE THAT YIELD LEVELS WILL BE ACHIEVED.  
Agri-Food Laboratories' recommendations may vary from OMAF recommendations due in part to differing yield goals and modifying influences of many factors such as pH, organic matter and cation exchange capacity (CEC), etc.

A magnesium recommendation has been printed to serve as a warning of possible magnesium shortages which may hurt yield or delay maturity. Crop observation and plant tissue testing is advised.

**BARBARA D'SILVA**  
365 LARK STREET  
THUNDERBAY, ONTARIO  
P7B1P4

CASH RECEIVED FOR TESTS 668.00  
GST # R124245911 RECEIVED \*



SUBMITTED BY:  
**BARBARA D'SILVA**

SUBMITTED FOR:

YOUR SAMPLE NUMBER **2** LABORATORY NUMBER **771318**

TEST RESULTS		FERTILIZER RECOMMENDATIONS					
TEST	RESULTS	OPTION 1		OPTION 2		OPTION 3	
		INSUFFICIENT INFORMATION PER ACRE		TONS PER ACRE		TONS PER ACRE	
		LAST CROP		LAST CROP		LAST CROP	
		ACRES		ACRES		ACRES	
SOIL PH	5.7						
BUFFER PH	5.8						
TOTAL SALTS							
	In ppm.						
SODIUM		OMAF REC	AFL REC	OMAF REC	AFL REC	OMAF REC	AFL REC
% ORGANIC MATTER	81.7	Kg/ha	lb/acre	Kg/ha	lb/acre	Kg/ha	lb/acre
NITRATE N		N	0	0			
PHOSPHOROUS	8	P <sub>2</sub> O <sub>5</sub>	0	0			
POTASSIUM	35	K <sub>2</sub> O	0	0			
MAGNESIUM	137	Mg	0	0			
CALCIUM	3820	Ca	lime (t/ha)	4	lime (t/ha)	lime (t/ha)	
SULPHATES		SO <sub>4</sub>					
ZINC		Zn					
MANGANESE		Mn					
COPPER		Cu					
IRON		Fe					
BORON		B					

ACTUAL % BASE SATURATION OF CEC

% POTASSIUM	% MAGNESIUM	% CALCIUM	CEC OF SOIL
	3	65	45

GRAPH OF TEST RESULTS

DEFICIENT      LOW      ADEQUATE      EXTRAVAGANT      EXCESSIVE

NITRATE N  
PHOSPHOROUS \*\*\*\*\*  
POTASSIUM \*\*\*\*\*  
MAGNESIUM \*\*\*\*\*  
CALCIUM \*\*\*\*\*  
SULPHATES  
ZINC  
MANGANESE  
COPPER  
IRON  
BORON

THE YIELD OF ANY CROP IS CONTROLLED BY MANY FACTORS OTHER THAN PLANT NUTRITION. STATING A YIELD GOAL IS NOT A GUARANTEE THAT YIELD LEVELS WILL BE ACHIEVED.  
Agri-Food Laboratories' recommendations may vary from DMAF recommendations due in part to differing yield goals and modifying influences of many factors such as pH, organic matter and cation exchange capacity (CEC), etc.

BARBARA D'SILVA  
365 LARK STREET  
THUNDERBAY, ONTARIO  
P7B1P4

CASH RECEIVED FOR TESTS \$68.00  
GST # R124245911 RECEIVED \*



REPORT NO. 20147

DATE RECEIVED: 19/07/91  
DATE PRINTED: 01/08/91

SUBMITTED BY:  
**BARBARA D'SILVA**

SUBMITTED FOR:

YOUR SAMPLE NUMBER **3** LABORATORY NUMBER **771319**

TEST RESULTS		FERTILIZER RECOMMENDATIONS					
TEST	RESULTS	OPTION 1		OPTION 2		OPTION 3	
SOIL PH	7.6	INSUFFICIENT INFORMATION					
		TONS PER ACRE		TONS PER ACRE		TONS PER ACRE	
BUFFER PH		LAST CROP		LAST CROP		LAST CROP	
TOTAL SALTS		ACRES		ACRES		ACRES	
	In ppm	OMAF REC	AFL REC	OMAF REC	AFL REC	OMAF REC	AFL REC
		Kg/ha	lb/acre	Kg/ha	lb/acre	Kg/ha	lb/acre
% ORGANIC MATTER	3.1						
NITRATE N		N	0	0			
PHOSPHOROUS	1	P <sub>2</sub> O <sub>5</sub>	0	0			
POTASSIUM	11	K <sub>2</sub> O	0	0			
MAGNESIUM	59	Mg	0	0			
CALCIUM	4713	Ca					
SULPHATES		SO <sub>4</sub>					
ZINC		Zn					
MANGANESE		Mn					
COPPER		Cu					
IRON		Fe					
BORON		B					
ACTUAL % BASE SATURATION OF CEC							
% POTASSIUM		% MAGNESIUM	2	% CALCIUM	93	CEC OF SOIL	25
GRAPH OF TEST RESULTS							
		DEFICIENT	LOW	ADEQUATE	EXTRAVAGANT	EXCESSIVE	

NITRATE N \*\*\*\*\*  
 PHOSPHOROUS \*\*\*\*\*  
 POTASSIUM \*\*\*\*\*  
 MAGNESIUM \*\*\*\*\*  
 CALCIUM \*\*\*\*\*  
 SULPHATES \*\*\*\*\*  
 ZINC \*\*\*\*\*  
 MANGANESE \*\*\*\*\*  
 COPPER \*\*\*\*\*  
 IRON \*\*\*\*\*  
 BORON \*\*\*\*\*

THE YIELD OF ANY CROP IS CONTROLLED BY MANY FACTORS OTHER THAN PLANT NUTRITION. STATING A YIELD GOAL IS NOT A GUARANTEE THAT YIELD LEVELS WILL BE ACHIEVED.  
 Agri-Food Laboratories' recommendations may vary from OMAF recommendations due in part to differing yield goals and modifying influences of many factors such as pH, organic matter and cation exchange capacity (CEC), etc.

BARBARA D'SILVA  
 365 LARK STREET  
 THUNDERBAY, ONTARIO  
 P7B1P4

CASH RECEIVED FOR TESTS \$65.00  
 GST # R124245911 RECEIVED \$



REPORT NO. 20147

DATE RECEIVED: 19/07/91  
DATE PRINTED: 01/08/91

SUBMITTED BY:  
**BARBARA D'SILVA**

SUBMITTED FOR:

YOUR SAMPLE NUMBER **4** LABORATORY NUMBER **771320**

TEST RESULTS		FERTILIZER RECOMMENDATIONS					
TEST	RESULTS	OPTION 1		OPTION 2		OPTION 3	
SOIL PH	<b>8.0</b>	INSUFFICIENT INFORMATI TONS PER ACRE		TONS PER ACRE		TONS PER ACRE	
BUFFER PH		LAST CROP		LAST CROP		LAST CROP	
TOTAL SALTS		ACRES		ACRES		ACRES	
	in ppm.	OMAF REC	AFL REC	OMAF REC	AFL REC	OMAF REC	AFL REC
% ORGANIC MATTER	<b>2.5</b>	Kg/ha	lbs/acre	Kg/ha	lbs/acre	Kg/ha	lbs/acre
NITRATE N		N	0				
PHOSPHOROUS	<b>1</b>	P <sub>2</sub> O <sub>5</sub>	0				
POTASSIUM	<b>10</b>	K <sub>2</sub> O	0				
MAGNESIUM	<b>61</b>	Mg	0				
CALCIUM	<b>3995</b>	Ca					
SULPHATES		SO <sub>4</sub>					
ZINC		Zn					
MANGANESE		Mn					
COPPER		Cu					
IRON		Fe					
BORON		B					

ACTUAL % BASE SATURATION OF CEC

% POTASSIUM	% MAGNESIUM <b>2</b>	% CALCIUM <b>92</b>	CEC OF SOIL <b>22</b>
-------------	----------------------	---------------------	-----------------------

GRAPH OF TEST RESULTS

DEFICIENT      LOW      ADEQUATE      EXTRAVAGANT      EXCESSIVE

NITRATE N  
PHOSPHOROUS \*\*\*\*\*  
POTASSIUM \*\*\*\*\*  
MAGNESIUM \*\*\*\*\*  
CALCIUM \*\*\*\*\*  
SULPHATES  
ZINC  
MANGANESE  
COPPER  
IRON  
BORON

THE YIELD OF ANY CROP IS CONTROLLED BY MANY FACTORS OTHER THAN PLANT NUTRITION. STATING A YIELD GOAL IS NOT A GUARANTEE THAT YIELD LEVELS WILL BE ACHIEVED.

Agri-Food Laboratories' recommendations may vary from OMAF recommendations due in part to differing yield goals and modifying influences of many factors such as pH, organic matter and cation exchange capacity (CEC), etc.

**BARBARA D'SILVA**  
365 LARK STREET  
THUNDERBAY, ONTARIO  
P7B1P4

CASH RECEIVED FOR TESTS      \$68.00  
GST # R124245911 RECEIVED \*



Ministry of  
Northern Development  
and Mines

# Report of Work Conducted After Recording Claim

Transaction Number

W9210-005

Mining Act

Personal information collected on this form is obtained under the authority of the  
this collection should be directed to the Provincial Manager, Mining Lands, Mi  
Sudbury, Ontario, P3E 6A5, telephone (705) 670-7264.



52G11NW0002 63.5900 ENGLISH LAKE

900

- Instructions:**
- Please type or print and submit in duplicate.
  - Refer to the Mining Act and Regulations for requirements of filing assessment work or consult the Mining Recorder.
  - A separate copy of this form must be completed for each Work Group.
  - Technical reports and maps must accompany this form in duplicate.
  - A sketch, showing the claims the work is assigned to, must accompany this form.

Recorded Holder(s) <b>DOUGLAS PARKER / BARBARA D'SILVA</b>		Client No. <b>179595/123550</b>
Address <b>365 LARK STREET, THUNDER BAY, ON, P7B1P4</b>		Telephone No. <b>(807) 345-3860</b>
Mining Division <b>KENORA</b>	Township/Area <b>ENGLISH LAKE <del>Q-2540</del></b>	M or G Plan No. <b>9-2540</b>
Dates Work Performed From: <b>JUNE 10, 1991</b>		To: <b>JUNE 16, 1991</b>

**Work Performed (Check One Work Group Only)**

Work Group	Type
<input type="checkbox"/> Geotechnical Survey	
<input checked="" type="checkbox"/> Physical Work, including Drilling	<b>TRENCHING + STRIPPING WITH BACKHOE</b>
<input type="checkbox"/> Rehabilitation	
<input type="checkbox"/> Other Authorized Work	
<input checked="" type="checkbox"/> Assays	
<input type="checkbox"/> Assignment from Reserve	

ONTARIO GEOLOGICAL SURVEY  
 GIS - ASSESSMENT FILES  
 JAN 20 1992  
**RECEIVED**

Total Assessment Work Claimed on the Attached Statement of Costs \$ 7708.70 7678

**Note:** The Minister may reject for assessment work credit all or part of the assessment work submitted if the recorded holder cannot verify expenditures claimed in the statement of costs within 30 days of a request for verification.

**Persons and Survey Company Who Performed the Work (Give Name and Address of Author of Report)**

Name	Address
<b>B. D'SILVA</b>	<b>365 LARK ST, THUNDER BAY, ON, P7B1P4</b>
<b>D. PARKER</b>	" "

(attach a schedule if necessary)

**Certification of Beneficial Interest \* See Note No. 1 on reverse side**

I certify that at the time the work was performed, the claims covered in this work report were recorded in the current holder's name or held under a beneficial interest by the current recorded holder.	Date <b>Dec 19/91</b>	Recorded Holder or Agent (Signature) <b>B. D'Silva</b>
----------------------------------------------------------------------------------------------------------------------------------------------------------------------------------------------------------	--------------------------	-----------------------------------------------------------

**Certification of Work Report**

I certify that I have a personal knowledge of the facts set forth in this Work report, having performed the work or witnessed same during and/or after its completion and annexed report is true.

Name and Address of Person Certifying <b>DOUG PARKER 365 LARK ST, THUNDER BAY ONT</b>		
Telephone No. <b>807-345-3860</b>	Date <b>DEC 19/1991</b>	Certified by (Signature) <b>D. Parker</b>

**For Office Use Only**

Total Value Cr. Recorded <b>\$ 7678</b>	Date Recorded <b>Dec 24/91</b>	Mining Recorder <b>Scott Rivett</b>	<b>KENORA</b> MINING DIV. <b>RECEIVED</b> DEC 24 1991 AM PM 7891011 12123456
	Deemed Approval Date	Date Approved <b>January 15/92</b>	
	Date Notice for Amendments Sent <b>January 7/92</b>		







Ministry of  
Northern Development  
and Mines

Ministère du  
Développement du Nord  
et des mines

*- Charlene -*  
**Statement of Costs  
for Assessment Credit**

**État des coûts aux fins  
du crédit d'évaluation**

Transaction No./N° de transaction

*W9210-005*

**Mining Act/Loi sur les mines**

Personal information collected on this form is obtained under the authority of the Mining Act. This information will be used to maintain a record and ongoing status of the mining claim(s). Questions about this collection should be directed to the Provincial Manager, Minings Lands, Ministry of Northern Development and Mines, 4th Floor, 159 Cedar Street, Sudbury, Ontario P3E 6A5, telephone (705) 870-7264.

Les renseignements personnels contenus dans la présente formule sont recueillis en vertu de la Loi sur les mines et serviront à tenir à jour un registre des concessions minières. Adresser toute question sur la collecte de ces renseignements au chef provincial des terrains miniers, ministère du Développement du Nord et des Mines, 159, rue Cedar, 4<sup>e</sup> étage, Sudbury (Ontario) P3E 6A5, téléphone (705) 870-7264.

**1. Direct Costs/Coûts directs**

Type	Description	Amount Montant	Totals Total global
Wages Salaires	Labour Main-d'oeuvre		
	Field Supervision Supervision sur le terrain	1200.00	1200.00
Contractor's and Consultant's Fees Droits de l'entrepreneur et de l'expert- conseil	Type		4935.60
	PERKHOE		4725.60
	ASSAYS	68.00 272.45 492.00	932.85
Supplies Used Fournitures utilisées	Type		6758.45
Equipment Rental Location de matériel	Type		
			6398.45
<b>Total Direct Costs Total des coûts directs</b>			<b>6768.45</b>

**2. Indirect Costs/Coûts indirects**

\*\* Note: When claiming Rehabilitation work indirect costs are not allowable as assessment work.  
Pour le remboursement des travaux de réhabilitation, les coûts indirects ne sont pas admissibles en tant que travaux d'évaluation.

Type	Description	Amount Montant	Totals Total global
Transportation Transport	Type		
	CAR	681.00	
<b>Sub Total of Indirect Costs Total partiel des coûts indirects</b>			<b>681.00</b>
Food and Lodging Nourriture et hébergement		360.00	629.25
		269.25	269.25
Mobilization and Demobilization Mobilisation et démobilisation			
<b>Amount Allowable (not greater than 20% of Direct Costs) Montant admissible (n'excédant pas 20 % des coûts directs)</b>			<b>1310.25</b>
<b>Total Value of Assessment Credit (Total of Direct and Allowable indirect costs)</b>			<b>950.25</b>
<b>Valueur totale du crédit d'évaluation (Total des coûts directs et indirects admissibles)</b>			<b>1277.70</b>
			<b>7678.14</b>

Note: The recorded holder will be required to verify expenditures claimed in this statement of costs within 30 days of a request for verification. If verification is not made, the Minister may reject for assessment work all or part of the assessment work submitted.

Note : Le titulaire enregistré sera tenu de vérifier les dépenses demandées dans le présent état des coûts dans les 30 jours suivant une demande à cet effet. Si la vérification n'est pas effectuée, le ministre peut rejeter tout ou une partie des travaux d'évaluation présentés.

**Filing Discounts**

1. Work filed within two years of completion is claimed at 100% of the above Total Value of Assessment Credit.
2. Work filed three, four or five years after completion is claimed at 50% of the above Total Value of Assessment Credit. See calculations below:

Total Value of Assessment Credit	Total Assessment Claimed
	x 0.50 =

**Remises pour dépôt**

1. Les travaux déposés dans les deux ans suivant leur achèvement sont remboursés à 100 % de la valeur totale susmentionnée du crédit d'évaluation.
2. Les travaux déposés trois, quatre ou cinq ans après leur achèvement sont remboursés à 50 % de la valeur totale du crédit d'évaluation susmentionné. Voir les calculs ci-dessous.

Valeur totale du crédit d'évaluation	Evaluation totale demandée
	x 0,50 =

**Certification Verifying Statement of Costs**

I hereby certify:  
that the amounts shown are as accurate as possible and these costs were incurred while conducting assessment work on the lands shown on the accompanying Report of Work form.

that as Recorded Holder I am authorized  
(Recorded Holder, Agent, Position in Company)

to make this certification

**Attestation de l'état des coûts**

J'atteste par la présente :  
que les montants indiqués sont le plus exact possible et que ces dépenses ont été engagées pour effectuer les travaux d'évaluation sur les terrains indiqués dans la formule de rapport de travail ci-joint.

Et qu'à titre de \_\_\_\_\_ je suis autorisé  
(titulaire enregistré, représentant, poste occupé dans la compagnie)

à faire cette attestation.

Signature B. D'Silva Date Dec 18, 1991

