



52G11NW0003 2.14018 ENGLISH LAKE

010

English Lake Property

27 February 1991
B.D. Silva BSc

RECEIVED

MAR 06 1991

MINING LANDS SECTION

2.14018

Introduction

There are only approximately twenty known occurrences of marl in northwestern and northeastern Ontario. Only a few of these occurrences have received any evaluation as mineral deposits. The potential market for this material in the control of acid emissions and in the treatment of acid lakes in northern Ontario is excellent.

Marl is a very fine grained water saturated calcium carbonate aggregate. Its physical properties make it extremely effective in the neutralization of acid soils and waters.

Acid effluent and runoff is discharged into the environment by many industries. Base metal producing mines have particular problems with acid control and tailings rehabilitation.

The presence of acid lakes in northeastern Ontario provides great potential for the use of marl as a neutralizing agent. Current Ministry of the Environment projects include "liming" lakes with "man made" marl and report excellent results.

Results and Recommendations

Seven areas of marl accumulation have been outlined in and adjacent to Surprise Lake. Further sampling is required to accurately delineate the size and grade of these deposits.

Location and Access

Surprise Lake is located east of highway 599 about 70 km southeast of Sioux Lookout and 50 km north of Ignace in the Kenora Mining Division.

Claim map sheet: 62565 Valora Lake and 62540 English Lake

NTS: 52 G/11, 52 G/14

Geology

The area under study is glacial drift covered Archean shield terrain. The Surprise Lake marl deposit occurs as an extensive sediment layer on the bottom of the south part of Surprise Lake and in a low wet area north of the railroad tracks. (See map)

The marl is composed of a calcium carbonate silt and variable amounts of organics and silica sand. The marl bed varies greatly in thickness, up to 3m, and typically overlays sand and minor gravel. An organic layer, up to 0.5m in thickness, locally overlays the marl. Water depth is 1.0 to 3.0m.

Testing of the marl bed has outlined several areas where the thickness and volume of the marl bed may be sufficient to sustain production.

KENORA — NORTHWESTERN REGION

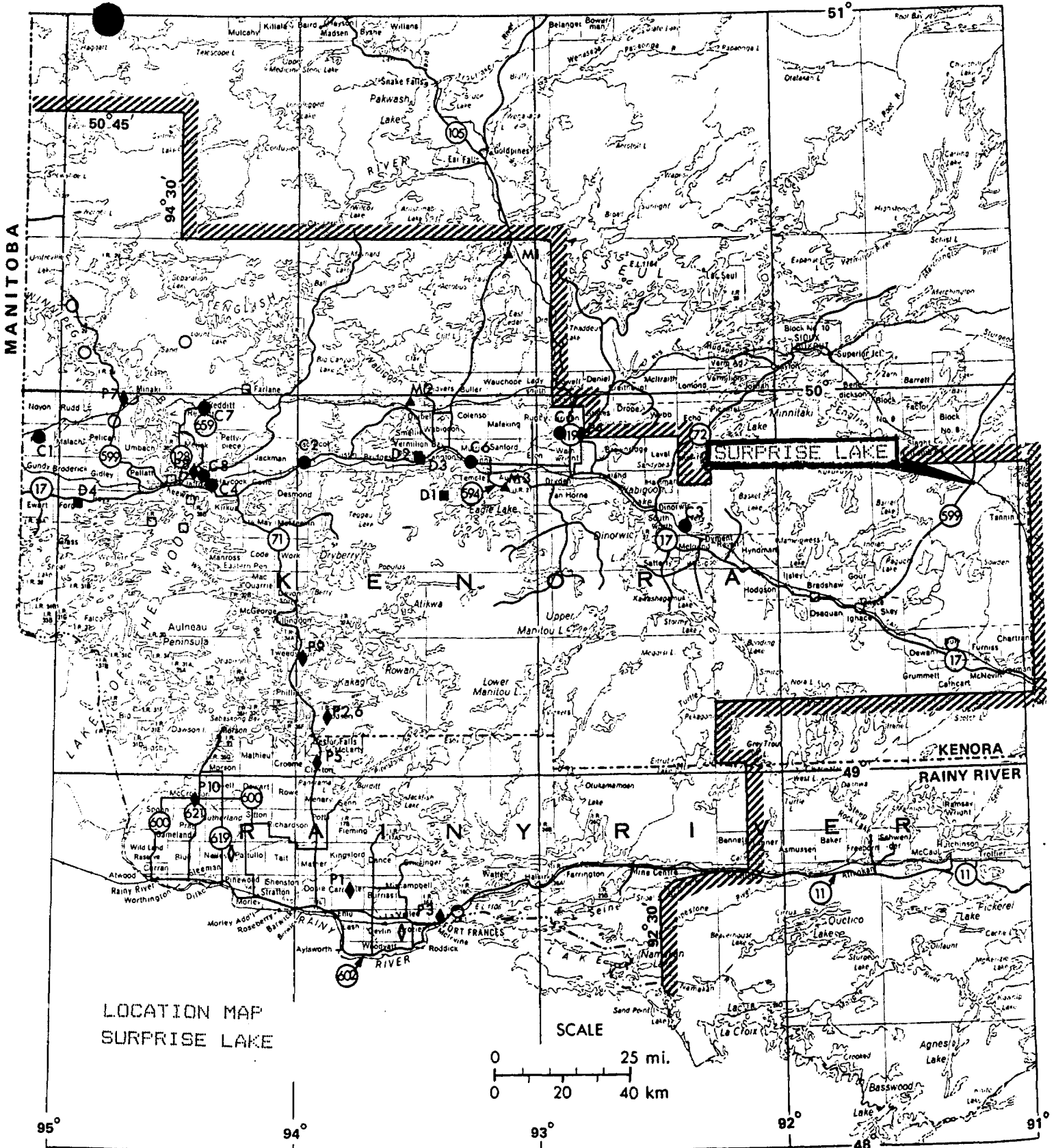

LOCATION MAP
SURPRISE LAKE

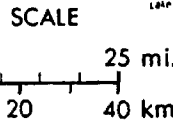

EXPLANATION

- Crushed Stone Quarry - Producer
- Crushed Stone Quarry - Past Producer
- Dimension Stone Quarry - Producer
- Dimension Stone Quarry - Past Producer
- ▲ Miscellaneous Rock Quarry (Boulders)
- ▨ Boundary of Resident Geologist's Area
- ◆ Peat / Black Soil Quarry - Producer
- ◇ Peat / Black Soil Quarry - Past Producer

Work Done

A 7 day program of prospecting and sampling was undertaken on the Surprise Lake property. 18 samples were obtained and analyzed for CaCO_3 , MgCO_3 , and organics. 4 days were required for data analysis, drafting and report preparation.

Marl Sampling Techniques

Sampling was facilitated with a 4" post hole auger on land and a 1" piston type sampler for lake sediments. Composite grab samples were taken over the vertical thickness of the marl bed and are considered to be a representative section. Numerous soundings were taken with steel rods, to provide a good indication of the lateral extent of the marl bed. Due to the low number of samples taken in any one zone of accumulation, grade and volume estimates should be considered to be approximate only.

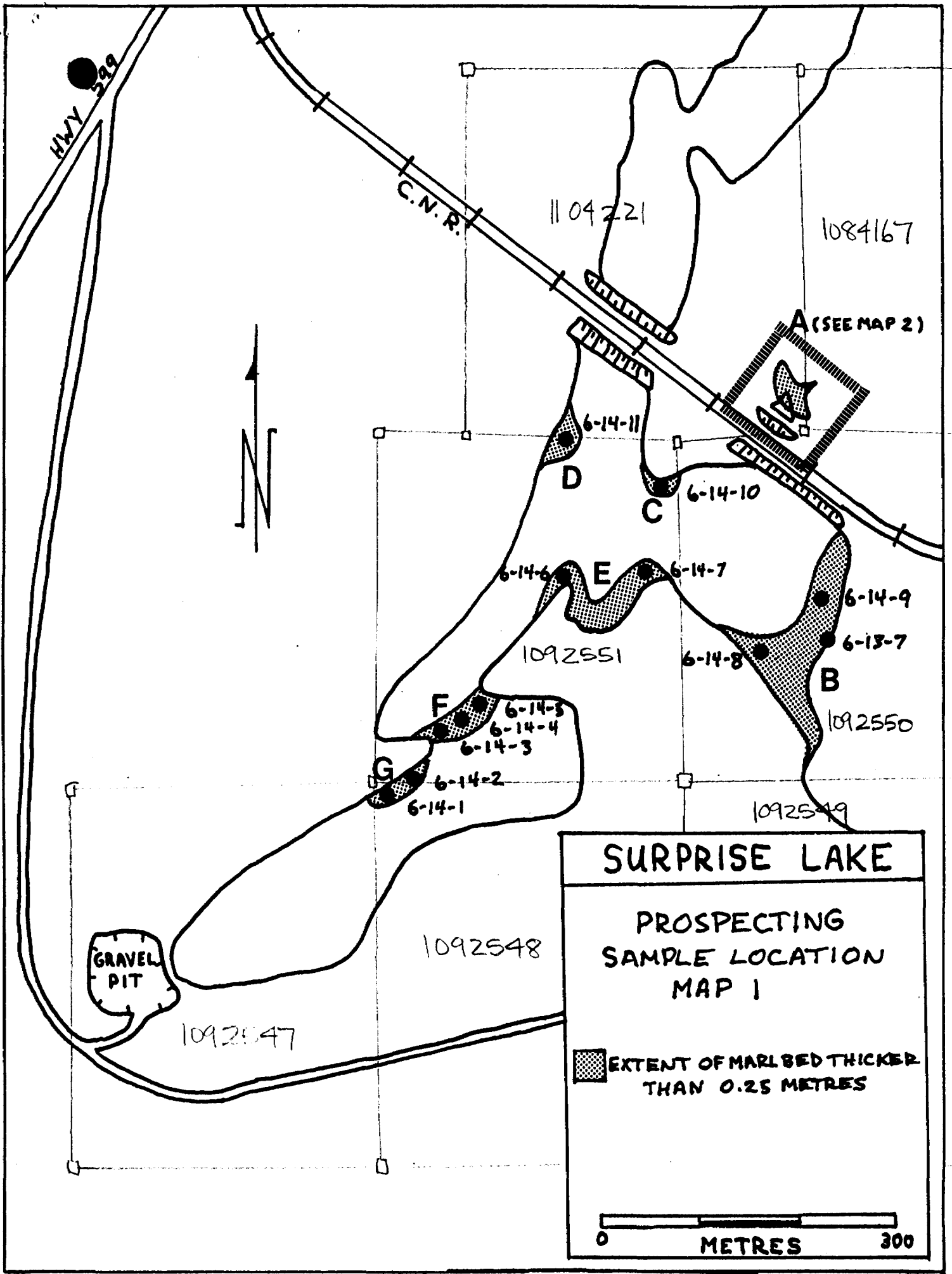

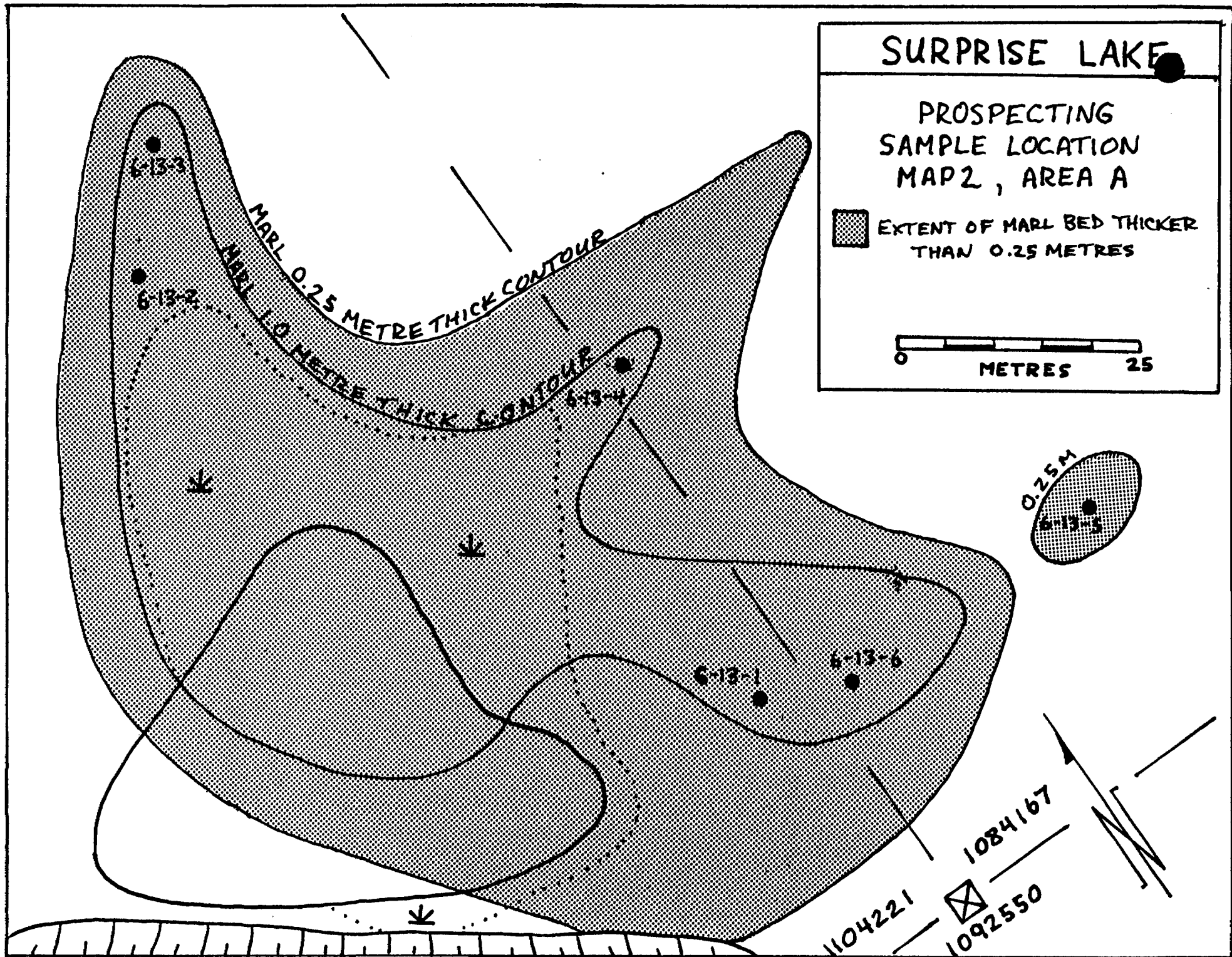

APPENDIX



ASSAYERS ONTARIO LABORATORIES

A DIVISION OF ASSAYERS CORPORATION LTD.

33 CHAUNCEY AVENUE, TORONTO, ONTARIO M8Z 2Z2 • TELEPHONE (416) 239-3527
FAX (416) 239-4012

Certificate of Analysis

Certificate No. MI-4001 -01/ 1637 Date: November 20, 1990
Received 101 Samples of Marl
Submitted by B. D'Silva / D. Parker

Sample No.	CaCO ₃	MgCO ₃	Organics
6-13-1	84.55	1.42	3.29
-2	81.00	1.39	5.40
-3	78.26	1.39	14.10
-4	48.81	1.52	14.08
-5	87.17	1.58	5.32
-6	10.09	0.36	62.38
6-14-1	46.90	1.58	2.49
-2	84.72	1.39	4.50
-3	91.91	1.39	4.03
-4	87.56	1.22	4.38
-5	91.79	1.32	4.67
-6	91.36	1.39	5.58
-7	87.39	1.49	6.23
-8	87.56	1.45	5.30
-9	85.40	1.39	6.93
-10	90.56	1.45	5.45
-11	86.03	1.42	5.44
6-24-1	71.61	1.85	6.44
-2	85.55	1.49	7.77

ASSAYERS ONTARIO LABORATORIES

Per

J. van Engelen Mgr.

INVOICE

A 1637



ASSAYERS ONTARIO LABORATORIES

33 CHAUNCEY AVENUE, TORONTO, ONTARIO M8Z 2Z2
TELEPHONE (416) 239-3527 • FAX (416) 239-4012

DATE	DATE	YEAR	SHIPPED VIA
20	11	90	

SOLD TO ▶

B. D'Silva / D. Parker

365 - Lark St.

Thunder Bay, Ontario

P7B 1P4

1.5% LATE CHARGE OVER 30
DAYS (ANNUAL RATE 18%)

RECEIVED

MAY 21 1991

#8

MINING LANDS SECTION

QUANTITY	DESCRIPTION	UNIT PRICE	AMOUNT
101	Assays CaCO ₃ and MgCO ₃	\$15.00	\$1515.00
101	Assays Organics	\$ 5.00	\$ 505.00
101	Assays Sample Prep	\$ 3.75	\$ 378.75
	Cert. No. MI-4001		
	November 20/1990		
	Thank You!		
	TOTAL		\$2398.75

*Paid
BUD.*

Certification of Qualifications

I, Barbara D'Silva, of 365 Lark Street, Thunder Bay, Ontario, certify that I have BSc ,majoring in Geology and that I hold a valid Ontario Prospector license. I have 10 years of field experience in Exploration Geology and have been an active participant in the work performed on this property.

Date: March 1, 1991

Signed: B. D'Silva
B. D'Silva BSc

DOUGLAS PARKER
W 10 031
2.14018



Mining Act
Report of Work
(Geophysical, Geological and Geochemical Surveys)

attach a list.
Technical Reports and maps in duplicate should be submitted to Mining Lands Section, Mineral Development and Lands Branch:

Type of Survey(s)	Mining Division KENORA	Township or Area ENGLISH LAKE G.2540
Recorded Holder(s) DOUGLAS PARKER / BARBARA D'SILVA	Prospector's Licence No. E32324/E32650	
Address 365 LARK ST	Telephone No. (807) 345-3860	
Survey Company SELF		
Name and Address of Author (of Geo-Technical Report) AS ABOVE	Date of Survey (from & to) 12 06 90 14 06 90 Day Mo. Yr. Day Mo. Yr.	

Credits Requested per Each Claim in Columns at right

Mining Claims Traversed (List in numerical sequence)

Special Provisions	Geophysical	Days per Claim
For first survey: Enter 40 days. (This includes line cutting)	- Electromagnetic	
	- Magnetometer	
For each additional survey: using the same grid:	- Other	
Enter 20 days (for each)	Geological	
	Geochemical	
Man Days	Geophysical	Days per Claim
Complete reverse side and enter total(s) here	- Electromagnetic	
	- Magnetometer	
	- Other	
	Geological	
	Geochemical	19.6
Airborne Credits	Electromagnetic	Days per Claim
Note: Special provisions credits do not apply to Airborne Surveys.	Magnetometer	
	Other	
Total miles flown over claim(s).		
Date	Recorded Holder or Agent (Signature)	

Mining Claim		Mining Claim		Mining Claim	
Prefix	Number	Prefix	Number	Prefix	Number
K	1109221				
K	1084167				
K	109248				
K	1092550				
K	1092551				

ONTARIO GEOLOGICAL SURVEY
GIS - ASSESSMENT FILES
MAY 28 1991
RECEIVED

Total number of mining claims covered by this report of work. **5**

Certification Verifying Report of Work

I hereby certify that I have a personal and intimate knowledge of the facts set forth in this Report of Work, having performed the work or witnessed same during and/or after its completion and annexed report is true.

Name and Address of Person Certifying
B. D'Silva 365 Lark St Thunder Bay, Ont.

Telephone No. **(807) 345-3860** Date **March 22, 1991** Certified By (Signature) **B. D'Silva**

For Office Use Only

Total Days Cr. Recorded 98	Date Recorded Mar 25/91	Mining Recorder McLemay/acting
	Date Approved as Recorded May 21/91	Provincial Manager, Mining Lands Ron C. Goshinski

KENORA MINING DIV
RECEIVED
MAR 25 1991
70910112128450

Mining Lands
Report of Work
(Expenditures, Subsection 77(19)) **2.14018**

Instructions
- Please type or print.
- Refer to Subsection 77(19), the Mining Act for assessment work requirements and maximum credits allowed under this Subsection.
- Technical Reports, maps and proof of expenditures in duplicate should be submitted to Mining Lands Section, Mineral Development and Lands Branch.

Type of Work Performed SEDIMENT SAMPLING	Mining Division KENORA	Township or Area ENGLISH LAKE G.2540
Recorded Holder B. D'SILVA / D. PARKER		Prospector's Licence No. E32650/E3232A
Address 365 LARK STREET, THUNDER BAY		Telephone No. (807) 345-3860
Work Performed By SELF		
Name and Address of Author (of Submission) SELF		Date When Work was Performed From: 12 06 90 To: 14 06 90 Day Mo. Yr. Day Mo. Yr.

All the work was performed on Mining Claim(s): Indicate no. of days performed on each claim. *See Note No. 1 on reverse side				Mining Claim K1092548	No. of Days 5.38	Mining Claim K1092551	No. of Days 5.38	Mining Claim K1092550	No. of Days 5.38	Mining Claim K1084167	No. of Days 5.38
Mining Claim	No. of Days	Mining Claim	No. of Days	Mining Claim	No. of Days	Mining Claim	No. of Days	Mining Claim	No. of Days	Mining Claim	No. of Days
K1109221	5.38										
Mining Claim	No. of Days	Mining Claim	No. of Days	Mining Claim	No. of Days	Mining Claim	No. of Days	Mining Claim	No. of Days	Mining Claim	No. of Days

Instructions Total days credits may be distributed at claim holder's choice. Enter number of days credits per claim in the expenditure days credit column (below).	Calculation of Expenditure Days Credits		Total Days Credits	Total Number of Mining Claims Covered by this Report of Work
	Total Expenditures \$ 403.75	+ 15	= 26.9	61

Mining Claims (List in numerical sequence). If space is insufficient, attach schedules with required information

Mining Claim Prefix	Mining Claim Number	Expend. Days Cr.	Mining Claim Prefix	Mining Claim Number	Expend. Days Cr.	Mining Claim Prefix	Mining Claim Number	Expend. Days Cr.	Mining Claim Prefix	Mining Claim Number	Expend. Days Cr.
K	1092548	—									
K	1092550	—									
K	1092551	—									
K	1084167	—									
K	1109221	—									
K	1092549	26.9									

RECEIVED
APR 03 1991

Total Number of Days Performed 26.9	Total Number of Days Claimed 26.9	Number of Days to be Claimed at a Future Date 0
---	---	---

Certification of Beneficial Interest *See Note No. 2 on reverse side

I hereby certify that, at the time the work was performed, the claims covered in this report of work were recorded in the current recorded holder's name or held under a beneficial interest by the current recorded holder.	Date MARCH 1, 1991	Recorded Holder or Agent (Signature) B. D'Silva
--	------------------------------	---

Certification Verifying Report of Work

I hereby certify that I have a personal and intimate knowledge of the facts set forth in the Report of Work annexed hereto, having performed the work or witnessed same during and/or after its completion and the annexed report is true.		
Name and Address of Person Certifying B. D'Silva 365 LARK ST THUNDER BAY, ONTARIO P7B 1P4		
Telephone No. (807) 345-3860	Date March 1, 1991	Certified By (Signature) B. D'Silva

For Office Use Only

Total Days Cr. Recorded 26.9	Date Recorded Mar 4/91	Mining Recorder ME Lemay (acting)
	Date Approved as Recorded May 21/91	Provincial Manager, Mining Lands Ross C. Goshinski

KENORA MINING DIV.
RECEIVED
MAR 04 1991
AM 7891011 12123456 PM



Instructions

- Please type or print.
- Refer to Subsection 77(19), the Mining Act for assessment work requirements and maximum credits allowed under this Subsection.
- Technical Reports, maps and proof of expenditures in duplicate should be submitted to Mining Lands Section, Mineral Development and Lands Branch.

Report of Work
(Expenditures, Subsection 77(19))

Type of Work Performed SEDIMENT SAMPLING	Mining Division KENORA	Township or Area ENGLISH LAKE
Recorded Holder B. D'SILVA / D. PARKER	Prospector's Licence No. E32650/E32324	
Address 365 LARK STREET, THUNDER BAY	Telephone No. (807) 345-3860	
Work Performed By SELF	Date When Work was Performed From: 12 06 90 To: 14 06 90 Day Mo. Yr. Day Mo. Yr.	
Name and Address of Author (of Submission) SELF		

All the work was performed on Mining Claim(s): Indicate no. of days performed on each claim. *See Note No. 1 on reverse side				Mining Claim K1092548	No. of Days	Mining Claim K1092551	No. of Days	Mining Claim K1092550	No. of Days	Mining Claim K1084167	No. of Days
Mining Claim K1104221	No. of Days	Mining Claim	No. of Days	Mining Claim	No. of Days	Mining Claim	No. of Days	Mining Claim	No. of Days	Mining Claim	No. of Days
Mining Claim	No. of Days	Mining Claim	No. of Days	Mining Claim	No. of Days	Mining Claim	No. of Days	Mining Claim	No. of Days	Mining Claim	No. of Days

Instructions Total days credits may be distributed at claim holder's choice. Enter number of days credits per claim in the expenditure days credit column (below).	Calculation of Expenditure Days Credits		Total Days Credits	Total Number of Mining Claims Covered by this Report of Work
	Total Expenditures \$ 403.75	÷ 15	= 26.9	6

Mining Claims (List in numerical sequence). If space is insufficient, attach schedules with required information

Prefix	Mining Claim Number	Expend. Days Cr.	Prefix	Mining Claim Number	Expend. Days Cr.	Prefix	Mining Claim Number	Expend. Days Cr.	Prefix	Mining Claim Number	Expend. Days Cr.
K	1092548	—									
K	1092550	—									
K	1092551	—									
K	1084167	—									
K	1104221	—									
K	1092549	26.9									

COPY

RECEIVED 13/15

MAR 06 1991

Total Number of Days Performed 26.9	Total Number of Days Claimed 26.9	Total Number of Days to be Claimed at a Future Date MINING LANDS SECTION
---	---	--

Certification of Beneficial Interest *See Note No. 2 on reverse side

I hereby certify that, at the time the work was performed, the claims covered in this report of work were recorded in the current recorded holder's name or held under a beneficial interest by the current recorded holder.	Date MARCH 1, 1991	Recorded Holder or Agent (Signature) B. D'Silva
--	------------------------------	---

Certification Verifying Report of Work

I hereby certify that I have a personal and intimate knowledge of the facts set forth in the Report of Work annexed hereto, having performed the work or witnessed same during and/or after its completion and the annexed report is true.

Name and Address of Person Certifying B. D'Silva 365 LARK ST THUNDER BAY, ONTARIO P7B 1P4	Telephone No. (807) 345-3860	Date March 1, 1991	Certified By (Signature) B. D'Silva
---	--	------------------------------	---

Received Stamp

For Office Use Only

Total Days Cr. Recorded	Date Recorded	Mining Recorder
	Date Approved as Recorded	Provincial Manager, Mining Lands

Instructions
 - Please type or print.
 - For each type of work performed, a separate Report of Work should be completed.
 - For Geo-technical work, use form no. 1362 "Report of Work (Geological, Geophysical, Geochemical)" and form no. 878 for Expenditures.
 - Refer to Sections 76 and 77, the Mining Act for assessment work requirements and the reverse side of this form for table of information.

Mining Act Report of Work

Name and Address of Recorded Holder BARBARA D'SILVA / DOUGLAS PARKER 365 LARK STREET, THUNDER BAY	Prospector's Licence No. E32650 / E32324 Telephone No. (807) 345-3860
---	--

Summary of Distribution of Credits and Work Performance

Mining Division KENORA	Mining Claim		Work Days Cr.	Mining Claim		Work Days Cr.	Mining Claim		Work Days Cr.
	Prefix	Number		Prefix	Number		Prefix	Number	
Township or Area ENGLISH LAKE	K	1092548	—						
Total Assessment Credits Claimed	K	1092551	—						
Type of Work Performed (Check one only) <input checked="" type="checkbox"/> Manual Work <input type="checkbox"/> Shaft Sinking Drifting or other Lateral Work <input type="checkbox"/> Mechanical equipment <input type="checkbox"/> Power Stripping other than Manual (maximum credit allowed - 100 days per claim) <input type="checkbox"/> Diamond or other Core drilling <input type="checkbox"/> Core Specimens	K	1092550	—						
	K	1084167	40						
	K	1104221	40						
	K	1092549	10						

COPY

Dates when work was performed From: 12/06/90 To: 14/06/90	Total No. of Days Performed 98	Total No. of Days Claimed 98	Total No. of Days to be Claimed at a Future Date 0
--	--	--	--

All the work was performed on Mining Claim(s): Indicate no. of days performed on each claim. * (See note No. 1 on reverse side)									
Mining Claim	No. of Days	Mining Claim	No. of Days	Mining Claim	No. of Days	Mining Claim	No. of Days	Mining Claim	No. of Days
K1092548	20	K1092551	20	K1092550	20	K1084167	20		
K1104221	20								

Required information eg. type of equipment, Names, Addresses, etc. (See Table on reverse side)
 If space below is insufficient, attach schedules with required information and location sketches

B. D'Silva 365 Lark Street, Thunder Bay Dates worked 12/06/90-14/06/90 incl.
D. Parker 365 Lark Street, Thunder Bay Dates worked 12/06/90-14/06/90 incl.

RECEIVED
 MAR 06 1991
 MINING LANDS SECTION

Certification of Beneficial Interest * (See Note No. 2 on reverse side)

I hereby certify that, at the time the work was performed, the claims covered in this report of work were recorded in the current recorded holder's name or held under a beneficial interest by the current recorded holder.	Date March 1, 1991	Recorded Holder or Agent (Signature) B. D'Silva
--	------------------------------	---

Certification Verifying Report of Work

I hereby certify that I have a personal and intimate knowledge of the facts set forth in the Report of Work annexed hereto, having performed the work or witnessed same during and/or after its completion and the annexed report is true.

Name and Address of Person Certifying B. D'Silva 365 LARK ST. THUNDER BAY, ONT. P7B1P4	Telephone No. (807) 345-3860	Date March 1, 1991	Certified By (Signature) B. D'Silva
--	--	------------------------------	---

For Office Use Only

Work Assignments	Received Stamp
------------------	----------------

Man Days Assessment Work Details MINING LANDS SECTION

Summary of Assessment Credits:

Total 8 hour Technical Days (including Consultants, Draughting, etc.).....

Calculation:

$$\frac{14}{\text{Technical}} * 7 = \frac{98}{\text{Number of Claims}}$$

$$= \frac{2 \times 40 + 1 \times 18}{\text{Assessment credits per claim}} = 98$$

1. Fieldwork:

Type of Work Name and Address Dates Worked Number of 8 hour days

Manual work	B. D'Silva	365 Lark St	12/06/90-14/06/90 incl.	3
Manual work	D. Parker	365 Lark St	12/06/90-14/06/90 incl.	3

2. Draughtsman, Typing, Other (specify)

typing-report prep.	B. D'Silva		7/12/90-10/12/90 incl.	4
drafting-report prep.	D. Parker		7/12/90-10/12/90 incl.	4

Total 8 hour man days: 14



Ministry of Northern Development and Mines

Mining Claim

Entered Checked
Mining Act

Claim No.
K.1092548

Recorded in the Name of JOLY, Ron O.		Licence No. M.23587	Date Recorded April 6, 1989
Address R.R. #11, Site #10, Box #13 Thunder Bay, Ontario P7B 5E2		Date and Time of Staking March 18, 1989 @3:00p.m.	
Office Use Only	Days Recorded	Description of Claim	
Assessment Work Credits Assigned to other Claims		ENGLISH LAKE G.2540	
		Reservations - 400 foot Surface Rights reservation around all lakes and rivers Sand, gravel and peat reserved. INCLUDING LAND UNDER WATER 5 EXCLUDING ROAD 6	
		File No. 1092547	

Date	Days Work	
1 Apr. 28/89		(T10) Ron O. Joly (M.23587) transfers 60% to Doug Parker (E.32324) (1092547)
2 Apr. 28/89		(T10) Ron O. Joly (M.23587) transfers 40% to Barbara D'Silva (E.32650) (1092547)
3 Apr. 17/90		(OC5) Commissioner extends time until and including June 6, 1990 for work and filing thereof. (E.9001.64) APPROVED JUL 27 1990
May 3/90	60	(X77-19) Section 77(19) Expenditures (W.9001.205)

This Abstract is copy of the entries in the Record Books and is not to be considered as assurance of the validity of the claim

MAR 11 1991
Scott Russell
MINING RECORDER



Mining Act

Claim No. **K.1104221**

Recorded in the Name of LARIVIERE, Joseph C.		Licence No. E.31835	Date Recorded April 6, 1989
Address R.R. #11, Site #10, Box #13 Thunder Bay, Ontario		Date and Time of Staking March 19, 1989 @10:30a.m.	P.T. X
Office Use Only		Days Recorded	Balance
Assessment Work Credits Assigned to other Claims			
Description of Claim ENGLISH LAKE G.2540			
Reservations - 400 foot Surface Rights reservation around all lakes and rivers. Sand, gravel and peat reserved. INCLUDING LAND UNDER WATER 5			
			File No. 1104220

Date	Days Work	
1 Apr. 28/89		(T10) Joe Lariviere (E.31835) transfers 60% to Doug Parker (E.32324) (1104220)
2 Apr. 28/89		(T10) Joe Lariviere (E.31835) transfers 40% to Barbara D'Silva (E.32650) (1104220)
3 Apr. 17/90		(OC5) Commissioner extends time until and including June 6, 1990 for work and filing thereof. (E.9001.64) APPROVED JUL 27 1990
May 3/90	60	(X77-19) Section 77(19) Expenditures (W.9001.205)

This Abstract is copy of the entries in the Record Books and is not to be considered an assurance of the validity of the claim.

MAR 11 1991

Keith Rivett
MINING RECORDER

- HIGHWAY AND ROUTE No.
- OTHER ROADS
- TRAILS
- SURVEYED LINES:
 - TOWNSHIPS, BASE LINES, ETC.
 - LOTS, MINING CLAIMS, PARCELS, ETC.
- UNSURVEYED LINES
- LOT LINES
- PARCEL BOUNDARY
- MINING CLAIMS ETC.
- RAILWAY AND RIGHT OF WAY
- UTILITY LINES
- NON-PERENNIAL STREAM
- FLOODING OR FLOODING RIGHTS
- SUBDIVISION OR COMPOSITE PLAN
- RESERVATIONS
- ORIGINAL SHORELINE
- MARSH OR MUSKEG
- MINES
- TRAVERSE MONUMENT

KENORA MINING DIVISION
RECEIVED
 AUG 17 1990
 89 10 11 12 1 2 3 4 5 6

THE INFORMATION THAT APPEARS ON THIS MAP HAS BEEN COMPILED FROM VARIOUS SOURCES AND ACCURACY IS NOT GUARANTEED. THOSE WISHING TO STAKE MINING CLAIMS SHOULD CONSULT WITH THE MINING RECORDER, MINISTRY OF NORTHERN DEVELOPMENT AND MINES, FOR ADDITIONAL INFORMATION ON THE STATUS OF THE LANDS SHOWN HEREON.

DISPOSITION OF CROWN LANDS

TYPE OF DOCUMENT	SYMBOL
PATENT, SURFACE & MINING RIGHTS	
" SURFACE RIGHTS ONLY	
" MINING RIGHTS ONLY	
LEASE, SURFACE & MINING RIGHTS	
" SURFACE RIGHTS ONLY	
" MINING RIGHTS ONLY	
LICENCE OF OCCUPATION	
ORDER-IN-COUNCIL	
RESERVATION	
CANCELLED	
SAND & GRAVEL	

NOTE: MINING RIGHTS IN PARCELS PATENTED PRIOR TO MAY 6 1913, VESTED IN ORIGINAL PATENTEE BY THE PUBLIC LANDS ACT, R.S.O. 1910, CHAP. 380, SEC. 63, SUBSEC.

REFERENCES

- AREAS WITHDRAWN FROM DISPOSITION**
- M.R.O. - MINING RIGHTS ONLY
 - S.R.O. - SURFACE RIGHTS ONLY
 - M+S - MINING AND SURFACE RIGHTS

Description	Order No.	Date	Disposition	File
SAND AND GRAVEL				

SAND AND GRAVEL

QUARRY PERMIT

NOTE

SOUTH PART OF THE WEST PART OF STP BLOCK 7, ORIGINALLY IN THE DISTRICT OF RAINY RIVER, PATENTED TO THE GRAND TRUNK PACIFIC CO. ON MARCH 31, 1909, REFERENCE 13929 AA, WAS AMENDED BY O.C. 2403/51 DATED NOVEMBER 1, 1951 (REFERENCE 372). SAID GRANT WAS VOID AB INITIO DATED AUGUST 2, 1951, TO THE ABITIBI POWER AND PAPER CO. LTD. REFERENCE 115817. PARCELS PREVIOUSLY SOLD BY GRAND TRUNK PACIFIC RAILWAY CO. AND EXCEPTED FROM THE GUIT CLAIM ARE UNDER THE ORIGINAL PATENT 13929AA.

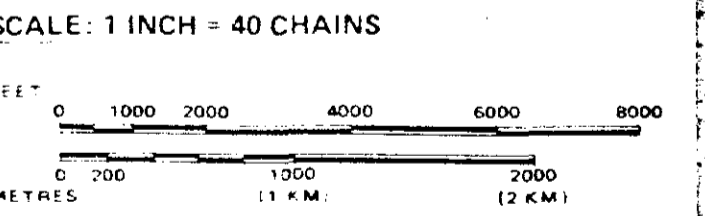

AREA ENGLISH LAKE

M.N.R. ADMINISTRATIVE DISTRICT
 IGNACE
 MINING DIVISION
 KENORA
 LAND TITLES / REGISTRY DIVISION
 KENORA

Ministry of Natural Resources
 Land Management Branch
 Ontario

Date: JANUARY, 1984
 Number: **G-2540**

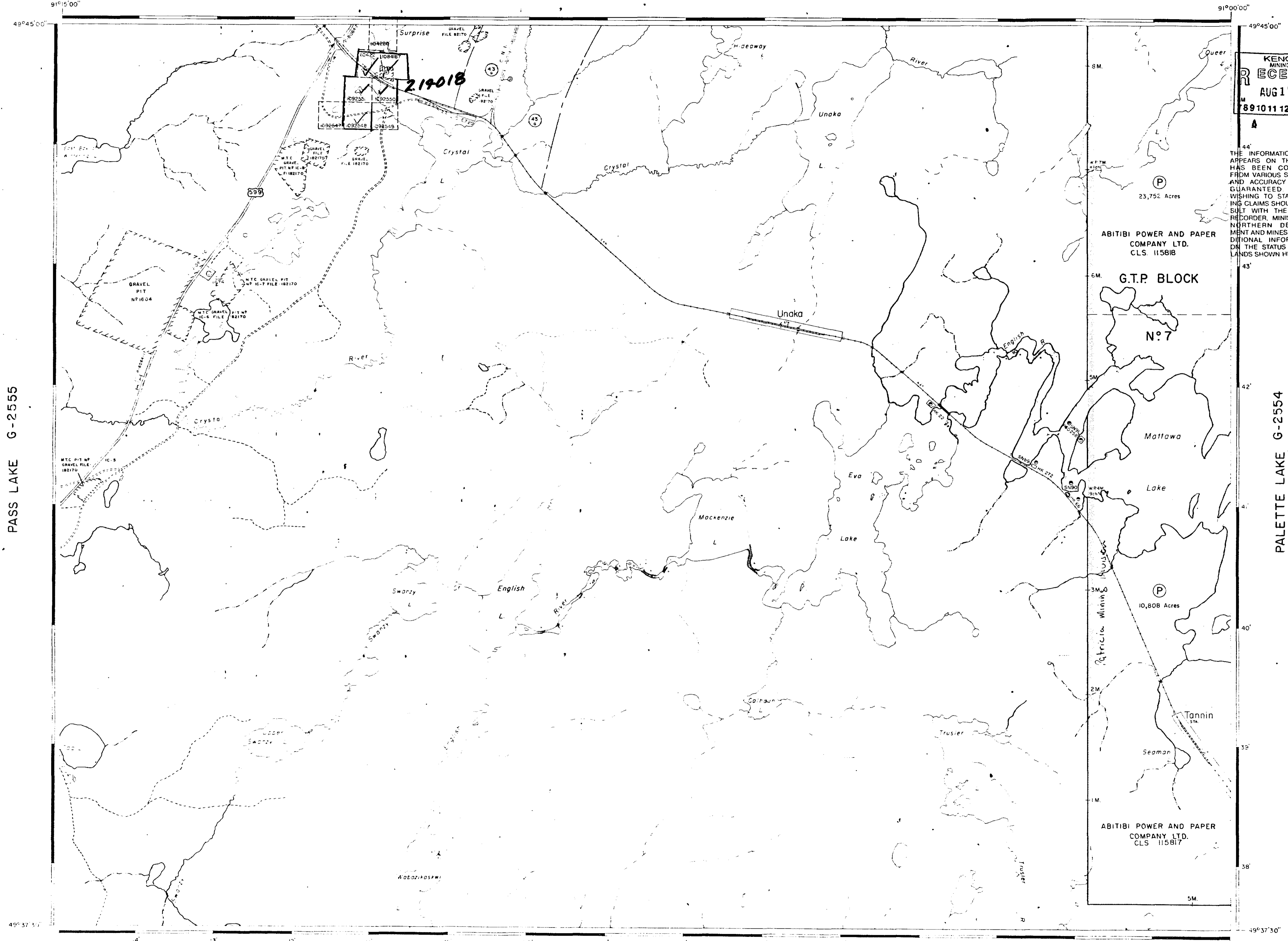

PASS LAKE G-2555

PALETTE LAKE G-2554

